

LAW OFFICES  
ROSE, SUNDSTROM & BENTLEY  
A PARTNERSHIP INCLUDING PROFESSIONAL ASSOCIATIONS  
2548 BLAIRSTONE PINES DRIVE  
TALLAHASSEE, FLORIDA 32301

(904) 877-6555

ORIGINAL  
FILE COPY

CHRIS H. BENTLEY, PA.  
JENNIFER S. BRUBAKER  
F. MARSHALL DETERDING  
BRIAN L. DOSTER  
MARTIN S. FRIEDMAN, PA.  
JOHN R. JENKINS, PA.  
STEVEN T. MINDLIN, PA.  
ROBERT M. C. ROSE  
DAREN L. SHIPPY  
WILLIAM E. SUNDSTROM, PA.  
DIANE D. TREMOR, PA.  
JOHN L. WHARTON

MAILING ADDRESS  
POST OFFICE BOX 1567  
TALLAHASSEE, FLORIDA 32302-1567  
TELECOPIER (904) 656-4029

October 16, 1996

VIA HAND DELIVERY

Blanca S. Bayo, Director  
Division of Records and Reporting  
Florida Public Service Commission  
2540 Shumard Oak Boulevard  
Tallahassee, Florida

961249-1111

Re: Sunrise Water Company, Inc.;  
Application for Grandfather Certificate  
Our File No. 27012.06

Dear Ms. Bayo:

Attached please find the original and 15 copies of the  
Application for Grandfather Certificate filed on behalf of Sunrise  
Water Company, Inc. Also enclosed is a check in the amount of  
\$500 for the appropriate filing fee.

The name and address of the Applicant is:

Sunrise Water Company, Inc.  
P.O. Box 2397  
Winter Park, Florida 32790.

Copies of all correspondence, notices, orders, and other  
communications concerning this Application should be sent to:

John R. Jenkins, Esquire  
Daren L. Shippy, Esquire  
ROSE, SUNDSTROM & BENTLEY  
2548 Blairstone Pines Drive  
Tallahassee, Florida 32301  
(904) 877-6555

Check received with filing and  
forwarded to Fiscal for deposit.  
Fiscal to forward a copy of check  
to RAR with proof of deposit.

Initials of person who forwarded check  
W.S.

Should you have any questions regarding this matter, please  
feel free to call.

RECEIVED & FILED

EPSC-BUREAU OF RECORDS

Enclosure

cc: Mr. Jon Pomerleau

Sincerely,

John R. Jenkins

For the Firm

DOCUMENT NUMBER-DATE

11081 OCT 16 96

FPSC-RECORDS/REPORTING

ACK \_\_\_\_\_  
AFA \_\_\_\_\_  
APP \_\_\_\_\_  
CAF \_\_\_\_\_  
CMU \_\_\_\_\_  
CTR \_\_\_\_\_  
EAG \_\_\_\_\_  
LEG \_\_\_\_\_  
LIN \_\_\_\_\_  
OPC \_\_\_\_\_  
RCH \_\_\_\_\_  
SEC \_\_\_\_\_  
WAS \_\_\_\_\_  
OTH \_\_\_\_\_

LAW OFFICES  
**ROSE, SUNDSTROM & BENTLEY**

A PARTNERSHIP INCLUDING PROFESSIONAL ASSOCIATIONS

2548 BLAIRSTONE PINES DRIVE

TALLAHASSEE, FLORIDA 32301

(904) 877-8555

DEPOSIT TREAS. REC.

DATE

D386 OCT 17 '96

MAILING ADDRESS  
POST OFFICE BOX 1567  
TALLAHASSEE, FLORIDA 32302-1567

TELECOPIER (904) 856-4029

CHRIS H. BENTLEY, P.A.  
JENNIFER S. BRUBAKER  
F. MARSHALL DETERING  
BRIAN L. DOSTER  
MARTIN S. FRIEDMAN, P.A.  
JOHN R. JENKINS, P.A.  
STEVEN T. MINOLIN, P.A.  
ROBERT M. C. ROSE  
DAREN L. SHIPPY  
WILLIAM E. SUNDSTROM, P.A.  
DAVID D. TREMOR, P.A.  
JOHN L. WHARTON

October 16, 1996

VIA HAND DELIVERY

Blanca S. Bayo, Director  
Division of Records and Reporting  
Florida Public Service Commission  
2540 Shumard Oak Boulevard  
Tallahassee, Florida

Re: Sunrise Water Company, Inc.;  
Application for Grandfather Certificate  
Our File No. 27012.06

Dear Ms. Bayo:

Attached please find the original and 15 copies of the Application for Grandfather Certificate filed on behalf of Sunrise Water Company, Inc. Also enclosed is a check in the amount of \$500 for the appropriate filing fee.

The name and address of the Applicant is:

Sunrise Water Company, Inc.  
P.O. Box 2397  
Winter Park, Florida 32790.

Copies of all correspondence, notices, orders, and other communications concerning this Application should be sent to:

John R. Jenkins, Esquire  
Daren L. Shippy, Esquire  
ROSE, SUNDSTROM & BENTLEY

ROSE, SUNDSTROM & BENTLEY 4-87  
ATTORNEYS AT LAW  
P.O. BOX 1567 PH. 877-8555  
TALLAHASSEE, FL 32302-1567

15948

PAY TO THE  
ORDER OF

Florida Public Service Commission

October 16, 1996

63-588/831  
1

\$ \*500.00\*

Five Hundred and 00/100

DOLLARS



680-001  
315 South Coliseum Street  
Tallahassee, Florida 32301

FOR

*[Handwritten signature]*

## BEFORE THE FLORIDA PUBLIC SERVICE COMMISSION

In Re: Application of Sunrise )  
Water Company, Inc. for a )  
Grandfather Certificate. )  
\_\_\_\_\_)

Docket No. \_\_\_\_\_

SUNRISE WATER COMPANY, INC.  
APPLICATION FOR GRANDFATHER CERTIFICATE

Pursuant to Section 367.171 Florida Statutes and Fla. Admin. Code Rule 25-30.035, the undersigned, on behalf of Sunrise Water Company, Inc. files this Application for Grandfather Certificate to the Florida Public Service Commission to operate a water utility in Polk County, Florida, and in support thereof provides the following information:

1. The Utility's complete name and mailing address is:

Sunrise Water Company, Inc.  
P.O. Box 2397  
Winter Park, Florida 32790.

2. The Utility's business organization is a corporation.

3. The names and addresses of all corporate officers and directors are:

a. Macauley Whiting, Jr. - President  
P.O. Box 2397  
Winter Park, Florida 32790

b. Jon T. Pomerleau - Vice President  
P.O. Box 2397  
Winter Park, Florida 32790

The Utility is a wholly owned subsidiary of Whiting Water Works, Inc. P.O. Box 2397 Winter Park, Florida 32790.

4. The Utility was established in 1977.
5. A description of the types of customers served by the utility are single family homes and mobile homes.

DOCUMENT NUMBER-DATE

11081 OCT 16 88

ROSE, SUNDSTROM &amp; BENTLEY

2548 BLAIRSTONE PINES DRIVE, TALLAHASSEE, FLORIDA 32301

FPSC-RECORDS/REPORTING



6. Evidence that the Utility owns the land upon which the utility treatment facilities are located is attached as Exhibit A.

7. An original and two copies of a tariff, containing all rates, classifications, charges, rules, and regulations of the Utility are attached as Exhibit B.

8. Authority for the Utility's current rates and charges is the action of the Polk County Board of County Commissioners sitting as the Polk County Utility Commission approving the Utility's rates and charges on May 24, 1988, a copy of minutes of which is attached as Exhibit C.

9. A description, using township, range, and section references, of the territory the Utility was serving, or was authorized to serve by Polk county on the day Chapter 367, Florida Statutes, became applicable is attached as Exhibit D.

10. One copy of a detailed system map is attached as Exhibit E. One copy of a site plant of the water treatment facilities is attached as Exhibit F.

11. A copy of the official county tax assessment map, or other map showing township, range, and section, with a scale such as 1" = 200', along with the proposed territory plotted thereon by use of metes and bounds or quarter sections and a defined reference point of beginning has not been provided with this Application because the Utility has no such document, the service area consists of a single subdivision, and a detailed legal description has been provided as Exhibit D.



12. A copy of the permit issued by the Florida Department of Environmental Protection for the water system, dated September 21, 1993 is attached as Exhibit G.

13. The Utility currently serves 282 residential customers (homes), each by 5/8" x 3/4" meters, and the service area is built out at this time.

14. The Utility has the capacity to serve from 201 to 500 ERC's, and hereby submits a filing fee in the amount of \$500.00.

15. The name and address of the person authorized to receive notices and communications with respect to this Application is:

John R. Jenkins, Esquire  
Daren L. Shippy, Esquire  
Rose, Sundstrom & Bentley  
2548 Blairstone Pines Drive  
Tallahassee, FL 32301

Respectfully submitted this 16<sup>th</sup> day of October, 1996 by:

ROSE, SUNDSTROM & BENTLEY  
2548 Blairstone Pines Drive  
Tallahassee, Florida 32301  
(904) 877-6555



JOHN R. JENKINS, ESQUIRE  
DAREN L. SHIPPY, ESQUIRE

ORIGINAL  
FILE COPY

**EXHIBIT A**

**This Warranty Deed** Made and executed the 3rd day of May  
SUN ACRES WATER COMPANY, a Florida corporation

A. D. 1990 by

a corporation existing under the laws of Florida, and having its principal place of  
business at 50 Orchid Springs Dr., Winter Haven, Fl.  
hereinafter called the grantor, to  
SUNRISE WATER COMPANY, INC.

R

whose postoffice address is 400 N. New York Ave. Suite 101, Winter Park, Fl.

hereinafter called the grantee (Wherever used herein the terms "grantor" and "grantee" include all the parties to this instrument and  
the heirs, legal representatives and assigns of individuals, and the successors and assigns of corporations)

**Witnesseth:** That the grantor, for and in consideration of the sum of \$ 10.00 and other  
valuable considerations, receipt whereof is hereby acknowledged, by these presents does grant, bargain, sell, alien, remise,  
release, convey and confirm unto the grantee, all that certain land situate in Polk  
County, Florida, to wit:

The South 45 feet of the North 155 feet of the East 100 feet of the West 760  
feet of the SW 1/4 of the NW 1/4 of Section 21, Township 28 South, Range 25  
East, Polk County, Florida. Also known as Lot 139 of Sun Acres Unit #2, an  
unrecorded subdivision, LESS AND EXCEPT the South 10 feet thereof.

90 MAY -4 PM 2:23

NOTES 5.00  
NOTES 1.00  
NOTES 137.50  
326 H  
DEEDS 143.50  
4125A

95/0 1/11

**Together** with all the tenements, hereditaments and appurtenances thereto belonging or in anywise appertaining.  
**To Have and to Hold**, the same in fee simple forever.

**And** the grantor hereby covenants with said grantee that it is lawfully seized of said land in fee simple; that it  
has good right and lawful authority to sell and convey said land; that it hereby fully warrants the title to said land and will  
defend the same against the lawful claims of all persons whomsoever; and that said land is free of all encumbrances

except taxes for the year 1990 and subsequent years.

Documentary Tax Pd. \$ 137.50  
Intangible Tax Pd. \$  
E.D. "Dix" Dixon, Clerk, Polk Co.  
By: [Signature] Deputy Clerk

**In Witness Whereof** the grantor has caused these presents to be  
executed in its name, and its corporate seal to be hereunto affixed, by its proper officers  
thereunto duly authorized, the day and year first above written.

Signed, sealed and delivered in the presence of:

[Signature]  
Carol Baylto

By: [Signature] (Seal)  
Attest: [Signature] (Seal)

STATE OF Florida )  
COUNTY OF Polk )

I HEREBY CERTIFY that on this day, before me, an officer duly authorized in the State and County aforesaid to take  
acknowledgments, personally appeared James E. Turner & Ralph Turner  
of Sunrise Water Company, Inc.  
well known to me to be the President and respectively of the corporation named  
as grantor in the foregoing deed, and that they severally acknowledged executing the same in the presence of two subscribing  
witnesses freely and voluntarily under authority duly vested in them by said corporation and that the seal affixed thereto  
is the true corporate seal of said corporation.

WITNESS my hand and official seal in the County and State last aforesaid this  
A. D. 19

This instrument prepared by:  
Carolyn F. Fenley  
LAWYERS TITLE INSURANCE CORPORATION  
245 West Central Avenue  
Winter Haven, Florida 33882

[Signature]  
Notary Public State of Florida

Notary Public, State of Florida at Large  
My Commission Expires 30, 1992

Case No. 106961-W

2851 0752  
POLK OFF. REC. PAGE

137-0 050661

RECORD VERIFIED  
E. D. "Dix" Dixon, CL. CL.  
POLK COUNTY, FLA.  
BY: [Signature]



ORIGINAL  
FILE COPY

25% COTTON

**EXHIBIT B**

WATER TARIFF

SUNRISE WATER COMPANY, INC.  
NAME OF COMPANY

FILED WITH  
FLORIDA PUBLIC SERVICE COMMISSION

WATER TARIFF

SUNRISE WATER COMPANY, INC.  
NAME OF COMPANY

Post Office Box 2397

Winter Park, Florida 32790  
(ADDRESS OF COMPANY)

904-628-8900  
(Business & Emergency Telephone Numbers)

FILED WITH  
FLORIDA PUBLIC SERVICE COMMISSION

MACAULEY WHITING, JR.  
ISSUING OFFICER

PRESIDENT  
TITLE



NAME OF COMPANY SUNRISE WATER COMPANY, INC.

WATER TARIFF

Table of Contents

	Sheet Number
Communities Served Listing "Held for Future Use" .....	4.0
Description of Territory Served.....	3.0
Index of	
Rates and Charges Schedules.....	11.0
Rules and Regulations.....	6.0 - 6.1
Standard Forms.....	17.0
Technical Terms and Abbreviations.....	5.0 - 5.1
Territory Served.....	3.0

MACAULEY WHITING, JR.  
ISSUING OFFICER

PRESIDENT  
TITLE

NAME OF COMPANY SUNRISE WATER COMPANY, INC.

WATER TARIFF

TERRITORY SERVED

CERTIFICATE NUMBER -

COUNTY -

COMMISSION ORDER(s) APPROVING TERRITORY SERVED -

Order Number

Date Issued

Docket Number

Filing Type

(Continued to Sheet No. 3.1)

MACAULEY WHITING, JR.  
ISSUING OFFICER

PRESIDENT  
TITLE

NAME OF COMPANY SUNRISE WATER COMPANY, INC.

WATER TARIFF

(Continued from Sheet No. 3.0)

DESCRIPTION OF TERRITORY SERVED

The north 892 feet of the Northwest 1/4 of the Northeast 1/4 and the Northeast 1/4 of the Northeast 1/4 and North 266 feet of Southeast 1/4 of Northeast 1/4 of Section 13, Township 29 South, Range 25 East.

MACAULEY WHITING, JR.  
ISSUING OFFICER

PRESIDENT  
TITLE



ORIGINAL SHEET NO. 4.0

NAME OF COMPANY SUNRISE WATER COMPANY, INC.

WATER TARIFF

COMMUNITIES SERVED LISTING

<u>County</u> <u>Name</u>	<u>Development</u> <u>Name</u>	<u>Rate</u> <u>Schedule(s)</u> <u>Available</u>	Sheet No.
Polk	Sun Acres	RS	13.0

MACAULEY WHITING, JR.  
ISSUING OFFICER

PRESIDENT  
TITLE

NAME OF COMPANY SUNRISE WATER COMPANY, INC.

WATER TARIFF

TECHNICAL TERMS AND ABBREVIATIONS

- 1.0 "BFC" - "BFC" is the abbreviation for "Base Facility Charge" which is the minimum amount the utility may charge to the Company's customers and is separate from the amount billed for water consumption on the utility's bills to its customers.
- 2.0 "CERTIFICATE" - A document issued by the Commission authorizing the Company to provide water service in a specific territory.
- 3.0 "COMMISSION" - "Commission" refers to the Florida Public Service Commission.
- 4.0 "COMMUNITIES SERVED" - The group of customers who receive water service from the Company and whose service location is within a specific area or locality that is uniquely separate from another.
- 5.0 "COMPANY" - Sunrise Water Company, Inc.
- 6.0 "CUSTOMER" - Any person, firm or corporation who has entered into an agreement to receive water service from the Company and who is liable for the payment of that water service.
- 7.0 "CUSTOMER'S INSTALLATION" - All pipes, shut-offs, valves, fixtures and appliances or apparatus of every kind and nature which are located on the customer's side of the "Point of Delivery" and used in connection with or forming a part of the installation necessary for rendering water service to the customer's premises regardless of whether such installation is owned by the customer or used by the consumer under lease or other agreement.
- 8.0 "MAIN" - A pipe, conduit, or facility used for conveying water service through individual services or through other mains.
- 9.0 "POINT OF DELIVERY" - For water systems, "Point of Delivery" shall mean the outlet connection of the meter for metered service or the point at which the company's piping, fittings and valves connect with the customer's piping, fittings and valves for non-metered service.
- 10.0 "RATE" - Amount which the utility may charge for water service which is applied to the customer's actual consumption.
- 11.0 "RATE SCHEDULE" - The rate(s) or charge(s) for a particular classification of service plus the several provisions necessary for billing, including all special terms and conditions under which service shall be furnished at such rate or charge.

(Continued to Sheet No. 5.1)

MACAULEY WHITING, JR.  
ISSUING OFFICERPRESIDENT  
TITLE

NAME OF COMPANY SUNRISE WATER COMPANY, INC.

WATER TARIFF

(Continued from Sheet No. 5.0)

- 12.0 "SERVICE" - Service, as mentioned in this tariff and in agreement with customers, shall be construed to include, in addition to all water service required by the customer the readiness and ability on the part of the Company to furnish water service to the customer. Service shall conform to the standards set forth in Section 367.111 of the Florida Statutes.
- 13.0 "SERVICE LINES" - The pipe between the Company's mains and the point of delivery and shall include all of the pipe, fittings and valves necessary to make the connection to the customer's premises excluding the meter.
- 14.0 "TERRITORY" - The geographical area described by metes and bounds with township, range and section in a certificate, which may be within or without the boundaries of an incorporated municipality and, may include areas in more than one county.

MACAULEY WHITING, JR.  
ISSUING OFFICER

PRESIDENT  
TITLE



NAME OF COMPANY SUNRISE WATER COMPANY, INC.  
WATER TARIFF

ORIGINAL SHEET NO. 6.0

INDEX OF RULES AND REGULATIONS

	<u>Sheet Number:</u>	<u>Rule Number:</u>
Access to Premises.....	9.0	13.0
Adjustment of Bills.....	10.0	23.0
Adjustment of Bills for Meter Error.....	10.0	24.0
All Water Through Meter.....	10.0	22.0
Application.....	7.0	3.0
Applications by Agents.....	7.0	4.0
Change of Customer's Installation.....	8.0	10.0
Continuity of Service.....	8.0	8.0
Customer Billing.....	9.0	15.0
Delinquent Bills.....	9.0	16.0
Extensions.....	7.0	6.0
Filing of Contracts.....	10.0	26.0
General Information.....	7.0	1.0
Inspection of Customer's Installation.....	8.0	11.0
Limitation of Use.....	7.0	7.0
Meters.....	10.0	21.0

(Continued to Sheet No. 6.1)

MACAULEY WHITING, JR.  
ISSUING OFFICER

PRESIDENT  
TITLE

NAME OF COMPANY SUNRISE WATER COMPANY, INC.

## WATER TARIFF

(Continued from Sheet No. 6.0)

	<u>Sheet Number:</u>	<u>Rule Number:</u>
Meter Accuracy Requirements.....	10.0	25.0
Payment of Water and Wastewater Service Bills Concurrently.....	9.0	17.0
Policy Dispute.....	7.0	2.0
Protection of Company's Property.....	8.0	12.0
Refusal or Discontinuance of Service.....	7.0	5.0
Right of Way or Easements.....	9.0	14.0
Termination of Service.....	9.0	18.0
Type and Maintenance.....	8.0	9.0
Unauthorized Connections - Water.....	10.0	20.0

MACAULEY WHITING, JR.  
ISSUING OFFICERPRESIDENT  
TITLE



NAME OF COMPANY SUNRISE WATER COMPANY, INC.  
WATER TARIFF

ORIGINAL SHEET NO. 7.0

RULES AND REGULATIONS

- 1.0 GENERAL INFORMATION - These Rules and Regulations are a part of the rate schedules and applications and contracts of the Company and, in the absence of specific written agreement to the contrary, apply without modifications or change to each and every customer to whom the Company renders water service.
- The Company shall provide water service to all customers requiring such service within its certificated territory pursuant to Chapter 25-30, Florida Administrative Code and Chapter 367, Florida Statutes.
- 2.0 POLICY DISPUTE - Any dispute between the Company and the customer or prospective customer regarding the meaning or application of any provision of this tariff shall upon written request by either party be resolved by the Florida Public Service Commission.
- 3.0 APPLICATION - In accordance with Rule 25-30.310, Florida Administrative Code, a signed application is required prior to the initiation of service.
- 4.0 APPLICATIONS BY AGENTS - Applications for water service requested by firms, partnerships, associations, corporations, and others shall be rendered only by duly authorized parties or agents.
- 5.0 REFUSAL OR DISCONTINUANCE OF SERVICE - The Company may refuse or discontinue water service rendered under application made by any member or agent of a household, organization, or business in accordance with Rule 25-30.320, Florida Administrative Code.
- 6.0 EXTENSIONS - Extensions will be made to the Company's facilities in compliance with Commission Rules and Orders and the Company's tariff.
- 7.0 LIMITATION OF USE - Water service purchased from the Company shall be used by the customer only for the purposes specified in the application for water service and the customer shall not sell or otherwise dispose of such water service supplied by the company.
- In no case shall a customer, except with the written consent of the company, extend his lines across a street, alley, lane, court, property line, avenue, or other way in order to furnish water service to the adjacent property through one meter even though such adjacent property may be owned by him. In case of such unauthorized extension, sale, or disposition of service, the customer's water service will be subject to discontinuance until such unauthorized extension, remetering, sale or disposition of service is discontinued and full payment is made to the Company for water service rendered by the Company (calculated on proper classification and rate schedules) and until reimbursement in full is made in full to the Company for all extra expenses incurred for clerical work, testing, and inspections.
- (Continued to Sheet No. 8.0)

MACAULEY WHITING, JR.  
ISSUING OFFICER

PRESIDENT  
TITLE



(Continued from Sheet No. 7.0)

8.0 CONTINUITY OF SERVICE - In accordance with Rule 25-30.250, Florida Administrative Code, the company will at all times use reasonable diligence to provide continuous water service and, having used reasonable diligence, shall not be liable to the customer for failure or interruption of continuous water service.

If at any time the Company shall interrupt or discontinue its service, all customers affected by said interruption or discontinuance shall be given not less than 24 hours written notice.

9.0 TYPE AND MAINTENANCE - In accordance with Rule 25-30.545, Florida Administrative Code, the customer's pipes, apparatus and equipment shall be selected, installed, used and maintained in accordance with standard practice and shall conform with the Rules and Regulations of the Company and shall comply with all Laws and Governmental Regulations applicable to same. The Company shall not be responsible for the maintenance and operation of the customer's pipes and facilities. The customer expressly agrees not to utilize any appliance or device which is not properly constructed, controlled and protected or which may adversely affect the water service; the Company reserves the right to discontinue or withhold water service to such apparatus or device.

10.0 CHANGE OF CUSTOMER'S INSTALLATION - No changes or increases in the customer's installation, which will materially affect the proper operation of the pipes, mains, or stations of the Company, shall be made without written consent of the Company. The customer shall be liable for any change resulting from a violation of this Rule.

11.0 INSPECTION OF CUSTOMER'S INSTALLATION - All customer's water service installations or changes shall be inspected upon completion by a competent authority to ensure that the customer's piping, equipment, and devices have been installed in accordance with accepted standard practice and local Laws and Governmental Regulations. Where Municipal or other Governmental inspection is required by local Rules and Ordinances, the Company cannot render water service until such inspection has been made and a formal notice of approval from the inspecting authority has been received by the Company.

Notwithstanding the above, the Company reserves the right to inspect the customer's installation prior to rendering water service, and from time to time thereafter, but assumes no responsibility whatsoever for any portion thereof.

12.0 PROTECTION OF COMPANY'S PROPERTY - The customer shall exercise reasonable diligence to protect the Company's property. If the customer is found to have tampered with any utility property or refuses to correct any problems reported by the utility, service may be discontinued in accordance with Rule 25-30.320, Florida Administrative Code.

(Continued to Sheet No. 9.0)

MACAULEY WHITING, JR.  
ISSUING OFFICER

PRESIDENT  
TITLE

NAME OF COMPANY SUNRISE WATER COMPANY, INC.

## WATER TARIFF

(Continued from Sheet No. 8.0)

In the event of any loss or damage to property of the Company caused by or arising out of carelessness, neglect, or misuse by the customer, the cost of making good such loss or repairing such damage shall be paid by the customer.

- 13.0 ACCESS TO PREMISES - In accordance with Rule 25-30.320(2)(f), Florida Administrative Code, the company shall provide the duly authorized agents of the Company access at all reasonable hours to its property. If reasonable access is not provided, service may be discontinued pursuant to the above rule.

- 14.0 RIGHT OF WAY OR EASEMENTS - The customer shall grant or cause to be granted to the Company, and without cost to the Company, all rights, easements, permits, and privileges which are necessary for the rendering of water service.

- 15.0 CUSTOMER BILLING - Bills for water service will be rendered - Monthly, Bimonthly, or Quarterly - as stated in the rate schedule.

In accordance with Rule 25-30.335, Florida Administrative Code, the utility may not consider a customer delinquent in paying his or her bill until the twenty-first day after the utility has mailed or presented the bill for payment.

A municipal or county franchise tax levied upon a water or wastewater public utility shall not be incorporated into the rate for water or wastewater service but shall be shown as a separate item on the utility's bills to its customers in such Municipality or County.

If a utility utilizes the base facility and usage charge rate structure and does not have a Commission authorized vacation rate, the utility shall bill the customer the base facility charge regardless of whether there is any usage.

- 16.0 DELINQUENT BILLS - When it has been determined that a customer is delinquent in paying any bill, water service may be discontinued after the Company has mailed or presented a written notice to the customer in accordance with Rule 25-30.320, Florida Administrative Code.

- 17.0 PAYMENT OF WATER AND WASTEWATER SERVICE BILLS CONCURRENTLY - In accordance with Rule 25-30.320(2)(g), Florida Administrative Code, when both water and wastewater service are provided by the Company, payment of any water service bill rendered by the Company to a customer shall not be accepted by the Company without the simultaneous or concurrent payment of any wastewater service bill rendered by the Company.

- 18.0 TERMINATION OF SERVICE - When a customer wishes to terminate service on any premises where water service is supplied by the Company with water service, the Company may require reasonable notice to the Company in accordance with Rule 25-30.325, Florida Administrative Code.

(Continued to Sheet No. 10.0)

MACAULEY WHITING, JR.  
ISSUING OFFICER

PRESIDENT  
TITLE



NAME OF COMPANY SUNRISE WATER COMPANY, INC.  
WATER TARIFF

ORIGINAL SHEET NO. 10.0

(Continued from Sheet No. 9.0)

- 20.0 UNAUTHORIZED CONNECTIONS - WATER - Any unauthorized connections to the customer's water service shall be subject to immediate discontinuance without notice, in accordance with Rule 25-30.320, Florida Administrative Code.
- 21.0 METERS - All water meters shall be furnished by and remain the property of the Company and shall be accessible and subject to its control, in accordance with Rule 25-30.230, Florida Administrative Code.
- 22.0 ALL WATER THROUGH METER - That portion of the customer's installation for water service shall be so arranged to ensure that all water service shall pass through the meter. No temporary pipes, nipples or spaces are permitted and under no circumstances are connections allowed which may permit water to by-pass the meter or metering equipment.
- 23.0 ADJUSTMENT OF BILLS - When a customer has been undercharged as a result of incorrect application of the rate schedule, incorrect reading of the meter, incorrect connection of the meter, or other similar reasons, the amount may be billed to the customer as the case may be pursuant to Rule 25-30.350, Florida Administrative Code.
- 24.0 ADJUSTMENT OF BILLS FOR METER ERROR - When meter tests are made by the Commission or by the Company, the accuracy of registration of the meter and its performance shall conform with Rule 25-30.262, Florida Administrative Code, and any adjustment of a bill due to a meter found to be in error as a result of any meter test performed whether for unauthorized use or for a meter found to be fast, slow, non-registering, or partially registering, shall conform with Rule 25-30.340, Florida Administrative Code.
- 25.0 METER ACCURACY REQUIREMENTS - All meters used by the company should conform to the provisions of Rule 25-30.262, Florida Administrative Code.
- 26.0 FILING OF CONTRACTS - Whenever a Developer Agreement or Contract, Guaranteed Revenue Contract, or Special Contract or Agreement is entered into by the Company for the sale of its product or services in a manner not specifically covered by its Rules and Regulations or approved Rate Schedules, a copy of such contracts or agreements shall be filed with the Commission prior to its execution in accordance with Rule 25-9.034 and Rule 25-30.550, Florida Administrative Code. If such contracts or agreements are approved by the Commission, a conformed copy shall be placed on file with the Commission within 30 days of execution.

MACAULEY WHITING, JR.  
ISSUING OFFICER

PRESIDENT  
TITLE



NAME OF COMPANY SUNRISE WATER COMPANY, INC.  
WATER TARIFF

ORIGINAL SHEET NO. 11.0

INDEX OF RATES AND CHARGES SCHEDULES

	<u>Sheet Number</u>
Customer Deposits .....	13.0
Meter Test Deposit .....	14 0
Miscellaneous Service Charges .....	15.0
Residential Service, RS .....	12.0
Service Availability Fees and Charges .....	16.0

MACAULEY WHITING, JR.  
ISSUING OFFICER

PRESIDENT  
TITLE

NAME OF COMPANY SUNRISE WATER COMPANY, INC.  
WATER TARIFF

ORIGINAL SHEET NO. 12.0

RESIDENTIAL SERVICE  
RATE SCHEDULE RS

AVAILABILITY - Available throughout the area served by the Company.  
APPLICABILITY - For water service for all purposes in private residences and individually metered apartment units.  
LIMITATIONS - Subject to all of the Rules and Regulations of this Tariff and General Rules and Regulations of the Commission.  
BILLING PERIOD - Monthly  
RATE -

Meter Size

5/8" x 3/4"

Base Facility Charge

\$8.45

GALLONAGE CHARGE \$1.25 (Per 1,000 Gallons)

MINIMUM CHARGE - Equals Base Facility Charge which includes 5,000 gallons of service.

TERMS OF PAYMENT Bills are due and payable when rendered. In accordance with Rule 25-30.320, Florida Administrative Code, if a customer is delinquent in paying the bill for water service, service may then be discontinued.

EFFECTIVE DATE -

TYPE OF FILING -

MACAULEY WHITING, JR.  
ISSUING OFFICER

PRESIDENT  
TITLE



NAME OF COMPANY SUNRISE WATER COMPANY, INC.  
WATER TARIFF

ORIGINAL SHEET NO. 13.0

SCHEDULE OF CUSTOMER DEPOSITS

ESTABLISHMENT OF CREDIT - Before rendering water service, the Company may require an applicant for service to satisfactorily establish credit, but such establishment of credit shall not relieve the customer from complying with the Company's rules for prompt payment. Credit will be deemed so established if the customer complies with the requirements of Rule 25-30.311, Florida Administrative Code.

AMOUNT OF DEPOSIT - The amount of initial deposit shall be the following according to meter size:

Residential

5/8" x 3/4" \$35.00

ADDITIONAL DEPOSIT - Under Rule 25-30.311(7), Florida Administrative Code, the Company may require a new deposit, where previously waived or returned, or an additional deposit in order to secure payment of current bills provided.

INTEREST ON DEPOSIT - The Company shall pay interest on customer deposits pursuant to Rule 25-30.311(4) and (4a). The Company will pay or credit accrued interest to the customers account annually.

REFUND OF DEPOSIT - After a residential customer has established a satisfactory payment record and has had continuous service for a period of 23 months, the Company shall refund the customer's deposit provided the customer has met the requirements of Rule 25-30.311(5), Florida Administrative Code. The Company may hold the deposit of a non-residential customer after a continuous service period of 23 months and shall pay interest on the non-residential customer's deposit pursuant to Rule 25-30.311(4) and (5), Florida Administrative Code.

Nothing in this rule shall prohibit the Company from refunding a customer's deposit in less than 23 months.

EFFECTIVE DATE -

TYPE OF FILING -

MACAULEY WHITING, JR.  
ISSUING OFFICER

PRESIDENT  
TITLE



NAME OF COMPANY SUNRISE WATER COMPANY, INC.

WATER TARIFF

METER TEST DEPOSITS

METER BENCH TEST REQUEST - If any customer requests a bench test of his or her water meter, in accordance with Rule 25-30.266, Florida Administrative Code, the Company may require a deposit to defray the cost of testing; such deposit shall not exceed the schedule of fees found in Rule 25-30.266, Florida Administrative Code.

<u>METER SIZE</u>	<u>FEE</u>
5/8" x 3/4"	\$30.00
Above 5/8" x 3/4"	Actual Cost

REFUND OF METER BENCH TEST DEPOSIT - The utility may refund the meter bench test deposit in accordance with Rule 25-30.266, Florida Administrative Code.

METER FIELD TEST REQUEST - A customer may request a field test in accordance with Rule 25-30.266, Florida Administrative Code.

MACAULEY WHITING, JR.  
ISSUING OFFICER

PRESIDENT  
TITLE

NAME OF COMPANY SUNRISE WATER COMPANY, INC.  
WATER TARIFF

ORIGINAL SHEET NO. 15.0

MISCELLANEOUS SERVICE CHARGES

The Company may charge the following miscellaneous service charges in accordance with the terms stated herein. If both water and wastewater services are provided, only a single charge is appropriate unless circumstances beyond the control of the Company requires multiple actions.

INITIAL CONNECTION - This charge would be levied for service initiation at a location where service did not exist previously.

NORMAL RECONNECTION - This charge would be levied for transfer of service to a new customer account at a previously served location or reconnection of service subsequent to a customer requested disconnection.

VIOLATION RECONNECTION - This charge would be levied prior to reconnection of an existing customer after disconnection of service for cause according to Rule 25-30.320(2), Florida Administrative Code, including a delinquency in bill payment, and in the case of a cut lock or metering tampering.

PREMISES VISIT CHARGE (IN LIEU OF DISCONNECTION) - This charge would be levied when a service representative visits a premises for the purpose of discontinuing service for nonpayment of a due and collectible bill and does not discontinue service because the customer pays the service representative or otherwise makes satisfactory arrangements to pay the bill.

LATE PAYMENT FEE - This charge would be levied for payments not timely made following rendering of a bill for service.

BAD CHECK CHARGE - This charge is levied for checks returned to the Company due to "not sufficient funds."

Schedule of Miscellaneous Service Charges

Initial Connection Fee	\$ 25.00
Normal Reconnection Fee	\$ 25.00
Violation Reconnection Fee	\$ 25.00
Premises Visit Fee (in lieu of disconnection)	\$ 25.00
Late Payment Fee	\$ 5.00
Bad check charge	\$ 15.00

EFFECTIVE DATE -

TYPE OF FILING -

MACAULEY WHITING, JR.  
ISSUING OFFICER

PRESIDENT  
TITLE



NAME OF COMPANY SUNRISE WATER COMPANY, INC.  
 WATER TARIFF

SERVICE AVAILABILITY SCHEDULE OF FEES AND CHARGES

<u>DESCRIPTION</u>	<u>AMOUNT</u>	<u>REFER TO SHEET NO.</u>
<u>Meter Installation Fee</u>		
5/8" x 3/4" metered service . . . . .	\$ 50.00	N/A
1" metered service . . . . .	Actual Cost [1]	N/A
1 1/2" metered service . . . . .	Actual Cost [1]	N/A
2" metered service . . . . .	Actual Cost [1]	N/A
Over 2" metered service . . . . .	Actual Cost [1]	N/A
<u>Guaranteed Revenue Charge</u>		
With Prepayment of Service Availability Charges:		N/A
Residential-per ERC/month (350) GPD . \$ Min. monthly rate		N/A
All others-per gallon/month . . . . . \$ Min. monthly rate		N/A
Without Prepayment of Service Availability Charges:		
Residential-per ERC/month ( ) GPD . \$ N/A		
All others-per gallon/month . . . . . \$ N/A		
<u>Inspection Fee</u> . . . . .	Actual Cost [1]	N/A
<u>Main Extension Charge</u>		
Residential-per ERC/month ( ) GPD . \$ N/A		N/A
All others-per gallon/month . . . . . \$ N/A		
<u>Plan Review Charge</u> . . . . .	N/A	N/A
<u>Application Charge</u> . . . . .	N/A	N/A
<u>Recording Charge</u> . . . . .	N/A	N/A
<u>Legal Review Charge</u> . . . . .	N/A	N/A
<u>Plant Capacity Charge</u>		
Residential-per ERC ( ) GPD . . . . .	N/A	N/A
All others-per gallon . . . . .	N/A	N/A
<u>System Capacity Charge</u>		
Residential-per ERC . . . . .	\$450	
All others-per gallon . . . . .	\$ N/A	N/A

[1] Actual Cost is equal to the total cost incurred for services rendered to a customer, plus appropriate overhead associated with installation.

EFFECTIVE DATE -

TYPE OF FILING -

MACAULEY WHITING, JR.  
 ISSUING OFFICER

PRESIDENT  
 TITLE



NAME OF COMPANY SUNRISE WATER COMPANY, INC.

WATER TARIFF

INDEX OF STANDARD FORMS

Sheet No.

APPLICATION FOR METER INSTALLATION.....	20.0
APPLICATION FOR WATER SERVICE.....	19.0
COPY OF CUSTOMER'S BILL.....	21.0
CUSTOMER'S GUARANTEE DEPOSIT RECEIPT.....	18.0

MACAULEY WHITING, JR.  
ISSUING OFFICER

PRESIDENT  
TITLE

NAME OF COMPANY SUNRISE WATER COMPANY, INC.  
WATER TARIFF

ORIGINAL SHEET NO. 18.0

CUSTOMER'S GUARANTEE DEPOSIT RECEIPT

MACAULEY WHITING, JR.  
ISSUING OFFICER

PRESIDENT  
TITLE

NAME OF COMPANY SUNRISE WATER COMPANY, INC.  
WATER TARIFF

ORIGINAL SHEET NO. 19.0

APPLICATION FOR WATER SERVICE

MACAULEY WHITING, JR.  
ISSUING OFFICER

PRESIDENT  
TITLE



NAME OF COMPANY SUNRISE WATER COMPANY, INC.

WATER TARIFF

APPLICATION FOR METER INSTALLATION

"Held for Future Use"

MACAULEY WHITING, JR.  
ISSUING OFFICER

PRESIDENT  
TITLE

NAME OF COMPANY SUNRISE WATER COMPANY, INC.  
WATER TARIFF

ORIGINAL SHEET NO. 21.0

COPY OF CUSTOMER'S BILL

MACAULEY WHITING, JR.  
ISSUING OFFICER

PRESIDENT  
TITLE

**EXHIBIT C**



APPROVE INCREASE IN FEES AND RATES FOR  
SUN ACRES WATER SYSTEM

This was the date and time set by the Board for a public hearing to consider a request by Sun Acres Water System for an increase in their fees and rates.

Chuck Foss, Assistant to the County Administrator, presented the following Staff Report and Recommendation.

SUN ACRES WATER COMPANY, INC.  
Rate Increase Request

Present Rate Request

The Company has requested a water rate increase of 80% for the first 5,000 gallons and 100% for each additional 1,000 gallons for both residential and commercial customers. The utility has 260 residential and 1 commercial customer. All customers are currently metered. The utility provides no wastewater service.

Development of Rate Base

The first step in a rate calculation is to develop a rate base for the purpose of developing an adequate rate of return. The schedule indicates a rate base of \$43,419. Included in this rate base is \$29,400 in capital expenditures necessary to comply with a D.E.R. order to develop a backup water system. Florida Statutes 367.081(2) allows pro forma plant cost to be included in the rate base if required by the Department of Environmental Regulation.

Revenue Requirement

The revenue requirement of \$39,352 includes operations and maintenance (\$16,698), depreciation (\$4,555), general and administrative (\$12,859) and rate of return (\$5,240). The costs included in the revenue requirement are historical costs except for the rate of return which was calculated. This was calculated by developing a ratio of the rate base to equity. This was accomplished assuming the utility must borrow the \$29,400 for capital improvement, because it appears the corporation does not have available funds. It was determined that 34% is related to equity while 66% is related to debt. For equity, a 14% rate of return was allowed pursuant to the Florida Public Service Commission cost of equity formula published in order number 16975. For debt, it was estimated the corporation's ability to borrow funds at 11%.

As the schedule indicates, additional revenue of \$16,033 is required which results in a water rate increase of 69%.

Recommendations

- 1) Adopt the water rates as recommended on the attached schedule.
- 2) Adopt the connection fees as requested by the utility.
- 3) The proposed capital expenditure of \$29,400 be completed within 18 months and certified to the Commission when completed. If not completed, the rates shall be rolled back for the uncompleted capital expenditure.



# SUN ACRES WATER COMPANY, INC. RATE ANALYSIS

DEVELOPMENT OF RATE BASE	22,286
Investment in plant	- 10,354
LESS: Accumulated depreciation	29,400
Improvements required pursuant to D.E.R. consent order 86-0204	41,332
Net investment in plant	2,087
Working capital	43,419
Rate base	

## CALCULATION OF RATE OF RETURN

Pro forma equity	15,375
Pro forma embedded debt	29,400
Total	44,775

## Percentage of assets

34 0.66

43,419 43,419

Rate base

14,909

26,657

Percentage of rate base applicable to equity  
Percentage of rate base applicable to debt

14 0.11  
2,087 3,152

5,240

Applicable rate of return  
Allowable rate of return

## REVENUE REQUIREMENT

Operations and maintenance	16,696
Depreciation	4,555
General and administrative	12,859
Rate of return	5,240
Total revenue requirement	39,352
Actual revenue	23,319
Additional revenue required	16,033
Percentage increase required	69

## CURRENT/REQUESTED/RECOMMENDED RATES

WATER:  
Residential and Commercial  
First 5000 gallons (minimum)  
Each additional 1000 gallons above min.

CURRENT	REQUEST	RECOMMEND
5.00	9.00	8.45
0.75	1.50	1.25
350	500	500

## CONNECTION FEES



The Chairman called on persons present who wished to speak.  
Ralph Turner, owner of the utility, discussed the deposit  
increase.

On motion of Commissioner Draper, seconded by Commissioner  
Simons and upon vote carried unanimously, the Board approved the rate  
increase as recommended by staff and approved an increase in the  
connection fees to \$450.00 and an increase in the deposit to \$15.00  
for new customers and delinquent customers whose service has been  
disconnected.

There being no further business to come before the Commission the  
Chairman adjourned the meeting at 3:05 P.M.

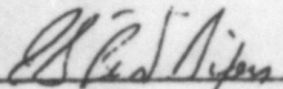
  
Clerk

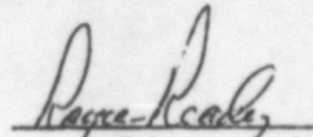
  
Chairman

ORIGINAL  
FILE COPY

EXHIBIT D

APPENDIX A

Sunrise Water Co., Inc.

The north 892 feet of the Northwest 1/4  
of the Northeast 1/4 and the Northeast 1/4  
of the Northeast 1/4 and North 266 feet of  
Southeast 1/4 of Northeast 1/4 of Section 13,  
Township 29 South, Range 25 East.



NO. 100-452

ORIGINAL  
FILE COPY

**EXHIBIT E**



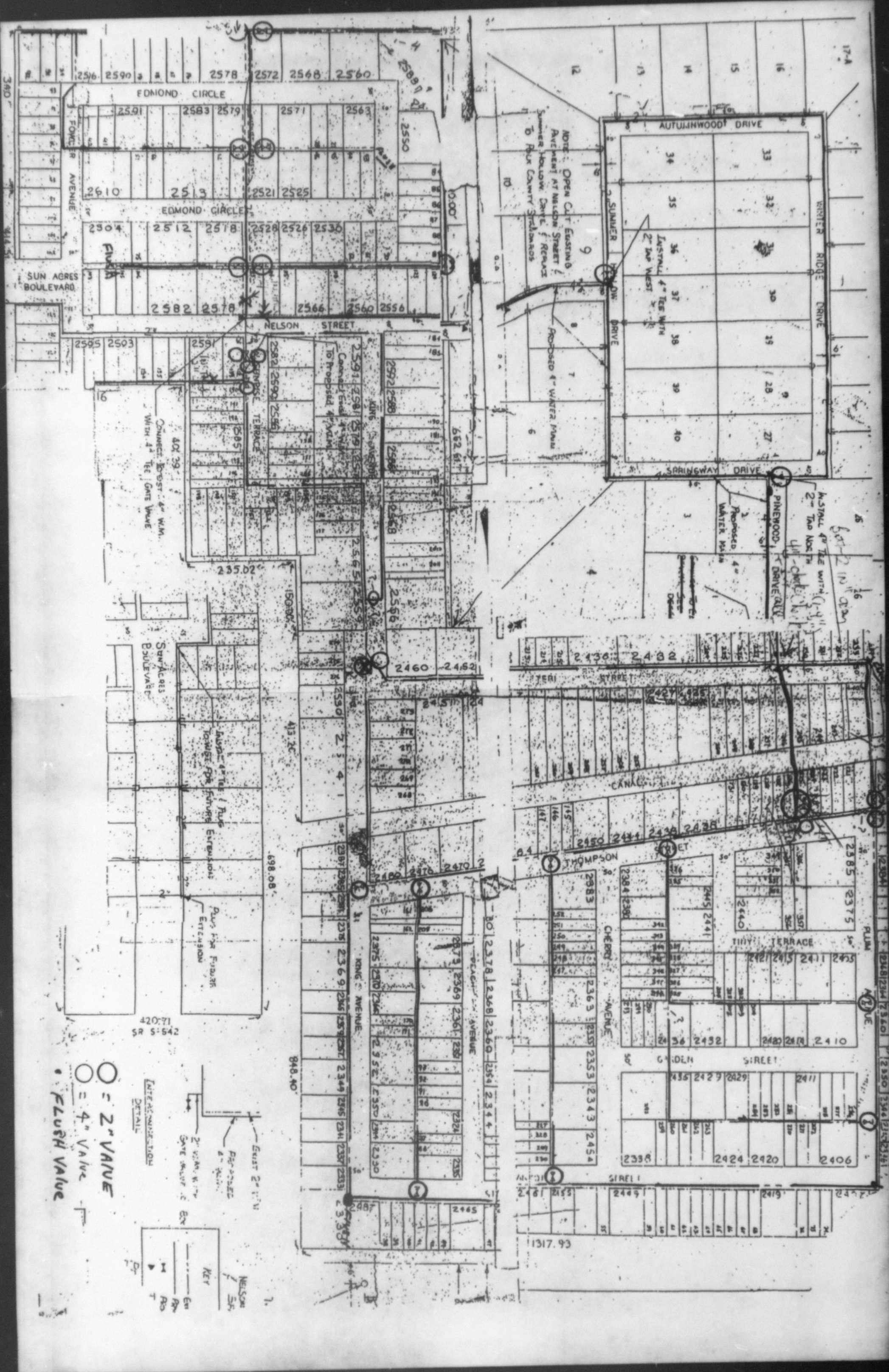



ORIGINAL  
FILE COPY

**EXHIBIT F**



ORIGINAL  
FILE COPY

EXHIBIT G