

*ALAFAYA UTILITIES, INC.
SERVICE AREA MAP BOOKLET*

DOCUMENT NUMBER-DATE
01461 FEB-78
FPSC-RECORDS/REPORTING

HARTMAN & ASSOCIATES, INC.

engineers, hydrogeologists, surveyors & management consultants

EXHIBIT

Q

*ALAFAYA UTILITIES, INC.
SERVICE AREA MAP BOOKLET*

PREPARED FOR:

*UTILITIES, INC.
2335 SANDERS ROAD
NORTHBROOK, ILLINOIS 60062*

PREPARED BY:

*HARTMAN & ASSOCIATES, INC.
201 EAST PINE STREET, SUITE 1000
ORLANDO, FLORIDA 32801*

JANUARY, 1996

HAI #95-533.00

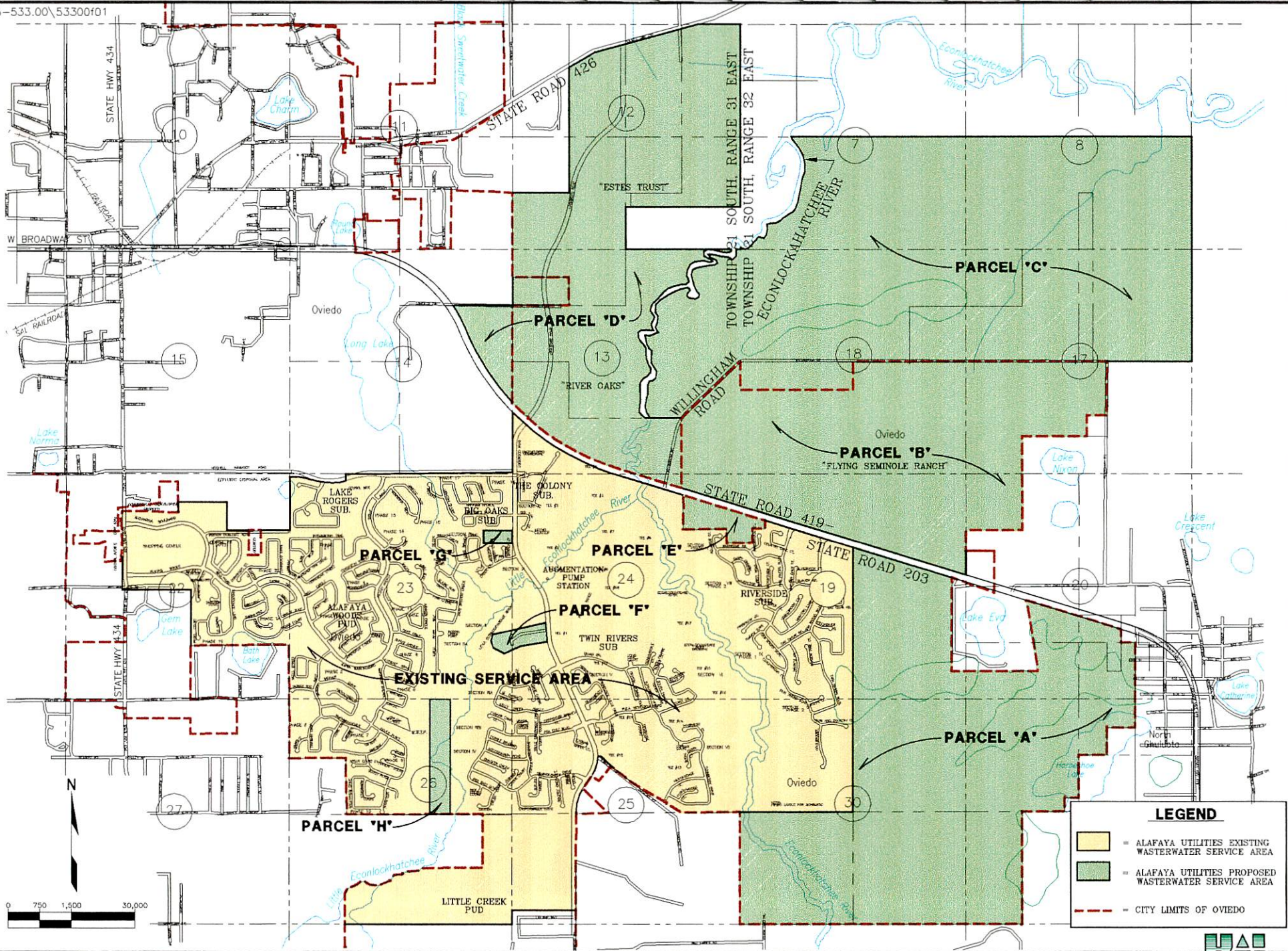

LEGEND

	= ALAFAYA UTILITIES EXISTING WASTERWATER SERVICE AREA
	= ALAFAYA UTILITIES PROPOSED WASTERWATER SERVICE AREA
	= CITY LIMITS OF OVIEDO

ALAFAYA UTILITIES PROPOSED CERTIFICATE EXTENSION



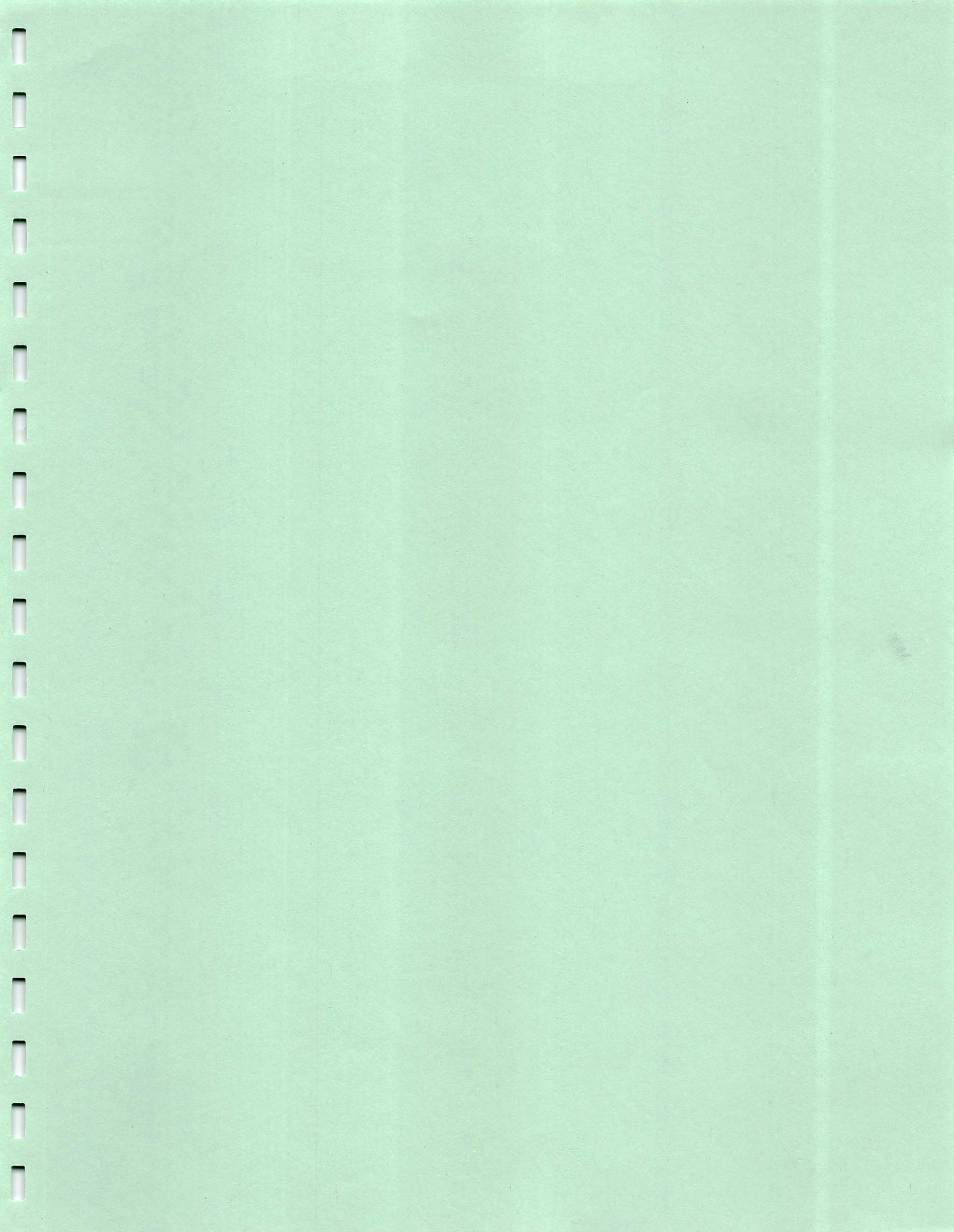

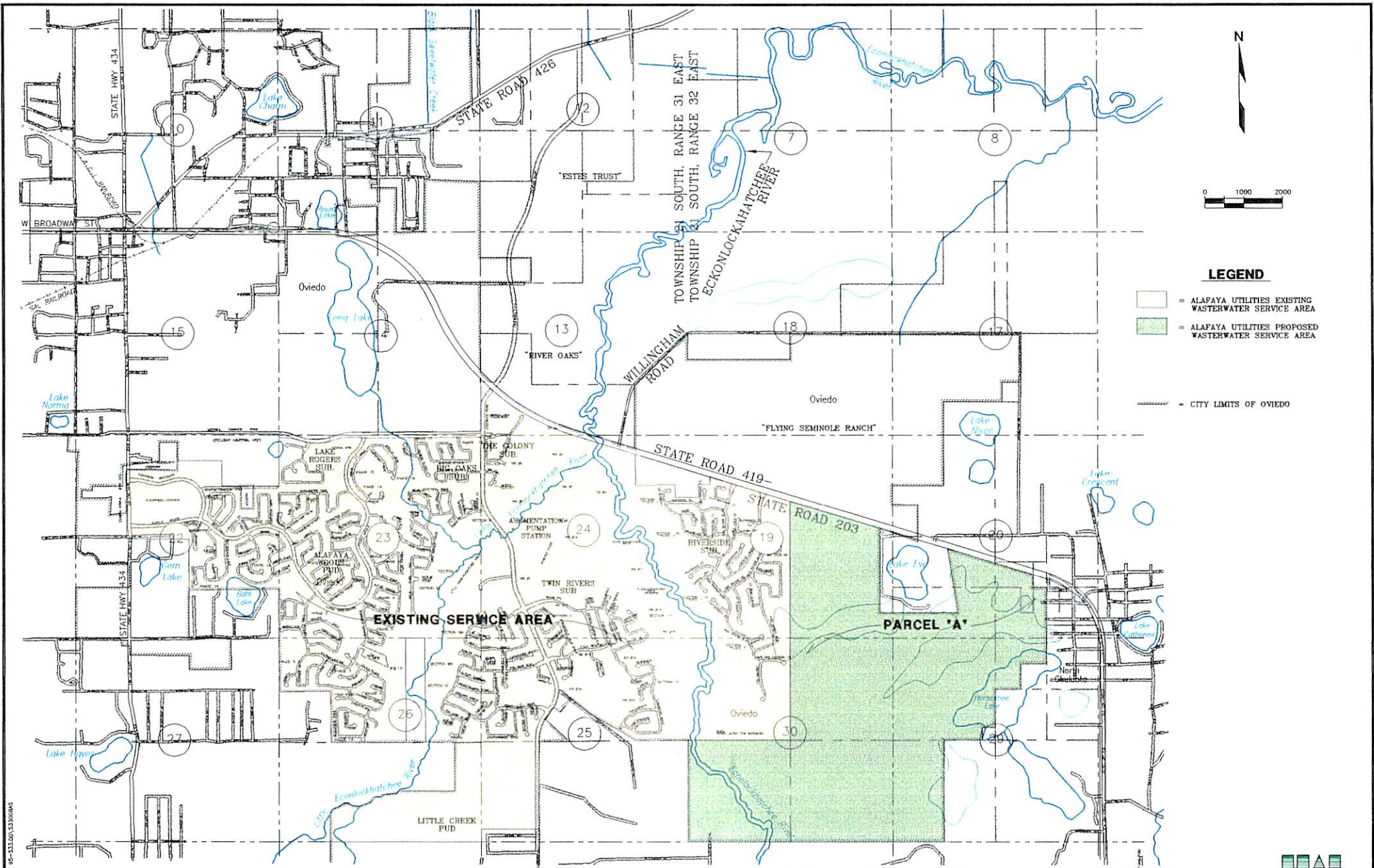

- LEGEND**
- ALAFAYA UTILITIES EXISTING WASTEWATER SERVICE AREA
 - ALAFAYA UTILITIES PROPOSED WASTEWATER SERVICE AREA
 - CITY LIMITS OF OVIEDO

EXISTING SERVICE AREA

PARCEL 'A'

ALAFAYA UTILITIES PROPOSED CERTIFICATE EXTENSION



45-33100-03-00000

Alafaya Utilities Proposed Certificate Extension
(PARCEL "A")

County: Seminole

Township 21 South, Range 32 East,

Section 19,

That part of the West 7/8 of the East 1/2 lying Southerly of State Road 419.

Together with:

The East 1/2 of the Southeast 1/4 of the Southeast 1/4 of the Southeast 1/4.

Section 20,

That part of the West 3/4 lying Southerly of State Road 419 (LESS: Begin at the intersection of State Road 419 and the West line of said Section 20; thence South for a distance of 2093 feet (more or less) to the Northwest corner of the South 1/4 of the Southwest 1/4; thence East along the North line of the South 1/4 of the Southwest 1/4 of said Section 20 for a distance of 1680 feet (more or less); thence North 9° West for a distance of 1680 feet (more or less) to State Road 419; thence North 73° West along State Road 419 for a distance of 1482 feet (more or less) to the Point of Beginning. Also, LESS: East 1/2 of the Southeast 1/4 of the Northwest 1/4 of the Southeast 1/4, lying Southerly of State Road 419).

Section 29,

The Northwest 1/4 (LESS: The Southeast 1/4 of the Southeast 1/4 of the Southeast 1/4 of the Northwest 1/4).

Together with:

The Northwest 1/4 of the Northeast 1/4 (LESS: The Southeast 1/4 of the Northwest 1/4 of the Northeast 1/4).

Together with:

The West 1/2 of the Southwest 1/4.

Section 30,

The East 1/2.

Together with:

The Southwest 1/4.

(Parcel "A" contains 1049.6952 Acres, more or less)

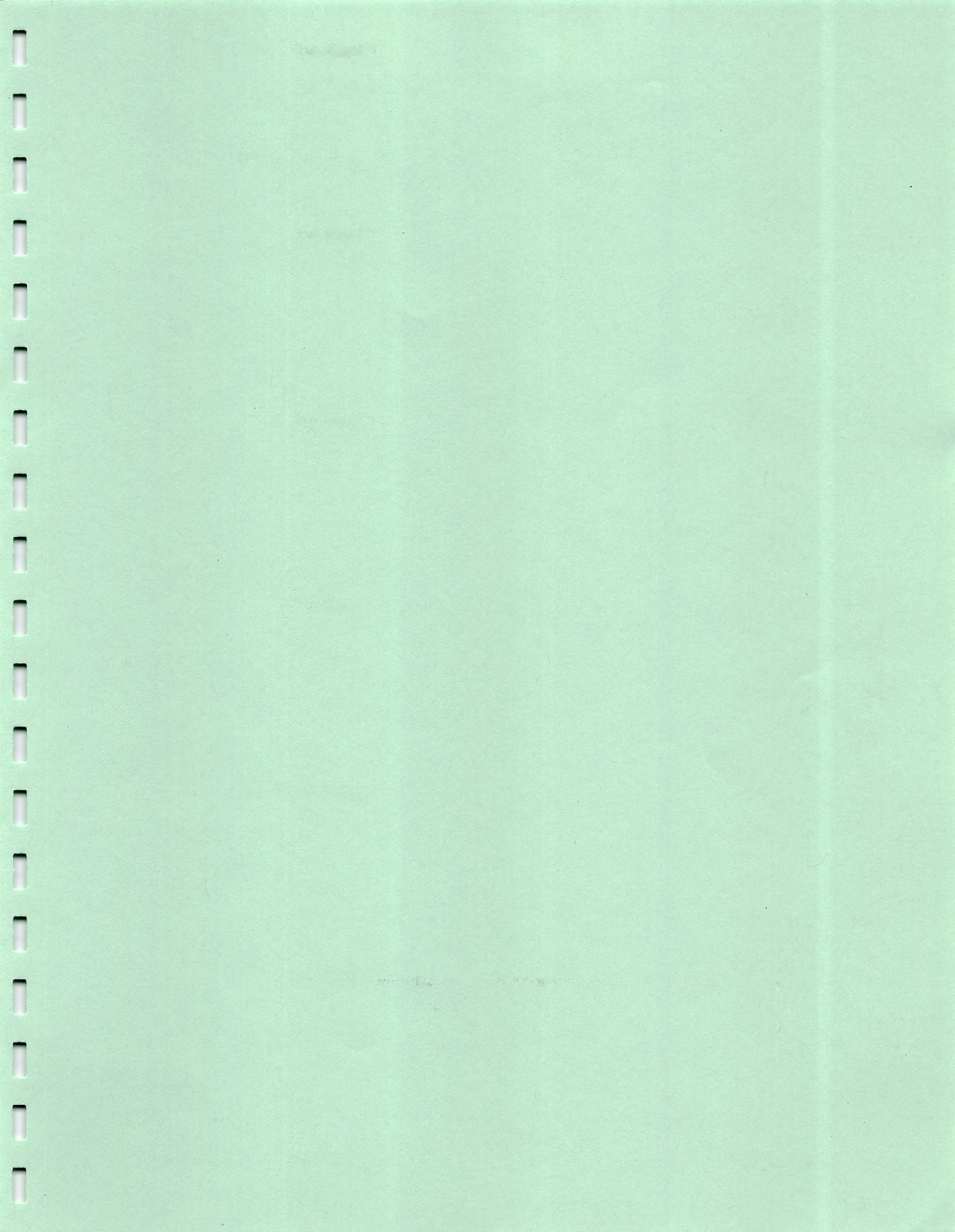

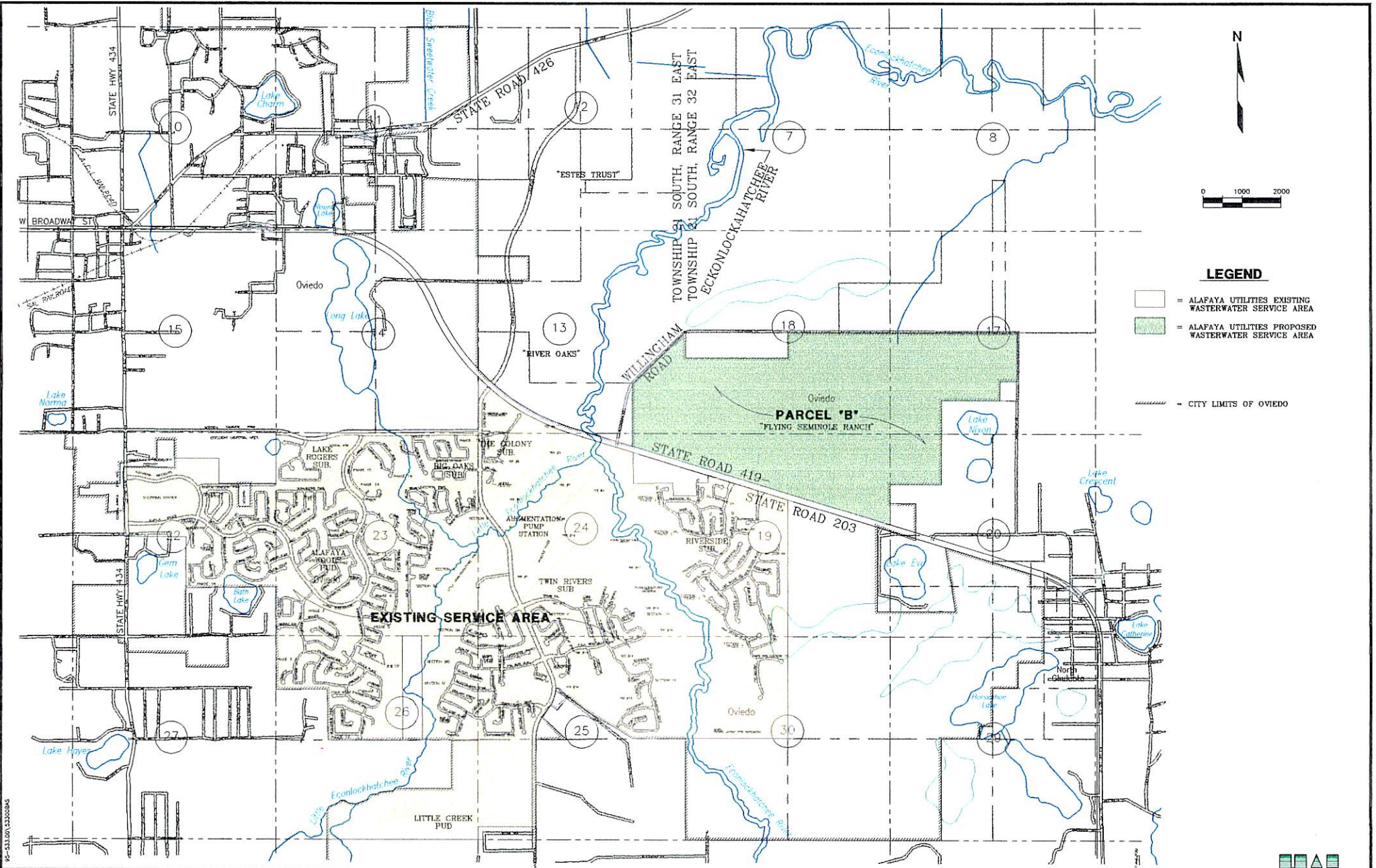

LEGEND

- = ALAFAYA UTILITIES EXISTING WASTEWATER SERVICE AREA
- = ALAFAYA UTILITIES PROPOSED WASTEWATER SERVICE AREA
- = CITY LIMITS OF OVIEDO



85-533100-33000848

Alafaya Utilities Proposed Certificate Extension
(PARCEL "B")

County: Seminole

Township 21 South, Range 31 East

Section 13,

Begin at the Southeast Corner; thence North along the East Line for a distance of 2640 feet (more or less) to Willingham Road; thence South 45° West along said Willingham Road 1867 feet (more or less) to the West Line of the East 1/4; thence South along the West Line of the East 1/4 for a distance of 1320 feet (more or less) to the South Line of said Section 13; thence East along said South line for 1320 feet (more or less) to the Point of Beginning.

Section 24,

That part of the Northeast 1/4 of the Northeast 1/4 lying Northerly of State Road 419.

Township 21 South, Range 32 East

Section 17,

The West 1/2 of the Southwest 1/4.

Together with:

The North 1760 feet of the West 1/2 of the South 1/2 of the East 3/4 (LESS: The South 500 feet of the East 470.6 feet of the North 1760 feet of the West 1/2 of the South 1/2 of the East 3/4).

Section 18,

The South 1/2 (LESS: The North 1/4 of the Southwest 1/4).

Section 19,

That part lying Northerly of State Road 419.

Section 20,

The Northwest 1/4 of the Northwest 1/4.

(Parcel "B" contains 742.4806 Acres, more or less)

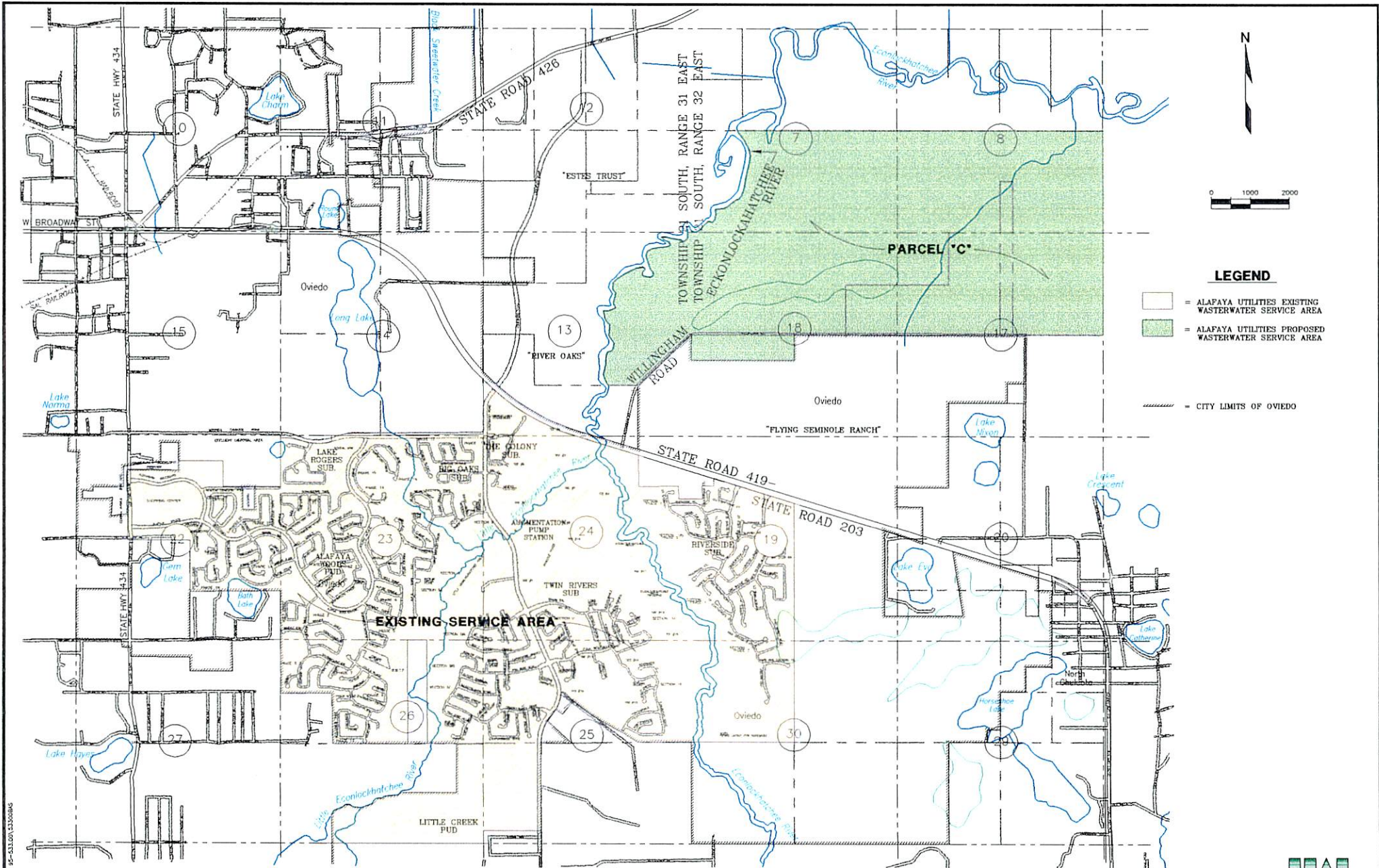

- LEGEND**
- = ALAFAYA UTILITIES EXISTING WASTERWATER SERVICE AREA
 - = ALAFAYA UTILITIES PROPOSED WASTERWATER SERVICE AREA
 - = CITY LIMITS OF OVIDO

ALAFAYA UTILITIES PROPOSED CERTIFICATE EXTENSION



15-433-001-03/06/08

Alafaya Utilities Proposed Certificate Extension
(PARCEL "C")

County: Seminole

Township 21 South, Range 31 East,

Section 13,

That part of the North 3/4 lying Southerly and Easterly of the Econlockhatchee River (LESS: Begin at the Southeast Corner of the North 3/4; thence North along the East Line of said Section 13 for a distance of 1320 feet (more or less) to Wilmingham Road; thence South 45° West along said Wilmingham Road for a distance of 1867 feet (more or less) to the South Line of the North 3/4 of said Section 13; thence East along said South Line of the North 3/4 for a distance of 1320 feet (more or less) to the Point of Beginning.)

Township 21 South, Range 32 East,

Section 7,

That part of the South 1/2 lying Easterly of the Econlockhatchee River.

Section 8,

The South 1/2.

Section 17,

The North 1/2.

Section 18,

The North 1/2.

Together with:

The North 1/4 of the Southwest 1/4.

(Parcel "C" contains 1388.3973 Acres, more or less)

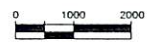
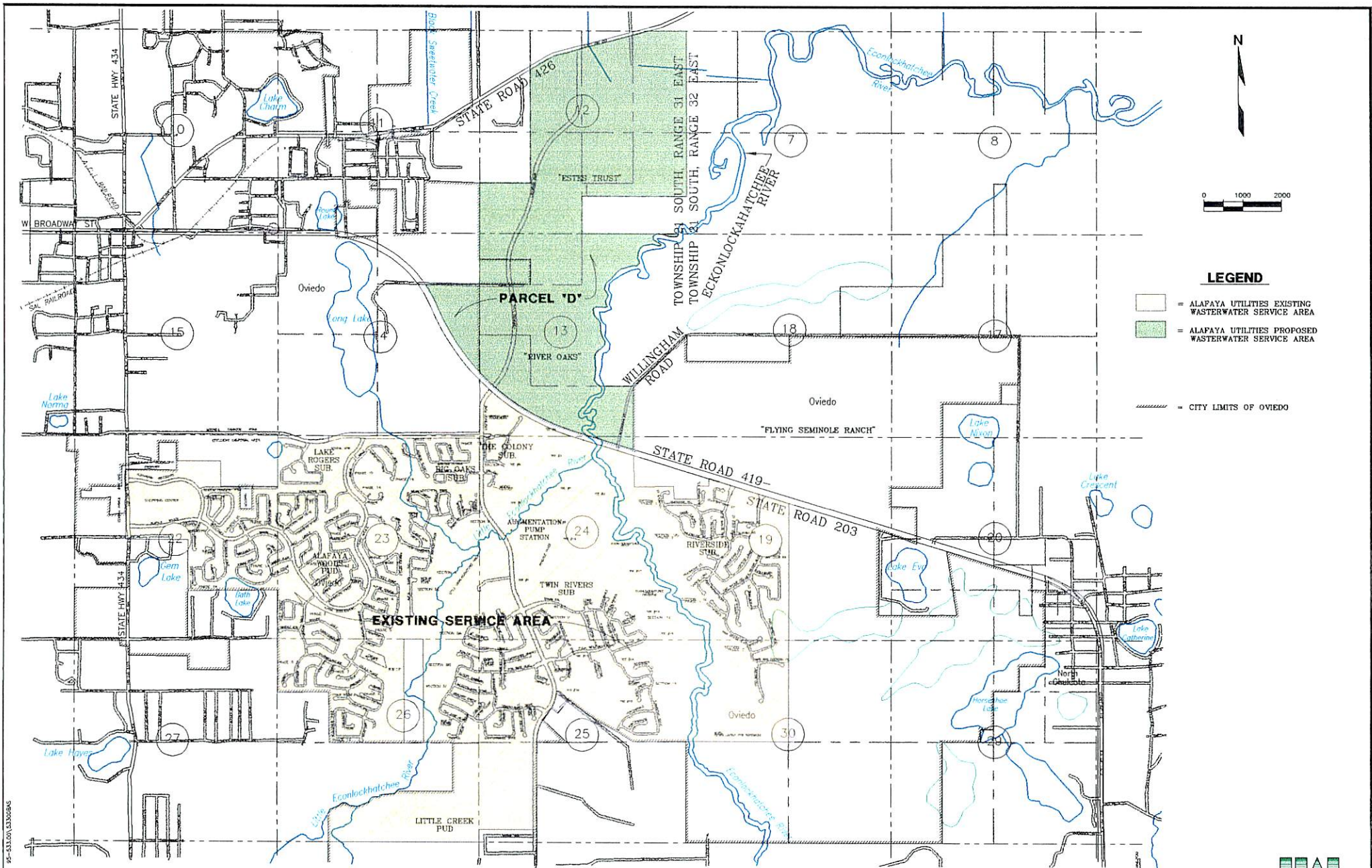

LEGEND

- = ALAFAYA UTILITIES EXISTING WASTEWATER SERVICE AREA
- = ALAFAYA UTILITIES PROPOSED WASTEWATER SERVICE AREA
- = CITY LIMITS OF OVIEDO

95-433.001.03.000898

ALAFAYA UTILITIES PROPOSED CERTIFICATE EXTENSION



Alafaya Utilities Proposed Certificate Extension
(PARCEL "D")

County: Seminole

Township 21 South, Range 31 East,

Section 12,

That part of the East 1/2 of the West 1/2 lying South of
State Road 426.

Together with:

The Southwest 1/4 of the Southwest 1/4.

Together with:

That part of the Northeast 1/4 lying South of State Road 426.

Together with:

The Southeast 1/4 (LESS: The North 330.5 feet of the
Southeast 1/4).

Section 13,

That part of the North 3/4 lying Westerly of the
Econlockhatchee River and lying Northerly of
State Road 419.

Together with:

The West 3/4 of the South 1/4.

Section 14,

That part of the South 3/4 of the East 1/2, lying North and
Easterly of State Road 419.

Section 24,

The Northwest 1/4 of the Northeast 1/4 lying North and Easterly
of State Road 419.

(Parcel "D" contains 865.5335 Acres, more or less)

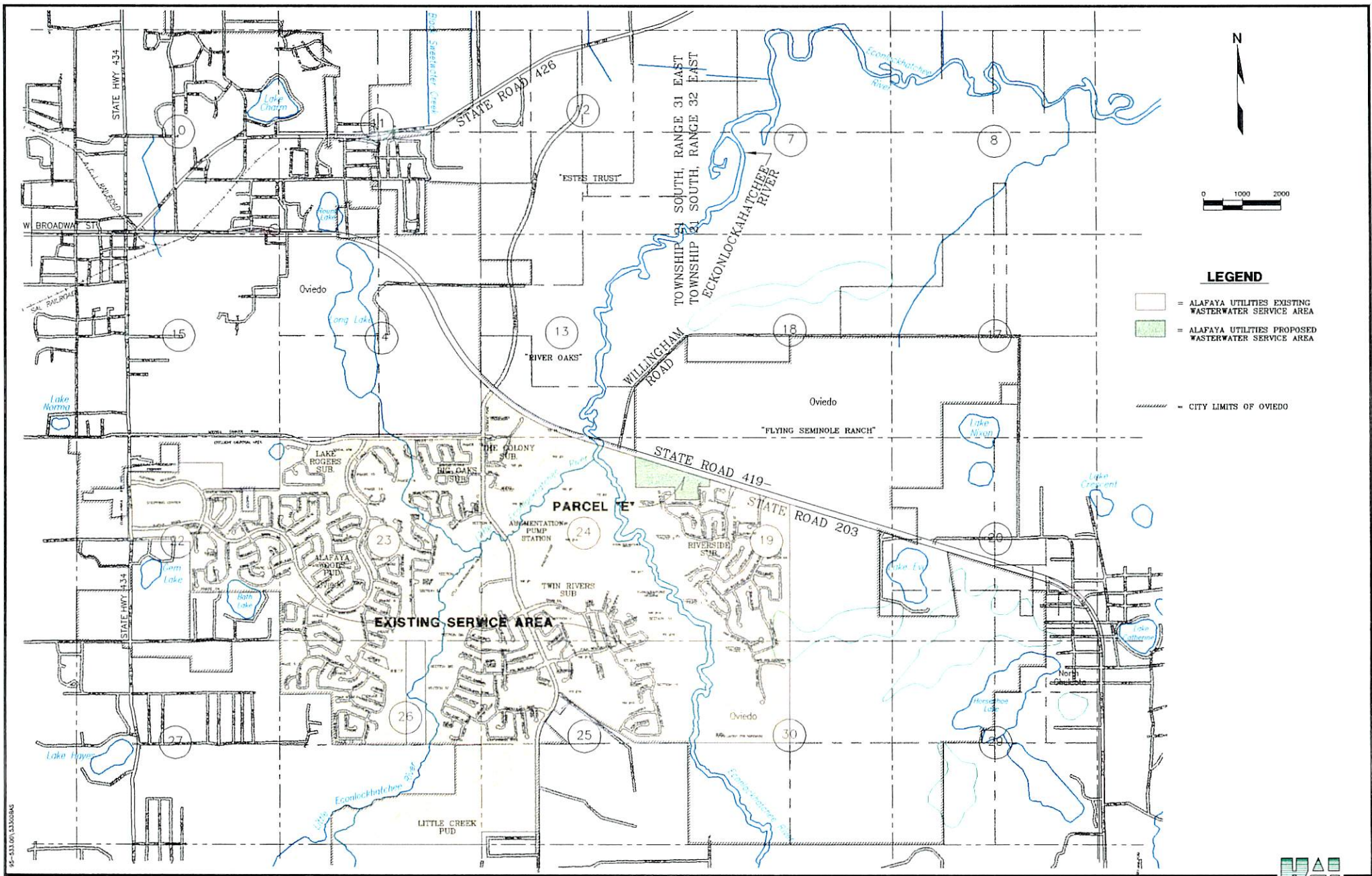

LEGEND

- = ALAFAYA UTILITIES EXISTING WASTERWATER SERVICE AREA
- = ALAFAYA UTILITIES PROPOSED WASTERWATER SERVICE AREA
- = CITY LIMITS OF OVIDO

15-531.001.03.0000AS

ALAFAYA UTILITIES PROPOSED CERTIFICATE EXTENSION



Alafaya Utilities Proposed Certificate Extension
(PARCEL "E")

County: Seminole

Township 21 South, Range 31 East,

Section 24,

That part of the Northeast 1/4 of the Northeast 1/4 lying
Southerly of State Road 419.

Together with:

The North 330 feet of the East 301.74 feet of the Southeast 1/4
of the Northeast 1/4.

Township 21 South, Range 32East,

Section 19,

That part of the Southwest 1/4 of Government Lot 1 lying
Southerly of State Road 419.

Together with:

The Northwest 1/4 of the Northwest 1/4 of Government Lot 2.

(Parcel "E" contains 26.3717 Acres, more or less)

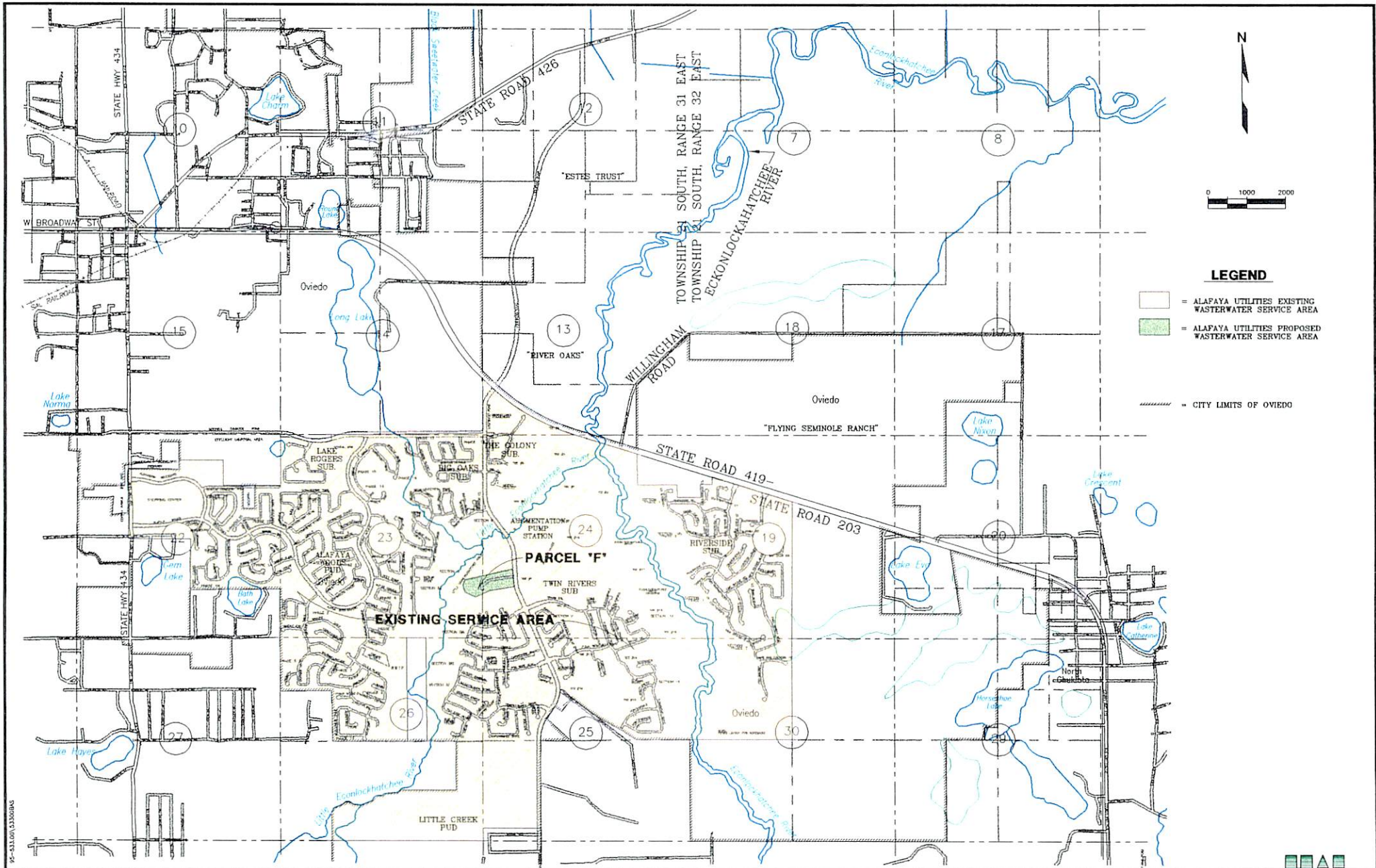

LEGEND

- = ALAFAYA UTILITIES EXISTING WASTERWATER SERVICE AREA
- = ALAFAYA UTILITIES PROPOSED WASTERWATER SERVICE AREA
- = CITY LIMITS OF OVIEDO

ALAFAYA UTILITIES PROPOSED CERTIFICATE EXTENSION



95-83106/13300846

Alafaya Utilities Proposed Certificate Extension
(PARCEL "F")

County: Seminole

Township 21 South, Range 31 East,

Section 23,

Begin 1192.97 feet North 02°25'58" West of the Southeast Corner; run South 56°14'08" West, 66.06 feet; North 80°10'45" West, 316.41 feet; North 16°03'38" West, 188.67 feet; North 19°45'34" East, 141.29 feet; North 77°12'32" East, 379.06 feet; South 00°25'58" East, 414.36 feet to the Point of Beginning.

Section 24,

Begin 1607.33 feet North 02°25'58" West of the Southwest Corner; run North 77°12'32" East, 800.92 feet to the Westerly Line of Lockwood Road; thence Southerly along said Westerly Line of Lockwood Road along a curve concave Easterly having a radius of 1003.48 feet; thence Southerly along said curve and Westerly Line, 292.05 feet, through a central angle of 16°40'32"; thence South 76°55'43" West 631.73 feet; thence South 56°14'08" West 315.67 feet; thence North 02°25'58" West, 414.36 feet to the Point of Beginning.

(Parcel "F" contains 12.8841 Acres, more or less)

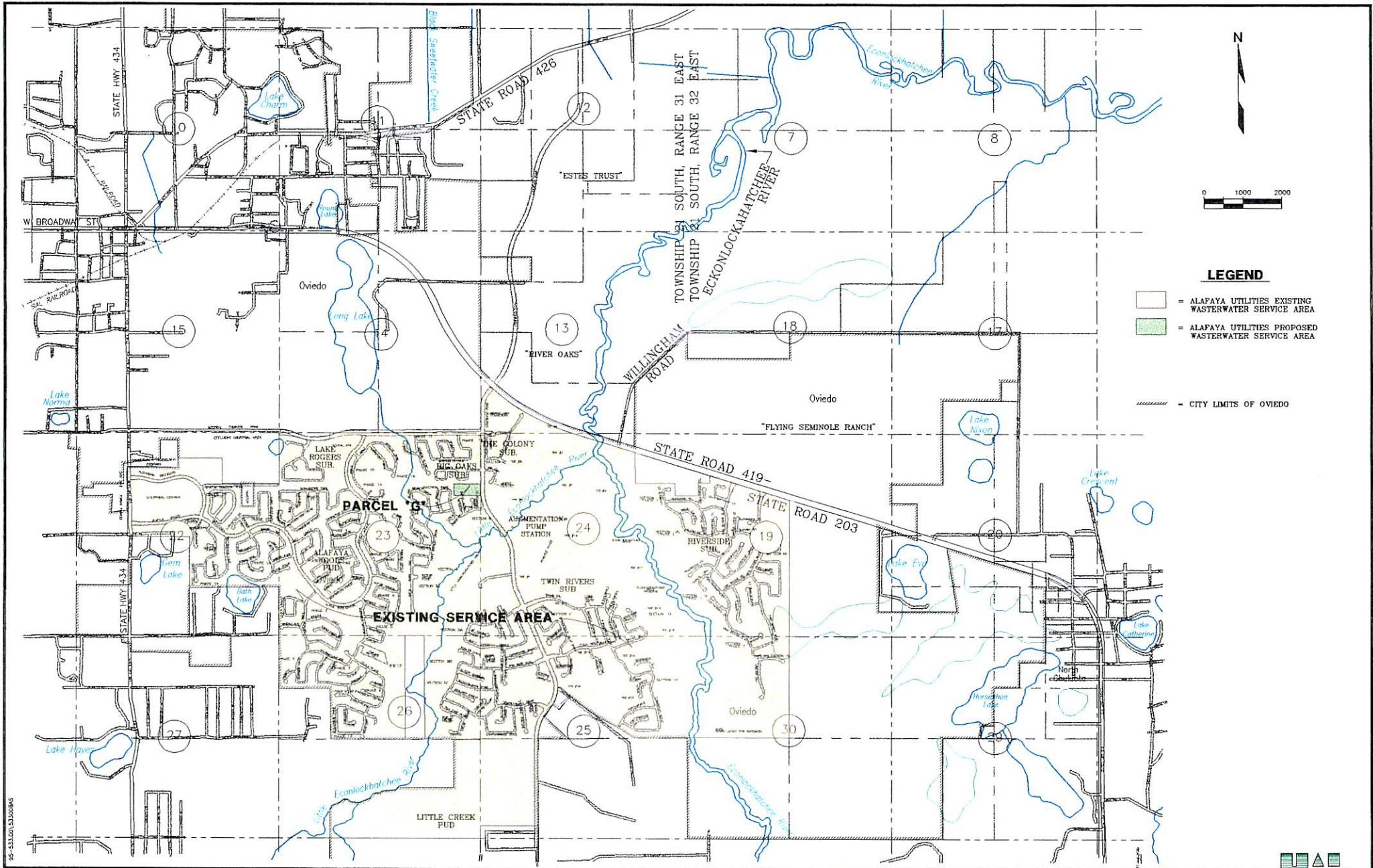

LEGEND

- = ALAFAYA UTILITIES EXISTING WASTERWATER SERVICE AREA
- = ALAFAYA UTILITIES PROPOSED WASTERWATER SERVICE AREA
- = CITY LIMITS OF OVIEDO



95-53101-03/04/05

Alafaya Utilities Proposed Certificate Extension
(PARCEL "G")

County: Seminole

Township 21 South, Range 31 East,

Section 23,

The North 231 feet of the East 660 feet of the Southeast 1/4 of
the Northeast 1/4.

(Parcel "G" contains 4.5837 Acres, more or less)

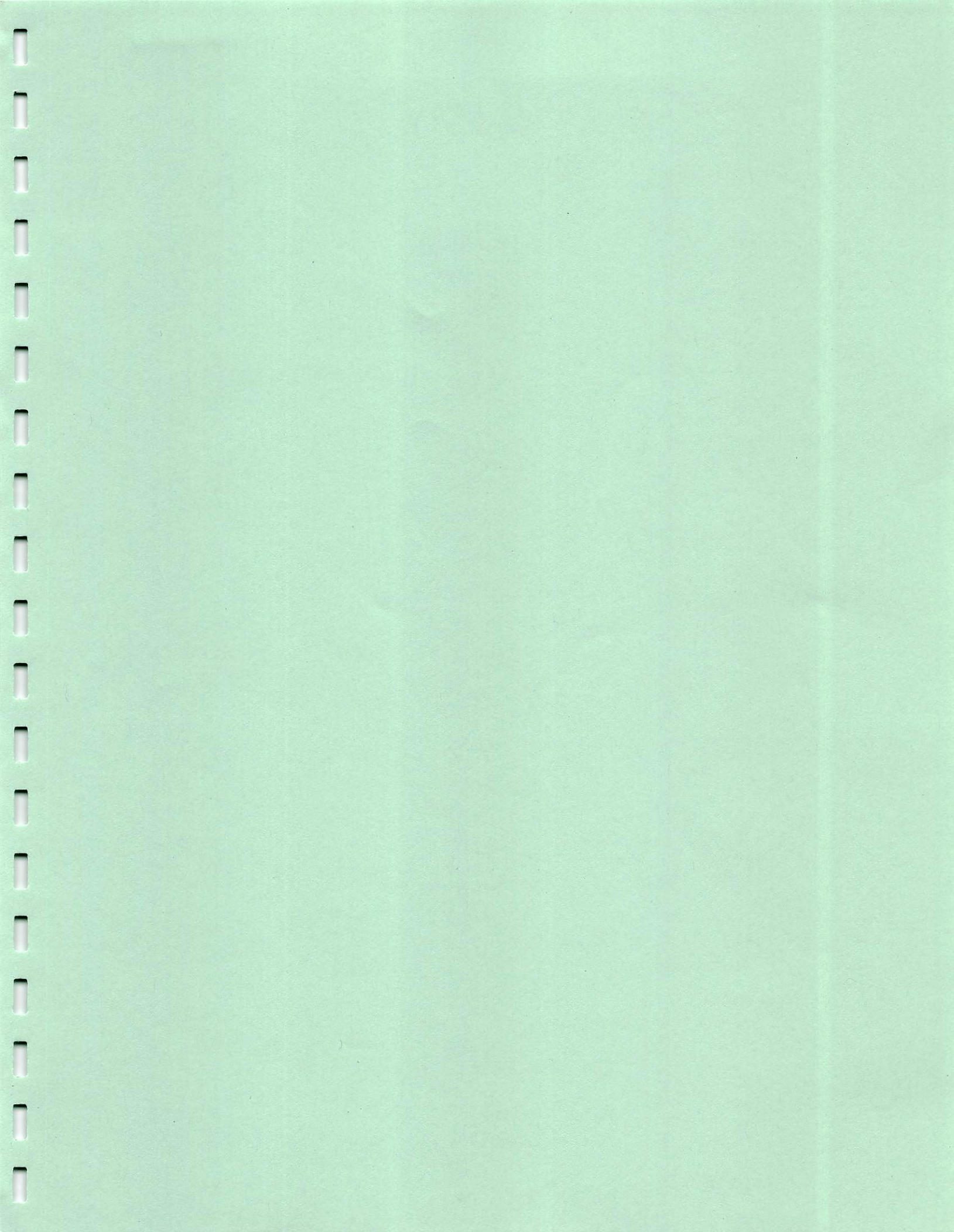

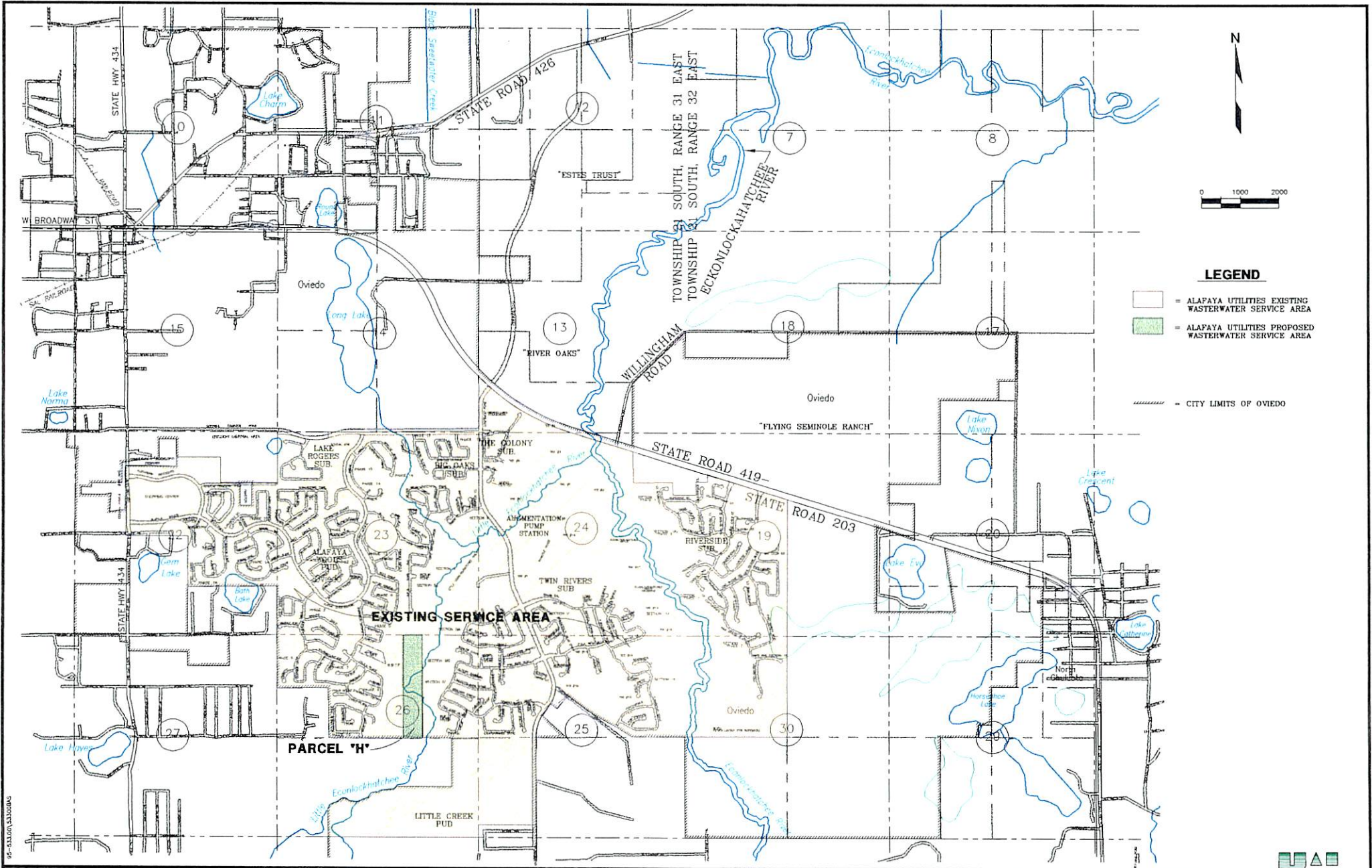

LEGEND

- = ALAFAYA UTILITIES EXISTING WASTEWATER SERVICE AREA
- = ALAFAYA UTILITIES PROPOSED WASTEWATER SERVICE AREA
- = CITY LIMITS OF OVIEDO

45-533.006.03.000000



Alafaya Utilities Proposed Certificate Extension
(PARCEL "H")

County: Seminole

Township 21 South, Range 31 East,

Section 26,
The West 1/4 of the Northeast 1/4.

(Parcel "H" contains 29.6789 Acres, more or less)

