



Florida Power & Light Company, P. O. Box 14000, Juno Beach, FL 33408-0420  
Law Department

ORIGINAL  
FILE COPY

(561) 691-7101

April 29, 1997

Ms. Blanco S. Bayó, Director  
Division of Records and Reporting  
Florida Public Service Commission  
2540 Shumard Oak Boulevard  
Tallahassee, Florida 32399-0850

970517-81

**RE: PETITION FOR APPROVAL OF ANNUAL UNDERGROUND  
RESIDENTIAL DISTRIBUTION TARIFF REVISION**

Dear Ms. Bayó:

Please find enclosed an original and fifteen copies of Florida Power & Light Company's Petition for Approval of 1997 Revisions to Florida Power & Light Company's Underground Residential Distribution Tariff. As is required by Rule 25-22.028, F.A.C., you will also find enclosed a diskette containing FPL's Petition in Word Perfect 5.2

If you have any questions regarding this filing, please call me at the above number.

Thank you for your assistance.

Very truly yours,

Patrick M. Bryan  
Attorney

- ACK  PMB/ak
- AFA
- APP  Enclosures
- CAF
- CMU  1727MII
- CTR
- EAG
- LEG
- LIN
- OFC
- RCH
- SEC
- WAS
- OTH

an FPL Group company

RECEIVED & FILED

DOCUMENT NUMBER-DATE  
04320 APR 30 1997  
FPSC-RECORDS/REPORTING

ORIGINAL  
FAC COPY

BEFORE THE  
FLORIDA PUBLIC SERVICE COMMISSION

In re: Petition for Approval of )  
Annual Underground Residential ) Docket No. \_\_\_\_\_  
Distribution Tariff Revision )  
\_\_\_\_\_ )

**PETITION FOR APPROVAL OF 1997 REVISIONS TO  
FLORIDA POWER & LIGHT COMPANY'S UNDERGROUND  
RESIDENTIAL DISTRIBUTION TARIFF**

COMES NOW Florida Power & Light Company (hereinafter FPL) pursuant to Rule 25-6.078 and 25-6.033, F.A.C., and hereby requests approval of FPL's revisions to its underground residential distribution tariff, as described below. Any pleading, motion, notice, order, or other document required to be served upon the petitioner or filed by any other party to this proceeding should be forwarded to the following individuals:

W. G. Walker, III  
Vice President  
Regulatory Affairs  
Florida Power & Light Company  
P.O. Box 029100  
Miami, Florida 33102-9100

Patrick M. Bryan  
Attorney  
Law Department  
Florida Power & Light Company  
700 Universe Boulevard  
Juno Beach, Florida 33408-0420

IN SUPPORT of its petition, FPL says:

1. Rule 25-6.078, F.A.C., requires the annual updating of the Estimated Average Cost Differential specified in FPL's tariffs utilizing cost data developed from the most recent 12 month period. This Petition and its appendices are filed to comply with said Rule.

2. In regard to compliance with Rule 25-6.078, F.A.C., FPL seeks the approval of the following revised tariff sheets which amend the charges found in Section 10, Supplement to

General Rules and Regulations for the Installation of Underground Electric Distribution Facilities to Serve Residential Customers, of FPL's tariff as found in Appendix 1:

Sheet No. 6.095  
Sheet No. 6.100  
Sheet No. 6.110  
Sheet No. 6.115  
Sheet No. 6.120  
Sheet No. 6.125  
Sheet No. 6.130  
Sheet No. 9.702

3. The revisions to the charges found in the above specified tariff sheets are shown in Legislative format in Appendix 4. Appendix 3 details and supports FPL's changes in its Estimated Average Cost Differential, which support the charges in FPL's tariffs identified above. Appendix 2 sets forth FPL's support for changes to its rules and regulations found in Section 10 of its tariff.

4. Appendices 1, 2, 3 and 4, filed herewith, are incorporated by reference.

5. FPL requests the effective date for implementation of the revised tariffs presented with this petition be 30 days after the day of the Commission's vote of approval.

WHEREFORE, Petitioner requests the Commission to approve the revised tariff sheets filed in Appendix 1, effective 30 days after the date of the Commission's vote of approval

Dated this 29th day of April, 1997.

Respectfully submitted,

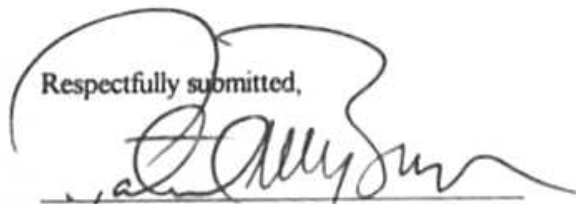

Patrick M. Bryan  
Attorney for Florida Power & Light Company  
700 Universe Boulevard, Bldg D-3  
Juno Beach, Florida 33408-0420  
Florida Bar No. 0457523

**Appendix No. 1**

(Continued from Sheet No. 6.090)

- 10.2.9. Location of Distribution Facilities  
Underground distribution facilities will be located, as determined by the Company, to maximize their accessibility for maintenance and operation. The Applicant shall provide accessible locations for meters when the design of a dwelling unit or its appurtenances limit perpetual accessibility for reading, testing, or making necessary repairs and adjustments.
- 10.2.10. Special Conditions  
The costs quoted in these rules are based on conditions which permit employment of rapid construction techniques. The Applicant shall be responsible for necessary additional hand digging expenses other than what is normally provided by the Company. The Applicant is responsible for clearing, compacting, boulder and large rock removal, stump removal, paving, and addressing other special conditions. Should paving, grass, landscaping or sprinkler systems be installed prior to the construction of the underground distribution facilities, the Applicant shall pay the added costs of trenching and backfilling and be responsible for restoration of property damaged to accommodate the installation of underground facilities.
- 10.2.11. Point of Delivery  
The point of delivery shall be determined by the Company and will normally be at or near the part of the building nearest the point at which the secondary electric supply is available to the property. When a location for a point of delivery different from that designated by the Company is requested by the Applicant, and approved by the Company, the Applicant shall pay the estimated full cost of service lateral length, including labor and materials, required in excess of that which would have been needed to reach the Company's designated point of service. The additional cost per trench foot is \$3.94. Where an existing trench is utilized, the additional cost per trench foot is \$1.91. Where the Applicant provides the trenching, installs Company provided conduit according to Company specifications and backfilling, the cost per additional trench foot is \$1.54. Any redesignation requested by the Applicant shall conform to good safety and construction practices as determined by the Company. Service laterals shall be installed, where possible, in a direct line to the point of delivery.
- 10.2.12. Location of Meter and Downpipe  
The Applicant shall install a meter enclosure, downpipe and e11 to accommodate the Company's service lateral conductors at the point designated by the Company. These facilities will be installed in accordance with the Company's specifications and all applicable codes.
- 10.2.13. Relocation or Removal of Existing Facilities:  
If the Company is required to relocate or remove existing facilities in the implementation of these Rules, all costs thereof shall be borne exclusively by the Applicant. These costs will include the costs of relocation or removal, the in-place value (less salvage) of the facilities so removed and any additional costs due to existing landscaping, pavement or unusual conditions.
- 10.2.14. Development of Subdivisions  
The Tariff charges are based on reasonably full use of the land being developed. Where the Company is required to construct underground electric facilities through a section or sections of the subdivision or development where full use of facilities as determined by the Company, will not be experienced for at least two years, the Company may require a deposit from the Applicant before construction is commenced. This deposit, to guarantee performance, will be based on the estimated total cost of such facilities rather than the differ nial cost. The amount of the deposit, without interest, less any required contributions will be returned to the Applicant on a pro rata basis at quarterly intervals on the basis of installations to new customers. Any portion of such deposit remaining unrefunded, after five years from the date the Company is first ready to re-start service from the extension, will be retained by the Company.

**SECTION 10.3 UNDERGROUND DISTRIBUTION FACILITIES FOR  
 RESIDENTIAL SUBDIVISIONS AND DEVELOPMENTS**

10.3.1. Availability

When requested by the Applicant, the Company will provide underground electric distribution facilities, other than for multiple occupancy buildings, in accordance with its standard practices in:

- a) Recognized new residential subdivision of five or more building lots.
- b) Tracts of land upon which five or more separate dwelling units are to be located.

For residential buildings containing five or more dwelling units, see SECTION 10.6 of these Rules.

10.3.2. Contribution by Applicant

a) The Applicant shall pay the Company the average differential cost for single phase residential underground distribution service based on the number of service laterals required or the number of dwelling units, as follows:

	<u>Applicant's Contribution</u>
1. Where density is 6.0 or more dwelling units per acre:	
1.1 Buildings that do not exceed four units, townhouses, and mobile homes - per service lateral.	\$224.00
1.2 Mobile homes having Customer-owned services from meter center installed adjacent to the FPL primary trench route - per dwelling unit.	\$22.00
2. Where density is 0.5 or greater, but less than 6.0 dwelling units per acre:	
Buildings that do not exceed four units, townhouses, and mobile homes - per service lateral	\$309.00
3. Where the density is less than 0.5 dwelling units per acre, or the Distribution System is of non-standard design, individual cost estimates will be used to determine the differential cost as specified in Paragraph 10.2.5.	

Additional charges specified in Paragraphs 10.2.10 and 10.2.11 may also apply.

b) The above costs are based upon arrangements that will permit serving the local underground distribution system within the subdivision from overhead feeder mains. If feeder mains within the subdivision are deemed necessary by the Company to provide and/or maintain adequate service and are required by the Applicant or a governmental agency to be installed underground, the Applicant shall pay the Company the average differential cost between such underground feeder mains within the subdivision and equivalent overhead feeder mains, as follows:

	<u>Applicant's Contribution</u>
Cost per foot of feeder trench within the subdivision (includes padmounted switches).	\$20.90

c) Where primary laterals are needed to cross open areas such as golf courses, parks, other recreation areas and water retention areas, the Applicant shall pay the average differential costs for these facilities as follows:

Cost per foot of primary lateral trench within the subdivision	\$3.00
--	--------

(Continued on Sheet No. 6.110)

(Continued from Sheet No. 6.100)

- d) For requests for service where underground facilities to the lot line are existing and a differential charge was previously paid for these facilities, the cost to install an underground service lateral to the meter is as follows:

Density less than 6.0 dwelling units per acre:	\$ 205.00
Density 6.0 or greater dwelling units per acre:	\$ 153.00

10.3.3. Contribution Adjustments

- a) Credits will be allowed to the Applicant's contribution in Section 10.3.2.a) where, by mutual agreement, the Applicant provides all trenching and backfilling for the Company's distribution system, excluding feeder.

	<u>Credit to Applicant's Contribution</u>	
	<u>Backbone</u>	<u>Service</u>
1. Where density is 6.0 or more dwelling units per acre:		
1.1 Buildings that do not exceed four units, townhouses, and mobile homes - per service lateral.	\$ 80.00	\$ 61.00
1.2 Mobile homes having Customer-owned services from meter center installed adjacent to the FPL primary trench route - per dwelling unit.	\$ 61.00	N/A
2. Where density is 0.5 or greater, but less than 6.0 dwelling units per acre:		
Buildings that do not exceed four units, townhouses, and mobile homes - per service lateral	\$ 111.00	\$ 109.00

- b) Credits will be allowed to the Applicant's contribution in Section 10.3.2.a) where, by mutual agreement, the Applicant installs all Company-provided conduit excluding feeder per FPL instructions. This credit is:

	<u>Credit to Applicant's Contribution</u>	
	<u>Backbone</u>	<u>Service</u>
1. Where density is 6.0 or more dwelling units per acre:		
1.1 Buildings that do not exceed four units, townhouses, and mobile homes - per service lateral.	\$ 33.00	\$ 15.00
1.2 Mobile homes having Customer-owned services from meter center installed adjacent to the FPL primary trench route - per dwelling unit.	\$ 25.00	N/A
2. Where density is .5 or greater, but less than 6.0 dwelling units per acre, per service lateral.	\$ 45.00	\$ 23.00

(Continued on Sheet No. 6.115)

(Continued from Sheet No. 6.110)

- c) Credits will be allowed to the Applicant's contribution in Section 10.3.2. where, by mutual agreement, the Applicant provides a portion of trenching and backfilling for the Company's facilities. The credit is:

Credit per foot of trench within the subdivision      \$ 1.70

- d) Credits will be allowed to the Applicant's contribution in section 10.3.2. where, by mutual agreement, the Applicant installs a portion of Company-provided PVC conduit, per FPL instructions (per foot of conduit): 2" PVC - \$.30; larger than 2" PVC - \$.42.
- e) Credit will be allowed to the Applicant's contribution in section 10.3.2., where, by mutual agreement, the Applicant installs an FPL-provided feeder splice box, per FPL instructions, per box - \$441.00.
- f) Credit will be allowed to the Applicant's contribution in section 10.3.2., where by mutual agreement, the Applicant installs an FPL-provided primary splice box, per FPL instructions, per box - \$116.00.
- g) Credit will be allowed to the Applicant's contribution in section 10.3.2., where, by mutual agreement, the Applicant installs an FPL-provided secondary handhole, per FPL instructions, per handhole: 17" handhole - \$11.00; 24" handhole - \$31.00.
- h) Credit will be allowed to the Applicant's contribution in section 10.3.2., where, by mutual agreement, the Applicant installs an FPL-provided concrete pad for a pad-mounted transformer, per FPL instructions, per pad - \$18.00.
- i) Credit will be allowed to the Applicant's contribution in Section 10.3.2., where, by mutual agreement, the Applicant installs a portion of Company-provided flexible HDPE conduit, per FPL instructions (per foot of conduit): \$.06.
- j) Credit will be allowed to the Applicant's contribution in Section 10.3.2., where, by mutual agreement, the Applicant installs an FPL-provided concrete pad and cable chamber for a pad-mounted feeder switch, per pad and cable chamber \$444.00.



SECTION 10.4 UNDERGROUND SERVICE LATERALS FROM  
OVERHEAD ELECTRIC DISTRIBUTION SYSTEMS10.4.1. New Underground Service Laterals

When requested by the Applicant, the Company will install underground service laterals from overhead systems to newly constructed residential buildings containing less than five separate dwelling units.

10.4.2. Contribution by Applicant

a) The Applicant shall pay the Company the following differential cost between an overhead service and an underground service lateral, as follows:

	<u>Applicant's Contribution</u>
1. For any density:	
Buildings that do not exceed four units, townhouses, and mobile homes - per service lateral.	\$ 383.00
2. For any density, the Company will provide a riser to a handhole at the base of a pole - per service lateral.	\$ 359.00

Additional charges specified in Paragraph 10.2.10. and 10.2.11. may also apply. Underground service or secondary extensions beyond the boundaries of the property being served will be subject to additional differential costs as determined by individual cost estimates.

10.4.3. Contribution Adjustments

a) Credit will be allowed to the Applicant's contribution in Section 10.4.2. where, by mutual agreement, the Applicant provides trenching and backfilling for the Company's facilities. This credit is:

	<u>Credit To Applicant's Contribution</u>
1. For any density:	
Buildings that do not exceed four units, townhouses, and mobile homes - per foot.	\$ 1.70

(Continued on Sheet No. 6.125)

(Continued from Sheet No. 6.120)

- b) Credit will be allowed to the Applicant's contribution in Section 10.4.2, where by mutual agreement, the Applicant installs Company-provided conduit, per FPL instructions, as follows:

1. For any density:

Buildings that do not exceed four units,  
townhouses, and mobile homes

- per foot:

2" PVC	\$ .30
Larger than 2" PVC	\$ .42

**SECTION 10.5 UNDERGROUND SERVICE LATERALS REPLACING  
 EXISTING RESIDENTIAL OVERHEAD AND UNDERGROUND SERVICES**

10.5.1. **Applicability**  
 When requested by the Applicant, the Company will install underground service laterals from existing systems as replacements for existing overhead and underground services to existing residential buildings containing less than five individual dwelling units.

10.5.2. **Rearrangement of Service Entrance**  
 The Applicant shall be responsible for any necessary rearranging of his existing electric service entrance facilities to accommodate the proposed underground service lateral in accordance with the Company's specifications.

10.5.3 **Trenching and Conduit Installation**  
 The Applicant shall also provide, at no cost to the Company, a suitable trench, perform the backfilling and any landscape, pavement or other similar repairs and install Company provided conduit according to Company specifications. When requested by the Applicant and approved by the Company, the Company may supply the trench and conduit and the Applicant shall pay for this work based on a specific cost estimate. Should paving, grass, landscaping or sprinkler systems need repair or replacement during construction, the Applicant shall be responsible for restoring the paving, grass, landscaping or sprinkler systems to the original condition.

10.5.4. **Contribution by Applicant**

- a) The charge per service lateral replacing an existing Company-owned overhead service for any density shall be:
 

Applicant's Contribution	\$ 291.00
--------------------------	-----------
- b) The charge per service lateral replacing an existing Company-owned underground service at Applicant's request for any density shall be:
 

1. Where the service is from an overhead system:	\$ 286.00
2. Where the service is from an underground system:	\$ 248.00
- c) The charge per service lateral replacing an existing Customer-owned underground service from an overhead system for any density shall be:
 

\$ 255.00
-----------
- d) The charge per service lateral replacing an existing Customer-owned underground service from an underground system for any density shall be:
 

\$ 77.00
----------

(Continued from Sheet No. 9.701)

- e) Pay for all additional costs incurred by FPL which may include, but are not limited to, engineering design, administration and relocation expenses, due to changes made subsequent to this agreement on the subdivision or development layout or grade.
  - f) Provide applicable trenching, backfilling and installation of Company provided conduit in accordance with FPL specifications.
  - g) Provide a meter enclosure, downpipe and ell which meet all applicable codes and FPL specifications and which will accommodate FPL's service cable size and design. These items must be confirmed with FPL prior to purchase. FPL will not be responsible for costs involved in modifying or replacing items which do not meet the above criteria.
9. FPL shall:
- a) Provide the Customer with a plan showing the location of all FPL underground facilities, point of delivery, and transformer locations and specifications required by FPL and to be adhered to by the Customer.
  - b) Install, own, and maintain the electric distribution facilities up to the designated point of delivery except when otherwise noted.
  - c) Request the Customer to participate in a pre-construction conference with the Customer's contractors, the FPL representatives and other utilities within six (6) weeks of the start of construction. At the pre-construction conference, FPL shall provide the Customer with an estimate of the date when service may be provided.
10. This Agreement is subject to FPL's Electric Tariff, including but not limited to the General Rules and Regulations for Electric Service and the Rules of the Florida Public Service Commission, as they are now written, or as they may be revised, amended or supplemented.

The Customer and FPL will coordinate closely in fulfilling obligations in order to avoid delays in providing permanent electric service at the time of the Customer's receipt of a certificate of occupancy.

Accepted:

\_\_\_\_\_  
 For FPL (Date)

Accepted:

\_\_\_\_\_  
 Customer (Date)

\_\_\_\_\_  
 Witness (Date)

\_\_\_\_\_  
 Witness (Date)

**Appendix No. 2**

Appendix No. 2  
FPL 1997  
Explanation of Proposed Revisions

This Appendix is to summarize proposed revisions to the Rules and Regulations included in Section 10 of FPL's General Rules and Regulations for Electric Service and in Standard Forms. An explanation of FPL's proposed tariff charges for underground installations can be found in Appendix No. 3.

The Fifteenth Revised Sheet No. 6.095 is revised to add more specific wording to clarify the intent of paragraph 10.2.12.

The Fifth Revised Sheet No. 9.702 is issued to add paragraph 8.g) to emphasize that the meter enclosure, downpipe, and ell must be confirmed with FPL before purchase to ensure that they meet all requirements and to avoid unnecessary expense to the Customer.

**Appendix No. 3**

APPENDIX NO. 3

FPL - 1997

**BASIS FOR UNDERGROUND RESIDENTIAL  
DISTRIBUTION DIFFERENTIAL**

**New Underground Subdivision with Overhead Feeder Mains.** The average differential costs for Underground Residential Distribution (URD) stated in the FPL Rules and Regulations were derived from cost estimates of underground facilities and their equivalent overhead designs. The high density subdivision used for these estimates was developed by the group of Florida Electric Utilities in response to Florida Public Service Commission Orders No. 6031 and 6031-B. The low density subdivision was also developed by the group of Florida Electric Utilities and was approved by Florida Public Service Commission Order No. PSC-96-0026-FOF-EI. They represent average conditions in Florida Subdivisions served by FPL. Densities range from 0.5 to 6.0 lots per acre for low density subdivisions. The low density subdivision contains 210 lots; the high density subdivision 176 lots. Subdivision plats are shown in Exhibits IV and XI. Differential cost estimates were made from engineering layouts of underground and overhead facilities. These included primary laterals, transformers, secondary lines and services, but not three phase feeders. These estimates employed the standard Company design and estimating practices and the system-wide unit cost for labor and material which were in use at the end of 1996. Design criteria included the following:

Design Customer Demand	-	7.25 KVA, including 2 1/2 tons of air conditioning for high density model and 9.35 KVA including 3 1/2 tons of air conditioning for low density model according to DERM.(1)
Primary Voltage	-	13200/7620 Volts
Underground Design	-	Rear/Front lot construction - All C-I-C*
Overhead Design	-	Rear/Front lot construction

1 FPL Distribution Engineering Reference Manual

\* All cables are to be installed in PVC conduit.



Estimates are broken down into a uniform format adopted as a standard by the participating companies (Exhibit I-X). The results of these estimates are as follow:

		<u>Differential Cost</u>
		<u>All Soil Conditions</u>
Case 1.	Where density is 0.5 or greater, but less than 6 dwelling units per acre: Buildings that do not exceed four units, townhouses, and mobile homes -- per service lateral.....	\$309.00
Case 2.	Where density is 6.0 or more dwelling units per acre: Buildings that do not exceed four units, townhouses, and mobile homes -- per service lateral.....	\$224.00
Case 3.	Where density is 6.0 or more dwelling units per acre: Mobile homes having Customer-owned services from meter centers installed adjacent to the FPL primary trench route -- per dwelling unit.....	\$22.00

**10.4.2 UG Service Laterals from Overhead Lines.** Service lateral costs are included in the differential costs previously stated except in Case 3. The costs of service laterals were estimated separately to determine the differential cost between a standard overhead service and a similar length underground service from an overhead line. This differential cost was calculated by adding the differential service lateral cost to the pole-conduit terminal cost. The average pole-conduit terminal cost was found to be \$177.76 per service lateral.

Service lateral cost.....	\$205.23
Pole-conduit cost.....	\$177.76
Total cost.....	<u>\$382.99</u>
Round To.....	\$383.00

A URD riser to a handhole at the base of the pole had a differential cost of \$358.87.

**10.5.4 Replacement of an Existing Service with an Underground Service.**

Costs were also estimated for replacing existing services with underground service laterals. These costs were based on the applicant providing the trench because of the wide variations in the cost of excavating established, landscaped area. Additional costs are associated with removal and premature retirement of existing services. Accordingly, adjustments were made to the cost of a new service lateral by adding the costs involved with the retirement of an existing service drop and subtracting trenching costs. The costs were estimated to be:

**A. Cost per service lateral to replace Company-owned Overhead Service with:**

	Company UG <u>Service</u>	Riser to <u>Handhole</u>
UG service lateral cost.....	\$382.99	\$0.00
Riser to handhole cost.....	\$0.00	\$358.87
Less trenching credit.....	(\$109.00)	\$0.00
Less conduit installation credit.....	(\$19.00)	\$0.00
Remaining value of existing service.....	\$20.51	\$20.51
Removal cost of existing service.....	\$22.51	\$22.51
Salvage.....	<u>(\$7.01)</u>	<u>(\$7.01)</u>
Total cost.....	\$291.00	\$394.88
Round To.....	\$291.00	\$395.00

**B. Cost per service lateral to replace Company-owned Underground Service.**

	<u>OH Source</u>	<u>UG Source</u>
UG service lateral cost.....	\$205.23	\$205.23
Handhole for connection to existing riser X .25.....	\$37.59	\$0.00
Less trenching credit.....	(\$109.00)	(\$109.00)
Less conduit credit.....	(\$19.00)	(\$19.00)
Remaining value of existing service.....	\$172.29	\$172.29
Removal cost of existing service.....	\$7.42	\$7.42
Salvage.....	<u>(\$8.68)</u>	<u>(\$8.68)</u>
Total Cost.....	\$285.85	\$248.28
Round To.....	\$286.00	\$248.00

**C. Cost to replace Customer-owned Underground Service from an Overhead System.**

UG service lateral cost.....	\$205.23
Pole-conduit cost.....	\$177.76
Less trenching credit.....	(\$109.00)
Less conduit installation credit.....	<u>(\$19.00)</u>
TOTAL.....	\$254.99
Round To.....	\$255.00

**D. Cost to replace Customer-owned Underground Service from an Underground System**

UG service lateral cost.....	\$205.23
Less trenching credit.....	(\$109.00)
Less conduit installation credit.....	<u>(\$19.00)</u>
TOTAL.....	\$77.23
Round To.....	\$77.00

**Underground Feeder/Lateral Cost.** Cost estimates were made for underground and overhead feeders and laterals necessary to serve residential communities in the mode subdivisions. The average differential costs per foot were then determined. These results are shown in Exhibit XII.

Underground feeders/laterals were assumed to be installed in conduit with above grade switch cabinets. Overhead feeder costs included wood pole costs.

**Operating and Maintenance Costs.** These costs for 1996 are furnished with the costs broken down to the various point accounts for overhead and underground. See Exhibit XIII.

**Cumulative Overhead and Underground Customers.** The cumulative total of overhead and underground customers as of December 31, 1996 served by FPL are as follows:

Underground.....	2,178,608
Overhead.....	1,684,054
Total*.....	3,862,662

NOTES: 1. Many of the underground systems are supplied by overhead feeders and laterals.

\*2. This figure includes inactive meters and outdoor lighting.

**Joint Trenching.** Exhibit XIV, attached, is a list of Joint Trench Installations made during 1996 with a summary of Joint Trench Footage installed since 1971.

URD REPORT TO THE FLORIDA PUBLIC SERVICE COMMISSION

FPL

DATE: 3/1/97

OVERHEAD VS. UNDERGROUNDSUMMARY SHEETCOST PER SERVICE LATERAL -BUILDINGS WITH DENSITY0.5 OR GREATER BUT LESS THAN 6 DWELLING UNITS PER ACRE(EXCLUDING MULTIPLE OCCUPANCY BUILDINGS)

ITEM	OVERHEAD	UNDERGROUND	DIFFERENTIAL
LABOR	\$421.73	\$648.21	\$226.48
MATERIAL	\$491.37	\$573.61	\$82.24
TOTAL	\$913.10	\$1,221.82	\$308.72

EXHIBIT I

**COST PER SERVICE LATERAL OVERHEAD MATERIAL AND LABOR****BUILDINGS WITH DENSITY 0.5 OR GREATER****BUT LESS THAN 6 DWELLING UNITS PER ACRE****(EXCLUDING MULTIPLE OCCUPANCY BUILDINGS)****1997**

ITEM	MATERIAL(1)	LABOR(4)	TOTAL
Service(2)	\$70.50	\$73.60	\$144.10
Primary	\$44.13	\$43.87	\$88.00
Secondary	\$56.46	\$66.35	\$122.81
Initial Tree Trim	_____	_____	_____
Poles	\$110.30	\$153.03	\$263.33
Transformers	\$101.95	\$21.64	\$123.59
Sub-Total	\$383.34	\$358.49	\$741.83
Stores Handling(3)	\$34.35	_____	\$34.35
SubTotal	\$417.69	\$358.49	\$776.18
Engineering(5)	\$73.68	\$63.24	\$136.92
TOTAL	\$491.37	\$421.73	\$913.10

1 - Includes Sales Tax.

2 - Includes Meters.

3 - 9.24% of All Material Except Meters. 4.62% of Meters.

4 - Includes Payroll, Taxes, Insurance, P&amp;W, &amp; Transportation.

5 - 17.64% of All Material and Labor.

EXHIBIT II

**COST PER SERVICE LATERAL UNDERGROUND MATERIAL AND LABOR****BUILDINGS WITH DENSITY 0.5 OR GREATER****BUT LESS THAN 6 DWELLING UNITS PER ACRE****(EXCLUDING MULTIPLE OCCUPANCY BUILDINGS)****1997**

ITEM	MATERIAL(1)	LABOR(4)	TOTAL
Service(2)	\$177.59	\$198.75	\$376.34
Primary	\$131.72	\$87.75	\$219.47
Secondary	\$33.60	\$17.27	\$50.87
Transformers	\$104.42	\$7.15	\$111.57
Prim. & Sec. Trenching	————	\$92.72	\$92.72
Service Trenching	————	\$147.37	\$147.37
Sub-Total	\$447.33	\$551.01	\$998.34
Stores Handling(3)	\$40.27	————	\$40.27
SubTotal	\$487.60	\$551.01	\$1,038.61
Engineering(5)	\$86.01	\$97.20	\$183.21
TOTAL	\$573.61	\$648.21	\$1,221.82

1 - Includes Sales Tax.

2 - Includes Meters.

3 - 9.24% of All Material Except Meters. 4.62% of Meters.

4 - Includes Payroll, Taxes, Insurance, P&amp;W, &amp; Transportation.

5 - 17.64% of All Material and Labor.





1/2" = 10'   
 1/4" = 10'   
 1/8" = 10'   
 1/16" = 10'   
 1/32" = 10'   
 1/64" = 10'

- NOTES:
1. ALL SERVICE CABLES ARE 1/2" DIA (1/2" DIA) UNLESS OTHERWISE NOTED.
  2. ALL RECORDING CABLES ARE 1/4" DIA UNLESS OTHERWISE NOTED.
  3. ALL RECORDING CABLES ARE 1/4" DIA UNLESS OTHERWISE NOTED.
  4. ALL PLOTS ARE 15' X 30'

1/2" = 10'   
 1/4" = 10'   
 1/8" = 10'   
 1/16" = 10'   
 1/32" = 10'   
 1/64" = 10'



U.S. LAY/OUT LOW CAPACITY 1987 AND 1988	
DATE:	1-1-88
BY:	J.P.
CHECKED BY:	J.P.
SCALE:	1/2" = 10'
PROJECT NO.:	100-100-100
SHEET NO.:	2 OF 2
TITLE:	UTILITY LAYOUT FOR LOT 1, PLOT 1
DATE:	1-1-88
BY:	J.P.
CHECKED BY:	J.P.
SCALE:	1/2" = 10'
PROJECT NO.:	100-100-100
SHEET NO.:	2 OF 2
TITLE:	UTILITY LAYOUT FOR LOT 1, PLOT 1

URD REPORT TO THE FLORIDA PUBLIC SERVICE COMMISSION

FPL

DATE: 3/1/97

OVERHEAD VS. UNDERGROUNDSUMMARY SHEET

COST PER SERVICE LATERAL FOR MOBILE HOMES, TOWNHOUSES, AND OTHER  
DWELLINGS WITH DENSITY OF 6 OR MORE DWELLING UNITS PER ACRE-  
EACH DWELLING ON AN INDIVIDUAL LOT WITH AN INDIVIDUAL SERVICE LATERAL

ITEM	OVERHEAD	UNDERGROUND	DIFFERENTIAL
LABOR	\$287.85	\$424.12	\$136.27
MATERIAL	\$322.47	\$410.38	\$87.91
TOTAL	\$610.32	\$834.50	\$224.18

EXHIBIT V

**COST PER SERVICE LATERAL OVERHEAD MATERIAL AND LABOR**  
**DWELLINGS WITH DENSITY OF 6 OR MORE DWELLING UNITS PER ACRE**  
**EACH DWELLING ON AN INDIVIDUAL LOT WITH AN INDIVIDUAL SERVICE LATERAL**

**1997**

ITEM	MATERIAL(1)	LABOR(4)	TOTAL
Service(2)	\$58.94	\$66.34	\$125.28
Primary	\$22.87	\$33.92	\$56.79
Secondary	\$44.71	\$43.66	\$88.37
Initial Tree Trim	-----	-----	-----
Poles	\$59.99	\$86.19	\$146.18
Transformers	\$65.40	\$14.58	\$79.98
Sub-Total	\$251.91	\$244.69	\$496.60
Stores Handling(3)	\$22.21	-----	\$22.21
SubTotal	\$274.12	\$244.69	\$518.81
Engineering(5)	\$48.35	\$43.16	\$91.51
<b>TOTAL</b>	<b>\$322.47</b>	<b>\$287.85</b>	<b>\$610.32</b>

1 - Includes Sales Tax.

2 - Includes Meters.

3 - 9.24% of All Material Except Meters. 4.62% of Meters.

4 - Includes Payroll, Taxes, Insurance, P&W, & Transportation.

5 - 17.64% of All Material and Labor.

**EXHIBIT VI**

**COST PER SERVICE LATERAL UNDERGROUND MATERIAL AND LABOR**  
**DWELLINGS WITH DENSITY OF 6 OR MORE DWELLING UNITS PER ACRE**  
**EACH DWELLING ON AN INDIVIDUAL LOT WITH AN INDIVIDUAL SERVICE LATERAL**

**1997**

ITEM	MATERIAL(1)	LABOR(4)	TOTAL
Service(2)	\$133.28	\$121.98	\$255.24
Primary	\$77.51	\$65.96	\$143.47
Secondary	\$30.23	\$13.92	\$44.15
Transformers	\$79.29	\$5.69	\$84.98
Prim. & Sec. Trenching	-----	\$58.66	\$58.66
Service Trenching	-----	\$94.33	\$94.33
Sub-Total	\$320.31	\$360.52	\$680.83
Stores Handling(3)	\$28.53	-----	\$28.53
SubTotal	\$348.84	\$360.52	\$709.36
Engineering(5)	\$61.54	\$63.60	\$125.14
<b>TOTAL</b>	<b>\$410.38</b>	<b>\$424.12</b>	<b>\$834.50</b>

1 - Includes Sales Tax.

2 - Includes Meters.

3 - 9.24% of All Material Except Meters. 4.62% of Meters.

4 - Includes Payroll, Taxes, Insurance, P&W, & Transportation.

5 - 17.64% of All Material and Labor.

**EXHIBIT VII**

**URD REPORT TO THE FLORIDA PUBLIC SERVICE COMMISSION**

FPL

DATE: 3/1/97

**OVERHEAD VS. UNDERGROUND****SUMMARY SHEET****COST PER DWELLING UNIT FOR MOBILE HOMES****WITH DENSITY OF 6 OR MORE DWELLING UNITS PER ACRE****WITH CUSTOMER-OWNED SERVICES FROM METER CENTERS**

ITEM	OVERHEAD	UNDERGROUND	DIFFERENTIAL
LABOR	\$235.88	\$228.27	(\$7.61)
MATERIAL	\$279.70	\$308.91	\$29.21
TOTAL	\$515.58	\$537.18	\$21.60

**COST PER DWELLING UNIT OVERHEAD MATERIAL AND LABOR**  
**MOBILE HOMES WITH DENSITY OF 6 OR MORE DWELLING UNITS PER ACRE**  
**WITH CUSTOMER-OWNED SERVICES FROM METER CENTERS**

**1997**

ITEM	MATERIAL(1)	LABOR(4)	TOTAL
Service(2)	\$30.23	\$27.25	\$57.48
Primary	\$22.41	\$33.01	\$55.42
Secondary	\$44.38	\$41.46	\$85.84
Initial Tree Trim	-----	-----	-----
Poles	\$57.94	\$84.21	\$142.15
Transformers	\$63.67	\$14.58	\$78.25
Sub-Total	\$218.63	\$200.51	\$419.14
Stores Handling(3)	\$19.13	-----	\$19.13
SubTotal	\$237.76	\$200.51	\$438.27
Engineering(5)	\$41.94	\$35.37	\$77.31
TOTAL	\$279.70	\$235.88	\$515.58

1 - Includes Sales Tax.

2 - Includes Meters.

3 -9.24% of All Material Except Meters. 4.62% of Meters.

4 - Includes Payroll, Taxes, Insurance, P&W, & Transportation.

5 -17.64% of All Material and Labor.

EXHIBIT IX

**COST PER DWELLING UNIT UNDERGROUND MATERIAL AND LABOR**  
**MOBILE HOMES WITH DENSITY OF 6 OR MORE DWELLING UNITS PER ACRE**  
**WITH CUSTOMER-OWNED SERVICES FROM METER CENTERS**

**1997**

ITEM	MATERIAL(1)	LABOR(4)	TOTAL
Service(2)	\$25.13	\$13.16	\$38.29
Primary	\$90.50	\$77.51	\$168.01
Secondary	\$56.70	\$31.72	\$88.42
Transformers	\$89.03	\$4.74	\$73.77
Prim. & Sec. Trenching	—————	\$66.91	\$66.91
Service Trenching	—————	—————	—————
Sub-Total	\$241.36	\$194.04	\$435.40
Stores Handling(3)	\$21.23	—————	\$21.23
SubTotal	\$262.59	\$194.04	\$456.63
Engineering(5)	\$46.32	\$34.23	\$80.55
TOTAL	\$308.91	\$228.27	\$537.18

1 - Includes Sales Tax.

2 - Includes Meters.

3 - 9.24% of All Material Except Meters. 4.62% of Meters.

4 - Includes Payroll, Taxes, Insurance, P&W, & Transportation.

5 - 17.64% of All Material and Labor.

EXHIBIT X







**NOTES**  
 1. METER LOCATIONS ① & ② HAVE BEEN DELETED.  
 2. ALL SLOTS TO CARRY WATER PEDISTALS ARE 8" DIA. 16" LONG.  
 3. ALL POLES ARE 30' / 3" UNLESS NOTED OTHERWISE.

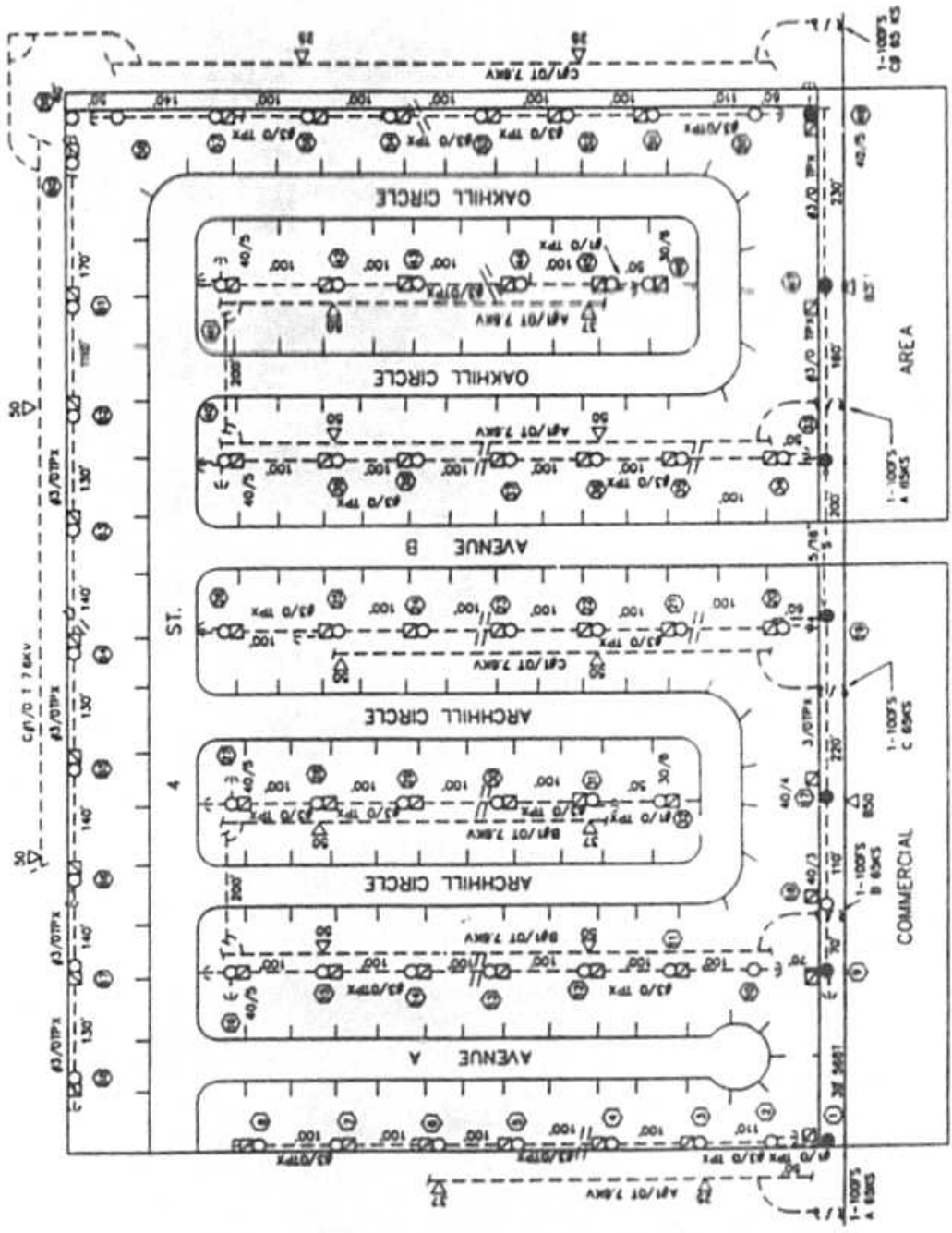

AB = 245 KVA  
 BB = 274 KVA  
 CB = 250 KVA  
 TOTAL = 773 KVA

METER PEDISTALS - 17% LOTS - OVERHEAD	
NO.	TYPE
1	40/3
2	100
3	100
4	100
5	100
6	100
7	100
8	100
9	100
10	100
11	100
12	100
13	100
14	100
15	100
16	100
17	100
18	100
19	100
20	100
21	100
22	100
23	100
24	100
25	100
26	100
27	100
28	100
29	100
30	100
31	100
32	100
33	100
34	100
35	100
36	100
37	100
38	100
39	100
40	100
41	100
42	100
43	100
44	100
45	100
46	100
47	100
48	100
49	100
50	100
51	100
52	100
53	100
54	100
55	100
56	100
57	100
58	100
59	100
60	100
61	100
62	100
63	100
64	100
65	100
66	100
67	100
68	100
69	100
70	100
71	100
72	100
73	100
74	100
75	100
76	100
77	100
78	100
79	100
80	100
81	100
82	100
83	100
84	100
85	100
86	100
87	100
88	100
89	100
90	100
91	100
92	100
93	100
94	100
95	100
96	100
97	100
98	100
99	100
100	100



## 1997 URD TARIFF

## A. AVERAGE UNDERGROUND FEEDER COST

	<u>Underground/Ft.</u>	<u>Overhead/Ft.</u>	<u>Difference/Ft.</u>
All Soil Conditions:	\$30.90	\$10.01	\$20.89
		Round To: .....	\$20.90

## B. AVERAGE UNDERGROUND LATERAL COST

	<u>Underground/Ft.</u>	<u>Overhead/Ft.</u>	<u>Difference/Ft.</u>
All Soil Conditions:	\$10.42	\$7.44	\$2.98
		Round To: .....	\$3.00

**NOTE:** All estimates based on three phase requirements.  
See Exhibit XI A for details.

**1997 URD TARIFF**  
**FEEDER/LATERAL COST\***

From Work Order Nos. 6486-07, 6480-07, 6482-05, 6484-05, 6481-02-010

Feeder Length = 25,428 Feet

UG Feeder Cost (#6486, 6480, 6482) = ..... \$830,517.00

26 UG Lateral Risers not required if UG Feeder is used

From Work Order #6484, cost of each Lateral Riser is \$1720.00.

26 Lateral Risers X \$1720 = ..... (\$44,720.00)

Net UG Feeder Cost = ..... \$785,797.00

UG Feeder per foot cost = ..... \$30.90

OH Feeder Cost (#6481) = ..... \$254,544.00

OH Feeder per foot cost = ..... \$10.01

Feeder Differential Cost = ..... \$20.89

\*NOTE: These costs include underground switches, cable-in-conduit and cable pull boxes.

## 1997 URD TARIFF

## LATERAL COST\*

From Work Orders Nos. 6485-07, 6485-01-010

Lateral Length = 1000 Feet

UG Lateral Cost (#6485-07) = .....	\$10,422.00
UG Lateral Cost Per Foot = .....	\$10.42
Overhead Lateral Cost (#6485-01) = .....	\$7,443.00
Overhead Lateral Cost Per Foot = .....	\$7.44
Lateral Differential Cost = .....	\$2.98

\*NOTE: These costs include underground switches, and cable-in-conduit.

**FLORIDA POWER & LIGHT COMPANY**  
**OPERATING & MAINTENANCE EXPENSES IN 1996**  
(Overhead vs. Underground)

		OVERHEAD	UNDERGROUND
583.1	OVERHEAD LINE EXPENSES	\$9,391,854.59	
583.11	OH LINE EXP ALLOC	314,520.73	
D*	583.15 OVERHEAD LINE EXPENSES - CANCELED WORK ORDER	487,495.87	
	583.16 OVERHEAD LINE EXPENSES - WORK ORDER	1,221,829.15	
E*	583.2 LINE TRANSFORMER FIRST INSTALLATION CAPITALIZED-EXP CR (55% OH, 45% UG)	(2,319,227.38)	(1,897,549.68)
	583.21 LINE TX 1ST INST. WORK TICKET	0.00	0.00
E*	583.28 LINE TRANSFORMER FIRST INSTALLATION EXPENSE-WORK ORDER (60.4% OH, 39.6% UG)	753,793.46	494,208.92
	<del>584.0 DUCT SYSTEM EXPENSE</del>		<del>2,562,312.37</del>
	<del>584.01 DUCT SYSTEM EXP ALLOC</del>		<del>60,982.87</del>
	<del>584.02 DUCT SYS INSPECTION</del>		<del>14,922.89</del>
	<del>584.04 DUCT SYS EMRGY WORK</del>		<del>49,674.16</del>
D*	<del>584.05 DUCT SYSTEM EXPENSE - CANCELED WORK ORDER</del>		<del>698,749.00</del>
	<del>584.06 DUCT SYSTEM EXPENSE - WORK ORDER</del>		<del>217,400.23</del>
	584.7 BURIED SYSTEM EXPENSE		5,210,801.60
	584.71 BURIED SYS EXP ALLOC		0.00
	584.72 BURIED SYS UNSPECTN		7,654.24
	584.74 BURIED SYS EMERG WORK		352,813.61
	584.78 BURIED SYSTEM EXPENSE - WORK ORDER		9,329.46
	593.1 MAINTENANCE OF OVERHEAD LINES	21,050,144.19	
	593.11 MAINTENANCE OH LINES ALLOC	1,968,982.00	
	593.16 MAINTENANCE OF OVERHEAD LINES - WORK ORDER	8,171,639.54	
	593.3 MAINTENANCE OF OVERHEAD LINES - TREE TRIMMING	18,435,001.27	
	593.33 MAINTENANCE OH LN-LN CIR CUS	1,723,814.19	
	593.38 MAINTENANCE OF OVERHEAD LINES - TREE TRIMMING - WORK ORDER	133,280.20	
	594.08 MAINT OF UG LINES W.O.		0.00
	<del>594.0 MAINTENANCE OF DUCT SYSTEM</del>		<del>4,488,332.00</del>
	<del>594.01 MAINTENANCE OF DU SYS ALLOC</del>		<del>108,648.00</del>

**FLORIDA POWER & LIGHT COMPANY  
OPERATING & MAINTENANCE EXPENSES IN 1996  
(Overhead vs. Underground)**

	OVERHEAD	UNDERGROUND
<del>594.63 MAINT DUCT SYS REPR</del>		<del>23,208.26</del>
<del>594.64 DUCT IN BRV FAILURE</del>		<del>135,715.94</del>
<del>594.68 MAINTENANCE OF DUCT SYSTEM WORK ORDER</del>		<del>1,676,516.92</del>
594.7 MAINTENANCE OF BURIED SYSTEM		12,630,643.58
594.71 MAINTENANCE OF BU SYS ALLOC		0.00
594.73 MAINTENANCE BURIED RPR WRK		107,761.84
594.74 BURIED IN BRV FAILURE		816,708.30
594.76 MAINTENANCE OF BURIED SYSTEM - WORK ORDER		96,166.78
595.06 MAINTENANCE LN TRNFRMRS W.O.		0.00
A* 595.1 MAINTENANCE OF LINE TRANSFORMERS GROUP	400,787.35	
595.11 MAINTENANCE LN TX GPA ALLOC	0.00	
595.18 MAINTENANCE LN TRNFRMRS A WO		0.00
B* <del>595.6 MAINTENANCE OF LINE TRANSFORMERS GROUP</del>		<del>220,281.26</del>
<del>595.61 MAINTENANCE LN TX GPS ALLOC</del>		<del>6.60</del>
<del>595.66 MAINTENANCE LN TX TRNFRMRS B WO</del>		<del>119.74</del>
C* 595.7 MAINTENANCE OF LINE TRANSFORMERS GROUP		192,770.40
595.71 MAINTENANCE LN TX GPC ALLOC		1,928.07
595.78 MAINTENANCE LN TRNFRM C WO		0.00
	<u>461,733,615.16</u>	<del>438,636,399.74</del>
		\$18,033,237.20

**NOTES:**

A\* - Aerial Transformers, Single Phase 100 KVA or less, and Line Regulators.  
(Generally Used Overhead)

B\* - Transformers Other than Group A and C and Network Protectors.  
(Generally used with Duct System)

C\* - Padmount Transformers. (Generally used with Buried System)

D\* - New accounts reported for the first time in the 1994 O & M expense.

E\* - % calculated from IM data extraction  
(Total quantity PURCHASED Src 14, OH & UG and total quantity ISSUED Src 11)  
Data provided by Inventory services

\*SOURCE: FIS/GLR FOR DEC. 1996 BALANCE BY ACCOUNT



## FPL 1996 OPERATING AND MAINTENANCE COSTS - OVERHEAD VS. UNDERGROUND

<u>Low Density Subdivision</u> (210 Lots)	<u>Pole/Trench Miles</u>	<u>Total O&amp;M Costs</u>	<u>Miles Per Subdivision</u>	<u>Cost Per Lot</u>
Overhead	38,857	\$43,165,234	2.48	\$13.12
Overhead w/Tree Trimming	38,857	\$61,733,515	2.48	\$18.76
Underground	17,698	\$18,033,237	2.01	\$9.75
Differential.....				(\$9.01)
<u>High Density Subdivision</u> (176 Lots)				
Overhead	38,857	\$43,165,234	1.12	\$7.07
Overhead w/Tree Trimming	38,857	\$61,733,515	1.12	\$10.11
Underground	17,698	\$18,033,237	1.09	\$6.31
Differential.....				(\$3.80)
<u>Meter Pedestal Subdivision</u> (176 Lots)				
Overhead	38,857	\$43,165,234	1.12	\$7.07
Overhead w/Tree Trimming	38,857	\$61,733,515	1.12	\$10.11
Underground	17,698	\$18,033,237	1.29	\$7.47
Differential.....				(\$2.64)

**JOINT TRENCHING WITH OTHER UTILITIES  
UNDERGROUND RESIDENTIAL DISTRIBUTION**

**1996 ADDITIONS**

<u>Date Closed</u>	<u>Location</u>	<u>Work Order Number</u>	<u>Footage</u>	<u>Company</u>	<u>Trenched by Other Utility - Amount Due From FPL</u>	<u>Trenched by FPL - Amount Due From Other Utility</u>
Jan-96	CLERMONT	1737-7-536	1340	Colony Cablevision	\$0.00	\$884.40
Jan-96	COSTA DEL SOL/PEL LDG	1812-7-536	990	United Telephone	\$0.00	\$653.00
Jan-96	COSTA DEL SOL-PEL LDG	1812-7-536	990	Colony Cablevision	\$0.00	\$653.00
Feb-96	HIGHLAND WOODS	1607-7-536	1098	United Telephone	\$0.00	\$867.42
Feb-96	STONEBRIDGE	1970-7-536	3055	United Telephone	\$0.00	\$2,413.00
Feb-96	BRECKENRIDGE	2061-7-536	1315	Colony	\$0.00	\$1,039.00
Feb-96	LEXINGTON	1833-7-536	8127	United Telephone	\$0.00	\$5,364.00
Feb-96	LEXINGTON	1833-7-537	9487	Jones	\$0.00	\$6,262.00
Jun-96	DEVONWOOD ESTATES	1755-7-536	2093	United Telephone	\$0.00	\$1,653.61
Mar-96	CLIPPER COVE	1983-7-536	1278	United Telephone	\$0.00	\$843.48
Mar-96	CLIPPER COVE	1984-7-536	2058	Colony Cablevision	\$0.00	\$1,626.00
Mar-96	HIGHLAND WOODS	2050-7-536	1330	United Telephone	\$0.00	\$1,050.70
Mar-96	HIGHLAND WOODS	7570-2-536	640	United Telephone	\$0.00	\$505.60
Apr-96	MARSH LANDING	2003-7-536	1440	Colony Cablevision	\$0.00	\$1,137.60
Apr-96	LES CHATEAUX	2032-7-536	796	Colony Cablevision	\$0.00	\$674.74
Apr-96	SPOONBILL COVE	2101-7-536	235	Colony Cablevision	\$0.00	\$162.69
May-96	GG EST COMM PARK	1901-7-536	1280	United Telephone	\$0.00	\$1,011.20
May-96	BERMUDA COVE	1922-7-536	870	United Telephone	\$0.00	\$574.20
May-96	BERMUDA COVE	1922-7-536	970	Colony Cablevision	\$0.00	\$653.20
May-96	CANDLEWOOD	1934-7-536	550	Colony Cablevision	\$0.00	\$714.00
May-96	BRIARWOOD/U3	2069-7-536	3040	United Telephone	\$0.00	\$2,402.00
May-96	PINE HAVEN	2085-7-536	350	Colony Cablevision	\$0.00	\$277.00
May-96	MORTON GROVE	2089-7-536	550	Colony Cablevision	\$0.00	\$435.00
May-96	HUNTGTN LKS/B14	2108-7-536	560	United Telephone	\$0.00	\$442.40
May-96	PELICAN MARSH/U12	5351-7-547	1415	Colony Cablevision	\$0.00	\$933.90

1996 ADDITIONS  
(CONTINUED)

Date Closed	Location	Work Order Number	Footage	Company	Trenched by Other Utility - Amount Due From FPL	Trenched by FPL - Amount Due From Other Utility
May-96	PELICAN MARSH U12	5351-7-547	1415	United Telephone	\$0.00	\$933.90
May-96	MANOR/ROYAL LKS	5359-7-547	180	United Telephone	\$0.00	\$241.50
May-96	SAPPHIRE LKS/PHS 1	5382-7-547	220	United Telephone	\$0.00	\$145.00
May-96	SAPPHIRE LKS/PHS 1	5382-7-547	220	Colony Cablevision	\$0.00	\$145.00
May-96	12801 HONEY HILL RD	2320-7-741	8291	BellSouth	\$0.00	\$22,541.65
May-96	12801 HONEY HILL RD	2320-7-741	8291	Telemedia	\$0.00	\$11,245.12
May-96	*13200 SW 50 ST	3055-7-741	5026	BellSouth & Telemedia	\$0.00	
May-96	*12100 PEMBROKE RD	2210-7-741	4338	BellSouth & TCI	\$0.00	
May-96	*12000 RENAISSANCE	2213-7-741	3255	BellSouth & TCI	\$0.00	
Jun-96	HARRINGTON SOUND	1660-7-536	490	Colony Cablevision	\$0.00	\$387.10
Jun-96	BLACK-HAWK 03	2021-7-536	3853	United Telephone	\$0.00	\$3,044.00
Jun-96	SANIBEL SUNSET VILLAS	2040-7-536	1015	Jones	\$0.00	\$669.90
Dec-96	*OAKSIDE	7043-7-878	1630	Dynamic Cable	\$0.00	
Jul-96	MIRAGE	1715-7-536	1530	Colony Cablevision	\$0.00	\$1,053.00
Jul-96	BREAKWATER	2087-7-536	1399	Colony Cablevision	\$0.00	\$1,105.50
Jul-96	IBIS WOODS	2102-7-536	550	United Telephone	\$0.00	\$363.00
Jul-96	IBIS WOODS	2102-7-536	550	Colony Cablevision	\$0.00	\$363.00
Jul-96	WILSHIRE LAKES PH-2	4784-7-547	15160	CVI	\$0.00	\$11,384.00
Jul-96	WILSHIRE LAKES PH-2	4784-7-547	4748	United Telephone	\$0.00	\$3,134.00
Jul-96	SAVANA/PELICAN MARSH	5352-7-547	1150	Colony Cablevision	\$0.00	\$788.00
Jul-96	SEVILLE/PEL MARSH	5373-7-547	350	United Telephone	\$0.00	\$231.00
Jul-96	SEVILLE/PEL MARSH	5373-7-547	350	Colony Cablevision	\$0.00	\$231.00
Jul-96	RAVENNA	5385-7-547	1050	United Telephone	\$0.00	\$693.00
Jul-96	RAVENNA	5385-7-547	1050	Colony Cablevision	\$0.00	\$693.00
Jul-96	VILLAGE WALK PH-3	5399-7-547	3288	CVI	\$0.00	\$2,365.60
Jul-96	VILLAGE WALK PH-3	5399-7-547	1869	United Telephone	\$0.00	\$1,244.59
Jul-96	MIRAGE	1715-7-536	1200	United Telephone	\$0.00	\$792.00

**1996 ADDITIONS  
(CONTINUED)**

<u>Date Closed</u>	<u>Location</u>	<u>Work Order Number</u>	<u>Footage</u>	<u>Company</u>	<u>Trenched by Other Utility - Amount Due From FPL</u>	<u>Trenched by FPL - Amount Due From Other Utility</u>
Jul-96	PEL MARSH/ISLAND COVE	2111-7-536	1640	Colony Cablevision	\$0.00	\$1,295.60
Jul-96	SAVANNA/PELICAN MARSH	5352-7-547	1100	United Telephone	\$0.00	\$749.40
Aug-96	HIGHLAND WOODS PH II	1599-7-536	1025	United Telephone	\$0.00	\$676.50
Aug-96	HIGHLAND WOODS PH II	1599-7-536	1025	Colony Cablevision	\$0.00	\$676.50
Aug-96	VILLAGE OF BONITA	5362-7-547	2675	Colony Cablevision	\$0.00	\$2,113.00
Aug-96	SHERWOOD PARK/U2/PH1	5439-7-547	745	United Telephone	\$0.00	\$491.70
Aug-96	SHERWOOD PARK/U2/PH1	5439-7-547	745	Colony Cablevision	\$0.00	\$491.70
Aug-96	*342 SW 200 TER	8495-7-727	1522	BellSouth & Telemedia	\$0.00	
Sep-96	BONITA BAY PLAZA - PH 1	1721-7-536	560	United Telephone	\$0.00	\$442.40
Sep-96	MARSH LANDING/LONE OAK	2145-7-536	570	United Telephone	\$0.00	\$376.20
Sep-96	MARSH LANDING/LONE OAK	2145-7-536	1250	Colony Cablevision	\$0.00	\$913.40
Sep-96	MARSH LANDINGS/SINGLE FAMI	2165-7-536	570	United Telephone	\$0.00	\$376.00
Sep-96	MARSH LANDINGS/SINGLE FAMI	2165-7-536	1065	Colony Cablevision	\$0.00	\$767.00
Sep-96	BAY POINTE AT BONITA BAY	5393-07-547	865	Colony Cablevision	\$0.00	\$570.90
Sep-96	BAY POINTE AT BONITA BAY	5393-07-547	865	United Telephone	\$0.00	\$570.90
Sep-96	HIGHLAND WOODS PH II	5431-7-547	1398	Colony Cablevision	\$0.00	\$1,104.42
Sep-96	SAXON MANOR APTS	5432-7-547	1280	United Telephone	\$0.00	\$1,011.20
Oct-96	HIGHLAND WOODS PH II	1768-7-536	1895	Colony Cablevision	\$0.00	\$1,398.90
Oct-96	HIGHLAND WOODS PH II	1768-7-536	755	United Telephone	\$0.00	\$498.30
Oct-96	CITRUS PARK	2006-7-536	2951	United Telephone	\$0.00	\$2,332.00
Oct-96	TURTLE CREEK APTS.	5376-07-547	2110	Colony Cablevision	\$0.00	\$1,666.90
Oct-96	CONVINGTON ROW/PELICAN BAY	5395-7-547	525	United Telephone	\$0.00	\$414.75
Oct-96	MARINA ISLE AT BONITA BAY	5406-7-547	1045	Colony Cablevision	\$0.00	\$794.20
Oct-96	FIDDLERS CREEK PHS 1A	5419-7-536	3060	United Telephone	\$0.00	\$2,019.60
Oct-96	SWEETWATER BAY STERL OAKS	5474-7-547	830	Colony Cablevision	\$0.00	\$655.70
Oct-96	WATERSIDE	1968-7-536	1200	United Telephone	\$0.00	\$792.00
Oct-96	WATERSIDE	1968-7-537	1200	Colony Cablevision	\$0.00	\$792.00

**1996 ADDITIONS  
(CONTINUED)**

<u>Date Closed</u>	<u>Location</u>	<u>Work Order Number</u>	<u>Footage</u>	<u>Company</u>	<u>Trenched by Other Utility - Amount Due From FPL</u>	<u>Trenched by FPL - Amount Due From Other Utility</u>
Dec-96	*SPANISH LAKE	3556-7-875	10190	BellSouth	\$0.00	
Oct-96	DEER LAKES	1567-7-536	3745	Jones	\$0.00	\$2,958.55
Nov-96	VISTAS AT BONITA BAY	1259-7-536	170	Colony Cablevision	\$0.00	\$134.30
Nov-96	PALM COLONY - PHASE 2	1803-7-536	910	Colony Cablevision	\$0.00	\$718.90
Nov-96	PELICAN MARSH UNIT 8	1806-7-536	2685	Colony Cablevision	\$0.00	\$1,772.10
Nov-96	PELICAN MARSH UNIT 8	1806-7-536	2685	United Telephone		\$1,772.10
Nov-96	JOHNNY CAKE CV	2080-7-536	570	Colony Cablevision	\$0.00	\$450.00
Nov-96	CARLTON LAKES BLV PH 1	2112-07-536	2120	Colony Cablevision	\$0.00	\$1,597.20
Nov-96	CARLTON LAKES BLV PH 1	2112-07-536	2420	United Telephone	\$0.00	\$1,597.20
Nov-96	MARSH LANDINGS/MULT FAM	2164-7-536	955	United Telephone	\$0.00	\$630.00
Nov-96	MARSH LANDINGS/MULT FAM	2164-7-536	1420	Colony Cablevision	\$0.00	\$997.00
Nov-96	CARLTON LAKES	2224-07-536	1270	United Telephone	\$0.00	\$838.20
Nov-96	CARLTON LAKES	2224-07-536	1640	Colony Cablevision	\$0.00	\$1,130.50
Nov-96	CARLTON LAKES	2225-07-536	720	Colony Cablevision	\$0.00	\$475.20
Nov-96	CARLTON LAKES	2225-07-536	720	United Telephone	\$0.00	\$475.20
Nov-96	ROCK CREEK CAMPGROUND	5398-7-547	805	United Telephone	\$0.00	\$531.30
Nov-96	ROCK CREEK CAMPGROUND	5398-7-547	935	Colony Cablevision	\$0.00	\$634.00
Nov-96	HIGHLAND WDS-2/S PART 2	5433-7-547	1085	United Telephone	\$0.00	\$773.30
Nov-96	HIGHLAND WDS-2/S PART 2	5433-7-547	645	Colony Cablevision	\$0.00	\$425.70
Nov-96	SABAL LAKE - UNIT 2	5465-7-547	2475	United Telephone	\$0.00	\$1,640.00
Nov-96	SABAL LAKE - UNIT 2	5465-7-547	2775	Colony Cablevision	\$0.00	\$1,877.00
Nov-96	THE HAMPTONS/BON BAY	5526-7-547	1225	Colony Cablevision	\$0.00	\$1,319.30
Nov-96	THE HAMPTONS/BON BAY	5526-7-547	895	United Telephone	\$0.00	\$877.10
Nov-96	CALLISA BAY CONV	7122-4-547	2040	United Telephone	\$0.00	\$1,611.60
Nov-96	AUGUSTA POINT	7612-4-536	1825	United Telephone	\$0.00	\$1,441.75
Nov-96	*1000 SW 161 AVE	8430-7-727	3633	BellSouth & Telemedia	\$0.00	
Dec-96	WATERWAYS - PH1 EXT/PUMP	2063-7-536	2925	United Telephone	\$0.00	\$1,951.30

1996 ADDITIONS  
(CONTINUED)

<u>Date Closed</u>	<u>Location</u>	<u>Work Order Number</u>	<u>Footage</u>	<u>Company</u>	<u>Trenched by Other Utility - Amount Due From FPL</u>	<u>Trenched by FPL - Amount Due From Other Utility</u>
Dec-96	WATERWAYS - PH 1 EXT/PUMP	2063-7-536	2895	CVI	\$0.00	\$1,910.70
Dec-96	CORAL WOODS	2068-7-536	994	United Telephone	\$0.00	\$638.00
Dec-96	CORAL WOODS	2068-7-536	949	Colony Cablevision	\$0.00	\$642.00
Dec-96	CALUSA BAY - PH1/EAST	5353-7-547	545	CVI	\$0.00	\$359.70
Dec-96	CALUSA BAY - PH1/EAST	5353-7-547	925	United Telephone	\$0.00	\$730.75
Dec-96	QUAIL WEST PH-2	5365-7-547	1635	CVI	\$0.00	\$1,079.00
Dec-96	QUAIL WEST PH-2	5365-7-547	1635	United Telephone	\$0.00	\$1,079.00
Dec-96	CALUSA BAY - PH1/SOUTH	5369-7-547	925	CVI	\$0.00	\$659.90
Dec-96	CALUSA BAY - PH1/SOUTH	5369-7-547	3090	United Telephone	\$0.00	\$2,110.25
Dec-96	THE POINTE/PELICAN LDNG	5394-7-547	715	Colony Cablevision	\$0.00	\$482.95
Dec-96	QUAIL WEST - BLK CC	5423-7-547	2005	United Telephone	\$0.00	\$1,323.00
Dec-96	QUAIL WEST - BLK CC	5423-7-547	2005	CVI	\$0.00	\$1,323.00
Dec-96	NAPLES HERITAGE	5426-7-547	4801	Colony Cablevision	\$0.00	\$3,793.80
Dec-96	LELY RESORT/MYSTIC GREENS	5494-7-547	410	Colony Cablevision	\$0.00	\$324.00
Dec-96	LASER CAR WASH	5532-7-547	197	United Telephone	\$0.00	\$155.63
Dec-96	*1400 SW 161 AVE	8433-7-727	5091	BellSouth & Telemedi	\$0.00	
Dec-96	*HARBOR ISLE-P12	1027-7-741	<u>4985</u>	BellSouth	<u>\$0.00</u>	
<b>TOTAL</b>			<b>240,381</b>		<b>\$0.00</b>	<b>\$166,258.65</b>

\* One joint contractor was used for all companies with separate bid prices for each company.

**JOINT TRENCHING WITH OTHER UTILITIES  
UNDERGROUND RESIDENTIAL DISTRIBUTION**

	<u>Footage</u>	<u>Amount Due From Other Utility</u>	<u>Amount Due From FPL</u>
Total for 1971	1,769	\$932.20	\$0.00
Total for 1972	118,523	\$27,225.38	\$15,891.43
Total for 1973	245,497	\$39,633.97	\$61,503.23
Total for 1974	148,415	\$41,263.72	\$19,260.50
Total for 1975	127,305	\$26,143.56	\$22,523.26
Total for 1976	33,471	\$3,797.65	\$3,199.00
Total for 1977	39,508	\$10,003.39	\$10,911.95
Total for 1978	13,418	\$5,350.47	\$495.55
Total for 1979	59,004	\$13,128.00	\$19,846.00
Total for 1980	21,941	\$614.00	\$10,878.00
Total for 1981	13,391	\$441.00	\$6,403.00
Total for 1982	23,924	\$10,669.00	\$0.00
Total for 1983	7,229	\$38,909.00	\$1,268.00
Total for 1984	3,455	\$4,836.00	\$0.00
Total for 1985	2,912	\$1,754.00	\$2,892.00
Total for 1986	19,072	\$15,538.12	\$0.00
Total for 1987	0	\$0.00	\$0.00
Total for 1988	0	\$0.00	\$0.00
Total for 1989	2,934	\$2,855.00	\$0.00
Total for 1990	6,325	\$0.00	\$0.00
Total for 1991	0	\$0.00	\$0.00
Total for 1992	15,901	\$37,759.00	\$0.00
Total for 1993	43,769	\$32,187.00	\$0.00
Total for 1994	88,755	\$68,720.00	\$0.00
Total for 1995	259,433	\$155,934.08	\$0.00
Total for 1996	<u>240,381</u>	<u>\$166,258.65</u>	\$0.00
<b>TOTAL</b>	<b>1,536,332</b>	<b>\$703,953.19</b>	<b>\$175,071.92</b>







**1997 URD TARIFF  
TRENCH CREDITS**

10.3.3

1. Low Density

Pri/Sec = .....	389.99 MH X	\$59.90 /MH = .....	\$23,360.40
			210 Lots
			\$111.24 /Lot
		Round To.....	\$111.00 /Lot
Svc = .....	0.029 MH X	\$59.90 /MH X 63 Ft. = .....	\$109.44 /Lot
		Round To.....	\$109.00 /Lot

2. High Density

Pri/Sec = .....	234.53 MH X	\$59.90 /MH = .....	\$14,048.35
			176 Lots
			\$79.82 /Lot
		Round To.....	\$80.00 /Lot
Svc = .....	0.029 MH X	\$59.90 /MH X 35 Ft. = .....	\$60.80 /Lot
		Round To.....	\$61.00 /Lot

3. Meter Pedestals

Pri/Sec = .....	180.7 MH X	\$59.90 /MH = .....	\$10,823.93
			176 Lots
			\$61.50 /Lot
		Round To.....	\$61.00 /Lot

Feeder/Lateral Trench Credit = .....	\$59.90 /MH X	0.029 MH = .....	\$1.74 /Ft
		Round To...	\$1.70 /Ft
Feeder Splice Box Installation Credit = .....	\$59.90 /MH X	7.36 MH = .....	\$440.86 /Box
		Round To...	\$441.00 /Box
Primary Splice Box Installation Credit = .....	\$59.90 /MH X	1.94 MH = .....	\$116.21 /Box
		Round To...	\$116.00 /Box
<b>Secondary Handhole Installation Credit</b>			
For 17" Handhole = .....	\$59.90 /MH X	0.18 MH = .....	\$10.78 /HH
		Round To...	\$11.00 /HH
For 24" Handhole = .....	\$59.90 /MH X	0.51 MH = .....	\$30.55 /HH
		Round To...	\$31.00 /HH
Concrete Pad for Pad Mounted Transformer Credit = .....	\$59.90 /MH X	0.3 MH = .....	\$17.97 /Pad
		Round To...	\$ 18.00 /Pad
Flexible HDPE Conduit Installation Credit = ....	\$59.90 /MH X	0.001 MH = .....	\$0.06 /Ft
Concrete Pad and Cable Chamber for Feeder Switch Pad = .....	\$59.90 /MH X	7.41 MH = .....	\$443.86 /Pad
		Round To...	\$ 444.00 /Pad

**Trench Credit for New UG Service Laterals**

<b>10.4.3</b>	\$59.90 /MH X	0.029 MH = .....	\$1.74 /Ft
		Round To...	\$1.70 /Ft

**Trench Credit for Replacement of OH Service with UG Service**

<b>10.5.4.</b>	0.029 MH X	\$59.90 /MH X	63 Ft.	\$109.44 /Svc
			Round To...	\$109.00 /Svc

Shown on Page 3 of Basis

**1997 URD TARIFF  
RISER TO HANDHOLE COST**

Overhead - Work Order #6488-07-010

<u>Material</u>	<u>Labor</u>	<u>Total</u>
\$59.44	\$71.67	\$131.11

Underground - Work Order #6487-07-010

<u>Material</u>	<u>Labor</u>	<u>Total</u>
\$245.52	\$244.46	<u>\$489.98</u>

**DIFFERENTIAL =** ..... **\$358.87**

**SERVICE LATERAL DIFFERENTIAL - LOW DENSITY**

	<u>Underground</u>	<u>Overhead</u>
Material	\$81.45	\$45.25
Labor	\$208.89	\$73.98
Stores loading	\$7.53	\$4.18
EO	<u>\$52.54</u>	<u>\$21.77</u>
Total	\$350.41	\$145.18

UNDERGROUND	\$350.41
OVERHEAD	<u>(\$145.18)</u>
DIFFERENTIAL =	\$205.23

## 1997 URD TARIFF

## SERVICE LATERAL DIFFERENTIAL - HIGH DENSITY

	<u>Underground</u>	<u>Overhead</u>
Material	\$62.34	\$34.19
Labor	\$165.37	\$66.37
Stores loading	\$5.76	\$3.16
EO	<u>\$41.18</u>	<u>\$18.30</u>
Total	\$274.65	\$122.02

UNDERGROUND	\$274.65
OVERHEAD	<u>(\$122.02)</u>
DIFFERENTIAL =	\$152.63

**Appendix No. 4**

(Continued from Sheet No. 6.090)

- 10.2.9. **Location of Distribution Facilities**  
Underground distribution facilities will be located, as determined by the Company, to maximize their accessibility for maintenance and operation. The Applicant shall provide accessible locations for meters when the design of a dwelling unit or its appliances limit perpetual accessibility for reading, testing, or making necessary repairs and adjustments.
- 10.2.10. **Special Conditions**  
The costs quoted in these rules are based on conditions which permit employment of rapid construction techniques. The Applicant shall be responsible for necessary additional hand digging expenses other than what is normally provided by the Company. The Applicant is responsible for clearing, compacting, boulder and large rock removal, stump removal, paving, and addressing other special conditions. Should paving, grass, landscaping or sprinkler systems be installed prior to the construction of the underground distribution facilities, the Applicant shall pay the added costs of trenching and backfilling and be responsible for restoration of property damaged to accommodate the installation of underground facilities.
- 10.2.11. **Point of Delivery**  
The point of delivery shall be determined by the Company and will normally be at or near the part of the building nearest the point at which the secondary electric supply is available to the property. When a location for a point of delivery different from that designated by the Company is requested by the Applicant, and approved by the Company, the Applicant shall pay the estimated full cost of service lateral length, including labor and materials, required in excess of that which would have been needed to reach the Company's designated point of service. The additional cost per trench foot is \$3,663.94. Where an existing trench is utilized, the additional cost per trench foot is \$1,791.91. Where the Applicant provides the trenching, installs Company provided conduit according to Company specifications and backfilling, the cost per additional trench foot is \$1,461.54. Any redesignation requested by the Applicant shall conform to good safety and construction practices as determined by the Company. Service laterals shall be installed, where possible, in a direct line to the point of delivery.
- 10.2.12. **Location of Meter and Meter/Dormance**  
The Applicant shall install a meter trench/closure, and a meter/dormance and all to accommodate the Company's service lateral conductors at the point designated by the Company. Both these facilities will be installed in accordance with the Company's specifications and all applicable codes.
- 10.2.13. **Relocation or Removal of Existing Facilities**  
If the Company is required to relocate or remove existing facilities in the implementation of these Rules, all costs thereof shall be borne exclusively by the Applicant. These costs will include the costs of relocation or removal, the in-place value (less salvage) of the facilities so removed and any additional costs due to existing landscaping, pavement or unusual conditions.
- 10.2.14. **Development of Subdivisions**  
The Tariff charges are based on reasonably full use of the land being developed. Where the Company is required to construct underground electric facilities through a section or sections of the subdivision or development where full use of facilities as determined by the Company, will not be experienced for at least two years, the Company may require a deposit from the Applicant before construction is commenced. This deposit, to guarantee performance, will be based on the estimated total cost of such facilities rather than the differential cost. The amount of the deposit, without interest, less any required contributions will be returned to the Applicant on a pro-rata basis at quarterly intervals on the basis of installations to new customers. Any portion of such deposit remaining unrefunded, after five years from the date the Company is first ready to render service from the extension, will be retained by the Company.

SECTION 10.3 UNDERGROUND DISTRIBUTION FACILITIES FOR  
 RESIDENTIAL SUBDIVISIONS AND DEVELOPMENTS

10.3.1. Availability  
 When requested by the Applicant, the Company will provide underground electric distribution facilities, other than for multiple occupancy buildings, in accordance with its standard practices in:

- a) Recognized new residential subdivision of five or more building lots.
- b) Tracts of land upon which five or more separate dwelling units are to be located.

For residential buildings containing five or more dwelling units, see SECTION 10.6 of these Rules.

10.3.2. Contribution by Applicant

a) The Applicant shall pay the Company the average differential cost for single phase residential underground distribution service based on the number of service laterals required or the number of dwelling units, as follows:

Applicant's  
 Contribution

1. Where density is 6.0 or more dwelling units per acre:

1.1 Buildings that do not exceed four units,  
 townhouses, and mobile homes - per service lateral. \$193.00/\$224.00

1.2 Mobile homes having Customer-owned services from meter  
 center installed adjacent to the FPL primary trench route  
 - per dwelling unit. \$--0-\$22.00

2. Where density is 0.5 or greater, but less than 6.0 dwelling units  
 per acre:

Buildings that do not exceed four units,  
 townhouses, and mobile homes - per service lateral \$377.00/\$392.00

3. Where the density is less than 0.5 dwelling units per acre,  
 or the Distribution System is of non-standard design,  
 individual cost estimates will be used to determine the  
 differential cost as specified in Paragraph 10.2.5.

Additional charges specified in Paragraphs 10.2.10 and 10.2.11 may also apply.

b) The above costs are based upon arrangements that will permit serving the local underground distribution system within the subdivision from overhead feeder mains. If feeder mains within the subdivision are deemed necessary by the Company to provide and/or maintain adequate service and are required by the Applicant or a governmental agency to be installed underground, the Applicant shall pay the Company the average differential cost between such underground feeder mains within the subdivision and equivalent overhead feeder mains, as follows:

Applicant's  
 Contribution

Cost per foot of feeder trench within the subdivision  
 (includes padmounted switches). \$34.30/\$20.90

c) Where primary laterals are needed to cross open areas such as golf courses, parks, other recreation areas and water retention areas, the Applicant shall pay the average differential costs for these facilities as follows:

Cost per foot of primary lateral trench within the subdivision \$-3-\$931.00

(Continued on Sheet No. 6.110)



(Continued from Sheet No. 6.110)

- c) Credit will be allowed to the Applicant's contribution in Section 10.3.2, where, by mutual agreement, the Applicant provides a portion of trenching and backfilling for the Company's facilities. The credit is:
- Credit per foot of trench within the subdivision      \$-1-60\$1.70
- d) Credit will be allowed to the Applicant's contribution in section 10.3.2, where, by mutual agreement, the Applicant installs a portion of Company-provided PVC conduit, per FPL instructions (per foot of conduit) 2" PVC - \$-37\$3.30; larger than 2" PVC - \$-37\$4.42.
- e) Credit will be allowed to the Applicant's contribution in section 10.3.2, where, by mutual agreement, the Applicant installs an FPL-provided feeder splice box, per FPL instructions, per box - \$394-00\$441.00.
- f) Credit will be allowed to the Applicant's contribution in section 10.3.2, where by mutual agreement, the Applicant installs an FPL-provided primary splice box, per FPL instructions, per box - \$104-00\$116.00.
- g) Credit will be allowed to the Applicant's contribution in section 10.3.2, where, by mutual agreement, the Applicant installs an FPL-provided secondary handhole, per FPL instructions, per handhole: 17" handhole - \$104-00\$110.00; 24" handhole - \$374-00\$110.00.
- h) Credit will be allowed to the Applicant's contribution in section 10.3.2, where, by mutual agreement, the Applicant installs an FPL-provided concrete pad for a pad-mounted transformer, per FPL instructions, per pad - \$14-00\$18.00.
- i) Credit will be allowed to the Applicant's contribution in Section 10.3.2, where, by mutual agreement, the Applicant installs a portion of Company-provided flexible HDPE conduit, per FPL instructions (per foot of conduit) \$-05\$5.05.
- j) Credit will be allowed to the Applicant's contribution in Section 10.3.2, where, by mutual agreement, the Applicant installs an FPL-provided concrete pad and cable chamber for a pad-mounted feeder switch, per pad and cable chamber - \$396-00\$444.00.

**SECTION 10.4 UNDERGROUND SERVICE LATERALS FROM  
OVERHEAD ELECTRIC DISTRIBUTION SYSTEMS**

10.4.1. New Underground Service Laterals

When requested by the Applicant, the Company will install underground service laterals from overhead systems to newly constructed residential buildings containing less than five separate dwelling units.

10.4.2. Contribution by Applicant

a) The Applicant shall pay the Company the following differential cost between an overhead service and an underground service lateral, as follows:

	<u>Applicant's Contribution</u>
1. For any density:	
Buildings that do not exceed four units, townhouses, and mobile homes - per service lateral.	\$ <del>386.00</del> <u>383.00</u>
2. For any density, the Company will provide a riser to a handhole at the base of a pole - per service lateral.	\$ 380.00 <u>359.00</u>

Additional charges specified in Paragraph 10.2.10. and 10.2.11. may also apply. Underground service or secondary extensions beyond the boundaries of the property being served will be subject to additional differential costs as determined by individual cost estimates.

10.4.3. Contribution Adjustments

a) Credit will be allowed to the Applicant's contribution in Section 10.4.2. where, by mutual agreement, the Applicant provides trenching and backfilling for the Company's facilities. This credit is:

	<u>Credit To Applicant's Contribution</u>
1. For any density:	
Buildings that do not exceed four units, townhouses, and mobile homes - per foot.	\$ 1.60 <u>1.70</u>

(Continued on Sheet No. 6.125)

(Continued from Sheet No. 6.120)

- b) Credit will be allowed to the Applicant's contribution in Section 10.4.2, where by mutual agreement, the Applicant installs Company-provided conduit, per FPL instructions, as follows:

1. For any density:

Buildings that do not exceed four units,  
townhouses, and mobile homes  
- per foot:

2" PVC	\$-37\$ <u>.30</u>
Larger than 2" PVC	\$-37\$ <u>.42</u>

**SECTION 10.5 UNDERGROUND SERVICE LATERALS REPLACING  
 EXISTING RESIDENTIAL OVERHEAD AND UNDERGROUND SERVICES**

**10.5.1. Applicability**

When requested by the Applicant, the Company will install underground service laterals from existing systems as replacements for existing overhead and underground services to existing residential buildings containing less than five individual dwelling units.

**10.5.2. Rearrangement of Service Entrance**

The Applicant shall be responsible for any necessary rearranging of his existing electric service entrance facilities to accommodate the proposed underground service lateral in accordance with the Company's specifications.

**10.5.3. Trenching and Conduit Installation**

The Applicant shall also provide, at no cost to the Company, a suitable trench, perform the backfilling and any landscape, pavement or other similar repairs and install Company provided conduit according to Company specifications. When requested by the Applicant and approved by the Company, the Company may supply the trench and conduit and the Applicant shall pay for this work based on a specific cost estimate. Should paving, grass, landscaping or sprinkler systems need repair or replacement during construction, the Applicant shall be responsible for restoring the paving, grass, landscaping or sprinkler systems to the original condition.

**10.5.4. Contribution by Applicant**

a)	The charge per service lateral replacing an existing Company-owned overhead service for any density shall be:	<u>Applicant's Contribution</u>
1.	Where the Company provides an underground service lateral:	\$— <del>303.00</del> <u>291.00</u>
2.	Where the Company provides a riser to a handhole at the base of the pole;	\$— <del>412.00</del> <u>395.00</u>
b)	The charge per service lateral replacing an existing Company-owned underground service at Applicant's request for any density shall be:	
1.	Where the service is from an overhead system:	\$— <del>304.00</del> <u>286.00</u>
2.	Where the service is from an underground system:	\$— <del>266.00</del> <u>248.00</u>
c)	The charge per service lateral replacing an existing Customer-owned underground service from an overhead system for any density shall be:	\$— <del>271.00</del> <u>255.00</u>
d)	The charge per service lateral replacing an existing Customer-owned underground service from an underground system for any density shall be:	\$— <del>84.00</del> <u>77.00</u>

(Continued from Sheet No. 9.701)

- e) Pay for all additional costs incurred by FPL which may include, but are not limited to, engineering design, administration and relocation expenses, due to changes made subsequent to this agreement on the subdivision or development layout or grade.
  - f) Provide applicable trenching, backfilling and installation of Company provided conduit in accordance with FPL specifications.
  - g) Provide a meter enclosure, downpipe and ell which meet all applicable codes and FPL specifications and which will accommodate FPL's service cable size and design. These items must be confirmed with FPL prior to purchase. FPL will not be responsible for costs involved in modifying or replacing items which do not meet the above criteria.
9. FPL shall:
- a) Provide the Customer with a plan showing the location of all FPL underground facilities, point of delivery, and transformer locations and specifications required by FPL and to be adhered to by the Customer.
  - b) Install, own, and maintain the electric distribution facilities up to the designated point of delivery except when otherwise noted.
  - c) Request the Customer to participate in a pre-construction conference with the Customer's contractors, the FPL representatives and other utilities within six (6) weeks of the start of construction. At the pre-construction conference, FPL shall provide the Customer with an estimate of the date when service may be provided.
10. This Agreement is subject to FPL's Electric Tariff, including but not limited to the General Rules and Regulations for Electric Service and the Rules of the Florida Public Service Commission, as they are now written, or as they may be revised, amended or supplemented.

The Customer and FPL will coordinate closely in fulfilling obligations in order to avoid delays in providing permanent electric service at the time of the Customer's receipt of a certificate of occupancy.

Accepted:

\_\_\_\_\_  
 For FPL (Date)

Accepted:

\_\_\_\_\_  
 Customer (Date)

\_\_\_\_\_  
 Witness (Date)

\_\_\_\_\_  
 Witness (Date)