

**Rhema Business Services, Inc.**

1344 Vickers Drive  
Tallahassee, FL 32303-3041

(850) 562-9886  
(850) 562-9887 FAX

**ORIGINAL**

RECEIVED-FPSC  
99 JAN - 8 AM 9:17  
RECORDS AND REPORTING

January 8, 1999

Division of Records and Reporting  
Florida Public Service Commission  
2540 Shumard Oak Boulevard  
Tallahassee, Florida 32399-0850

Re: Docket No. 981338-WS, Application of PLANTATION LANDINGS, LTD. for Grandfather Water and Wastewater Certificates in Polk County, Florida

Gentlemen:

Enclosed are the original and five (5) copies of the Plantation Landings, Ltd. response to John D. Williams' letter of November 16, 1998, the original revised maps, and the original and two (2) copies of the modified tariff sheets. Each item in that letter is addressed in the order it appeared.

1. **Rate Authority.** The Board of Commissioners of Polk County considered this utility exempt from its regulation, due to it being subject to the requirements of Chapter 723, Florida Statutes. Polk County, accordingly, did not authorize the current rates.

- ACK \_\_\_\_\_
- AFA \_\_\_\_\_
- APP \_\_\_\_\_
- CAF \_\_\_\_\_
- CMU \_\_\_\_\_
- CTR \_\_\_\_\_
- EAG \_\_\_\_\_
- LEG 1 \_\_\_\_\_
- LIN \_\_\_\_\_
- OPC \_\_\_\_\_
- RCH \_\_\_\_\_
- SEC 1 \_\_\_\_\_
- WAS Clapp \_\_\_\_\_
- OTH \_\_\_\_\_

Plantation Landings put the current rates into effect on July 28, 1987. A copy of the portion of the current prospectus pertaining to the water and wastewater rates, and a copy of the lease for the park are enclosed. The rates reflected in the prospectus are those after implementation of the regulatory assessment fee pass-through rate adjustment. Management purged all earlier versions to assure that any prospectus issued is the current version.

2. **Legal Description and Territory Map.** Tariff sheets reflecting the corrected legal description, and revised territory maps are enclosed. The percolation pond is shown on the Hidden Cove territory map. *To WAW*

3. **Permit Information.**

a. Plantation Landings can not locate its water construction permit. The new wastewater permit application is enclosed.

RECEIVED & FILED

*Mark Redd*

FPSC BUREAU OF RECORDS

DOCUMENT NUMBER-DATE

~~00012~~ JAN - 8 8

FPSC-RECORDS/REPORTING

- b. A copy of the current wastewater permit application is enclosed.
  - c. Copies of the monthly operating reports are enclosed.
  - d. The utility is in the Highland Ridge Water Use Caution Area.
4. **Tariff Address and Phone Number.** Plantation Landings, Ltd. is managed by the Managing General Partner, which is responsible for the day-to-day management of the utility. The General Partner has a pool of employees available, which is in common with General Partners of the other utilities, all of which are located at the same address. This office is approximately twenty-five miles from the mobile home park. The business and emergency telephone numbers are extended area calls for the utility's customers.
5. **Tariff Rates.** Plantation Landings is making application for grandfather certificates. The application for grandfather certificates is not the appropriate forum in which to modify its rate structure. The Commission can not fairly modify the rate structure without concurrently authorizing an increase in rates to offset the additional costs.

Plantation Landings respectfully declines to provide the information requested in items a through c. Plantation Landings does not have the staffing to provide the detailed information that has been requested.

Changing the rate structure to separate usage and base facility charges would impose a financial hardship on the utility. The change would require Plantation Landings to reprogram its billing program. The change would also require Plantation Landings to change its prospectus pursuant to Chapter 723, Florida Statutes. Amendment of the prospectus entails engaging attorneys to prepare and file the prospectus with the Bureau of Mobile Homes. In addition to the legal costs, Plantation Landings would have to pay a filing fee equal to ten dollars (\$10.00) per lot. Preparation, filing and processing the prospectus would require approximately three months. Plantation Landings would then have to give its customers ninety (90) days notice.

The group which manages Plantation Landings would have to prepare a prospectus for each of ten (10) different mobile home parks. The expense of changing the prospectus for each of the ten mobile home parks would provide no benefit to the customers.

The Commission can not fairly impose a change of rate structure without concurrently authorizing an increase in rates to offset the additional costs. The application for grandfather certificates is, accordingly, not the proper forum in which to change the rate structure.

6. **Combined Rates.** The utility's rates are for water and wastewater service combined.
7. **Cost of Service.** Plantation Landings is making application for grandfather certificates. The application for grandfather certificates is not the appropriate forum in which to modify its rate structure. The Commission can not fairly require Plantation Landings to separate its water and wastewater charge without concurrently allowing it to recover the cost of separating the charge.

Separating the water and wastewater charge would require Plantation Landings to reprogram its customer billing program. It would also require Plantation Landings to change its prospectus pursuant to Chapter 723, Florida Statutes. Amendment of the prospectus entails engaging attorneys to prepare and file the prospectus with the Bureau of Mobile Homes. In addition to the legal costs, Plantation Landings would have to pay a filing fee equal to ten dollars (\$10.00) per lot. Preparation, filing and processing the prospectus would require approximately three months. Plantation Landings would then have to give its customers ninety (90) days notice.

The group which manages Plantation Landings would have to prepare a prospectus for each of ten (10) different mobile home parks. The expense of changing the prospectus for each of the ten mobile home parks would provide no benefit to the customers.

The Commission can not fairly require Plantation Landings to separate its water and wastewater charge without concurrently allowing it to recover the costs of separating the charge. This application for grandfather certificates is, accordingly, not the proper forum in which to separate the water and wastewater charge.

Division of Records and Reporting  
January 8, 1999  
Page 4

**8. Miscellaneous Tariff Corrections.** Please see the enclosed, modified tariff sheets. In Water Tariff Rule 7.0, we have added the phrase, "without the prior written consent of the Utility", rather than deleting the paragraph.

Please direct any additional questions to me at 562-9886.

Sincerely,



Norman F. Mears  
Senior Utility Consultant

Hand deliver  
Enclosures  
cc: Ray Moats

PROSPECTUS

PLANTATION LANDINGS MOBILE HOME PARK

1. THIS PROSPECTUS (OFFERING CIRCULAR) CONTAINS IMPORTANT MATTERS TO BE CONSIDERED IN LEASING A MOBILE HOME LOT.
2. THE STATEMENTS CONTAINED HEREIN ARE ONLY SUMMARY IN NATURE. A PROSPECTIVE LESSEE SHOULD REFER TO ALL REFERENCES, ALL EXHIBITS HERETO, THE CONTRACT DOCUMENTS, AND SALES MATERIALS.
3. ORAL REPRESENTATIONS SHOULD NOT BE RELIED UPON AS CORRECTLY STATING THE REPRESENTATIONS OF THE PARK OWNER OR OPERATOR. REFER TO THIS PROSPECTUS (OFFERING CIRCULAR) AND ITS EXHIBITS FOR CORRECT REPRESENTATIONS.
4. UPON DELIVERY OF THIS PROSPECTUS TO A PROSPECTIVE LESSEE, THE RENT AGREEMENT IS VOIDABLE BY THE LESSEE FOR A PERIOD OF FIFTEEN (15) DAYS.

The Park Owner does not maintain a mobile home owner's lawn, trees and shrubs, or premises in any manner. The park will not be liable for damage to mobile home owner's mobile home or other property as a result of falling trees, limbs, or other debris. Mobile home owner will be subject to payment of the costs of lawn maintenance or tree and shrub trimming, and/or removal if necessary (which, in that event, would be included in the lot rental amount as an additional charge) and possible eviction if mobile home owner fails to maintain his premises within the standards set forth in the Park Rules and Regulations.

At any time, regardless of whether a mobile home is being sold or not, in order to maintain the quality of the park, the Park Owner may require removal from the park of any mobile home that is not or can not be maintained to meet the park's established standards. The "established standards" require that the lot must be clean and well landscaped and the exterior of the home must appear neat, clean, and free of rust, chipping paint, and similar conditions indicating poor maintenance.

## VII. UTILITIES AND OTHER SERVICES

Utilities, sewage and garbage disposal, cable television, water supply, storm drainage, and the person or entity furnishing each will be provided as follows:

**Water and Sewer** - Each mobile home is individually metered and will be paid by the mobile home owner. So long as water and sewage are provided by the Park Owner, the minimum fee will be \$ 12.57 per month. For every 1,000 gallons or portion thereof in excess of 3,000 gallons per month, the rate shall be an additional \$ 1.26 per month, and will be a part of the lot rental amount as long as it is provided by the Park Owner. In the event that water or sewage is provided directly to the mobile home owner by a municipality, other government or agency thereof, or franchised utility company, the fees for water and sewage will be established by those authorities and will be paid by the mobile home owner. The mobile home owner shall be responsible for and pay for monthly usage fees and other fees, including any connections, impact or tap fees, all as established by such municipality or utility company. Responsibility for water and sewage lines in the park up to the lot line only is the responsibility of the park owner. The in-ground connection and the lines for water and sewage to and including the mobile home owner's lot line are the mobile home owner's responsibility.

**Garbage Disposal** - Garbage disposal and pick up location is provided by AAA Sanitation, is billed directly to the mobile home owner, and is not included in the rental amount of the lot. The fee for such garbage disposal is a matter of contract between the mobile home owner and the garbage disposal company (any increase in waste disposal fee will be the result of that company raising its rates and will be the responsibility of the mobile home owner).

**Cable Television** - Cable TV may at some time in the future be available through a private company, and will be the responsibility of the individual mobile home owner. The fee for such service will be a matter of contract between the mobile home owner and the cable TV company (any increases in cable TV fees will be as a result of the cable TV company raising its rates and will be the responsibility of the mobile home owner). Exterior antennas are permitted, so long as they are of the uniform dish type identical to those provided by the Park Owner at the time of initial mobile home purchase. The antenna may not exceed three feet in height above the mobile home roof line. Any other type of antenna must be approved in writing by the Park Owner.

**Storm Drainage** - Storm drainage is provided and maintained by the mobile home park through a system of in-ground drainage systems, together with natural run-off. Presently, storm drainage is included in the base rent. However, should any assessment by a governmental agency be imposed, that assessment or fee will be the responsibility of the mobile home owner on a pro-rata basis.

**Electricity** - Electric power is provided by Tampa Electric Company. Electric usage is billed directly to the mobile home owner and is the mobile home owner's sole responsibility. Tampa Electric Company

PLANTATION LANDINGS MOBILE HOME PARK  
LEASE AGREEMENT

THIS LEASE made and entered into this \_\_\_\_\_ day of \_\_\_\_\_, 19 \_\_\_\_\_, by and between \_\_\_\_\_, hereinafter called the Community and \_\_\_\_\_, hereinafter called the Owner-tenant.

WITNESSETH, that in consideration of the covenants herein contained, on the part of the said Owner-tenant to be kept and performed, the said Community does hereby lease to the said Owner-tenant the following described property: Street \_\_\_\_\_ Lot No. \_\_\_\_\_.

TO HAVE AND TO HOLD the same from the \_\_\_\_\_ day of \_\_\_\_\_, 19 \_\_\_\_\_, until the 31st day of December 19 \_\_\_\_\_, the said Owner-tenant paying the initial monthly base rental of \$ \_\_\_\_\_ from the beginning of this Lease until the 31st day of December, 19 \_\_\_\_\_. Annual monthly base rental increases for calendar years 19 \_\_\_\_\_ and subsequent years will be based on no less than \$ 5.00 or the increase in the Consumer Price Index (defined as the United States Department of Labor Consumer Price Index, U. S. City Average, All Urban Consumers, 1967 equals 100) ("CPI"), whichever is greater. Lease renewals and increases will become effective the first day of January of each year thereafter and will be a part of the Lease agreement for that year.

Base rent will also be increased in calendar years subsequent to the initial year by any increase in real estate or other taxes and assessments by a state or local government. Such increase in taxes and assessments will be based on a prorata computation among all lots in the mobile home park and will be charged to all residents to whom this Prospectus is applicable. The mobile home owner shall be notified of the increase in base rent at least ninety (90) days prior to the increase.

Rental payments are due on or before the 1st day of each month for that month, at the place designated by the Community.

The Owner-tenant covenants and agrees to the following:

1. To make no unlawful, improper, or offensive use of the property.
2. To comply with the Rules & Regulations of the park. A copy of said Rules & Regulations has been furnished to the Owner-tenant.
3. That the Lease is governed by Chapter 723, Florida Statutes (Florida Mobile Home Act) as currently in effect at the time of execution of this document, the provisions of which are incorporated herein by reference.
4. Actions by the Owner-tenant which constitute grounds for eviction under Section 723.061, Florida Statutes, shall be a violation of this Lease. Failure of the Community to evict a tenant for violation of any one of the grounds set forth in Section 723.061, Florida Statutes, or for any grounds provided for in this Lease, shall not waive the right for the Community to consider any subsequent violation of the same grounds, or the violation of any other grounds, a breach of this Lease by Owner-tenant so long as permitted by Chapter 723, Florida Statutes.
5. As provided in the Rules & Regulations, rules and regulations may be modified, eliminated, or additional rules and regulations adopted by the Community upon giving the Owner-tenant notice thereof as required by law and said Rules & Regulations in accordance with Chapter 723, Florida Statutes.
6. This Lease and the privileges contained herein are not assignable, and said Lease is only valid as long as those executing this Lease reside upon the premises set forth in this Lease, and are in full conformance of all provisions of this Lease and the park Rules & Regulations, except that a new home owner may assume in writing the balance of the annual Lease through December 31 of the year of purchase in accordance with Chapter 723, Florida Statutes.

7. Owner-tenant expressly understands and agrees that, upon execution of this Lease, all prior leases, rental agreements, negotiations, and other agreements between the parties regarding the lot leased are hereby terminated, void, and of no legal force and effect.

8. Other financial obligations of the Owner-tenant, not including any user fees, are as follows:

	<u>Fees or Charges</u>
Water and Sewage	\$ <u>12.57</u> minimum per month \$ <u>1.26</u> excess per month (each 1,000 gallons in excess of 3,000 gallons)
Yard Maintenance (not charged unless Owner-tenant fails to maintain yard)	\$ <u>20.00</u> per cut
Tree Trimming/Removal, Debris Removal (not charged unless Owner-tenant fails to provide services himself)	\$ <u>billed amount</u>
Late Check Charge	\$ <u>1.50</u> per day
Bad Check Charge	\$ <u>15.00</u>
Extra Resident Fee	\$ <u>10.00</u>
Debris Removal	charged in accordance with Section VIII(K) of the Prospectus
Governmental Assessments, Fees, Surcharges, and Charges	charged in accordance with Section VIII(J) of the Prospectus
Garbage disposal, cable television, and electricity	<u>Paid direct</u> by home owner to company providing service

The fees will be charged and increased as set out in Sections VIII(F) through (K) of the Prospectus.

9. The Community reserves the right to pass on and pass through charges in accordance with the Prospectus and Chapter 723, Florida Statutes.

10. Owner-tenant(s) acknowledge that they have read the foregoing, the Rules & Regulations, and the Prospectus, and that Owner-tenant was offered the foregoing Lease prior to occupancy.

We have read and understand this agreement and agree to the terms set out herein.

WITNESS our hands and seals of the date set out above.

\_\_\_\_\_  
Owner-tenant

\_\_\_\_\_  
Community Representative

\_\_\_\_\_  
Owner-tenant



**PLANTATION LANDINGS  
WASTEWATER TREATMENT PLANT**  
Application for Renewal of  
Operating Permit No. DO53-243034  
GMS ID No. 4053PO2226

*Submitted to*

**FLORIDA DEPARTMENT OF ENVIRONMENTAL PROTECTION**  
3804 Coconut Palm Drive  
Tampa, Florida 33619-8218

*Prepared for*

**PLANTATION LANDINGS, LTD.**  
Post Office Box 5252  
Lakeland, Florida 33807-5252

*Prepared by*

**CHASTAIN-SKILLMAN, INC.**  
4705 Old Highway 37  
Lakeland, Florida 33813  
941/646-1402

CSI File No. 6601.02

July 1998

## TABLE OF CONTENTS

Attachment A - Wastewater Permit Application Form 1

Attachment B - Wastewater Permit Application Form 2A

Attachment C - Capacity Analysis Report Update

Attachment D - Wastewater Flows

Attachment E - USGS Map

Attachment F - Location Map

Attachment G - Process Flow Diagram

Attachment H - RPZ Inspection Report

Attachment I - Flow Meter Calibration

Attachment J - Agricultural Use Plan Annual Report

CHASTAIN-SKILLMAN, INC. - engineers • scientists • surveyors

PLANTATION LANDINGS  
Wastewater Treatment Plant  
Application for Renewal of Operating Permit

**Wastewater Permit Application  
Form 1**

**Attachment A**

**WASTEWATER PERMIT  
APPLICATION FORM 1  
GENERAL INFORMATION**

**I IDENTIFICATION NUMBER:**

Facility ID 4053PO226

**II CHARACTERISTICS:**

INSTRUCTIONS: Complete the questions below to determine whether you need to submit any permit application forms to the Department of Environmental Protection. If you answer "yes" to any questions, you must submit this form and the supplemental form listed in the parenthesis following the question. Mark "X" in the blank in the third column if the supplemental form is attached. If you answer "no" to each question, you need not submit any of these forms. You may answer "no" if your activity is excluded from permit requirements. See Section B of the instructions. See also, Section C of the instructions for definitions of the terms used here.

SPECIFIC QUESTIONS	YES	NO	FORM ATTACHED
A. Is this facility a domestic wastewater facility which results in a discharge to surface or ground waters?		X	
B. Does or will this facility (either existing or proposed) include a concentrated animal feeding operation or aquatic animal production facility which results in a discharge to waters?		X	
C. Does or will this facility (other than those describe in A. or B.) discharge process wastewater, or non-process wastewater regulated by effluent guidelines or new source performance standards, to surface waters?		X	
D. Does or will this facility (other than those described in A. or B.) discharge process wastewater to ground waters?		X	
E. Does or will this facility discharge non-process wastewater, not regulated by effluent guidelines or new source performance standards, to surface waters?		X	
F. Does or will this facility discharge non-process wastewater to ground waters?		X	
G. Does or will this facility discharge stormwater to surface waters?		X	
H. Is this facility a non-discharging/closed loop recycle system?		X	

**III NAME OF FACILITY: (40 characters and spaces)**

Plantation Landings WWTP

**IV FACILITY CONTACT:** (A. 30 characters and spaces)

A. Name and Title (Last, first, & title)	B. Phone (area code & no.)
Moats, Raymond, Vice-President of Plantation Landings, Ltd.	941-647-1581

**V FACILITY MAILING ADDRESS:** (A. 30 characters and spaces; B. 25 characters and spaces)

A. Street or P.O. Box: P.O. Box 5252		
B. City or Town: Lakeland	State: FL	Zip Code: 33807-5252

**VI FACILITY LOCATION:** (A. 30 characters and spaces; B. 24 characters and spaces; C. 3 spaces (if known); D. 25 characters and spaces; E. 2 spaces; F. 9 spaces)

A. Street, Route or Other Specific Identifier: US 17/92 West		
B. County Name: Polk	C. County Code (if known): PLK	
D. City or Town: Haines City	E. State: FL	F. Zip Code: 33844

**VII SIC CODES:** (4-digit, in order of priority)

1. Code #: 4952	(Specify) Domestic WWTP	2. Code #:	(Specify)
3. Code #:	(Specify)	4. Code #:	(Specify)

**VIII OPERATOR INFORMATION:** (A. 40 characters and spaces; B. 1 character; C. 1 character (if other, specify); D. 12 characters; E. 30 characters and spaces; F. 25 characters and spaces; G. 2 characters; H. 9 characters)

A. Name: Plantation Landings, Ltd.		B. Is the name in VIII A. the owner? Yes: <input checked="" type="checkbox"/> No:	
C. Status of Operator: F = Federal; S = State; P = Private; O = Other; M = Public (other than F or S)		(code)	(specify)
P		Robert A. Byrd	D. Phone No.: 941-647-1581
E. Street or P. O. Box: P.O. Box 5252			
F. City or Town: Lakeland		G. State: FL	H. Zip Code: 33807-5252

**IX INDIAN LAND:** Is the facility located on Indian lands? Yes: \_\_\_\_\_ No:  X

**X EXISTING ENVIRONMENTAL PERMITS:**

A. NPDES Permit No.	B. UIC Permit No.	C. Other (specify)	D. Other (specify)
None	None	FDEP DO53-243034	FLA013033

**XI MAP:** Attach to this application a topographic map of the area extending to at least one mile beyond property boundaries. The map must show the outline of the facility, the location of each of its existing and proposed intake and discharge structures, each of its hazardous waste treatment, storage, or disposal facilities, and each well where it injects fluids underground. Include all springs, rivers and other surface water bodies in the map area. See instructions for precise requirements.

**XII NATURE OF BUSINESS** (provide a brief description)

Private golf club and adult residential community

**XIII CERTIFICATION** (see instructions)

I certify under penalty of law that I have personally examined and am familiar with the information submitted in this application and all attachments and that, based on my inquiry of those persons immediately responsible for obtaining the information contained in the application, I believe that the information is true, accurate and complete. I am aware that there are significant penalties for submitting false information, including the possibility of fine and imprisonment.

Raymond Moats  
A. Name (type or print)

  
B. Signature

Vice-President, Plantation Landings, Ltd.  
Official Title (type or print)

1/31/98  
C. Date Signed

PLANTATION LANDINGS  
Wastewater Treatment Plant  
Application for Renewal of Operating Permit

**Wastewater Permit Application  
Form 2A**

**Attachment B**

**WASTEWATER APPLICATION FORM 2A  
FOR A DOMESTIC  
WASTEWATER FACILITY PERMIT**

Instructions for selected items are included in the "INSTRUCTIONS FOR FORM 2A". Refer to these instructions before filling out each item.

**SECTION 1. APPLICANT AND FACILITY DESCRIPTION**

**1. Application Type**

- New
- Substantial Modification
- Permit Renewal

**2. Facility Type**

- Wastewater Treatment
- Reuse or Disposal
- Limited Wet Weather Discharge
- Residuals/Septage Management

**3. Treatment Facility Information**

a. Name

Plantation Landings Wastewater Treatment Plant

b. Facility Identification Number

4053PO226

c. Location

Plantation Landings

Number and Street

US 17/92 West

City/State/Zip Code

Haines City, FL 33844

Telephone

941-647-1581

Latitude

28 ° 06 ' 22 "N

Longitude

81 ° 39 ' 53 "W

Dates Coordinates Determined

From previous application 12/93

Method Used to Obtain Coordinates

USGS 7.5 minute map

d. Ownership Type

- Municipal
- County
- State
- Private



## e. Contact

Name Raymond MoatsTelephone 941-647-1581

## f. Facility Mailing Address

Number and Street Plantation Landings, Ltd. P.O. Box 5252City/State/Zip Code Lakeland, FL 33807-5252g. Year Facility Began Operation 1988 +/-h. Year of Facility's Last Substantial Modification 1993**4. Applicant or Authorized Representative**Legal Name Plantation Landings, Ltd.Number and Street P.O. Box 5252City/State/Zip Code Lakeland, FL 33807-5252Telephone 941-647-1581**5. Applicant's Authorized Agent**Name and Title Raymond Moats, Vice-PresidentNumber and Street P.O. Box 5252City/State/Zip Code Lakeland, FL 33807-5252Telephone 941-647-1581**6. Project Name and Description**

Plantation Landings Wastewater Treatment Plant  
is a secondary activated sludge facility with  
treated effluent discharged to dual percolation/  
evaporation ponds. The facility serves 400 adult  
rental lots.

7. Collection System Length unknown miles

8. Industrial Wastewater Contributions

a. Average Daily Flow 0 mgd

b. Does this facility have an approved pretreatment program?  Yes  No

Coordinator Name \_\_\_\_\_  
 Number and Street \_\_\_\_\_  
 City/State/Zip Code \_\_\_\_\_  
 Telephone \_\_\_\_\_

9. Municipalities or Areas Served

Name of Municipality or Area	Population Served
Plantation Landings	400 units with 2 persons per unit
Total Population Served	800

10. Reclaimed Water Reuse and Effluent Disposal

Method of Reuse or Disposal	Number of Reuse or Disposal Points	Total Design Capacity (mgd)	Basis of Design Flow
Surface Waters - Excluding Ocean Outfalls and Wetlands (Rule 62-600.510, F.A.C.)			
Ocean Outfalls (Rule 62-600.520, F.A.C.)			
Wetlands (Rule 62-600.620, F.A.C.)			
Reuse of Reclaimed Water and Land Application (Rule 62-600.530, F.A.C.)	1- dual basins	0.080	Annual Average
Ground Water Disposal by Underground Injection (Rule 62-600.540, F.A.C.)			
Other (Describe)			
Total Item 10		0.080	Annual Average

11. Number of Seasonal or Periodic Discharges None

**12. Flows to Another Wastewater Facility**

a. Does part of the facility's flow go into a collection/transmission system or reclaimed water distribution system under another responsible organization?

Yes  No

b. If yes, which one?

Collection/Transmission System  
 Reclaimed Water Distribution System

c. Responsible Organization Receiving the Flow

Name

Not Applicable

Number and Street

City/State/Zip Code

d. Name of Facility Which Receives the Flow

Not Applicable

e. Facility Identification Number of Facility Which Receives the Flow

Not Applicable

f. Average Daily Flow Discharge to the Receiving Facility

Not Applicable mgd

**13. Residuals Use or Disposal**

a. Amount of Residuals Generated by the Facility

5.7 dry tons/year

b. Does this facility receive residuals from another facility for further treatment and disposal?

Yes  No

c. Method of Residuals Use or Disposal

Method	Number of Sites or Number of Receiving Facilities	Dry Tons Used or Disposed per Year
Land Application (Chapter 62-640, F.A.C.)	1	5.7
Distribution and Marketing (Chapter 62-640, F.A.C.)		
Landfill Disposal (Chapter 62-701, F.A.C.)		
Incineration (Chapter 62-200 Series, F.A.C.)		
Transport to Another Treatment Facility		
Other (Describe)		
Total		5.7

- d. If residuals are transported to another facility for landfill disposal, incineration, or treatment, provide the facility name, Facility identification number and address.

Name

Not Applicable

Facility Identification Number

Number and Street

City/State/Zip Code

County

Telephone

Treatment Codes for Receiving Facility

**14. Permits and Applications**

- a. Expiration Date of Current NPDES Permit

Not Applicable

- b. Expiration Date of Current DEP Permit

February 7, 1999

- c. Existing, Pending, or Denied Permits and Permit Applications

Issuing Agency	Permit Type	Permit Number	Date Filed	Date Issued	Date Denied	Date of Expiration
FDEP	Domestic WW	DO53-243034		3/29/94		2/7/99

- d. Orders and Notices

Type of Order or Notice	Issuing Agency	Date of Order or Notice
Notice or Violation		None
Consent Order		None
Administrative Order		None
Other (Describe):		

**SECTION 2. TREATMENT FACILITY DESCRIPTION**

**1. Description**

Extended aeration, clarification, chlorine contact,  
sand filter, rapid infiltration basins, aerobic digester,  
sludge is hauled wet to an agricultural use site

---



---



---

**2. Treatment Codes**

J, ASE, N, PH, FS, M, ID/ID, DD, DL, XA

---



---



---

**3. Design Capacity of the Treatment Facility**

Current Design Capacity 0.080 mgd  
 Proposed Incremental Design Capacity + 0 mgd  
 Proposed Total Design Capacity = 0.080 mgd

**4. Basis of Design Flow**

- Annual Average Daily Flow
- Maximum Monthly Average Daily Flow
- Three-Month Average Daily Flow
- Other. If other, specify \_\_\_\_\_

**5. Design Treatment Levels**

Parameter	Effluent Concentration	Units	Basis	Percent Removal
pH	6.0-8.5	Standard Units		
CBOD <sub>5</sub>	20	mg/L	annual ADF	
TSS	20	mg/L	annual ADF	
Nitrate (as N)	12	mg/L	monthly ADF	
Fecal Coliform	200	#/100 mL	monthly ADF	
Chlorine residual	0.5	mg/L	daily minimum	

**6. Disinfection Level Provided**

- Low-level
- Basic
- Intermediate
- High-level
- High-level Alternative

If the facility disinfects by chlorination and the discharge is to surface waters, is dechlorination provided?

- Yes
- No
- Not Applicable

**7. Residuals Treatment**

a. Class of Residuals

- Class AA (Rule 62-640.850, F.A.C.)
- Class A (Rule 62-640.600, F.A.C.)
- Class B (Rule 62-640.600, F.A.C.)
- Other

If other, describe.

---



---



---

b. Parameter Concentrations

Total Nitrogen	<u>0.9</u> % dry weight
Total Phosphorus	<u>1.5</u> % dry weight
Total Potassium	<u>0.9</u> % dry weight
Cadmium	<u>0.9</u> mg/kg dry weight
Copper	<u>110.</u> mg/kg dry weight
Lead	<u>3.3</u> mg/kg dry weight
Nickel	<u>4.7</u> mg/kg dry weight
Zinc	<u>290.</u> mg/kg dry weight
pH	<u>6.3</u> standard units
Total Solids	<u>0.5</u> %

Other Parameters (Describe.)

As=4.7 mg/kg, Se=10.2 mg/kg, Hg=27. mg/kg,  
Mo=4.7 mg/kg, Cr=4.2 mg/kg

Date of Sample

2/11/98

**8. Reliability Class**

- Class I
- Class II
- Class III
- Other Equivalent Reliability

**SECTION 3. A. DISCHARGES TO SURFACE WATERS (including wetlands)**

**Not Applicable**

**1. Discharge Serial Number and Name**

Discharge Serial Number \_\_\_\_\_

Discharge Name \_\_\_\_\_

Previous Discharge Serial Number \_\_\_\_\_

**2. Discharge Location**

County \_\_\_\_\_

City or Town (if applicable) \_\_\_\_\_

Street or Description \_\_\_\_\_

Latitude \_\_\_\_\_ ° \_\_\_\_\_ ' \_\_\_\_\_ "N

Longitude \_\_\_\_\_ ° \_\_\_\_\_ ' \_\_\_\_\_ "W

Dates Coordinates Determined \_\_\_\_\_

Method Used to Obtain Coordinates \_\_\_\_\_

**3. Discharge Operating Dates**

Discharge Start Date \_\_\_\_\_

Discharge End Date \_\_\_\_\_

Reason for Discontinuing the Discharge \_\_\_\_\_

**4. Design Capacity of the Outfall**

Current Design Capacity \_\_\_\_\_ mgd

Proposed Incremental Design Capacity + \_\_\_\_\_ mgd

Proposed Total Design Capacity = \_\_\_\_\_ mgd

**5. Basis of Design Flow**

\_\_\_\_\_ Annual Average Daily Flow

\_\_\_\_\_ Maximum Monthly Average Daily Flow

\_\_\_\_\_ Three-Month Average Daily Flow

\_\_\_\_\_ Other

If other, specify. \_\_\_\_\_

**Not Applicable**

**6. Basis for Effluent Limitations**

- TBEL
- Level I WQBEL
- Level II WQBEL
- Other

If other, specify.

Date Effluent Limitations Established

**7. Discharge Point Description**

- Ocean
- Stream
- Estuary
- Lake
- Wetland
- Other

If other, specify.

**8. Receiving Waterbody Name**

**9. Type of Receiving Waterbody**

- Fresh
- Brackish or Marine

**10. Classification of Receiving Waterbody**

- Class I
- Class II
- Class III
- Class IV
- Class V

Is the receiving waterbody contiguous to, or identified as, an Outstanding Florida Water (OFW) or an Outstanding National Resource Water?

- Yes
- No

If yes, name and locate on a USGS map.

**11. Outfall Information**

Description of Outfall and Diffuser

Construction Materials

Length From Shore

Diameter

Discharge Depth Below Water Surface

Receiving Water Bottom Depth Below Water Surface

\_\_\_\_\_ feet

\_\_\_\_\_ inches

\_\_\_\_\_ feet

\_\_\_\_\_ feet



**Not Applicable**

**12. Surface Water Improvement and Management (SWIM)**

- a. Will the discharge affect any SWIM plan waterbodies?  Yes  No
- b. If yes, name the waterbody. \_\_\_\_\_
- c. Has the SWIM plan been approved by a water management district and the Department?  Yes  No
- d. If yes, attach documentation that the proposed discharge is consistent with the SWIM plan.

**13. Additional Information Required for Seasonal or Periodic Discharges**

Frequency \_\_\_\_\_ Times Per Year  
 Duration \_\_\_\_\_ Days  
 Volume \_\_\_\_\_ Thousand Gallons Per Incident

Occurrence

	Jan		May		Sep
	Feb		Jun		Oct
	Mar		Jul		Nov
	Apr		Aug		Dec

**14. Additional Information Required for Limited Wet Weather Discharges Permitted in Accordance with Rule 62-610.860, F.A.C.**

a. Downstream Waterbody

Name of nearest downstream lake, estuary, reservoir, OFW, or Class I water. Show location on a USGS map.

Downstream Waterbody Description

- Ocean
- Stream
- Estuary
- Lake
- Wetland
- Other

If other, specify. \_\_\_\_\_

**Not Applicable**

Classification of Downstream Waterbody

- Class I
- Class II
- Class III
- Class IV
- Class V

Distance Downstream \_\_\_\_\_ miles

Average Flow Velocity During Anticipated Periods of Discharge \_\_\_\_\_ feet per second

Travel Time During Anticipated Periods of Discharge \_\_\_\_\_ hours

b. Rainfall Information

Rainfall Gauging Station Location \_\_\_\_\_

Period of Record Analyzed:

Beginning Year \_\_\_\_\_

Ending Year \_\_\_\_\_

Number of Years \_\_\_\_\_

Average Annual Rainfall \_\_\_\_\_ inches per year

c. Simulation of Operation of the Reuse, Storage, and Limited Wet Weather Discharge for an Average Rainfall Year

Year Simulated \_\_\_\_\_

Annual Rainfall During Average Year \_\_\_\_\_ inches

Number of Days Limited Wet Weather Discharge is Used During Average Rainfall Year (N) \_\_\_\_\_ days

Percent of the Days of the Year that the Limited Wet Weather Discharge will Occur During Average Rainfall Year (P) \_\_\_\_\_ %

Note:

$P = [(N)/(365)] \times 100\%$ .

P cannot exceed 25% or be less than 1%.

d. Reclaimed Water Quality (maximum monthly average)

CBOD<sub>5</sub> \_\_\_\_\_ mg/L

TKN (as Nitrogen) \_\_\_\_\_ mg/L

**Not Applicable**

e. Minimum Acceptable Stream Dilution Factor (SDF) \_\_\_\_\_

Note:

$$SDF = P(0.085 \times CBOD_5 + 0.272 \times TKN - 0.484)$$

The values for  $CBOD_5$  and TKN should be in terms of maximum monthly average limitations as provided in 14.d. above. The value of P should be as calculated in 14.c. above.

f. Adjusted Stream Dilution Factor \_\_\_\_\_

Note:

If the travel time shown in 14.a., above, is less than 24 hours, provide the adjusted minimum acceptable stream dilution factor.

$$\text{Adjusted SDF} = SDF \times (24 \text{ hours}) / (\text{travel time in hours})$$

**15. Additional Information Required for Wetland Discharges**

a. Is the wetland a jurisdictional wetland (i.e. within the landward extent of waters as defined in Rule 62-301.400, F.A.C., or isolated and not owned entirely by one person, or owned entirely by the State)?  Yes  No

b. Will the wetland be used as a treatment wetland or receiving wetland?  Treatment  Receiving

If the wetland is to be used as a treatment wetland, attach documentation showing ownership or the applicant's legal interest in the treatment wetland.

c. If the wetland is to be used for treatment, identify the type.  Man-made  Hydrologically Altered  Unaltered

d. Is the wetland herbaceous or woody?  Herbaceous  Woody

e. Identify the classification of surface waters within the wetland.  Class I  Class II  Class III  Class IV  Class V

f. Are the waters within the wetland part of an OFW?  Yes  No

**16. Operational Data      Not Applicable**

a. Description of Influent and Effluent

Parameter	Influent	Effluent					
	Annual Average	Annual Average	Lowest Monthly Average	Highest Monthly Average	Frequency of Analysis	Number of Analyses	Sample Type
Flow mgd							
pH Units							
Fecal Coliform Bacteria Number/100 mL							
CBOD 5-day mg/L							
Chlorine Total Residual mg/L							
Total Suspended Solids mg/L							
Ammonia (an N) mg/L							
Kjeldahl Nitrogen mg/L							
Nitrate (as N) mg/L							
Total Phosphorus (as P) mg/L							
Dissolved Oxygen mg/L							

**Not Applicable**

## b. Additional Wastewater Characteristics

Parameter	Present	Parameter	Present	Parameter	Present
Bromide		Cobalt		Thallium	
Chloride		Chromium		Titanium	
Cyanide		Copper		Tin	
Fluoride		Iron		Zinc	
Sulfide		Lead		Algicides*	
Aluminum		Manganese		Chlorinated Organic Compounds*	
Antimony		Mercury		Oil and Grease	
Arsenic		Molybdenum		Pesticides*	
Beryllium		Nickel		Phenols	
Barium		Selenium		Surfactants	
Boron		Silver		Radioactivity*	
Cadmium					

- Provide specific compound or element as "Additional Information", if known.

**SECTION 3. B. REUSE AND LAND APPLICATION SYSTEMS****1. Reuse or Land Application System Serial Number and Name**

Reuse or Land Application System Serial Number R001  
 Reuse or Land Application System Name Dual Percolation/Evaporation Ponds  
 Previous Reuse or Land Application System Serial Number NA

**2. Reuse or Land Application System Location**

County Polk  
 City or Town (if applicable) West of Haines City  
 Street or Description Dyson Road

Latitude 28° 05' 52" N  
 Longitude 81° 39' 22" W  
 Dates Coordinates Determined Last permit application  
 Method Used to Obtain Coordinates USGS 7.5 min. quad

**3. Reuse or Land Application System Operating Dates**

System Operation Start Date 1993  
 System Operation End Date NA  
 Reason for Discontinuing System Operation NA

**4. Design Capacity of the Reuse or Land Application System**

Current Design Capacity 0.080 mgd  
 Proposed Incremental Design Capacity + 0 mgd  
 Proposed Total Design Capacity = 0.080 mgd

**5. Basis of Design Flow**

- Annual Average Daily Flow  
 Maximum Monthly Average Daily Flow  
 Three-Month Average Daily Flow  
 Other

If other, specify.  
 \_\_\_\_\_  
 \_\_\_\_\_

**6. Underdrains and Perimeter Ditches**

- a. Is the reuse or land application system underdrained?  
 Yes  No

b. Are perimeter ditches used?  Yes  No

If yes, will they be excavated to a depth which will intersect the seasonal high ground water table or the ground water mound during any portion of the year?  Yes  No

**7. Type of Reuse or Land Application System**

- Slow-rate land application system/restricted public access (Chapter 62-610, F.A.C., Part II)
- Slow-rate land application system/public access areas, residential irrigation, and edible crop irrigation (Chapter 62-610, F.A.C., Part III)
- Rapid-rate land application system (Chapter 62-610, F.A.C., Part IV)
- Absorption field system (Chapter 62-610, F.A.C., Part V)
- Overland flow system (Chapter 62-610, F.A.C., Part VI)
- Other land application system with additional levels of preapplication treatment (Rule 62-610.660, F.A.C.)
- Other land application system with lower levels of preapplication treatment (Rule 62-610.670, F.A.C.)

**8. Application Areas and Rates**

Site/Use Type/Major User	Area (acres)	Rate (inches/week)	Capacity (mgd)
Dual Percolation/Evaporation Ponds/WWTP	2.94	7.02	0.080
<b>Total</b>	<b>2.94</b>	<b>7.02</b>	<b>0.080</b>

**9. Additional Information Required for Reuse Systems Permitted Under Part III of Chapter 62-610, F.A.C.**

a. Areas Irrigated **Not Applicable**

- Residential lawns
- Golf courses
- Cemeteries
- Parks, playgrounds
- Landscape areas
- Highway medians, rights-of-way
- Edible crops
- Others

If other, specify. \_\_\_\_\_

**Not Applicable**

Serial Number R001

b. Other Uses of Reclaimed Water

- Toilet flushing
- Fire protection
- Construction dust control
- Aesthetic purposes (decorative ponds, fountains, etc.)
- Others

If other, specify.

\_\_\_\_\_

c. How many hours per day, seven days per week, is or will an operator be on-site at the wastewater treatment facility?

\_\_\_\_\_ hours per day

If the treatment facility is or will be staffed by an operator less than 24 hrs/day, describe the additional levels of reliability included within the treatment or reuse systems.  
(See Rule 62-610.462, F.A.C.)

\_\_\_\_\_  
\_\_\_\_\_  
\_\_\_\_\_  
\_\_\_\_\_  
\_\_\_\_\_

d. For permit renewals, list the dates on which the operating protocols (as described in Rule 62-610.463, F.A.C.) were submitted to the Department and the date of the Department's approvals during the last five years.

Date Submitted	Date Approved

e. For each site where edible crops are or will be irrigated with reclaimed water, describe the crops grown; the type of application system used; provisions for crop washing and for processing, if any; and provisions for control of public access, if any. (See Rule 62-610.475, F.A.C.)

\_\_\_\_\_  
\_\_\_\_\_  
\_\_\_\_\_  
\_\_\_\_\_  
\_\_\_\_\_



**SECTION 3. C. GROUND WATER DISPOSAL BY UNDERGROUND INJECTION**

**1. Underground Injection Well Facility Serial Number and Name** **Not Applicable**

Underground Injection Well Facility Serial Number \_\_\_\_\_

Underground Injection Well Facility Name \_\_\_\_\_

Previous Underground Injection Well Facility Serial Number \_\_\_\_\_

**2. Underground Injection Well Facility Location**

County \_\_\_\_\_

City or Town (if applicable) \_\_\_\_\_

Street or Description \_\_\_\_\_

Latitude \_\_\_\_\_ ° \_\_\_\_\_ ' \_\_\_\_\_ "N

Longitude \_\_\_\_\_ ° \_\_\_\_\_ ' \_\_\_\_\_ "W

Dates Coordinates Determined \_\_\_\_\_

Method Used to Obtain Coordinates \_\_\_\_\_

**3. Underground Injection Well Facility DEP Identification Number or Permit Application Number** \_\_\_\_\_

**4. Discharge Operating Dates**

Discharge Start Date \_\_\_\_\_

Discharge End Date \_\_\_\_\_

Reason for Discontinuing the Discharge \_\_\_\_\_

**5. Design Capacity of the Underground Injection Well Facility**

Current Design Capacity \_\_\_\_\_ mgd

Proposed Incremental Design Capacity + \_\_\_\_\_ mgd

Proposed Total Design Capacity = \_\_\_\_\_ mgd

**6. Basis of Design Flow**

Annual Average Daily Flow

Maximum Monthly Average Daily Flow

Three-Month Average Daily Flow

Other

If other, specify. \_\_\_\_\_

**SECTION 4.  
SCHEDULED IMPROVEMENTS AND SCHEDULES OF IMPLEMENTATION**

**1. Improvements Required** **Not Applicable**

a. Discharge Serial Numbers, Reclaimed Water Reuse or Land Application System Serial Numbers, and Underground Injection Well Facility Serial Numbers Affected

---

b. Authority Imposing Requirement

- Local
- State
- Federal
- Developed by Applicant
- Other

If other, specify.

---

c. Improvement Description:

3-character General Action Description  
3-character Specific Action Descriptions

---



---

**2. Implementation Schedule and Actual Completion Dates**

Implementation Steps	Schedule	Actual Completion
a. Preliminary Plans Complete		
b. Final Plans and Specifications Complete		
c. Financing Complete		
d. Site Acquired		
e. Begin Construction		
f. End Construction		
g. Begin Reuse or Disposal		
h. Operational Level Attained		

**SECTION 5. INDUSTRIAL WASTEWATER CONTRIBUTIONS**

**Not Applicable**

**1. Significant Industrial User**

Name  
 Number and Street  
 City/State/Zip Code  
 County

\_\_\_\_\_  
 \_\_\_\_\_  
 \_\_\_\_\_  
 \_\_\_\_\_

**2. Primary Standard Industrial Classification Code**

\_\_\_\_\_

**3. Principal Product or Raw Material**

	Description	Quantity per Day	Units (See Table 3)
Product			
Raw Material			

**4. Flow**

Volume \_\_\_\_\_ Gallons Per Day  
 Frequency \_\_\_\_\_ Intermittent \_\_\_\_\_ Continuous

**5. Pretreatment Provided**

Yes  No

**6. Characteristics of Wastewater**

Parameter Name	Value	Units

**SECTION 6. ADDITIONAL INFORMATION REQUIRED FOR PERMIT RENEWALS**

1. Have there been any modifications to the treatment facilities or reuse or disposal system, since the issuance of the current permit? If yes, describe on a separate sheet and attach.  Yes  No
  
2. For limited wet weather discharges, have any modifications been made to the operation, frequency of discharge, or stream hydrology since the original limited wet weather discharge permit or the most recent permit? If yes, describe on a separate sheet and attach. Added second set of sand filters  
 Yes  No  NA
  
3. Have there been any violations during the last six months? If yes, describe on a separate sheet and attach.  Yes  No
  
4. Have there been any treatment facility interferences due to the discharge of industrial wastewater to the treatment facility during the last six months? If yes, describe on a separate sheet and attach.  Yes  No
  
5. Is there any enforcement action pending against these treatment, reuse, or disposal facilities? If yes, describe on a separate sheet and attach.  Yes  No
  
6. Have all previous permit conditions, including pretreatment requirements, monitoring requirements, and operator attendance been complied with? If no, describe on a separate sheet and attach.  Yes  No
  
7. For permit renewals involving a limited wet weather discharge permitted under Rule 62-610.860, F.A.C., list the number of days during each of the last five years that the limited wet weather discharge was used. Also, list the total annual rainfall for each year. **Not Applicable**

Year	Number of Days Used	P (%)	Annual Rainfall (inches)
1.			
2.			
3.			
4.			
5.			
Total/Average			

8. For permit renewals involving a limited wet weather discharge permitted under Rule 62-610.860, F.A.C., provide the number of days during each of the last five years that the actual dilution ratio, as defined in Rule 62-610.860, F.A.C., was less than the minimum SDF and the number of months in which the monthly average CBOD<sub>5</sub> or TKN in the limited wet weather discharge exceeded the permit limitations. **Not Applicable**

Year	Number of Days the Dilution Ratio Was Less Than SDF	Number of Months the Limits Were Exceeded	
		CBOD <sub>5</sub>	TKN
1.			
2.			
3.			
4.			
5.			

**SECTION 7. ADDITIONAL INFORMATION REQUIRED  
FOR RESIDUALS/SEPTAGE MANAGEMENT FACILITIES**

**Not Applicable**

**1. Location of Residuals Treatment Processes**

(Describe in relation to the wastewater treatment processes.)

---

---

---

---

---

---

---

---

---

---

**2. Type and Amount of Waste Treated at this Facility**

Type	Amount (dry tons/day)	Amount (gallons/day)
Residuals	or	
Septage		
Food Establishment Sludge		
Portable Toilet Waste		
Holding Tank Waste		
Boat or Marina Waste		
Other (Describe.)	or	
Total	or	

Is the total amount estimated or actual?

- Estimated  
 Actual

**3. Information on Treatment Facilities Transporting Residuals**

a. DEP Permit Number

---

b. Facility Name

Number and Street

City/State/Zip Code

County

Telephone

---

---

---

---

---

---

c. Facility Type **Not Applicable**

- Type I
- Type II
- Type III

d. Amount of Residuals Received From This Facility

\_\_\_\_\_ dry tons/day or \_\_\_\_\_ gpd

Is this amount estimate or actual?

- Estimated
- Actual

e. Describe the treatment provided by this facility before transport.

---

---

---

---

---

---

---

f. Parameter Concentrations

Total Nitrogen

\_\_\_\_\_ % dry weight

Total Phosphorus

\_\_\_\_\_ % dry weight

Total Potassium

\_\_\_\_\_ % dry weight

Cadmium

\_\_\_\_\_ mg/kg dry weight

Copper

\_\_\_\_\_ mg/kg dry weight

Lead

\_\_\_\_\_ mg/kg dry weight

Nickel

\_\_\_\_\_ mg/kg dry weight

Zinc

\_\_\_\_\_ mg/kg dry weight

pH

\_\_\_\_\_ standard units

Total Solids

\_\_\_\_\_ %

Other Parameters (Describe.)

---

---

---

---

---

Date of Sample

---

---

---

---

---

---

---

---

---

---

---

4. Describe the manifest system used for tracking residuals during transport from the facilities.

**SECTION 8. DOCUMENTATION SUBMITTED**

1. General Application Requirements	Attached	
	Yes	No
a. Process Flow Diagram <b>Attachment G</b>	X	
b. Site Plan <b>Attachment E - USGS Map</b>	X	
c. Location Map <b>Attachment F</b>	X	
d. Agricultural Use Plan or Dedicated Site Plan <b>Attachment J - Annual Report</b>	X	
e. Capacity Analysis Report <b>Attachment C- Update</b>	X	
f. Results of Whole Effluent Biological Toxicity Testing		X
g. Reuse Feasibility Study		X
h. Binding Agreements and Documentation of Controls on Individual Users of Reclaimed Water		X

2. Additional Application Requirements for New Facilities and Modifications to Existing Facilities	Yes	No
a. Preliminary Design Report		X
b. Documentation of Compliance with Antidegradation Requirements		X
c. Public Service Commission Certification Number and Copy of Certificate or Order Number and Copy of Order		X
d. Letter from the Management and Storage of Surface Waters Permitting Agency		X
e. Request for Approval of Monitoring Plans for Discharge of Domestic Wastewater to Wetlands		X
f. Concurrent Application for Ground Water Disposal by Underground Injection		X
g. Application for Monitoring Plan Approval		X

3. Additional Application Requirements for Permit Renewals	Yes	No
a. Operation and Maintenance Performance Report <b>Submitted under separate cover</b>	X	
b. Reclaimed Water of Effluent Analysis Report		X
c. Technical Evaluation of Need to Revise Local Pretreatment Limits		X
d. Results of Mechanical Integrity Testing		X



SECTION 9. CERTIFICATIONS

1. Certifications for Construction of New Facilities or Modifications to Existing Facilities

a. Applicant or Authorized Representative **Not Applicable**

I certify that the statements made in this application for a permit and all attachments are true, correct, and complete to the best of my knowledge and belief. I agree to retain the design engineer, or another professional engineer registered in Florida, to conduct on-site observation of construction, to prepare a notification of completion of construction, and to review record drawings for adequacy as referenced in Rule 62-620.630, F.A.C. Further, I agree to provide an appropriate operation and maintenance manual for the facilities pursuant to Rule 62-620.630, F.A.C., and to retain a professional engineer registered in Florida to examine (or to prepare or revise, if necessary) the manual. For projects regulated by Chapter 62-610, F.A.C., I agree to provide the additional operation requirements of that Chapter.

\_\_\_\_\_  
(Signature of Applicant or Authorized Representative)

\_\_\_\_\_  
Date

\_\_\_\_\_  
Name (please type)

\_\_\_\_\_  
Company Name

\_\_\_\_\_  
Title

\_\_\_\_\_  
Company Street Address or P O Box

\_\_\_\_\_  
Telephone No. (including area code)

\_\_\_\_\_  
City, State, Zip Code

b. Professional Engineer Registered in Florida

I certify that the engineering features of this domestic wastewater project have been (designed) (examined) by me and found to conform to engineering principles applicable to such projects. In my professional judgment, this facility, when properly constructed, operated, and maintained, will comply with all applicable statutes of the State of Florida and rules of the Department.

\_\_\_\_\_  
Name (please type)

\_\_\_\_\_  
Company Name

\_\_\_\_\_  
Florida Registration Number

\_\_\_\_\_  
Company Street Address or P O Box

\_\_\_\_\_  
Phone No. including area code

\_\_\_\_\_  
City, State, Zip Code

(Seal, Signature, Date, and Registration No.)

1 If signed by the authorized representative, attach a letter of authorization.

c. Professional Engineer Registered in Florida **Not Applicable**

I certify that this firm or individual has been retained by the applicant to prepare a notification of completion of construction, to prepare operation and maintenance manuals, and to review record drawings for adequacy as referenced in Rules 62-620.630, 62-600.717, and 62-600.720, F.A.C.

Name (please type):

Florida Registration Number:

Company Name:

Company Address:

City/State/Zip Code:

Phone Number:

\_\_\_\_\_  
(Seal, Signature, Date, Registration No.)

**2. Certifications for Permit Renewals**

a. Applicant or Authorized Representative

I certify that the statements made in this application for a permit and all attachments are true, correct and complete to the best of my knowledge and belief. I agree to operate and maintain these wastewater facilities in such a manner as to comply with the provisions of Chapter 403, F.S., Chapter 62-600, F.A.C., and all other applicable rules of the Department. Further, an appropriate operation and maintenance manual which has been examined by a professional engineer as certified below is available and located at Century Realty's Corp. Office Bldg. and can be submitted upon request as part of the permit procedure. A copy of the record drawings or other plans (as applicable) showing modifications to existing facilities, as referenced in Rule 62-600.717, F.A.C., is available at the same location. I also understand that a permit if granted by the Department, is transferable only upon Department approval in accordance with Rule 62-620.340, F.A.C., and I will notify the Department in accordance with this rule upon sale or legal transfer of the permitted facilities. In the event of abandonment or inactivation of the facilities, I will notify the Department and ensure that public health and safety are protected as required by Rule 62-620.610, F.A.C.

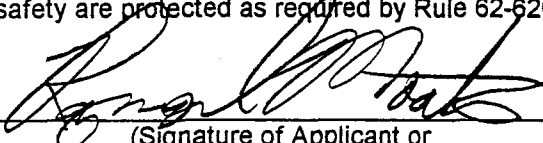
  
\_\_\_\_\_  
(Signature of Applicant or Authorized Representative<sup>2</sup>)

7/31/98  
\_\_\_\_\_  
Date

Raymond Moats  
\_\_\_\_\_  
Name (please type)

Plantation Landings, Ltd.  
\_\_\_\_\_  
Company Name

Vice-President  
\_\_\_\_\_  
Title

P.O. Box 5252  
\_\_\_\_\_  
Company Street Address or P O Box

(941)647-1581  
\_\_\_\_\_  
Telephone No. (including area code)

Lakeland, FL 33807-5252  
\_\_\_\_\_  
City, State, Zip Code

<sup>2</sup> If signed by the authorized representative, attach a letter of authorization.

b. Professional Engineer

I certify that the engineering features of these domestic wastewater facilities have been examined by me and found to conform to engineering principles applicable to such projects. I certify that the operation and maintenance manual for these wastewater facilities has been prepared or examined by me or by individual(s) under my direct supervision and that there is reasonable assurance, in my professional judgement, that the facilities, when properly operated and maintained in accordance with this manual, will comply with all applicable statutes of the State of Florida and rules of the Department.

Name (please type): Lisa Strine Lassi, P.E.

Florida Registration Number: 44157

Company Name: Chastain-Skillman, Inc.

Company Address: P.O. Box 5710

City/State/Zip Code: Lakeland, FL 33807-5710

Phone Number: (941)646-1402

  
(Seal, Signature, Date, Registration No.)

8-3-98  
#44157

PLANTATION LANDINGS  
Wastewater Treatment Plant  
Application for Renewal of Operating Permit

**Wastewater Permit Application  
Capacity Analysis Report Update**

**Attachment C**

## SECTION 8. DOCUMENTATION

### 1.e. Capacity Analysis Report Update

The Plantation Landings wastewater treatment facility services the Plantation Landings Development consisting of 400 rental adult mobile home sites, an office building, and clubhouse. Because the service area is built-out and there are no plans to expand the service area beyond its current boundaries, an abbreviated update is provided in this section. According to the *Guidelines for Preparation of Capacity Analysis Reports*, facilities serving areas that are built-out may submit abbreviated reports when operating history indicates that the facility is in compliance with its effluent limitations. A previous update to the Capacity Analysis Report was submitted with the permit application in 1993.

Plantation Landings wastewater treatment plant is a privately-owned facility serving the residents of the development since approximately 1988. The general location of the plant is indicated on the Location Map (**Figure 1**, included as **Attachment F**). The extended aeration treatment facility is a concrete and masonry package-type plant with a capacity of 80,000 gallons per day (gpd). It includes an influent flow splitter box, 2 aeration basins, 2 clarifiers, 2 chlorine contact chambers, 2 digesters, and 2 sand filters. In addition, effluent clearwells and effluent pumping are provided. Treated effluent is pumped to dual rapid infiltration basins located off-site. A process flow diagram indicating flow lines and tank volumes is included as **Figure 2, Attachment G**.

Flow data for the past three years was obtained from the FDEP monthly operating reports. Effluent flow from the plant is measured using an ultra-sonic type flow meter. The flow meter is calibrated on an annual basis.

Monthly average daily flows (ADF), 3-month ADFs, and annual ADFs for the past three years are presented in **Table 2, Wastewater Flows**, included as **Attachment D**.

PLANTATION LANDINGS  
Wastewater Treatment Plant  
Application for Renewal of Operating Permit

**Wastewater Permit Application  
Wastewater Flows**

**Attachment D**

**TABLE 2. Wastewater Flows (June 1995-June 1998)**

<b>Month-Yr</b>	<b>Monthly ADF (mgd)</b>	<b>% of Permit Capacity</b>	<b>3-Month ADF (mgd)</b>	<b>Annual ADF (mgd)</b>
Jun-95	0.022	28		
Jul-95	0.024	30		
Aug-95	0.023	29	0.023	
Sep-95	0.019	24	0.022	
Oct-95	0.023	29	0.022	
Nov-95	0.038	48	0.027	
Dec-95	0.025	31	0.029	
Jan-96	0.028	35	0.030	
Feb-96			0.027	
Mar-96	0.037	46	0.033	
Apr-96	0.028	35	0.033	
May-96	0.022	28	0.029	
Jun-96	0.020	25	0.023	
Jul-96			0.021	
Aug-96	0.018	23	0.019	
Sep-96	0.017	21	0.018	
Oct-96	0.020	25	0.018	
Nov-96	0.015	19	0.017	
Dec-96	0.020	25	0.018	0.023
Jan-97	0.026	33	0.020	0.022
Feb-97	0.027	34	0.024	0.023
Mar-97	0.032	40	0.028	0.022
Apr-97	0.021	26	0.027	0.022
May-97	0.009	11	0.021	0.020
Jun-97	0.015	19	0.015	0.020
Jul-97	0.015	19	0.013	0.020
Aug-97	0.017	21	0.016	0.020
Sep-97	0.014	18	0.015	0.019
Oct-97	0.014	18	0.015	0.019
Nov-97	0.021	26	0.016	0.019
Dec-97	0.028	35	0.021	0.020
Jan-98	0.030	38	0.026	0.020
Feb-98	0.035	44	0.031	0.021
Mar-98	0.034	43	0.033	0.021
Apr-98	0.023	29	0.031	0.021
May-98	0.011	14	0.023	0.021
Jun-98	0.011	14	0.015	0.021

PLANTATION LANDINGS  
Wastewater Treatment Plant  
Application for Renewal of Operating Permit

**Wastewater Permit Application  
USGS Map**

**Attachment E**



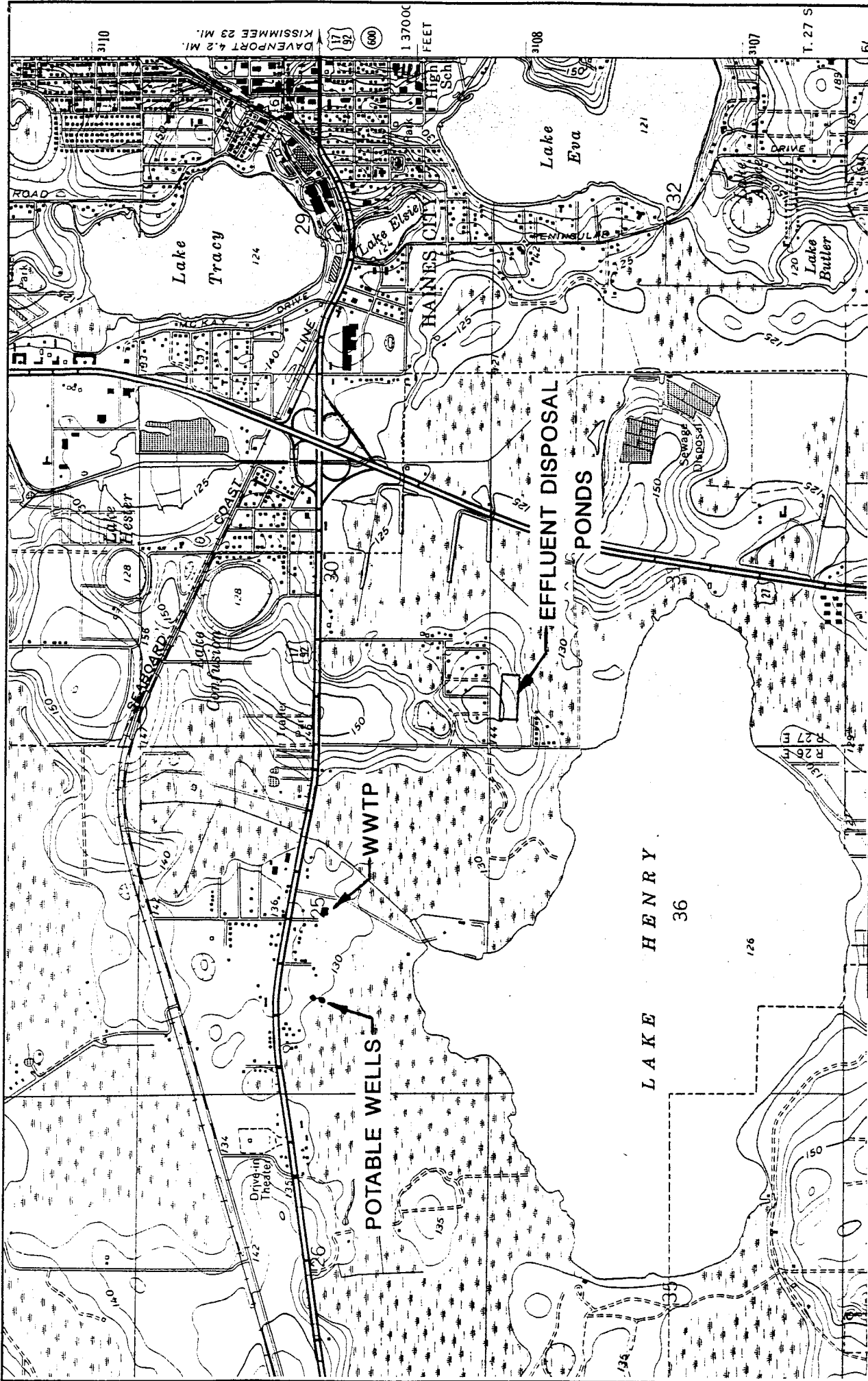

USGS  
MAP

PLANTATION LANDINGS  
WASTEWATER TREATMENT PLANT  
HAINES CITY, FLORIDA

WINTER HAVEN, FLA.  
28081-A6-TF-024  
PHOTOINSPECTED 1983  
1959  
PHOTOREVISED 1980  
DMA 4640 II SW-SERIES V847

C.S.I. PROJ. NO. 6601.02 FIG. NO. 3

CHASTAIN-SKILLMAN, INC.  
DRAFTED BY: 7/27/98 BAC  
REVIEWED/APPROVED BY: L.S.L.

CHASTAIN-SKILLMAN, INC. - *engineers • scientists • surveyors*

PLANTATION LANDINGS  
Wastewater Treatment Plant  
Application for Renewal of Operating Permit

**Wastewater Permit Application  
Location Map**

**Attachment F**

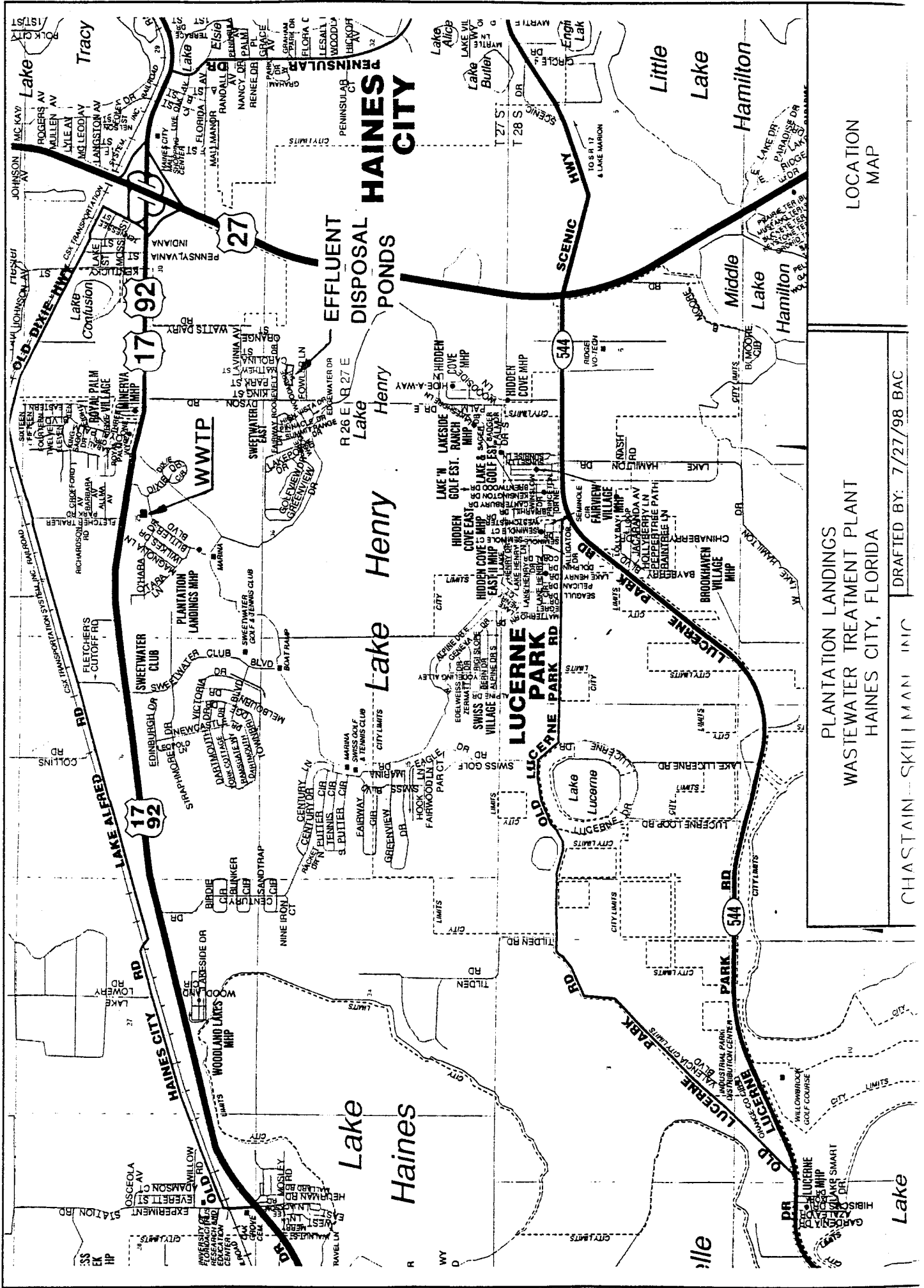

PLANTATION LANDINGS  
WASTEWATER TREATMENT PLANT  
HAINES CITY, FLORIDA

CHASTAIN SKI I MAN INC DRAFTED BY: 7/27/98 BAC

LOCATION  
MAP

PLANTATION LANDINGS  
Wastewater Treatment Plant  
Application for Renewal of Operating Permit

**Wastewater Permit Application  
Process Flow Diagram**

**Attachment G**

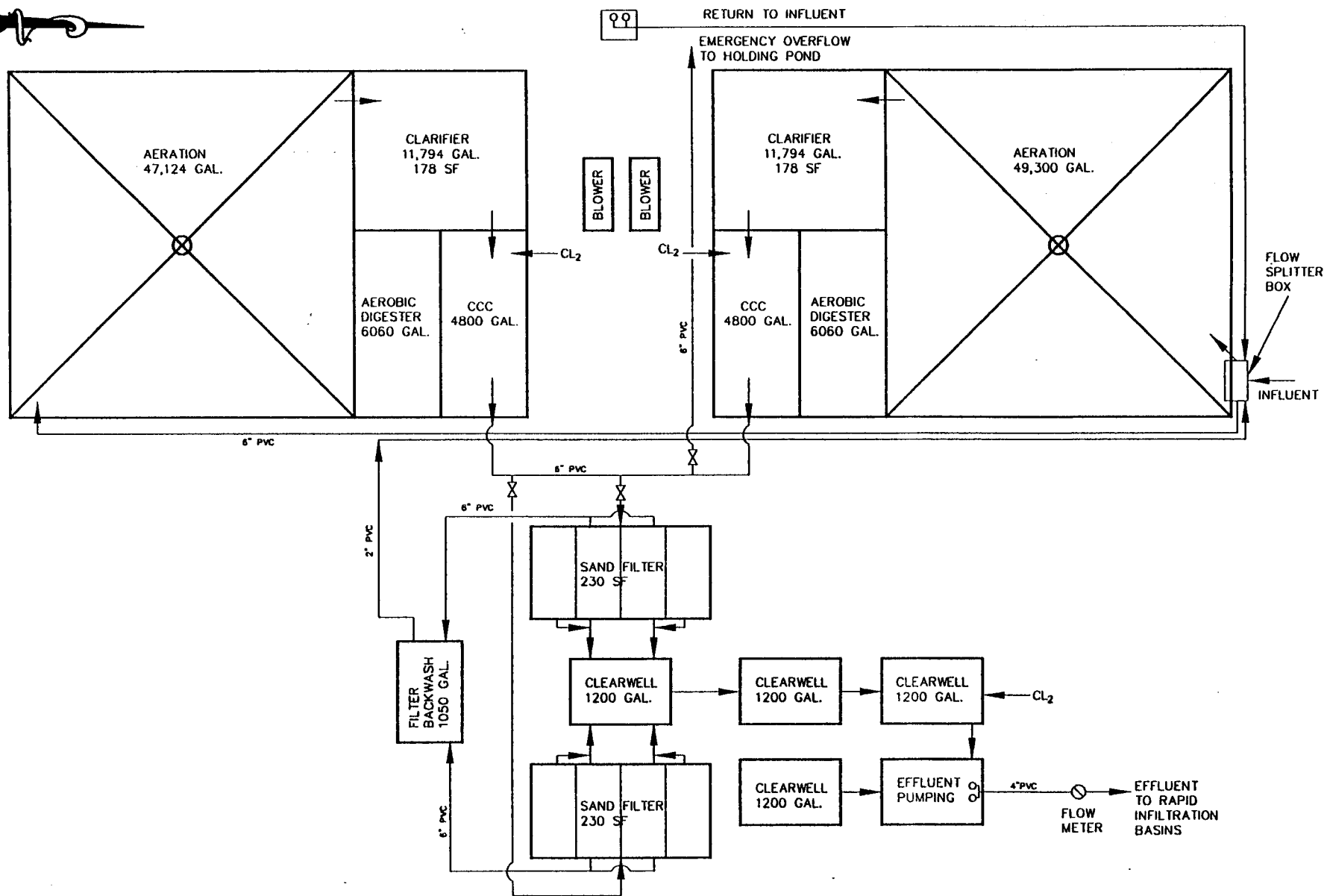

PLANTATION LANDINGS  
 WASTEWATER TREATMENT PLANT  
 HAINES CITY, FLORIDA

PROCESS FLOW  
 DIAGRAM

CHASTAIN-SKILLMAN, INC. DRAFTED BY: 7/27/98 BAC  
 REVIEWED/APPROVED BY: L.S.J.

C.S.I. PROJ. NO. 6601 02 FIG. NO. 2

PLANTATION LANDINGS  
Wastewater Treatment Plant  
Application for Renewal of Operating Permit

**Wastewater Permit Application  
RPZ Inspection Report**

**Attachment H**

# Backflo Testing Co., Inc.

Safe Drinking Water for America

1901 Bearview Drive, Apopka, FL 32703 • (407) 532-0400 • FAX (407) 532-0402 • Cell. (407) 256-6236

## BACKFLOW ASSEMBLY FIELD TEST REPORT

NAME OF CUSTOMER PLANTATION LANDINGS

STREET ADDRESS \_\_\_\_\_

LOCATION OF DEVICE SEWAGE PLANT - ROAD SIDE

TYPE OF DEVICE RPZ MANUFACTURER HERSHEY MODEL NO. FRP # SERIAL NO. 136036

SIZE OF DEVICE 1" METER SER. NO. \_\_\_\_\_ UTIL. ACCT. NO. \_\_\_\_\_

TYPE OF SERVICE (CHECK ONE): POTABLE \_\_\_\_\_ IRRIGATION \_\_\_\_\_ FIRE LINE \_\_\_\_\_

PRESSURE DROP ACROSS FIRST CHECK VALVE 7.8 PSI

	CHECK VALVE #1	DIFFERENTIAL PRESSURE RELIEF VALVE	CHECK VALVE #2	PRESSURE VACUUM BREAKER
INITIAL TEST	1. LEAKED <input type="checkbox"/> 2. CLOSED TIGHT <input checked="" type="checkbox"/>	OPENED AT <u>2.8</u> LBS DID NOT OPEN <input type="checkbox"/>	1. LEAKED <input type="checkbox"/> 2. CLOSED TIGHT <input checked="" type="checkbox"/> <u>1.4</u>	AIR INLET OPENED AT _____ PSI DID NOT OPEN <input type="checkbox"/>
R E P A I R S	CLEANED <input type="checkbox"/> REPLACED: RUBBER PARTS KIT <input type="checkbox"/>	CLEANED <input type="checkbox"/> REPLACED: RUBBER PARTS KIT <input type="checkbox"/>	CLEANED <input type="checkbox"/> REPLACED: RUBBER PARTS KIT <input type="checkbox"/>	CHECK VALVE _____ PSI LEAKED <input type="checkbox"/>
	C V ASSEMBLY <input type="checkbox"/> OR	C V ASSEMBLY <input type="checkbox"/> OR	C V ASSEMBLY <input type="checkbox"/> OR	CLEANED <input type="checkbox"/> REPLACED:
	DISC <input type="checkbox"/> O-RINGS <input type="checkbox"/> SEAT <input type="checkbox"/>	DISC <input type="checkbox"/> O-RINGS <input type="checkbox"/> SEAT <input type="checkbox"/>	DISC <input type="checkbox"/> O-RINGS <input type="checkbox"/> SEAT <input type="checkbox"/>	C V ASSEMBLY <input type="checkbox"/> DISC AIR INLET <input type="checkbox"/> DISC C V <input type="checkbox"/> SPRING <input type="checkbox"/> RETAINER <input type="checkbox"/> GUIDE <input type="checkbox"/> O-RING <input type="checkbox"/> OTHER <input type="checkbox"/>
	SPRING <input type="checkbox"/> STEM/GUIDE <input type="checkbox"/> RETAINER <input type="checkbox"/> LOCK NUTS <input type="checkbox"/> OTHER <input type="checkbox"/>	SPRING <input type="checkbox"/> STEM/GUIDE <input type="checkbox"/> RETAINER <input type="checkbox"/> LOCK NUTS <input type="checkbox"/> OTHER <input type="checkbox"/>	SPRING <input type="checkbox"/> STEM/GUIDE <input type="checkbox"/> RETAINER <input type="checkbox"/> LOCK NUTS <input type="checkbox"/> OTHER <input type="checkbox"/>	
FINAL TEST	CLOSED TIGHT <input type="checkbox"/>	OPEN AT _____ LBS. REDUCED PRESSURE	CLOSED TIGHT <input type="checkbox"/>	SATISFACTORY <input type="checkbox"/>

COMMENTS \_\_\_\_\_

I HEREBY CERTIFY THAT THIS DATA IS ACCURATE AND REFLECTS THE PROPER OPERATION AND MAINTENANCE OF THE UNIT

[Signature]  
SIGNATURE OF TECHNICIAN

(407) 532-0400  
PHONE NUMBER OF TECHNICIAN

INITIAL TEST BY [Signature] CERTIFIED TECH NO. A07-97-3786 DATE 2-12-98

REPAIRED BY \_\_\_\_\_ REPAIR COMPANY BACKFLO TESTING CO., INC. DATE \_\_\_\_\_

FINAL TEST BY \_\_\_\_\_ CERTIFIED TECH NO. \_\_\_\_\_ DATE \_\_\_\_\_

OWNER'S AUTHORIZED REP SIGNATURE \_\_\_\_\_ TITLE \_\_\_\_\_ DATE \_\_\_\_\_

PLANTATION LANDINGS  
Wastewater Treatment Plant  
Application for Renewal of Operating Permit

**Wastewater Permit Application  
Flow Meter Calibration**

**Attachment I**



CERTIFICATE OF CALIBRATION

MEMBER:  
AMERICAN WATER WORKS ASSOC.  
INSTRUMENT SOCIETY OF AMERICA  
MEASUREMENTS & DATA SOCIETY  
U.S.N.I.  
RURAL WATER ASSOC.

**A.W.K. INDUSTRIES, INC.**

P.O. BOX 607267 • ORLANDO, FLORIDA 32860 • PHONE (407) 293-1329 • FAX (407) 294-6244

THIS WILL CERTIFY THAT THE HERIN LISTED INSTRUMENTS WERE CALIBRATED IN ACCORDANCE WITH NORMALLY ACCEPTED PRACTICES AND MANUFACTURERS RECOMMENDED PROCEDURES.

REFERENCES: DEPT. OF AGRICULTURE, CIRCULAR 843  
ISCO OPEN CHANNEL FLOW HANDBOOK FOURTH EDITION  
FLUID MECHANICS, DODGE & THOMPSON

DATE CALIBRATED 3/31/98

INSTRUMENT I.D. McCrometer MO304 S/N 95-5735-4

OWNER/ LOCATION Century Realty/ Plantation

COMMENTS/ACTIONS Checked with Doppler Compu-Flo/Tesco C4.  
Checked within 2%.

CALIBRATED BY

*Alvin W. Klutts*  
Alvin W. Klutts ISA/CCST, 111 11847

PLANTATION LANDINGS  
Wastewater Treatment Plant  
Application for Renewal of Operating Permit

**Wastewater Permit Application  
Agricultural Use Plan  
Annual Report**

**Attachment J**



# Florida Department of Environmental Regulation

Twin Towers Office Bldg. • 2600 Blair Stone Road • Tallahassee, Florida 32399-2400

DER Form #	17-640.900(1)
Form Title	Agricultural Use Plan
Effective Date	March 1, 1991
DER Application No.	(Filed in by DER)

## Agricultural Use Plan

### Part I - Instructions

- (1) This Agricultural Use Plan form should be submitted if residuals will be applied at rates appropriate for the nitrogen needs of the crops. If residuals will be applied at rates higher than the nitrogen needs of the crops, a Dedicated Disposal Site Plan must be submitted in lieu of this form.
- (2) All applicable items must be completed in full to avoid delay in processing. If attached sheets (or other technical documentation) are used in place of the blank space provided, refer to them in that space.
  - ) All information is to be typed or printed in ink.
- (4) The Agricultural Use Plan form must be completed and submitted to the Department District Office with the application for a construction permit or operation permit for any domestic wastewater treatment facility which will dispose of its residuals by application to the land. A form must be completed for each site where the treatment facility's residuals will be land applied. If application sites are modified or new application sites are used, a modified or new Agricultural Use Plan must be submitted by the date specified for annual updates in the operation permit.
- (5) Residuals which are AA quality in accordance with Rule 17-640.850, Florida Administrative Code (F.A.C.), are exempt from this requirement and may be disposed of in accordance with the provisions of Rule 17-640.850, F.A.C.

### Part II - Residuals Generator Information

(1) Residuals Generator:

Facility Name PLANTATION LANDINGS

The facility's DER identification number (also known as the GMS identification number) 53 P 02226

Address U.S. HIGHWAY 17-92 E. HAINES CITY

Contact Person and title RAYMOND MOATS, PRESIDENT of General Partner

Phone Number (941) 647-1581

(2) Estimated/actual quantity of residuals generated:

(a) New facilities: Proposed quantity on dry weight basis \_\_\_\_\_ tons/day or \_\_\_\_\_ lbs/day

Solids concentration \_\_\_\_\_ % Estimated quantity \_\_\_\_\_ gallons/day or \_\_\_\_\_ lbs/day

(b) Existing facilities: Actual quantity 250.68 gallons/day or \_\_\_\_\_ wet tons/day

(3) Residuals Characteristics (Annual Average):

Nitrogen concentration - 0.8 % (dry weight)

Heavy metals: Cadmium 0.9 mg/kg (dry weight) Copper 110 mg/kg (dry weight) Lead 3.3 mg/kg (dry weight)

Nickel 4.7 mg/kg (dry weight) Zinc 290 mg/kg (dry weight)

Last analysis date: 3-11-98 (Attach all analyses taken within the last year.)

NOTE: For new facilities the residuals characteristics may be estimated by the design engineer, but a complete analysis shall be submitted to the Department prior to any land application.

(4) Stabilization Class Provided: A \_\_\_\_\_ B X C \_\_\_\_\_

Process description: AEROBIC DIGESTION / LIME STABILIZATION

(8) The maximum allowable annual application rate is determined based on the nitrogen demand of the site vegetation.

a. Crop(s) or vegetation name: BAHIA GRASS

b. Nitrogen demand: 160 lbs/acre/year  
 determined by:

- Nitrogen loading table in Rule 17-640.700(3)(d)1., F.A.C.
- Recommendations of Soil Conservation Service or Institute of Food and Agricultural Sciences (attach documentation)
- Other; identify (attach documentation) \_\_\_\_\_

c. Adjusted nitrogen application rate: Allowances for volatilization losses and mineralization rates may be made based on one of the following procedures (check method used):

- Rule 17-640.700(3)(d)2.a., F.A.C. - For surface-applied residuals, the allowable nitrogen loading rate in (b) above may be doubled. For residuals incorporated into the soil, the allowable nitrogen loading rate in (b) above may be increased by 33%.
- Rule 17-640.700(3)(d)2.b., F.A.C. - The analysis procedure in Chapter 6, Environmental Protection Agency, *Process Design Manual for Land Application of Municipal Sludge*, may be used to justify higher application rates.
- Rule 17-640.700(3)(d)2.c., F.A.C. - An equivalent procedure may be used if approved by the Department.

Maximum allowable nitrogen application rate: 320 lbs/acre/year

Show calculation here or attach additional sheets if necessary.

$$160 \text{ lb/ac/yr} \times 2 = 320 \text{ lbs/ac./yr.}$$

(9) List the names of other treatment facilities that will dispose of residuals on this site: SWISS GOLF, SWISS VILLAGE

### Part IV - Certifications

The residuals generator certifies that he is familiar with and shall comply with the applicable requirements of Chapter 17-640, F.A.C.; shall allow his residuals to be applied only on a site for which an Agricultural Use Plan has been approved with the operation or construction permit, or submitted to the Department with the annual update; and that the residuals to be land applied shall meet the chemical criteria for "residuals suitable for land application" in Rule 17-640.700(2), F.A.C., and shall be stabilized to Class D standards as identified in this plan. He also certifies that he shall maintain a record of the total quantity of residuals land applied on this site and will file with the Department an annual summary of the total quantity of residuals, heavy metals, and nitrogen land applied on this site, and that the residuals hauler and application site owner or manager have been made aware of the provisions of the rule.

*Ronald M. [Signature]*  
 Residuals Generator

5/18/98  
 Date

Wastewater Treatment Plant  
 PLANTATION LANDINGS  
 Sludge Calculations

A. Sludge Production JANUARY - DECEMBER 1997

Annual Sludge Production: 274,000 gal/yr

Dry Weight Annual sludge Production:  
 $274,000 \text{ gal/yr} \times 0.005 \text{ sd} \times 8.34 \text{ lb/gal} = 11,425.80 \text{ dry lb/yr}$

Average Daily  
 Production =  $11,425.8 \text{ lb/yr} / 365 \text{ day/yr}$   
 = 31.30 lb/day

B. Nitrogen Production 0.9%

Total Nitrogen  $11,425.8 \text{ lb/yr} \times 0.009 = 102.83 \text{ lb-N/yr}$

C. Land Area Requirement - Nitrogen Limit

Max. Allowable Nitrogen Application Rate  
 $320 \text{ lb/ac/yr}$  [2015 17-640.700(3)(d)2.2] BAHIA GRASS  
 $102.83 \text{ lb/yr} / 320 \text{ lb/ac/yr} = 0.32 \text{ acres}$  [0.5 acres allotted]

D. Land Area Requirement - Metals Limit (lb./Ac.)

1) Allowable Cumulative Application (lb./Ac.)

Cadmium	44
Copper	125
Lead	500
Nickel	125
Zinc	250
Arsenic	
Selenium	
Mercury	
Molybdenum	
Chromium	

2) Sludge Metals Concentrations

	mg/kg		mg/kg
Cadmium	0.9	Arsenic	4.7
Copper	110	Selenium	10.2

Lead 3.3  
 Nickel 4.7  
 Zinc 29.0

Mercury 27  
 Molybdenum 4.7  
 Chromium 4.2

3) Sludge Loading (Metals)

Available Application Area = 0.5 acres

$$0.9 \text{ mg/kg} \times \frac{1}{1,000,000} \times 31.3 \text{ lb/day} \times 365 \text{ day/yr} \times \frac{1}{0.5 \text{ ac}}$$

Cadmium = 0.02

Life	Loading	Site Life	Loading	Site
Cadmium	0.02	220	Arsenic	
Copper	2.51	49.8	Selenium	
Lead	0.08	6,250	Mercury	
Nickel	0.11	1,136.36	Molybdenum	
Zinc	6.63	37.71	Chromium	

4) Cumulative Sludge Loading

Site Life 37.71 yrs.

Acreage 0.5 ac.

Sludge Volume 31.3 lb/day

$$31.3 \text{ lb/day} \times 365 \text{ day/yr} \times \frac{1}{0.5 \text{ ac}} \times 37.71 \text{ yrs} \times \frac{1 \text{ ton}}{2,000 \text{ lb}}$$

= 430.87 TONS/acre

HRS# E84088  
 HRS# 84172  
 DEP CQAP# 860208

**Pembroke Laboratories, Inc.**  
 528 Gooch Road  
 Ft. Meade, Florida 33841

(941) 285-8145  
 (941) 285-7030 FAX

Century Realty Funds  
 P. O. Box 5252  
 Lakeland, FL 33807

ATTN: Jerry Coryell

Date Sampled: 02-11-98  
 Time Sampled: 12:40  
 Date Received: 02-11-98  
 Time Received: 08:37  
 Date Reported: 03-11-98

Lab Number	MC-12420	Analysis	Analysis	
Sample I.D.	Plantation	Method	Date	Analyst
	Landings			

CHAPTER 62-640 SLUDGE/EPA 503 Metals

pH		6.3	EPA 9045	02/18/98	JL
Total Solids	%	0.5	EPA 160.3	02/13/98	JL

Dry Basis:

Total Nitrogen	% N	0.9	EPA 351.2	03/09/98	DS
Total Phosphorous	% P	1.5	EPA 365.2	02/17/98	AF
Total Potassium	% K	0.9	EPA 6010	02/20/98	WC
Cadmium	mg/kg Cd	0.9	EPA 6010	02/20/98	WC
Copper	mg/kg Cu	110.	EPA 6010	02/24/98	WC
Lead	mg/kg Pb	3.3	EPA 6010	02/20/98	WC
Nickel	mg/kg Ni	4.7	EPA 6010	02/24/98	WC
Zinc	mg/kg Zn	290.	EPA 6010	02/24/98	WC
Arsenic	mg/kg As	4.7	U EPA 6010	02/18/98	WC
Selenium	mg/kg Se	10.2	EPA 6010	02/18/98	WC
Mercury	mg/kg Hg	27.	EPA 7471	02/24/98	WC
Molybdenum	mg/kg Mo	4.7	U EPA 6010	02/20/98	WC
Chromium	mg/kg Cr	4.2	EPA 6010	02/20/98	WC

# Standard Domestic Wastewater Residuals Record Keeping Form

Residuals Application Site Location O'Kelly Ranch  
131 1/2 Street West Wahneta Fl 33870

Site Number \_\_\_\_\_

Site Owner/Manager Jeff Mann Septic Tank Service Phone Number 399-5492

Date of analysis 2-26-97 Plantation Landing

Residuals Concentration of (mg/kg): Nitrogen 6.8 Copper 240 Nickel 32 Cadmium 6  
Lead 17 Zinc 450 0.5 % Solids

1st Qtr.

Date Residuals Applied	Amount of Residuals Applied (gal or lb)	Specific Location and Acreage of the Area of Site Where Residuals Were Applied	Method of Incorporation of Residuals (if any)	Water Table Level (ft)
1/6/97	18,000 gal.	Zone 1		Below 24"
1/15/97	16,000 gal.	Zone 1		Below 24"
1/29/97	16,000 gal.	Zone 1		Below 24"
2/6/97	16,000 gal.	Zone 1		Below 24"
2/19/97	16,000 gal.	Zone 2		Below 24"
3/11/97	16,000 gal.	Zone 2		Below 24"
3/18/97	16,000 gal.	Zone 2		Below 24"
3/25/97	16,000 gal.	Zone 3		Below 24"



# Standard Domestic Wastewater Residuals Record Keeping Form

Residuals Application Site Location O'Kelly Ranch  
131 1 Street West Webster FL 33890

Site Number \_\_\_\_\_

Site Owner/Manager Callman Septic Tank Service Phone Number 299-5492

Date of analysis 2-26-91 Plantation Landing

Residuals Concentration of (mg/kg). Nitrogen 6.8 .. Copper 240. Nickel 32. Cadmium 6.  
 Lead 17. Zinc 450. 0.5 % Solids

2nd Qtr.

Date Residuals Applied	Amount of Residuals Applied (gal or lb)	Specific Location and Acreage of the Area of Site Where Residuals Were Applied	Method of Incorporation of Residuals (if any)	Water Table Level (ft)
4/1/97	16,000 gal.	Zone 3		Below 24"
6/3/97	16,000 gal.	Zone 4		Below 24"
6/17/97	18,000 gal.	Zone 4		Below 24"
1/1				
1/1				
1/1				
1/1				
1/1				
1/1				
1/1				

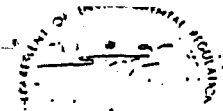

# Standard Domestic Wastewater Residuals Record Keeping Form

Residuals Application Site Location O'Kelly Ranch  
131 1/2 Saddle West Walnut FC 33880

Site Number \_\_\_\_\_

Site Owner/Manager Jeff Mann Septic Tank Service Phone Number 999-5492

Date of analysis 2-26-97 Plantation

Residuals Concentration of (mg/kg): Nitrogen 6.8 .. Copper 240 .. Nickel 32 .. Cadmium 6  
Lead 17 .. Zinc 450 .. 0.5 % Solids

3rd Qtr.

Date Residuals Applied	Amount of Residuals Applied (gal or lb)	Specific Location and Acreage of the Area of Site Where Residuals Were Applied	Method of Incorporation of Residuals (if any)	Water Table Level (ft)
7/8/97	12,000 gal.	Zone 1		Below 24"
8/13/97	16,000 gal.	Zone 1		Below 24"

# Standard Domestic Wastewater Residuals Record Keeping Form

Residuals Application Site Location O'Kelly Ranch  
131 I St west Waldo FL 32890

Site Number \_\_\_\_\_

Site Owner/Manager 16 Man Septic Tank Service Phone Number 299-5492

Date of analysis 2-26-97 Plantation Landfill

Residuals Concentration of (mg/kg): Nitrogen 6.8 Copper 240. Nickel 32. Cadmium 6.  
Lead 17. Zinc 450. 0.5 % Solids

4th Qtr.

Date Residuals Applied	Amount of Residuals Applied (gal or lb)	Specific Location and Acreage of the Area of Site Where Residuals Were Applied	Method of Incorporation of Residuals (if any)	Water Table Level (ft)
11/4/97	12,000 gal	Zone 3		Below 24"
11/18/97	10,000 gal	Zone 3		Below 24"
12/2/97	16,000 gal	Zone 4		Below 24"
12/9/97	16,000 gal	Zone 4		Below 24"
12/16/97	12,000 gal	Zone 4		Below 24"

TWP. 29S.-RNG. 28E.

NORTHWEST QUARTER  
POLK COUNTY, FLORIDA

1 MILE 1/2  
600 1200 1800 2400 (FEET)

SEE PAGE 114

Lot 2757-5  
L-99 810 4/11/00 0 SEC

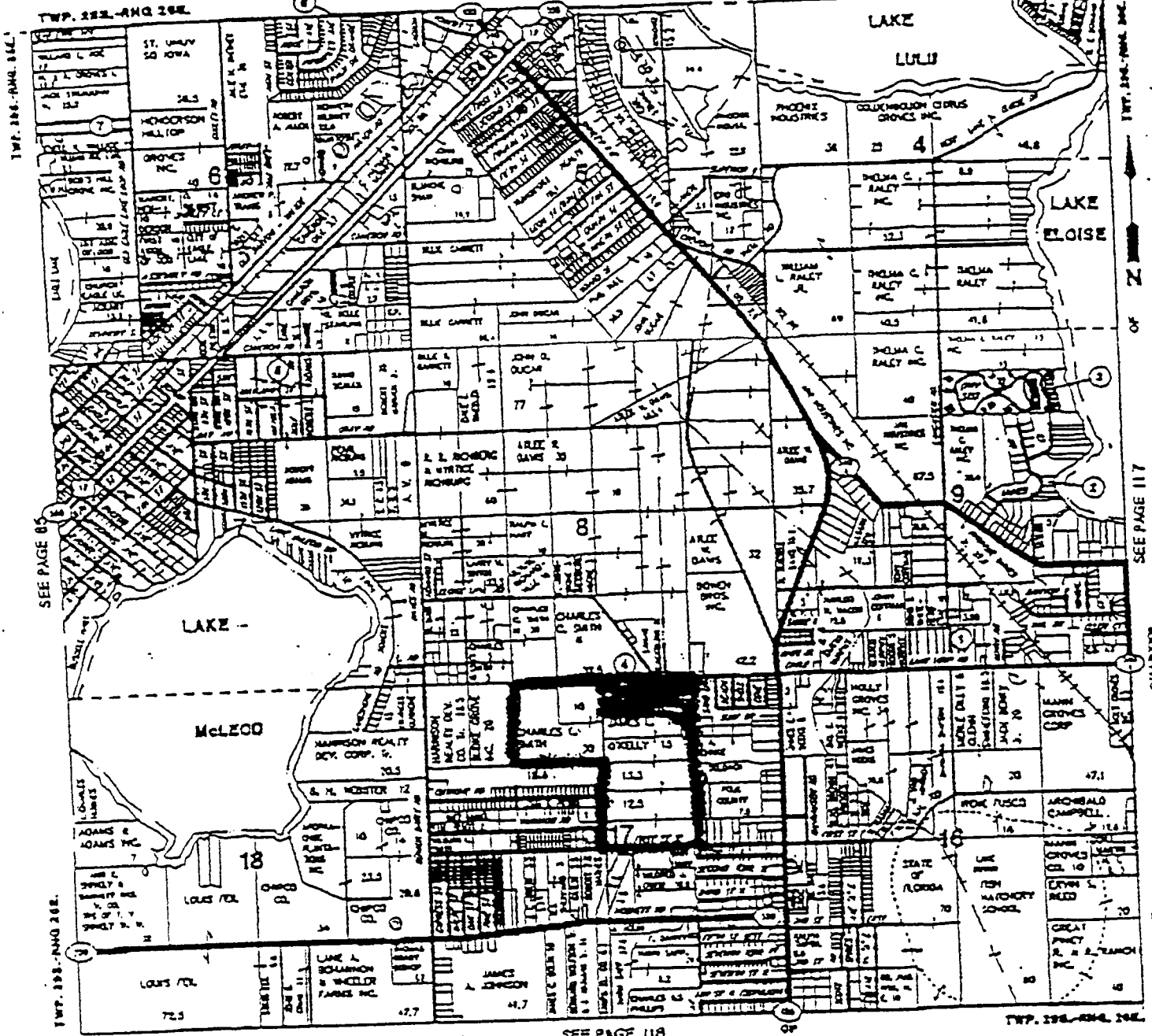

D.E.P.

JUN 19 1996

SOUTHWEST DISTRICT BARTOW

### GENERAL LEGEND

--- HIGHWAY	--- PROPERTY BOUNDARY
--- LOW POINT OF CUT STREET	--- DRAINAGE BOUNDARY
--- WIDTH OF IMPROVED ROAD	--- CITY AND BOUNDARY
--- RAILROAD	--- CITY OF WEAVER
--- TRAIL	--- POWER LINE
--- STATE HIGHWAY	--- SUBDIVISION LINE
--- CLIFF ROAD	--- QUARRY SECTION OF QUARRY BOUNDARY
--- LAKE	--- PRIVATE LANE
--- SITE OF TRAIL OR DITCH	---

JAMES L. (DON) O'KELLEY

P.O. BOX 802

EAGLE LAKE, FLA. 33839

TELEPHONE (813) 293-6385

~~Payable the 15th of following month~~

~~CHECK NO.~~ \_\_\_\_\_ DATE 6-18 19 96

~~SUBJECT TO~~ \_\_\_\_\_

ADDRESS \_\_\_\_\_

*This note gives Jeff Mann  
permission to dump sludge  
on my pasture.*

*James L. O'Kelley*

D.E.P.

JUN 19 1996

SOUTHWEST DISTRICT BARTOW

All Claims and Returned Goods MUST Be Accompanied By This Bill

SIGNATURE \_\_\_\_\_



Department of Environmental Protection

Monthly Operation Report for Public Water Systems that Use Ground Water and for Consecutive Public Water Systems that Treat Their Water

INSTRUCTIONS: See Page 4.

GENERAL WATER SYSTEM AND WATER TREATMENT PLANT INFORMATION FOR THE MONTH/YEAR OF OCTOBER 1997

Water System Information

System Name: Plantation Landings PWS Identification No.: 6531000
System Owner: CRF, Inc Telephone No.: 647-1581
Address: P.O. Box 5252
City: Lakeland State: FL Zip Code: 33807
System Type: [X] community; [ ] non-transient non-community; [ ] non-community; [ ] consecutive
No. of Service Connections at End of Month: 410 Total Population Served at End of Month: 803

Water Treatment Plant Information

Treatment Plant Name: Plantation Landings Telephone No.: 647-1581
Address: Hwy 17/92 West
City: Haines City, FL State: FL Zip Code:
Permitted Maximum Day Capacity of Plant: gpd
Plant Category and Class per Rule 62-699.310(4), F.A.C.:
Lead/Chief Plant Operator:

Table with 4 columns: Name, Certificate Number, Class (A, B, C, or D), Day(s)/Shift(s) Worked. Row 1: Robert A. Byrd, 007483, C, 14

Other Certified Plant Operators (attach additional sheets if necessary):

Table with 4 columns: Name, Certificate Number, Class (A, B, C, or D), Day(s)/Shift(s) Worked. Multiple empty rows.

STATEMENT BY LEAD/CHIEF WATER TREATMENT PLANT OPERATOR FOR THE MONTH/YEAR OF OCTOBER 1997

I, the undersigned lead/chief operator of the water treatment plant listed in Part I of this form, certify that, to the best of my knowledge and belief, the information provided in this report is true and accurate. Also, I certify that the following additional operations records for the plant listed in Part I of this form were prepared each day that a certified operator staffed or visited the plant during the month indicated above:

- records of amounts of chemicals used and chemical feed rates; and
if applicable, appropriate treatment process performance records.

Furthermore, I agree to retain these additional operations records at the plant site for at least five years and to make them available for review upon request.

Signature and Date: Robert Byrd 11/5/97

Name and Certificate Number (please type or print): Robert A Byrd, 07483

Monthly Operation Report for Public Water Systems that Use Ground Water and for Consecutive Public Water Systems that Treat Their Water  
 System PWS Identification Number: 6531000  
 Treatment Plant Name: Plantation Landings

**SUMMARY OF DAILY WATER TREATMENT DATA FOR THE MONTH YEAR OF OCTOBER 1997**

- Type of Residual Disinfectant Maintained in Distribution System Served by Plant:  free chlorine;  combined chlorine (chloramine);  chlorine dioxide
- Summary of Daily Water Treatment Data for Month:

Day of the Month	Hours Plant in Operation	Quantity of Finished Water Produced by Plant (gallons)	Lowest Residual Disinfectant Concentration at Entry to Distribution System (mg/L)	Residual Disinfectant in Distribution System			Reported Emergency or Abnormal Operating Conditions
				Lowest Residual Disinfectant Concentration at Remote Point (mg/L)	Number of Instances Where Residual Disinfectant Measurements Taken at Total Coliform Sampling Points	Lowest Residual Disinfectant Concentration at Total Coliform Sampling Points (mg/L)	
1		159,000	3.0	1.5			
2							
3		148,000	3.0	1.5			
4							
5							
6		260,000	3.0	1.5			
7							
8		161,000	3.0	1.5			
9							
10		127,000	3.0	1.5			
11							
12							
13		231,000	3.0	1.5			
14							
15		181,000	3.0	1.5			
16							
17		147,000	3.0	1.5			
18							
19							
20		255,000	3.0	1.5			
21							
22		271,000	3.0	1.5	2	1.5	
23							
24		91,000	3.0	1.5			
25							
26							
27		295,000	3.0	1.5			
28							
29		143,000	3.0	1.5			
30							
31		138,000	3.0	1.5			
Total		2,607,000			2		
Avg.		84,000					
Max.		136,000					



Department of Environmental Protection

Monthly Operation Report for Public Water Systems that Use Ground Water and for Consecutive Public Water Systems that Treat Their Water

INSTRUCTIONS: See Page 4.

GENERAL WATER SYSTEM AND WATER TREATMENT PLANT INFORMATION FOR THE MONTH/YEAR OF NOVEMBER 1997

Water System Information

System Name: Plantation Landings PWS Identification No.: 6531000
System Owner Name: CRF, Inc Telephone No.: (941) 647-1581
Address: P.O. Box 5252
City: Lakeland State: FL Zip Code: 33867-5252
System Type: [X] community; [ ] non-transient non-community; [ ] non-community; [ ] consecutive
No. of Service Connections at End of Month: 410 Total Population Served at End of Month: 871

Water Treatment Plant Information

Treatment Plant Name: Plantation Landings Telephone No.: (941) 647-1581
Address: 1.5 MILES West Hwy 600
City: Haines City State: FL Zip Code: 33844
Permitted Maximum Day Capacity of Plant: 132,800 gpd
Plant Category and Class per Rule 62-699.310(4), F.A.C.:
Lead/Chief Plant Operator:

Table with 4 columns: Name, Certificate Number, Class (A, B, C, or D), Day(s)/Shift(s) Worked. Row 1: Robert A. Byrd, 007483, C, 12

Other Certified Plant Operators (attach additional sheets if necessary):

Table with 4 columns: Name, Certificate Number, Class (A, B, C, or D), Day(s)/Shift(s) Worked. Multiple empty rows.

II. STATEMENT BY LEAD/CHIEF WATER TREATMENT PLANT OPERATOR FOR THE MONTH/YEAR OF NOVEMBER 1997

I, the undersigned lead/chief operator of the water treatment plant listed in Part I of this form, certify that, to the best of my knowledge and belief, the information provided in this report is true and accurate. Also, I certify that the following additional operations records for the plant listed in Part I of this form were prepared each day that a certified operator staffed or visited the plant during the month indicated above:

- records of amounts of chemicals used and chemical feed rates; and
if applicable, appropriate treatment process performance records.

Furthermore, I agree to retain these additional operations records at the plant site for at least five years and to make them available for review upon request.

Signature and Date: Robert A. Byrd, 12/2/97

Name and Certificate Number (please type or print): Robert A. Byrd, DW007483C



Monthly Operation Report for Public Water Systems that Use Ground Water and for Consecutive Public Water Systems that Treat Their Water  
 System PWS Identification Number: 6531000  
 Treatment Plant Name: Plantation Landings

**SUMMARY OF DAILY WATER TREATMENT DATA FOR THE MONTH YEAR OF NOVEMBER 1997**

Type of Residual Disinfectant Maintained in Distribution System Served by Plant:  free chlorine;  
 combined chlorine (chloramine);  chlorine dioxide  
 Summary of Daily Water Treatment Data for Month:

Day of the Month	Hours Plant in Operation	Quantity of Finished Water Produced by Plant (gallons)	Lowest Residual Disinfectant Concentration at Entry to Distribution System (mg/L)	Residual Disinfectant in Distribution System			Reported Emergency or Abnormal Operating Conditions
				Lowest Residual Disinfectant Concentration at Remote Point (mg/L)	Number of Instances Where Residual Disinfectant Measurements Taken at Total Coliform Sampling Points	Lowest Residual Disinfectant Concentration at Total Coliform Sampling Points (mg/L)	
1							
2							
3		177,000	3.0	1.5			
4							
5		153,000	3.0	1.5			
6							
7		134,000	3.0	1.5			
8							
9							
10		214,000	3.0	1.5			
11							
12		174,000	3.0	1.5			
13							
14		108,000	3.0	1.5			
15							
16							
17		197,000	3.0	1.5			
18							
19		149,000	3.0	1.5			
20							
21		145,000	3.0	1.5			
22							
23							
24		260,000	3.0	1.5	2	1.5	
25							
26		189,000	3.0	1.5			
27							
28		132,000	3.0	1.5			
29							
30							
31							
Total		2,032,000			2		
Avg.		67,733					
Max.		94,500					



Department of Environmental Protection

Monthly Operation Report for Public Water Systems that Use Ground Water and for Consecutive Public Water Systems that Treat Their Water

INSTRUCTIONS: See Page 4.

GENERAL WATER SYSTEM AND WATER TREATMENT PLANT INFORMATION FOR THE MONTH/YEAR OF DECEMBER 1997

Water System Information

System Name: Plantation Landings PWS Identification No.: 6531000
System Owner: CRF, Inc Telephone No.: (941) 647-1581
Name: CRF, Inc
Address: P.O. Box 5252
City: Lakeland State: FL Zip Code: 33807-5252
System Type: [X] community; [ ] non-transient non-community; [ ] non-community; [ ] consecutive
No. of Service Connections at End of Month: 410 Total Population Served at End of Month: 871

Water Treatment Plant Information

Treatment Plant Name: Plantation Landings Telephone No.: (941) 647-1581
Address: 1.5 Miles West Hwy 600
City: Haines City State: FL Zip Code: 33844
Permitted Maximum Day Capacity of Plant: 132,800 gpd
Plant Category and Class per Rule 62-399.310(4), F.A.C.: SC
Lead/Chief Plant Operator:

Table with 4 columns: Name, Certificate Number, Class (A, B, C, or D), Day(s)/Shift(s) Worked. Row 1: Robert A. Byrd, 007483, C, 14

Other Certified Plant Operators (attach additional sheets if necessary):

Table with 4 columns: Name, Certificate Number, Class (A, B, C, or D), Day(s)/Shift(s) Worked. Multiple empty rows for additional operators.

STATEMENT BY LEAD/CHIEF WATER TREATMENT PLANT OPERATOR FOR THE MONTH/YEAR OF DECEMBER 1997

I, the undersigned lead/chief operator of the water treatment plant listed in Part I of this form, certify that, to the best of my knowledge and belief, the information provided in this report is true and accurate. Also, I certify that the following additional operations records for the plant listed in Part I of this form were prepared each day that a certified operator staffed or visited the plant during the month indicated above:

- records of amounts of chemicals used and chemical feed rates; and
if applicable, appropriate treatment process performance records.

Furthermore, I agree to retain these additional operations records at the plant site for at least five years and to make them available for review upon request.

Signature and Date: Robert A. Byrd, 01/07/98

Name and Certificate Number (please type or print): Robert A. Byrd, DW007483C

Monthly Operation Report for Public Water Systems that Use Ground Water and for Consecutive Public Water

Systems that Treat Their Water

System PWS Identification Number: 6531000

Treatment Plant Name: Plantation Landings

**III. SUMMARY OF DAILY WATER TREATMENT DATA FOR THE MONTH/YEAR OF December 1997**

- Type of Residual Disinfectant Maintained in Distribution System Served by Plant:  free chlorine;  combined chlorine (chloramine);  chlorine dioxide
- Summary of Daily Water Treatment Data for Month:

Day of the Month	Hours Plant in Operation	Quantity of Finished Water Produced by Plant (gallons)	Lowest Residual Disinfectant Concentration at Entry to Distribution System (mg/L)	Residual Disinfectant in Distribution System			Reported Emergency or Abnormal Operating Conditions
				Lowest Residual Disinfectant Concentration at Remote Point (mg/L)	Number of Instances Where Residual Disinfectant Measurements Taken at Total Coliform Sampling Points	Lowest Residual Disinfectant Concentration at Total Coliform Sampling Points (mg/L)	
1		216,000	3.0	1.5			
2							
3		140,000	3.0	1.5			
4							
5		135,000	3.0	1.5			
6							
7							
8		204,000	3.0	1.2			
9							
10		177,000	3.0	1.5			
11							
12		85,000	3.0	1.5			
13							
14							
15		179,000	3.0	1.5			
16							
17		101,000	1.0	0.2	2	0.2	
18							
19		94,000	1.2	0.5			
20							
21							
22		178,000	0.8	0.2			
23							
24		110,000	1.0	0.5			
25							
26		106,000	0.8	0.2			
27							
28							
29		182,000	2.0	1.0			
30							
31		124,000	2.0	0.8			
Total		1,971,000			2		
Avg.		63,581					
Max.		216,000					

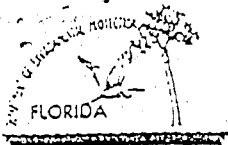

Department of  
Environmental Protection

Monthly Operation Report for Public Water Systems that Use Ground Water and  
for Consecutive Public Water Systems that Treat Their Water

INSTRUCTIONS: See Page 4.

**GENERAL WATER SYSTEM AND WATER TREATMENT PLANT INFORMATION FOR THE MONTH/YEAR OF**  
JANUARY 1998

Water System Information

- System Name: Plantation Landings PWS Identification No.: 6531000
- System Owner Name: CRF, INC Telephone No.: (941)647,1581
- Address: P.O. BOX 5252
- City: LARGO State: FL Zip Code: 33801-5252
- System Type:  community;  non-transient non-community;  non-community;  consecutive
- No. of Service Connections at End of Month: 410 Total Population Served at End of Month: 871

Water Treatment Plant Information

- Treatment Plant Name: Plantation Landings Telephone No.: (941)647-1581
- Address: 1.5 miles west Hwy 600
- City: Haines City State: FL Zip Code: 33844
- Permitted Maximum Day Capacity of Plant: 132,800 gpd
- Plant Category and Class per Rule 62-699.310(4), F.A.C.: 5C
- Lead/Chief Plant Operator:

Name	Certificate Number	Class (A, B, C, or D)	Day(s)/Shift(s) Worked
<u>Robert A. Byrd</u>	<u>007483</u>	<u>C</u>	<u>13</u>

- Other Certified Plant Operators (attach additional sheets if necessary):

Name	Certificate Number	Class (A, B, C, or D)	Day(s)/Shift(s) Worked

**STATEMENT BY LEAD/CHIEF WATER TREATMENT PLANT OPERATOR FOR THE MONTH/YEAR OF**  
JANUARY 1998

I, the undersigned lead/chief operator of the water treatment plant listed in Part I of this form, certify that, to the best of my knowledge and belief, the information provided in this report is true and accurate. Also, I certify that the following additional operations records for the plant listed in Part I of this form were prepared each day that a certified operator staffed or visited the plant during the month indicated above:

- records of amounts of chemicals used and chemical feed rates; and
- if applicable, appropriate treatment process performance records.

Furthermore, I agree to retain these additional operations records at the plant site for at least five years and to make them available for review upon request.

Robert A. Byrd, 2/13/98  
Signature and Date

Robert A. Byrd, DW002483C  
Name and Certificate Number (please type or print)

Monthly Operation Report for Public Water Systems that Use Ground Water and for Consecutive Public Water

Systems that Treat Their Water  
System PWS Identification Number: 6531000

Treatment Plant Name: Purification Lab

**SUMMARY OF DAILY WATER TREATMENT DATA FOR THE MONTH/YEAR OF JANUARY 1998**

Type of Residual Disinfectant Maintained in Distribution System Served by Plant:  free chlorine;

combined chlorine (chloramine);  chlorine dioxide

Summary of Daily Water Treatment Data for Month:

Day of the Month	Hours Plant in Operation	Quantity of Finished Water Produced by Plant (gallons)	Lowest Residual Disinfectant Concentration at Entry to Distribution System (mg/L)	Residual Disinfectant in Distribution System			Reported Emergency or Abnormal Operating Conditions
				Lowest Residual Disinfectant Concentration at Remote Point (mg/L)	Number of Instances Where Residual Disinfectant Measurements Taken at Total Coliform Sampling Points	Lowest Residual Disinfectant Concentration at Total Coliform Sampling Points (mg/L)	
1							
2		112,000	2.5	1.2			
3							
4							
5		175,000	2.2	1.0			
6							
7		157,000	2.5	1.5			
8							
9		110,000	2.2	1.2			
10							
11							
12		198,000	2.5	1.2			
13							
14		121,000	2.4	1.4			
15							
16		121,000	2.5	1.5			
17							
18							
19		172,000	2.8	1.4			
20							
21		142,000	2.5	1.5			
22							
23		120,000	2.4	1.2			
24							
25							
26		184,000	2.5	1.2	2	1.2	
27							
28		100,000	2.4	1.3			
29							
30		127,000	2.2	1.2			
31							
Total		1,839,000			2		
Avg.		59,323					
Max.		78,500					

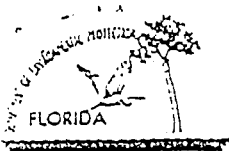

Department of Environmental Protection

Monthly Operation Report for Public Water Systems that Use Ground Water and for Consecutive Public Water Systems that Treat Their Water

INSTRUCTIONS: See Page 4.

GENERAL WATER SYSTEM AND WATER TREATMENT PLANT INFORMATION FOR THE MONTH/YEAR OF FEBRUARY 1998

Water System Information

System Name: Plantation Landings PWS Identification No.: 6531000
System Owner: CRF, Inc. Telephone No.: (941) 647-1581
Name: CRF, Inc. Address: P.O. Box 8252 City: Lakeland State: FL Zip Code: 33807-5252
System Type: [X] community; [ ] non-transient non-community; [ ] non-community; [ ] consecutive
No. of Service Connections at End of Month: 416 Total Population Served at End of Month: 871

Water Treatment Plant Information

Treatment Plant Name: Plantation Landings Telephone No.: (941) 647-1581
Address: 1.5 Miles West Hwy 600 City: Haines City State: FL Zip Code: 33844
Permitted Maximum Day Capacity of Plant: 132,800 gpd
Plant Category and Class per Rule 62-699.310(4), F.A.C.: 5C
Lead/Chief Plant Operator:

Table with 4 columns: Name, Certificate Number, Class (A, B, C, or D), Day(s)/Shift(s) Worked. Row 1: Robert A. Byrd, 007483, C, 12

Other Certified Plant Operators (attach additional sheets if necessary):

Table with 4 columns: Name, Certificate Number, Class (A, B, C, or D), Day(s)/Shift(s) Worked. Multiple empty rows.

STATEMENT BY LEAD/CHIEF WATER TREATMENT PLANT OPERATOR FOR THE MONTH/YEAR OF FEBRUARY 1998

I, the undersigned lead/chief operator of the water treatment plant listed in Part I of this form, certify that, to the best of my knowledge and belief, the information provided in this report is true and accurate. Also, I certify that the following additional operations records for the plant listed in Part I of this form were prepared each day that a certified operator staffed or visited the plant during the month indicated above:

- records of amounts of chemicals used and chemical feed rates; and
if applicable, appropriate treatment process performance records.

Furthermore, I agree to retain these additional operations records at the plant site for at least five years and to make them available for review upon request.

Signature and Date: Robert A. Byrd, 3/10/98

Name and Certificate Number (please type or print): Robert A. Byrd, DW007483 C

Monthly Operation Report for Public Water Systems that Use Ground Water and for Consecutive Public Water Systems that Treat Their Water

System PWS Identification Number: 6531000

Treatment Plant Name: PLANTATION LAKINGS

**SUMMARY OF DAILY WATER TREATMENT DATA FOR THE MONTH/YEAR OF** FEBRUARY 1998

Type of Residual Disinfectant Maintained in Distribution System Served by Plant:  free chlorine;  
 combined chlorine (chloramine);  chlorine dioxide

Summary of Daily Water Treatment Data for Month:

Day of the Month	Hours Plant in Operation	Quantity of Finished Water Produced by Plant (gallons)	Lowest Residual Disinfectant Concentration at Entry to Distribution System (mg/L)	Residual Disinfectant in Distribution System			Reported Emergency or Abnormal Operating Conditions
				Lowest Residual Disinfectant Concentration at Remote Point (mg/L)	Number of Instances Where Residual Disinfectant Measurements Taken at Total Coliform Sampling Points	Lowest Residual Disinfectant Concentration at Total Coliform Sampling Points (mg/L)	
1							
2		191,000	2.5	1.5			
3							
4		122,000	2.8	1.6			
5							
6		94,000	2.5	1.2			
7							
8							
9		211,000	2.5	1.0			
10							
11		128,000	1.8	0.5			
12							
13		113,000	2.0	0.8			
14							
15							
16		216,000	2.2	1.0			
17							
18		117,000	1.5	0.8			
19							
20		103,000	1.8	1.0			
21							
22							
23		186,000	1.5	0.8			
24							
25		131,000	1.5	0.8	2	0.8	
26							
27		119,000	1.8	1.2			
28							
29							
30							
31							
Total		1,731,000			2		
Avg.		61,821					
Max.		72,000					

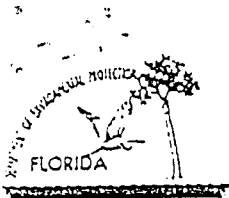

Department of Environmental Protection

Monthly Operation Report for Public Water Systems that Use Ground Water and for Consecutive Public Water Systems that Treat Their Water

INSTRUCTIONS: See Page 4.

GENERAL WATER SYSTEM AND WATER TREATMENT PLANT INFORMATION FOR THE MONTH/YEAR OF MARCH 1998

Water System Information

System Name: Plantation Landings PWS Identification No.: 6531000
System Owner Name: C.R.F. Telephone No.: (941) 647-1581
Address: P.O. Box 5252
City: LAKELAND State: FL Zip Code: 33807
System Type: [X] community, [ ] non-transient non-community, [ ] non-community, [ ] consecutive
No. of Service Connections at End of Month: 410 Total Population Served at End of Month: 871

Water Treatment Plant Information

Treatment Plant Name: Plantation Landings Telephone No.: (941) 647-1581
Address: 1.5 Miles West Hwy 600
City: Haines City State: FL Zip Code: 33844
Permitted Maximum Day Capacity of Plant: 122,800 gpd
Plant Category and Class per Rule 62-699.310(4), F.A.C.: 5C
Lead/Chief Plant Operator:

Table with 4 columns: Name, Certificate Number, Class (A, B, C, or D), Day(s)/Shift(s) Worked. Row 1: Robert A. Byrd, 007483, C, 13

Other Certified Plant Operators (attach additional sheets if necessary):

Table with 4 columns: Name, Certificate Number, Class (A, B, C, or D), Day(s)/Shift(s) Worked. Multiple empty rows.

II. STATEMENT BY LEAD/CHIEF WATER TREATMENT PLANT OPERATOR FOR THE MONTH/YEAR OF MARCH 1998

I, the undersigned lead/chief operator of the water treatment plant listed in Part I of this form, certify that, to the best of my knowledge and belief, the information provided in this report is true and accurate. Also, I certify that the following additional operations records for the plant listed in Part I of this form were prepared each day that a certified operator staffed or visited the plant during the month indicated above:

- records of amounts of chemicals used and chemical feed rates; and
if applicable, appropriate treatment process performance records.

Furthermore, I agree to retain these additional operations records at the plant site for at least five years and to make them available for review upon request.

Signature and Date: Robert Byrd, 4/1/98

Name and Certificate Number (please type or print): Robert A Byrd, DW007483C



Monthly Operation Report for Public Water Systems that Use Ground Water and for Consecutive Public Water Systems that Treat Their Water  
 System PWS Identification Number: 6531000  
 Treatment Plant Name: Plantation Landings

**SUMMARY OF DAILY WATER TREATMENT DATA FOR THE MONTH YEAR OF** MARCH 1998

Type of Residual Disinfectant Maintained in Distribution System Served by Plant:  free chlorine;  
 combined chlorine (chloramine);  chlorine dioxide

Summary of Daily Water Treatment Data for Month:

Day of the Month	Hours Plant in Operation	Quantity of Finished Water Produced by Plant (gallons)	Lowest Residual Disinfectant Concentration at Entry to Distribution System (mg/L)	Residual Disinfectant in Distribution System			Reported Emergency or Abnormal Operating Conditions
				Lowest Residual Disinfectant Concentration at Remote Point (mg/L)	Number of Instances Where Residual Disinfectant Measurements Taken at Total Coliform Sampling Points	Lowest Residual Disinfectant Concentration at Total Coliform Sampling Points (mg/L)	
1							
2		187,000	1.8	1.0			
3							
4		129,000	1.5	0.8			
5							
6		143,000	1.4	0.8			
7							
8							
9		234,000	1.5	0.8			
10							
11		119,000	1.8	1.0			
12							
13		143,000	1.5	0.8			
14							
15							
16		258,000	1.5	0.8			
17							
18		158,000	1.5	0.8			
19							
20		121,000	1.5	0.8			
21							
22							
23		183,000	1.5	1.0			
24							
25		135,000	1.5	0.8			
26							
27		144,000	1.5	0.8			
28							
29							
30		283,000	1.5	1.0	2	1.0	
31							
Total		2,237,000			2		
Avg.		72,161					
Max.		94,333					



CER Form 17-20150011  
 Domestic Wastewater Treatment Plant  
 Form Title Monthly Operating Report  
 Effective Date July 1, 1991  
 CER Application No. \_\_\_\_\_ (Printed in by CER)

## Domestic Wastewater Treatment Plant Monthly Operating Report

34)

Month JUNE Year 1998

Day of the Month	Flow (mgd)	Chlorine Residual after Contact	Chlorine Residual after Dechlorination	CBOD <sub>5</sub> Influent (mg/L)	TSS Influent (mg/L)	CBOD <sub>5</sub> Effluent (mg/L)	TSS Effluent (mg/L)	pH Effluent	TKN Effluent (mg/L)	NH <sub>4</sub> - N Effluent (mg/L)	Nitrate Effluent (mg/L)	Total P Effluent (mg/L)	Fecal Coliform (/100ml)						
1	.050	1.5					7.2												
2	.029	6.8					7.2												
3	.005	1.0					7.2												
4	.011	1.0					7.2												
5	.010	3.0					7.1												
6	.001	2.8					7.1												
7	.015	1.5					7.1												
8	.000	1.8					7.2												
9	.001	3.5					7.2												
10	.000	1.5					7.2												
11	.008	4.0		580	414	3.8	6.0	7.2		1.65		<1							
12	.008	4.0					7.2												
13	.009	4.0					7.2												
14	.013																		
15	.012	4.0					7.2												
16	.010	4.0					7.2												
17	.007	4.0					7.2												
18	.012	4.0					7.2												
19	.006	4.0					7.2												
20	.012	4.0					7.2												
21	.012																		
22	.012	3.2					7.2												
23	.012	4.0					7.2												
24	.005	3.5					7.2												
25	.016	4.0					7.2												
26	.008	3.5					7.2												
27	.008																		
28	.008	1.6					7.2												
29	.020	2.0					7.2												
30	.005	3.0					7.1												
31																			

I, the undersigned, Lead Operator, This is to certify that I am familiar with the information contained in this report and that to the best of my knowledge and belief, this information is true, complete and accurate.

Signed: Robert A. Byrd

Date: 7/15/98

Name (Please Type) Robert A. Byrd  
CRF

Telephone No. (941) 647-1581



# Domestic Wastewater Treatment Plant Monthly Operating Report

Month JULY Year 1998

34)

Day of the Month	Flow (mgd)	Chlorine Residual after Contact	Chlorine Residual after Dechlorination	CBOD <sub>5</sub> Influent (mg/L)	TSS Influent (mg/L)	CBOD <sub>5</sub> Effluent (mg/L)	TSS Effluent (mg/L)	pH Effluent	TKN Effluent (mg/L)	NH <sub>3</sub> - N Effluent (mg/L)	Nitrate Effluent (mg/L)	Total P Effluent (mg/L)	Fecal Coliform (#/100ml)
1	.016	2.8						7.1					
2	.009	3.5						7.1					
3	.021	4.0						7.1					
4	.009												
5	.009	2.0						7.0					
6	.016	1.2						7.0					
7	.013	1.0						7.0					
8	.019	4.0						7.0					
9	.012	4.0		240	380	2.5	1.8	7.0		2.37		<1	
10	.019	4.0						7.0					
11	.013												
12	.012	4.0						7.0					
13	.009	4.0						7.0					
14	.032	3.8						7.1					
15	.034	2.8						7.1					
16	.018	3.5						7.1					
17	.020	2.4						7.1					
18	.017	4.0						7.1					
19	.031												
20	.030	3.0						7.2					
21	.026	3.5						7.1					
22	.012	4.0						7.1					
23	.026	3.2						7.1					
24	.024	3.0						7.1					
25	.019												
26	.019	2.1						7.1					
27	.013	4.0						7.2					
28	.020	3.0						7.2					
29	.034	2.8						7.2					
30	.057	2.0						7.2					
31	.034	1.6						7.2					

Lead Operator: This is to certify that I am familiar with the information contained in this report and that to the best of my knowledge and belief, this information is true, complete, and accurate.

Signed: Robert A. Byrd  
 Name (Please Type) Robert A. Byrd

Date: 8/12/98

Phone: (941) 647-1581



## Domestic Wastewater Treatment Plant Monthly Operating Report

Month AUGUST Year 1998

34)

Day of the Month	Flow (mgd)	Chlorine Residual after Contact	Chlorine Residual after Dechlorination	CBOD <sub>5</sub> Influent (mg/L)	TSS Influent (mg/L)	CBOD <sub>5</sub> Effluent (mg/L)	TSS Effluent (mg/L)	pH Effluent	TKN Effluent (mg/L)	NH <sub>3</sub> - N Effluent (mg/L)	Nitrate Effluent (mg/L)	Total P Effluent (mg/L)	Fecal Coliform (#/100ml)						
1	.017																		
2	.016	1.7					7.4												
3	.018	3.1					7.2												
4	.033	2.8					7.2												
5	.016	3.0					7.2												
6	.014	4.0		170	140	3.7	<1	7.2		0.45		<1							
7	.003	4.0					7.2												
8	.006																		
9	.006	3.5					7.2												
10	.009	3.5					7.2												
11	.009	3.0					7.2												
12	.012	1.8					7.2												
13	.018	4.0					7.2												
14	.012	3.8					7.2												
15	.016																		
16	.015	2.7					7.2												
17	.015	3.8					7.2												
18	.013	4.0					7.4												
19	.011	4.0					7.3												
20	.020	4.0					7.3												
21	.002	4.0					7.3												
22	.016																		
23	.016	3.2					7.2												
24	.010	3.8					7.2												
25	.014	3.4					7.2												
26	.018	2.8					7.2												
27	.014	2.4					7.2												
28	.012	2.0					7.2												
29	.013																		
30	.013	1.8					7.2												
31	.019	4.0					7.2												

Lead Operator: This is to certify that I am familiar with the information contained in this report and that to the best of my knowledge and belief, this information is true, complete, and accurate.

Signed: Robert A. Byrd  
 Name (Please Type) Robert A. Byrd  
 Title (Please Type) C.R.F.

Date: 9/6/98  
 Telephone No. (Please Type) (941) 647-1581





CER Form 17-501.500(1)  
 Domestic Wastewater Treatment Plant  
 Monthly Operating Report  
 Effective Date July 1, 1991  
 CER Application No. (filled in by CER)

# Domestic Wastewater Treatment Plant Monthly Operating Report

Month SEPTEMBER Year 1998

34)

Day of the Month	Flow (mgd)	Chlorine Residual after Contact	Chlorine Residual after Dechlorination	CBOD <sub>5</sub> Influent (mg/L)	TSS Influent (mg/L)	CBOD <sub>5</sub> Effluent (mg/L)	TSS Effluent (mg/L)	pH Effluent	TKN Effluent (mg/L)	NH <sub>3</sub> - N Effluent (mg/L)	Nitrate Effluent (mg/L)	Total P Effluent (mg/L)	Fecal Coliform (#/100ml)						
1	.013	4.0						7.1											
2	.010	4.0						7.1											
3	.009	4.0		275	306	2.2	1.6	7.2		2.70			41						
4	.017	4.0						7.2											
5	.019																		
6	.019	3.2						7.2											
7	.011	1.8						7.2											
8	.018	2.8						7.1											
9	.009	3.4						7.1											
10	.011	2.8						7.1											
11	.011	1.8						7.1											
12	.010	4.0						7.3											
13	.011	3.6						7.2											
14	.016	3.1						7.2											
15	.007	2.4						7.4											
16	.009	2.1						7.2											
17	.009	4.0						7.2											
18	.004	4.0						7.2											
19	.042																		
20	.041	3.1						7.2											
21	.024	2.4						7.3											
22	.031	2.1						7.2											
23	.024	1.8						7.2											
24	.037	1.1						7.2											
25	.041	1.8						7.2											
26	.037																		
27	.036	1.4						7.2											
28	.022	3.8						7.2											
29	.019	4.0						7.2											
30	.023	4.0						7.2											
31																			

Lead Operator: This is to certify that I am familiar with the information contained in this report and that to the best of my knowledge and belief, this information is true, complete and accurate.

Signed: Robert A. Byrd  
 Name (Please Type) Robert A. Byrd  
 Company Name C.R.F.

Date: 10/11/98  
 Telephone No. (Please Type) (941) 647-1581



Department of Environmental Protection

Monthly Operation Report for Public Water Systems that Use Ground Water and for Consecutive Public Water Systems that Treat Their Water

INSTRUCTIONS: See Page 4.

GENERAL WATER SYSTEM AND WATER TREATMENT PLANT INFORMATION FOR THE MONTH/YEAR OF APRIL 1998

Water System Information

System Name: Plantation Landings PWS Identification No.: 6531000
System Owner Name: C.R.F. Telephone No.: (941) 647-1581
Address: P.O. Box 5252
City: Lakeland State: FL Zip Code: 33801
System Type: [X] community; [ ] non-transient non-community; [ ] non-community; [ ] consecutive
No. of Service Connections at End of Month: 410 Total Population Served at End of Month: 871

Water Treatment Plant Information

Treatment Plant Name: Plantation Landings Telephone No.: (941) 647-1581
Address: 1.5 Miles West Hwy 600
City: Haines City State: FL Zip Code: 33844
Permitted Maximum Day Capacity of Plant: 132,800 gpd
Plant Category and Class per Rule 62-699.310(4), F.A.C.: SC
Lead/Chief Plant Operator:

Table with 4 columns: Name, Certificate Number, Class (A, B, C, or D), Day(s)/Shift(s) Worked. Row 1: Robert A. Byrd, 007483, C, 13

Other Certified Plant Operators (attach additional sheets if necessary):

Table with 4 columns: Name, Certificate Number, Class (A, B, C, or D), Day(s)/Shift(s) Worked. Multiple empty rows.

II. STATEMENT BY LEAD/CHIEF WATER TREATMENT PLANT OPERATOR FOR THE MONTH/YEAR OF APRIL 1998

I, the undersigned lead/chief operator of the water treatment plant listed in Part I of this form, certify that, to the best of my knowledge and belief, the information provided in this report is true and accurate. Also, I certify that the following additional operations records for the plant listed in Part I of this form were prepared each day that a certified operator staffed or visited the plant during the month indicated above:

- records of amounts of chemicals used and chemical feed rates; and
if applicable, appropriate treatment process performance records.

Furthermore, I agree to retain these additional operations records at the plant site for at least five years and to make them available for review upon request.

Signature and Date: Robert A. Byrd, 5/12/98

Name and Certificate Number (please type or print): Robert A. Byrd, DW007483C

Monthly Operation Report for Public Water Systems that Use Ground Water and for Consecutive Public Water

Systems that Treat Their Water

System PWS Identification Number: 6531000

Treatment Plant Name: Plantation Landings

**III. SUMMARY OF DAILY WATER TREATMENT DATA FOR THE MONTH/YEAR OF APRIL 1998**

Type of Residual Disinfectant Maintained in Distribution System Served by Plant:  free chlorine;

combined chlorine (chloramine);  chlorine dioxide

Summary of Daily Water Treatment Data for Month:

Day of the Month	Hours Plant in Operation	Quantity of Finished Water Produced by Plant (gallons)	Lowest Residual Disinfectant Concentration at Entry to Distribution System (mg/L)	Residual Disinfectant in Distribution System			Reported Emergency or Abnormal Operating Conditions
				Lowest Residual Disinfectant Concentration at Remote Point (mg/L)	Number of Instances Where Residual Disinfectant Measurements Taken at Total Coliform Sampling Points	Lowest Residual Disinfectant Concentration at Total Coliform Sampling Points (mg/L)	
1		178,000	1.8	1.0			
2							
3		178,000	1.5	0.8			
4							
5							
6		266,000	1.5	0.8			
7							
8		190,000	1.5	0.8			
9							
10		119,000	1.5	0.8			
11							
12							
13		334,000	1.5	0.8			
14							
15		224,000	1.5	0.8			
16							
17		176,000	1.5	0.8			
18							
19							
20		318,000	1.5	1.0			
21							
22		201,000	1.8	1.2			
23					2, 1 @ P	1.0	
24		146,000	1.8	1.5			
25							
26							
27		276,000	1.8	1.2			
28							
29		205,000	1.8	1.0			
30					3, 1 @ P	1.8	
31							
Total		2,811,000			5		
Avg.		93,700					
Max.		112,000					



Department of Environmental Protection

Monthly Operation Report for Public Water Systems that Use Ground Water and for Consecutive Public Water Systems that Treat Their Water

INSTRUCTIONS: See Page 4.

GENERAL WATER SYSTEM AND WATER TREATMENT PLANT INFORMATION FOR THE MONTH/YEAR OF MAY 1998

Water System Information

System Name: Plantation Landings PWS Identification No.: 6531000
System Owner: C.R.F. Telephone No.: (941) 647-1581
Address: P.O. Box 5252
City: Lakeland, State: FL Zip Code: 33807
System Type: community
No. of Service Connections at End of Month: 410 Total Population Served at End of Month: 871

Water Treatment Plant Information

Treatment Plant Name: Plantation Landings Telephone No.: (941) 647-1581
Address: 1.5 Miles West Hwy 17/92
City: Haines City State: FL Zip Code: 33844
Permitted Maximum Day Capacity of Plant: 132,800 gpd
Plant Category and Class per Rule 62-699.310(4), F.A.C.: 5C
Lead/Chief Plant Operator:

Table with 4 columns: Name, Certificate Number, Class (A, B, C, or D), Day(s)/Shift(s) Worked. Row 1: Robert A. Byrd, 007483, C, 13

Other Certified Plant Operators (attach additional sheets if necessary):

Table with 4 columns: Name, Certificate Number, Class (A, B, C, or D), Day(s)/Shift(s) Worked. Multiple empty rows.

STATEMENT BY LEAD/CHIEF WATER TREATMENT PLANT OPERATOR FOR THE MONTH/YEAR OF MAY 1998

I, the undersigned lead/chief operator of the water treatment plant listed in Part I of this form, certify that, to the best of my knowledge and belief, the information provided in this report is true and accurate. Also, I certify that the following additional operations records for the plant listed in Part I of this form were prepared each day that a certified operator staffed or visited the plant during the month indicated above:

- records of amounts of chemicals used and chemical feed rates; and
if applicable, appropriate treatment process performance records.

Furthermore, I agree to retain these additional operations records at the plant site for at least five years and to make them available for review upon request.

Signature and Date: [Signature] 6/9/98

Name and Certificate Number (please type or print): Robert A. Byrd, DW007483C

Monthly Operation Report for Public Water Systems that Use Ground Water and for Consecutive Public Water

Systems that Treat Their Water  
System PWS Identification Number: 6531000

Treatment Plant Name: Plantation Landings

**U.S. SUMMARY OF DAILY WATER TREATMENT DATA FOR THE MONTH/YEAR OF MAY 1998**

Type of Residual Disinfectant Maintained in Distribution System Served by Plant:  free chlorine;

combined chlorine (chloramine);  chlorine dioxide

Summary of Daily Water Treatment Data for Month:

Day of the Month	Hours Plant in Operation	Quantity of Finished Water Produced by Plant (gallons)	Lowest Residual Disinfectant Concentration at Entry to Distribution System (mg/L)	Residual Disinfectant in Distribution System			Reported Emergency or Abnormal Operating Conditions
				Lowest Residual Disinfectant Concentration at Remote Point (mg/L)	Number of Instances Where Residual Disinfectant Measurements Taken at Total Coliform Sampling Points	Lowest Residual Disinfectant Concentration at Total Coliform Sampling Points (mg/L)	
1		123,000	1.5	0.8			
2							
3							
4		238,000	1.5	1.0			
5							
6		143,000	1.8	1.2			
7							
8		103,000	1.8	1.0			
9							
10							
11		247,000	1.5	1.0			
12							
13		169,800	1.8	1.0			
14							
15		142,000	1.5	1.0			
16							
17							
18		279,000	1.2	0.8			
19							
20		189,000	1.2	0.8	3 @ A	0.8	
21							
22		198,000	1.0	0.8			
23							
24							
25		382,000	1.2	0.8			
26							
27		242,000	1.2	0.8	2 @ A	0.8	
28					3 @ A	0.8	
29		106,000	1.2	0.8			
30							
31							
Total		2561,000			8		
Avg.		82,613					
Max.		127,333					



Department of Environmental Protection

Monthly Operation Report for Public Water Systems that Use Ground Water and for Consecutive Public Water Systems that Treat Their Water

INSTRUCTIONS: See Page 4.

GENERAL WATER SYSTEM AND WATER TREATMENT PLANT INFORMATION FOR THE MONTH/YEAR OF JUNE 1998

Water System Information

System Name: Plantation Landings PWS Identification No.: 6531000
System Owner Name: C.R.F. Telephone No.: (941)647-1581
Address: P.O. Box 5252 State: FL Zip Code: 33807
City: Lakeland
System Type: Community
No. of Service Connections at End of Month: 410 Total Population Served at End of Month: 871

Water Treatment Plant Information

Treatment Plant Name: Plantation Landings Telephone No.: (941)647-1581
Address: 1.5 Miles West Hwy 17/92 State: FL Zip Code: 33844
City: Haines City
Permitted Maximum Day Capacity of Plant: 132,000 gpd
Plant Category and Class per Rule 62-699.310(4), F.A.C.: SC
Lead/Chief Plant Operator:

Table with 4 columns: Name, Certificate Number, Class (A, B, C, or D), Day(s)/Shift(s) Worked. Row 1: Robert A. Byrd, 007483, C, 13

Other Certified Plant Operators (attach additional sheets if necessary):

Table with 4 columns: Name, Certificate Number, Class (A, B, C, or D), Day(s)/Shift(s) Worked. Multiple empty rows.

STATEMENT BY LEAD/CHIEF WATER TREATMENT PLANT OPERATOR FOR THE MONTH/YEAR OF JUNE 1998

I, the undersigned lead/chief operator of the water treatment plant listed in Part I of this form, certify that, to the best of my knowledge and belief, the information provided in this report is true and accurate. Also, I certify that the following additional operations records for the plant listed in Part I of this form were prepared each day that a certified operator staffed or visited the plant during the month indicated above:

- records of amounts of chemicals used and chemical feed rates; and
if applicable, appropriate treatment process performance records.

Furthermore, I agree to retain these additional operations records at the plant site for at least five years and to make them available for review upon request.

Signature and Date: Robert A. Byrd, 7/13/98

Name and Certificate Number (please type or print): Robert A. Byrd, DW007483C

Monthly Operation Report for Public Water Systems that Use Ground Water and for Consecutive Public Water Systems that Treat Their Water  
 System PWS Identification Number: 6531000  
 Treatment Plant Name: Plantation Landings

**III. SUMMARY OF DAILY WATER TREATMENT DATA FOR THE MONTH/YEAR OF June 1998**

- Type of Residual Disinfectant Maintained in Distribution System Served by Plant:  free chlorine;  combined chlorine (chloramine);  chlorine dioxide
- Summary of Daily Water Treatment Data for Month:

Day of the Month	Hours Plant in Operation	Quantity of Finished Water Produced by Plant (gallons)	Lowest Residual Disinfectant Concentration at Entry to Distribution System (mg/L)	Residual Disinfectant in Distribution System			Reported Emergency or Abnormal Operating Conditions
				Lowest Residual Disinfectant Concentration at Remote Point (mg/L)	Number of Instances Where Residual Disinfectant Measurements Taken at Total Coliform Sampling Points	Lowest Residual Disinfectant Concentration at Total Coliform Sampling Points (mg/L)	
1		257,000	1.2	0.7			
2							
3		226,000	1.0	0.5			
4							
5		157,000	1.5	1.0			
6							
7							
8		288,000	1.2	0.2			
9							
10		210,000	1.5	1.0	2	1.0	
11							
12		152,000	1.2	0.7			
13							
14							
15		327,000	1.6	0.6			
16							
17		215,000	2.1	1.1			
18							
19		163,000	2.0	0.9			
20							
21							
22		331,000	1.6	0.7			
23							
24		240,000	1.8	1.0			
25							
26		185,000	1.8	1.0			
27							
28							
29		335,000	1.5	0.8			
30							
31							
Total		2,086,000			2		
Avg.		102,867					
Max.		120,000					



Department of  
Environmental Protection

Monthly Operation Report for Public Water Systems that Use Ground Water and  
for Consecutive Public Water Systems that Treat Their Water

INSTRUCTIONS: See Page 4.

**GENERAL WATER SYSTEM AND WATER TREATMENT PLANT INFORMATION FOR THE MONTH/YEAR OF**  
JULY 1998

Water System Information

• System Name: Plantation Landings PWS Identification No.: 6531000  
 • System Owner Name: C.R.F. Telephone No.: (941)647-1581  
 Address: P.O. Box 5252  
 City: Lakeland State: FL Zip Code: 33807  
 • System Type:  community;  non-transient non-community;  non-community;  consecutive  
 • No. of Service Connections at End of Month: 410 Total Population Served at End of Month: 871

Water Treatment Plant Information

• Treatment Plant Name: Plantation Landings Telephone No.: (941)647-1581  
 Address: 1.5 Miles West Hwy 17/92  
 City: Haines City State: FL Zip Code: 33844  
 • Permitted Maximum Day Capacity of Plant: 132,800 gpd  
 • Plant Category and Class per Rule 62-699.310(4), F.A.C.: 5C  
 • Lead/Chief Plant Operator:

Name	Certificate Number	Class (A, B, C, or D)	Day(s)/Shift(s) Worked
<u>Robert A. Byrd</u>	<u>007483</u>	<u>C</u>	<u>14</u>

• Other Certified Plant Operators (attach additional sheets if necessary):

Name	Certificate Number	Class (A, B, C, or D)	Day(s)/Shift(s) Worked

**II. STATEMENT BY LEAD/CHIEF WATER TREATMENT PLANT OPERATOR FOR THE MONTH/YEAR OF**  
JULY 1998

I, the undersigned lead/chief operator of the water treatment plant listed in Part I of this form, certify that, to the best of my knowledge and belief, the information provided in this report is true and accurate. Also, I certify that the following additional operations records for the plant listed in Part I of this form were prepared each day that a certified operator staffed or visited the plant during the month indicated above:

- records of amounts of chemicals used and chemical feed rates; and
- if applicable, appropriate treatment process performance records.

Furthermore, I agree to retain these additional operations records at the plant site for at least five years and to make them available for review upon request.

Robert A. Byrd, 8/12/98  
Signature and Date

Robert A. Byrd, DW007483C  
Name and Certificate Number (please type or print)



Monthly Operation Report for Public Water Systems that Use Ground Water and for Consecutive Public Water

Systems that Treat Their Water  
System PWS Identification Number: 6531000

Treatment Plant Name: Plantation Landings

**SUMMARY OF DAILY WATER TREATMENT DATA FOR THE MONTH YEAR OF** JULY 1998

Type of Residual Disinfectant Maintained in Distribution System Served by Plant:  free chlorine;  
 combined chlorine (chloramine);  chlorine dioxide

Summary of Daily Water Treatment Data for Month:

Day of the Month	Hours Plant in Operation	Quantity of Finished Water Produced by Plant (gallons)	Lowest Residual Disinfectant Concentration at Entry to Distribution System (mg/L)	Residual Disinfectant in Distribution System			Reported Emergency or Abnormal Operating Conditions
				Lowest Residual Disinfectant Concentration at Remote Point (mg/L)	Number of Instances Where Residual Disinfectant Measurements Taken at Total Coliform Sampling Points	Lowest Residual Disinfectant Concentration at Total Coliform Sampling Points (mg/L)	
1		210,000	1.8	0.8			
2							
3		184,000	1.2	0.5			
4							
5							
6		275,000	1.0	0.5			
7							
8		187,000	0.8	0.2			
9							
10		157,000	1.5	1.0			
11							
12							
13		203,000	1.8	1.0			
14							
15		141,000	2.0	1.0			
16							
17		95,000	2.0	0.8			
18							
19							
20		248,000	2.2	1.0			
21							
22		115,000	2.0	1.0			
23							
24		125,000	2.0	1.0			
25							
26							
27		260,000	2.2	1.2			
28							
29		168,000	2.2	1.0	2 @ A, 1 @ P		
30							
31		143,000	2.0	1.0			
Total		2,511,000			2		
Avg.		81,000					
Max.		165,000					



Department of Environmental Protection

Monthly Operation Report for Public Water Systems that Use Ground Water and for Consecutive Public Water Systems that Treat Their Water

INSTRUCTIONS: See Page 4.

GENERAL WATER SYSTEM AND WATER TREATMENT PLANT INFORMATION FOR THE MONTH/YEAR OF AUGUST 1998

Water System Information

System Name: PLANTATION LANDINGS PWS Identification No.: 6531000
System Owner Name: C.R.F. Telephone No.: (941) 647-1581
Address: P.O. Box 5252
City: LAKELAND State: FL Zip Code: 33807
System Type: [X] community; [ ] non-transient non-community; [ ] non-community; [ ] consecutive
No. of Service Connections at End of Month: 410 Total Population Served at End of Month: 871

Water Treatment Plant Information

Treatment Plant Name: PLANTATION LANDINGS Telephone No.: (941) 647-1581
Address: 1.5 Miles West Hwy 17/92
City: HAINES CITY State: FL Zip Code: 33844
Permitted Maximum Day Capacity of Plant: 132,800 gpd
Plant Category and Class per Rule 62-699.310(4), F.A.C.: 5C
Lead/Chief Plant Operator:

Table with 4 columns: Name, Certificate Number, Class (A, B, C, or D), Day(s)/Shift(s) Worked. Row 1: Robert A. Byrd, 007483, C, 13

Other Certified Plant Operators (attach additional sheets if necessary):

Table with 4 columns: Name, Certificate Number, Class (A, B, C, or D), Day(s)/Shift(s) Worked. Multiple empty rows for additional operators.

STATEMENT BY LEAD/CHIEF WATER TREATMENT PLANT OPERATOR FOR THE MONTH/YEAR OF AUGUST 1998

I, the undersigned lead/chief operator of the water treatment plant listed in Part I of this form, certify that, to the best of my knowledge and belief, the information provided in this report is true and accurate. Also, I certify that the following additional operations records for the plant listed in Part I of this form were prepared each day that a certified operator staffed or visited the plant during the month indicated above:

- records of amounts of chemicals used and chemical feed rates; and
if applicable, appropriate treatment process performance records.

Furthermore, I agree to retain these additional operations records at the plant site for at least five years and to make them available for review upon request.

Signature and Date: Robert Byrd, 9/6/98

Name and Certificate Number (please type or print): Robert A. Byrd, DW007483C

Monthly Operation Report for Public Water Systems that Use Ground Water and for Consecutive Public Water Systems that Treat Their Water  
 System PWS Identification Number: 6531 000  
 Treatment Plant Name: PLANTATION LAMING

**SUMMARY OF DAILY WATER TREATMENT DATA FOR THE MONTH YEAR OF** AUGUST 1998

- Type of Residual Disinfectant Maintained in Distribution System Served by Plant:  free chlorine;
- combined chlorine (chloramine);  chlorine dioxide
- Summary of Daily Water Treatment Data for Month:

Day of the Month	Hours Plant in Operation	Quantity of Finished Water Produced by Plant (gallons)	Lowest Residual Disinfectant Concentration at Entry to Distribution System (mg/L)	Residual Disinfectant in Distribution System			Reported Emergency or Abnormal Operating Conditions
				Lowest Residual Disinfectant Concentration at Remote Point (mg/L)	Number of Instances Where Residual Disinfectant Measurements Taken at Total Coliform Sampling Points	Lowest Residual Disinfectant Concentration at Total Coliform Sampling Points (mg/L)	
1							
2							
3		250,000	2.4	1.4			
4							
5		208,000	2.5	1.8			
6							
7		121,000	3.0	2.0			
8							
9							
10		215,000	2.8	1.8			
11							
12		140,000	2.2	1.2			
13							
14		141,000	2.4	1.4			
15							
16							
17		230,000	3.0	1.9			
18							
19		142,000	2.8	1.7			
20							
21		125,000	3.0	1.5			
22							
23							
24		214,000	2.4	1.2			
25					3@A		
26		189,000	3.0	1.5	5@A		
27							
28		155,000	3.0	1.5			
29							
30							
31		294,000	3.0	1.5			
Total		2,424,000			8		
Avg.		78,194					
Max.		104,000					



Department of Environmental Protection

Monthly Operation Report for Public Water Systems that Use Ground Water and for Consecutive Public Water Systems that Treat Their Water

INSTRUCTIONS: See Page 4.

GENERAL WATER SYSTEM AND WATER TREATMENT PLANT INFORMATION FOR THE MONTH/YEAR OF SEPTEMBER 1998

Water System Information

System Name: PLANTATION LANDINGS PWS Identification No.: 6531000
System Owner Name: C.R.F. Telephone No.: (941) 647-1581
Address: P.O. Box 5152
City: LAKEWOOD State: FL Zip Code: 33807
System Type: [X] community; [ ] non-transient non-community; [ ] non-community; [ ] consecutive
No. of Service Connections at End of Month: 410 Total Population Served at End of Month: 871

Water Treatment Plant Information

Treatment Plant Name: PLANTATION LANDINGS Telephone No.: (941) 647-1581
Address: 15 MILES WEST HWY 17/92
City: HAINES CITY State: FL Zip Code: 33844
Permitted Maximum Day Capacity of Plant: 132,800 gpd
Plant Category and Class per Rule 62-699.310(4), F.A.C.: SC
Lead/Chief Plant Operator:

Table with 4 columns: Name, Certificate Number, Class (A, B, C, or D), Day(s)/Shift(s) Worked. Row 1: Robert A. Boyd, 007483, C, 13

Other Certified Plant Operators (attach additional sheets if necessary):

Table with 4 columns: Name, Certificate Number, Class (A, B, C, or D), Day(s)/Shift(s) Worked. Multiple empty rows for additional operators.

STATEMENT BY LEAD/CHIEF WATER TREATMENT PLANT OPERATOR FOR THE MONTH/YEAR OF SEPTEMBER 1998

I, the undersigned lead/chief operator of the water treatment plant listed in Part I of this form, certify that, to the best of my knowledge and belief, the information provided in this report is true and accurate. Also, I certify that the following additional operations records for the plant listed in Part I of this form were prepared each day that a certified operator staffed or visited the plant during the month indicated above:

- records of amounts of chemicals used and chemical feed rates; and
if applicable, appropriate treatment process performance records.

Furthermore, I agree to retain these additional operations records at the plant site for at least five years and to make them available for review upon request.

Signature and Date: Robert Boyd, 10/11/98

Name and Certificate Number (please type or print): Robert A. Boyd, DW 007483 C

Monthly Operation Report for Public Water Systems that Use Ground Water and for Consecutive Public Water Systems that Treat Their Water  
 System PWS Identification Number: 6531000  
 Treatment Plant Name: PURDUE LANDINGS

**II. SUMMARY OF DAILY WATER TREATMENT DATA FOR THE MONTH YEAR OF JULY 1998**

- Type of Residual Disinfectant Maintained in Distribution System Served by Plant:  free chlorine;  combined chlorine (chloramine);  chlorine dioxide
- Summary of Daily Water Treatment Data for Month:

Day of the Month	Hours Plant in Operation	Quantity of Finished Water Produced by Plant (gallons)	Lowest Residual Disinfectant Concentration at Entry to Distribution System (mg/L)	Residual Disinfectant in Distribution System			Reported Emergency or Abnormal Operating Conditions
				Lowest Residual Disinfectant Concentration at Remote Point (mg/L)	Number of Instances Where Residual Disinfectant Measurements Taken at Total Coliform Sampling Points	Lowest Residual Disinfectant Concentration at Total Coliform Sampling Points (mg/L)	
1					2	1.5	
2		197,000	3.0	1.8			
3							
4		118,000	2.5	1.0			
5							
6							
7		261,000	3.0	1.5			
8							
9		150,000	3.0	1.5			
10							
11		123,000	3.0	1.5			
12							
13							
14		271,000	3.0	1.5			
15							
16		168,000	3.0	1.5			
17							
18		114,000	3.0	1.5			
19							
20							
21		191,000	3.0	1.5			
22							
23		143,000	2.9	1.2			
24							
25		85,000	3.0	1.5			
26							
27							
28		176,000	3.0	1.5			
29							
30		139,000	3.0	1.5			
31							
Total		2,136,000			2		
Avg.		71,200					
Max.		98,500					



CER Form 17-501.000(1)  
 Domestic Wastewater Treatment Plant  
 Form Title Monthly Operating Report  
 Effective Date JULY 1, 1991  
 CER Application No. (filled in by CER)

## Domestic Wastewater Treatment Plant Monthly Operating Report

Month October Year 1997

Day of the Month	Flow (mgd)	Chlorine Residual after Contact	Chlorine Residual after Dechlorination	CBOD <sub>5</sub> Influent (mg/L)	TSS Influent (mg/L)	CBOD <sub>5</sub> Effluent (mg/L)	TSS Effluent (mg/L)	pH Effluent	TKN Effluent (mg/L)	NH <sub>3</sub> - N Effluent (mg/L)	Nitrate Effluent (mg/L)	Total P Effluent (mg/L)	Fecal Coliform (#/100ml)						
1	.006	1.5						7.2											
2	.012	1.5		316	259	<1	3.3	7.2					<1						
3	.019	3.5						7.2											
4	.017	3.5						7.2											
5	.014																		
6	.014	2.0						7.2											
7	.011	3.0						7.2											
8	.014	3.5						7.2											
9	.012	2.0						7.2											
10	.011	3.0						7.2											
11	.013																		
12	.013	4.0						7.2											
13	.008	4.0						7.2											
14	.020	3.0						7.2											
15	.015	2.0						7.2											
16	.014	2.0						7.1		3.5									
17	.018	2.5						7.1											
18	.016																		
19	.016	3.0						7.1											
20	.008	3.0						7.1											
21	.014	3.0						7.1											
22	.016	2.0						7.1											
23	.004	1.5						7.1											
24	.015	2.5						7.1											
25	.013																		
26	.013	3.5						7.2											
27	.008	3.0						7.1											
28	.028	3.0						7.1											
29	.007	3.5						7.1											
30	.030	4.0						7.1											
31	.018	3.0						7.1											

I, the undersigned, certify that I am familiar with the information contained in this report and that to the best of my knowledge and belief, the information is true, complete and accurate.

Signed: Robert A. Byrd  
 \_\_\_\_\_  
 Robert A. Byrd

Date: 11/7/97





CER Form 17-501.500(1)  
 Domestic Wastewater Treatment Plant  
 Monthly Operating Report  
 Effective Date July 1, 1991  
 CER Application No. (Filled in by CER)

## Domestic Wastewater Treatment Plant Monthly Operating Report

Month November Year 1997

Day of this Month	Flow (mgd)	Chlorine Residual after Contact	Chlorine Residual after Dechlorination	CBOD <sub>5</sub> Influent (mg/L)	TSS Influent (mg/L)	CBOD <sub>5</sub> Effluent (mg/L)	TSS Effluent (mg/L)	pH Effluent	TKN Effluent (mg/L)	NH <sub>3</sub> - N Effluent (mg/L)	Nitrate Effluent (mg/L)	Total P Effluent (mg/L)	Fecal Coliform (#/100ml)
1	.026	3.0						7.1					
2	.020	2.5						7.1					
3	.011	3.5						7.1					
4	.021	2.5						7.1					
5	.017	3.5						7.1					
6	.032	4.0						7.2					
7	.021	3.0						7.2					
8	.026												
9	.025	3.0						7.2					
10	.009	3.0						7.2					
11	.030	3.5						7.3					
12	.017	4.0						7.2					
13	.005	4.0		180	110.7	4.95	2.65	7.3		0.55		4.1	
14	.042	4.0						7.2					
15	.031												
16	.030	3.0						7.2					
17	.007	4.0						7.2					
18	.026	3.5						7.2					
19	.015	4.0						7.2					
20	.014	3.5						7.1					
21	.017	3.0						7.1					
22	.024												
23	.024	4.0						7.1					
24	.018	3.0						7.1					
25	.016	4.0						7.1					
26	.026	2.0						7.1					
27	.018												
28	.018	1.5						7.1					
29	.019												
30	.019	4.0						7.1					
31													

I, the undersigned Operator, This is to certify that I am familiar with the information contained in this report and that to the best of my knowledge and belief, the information is true, complete, and accurate.

Signed: Robert A. Byrd  
 Name (Please Type) Robert A. Byrd

Date: 12/2/97

(201) 647-6581







CEA Form 17-50150011  
 Domestic Wastewater Treatment Plant  
 Monthly Operating Report  
 Effective Date July 1, 1991  
 CEA Account No. (filled in by CEA)

## Domestic Wastewater Treatment Plant Monthly Operating Report

Month JANUARY Year 1998

34)

Day of the Month	Flow (mgd)	Chlorine Residual after Contact	Chlorine Residual after Decolorization	CBOD <sub>5</sub> Influent (mg/L)	TSS Influent (mg/L)	CBOD <sub>5</sub> Effluent (mg/L)	TSS Effluent (mg/L)	pH Effluent	TKN Effluent (mg/L)	NH <sub>3</sub> - N Effluent (mg/L)	Nitrate Effluent (mg/L)	Total P Effluent (mg/L)	Fecal Coliform (#/100ml)						
1	.034																		
2	.034	2.0						7.2											
3	.028																		
4	.028	3.5						7.2											
5	.017	3.0						7.2											
6	.037	3.0						7.2											
7	.031	2.5						7.2											
8	.028	2.5		220	300	4.7	3.0	7.2		1.5			21						
9	.050	2.0						7.2											
10	.033																		
11	.032	3.0						7.2											
12	.026	2.0						7.2											
13	.022	3.0						7.2											
14	.016	4.0						7.2											
15	.026	4.0						7.2											
16	.053	4.0						7.2											
17	.033																		
18	.033	3.0						7.2											
19	.009	4.0						7.2											
20	.040	4.0						7.2											
21	.025	4.0						7.2											
22	.042	3.5						7.2											
23	.025	4.0						7.2											
24	.041																		
25	.041	3.0						7.2											
26	.033	2.0						7.2											
27	.013	4.0						7.2											
28	.025	4.0						7.2											
29	.020	4.0						7.2											
30	.031	4.0						7.2											
31	.030	4.0						7.2											

Plant Operator: This is to certify that I am familiar with the information contained in this report and that to the best of my knowledge and belief, this information is true, complete and accurate.

Signed: *Robert A. Bryant*  
 Name (Please Type) Robert A. Bryant  
 Telephone Name C.R.F.

Date: 2/14/98  
 Telephone No. (Please Type) (841) 647-1581



CER Form 17-201-50011  
 Domestic Wastewater Treatment Plant  
 Monthly Operating Report  
 Effective Date July 1, 1991  
 CER Application No. (filled in by CER)

## Domestic Wastewater Treatment Plant Monthly Operating Report

34)

Month February Year 1998

Day of the Month	Flow (mgd)	Chlorine Residual after Contact	Chlorine Residual after Dechlorination	CBOD <sub>5</sub> Influent (mg/L)	TSS Influent (mg/L)	CBOD <sub>5</sub> Effluent (mg/L)	TSS Effluent (mg/L)	pH Effluent	TKN Effluent (mg/L)	NH <sub>4</sub> -N Effluent (mg/L)	Nitrate Effluent (mg/L)	Total P Effluent (mg/L)	Fecal Coliform (#/100ml)
1	1,026	4.0						7.2					
2	1,018	4.0						7.2					
3	1,034	4.0						7.2					
4	1,047	3.0						7.2					
5	1,014	3.0		258	300	1.8	3.9	7.2		5.5		21	
6	1,028	2.5						7.2					
7	1,040	2.5						7.2					
8	1,027	2.0						7.2					
9	1,035	3.0						7.2					
10	1,014	3.0						7.2					
11	1,040	3.0						7.2					
12	1,025	2.0						7.2					
13	1,015	2.0						7.2					
14	1,029												
15	1,028	1.5						7.2					
16	1,041	2.0						7.2					
17	1,068	1.5						7.2					
18	1,050	1.0						7.2					
19	1,038	1.0						7.2					
20	1,054	3.0						7.2					
21	1,041	2.0						7.2					
22	1,043												
23	1,042	1.5						7.2					
24	1,026	1.5						7.2					
25	1,045	3.0						7.3					
26	1,029	1.5						7.2					
27	1,040	2.0						7.2					
28	1,036												
29													
30													
31													

I, the undersigned Operator, certify that I am familiar with the information contained in this report and that to the best of my knowledge and belief, this information is true, complete, and accurate.

Signed: Robert A. Byrd  
 Name (Please Type) Robert A. Byrd  
 Agency Name C.R.F.

Date: 3/10/98  
 Telephone No. (Please Type) (941) 647-1581





CCR Form 17-20150011  
 Domestic Wastewater Treatment Plant  
 Monthly Operating Report  
 Effective Date July 1, 1991  
 CCR Application No. \_\_\_\_\_ (Filed in by CCR)

## Domestic Wastewater Treatment Plant Monthly Operating Report

Month MARCH Year 1998

Day of the Month	Flow (mgd)	Chlorine Residual after Contact	Chlorine Residual after Dechlorination	CBOD <sub>5</sub> Influent (mg/L)	TSS Influent (mg/L)	CBOD <sub>5</sub> Effluent (mg/L)	TSS Effluent (mg/L)	pH Effluent	TKN Effluent (mg/L)	NH <sub>3</sub> - N Effluent (mg/L)	Nitrate Effluent (mg/L)	Total P Effluent (mg/L)	Fecal Coliform (#/100ml)
1	,036	3.0						7.1					
2	,043	2.0						7.1					
3	,029	3.0						7.2					
4	,038	3.0						7.2					
5	,019	3.5		270	234	1.7	2.2	7.2					1
6	,042	1.5						7.1					
7	,038	2.5						7.1					
8	,039												
9	,038	2.0						7.2					
10	,022	3.5						7.2					
11	,035	3.0						7.2					
12	,037	3.0						7.2					
13	,032	3.5						7.2					
14	,034												
15	,033	3.0						7.2					
16	,035	3.0						7.2					
17	,014	3.0						7.2					
18	,039	3.5						7.0					
19	,027	4.0						7.0		0.3			
20	,081	3.0						7.0					
21	,037												
22	,037	3.5						7.0					
23	,037	4.0						7.0					
24	,013	4.0						7.0					
25	,042	3.5						7.0					
26	,018	4.0						7.0					
27	,033	3.5						7.0					
28	,034												
29	,033	4.0						7.0					
30	,042	3.5						7.0					
31	,016	4.0						7.0					

I, the Lead Operator, This is to certify that I am familiar with the information contained in this report and that to the best of my knowledge and belief, this information is true, complete, and accurate.

Signed: Robert A. Byrd  
 Name (Please Type) Robert A. Byrd  
 Title Name C.R.F.

Date: 4/1/98  
 Telephone No. (Please Type) (941) 647-1581



## Domestic Wastewater Treatment Plant Monthly Operating Report

Month APRIL Year 1998

34)

Day of the Month	Flow (mgd)	Chlorine Residual after Contact	Chlorine Residual after Decoloration	CBOD <sub>5</sub> Influent (mg/L)	TSS Influent (mg/L)	CBOD <sub>5</sub> Effluent (mg/L)	TSS Effluent (mg/L)	pH Effluent	TKN Effluent (mg/L)	NH <sub>3</sub> - N Effluent (mg/L)	Nitrate Effluent (mg/L)	Total P Effluent (mg/L)	Fecal Coliform (#/100ml)						
1	.035	3.5						7.0											
2	.027	4.0		473	446	3.1	3.8	7.0		6.5			21						
3	.043	4.0						7.0											
4	.027																		
5	.027	4.0						7.0											
6	.030	4.0						7.0											
7	.011	3.5						7.0											
8	.027	4.0						7.0											
9	.025	4.0						7.0											
10	.020	4.0						7.0											
11	.036																		
12	.035	3.5						7.0											
13	.029	4.0						7.1											
14	.014	4.0						7.1											
15	.029	4.0						7.2											
16	.019	4.0						7.2											
17	.024	4.0						7.2											
18	.006	4.0						7.2											
19	.026																		
20	.026	4.0						7.2											
21	.015	4.0						7.2											
22	.025	3.5						7.2											
23	.009	4.0						7.2											
24	.027	4.0						7.2											
25	.016																		
26	.016	4.0						7.2											
27	.013	4.0						7.2											
28	.017	3.5						7.2											
29	.017	2.0						7.2											
30	.004	4.0						7.2											
31																			

Lead Operator: This is to certify that I am familiar with the information contained in this report and that to the best of my knowledge and belief, this information is true, complete and accurate.

Signed: Robert A. Byrd  
 Name (Please Type) Robert A. Byrd  
 Telephone No. C.R.F.

Date: 5/5/98  
 Telephone No. (Please Type) (94) 647-1581



CEA Form 17-501-200(1)  
 Domestic Wastewater Treatment Plant  
 Monthly Operating Report  
 Effective Date July 1, 1998  
 CEA Application No. (Printed in by CEA)

## Domestic Wastewater Treatment Plant Monthly Operating Report

34)

Month MAY Year 1998

Day of the Month	Flow (mgd)	Chlorine Residual after Contact	Chlorine Residual after Dechlorination	CBOD <sub>5</sub> Influent (mg/L)	TSS Influent (mg/L)	CBOD <sub>5</sub> Effluent (mg/L)	TSS Effluent (mg/L)	pH Effluent	TKN Effluent (mg/L)	NH <sub>3</sub> - N Effluent (mg/L)	Nitrate Effluent (mg/L)	Total P Effluent (mg/L)	Fecal Coliform (#/100ml)						
1	.032	4.0						7.2											
2	.013																		
3	.013	4.0						7.2											
4	.017	4.0						7.1											
5	.006	4.0						7.1											
6	.020	4.0						7.1											
7	.013	4.0						7.1											
8	.006	4.0						7.1											
9	.011																		
10	.011	4.0						7.1											
11	.013	4.0						7.0											
12	.009	4.0						7.0											
13	.003	4.0						7.0											
14	.006	4.0		250	340	1.6	1.3	7.0		3.88		<1							
15	.015	4.0						7.0											
16	.010																		
17	.009	4.0						7.0											
18	.009	3.0						7.0											
19	.009	3.0						7.0											
20	.002	4.0						7.0											
21	.009	3.0						7.0											
22	.009	2.0						7.0											
23	.010																		
24	.009	1.5						7.0											
25	.009	3.5						7.2											
26	.008	4.0						7.2											
27	.013	3.5						7.4											
28	.004	4.0						7.2											
29	.015	4.0						7.2											
30	.013	4.0						7.2											
31	.008	4.0						7.2											

Lead Operator: This is to certify that I am familiar with the information contained in this report and that to the best of my knowledge and belief, this information is true, complete, and accurate.

Signed: Robert D. Byrd  
 Name (Please Type) Robert D. Byrd  
 Telephone No. C.R.F.

Date: 6/9/98  
 Telephone No. (Please Type) (941)647-1581

Table of Contents

	<u>Sheet Number</u>
Communities Served Listing .....	4.0
Index of	
Rates and Charges Schedules .....	16.0
Rules and Regulations .....	6.0-6.1
Service Availability Policy .....	31.0
Standard Forms .....	25.0
Technical Terms and Abbreviations .....	5.0-5.1
Territory Served .....	3.0-3.2

Ray Moats  
President of General Partner

## WATER TARIFF

(Continued from Sheet No. 3.0)

DESCRIPTION OF TERRITORY SERVED

Section 25, Township 27 South, Range 26 East, Polk County, Florida

Description of Total Tract

Commence at the Southwest corner of the SE 1/4 of the SW 1/4 of the NE 1/4 of Section 25, Township 27 South, Range 26 East, Polk County, Florida and thence run N89°50'54"E a distance of 366.37 feet to the Point of Beginning; thence run N00°07'52"W a distance of 70.32 feet; thence run S79°37'37"E along the southerly boundary line of U.S. 17-92 (State Road 600) to the intersection of said line with the North boundary line of said South 1/2 of Section 25; thence run S89°50'54"W to the point of Beginning; and

That part of the East 3/4 of the South 1/2 of Section 25, Township 27 South, Range 26 East which lies south of U.S. 17-92 (State Road 600) LESS AND EXCEPT the following tracts of land:

- A. The North 208.71 feet of the easterly 869.6 feet of the NE 1/4 of the SW 1/4 of Section 25.
- B. That certain parcel of land described as follows: commence at the center of Section 25, Township 27 South, Range 26 East; thence run S00°12'09"E along the quarter line a distance of 138.44 feet; thence run S79°38'00"E a distance of 674.55 feet; thence run N00°10'00"W a distance of 261.60 feet; thence run westerly along the North boundary line of the S 1/2 of said Section 25 to the Point of Beginning.
- C. The East 1/4 of the NE 1/4 of the SE 1/4 and West 1/2 of NE 1/4 of NE 1/4 of SE 1/4 of said Section 25.
- D. The South 600. feet of the North 612.93 feet of the West 200. feet of the East 240. feet of the SE 1/4 of the SE 1/4 of said Section 25.

(Continued to Sheet No. 3.2)

Ray Moats  
President of General Partner

WATER TARIFF

(Continued from Sheet No. 3.1)

Section 31, Township 27 South, Range 27 East Plantation Landings  
(percolation pond)

Commence at the Northwest corner of Section 31, Township 27 South, Range 27 East, Polk County, Florida run  $S00^{\circ}00'54''W$ , along the West boundary of said Section 31, a distance of 30.0 feet to the Point of Beginning; thence run  $N89^{\circ}38'18''E$  a distance of 558.0 feet; thence run  $S00^{\circ}16'22''W$ , a distance of 37.81 feet; thence run  $S86^{\circ}35'00''E$ , a distance of 688.0 feet; thence run  $S03^{\circ}00'00''E$ , a distance of 295.0 feet; thence run  $N83^{\circ}07'00''W$ , a distance of 925.0 feet; thence run  $N04^{\circ}25'00''E$ , a distance of 237.0 feet; thence run  $S89^{\circ}38'18''W$ , a distance of 360.0 feet to a point in the West boundary of said Section 31; thence run  $N00^{\circ}03'54''E$ , a distance of 25.0 feet to the Point of Beginning. LESS AND EXCEPT the West 25.0 feet, thereof, for road Right-of-Way of Dyson Road.

Ray Moats  
President of General Partner



WATER TARIFF

(Continued from Sheet No. 6.0)

	<u>Sheet Number</u>	<u>Rule Number</u>
Protection of Company's Property .....	10.0	12.0
Right of Way or Easement .....	11.0	14.0
Signed Application Necessary .....	7.0	3.0
Tax Clause .....	12.0	18.0
Temporary Discontinuance of Service .....	14.0	27.0
Type and Maintenance .....	9.0	9.0
Unauthorized Connections - Water .....	12.0	20.0
Withholding Service .....	8.0	5.0

Ray Moats  
President of General Partner

## WATER TARIFF

(Continued from Sheet No. 7.0)

- 4.0 APPLICATIONS BY AGENTS - Applications for water service requested by firms, partnerships, associations, corporations, and others shall be rendered only by duly authorized parties. When water service is rendered under agreement or agreements entered into between the Company and an agent of the principal, the use of such water service by the principal shall constitute full and complete ratification by the principal of the agreement or agreements entered into between the agent and the Company and under which such water service is rendered.
- 5.0 WITHHOLDING SERVICE - The Company may withhold or discontinue water service rendered under application made by any member or agent of a household, organization, or business unless all prior indebtedness to the Company of such household, organization, or business for water service has been settled in full in accordance with Rule 25-30.320, Florida Administrative Code.
- 6.0 EXTENSIONS - Extensions will be made to the Company's facilities in compliance with Commission Rules and Orders and the Company's tariff.
- 7.0 LIMITATION OF USE - Water service purchased from the Company shall be used by the customer only for the purposes specified in the application for water service and the customer shall not sell or otherwise dispose of such water service supplied by the Company.

Water service furnished to the customer shall be rendered directly to the customer through Company's individual meter and may not be remetered by the customer for the purpose of selling or otherwise disposing of water service to lessees, tenants, or others and under no circumstances shall the customer or customer's agent or any other individual, association or corporation install meters for the purpose of so remetering said water service without the prior written consent of the Utility.

In no case shall a customer, except with the written consent of the Company, extend his lines across a street, alley, lane, court, property line, avenue, or other way

(Continued to Sheet No. 9.0)

Ray Moats  
President of General Partner

## WATER TARIFF

(Continued from Sheet No. 8.0)

in order to furnish water service to the adjacent property through one meter even though such adjacent property may be owned by him. In case of such unauthorized extension, remetering, sale or disposition of service, the customer's water service will be subject to discontinuance until such unauthorized extension, remetering, sale or disposition of service is discontinued and full payment is made to the Company for water service rendered by the Company (calculated on proper classification and rate schedules) and until reimbursement in full is made to the Company for all extra expenses incurred for clerical work, testing, and inspections. (This shall not be construed as prohibiting a Customer from remetering.)

- 8.0 CONTINUITY OF SERVICE - The Company will at all times use reasonable diligence to provide continuous water service, and having used reasonable diligence, shall not be liable to the customer for failure or interruption of continuous water service. The Company shall not be liable for any act or omission caused directly or indirectly by strikes, labor troubles, accidents, litigations, breakdowns, shutdowns for emergency repairs, or adjustments, acts of sabotage, enemies of the United States, Wars, United States, State, Municipal or other governmental interference, acts of God or other causes beyond its control.

If at any time the Company shall interrupt or discontinue its service, all customers affected by said interruption or discontinuance shall be given not less than 24 hours written notice.

- 9.0 TYPE AND MAINTENANCE - The customer's pipes, apparatus and equipment shall be selected, installed, used and maintained in accordance with standard practice, and shall conform with the Rules and Regulations of the Company, and shall comply with all Laws and Governmental Regulations applicable to same. The Company shall not be responsible for the maintenance and operation of the customer's pipes and facilities. The customer expressly agrees not to utilize any appliance or device which is not properly constructed, controlled and protected or which may adversely affect the water service; and the Company reserves the right to discontinue or withhold water to such apparatus or device.

(Continued to Sheet No. 10.0)

Ray Moats  
President of General Partner

WATER TARIFF

INDEX OF RATE AND CHARGES SCHEDULES

	<u>Sheet No.</u>
Customers Deposits .....	21.0-21.1
Fire Protection Service .....	20.0
General Service, GS .....	17.0
Meter Test Deposits .....	22.0
Miscellaneous Service Charges .....	23.0
Multi-Residential Service, MS .....	19.0
Residential Service, RS .....	18.0
Service Availability Fees and Charges .....	24.0

Ray Moats  
President of General Partner

WATER TARIFF

FIRE PROTECTION SERVICE

WATER

AVAILABILITY -

APPLICABILITY -

LIMITATIONS - Subject to all of the Rules and Regulations of this Tariff and General Rules and Regulations of the Commission.

BILLING PERIOD- N/A

RATE - Public Fire Protection - per hydrant  
N/A

Private Fire Protection -

N/A

BASE FACILITY CHARGE -

TERMS OF PAYMENT -

EFFECTIVE DATE -

TYPE OF FILING - Grandfather Certificate

Ray Moats  
President of General Partner

WATER TARIFF

CUSTOMER DEPOSITS

ESTABLISHMENT OF CREDIT - Before rendering water service, the Company may require an applicant for service to satisfactorily establish credit, but such establishment of credit shall not relieve the customer from complying with the Company's Rules for prompt payment. Credit will be deemed so established, in accordance with Rule 25-30.311, Florida Administrative Code, if:

- (A) The applicant for service furnishes a satisfactory guarantor to secure payment of bills for the service requested,
- (B) The applicant pays a cash deposit,
- (C) The applicant for service furnishes an irrevocable letter of credit from a bank or surety bond.

AMOUNT OF DEPOSIT - The amount of initial deposit shall be the following according to meter size:

	<u>Residential</u>	<u>General Service</u>
5/8 x 3/4"	N/A	N/A
1"	N/A	N/A
1 1/2"	N/A	N/A
Over 2"	N/A	N/A

ADDITIONAL DEPOSIT - Under Rule 25-30.311(7), Florida Administrative Code, the Company may require a new deposit, where previously waived or returned, or an additional deposit in order to secure payment of current bills. The Company shall provide the customer with reasonable written notice of not less than thirty (30) days where such request or notice is separate and apart from any bill for service. The total amount of the required deposit shall not exceed an amount equal to the average actual charge for water service for two (2) monthly billing periods for the twelve-month period immediately prior to the date of notice. In the event the customer has had service less than 12 months, the Company shall base its new or additional deposit upon the average actual monthly billing available.

(Continued to Sheet No. 21.1)

Ray Moats  
President of General Partner

## WATER TARIFF

METER TEST DEPOSITS

METER BENCH TEST REQUEST - If any customer requests a bench test of his or her water meter, the Company will require a deposit to defray the cost of testing; such deposit shall not exceed the following schedule of fees and shall be in accordance with Rule 25-30.266, Florida Administrative Code:

<u>METER SIZE</u>	<u>FEE</u>
5/8 x 3/4"	\$20.00
1" and 1 1/2"	\$25.00
2" and over	Actual Cost

REFUND OF METER BENCH TEST DEPOSIT - If the meter is found to register in excess of prescribed accuracy limits pursuant to Rule 25-30.262, Florida Administrative Code, the deposit shall be refunded. If the meter is found to register accurately or below such prescribed accuracy limits, the deposit shall be retained by the Company as a service charge for conducting the meter test.

METER FIELD TEST REQUEST - Upon written request of any customer, the Company shall, without charge, make a field test of the accuracy of the water meter in use at the customer's premises provided that the meter has not been tested within one-half the maximum interval allowed under Rule 25-30.265, Florida Administrative Code.

EFFECTIVE DATE -

TYPE OF FILING - Grandfather Certificate

Ray Moats  
President of General Partner

WATER TARIFF

SERVICE AVAILABILITY FEES AND CHARGES

<u>DESCRIPTION</u>	<u>AMOUNT</u>	<u>SHEET NUMBER</u>
<u>Back-Flow Preventer Installation Fee</u>		
5/8 x 3/4" .....	\$	
1" .....	\$	
1 1/2" .....	\$	
2" .....	\$	
Over 2" .....	Actual Cost	[1]
<u>Customer Connection (Tap-in) Charge</u>		
5/8 x 3/4" metered service .....	\$	
1" metered service .....	\$	
1 1/2" metered service .....	\$	
2" metered service .....	\$	
Over 2" metered service .....	Actual Cost	[1]
<u>Guaranteed Revenue Charge</u>		
With Prepayment of Service Availability Charges:		
Residential-per ERC/month (___)GPD .....	\$	
All others-per gallon/month .....	\$	
Without Prepayment of Service Availability Charges:		
Residential-per ERC/month (___)GPD .....	\$	
All others-per gallon/month .....	\$	
<u>Inspection Fee</u> .....	Actual Cost	[1]
<u>Main Extension Charge</u>		
Residential-per ERC (___)GPD .....	\$	
All others-per gallon .....	\$	
or		
Residential-per lot (___ foot frontage) ....	\$	
All others-per front foot .....	\$	
<u>Meter Installation Fee</u>		
5/8 x 3/4" .....	\$	
1" .....	\$	
1 1/2" .....	\$	
2" .....	\$	
Over 2" .....	\$	
<u>Plan Review Charge</u> .....	Actual Cost	[1]
<u>Plant Capacity Charge</u>		
Residential-per ERC (___)GPD .....	\$	
All others-per gallon .....	\$	
<u>System Capacity Charge</u>		
Residential-per ERC (___)GPD .....	\$	
All others-per gallon .....	\$	

[1] Actual Cost is equal to the total cost incurred for services rendered by a customer.

EFFECTIVE DATE -

TYPE OF FILING - Grandfather Certificate

Ray Moats  
President of General Partner



WATER TARIFF

APPLICATION FOR WATER SERVICE

PLANTATION LANDINGS MOBILE HOME PARK  
LEASE AGREEMENT

THIS LEASE made and entered into this \_\_\_\_\_ day of \_\_\_\_\_, 19 \_\_\_\_\_, by and between \_\_\_\_\_, hereinafter called the Community and \_\_\_\_\_, hereinafter called the Owner-tenant.

WITNESSETH, that in consideration of the covenants herein contained, on the part of the said Owner-tenant to be kept and performed, the said Community does hereby lease to the said Owner-tenant the following described property: Street \_\_\_\_\_ Lot No. \_\_\_\_\_.

TO HAVE AND TO HOLD the same from the \_\_\_\_\_ day of \_\_\_\_\_, 19 \_\_\_\_\_, until the 31st day of December 19 \_\_\_\_\_, the said Owner-tenant paying the initial monthly base rental of \$ \_\_\_\_\_ from the beginning of this Lease until the 31st day of December, 19 \_\_\_\_\_. Annual monthly base rental increases for calendar years 19 \_\_\_\_\_ and subsequent years will be based on no less than \$ 5.00 or the increase in the Consumer Price Index (defined as the United States Department of Labor Consumer Price Index, U. S. City Average, All Urban Consumers, 1967 equals 100) ("CPI"), whichever is greater. Lease renewals and increases will become effective the first day of January of each year thereafter and will be a part of the Lease agreement for that year.

Base rent will also be increased in calendar years subsequent to the initial year by any increase in real estate or other taxes and assessments by a state or local government. Such increase in taxes and assessments will be based on a prorata computation among all lots in the mobile home park and will be charged to all residents to whom this Prospectus is applicable. The mobile home owner shall be notified of the increase in base rent at least ninety (90) days prior to the increase.

Rental payments are due on or before the 1st day of each month for that month, at the place designated by the Community.

The Owner-tenant covenants and agrees to the following:

1. To make no unlawful, improper, or offensive use of the property.
2. To comply with the Rules & Regulations of the park. A copy of said Rules & Regulations has been furnished to the Owner-tenant.
3. That the Lease is governed by Chapter 723, Florida Statutes (Florida Mobile Home Act) as currently in effect at the time of execution of this document, the provisions of which are incorporated herein by reference.

(Continued to Sheet No. 27.1)

Ray Moats  
President of General Partner

WATER TARIFF

(Continued from Sheet No. 27.0)

4. Actions by the Owner-tenant which constitute grounds for eviction under Section 723.061, Florida Statutes, shall be a violation of this Lease. Failure of the Community to evict a tenant for violation of any one of the grounds set forth in Section 723.061, Florida Statutes, or for any grounds provided for in this Lease, shall not waive the right for the Community to consider any subsequent violation of the same grounds, or the violation of any other grounds, a breach of this Lease by Owner-tenant so long as permitted by Chapter 723, Florida Statutes.

5. As provided in the Rules & Regulations, rules and regulations may be modified, eliminated, or additional rules and regulations adopted by the Community upon giving the Owner-tenant notice thereof as required by law and said Rules & Regulations in accordance with Chapter 723, Florida Statutes.

6. This Lease and the privileges contained herein are not assignable, and said Lease is only valid as long as those executing this Lease reside upon the premises set forth in this Lease, and are in full conformance of all provisions of this Lease and the park Rules & Regulations, except that a new home owner may assume in writing the balance of the annual Lease through December 31 of the year of purchase in accordance with Chapter 723, Florida Statutes.

7. Owner-tenant expressly understands and agrees that, upon execution of this Lease, all prior leases, rental agreements, negotiations, and other agreements between the parties regarding the lot leased are hereby terminated, void, and of no legal force and effect.

8. Other financial obligations of the Owner-tenant, not including any user fees, are as follows:

	<u>Fees or Charges</u>
Water and Sewage	\$ <u>12.57</u> minimum per month \$ <u>1.26</u> excess per month (each 1,000 gallons in excess of 3,000 gallons)
Yard Maintenance (not charged unless Owner-tenant fails to maintain yard)	\$ <u>20.00</u> per cut
Tree Trimming/Removal, Debris Removal (not charged unless Owner-tenant fails to provide services himself)	\$ <u>billed amount</u>
Late Check Charge	\$ <u>1.50</u> per day
Bad Check Charge	\$ <u>15.00</u>
Extra Resident Fee	\$ <u>10.00</u>
Debris Removal	charged in accordance with Section VIII(K) of the Prospectus

(Continued to Sheet No. 27.2)

Ray Moats  
President of General Partner

WATER TARIFF

(Continued from Sheet No. 27.1)

Governmental Assessments, Fees,  
Surcharges, and Charges

charged in accordance with Section VIII(J)  
of the Prospectus

Garbage disposal,  
cable television, and electricity

Paid direct by home owner to company  
providing service

The fees will be charged and increased as set out in Sections VIII(F) through (K) of the Prospectus.

9. The Community reserves the right to pass on and pass through charges in accordance with the Prospectus and Chapter 723, Florida Statutes.

10. Owner-tenant(s) acknowledge that they have read the foregoing, the Rules & Regulations, and the Prospectus, and that Owner-tenant was offered the foregoing Lease prior to occupancy.

We have read and understand this agreement and agree to the terms set out herein.

WITNESS our hands and seals of the date set out above.

\_\_\_\_\_  
Owner-tenant

\_\_\_\_\_  
Community Representative

\_\_\_\_\_  
Owner-tenant

Ray Moats  
President of General Partner

PLANTATION LANDINGS, LTD.

ORIGINAL SHEET NO. 29.0

WATER TARIFF

COPY OF CUSTOMER'S BILL

PLANTATION LANDINGS	FORWARDING & ADDRESS
PO BOX 5252 • LAKE LAND, FL 33807-5252	CORRECTION REQUESTED
UTILITY INQUIRIES CALL (941) 647-1501	REQUEST UTILITY BILLING DEPT.

DATE OF METER READING	METER READING		USED	CHARGES
	THIS PERIOD	PREVIOUS		

PLEASE BRING THIS ENTIRE BILL TO OFFICE OR MAIL THIS STUB WITH YOUR PAYMENT.

METER READ		CLASS	AMOUNT TO BE PAID	AMOUNT TO BE PAID
MONTH	DAY			

CUSTOMER		PLEASE REMIT BY THIS DATE
ROUTE	ACCOUNT	

Ray Moats  
President of General Partner

WASTEWATER TARIFF

Table of Contents

	<u>Sheet Number</u>
Communities Served Listing .....	4.0
Index of	
Rates and Charges Schedules .....	16.0
Rules and Regulations .....	6.0-6.1
Service Availability Policy .....	27.0
Standard Forms .....	23.0
Technical Terms and Abbreviations .....	5.0-5.1
Territory Served .....	3.0-3.2

Ray Moats  
 President of General Partner

## WASTEWATER TARIFF

(Continued from Sheet No. 3.0)

DESCRIPTION OF TERRITORY SERVED

Section 25, Township 27 South, Range 26 East, Polk County, Florida

Description of Total Tract

Commence at the Southwest corner of the SE 1/4 of the SW 1/4 of the NE 1/4 of Section 25, Township 27 South, Range 26 East, Polk County, Florida and thence run N89°50'54"E a distance of 366.37 feet to the Point of Beginning; thence run N00°07'52"W a distance of 70.32 feet; thence run S79°37'37"E along the southerly boundary line of U.S. 17-92 (State Road 600) to the intersection of said line with the North boundary line of said South 1/2 of Section 25; thence run S89°50'54"W to the point of Beginning; and

That part of the East 3/4 of the South 1/2 of Section 25, Township 27 South, Range 26 East which lies south of U.S. 17-92 (State Road 600) LESS AND EXCEPT the following tracts of land:

- A. The North 208.71 feet of the easterly 869.6 feet of the NE 1/4 of the SW 1/4 of Section 25.
- B. That certain parcel of land described as follows: commence at the center of Section 25, Township 27 South, Range 26 East; thence run S00°12'09"E along the quarter line a distance of 138.44 feet; thence run S79°38'00"E a distance of 674.55 feet; thence run N00°10'00"W a distance of 261.60 feet; thence run westerly along the North boundary line of the S 1/2 of said Section 25 to the Point of Beginning.
- C. The East 1/4 of the NE 1/4 of the SE 1/4 and West 1/2 of NE 1/4 of NE 1/4 of SE 1/4 of said Section 25.
- D. The South 600. feet of the North 612.93 feet of the West 200. feet of the East 240. feet of the SE 1/4 of the SE 1/4 of said Section 25.

(Continued to Sheet No. 3.2)

Ray Moats  
President of General Partner

WASTEWATER TARIFF

(Continued from Sheet No. 3.1)

Section 31, Township 27 South, Range 27 East Plantation Landings  
(percolation pond)

Commence at the Northwest corner of Section 31, Township 27 South, Range 27 East, Polk County, Florida run  $S00^{\circ}0.'54''W$ , along the West boundary of said Section 31, a distance of 30.0 feet to the Point of Beginning; thence run  $N89^{\circ}38'18''E$  a distance of 558.0 feet; thence run  $S00^{\circ}16'22''W$ , a distance of 37.81 feet; thence run  $S86^{\circ}35'00''E$ , a distance of 688.0 feet; thence run  $S03^{\circ}00'00''E$ , a distance of 295.0 feet; thence run  $N83^{\circ}07'00''W$ , a distance of 925.0 feet; thence run  $N04^{\circ}25'00''E$ , a distance of 237.0 feet; thence run  $S89^{\circ}38'18''W$ , a distance of 360.0 feet to a point in the West boundary of said Section 31; thence run  $N00^{\circ}03'54''E$ , a distance of 25.0 feet to the Point of Beginning. LESS AND EXCEPT the West 25.0 feet, thereof, for road Right-of-Way of Dyson Road.

Ray Moats  
President of General Partner

## WASTEWATER TARIFF

(Continued from Sheet No. 5.0)

- 10.0 "POINT OF COLLECTION" - For wastewater systems, "Point of Collection" shall mean the point at which the Company's piping, fittings, and valves connect with the customer's piping, fittings, and valves.
- 11.0 "RATE SCHEDULE" - The rate(s) or charge(s) for a particular classification of service plus the several provisions necessary for billing, including all special terms and conditions under which service shall be furnished at such rate or charge.
- 12.0 "SERVICE" - Service, as mentioned in this tariff and in agreement with customers, shall be construed to include, in addition to all wastewater service required by the customer the readiness and ability on the part of the Company to furnish wastewater service to the customer. Service shall conform to the standards set for in Section 367.111 of the Florida Statutes.
- 13.0 "SERVICES LINES" - The pipe between the Company's mains and the point of collection which includes all the pipe, fittings and valves necessary to make the connection to the customer's premises.
- 14.0 "TERRITORY" - The geographical area described by metes and bounds with township, range and section in a certificate, which may be within or without the boundaries of an incorporated municipality, and may include areas in more than one county.

Ray Moats  
President of General Partner



## WASTEWATER TARIFF

INDEX OF RULES AND REGULATIONS

	<u>Sheet Number</u>	<u>Rule Number</u>
Access to Premises .....	10.0	13.0
Adjustment of Bills .....	13.0	21.0
Applications by Agents .....	7.0	4.0
Billing Periods .....	11.0	15.0
Change of Customer's Installation .....	9.0	10.0
Change of Occupancy .....	12.0	19.0
Continuity of Service .....	9.0	8.0
Delinquent Bills .....	11.0	16.0
Evidence of Consumption .....	13.0	23.0
Extensions .....	8.0	6.0
Filing of Contracts .....	13.0	22.0
General Information .....	7.0	2.0
Held for Future Use .....	14.0-15.0	
Inspection of Customer's Installation .....	10.0	11.0
Limitation of Use .....	8.0	7.0
Payment of Wastewater and Water Service Bills Concurrently .....	11.0	17.0
Policy Dispute .....	7.0	1.0
Protection of Company's Property .....	10.0	12.0
Right of Way or Easements .....	10.0	14.0
Signed Application Necessary .....	7.0	3.0

(Continued to Sheet No. 6.1)

Ray Moats  
President of General Partner

WASTEWATER TARIFF

(Continued for Sheet No. 6.0)

	<u>Sheet Number</u>	<u>Rule Number</u>
Tax Clause .....	12.0	18.0
Temporary Discontinuance of Service .....	13.0	23.1
Type and Maintenance .....	9.0	9.0
Unauthorized Connections - Wastewater .....	12.0	20.0
Withholding Service .....	8.0	5.0

Ray Moats  
President of General Partner

## WASTEWATER TARIFF

RULES AND REGULATIONS

- 1.0 POLICY DISPUTE - Any dispute between the Company and the customer or prospective customer regarding the meaning or application of any provision this tariff shall upon written request by either party be resolved by the Florida Public Service Commission.
- 2.0 GENERAL INFORMATION - The Company's Rules and Regulations insofar as they are inconsistent with any Statute, Law, Rule or Commission Order shall be null and void. These Rules and Regulations are a part of the rate schedules and applications and contracts of the Company, and in the absence of specific written agreement to the contrary, apply without modification or change to each and every customer to whom the Company renders wastewater service.

In the event that a portion of these Rules and Regulations are declared unconstitutional or void for any reason by any court of competent jurisdiction, such decision shall in no way affect the validity of the remaining portions of the Rules and Regulations for wastewater service unless such court order or decision shall so direct.

The Company shall provide to all customers requiring such service within the territory described in its certificate upon such terms as are set forth in this tariff pursuant to Chapter 25-9 and 25-30, Florida Administrative Code, and Chapter 367, Florida Statutes.

- 3.0 SIGNED APPLICATION NECESSARY - Wastewater service is furnished only after a signed application or agreement and payment of the initial connection fee are accepted by the Company. The conditions of such application or agreement are binding upon the customer as well upon the Company. A copy of the application or agreement for wastewater service accepted by the Company will be furnished to the applicant on request.

The applicant shall furnish to the Company the correct name and street address or lot and block number at which wastewater service is to be rendered.

- 4.0 APPLICATIONS BY AGENTS - Applications for wastewater service requested by firms, partnerships, associations, corporations, and others shall be rendered only by duly

(Continued to Sheet No. 8.0)

Ray Moats  
President of General Partner

## WASTEWATER TARIFF

(Continued from Sheet No. 7.0)

authorized parties. When wastewater service is rendered under agreement or agreements entered into between the Company and an agent of the principal, the use of such wastewater service by the principal or agent shall constitute full and complete ratification by the principal of the agreement or agreements entered into between agent and the Company and under which such wastewater service is rendered.

- 5.0 WITHHOLDING SERVICE - The Company may withhold or discontinue wastewater service rendered under application made by any member or agent of a household, organization, or business unless all prior indebtedness to the Company of such household, organization, or business for wastewater service has been settled in full in accordance with Rule 25-30.320, Florida Administrative Code.
- 6.0 EXTENSIONS - Extensions will be made to the Company's facilities in compliance with Commission Rules and Orders and the Company's tariff.
- 7.0 LIMITATION OF USE - Wastewater service purchased from the Company shall be used by the consumer only for the purposes specified in the application for wastewater service. Wastewater service rendered to the customer for the consumer's own use and shall be collected directly into the Company's main wastewater lines.

In no case shall a customer, except with the written consent of the Company, extend his lines across a street, alley, lane, court, property line, avenue, or other way in order to furnish wastewater service to the adjacent property even though such adjacent property may be owned by him. In case of such unauthorized extension, remetering, sale, or disposition of service, the consumer's wastewater service will be is subject to discontinuance until such unauthorized extension, remetering, sale, or disposition of service discontinued and full payment is made to the Company for wastewater service rendered by the Company (calculated on proper classifications and rate schedules)

(Continued to Sheet No. 9.0)

Ray Moats  
President of General Partner

## WASTEWATER TARIFF

(Continued from Sheet No. 8.0)

and until reimbursement in full made to the Company for all extra expenses incurred for clerical work, testing, and inspections. (This shall not be construed as prohibiting a Customer from remetering.)

- 8.0 CONTINUITY OF SERVICE - The Company will at all times use reasonable diligence to provide continuous wastewater service, and having used reasonable diligence, shall not be liable to the customer for failure or interruption of continuous wastewater service. The Company shall not be liable for any act or omission caused directly or indirectly by strikes, labor troubles, accidents, litigations, breakdowns, shutdowns for emergency repairs, or adjustments, acts of sabotage, enemies of the United States, Wars, United States, State, Municipal or other governmental interference, acts of God or other causes beyond its control.

If at any time the Company shall interrupt or discontinue its service, all customers affected by said interruption or discontinuance shall be given not less than twenty-four (24) hours written notice.

- 9.0 TYPE AND MAINTENANCE - The customer's pipes, apparatus and equipment shall be selected, installed, used and maintained in accordance with standard practice and shall conform with the Rules and Regulations of the Company and shall comply with all Laws and Governmental Regulations applicable to same. The Company shall not be responsible for the maintenance and operation of the customer's pipes and facilities. The customer expressly agrees not to utilize any appliance or device which is not properly constructed, controlled and protected, or which may adversely affect the wastewater service; the Company reserves the right to discontinue or withhold wastewater service to such apparatus or device.
- 10.0 CHANGE OF CUSTOMER'S INSTALLATION - No changes or increases in customer's installation, which will materially affect the proper operation of the pipes, mains, or stations of the Company, shall be made without written consent of the Company. The customer shall be liable for any change resulting from a violation of this Rule.

(Continued to Sheet No. 10.0)

Ray Moats  
President of General Partner

## WASTEWATER TARIFF

(Continued from Sheet No. 9.0)

- 11.0 INSPECTION OF CUSTOMER'S INSTALLATION - All Customer's wastewater service installations or changes shall be inspected upon completion by a competent authority to ensure that customer's piping, equipment, and devices have been installed in accordance with accepted standard practice and local Laws and Governmental Regulations. Where Municipal or other Governmental inspection is required by local Rules and Ordinances, the Company cannot render wastewater service until such inspection has been made and a formal notice of approval from the inspecting authority has been received by the Company.

Notwithstanding the above, the Company reserves the right to inspect the customer's installation prior to rendering wastewater service, and from time to time thereafter, but assumes no responsibility whatsoever for any portion thereof.

- 12.0 PROTECTION OF COMPANY'S PROPERTY - The customer shall exercise reasonable diligence to protect the Company's property on the customer's premises and shall knowingly permit no one, but the Company's agents or persons authorized by law, to have access to the Company's pipes and apparatus.

In the event of any loss or damage to property of the Company caused by or arising out of carelessness, neglect, or misuse by the customer, the cost of making good such loss or repairing such damage shall be paid by the customer.

- 13.0 ACCESS TO PREMISES - The duly authorized agents of the Company shall have access at all reasonable hours to the premises of the customer for the purpose of installing, maintaining, inspecting, or removing the Company's property or for performance under or termination of the Company's agreement with the customer and under such performance shall not be liable for trespass.

- 14.0 RIGHT OF WAY OR EASEMENTS - The customer shall grant or cause to be granted to the Company, and without cost to the Company, all rights, easements, permits, and privileges which are necessary for the rendering of wastewater service.

(Continued to Sheet No. 11.0)

Ray Moats  
President of General Partner

## WASTEWATER TARIFF

(Continued from Sheet No. 10.0)

- 15.0 BILLING PERIODS - Bills for wastewater service will be rendered monthly as stated in the rate schedule and shall become due when rendered and be considered as received by the customer when delivered or mailed to the wastewater service address or some other place mutually agreed upon. Non-receipt of bills by the customer shall not release or diminish the obligation of the customer with respect to payment thereof.
- 16.0 DELINQUENT BILLS - Bills are due when rendered. However, the Company shall not consider the customer delinquent in paying any bill until the twenty-first (21) day after the Company has mailed or presented the bill to the customer for payment. Wastewater service may then be discontinued only after the Company has mailed or presented within five (5) working days a written notice to the customer in accordance with Rule 25-30.320, Florida Administrative Code. Wastewater service shall be restored only after the Company has received payment for all past-due bills and reconnect charges from the customer.

There shall be no liability of any kind against the Company for the discontinuance of wastewater service to a customer for that customer's failure to pay the bills on time.

Partial payment of any bill for wastewater service rendered will not be accepted by the Company, except by the Company's agreement thereof or by direct order from the Commission.

- 17.0 PAYMENT OF WASTEWATER AND WATER SERVICE BILLS CONCURRENTLY - When both wastewater and water service are provided by the Company, payment of any wastewater service bill rendered by the Company to a customer shall not be accepted by the Company without the simultaneous or concurrent payment of any water service bill rendered by the Company. The Company may discontinue both wastewater service and water service to the customer's premises for non-payment of the wastewater service bill or water service bill or if payment is not made concurrently. The Company shall not re-establish or reconnect wastewater service and/or water service until such time as all wastewater and water service bills and all charges are paid.

(Continued to Sheet No. 12.0)

Ray Moats  
President of General Partner

## WASTEWATER TARIFF

(Continued from Sheet No. 11.0)

- 18.0 TAX CLAUSE - A municipal or county franchise tax levied upon a wastewater or water public utility shall not be incorporated into the rate for wastewater or water service but shall be shown as a separate item on the utility's bills to its customers in such Municipality or County.
- 19.0 CHANGE OF OCCUPANCY - When a change of occupancy takes place on any premises supplied by the Company with wastewater service, written notice thereof shall be given at the office of the Company not less than three (3) days prior to the date of change by the outgoing Customer. The outgoing customer shall be held responsible for all wastewater service rendered on such premises until such written notice is so received by the Company and the Company has had reasonable time to discontinue the wastewater service. However, if such written notice has not been received, the application of a succeeding occupant for wastewater service will automatically terminate the prior account. The customer's deposit may be transferred from one service location to another, if both locations are supplied wastewater service by the Company; the customer's deposit may not be transferred from one name to another.

Notwithstanding the above, the Company will accept telephone orders, for the convenience of its customers, to discontinue or transfer wastewater service from one service address to another and will use all reasonable diligence in the execution thereof. However, oral orders or advice shall not be deemed binding or be considered formal notification to the Company.

- 20.0 UNAUTHORIZED CONNECTIONS - WASTEWATER - Connections to the Company's wastewater system for any purpose whatsoever are to be made only by employees of the Company. Any unauthorized connections to the customer's wastewater service shall be subject to immediate discontinuance without notice. Wastewater service shall not be restored until such unauthorized connections have been removed and until settlement is made in full to the Company for all wastewater service estimated by the Company to have been used by reason of such unauthorized connection.

(Continued to Sheet No. 13.0)

Ray Moats  
President of General Partner



## WASTEWATER TARIFF

(Continued from Sheet No. 12.0)

- 21.0 ADJUSTMENT OF BILLS - When a customer has been overcharged or undercharged as a result of incorrect application of the rate schedule, incorrect reading of a water meter, or similar reasons, the amount may be credited or billed to the customer in accordance with Rule 25-30.340 and 25-30.350, Florida Administrative Code.
- 22.0 FILING OF CONTRACTS - Whenever a Developer Agreement or Contract, Guaranteed Revenue Contract, or Special Contract or Agreement is entered into by the Company for the sale of its product or services in a manner not specifically covered by its Rules and Regulations or approved Rate Schedules, a copy of such contracts or agreements shall be filed with the Commission prior to its execution in accordance with Rules 25-9.034 and Rule 25-30.550, Florida Administrative Code. If such contracts or agreements are approved by the Commission, a conformed copy shall be placed on file with the Commission prior to its effective date.
- 23.0 EVIDENCE OF CONSUMPTION - The initiation or continuation or resumption of water service to the customer's premises shall constitute the initiation or continuation or resumption of wastewater service to the customer's premises regardless of occupancy.
- 23.1 TEMPORARY DISCONTINUANCE OF SERVICE - At any time a customer may request a temporary discontinuance of service in order to insure that customer is not billed for any wastewater usage during the period of time in which that premises is not occupied or otherwise utilized. The customer will, however, be liable for payment of the base facility charge during the entire period of time the temporary disconnect remains in effect, in order for the Company to be able to recover its fixed cost of having wastewater service available to those premises upon request by the customer.

Ray Moats  
President of General Partner

PLANTATION LANDINGS, LTD.

ORIGINAL SHEET NO. 14.0

WASTEWATER TARIFF

HELD FOR FUTURE USE

Ray Moats  
President of General Partner

PLANTATION LANDINGS, LTD.

ORIGINAL SHEET NO. 15.0

WASTEWATER TARIFF

HELD FOR FUTURE USE

Ray Moats  
President of General Partner

WASTEWATER TARIFF

INDEX OF RATES AND CHARGES SCHEDULES

	<u>Sheet No.</u>
Customer Deposits .....	20.0-20.1
General Service, GS .....	17.0
Miscellaneous Service Charges .....	21.0
Multi-Residential Service, MS .....	19.0
Residential Service, RS .....	18.0
Service Availability Fees and Charges .....	22.0

Ray Moats  
President of General Partner

WASTEWATER TARIFF

GENERAL SERVICE

RATE SCHEDULE GS

- AVAILABILITY - Available throughout the area serviced by the Company.
- APPLICABILITY - For water service to all customers for which no other schedule applies.
- LIMITATIONS - Subject to all of the Rules and Regulations of this tariff and General Rules and Regulations of the Commission.
- BILLING PERIOD- N/A
- RATE - N/A

MINIMUM BILL - N/A

TERMS OF PAYMENT - Bills are due and payable when rendered and become delinquent if not paid within twenty (20) days. After five (5) working days' written notice is mailed to the customer separate and apart from any other bill, service may then be discontinued.

EFFECTIVE DATE -

TYPE OF FILING - Grandfather Certificate

Ray Moats  
President of General Partner

WASTEWATER TARIFF

RESIDENTIAL SERVICE

RATE SCHEDULE RS

- AVAILABILITY - Available throughout the area served by the Company.
- APPLICABILITY - For water and wastewater service for all purposes in private residences and individually metered apartment units
- LIMITATIONS - Subject to all of the Rules and Regulations of this tariff and General Rules and Regulations of the Commission.

BILLING PERIOD- Monthly

RATE - Water and Wastewater for 5/8x3/4" Meters:

Up to 3,000 gallons	\$12.00
per 1,000 gal. over 3,000	\$ 1.20

MINIMUM BILL - \$12.00

TERMS OF PAYMENT - Bills are due and payable when rendered and become delinquent if not paid within twenty (20) days. After five (5) working days' written notice is mailed to the customer separate and apart from any other bill, service may then be discontinued.

EFFECTIVE DATE -

TYPE OF FILING - Grandfather Certificate

Ray Moats  
President of General Partner

WASTEWATER TARIFF

MULTI-RESIDENTIAL SERVICE

RATE SCHEDULE MS

AVAILABILITY - Available throughout the Sumter County systems.

APPLICABILITY - For wastewater service to all master-metered residential customers including, but not limited to, Condominiums, Apartments, and Mobile Home Parks.

LIMITATIONS - Subject to all of the Rules and Regulations of this tariff and General Rules and Regulations of the Commission.

BILLING PERIOD - Monthly

RATE - Per Unit

Base Facilities Charge

All meter sizes N/A

Gallonge Charge per  
1,000 gallons N/A

BASE FACILITY CHARGE - N/A

TERMS OF PAYMENT - Bills are due and payable when rendered and become delinquent if not paid within twenty (20) days. After five (5) working days' written notice is mailed to the customer separate and apart from any other bill, service may then be discontinued.

EFFECTIVE DATE -

TYPE OF FILING -

Ray Moats  
President of General Partner

WASTEWATER TARIFF

CUSTOMER DEPOSITS

ESTABLISHMENT OF CREDIT - Before rendering wastewater service, the Company may require an applicant for service to satisfactorily establish credit, but such establishment of credit shall not relieve the customer from complying with the Company's Rules for prompt payment. Credit will be deemed so established, in accordance with Rule 25-30.311, Florida Administrative Code, if:

- (A) The applicant for service furnishes a satisfactory guarantor to secure payment of bills for the service requested,
- (B) The applicant pays a cash deposit,
- (C) The applicant for service furnishes an irrevocable letter of credit from a bank or surety bond.

AMOUNT OF DEPOSIT - The amount of initial deposit shall be the following according to meter size:

	<u>Residential</u>	<u>General Service</u>
5/8 x 3/4"	N/A	N/A
1"	N/A	N/A
1 1/2"	N/A	N/A
Over 2"	N/A	N/A

ADDITIONAL DEPOSIT - Under Rule 25-30.311(7), Florida Administrative Code, the Company may require a new deposit, where previously waived or returned, or an additional deposit in order to secure payment of current bills. The Company shall provide the customer with reasonable written notice of not less than thirty (30) days where such request or notice is separate and apart from any bill for service. The total amount of the required deposit shall not exceed an amount equal to the average actual charge for wastewater service for two (2) monthly billing periods for the twelve-month period immediately prior to the date of notice. In the event the customer has had service less than 12 months, the Company shall base its new or additional deposit upon the average actual monthly billing available.

(Continued to Sheet No. 20.1)

Ray Moats  
President of General Partner



## WASTEWATER TARIFF

(Continued from Sheet No. 20.0)

INTEREST ON DEPOSIT - The Company shall pay interest on customer deposits pursuant to Rule 25-30.311(4)(a). The rate of interest is six percent (6%) per annum. The payment of interest shall be made once each year as a credit on regular bills or when service is discontinued as a credit on final bills. No customer depositor will receive interest on his or her deposit until a customer relationship and the deposit have been in existence for at least six (6) months. At such time, the customer depositor shall be entitled to receive interest from the day of the commencement of the customer relationship and placement of the deposit. The Company will pay or credit accrued interest to the customer's account during the month of     N/A     each year.

REFUND OF DEPOSIT - After a residential customer has established a satisfactory payment record and has had continuous service for a period of twenty-three (23) months, the Company shall refund the customer's deposit provided the customer has not, in the preceding twelve (12) months:

- (a) made more than one late payment of the bill (after the expiration of twenty (20) days from the date of mailing or delivery by the Company),
- (b) paid with a check refused by a bank,
- (c) been disconnected or non-payment, or
- (d) at any time tampered with the meter or used service in a fraudulent or unauthorized manner.

Notwithstanding the above, the Company may hold the deposit of a non-residential customer after a continuous service period of twenty-three (23) months and shall pay interest on the non-residential customer's deposit at the rate of seven percent (7%) per annum upon retainment of such deposit.

Nothing in this rule shall prohibit the Company from refunding a customer's deposit in less than twenty-three (23) months.

EFFECTIVE DATE -

TYPE OF FILING - Grandfather Certificate

Ray Moats  
President of General Partner

## WASTEWATER TARIFF

MISCELLANEOUS SERVICE CHARGES

The company may charge the following miscellaneous service charges in accordance with the terms stated herein. If both water and wastewater services are provided, only a single charge is appropriate unless circumstances beyond the control of the Company require multiple actions.

INITIAL CONNECTION - This charge would be levied for service initiation at a location where service did not exist previously.

NORMAL RECONNECTION - This charge would be levied for transfer of service to a new customer account at a previously served location or reconnection of service subsequent to a customer requested disconnection.

VIOLATION RECONNECTION - This charge would be levied prior to reconnection of an existing customer after disconnection of service for cause according to Rule 25-30.320(2), Florida Administrative Code, including a delinquency in bill payment.

PREMISES VISIT CHARGE (IN LIEU OF DISCONNECTION) - This charge would be levied when a service representative visits a premises for the purpose of discontinuing service for nonpayment of a due and collectible bill and does not discontinue service because the customer pays the service representative or otherwise makes satisfactory arrangements to pay the bill.

Schedule of Miscellaneous Service Charges

Initial Connection	N/A
Normal Reconnection	N/A
Violation Reconnection	N/A
Premises Visit (in lieu of disconnection)	N/A

[1] Actual cost is equal to the total cost incurred for services.

EFFECTIVE DATE -

TYPE OF FILING - Grandfather Certificate

Ray Moats  
President of General Partner

WASTEWATER TARIFF

SERVICE AVAILABILITY FEES AND CHARGES

<u>DESCRIPTION</u>	<u>AMOUNT</u>	<u>SHEET NUMBER</u>
<u>Customer Connection (Tap-in) Charge</u>		
5/8 x 3/4" metered service .....	\$	
1" metered service .....	\$	
1 1/2" metered service .....	\$	
2" metered service .....	\$	
Over 2" metered service .....	Actual Cost	[1]
<u>Guaranteed Revenue Charge</u>		
With Prepayment of Service Availability Charges:		
Residential-per ERC/month (___)GPD .....	\$	
All others-per gallon/month .....	\$	
Without Prepayment of Service Availability Charges:		
Residential-per ERC/month (___)GPD .....	\$	
All others-per gallon/month .....	\$	
Inspection Fee .....	Actual Cost	[1]
<u>Main Extension Charge</u>		
Residential-per ERC (___)GPD .....	\$	
All others-per gallon .....	\$	
or		
Residential-per lot (___ foot frontage) ....	\$	
All others-per front foot .....	\$	
Plan Review Charge .....	Actual Cost	[1]
<u>Plant Capacity Charge</u>		
Residential-per ERC (___)GPD .....	\$	
All others-per gallon .....	\$	
<u>System Capacity Charge</u>		
Residential-per ERC (___)GPD .....	\$	
All others-per gallon .....	\$	

[1] Actual Cost is equal to the total cost incurred for services rendered by a customer.

EFFECTIVE DATE -

TYPE OF FILING -

Ray Moats  
President of General Partner

WASTEWATER TARIFF

INDEX OF STANDARD FORMS

	<u>Sheet No.</u>
APPLICATION FOR WASTEWATER SERVICE.....	25.0
COPY OF CUSTOMER'S BILL .....	26.0
CUSTOMER'S GUARANTEE DEPOSIT RECEIPT .....	24.0

Ray Moats  
President of General Partner

PLANTATION LANDINGS, LTD.

ORIGINAL SHEET NO. 24.0

WASTEWATER TARIFF

CUSTOMER'S GUARANTEE DEPOSIT RECEIPT

N/A

Ray Moats  
President of General Partner

WASTEWATER TARIFF

APPLICATION FOR WASTEWATER SERVICE

PLANTATION LANDINGS MOBILE HOME PARK  
LEASE AGREEMENT

THIS LEASE made and entered into this \_\_\_\_\_ day of \_\_\_\_\_, 19 \_\_\_\_\_, by and between \_\_\_\_\_, hereinafter called the Community and \_\_\_\_\_, hereinafter called the Owner-tenant.

WITNESSETH, that in consideration of the covenants herein contained, on the part of the said Owner-tenant to be kept and performed, the said Community does hereby lease to the said Owner-tenant the following described property: Street \_\_\_\_\_ Lot No. \_\_\_\_\_.

TO HAVE AND TO HOLD the same from the \_\_\_\_\_ day of \_\_\_\_\_, 19 \_\_\_\_\_, until the 31st day of December 19 \_\_\_\_\_, the said Owner-tenant paying the initial monthly base rental of \$ \_\_\_\_\_ from the beginning of this Lease until the 31st day of December, 19 \_\_\_\_\_. Annual monthly base rental increases for calendar years 19 \_\_\_\_\_ and subsequent years will be based on no less than \$ 5.00 or the increase in the Consumer Price Index (defined as the United States Department of Labor Consumer Price Index, U. S. City Average, All Urban Consumers, 1967 equals 100) ("CPI"), whichever is greater. Lease renewals and increases will become effective the first day of January of each year thereafter and will be a part of the Lease agreement for that year.

Base rent will also be increased in calendar years subsequent to the initial year by any increase in real estate or other taxes and assessments by a state or local government. Such increase in taxes and assessments will be based on a prorata computation among all lots in the mobile home park and will be charged to all residents to whom this Prospectus is applicable. The mobile home owner shall be notified of the increase in base rent at least ninety (90) days prior to the increase.

Rental payments are due on or before the 1st day of each month for that month, at the place designated by the Community.

The Owner-tenant covenants and agrees to the following:

1. To make no unlawful, improper, or offensive use of the property.
2. To comply with the Rules & Regulations of the park. A copy of said Rules & Regulations has been furnished to the Owner-tenant.
3. That the Lease is governed by Chapter 723, Florida Statutes (Florida Mobile Home Act) as currently in effect at the time of execution of this document, the provisions of which are incorporated herein by reference.

(Continued on Sheet No. 25.1)

Ray Moats  
President of General Partner

WASTEWATER TARIFF

(Continued from Sheet No. 25.0)

4. Actions by the Owner-tenant which constitute grounds for eviction under Section 723.061, Florida Statutes, shall be a violation of this Lease. Failure of the Community to evict a tenant for violation of any one of the grounds set forth in Section 723.061, Florida Statutes, or for any grounds provided for in this Lease, shall not waive the right for the Community to consider any subsequent violation of the same grounds, or the violation of any other grounds, a breach of this Lease by Owner-tenant so long as permitted by Chapter 723, Florida Statutes.

5. As provided in the Rules & Regulations, rules and regulations may be modified, eliminated, or additional rules and regulations adopted by the Community upon giving the Owner-tenant notice thereof as required by law and said Rules & Regulations in accordance with Chapter 723, Florida Statutes.

6. This Lease and the privileges contained herein are not assignable, and said Lease is only valid as long as those executing this Lease reside upon the premises set forth in this Lease, and are in full conformance of all provisions of this Lease and the park Rules & Regulations, except that a new home owner may assume in writing the balance of the annual Lease through December 31 of the year of purchase in accordance with Chapter 723, Florida Statutes.

7. Owner-tenant expressly understands and agrees that, upon execution of this Lease, all prior leases, rental agreements, negotiations, and other agreements between the parties regarding the lot leased are hereby terminated, void, and of no legal force and effect.

8. Other financial obligations of the Owner-tenant, not including any user fees, are as follows:

	<u>Fees or Charges</u>
Water and Sewage	\$ <u>12.57</u> minimum per month \$ <u>1.26</u> excess per month (each 1,000 gallons in excess of 3,000 gallons)
Yard Maintenance (not charged unless Owner-tenant fails to maintain yard)	\$ <u>20.00</u> per cut
Tree Trimming/Removal, Debris Removal (not charged unless Owner-tenant fails to provide services himself)	\$ <u>billed amount</u>
Late Check Charge	\$ <u>1.50</u> per day
Bad Check Charge	\$ <u>15.00</u>
Extra Resident Fee	\$ <u>10.00</u>
Debris Removal	charged in accordance with Section VIII(K) of the Prospectus

(Continued on Sheet No. 25.2)

Ray Moats  
President of General Partner

WASTEWATER TARIFF

(Continued from Sheet No. 25.1)

Governmental Assessments, Fees,  
Surcharges, and Charges

charged in accordance with Section VIII(J)  
of the Prospectus

Garbage disposal,  
cable television, and electricity

Paid direct by home owner to company  
providing service

The fees will be charged and increased as set out in Sections VIII(F) through (K) of the Prospectus.

9. The Community reserves the right to pass on and pass through charges in accordance with the Prospectus and Chapter 723, Florida Statutes.

10. Owner-tenant(s) acknowledge that they have read the foregoing, the Rules & Regulations, and the Prospectus, and that Owner-tenant was offered the foregoing Lease prior to occupancy.

We have read and understand this agreement and agree to the terms set out herein.

WITNESS our hands and seals of the date set out above.

\_\_\_\_\_  
Owner-tenant

\_\_\_\_\_  
Community Representative

\_\_\_\_\_  
Owner-tenant

Ray Moats  
President of General Partner



WASTEWATER TARIFF

COPY OF CUSTOMER'S BILL

PLANTATION LANDINGS  
 P.O. BOX 2520 6 LAKELAND, FL 33807 8252  
 BILLING INQUIRIES CALL 904 (941) 647-1581 REQUEST UTILITY BILLING DEPT.

FORWARDING & ADDRESS  
 CORRECTION REQUESTED

METER NO.	METER READING		USED	CHARGES
	CURRENT	PREVIOUS		

PLEASE BRING THIS ENTIRE BILL TO OFFICE  
 OR MAIL THIS STUB WITH YOUR PAYMENT.

METER READ MONTH	DAY	CLASS	AMOUNT TO BE PAID		CUSTOMER		PLEASE REMIT BY THIS DATE
					ROUTE	ACCOUNT	

Ray Moats  
 President of General Partner

WASTEWATER TARIFF

INDEX OF SERVICE AVAILABILITY

	<u>Sheet Number</u>
Schedule of Fees and Charges.....	22.0
Service Availability Policy.....	28.0
Table of Daily Flows.....	N/A

Ray Moats  
President of General Partner

PLANTATION LANDINGS, LTD.

ORIGINAL SHEET NO. 28.0

WASTEWATER TARIFF

SERVICE AVAILABILITY POLICY

N/A

Ray Moats  
President of General Partner

PLANTATION LANDINGS, LTD.

ORIGINAL SHEET NO. 29.0

WASTEWATER TARIFF

HELD FOR FUTURE USE

Ray Moats  
President of General Partner