

State of Florida



ORIGINAL

Public Service Commission
-M-E-M-O-R-A-N-D-U-M-

DATE: July 15, 2003
TO: Division of Commission Clerk and Administrative Services
FROM: Thomas Walden, Division of Economic Regulation
RE: Docket No. 030294-WU; Application for amendment of Certificate No. 419-W to add territory in Marion County by Residential Water Systems, Inc.

Attached is a letter from the Department of Community Affairs that should be included in the docket file.

TJW

RECEIVED FPSC
03 JUL 15 PM 4:08
COMMISSION
CLERK

- AUS _____
- CAF _____
- CMP _____
- COM _____
- CTR _____
- ECR _____
- GCL _____
- OPC _____
- WMS _____
- SEC I
- OTH _____

DOCUMENT NUMBER - DATE
06251 JUL 15 03
FPSC-COMMISSION CLERK



STATE OF FLORIDA

DEPARTMENT OF COMMUNITY AFFAIRS

"Dedicated to making Florida a better place to call home"

JEB BUSH
Governor

COLLEEN CASTILLE
Secretary

May 22, 2003

Mr. Timothy Devlin, Director
Division of Economic Regulation
Public Service Commission
2540 Shumard Oak Boulevard
Tallahassee, Florida 32399-0850

03 MAY 27 PM 3:18
ECONOMIC REGULATION
PUBLIC SERVICE

Re: Application for Amendment of Certificate No. 419-W
by Residential Water Systems, Inc. to add potable water territory in Marion County
Docket No. 030294-WU

Dear Mr. Devlin:

On April 29, 2003, the Department received information concerning the application to expand potable water service in Marion County, by Residential Water Systems, Inc. (Figure 1). Pursuant to the Memorandum of Understanding between the Public Service Commission (PSC) and the Department of Community Affairs, the Department will provide information to the PSC regarding the relationship of the certificate application and the Marion County comprehensive plan, including information about land use categories, including densities and intensities of use as well as information regarding patterns of development, and service needs in the County. The Department has completed its review and offers the following comments:

Based on our review of the proposed expansion by Residential Water Systems, Inc., it appears that it is consistent with the Marion County Comprehensive plan. The proposed service expansion area is designated Medium Density Residential (1 to 4 dwelling unit /acre) land use category (Figure 2). A portion of the site received a land use change from Urban Reserve to Medium Density Residential in 2001 and at that time the County stated that they would require the site to be served by central water service; therefore, the Department does not object to the proposed expansion to provide potable water service for the parcel.

DOCUMENT NUMBER-DATE
06251 JUL 15 08
FPSC-COMMISSION CLERK

2555 SHUMARD OAK BOULEVARD • TALLAHASSEE, FLORIDA 32399-2100

Phone: 850.488.8466/Suncom 278.8466 FAX: 850.921.0781/Suncom 291.0781

Internet address: <http://www.dca.state.fl.us>

CRITICAL STATE CONCERN FIELD OFFICE
2796 Overseas Highway, Suite 212
Marathon, FL 33050-2227
(305) 289-2402

COMMUNITY PLANNING
2555 Shumard Oak Boulevard
Tallahassee, FL 32399-2100
(850) 488-2356

EMERGENCY MANAGEMENT
2555 Shumard Oak Boulevard
Tallahassee, FL 32399-2100
(850) 413-9969

HOUSING & COMMUNITY DEVELOPMENT
2555 Shumard Oak Boulevard
Tallahassee, FL 32399-2100
(850) 488-7956

Mr. Timothy Devlin
May 22, 2003
Page Two

Thank you for the opportunity to comment on this application. If you have any questions regarding this matter, please call Ron Horlick, Planner, in the Bureau of Local Planning at (850) 922-1801.

Sincerely Yours,



Charles Gauthier, AICP
Chief of Comprehensive Planning

CG/rh

cc: Michael R. Mochlman, Executive Director, Withlacoochee RPC
Dwight Ganoë, Planning Director, Marion County
Patti Daniel, Certification Supervisor, PSC

Figure 1

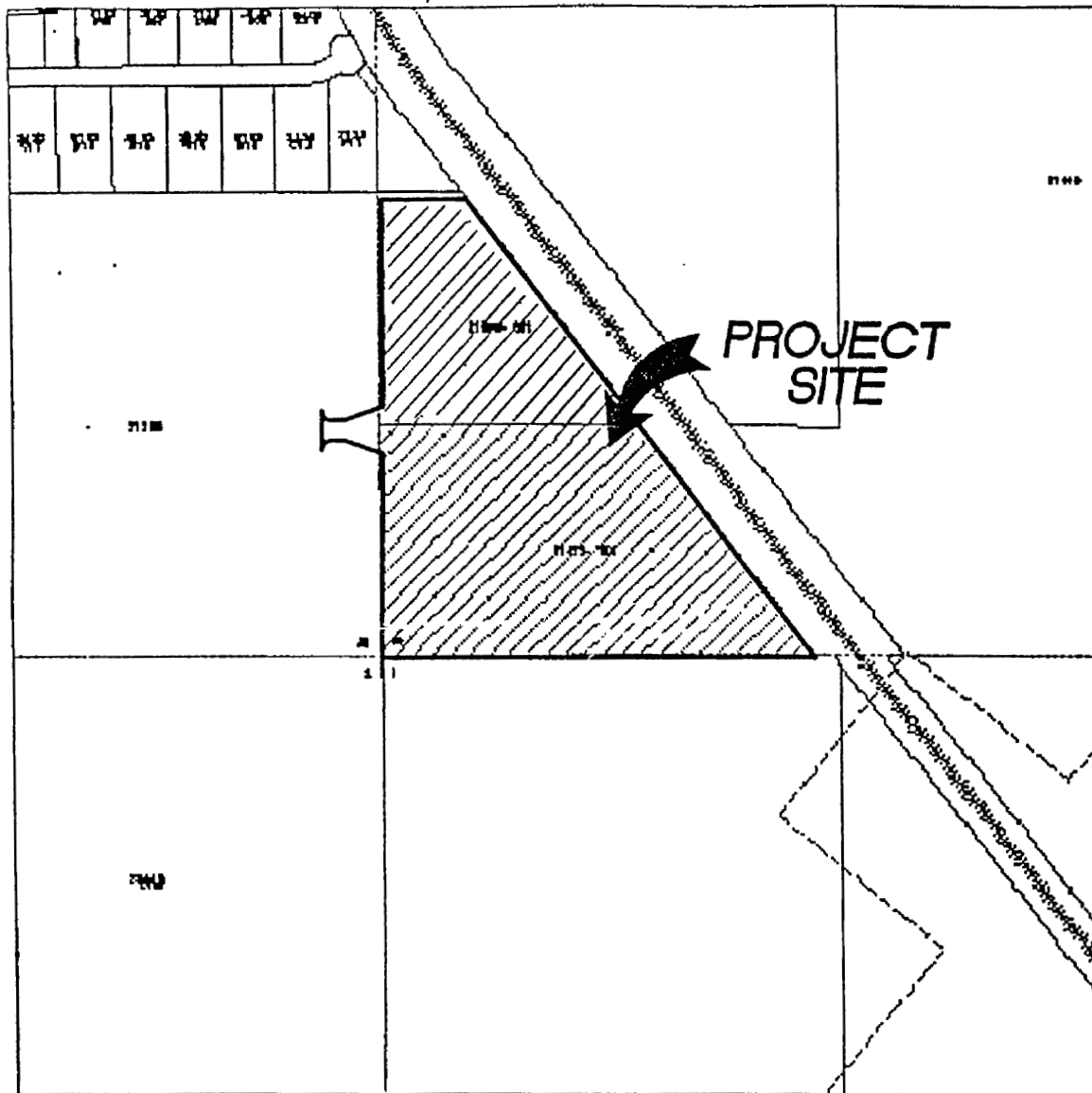

C:\0-Projects\353-002 Dalton Woods 1st Addition S-D\DWG\353-002.dwg, 03/18/2003 02:09:14 PM

Dalton Woods - 1st Addition

A Private Residential Subdivision
Marion County, Florida

PROJECT NO. 353-002

MARION COUNTY
PROPERTY
OWNERSHIP
MAP

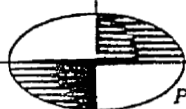

COA No. 5055

JOHN P. DANIELS ENGINEERING, INC.

1309 S.E. 25th LOOP, SUITE 102 OCALA, FLORIDA 34471
PHONE: (352) 369-4000 FAX: (352) 369-4002 EMAIL: mailbox@jpdeng.com

| | | |
|------------|-----------|---------|
| DRAWN: | JW | 3-18-03 |
| CHECKED: | J.P.D. | 3-18-03 |
| SCALE: | 1" = 500' | |
| DWG. NAME: | "MCPAIMG" | |

Figure 2

EXISTING USE & PROPOSED LAND USE DESIGNATION

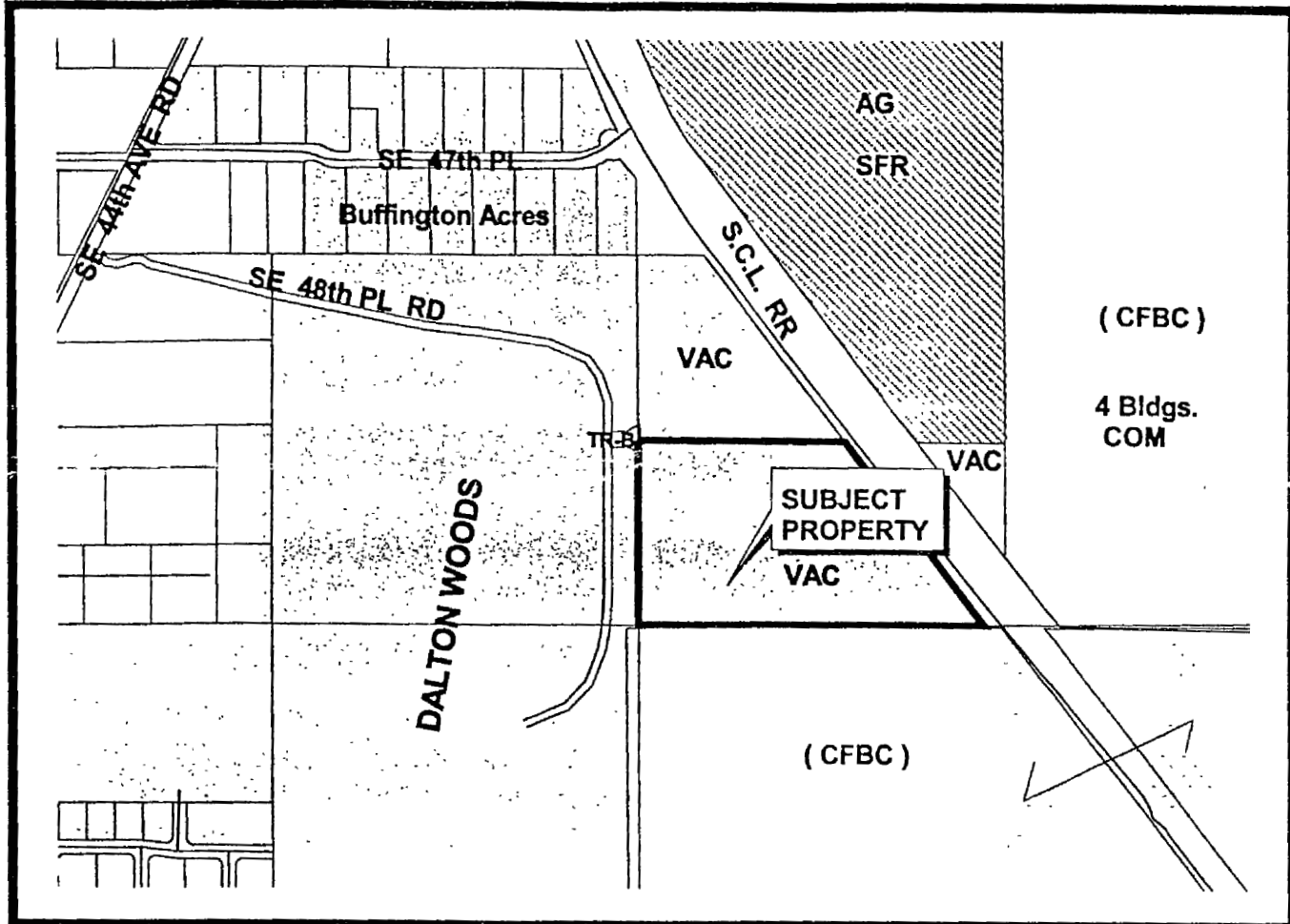

| | | | | |
|-----|---------------------------|--|--|--|
| SFR | SINGLE FAMILY RESIDENTIAL | <ul style="list-style-type: none"> Natural Reservation Municipalities RAC DRI Boundaries Low Density Residential Med Density Residential High Density Residential Commercial Limited Commercial Industrial Public Use Conservation Recreation Urban Commerce District Urban Neighborhood District Rural Village District Rural Lands COMM-REC Specialized Comm Dist Urban Reserve | OWNER: Robert P. Drake Trustee | |
| AG | AGRICULTURAL | | AGENT: David G. Cope | |
| VAC | VACANT | | PARCEL(S): 31413-001-00 | |
| CRH | CHURCH | | LOCATION: | |
| MH | MOBILE HOME | | Property is West of S.C.L. right of way and East of Tract B of Dalton Woods Plat lying on East side of SE 48th PL RD. . | |
| COM | COMMERCIAL | | Approximate scale: 1" = 660' | |
| IND | INDUSTRIAL | | The information shown hereon is compiled from the best available sources and for use by the County offices only. This data should not be used for surveying or land transfer of any type | |
| PUB | PUBLIC | | 01-L3 | |
| REC | RECREATION | | Feb. 2001 | |
| | | | | |
| | | | | |