

ORIGINAL LAW OFFICES
ROSE, SUNDBSTROM & BENTLEY, LLP

031043-4S

2548 BLAIRSTONE PINES DRIVE
TALLAHASSEE, FLORIDA 32301

(850) 877-6555

FAX (850) 656-4029

www.rsbatorneys.com

REPLY TO ALTAMONTE SPRINGS

CHRIS H. BENTLEY, P.A.
ROBERT C. BRANNAN
DAVID F. CHESTER
F. MARSHALL DETERDING
JOHN R. JENKINS, P.A.
STEVEN T. MINDLIN, P.A.
DAREN L. SHIPPY
WILLIAM E. SUNDBSTROM, P.A.
DIANE D. TREMOR, P.A.
JOHN L. WHARTON

ROBERT M. C. ROSE, OF COUNSEL
WAYNE L. SCHIEFELBEIN, OF COUNSEL

CENTRAL FLORIDA OFFICE
600 S. NORTH LAKE BLVD., SUITE 160
ALTAMONTE SPRINGS, FLORIDA 32701
(407) 830-6331
FAX (407) 830-8522

MARTIN S. FRIEDMAN, P.A.
VALERIE L. LORD, OF COUNSEL
(LICENSED IN TEXAS ONLY)

November 12, 2003

HAND DELIVERY

RECEIVED-FPSC
03 NOV 12 AM 10:50
COMMISSION
CLERK

Ms. Blanca Bayo
Commission Clerk and Administrative Services Director
Florida Public Service Commission
2540 Shumard Oak Boulevard
Tallahassee, FL 32399

Re: Docket No. _____ Application of North Sumter Utility Company, LLC, for
Amendment to Certificate of Authorization
Our File No.: 34078.04

Dear Ms. Bayo:

Enclosed for filing are the original and fifteen (15) copies of the Application of North Sumter Utility Company, LLC,, for Amendment of its Service Area in Sumter County, Florida. Also enclosed is our check in the amount of \$3,500 representing the appropriate filing fee.

Should you have any questions regarding this filing, please do not hesitate to give me a call.

Check received with filing and forwarded
to Fiscal for deposit. Fiscal to forward
deposit information to Records.

Initials of person who forwarded check:

W.S.

Original
Tarriffs forwarded to ECR

MSF/tlc
Enclosures

Very truly yours,

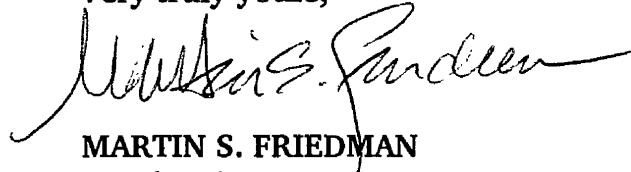

MARTIN S. FRIEDMAN
For the Firm

cc: Mr. John Wise (w/enclosure)

BEFORE THE FLORIDA PUBLIC SERVICE COMMISSION

IN RE: Application of)
NORTH SUMTER UTILITY COMPANY,)
L.L.C., for deletion of water)
and wastewater service area in)
Sumter County, Florida.)
)
)
)

Docket No. 031043-WS

APPLICATION FOR AMENDMENT TO
CERTIFICATE OF AUTHORIZATION

NORTH SUMTER UTILITY COMPANY, L.L.C., ("NSU"), by and through its undersigned attorneys, and pursuant to §367.045(2), Florida Statutes, and Rule 25-30.036, Florida Administrative Code, files this Application for Amendment of Certificates 532-S and 618-W to delete a portion of its water and wastewater service area in Sumter County, and in support thereof states:

1. The exact name of the Company and the address of its principal business office is:

NORTH SUMTER UTILITY COMPANY, LLC
1100 Main Street
The Villages, Florida 32159
PHONE: (352)753-2270

2. The name and address of the person authorized to receive notices and communications in respect to this application is:

Martin S. Friedman, Esquire
Rose, Sundstrom & Bentley, LLP
600 S. North Lake Boulevard, Suite 160
Altamonte Springs, FL 32701
(407)830-6331
(407)830-8522 fax
mfriedman@rsbattorneys.com

DOCUMENT NUMBER-DATE

11255 NOV 12 8

FPSC-COMMISSION CLERK

3. A description of the territory proposed to be deleted, using township, range and section references is attached hereto as Exhibit "A".

4. A detailed map showing township, range and section with the proposed territory plotted thereon are attached as Exhibit "B".

5. There are no existing lines and facilities in the territory to be deleted.

6. There are no active connections within the territory to be deleted.

7. The territory is proposed to be deleted because due to the timing of the development of that territory it would not be expedient for NSU to provide water and wastewater service.

8. It is in the public interest to delete this territory because the developer is not in need of service within the time schedule that NSU will be providing water and wastewater service to the remainder of its territory.

9. The only landowner affected by the deletion is The Villages of Lake-Sumter, Inc., which is a related party to NSU, and which consents to the deletion of this territory from NSU's Certificates.

10. Attached as Exhibit "C" to the original Application are the original and two (2) copies of the revised tariff sheets reflecting the additional service area. A copy of the revised tariff sheets is attached to each copy of the Application.

11. Attached as Exhibit "D" is an affidavit that the notice of actual application was given in accordance with §367.045(1)(a); Florida Statutes, and Rule 25-30.030, Florida Administrative Code, by regular mail to the following:

- (1) the governing body of the municipality, county or counties in which the system or territory proposed to be served is located;
 - (2) the privately owned water utility that holds a certificate granted by the Public Service Commission and that is located within the county in which the utility or the territory proposed to be served is located;
 - (3) if any portion of the proposed territory is within one mile of a county boundary, the utility shall notice the privately owned utilities located in the bordering counties and holding a certificate granted by the Commission;
 - (4) the regional planning council;
 - (5) the Office of Public Counsel;
 - (6) the Public Service Commission's Director of Records and Reporting;
 - (7) the appropriate regional office of the Department of Environmental Protection; and
 - (8) the appropriate water management district;
- Copies of the Notice and a list of entities noticed shall accompany the affidavit.

12. Late Filed Exhibit "E" will be the notice of actual application was given in accordance with Rule 25-30.030, Florida Administrative Code, by regular mail or personal delivery to each property owner in the proposed territory.

14. Late Filed Exhibit "F" will be an affidavit that the notice of application was published once a week in a newspaper of general circulation in the territory in accordance with Rule 25-30.030, Florida Administrative Code. A copy of the proof of publication will accompany the affidavit.

15. Attached hereto as Exhibit "G" is an Affidavit that NSU has on file with the PSC Tariffs and Annual Reports.

16. NSU's rates and service availability charges were set in connection with obtaining its original certificates in Docket No. 010859-WS, Order No. PSC-02-0554-PAA-WS, issued April 23, 2002.

17. After a diligent search, NSU has been unable to locate Original Certificates 532-S and 618-W.

18. The deleted territory would have served 4,000 or less water and wastewater ERCs so the appropriate filing fee is \$3,500.00, which is attached.

Respectfully submitted on this
12th day of November, 2003, by:

ROSE, SUNDSTROM & BENTLEY, LLP
600 S. North Lake Boulevard
Suite 160
Altamonte Springs, Florida 32701
(407) 830-6331
(407) 830-8522 Fax

By:



MARTIN S. FRIEDMAN

EXHIBIT "A"

DESCRIPTION OF TERRITORY TO BE DELETED

THOSE PORTIONS OF SECTIONS 27, 28, 33 AND 34 OF TOWNSHIP 18 SOUTH, RANGE 23 EAST AND OF SECTIONS 3 AND 4 OF TOWNSHIP 19 SOUTH, RANGE 23 EAST, ALL IN SUMTER COUNTY, FLORIDA, DESCRIBED AS FOLLOWS:

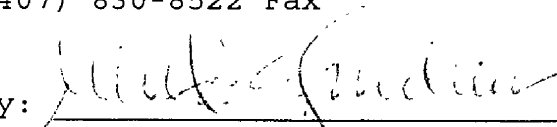
COMMENCE AT THE EAST 1/4 CORNER (SOUTHEAST CORNER OF GOVERNMENT LOT 1) OF SECTION 28, TOWNSHIP 18 SOUTH, RANGE 23 EAST, SUMTER COUNTY, FLORIDA; THENCE WESTERLY ALONG THE NORTH LINE OF THE NORTHEAST 1/4 OF THE SOUTHEAST 1/4 OF SAID SECTION 27 A DISTANCE OF 1,321.65 FEET TO THE SOUTHWEST CORNER OF GOVERNMENT LOT 1 AND THE POINT OF BEGINNING; THENCE N00°24'57"E, 697.24 FEET; THENCE S89°35'03"E, 310.55 FEET; THENCE S12°39'38"E, 701.50 FEET; THENCE N77°04'03"E, 611.75 FEET; THENCE S82°42'52"E, 416.88 FEET; THENCE S37°58'44"E, 215.53 FEET; THENCE N90°00'00"E, 68.67 FEET; THENCE N51°59'31"E, 172.57 FEET; THENCE N89°56'32"E, 362.50 FEET; THENCE S46°47'34"E, 266.30 FEET; THENCE S80°11'14"E, 133.65 FEET; THENCE N65°13'16"E, 616.99 FEET; THENCE N83°07'11"E, 178.87 FEET; THENCE S34°48'37"E, 674.15 FEET; THENCE S17°20'35"E, 257.20 FEET; THENCE S09°46'55"E, 83.22 FEET; THENCE S32°39'58"W, 605.09 FEET; THENCE S24°01'20"W, 148.63 FEET; THENCE CONTINUE S24°01'20"W, 446.81 FEET; THENCE S05°12'27"W, 645.38 FEET; THENCE S31°26'11"W, 101.22 FEET; THENCE S61°59'19"W, 77.51 FEET; THENCE S87°48'34"W, 605.13 FEET; THENCE S00°00'00"E, 397.53 FEET; THENCE S30°57'38"W, 127.21 FEET; THENCE S06°34'04"E, 30.00 FEET TO A POINT ON THE ARC OF A CURVE CONCAVE SOUTH, HAVING A RADIUS OF 5,430.00 FEET AND A CHORD BEARING AND DISTANCE OF N83°36'21"E, 32.88 FEET; THENCE EASTERLY ALONG THE ARC OF SAID CURVE, THROUGH A CENTRAL ANGLE OF 00°20'49", AN ARC DISTANCE OF 32.88 FEET; THENCE N83°46'45"E, 757.37 FEET TO THE POINT OF CURVATURE OF A CURVE CONCAVE SOUTH AND HAVING A RADIUS OF 12,000.00 FEET; THENCE EASTERLY ALONG THE ARC OF SAID CURVE THROUGH A CENTRAL ANGLE OF 01°00'13", AN ARC DISTANCE OF 210.20 FEET; THENCE N84°46'58"E, 306.58 FEET TO THE POINT OF CURVATURE OF A CURVE CONCAVE SOUTH AND HAVING A RADIUS OF 9,970.00 FEET; THENCE EASTERLY ALONG THE ARC OF SAID CURVE THROUGH A CENTRAL ANGLE OF 01°48'09", AN ARC DISTANCE OF 313.65 FEET; THENCE N86°35'07"E, 255.07 FEET TO THE POINT OF CURVATURE OF A CURVE CONCAVE SOUTH AND HAVING A RADIUS OF 2,000.00 FEET; THENCE EASTERLY ALONG THE ARC OF SAID CURVE THROUGH A CENTRAL ANGLE OF 01°48'38", AN ARC DISTANCE OF 63.20 FEET; THENCE N88°23'44"E, 110.47 FEET TO A POINT ON THE ARC OF A CURVE CONCAVE WEST, HAVING A RADIUS OF 1,200.00 FEET AND A CHORD BEARING AND DISTANCE OF S06°03'43"W, 4.77 FEET; THENCE SOUTHERLY ALONG THE ARC OF SAID CURVE, THROUGH A CENTRAL ANGLE OF 00°13'40", AN ARC DISTANCE OF 4.77 FEET TO THE POINT OF COMPOUND CURVATURE OF A CURVE CONCAVE WEST AND HAVING A RADIUS OF 2,000.00 FEET; THENCE SOUTHERLY ALONG THE ARC OF SAID CURVE THROUGH A CENTRAL ANGLE OF 11°15'30", AN ARC DISTANCE OF 392.99 FEET; THENCE S17°26'05"W, 418.34 FEET TO THE POINT OF CURVATURE OF A CURVE CONCAVE EAST AND HAVING A RADIUS OF 3,000.00 FEET; THENCE SOUTHERLY ALONG THE ARC OF SAID CURVE THROUGH A CENTRAL ANGLE OF 26°56'40", AN ARC DISTANCE OF 1,410.81 FEET TO THE POINT OF COMPOUND CURVATURE OF A CURVE CONCAVE NORTHEAST AND HAVING A RADIUS OF 1,500.00 FEET; THENCE SOUTHEASTERLY ALONG THE ARC OF SAID CURVE THROUGH A CENTRAL ANGLE OF 27°06'39", AN ARC DISTANCE OF 709.76 FEET TO THE POINT

OF COMPOUND CURVATURE OF A CURVE CONCAVE NORTHEAST AND HAVING A RADIUS OF 5,720.00 FEET; THENCE SOUTHEASTERLY ALONG THE ARC OF SAID CURVE THROUGH A CENTRAL ANGLE OF 16°39'50", AN ARC DISTANCE OF 1,663.60 FEET TO A POINT ON THE ARC OF A CURVE CONCAVE WEST, HAVING A RADIUS OF 72.50 FEET AND A CHORD BEARING AND DISTANCE OF S05°23'43"E, 96.55 FEET; THENCE SOUTHERLY ALONG THE ARC OF SAID CURVE, THROUGH A CENTRAL ANGLE OF 276°30'17", AN ARC DISTANCE OF 349.88 FEET; THENCE S42°51'25"W, 2,526.80 FEET; THENCE N90°00'00"E, 1,450.06 FEET, MORE OR LESS, TO THE WEST LINE OF THE EAST OF THE NORTHEAST 1/4 OF SAID SECTION 3 ; THENCE SOUTHERLY ALONG SAID WEST LINE A DISTANCE OF 1,647.46 FEET , MORE OR LESS, TO THE NORTH RIGHT-OF-WAY OF COUNTY ROAD 466A; THENCE WEST ALONG SAID RIGHT-OF-WAY TO THE WEST LINE OF THE EAST 3/4 OF SAID SECTION 3; THENCE NORTH TO THE SOUTHEAST CORNER OF THE NORTHWEST 1/4 OF NORTHWEST 1/4 OF SAID SECTION 3; THENCE WEST TO THE SOUTHEAST CORNER OF THE EAST ½ OF THE NORTHEAST 1/4 OF THE NORTHEAST 1/4 OF SAID SECTION 4; THENCE WEST 660.00 FEET MORE OR LESS TO THE SOUTHWEST CORNER OF THE EAST ½ OF THE NORTHEAST 1/4 OF NORTHEAST 1/4; THENCE NORTH TO THE NORTHWEST CORNER OF THE EAST ½ OF THE NORTHEAST 1/4 OF NORTHEAST 1/4 OF SAID SECTION 4; THENCE WEST TO THE SOUTHWEST CORNER OF THE EAST ½ OF THE SOUTHEAST 1/4 OF SAID SECTION 33; THENCE NORTH TO THE NORTHWEST CORNER OF THE EAST OF THE SOUTHEAST 1/4 OF SAID SECTION 33; THENCE EAST TO THE NORTHEAST CORNER OF THE SAID EAST ½ OF SOUTHEAST 1/4; THENCE NORTH TO THE SOUTHEAST CORNER OF SAID SECTION 28; THENCE WEST ALONG THE SOUTH LINE THEREOF TO THE EAST RIGHT-OF-WAY OF COUNTY ROAD 121; THENCE NORTH ALONG SAID RIGHT-OF-WAY TO THE NORTH LINE OF THE SOUTH 1/4 OF SAID SECTION 28; THENCE EAST ALONG SAID NORTH LINE TO THE WEST LINE OF THE EAST 1/4 OF SAID SECTION 28; THENCE NORTH ALONG SAID WEST LINE TO THE POINT OF BEGINNING.

AND

BEGIN AT THE SOUTHEAST CORNER OF THE NORTHWEST 1/4 OF THE SOUTHEAST 1/4 OF SECTION 28, TOWNSHIP 18 SOUTH, RANGE 23 EAST, SUMTER COUNTY, FLORIDA: THENCE N89°37'21"W ALONG THE SOUTH LINE THEREOF A DISTANCE OF 1167.35 FEET; THENCE N46°32'09"E, 185.43 FEET; THENCE N07°26'37"E, 90.00 FEET; THENCE N07°26'52"E, 122.83 FEET; THENCE N10°16'58"E, 112.95 FEET; THENCE N10°17'58"E, 99.99 FEET; THENCE N12°34'39"E, 94.28 FEET; THENCE N20°23'02"E, 95.92 FEET; THENCE N23°17'14"E, 100.02 FEET; THENCE N37°06'44"E, 92.47 FEET; THENCE N48°11'09"E, 170.00 FEET; THENCE N00°21'51"E, 300.16 FEET TO A POINT THAT IS 10 FEET SOUTH OF THE NORTH LINE OF THE SAID NORTHWEST 1/4 OF THE SOUTHEAST 1/4; THENCE PARALLEL TO SAID NORTH LINE RUN EAST A DISTANCE OF 698.52 FEET TO A POINT ON THE EAST LINE OF THE SAID NORTHWEST 1/4 OF THE SOUTHEAST 1/4; THENCE SOUTHERLY ALONG SAID EAST LINE TO THE POINT OF BEGINNING.

EXHIBIT "B"

A DETAILED MAP

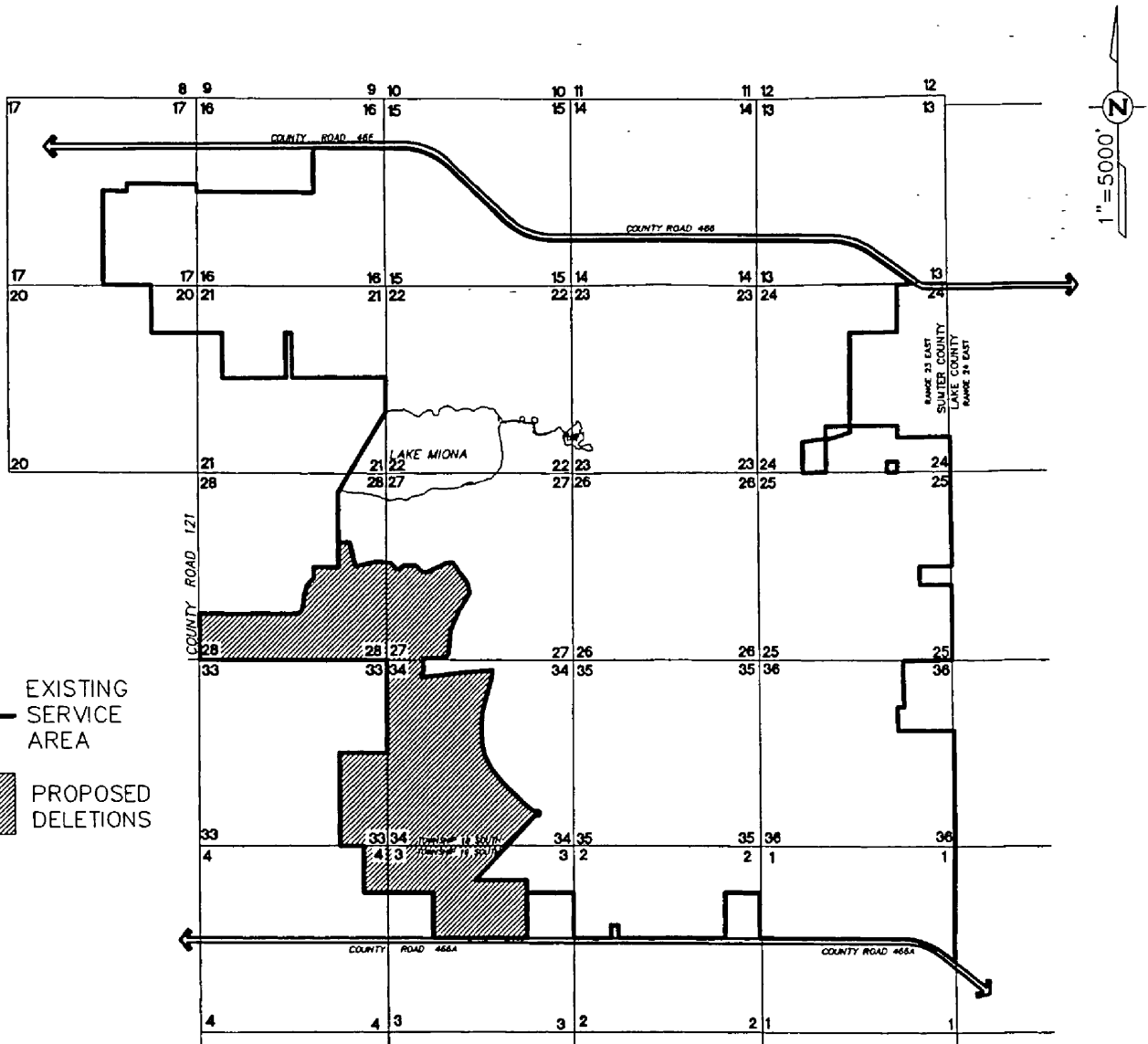

NORTH SUMTER UTILITY COMPANY FLORIDA PUBLIC SERVICE COMMISSION SERVICE AREA DELETIONS



**FARNER
BARLEY**
AND ASSOCIATES, INC.

- ▲ ENGINEERS
- ▲ SURVEYORS
- ▲ PLANNERS
- LB 4709

1507 BUENOS AIRES BOULEVARD ◀ THE VILLAGES, FL 32159 ▲ (352) 753-3114

EXHIBIT "C"

ORIGINAL & TWO (2) COPIES OF REVISED TARIFF SHEETS

FIRST REVISED SHEET NO. 2.0
CANCELS ORIGINAL SHEET NO. 2.0

NAME OF COMPANY: NORTH SUMTER UTILITY COMPANY, LLC
WATER TARIFF

WATER TARIFF

TABLE OF CONTENTS

	Sheet Number
Communities Served Listing "Held for Future Use"	4.0
Description of Territory Served.....	3.1 - 3.7
Index of	
Rates and Charges Schedules.....	11.0
Rules and Regulations.....	6.0 - 6.1
Service Availability Policy.....	23.0
Standard Forms.....	18.0
Technical Terms and Abbreviations.....	5.0 - 5.1
Territory Served.....	3.0

H.G. MORSE
Issuing Officer

PRESIDENT
Title

SECOND REVISED SHEET NO. 3.0
CANCELS FIRST REVISED SHEET NO. 3.0

NAME OF COMPANY: NORTH SUMTER UTILITY COMPANY, LLC

WATER TARIFF

TERRITORY AUTHORITY

CERTIFICATE NUMBER - 618 - W

COUNTY - Sumter

COMMISSION ORDER(s) APPROVING TERRITORY SERVED -

<u>Order Number</u>	<u>Date Issued</u>	<u>Docket Number</u>	<u>Filing Type</u>
PSC-02-0554-PAA-WS	April 23, 2002	010859-WS	Original Certificate
PSC-03-0768-FOF-WS	June 27, 2003	021036-WS	Amendment Deletion Amendment

H.G. MORSE
Issuing Officer

PRESIDENT
Title

NAME OF COMPANY: NORTH SUMTER UTILITY COMPANY, LLC

WATER TARIFF

(Continued from Sheet No. 3.4)

DESCRIPTION OF TERRITORY TO BE SERVEDAREA TO BE DELETED

THOSE PORTIONS OF SECTIONS 27, 28, 33 AND 34 OF TOWNSHIP 18 SOUTH, RANGE 23 EAST AND OF SECTIONS 3 AND 4 OF TOWNSHIP 19 SOUTH, RANGE 23 EAST, ALL IN SUMTER COUNTY, FLORIDA, DESCRIBED AS FOLLOWS:

COMMENCE AT THE EAST 1/4 CORNER (SOUTHEAST CORNER OF GOVERNMENT LOT 1) OF SECTION 28, TOWNSHIP 18 SOUTH, RANGE 23 EAST, SUMTER COUNTY, FLORIDA; THENCE WESTERLY ALONG THE NORTH LINE OF THE NORTHEAST 1/4 OF THE SOUTHEAST 1/4 OF SAID SECTION 27 A DISTANCE OF 1,321.65 FEET TO THE SOUTHWEST CORNER OF GOVERNMENT LOT 1 AND THE POINT OF BEGINNING; THENCE N00°24'57"E, 697.24 FEET; THENCE S89°35'03"E, 310.55 FEET; THENCE S12°39'38"E, 701.50 FEET; THENCE N77°04'03"E, 611.75 FEET; THENCE S82°42'52"E, 416.88 FEET; THENCE S37°58'44"E, 215.53 FEET; THENCE N90°00'00"E, 68.67 FEET; THENCE N51°59'31"E, 172.57 FEET; THENCE N89°56'32"E, 362.50 FEET; THENCE S46°47'34"E, 266.30 FEET; THENCE S80°11'14"E, 133.65 FEET; THENCE N65°13'16"E, 616.99 FEET; THENCE N83°07'11"E, 178.87 FEET; THENCE S34°48'37"E, 674.15 FEET; THENCE S17°20'35"E, 257.20 FEET; THENCE S09°46'55"E, 83.22 FEET; THENCE S32°39'58"W, 605.09 FEET; THENCE S24°01'20"W, 148.63 FEET; THENCE CONTINUE S24°01'20"W , 446.81 FEET; THENCE S05°12'27"W, 645.38 FEET; THENCE S31°26'11"W, 101.22 FEET; THENCE S61°59'19"W, 77.51 FEET; THENCE S87°48'34"W, 605.13 FEET; THENCE S00°00'00"E, 397.53 FEET; THENCE S30°57'38"W, 127.21 FEET; THENCE S06°34'04"E, 30.00 FEET TO A POINT ON THE ARC OF A CURVE CONCAVE SOUTH, HAVING A RADIUS OF 5,430.00 FEET AND A CHORD BEARING AND DISTANCE OF N83°36'21"E, 32.88 FEET; THENCE EASTERLY ALONG THE ARC OF SAID CURVE, THROUGH A CENTRAL ANGLE OF 00°20'49", AN ARC DISTANCE OF 32.88 FEET; THENCE N83°46'45"E, 757.37 FEET TO THE POINT OF CURVATURE OF A CURVE CONCAVE SOUTH AND HAVING A RADIUS OF 12,000.00 FEET; THENCE EASTERLY ALONG THE ARC OF SAID CURVE THROUGH A CENTRAL ANGLE OF 01°00'13", AN ARC DISTANCE OF 210.20 FEET; THENCE N84°46'58"E, 306.58 FEET TO THE POINT OF CURVATURE OF A CURVE CONCAVE SOUTH AND HAVING A RADIUS OF 9,970.00 FEET; THENCE EASTERLY ALONG THE ARC OF SAID CURVE THROUGH A CENTRAL ANGLE OF 01°48'09", AN ARC DISTANCE OF 313.65 FEET; THENCE N86°35'07"E, 255.07 FEET TO THE POINT OF CURVATURE OF A CURVE CONCAVE SOUTH AND HAVING A RADIUS OF 2,000.00 FEET; THENCE EASTERLY ALONG THE ARC OF SAID CURVE

(Continued on Sheet No. 3.6)

H.G. MORSE
Issuing Officer

PRESIDENT
Title

NAME OF COMPANY: NORTH SUMTER UTILITY COMPANY, LLC

WATER TARIFF

(Continued from Sheet No. 3.5)

DESCRIPTION OF TERRITORY TO BE SERVEDAREA TO BE DELETED (continued)

THROUGH A CENTRAL ANGLE OF 01°48'38", AN ARC DISTANCE OF 63.20 FEET; THENCE N88°23'44"E, 110.47 FEET TO A POINT ON THE ARC OF A CURVE CONCAVE WEST, HAVING A RADIUS OF 1,200.00 FEET AND A CHORD BEARING AND DISTANCE OF S06°03'43"W, 4.77 FEET; THENCE SOUTHERLY ALONG THE ARC OF SAID CURVE, THROUGH A CENTRAL ANGLE OF 00°13'40", AN ARC DISTANCE OF 4.77 FEET TO THE POINT OF COMPOUND CURVATURE OF A CURVE CONCAVE WEST AND HAVING A RADIUS OF 2,000.00 FEET; THENCE SOUTHERLY ALONG THE ARC OF SAID CURVE THROUGH A CENTRAL ANGLE OF 11°15'30", AN ARC DISTANCE OF 392.99 FEET; THENCE S17°26'05"W, 418.34 FEET TO THE POINT OF CURVATURE OF A CURVE CONCAVE EAST AND HAVING A RADIUS OF 3,000.00 FEET; THENCE SOUTHERLY ALONG THE ARC OF SAID CURVE THROUGH A CENTRAL ANGLE OF 26°56'40", AN ARC DISTANCE OF 1,410.81 FEET TO THE POINT OF COMPOUND CURVATURE OF A CURVE CONCAVE NORTHEAST AND HAVING A RADIUS OF 1,500.00 FEET; THENCE SOUTHEASTERLY ALONG THE ARC OF SAID CURVE THROUGH A CENTRAL ANGLE OF 27°06'39", AN ARC DISTANCE OF 709.76 FEET TO THE POINT OF COMPOUND CURVATURE OF A CURVE CONCAVE NORTHEAST AND HAVING A RADIUS OF 5,720.00 FEET; THENCE SOUTHEASTERLY ALONG THE ARC OF SAID CURVE THROUGH A CENTRAL ANGLE OF 16°39'50", AN ARC DISTANCE OF 1,663.60 FEET TO A POINT ON THE ARC OF A CURVE CONCAVE WEST, HAVING A RADIUS OF 72.50 FEET AND A CHORD BEARING AND DISTANCE OF S05°23'43"E, 96.55 FEET; THENCE SOUTHERLY ALONG THE ARC OF SAID CURVE, THROUGH A CENTRAL ANGLE OF 276°30'17", AN ARC DISTANCE OF 349.88 FEET; THENCE S42°51'25"W, 2,526.80 FEET; THENCE N90°00'00"E, 1,450.06 FEET, MORE OR LESS, TO THE WEST LINE OF THE EAST OF THE NORTHEAST 1/4 OF SAID SECTION 3 ; THENCE SOUTHERLY ALONG SAID WEST LINE A DISTANCE OF 1,647.46 FEET , MORE OR LESS, TO THE NORTH RIGHT-OF-WAY OF COUNTY ROAD 466A; THENCE WEST ALONG SAID RIGHT-OF-WAY TO THE WEST LINE OF THE EAST 3/4 OF SAID SECTION 3; THENCE NORTH TO THE SOUTHEAST CORNER OF THE NORTHWEST 1/4 OF NORTHWEST 1/4 OF SAID SECTION 3; THENCE WEST TO THE SOUTHEAST CORNER OF THE EAST ½ OF THE NORTHEAST 1/4 OF THE NORTHEAST 1/4 OF SAID SECTION 4; THENCE WEST 660.00 FEET MORE OR LESS TO THE SOUTHWEST CORNER OF THE EAST ½ OF THE NORTHEAST 1/4 OF NORTHEAST 1/4; THENCE NORTH TO THE NORTHWEST CORNER OF THE EAST ½ OF THE NORTHEAST 1/4 OF NORTHEAST 1/4 OF SAID SECTION 4; THENCE WEST TO THE SOUTHWEST

(Continued on Sheet No. 3.7)

H.G. MORSE
Issuing Officer

PRESIDENT
Title

NAME OF COMPANY: NORTH SUMTER UTILITY COMPANY, LLC

WATER TARIFF

(Continued from Sheet No. 3.6)

DESCRIPTION OF TERRITORY TO BE SERVED

AREA TO BE DELETED (continued)

CORNER OF THE EAST ½ OF THE SOUTHEAST 1/4 OF SAID SECTION 33; THENCE NORTH TO THE NORTHWEST CORNER OF THE EAST OF THE SOUTHEAST 1/4 OF SAID SECTION 33; THENCE EAST TO THE NORTHEAST CORNER OF THE SAID EAST ½ OF SOUTHEAST 1/4; THENCE NORTH TO THE SOUTHEAST CORNER OF SAID SECTION 28; THENCE WEST ALONG THE SOUTH LINE THEREOF TO THE EAST RIGHT-OF-WAY OF COUNTY ROAD 121; THENCE NORTH ALONG SAID RIGHT-OF-WAY TO THE NORTH LINE OF THE SOUTH 1/4 OF SAID SECTION 28; THENCE EAST ALONG SAID NORTH LINE TO THE WEST LINE OF THE EAST 1/4 OF SAID SECTION 28; THENCE NORTH ALONG SAID WEST LINE TO THE POINT OF BEGINNING.

AND

BEGIN AT THE SOUTHEAST CORNER OF THE NORTHWEST 1/4 OF THE SOUTHEAST 1/4 OF SECTION 28, TOWNSHIP 18 SOUTH, RANGE 23 EAST, SUMTER COUNTY, FLORIDA: THENCE N89°37'21"W ALONG THE SOUTH LINE THEREOF A DISTANCE OF 1167.35 FEET; THENCE N46°32'09"E, 185.43 FEET; THENCE N07°26'37"E, 90.00 FEET; THENCE N07°26'52"E, 122.83 FEET; THENCE N10°16'58"E, 112.95 FEET; THENCE N10°17'58"E, 99.99 FEET; THENCE N12°34'39"E, 94.28 FEET; THENCE N20°23'02"E, 95.92 FEET; THENCE N23°17'14"E, 100.02 FEET; THENCE N37°06'44"E, 92.47 FEET; THENCE N48°11'09"E, 170.00 FEET; THENCE N00°21'51"E, 300.16 FEET TO A POINT THAT IS 10 FEET SOUTH OF THE NORTH LINE OF THE SAID NORTHWEST 1/4 OF THE SOUTHEAST 1/4; THENCE PARALLEL TO SAID NORTH LINE RUN EAST A DISTANCE OF 698.52 FEET TO A POINT ON THE EAST LINE OF THE SAID NORTHWEST 1/4 OF THE SOUTHEAST 1/4; THENCE SOUTHERLY ALONG SAID EAST LINE TO THE POINT OF BEGINNING.

H.G. MORSE
Issuing Officer

PRESIDENT
Title

FIRST REVISED SHEET NO. 2.0
CANCELS ORIGINAL SHEET NO. 2.0

NAME OF COMPANY: NORTH SUMTER UTILITY COMPANY, LLC

WASTEWATER TARIFF

WASTEWATER TARIFF

Table of Contents

	Sheet Number
Communities Served Listing.....	4.0
Description of Territory Served.....	3.1 - 3.7
Index of	
Rates and Charges Schedules.....	11.0
Rules and Regulations.....	6.0 - 6.1
Service Availability Policy.....	21.0
Standard Forms.....	17.0
Technical Terms and Abbreviations.....	5.0 - 5.1
Territory Served.....	3.0

H.G. MORSE
Issuing Officer

PRESIDENT
Title

SECOND REVISED SHEET NO. 3.0
CANCELS FIRST REVISED SHEET NO. 3.0

NAME OF COMPANY: NORTH SUMTER UTILITY COMPANY, LLC
WASTEWATER TARIFF

TERRITORY SERVED

CERTIFICATE NUMBER - 532-S

COUNTY - SUMTER

COMMISSION ORDER(S) APPROVING TERRITORY SERVED -

<u>Order Number</u>	<u>Date Issued</u>	<u>Docket Number</u>	<u>Filing Type</u>
PSC-02-0554-PAA-WS	April 23, 2002	010859-WS	Original Certificate
PSC-03-0768-FOF-WS	June 27, 2003	021036-WS	Amendment Deletion Amendment

H.G. MORSE
Issuing Officer

PRESIDENT
Title

NAME OF COMPANY: NORTH SUMTER UTILITY COMPANY, LLC

WASTEWATER TARIFF

(Continued from Sheet No. 3.4)

DESCRIPTION OF TERRITORY TO BE SERVED

AREA TO BE DELETED

THOSE PORTIONS OF SECTIONS 27, 28, 33 AND 34 OF TOWNSHIP 18 SOUTH, RANGE 23 EAST AND OF SECTIONS 3 AND 4 OF TOWNSHIP 19 SOUTH, RANGE 23 EAST, ALL IN SUMTER COUNTY, FLORIDA, DESCRIBED AS FOLLOWS:

COMMENCE AT THE EAST 1/4 CORNER (SOUTHEAST CORNER OF GOVERNMENT LOT 1) OF SECTION 28, TOWNSHIP 18 SOUTH, RANGE 23 EAST, SUMTER COUNTY, FLORIDA; THENCE WESTERLY ALONG THE NORTH LINE OF THE NORTHEAST 1/4 OF THE SOUTHEAST 1/4 OF SAID SECTION 27 A DISTANCE OF 1,321.65 FEET TO THE SOUTHWEST CORNER OF GOVERNMENT LOT 1 AND THE POINT OF BEGINNING; THENCE N00°24'57"E, 697.24 FEET; THENCE S89°35'03"E, 310.55 FEET; THENCE S12°39'38"E, 701.50 FEET; THENCE N77°04'03"E, 611.75 FEET; THENCE S82°42'52"E, 416.88 FEET; THENCE S37°58'44"E, 215.53 FEET; THENCE N90°00'00"E, 68.67 FEET; THENCE N51°59'31"E, 172.57 FEET; THENCE N89°56'32"E, 362.50 FEET; THENCE S46°47'34"E, 266.30 FEET; THENCE S80°11'14"E, 133.65 FEET; THENCE N65°13'16"E, 616.99 FEET; THENCE N83°07'11"E, 178.87 FEET; THENCE S34°48'37"E, 674.15 FEET; THENCE S17°20'35"E, 257.20 FEET; THENCE S09°46'55"E, 83.22 FEET; THENCE S32°39'58"W, 605.09 FEET; THENCE S24°01'20"W, 148.63 FEET; THENCE CONTINUE S24°01'20"W , 446.81 FEET; THENCE S05°12'27"W, 645.38 FEET; THENCE S31°26'11"W, 101.22 FEET; THENCE S61°59'19"W, 77.51 FEET; THENCE S87°48'34"W, 605.13 FEET; THENCE S00°00'00"E, 397.53 FEET; THENCE S30°57'38"W, 127.21 FEET; THENCE S06°34'04"E, 30.00 FEET TO A POINT ON THE ARC OF A CURVE CONCAVE SOUTH, HAVING A RADIUS OF 5,430.00 FEET AND A CHORD BEARING AND DISTANCE OF N83°36'21"E, 32.88 FEET; THENCE EASTERLY ALONG THE ARC OF SAID CURVE, THROUGH A CENTRAL ANGLE OF 00°20'49", AN ARC DISTANCE OF 32.88 FEET; THENCE N83°46'45"E, 757.37 FEET TO THE POINT OF CURVATURE OF A CURVE CONCAVE SOUTH AND HAVING A RADIUS OF 12,000.00 FEET; THENCE EASTERLY ALONG THE ARC OF SAID CURVE THROUGH A CENTRAL ANGLE OF 01°00'13", AN ARC DISTANCE OF 210.20 FEET; THENCE N84°46'58"E, 306.58 FEET TO THE POINT OF CURVATURE OF A CURVE CONCAVE SOUTH AND HAVING A RADIUS OF 9,970.00 FEET; THENCE EASTERLY ALONG THE ARC OF SAID CURVE THROUGH A CENTRAL ANGLE OF 01°48'09", AN ARC DISTANCE OF 313.65 FEET; THENCE N86°35'07"E, 255.07 FEET TO THE POINT OF CURVATURE OF A CURVE CONCAVE SOUTH AND HAVING A RADIUS OF 2,000.00 FEET; THENCE EASTERLY ALONG THE ARC OF SAID CURVE

(Continued on Sheet No. 3.6)

H.G. MORSE
Issuing Officer

PRESIDENT
Title

NAME OF COMPANY: NORTH SUMTER UTILITY COMPANY, LLC

WASTEWATER TARIFF

(Continued from Sheet No. 3.5)

DESCRIPTION OF TERRITORY TO BE SERVEDAREA TO BE DELETED (continued)

THROUGH A CENTRAL ANGLE OF 01°48'38", AN ARC DISTANCE OF 63.20 FEET; THENCE N88°23'44"E, 110.47 FEET TO A POINT ON THE ARC OF A CURVE CONCAVE WEST, HAVING A RADIUS OF 1,200.00 FEET AND A CHORD BEARING AND DISTANCE OF S06°03'43"W, 4.77 FEET; THENCE SOUTHERLY ALONG THE ARC OF SAID CURVE, THROUGH A CENTRAL ANGLE OF 00°13'40", AN ARC DISTANCE OF 4.77 FEET TO THE POINT OF COMPOUND CURVATURE OF A CURVE CONCAVE WEST AND HAVING A RADIUS OF 2,000.00 FEET; THENCE SOUTHERLY ALONG THE ARC OF SAID CURVE THROUGH A CENTRAL ANGLE OF 11°15'30", AN ARC DISTANCE OF 392.99 FEET; THENCE S17°26'05"W, 418.34 FEET TO THE POINT OF CURVATURE OF A CURVE CONCAVE EAST AND HAVING A RADIUS OF 3,000.00 FEET; THENCE SOUTHERLY ALONG THE ARC OF SAID CURVE THROUGH A CENTRAL ANGLE OF 26°56'40", AN ARC DISTANCE OF 1,410.81 FEET TO THE POINT OF COMPOUND CURVATURE OF A CURVE CONCAVE NORTHEAST AND HAVING A RADIUS OF 1,500.00 FEET; THENCE SOUTHEASTERLY ALONG THE ARC OF SAID CURVE THROUGH A CENTRAL ANGLE OF 27°06'39", AN ARC DISTANCE OF 709.76 FEET TO THE POINT OF COMPOUND CURVATURE OF A CURVE CONCAVE NORTHEAST AND HAVING A RADIUS OF 5,720.00 FEET; THENCE SOUTHEASTERLY ALONG THE ARC OF SAID CURVE THROUGH A CENTRAL ANGLE OF 16°39'50", AN ARC DISTANCE OF 1,663.60 FEET TO A POINT ON THE ARC OF A CURVE CONCAVE WEST, HAVING A RADIUS OF 72.50 FEET AND A CHORD BEARING AND DISTANCE OF S05°23'43"E, 96.55 FEET; THENCE SOUTHERLY ALONG THE ARC OF SAID CURVE, THROUGH A CENTRAL ANGLE OF 276°30'17", AN ARC DISTANCE OF 349.88 FEET; THENCE S42°51'25"W, 2,526.80 FEET; THENCE N90°00'00"E, 1,450.06 FEET, MORE OR LESS, TO THE WEST LINE OF THE EAST 1/4 OF THE NORTHEAST 1/4 OF SAID SECTION 3 ; THENCE SOUTHERLY ALONG SAID WEST LINE A DISTANCE OF 1,647.46 FEET , MORE OR LESS, TO THE NORTH RIGHT-OF-WAY OF COUNTY ROAD 466A; THENCE WEST ALONG SAID RIGHT-OF-WAY TO THE WEST LINE OF THE EAST 3/4 OF SAID SECTION 3; THENCE NORTH TO THE SOUTHEAST CORNER OF THE NORTHWEST 1/4 OF NORTHWEST 1/4 OF SAID SECTION 3; THENCE WEST TO THE SOUTHEAST CORNER OF THE EAST 1/2 OF THE NORTHEAST 1/4 OF THE NORTHEAST 1/4 OF SAID SECTION 4; THENCE WEST 660.00 FEET MORE OR LESS TO THE SOUTHWEST CORNER OF THE EAST 1/2 OF THE NORTHEAST 1/4 OF NORTHEAST 1/4; THENCE NORTH TO THE NORTHWEST CORNER OF THE EAST 1/2 OF THE NORTHEAST 1/4 OF NORTHEAST 1/4 OF SAID SECTION 4; THENCE WEST TO THE SOUTHWEST

(Continued on Sheet No. 3.7)

H.G. MORSE
Issuing Officer

PRESIDENT
Title

NAME OF COMPANY: NORTH SUMTER UTILITY COMPANY, LLC

WATER TARIFF

(Continued from Sheet No. 3.6)

DESCRIPTION OF TERRITORY TO BE SERVED

AREA TO BE DELETED (continued)

CORNER OF THE EAST ½ OF THE SOUTHEAST 1/4 OF SAID SECTION 33; THENCE NORTH TO THE NORTHWEST CORNER OF THE EAST OF THE SOUTHEAST 1/4 OF SAID SECTION 33; THENCE EAST TO THE NORTHEAST CORNER OF THE SAID EAST ½ OF SOUTHEAST 1/4; THENCE NORTH TO THE SOUTHEAST CORNER OF SAID SECTION 28; THENCE WEST ALONG THE SOUTH LINE THEREOF TO THE EAST RIGHT-OF-WAY OF COUNTY ROAD 121; THENCE NORTH ALONG SAID RIGHT-OF-WAY TO THE NORTH LINE OF THE SOUTH 1/4 OF SAID SECTION 28; THENCE EAST ALONG SAID NORTH LINE TO THE WEST LINE OF THE EAST 1/4 OF SAID SECTION 28; THENCE NORTH ALONG SAID WEST LINE TO THE POINT OF BEGINNING.

AND

BEGIN AT THE SOUTHEAST CORNER OF THE NORTHWEST 1/4 OF THE SOUTHEAST 1/4 OF SECTION 28, TOWNSHIP 18 SOUTH, RANGE 23 EAST, SUMTER COUNTY, FLORIDA: THENCE N89°37'21"W ALONG THE SOUTH LINE THEREOF A DISTANCE OF 1167.35 FEET; THENCE N46°32'09"E, 185.43 FEET; THENCE N07°26'37"E, 90.00 FEET; THENCE N07°26'52"E, 122.83 FEET; THENCE N10°16'58"E, 112.95 FEET; THENCE N10°17'58"E, 99.99 FEET; THENCE N12°34'39"E, 94.28 FEET; THENCE N20°23'02"E, 95.92 FEET; THENCE N23°17'14"E, 100.02 FEET; THENCE N37°06'44"E, 92.47 FEET; THENCE N48°11'09"E, 170.00 FEET; THENCE N00°21'51"E, 300.16 FEET TO A POINT THAT IS 10 FEET SOUTH OF THE NORTH LINE OF THE SAID NORTHWEST 1/4 OF THE SOUTHEAST 1/4; THENCE PARALLEL TO SAID NORTH LINE RUN EAST A DISTANCE OF 698.52 FEET TO A POINT ON THE EAST LINE OF THE SAID NORTHWEST 1/4 OF THE SOUTHEAST 1/4; THENCE SOUTHERLY ALONG SAID EAST LINE TO THE POINT OF BEGINNING.

H.G. MORSE
Issuing Officer

PRESIDENT
Title

FIRST REVISED SHEET NO. 2.0
CANCELS ORIGINAL SHEET NO. 2.0

NAME OF COMPANY: NORTH SUMTER UTILITY COMPANY, LLC
WATER TARIFF

WATER TARIFF

TABLE OF CONTENTS

	Sheet Number
Communities Served Listing "Held for Future Use"	4.0
Description of Territory Served.....	3.1 - 3.7
Index of	
Rates and Charges Schedules.....	11.0
Rules and Regulations.....	6.0 - 6.1
Service Availability Policy.....	23.0
Standard Forms.....	18.0
Technical Terms and Abbreviations.....	5.0 - 5.1
Territory Served.....	3.0

H.G. MORSE
Issuing Officer

PRESIDENT
Title

SECOND REVISED SHEET NO. 3.0
CANCELS FIRST REVISED SHEET NO. 3.0

NAME OF COMPANY: NORTH SUMTER UTILITY COMPANY, LLC

WATER TARIFF

TERRITORY AUTHORITY

CERTIFICATE NUMBER - 618 - W

COUNTY - Sumter

COMMISSION ORDER(s) APPROVING TERRITORY SERVED -

<u>Order Number</u>	<u>Date Issued</u>	<u>Docket Number</u>	<u>Filing Type</u>
PSC-02-0554-PAA-WS	April 23, 2002	010859-WS	Original Certificate
PSC-03-0768-FOF-WS	June 27, 2003	021036-WS	Amendment Deletion Amendment

H.G. MORSE
Issuing Officer

PRESIDENT
Title

NAME OF COMPANY: NORTH SUMTER UTILITY COMPANY, LLC

WATER TARIFF

(Continued from Sheet No. 3.4)

DESCRIPTION OF TERRITORY TO BE SERVED

AREA TO BE DELETED

THOSE PORTIONS OF SECTIONS 27, 28, 33 AND 34 OF TOWNSHIP 18 SOUTH, RANGE 23 EAST AND OF SECTIONS 3 AND 4 OF TOWNSHIP 19 SOUTH, RANGE 23 EAST, ALL IN SUMTER COUNTY, FLORIDA, DESCRIBED AS FOLLOWS:

COMMENCE AT THE EAST 1/4 CORNER (SOUTHEAST CORNER OF GOVERNMENT LOT 1) OF SECTION 28, TOWNSHIP 18 SOUTH, RANGE 23 EAST, SUMTER COUNTY, FLORIDA; THENCE WESTERLY ALONG THE NORTH LINE OF THE NORTHEAST 1/4 OF THE SOUTHEAST 1/4 OF SAID SECTION 27 A DISTANCE OF 1,321.65 FEET TO THE SOUTHWEST CORNER OF GOVERNMENT LOT 1 AND THE POINT OF BEGINNING; THENCE N00°24'57"E, 697.24 FEET; THENCE S89°35'03"E, 310.55 FEET; THENCE S12°39'38"E, 701.50 FEET; THENCE N77°04'03"E, 611.75 FEET; THENCE S82°42'52"E, 416.88 FEET; THENCE S37°58'44"E, 215.53 FEET; THENCE N90°00'00"E, 68.67 FEET; THENCE N51°59'31"E, 172.57 FEET; THENCE N89°56'32"E, 362.50 FEET; THENCE S46°47'34"E, 266.30 FEET; THENCE S80°11'14"E, 133.65 FEET; THENCE N65°13'16"E, 616.99 FEET; THENCE N83°07'11"E, 178.87 FEET; THENCE S34°48'37"E, 674.15 FEET; THENCE S17°20'35"E, 257.20 FEET; THENCE S09°46'55"E, 83.22 FEET; THENCE S32°39'58"W, 605.09 FEET; THENCE S24°01'20"W, 148.63 FEET; THENCE CONTINUE S24°01'20"W , 446.81 FEET; THENCE S05°12'27"W, 645.38 FEET; THENCE S31°26'11"W, 101.22 FEET; THENCE S61°59'19"W, 77.51 FEET; THENCE S87°48'34"W, 605.13 FEET; THENCE S00°00'00"E, 397.53 FEET; THENCE S30°57'38"W, 127.21 FEET; THENCE S06°34'04"E, 30.00 FEET TO A POINT ON THE ARC OF A CURVE CONCAVE SOUTH, HAVING A RADIUS OF 5,430.00 FEET AND A CHORD BEARING AND DISTANCE OF N83°36'21"E, 32.88 FEET; THENCE EASTERLY ALONG THE ARC OF SAID CURVE, THROUGH A CENTRAL ANGLE OF 00°20'49", AN ARC DISTANCE OF 32.88 FEET; THENCE N83°46'45"E, 757.37 FEET TO THE POINT OF CURVATURE OF A CURVE CONCAVE SOUTH AND HAVING A RADIUS OF 12,000.00 FEET; THENCE EASTERLY ALONG THE ARC OF SAID CURVE THROUGH A CENTRAL ANGLE OF 01°00'13", AN ARC DISTANCE OF 210.20 FEET; THENCE N84°46'58"E, 306.58 FEET TO THE POINT OF CURVATURE OF A CURVE CONCAVE SOUTH AND HAVING A RADIUS OF 9,970.00 FEET; THENCE EASTERLY ALONG THE ARC OF SAID CURVE THROUGH A CENTRAL ANGLE OF 01°48'09", AN ARC DISTANCE OF 313.65 FEET; THENCE N86°35'07"E, 255.07 FEET TO THE POINT OF CURVATURE OF A CURVE CONCAVE SOUTH AND HAVING A RADIUS OF 2,000.00 FEET; THENCE EASTERLY ALONG THE ARC OF SAID CURVE

(Continued on Sheet No. 3.6)

H.G. MORSE
Issuing Officer

PRESIDENT
Title

NAME OF COMPANY: NORTH SUMTER UTILITY COMPANY, LLC

WATER TARIFF

(Continued from Sheet No. 3.5)

DESCRIPTION OF TERRITORY TO BE SERVEDAREA TO BE DELETED (continued)

THROUGH A CENTRAL ANGLE OF 01°48'38", AN ARC DISTANCE OF 63.20 FEET; THENCE N88°23'44"E, 110.47 FEET TO A POINT ON THE ARC OF A CURVE CONCAVE WEST, HAVING A RADIUS OF 1,200.00 FEET AND A CHORD BEARING AND DISTANCE OF S06°03'43"W, 4.77 FEET; THENCE SOUTHERLY ALONG THE ARC OF SAID CURVE, THROUGH A CENTRAL ANGLE OF 00°13'40", AN ARC DISTANCE OF 4.77 FEET TO THE POINT OF COMPOUND CURVATURE OF A CURVE CONCAVE WEST AND HAVING A RADIUS OF 2,000.00 FEET; THENCE SOUTHERLY ALONG THE ARC OF SAID CURVE THROUGH A CENTRAL ANGLE OF 11°15'30", AN ARC DISTANCE OF 392.99 FEET; THENCE S17°26'05"W, 418.34 FEET TO THE POINT OF CURVATURE OF A CURVE CONCAVE EAST AND HAVING A RADIUS OF 3,000.00 FEET; THENCE SOUTHERLY ALONG THE ARC OF SAID CURVE THROUGH A CENTRAL ANGLE OF 26°56'40", AN ARC DISTANCE OF 1,410.81 FEET TO THE POINT OF COMPOUND CURVATURE OF A CURVE CONCAVE NORTHEAST AND HAVING A RADIUS OF 1,500.00 FEET; THENCE SOUTHEASTERLY ALONG THE ARC OF SAID CURVE THROUGH A CENTRAL ANGLE OF 27°06'39", AN ARC DISTANCE OF 709.76 FEET TO THE POINT OF COMPOUND CURVATURE OF A CURVE CONCAVE NORTHEAST AND HAVING A RADIUS OF 5,720.00 FEET; THENCE SOUTHEASTERLY ALONG THE ARC OF SAID CURVE THROUGH A CENTRAL ANGLE OF 16°39'50", AN ARC DISTANCE OF 1,663.60 FEET TO A POINT ON THE ARC OF A CURVE CONCAVE WEST, HAVING A RADIUS OF 72.50 FEET AND A CHORD BEARING AND DISTANCE OF S05°23'43"E, 96.55 FEET; THENCE SOUTHERLY ALONG THE ARC OF SAID CURVE, THROUGH A CENTRAL ANGLE OF 276°30'17", AN ARC DISTANCE OF 349.88 FEET; THENCE S42°51'25"W, 2,526.80 FEET; THENCE N90°00'00"E, 1,450.06 FEET, MORE OR LESS, TO THE WEST LINE OF THE EAST OF THE NORTHEAST 1/4 OF SAID SECTION 3 ; THENCE SOUTHERLY ALONG SAID WEST LINE A DISTANCE OF 1,647.46 FEET , MORE OR LESS, TO THE NORTH RIGHT-OF-WAY OF COUNTY ROAD 466A; THENCE WEST ALONG SAID RIGHT-OF-WAY TO THE WEST LINE OF THE EAST 3/4 OF SAID SECTION 3; THENCE NORTH TO THE SOUTHEAST CORNER OF THE NORTHWEST 1/4 OF NORTHWEST 1/4 OF SAID SECTION 3; THENCE WEST TO THE SOUTHEAST CORNER OF THE EAST ½ OF THE NORTHEAST 1/4 OF THE NORTHEAST 1/4 OF SAID SECTION 4; THENCE WEST 660.00 FEET MORE OR LESS TO THE SOUTHWEST CORNER OF THE EAST ½ OF THE NORTHEAST 1/4 OF NORTHEAST 1/4; THENCE NORTH TO THE NORTHWEST CORNER OF THE EAST ½ OF THE NORTHEAST 1/4 OF NORTHEAST 1/4 OF SAID SECTION 4; THENCE WEST TO THE SOUTHWEST

(Continued on Sheet No. 3.7)

H.G. MORSE
Issuing Officer

PRESIDENT
Title

NAME OF COMPANY: NORTH SUMTER UTILITY COMPANY, LLC

WATER TARIFF

(Continued from Sheet No. 3.6)

DESCRIPTION OF TERRITORY TO BE SERVED

AREA TO BE DELETED (continued)

CORNER OF THE EAST 1/2 OF THE SOUTHEAST 1/4 OF SAID SECTION 33; THENCE NORTH TO THE NORTHWEST CORNER OF THE EAST OF THE SOUTHEAST 1/4 OF SAID SECTION 33; THENCE EAST TO THE NORTHEAST CORNER OF THE SAID EAST 1/2 OF SOUTHEAST 1/4; THENCE NORTH TO THE SOUTHEAST CORNER OF SAID SECTION 28; THENCE WEST ALONG THE SOUTH LINE THEREOF TO THE EAST RIGHT-OF-WAY OF COUNTY ROAD 121; THENCE NORTH ALONG SAID RIGHT-OF-WAY TO THE NORTH LINE OF THE SOUTH 1/4 OF SAID SECTION 28; THENCE EAST ALONG SAID NORTH LINE TO THE WEST LINE OF THE EAST 1/4 OF SAID SECTION 28; THENCE NORTH ALONG SAID WEST LINE TO THE POINT OF BEGINNING.

AND

BEGIN AT THE SOUTHEAST CORNER OF THE NORTHWEST 1/4 OF THE SOUTHEAST 1/4 OF SECTION 28, TOWNSHIP 18 SOUTH, RANGE 23 EAST, SUMTER COUNTY, FLORIDA: THENCE N89°37'21"W ALONG THE SOUTH LINE THEREOF A DISTANCE OF 1167.35 FEET; THENCE N46°32'09"E, 185.43 FEET; THENCE N07°26'37"E, 90.00 FEET; THENCE N07°26'52"E, 122.83 FEET; THENCE N10°16'58"E, 112.95 FEET; THENCE N10°17'58"E, 99.99 FEET; THENCE N12°34'39"E, 94.28 FEET; THENCE N20°23'02"E, 95.92 FEET; THENCE N23°17'14"E, 100.02 FEET; THENCE N37°06'44"E, 92.47 FEET; THENCE N48°11'09"E, 170.00 FEET; THENCE N00°21'51"E, 300.16 FEET TO A POINT THAT IS 10 FEET SOUTH OF THE NORTH LINE OF THE SAID NORTHWEST 1/4 OF THE SOUTHEAST 1/4; THENCE PARALLEL TO SAID NORTH LINE RUN EAST A DISTANCE OF 698.52 FEET TO A POINT ON THE EAST LINE OF THE SAID NORTHWEST 1/4 OF THE SOUTHEAST 1/4; THENCE SOUTHERLY ALONG SAID EAST LINE TO THE POINT OF BEGINNING.

H.G. MORSE
Issuing Officer

PRESIDENT
Title

EXHIBIT "D"

**AFFIDAVIT OF NOTICE GIVEN PURSUANT TO
§367.045(1)(a), FLORIDA STATUTES AND
RULE 25-30.030, FLORIDA ADMINISTRATIVE CODE**

AFFIDAVIT OF MAILING

STATE OF FLORIDA

COUNTY OF SEMINOLE

Before me, the undersigned authority, authorized to administer oaths and take acknowledgments, personally appeared Trina Collins, who, after being duly sworn on oath, did depose on oath and say that she is a legal assistant to Martin S. Friedman, the attorney for North Sumter Utility Company, L.L.C., and that on November 12, 2003, she did send by regular U.S. mail, a copy of the Notice attached hereto to each of the utilities, governmental bodies, agencies, or municipalities, in accordance with the list provided by the Florida Public Service Commission, which is also attached hereto.

FURTHER AFFIANT SAYETH NAUGHT.



TRINA COLLINS

Sworn to and subscribed before me this 12th day of November, 2003, by Trina Collins, who is personally known to me.



D. Michele Parks
MY COMMISSION # DD152693 EXPIRES
September 24, 2006
BONDED THRU TROY FAJN INSURANCE, INC



NOTARY PUBLIC - STATE OF FLORIDA
My Commission Expires:

**LIST OF WATER AND WASTEWATER UTILITIES IN SUMTER COUNTY
(VALID FOR 60 DAYS)
11/06/2003 - 01/04/2004**

UTILITY NAME

SUMTER COUNTY

MANAGER

CONTINENTAL UTILITY, INC. (WS606)
50 CONTINENTAL BLVD.
WILDWOOD, FL 34785-8147

BOB HUNT
(352) 748-0100

CRYSTAL RIVER UTILITIES, INC. (WS768)
% AQUASOURCE, INC.
6960 PROFESSIONAL PARKWAY EAST, #400
SARASOTA, FL 32240-8432

NANCE GUTH
(941) 907-7411

FLORIDA WATER SERVICES CORPORATION (WS487)
P. O. BOX 609520
ORLANDO, FL 32860-9520

CARLYN KOWALSKY
(407) 598-4297

LITTLE SUMTER UTILITY COMPANY (WS762)
1100 MAIN STREET
THE VILLAGES, FL 32159-7719

H. GARY MORSE
(352) 753-2270

NORTH SUMTER UTILITY COMPANY, L.L.C. (WS846)
1100 MAIN STREET
THE VILLAGES, FL 32159-7719

GARY MORSE
(352) 753-2270

**LIST OF WATER AND WASTEWATER UTILITIES IN SUMTER COUNTY
(VALID FOR 60 DAYS)
11/06/2003 - 01/04/2004**

UTILITY NAME

MANAGER

GOVERNMENTAL AGENCIES

CLERK, BOARD OF COUNTY COMMISSIONERS, SUMTER COUNTY
SUMTER COUNTY COURTHOUSE
209 NORTH FLORIDA STREET
BUSHNELL, FL 33513-6127

DEP SOUTHWEST DISTRICT
3804 COCONUT PALM DRIVE
TAMPA, FL 33618-8318

MAYOR, CITY OF BUSHNELL
P. O. BOX 115
BUSHNELL, FL 33513-0115

MAYOR, CITY OF CENTER HILL
P. O. BOX 649
CENTER HILL, FL 33514-0649

MAYOR, CITY OF COLEMAN
WEST CENTRAL AVENUE
P. O. BOX 456
COLEMAN, FL 33521-0456

MAYOR, CITY OF WEBSTER
P. O. BOX 28
WEBSTER, FL 33597-0028

MAYOR, CITY OF WILDWOOD
100 NORTH MAIN STREET
WILDWOOD, FL 34785-4047

S.W. FLORIDA WATER MANAGEMENT DISTRICT
2379 BROAD STREET
BROOKSVILLE, FL 34609-6899

WITHLACOOCHEE PLANNING COUNCIL
1241 S.W. 10TH STREET
OCALA, FL 34474-2798

**LIST OF WATER AND WASTEWATER UTILITIES IN SUMTER COUNTY
(VALID FOR 60 DAYS)
11/06/2003 - 01/04/2004**

UTILITY NAME

STATE OFFICIALS

MANAGER

STATE OF FLORIDA PUBLIC COUNSEL
C/O THE HOUSE OF REPRESENTATIVES
THE CAPITOL
TALLAHASSEE, FL 32399-1300

DIVISION OF THE COMMISSION CLERK AND ADMINISTRATIVE SERVICES
FLORIDA PUBLIC SERVICE COMMISSION
2540 SHUMARD OAK BOULEVARD
TALLAHASSEE, FL 32399-0850

EXHIBIT "E"

LATE FILED

AFFIDAVIT OF NOTICE TO PROPERTY OWNERS

EXHIBIT "F"

LATE FILED

AFFIDAVIT OF PUBLICATION
§367.045(1)(a), FLORIDA STATUTES AND
RULE 25-30.030, FLORIDA ADMINISTRATIVE CODE

AFFIDAVIT

STATE OF FLORIDA
COUNTY OF SEMINOLE

Before me, the undersigned authority, authorized to administer oaths and take acknowledgments, personally appeared MARTIN S. FRIEDMAN, ESQUIRE, who, after being duly sworn on oath, did depose on oath and say that he is the attorney for North Sumter Utility Company, L.L.C., and that as of November 6, 2003, North Sumter Utility Company, L.L.C., has Tariffs and Annual Reports on file with the Public Service Commission.

FURTHER AFFIANT SAYETH NAUGHT.



MARTIN S. FRIEDMAN

Sworn to and subscribed before me this 12th day of November, 2003, by MARTIN S. FRIEDMAN, who is personally known to me.

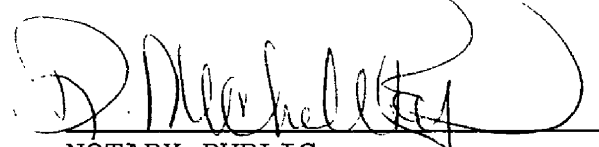

NOTARY PUBLIC
My Commission Expires:



D. Michele Parks
MY COMMISSION # DD152693 EXPIRES
September 24, 2006
BONDED THROUGH TROY FAIN INSURANCE, INC.

EXHIBIT "G"