

LAW OFFICES
ROSE, SUNDSTROM & BENTLEY, LLP
2548 BLAIRSTONE PINES DRIVE
TALLAHASSEE, FLORIDA 32301

FREDERICK L. ASCHAUER, JR.
CHRIS H. BENTLEY, P.A.
ROBERT C. BRANNAN
DAVID F. CHESTER
F. MARSHALL DETERDING
JOHN R. JENKINS, P.A.
STEVEN T. MINDLIN, P.A.
DAREN L. SHIPPY
WILLIAM E. SUNDSTROM, P.A.
DIANE D. TREMOR, P.A.
JOHN L. WHARTON
ROBERT M. C. ROSE, *OF COUNSEL*
WAYNE L. SCHIEFELBEIN, *OF COUNSEL*

(850) 877-6555
FAX (850) 656-4029
www.rsbatorneys.com

CENTRAL FLORIDA OFFICE
600 S. NORTH LAKE BLVD., SUITE 160
ALTAMONTE SPRINGS, FLORIDA 32701
(407) 830-6331
FAX (407) 830-8522

MARTIN S. FRIEDMAN, P.A.
VALERIE L. LORD, *OF COUNSEL*
(LICENSED IN TEXAS ONLY)

November 17, 2003

VIA HAND DELIVERY

Ms. Blanca Bayo
Director
Division of the Commission Clerk
And Administrative Services
Florida Public Service Commission
2540 Shumard Oak Boulevard
Tallahassee, Florida 32399-0850

RE: Docket No. 030423-WU
Residential Water Systems, Inc.

Dear Ms. Bayo:

Enclosed on behalf of Residential Water Systems, Inc. for filing in the above docket are an original and 3 copies of:

1. Response to Staff Data Request #44 (3 pp)
2. Response to Staff Data Request #45 (1 page)
3. Response to Staff Data Request #46 (1 page)
4. Response to Staff Data Requests #48 & #49 (63 pp)
5. Letter dated November 17, 2003 from Charles deMenzes with three pages of attachments, responding to Staff Data Requests #50 through #53.

With reference to Staff Data Request #47, I am advised by Mr. deMenzes that the Company cannot find a copy of its current Consumptive Use Permit and that he will therefore request the Company's engineers to obtain a copy from the St. Johns River Water Management District. Upon receipt, a copy will be furnished to Staff.

DOCUMENT NUMBER 030423
11498 NOV 17 8
FPSC-COMMISSION CLERK

Ms. Blanca Bayo
November 17, 2003
Page 2

Please acknowledge receipt by date stamping the extra copy provided.

Sincerely,

A handwritten signature in black ink, reading "Wayne L. Schiefelbein". The signature is written in a cursive style with a large, sweeping initial "W".

Wayne L. Schiefelbein
Of Counsel

WLS/dcr
Residential Water Systems/Bayo ltr

Docket No.: 030423-WU

RESPONSE TO STAFF DATA REQUEST #44

44

| Month/Year | Cust Class | Meter Size | # Cust Billed | # ERC's | # Gal Sold |
|------------|-------------|------------|---------------|---------|------------|
| Jan-98 | Residential | 5/8" | 520 | 303 | 3291253 |
| Feb-98 | Residential | 5/8" | 522 | 328 | 3444112 |
| Mar-98 | Residential | 5/8" | 521 | 307 | 3335726 |
| Apr-98 | Residential | 5/8" | 521 | 546 | 5728567 |
| May-98 | Residential | 5/8" | 519 | 799 | 8672073 |
| Jun-98 | Residential | 5/8" | 521 | 853 | 8953875 |
| Jul-98 | Residential | 5/8" | 521 | 499 | 5417066 |
| Aug-98 | Residential | 5/8" | 522 | 404 | 4379946 |
| Sep-98 | Residential | 5/8" | 523 | 430 | 4519503 |
| Oct-98 | Residential | 5/8" | 525 | 407 | 4416751 |
| Nov-98 | Residential | 5/8" | 525 | 496 | 5203860 |
| Dec-98 | Residential | 5/8" | 524 | 404 | 4388094 |
| Jan-99 | Residential | 5/8" | 526 | 350 | 3797266 |
| Feb-99 | Residential | 5/8" | 527 | 379 | 3975199 |
| Mar-99 | Residential | 5/8" | 527 | 400 | 4335158 |
| Apr-99 | Residential | 5/8" | 528 | 751 | 7880954 |
| May-99 | Residential | 5/8" | 528 | 680 | 7375756 |
| Jun-99 | Residential | 5/8" | 527 | 572 | 6001912 |
| Jul-99 | Residential | 5/8" | 528 | 420 | 4559264 |
| Aug-99 | Residential | 5/8" | 526 | 550 | 5963254 |
| Sep-99 | Residential | 5/8" | 525 | 525 | 5516575 |
| Oct-99 | Residential | 5/8" | 526 | 377 | 4086899 |
| Nov-99 | Residential | 5/8" | 526 | 428 | 4495589 |
| Dec-99 | Residential | 5/8" | 533 | 454 | 4929437 |
| Jan-00 | Residential | 5/8" | 531 | 385 | 4176040 |
| Feb-00 | Residential | 5/8" | 532 | 361 | 3790974 |
| Mar-00 | Residential | 5/8" | 531 | 491 | 5327678 |
| Apr-00 | Residential | 5/8" | 531 | 609 | 6395184 |
| May-00 | Residential | 5/8" | 528 | 294 | 3188520 |
| Jun-00 | Residential | 5/8" | 530 | 850 | 8925251 |
| Jul-00 | Residential | 5/8" | 529 | 487 | 5279709 |
| Aug-00 | Residential | 5/8" | 529 | 372 | 4033223 |
| Sep-00 | Residential | 5/8" | 530 | 450 | 4719788 |
| Oct-00 | Residential | 5/8" | 531 | 404 | 4387224 |
| Nov-00 | Residential | 5/8" | 531 | 487 | 5113643 |
| Dec-00 | Residential | 5/8" | 532 | 378 | 3965846 |

| | | | | | |
|--------|---------------------|-----------|-----------|------------|----------------|
| Jan-01 | Residential | 5/8" | 531 | 376 | 4079570 |
| | Dalton Woods | 1" | 3 | 0 | 1110 |
| Feb-01 | Residential | 5/8" | 533 | 357 | 3753193 |
| | Dalton Woods | 1" | 6 | 5 | 49950 |
| Mar-01 | Residential | 5/8" | 533 | 332 | 3597977 |
| | Dalton Woods | 1" | 10 | 19 | 207080 |
| Apr-01 | Residential | 5/8" | 531 | 451 | 4739408 |
| | Dalton Woods | 1" | 11 | 21 | 224750 |
| May-01 | Residential | 5/8" | 531 | 568 | 6160406 |
| | Dalton Woods | 1" | 17 | 38 | 416000 |
| Jun-01 | Residential | 5/8" | 527 | 590 | 6199224 |
| | Dalton Woods | 1" | 19 | 37 | 387430 |
| Jul-01 | Residential | 5/8" | 528 | 370 | 4015452 |
| | Dalton Woods | 1" | 29 | 30 | 328120 |
| Aug-01 | Residential | 5/8" | 531 | 313 | 3397614 |
| | Dalton Woods | 1" | 32 | 42 | 452760 |
| Sep-01 | Residential | 5/8" | 532 | 367 | 3850442 |
| | Dalton Woods | 1" | 45 | 89 | 939200 |
| Oct-01 | Residential | 5/8" | 532 | 548 | 5945989 |
| | Dalton Woods | 1" | 50 | 157 | 1707580 |
| Nov-01 | Residential | 5/8" | 529 | 362 | 3798739 |
| | Dalton Woods | 1" | 53 | 93 | 975680 |
| Dec-01 | Residential | 5/8" | 533 | 359 | 3892867 |
| | Dalton Woods | 1" | 57 | 104 | 1131030 |
| Jan-02 | Residential | 5/8" | 533 | 344 | 3733283 |
| | Dalton Woods | 1" | 59 | 89 | 961750 |
| Feb-02 | Residential | 5/8" | 535 | 347 | 3640914 |
| | Dalton Woods | 1" | 61 | 121 | 1267390 |
| Mar-02 | Residential | 5/8" | 536 | 343 | 3726012 |
| | Dalton Woods | 1" | 64 | 215 | 2333000 |
| Apr-02 | Residential | 5/8" | 536 | 541 | 5683371 |
| | Dalton Woods | 1" | 67 | 328 | 3446824 |
| May-02 | Residential | 5/8" | 535 | 614 | 6664558 |
| | Dalton Woods | 1" | 70 | 299 | 3242086 |
| Jun-02 | Residential | 5/8" | 536 | 544 | 5715274 |
| | Dalton Woods | 1" | 75 | 270 | 2836511 |
| Jul-02 | Residential | 5/8" | 534 | 354 | 3837361 |
| | Dalton Woods | 1" | 78 | 133 | 1446013 |

| | | | | | |
|--------|---------------------|-----------|-----------|-----|----------------|
| Aug-02 | Residential | 5/8" | 536 | 351 | 3804565 |
| | Dalton Woods | 1" | 86 | 113 | 1224391 |
| Sep-02 | Residential | 5/8" | 537 | 359 | 3767072 |
| | Dalton Woods | 1" | 90 | 126 | 1326153 |
| Oct-02 | Residential | 5/8" | 537 | 351 | 3807966 |
| | Dalton Woods | 1" | 94 | 193 | 2093835 |
| Nov-02 | Residential | 5/8" | 537 | 416 | 4369993 |
| | Dalton Woods | 1" | 96 | 237 | 2483880 |
| Dec-02 | Residential | 5/8" | 535 | 367 | 3985711 |
| | Dalton Woods | 1" | 97 | 170 | 1847949 |
| | | | | | |
| | | | | | |
| 1998 | Consumption | 5/8" | | | 61,750,826 |
| 1999 | Consumption | 5/8" | | | 62,917,263 |
| 2000 | Consumption | 5/8" | | | 59,303,080 |
| 2001 | Consumption | 5/8" | | | 53,430,881 |
| 2001 | Consumption | 1" | | | 9,082,750 |
| 2002 | Consumption | 5/8" | | | 52,736,080 |
| 2002 | Consumption | 1" | | | 28,879,775 |

Docket No.: 030423-WU

RESPONSE TO STAFF DATA REQUEST #45

45

HIGH POINT

SE 62ND STREET
SE 42ND AVE
SE 59TH STREET
SE 46TH AVE
SE 42ND CT
SE 60TH STREET
SE 61ST STREET
SE 65TH PLACE

EDGEWOOD

SE 66TH PL
SE 38TH CT
SE 67TH PL
SE 68TH STREET

SUNTREE

SE 58TH PL
SE 46TH TERR
SE 57TH LN
SE 58TH PL

COUNTRY ESTATES

SE 56TH LN
SE 42ND AVE
SE 54TH STREET
SE 44TH AVE
SE 42ND CT
SE 43RD CT

WINEBERRY

SE 61ST PL
SE 39TH AVE
SE 62ND ST
SE 37TH TERR
SE 60TH STREET
SE 59TH PL
SE 37TH AVE

DALTON WOODS

SE 48TH PL RD
SE 44TH CIR

OTHER NON-SUB

SE 66TH STREET
SE 41ST CT

Docket No.: 030423-WU

RESPONSE TO STAFF DATA REQUEST #46

46

SECOND REVISED SHEET NO. 4.0
CANCELS FIRST REVISED SHEET NO. 4.0

NAME OF COMPANY RESIDENTIAL WATER SYSTEMS, INC.

WATER TARIFF

COMMUNITIES SERVED LISTING

| <u>County Name</u> | <u>Development Name</u> | <u>Rate Schedule(s) Available</u> | <u>Sheet No.</u> |
|--------------------|--------------------------|-----------------------------------|------------------|
| MARION | HIGH POINTE SUB | YES | 13.0 |
| MARION | SUNTREE SUB | YES | 13.0 |
| MARION | EDGEWOOD SUB | YES | 13.0 |
| MARION | WINEBERRY SUB | YES | 13.0 |
| MARION | COUNTRY ESTATES | YES | 13.0 |
| | BUFFINGTON ADD. | | |
| MARION | DALTON WOODS | YES | 13.0 |
| MARION | DALTON WOODS | YES | 13.0 |
| | 1 ST ADDITION | | |

Charles deMenzes
Issuing Officer

President
Title

Docket No.: 030423-WU

**RESPONSE TO STAFF DATA REQUESTS
#48 AND #49**



St. Johns River Water Management District

Kirby B. Green III, Executive Director • John R. Wehle, Assistant Executive Director

Post Office Box 1429 • Palatka, FL 32178-1429 • (386) 329-4500

~~January 09, 2003~~

*Remailed Regular Mail
February 25, 2003*

Residential Water Systems

PO Box 5220

Ocala, FL, 34478

~~Certified Number: 7001-0320-0003-54215999~~

Subject: Consumptive Water Use Permit #3002 formerly know as: 2-083-0023
Residential Water Systems

Dear Sir/Madam:

Our records indicate Residential Water Systems was issued the above Consumptive Use Permit by St. Johns River Water Management District for household type uses, water utility type uses on March 12, 1996. The expiration date on this permit was March 12, 2003. For your convenience, we are enclosing an application form for your use in submitting an application for renewal. In addition, if you would like assistance in completing this application form, you may contact this office and we will be happy to assist you.

Please submit the enclosed application, along with the appropriate fee as listed on the enclosed attachment . This will allow your permit to continue and you will not be in violation of Chapter 40C-2. Your application for renewal must be received by this agency no later than 5:00 pm on the date of expiration. If your submittal is not received on or before March 12, 2003, you will then have to re-apply to the District as a new applicant for a new permit in order to resume use.

If you have any questions regarding your permit or if we can be of any assistance, please feel free to contact this office at (904) 329-4152.

Sincerely,

Gloria Lewis, Director
Division of Permit Data Services

GL/lm

Enclosures: Application
Fee Schedule

cc: District Permit File
Lynn Minor

GOVERNING BOARD

Duane Ottenstroer, CHAIRMAN
JACKSONVILLE

Ometrias D. Long, VICE CHAIRMAN
APOPKA

R. Clay Albright, SECRETARY
EAST LAKE WEIR

David G. Graham, TREASURER
JACKSONVILLE

W. Michael Branch
FERNANDINA BEACH

Jeff K. Jennings
MAITLAND

William Kerr
MELBOURNE BEACH

Ann T. Moore
BUNNELL

Catherine A. Walker
ALTAMONTE SPRINGS



St. Johns River Water Management District

Kirby B. Green III, Executive Director • John R. Wehle, Assistant Executive Director

Post Office Box 1429 • Palatka, FL 32178-1429 • (386) 329-4500

August 21, 2003
CERTIFIED MAIL NO: 70010320000354218969

Miles C. Anderson
2300 SE 17th St Suite 200
Ocala, FL 34471

Re: Request for Additional Information
CUP No. 3002
Project Name: High Pointe

Dear Mr. Anderson :

Thank you for submitting an RAI response. The District received your response on August 8, 2003, however, certain information is still needed to complete your application. The information requested below is specifically required in District Rule Section 4.3 of the Applicant's Handbook. The citation A.H. refers to the Applicant's Handbook. The citation "F.S." refers to Florida Statutes, the citation "F.A.C." refers to the Florida Administrative Code, and the citation "A.H." refers to the Applicant's Handbook: Consumptive Uses of Water, April 10, 2002.

In order to expedite the review of this permit application, please include the District's permit application number (3002) on all correspondence and submit (2) copies of all requested information unless otherwise instructed by a specific information request. All responses to additional information should be addressed to me at the Palatka address noted above.

REQUESTED INFORMATION:

- 1. Please fill out page 14 of the Water Conservation Plan Form for Public Supply. Showing how residences are charged for their water usage. [Paragraph 10.3; (e) A.H.]**

GOVERNING BOARD

Duane Ottenstroer, CHAIRMAN
JACKSONVILLE

Ometrias D. Long, VICE CHAIRMAN
APOPKA

R. Clay Albright, SECRETARY
EAST LAKE WEIR

David G. Graham, TREASURER
JACKSONVILLE

W. Michael Branch
FERNANDINA BEACH

Jeff K. Jennings
MAITLAND

William Kerr
MELBOURNE BEACH

Ann T. Moore
BUNNELL

Catherine A. Walker
ALTAMONTE SPRINGS



St. Johns River Water Management District

Kirby B. Green III, Executive Director • John R. Wehle, Assistant Executive Director

Post Office Box 1429 • Palatka, FL 32178-1429 • (386) 329-4500

April 4, 2003

CERTIFIED MAIL NO: 70010320000354219294

Miles C. Anderson
2300 SE 17th St Suite 200
Ocala, FL 34471

Re: Request for Additional Information
CUP No. 3002
Project Name: High Pointe Subdivision
Dear Mr. Anderson :

Thank you for submitting an application for a Consumptive Use Permit (CUP) for the High Pointe Subdivision. The District received your application on March 10, 2003, and upon review, has determined that additional information is needed to complete the application.

The information requested below is required pursuant to District Rule 4.3 of the Applicant's Handbook. The citation "F.S." refers to Florida Statutes, the citation "F.A.C." refers to the Florida Administrative Code, and the citation "A.H." refers to the Applicant's Handbook: Consumptive Uses of Water, April 10, 2002.

In order to expedite the review of this permit application, please include the District's permit application number (3002) on all correspondence and submit (2) copies of all requested information unless otherwise instructed by a specific information request. All responses to additional information should be addressed to me at the Palatka address noted above.

REQUESTED INFORMATION:

1. **Please send in a copy of the past 12 months of DEP Water Treatment Plant's Monthly Operating Reports.**
[Paragraph 10.3; (a), (b), (c), (d), (e), (f) and (g) A.H.] ✓
2. **Page PS-5 of the Public Supply and/or Essential Type Uses form indicates a projected increase in per capita usage for this utility (88 gallons per capita per day in 2003 to 100 gallons per capita per day in 2004 and beyond). Please provide an explanation of why per capita use is expected to increase at this site. Please provide a plan to prevent the estimated increase in per capita use. This plan should include specific, substantive initiatives with** ✓

GOVERNING BOARD

Duane Ottenstroer, CHAIRMAN
JACKSONVILLE

Ometrias D. Long, VICE CHAIRMAN
APOPKA

R. Clay Albright, SECRETARY
EAST LAKE WEIR

David G. Graham, TREASURER
JACKSONVILLE

W. Michael Branch
FERNANDINA BEACH

Jeff K. Jennings
MAITLAND

William Kerr
MELBOURNE BEACH

Ann T. Moore
BUNNELL

Catherine A. Walker
ALTAMONTE SPRINGS

implementation schedules to maintain or decrease GPCD amounts. This plan should provide District staff reasonable assurance that the projected GPCD will be maintained at current levels in the future. Examples of these initiatives include at a minimum: (a) an implementation schedule for a water conservation rate structure or provide an explanation why this program cannot be implemented. Such rate structures should include at least one of the following: increasing block rates, seasonal rates, quantity surcharges and/or time of day pricing; (b) conducting customer indoor audits, and (c) conducting customer outdoor audits. [Paragraph 10.3 (a), (b), (c), (d), and (e) A.H.]

3. The projected Water Use Table (Table 2) of the application indicates that there will be 3.5 people per residence for this community. This is above the average of 2.5 people per ERC (Equivalent Residence Connections) in Florida. Please provide a reasonable estimate with supporting documentation for the actual number of residents per unit for this project. Please note that population numbers that are derived from ERC's multiplied by 2.5 do not require substantiation. Please revise Table 2 – Projected Water Use (page PS-5 of the Public Supply and/or Essential Type uses form) using 2.5 people or lower per unit or substantiate the use of a higher number of people per ERC. [Paragraph 10.3; (a) and (b) A.H.] N/A.

4. Please complete and submit the following enclosed forms: (1) Water Conservation Plan Form for Public Supply Applicants; (2) projected Water Use Table (Table 2). Please be sure that the projected water use table is filled out for the next 20 years. [Paragraph 10.3; (a), (b), (c), (d), (e), (f), (g), (h), (i), (j) and (k) A.H.] ✓

5. Based on the submitted information, the required application fee for a Consumptive Use Permit with an increase in allocation and using over 100,000 gallons per day on average is \$400.00. Please submit the additional \$200.00 required for your application. Make check payable to the St. Johns River Water Management District. [40C-1.603 F.A.C.] \$200 req'd

We ask that you submit the requested information in a timely manner to help expedite review of your application. Please be advised that, pursuant to District procedural rules, any application which has not been technically and administratively completed within 120 days from the date of receipt of a Request for Additional Information by the District, must be forwarded to the Governing Board with a recommendation for denial based upon an incomplete application. However, should you require more than 120 days to respond, additional time to respond may be granted for good cause. You must request, in writing, additional time to respond along with the reason for the request. Please direct such a written request to me and I will let you know if we can grant such an extension.

We thank you again for your application and remind you that should you have any questions regarding this letter or the application in general, please contact me at the Palatka Service Center at (386) 329-4561. I look forward to working with you to get your application completed for Governing Board action at the earliest possible date.

Sincerely,



Randall Motes, Hydrologist II
Department of Resource Management

cc: PDS/RAIL
Todd Eller
Residential Water System
Charles Demenzes
PO Box 5220
Ocala, FL 34478



**MILES CHRISTIAN ANDERSON
CONSULTING ENGINEERS, INC.**

CIVIL • STRUCTURAL • LAND PLANNING • GOLF COURSE DESIGN

2300 S.E. 17TH STREET SUITE 200
OCALA, FLORIDA 34471

(352) 629-5591
FAX (352) 629-4402

May 15, 2003

Charles deMenzes
Residential Water Systems
P.O. BOX 5220
Ocala, Florida 34478

RE: M.O.R. Data Confirmation

Dear Mr. deMenzes,

As discussed, we reviewed the monthly operating reports for the year 2002 for the Residential Water Systems Treatment Plant (PWS: 3424625). Based on the review we found a few places in which we believe that incorrect data was entered into the cell for a particular day of the month. More specifically on February 17 (2,449,000 gal), May 7 (4,445,000 gal), and December 10th (2,800,000 gal). We reviewed the amount of water usage in the prior & following days of these events and found that the water usage for each day of the month was consistent except for the days mentioned above. Based on our conversation you confirmed that indeed, these instances were not valid and were the cause of a data entry error in the report.

Another high water usage amount (902,000 gal) was indicated on May 30. You confirmed that this amount was due to a failed valve in which the pumps stayed on & pumped excess water.

Also, on May 11, 65,000 gal were produced, and on May 12, 893,000 gal were produced. You confirmed that these readings were incorrect and should be averaged for the two days giving 479,000 gallons for each day.

If this information is correct please acknowledge and confirm by signing in the location provided below.

Sincerely,

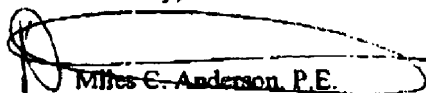
Miles C. Anderson, P.E.

Confirmed by:

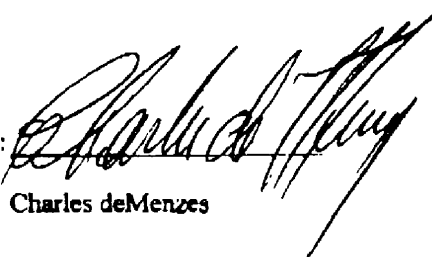
Charles deMenzes



**MILES CHRISTIAN ANDERSON
CONSULTING ENGINEERS, INC.**

CIVIL • STRUCTURAL • LAND PLANNING • GOLF COURSE DESIGN

2300 S E. 17TH STREET, SUITE 200
OCALA, FLORIDA 34471

(352) 629-5591
FAX (352) 629-4402

June 17, 2003

Gloria Lewis, Director
St. John's River Water Management District
Division of Permit Data Services
P O Box 1429
Palatka, FL 32178-4500

Re Request for Additional Information
CUP No. 3002
High Pointe Subdivision

Dear Ms. Lewis,

We are in receipt of your correspondence of April 4, 2003 regarding the above referenced project
We are attaching the following items requested:

- 1 Appropriate Fee
- 2 Consumptive Use Individual Permit Application
- 3 Copy of Executed Deed or Lease Agreement
- 4 Location Map
- 5 Completed Water Use Type Package
- 6 Water Conservation Plan

We have determined that the permit daily flow in 1990 maximum daily withdraw of 0 250 Mgal has been exceeded. Based on current billage, the WTP is pumping 0.23 +/- mgd on average, the annual maximum day pumped is 0.311 +/- mgd. We are requesting, on behalf of our client/owner, to increase the maximum daily flow from 0.25 mgd to 0.410 mgd. The system can pump to 0 650 mgd.

We trust that we have answered your comments in a satisfactory manner and look forward to an approved St. John's River Water Management Distinct permit. Should you have any questions please contact me at (352) 629-5591.

Sincerely,

A handwritten signature in black ink, appearing to read 'Miles C. Anderson', is written over a horizontal line. The signature is stylized and somewhat cursive.

Miles C. Anderson, P.E.
FL Professional Engineer #39385
MCA/lb

File Residential Water



**MILES CHRISTIAN ANDERSON
CONSULTING ENGINEERS, INC.**

CIVIL • STRUCTURAL • LAND PLANNING • GOLF COURSE DESIGN

2300 S.E. 17TH STREET, SUITE 200
OCALA, FLORIDA 34471

(352) 629-5591
FAX (352) 629-4402

CONSUMPTIVE USE PERMIT

HIGH POINTE SUBDIVISION

June 2003

Prepared by:
MCA Consulting Engineers, Inc
2300 SE 17th Street, Suite 200
Ocala, FL 34471



St. Johns River Water Management District
Permit Application
For Consumptive Uses of Water

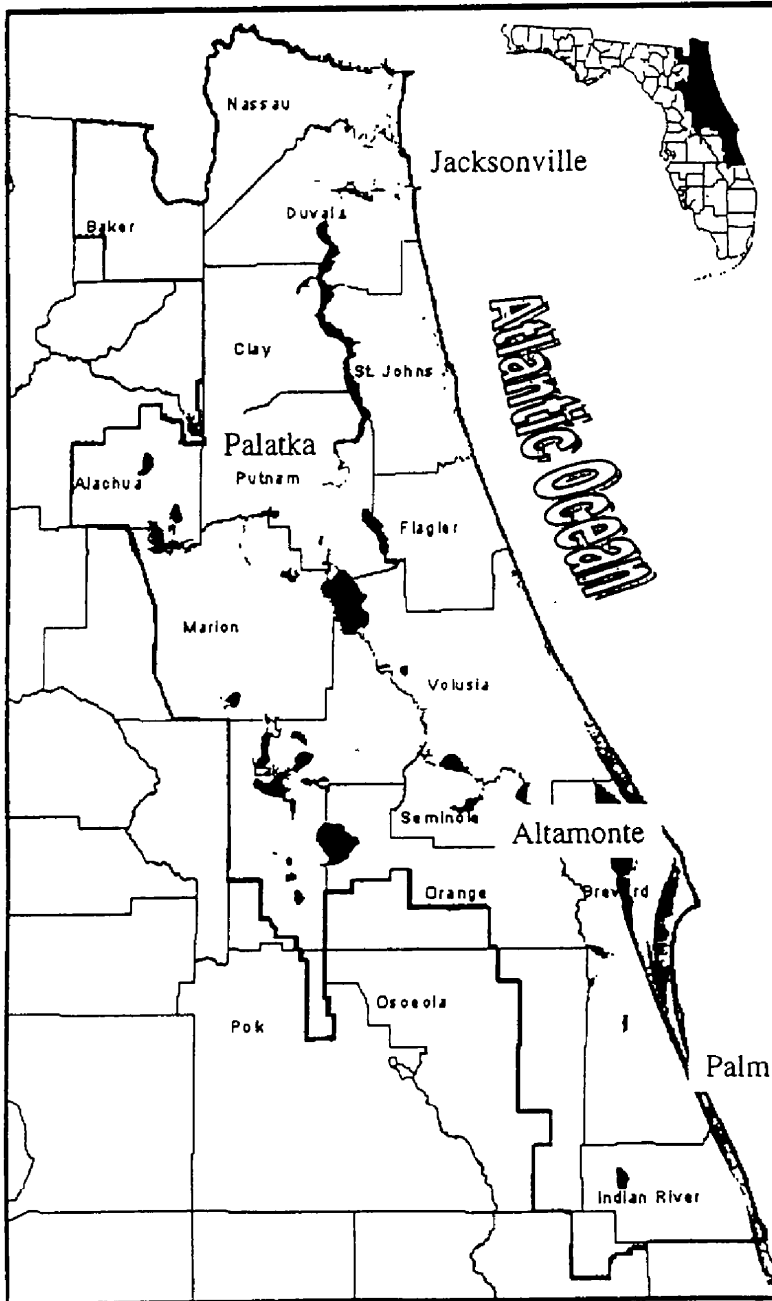

District Headquarters

P.O. Box 1429
Palatka, Florida 32178
Phone 386-329-4500

Jacksonville Service Center

7775 Baymeadows Way
Suite 102
Jacksonville, Florida 32256
Phone 904-730-6270

Altamonte Service Center

975 Keller Road
Altamonte Springs,
Florida 32717
Phone 407-659-4800

Palm Bay Service Center

525 Community College
Parkway
Palm Bay, Florida 32909
Phone 321-984-4940

INTRODUCTION

Unless expressly exempted by law or District regulation, a consumptive use permit is required for any use, diversion or withdrawal of surface or ground water which meets any of the following criteria:

1. Average annual daily withdrawal exceeding one hundred thousand (100,000) gallons average per day on an annual basis.
2. Withdrawal equipment or other facility which have a capacity of more than one million (1,000,000) gallons per day.
3. Withdrawals from a combination of wells or of other facilities, having a combined capacity of more than one million (1,000,000) gallons per day.
4. Withdrawals from a well in which the outside diameter of the largest permanent water bearing casing is six inches or greater. For purposes of this paragraph, the diameter of the well at ground surface will be presumed to be the diameter of the well for the entire length unless the well owner or well contractor can demonstrate that the well has a smaller diameter water bearing casing below ground surface.
5. Within the Delineated Area as set forth in 6.7.1.6, Applicant's Handbook: Consumptive Uses of Water, withdrawals from a well in which the inside diameter of the largest permanent water bearing casing is five inches or greater. For purposes of this paragraph, the diameter of the well at ground surface will be presumed to be the diameter of the well for the entire length unless the well owner or well contractor can demonstrate that the well has a smaller diameter water bearing casing below ground surface.
6. Within the Delineated Area as set forth in 6.7.1.6, Applicant's Handbook: Consumptive Uses of Water, for freeze protection uses of water on agricultural and nursery property greater than 5 acres in size.
7. Any secondary use, as defined in paragraph 2.0(w) of the Applicant's Handbook: Consumptive Uses of Water, which exceeds 100,000 gallons per day estimated on an average annual basis.

PROCESSING

Processing of permit applications is in accordance with provisions of the Water Resources Act, Chapter 373, Florida Statutes, Chapter 120, Florida Statutes, Chapters 28-106, 28-107, 40C-1, 40C-2 and 40C-20, Florida Administrative Code and the Applicant's Handbook: Consumptive Uses of Water

The District will notify an applicant if an application is incomplete within 30 days of receipt and will inform the applicant of what additional information is required to make the application complete. For those permits processed as individual permits, the Board will issue or deny permits within 90 days of receipt of the completed application. Those permits processed as general permits will be issued within 30 days of receipt of a completed application.

Failure to obtain a permit prior to undertaking a regulated activity is a violation of District requirements, even if the project would receive a favorable review in a standard permitting process. The District may initiate administrative, civil or criminal actions against violators, and may require restorative steps.

PERMIT APPLICATION FOR CONSUMPTIVE USES OF WATER



| | |
|--|--|
| Permit Type: Individual CUP <input checked="" type="checkbox"/> Secondary Use <input type="checkbox"/> | |
| Standard General CUP <input type="checkbox"/> | |
| Application is for: New use <input type="checkbox"/> Renewal <input checked="" type="checkbox"/> | |
| Modification of Existing Permit <input type="checkbox"/> | |

APPLICANT INFORMATION

ORGANIZATION NAME (please print all responses)
Residential Water System

| | |
|--|------------------------------|
| LAST NAME (please print all responses) Demenzes | FIRST NAME Charles |
| STREET NO. P.O. Box 5220 | STREET NAME CITY Ocala |
| STATE Florida | ZIP 34478 |
| | PHONE 352-622-4949 |

| | |
|--|----------------------------|
| <input type="checkbox"/> Same as above | AGENT OR CONSULTANT |
|--|----------------------------|

ORGANIZATION NAME (please print all responses)
Miles Christian Anderson Consulting Engineers, Inc.

| | |
|--|------------------------------|
| LAST NAME (please print all responses) Anderson | FIRST NAME Miles |
| STREET NO. 2300 SE 17th Street, Suite 200 | STREET NAME CITY Ocala |
| STATE Florida | ZIP 34471 |
| | PHONE 352-629-5591 |

| | |
|---|--------------------------|
| <input checked="" type="checkbox"/> Same as applicant | OWNER INFORMATION |
|---|--------------------------|

ORGANIZATION NAME (please print all responses)

| | |
|--|---------------------|
| LAST NAME (please print all responses) | FIRST NAME |
| STREET NO. | STREET NAME CITY |
| STATE | ZIP PHONE |

| | | |
|---------------------------------|-----------------------|--------|
| Charles Demenzes | | 3-7-03 |
| APPLICANT'S NAME (Please print) | APPLICANT'S SIGNATURE | DATE |

If a person other than applicant has completed this form, that person certifies by his signature below that he is acting as an authorized agent of the applicant and his signature will be certification that he is in fact the authorized agent.

| | | |
|-----------------------------|-------------------|--------|
| Miles C. Anderson | | 3/7/03 |
| AGENT'S NAME (Please print) | AGENT'S SIGNATURE | DATE |

SITE INFORMATION

COUNTY Marion ACRES OWNED _____
SECTION 2 TOWNSHIP 16 S RANGE 22 E
PROJ. NAME High Pointe PROJECT ACRES _____
COUNTY PARCEL NO. _____

TYPE OF USE

DARKEN ALL THAT APPLY

AESTHETIC AGRICULTURAL AQUACULTURAL COOLING AND AIR CONDITIONING
DEWATERING COMMERCIAL AND INDUSTRIAL ESSENTIAL FREEZE PROTECTION
GOLF COURSE RECREATION AREA HOUSEHOLD TYPE LIVESTOCK
NURSERY URBAN LANDSCAPE IRRIGATION WATER BASED RECREATION
UNACCOUNTED FOR WATER OTHER

Previous Permit No. 2-083-0023

| | |
|---------------------|--|
| AMOUNT REQUESTED | INCHES PER YEAR _____ MILLION GALLONS PER YEAR <u>124.100</u> mgv _____ MILLION GALLONS PER DAY <u>.340</u> _____ DATE OF START OF USE <u>8/25/99</u> _____ |
|---------------------|--|

| | |
|---------------------------------|--|
| REQUESTED PERMIT DURATION | 20 YEARS <input checked="" type="checkbox"/> Other (Specify Years): _____ |
|---------------------------------|--|

WATER USE MONITORING

All permittees are required to measure their water usage on a continuous basis. All users must report their use using form EN-50 to the District at the intervals specified in their permit. If used, meters must be 95% accurate, verifiable and installed according to manufacturers' specifications. Meters or alternative methods utilized by the water supplier to charge for the water may suffice as a water use monitoring tool.

Alternative methods must be 90% accurate and verifiable. All alternative methods must be approved in advance and in writing by District staff.

| | |
|---|--------------------------|
| <input checked="" type="checkbox"/> Same as applicant | COMPLIANCE ENTITY |
|---|--------------------------|

Consumptive Use Permits require the periodic submittal of data to the District. Please provide the name, address and phone number of the person who will be responsible for ensuring that the permitted conditions are met. Submittal of this information does not relieve the permit holder from the responsibility for compliance.

Name: _____

Address: _____

Phone Number: (_____) - _____

| |
|---------------------------|
| SECONDARY TYPE USE |
|---------------------------|

Please supply information regarding the source(s) of water for your activities.

1. The name of the supplier of water. N/A
2. Is this source of water potable or non-potable? (circle one) **N/A**
3. What percentage of your total water use is from this supplier? N/A
4. If 100% of your water is not provided from the supplier, please indicate what uses are self supplied. **N/A**
5. The applicant must also complete other packages which address the requested consumptive use identified in question 4. **N/A**

Description of Use Classes: Each permit shall be identified with one or more of the following use classifications:

- (a) **Aesthetic use** – the use of water for fountains, waterfalls, and landscape lakes and ponds where such uses are entirely ornamental and decorative.
- (b) **Agricultural use** – use of water for the commercial production of crops or the growing of farm products including, but not limited to, vegetables, citrus and other fruits, pasture, rice and sod.
- (c) **Aquacultural use** – the use or withdrawal of water for cultivation of animal and plant life in a water environment, including but not limited to food fish, aquatic bait, game fish, aquatic plants (i.e. watercress), alligators, tropical fish, shellfish, and turtles.
- (d) **Commercial and industrial process use** – the use of water essential to the production of the goods or services provided by a business establishment.
- (e) **Cooling and air conditioning use** – the use of water for heating or cooling, or for air conditioning.
- (f) **Dewatering use** – the removal of water from a specific area to facilitate mining or construction.
- (g) **Essential use** – the use of water strictly for fire fighting purposes, health and medical purposes and the use of water to satisfy federal, state or local public health and safety requirements.
- (h) **Freeze protection** – the periodic and infrequent use of water to protect agricultural and nursery crops from damage due to low temperatures.
- (i) **Golf course use** – water used to irrigate an establishment designed and used for playing golf.
- (j) **Household use** – the use of water for personal needs or for household purposes such as drinking, bathing, heating, cooking, sanitation or cleaning, whether the use occurs in a residence or in a business or industrial establishment.
- (k) **Livestock use** – the use of water for watering or washing of livestock.
- (l) **Nursery use** – the use of water on premises or in which nursery stock is grown, propagated or held for sale or distribution or sold or reshipped.
- (m) **Recreation area use** – the use of water for the maintenance and support of intensive recreational areas such as, but not limited to, playgrounds, football, baseball, and soccer fields.
- (n) **Urban landscape irrigation** – the outside watering or sprinkling of shrubbery, trees, lawns, grass, ground covers, plants, vines, gardens and other such flora which are situated in such diverse locations as residential landscaping, recreational areas, cemeteries, public, commercial and industrial establishments, public medians and rights of way.
- (o) **Water based recreation use** – water used for public or private swimming and wading pools, including water slides. This terms does not include pools specifically maintained to provide habitat for aquatic life.
- (p) **Water utility use** – water used for withdrawal, treatment, transmission and distribution by potable water systems.

SOURCES OF WATER (Summary Data Sheet)

Please supply information regarding the source(s) of water for your activities. Include information regarding **all** wells/pumps on the property.

**Table 1.
SUMMARY OF GROUND WATER SOURCES**

| Well or Pump Number | Wellfield or Facility Name | Casing Dia. (in.) | Casing Depth (ft) | Total Depth (ft) | Operation Hrs/wk | Pump Capacity (in gpm) | Date Drilled | Existing or Proposed (date) | Type of Use* |
|---------------------|----------------------------|-------------------|-------------------|------------------|------------------|------------------------|---------------|-----------------------------|--------------|
| A | High Pointe | 8" | 101 | 220 | 168/wk | 560 | Nov. 23, 1983 | Existing | Residential |
| B | High Pointe | 8" | 84 | 220 | 168/wk | 560 | Nov. 26, 1983 | Existing | Residential |
| | | | | | | | | | |
| | | | | | | | | | |
| | | | | | | | | | |
| | | | | | | | | | |
| | | | | | | | | | |

*See use descriptions on page 4. If more than one use type, show predominate use

**Table 2.
SUMMARY OF SURFACE WATER SOURCES N/A**

| Pump Number | Pump Capacity (gpm) | Operation Hrs/wk | Acreage of Surface Water Body | Name of Source | Status (date if proposed) | Type of Use |
|-------------|---------------------|------------------|-------------------------------|----------------|---------------------------|-------------|
| | | | | | | |
| | | | | | | |
| | | | | | | |
| | | | | | | |

PROPERTY CONTROL AND LOCATION

I. PROPERTY CONTROL

1. Property Ownership - Provide a copy of the excuted deed indicating the current owner of the property which is the subject of this application.
2. Leased Property - Provide a copy of the current lease, or a letter signed by the property owner describing the lease arrangement and the duration of the lease.

II. LOCATION MAPS

Provide a recent map (preferably a USGS topographic quadrangle, a map from a county plat directory, or survey map) indicating the following:

- (a) property boundaries (include approximate lengths of boundaries in feet); (public supply water uses please show service areas)
- (b) All existing and proposed withdrawal point locations. Indicate well number and casing size for ground water withdrawals, and pump number and maximum pump capacity for surface water withdrawals;
- (c) a north arrow;
- (d) a scale designation - all maps should have a minimum scale of 1 inch = 2,000 feet; and
- (e) labeled landmarks such as roads and political boundaries.

Please provide identification numbers and date permitted if you obtained or are in the process of obtaining any of the following permits for this project

| | |
|---|-----------|
| Environmental Resource Permit (ERP) | <u>NA</u> |
| EPA Ordered Environmental Impact Statements | <u>NA</u> |
| Agricultural Discharge | <u>NA</u> |
| FDEP Wastewater Site Identification No. | <u>NA</u> |
| FDEP Public Water Supply (PWS) Identification No. | <u>NA</u> |

III. ADJACENT PROPERTY OWNERS

(not applicable to Secondary Users Permits)

Provide a complete list of adjacent property owners and mailing address as prescribed in Tables #3 and 4. Attach additional sheets as needed. **N/A**

| Name | Address | City | State | Zip Code |
|------|---------|------|-------|----------|
| | | | | |
| | | | | |
| | | | | |
| | | | | |
| | | | | |
| | | | | |
| | | | | |
| | | | | |
| | | | | |
| | | | | |

USE OF LOWEST ACCEPTABLE QUALITY WATER SOURCE

1. Are you proposing to use the most appropriate (lowest quality) source of water?
2. Is reclaimed water readily available as a source of water?

WATER CONSERVATION PLAN

A water conservation plan must be submitted with this application. Please refer to Section 12.0 and Appendix I, Applicant's Handbook, Consumptive Uses of Water, for information on how to meet the District's requirements regarding water conservation. Available water conservation measures must be implemented pursuant to requirements in sections 10.2(e) and 12.0, A.H. These measures must be explained as part of this application.

Table 3 - Ground Water Withdrawals

| Withdrawal Amount | Property Owners to be Listed |
|--|---|
| Less than 1,000,000 gallons maximum per day -and- Less than 100,000 gallons per day annual average | None required |
| Max day is between 1 and 5 million gallons - or- Average day is between 100,000 and 500,000 gallons | All property owners within 600 feet of well or 100 feet of property boundary. |
| Max day is between 5 and 10 million gallons - or- Average day between 500,000 and 1,000,000 gallons | All property owners within 1,320 feet of each well or 200 feet of the property boundary. |
| Max day exceeding 10 million gallons -or- Average day exceeds 1,000,000 gallons | All property owners within 2,640 feet of the well, or 400 feet of the property boundary. |

Table 4 - Surface Water Withdrawals

| Withdrawal Amount | Property Owners to be Listed |
|--|--|
| Surface area of the withdrawal lake is less than 80 acres | All riparian land owners on lake and those up to 600 feet downstream if the lake has an outlet |
| Surface area of the withdrawal lake is greater than 80 acres | All riparian land owners up to 600 feet from the withdrawal point |
| Withdrawals from a stream and average daily pumpage is less than 5 million gallons | All riparian land owners up to 600 feet upstream and 1,320 feet downstream from the withdrawal point |
| Withdrawals from a stream and average daily pumpage is greater than 5 million gallons | All riparian land owners up to 1,320 feet upstream and 2,640 downstream from the withdrawal point |

SECTION III

Applicant Checklist

Please verify that the following information has been provided as part of this application package:

| | <u>Attached</u> |
|--|------------------|
| 1. Appropriate Fee | \$ <u>200.00</u> |
| 2. Signature of Applicant and/or Agent | <u>X</u> |
| 3. Authorization from Owner for Agent (if Agent is listed on application) | <u>N/A</u> |
| 4. Copy of Executed Deed or Lease Agreement | <u>X</u> |
| 5. Location Map | <u>X</u> |
| 6. List of adjacent land owners | <u>N/A</u> |
| 7. Completed Water Use Type Package* | <u>X</u> |
| 8. Water Conservation Plan | <u>X</u> |

***NOTE:** Applications for Public Supply, Commercial/Industrial, Agricultural, Aquacultural, Nursery/Fern, Golf Course Irrigation, Dewatering, and Landscape Irrigation water uses must also include the supplemental water use package specific to each use type. Those applying for a **Secondary Use Permit** must complete and submit each of the supplemental water use packages that applies to their type use.

FEE LIST

Consumptive Uses of Water

Individual Consumptive Use Permits (40C-2, FAC) Allocation >500,000 Gallons Per Day

| | |
|--|-----------|
| New Uses or Modifications with an Increase in Allocation | \$1000.00 |
| Renewals or Modifications with NO Increase in Allocation | \$200.00 |

Standard General Consumptive Use Permits (40C-20, FAC) Allocation <500,000 Gallons Per Day

New Uses or Modifications with an Increase in Allocation

| | |
|-------------------------------------|----------|
| Allocation <100,000 Gallons Per Day | \$200.00 |
| Allocation >100,000 Gallons Per Day | \$400.00 |

Renewals or Modifications with No Increase in Allocation

| | |
|-------------------------------------|----------|
| Allocation <100,000 Gallons Per Day | \$100.00 |
| Allocation >100,000 Gallons Per Day | \$200.00 |

Delineated Area General Permit (well Diameter >5 inches and < 6 inches or freeze protection of >5 acres

\$50.00

Noticed General Water Use Permits (40C-22, FAC)

| | |
|------------------------------------|----------|
| Short Term Construction Dewatering | \$100.00 |
| Fire Protection | \$50.00 |



PUBLIC SUPPLY AND/OR ESSENTIAL TYPE USES

(Submit 2 copies of application, supplemental information, drawings, calculations, etc.)

I. YEAR-ROUND PUBLIC SUPPLY

A. POTABLE WATER SUPPLY

1. Please submit a map (minimum 1:2000 scale or larger) showing the current and proposed service area
2. Please submit any of the following that apply:
 - a) Copy of the Public Service Commission (PSC) certification describing service area;
 - b) Copy of local government franchise agreement; or
 - c) Documentation that utility is not regulated by PSC or local government.
3. Complete Table 1 - Historic Water Use, and Table 2 - Projected Water Use as a basis for the requested allocations. In addition:
 - (a) Provide the past 12 months of monitored water use data (MOR's if available) and calculate historic average daily and maximum daily per capita use;
 - (b) Explain the method of projecting population growth (historic projection preferred).

Attach documentation for method of determining growth projections.

B. WASTEWATER DISPOSAL

1. Specify the present and projected amounts of wastewater:

| | PRESENT (mgd)* | PROJECTED (5 YEARS) | PROJECTED (10 YEARS) | PROJECTED (15 YEARS) | PROJECTED (20 YEARS) |
|-------------------------|-------------------|------------------------|-------------------------|-------------------------|-------------------------|
| Average daily disposal* | 0.19 | .27 | N/A | N/A | N/A |
| Plant capacity | | | | | |

*mgd = million gallons per day

*Identify WWTP if more than one

2. Specify the percentage for each type of disposal (total 100%) N/A

| DISPOSAL TYPE | PRESENT % | PROJECTED % (5 YEARS) | PROJECTED % (10 YEARS) | PROJECTED % (15 YEARS) | PROJECTED % (20 YEARS) |
|---------------------------|-----------|-----------------------|------------------------|------------------------|------------------------|
| Reuse | | | | | |
| Offsite Discharge | | | | | |
| Individual Septic Tanks | | | | | |
| On-site Percolation Ponds | | | | | |
| On-site Spray Fields | | | | | |
| Other | | | | | |

C. REUSE OF RECLAIMED WATER

1. Describe the method of reuse by completing the table below:

Check here if no reuse projected at this time

| TYPE OF SITE (golf, landscape, etc) | FACILITY NAME | ACREAGE | AVERAGE USE (mgd) | PROJECTED AVE USE (mgd) |
|--|---------------|---------|----------------------|----------------------------|
| | | | | |
| | | | | |
| | | | | |
| | | | | |
| | | | | |
| | | | | |
| | | | | |

2. Please provide a map (minimum 1:2000 scale) showing the location of the sites listed in the table above as well as the location of all major existing reuse lines and those proposed for the next 15 years. N/A

3. If wastewater is treated on-site specify level of treatment: N/A

primary

secondary

secondary with disinfection

D. ESSENTIAL USE

Are you requesting the use of any of the identified sources for fire protection?

YES NO

If yes, please list the wells/pumps that will be used.

High Pointe Subdivision

TABLE 1
HISTORIC WATER USE

| Last 5 years | Past Population | Number of Units | Per Capita Usage (gpcd) | Household Avg. day (mgal) | Household Max Day (mgal) | Commerical/Industrial Avg. day (mgal) | Irrigation (urban landscape or common areas) (mgal)(avg day) | Irrigation (urban landscape or common areas) (mgal)(max day) | Water Utility (mgal) | Unaccounted for water (mgal) | Total Annual Avg day (mgal) | Total Annual Max day (mgal) |
|--------------|-----------------|-----------------|-------------------------|---------------------------|--------------------------|---------------------------------------|--|--|----------------------|------------------------------|-----------------------------|-----------------------------|
| 1999 | 1300 | 520 | 145 | 0.00036 | 0.0005 | | | | | 0.0047 | 0.19 | 0.267 |
| 2000 | 1355 | 542 | 145 | 0.00036 | 0.0005 | | | | | 0.0049 | 0.20 | 0.278 |
| 2001 | 1500 | 600 | 145 | 0.00036 | 0.0005 | | | | | 0.0054 | 0.22 | 0.308 |
| 2003 | 1518 | 607 | 145 | 0.00036 | 0.0005 | | | | | 0.0055 | 0.23 | 0.311 |
| | | | | | | | | | | | | |
| | | | | | | | | | | | | |
| | | | | | | | | | | | | |

Table Definitions

- Household Use: Amount sold or given to domestic customers. Typically includes 5/8 and 3/4 inch metered accounts. Includes private lawn irrigation
- Population. Estimated number of residents served
- # of Units: Number of residential units served.
- Per Capita Use: Use per person per household; Aveage household use (column 5) divided by population (column 2)
- Commercial/Industrial Use: Amount sold to commercial customers. Typically includes meters larger than 1 inch. Include bulk customers in this use.
- Irrigation Use: Amount used for common area irrigation owned or maintained by a public entity. This does not include areas privately owned areas or amounts previously accounted for under household use.
- Water Utility Misc. monitored use (eg. fire protection, sewer flushing, construction use, & maint. features)
- Unaccounted Water: Unaccounted for water use. Obtained from an audit of system
- Total Use: Sum of all uses - household + comm/ind. + irrigation + water util = MOR's for year

High Pointe Subdivision

TABLE 2
PROJECTED WATER USE

| Next 20 years | Past Population | Number of Units | Per Capita Usage (gpcd) | Household Avg day (mgal) | Household Max. Day (mgal) | Commerical/ Industrial Avg day (mgal) | Irrigation (urban landscape or common areas) (mgal)(avg day) | Irrigation (urban landscape or common areas) (mgal)(max day) | Water Utility (mgal) | Unaccounted for water (mgal) | Total Annual Avg day (mgal) | Total Annual Max day (mgal) |
|---------------|-----------------|-----------------|-------------------------|--------------------------|---------------------------|---------------------------------------|--|--|----------------------|------------------------------|-----------------------------|-----------------------------|
| 2003 | 1620 | 648 | 145 | 0.00036 | 0 0006 | | | | | 0 0059 | 0 241 | 0 332 |
| 2004 | 1650 | 660 | 145 | 0.00036 | 0 0006 | | | | | 0.0060 | 0 245 | 0 338 |
| 2005 | 1680 | 672 | 145 | 0.00036 | 0 0006 | | | | | 0 0061 | 0 250 | 0.345 |
| 2006 | 1745 | 698 | 145 | 0 00036 | 0 0006 | | | | | 0 0063 | 0 259 | 0 358 |
| 2007 | 1800 | 720 | 145 | 0 00036 | 0 0006 | | | | | 0 0065 | 0 268 | 0 369 |
| 2008 | 1855 | 742 | 145 | 0.00036 | 0 0006 | | | | | 0.0067 | 0 276 | 0 380 |
| 2009 | 1925 | 770 | 145 | 0 00036 | 0 0006 | | | | | 0.0070 | 0 286 | 0 395 |
| 2010 | 2000 | 800 | 145 | 0 00036 | 0 0006 | | | | | 0 0073 | 0 297 | 0 410 |
| 2011 | 2000 | 800 | 145 | 0.00036 | 0 0006 | | | | | 0 0073 | 0 297 | 0 410 |
| 2012 | 2000 | 800 | 145 | 0 00036 | 0 0006 | | | | | 0 0073 | 0.297 | 0 410 |
| 2013 | 2000 | 800 | 145 | 0 00036 | 0 0006 | | | | | 0 0073 | 0 297 | 0 410 |
| 2014 | 2000 | 800 | 145 | 0.00036 | 0 0006 | | | | | 0.0073 | 0.297 | 0 410 |
| 2015 | 2000 | 800 | 145 | 0 00036 | 0 0006 | | | | | 0.0073 | 0 297 | 0 410 |
| 2016 | 2000 | 800 | 145 | 0 00036 | 0 0006 | | | | | 0 0073 | 0 297 | 0 410 |
| 2017 | 2000 | 800 | 145 | 0.00036 | 0.0006 | | | | | 0 0073 | 0.297 | 0.410 |

*see table definitions from Table 1

II. SEASONAL PUBLIC SUPPLY
 (Mobile Home Parks, RV Parks, Campgrounds, etc.)

N/A

(Submit 2 copies of application, supplemental information, drawings, calculations, etc.)

1. Number of acres owned: _____
2. Total number of lots/spaces: _____
3. Average number of residents over the past 12 months: _____
4. What is the maximum number of residents served?: _____
5. What is the minimum number of residents served?: _____
6. Does each lot/space have an individual water meter?: _____
7. Does this facility have any of the following water uses: (yes or no)

| | |
|--|---|
| <input type="checkbox"/> a) Laundry <input type="checkbox"/> b) Club house with restrooms <input type="checkbox"/> c) Common areas with irrigation # of Acres _____ | <input type="checkbox"/> d) Bath house/restrooms <input type="checkbox"/> e) Swimming pool <input type="checkbox"/> f) Other uses, please specify _____ |
|--|---|
8. Attach copies of monthly water use reports for the last 12 months. Using the past months of water use, please calculate:
 - a) Average Daily water use over the past 12 months: _____ mgd*
 - b) Maximum Daily water use over the past 12 months: _____ mgd*
 - c) TOTAL water used over the past 12 months: _____ mg
9. WASTEWATER DISPOSAL - specify the percentage for each, total 100%:

| DISPOSAL TYPE | PRESENT % | PROJECTED % (5 YEARS) | PROJECTED % (10 YEARS) | PROJECTED % (15 YEARS) | PROJECTED % (20 YEARS) |
|---------------------------|-----------|------------------------|------------------------|------------------------|------------------------|
| Reuse | | | | | |
| Offsite Discharge | | | | | |
| Individual Septic Tanks | | | | | |
| On-site Percolation Ponds | | | | | |
| On-site Spray Fields | | | | | |
| Other | | | | | |

10. If wastewater is treated on-site, specify level of treatment:

primary secondary secondary with disinfection

11. Discription of lots.

- a) Average lot size: _____ sq. ft.
- b) Average home size: _____ sq. ft.
- c) Square footage of drive and walkways: _____ sq. ft.

12. WASTEWATER DISPOSAL

a) Specify the present and projected amounts of wastewater:

| | PRESENT (mgd)* | PROJECTED (5 YEARS) | PROJECTED (10 YEARS) | PROJECTED (15 YEARS) | PROJECTED (20 YEARS) |
|------------------------|-------------------|------------------------|-------------------------|-------------------------|-------------------------|
| Average daily disposal | | | | | |
| Plant capacity | | | | | |

*mgd = million gallons per day

LOCATION MAP

AND

USGS MAP

EXHIBIT 'A'

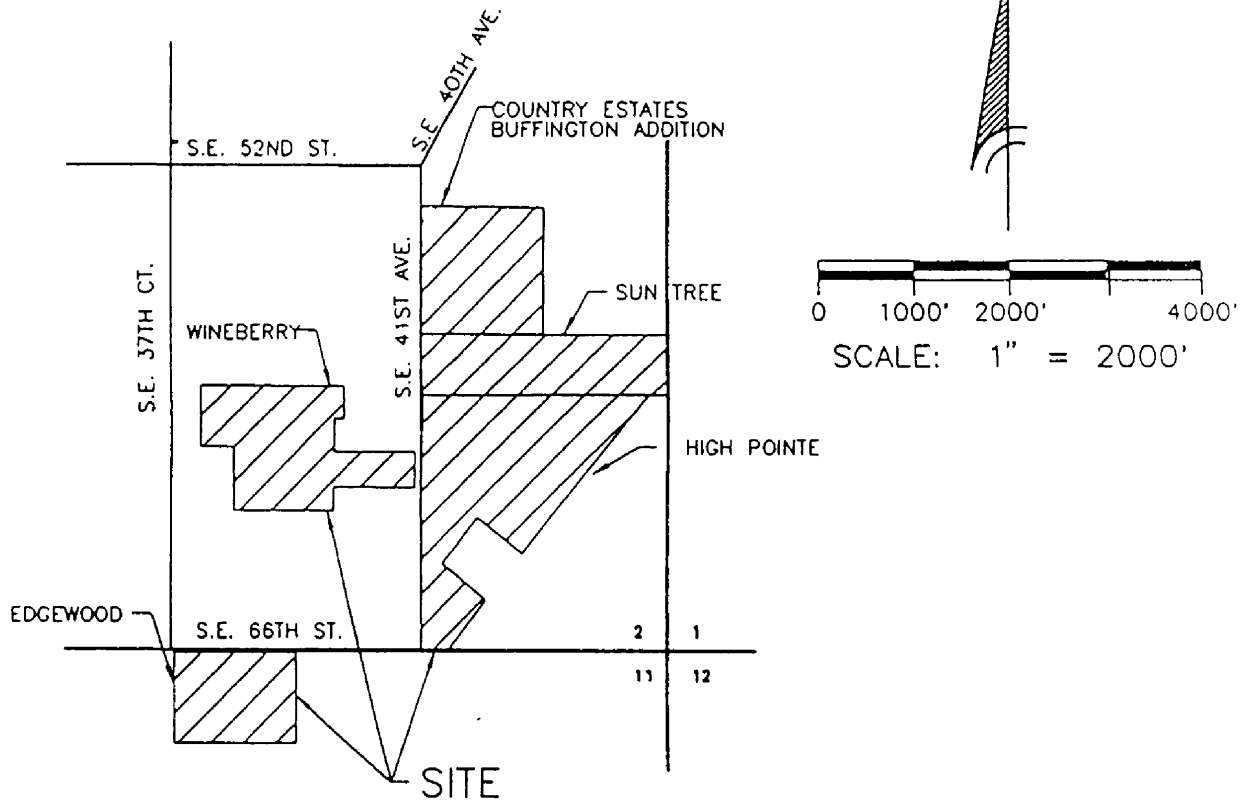

LOCATION MAP

PERMIT NO. 2-083-0023AN/
Permit No. 3002

MARION COUNTY
SECTIONS 2 & 11, TOWNSHIP 16 SOUTH, RANGE 22 EAST

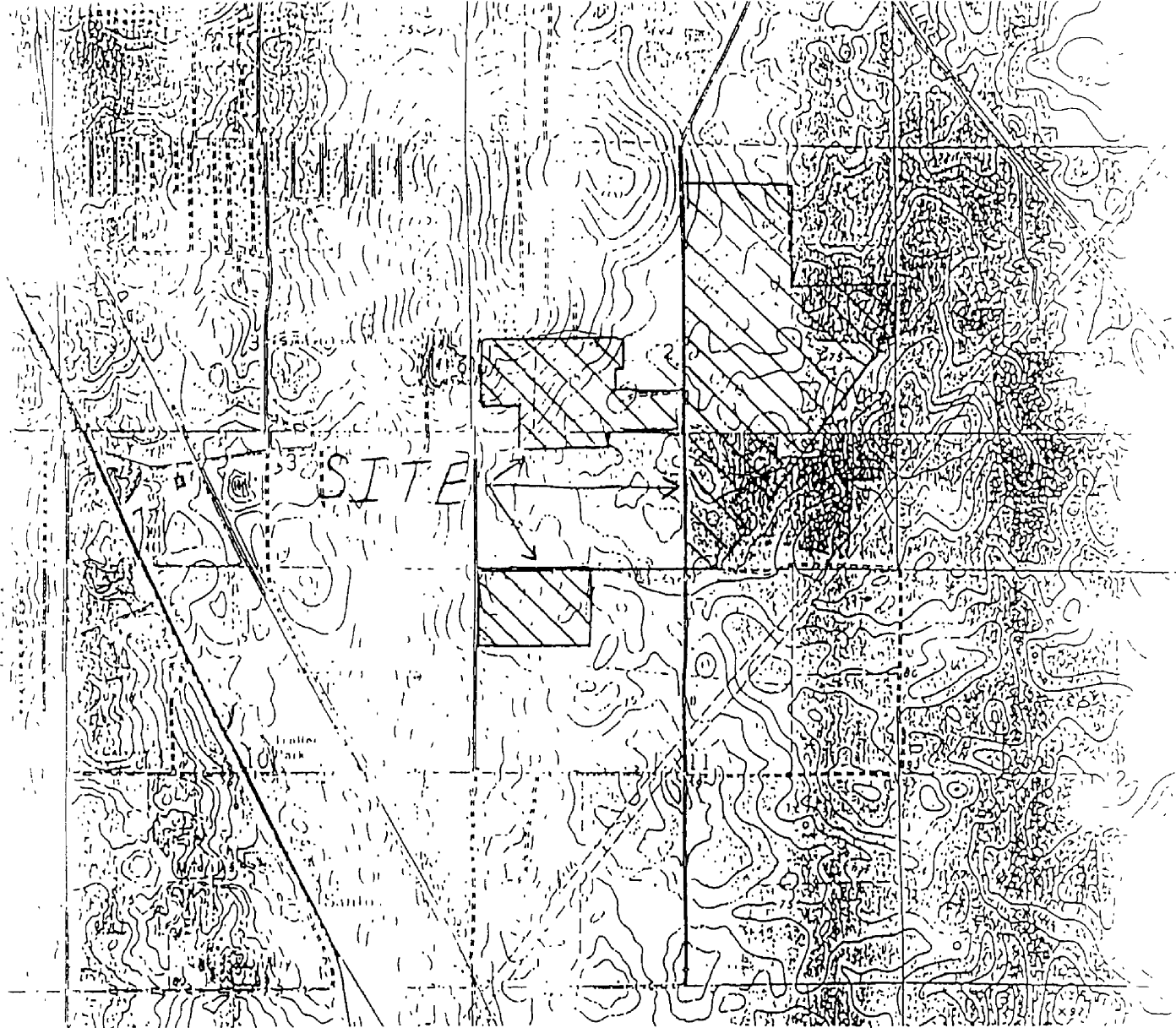

ROAD CLASSIFICATION

| | | | |
|--|-------|--|-----------|
| Primary highway, all weather, hard surface | ————— | Light duty road, all weather, improved surface | ————— |
| Secondary highway, all weather, hard surface | ————— | Unimproved road, fair or dry weather | - - - - - |

□ U S Route

○ State Route

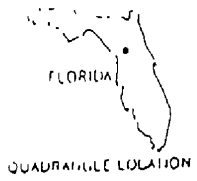
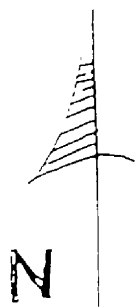

Charles DeMenzes

OCALA EAST, FLA
N2907.5—W8700/7.5
1967

U.S.G.S Map

AMS 4542 II NE—SERIES YB47

BELLEVIEW, FLA

2908/AL-TF-024

on the predicted North American Datum 1983
the projection lines 25 meters south and
west as shown by dashed corner ticks.

DMA 4542 I - SERIES YB47

PUBLIC SERVICE COMMISSION
CERTIFICATE

FLORIDA PUBLIC SERVICE COMMISSION

Certificate Number

419 - W

Upon consideration of the record it is hereby ORDERED that authority be and is hereby granted to:

RESIDENTIAL WATER SYSTEMS, INC.

Whose principal address is:

1732 N.E. 25th Avenue
Ocala, FL 34470 (Marion County)

to provide water service in accordance with the provision of Chapter 367, Florida Statutes, the Rules, Regulations and Orders of this Commission in the territory described by the Orders of this Commission.

This Certificate shall remain in force and effect until suspended, cancelled or revoked by Orders of this Commission.

| | | | |
|-------|--------------------|--------|-----------|
| ORDER | 12842 | DOCKET | 830436-W |
| ORDER | 14554 | DOCKET | 840284-WU |
| ORDER | PSC-96-0165-FOF-WU | DOCKET | 950907-WU |
| ORDER | PSC-98-1152-FOF-WU | DOCKET | 961310-WU |
| ORDER | PSC-99-2248-FOF-WU | DOCKET | 990698-WU |
| ORDER | | DOCKET | |
| ORDER | | DOCKET | |
| ORDER | | DOCKET | |
| ORDER | | DOCKET | |
| ORDER | | DOCKET | |

FLORIDA PUBLIC SERVICE COMMISSION

Blanca L. Bays

Director

Division of Records and Reporting

PROOF OF OWNERSHIP

10.50
.55
S.S.No.1



The instrument prepared by
MARY B. STUBBS
ADMINISTRATOR
1701 S. E. 10th Street
Ocala, Florida 32671

Parcel No.: In 34818-000-01

WARRANTY DEED

Made this 4th day of April, 1991, BETWEEN

WILLIAM A. CARBAUGH, JOSEPH C. LONDON, DORIS ELLZEY and MIKE ELLZEY, as a majority of the surviving trustees of SUN TREE, OCALA, INC., a dissolved Florida corporation, hereinafter called the Grantor, and

RESIDENTIAL WATER SYSTEMS, INC., a Florida Corporation, whose address is 310 E. E. 8th Street, Ocala, Florida 32671, hereinafter called the Grantee;

(whenever used herein the terms "grantor" and "grantee" include the parties to this instrument and the heirs, legal representatives and assigns of individuals, and the successors and assigns of corporations).

WITNESSETH, That said grantor, for and in consideration of the sum of Ten and no/100 (\$10.00) Dollars, and other good and valuable considerations to said Grantor in hand paid by said Grantee, the receipt whereof is hereby acknowledged, has granted, bargained and sold to the said grantee, and grantee's heirs and assigns forever, the following described land, situate, lying and being in Marion County, Florida, to wit:

Tract "A", SUN TREE, per plat thereof recorded in Plat Book "X", pages 3 and 4, public records of Marion County, Florida.

and said grantor does hereby fully warrant the title to said land, and will defend the same against the lawful claims of all persons whomsoever.

*"Grantor" and "grantee" are used for singular or plural, as context requires.

IN WITNESS WHEREOF, Grantor has hereunto set grantor's hand and seal the day and year first above written.

Signed, sealed and delivered in the presence of:

[Signature]

[Signature]
WILLIAM A. CARBAUGH

[Signature]
As to Carbaugh

[Signature]
JOSEPH C. LONDON

[Signature]

[Signature]
As to London

[Signature]
DORIS ELLZEY

[Signature]

[Signature]
As to Doris Ellzey

[Signature]
MIKE ELLZEY

[Signature]

[Signature]
As to Mike Ellzey

EC172950623

91-021321

91 APR 10 12:53:52

STATE OF FLORIDA
COUNTY CLERK
0055

EX 172910426

STATE OF FLORIDA
COUNTY OF MARION

I HEREBY CERTIFY that on this day before me, an officer duly qualified to take acknowledgements, personally appeared WILLIAM A. CARBAUGH, to me known to be the person described in and who executed the foregoing instrument and acknowledged before me that he executed the same.

WITNESS my hand and official seal in the County and State last aforesaid this 9th day of April, 1991.

My commission expires: Don J. Pelt
Notary Public, State of Florida
at Large
Notary Public, State of Florida at Large
My Commission Expires May 21, 1992

STATE OF FLORIDA
COUNTY OF MARION

I HEREBY CERTIFY that on this day before me, an officer duly qualified to take acknowledgements, personally appeared JOSEPH C. LONDON, to me known to be the person described in and who executed the foregoing instrument and acknowledged before me that he executed the same.

WITNESS my hand and official seal in the County and State last aforesaid this 4th day of April, 1991.

Notary Public, State of Florida at Large
My Commission Expires March 21, 1991
My commission expires: Yousang Park
Notary Public, State of Florida
at Large

STATE OF FLORIDA
COUNTY OF MARION

I HEREBY CERTIFY that on this day before me, an officer duly qualified to take acknowledgements, personally appeared DONIS ELLIEY, to me known to be the person described in and who executed the foregoing instrument and acknowledged before me that she executed the same.

WITNESS my hand and official seal in the County and State last aforesaid this 4th day of April, 1991.

Notary Public, State of Florida at Large
My Commission Expires March 21, 1991
My commission expires: Yousang Park
Notary Public, State of Florida
at Large

STATE OF FLORIDA
COUNTY OF MARION

I HEREBY CERTIFY that on this day before me, an officer duly qualified to take acknowledgements, personally appeared MIKE ELLIEY, to me known to be the person described in and who executed the foregoing instrument and acknowledged before me that he executed the same.

WITNESS my hand and official seal in the County and State last aforesaid this 4th day of April, 1991.

My commission expires: 6/25/93
Kevin R. Goble
Notary Public, State of Florida
at Large

WATER CONSERVATION PLAN

DRAFT
7-29-92

WATER CONSERVATION PLAN FORM
FOR PUBLIC SUPPLY APPLICANTS

Section 12.4.5.1 - Applicant's Handbook:

All individual permit applicants for a public supply type water use must submit a water conservation plan for their facility to the District at the time of permit application. The plan must contain specific measures designed to conserve water. At a minimum, the water conservation plan must include the following elements:

- (a) An audit of the amount of water used in the applicant's production facility, transmission lines, and distribution system;
 - leak detection and repair program if necessary and cost effective
- (b) A program for technological, procedural, and/or programmatic improvements to the applicant's production facility, transmission lines, and distribution system to decrease water consumption;
- (c) An analysis of the economic, environmental and technical feasibility of reusing reclaimed water, recycling water on-site, utilizing the lowest acceptable quality water source, and providing reclaimed water or stormwater for use;
- (d) Develop and implement an employee awareness and customer education program concerning water conservation; and
- (e) Procedures and timeframes for implementation, and for periodic assessment and revision of the water conservation plan.

In evaluating this form, the District will consider:

- your specific use relative to other similar uses
- available technology
- economic feasibility

General Information

Applicant/Owner Name: _____

CUP Number: _____

Date Plan Submitted: _____

Agent/Consultant Name: _____

Project Name: _____

- If you serve multiple developments and/or municipalities, please provide a map identifying service area boundaries and the associated geographical entities served.
- If you have additional information regarding your water conservation activities, please attach copies to this form.

Section I

WATER AUDIT

New Applicants: Must conduct an audit within two years after permit issuance.

Renewing, Existing Violations, or Expired Applicants:

Must conduct an audit as part of the application process.

Purpose: To help focus water conservation efforts via determination of system efficiency and identification of sources of water and revenue loss.

Required Information:

- Water Audit Component Summary
- Unaccounted Water Determination (Worksheet 1)
- Leak Detection Cost Feasibility (Worksheet 2)
- Corrective Action Plan

Note: New Applicants are defined as new facilities, it does not include existing violations or late renewals which are reclassified as "new uses".

WATER AUDIT COMPONENT SUMMARY

The following guidelines are designed to assist the applicant in collecting sufficient data necessary to conduct the required water audit. Each of the following components must be summarized unless they are part of the consumptive use permit application. These summaries will then allow the applicant to accurately complete Worksheets 1 and 2.

Information to Summarize

- Water production/service summary (daily and monthly figures)
- Water use records for past 12 months (review residential and commercial meter sales on a month by month basis). Please submit summary of this information if available.
- Sources of water (i.e., wells, surface, purchased, reclaimed)
- Location, type, and size, of production facility meters
- Accounting and meter reading processes which may provide for inconsistencies in commercial and residential sales records (i.e., frequency of readings and noted calibration errors)
- Records from metered services (i.e., construction, street cleaning, line flushing, etc.)

WORKSHEET 1
UNACCOUNTED WATER

1. What is the total volume of water entering the distribution system? 83.95 MGY
(million gallons/year)
2. What is the total volume of water sold and or metered in the distribution system? 81.9425 MGY
3. Unaccounted Water (Line 1 minus 2) 2.0075 MGY
4. What is the estimated volume of water for each Unmetered uses:
 - a. Firefighting _____ MGY
 - b. Sewer flushing _____ MGY
 - ✓ c. Main flushing .669 MGY
 - d. Street cleaning _____ MGY
 - ✓ e. Construction use .669 MGY
 - f. Public use - schools, irrigation, municipal buildings _____ MGY
 - g. Other: _____ MGY
5. Total amount of unmetered water use (Add a - g) 1.338 MGY
6. Actual unaccounted for water in system (Line 3 minus Line 5) 0.6695 MGY
7. System unaccounted water percentage (Line 6 Divided by Line 1 x 100) 0.8% Percent

Note: For unmetered uses (Line 4), please provide a narrative on how each estimate was calculated.

WORKSHEET 2
LEAK DETECTION EVALUATION

To demonstrate the cost effectiveness of a leak detection and repair program, the following Worksheet has been prepared.

| | | |
|-----|---|--|
| 1. | Actual unaccounted for water in system (Line 6 on UAW) | <u>0.665</u> MGY |
| 2. | Estimated amount of total due to leakage (District typically estimates 50% of unaccounted water) | <u>0.335</u> MGY |
| 3. | Estimated recoverable leakage (Typically 80% of Line 2) | <u>0.2678</u> MGY |
| 4. | Purchase cost of water per year (if applicable) | \$ <u>1.40</u> ^{TL} per/1000 gal. |
| 5. | Cost of chemicals for treatment per year | \$ <u>*</u> per/1000 gal. |
| 6. | Cost of electricity for pumpage per year | \$ <u>*</u> per/1000 gal. |
| 7. | Total production cost per year (Add Lines 4 - 6) | \$ <u>1.40</u> ^{TL} per/1000 gal. |
| 8. | Average production cost per 1,000 gallons (Line 7 divided by Line 1 of UAW x 1,000) | \$ <u>2,091.00</u> |
| 9. | One-year benefits from recovered leakage (Line 8 x Line 3, divided by 1,000) | \$ <u>0.56</u> |
| 10. | Total benefits from recovered leakage over two years (Line 9 x 2) | \$ <u>1.12</u> |
| 11. | Estimated cost of leak detection | \$ <u>500.00</u> |
| 12. | Estimated time for cost recovery | <u>.30</u> ^{TL} years |

Note: "UAW" refers to Unaccounted Water Worksheet 1

Provide a narrative to justify the estimated cost for leak detection.

* Included in line 4

CORRECTIVE ACTION PLAN

The following are examples of system improvements that could form a comprehensive corrective action plan.

- Update Utility Master Plan
- Update water distribution maps
- ✓ ● Repeat audit annually
- ✓ ● Computerize billing and accounting system
- Account for fire, street, and sewer unmetered use
- ✓ ● Annually test and calibrate all production meters
- Annually test all large meters
- Standardized meter reading cycle
- Remove meters not in use
- Establish water main replacement program
- Begin comprehensive leak detection and repair program
- Require contractors to inform utility and meter water used
- Complete systemwide metering
- ✓ ● Review line maintenance procedures

If it is necessary and cost effective, propose an implementation schedule for a leak detection, repair and corrective action program.

Section II

Technological, Procedural, and/or Programmatic Improvements Management

Water Treatment Plant Technologies:

Describe conservation measures used during the water treatment process.
(You may wish to use a flow chart.)

Water Use Monitoring:

1. Are your production wells currently equipped with individual meters?

Yes No

If yes;

(a) Indicate what type(s) you use (i.e., in-line flow meter, hour meter).

(b) What is the calibration schedule for the production well meters?

Annually

(c) What was the last date of calibration of these meters?

New Meters, installed 2 yrs ago.

If no, what type of meter do you plan to install to meet District monitoring requirements?

Note: New applicants are required to install in-line totalizing flow meters to measure water use before initiating withdrawal.

Renewing applicants are required to measure water use within one year of permit renewal, or by January 1, 1994, whichever is sooner, using either in-line flow meters or a District-approved alternative method.

2. Is each service connection including residential, commercial, industrial and other users currently equipped with a meter? Yes No

Note: The District now requires that all public supply service connections be metered.

If no, propose implementation and calibration schedules for placing individual meters on all service connections.

3. Are there any master meters on your system? Yes No

If yes:

- (a) Propose an implementation schedule which will prohibit new master meters. *NO NEW MASTER METERS can be placed on the system.*
- (b) Propose an implementation schedule which will supply sub-meters to master metered customers. *MA.*

4. Provide a table showing the breakdown of the present number of service connections for residential, commercial (includes apartments, schools, hospital, etc.), and industrial uses.

THIS WTP SERVES RESIDENTIAL UNITS ONLY.

Other Water Treatment Plant Water Use Practices:

What other water use practices have you undertaken or do you plan to undertake to conserve water at the water treatment plant?
(i.e., vehicle/equipment washing with reclaimed water)

Indoor Conservation Programs for Customers:

1. Do you provide indoor water audits for your customers?

| | | | | |
|--------------|-----|--------------------------|----|-------------------------------------|
| Residential: | Yes | <input type="checkbox"/> | No | <input checked="" type="checkbox"/> |
| Commercial: | Yes | <input type="checkbox"/> | No | <input checked="" type="checkbox"/> |
| Industrial: | Yes | <input type="checkbox"/> | No | <input checked="" type="checkbox"/> |

If yes:

- (a) Describe the type of audit and procedure for conducting the audit.
- (b) How many audits are conducted per year?
- (c) Assess the success of this program (estimate how much water has been saved).

If no, propose an implementation schedule for an indoor audit program or provide an explanation of why this type of program cannot be undertaken.

Residential Plumbing Retrofitting Programs:

Do you provide water conservation plumbing retrofitting devices and/or kits to your residential customers? Yes No

If yes:

- (a) Describe the devices and/or contents of the kits and their cost to you and/or the customer.
- (b) Describe the method(s) used to distribute the devices and kits.
- (c) Indicate the number and percent of customers impacted by this program.

- (d) Assess the success of this program (estimate how much water has been saved).

If no, propose an implementation schedule for an indoor retrofitting program or provide an explanation of why this type of program cannot be undertaken.

Non-Residential Retrofitting Programs:

NA

Describe involvement your facility has had in retrofitting non-residential plumbing or equipment for large volume users of water (i.e., industries, institutions, commercial entities).

New Construction Programs:

Do you have new construction incentives for water conservation?
Yes No Not Applicable

If yes, describe these incentive programs (i.e., rebates for builders or homeowners who equip houses or other structures with ultra low volume plumbing fixtures, variable or sliding hookup fees favoring those who have ultra low volume plumbing fixtures, favorable water pricing structure for customers equipped with water efficient plumbing.

If no, propose an implementation schedule for new construction water conservation incentives or provide an explanation of why this type of program cannot be undertaken.

Other Indoor Conservation Programs for Customers:

Please describe any other indoor conservation programs you have implemented.

Outdoor Conservation Programs for Customers:

Do you provide outdoor water audits for your customers?

| | | | | |
|--------------|-----|--------------------------|----|-------------------------------------|
| Residential: | Yes | <input type="checkbox"/> | No | <input checked="" type="checkbox"/> |
| Commercial: | Yes | <input type="checkbox"/> | No | <input checked="" type="checkbox"/> |
| Industrial: | Yes | <input type="checkbox"/> | No | <input type="checkbox"/> |

If yes:

- (a) Describe the type of audit and procedure for conducting the audit.
- (b) How many audits are conducted per year?
- (c) Assess the success of this program (estimate how much water has been saved).

If no, propose an implementation schedule for an outdoor audit program or provide an explanation of why this type of program cannot be undertaken.

RESTRICT IRRIGATION USE by installing
STATE OF THE ART ZONE controllers, AND LANDSCAPE
WITH LOW MAINTENANCE type of plants.

Water Efficient Landscaping:

1. Do you provide information on water efficient landscaping (Xeriscape) to customers?

Yes No

2. Have you sponsored a water conservation demonstration garden or landscape plot(s)?

Yes No

3. Do you have a rebate or other incentive program to encourage the use of water conservation landscaping for new construction?

Yes No

If no to any of the above questions, propose an implementation schedule for providing information on water efficient landscaping or provide an explanation of why this program cannot be undertaken.

4. Please describe any other activities you have implemented relative to water efficient landscaping (i.e., soil moisture monitoring and rain shutoff device distribution program).

INSTALL RAIN SOAK AND SYSTEM

Other Outdoor Conservation Programs for Customers:

Please describe any other outdoor conservation programs you have implemented (i.e., recirculating stormwater for aesthetic uses).

Rate Structure:

1. What type of rate structure do you currently utilize?

- Flat Rate
- Decreasing Rate
- Inclined Rate
- Combination (explain) _____
- Variable for seasonal demand (explain) REDUCE volume DURING WARM
SEASONS & WINTER
- Other (explain) _____

2. Please describe the rate structure. 50% reduction / notice on billing
STATEMENT

3. What is the rate?

- Residential 2nd OF WATER / WK
per gallons
- Commercial _____ per _____ gallons

4. Does your rate structure encourage conservation?

Yes No

If yes, please describe. XERISCAPE planting

If no, propose an implementation schedule for a conservation rate structure or provide an explanation why this program cannot be implemented. Such rate structure should include at least one of the following: increasing block rates, seasonal rates, quantity based surcharges and/or time of day pricing.

Ordinance Development

1. If you are a publicly owned and operated utility, provide a schedule for the adoption of the following water conservation related ordinances or an explanation of why it cannot be undertaken?
 - (a) Requiring the installation of ultra-low volume plumbing fixtures in all new construction, such that plumbing fixtures are installed to comply with the following maximum flow volumes at 80 PSI:

| | |
|--------------------|---------------|
| Toilets: | 1.6 gal/flush |
| Urinals: | 1.0 gal/flush |
| Shower heads | 2.5 gal/min |
| faucets (bathroom) | 2.0 gal/min |
| (kitchen) | 2.5 gal/min |
 - (b) Adoption of water conservation - based rate structure.
 - (c) Prohibiting master meters on new service connections.
 - (d) In areas which are prone to freezing temperatures: prohibiting the use of water to freeze protect pipes and bibs.
 - (e) Prohibiting wasteful use of water.
 - (f) Requiring the installation, where practical, of a dual piping system to provide reclaimed water in new construction.
2. Where the local government operating the public water supply utility, pursuant to section 125.568 or 166.048, F.S., determines that water efficient landscaping (Xeriscape) would be of significant benefit as a water conservation measure relative to the cost of water efficient landscape implementation, the local government operating the public water supply utility is required to adopt a water efficient landscape ordinance meeting the requirements of section 373.185(2)(a)-(f), F.S. In the event such a water efficient landscape ordinance is proposed for adoption, the permit applicant shall submit the draft ordinance to the District for determination of compliance with section 373.185(2)(a)-(f), F.S. If the cost/benefit analysis has not been done, the applicant may utilize the District's Guide for Local Governments Water Efficient Landscaping (Xeriscape) ordinance economic feasibility analysis.

3. What other regulatory or policy activities have you undertaken or do you plan to undertake to conserve water? (i.e., establishment of a water conservation coordinator position, meter readers monitoring and reporting watering restrictions violations)
4. Public water supply utilities operated by private entities are required to document the fact they requested local governments within their service area to adopt those water conservation ordinances listed above. Documentation of the local government's response must be provided.

Section III

USE OF LOWER QUALITY WATER SOURCES

1. Describe your current reuse program.

2. If you do not have a reuse program currently in place, for those public water supply utilities who control, either directly or indirectly, a wastewater treatment plant, provide a time-frame for the completion of an analysis of the economic, environmental, and technical feasibility of reusing reclaimed water, recycling water on-site, utilizing the lowest acceptable quality water source for the intended purpose, and providing reclaimed water or stormwater for end use.

Applicants are required to utilize the *Guidelines for Preparation of Reuse Feasibility Studies* published by the Department of Environmental Regulation in November, 1991.

3. If you recycle treatment process discharge water or stormwater for onsite landscape irrigation or for any other purpose, please describe the use.

4. Provide a map of the reclaimed water service area showing distribution lines (existing and proposed) and the name, addresses and quantities used by each existing reuse customer.

Section IV

Customer and Employee Education

(Please attach examples of water conservation information you provide to customers)

1. Using the appropriate letter, please summarize on the following list of which public education and employee awareness measures you have already implemented (I) or plan to implement (P).

| <u>Activity</u> | <u>Implementation date</u> |
|---|----------------------------|
| <input checked="" type="checkbox"/> Use bill stuffers to provide water conservation tips and information to customers | <u>current</u> |
| <input type="checkbox"/> Use special mailings to provide water conservation tips and information to customers | <u> </u> |
| <input type="checkbox"/> Provide specific water conservation literature or other information for different customer categories | <u> </u> |
| <input type="checkbox"/> Use other advertising (radio and TV public service announcements, billboards, newspaper or magazine ads) to encourage water conservation among customers | <u> </u> |
| <input type="checkbox"/> Provide water conservation materials to schools | <u> </u> |
| <input type="checkbox"/> Conduct public tours of your facilities | <u> </u> |
| <input type="checkbox"/> Operate informational booths which include water conservation literature | <u> </u> |
| <input type="checkbox"/> Seek employees' ideas for water conservation, using contests, suggestion boxes or other incentives | <u> </u> |
| <input type="checkbox"/> Install signs in employee restrooms encouraging water conservation | <u> </u> |
| <input type="checkbox"/> Publish and distribute water conservation tips and information via company newsletters, bulletin boards, or employee paychecks | <u> </u> |

- _____ Appoint an employee water conservation coordinator to design and implement your internal plan _____
- _____ Conduct other public education and employee awareness activities (please explain) _____
- _____ Private utility provide information for applicable local water conservation ordinances

2. Of the education and awareness programs you have implemented, which have been especially effective?

Notices to users

3. Of the education and awareness programs you have implemented, which have not been effective? Why?

N/A.



St. Johns River Water Management District

Kirby B. Green III, Executive Director • John R. Wehle, Assistant Executive Director

Post Office Box 1429 • Palatka, FL 32178-1429 • (386) 329-4500

July 17, 2003

CERTIFIED MAIL NO: 70010320000354219034

Miles C. Anderson
2300 SE 17th St Suite 200
Ocala, FL 34471

Re: Request for Additional Information
CUP No. 3002
Project Name: High Pointe

Dear Mr. Anderson :

Thank you for submitting an RAI response. The District received your response on June 20, 2003, however, certain information is still needed to complete your application. The information requested below is specifically required in District Rule Section 4.3 of the Applicant's Handbook. The citation A.H. refers to the Applicant's Handbook. The citation "F.S." refers to Florida Statutes, the citation "F.A.C." refers to the Florida Administrative Code, and the citation "A.H." refers to the Applicant's Handbook: Consumptive Uses of Water, April 10, 2002.

In order to expedite the review of this permit application, please include the District's permit application number (3002) on all correspondence and submit (2) copies of all requested information unless otherwise instructed by a specific information request. All responses to additional information should be addressed to me at the Palatka address noted above.

REQUESTED INFORMATION:

- The St. Johns River Water Management District proposes to allocate 89.4 million gallons per year (mgy) annual withdrawal through year 2004, 94.5 mgy annual withdrawal through year 2006, 100.7 mgy annual withdrawal through year 2008, and 108.4 mgy annual withdrawal through the duration of the permit as per the information you submitted on the projected water use table. Please indicate if the proposed allocations are acceptable. If not acceptable, please justify any requested increases. [Paragraph 10.3; (a), (b), and (d) A.H.]**

GOVERNING BOARD

Duane Ottenstroer, CHAIRMAN
JACKSONVILLE

Ometrias D. Long, VICE CHAIRMAN
APOPKA

R. Clay Albright, SECRETARY
EAST LAKE WEIR

David G. Graham, TREASURER
JACKSONVILLE

W. Michael Branch
FERNANDINA BEACH

Jeff K. Jennings
MAITLAND

William Kerr
MELBOURNE BEACH

Ann T. Moore
BUNNELL

Catherine A. Walker
ALTAMONTE SPRINGS

We ask that you submit the requested information in a timely manner to help expedite review of your application. Please be advised that, pursuant to District procedural rules, any application which has not been technically and administratively completed within 120 days from the date of receipt of a Request for Additional Information by the District, must be forwarded to the Governing Board with a recommendation for denial based upon an incomplete application. However, should you require more than 120 days to respond, additional time to respond may be granted for good cause. You must request, in writing, additional time to respond along with the reason for the request. Please direct such a written request to me and I will let you know if we can grant such an extension.

We thank you again for your application and remind you that should you have any questions regarding this letter or the application in general, please contact me at the Palatka Service Center at (386) 329-4561. I look forward to working with you to get your application completed for Governing Board action at the earliest possible date.

Sincerely,

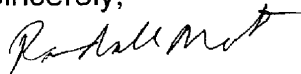

Randall Motes, Hydrologist II
Department of Resource Management

cc: PDS/RAIL
Todd Eller
Residential Water System
Charles Demenzes
PO Box 5220
Ocala, FL 34478



**MILES CHRISTIAN ANDERSON
CONSULTING ENGINEERS, INC.**

CIVIL • STRUCTURAL • LAND PLANNING • GOLF COURSE DESIGN

2300 S.E. 17TH STREET, SUITE 200
OCALA, FLORIDA 34471

(352) 629-5591
FAX (352) 629-4402

August 1, 2003

Randall Motes
SJRWMD
P.O. Box 1429
Palatka, FL 32178-1429

Re: CUP No. 3002
Project Name: High Pointe

Dear Mr. Motes,

I am in receipt of your correspondence of July 17, 2003, and confirm that annual withdrawal as stated is in accordance with the project Water Table 2 contained in the C.U.P. submittal for High Pointe Subdivision.

Should you have any further questions or comments, please feel free to contact me at 352-629-5591.

Sincerely,

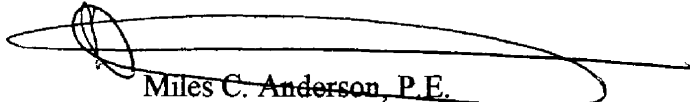
Miles C. Anderson, P.E.
FL. Professional Engineer #39385

MCA/lb

File: CUP3002



St. Johns River Water Management District

Kirby B. Green III, Executive Director • John R. Wehle, Assistant Executive Director

Post Office Box 1429 • Palatka, FL 32178-1429 • (386) 329-4500

August 21, 2003

CERTIFIED MAIL NO: 70010320000354218969

Miles C. Anderson
2300 SE 17th St Suite 200
Ocala, FL 34471

Re: Request for Additional Information
CUP No. 3002
Project Name: High Pointe

Dear Mr. Anderson :

Thank you for submitting an RAI response. The District received your response on August 8, 2003, however, certain information is still needed to complete your application. The information requested below is specifically required in District Rule Section 4.3 of the Applicant's Handbook. The citation A.H. refers to the Applicant's Handbook. The citation "F.S." refers to Florida Statutes, the citation "F.A.C." refers to the Florida Administrative Code, and the citation "A.H." refers to the Applicant's Handbook: Consumptive Uses of Water, April 10, 2002.

In order to expedite the review of this permit application, please include the District's permit application number (3002) on all correspondence and submit (2) copies of all requested information unless otherwise instructed by a specific information request. All responses to additional information should be addressed to me at the Palatka address noted above.

REQUESTED INFORMATION:

- 1. Please fill out page 14 of the Water Conservation Plan Form for Public Supply. Showing how residences are charged for their water usage. [Paragraph 10.3; (e) A.H.]**

GOVERNING BOARD

| | | | |
|---|---|---|--|
| Duane Ottenstroer, CHAIRMAN JACKSONVILLE | Ometrias D. Long, VICE CHAIRMAN APOPKA | R. Clay Albright, SECRETARY EAST LAKE WEIR | David G. Graham, TREASURER JACKSONVILLE |
| W. Michael Branch FERNANDINA BEACH | Jeff K. Jennings MAITLAND | William Kerr MELBOURNE BEACH | Ann T. Moore BUNNELL |
| | | | Catherine A. Walker ALTAMONTE SPRINGS |

We ask that you submit the requested information in a timely manner to help expedite review of your application. Please be advised that, pursuant to District procedural rules, any application which has not been technically and administratively completed within 120 days from the date of receipt of a Request for Additional Information by the District, must be forwarded to the Governing Board with a recommendation for denial based upon an incomplete application. However, should you require more than 120 days to respond, additional time to respond may be granted for good cause. You must request, in writing, additional time to respond along with the reason for the request. Please direct such a written request to me and I will let you know if we can grant such an extension.

We thank you again for your application and remind you that should you have any questions regarding this letter or the application in general, please contact me at the Palatka Service Center at (386) 329-4561. I look forward to working with you to get your application completed for Governing Board action at the earliest possible date.

Sincerely,

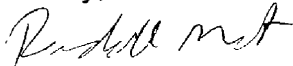

Randall Motes, Hydrologist II
Department of Resource Management

cc: PDS/RAIL
Todd Eller
Residential Water System
Charles Demenzes
PO Box 5220
Ocala, FL 34478



**MILES CHRISTIAN ANDERSON
CONSULTING ENGINEERS, INC.**

CIVIL • STRUCTURAL • LAND PLANNING • GOLF COURSE DESIGN

2300 S.E. 17TH STREET, SUITE 200
OCALA, FLORIDA 34471

(352) 629-5591
FAX (352) 629-4402

August 29, 2003

Randall Motes, Hydrologist II
S.J.R.W.M.D.
Department of Resource Management
P.O. Box 1429
Palatka, FL 32178-1429

RE: CUP No. 3002
Project Name: High Pointe
Request for additional information

Dear Sir,

As requested find attached page 14 of the Water Conservation Plan Form for Public Supply and a copy of billing sent with conservation tips.

Sincerely,

A handwritten signature in black ink, appearing to read 'Miles C. Anderson, P.E.', is written over a horizontal line.

Miles C. Anderson, P.E.
FL. Professional Engineer #39385

MCA/lb

File:High Pointe
Request for info.

High Pointe WTP - sup

Rate Structure:

1. What type of rate structure do you currently utilize?

Flat Rate

Decreasing Rate

Inclined Rate

Combination (explain) _____

Variable for seasonal demand (explain) _____

Other (explain) BASE FACILITY CHARGE + USAGE CHG.

2. Please describe the rate structure.

BASE FACILITY CHARGE of \$9.85 FOR WATER (1/4 ACRE LOT)
BASE FACILITY CHARGE of \$24.63 FOR 1/2 ACRE AND UP.

3. What is the rate?

Residential 1.38 per 1000 gallons

Commercial _____ per _____ gallons

4. Does your rate structure encourage conservation?

Yes _____ No

If yes, please describe.

If no, propose an implementation schedule for a conservation rate structure or provide an explanation why this program cannot be implemented. Such rate structure should include at least one of the following: increasing block rates, seasonal rates, quantity based surcharges and/or time of day pricing.

SEE ATTACHED BILLING FOR WEB SITE INFORMATION
THAT IS EXTREMELY INFORMATIVE.

RESIDENTIAL WATER SYS, INC

| BILLING PERIOD | | TYPE | BEGINNING | ENDING | CURRENT MONTH | SAME MONTH LAST YEAR |
|----------------|------------|------|-----------|---------|---------------|----------------------|
| FROM | TO | SERV | READING | READING | GALLONS USED | GALLONS USED |
| 07/23/2003 | 08/22/2003 | RS | 0 | 0 | 0 | 0 |

WATER BASE FACILITY CHARGE: 9.85 + 0.00 (1.38 PER 1000 GALS)
 SEWER BASE FACILITY CHARGE: 0.00 + (0.00 PER 1000 GALS)

PRIOR BALANCE 201.57 PMTS/ADJ 0.00 CUR CHGS 9.85 >>>> TOTAL DUE: 211.42

ACCOUNT NUMBER 831150
 SERV ADDR: 3793 SE 67TH PL

DON, M. M.
 4920 ALEXANDER DR
 METAIRIE, LA. 70003

YOUR AVG USAGE OVER THE LAST 14 MONTHS - 605
 AVG FOR YOUR TYPE SERV OVER LAST 16 MONTHS - 9197

OFFICE HOURS 9AM-4PM MON - FRI PHONE 622-4949 AFTER HOURS 843-7717 OR 690-5256

WATER IS OUR MOST VALUABLE RESOURCE. FOR WATER SAVING TIPS SEE-
<http://www.swfwmd.state.fl.us/watercon/tips/tips.htm>

PLEASE RETURN THIS PORTION WITH YOUR PAYMENT
 YOUR ACCOUNT WILL BE CONSIDERED DELINQUENT IF NOT PAID BY>>>> 09/21/2003

AMOUNT DUE UPON RECEIPT -----> 211.42 PAID _____

(please write your account
 number 831150 on your check)

RESIDENTIAL WATER SYS, INC
 P.O. BOX 5220
 OCALA, FL 34478-5220

DON, M. M.

Monthly messages to print on the billing statements.

1. Water is our most valuable resource. For water savings tips see <http://www.swfwmd.state.fl.us/watercon/tips/tips.htm>
2. Water restrictions are still in effect. No watering from 10AM to 4PM. TIP this Month... A faucet drip can use hundreds of gallons a month.
3. Did you know that a garden hose lets out 6 gallons of water per minute? Washing a car for 30 minutes will use 180 gallons!!!!
4. When you wash cloths, us the "LOW" water setting and save tons of water per year.
5. Check your commode tank monthly for running water. Water conservation is everybody's responsibility.
6. Showerheads can pump out 3 to 6 gallons per minute. Limit your shower time accordingly.
7. For young children, using a bathtub is conserving water. The kids love it also.
8. When watering plants, use a water bucket rather than a hose. It limits how much water you put on the plants where a hose does not.
9. A leaking spigot can waste hundreds of gallons per month. Do a monthly review of your outside spigots.
10. Flush your hot water tank at least every 6 months to get rid of calcium deposits. It extends the life of the water heater elements.
11. Don't leave water running when brushing your teeth, and save up to six gallons per brushing. Do the math and you will be surprised.
12. Wait and save money by washing a full load of dishes rather than partial load. It all adds up at the end of the year.

Residential Water Systems, Inc.
P.O. Box 5220
Ocala, FL 34478-5220
352-622-4949

November 17, 2003

Ms. Blanca Bayo, Director
Division of the Commission Clerk
Florida Public Service Commission
2540 Shumard Oak Boulevard
Tallahassee, Florida 32399-0850

Docket No. 030423-WU

Dear Ms. Bayo,

The following are responses to the letter of November 5, 2003 from Ralph Jaeger, Senior Attorney.

50. For the first six (6) months of 2002, the weekly management fee was allocated among various expense accounts. In the case of account 604, Pensions and Benefits, the Vice President was not on salary from Residential Water Systems, Inc. and specific expenses such as dental and medical was paid by RWS. The allocation of \$30.00 per week was recorded as shown by exhibit "A". As to \$4,785 in Account 636, I have no idea what was used to develop this amount from the Auditors. Pending detailed information, I will attempt to answer the request. Last but not least, Hospitalization Insurance was paid by MIRA International, Inc. and not charged to RWS in the amount of \$5,966.88 per year. This Hospitalization policy does not include Dental and has a \$500.00 Deductible. The amounts in Account 604 of \$124.00 are for Dental and \$275.08 is against the deductible.
51. See number 50 above.
52. Regarding Attachment F to Data Request 21 Attachment A to Data Request 39.
 - a. For new construction of residential units, Contractors are charged \$175.00 for 1" Meters, which includes the meter and parts required to connect to the home. Those 1" meters replacing existing 1" non-AMR meters are paid and capitalized by RWS.
 - b. All 5/8" replacement meters are capitalized by RWS.
 - c. In 2003, 13 1" Meters were installed and paid for by Contractors in the amount of \$2,275.00, which was posted as CIAC. The balance of \$18,803.00 was paid by RWS.
 - d. A 5/8" meter and (2) couplings are \$78.00 (Meter) \$5.76 (Couplings) and sales tax of 7% for a total of \$89.62. See attachment "B & C". The cost noted does not include labor to install.
 - e. A 1" meter and (2) couplings are \$135.00 (Meter) \$11.47 (Couplings) and sales tax of 7% for a total of \$156.72. See attachment "B & C". The cost noted does not include labor to install.
53. Plant modifications have been completed and paid for. Per our Developer's Agreement, the Developer has paid for that portion of the modification dealing with Fire Flow Requirements by Marion County Code. Of the Total Modification cost of \$41,723.64, the Developer has contributed \$30,000.00.

Sincerely,



Charles deMenzes
President

Exhibit "A"

| ACCT # | DATE | C/J | NUM | BEG BAL | TR AMT | DESCRIPTION |
|--------|------------|------|------|-----------|-----------|------------------------|
| 503000 | 12/20/2002 | 2 | 1220 | | 2,000.00 | PAYROLL..12/20/2002 |
| 503000 | 12/27/2002 | 2 | 1227 | | 1,000.00 | PAYROLL..12/27/2002 |
| CR | | 0.00 | DB | 41,800.00 | 41,800.00 | ENDING ACCOUNT BALANCE |

| 504000 EMPLOYEE PENSION & BENEFITS | | | | 0.00 | BEGINNING ACCOUNT BALANCE | |
|------------------------------------|------------|------|------|----------|---------------------------|--|
| 504000 | 01/02/2002 | 1 | 2864 | | 30.00 | RECLASSIFY..01/02/2002 |
| 504000 | 01/07/2002 | 1 | 2865 | | 30.00 | RECLASSIFY..01/07/2002 |
| 504000 | 01/15/2002 | 1 | 2869 | | 30.00 | RECLASSIFY..01/15/2002 |
| 504000 | 01/21/2002 | 1 | 2871 | | 30.00 | RECLASSIFY..01/21/2002 |
| 504000 | 01/28/2002 | 1 | 2874 | | 30.00 | RECLASSIFY..01/28/2002 |
| 504000 | 02/04/2002 | 1 | 2875 | | 30.00 | RECLASSIFY..02/04/2002 |
| 504000 | 02/11/2002 | 1 | 2876 | | 30.00 | RECLASSIFY..02/11/2002 |
| 504000 | 02/18/2002 | 1 | 2880 | | 30.00 | RECLASSIFY..02/18/2002 |
| 504000 | 02/25/2002 | 1 | 2883 | | 30.00 | RECLASSIFY..02/25/2002 |
| 504000 | 03/04/2002 | 1 | 2884 | | 30.00 | RECLASSIFY..03/04/2002 |
| 504000 | 03/11/2002 | 1 | 2889 | | 30.00 | RECLASSIFY..03/11/2002 |
| 504000 | 03/15/2002 | 1 | 2891 | | 30.00 | RECLASSIFY..03/15/2002 |
| 504000 | 03/25/2002 | 1 | 2894 | | 30.00 | RECLASSIFY..03/25/2002 |
| 504000 | 04/01/2002 | 1 | 2895 | | 30.00 | RECLASSIFY..04/01/2002 |
| 504000 | 04/08/2002 | 1 | 2898 | | 30.00 | RECLASSIFY..04/08/2002 |
| 504000 | 04/15/2002 | 1 | 2902 | | 30.00 | RECLASSIFY..04/15/2002 |
| 504000 | 04/18/2002 | 1 | 2903 | | 30.00 | RECLASSIFY..04/18/2002 |
| 504000 | 04/29/2002 | 1 | 2909 | | 30.00 | RECLASSIFY..04/29/2002 |
| 504000 | 05/07/2002 | 1 | 2911 | | 30.00 | RECLASSIFY..05/07/2002 |
| 604000 | 05/13/2002 | 1 | 2915 | | 30.00 | RECLASSIFY..05/13/2002 |
| 604000 | 05/20/2002 | 1 | 2916 | | 30.00 | RECLASSIFY..05/20/2002 |
| 604000 | 05/24/2002 | 1 | 2917 | | 30.00 | RECLASSIFY..05/24/2002 |
| 604000 | 06/03/2002 | 1 | 2924 | | 30.00 | RECLASSIFY..06/03/2002 |
| 604000 | 06/07/2002 | 1 | 2925 | | 30.00 | RECLASSIFY..06/07/2002 |
| 604000 | 06/17/2002 | 1 | 2930 | | 30.00 | RECLASSIFY..06/17/2002 |
| 604000 | 06/24/2002 | 1 | 2933 | | 30.00 | MIRA..06/24/2002 |
| 604000 | 07/01/2002 | 1 | 2934 | | 145.00 | MIRA INTERNATIONAL-WE 07/05/20..07/01/2002 |
| 604000 | 07/02/2002 | 1 | 2935 | | 124.00 | HARLAN GOLDBERG DDS-01269 07/2..07/02/2002 |
| 604000 | 07/02/2002 | 1 | 2936 | | 51.39 | STEVEN T. POWELL M.D. P.A.-735..07/02/2002 |
| 604000 | 07/02/2002 | 1 | 2936 | | 223.69 | STEVEN T. POWELL M.D. P.A.-456..07/02/2002 |
| CR | | 0.00 | DB | 1,324.08 | 1,324.08 | ENDING ACCOUNT BALANCE |

| 615000 PURCHASED POWER | | | | 0.00 | BEGINNING ACCOUNT BALANCE | |
|------------------------|------------|---|------|------|---------------------------|--|
| 615000 | 01/11/2002 | 1 | 2867 | | 473.74 | FLORIDA POWER CORP-27319-65069..01/11/2002 |
| 615000 | 02/14/2002 | 1 | 2877 | | 381.46 | FLORIDA POWER CORP-27319-65069..02/14/2002 |
| 615000 | 03/08/2002 | 1 | 2885 | | 481.12 | FLORIDA POWER CORP-27319 65069..03/08/2002 |
| 615000 | 04/04/2002 | 1 | 2896 | | 581.95 | FLORIDA POWER CORP-27319-65069..04/04/2002 |
| 615000 | 05/10/2002 | 1 | 2913 | | 684.60 | FLORIDA POWER CORP-27319 65069..05/10/2002 |
| 615000 | 06/10/2002 | 1 | 2927 | | 869.17 | FLORIDA POWER CORP-27319-65069..06/10/2002 |
| 615000 | 07/05/2002 | 1 | 2941 | | 490.39 | FLORIDA POWER CORP-27319 65069..07/05/2002 |
| 615000 | 08/21/2002 | 1 | 2956 | | 455.00 | FLORIDA POWER CORP-2731965069..08/21/2002 |
| 615000 | 09/06/2002 | 1 | 2967 | | 389.41 | FLORIDA POWER CORP-27319 65069..09/06/2002 |
| 615000 | 10/04/2002 | 1 | 2980 | | 448.12 | FLORIDA POWER CORP-27319 65069..10/04/2002 |
| 615000 | 11/01/2002 | 1 | 2994 | | 470.61 | FLORIDA POWER CORP-2731965069..11/01/2002 |

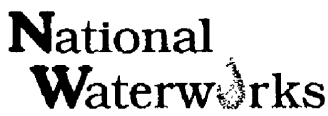

| Branch | Account | Salesperson | Invoice Date | Invoice Number |
|--------|---------|---------------|--------------|----------------|
| 055 | 091242 | Jeff Marshall | 9/26/03 | 9780200 |

NWW - Ocala FL
 Branch - 055
 820 SW 33rd Avenue
 Ocala FL 34474 0000

352/351-8144

INVOICE

Remit to:

National Waterworks, Inc.
 PO BOX 100467
 ATLANTA, GA

30384-0467



M.I.R.A. INTERNATIONAL INC
 PO BOX 4230
 Ocala FL 34478 4230

Shipped to:
 CUSTOMER PICK-UP

00/000

| |
|-------------------------|
| Total Amount Due |
| 834.60 |

Return Top Portion With Payment For Faster Credit

*Thank You For The Opportunity To Serve You.
 We appreciate your prompt payment.*

| Date Ordered | Date Shipped | Customer PO No. | Job Name | Job No. | Bill of Lading | Shipped Via | Order Number |
|--------------|--------------|-----------------|----------|---------|----------------|-------------|--------------|
| 9/25/03 | 9/25/03 | | | | | WILL CALL | 9780200 |

| Product Code | Description | Quantity Ordered | Quantity Shipped | Back-Ordered | Price | Per | Amount |
|---------------|---|------------------|------------------|--------------|-----------|-----|--------|
| 4307GTRCPMM7W | 5/8X3/4 PMM TRC 7WHEEL 1GAL BID SEQ# 160 | 46 | 10 | 36 | 78.00000 | EA | 780.00 |
| 4310GTRCPMM7W | 1 PMM TRC 7WHEEL 1GAL BID SEQ# 180 | 12 | | 12 | 135.00000 | EA | .00 |

| | | | | | | | |
|---------|----------|----------|---------|------|--|--------|---------------|
| | | | | | | Terms | Subtotal |
| | | | | | | NET 30 | 780.00 |
| Freight | Delivery | Handling | Restock | Misc | | Tax | Invoice Total |
| | | | | | | 54.60 | 834.60 |

***** THANK YOU FOR ORDER *****
 VISIT WWW.NATIONALWATERWORKS.COM
 FOR INVOICING BY EMAIL AND
 OTHER SERVICES

Please pay this amount

NWW - Ocala FL
 Branch - 055
 820 SW 33rd Avenue
 Ocala FL 34474 0000

"Local Service, Nationwide"
 www.nationalwaterworks.com

INVOICE

Page: 1
 Invoice: 9780200

00000



| Branch | Account | Salesperson | Invoice Date | Invoice Number |
|--------|---------|---------------|--------------|----------------|
| 055 | 091242 | Jeff Marshall | 11/06/03 | 9910167 |

NWW - Ocala FL
 Branch - 055
 820 SW 33rd Avenue
 Ocala FL 34474 0000

352/351-8144

|||||
M.I.R.A. INTERNATIONAL INC
 PO BOX 4230
 OCALA FL 34478 4230

INVOICE

Remit to:

National Waterworks, Inc.
 PO BOX 100467
 ATLANTA, GA

30384-0467

Shipped to:
 CUSTOMER PICK-UP

00/000

| |
|-------------------------|
| Total Amount Due |
| 861.22 |

Return Top Portion With Payment For Faster Credit

*Thank You For The Opportunity To Serve You.
 We appreciate your prompt payment.*

| Date Ordered | Date Shipped | Customer PO No. | Job Name | Job No. | Bill of Lading | Shipped Via | Order Number |
|--------------|--------------|-----------------|----------|---------|----------------|-------------|--------------|
| 11/05/03 | 11/05/03 | | | | | WILL CALL | 9910167 |

| Product Code | Description | Quantity Ordered | Quantity Shipped | Back-Ordered | Price | Per | Amount |
|--------------|--|------------------|------------------|--------------|----------|-----|--------|
| 45MPR1914 | 1914 PLAS MTR BOX W/PLAS RDR | 12 | 12 | | 11.62700 | EA | 139.52 |
| 4407MC | 3/4 METER CPLG (EACH) | 50 | 50 | | 2.88000 | EA | 144.00 |
| 4410MC | 1 METER CPLG (ROUGH BARREL) EA | 50 | 50 | | 5.73300 | EA | 286.65 |
| 65REPES01 | REED PE SHUT OFF TOOL PES01 F/WATER SERVICE | 2 | 2 | | 62.05500 | EA | 124.11 |
| 29007409MH | 3/4 PVC ST 90 BEND MIPTXH | 6 | 6 | | .76000 | EA | 4.56 |
| 2901040AHM | 1 PVC SCH40 MALE ADPT MIPTXH | 6 | 6 | | .54000 | EA | 3.24 |
| 2900740AHM | 3/4 PVC SCH40 MALE ADPT MIPTXH | 23 | 23 | | .30000 | EA | 6.90 |
| 3910I52 | #52 1 SS INSERT F/CTS PE | 100 | 100 | | .95900 | EA | 95.90 |

| | |
|--------|----------|
| Terms | Subtotal |
| NET 30 | 804.88 |

| | | | | | | |
|---------|----------|----------|---------|------|-------|---------------|
| Freight | Delivery | Handling | Restock | Misc | Tax | Invoice Total |
| | | | | | 56.34 | 861.22 |

***** THANK YOU FOR ORDER *****
 VISIT WWW.NATIONALWATERWORKS.COM
 FOR INVOICING BY EMAIL AND
 OTHER SERVICES

Please pay this amount

NWW - Ocala FL
 Branch - 055
 820 SW 33rd Avenue
 Ocala FL 34474 0000

"Local Service, Nationwide" INVOICE
 www.nationalwaterworks.com

Page: 1
 Invoice: 9910167