



Fort Lauderdale  
Jacksonville  
Los Angeles  
Madison  
Miami  
New York  
Orlando  
Tallahassee  
Tampa  
Tysons Corner  
Washington, DC  
West Palm Beach

Suite 1200  
106 East College Avenue  
Tallahassee, FL 32301  
www.akerman.com  
850 224 9634 tel 850 222 0103 fax

ORIGINAL

July 9, 2007

RECEIVED-FPSC  
07 JUL -9 AM 11:38  
COMMISSION  
CLERK  
C. V.N.

Ann Cole  
Commission Clerk  
Florida Public Service Commission  
2540 Shumard Oak Boulevard  
Tallahassee, Florida 32399-0850

Re: Docket No. 050862-WU – Application for staff-assisted rate case in Marion County by County-Wide Utility Co., Inc.

Dear Ms. Cole:

Enclosed are five colored copies of a map of the service area of County-Wide Utility Co., Inc., to be filed in the above docket. The map shows the location of the former water plant site circled in red, the interconnection point with the City of Ocala's water system; the location of the existing customer base outlined in blue; the new development outlined in yellow; and the route of the new water line indicated by a black solid line and a red dash line.

Copies of this map have previously been provided to PSC staff. If you need anything further, please do not hesitate to contact me.

- CMP \_\_\_\_\_
- COM \_\_\_\_\_
- CTR \_\_\_\_\_
- ECR** \_\_\_\_\_
- GCL   1
- OPC \_\_\_\_\_
- RCA   1
- SCR \_\_\_\_\_
- SGA \_\_\_\_\_
- SEC \_\_\_\_\_
- OTH \_\_\_\_\_

Sincerely,  
  
Todd Engelhardt



cc: Rosanne Gervasi  
Cheryl Bulecza-Banks  
Troy Rendell  
Gerald Edwards  
Shannon Hudson

DOCUMENT NUMBER - DATE  
05702 JUL -9 07  
FPSC-COMMISSION CLERK

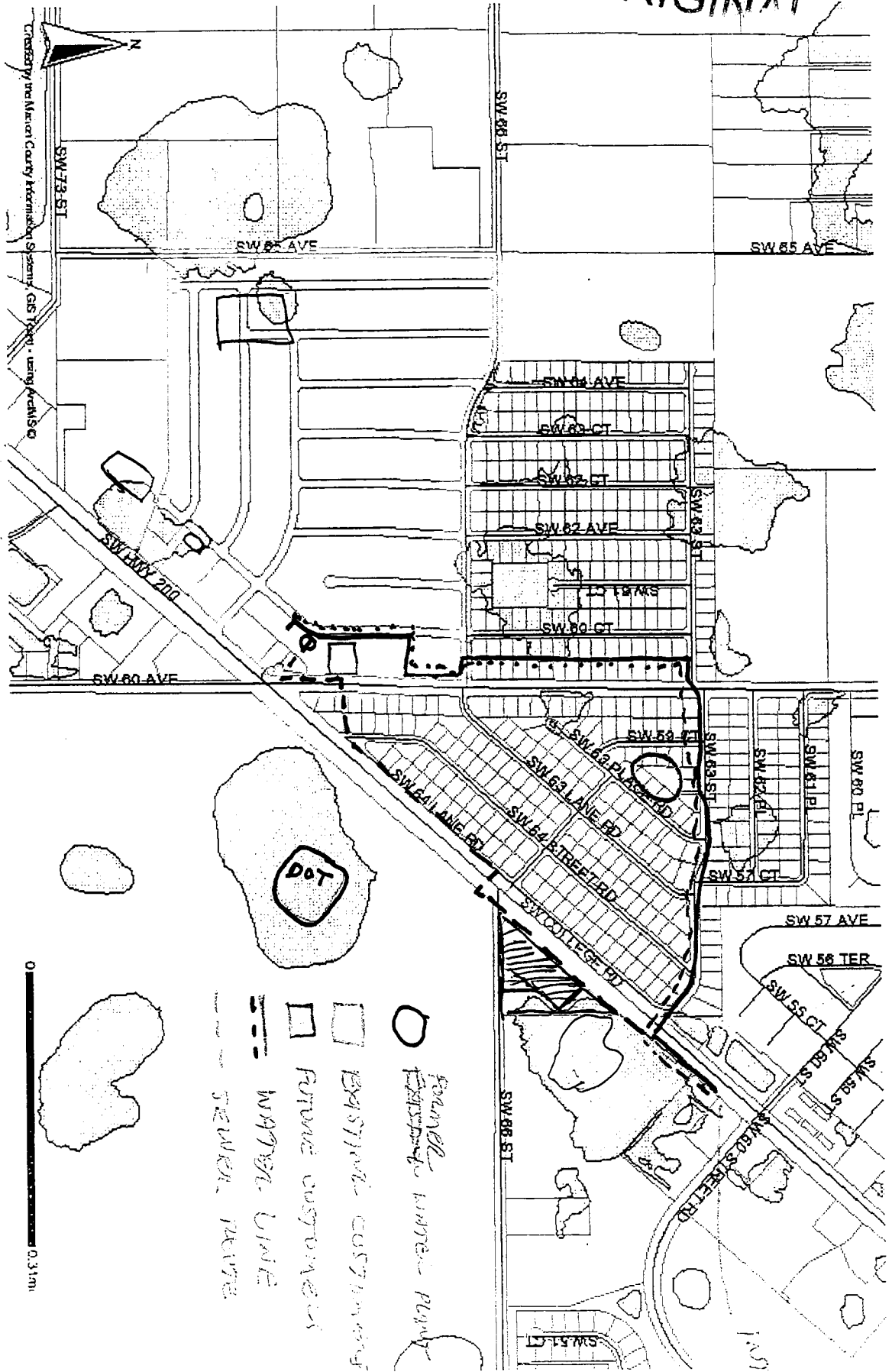
ORIGINAL

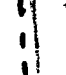
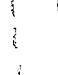

Created by the Marion County Information Systems GIS Dept. using ArcGIS 9.0

-  Future Sewer Plant Site
-  Future Customers
-  Water Line
-  Sewer Line

0 0.31mi

1995/2000/2005  
GIS Dept  
Marion County