

AC Public Charging Station

Overview

- Charge all Mode-3 vehicle
- Ground or wall-mount installation
- Output power from 3,7 kVA up to 22 kVA
- Simultaneous charging of 2 vehicles
- Master-slave architecture
- Display (for user interface)
- Network integration (OCPP or proprietary protocol);
- Built-in communications (3G; LAN; Wi-Fi)

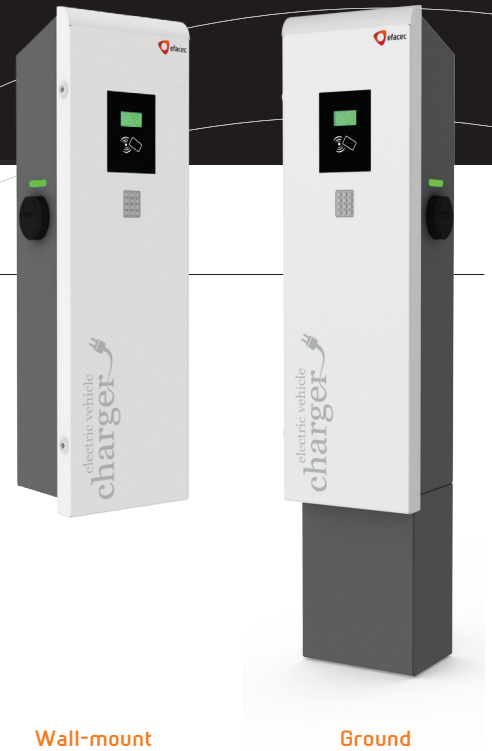

Wall-mount

Ground



User-Friendly



Scalable

 Communication
& Management

 Available
Outputs

Product description

Efacec Electric Vehicle Public Charger (EV-PC) product line is composed by 3 families of products:

- EV - Public Charger (here presented)
- EV - PC Modular⁽¹⁾
- EV - PC Pole-Mount⁽²⁾

Using easy installation procedures and requirements, Efacec EV-Public Charger can be mounted in a wall or in a ground mount using one for the possible pedestal configurations allowing versatile installation capability.

The EV-Public Charger was designed to have up to 2 outputs, Mode 3 charging socket (power ranging from 3,7 kVA to 22 kVA), can charge any EV compatible with IEC61851.

The Human Machine Interface (HMI) with LCD display, RFID reader and keyboard, was conceived not only to control the 2 built-in outputs, but also a wide number of further charging outputs in master-slave architecture.

Each Efacec EV-PC can be integrated in a charging infrastructure network and its operation and status is controlled by the central management system.

Main features

- Reduced cost
- Multiple outputs (Mode-3)
- Multiple powers (up to 22 kVA)
- Scalability (Master-slave)
- Ground or wall-mount
- Aluminum enclosure
- Space for grid provider protections and meter
- Simple plug & play installation
- Standalone or network integration charger
- Local and remote monitoring and control
- Customized personalization
- 8 colors available

Technical data	CE			
Nominal Input				
Phases / lines	1 phase + neutral + PE		3 phases + neutral + PE	
Voltage	230 Vac ± 10%		400 Vac ± 10%	
Frequency	50 or 60 Hz		50 or 60 Hz	
Input current	16 A	32 A	16 A	32 A
Input power	3,7 kVA	7,4 kVA	11 kVA	22 kVA
Nominal Output				
Voltage	230 Vac ± 10%		400 Vac ± 10%	
Current	16 A	32 A	16 A	32 A
Nominal power	3,7 kVA	7,4 kVA	11 kVA	22 kVA
Over current	20 A	40 A	20 A	40 A
RCD	30mA (Type A)		30 mA (Type B)	
General Specifications				
Equipment	Single or dual output equipment			
Mounting	Ground or wall mount			
Communication with EV	Pilot signal according to IEC61851			
AC plug (or socket)	IEC62196 Type-2 (others under request)			
Human machine interface	By default			
Display	Yes - Monochromatic (or color display optional)			
RFID system	Mifare (Classic, DesFire EV1)			
Communication	3G (GSM or CDMA) LAN Wi- Fi			
Communication protocols	OCPP (1.2; 1.5) and others			
Place of installation	Indoor/Outdoor			
Altitude	Up to 1000 m			
Protection degree	IP44 IK10			
Operating Temperature	-25 to +50 °C			
Optional Cold Option	-35 to +50 °C			
Storage temperature	-40 to +60 °C			
Humidity	30% to 90%			
Dimensions (W x D x H)	Wall-mount: 330x255x1080 Ground-mount: 330x255x1450			
Weight	20 to 30 kg			

Configurations

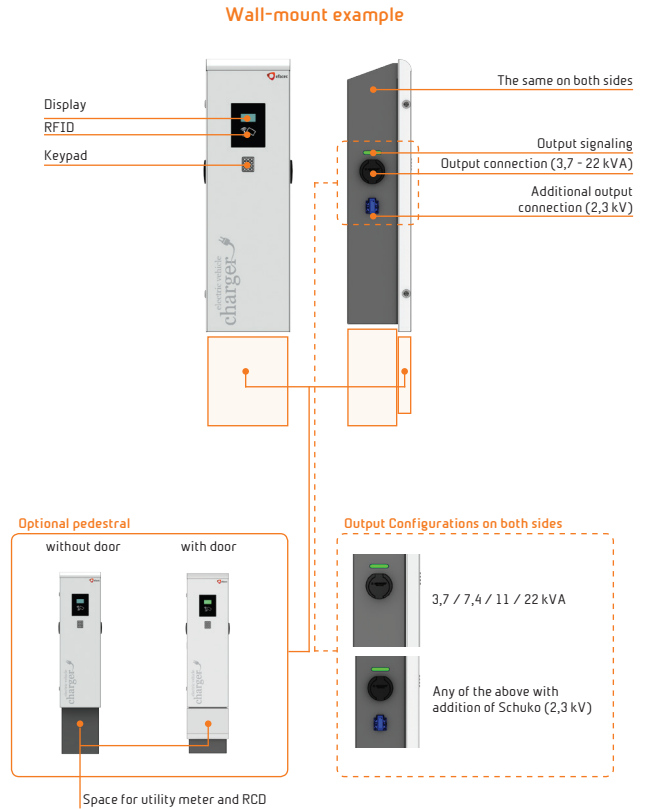

Master/Slave scheme

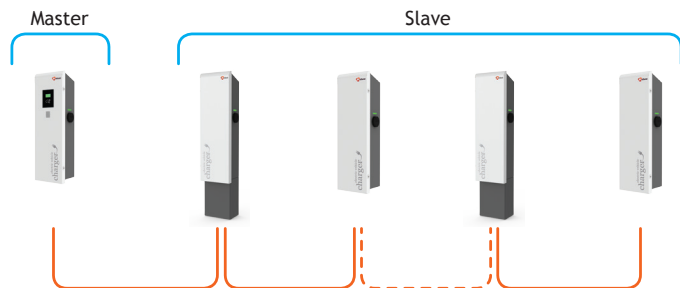

- Applications**
- Public parking
 - Supermarkets and shopping centers
 - Bus and railway stations
 - Restaurants
 - EV infrastructure operators
 - EV fleets (private and public)



Choose your color

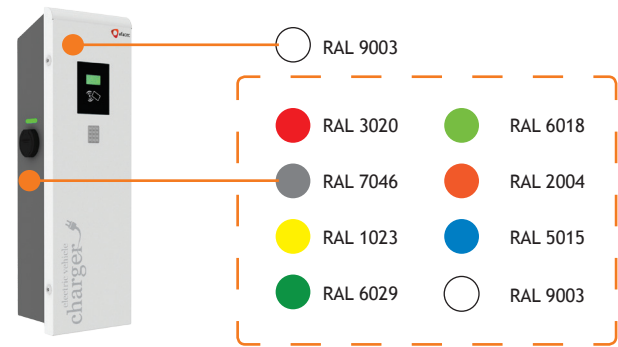

Main Office:
Rua Eng. Frederico Ulrich | Apartado 3078 | 4471-907 Moreira da Maia | Portugal | Phone: +351 229 402 000 | Fax: +351 229 403 209 | e-mail: efapower@efacec.com | web: www.efacec.com
Office:
2755 Northwoods Parkway | Norcross, Georgia 30071 USA | Phone: 770 446 8854 | Fax: 770 446 8920 | e-mail: usag@efacecusa.com

