

**OFFICIAL COPY**  
Public Service Commission  
Do Not Remove from this Office

**CLASS "C"**

**WATER AND/OR WASTEWATER UTILITIES**

(Gross Revenue of Less Than \$200,000 Each)

# ***ANNUAL REPORT***

OF

WU865-04-AR  
Gary A. Deremer  
Dixie Groves Utility Company a Division of Community Utili  
P. O. Box 398  
New Port Richey, FL 34656-0398

*Submitted To The*

***STATE OF FLORIDA***



***PUBLIC SERVICE COMMISSION***

FOR THE

**YEAR ENDED DECEMBER 31, 2004**

**J. S. BAILLIE, JR.**  
CERTIFIED PUBLIC ACCOUNTANT  
2153 GRAND BLVD.  
HOLIDAY, FL 34690  
(727) 937-6650

April 27, 2005

Board of Directors  
Dixie Groves Utility Company  
New Port Richey, Florida

We have compiled the comparative Balance Sheet as of December 31, 2003 and 2004 of Dixie Groves Utility Company and the related detail schedules and the Statement of Income and related detail schedules for the year ended December 31, 2004, included in the accompanying prescribed form in accordance with Statements on Standards for Accounting and Review Services issued by the American Institute of Certified Public Accountants.

Our compilation was limited to presenting in the form prescribed by the Florida Public Service Commission information that is the representation of the management of the company. We have not audited or reviewed the financial statements referred to above, and accordingly, do not express an opinion or any other form of assurance on them.

These financial statements including related disclosures are presented in accordance with the requirements of the Florida Public Service Commission, which differ from generally accepted accounting principles. Accordingly, these financial statements are not designed for those who are not informed about such differences.

Respectfully submitted,



J. S. Baillie, Jr.  
Certified Public Accountant

TABLE OF CONTENTS

| FINANCIAL SECTION  | PAGE |
|--|------|
| Identification   | F-2  |
| Income Statement   | F-3  |
| Balance Sheet  | F-4  |
| Net Utility Plant  | F-5  |
| Accumulated Depreciation and Amortization of Utility Plant           | F-5  |
| Capital Stock  | F-6  |
| Retained Earnings  | F-6  |
| Proprietary Capital  | F-6  |
| Long Term Debt   | F-6  |
| Taxes Accrued  | F-7  |
| Payment for Services Rendered by Other Than Employees                | F-7  |
| Contributions in Aid of Construction                                 | F-8  |
| Cost of Capital Used for AFUDC Calculation                           | F-9  |
| AFUDC Capital Structure Adjustments                                  | F-10 |
| WATER OPERATING SECTION  | PAGE |
| Water Utility Plant Accounts   | W-1  |
| Analysis of Accumulated Depreciation by Primary Account - Water      | W-2  |
| Water Operation and Maintenance Expense                              | W-3  |
| Water Customers  | W-3  |
| Pumping and Purchased Water Statistics and Mains                     | W-4  |
| Wells and Well Pumps, Reservoirs, and High Service Pumping           | W-5  |
| Sources of Supply and Water Treatment Facilities                     | W-6  |
| General Water System Information                                     | W-7  |
| WASTEWATER OPERATING SECTION   | PAGE |
| Wastewater Utility Plant Accounts                                    | S-1  |
| Analysis of Accumulated Depreciation by Primary Account - Wastewater | S-2  |
| Wastewater Operation and Maintenance Expense                         | S-3  |
| Wastewater Customers   | S-3  |
| Pumping Equipment, Collecting and Force Mains and Manholes           | S-4  |
| Treatment Plant, Pumps and Pumping Wastewater Statistics             | S-5  |
| General Wastewater System Information                                | S-6  |
| VERIFICATION SECTION   | PAGE |
| Verification   | V-1  |

# FINANCIAL SECTION

REPORT OF

DIXIE GROVES UTILITY COMPANY  
(EXACT NAME OF UTILITY)

|  |                        |
|--|------------------------|
| <u>P.O. BOX 398</u><br><u>NEW PORT RICHEY, FL 34652</u><br>Mailing Address | <u>PASCO</u><br>County |
|--|------------------------|

Telephone Number (727) 815-0737 Date Utility First Organized 7/11/1972

Fax Number (727) 848-7701 E-mail Address \_\_\_\_\_

Sunshine State One-Call of Florida, Inc. Member No. \_\_\_\_\_

Check the business entity of the utility as filed with the Internal Revenue Service:

Individual     Sub Chapter S Corporation     1120 Corporation     Partnership

Name, Address and phone where records are located: VICTORIA PENICK  
(727) 815-0737

Name of subdivisions where services are provided: DIXIE GROVES, KNOLLWOOD VILLAGE

CONTACTS:

| Name   | Title  | Principle Business Address | Salary Charged Utility |
|--|--|----------------------------|------------------------|
| Person to send correspondence:<br><u>GARY DEREMER</u>              | <u>PRESIDENT</u>                             | <u>SAME</u>                |                        |
| Person who prepared this report:<br><u>J. S. BAILLIE, JR., CPA</u> | <u>(SEE ACCOUNTANT'S COMPILATION REPORT)</u> |                            |                        |
| Officers and Managers:<br><u>GARY DEREMER</u>                      | <u>PRESIDENT</u>                             | <u>SAME</u>                | \$ 12,000              |
| <u>VICTORIA PENICK</u>   | <u>ADMIN. SERVICES</u>                       | <u>SAME</u>                | \$ -                   |
| _____  | <u>DIRECTOR</u>                              | _____                      | \$ _____               |
| _____  | _____  | _____                      | \$ _____               |
| _____  | _____  | _____                      | \$ _____               |

Report every corporation or person owning or holding directly or indirectly 5 percent or more of the voting securities of the reporting utility:

| Name  | Percent Ownership in Utility | Principle Business Address | Salary Charged Utility |
|---|------------------------------|----------------------------|------------------------|
| <u>COMMUNITY UTILITIES OF FLORIDA, INC.</u> | <u>100%</u>                  | <u>SAME</u>                | \$ -                   |
| _____                                       | _____                        | _____                      | \$ _____               |
| _____                                       | _____                        | _____                      | \$ _____               |
| _____                                       | _____                        | _____                      | \$ _____               |
| _____                                       | _____                        | _____                      | \$ _____               |
| _____                                       | _____                        | _____                      | \$ _____               |

UTILITY NAME: DIXIE GROVES UTILITY COMPANY

|                                     |
|-------------------------------------|
| YEAR OF REPORT<br>DECEMBER 31, 2004 |
|-------------------------------------|

INCOME STATEMENT

| Account Name                                      | Ref. Page  | Water       | Wastewater | Other      | Total Company |
|---|------------|-------------|------------|------------|---------------|
| Gross Revenue:                                    |            |             |            |            |               |
| Residential_____                                  |            | \$ 50,590   | \$ N/A     | \$ -       | \$ 50,590     |
| Commercial_____                                   |            | 597         |            |            | 597           |
| Industrial_____                                   |            |             |            |            |               |
| Multiple Family_____                              |            |             |            |            |               |
| Guaranteed Revenues_                              |            |             |            |            |               |
| Other (Specify)_____                              |            | 1,125       |            |            | 1,125         |
| Total Gross Revenue___                            |            | \$ 52,312   | N/A        | -          | 52,312        |
| Operation Expense (Must tie to pages W-3 and S-3) | W-3<br>S-3 | \$ 65,351   | \$         | \$         | \$ 65,351     |
| Depreciation Expense_____                         | F-5        | 4,346       |            |            | 4,346         |
| CIAC Amortization Expense_                        | F-8        | -           |            |            | -             |
| Taxes Other Than Income_                          | F-7        | 3,980       |            |            | 3,980         |
| Income Taxes_____                                 | F-7        |             |            |            |               |
| Total Operating Expense                           |            | \$ 73,677   | N/A        | -          | \$ 73,677     |
| Net Operating Income (Loss)                       |            | \$ (21,365) | \$ N/A     | \$ -       | \$ (21,365)   |
| Other Income:                                     |            |             |            |            |               |
| Nonutility Income_____                            |            | \$ -        | \$ N/A     | \$ (691)   | \$ (691)      |
| Other Deductions:                                 |            |             |            |            |               |
| Miscellaneous Nonutility Expenses_____            |            | \$          | \$         | \$         | \$            |
| Interest Expense_____                             |            |             |            |            |               |
| Amortization of Acquisition Adjustment            |            |             |            | 5,721      | 5,721         |
| Net Income (Loss)                                 |            | \$ (21,365) | \$ N/A     | \$ (6,412) | \$ (27,777)   |

UTILITY NAME: DIXIE GROVES UTILITY COMPANY

|                                     |
|-------------------------------------|
| YEAR OF REPORT<br>DECEMBER 31, 2004 |
|-------------------------------------|

COMPARATIVE BALANCE SHEET

| ACCOUNT NAME  | Reference Page | Current Year      | Previous Year     |
|---|----------------|-------------------|-------------------|
| <b>Assets:</b>  |                |                   |                   |
| Utility Plant in Service (101-105) -----                          | F-5,W-1,S-1    | \$ <u>130,551</u> | \$ <u>88,808</u>  |
| Accumulated Depreciation and Amortization (108)-----              | F-5,W-2,S-2    | <u>62,986</u>     | <u>58,640</u>     |
|   |                |                   |                   |
| Net Utility Plant -----   |                | \$ <u>67,565</u>  | \$ <u>30,168</u>  |
|   |                |                   |                   |
| Cash -----  |                | <u>3,487</u>      | <u>6,611</u>      |
| Customer Accounts Receivable (141)-----                           |                | <u>1</u>          | <u>5,716</u>      |
| Other Assets (Specify): -----                                     |                |                   |                   |
| Unamortized Acquisition Adjustment                                |                | <u>85,814</u>     | <u>85,814</u>     |
| Accumulated Amortization  |                | <u>(11,442)</u>   | <u>(5,721)</u>    |
|   |                |                   |                   |
|   |                |                   |                   |
| Total Assets -----  |                | \$ <u>145,425</u> | \$ <u>122,588</u> |
| <b>Liabilities and Capital:</b>                                   |                |                   |                   |
|   |                |                   |                   |
| Common Stock Issued (201)-----                                    | F-6            | <u>1,000</u>      | <u>1,000</u>      |
| Preferred Stock Issued (204)-----                                 | F-6            |                   |                   |
| Other Paid in Capital (211)-----                                  |                | <u>114,000</u>    | <u>114,000</u>    |
| Retained Earnings (215)-----                                      | F-6            | <u>(47,746)</u>   | <u>(19,969)</u>   |
| Proprietary Capital (Proprietary and partnership only) (218)----- | F-6            |                   |                   |
|   |                |                   |                   |
| Total Capital -----   |                | \$ <u>67,254</u>  | \$ <u>95,031</u>  |
|   |                |                   |                   |
| Long Term Debt (224)-----   | F-6            | \$ <u>70,599</u>  | \$ <u>20,464</u>  |
| Accounts Payable (231)-----                                       |                |                   |                   |
| Notes Payable (232)-----  |                |                   |                   |
| Customer Deposits (235)-----                                      |                | <u>5,218</u>      | <u>4,773</u>      |
| Accrued Taxes (236)-----  |                | <u>2,354</u>      | <u>2,320</u>      |
| Other Liabilities (Specify)-----                                  |                |                   |                   |
|   |                |                   |                   |
|   |                |                   |                   |
| Advances for Construction -----                                   |                |                   |                   |
| Contributions in Aid of Construction - Net (271-272)-----         | F-8            | <u>-</u>          | <u>-</u>          |
|   |                |                   |                   |
| Total Liabilities and Capital -----                               |                | \$ <u>145,425</u> | \$ <u>122,588</u> |

UTILITY NAME DIXIE GROVES UTILITY COMPANY

|                                     |
|-------------------------------------|
| YEAR OF REPORT<br>DECEMBER 31, 2004 |
|-------------------------------------|

GROSS UTILITY PLANT

| Plant Accounts:<br>(101 - 107) inclusive     | Water             | Wastewater    | Plant other<br>Than<br>Reporting<br>Systems | Total             |
|--|-------------------|---------------|---|-------------------|
| Utility Plant in Service (101)               | \$ <u>130,551</u> | \$ <u>N/A</u> | \$ <u>N/A</u>                               | \$ <u>130,551</u> |
| Construction Work in Progress<br>(105) _____ | _____             | _____         | _____                                       | _____             |
| Other (Specify) _____                        | _____             | _____         | _____                                       | _____             |
| _____  | _____             | _____         | _____                                       | _____             |
| _____  | _____             | _____         | _____                                       | _____             |
| Total Utility Plant _____                    | \$ <u>130,551</u> | \$ <u>N/A</u> | \$ <u>N/A</u>                               | \$ <u>130,551</u> |

ACCUMULATED DEPRECIATION (A/D) AND AMORTIZATION OF UTILITY PLANT

| Account 108                                       | Water            | Wastewater    | Other Than<br>Reporting<br>Systems | Total            |
|---|------------------|---------------|------------------------------------|------------------|
| Balance First of Year _____                       | \$ <u>58,640</u> | \$ <u>N/A</u> | \$ <u>N/A</u>                      | \$ <u>58,640</u> |
| <u>Add Credits During Year:</u>                   |                  |               |                                    |                  |
| Accruals charged to<br>depreciation account _____ | \$ <u>4,346</u>  | \$ _____      | \$ _____                           | \$ <u>4,346</u>  |
| Salvage _____                                     | _____            | _____         | _____                              | _____            |
| Other Credits (specify) _____                     | _____            | _____         | _____                              | _____            |
| _____   | _____            | _____         | _____                              | _____            |
| Total Credits _____                               | \$ <u>4,346</u>  | \$ <u>N/A</u> | \$ <u>N/A</u>                      | \$ <u>4,346</u>  |
| <u>Deduct Debits During Year:</u>                 |                  |               |                                    |                  |
| Book cost of plant<br>retired _____               | \$ _____         | \$ _____      | \$ _____                           | \$ _____         |
| Cost of removal _____                             | _____            | _____         | _____                              | _____            |
| Other debits (specify) _____                      | _____            | _____         | _____                              | _____            |
| _____   | _____            | _____         | _____                              | _____            |
| Total Debits _____                                | \$ <u>-</u>      | \$ <u>N/A</u> | \$ <u>N/A</u>                      | \$ <u>-</u>      |
| Balance End of Year _____                         | \$ <u>62,986</u> | \$ <u>N/A</u> | \$ <u>N/A</u>                      | \$ <u>62,986</u> |



UTILITY NAME: DIXIE GROVES UTILITY COMPANY

|                                     |
|-------------------------------------|
| YEAR OF REPORT<br>DECEMBER 31, 2004 |
|-------------------------------------|

CAPITAL STOCK ( 201 - 204 )

|   | Common<br>Stock | Preferred<br>Stock |
|---|-----------------|--------------------|
| Par or stated value per share _____         | 1               | N/A                |
| Shares authorized _____                     | 1000            | _____              |
| Shares issued and outstanding _____         | 1000            | _____              |
| Total par value of stock issued _____       | 1000            | _____              |
| Dividends declared per share for year _____ | 0               | _____              |

RETAINED EARNINGS ( 215 )

|                                    | Appropriated | Un-<br>Appropriated |
|------------------------------------|--------------|---------------------|
| Balance first of year _____        | \$ N/A       | \$ (19,969)         |
| Changes during the year (Specify): |              |                     |
| Net Loss for the Year _____        | _____        | (27,777)            |
| _____                              | _____        | _____               |
| _____                              | _____        | _____               |
| Balance end of year _____          | \$ N/A       | \$ (47,746)         |

PROPRIETARY CAPITAL ( 218 )

|                                    | Proprietor<br>Or Partner | Partner |
|------------------------------------|--------------------------|---------|
| Balance first of year _____        | \$ N/A                   | \$ N/A  |
| Changes during the year (Specify): |                          |         |
| _____                              | _____                    | _____   |
| _____                              | _____                    | _____   |
| Balance end of year _____          | \$ N/A                   | \$ N/A  |

LONG TERM DEBT ( 224 )

| Description of Obligation (Including Date of Issue<br>and Date of Maturity): | Interest |               | Principal<br>per Balance<br>Sheet Date |
|--|----------|---------------|--|
|  | Rate     | # of<br>Pymts |  |
| _____  | _____    | _____         | \$ _____                               |
| _____  | _____    | _____         | _____                                  |
| _____  | _____    | _____         | _____                                  |
| Total _____  | N/A      | _____         | \$ N/A                                 |

UTILITY NAME: DIXIE GROVES UTILITY COMPANY

|                                     |
|-------------------------------------|
| YEAR OF REPORT<br>DECEMBER 31, 2004 |
|-------------------------------------|

**TAX EXPENSE**

| (a)                             | Water<br>(b) | Wastewater<br>(c) | Other<br>(d) | Total<br>(e) |
|---------------------------------|--------------|-------------------|--------------|--------------|
| Income Taxes:                   |              |                   |              |              |
| Federal income tax _____        | \$ _____     | \$ _____          | \$ _____     | \$ _____     |
| State income Tax _____          | _____        | _____             | _____        | _____        |
| Taxes Other Than Income:        |              |                   |              |              |
| State ad valorem tax _____      | _____        | _____             | _____        | _____        |
| Local property tax _____        | 1,626        | _____             | _____        | 1,626        |
| Regulatory assessment fee _____ | 2,354        | _____             | _____        | 2,354        |
| Other (Specify) _____           | _____        | _____             | _____        | _____        |
| _____                           | _____        | _____             | _____        | _____        |
| _____                           | _____        | _____             | _____        | _____        |
| Total Tax Expense _____         | \$ 3,980     | \$ N/A            | \$ N/A       | \$ 3,980     |

**PAYMENTS FOR SERVICES RENDERED BY OTHER THAN EMPLOYEES**

Report all information concerning outside rate, management, construction, advertising, labor relations, public relations, or other similar professional services rendered the respondent for which aggregate payments during the year to any corporation, partnership, individual, or organization of any kind whatever amounting to \$500 or more.

| Name of Recipient | Water<br>Amount | Wastewater<br>Amount | Description of Service |
|-------------------|-----------------|----------------------|------------------------|
| U.S. WATER        | \$ 33,807       | \$ N/A               | PROFESSIONAL SERVICES  |
| U.S. WATER        | \$ 4,988        | \$ N/A               | TESTING                |
| U.S. WATER        | \$ 5,196        | \$ N/A               | OTHER                  |
| GARY DEREMER      | \$ 12,000       | \$ N/A               | MANAGEMENT FEES        |
| _____             | \$ _____        | \$ _____             | _____                  |
| _____             | \$ _____        | \$ _____             | _____                  |
| _____             | \$ _____        | \$ _____             | _____                  |
| _____             | \$ _____        | \$ _____             | _____                  |
| _____             | \$ _____        | \$ _____             | _____                  |
| _____             | \$ _____        | \$ _____             | _____                  |
| _____             | \$ _____        | \$ _____             | _____                  |
| _____             | \$ _____        | \$ _____             | _____                  |

**CONTRIBUTIONS IN AID OF CONSTRUCTION ( 271 )**

| (a)                                     | Water<br>(b)     | Wastewater<br>(c) | Total<br>(d)     |
|---|------------------|-------------------|------------------|
| 1) Balance first of year _____          | \$ <u>10,330</u> | \$ <u>N/A</u>     | \$ <u>10,330</u> |
| 2) Add credits during year _____        |                  |                   |                  |
| 3) Total _____                          | \$ <u>10,330</u> | \$ _____          | \$ <u>10,330</u> |
| 4) Deduct charges during the year _____ |                  |                   |                  |
| 5) Balance end of year _____            | <u>10,330</u>    |                   | <u>10,330</u>    |
| 6) Less Accumulated Amortization _____  | <u>10,330</u>    |                   | <u>10,330</u>    |
| 7) Net CIAC _____                       | \$ <u>-</u>      | \$ <u>N/A</u>     | \$ <u>-</u>      |

**ADDITIONS TO CONTRIBUTIONS IN AID OF CONSTRUCTION DURING YEAR (CREDITS)**

| Report below all developers or contractors agreements from which cash or property was received during the year.     | Indicate<br>"Cash" or<br>"Property" | Water                 | Wastewater    |
|---|-------------------------------------|-----------------------|---------------|
| _____   | _____                               | _____                 | _____         |
| _____   | _____                               | _____                 | _____         |
| _____   | _____                               | _____                 | _____         |
| _____   | _____                               | _____                 | _____         |
| _____   | _____                               | _____                 | _____         |
| _____   | _____                               | _____                 | _____         |
| Sub-total _____   |                                     | \$ <u>N/A</u>         | \$ <u>N/A</u> |
| Report below all capacity charges, main extension charges and customer connection charges received during the year. |                                     |                       |               |
| Description of Charge   | Number of Connections               | Charge per Connection |               |
| _____   | _____                               | \$ _____              | \$ _____      |
| _____   | _____                               | \$ _____              | \$ _____      |
| _____   | _____                               | \$ _____              | \$ _____      |
| _____   | _____                               | \$ _____              | \$ _____      |
| Total Credits During Year (Must agree with line # 2 above.) _____   |                                     |                       | \$ <u>N/A</u> |

**ACCUMULATED AMORTIZATION OF CIAC (272)**

|  | Water            | Wastewater    | Total            |
|--|------------------|---------------|------------------|
| Balance First of Year _____                          | \$ <u>10,330</u> | \$ <u>N/A</u> | \$ <u>10,330</u> |
| Add Debits During Year: _____                        |                  |               | -                |
| Deduct Credits During Year: _____                    |                  |               |                  |
| Balance End of Year (Must agree with line #6 above.) | \$ <u>10,330</u> | \$ <u>N/A</u> | \$ <u>10,330</u> |

**\*\* COMPLETION OF SCHEDULE REQUIRED ONLY IF AFUDC WAS CHARGED DURING YEAR \*\***

UTILITY NAME DIXIE GROVES UTILITY COMPANY

|                                     |
|-------------------------------------|
| YEAR OF REPORT<br>DECEMBER 31, 2004 |
|-------------------------------------|

**N/A  
SCHEDULE "A"**

**SCHEDULE OF COST OF CAPITAL USED FOR AFUDC CALCULATION (1)**

| Class of Capital<br>(a)     | Dollar<br>Amount<br>(b) | Percentage<br>of<br>Capital<br>(c) | Actual<br>Cost<br>Rates<br>(d) | Weighted<br>Cost<br>[ c x d ]<br>(e) |
|-----------------------------|-------------------------|------------------------------------|--------------------------------|--------------------------------------|
| Common Equity               | \$ <u>N/A</u>           | <u>          </u> %                | <u>          </u> %            | <u>N/A</u> %                         |
| Preferred Stock             | <u>          </u>       | <u>          </u> %                | <u>          </u> %            | <u>          </u> %                  |
| Long Term Debt              | <u>          </u>       | <u>          </u> %                | <u>          </u> %            | <u>          </u> %                  |
| Customer Deposits           | <u>          </u>       | <u>          </u> %                | <u>          </u> %            | <u>          </u> %                  |
| Tax Credits - Zero Cost     | <u>          </u>       | <u>          </u> %                | 0.00 %                         | <u>          </u> %                  |
| Tax Credits - Weighted Cost | <u>          </u>       | <u>          </u> %                | <u>          </u> %            | <u>          </u> %                  |
| Deferred Income Taxes       | <u>          </u>       | <u>          </u> %                | <u>          </u> %            | <u>          </u> %                  |
| Other (Explain)             | <u>          </u>       | <u>          </u> %                | <u>          </u> %            | <u>          </u> %                  |
| Total                       | \$ <u><u>N/A</u></u>    | <u><u>100.00</u></u> %             |                                | <u><u>N/A</u></u> %                  |

(1) Must be calculated using the same methodology used to calculate AFUDC rate approved by the Commission.

**APPROVED AFUDC RATE**

|   |                     |
|---|---------------------|
| Current Commission approved AFUDC rate:       | <u>          </u> % |
| Commission Order Number approving AFUDC rate: | <u>          </u>   |



WATER  
OPERATING  
SECTION

UTILITY NAME: DIXIE GROVES UTILITY COMPANY

|                                     |
|-------------------------------------|
| YEAR OF REPORT<br>DECEMBER 31, 2004 |
|-------------------------------------|

**WATER UTILITY PLANT ACCOUNTS**

| Acct. No. (a) | Account Name (b)                             | Previous Year (c) | Additions (d) | Retirements (e) | Current Year (f) |
|---------------|--|-------------------|---------------|-----------------|------------------|
| 301           | Organization_____                            | \$ _____          | \$ _____      | \$ _____        | \$ _____         |
| 302           | Franchises_____                              | _____             | _____         | _____           | _____            |
| 303           | Land and Land Rights_____                    | 1,211             | _____         | _____           | 1,211            |
| 304           | Structures and Improvements_____             | 3,811             | 5,068         | _____           | 8,879            |
| 305           | Collecting and Impounding Reservoirs_____    | _____             | _____         | _____           | _____            |
| 306           | Lake, River and Other Intakes_____           | _____             | _____         | _____           | _____            |
| 307           | Wells and Springs_____                       | 7,713             | 1,351         | _____           | 9,064            |
| 308           | Infiltration Galleries and Tunnels_____      | _____             | _____         | _____           | _____            |
| 309           | Supply Mains_____                            | _____             | _____         | _____           | -                |
| 310           | Power Generation Equipment_____              | _____             | _____         | _____           | _____            |
| 311           | Pumping Equipment_____                       | 13,469            | 3,880         | _____           | 17,349           |
| 320           | Water Treatment Equipment_____               | 2,770             | _____         | _____           | 2,770            |
| 330           | Distribution Reservoirs and Standpipes_____  | 11,709            | _____         | _____           | 11,709           |
| 331           | Transmission and Distribution Lines_____     | 16,299            | 30,266        | _____           | 46,565           |
| 333           | Services_____                                | _____             | _____         | _____           | _____            |
| 334           | Meters and Meter Installations_____          | 23,761            | 1,178         | _____           | 24,939           |
| 335           | Hydrants_____                                | 6,933             | _____         | _____           | 6,933            |
| 336           | Backflow Prevention Devices_____             | _____             | _____         | _____           | _____            |
| 339           | Other Plant and Miscellaneous Equipment_____ | _____             | _____         | _____           | -                |
| 340           | Office Furniture and Equipment_____          | 1,132             | _____         | _____           | 1,132            |
| 341           | Transportation Equipment_____                | _____             | _____         | _____           | _____            |
| 342           | Stores Equipment_____                        | _____             | _____         | _____           | _____            |
| 343           | Tools, Shop and Garage Equipment_____        | _____             | _____         | _____           | _____            |
| 344           | Laboratory Equipment_____                    | _____             | _____         | _____           | _____            |
| 345           | Power Operated Equipment_____                | _____             | _____         | _____           | _____            |
| 346           | Communication Equipment_____                 | _____             | _____         | _____           | _____            |
| 347           | Miscellaneous Equipment_____                 | _____             | _____         | _____           | _____            |
| 348           | Other Tangible Plant_____                    | _____             | _____         | _____           | -                |
|               | <b>Total Water Plant_____</b>                | <b>\$ 88,808</b>  | <b>41,743</b> | <b>-</b>        | <b>130,551</b>   |

UTILITY NAME: DIXIE GROVES UTILITY COMPANY

ANALYSIS OF ACCUMULATED DEPRECIATION BY PRIMARY ACCOUNT - WATER

| Acct. No. (a) | Account (b)                             | Average Service Life in Years (c) | Average Salvage in Percent (d) | Depr. Rate Applied (e) | Accumulated Depreciation Balance Previous Year (f) | Debits (g) | Credits (h) | Accum. Depr. Balance End of Year (f-g+h=i) (i) |
|---------------|---|-----------------------------------|--------------------------------|------------------------|--|------------|-------------|--|
| 304           | Structures and Improvements             | 28                                | %                              | 3.57 %                 | \$ 2,892   | \$         | \$ 226      | \$ 3,118                                       |
| 305           | Collecting and Impounding Reservoirs    |                                   | %                              |                        |  |            |             |  |
| 306           | Lake, River and Other Intakes           |                                   | %                              |                        |  |            |             |  |
| 307           | Wells and Springs                       | 33                                | %                              | 3.70 %                 | 6,524  |            | 310         | 6,834  |
| 308           | Infiltration Galleries & Tunnels        |                                   | %                              |                        |  |            |             |  |
| 309           | Supply Mains                            |                                   | %                              |                        |  |            |             |  |
| 310           | Power Generating Equipment              |                                   | %                              |                        |  |            |             |  |
| 311           | Pumping Equipment                       | 20                                | %                              | 5.88 %                 | 6,727  |            | 906         | 7,633  |
| 320           | Water Treatment Equipment               | 20                                | %                              | 5.88 %                 | 2,319  |            | 163         | 2,482  |
| 330           | Distribution Reservoirs & Standpipes    | 28                                | %                              | 3.03 %                 | 6,092  |            | 355         | 6,447  |
| 331           | Trans. & Dist. Mains                    | 28                                | %                              | 2.63 %                 | 14,058   |            | 827         | 14,885   |
| 333           | Services                                |                                   | %                              |                        |  |            |             |  |
| 334           | Meter & Meter Installations             | 10                                | %                              | 5.88 %                 | 14,822   |            | 1,432       | 16,254   |
| 335           | Hydrants                                | 40                                | %                              | 2.50 %                 | 4,028  |            | 173         | 4,201  |
| 336           | Backflow Prevention Devices             |                                   | %                              |                        |  |            |             |  |
| 339           | Other Plant and Miscellaneous Equipment |                                   | %                              |                        |  |            |             |  |
| 340           | Office Furniture and Equipment          | 10                                | %                              | 16.67 %                | 1,178  |            | (46)        | 1,132  |
| 341           | Transportation Equipment                |                                   | %                              |                        |  |            |             |  |
| 342           | Stores Equipment                        |                                   | %                              |                        |  |            |             |  |
| 343           | Tools, Shop and Garage Equipment        |                                   | %                              |                        |  |            |             |  |
| 344           | Laboratory Equipment                    |                                   | %                              |                        |  |            |             |  |
| 345           | Power Operated Equipment                |                                   | %                              |                        |  |            |             |  |
| 346           | Communication Equipment                 |                                   | %                              |                        |  |            |             |  |
| 347           | Miscellaneous Equipment                 |                                   | %                              |                        |  |            |             |  |
| 348           | Other Tangible Plant                    |                                   | %                              |                        |  |            |             |  |
|               | Totals                                  |                                   |                                |                        | \$ 58,640  | \$ -       | 4,346       | 62,986 *                                       |

\* This amount should tie to Sheet F-5.



**WATER OPERATION AND MAINTENANCE EXPENSE**

| Acct. No. | Account Name  | Amount             |
|-----------|---|--------------------|
| 601       | Salaries and Wages - Employees                                      | \$ _____           |
| 603       | Salaries and Wages - Officers, Directors, and Majority Stockholders | <u>12,000</u>      |
| 604       | Employee Pensions and Benefits                                      | _____              |
| 610       | Purchased Water   | _____              |
| 615       | Purchased Power   | <u>1,627</u>       |
| 616       | Fuel for Power Production   | _____              |
| 618       | Chemicals   | <u>2,704</u>       |
| 620       | Materials and Supplies  | <u>1,336</u>       |
| 630       | Contractual Services:   |                    |
|           | Billing   | _____              |
|           | Professional  | <u>33,807</u>      |
|           | Testing   | <u>4,988</u>       |
|           | Other   | <u>5,196</u>       |
| 640       | Rents   | _____              |
| 650       | Transportation Expense  | _____              |
| 655       | Insurance Expense   | <u>724</u>         |
| 665       | Regulatory Commission Expenses (Amortized Rate Case Expense)        | _____              |
| 670       | Bad Debt Expense  | <u>108</u>         |
| 675       | Miscellaneous Expenses  | <u>2,861</u>       |
|           | Total Water Operation And Maintenance Expense                       | \$ <u>65,351</u> * |

\* This amount should tie to Sheet F-3.

**WATER CUSTOMERS**

| Description<br>(a)                                 | Type of Meter **<br>(b) | Equivalent Factor<br>(c) | Number of Active Customers |                    | Total Number of Meter Equivalents<br>(c x e)<br>(f) |
|--|-------------------------|--------------------------|----------------------------|--------------------|---|
|  |                         |                          | Start of Year<br>(d)       | End of Year<br>(e) |   |
| <b>Residential Service</b>                         |                         |                          |                            |                    |   |
| 5/8"   | D                       | 1.0                      | <u>336</u>                 | <u>336</u>         | <u>336</u>  |
| 3/4"   | D                       | 1.5                      | <u>1</u>                   | <u>1</u>           | <u>1.5</u>  |
| 1"   | D                       | 2.5                      | _____                      | _____              | _____   |
| 1 1/2"   | D,T                     | 5.0                      | _____                      | _____              | _____   |
| <b>General Service</b>                             |                         |                          |                            |                    |   |
| 5/8"   | D                       | 1.0                      | _____                      | _____              | _____   |
| 3/4"   | D                       | 1.5                      | _____                      | _____              | _____   |
| 1"   | D                       | 2.5                      | _____                      | _____              | _____   |
| 1 1/2"   | D,T                     | 5.0                      | _____                      | _____              | _____   |
| 2"   | D,C,T                   | 8.0                      | _____                      | _____              | _____   |
| 3"   | D                       | 15.0                     | _____                      | _____              | _____   |
| 3"   | C                       | 16.0                     | _____                      | _____              | _____   |
| 3"   | T                       | 17.5                     | _____                      | _____              | _____   |
| Unmetered Customers                                | _____                   | _____                    | _____                      | _____              | _____   |
| Other (Specify)                                    | _____                   | _____                    | _____                      | _____              | _____   |
| ** D = Displacement<br>C = Compound<br>T = Turbine |                         |                          | <b>Total</b>               | <u>337</u>         | <u>337</u>  |
|  |                         |                          |                            | <u>337</u>         | <u>337.5</u>  |

UTILITY NAME: DIXIE GROVES UTILITY COMPANY

|                                     |
|-------------------------------------|
| YEAR OF REPORT<br>DECEMBER 31, 2004 |
|-------------------------------------|

SYSTEM NAME: \_\_\_\_\_

**PUMPING AND PURCHASED WATER STATISTICS**

| (a)                  | (b)                                     | (c)                                    | (d)   | (e)   | (f)                                  |
|----------------------|---|--|---|---|--------------------------------------|
|                      | Water Purchased For Resale (Omit 000's) | Finished Water From Wells (Omit 000's) | Recorded Accounted For Loss Through Line Flushing Etc. (Omit 000's) | Total Water Pumped And Purchased (Omit 000's) [ (b)+(c)-(d) ] | Water Sold To Customers (Omit 000's) |
| January_-----        | 0                                       | 1,633                                  | 1% 0  | 1,633   | 868                                  |
| February_-----       | 0                                       | 1,552                                  | " 0   | 1,552   | 922                                  |
| March_-----          | 0                                       | 1,548                                  | " 0   | 1,548   | 1,099                                |
| April_-----          | 0                                       | 1,615                                  | " 0   | 1,615   | 1,281                                |
| May_-----            | 0                                       | 1,527                                  | " 0   | 1,527   | 1,024                                |
| June_-----           | 0                                       | 1,405                                  | " 0   | 1,405   | 1,162                                |
| July_-----           | 0                                       | 1,365                                  | " 0   | 1,365   | 994                                  |
| August_-----         | 0                                       | 1,351                                  | " 0   | 1,351   | 1,228                                |
| September_-----      | 0                                       | 1,123                                  | " 0   | 1,123   | 882                                  |
| October_-----        | 0                                       | 1,127                                  | " 0   | 1,127   | 1,084                                |
| November_-----       | 0                                       | 1,150                                  | " 0   | 1,150   | 1,159                                |
| December_-----       | 0                                       | 1,250                                  | " 0   | 1,250   | 1,070                                |
| Total for Year_----- | 0                                       | 16,646                                 | 1% 0  | 16,483<br>16,646  | 12,773                               |

If water is purchased for resale, indicate the following:  
 Vendor NA  
 Point of delivery \_\_\_\_\_

If water is sold to other water utilities for redistribution, list names of such utilities below:  
 \_\_\_\_\_  
 \_\_\_\_\_  
 \_\_\_\_\_

**MAINS (FEET)**

| Kind of Pipe (PVC, Cast Iron, Coated Steel, etc.) | Diameter of Pipe | First of Year | Added | Removed or Abandoned | End of Year |
|---|------------------|---------------|-------|----------------------|-------------|
| AC  | 4"               | 3,170         | 0     | 0                    | 3,170       |
| GALVANIZED  | 3"               | 210           | 0     | 0                    | 210         |
| GALVANIZED  | 2"               | 7,940         | 0     | 0                    | 7,940       |
| _____   | _____            | _____         | _____ | _____                | _____       |
| _____   | _____            | _____         | _____ | _____                | _____       |
| _____   | _____            | _____         | _____ | _____                | _____       |
| _____   | _____            | _____         | _____ | _____                | _____       |
| _____   | _____            | _____         | _____ | _____                | _____       |
| _____   | _____            | _____         | _____ | _____                | _____       |
| _____   | _____            | _____         | _____ | _____                | _____       |

UTILITY NAME: DIXIE GROVES UTILITY COMPANY

|                                     |
|-------------------------------------|
| YEAR OF REPORT<br>DECEMBER 31, 2004 |
|-------------------------------------|

SYSTEM NAME: \_\_\_\_\_

**WELLS AND WELL PUMPS**

| (a)   | (b)          | (c)                | (d)                | (e)   |
|---|--------------|--------------------|--------------------|-------|
| Year Constructed _____                      | <u>1957</u>  | <u>1960</u>        | <u>1965</u>        | _____ |
| Types of Well Construction and Casing _____ | <u>STEEL</u> | <u>STEEL</u>       | <u>STEEL</u>       | _____ |
| Depth of Wells _____                        | <u>56'</u>   | <u>65'</u>         | <u>71'</u>         | _____ |
| Diameters of Wells _____                    | <u>4"</u>    | <u>6"</u>          | <u>4"</u>          | _____ |
| Pump - GPM _____                            | <u>NONE</u>  | <u>150</u>         | <u>50</u>          | _____ |
| Motor - HP _____                            | <u>NONE</u>  | <u>7.5</u>         | <u>3</u>           | _____ |
| Motor Type * _____                          | <u>NONE</u>  | <u>SUBMERSIBLE</u> | <u>SUBMERSIBLE</u> | _____ |
| Yields of Wells in GPD _____                | <u>NONE</u>  | <u>216,000</u>     | <u>72,000</u>      | _____ |
| Auxiliary Power _____                       | <u>NONE</u>  | <u>NONE</u>        | <u>NONE</u>        | _____ |

\* Submersible, centrifugal, etc.

**RESERVOIRS**

| (a)                                 | (b)         | (c)                   | (d)                   | (e)   |
|-------------------------------------|-------------|-----------------------|-----------------------|-------|
| Description (steel, concrete) _____ | <u>NONE</u> | <u>HYDROPNEUMATIC</u> | <u>HYDROPNEUMATIC</u> | _____ |
| Capacity of Tank _____              | <u>NONE</u> | <u>1000 GAL</u>       | <u>4000 GAL</u>       | _____ |
| Ground or Elevated _____            | <u>NONE</u> | <u>GROUND</u>         | <u>GROUND</u>         | _____ |

**HIGH SERVICE PUMPING**

| (a)  | (b)        | (c)        | (d)        | (e)   |
|--|------------|------------|------------|-------|
| <b>Motors</b>                                  |            |            |            |       |
| Manufacturer _____                             | <u>N/A</u> | <u>N/A</u> | <u>N/A</u> | _____ |
| Type _____                                     | _____      | _____      | _____      | _____ |
| Rated Horsepower _____                         | _____      | _____      | _____      | _____ |
| <b>Pumps</b>                                   |            |            |            |       |
| Manufacturer _____                             | <u>N/A</u> | <u>N/A</u> | <u>N/A</u> | _____ |
| Type _____                                     | _____      | _____      | _____      | _____ |
| Capacity in GPM _____                          | _____      | _____      | _____      | _____ |
| Average Number of Hours Operated Per Day _____ | _____      | _____      | _____      | _____ |
| Auxiliary Power _____                          | _____      | _____      | _____      | _____ |

UTILITY NAME: DIXIE GROVES UTILITY COMPANY

|                                     |
|-------------------------------------|
| YEAR OF REPORT<br>DECEMBER 31, 2004 |
|-------------------------------------|

**SOURCE OF SUPPLY**

| List for each source of supply ( Ground, Surface, Purchased Water etc. ) |                         |       |       |
|--|-------------------------|-------|-------|
| Permitted Gals. per day ___  | 75,000 AVG 150,000 PEAK | _____ | _____ |
| Type of Source _____   | 2 WELLS                 | _____ | _____ |

**WATER TREATMENT FACILITIES**

| List for each Water Treatment Facility: |                         |                         |       |
|---|-------------------------|-------------------------|-------|
| Type _____                              | PRIMARY TREATMENT       | PRIMARY TREATMENT       | _____ |
| Make _____                              | DISINFECT/STABILIZATION | DISINFECT/STABILIZATION | _____ |
| Permitted Capacity (GPD) ___            | 75,000                  | 75,000                  | _____ |
| High service pumping                    | NONE                    | NONE                    | _____ |
| Gallons per minute _____                | NONE                    | NONE                    | _____ |
| Reverse Osmosis _____                   | NONE                    | NONE                    | _____ |
| Lime Treatment                          |                         |                         |       |
| Unit Rating _____                       | NONE                    | NONE                    | _____ |
| Filtration                              |                         |                         |       |
| Pressure Sq. Ft. _____                  | NONE                    | NONE                    | _____ |
| Gravity GPD/Sq.Ft. _____                | NONE                    | NONE                    | _____ |
| Disinfection                            |                         |                         |       |
| Chlorinator _____                       | STENNER (LIQUID)        | STENNER (LIQUID)        | _____ |
| Ozone _____                             | N/A                     | N/A                     | _____ |
| Other _____                             | N/A                     | N/A                     | _____ |
| Auxiliary Power _____                   | NONE                    | NONE                    | _____ |

UTILITY NAME: DIXIE GROVES UTILITY COMPANY

YEAR OF REPORT  
DECEMBER 31, 2004

SYSTEM NAME: \_\_\_\_\_

### GENERAL WATER SYSTEM INFORMATION

Furnish information below for each system. A separate page should be supplied where necessary.

1. Present ERC's \* the system can efficiently serve. 100
2. Maximum number of ERCs\* which can be served. 100
3. Present system connection capacity (in ERCs \*) using existing lines. 100
4. Future connection capacity (in ERCs \*) upon service area buildout. 0
5. Estimated annual increase in ERCs \*. 0
6. Is the utility required to have fire flow capacity? NO  
If so, how much capacity is required? N/A
7. Attach a description of the fire fighting facilities.
8. Describe any plans and estimated completion dates for any enlargements or improvements of this system.  
CURRENTLY UNDER CONSTRUCTION/REPLACEMENT. SEE ENGINEERING REPORT.
9. When did the company last file a capacity analysis report with the DEP? UNKNOWN
10. If the present system does not meet the requirements of DEP rules, submit the following:
  - a. Attach a description of the plant upgrade necessary to meet the DEP rules. SEE ENGINEERING REPORT
  - b. Have these plans been approved by DEP? NO
  - c. When will construction begin? UNDER CONSTRUCTION CURRENTLY
  - d. Attach plans for funding the required upgrading. SEE ENGINEERING REPORT
  - e. Is this system under any Consent Order with DEP? NO
11. Department of Environmental Protection ID # 6510461
12. Water Management District Consumptive Use Permit # 20007718.002
  - a. Is the system in compliance with the requirements of the CUP? NO
  - b. If not, what are the utility's plans to gain compliance? SEE ENGINEERING REPORT

- \* An ERC is determined based on one of the following methods:
- (a) If actual flow data are available from the preceding 12 months:  
Divide the total annual single family residence (SFR) gallons sold by the average number of single family residents (SFR) gallons sold by the average number of single family residence customers for the same period and divide the result by 365 days.
  - (b) If no historical flow data are available use:  
ERC = (Total SFR gallons sold (omit 000/365 days/350 gallons per day).

# WASTEWATER OPERATING SECTION

N/A  
WATER UTILITY ONLY

UTILITY NAME: DIXIE GROVES UTILITY COMPANY

YEAR OF REPORT  
DECEMBER 31, 2004

# CERTIFICATION OF ANNUAL REPORT

I HEREBY CERTIFY, to the best of my knowledge and belief:

- |  |                                |    |  |
|--|--------------------------------|----|--|
| YES<br><input checked="" type="checkbox"/> | NO<br><input type="checkbox"/> | 1. | The utility is in substantial compliance with the Uniform System of Accounts prescribed by the Florida Public Service Commission in Rule 25-30.115 (1), Florida Administrative Code.   |
| YES<br><input checked="" type="checkbox"/> | NO<br><input type="checkbox"/> | 2. | The utility is in substantial compliance with all applicable rules and orders of the Florida Public Service Commission.  |
| YES<br><input checked="" type="checkbox"/> | NO<br><input type="checkbox"/> | 3. | There have been no communications from regulatory agencies concerning noncompliance with, or deficiencies in, financial reporting practices that could have a material effect on the financial statement of the utility.   |
| YES<br><input checked="" type="checkbox"/> | NO<br><input type="checkbox"/> | 4. | The annual report fairly represents the financial condition and results of operations of the respondent for the period presented and other information and statements presented in the report as to the business affairs of the respondent are true, correct, and complete for the period for which it represents. |

**Items Certified**

1.  2.  3.  4.

\_\_\_\_\_  
(signature of chief executive officer of the utility) \*

Date: \_\_\_\_\_

1.  2.  3.  4.

\_\_\_\_\_  
(signature of chief financial officer of the utility) \*

Date: \_\_\_\_\_

\* Each of the four items must be certified YES or NO. Each item need not be certified by both officers. The items being certified by the officer should be indicated in the appropriate area to the left of the signature.

Notice: Section 837.06, Florida Statutes, provides that any person who knowingly makes a false statement in writing with the intent to mislead a public servant in the performance of his duty shall be guilty of a misdemeanor of the second degree.

*Reconciliation of Revenue to  
Regulatory Assessment Fee Revenue  
Water Operations  
Class C*

**Company:** DIXIE GROVES UTILITY COMPANY

**For the Year Ended December 31, 2004**

| (a)  | (b)                               | (c)                                 | (d)                  |
|--|-----------------------------------|-------------------------------------|----------------------|
| Accounts   | Gross Water Revenues Per Sch. F-3 | Gross Water Revenues Per RAF Return | Difference (b) - (c) |
| Gross Revenue:   |                                   |                                     |                      |
| Residential  | \$ 50,590                         | \$ 50,590                           | \$ 0                 |
| Commercial   | 597                               | 597                                 | 0                    |
| Industrial   |                                   |                                     |                      |
| Multiple Family  |                                   |                                     |                      |
| Guaranteed Revenues  |                                   |                                     |                      |
| Other  | 1,125                             | 1,125                               | 0                    |
| <b>Total Water Operating Revenue</b>                                 | <b>\$ 52,312</b>                  | <b>\$ 52,312</b>                    | <b>\$ 0</b>          |
| <b>LESS: Expense for Purchased Water from FPSC-Regulated Utility</b> |                                   |                                     |                      |
| <b>Net Water Operating Revenues</b>                                  | <b>\$ 52,312</b>                  | <b>\$ 52,312</b>                    | <b>\$ 0</b>          |

Explanations:

**Instructions:**

For the current year, reconcile the gross water revenues reported on Schedule F-3 with the gross water revenues reported on the company's regulatory assessment fee return. Explain any differences reported in column (d).



# **WATER DISTRIBUTION SYSTEM EVALUATION**

---

## **Engineering Services**

**DIXIE GROVES UTILITY COMPANY  
PASCO COUNTY, FLORIDA**

**PROJECT I.D. NO. 1004-20.01**

Prepared by  
U.S. Water Services Corporation  
4939 Cross Bayou Boulevard  
New Port Richey, Florida 34652

**U.S. Water**  
Services Corporation

**For**

**Dixie Groves Utility Company  
4821 U.S. Highway 19, Suite 2  
New Port Richey, Florida 34652**

**(Revised)  
March 9, 2005**

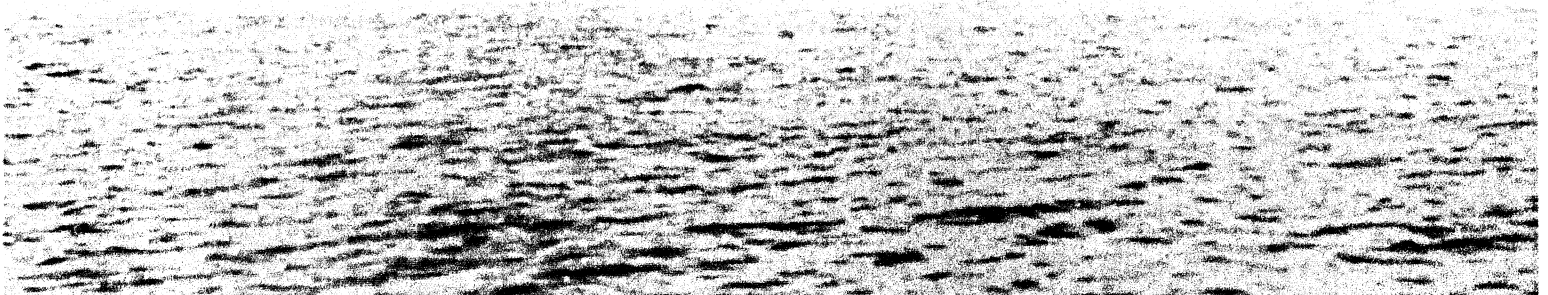

## TABLE OF CONTENTS

|  | Page No. |
|--|----------|
| 1.0 INTRODUCTION   | 1        |
| 1.1 Purpose  | 1        |
| 1.2 Background   | 1        |
| 1.3 Water Use Caution Areas                                    | 2        |
| 2.0 EXISTING WATER SUPPLY                                      | 3        |
| 2.1 Water Supply   | 3        |
| 2.2 Production Wells   | 4        |
| 3.0 WATER DISTRIBUTION SYSTEM EVALUATION                       | 4        |
| 3.1 Permitting and Compliance Background                       | 4        |
| 3.2 Current Water Distribution System Conditions               | 6        |
| 3.3 Unaccounted-for Water                                      | 7        |
| 4.0 CURRENT AND PROJECTED WATER DEMAND                         | 7        |
| 4.1 Water Conservation Policy                                  | 8        |
| 5.0 WATER DISTRIBUTION REPLACEMENT OPTIONS WITH COST ESTIMATES | 9        |
| 6.0 ROAD RESURFACING   | 10       |
| 7.0 SUMMARY AND RECOMMENDATIONS                                | 12       |
| Appendix A (Site Location Maps)                                |          |
| Appendix B (Boundaries of Water Use Caution Areas)             |          |
| Appendix C (Summary of Monthly Flow Data)                      |          |
| Appendix D (Water Use Permit)                                  |          |
| Appendix E (Engineer's Cost Estimate)                          |          |
| Appendix F (Preliminary Engineering Plans and Details)         |          |

## **1.0 INTRODUCTION**

### **1.1 Purpose**

The purpose of this report is to present an evaluation of the water distribution system at Dixie Groves Utility Company along with recommendations for remedial measures with engineering cost estimates for implementation of two corrective action alternatives.

### **1.2 Background**

Dixie Groves Utility Company is a privately-owned utility located in western Pasco County, Florida. The limits of the service area and the lots that are included within the boundary are depicted on the attached Figures under Appendices A and F. It is located in Section 32 of Township 26 and Range 16 within the boundaries of Northern Tampa Bay Water Use Caution Area (WUCA). The boundaries of the water use caution areas are depicted on the figure under Appendix B.

The potable water service area for Dixie Groves Utility covers an area of approximately 42 acres. A total of 411 lots comprised the original system service area. The present customer service area includes 338 customers. This is due to the fact that several of the smaller residential parcels have been combined under common ownership while other parcels have been combined as light commercial and professional office spaces. A summary of the users, based on land use type, is given below.

**Table 1-1**  
**Summary of Water Users**

| <b>LAND USE</b>   | <b>NUMBER OF UNITS</b> |
|---|------------------------|
| Single Family Residential                                     | 219                    |
| Single Family Seasonal/Retirement Residential                 | 110                    |
| Light Commercial (Strip Centers, Churches, Restaurants, etc.) | 6                      |
| Professional Offices (Doctors, Dentists, etc.)                | 3                      |
| <b>TOTAL:</b>   | <b>338</b>             |

Most of the existing single family residential and mobile homes are older units dating back to the mid 1950's. The current demographics within the limits of the Dixie Groves' service area include a mixture of retirees, seasonal residents, and younger family groups. A limited number of multi-family structures, professional office spaces and light commercial properties also exist along the south side of Mile Stretch Drive. Based on the past twenty three (23)-month period of record ending January 2005, the average daily water usage is approximately 34,000 gpd. The monthly water demand and withdrawal records are summarized in a tabular format under Appendix C. It is clear from the general trends of the data that the monthly amounts of unaccounted-for water continue to decrease while corrective actions to the water distribution system are implemented.

### **1.3 Water Use Caution Area**

Dixie Groves Utility Company is also located within the boundaries of the Northern Tampa Bay Water Use Caution Area (WUCA) as indicated in the figure under Appendix B. Water Use Caution Areas are defined by State law and Chapter 40D-2, F.A.C., as areas where water resources are, or expected to, become critical within the next twenty years. The Northern Tampa Bay WUCA is one

of several water use caution areas within the jurisdictions of the Southwest Florida Water Management District (SWFWMD). These areas have been declared as necessary to address cumulative water withdrawals which are causing or may cause adverse impacts to water resources, land resources or the public interest.

## **2.0 EXISTING WATER SUPPLY**

### **2.1 Water Supply**

Dixie Groves Utility Company currently has a wellfield with two production wells known as Well #2 and Well #3. The locations of the wells are shown on the attached plans under Appendix G, which also depicts the layout of the existing water distribution system. The SWFWMD regulates the total allotted withdrawal quantity from the wellfield under SWFWMD Water Use Permit No. 20007718. A copy of the permit is attached under Appendix D. The water use permit allows a peak monthly daily withdrawal of 150,000 gallons per day from the wellfield with an annual average daily withdrawal of 75,000 gallons per day.

Special Condition No. 3 of the SWFWMD Water Use Permit requires the permittee to implement the approved water conservation plan in order to reduce the percentage of the unaccounted-for water through the water distribution system to acceptable levels below 12%. The condition also requires submission of progress reports to the SWFWMD concerning the implementation of the plan.

Dixie Groves wellfield is located near the Gulf Coast in western Pasco County. This location is coincident with the thinner portions of the potable zone underlying peninsular Florida. The potable water zone in this area consists of a thin lens of fresh water that is underlain by denser saline water. As fresh water is withdrawn from this zone, the saltwater interface rises at a greater percent than the potable water drawdown due to the density difference between the two aqueous layers. This action may cause degradation of the potable aquifer water quality because of increasing mineral concentrations within the raw water supply.

## **2.2 Production Wells**

The main production well for Dixie Groves Utility Company is Well #2. Well #3 is considered as a standby well. Each well is permitted for a total withdrawal quantities of 75,000 gpd (annual average) and 150,000 gpd (peak monthly). However, the total withdrawal from the wellfield is limited to 75,000 gpd (annual average) and 150,000 gpd (peak monthly) by the SWFWMD Water Use Permit.

### Well No. 2

This well has a diameter of 6 inches with a total depth of 65 feet and cased to 47 feet. The SWFWMD water use permit allows a peak monthly and annual average withdrawals of 150,000 gpd and 75,000 gpd, respectively.

### Well No. 3 (Standby)

This well has a diameter of 4 inches with a total depth of 72 feet and cased to 42 feet. The SWFWMD water use permit allows a peak monthly and annual average withdrawals of 150,000 gpd and 75,000 gpd, respectively.

## **3.0 WATER DISTRIBUTION SYSTEM EVALUATION**

### **3.1 Permitting and Compliance Background**

A notice of non-compliance was generated by the SWFWMD on February 8, 2001, as a result of apparent discrepancies between the permitted daily average withdrawal amounts and the actual withdrawals reported to the District. As a result, the District requested a complete evaluation of

these discrepancies and the water distribution system followed by remedial measures to reduce pumpage rates to acceptable levels below the maximum allowable permitted limits.

Consequently, an assessment of the water distribution system was performed by the operating company at that time to determine the cause(s) of water losses through the water distribution system and recommend certain corrective actions to remedy the problem. The initial tests of the water distribution system revealed that significant amounts of water had been lost between the meters at the wells and the meters at the individual service connections. Also, pumpage data from the wells as compared to the amounts sold to the customers, indicated that large and variable amounts of water are not accounted for between the well meters and the individual meters.

Following these results, the former operating company assessed the site on March 3, 2001, and determined that numerous small leaks existed at a significant percentage of service connections. A random check of approximately 50 individual service connections was performed. Of the number of meters checked, approximately 30 percent of the meters indicated small to significant leaks between the distribution line and the service connection meter. Most leaks were observed to be at the cutoff valves between the meters and the distribution line and also as a result of minor leaks associated with the fittings and couplings in the meter box.

The original evaluation also revealed that 33 water meters recorded zero usage during a 12-month period indicating that they were not functioning. In addition, 42 meters had recorded greater than 700,000 gallons of total accumulated flow. The useful life of a residential water meter is considered to be 1,000,000 gallons. Following these findings, based on recommendations by the operating company, the following remedial measures were implemented:

- All residential water meters recording zero flow were replaced.
- All residential water meters that had total accumulated readings of 900,000 gallons or greater were replaced.
- A program was initiated to inspect and repair all leaks at water meters on a regular basis.

Following completion of the above system improvements, Dixie Groves requested a modification to the water use permit to increase the annual average withdrawal limit from 39,000 to 75,000 gpd. The request was approved by the SWFWMD and, accordingly, a permit modification was issued on February 14, 2002.

### **3.2 Current Water Distribution System Conditions**

As mentioned above, the water distribution system at Dixie Groves Utility Company was built in the 1950's along with the two water supply wells. The water distribution system consists of a combination of both 4-inch asbestos cement piping and 2-inch galvanized iron piping. Over the past fifty years, this piping has deteriorated significantly and is currently in a poor condition. See attached site plan under Appendix F for more details about the layout of the existing piping.

Asbestos cement piping was commonly used in water distribution systems built before 1980. However, its use in water distribution systems was discontinued following the enactment of legislation by the U.S. Congress in 1984 to control asbestos hazards in building materials, and following the USEPA proposed nationwide standard for asbestos in drinking water.

The condition of the piping at Dixie Groves, based on our most recent inspections, is considered very poor. The 2-inch galvanized iron piping has deteriorated substantially and contains significant number of cracks and leaks throughout the distribution system. The high degree of corrosion in the piping has also resulted in significantly reducing the inside diameter of the piping due to the deposition and accumulation of iron oxides on the inside surfaces of the pipes. Also, the walls of the existing hydropneumatic tanks (pressure tanks) for Well #2 and Well #3 are highly corroded with obvious water leaks through the external surfaces of the walls.



### **3.3 Unaccounted-for Water**

Historical water quantity withdrawal data from the two wells has shown an increasing trend of water loss through the water distribution system with an average of 40%. See the attached table and graph under Appendix C. However, following the most recent repairs to the system over the past several months, the water losses have dropped to acceptable levels.

Public water supply utilities that are located in Water Use Caution Areas are required by the SWFWMD to perform periodic water audits to ascertain that the total amount of the unaccounted-for water does not exceed 12% of the total withdrawal amounts. Water Auditing is performed in accordance with the guidelines given in the American Water Works Association's (AWWA) Manual #36, entitled Water Audits and Leak Detection.

Based on the most recent well withdrawal flow data and the total amounts of water sold, the average of the total amount of water that is unaccounted-for through the water distribution system over the past six (6) months is about 11%. This amount continues to decrease as shown by the trends on the figure under Appendix C. This percentage is considered acceptable in comparison with the maximum allowable rate of 12%. It is apparent that the remedial measures that have been undertaken in the past, including piping and water meter replacement, have contributed significantly to the reduction of the total amounts of unaccounted-for water. However, due to the age of the water system, water is still leaking through the cracks in the water distribution system piping which has extensively deteriorated.

With that said, it has become strategic and prudent for Dixie Groves Utility Company to pursue and consider an effective and permanent solution to this problem for years to come.

### **4.0 CURRENT AND PROJECTED WATER DEMAND**

Dixie Grove Utility Company provides water services to a total population of approximately 877. As shown above, the current annual average potable water demand is approximately 34,000

gallons per day (equivalent to 39 gpcd) which is significantly lower than the standard average per capita consumption rates between 85-135 gpd. The utility service area is nearly built-out. Little to no growth is anticipated in the future. Also, the water consumption rate is not expected to change.

#### **4.1 Water Conservation Policy**

The following water conservation policies are established for Dixie Grove Utility Company:

**A.** Full compliance with Pasco County Emergency Ordinance No. 01-016 regarding water use in Pasco County. The ordinance limits lawn watering times during the week to only one day per week to conserve water.

**B.** Conservation Devices - In designing any building for which a building permit is required, the owner, architect or developer shall include the following water conservation devices in any plans submitted for approval and permitting:

- Slope control devices
- Reduced flow showerheads
- Reduced water use appliances, where feasible

In addition, any such owner, developer or architect shall utilize only those heating and cooling systems which are designed to minimize water usage. Ornamental water features such as exterior fountains and reflection pools shall be permitted only if they re-circulate water.

**C.** Shallow Wells – Private shallow wells for irrigation purposes must be permitted by the utility. No private shallow well shall be approved by the utility which may adversely affect or promote salt water intrusion of utility-owned potable water wells.

**D. Catch Basins** – The developers of proposed residential, industrial and commercial projects shall design catchment basins for use, where feasible, for the storage of rainwater for later use in irrigation. The design and use of such catchment basins shall conform to all applicable local, state, and federal regulations.

**E. Xeriscaping** – Any new or re-landscaped utility owner property shall incorporate a landscape plan which utilizes the concept of xeriscaping.

**F. Prohibition** – Within the Dixie Groves Utility service area, in connection with any new development or substantial redevelopment, the use of high volume irrigation equipment shall be prohibited. The installation of any automatic sprinkling system which is not equipped with moisture sensors or other devices designed to keep the sprinkling system from operating during periods of rain or high water content in the soil, shall be prohibited.

## **5.0 WATER DISTRIBUTION SYSTEM REPLACEMENT WITH COST ESTIMATES**

The following alternatives are recommended for replacement of the water distribution system:

### **Alternative I (Replacement of the System with Fire Protection Capability):**

Under the proposed upgrades, the entire water distribution system will be replaced with 4-inch and 8-inch C-900 DR-18 PVC piping with design considerations to fire protection and storage. The details of the proposed layout of the water distribution system are depicted on the attached site plans under Appendix F. The raw water from Well #2 and Well #3 will be transferred to the proposed 110,000-gallon above-ground storage tank at Well #3 using the well pumps which will be activated through a mercury floating switch in the storage tank. The water in the storage tank will then be pumped to the water distribution system via the new hydropneumatic tank. All piping from the hydropneumatic tank to the proposed fire hydrants will have a minimum diameter of 8 inches. This size is necessary to accommodate flows during fire flow demand of a minimum of 1,000 gallons per minute for two hours.

In addition, two new 15 h.p. high service pumps will be installed to pump the water from the storage tank to the hydropneumatic tank. An additional 40 h.p. high service pump will be installed to supply the additional fire flow demand from the storage tank to the water distribution system. The total pumping capacity of the system, with all of these pumps under operation, will be approximately 1,200 gallons per minute. See the attached plans for more details under Appendix G.

Furnishing and installation of the 110,000-gallon above-ground storage tank would also contribute to compliance with Rule 62-555, F.A.C., which require providing a storage capacity of at least 25% of the system's maximum day water demand.

An itemized list of the proposed modifications along with their respective cost estimates are provided in the spreadsheet under Appendix E. The total estimated cost for the project including road resurfacing is approximately \$1,434,407.10.

**Alternative II (Replacement of the System without Fire Protection Capability):**

Under the proposed upgrades, the entire water distribution system will be replaced with 4-inch C-900 DR-18 PVC piping without design considerations to fire protection and storage. The details of the proposed layout of the water distribution system are depicted on the attached site plans under Appendix F. Also, the hydropneumatic tanks for Well #2 and Well #3 will be replaced with new tanks with all necessary supply piping, bypass valves and air compressors.

An itemized list of the proposed modifications along with their respective cost estimates are provided in the spreadsheet under Appendix E. The total estimated cost for the project including road resurfacing is approximately \$1,090,583.84.

## **6.0 ROAD RESURFACING**

The existing roads at Dixie Groves area are in a poor condition and need resurfacing. To accomplish this task, Pasco County, under the Pasco County Paving Assessment Program, initiated a plan to resurface the roads around the middle of October 2003. As part of this plan, Pasco County requested a schedule from U.S. Water Services Corporation regarding the proposed upgrades to the water distribution system. Based on the County's estimates, a one time fee of \$1,059.00 will be charged to each homeowner at Dixie Groves Estates to recover the cost of paving, which will consist of a 1-inch Type S-III asphalt leveling course including, filling all the pot holes, and a top 1-inch Type S-III asphalt wearing course.

In response to the County's letter, dated September 19, 2003, U.S. Water Services Corporation requested, in a letter, dated September 25, 2003, that the County put the project on hold until the layout of the water distribution system is complete. U.S. Water indicated that deferral of the road resurfacing project would be in the best interest of the public due to the fact that the roads will be repaired only once with resulting cost savings to the homeowners of more than 50 percent. Consequently, Pasco County responded to the request, in a letter, dated September 30, 2003, with the consent to put the project on hold until the water distribution system design, permitting and construction are complete. In addition, Pasco County did not have any objections to incorporating the proposed road resurfacing project under the overall water distribution system replacement project.

Under the proposed road resurfacing project, a total area of approximately 20,138 square yards will be paved which includes the following roads (see attached plans under Appendix G for more details):

- Lake Ridge Lane
- Briar Hill Lane
- Rosedale Lane
- Knollwood Lane

- Arcadia Drive
- Mary Lane
- Dixie Lane
- Patriot Lane
- Viceroy Lane
- Sparkle Lane

The proposed procedure for the road resurfacing plan include the following:

- All open road cuts will be filled with a minimum of 8 inches of limerock base which will be compacted with vibratory plate compactor to a minimum of 98% density.
- Fill all open road cuts with Type S-III Asphalt and compact thoroughly.
- Clean road surfaces to be overlaid from dirt and debris and haul off-site.
- Apply asphalt emulsion tack coat for proper bonding of asphalt.
- Fill and compact all pot holes with Type-III asphalt.
- Overlay with 1-inch leveling course of Type S-III asphalt.
- Compact leveling course.
- Furnish and install a 1-inch finish wearing course of Type S-III asphalt.
- Compact to a smooth finish with a vibratory steel wheel roller.

## **7.0 SUMMARY AND RECOMMENDATIONS**

As mentioned above, the existing water distribution system at Dixie Groves is in a very poor condition and has extensive amounts of deterioration. This deterioration has resulted in substantial losses of water through the water distribution system for many years. Based on the current trends of the total amounts of unaccounted-for water, the water losses are expected to continue to increase in the future with further and more excessive deterioration in the piping.

Based on the foregoing, replacing the existing water distribution system with a new one is the most viable option at this time. Replacing the system is highly recommended and has several advantages including:

- Elimination of potential risks to public health by improving the water quality. The existing piping of the water distribution system was built in the 1950's of a combination of both 4-inch asbestos cement piping and 2-inch galvanized iron piping. These types of pipes are no longer used in the construction of underground utilities, especially in water distribution systems. Most States have banned installation of new asbestos pipes due to health-related issues attributed to cancer. Also, galvanized iron piping is not recommended for underground utilities because it decays very fast as a result of corrosion which consequently causes clogging of the piping and deterioration of water quality.
- Water conservation. Based on current water withdrawal and consumption rates, the percentage of the unaccounted-for water that is lost through the water distribution system is about 11% (based on the past 6 months). This rate is close to the maximum allowable rate of 12% (as given by the guidelines of the Southwest Florida Water Management District). Therefore, replacing the water distribution system would result in conserving more water and elimination of water losses through the water distribution system.
- Achieve the goals of the Southwest Florida Water Management District. Since the facility is located in a Water Use Caution Area as outlined by the permitting rules of the Southwest Florida Water Management District, it would be imperative for the Utility to aggressively tackle these issues and replace the water distribution system to achieve the goals and policies of the SWFWMD Water Management Plan for water conservation in such sensitive areas. According to the recent updates to the 1992 SWFWMD Needs and Sources Water Supply Planning Study, the water demand in the District would increase from 1.5 billion in 1994 to 1.8 billion gallons per day by 2020. In addition, the study concludes that unless greater than anticipated conservation occurs, it is unlikely that all projected demands will be met.

In summary, by pursuing this project, the Utility will be able to contribute positively to addressing the cumulative water withdrawals which are causing or may cause adverse impacts to water resources in the region, land resources or the public interest.



**Appendix A**  
**(Site Location Maps)**

Site Location Map  
Dixie Grove Utility Company

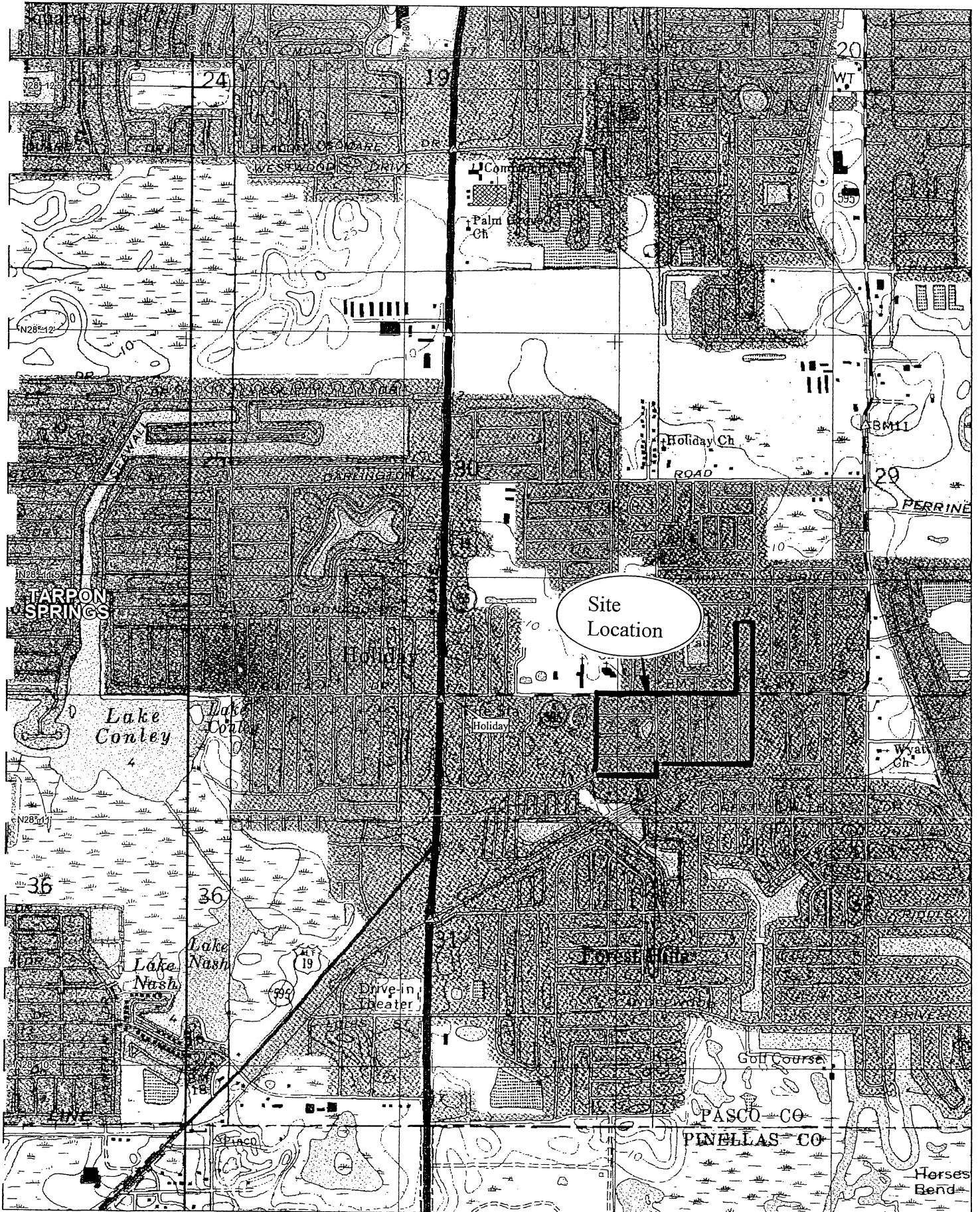

MAPQUEST™

Site Location  
Dixie Groves Utility Company

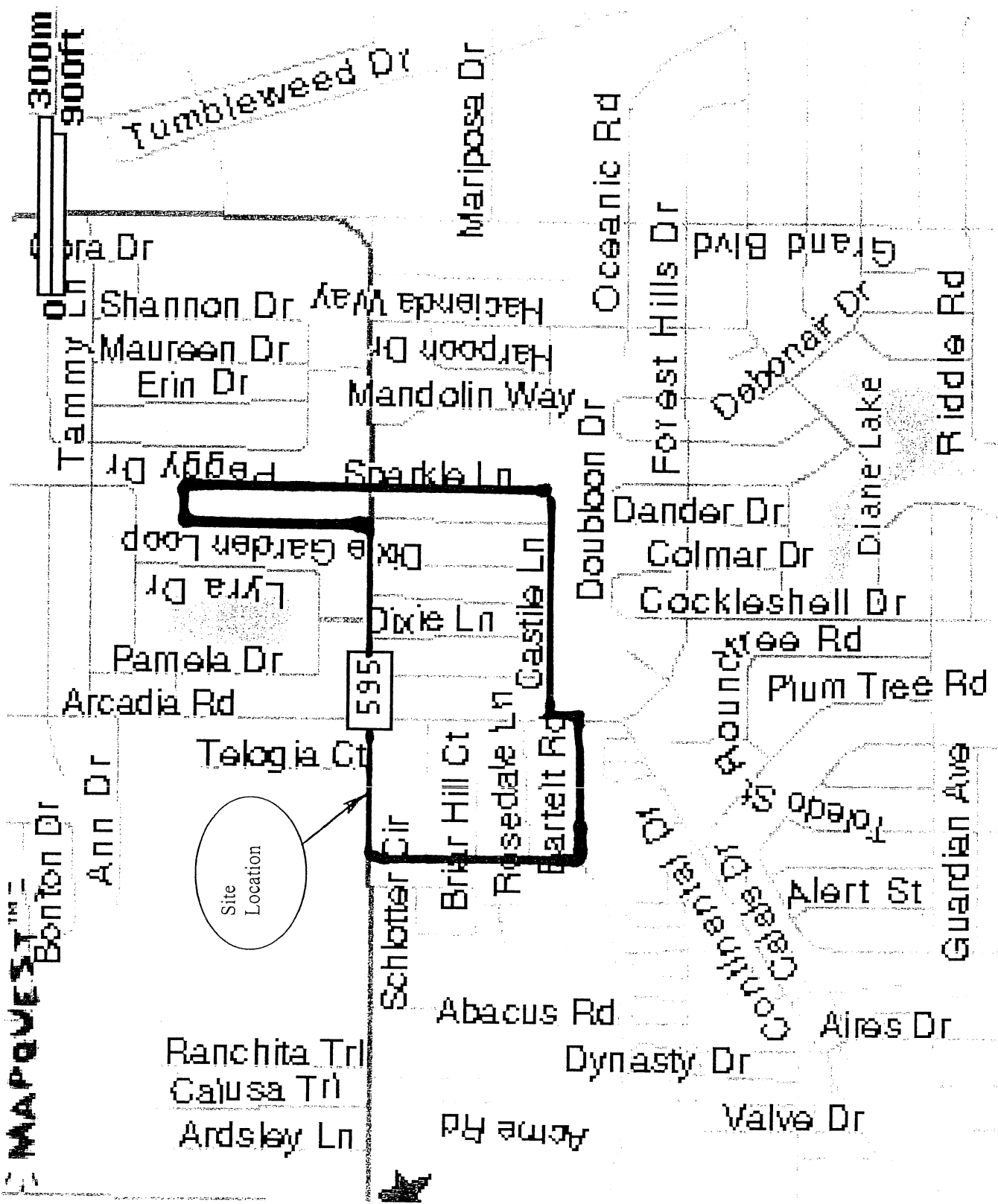

## **Appendix B**

**(Boundaries of Water Use Caution Areas)**

Figure 1. Water Use Caution Areas (WUCAs) within the Southwest Florida Water Management District.

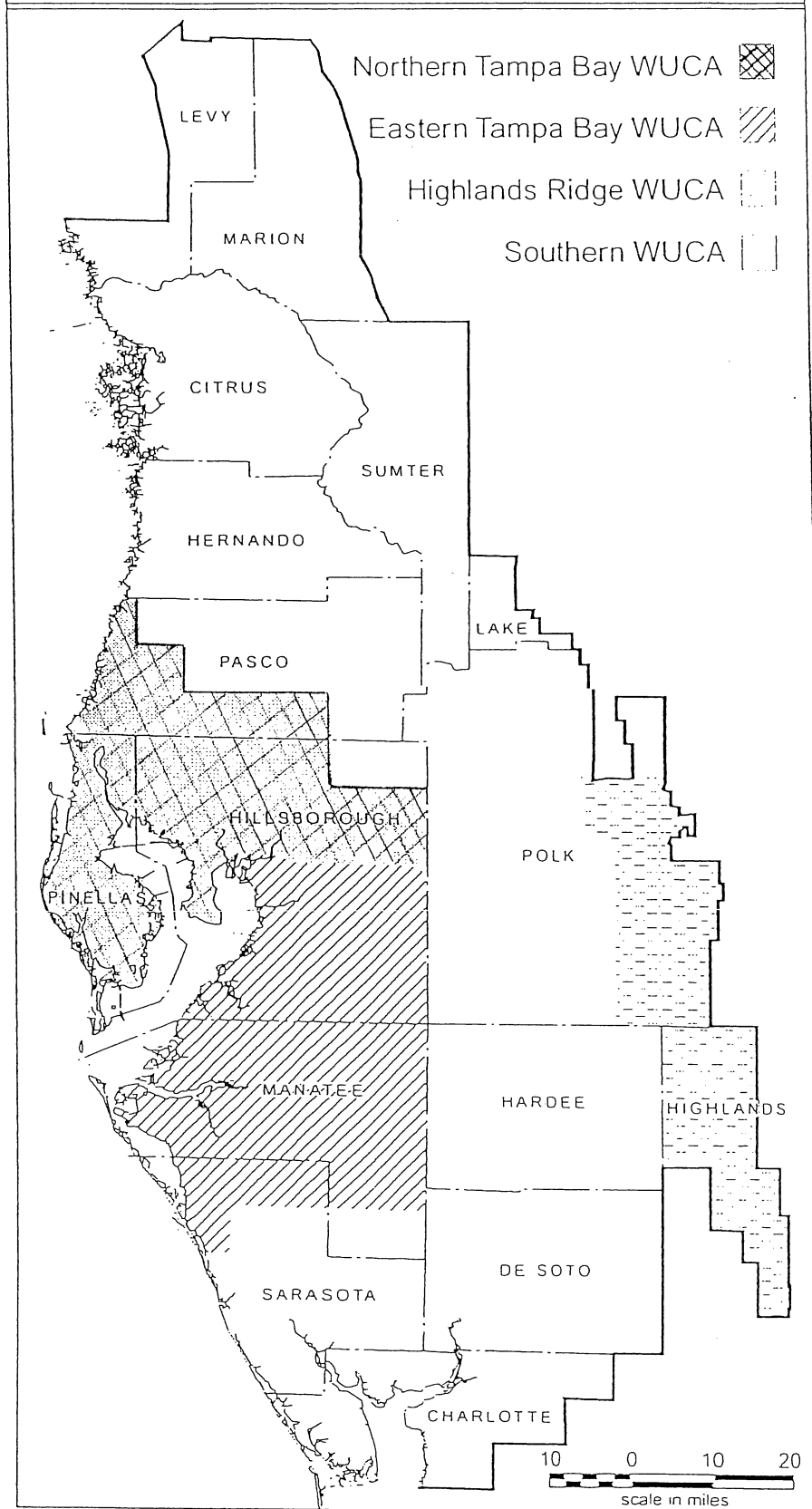

## **Appendix C**

**(Summary of Monthly Flow Data)**

**Summary of Total Monthly Water Withdrawal and Consumption  
Dixie Groves Utility Company**

| <b>MONTH</b>    | <b>TOTAL WELL<br/>WITHDRAWAL<br/>(GALLONS)</b> | <b>AMOUNT SOLD<br/>(GALLONS)</b> | <b>AMOUNT<br/>UNACCOUNTED<br/>FOR (GALLONS)</b> | <b>PERCENTAGE OF<br/>WATER<br/>UNACCOUNTED<br/>FOR (%)</b> |
|-----------------|--|----------------------------------|---|--|
| Mar-03          | 1,434,000.00                                   | 847,000.00                       | 587,000.00                                      | 40.93  |
| Apr-03          | 1,538,000.00                                   | 924,000.00                       | 614,000.00                                      | 39.92  |
| May-03          | 1,902,000.00                                   | 1,133,000.00                     | 769,000.00                                      | 40.43  |
| Jun-03          | 1,383,000.00                                   | 1,122,000.00                     | 261,000.00                                      | 18.87  |
| Jul-03          | 1,481,000.00                                   | 870,000.00                       | 611,000.00                                      | 41.26  |
| Aug-03          | 1,617,400.00                                   | 881,000.00                       | 736,400.00                                      | 45.53  |
| Sep-03          | 1,533,000.00                                   | 918,000.00                       | 615,000.00                                      | 40.12  |
| Oct-03          | 1,562,000.00                                   | 874,000.00                       | 688,000.00                                      | 44.05  |
| Nov-03          | 1,649,000.00                                   | 1,406,000.00                     | 243,000.00                                      | 14.74  |
| Dec-03          | 1,744,000.00                                   | 597,000.00                       | 1,147,000.00                                    | 65.77  |
| Jan-04          | 1,633,000.00                                   | 868,000.00                       | 765,000.00                                      | 46.85  |
| Feb-04          | 1,552,000.00                                   | 922,000.00                       | 630,000.00                                      | 40.59  |
| Mar-04          | 1,547,600.00                                   | 1,099,000.00                     | 448,600.00                                      | 28.99  |
| Apr-04          | 1,614,500.00                                   | 1,281,000.00                     | 333,500.00                                      | 20.66  |
| May-04          | 1,527,000.00                                   | 1,024,000.00                     | 503,000.00                                      | 32.94  |
| Jun-04          | 1,404,800.00                                   | 1,162,000.00                     | 242,800.00                                      | 17.28  |
| Jul-04          | 1,365,000.00                                   | 994,000.00                       | 371,000.00                                      | 27.18  |
| Aug-04          | 1,351,000.00                                   | 1,228,000.00                     | 123,000.00                                      | 9.10   |
| Sep-04          | 1,123,000.00                                   | 882,000.00                       | 241,000.00                                      | 21.46  |
| Oct-04          | 1,127,000.00                                   | 1,084,000.00                     | 43,000.00                                       | 3.82   |
| Nov-04          | 1,173,090.00                                   | 1,159,000.00                     | 14,090.00                                       | 1.20   |
| Dec-04          | 1,250,000.00                                   | 1,070,000.00                     | 180,000.00                                      | 14.40  |
| Jan-05          | 1,164,000.00                                   | 1,020,000.00                     | 144,000.00                                      | 12.37  |
| <b>Average:</b> | <b>1,464,147.39</b>                            | <b>1,015,869.57</b>              | <b>448,277.83</b>                               | <b>29.06</b>   |

# Summary of Total Monthly Water Withdrawal and Consumption Dixie Groves Utility Company

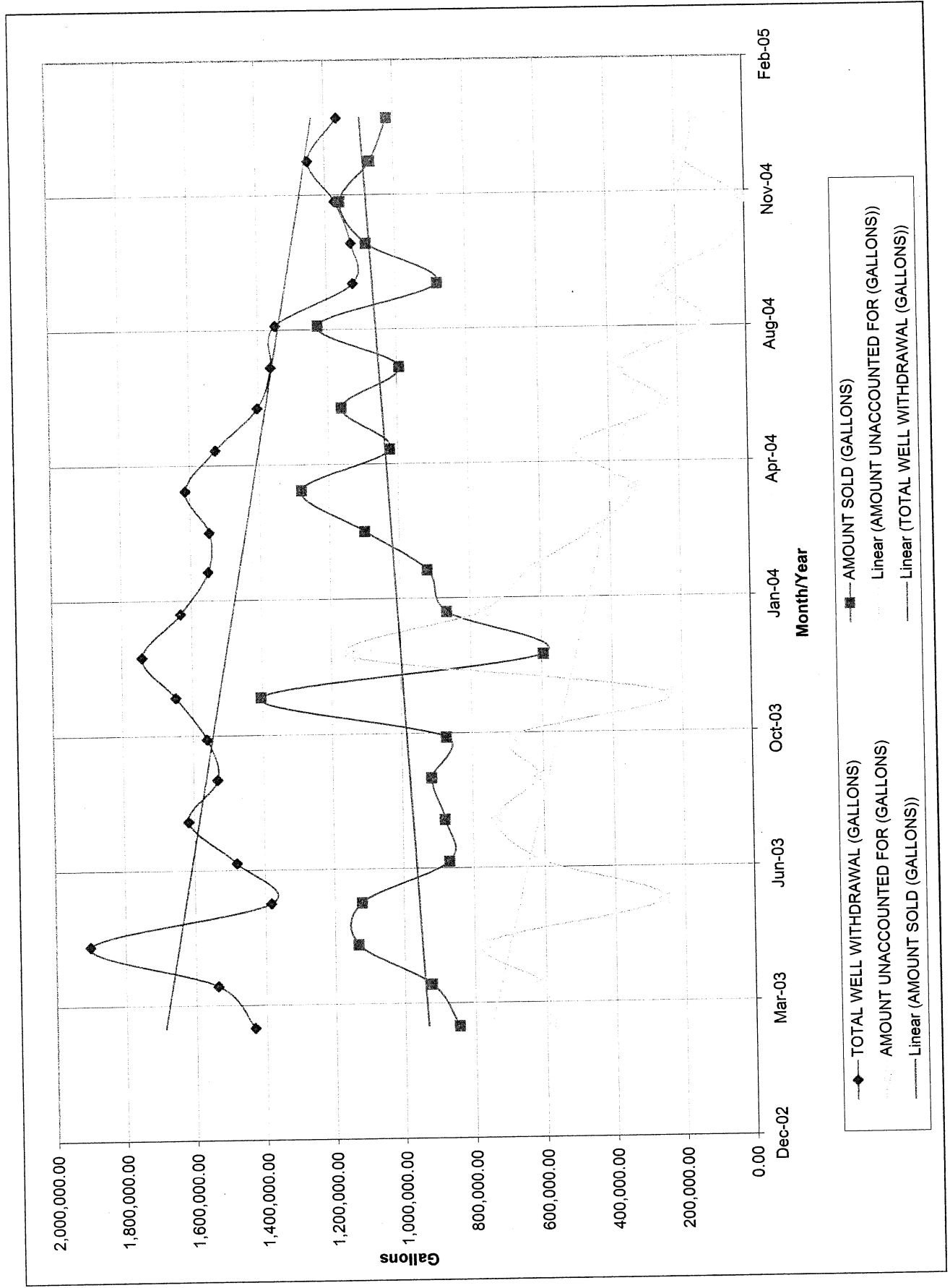



**Appendix D**  
**(Water Use Permit)**

SOUTHWEST FLORIDA WATER MANAGEMENT DISTRICT  
WATER USE  
GENERAL  
PERMIT NO. 20007718.002

**EXPIRATION DATE:** October 19, 2013

**PERMIT ISSUE DATE:** February 14, 2002

THE PERMITTEE IS RESPONSIBLE FOR APPLYING FOR A RENEWAL OF THIS PERMIT PRIOR TO THE EXPIRATION DATE WHETHER OR NOT THE PERMITTEE RECEIVES PRIOR NOTIFICATION BY MAIL. FAILURE TO DO SO AND CONTINUED USE OF WATER AFTER EXPIRATION DATE IS A VIOLATION OF DISTRICT RULES AND MAY RESULT IN A MONETARY PENALTY AND/OR LOSS OF WATER. APPLICATION FOR RENEWAL PRIOR TO THE EXPIRATION DATE IS SUBJECT TO DISTRICT EVALUATION AND APPROVAL.

This permit, issued under the provision of Chapter 373, Florida Statutes and Florida Administrative Code 40D-2, authorizes the Permittee to withdraw the quantities outlined herein, and may require various activities to be performed by the Permittee as outlined by the Special Conditions. This permit, subject to all terms and conditions, meets all District permitting criteria.

**GRANTED TO:** Dixie Groves Estates, Inc.  
PO Box 845  
New Port Richey, FL 34656

**PROJECT NAME:** Not Specified

**TYPE OF APPLICATION:** Modification

**WATER USE CAUTION AREA:**  
Northern Tampa Bay

**APPLICATION FILED:** November 16, 2001

**APPLICATION AMENDED:** N/A

**ACRES:** 0.26 Owned  
41.57 Serviced  
41.83 Total

**PROPERTY LOCATION:** Pasco County, approximately 3 miles south of New Port Richey, and one mile east of the intersection of US Highway 19 and County Road 595.

**TOTAL QUANTITIES AUTHORIZED UNDER THIS PERMIT (in gpd)**

AVERAGE: 75,000      PEAK MONTHLY: 150,000

| <u>Use</u>    | <u>Average</u> | <u>Peak Monthly</u> |
|---------------|----------------|---------------------|
| Agricultural: | 75,000 gpd     | 150,000 gpd         |

See Withdrawal Table for quantities permitted for each withdrawal point.

Permit No.: 20007718.002  
 Permittee: Dixie Groves Estates, Inc.  
 Page 2

WATER USE: PUBLIC SUPPLY

SERVICE AREA NAME

Dixie Groves Estates

| <u>USE TYPE</u>                                 | <u>POPULATION SERVED</u> | <u>PER CAPITA RATE</u>                           |
|---|--------------------------|--|
| Residential Single Family<br>Other Metered Uses |                          |  |
|   |                          | Gross 85 gpd/person<br>Compliance 150 gpd/person |
| Total Public Supply                             | 877                      |  |

| <u>I.D. NO.</u><br><u>PERMITTEE/</u><br><u>DISTRICT</u> | <u>DIAM.</u><br><u>(IN.)</u> | <u>DEPTH</u><br><u>TTL./CSD.</u> | <u>USE</u> | <u>GALLONS PER DAY</u> |                               |         |
|---|------------------------------|----------------------------------|------------|------------------------|-------------------------------|---------|
|   |                              |                                  |            | <u>AVERAGE</u>         | <u>PEAK</u><br><u>MONTHLY</u> |         |
| 2 / 2   | 6                            | 65 / 47                          | B          | 75,000                 | 150,000                       |         |
| 3 / 3   | 4                            | 72 / 42                          | B          | 75,000                 | 150,000                       | Standby |

B = Public Supply

| <u>DISTRICT</u><br><u>I.D. NO.</u> | <u>LOCATION</u><br><u>LAT./LONG.</u> | <u>SECTION/TOWNSHIP/RANGE</u> |
|------------------------------------|--------------------------------------|-------------------------------|
| 2                                  | 281115.24/824346.57                  | 32/26/16                      |

SPECIAL CONDITIONS:

1. All reports required by the permit shall be submitted to the District on or before the tenth day of the month following data collection and shall be addressed to:

Permit Data Section, Records and Data Department  
 Southwest Florida Water Management District  
 2379 Broad Street  
 Brooksville, Florida 34604-6899

Unless otherwise indicated, three copies of each plan or report, with the exception of pumpage, rainfall, evapotranspiration, water level or water quality data which require one copy, are required by the permit.

2. Any wells not in use, District ID No. 1, Permittee ID No. 1, and in which pumping equipment is not installed shall be capped or valved in a water-tight manner in accordance with Chapter 62-532.500(3)(a)4, F.A.C.
3. The Permittee shall begin carrying out the provisions of its District approved conservation plan dated **June 7, 2001**, upon receipt of this permit. The Permittee shall submit progress reports to the Permit Data Section, Records and Data Department, concerning implementation of the plan on **February 1, 2007**.

Permit No.: 20007718.002  
Permittee: Dixie Groves Estates, Inc.  
Page 3

STANDARD CONDITIONS:

1. The Permittee shall comply with the Standard Conditions attached hereto, incorporated herein by reference as Exhibit "A" and made a part hereof.

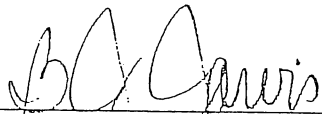

---

Authorized Signature  
SOUTHWEST FLORIDA WATER MANAGEMENT DISTRICT

40D-2  
Exhibit "A"  
WATER USE PERMIT CONDITIONS

STANDARD CONDITIONS

1. If any of the statements in the application and in the supporting data are found to be untrue and inaccurate, or if the Permittee fails to comply with all of the provisions of Chapter 373, F.S., Chapter 40D, or the conditions set forth herein, the Governing Board shall revoke this permit in accordance with Rule 40D-2.341, following notice and hearing.
2. This permit is issued based on information provided by the Permittee demonstrating that the use of water is reasonable and beneficial, consistent with the public interest, and will not interfere with any existing legal use of water. If, during the term of the permit, it is determined by the District that the use is not reasonable and beneficial, in the public interest, or does impact an existing legal use of water, the Governing Board shall modify this permit or shall revoke this permit following notice and hearing.
3. The Permittee shall not deviate from any of the terms or conditions of this permit without written approval by the District.
4. In the event the District declares that a Water Shortage exists pursuant to Chapter 40D-21, the District shall alter, modify, or declare inactive all or parts of this permit as necessary to address the water shortage.
5. The District shall collect water samples from any withdrawal point listed in the permit or shall require the Permittee to submit water samples when the District determines there is a potential for adverse impacts to water quality.
6. The Permittee shall provide access to an authorized District representative to enter the property at any reasonable time to inspect the facility and make environmental or hydrologic assessments. The Permittee shall either accompany District staff onto the property or make provision for access onto the property.
7. Issuance of this permit does not exempt the Permittee from any other District permitting requirements.
8. The Permittee shall cease or reduce surface water withdrawal as directed by the District if water levels in lakes fall below applicable minimum water level established in Chapter 40D-8 or rates of flow in streams fall below the minimum levels established in Chapter 40D-8.
9. The Permittee shall cease or reduce withdrawal as directed by the District if water levels in aquifers fall below the minimum levels established by the Governing Board.
10. The Permittee shall practice water conservation to increase the efficiency of transport, application, and use, as well as to decrease waste and to minimize runoff from the property. At such time as the Governing Board adopts specific conservation requirements for the Permittee's water use classification, this permit shall be subject to those requirements upon notice and after a reasonable period for compliance.
11. The District may establish special regulations for Water Use Caution Areas. At such time as the Governing Board adopts such provisions, this permit shall be subject to them upon notice and after a reasonable period for compliance.

Permit No.: 20007718.002

Permittee: Dixie Groves Estates, Inc.

Page 5

12. When necessary to analyze impacts to the water resource or existing users, the District shall require the Permittee to install flow metering or other measuring devices to record withdrawal quantities and submit the data to the District.
13. A District identification tag shall be prominently displayed at each withdrawal point by permanently affixing the tag to the withdrawal facility.
14. The Permittee shall notify the District within 30 days of the sale or conveyance of permitted water withdrawal facilities or the land on which the facilities are located.
15. All permits issued pursuant to these Rules are contingent upon continued ownership or legal control of all property on which pumps, wells, diversions or other water withdrawal facilities are located.
16. The annual average daily withdrawal quantity is determined by calculating the total quantity of water to be withdrawn over a 1-year period, divided by 365 days, which results in a gallons per day (gpd) quantity pursuant to Basis of Review, Section 3.2, Permitted Withdrawal Quantities. This is a running 12-month average, whereby each month the annual average daily quantity is recalculated based on the previous 12-month pumpage.

R. 02/20/2001

PART II HEARINGS INVOLVING DISPUTED ISSUES  
OF MATERIAL FACT

28-106.201 Initiation of Proceedings.

(1) Unless otherwise provided by statute, initiation of proceedings shall be made by written petition to the agency responsible for rendering final agency action. The term "petition" includes any document that requests an evidentiary proceeding and asserts the existence of a disputed issue of material fact. Each petition shall be legible and on 8 1/2 by 11 inch white paper. Unless printed, the impression shall be on one side of the paper only and lines shall be double-spaced.

(2) All petitions filed under these rules shall contain:

(a) The name and address of each agency affected and each agency's file or identification number, if known;

(b) The name, address, and telephone number of the petitioner; the name, address, and telephone number of the petitioner's representative, if any, which shall be the address for service purposes during the course of the proceeding; and an explanation of how the petitioner's substantial interests will be affected by the agency determination;

(c) A statement of when and how the petitioner received notice of the agency decision;

(d) A statement of all disputed issues of material fact. If there are none, the petition must so indicate;

(e) A concise statement of the ultimate facts alleged, including the specific facts the petitioner contends warrant reversal or modification of the agency's proposed action;

(f) A statement of the specific rules or statutes the petitioner contends require reversal or modification of the agency's proposed action; and

(g) A statement of the relief sought by the petitioner, setting precisely the action petitioner wishes the agency to take with respect to the agency's proposed action.

(3) Upon receipt of a petition involving disputed issues of material fact, the agency shall grant or deny the petition, and if granted shall, unless otherwise provided by law, refer the matter to the Division of Administrative Hearings with a request that an administrative law judge be assigned to conduct the hearing. The request shall be accompanied by a copy of the petition and a copy of the notice of agency action.

(4) A petition shall be dismissed if it is not in substantial compliance with subsection (2) of this rule or it has been untimely filed. Dismissal of a petition shall, at least once, be without prejudice to petitioner's filing a timely amended petition curing the defect, unless it conclusively appears from the face of the petition that the defect cannot be cured.

(5) The agency shall promptly give written notice to all parties of the action taken on the petition, shall state with particularity its reasons if the petition is not granted, and shall state the deadline for filing an amended petition if applicable.

*Specific Authority 120.54(3), (5) FS. Law Implemented 120.54(5), 120.569, 120.57 FS. History—New 4-1-97, Amended 9-17-98.*

PART III PROCEEDINGS AND HEARINGS NOT  
INVOLVING DISPUTED ISSUES OF MATERIAL  
FACT

28-106.301 Initiation of Proceedings.

(1) Initiation of a proceeding shall be made by written petition to the agency responsible for rendering final agency action. The term "petition" includes any document which requests a proceeding. Each petition shall be legible and on 8 1/2 by 11 inch white paper or on a form provided by the agency. Unless printed, the impression shall be on one side of the paper only and lines shall be doubled-spaced.

(2) All petitions filed under these rules shall contain:

(a) The name and address of each agency affected and each agency's file or identification number, if known;

(b) The name, address, and telephone number of the petitioner; the name, address, and telephone number of the petitioner's representative, if any, which shall be the address for service purposes during the course of the proceeding; and an explanation of how the petitioner's substantial interests will be affected by the agency determination;

(c) A statement of when and how the petitioner received notice of the agency decision;

(d) A concise statement of the ultimate facts alleged, including the specific facts the petitioner contends warrant reversal or modification of the agency's proposed action;

(e) A statement of the specific rules or statutes the petitioner contends require reversal or modification of the agency's proposed action; and

(f) A statement of the relief sought by the petitioner, stating precisely the action petitioner wishes the agency to take with respect to the agency's proposed action.

(3) If the petition does not set forth disputed issues of material fact, the agency shall refer the matter to the presiding officer designated by the agency with a request that the matter be scheduled for a proceeding not involving disputed issues of material fact. The request shall be accompanied by a copy of the petition and a copy of the notice of agency action.

(4) A petition shall be dismissed if it is not in substantial compliance with subsection (2) of this Rule or it has been untimely filed. Dismissal of a petition shall, at least once, be without prejudice to petitioner's filing a timely amended petition curing the defect, unless it conclusively appears from the face of the petition that the defect cannot be cured.

(5) The agency shall promptly give written notice to all parties of the action taken on the petition, shall state with particularity its reasons if the petition is not granted, and shall state the deadline for filing an amended petition if applicable.

*Specific Authority 120.54(5) FS. Law Implemented 120.54(5), 120.569, 120.57 FS. History—New 4-1-97, Amended 9-17-98.*

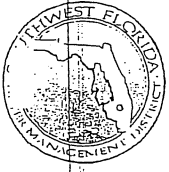

An Equal Opportunity Employer

# Southwest Florida Water Management District

2379 Broad Street, Brooksville, Florida 34604-6899  
(352) 796-7211 or 1-800-423-1476 (FL only)  
SUNCOM 628-4150 TDD only 1-800-231-6103 (FL only)  
On the Internet at: WaterMatters.org

**Tampa Service Office**  
7601 Highway 301 North  
Tampa, Florida 33637-6759  
(813) 985-7481 or  
1-800-836-0797 (FL only)  
SUNCOM 578-2070

**Bartow Service Office**  
170 Century Boulevard  
Bartow, Florida 33830-7700  
(863) 534-1448 or  
1-800-492-7862 (FL only)  
SUNCOM 572-6200

**Sarasota Service Office**  
6750 Fruitville Road  
Sarasota, Florida 34240-9711  
(941) 377-3722 or  
1-800-320-3503 (FL only)  
SUNCOM 531-6900

**Lecanto Service Office**  
3600 West Sovereign Path  
Suite 226  
Lecanto, Florida 34461-8070  
(352) 527-8131  
SUNCOM 667-3271

February 14, 2002

- Ronnie E. Duncan**  
Chair, Pinellas
- Thomas G. Dabney, II**  
Vice Chair, Sarasota
- Janet D. Kovach**  
Secretary, Hillsborough
- Watson L. Haynes, II**  
Treasurer, Pinellas
- Edward W. Chance**  
Manatee
- Lonroe "Al" Coogler**  
Citrus
- Maggie N. Dominguez**  
Hillsborough
- Pamela L. Fentress**  
Highlands
- Ronald C. Johnson**  
Polk
- Heidi B. McCree**  
Hillsborough
- John K. Renke, III**  
Pasco
- E. D. "Sonny" Vergara**  
Executive Director
- Gene A. Heath**  
Assistant Executive Director
- William S. Bilenky**  
General Counsel

Dixie Groves Estates, Inc.  
PO Box 845  
New Port Richey, FL 34656

Subject: Final Agency Action Transmittal Letter  
General Water Use Permit No. 20007718.002

Your Water Use Permit has been approved. Final approval is contingent upon no objection to the District's action being received by the District within the time frames described below.

You or any person whose substantial interests are affected by the District's action regarding a permit may request an administrative hearing in accordance with Sections 120.569 and 120.57, Florida Statutes (F.S.), and Chapter 28-106, Florida Administrative Code (F.A.C.), of the Uniform Rules of Procedure. A request for hearing must (1) explain how the substantial interests of each person requesting the hearing will be affected by the District's action, or proposed action; (2) state all material facts disputed by the person requesting the hearing or state that there are no disputed facts; and (3) otherwise comply with Chapter 28-106, F.A.C. Copies of Sections 28-106.201 and 28-106.301, F.A.C., are enclosed for your reference. A request for hearing must be filed with (received by) the Agency Clerk of the District at the District's Brooksville address within 21 days of receipt of this notice. Receipt is deemed to be the fifth day after the date on which this notice is deposited in the United States mail. Failure to file a request for hearing within this time period shall constitute a waiver of any right you or such person may have to request a hearing under Sections 120.569 and 120.57, F.S. Mediation pursuant to Section 120.573, F.S. to settle an administrative dispute regarding the District's action in this matter is not available prior to the filing of a request for hearing.

Enclosed is a 'Noticing Packet' that provides information regarding District Rule, 40D-1.1010, F.A.C. which addresses the notification of persons having substantial interests that may be affected by the District's action in this matter. The packet contains guidelines on how to provide notice of the District's action, and a notice that you may use.

Please be advised that the Governing Board has formulated a water shortage plan as referenced in Condition 4 of the Standard Water Use Permit Conditions (Exhibit A), and will implement such a plan during periods of water shortage. You will be notified during a declared water shortage of any change in the conditions of your Permit or any suspension of your Permit, or of any restriction on your use of water for the duration of any declared water shortage. Please further note that water conservation is a condition of your Permit and should be practiced at all times.

The ID tags for your withdrawals shall be installed by a District representative. This representative will attempt to contact you within 30 days to discuss placement of your tags. If you have any questions or concerns regarding your tags, please contact Sandy Semegen at extension 4349 in the Brooksville Regulation Department. If you have any questions or concerns regarding your permit or any other information, please contact this office at extension 4338.

Sincerely,

BJ Jarvis, Director  
Records and Data Department

BJJ:tg  
Enclosures: Approved Permit, Rules 28-106.201 and 28-106.301, F.A.C., and Noticing Packet  
cc: Donald Fenderson



**Appendix E**  
**(Engineer's Cost Estimate)**



## ENGINEER'S COST ESTIMATE DIXIE GROVES UTILITY COMPANY

### REPLACEMENT OF ENTIRE WATER DISTRIBUTION SYSTEM WITH 4" DR-18 C-900 PVC

| ITEM DESCRIPTION  | QUANTITY | UNITS | *UNIT PRICE (\$) | TOTAL PRICE (\$) |
|---|----------|-------|------------------|------------------|
| <b>Piping</b>   |          |       |                  |                  |
| 1) 4" DR-18 C-900 PVC   | 14,182   | L.F.  | 13.77            | 195,286.14       |
| 2) 4" M/J 90° Bend  | 8        | EA    | 111.72           | 893.76           |
| 3) 4" M/J Tee   | 21       | EA    | 159.60           | 3,351.60         |
| 4) 4" M/J R/W G/V w/ Box  | 28       | EA    | 339.15           | 9,496.20         |
| 5) 4" M/J 45°   | 2        | EA    | 111.72           | 223.44           |
| 6) 4"x2" Blowoff Assembly w/ 4" G/V   | 2        | EA    | 478.80           | 957.60           |
| 7) 4" P/V Mega w/ Acc.  | 136      | EA    | 63.84            | 8,682.24         |
| <b>Meters &amp; Service Connections</b>   |          |       |                  |                  |
| 8) Double Service Meter Assembly (Two 3/4") - Long Side   | 85       | EA    | 526.68           | 44,767.80        |
| 9) Double Service Meter Assembly (Two 3/4") - Short Side  | 109      | EA    | 380.00           | 41,420.00        |
| 10) 3/4" Sch 40 PVC on customer side  | 29,000   | L.F.  | 2.95             | 85,550.00        |
| <b>Directional Drilling</b>   |          |       |                  |                  |
| 11) Directional Drill 2" (Water Service Casing - Sch 26 PVC)  | 598      | L.F.  | 16.00            | 9,568.00         |
| 12) Directional Drill 4" DR-18 C900   | 80       | L.F.  | 35.91            | 2,872.80         |
| <b>Excavation</b>   |          |       |                  |                  |
| 13) Driveway Replacement  | 822      | S.Y.  | 22.34            | 18,363.48        |
| 14) SOD   | 13,526   | S.Y.  | 2.59             | 35,032.34        |
| 15) Silt Fencing  | 7,000    | L.F.  | 1.60             | 11,200.00        |
| 16) Abandon Existing Piping   | 1        | L.S.  | 5000             | 5,000.00         |
| 17) Road Crossing Excavation for Service Connections  | 1,534    | L.F.  | 9.98             | 15,309.32        |
| 18) Disposal of Unsuitable Material   | 1,370    | C.Y.  | 4.79             | 6,562.30         |
| 19) Miscellaneous Restoration (Gravel Loans, Fence Repair, etc.)  | 1        | L.S.  | 10,000           | 10,000.00        |
| <b>Pressure Tanks</b>   |          |       |                  |                  |
| 20) 3000-gal Horizontal Hydropneumatic Tanks w/ Accessories<br>w/ Tank Supply Piping, Bypass Valves, and Air Compressors. | 2        | EA    | 20,000.00        | 40,000.00        |
| <b>Fence</b>  |          |       |                  |                  |
| 21) 6-Foot High Chainlink Fence   | 360      | L.F.  | 8.00             | 2,880.00         |
| <b>Asphalt Paving</b>   |          |       |                  |                  |
| 22) 8" Limerock Base for Road Crossings   | 3,181    | S.Y.  | 11.17            | 35,531.77        |
| 23) 2" Asphalt, Type S-III  | 20,138   | S.Y.  | 9.78             | 196,949.64       |
| 24) Density & two Proctors  | 3        | EA    | 251.37           | 754.11           |
| 25) Density   | 100      | EA    | 19.95            | 1,995.00         |
| 26) Security and Telemetry  | 1        | EA    | 15000            | 15,000.00        |



**ENGINEER'S COST ESTIMATE  
DIXIE GROVES UTILITY COMPANY**

**REPLACEMENT OF ENTIRE WATER DISTRIBUTION SYSTEM  
WITH 4" DR-18 C-900 PVC**

| ITEM DESCRIPTION                                     | QUANTITY | UNITS | *UNIT PRICE (\$) | TOTAL PRICE (\$)    |
|--|----------|-------|------------------|---------------------|
| <b>Disinfection and Pressure Testing</b>             |          |       |                  |                     |
| 27) Disinfection and Pressure Testing                | 1        | EA    | 3500             | 3,500.00            |
| <b>Pumping System</b>                                |          |       |                  |                     |
| 28) Propane generator with automatic transfer switch | 1        | EA    | 35000            | 55,000.00           |
| <b>Surveying</b>                                     |          |       |                  |                     |
| 29) Survey work for the whole system                 | 1        | EA    | 20000            | 20,000.00           |
| <b>SUBTOTAL:</b>                                     |          |       |                  | <b>876,147.54</b>   |
| 30) Mobilization (3% of Subtotal)                    |          |       |                  | 26,284.43           |
| 31) Maintenance of Traffic (3% of Subtotal)          |          |       |                  | 26,284.43           |
| <b>TOTAL:</b>  |          |       |                  | <b>928,716.39</b>   |
| 32) Design & Permitting (8%)                         |          |       |                  | 74,297.31           |
| 33) Project Management (PM) (4%)                     |          |       |                  | 37,148.66           |
| <b>TOTAL PLUS DESIGN AND PM:</b>                     |          |       |                  | <b>1,040,162.36</b> |
| 34) Contingencies (5%)                               |          |       |                  | 52,008.12           |
| <b>TOTAL:</b>  |          |       |                  | <b>1,092,170.48</b> |

\*NOTE: These are preliminary cost estimates that are subject to change as a result of price/design adjustments.



**ENGINEER'S COST ESTIMATE**  
**DIXIE GROVES UTILITY COMPANY**  
**REPLACEMENT OF ENTIRE WATER DISTRIBUTION SYSTEM CONSIDERING**  
**FIRE PROTECTION AND STORAGE**  
**WITH 4" and 8" DR-18 C-900 PVC**

| ITEM DESCRIPTION   | QUANTITY | UNITS | *UNIT PRICE (\$) | TOTAL PRICE (\$) |
|--|----------|-------|------------------|------------------|
| <b>Piping</b>  |          |       |                  |                  |
| 1) 8" DR-18 C-900 PVC  | 7,357    | L.F.  | 17.56            | 129,192.78       |
| 2) 8" M/J 90° Bend   | 4        | EA    | 167.58           | 670.32           |
| 3) 8" M/J Tee  | 4        | EA    | 319.20           | 1,276.80         |
| 4) 8" M/J R/W G/V w/ Box                                     | 9        | EA    | 518.70           | 4,668.30         |
| 5) 8" P/V Mega w/ Acc.                                       | 60       | EA    | 95.76            | 5,745.60         |
| 6) 8" D/I Mega w/ Acc.                                       | 0        | EA    | 95.76            | 0.00             |
| 7) F.H.A. Perpendicular Installation                         | 12       | EA    | 3,500.00         | 42,000.00        |
| 8) 6" DR-18 C-900 PVC  | 0        | L.F.  | 14.36            | 0.00             |
| 9) 6" M/J R/W G/V w/ Box                                     | 0        | EA    | 399.00           | 0.00             |
| 10) 6" M/J Tee   | 0        | EA    | 239.40           | 0.00             |
| 11) 6" M/J 90° Bend  | 0        | EA    | 127.68           | 0.00             |
| 12) 6" P/V Mega w/ Acc.                                      | 0        | EA    | 79.80            | 0.00             |
| 13) 6" D/I Mega w/ Acc.                                      | 0        | EA    | 79.80            | 0.00             |
| 14) 4" DR-18 C-900 PVC                                       | 7,196    | L.F.  | 12.77            | 91,890.62        |
| 15) 4" M/J R/W G/V w/ Box                                    | 15       | EA    | 339.15           | 5087.25          |
| 16) 4" Blowoff Assembly                                      | 1        | EA    | 478.80           | 478.8            |
| 17) 4" P/V Mega w/ Acc.                                      | 52       | EA    | 63.84            | 3,319.68         |
| 18) 8"x4" Reducer  | 4        | EA    | 143.64           | 574.56           |
| 19) 6"x4" Reducer  | 0        | EA    | 103.74           | 0.00             |
| 20) 8"x6" M/J Tee (FH)                                       | 12       | EA    | 287.28           | 3,447.36         |
| 21) 8"x4" M/J Tee  | 12       | EA    | 271.32           | 3,255.84         |
| 22) 6"x4" M/J Tee  | 0        | EA    | 223.44           | 0.00             |
| <b>Raw Water Transmission Line</b>                           |          |       |                  |                  |
| 23) 3" DR-18 C-900 PVC Piping                                | 1,035    | L.F.  | 12.77            | 13,216.95        |
| 24) 3" M/J 90° Bend  | 5        | EA    | 111.72           | 558.60           |
| 25) 3" M/J R/W G/V w/ Box                                    | 1        | EA    | 339.15           | 339.15           |
| 26) 3" P/V Mega w/ Acc.                                      | 10       | EA    | 63.84            | 638.40           |
| <b>Meters &amp; Service Connections</b>                      |          |       |                  |                  |
| 27) Double Service Meter Assembly (Two 3/4") - Long Side     | 85       | EA    | 526.68           | 44,767.80        |
| 28) Double Service Meter Assembly (Two 3/4") - Short Side    | 109      | EA    | 380.00           | 41,420.00        |
| 29) 3/4" Sch 40 PVC on customer side                         | 29,000   | L.F.  | 2.95             | 85,550.00        |
| <b>Directional Drilling</b>                                  |          |       |                  |                  |
| 30) Directional Drill 2" (Water Service Casing - Sch 26 PVC) | 598      | L.F.  | 16.00            | 9,568.00         |
| 31) Directional Drill 8" DR-18 C900                          | 80       | L.F.  | 47.88            | 3,830.40         |



**ENGINEER'S COST ESTIMATE  
DIXIE GROVES UTILITY COMPANY  
REPLACEMENT OF ENTIRE WATER DISTRIBUTION SYSTEM CONSIDERING  
FIRE PROTECTION AND STORAGE  
WITH 4" and 8" DR-18 C-900 PVC**

| ITEM DESCRIPTION  | QUANTITY | UNITS | *UNIT PRICE (\$) | TOTAL PRICE (\$) |
|---|----------|-------|------------------|------------------|
| <b>Excavation</b>   |          |       |                  |                  |
| 32) Driveway Replacement  | 822      | S.Y.  | 22.34            | 18,363.48        |
| 33) SOD   | 13,526   | S.Y.  | 2.59             | 35,032.34        |
| 34) Silt Fencing  | 7,000    | L.F.  | 1.60             | 11,200.00        |
| 35) Abandon Existing Piping   | 1        | L.S.  | 5,000.00         | 5,000.00         |
| 36) Road Crossing Excavation for Service Connections  | 1,534    | L.F.  | 9.98             | 15,309.32        |
| 37) Disposal of Unsuitable Material   | 1,370    | C.Y.  | 4.79             | 6,562.30         |
| 38) Miscellaneous Restoration (Gravel Loans, Fence Repair, etc.)  | 1        | L.S.  | 10,000.00        | 10,000.00        |
| <b>Pressure Tank</b>  |          |       |                  |                  |
| 39) 3000-gallon Horizontal Hydropneumatic Tank w/ Accessories w/ Tank Support Piping, Bypass Valves, Air Compressor | 1        | EA    | 20,000.00        | 20,000.00        |
| <b>Above Ground Storage Tank</b>  |          |       |                  |                  |
| 40) 110,000-gal glass-fused-to-steel water storage tank   | 1        | EA    | 140,721          | 140,721.00       |
| 41) Soil Investigations and site preparation  | 1        | EA    | 15,000.00        | 15,000.00        |
| <b>Pumping System</b>   |          |       |                  |                  |
| 42) 15-h.p. 200-gpm High Service Pumps  | 2        | EA    | 5,500.00         | 11000            |
| 43) 40-h.p. 800-gpm High Service Pump   | 1        | EA    | 9,500.00         | 9,500.00         |
| 44) Electrical Control Panel  | 1        | EA    | 19,000.00        | 19,000.00        |
| 45) Flow metering, yard piping, valves for pumping equipment  | 1        | EA    | 15,556.00        | 15,556.00        |
| 46) Propane generator with automatic transfer switch  | 1        | EA    | 55,000.00        | 55,000.00        |
| 47) Plant lighting  | 1        | EA    | 5,000.00         | 5,000.00         |
| 48) Security and Telemetry  | 1        | EA    | 15,000.00        | 15,000.00        |
| <b>Disinfection and Pressure Testing</b>  |          |       |                  |                  |
| 49) Disinfection and Pressure Testing   | 1        | EA    | 3,500.00         | 3,500.00         |
| <b>Fence</b>  |          |       |                  |                  |
| 50) 6-Foot High Chainlink Fence   | 360      | L.F.  | 8.00             | 2,880.00         |
| <b>Asphalt Paving</b>   |          |       |                  |                  |
| 51) 8" Limerock Base for Road Crossings   | 3,181    | S.Y.  | 11.17            | 35,531.77        |
| 52) 2" Asphalt, Type S-III  | 20,138   | S.Y.  | 9.78             | 196,949.64       |
| 53) Density & two Proctors  | 3        | EA    | 251.37           | 754.11           |
| 54) Density   | 100      | EA    | 19.95            | 1,995.00         |



**ENGINEER'S COST ESTIMATE**  
**DIXIE GROVES UTILITY COMPANY**  
**REPLACEMENT OF ENTIRE WATER DISTRIBUTION SYSTEM CONSIDERING**  
**FIRE PROTECTION AND STORAGE**  
**WITH 4" and 8" DR-18 C-900 PVC**

| ITEM DESCRIPTION                                     | QUANTITY | UNITS | *UNIT PRICE (\$) | TOTAL PRICE (\$)    |
|--|----------|-------|------------------|---------------------|
| <b>Surveying</b>                                     |          |       |                  |                     |
| 55) Survey work for the whole system                 | 1        | EA    | 20,000.00        | 20,000.00           |
| <b>SUBTOTAL:</b>                                     |          |       |                  | <b>1,160,352.17</b> |
| 56) Mobilization (3% of Subtotal)                    |          |       |                  | 34,810.57           |
| 57) Maintenance of Traffic (M.O.T.) (3% of Subtotal) |          |       |                  | 34,810.57           |
| <b>TOTAL:</b>  |          |       |                  | <b>1,229,973.31</b> |
| 58) Design & Permitting (8% of Total)                |          |       |                  | 98,397.86           |
| 59) Project Management (PM) (4% of Total)            |          |       |                  | 49,198.93           |
| <b>TOTAL PLUS DESIGN AND PM:</b>                     |          |       |                  | <b>1,377,570.10</b> |
| 60) Contingencies (5%)                               |          |       |                  | 68,878.51           |
| <b>GRAND TOTAL:</b>                                  |          |       |                  | <b>1,446,448.61</b> |

\*NOTE: These are preliminary cost estimates that are subject to change as a result of price/design adjustments.

## **Appendix F**

**(Preliminary Engineering Plans and Details)**