

Commissioners:
JULIA L. JOHNSON, CHAIRMAN
SUSAN F. CLARK
J. TERRY DEASON
JOE GARCIA
DIANE K. KIESLING



DIVISION OF WATER &
WASTEWATER
CHARLES HILL
DIRECTOR
(904) 413-6900

ORIGINAL
FILE COPY

Public Service Commission

January 17, 1997

Mr. Kenneth J. Knowlton
Crooked Lake Park Sewerage Company, Inc.
227 Caloosa Lake Circle, North
Lake Wales, Florida 33853

RE: Docket No. 961478-SU, Application for grandfather certificate to operate a wastewater utility in Polk County by Crooked Lake Park Sewerage Company, Inc.

Dear Mr. Knowlton:

Staff has reviewed the utility's application for a wastewater certificate and determined that it is deficient pursuant to Rule 25-30.035, Florida Administrative Code. The following deficiencies have been noted:

1. **Tariff.** Rule 25-30.035(7), Florida Administrative Code, requires one original and two copies of a tariff, containing all rates, classifications, charges, rules, and regulations, which shall be consistent with Chapter 25-9, Florida Administrative Code. The tariff submitted with the application contains an initial connection charge of \$628.26, but does not contain the service availability policy section. Please provide tariff sheets containing the utility's service availability policy. I have attached the blank service availability sheets from the model tariff for your reference.

- ACK _____
- AFA _____
- APP _____
- CAF _____
- CMU _____
- CTR _____
- EAG _____
- LEG _____
- LIN _____
- OPC _____
- RCH _____
- SEC +
- WAS _____
- OTH _____

2. **Rates and Charges.** Rule 25-30.035(8), Florida Administrative Code, requires a statement specifying on what date and under what authority the current rates and charges were established.

A. The application states that the current rates were authorized by the Polk County Utilities Commission and have been in effect since June 1988. Also, as discussed above, the utility's proposed tariff contains a \$628.26 initial connection fee. Please provide a copy of the County's order(s) that authorized these rates and initial connection fee.

B. According to a letter the Commission received from the Polk County Utilities Department, the utility had a pending rate application that was due to be completed on August 20, 1996. Did the County adjust any of the utility's rates

DOCUMENT NUMBER-DATE

00688 JAN 21 97

REC-RECORDS/REPORTING

or charges in that rate proceeding? Additionally, please provide a copy of the order which resulted from that proceeding.

3. **Territory Description.** Rule 25-30.035(9), Florida Administrative Code, requires a description of the territory proposed to be served, using township, range and section references as specified in Rule 25-30.030(2). Although a description was provided, the description does not match your map and we need additional information to clarify the description. We have attached your territory description (Attachment B), along with your map (Attachment C.) Each territory description was numbered for reference. Also, our comments and suggestions are outlined on the description and discussed below.
 - A. After reviewing the following comments and the map, please provide an updated territory description.
 1. Territory description number 8 is described as: The North $\frac{1}{2}$ of the Northwest $\frac{1}{4}$ of the Northeast $\frac{1}{4}$ of U.S. Hwy 27, in Section 35, T. 30 S., R. 27 E., Polk County, Florida. This area is already described in description number 2 described as: The North $\frac{1}{2}$ of the Northeast $\frac{1}{4}$ of Section 35. Please explain. It would appear that description number 8 could be eliminated. (See Attachment D.)
 2. On the sixth line of territory description number 3 in Section 36 it states: thence along the shore line of said Crooked Lake to the West line of Said Section. There does not appear to be shoreline on the map. Please insert an angle and distance such as "Approximately South 47 degrees West a distance of 2,000 feet more or less", to make the description more clear.
 3. On the sixth line of territory description number 5 the approximate distance along the Easterly right-of-way of said State Road No. 25 is needed to make the description more clear.
 4. Territory description number 2 described as: The North $\frac{1}{2}$ of the Northeast $\frac{1}{4}$ of Section 35, does not agree with the territory map. This description extends Westerly of State Road No. 25; however, the map does not. Is the description correct or the map? Please explain.
 5. The map shows an area in the Northwest $\frac{1}{4}$ that is East of State Road No. 25, but there is no description for this. Please see the map.

- B. The utility is not serving the complete service area. Specifically, the area in description 1, 3, 4 and the East 950 feet of the North ½ of the Northeast 1/4 of Section 35. Please provide the following information regarding this area:
1. Who owns this property?
 2. When did Polk County originally grant it to the utility?
 3. When do you believe service will be needed in this area?
 4. How many customers or equivalent residential connections (ERCs) does this area represent?
 5. What is the current capacity in gallons per day (gpd) of your wastewater treatment plant and disposal system? What are your current wastewater flows in gpd?
 6. Does the utility have the wastewater treatment plant and disposal capacity to serve this area? If not, what would be required in terms of wastewater treatment plant capacity and disposal capacity?
 7. If the Commission does not grant the above area to the utility, would that have any negative impact on the utility?
4. **Meter Sizes.** Rule 25-30.035(13), Florida Administrative Code, requires a schedule showing the number of customers currently served, by class and meter size. The schedule provided in the application does not provide meter sizes. Please specify whether or not the customers have water meters, and provide the meter sizes if possible.

In addition to the above noted deficiencies, please provide the following additional information:

1. Do the utility's customers receive water service from another utility or private wells? If they receive water service from a utility, please provide the name of the utility.
2. According to the application, the utility has one commercial customer that is billed based upon usage. How is the commercial customer's usage determined for billing purposes (i.e., the utility reads the customer's water meter, the utility receives the water usage from the water utility, etc.?)

Mr. Kenneth J. Knowlton

January 17, 1997

Page 4

Please file an original and two copies of the service availability policy tariff sheets, and an original and five copies of the remaining information no later than May 13, 1997 with Ms. Blanca Bayo, Director, Division of Records and Reporting, 2540 Shumard Oak Boulevard, Tallahassee, FL 32399-0850. Please feel free to call Richard Redemann at (904)413-6999 or me at (904)413-7015 if you have any questions.

Sincerely,

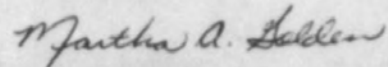

Martha A. Golden
Economic Analyst

/MAG

Attachments

cc: Division of Water and Wastewater (Hill, Williams, Messer, Redemann) w/o atch.
Division of Legal Services (Jaber, Crosby) w/o atch.
Division of Records and Reporting

NAME OF COMPANY _____
 WASTEWATER TARIFF _____

ORIGINAL SHEET NO. 16.0

SERVICE AVAILABILITY SCHEDULE OF FEES AND CHARGES

<u>DESCRIPTION</u>	REFER TO SERVICE AVAIL. POLICY <u>AMOUNT</u>	<u>SHEET NO./RULE NO.</u>
<u>Customer Connection (Tap-in) Charge</u>		
5/8" x 3/4" metered service	\$	
1" metered service	\$	
1 1/2" metered service	\$	
2" metered service	\$	
Over 2" metered service	\$	
	Actual Cost [1]	
<u>Guaranteed Revenue Charge</u>		
With Prepayment of Service Availability Charges:		
Residential-per ERC/month (___)GPD.....	\$	
All others-per gallon/month.....	\$	
Without Prepayment of Service Availability Charges:		
Residential-per ERC/month (___)GPD.....	\$	
All others-per gallon/month.....	\$	
Inspection Fee		Actual Cost [1]
<u>Main Extension Charge</u>		
Residential-per ERC (___GPD).....	\$	
All others-per gallon	\$	
or		
Residential-per lot (___foot frontage).....	\$	
All others-per front foot	\$	
Plan Review Charge		Actual Cost [1]
<u>Plant Capacity Charge</u>		
Residential-per ERC (___GPD).....	\$	
All others-per gallon	\$	
<u>System Capacity Charge</u>		
Residential-per ERC (___GPD).....	\$	
All others-per gallon	\$	

[1] Actual Cost is equal to the total cost incurred for services rendered by a customer.

EFFECTIVE DATE -
TYPE OF FILING -

 ISSUING OFFICER

 TITLE

NAME OF COMPANY _____
WASTEWATER TARIFF _____

INDEX OF SERVICE AVAILABILITY

Sheet Number

Rule Number

- Acceptance of Facilities.....
- Availability.....
- Construction of Oversized Facilities.....
- Customer Connection (Tap-in).....
- Customer Installation (Customer Maintained Lines).
- Cost Records and "As-Built" Plans.....
- Design by Independent Engineers.....
- Developer Agreements.....
- Easements and Rights-of-Way.....
- Extensions Outside Certificated Territory.....
- General Information.....
- Inspections.....
- Obligations of Developer.....
- Obligations of Utility.....
- Off-Site Facilities.....
- On-Site Facilities.....
- Refundable Advances.....
- Schedule of Fees and Charges.....
- System Design and Construction.....
- Transfer of Contributed Property - Bills of Sale..

Go to Sheet No. 16.0

ISSUING OFFICER

TITLE

NAME OF COMPANY _____

WASTEWATER TARIFF

INDEX OF SERVICE AVAILABILITY

	<u>Sheet Number</u>
Schedule of Fees and Charges.....	Go to Sheet No. 16.0
Service Availability Policy.....	22.0

ISSUING OFFICER

TITLE

NAME OF COMPANY _____

WASTEWATER TARIFF

SERVICE AVAILABILITY POLICY

ISSUING OFFICER

TITLE

Description:

Parcels or tracts of land situate, lying and being in T. 30 S., R. 27 E., Polk County, Florida, and more particularly described as follows:

- 1 The S.E.¼ of the S.E.¼ of Section 26;
- 2 The N.¼ of the N.E.¼ of Section 35;
- 3 Beginning at the Northwest corner of Section 36, T. 30 S., R. 27 E.; run thence S. 00°05'00" W. with the West line of said Section 801.90' for a point of beginning; thence S. 89°25'00" E., 1109.00'; thence S. 16°23'00" E., 1086.00' to the lake shore of Crooked Lake; thence along the shore line of said Crooked Lake to the West line of said Section; thence along said Section line N. 00°05'00" E., 2529.90', more or less to the place of beginning;

S 47° W, 2,000'
more or less

- 4 Also beginning at the Northwest corner of Section 36, T. 30 S., R. 27 E.; run thence S. 00°05'00" W. with the West line of said Section 801.90' for a point of beginning; thence N. 00°05'00" E. along said Section line 156.30'; thence S. 89°25'00" E., 20.00'; thence S. 00°05'00" W., 156.30'; thence N. 89°25'00" W., 20.00' to place of beginning; being a strip of land 20.00' wide and 156.30' long East of and parallel to the West line of said Section;

- 5 From the Northeast corner of the S.E.¼ of the N.E.¼ of the N.E.¼ of said Section 35, run Westerly along the North line of said fraction 2646.94' to the Easterly right-of-way line of State Road No. 25; thence S. 22°01'00" W. along the Easterly right-of-way of said State Road No. 25, to the Southerly boundary of Crooked Lake Park, Tract No. 1, as recorded in Plat Book 38, Page 40 of the Public Records of Polk

(a distance of approximately 2,300 feet)?
(U.S. Highway 27)

County, Florida; thence S. $56^{\circ}28'25''$ E. along said Southerly boundary 1790.00', more or less, to the shore of Lake Caloosa; thence Northeasterly along said waters edge to the East line of said Section 35; thence Northerly along said East line of Section 35 to the point of beginning.

AND

6) Beginning at the Northeast corner of the S.E. $\frac{1}{4}$ of the N.W. $\frac{1}{4}$ of the N.E. $\frac{1}{4}$ of Section 35, T. 30 S., R. 27 E., Polk County, Florida; run West 1308.76' to S.R. 25; (U.S. Highway 27) thence Northeasterly along said road 700.00' for the point of beginning; thence run Northeasterly along right-of-way 200.00'; thence East 250.00'; thence Southwesterly to a point lying 250.00' East of the P.O.B.; thence West 250.00' to the P.O.B.

AND

7) Beginning at the Northeast corner of the S.E. $\frac{1}{4}$ of the N.W. $\frac{1}{4}$ of the N.E. $\frac{1}{4}$ of Section 35, T. 30 S., R. 27 E., Polk County, Florida; thence run West 1308.76' to the Easterly right-of-way of S.R. 25; thence run Northeasterly along right-of-way 900.00' to the point of beginning; thence run N. $22^{\circ}01'00''$ E. along right-of-way 335.00'; thence S. $67^{\circ}59'00''$ E., 231.45'; thence S. $22^{\circ}01'00''$ W., 240.50'; thence West 250.00' to the P.O.B.

AND

8) The N. $\frac{1}{4}$ of the N.W. $\frac{1}{4}$ of the N.E. $\frac{1}{4}$ of U.S. Hwy. 27, in Section 35, T. 30 S., R. 27 E., Polk County, Florida.

DOCKET NO. 961478-SU

ATTACHMENT "C" of DN 00688-97
(WAW/Golden 1/17/97 letter to Crooked Lake/Knowlton
listing deficiencies; responses due 5/13/97)

CAN BE LOCATED IN SRC MAPS'
BOX C00000031114.

Section Chart

Section _____

Township _____

South Range _____

East

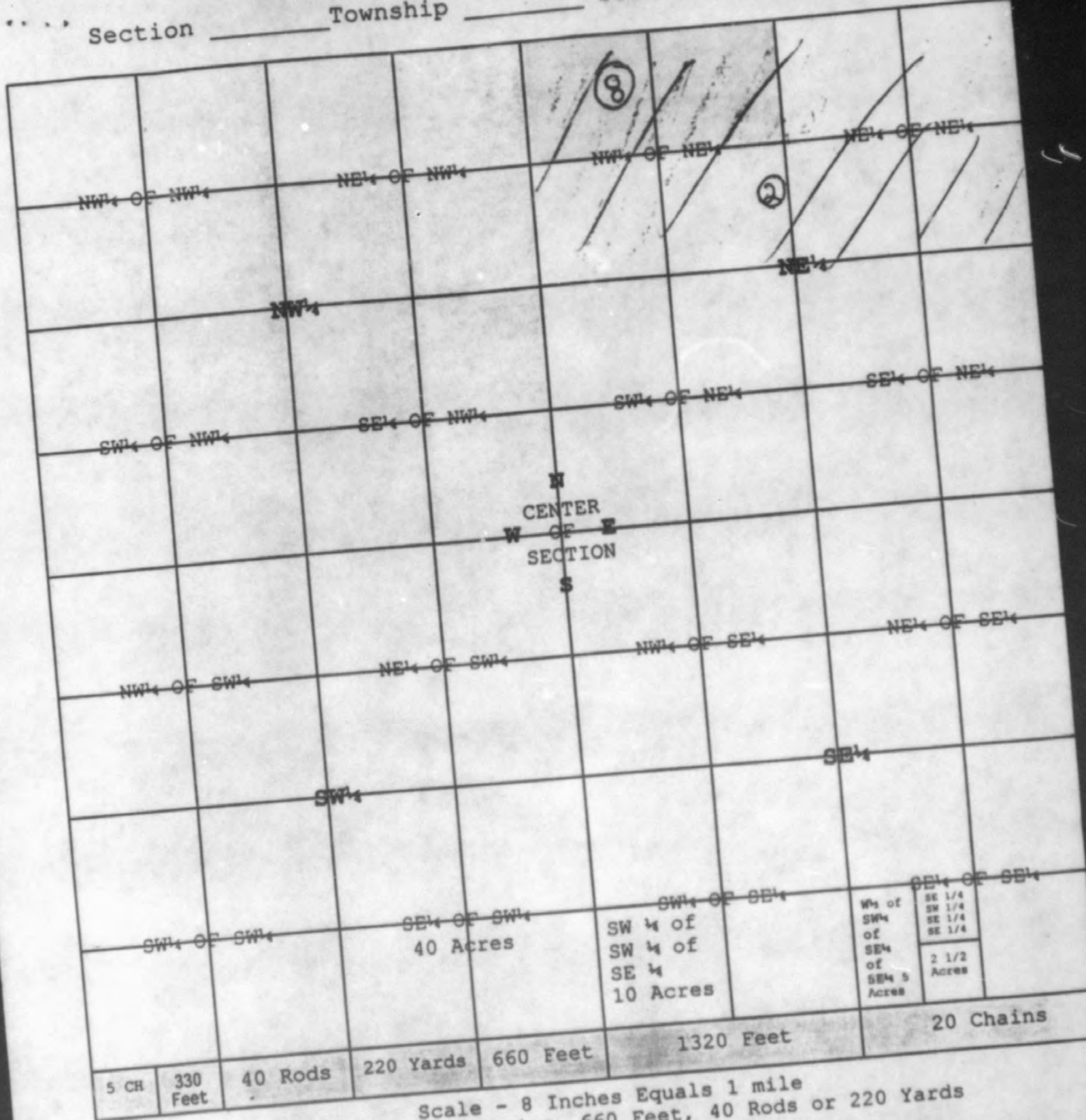

Scale - 8 Inches Equals 1 mile
1 Inch Equals 10 Chains, 660 Feet, 40 Rods or 220 Yards

One Rod = 16.5 feet; 1/4 Chain or 25 Links
One Link = 7.92 Inches;
One Chain = 66 feet, 4 Rods or 100 Links
One Mile = 5 280 feet 320 Rods or 80 Chains

Sectional Map of a Township
With Adjoining Sections