

Sam Koury
5907 Jessup Drive
Zephyrhills, FL 33540-8513
1 (813) 782-0981
June 3, 2000

ORIGINAL

Director - Division of Records and Reporting
Florida Public Service Commission
2540 Shumard Oak Boulevard
Tallahassee, FL 32399-0850

000545-145

Dear Sir:

I am writing in response to a Legal Notice referencing an Application for Original Certificate (for a utility in existence and charging rates) from Labrador Services, Inc. This corporation is currently operating a water and sewer utility in Forest Lake Estates, Zephyrhills, Fl. The Legal Notice says that any objections to the application must be made in writing to you.

The area in which Labrador Services is applying is a mobile home park, Forest Lake Estates, formerly owned and operated by Mr. Henri Viau. At the time he owned the park he supplied the water and sewer service which is now re-named Labrador Services, Inc This park is a "snowbird" park where most residents go to their homes somewhere up north for the summer. They reside in Forest Lake Estates during the six month winter season when the park is full to capacity.

The current and past service for both water and sewer provided by Henri Viau ranges from inadequate to very poor. The water quality is poor because it is not filtered and frequently is odoriferous. A glass filled from a water tap clearly shows disgusting little white particles floating in the water. The smell of the water is often so bad that it is nauseating. Most residents in this park purchased water filters in order to make the water more palatable. The home filters help with the particles but does not remove the odor. Many residents purchase bottle water for drinking and cooking. Two years ago the water was declared unfit to drink by the Department of Public Health because it contained dangerous levels of e-coli bacteria.

A water holding/pressure tank exists on the well field. This tank needs to be flushed and cleaned periodically. That has not been done. Flushing of the complete water system should be done periodically. The flushing

P
V
M
M
R
R
G
C
V
SO
EC
ER
FH

Done 6/13/00 see Pz address per post Brady.

DOCUMENT NUMBER-DATE 06/03/2000
06997 JUN-88
FPSC-RECORDS/REPORTING

has not been performed in more than a year.

The sewer system is inadequate at best. During the summer months when only about 1/2 of the residents are here two to three large tank trucks pump waste from the sewer plant weekly. During the winter months two to three large tanker trucks pump and remove sewer waste every day. This pumping and hauling of sewer waste out of the park is necessary because the sewer plant cannot handle the load generated by the residents.

Because of the overload of this inadequate sewer system there frequently is a strong smell of human waste throughout the park. During the winter months the strong smell of human waste is present almost daily. Complaints have been made without any noticeable result.

The sewer plant was initially planned to handle the original section of the park. Since its construction and operation the park expanded by 204 homes. Subsequently, Forest Lake Estates constructed and commenced operation of an RV park consisting of 274 units. This RV park is also serviced by this same sewer system. The sewer and waste plant was never upgraded to handle those 478 additions. It just can't adequately and efficiently handle the load!

In addition to the above the prospectus we agreed to when we purchased our home in this park stated that water and sewer would be provided at \$15.00 per month. That monthly cost for water and sewer should continue.

Instead of granting Labrador Services Inc. their request you should investigate Mr. Viau to determine how he can continue to operate with such inadequate and unsafe facilities.

Sincerely,

Sam Koury

attachment: Map of Park

2

Please note our address for the summer is 34660 HUNTLEY DR STERLING HTS, MICH 48312 1810 939 5379

06/03/2000

Section A 028

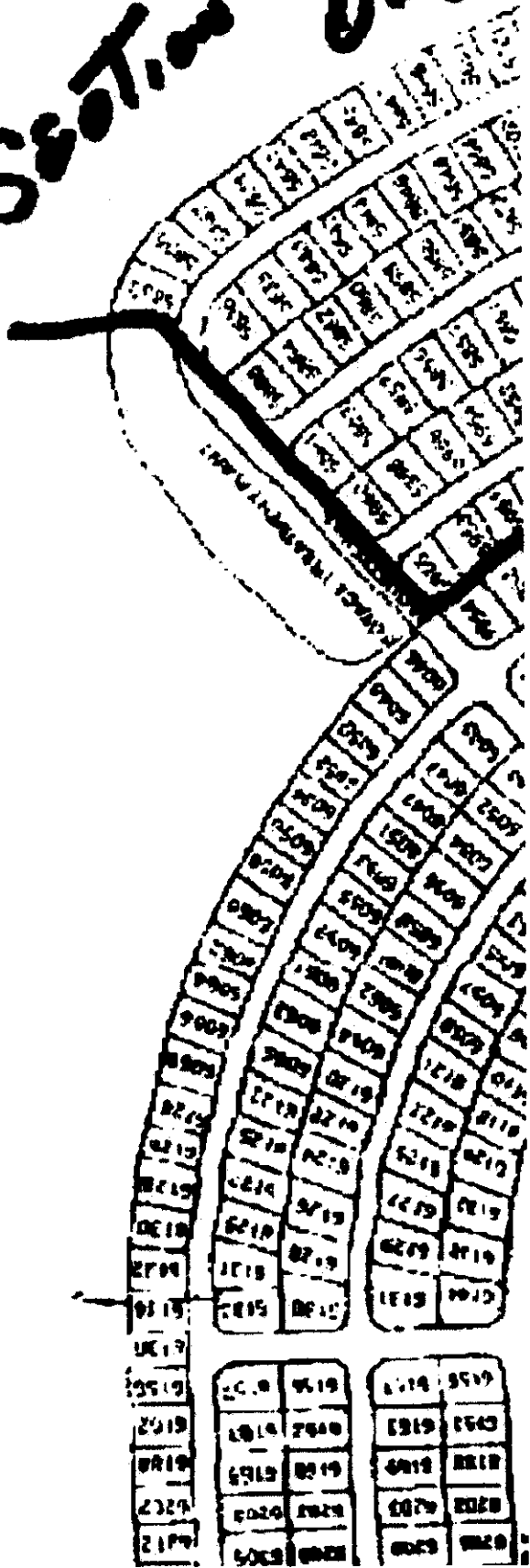

RV PARK NOT SHOWN

The table below represents the grid of parcels shown in the image. The columns are labeled with street names: KORALENE (left side) and JANUS DRIVE (right side). The rows correspond to the horizontal divisions of the grid.

KORALENE	Parcel 1	Parcel 2	JANUS DRIVE	Parcel 5
8129	5129	9129	4129	9129
2229	1229	6229	1229	8229
8729	7229	8229	4229	6229
6229	1129	8229	8229	2229
9229	6229	8229	6229	9229
7229	1929	9229	1229	9229
2029	5029	8229	4229	9229
9229	9229	8229	1229	2229
0229	0229	0229	1229	1229
1029	1029	1029	2029	1229
8029	8029	7129	2029	1229
6229	6229	8129	2129	1229
8229	1129	9129	2129	1229
0229	1129	2229	1229	1229
6229	1229	8229	6229	1229
6229	6229	8229	1229	1229
6229	8229	8229	6229	1229
2229	8229	8229	6229	1229
9229	8229	8229	6229	1229
8229	1729	8229	1229	1229
6229	6229	8229	2229	1229
1229	8229	2129	1229	1229
8229	8229	8229	1229	1229