

ORIGINAL

ROSE, SUNDBSTROM & BENTLEY, LLP

2548 BLAIRSTONE PINES DRIVE
TALLAHASSEE, FLORIDA 32301

CHRIS H. BENTLEY, P.A.
ROBERT C. BRANNAN
DAVID F. CHESTER
F. MARSHALL DETERDING
JOHN R. JENKINS, P.A.
STEVEN T. MINDLIN, P.A.
DAREN L. SHIPPY
WILLIAM E. SUNDBSTROM, P.A.
DIANE D. TREMOR, P.A.
JOHN L. WHARTON
ROBERT M. C. ROSE, OF COUNSEL
WAYNE L. SCHIEFELBEIN, OF COUNSEL

(850) 877-6555
FAX (850) 656-4029
www.rsbatorneys.com

REPLY TO ALTAMONTE SPRINGS

CENTRAL FLORIDA OFFICE
600 S. NORTH LAKE BLVD., SUITE 160
ALTAMONTE SPRINGS, FLORIDA 32701
(407) 830-6331
FAX (407) 830-8522

MARTIN S. FRIEDMAN, P.A.
VALERIE L. LORD, OF COUNSEL
(LICENSED IN TEXAS ONLY)

June 18, 2003

Ms. Blanca Bayo
Commission Clerk and Administrative Services Director
Florida Public Service Commission
2540 Shumard Oak Boulevard
Tallahassee, FL 32399

RECEIVED FPSC
JUN 20 AM 9:48
COMMISSION
CLERK

Re: Docket No. 030123-WS; Application for Transfer of Majority Organizational Control to Grenelefe Resorts, LLC, and Name Change
Our File No.: 37058.01

Dear Ms. Bayo:

Enclosed for filing in the above-referenced docket are the original and fifteen (15) copies of the Easement for Water Plant Site.

Very truly yours,



MARTIN S. FRIEDMAN
For the Firm

AUS _____
CAF _____ MSF:dmp
CMP _____ Enclosures
COM _____
CTR _____
ECR _____
GCL _____
OPC _____
MMS _____
SEC I
OTH _____

cc: Mr. Mark Waltrip (w/o enclosure)
Mr. Harry D. Stecher (w/o enclosure)
Mr. Bill Goaziou (w/o enclosure)
Mr. Mark Waltrip

DISTRIBUTION CENTER

2003 JUN 20 AM 8:46

BEFORE THE FLORIDA PUBLIC SERVICE COMMISSION

IN RE: Application for Authority
to Transfer Majority Organizational
Control of SPORTS SHINKO UTILITY, INC.
and name change to GRENELEFE RESORT
UTILITY, INC., in Polk County, Florida
to GRENELEFE RESORT, L.L.C.

DOCKET NO.: 03-0123-WS

NOTICE OF FILING

GRENELEFE RESORT, L.L.C., by and through its undersigned attorneys, hereby
notices filing in the above-referenced docket the Easement for Water Plant Site.

Respectfully submitted on this 18th day
of June, 2003, by:

ROSE, SUNDSTROM & BENTLEY, LLP
600 S. North Lake Boulevard
Suite 160
Altamonte Springs, FL 32701
PHONE: (407) 830-6331
FAX: (407) 830-8522

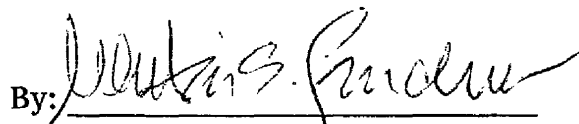
By: 
MARTIN S. FRIEDMAN

GRENELEFE CAMELOT CONDOMINIUM UNIT No 5-PHASE II:

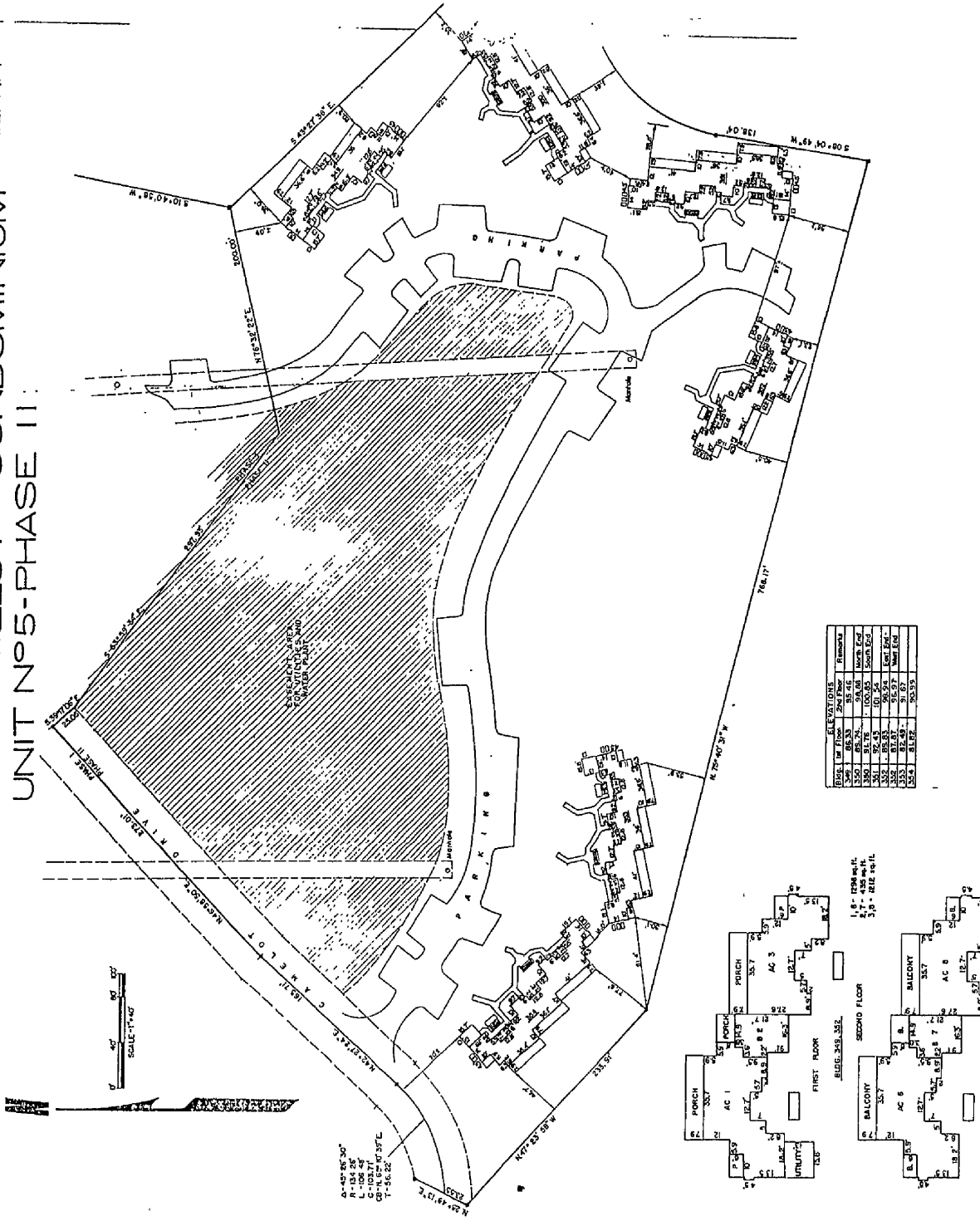

A-40' 87" 30"
L-108' 47"
C-102' 17"
T-146' 32"

FLOOR	2nd Floor	3rd Floor	4th Floor
1	100.00	100.00	100.00
2	100.00	100.00	100.00
3	100.00	100.00	100.00
4	100.00	100.00	100.00
5	100.00	100.00	100.00
6	100.00	100.00	100.00
7	100.00	100.00	100.00
8	100.00	100.00	100.00
9	100.00	100.00	100.00
10	100.00	100.00	100.00
11	100.00	100.00	100.00
12	100.00	100.00	100.00
13	100.00	100.00	100.00
14	100.00	100.00	100.00
15	100.00	100.00	100.00
16	100.00	100.00	100.00
17	100.00	100.00	100.00
18	100.00	100.00	100.00
19	100.00	100.00	100.00
20	100.00	100.00	100.00
21	100.00	100.00	100.00
22	100.00	100.00	100.00
23	100.00	100.00	100.00
24	100.00	100.00	100.00
25	100.00	100.00	100.00
26	100.00	100.00	100.00
27	100.00	100.00	100.00
28	100.00	100.00	100.00
29	100.00	100.00	100.00
30	100.00	100.00	100.00
31	100.00	100.00	100.00
32	100.00	100.00	100.00
33	100.00	100.00	100.00
34	100.00	100.00	100.00
35	100.00	100.00	100.00
36	100.00	100.00	100.00
37	100.00	100.00	100.00
38	100.00	100.00	100.00
39	100.00	100.00	100.00
40	100.00	100.00	100.00
41	100.00	100.00	100.00
42	100.00	100.00	100.00
43	100.00	100.00	100.00
44	100.00	100.00	100.00
45	100.00	100.00	100.00
46	100.00	100.00	100.00
47	100.00	100.00	100.00
48	100.00	100.00	100.00
49	100.00	100.00	100.00
50	100.00	100.00	100.00
51	100.00	100.00	100.00
52	100.00	100.00	100.00
53	100.00	100.00	100.00
54	100.00	100.00	100.00
55	100.00	100.00	100.00
56	100.00	100.00	100.00
57	100.00	100.00	100.00
58	100.00	100.00	100.00
59	100.00	100.00	100.00
60	100.00	100.00	100.00
61	100.00	100.00	100.00
62	100.00	100.00	100.00
63	100.00	100.00	100.00
64	100.00	100.00	100.00
65	100.00	100.00	100.00
66	100.00	100.00	100.00
67	100.00	100.00	100.00
68	100.00	100.00	100.00
69	100.00	100.00	100.00
70	100.00	100.00	100.00
71	100.00	100.00	100.00
72	100.00	100.00	100.00
73	100.00	100.00	100.00
74	100.00	100.00	100.00
75	100.00	100.00	100.00
76	100.00	100.00	100.00
77	100.00	100.00	100.00
78	100.00	100.00	100.00
79	100.00	100.00	100.00
80	100.00	100.00	100.00
81	100.00	100.00	100.00
82	100.00	100.00	100.00
83	100.00	100.00	100.00
84	100.00	100.00	100.00
85	100.00	100.00	100.00
86	100.00	100.00	100.00
87	100.00	100.00	100.00
88	100.00	100.00	100.00
89	100.00	100.00	100.00
90	100.00	100.00	100.00
91	100.00	100.00	100.00
92	100.00	100.00	100.00
93	100.00	100.00	100.00
94	100.00	100.00	100.00
95	100.00	100.00	100.00
96	100.00	100.00	100.00
97	100.00	100.00	100.00
98	100.00	100.00	100.00
99	100.00	100.00	100.00
100	100.00	100.00	100.00

