

AUSLEY & McMULLEN

ATTORNEYS AND COUNSELORS AT LAW

227 SOUTH CALHOUN STREET
P.O. BOX 391 (ZIP 32302)
TALLAHASSEE, FLORIDA 32301
(850) 224-9115 FAX (850) 222-7560

ORIGINAL

RECEIVED FPSC
JUL -3 PM 3:36
COMMISSION
CLERK

July 3, 2003

HAND DELIVERED

Ms. Kay Flynn, Chief
Bureau of Records and Hearing Services
Florida Public Service Commission
2540 Shumard Oak Boulevard
Tallahassee, FL 32399-0850

Re: Complaint of The Links Homeowners Association, Inc. against
Tampa Electric Company; FPSC Docket No. 021051-EI

Dear Ms. Flynn:

Enclosed is a package of information requested by the Staff during the June 18, 2003 conference call between the Staff and the parties to this proceeding. This package is accompanied by a summary of what is contained in the exhibits.

Tampa Electric believes that the Staff's assessment of this situation reflected in its April 3, 2003 recommendation to the Commission remains sound and is supported by the company's records. Tampa Electric at all times has acted in accordance with requests made on behalf of The Links subdivision. Those requests evolved through time as is always the case with the development and eventual population of a new subdivision. The company complied with the developer's request and ultimately the request made on behalf of The Links Homeowners Association itself. In this regard, Item 5 of Exhibit "B" in the enclosed materials makes clear that The Links Homeowners Association was billed for the street lighting service Tampa Electric provided at the request of Ms. Dee Anne King, the very same individual who acted on behalf of the Association as its licensed property manager in the Affidavit submitted to the Commission under Mr. Appleton's letter of May 2, 2003.

As the Staff observed in the March 20 recommendation, it is undisputed The Links has been receiving the benefits of street lighting provided by Tampa Electric during the period of time in question down through today. Tampa Electric also shares the belief that neither Tampa Electric nor its general body of customers should be made to absorb costs on account of any miscommunications between The Links and its developer. Simply put, the benefit the subdivision has received should not be subsidized by Tampa Electric or born by its other customers.

AUS
CAF
CMP
COM
CTR
ECR
GCL
OPC
MMS
SEC
OTH

RECEIVED & FILED

mas

FPSC-BUREAU OF RECORDS

DOCUMENT NUMBER-DATE

05942 JUL-3 03

FPSC-COMMISSION CLERK

During the recent conference call between the Links, Tampa Electric and the PSC Staff, a new issue was raised regarding the authority of the Links Homeowner's Association to legally take on the responsibility for the lighting agreement entered into with Tampa Electric. There can be no reasonable doubt as to the authority of the Links, as a Florida Not For Profit Corporation, to contract with Tampa Electric for lighting service and to compel the members of the Association to pay the Commission-approved tariff charges for that service. Furthermore, there can be no reasonable doubt as to the ability of a developer, prior to the transfer of control of the association to homeowners, to enter into contracts that are binding on the Association, so long as such contracts are fair and reasonable.

The Links Homeowners' Association, Inc. was incorporated on December 19, 1995 as a not for profit corporation under Chapter 617 of the Florida Statutes. Pursuant to Section 617.0302, Florida Statutes:

“Every corporation not for profit organized under this act, unless otherwise provided in its articles of incorporation or by-laws, shall have power to: ...

(7) Make contracts and incur liabilities, borrow money at such rates of interest as the corporation may determine, issue its notes, bonds and other obligations, and secure any of its obligations by mortgage and pledge of all or any of its property, franchises or income...”

Article III of the Links Articles of Incorporation, attached hereto as Exhibit D, provides, in relevant part, that:

“The Association shall have all of the powers given to corporations not for profit by the Florida Statutes and all of the powers expressly conferred upon it by the Declaration, together with all powers necessary to fulfill all such stated powers and the duties expressly given to it by such Declaration. These powers include, but are not limited to, the power to:

- A. Maintain, repair, improve and insure the Common Area as defined in the Declaration and all other real or personal property which the Association owns or which it has assumed the obligation to maintain; . . .
- B. Make and collect assessments from its members;
- C. Pay all Association expenses; . . .
- G. Enforce the terms of the Declaration, these Articles, and the By-Laws of the Association; . . .
- I. Contract for operation and maintenance services; . . .
- M. Take any other action necessary for the purposes for which the Association was formed.”

Ms. Kay Flynn
July 3, 2003
Page 3

Pursuant to Section 720.309, Florida Statutes, which deals specifically with the organization and operation of Homeowners' Associations:

“Any grant or reservation made by any document, and any contract with a term in excess of 10 years made by an association before control of the association is turned over to the members other than the developer, which provide for operation, maintenance, or management of the association or common areas must be fair and reasonable.”

In this case there can be no question as to the reasonableness or fairness of the contract involved since the “contract” is a Commission-approved tariff. In summary, the Links, as a not for profit corporation, clearly had the power to contract with Tampa Electric for lighting service and the developer clearly had the ability to bind subsequent homeowner- members of the Links with regard to a contract for the provision of outdoor lighting in the common areas of the Links subdivision.

We appreciate your assistance in connection with this matter. Should you have any questions or desire further information, please feel free to call.

Sincerely,

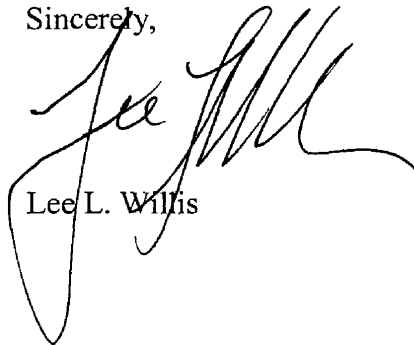
A handwritten signature in black ink, appearing to read "Lee L. Willis", written over a printed name.

Lee L. Willis

LLW/pp
Enclosure

cc: Eric N. Appleton (w/encl.)
Lorena A. Holley (w/encl.)
Connie Kummer (w/encl.)

**Tampa Electric Company's Response to
FPSC Staff Inquiry on June 18, 2003
Regarding
Complaint of The Links Homeowners Association, Inc.**

Summary of Exhibits

Exhibit A

Street Lighting Contracts for Bloomingdale AA&GG Unit 3 Phase 2 (Phase 2 of The Links subdivision)

Exhibit B

Copies of Activity File Print for Account No. 1800 0030631 showing the following:

- 1.) 7/12/96 Turn-on order for Brandon Property Owners for street lights located in The Links (Phase II) based on the lighting contract.
- 2.) 4/25/97 Change in mailing address to P.O. Box 489, Riverview, FL 335690489 based on correspondence.
- 3.) 11/19/98 Change in mailing address to Buschwood Park, Tampa, FL 336184435 based on correspondence.
- 4.) 3/2/99 Transfer of Account No. 1800 0030631 from Brandon Property Owners to Bristol Green (New Account No. 1800 0030632) Mailing address remains Buschwood Park, Tampa, FL Request was faxed.
- 5.) 3/28/01 Transfer of Account No. 1800 0030632 to The Links HOA (New Account No. 1800 0030633) at mailing address P.O. Box 1058, Ruskin, FL, 335701058 ordered by Dee Anne King.

Exhibit C

Copy of Work Order for installation of street lights for Bloomingdale AA&GG Unit 3 Phase 2

Exhibit D

Links Articles of Incorporation

Exhibit A

STREET LIGHTING CONTRACT

No. 124

THIS AGREEMENT MADE THIS 2nd day of July, 1996,

between Brandon Properties Partners, Ltd., 611 West Bay St. Tampa, Florida 33606 herein called the **Customer**, and

TAMPA ELECTRIC COMPANY, A Florida Corporation, herein called the **Company**,

WITNESSETH

That the Company, in consideration of the Customer's undertakings hereunder, including making the payments herein provided for, agrees to furnish and install, at its expense, at the locations shown on the drawing, designated as **Lighting Plan Number ~~124~~** attached hereto, the street lighting equipment described as follows, to wit:

Fifteen (15) 100 Watt HPS Cobrahead Street Lights Rate 672 on Concrete Poles Rate 607 served by underground wiring, at Bloomingdale AA&GG Unit 3 Phase 2.

The Company agrees to burn said lights approximately 4,200 hours per year and to maintain said equipment and the lines service the same in operating order at all times practicable and reasonable. The Customer agrees to pay the Company the sum of:

Rate 672/607 \$189.48 per unit per year pre-tax total.

to wit, the total sum of \$2,842.20 per annum, plus fuel adjustment and (where applicable) franchise fees and taxes. Such total sum to be payable in monthly installments for a period of not less than five (5) years after the installation is completed. Further, the Customer agrees to deposit with the Company the additional cash sum of \$500.00 which is equivalent to two (2) months service under this contract, or upon acceptance of the Company, place a surety bond or an irrevocable letter of credit, from a local bank, with the Company in the same amount. The Company will annually credit the Customer's bill with an interest amount designated and approved by the Florida Public Service Commission on a cash deposit.

This agreement shall remain in force: (1) for a term of five (5) years beginning on the date all lights are installed and burning; or (2) until such time as a Special Street Light Tax District has been legally formed, assumed all obligations of Customer permitted by law in this agreement and has collected sufficient taxes to pay Company for the continuation of the service provided for herein. The event (1) or (2) occurring first shall control. No additional lighting will be furnished except by mutual agreement of the Customer and Company.

Whenever the Company's engineers decide that the proposed installation requires that the service lines necessary to supply energy to said street lighting equipment shall be erected on private property, the Customer shall obtain, without cost to the Company, adequate written or sufficiently dedicated easements for the purpose of making said installation and maintaining same.

The Customer agrees to reimburse the Company for any expense incurred by the latter in changing the installation at the Customer's request.

Title to all equipment furnished hereunder shall remain in the Company at all times and may be removed by it at the expiration of this agreement or upon sooner termination of the same for any reason.

Payment for the deposit shall be made simultaneously with the signing of this contract. All bills shall be due

when rendered, and upon default of the payment thereof within such reasonable time, not to exceed one (1) month, as the Company may require, all obligations of the Company to perform hereunder shall forthwith terminate and it may take such legal action as may be deemed advisable because of the Customer's breach of performance

The rates and services of the Company are subject to regulation by the Florida Public Service Commission, and in the event that commission or any other regulatory body having jurisdiction in the premises, in the exercise of its lawful authority, shall order any increase or decrease in the standard rate schedules of the Company applicable to the service herein contracted for, it is distinctly understood by the Customer that such order shall apply to the rate herein specified.

The agreements herein contained shall inure to the benefits of and be binding upon the respective successors and assigns of the parties hereto.

IN WITNESS WHEREOF, the parties hereto have caused this instrument to be executed in due form required by law this 08 day of 07, 19 06.

By: 

Signed in the presence of:

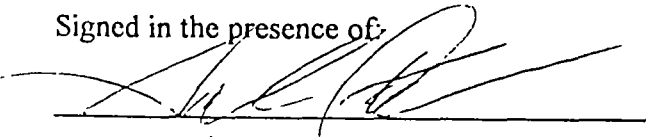

D. Kay Mills
Witnesses as to execution by the
Customer

TAMPA ELECTRIC COMPANY

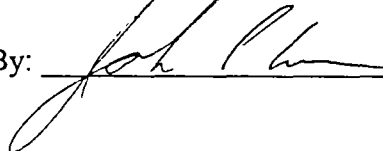
By: 

Signed in the presence of:

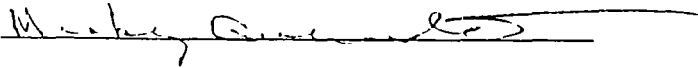

Witnesses as to execution by the
Company

Exhibit B

1800 0220471 S/O TYPE-STON SEQ-999 S/O STAT-POSTED ACTVTY DT-07/12/96 BATCH-FV81 TAKENBY-JMB ORDER DT-07/12/96 TIM
ACT CD-2 T/O-3 DT WND-06/28/96 MOVE FR-N/A NAME-DEVONSHIRE WOOD HOW C/O-
M/A-330 FLETCHER AV W #192 CITY/ST-TAMPA FL ZIP-336100000 DEP CD-6210 AMT- .00 TRANSFER FR-0012-1896
TAX-ID-CODE-3 TAX-ID-NO-**
ORD BY-S/L CONTRACT PH-0000000 RMK-TRANSF DEP FR HOLD ACCT

1800 0030471 TRANS-3001 Q-999 ACTVTY STAT-POSTED ACTVTY DT-07/12/96 BATCH-Q112 ORD DT-07/12/96 MADE BY-JMB
TRANS FLD-DEVONSHIRE WOOD SUBDIVISION APPRVD BY-
TIME-144 DT WNTD-07/12/96 CHGD BY- COMMENT- APPRVD

1800 0030551 S/O TYPE-STON SEQ-999 S/O STAT-POSTED ACTVTY DT-07/12/96 BATCH-FV81 TAKENBY-JMB ORDER DT-07/12/96 TIM
ACT CD-2 T/O-3 DT WND-05/16/96 MOVE FR-N/A NAME-LAKE ST CHARLES COMM DEV C/O-
M/A-611 WEST BAY ST CITY/ST-TAMPA FL ZIP-336060000 DEP CD-6240 AMT- 300.00 TRANSFER FR-0000-0000
TAX-ID-CODE-3 TAX-ID-NO-**
ORD BY-S/L CONTRACT PH-0000000 RMK-

1800 0030551 TRANS-3001 Q-999 ACTVTY STAT-POSTED ACTVTY DT-07/12/96 BATCH-Q112 ORD DT-07/12/96 MADE BY-JMB
TRANS FLD-DEVONSHIRE ST CHARLES MAIN BLV APPRVD BY-
TIME-1243 DT WNTD-07/12/96 CHGD BY- COMMENT- APPRVD

1800 0030631 S/O TYPE-STON SEQ-999 S/O STAT-POSTED ACTVTY DT-07/12/96 BATCH-FV81 TAKENBY-JMB ORDER DT-07/12/96 TIM
ACT CD-2 T/O-3 DT WND-07/02/96 MOVE FR-N/A NAME-BRANDON PROPERTIES PTNR C/O-
M/A-611 WEST BAY ST CITY/ST-TAMPA FL ZIP-336060000 DEP CD-6240 AMT- 1500.00 TRANSFER FR-0000-0000
TAX-ID-CODE-3 TAX-ID-NO-**
ORD BY-S/L CONTRACT PH-0000000 RMK-

1800 0030631 TRANS-3001 Q-999 ACTVTY STAT-POSTED ACTVTY DT-07/12/96 BATCH-Q112 ORD DT-07/12/96 MADE BY-JMB
TRANS FLD-BLOOMINGDALE AA&GG U2 P1 APPRVD BY-
TIME-1250 DT WNTD-07/12/96 CHGD BY- COMMENT- APPRVD

1800 0030981 S/O TYPE-STON SEQ-999 S/O STAT-POSTED ACTVTY DT-07/12/96 BATCH-FV81 TAKENBY-JMB ORDER DT-07/12/96 TIM
ACT CD-2 T/O-3 DT WND-06/11/96 MOVE FR-N/A NAME-US HOME CORP C/O-CENTRAL FLORIDA DIV
M/A-311 PARK PLACE SUITE 600 CITY/ST-CLEARWATER FL ZIP-346190000 DEP CD-6240 AMT- 200.00 TRANSFER FR-0000-0000
TAX-ID-CODE-3 TAX-ID-NO-**
ORD BY-S/L CONTRACT PH-0000000 RMK-

1800 0030981 TRANS-3001 Q-999 ACTVTY STAT-POSTED ACTVTY DT-07/12/96 BATCH-Q112 ORD DT-07/12/96 MADE BY-JMB
TRANS FLD-HEATHER LAKES UNIT 27 P 1 APPRVD BY-
TIME-1302 DT WNTD-07/12/96 CHGD BY- COMMENT- APPRVD

1800 0031011 S/O TYPE-STON SEQ-999 S/O STAT-POSTED ACTVTY DT-07/12/96 BATCH-FV81 TAKENBY-JMB ORDER DT-07/12/96 TIM
ACT CD-2 T/O-3 DT WND-06/11/96 MOVE FR-N/A NAME-US HOME CORP C/O-CENTRAL FLORIDA DIV
M/A-311 PARK PLACE SUITE 600 CITY/ST-CLEARWATER FL ZIP-346190000 DEP CD-6240 AMT- 300.00 TRANSFER FR-0000-0000
TAX-ID-CODE-3 TAX-ID-NO-**
ORD BY-S/L CONTRACT PH-0000000 RMK-

1800 0031011 TRANS-3001 Q-999 ACTVTY STAT-POSTED ACTVTY DT-07/12/96 BATCH-Q112 ORD DT-07/12/96 MADE BY-JMB
TRANS FLD-HEATHER LAKES UNIT 12 P 1 APPRVD BY-
TIME-1302 DT WNTD-07/12/96 CHGD BY- COMMENT- APPRVD

1800 0050811 S/O TYPE-STON SEQ-998 S/O STAT-POSTED ACTVTY DT-07/12/96 BATCH-9999 TAKENBY- ORDER DT-07/02/96 TIM
M/FNO 0000000672 RN BY-07/08/96
*ARK TYPE-EXTENTIN RANGE AMT- 241.85 PAY BY DT-07/02/96 RMK-FROM DISCONNECT ORDER
FLD ACT ACT-NO ACTION COLLECT AMT- .00 FC REP-99 KWH RSG- DT WND-07/12/96 EXT TO-00/00/00

M/R#051195 RETURN BY-4/12/97
 DEP BILL NO-078 CURR AMT DUE- 200.00 PAY BY DT-04/01/97 DT NEXT BILL-05/06/97 CTS DT-04/12/97
 FLD ACT ACT- COMMENT AMT- 0.00 FC REP- KWH RGG- DT WKO-00/00/00 EXT TO-00/00/00
 TIME-000 CR CODE- REASON COF- KW RGG- BATCH- CLR FEES-11/00/00
 REC BY- FR- RMK-

1791 0544790 S/O TYPE-STAT SEC-399 S/O STAT-INCOMPLETE ACTVY DT-04/21/97 BATCH-R001 TAPENEY-000 ORDER DT-04/21/97 TIME-1037
 ACT CD-1 DT WKO-04/21/97 MOVE FR-01511337915 NAME-TRAN NHAM B C/O-
 M/A- CITY/ST- ZIP- TRANSFER TO-
 M/R#057250 RATE-110 FLD ACT-LR DT WKO-04/21/97 BATCH- FLD ORD-071148619457 DMIT- RGG/FWR- KW-
 CR BY-N000 FR- RMK-

1791 0544791 S/O TYPE-STAT SEC-399 S/O STAT-READY ACTVY DT-04/24/97 BATCH-R001 TAPENEY-000 ORDER DT-04/21/97 TIME-1037
 ACT CD-1 T/O-1 DT WKO-04/21/97 MOVE FR-01511337915 NAME-TRAN NHAM B C/O-
 M/A- CITY/ST- ZIP- DEF CD-6210 AMT- .00 TRANSFER FR-000-000100-1
 M/R#057250 RATE-110 FLD ACT-LR DT WKO-04/25/97 BATCH- FLD ORD- DMIT-CMP RGG/FWR- KW-
 TAX-ID-CODE-1 TAX-ID-NO-001-17-1904
 CR BY-0000 FR- RMK-

1791 0544804 S/O TYPE-STAT SEC-399 S/O STAT-CURRENT ACTVY DT-04/24/97 BATCH-0000 TAPENEY- ORDER DT-04/21/97 TIME-0100
 M/R#059100 RETURN BY-4/12/97
 DEP BILL NO-003 CURR AMT DUE- 200.00 PAY BY DT-04/15/97 DT NEXT BILL-05/06/97 CTS DT-04/16/97
 FLD ACT ACT- COMMENT AMT- 0.00 FC REP- KWH RGG- DT WKO-00/00/00 EXT TO-00/00/00
 TIME-000 CR CODE- REASON COF- KW RGG- BATCH- CLR FEES-00/00/00
 REC BY- FR- RMK-

1791 0544830 S/O TYPE-STAT SEC-399 S/O STAT-POSTED ACTVY DT-04/25/97 BATCH-C110 TAPENEY-TNE ORDER DT-04/25/97 TIME-1038
 ACT CD-1 T/O-3 DT WKO-04/21/97 MOVE FR-N/A NAME-LANE FLAC CONDO C/O-UNIVERSITY PROPERTIES
 M/A-204 FLETCHER AV E CITY/ST-TAMPA FL ZIP-336121000 DEF CD-6220 AMT- .00 TRANSFER FR-0001-00110-1
 TAX-ID-CODE-1 TAX-ID-NO-***
 CR BY-0100 FR- RMK-

1800 0000031 TRANS-3003 C-*** ACTVY STAT-POSTED ACTVY DT-04/25/97 BATCH-1325 CRD DT-04/25/97 MADE BY-JVC
 STREET-PO BOX 449 CITY/ST-RIVERVIEW FL ZIP-335690489
 TIME-1201 DT WKO-04/25/97 CRD BY- COMMENT-BER CORESE APPROV BY-

1800 0000061 S/O TYPE-SURA SEC-100 S/O STAT-COMplete ACTVY DT-01/31/97 BATCH-F781 TAPENEY-DMB ORDER DT-01/31/97 TIME-1011
 START DATE-01/31/97 END DATE-12/31/97 ARR TYPE-MONTHLY ARR REASON-
 ARR RAK-0/PAY CURRBIOL- 2111.45 TOL PAY 215540. 1/14 MO 2/PY TOTAL TYPE BUSINESS-

1800 0000141 TRANS-3003 C-*** ACTVY STAT-POSTED ACTVY DT-04/25/97 BATCH-1425 CRD DT-04/25/97 MADE BY-LMT
 TRANS FLD-THE HERSCHE XXXX 1516 APPROV BY-
 TIME-1027 DT WKO-04/25/97 CRD BY- COMMENT- APPROV BY-

1800 0000141 TRANS-3003 C-*** ACTVY STAT-POSTED ACTVY DT-04/25/97 BATCH-1425 CRD DT-04/25/97 MADE BY-LMT
 STREET-PO BOX 2071 CITY/ST-TAMPA FL ZIP-336011071
 TIME-1047 DT WKO-04/25/97 CRD BY- COMMENT- APPROV BY-

1800 0000141 TRANS-3003 C-*** ACTVY STAT-POSTED ACTVY DT-04/25/97 BATCH-1425 CRD DT-04/25/97 MADE BY-LMT
 STREET-1702 W 80 N WHITE RD CITY/ST-TAMPA FL ZIP-336177033
 TIME-1047 DT WKO-04/25/97 CRD BY- COMMENT- APPROV BY-

1800 0000141 TRANS-3003 C-*** ACTVY STAT-POSTED ACTVY DT-04/25/97 BATCH-1425 CRD DT-04/25/97 MADE BY-LMT
 STREET-11000 11 MANOR DR CITY/ST-ORLAND SPRINGS FL ZIP-320710330

Mailing address change to P.O. Box

NAME-0010 RATE-00 FLD ACT-00 DT WAD-00/00/99 BATCH- FLD 000-0000 WSA00020 INIT- FIGS/KWH- KW-
 CRT BY-0010 F--(010)01-0000 RM-REMOVE C/F

174 004457 TRANS-0000 C-000 ACTVT. STAT-ERROR ACTVTY DT-10/29/98 BATCH-029 CRT DT-10/29/98 MADE BY-ROD
 TIME-1901 DT WADTD-10/29/98 CHG B-- COMMENT- APPROVD BY-

174 004457 TRANS-3108 C-000 ACTVT. STAT-POSTED ACTVTY DT-11/19/98 BATCH-019 CRT DT-11/19/98 MADE BY-MDJ
 TRANS FLD-10004530400 APPROVD BY- M/F#-000047
 TIME-1244 DT WADTD-11/19/98 CHG B-- COMMENT- APPROVD BY-

174 004457 TRANS-3116 C-000 ACTVT. STAT-POSTED ACTVTY DT-11/19/98 BATCH-019 CRT DT-11/19/98 MADE BY-MDJ
 TRANS FLD-20 APPROVD BY- M/F#-000047
 TIME-1207 DT WADTD-11/19/98 CHG B-- COMMENT- APPROVD BY-

174 004457 S/O TREE-STOP SEQ-000 S/C STAT-INCOMPLETE ACTVTY DT-11/12/98 BATCH-LINQ TAKENBY-RSL ORDER DT-11/12/98 TIME-1444
 ACT CI-1 T/C-1 DT WADTD-11/20/98 MOVE FR-BOOK BATCH- NAME-HERMAN DAVID A C/O-
 M/A- CITY/ST- ZIP- LEP CD-6220 AMT- .00 TRANSFER FR-0000-000000-0
 M/F-000007 RATE-110 FLD ACT-00 DT WAD-00/00/00 BATCH- FLD 000-99323MRC00005 INIT- FIGS/KWH- KW-
 TRF-IF-CODE-0 TAX-ID-N-015-00911

174 004457 S/O TREE-STOP SEQ-000 S/C STAT-READS ACTVTY DT-11/19/98 BATCH-LINQ TAKENBY-RSL ORDER DT-11/12/98 TIME-1444
 ACT CI-1 T/C-1 DT WAD-11/20/98 MOVE FR-BOOK BATCH- NAME-HERMAN DAVID A C/O-
 M/A- CITY/ST- ZIP- LEP CD-6220 AMT- .00 TRANSFER FR-0000-000000-0
 M/F-000007 RATE-110 FLD ACT-00 DT WAD-11/20/98 BATCH- FLD 000- INIT-CMP FIGS/KWH- KW-
 TRF-IF-CODE-0 TAX-ID-N-015-00911

174 004457 S/O TREE-STOP SEQ-000 S/C STAT-POSTED ACTVTY DT-11/19/98 BATCH-RING TAKENBY-CXD ORDER DT-11/16/98 TIME-1030
 ACT CI-1 T/C-1 DT WADTD-11/17/98 MOVE FR-BOOK BATCH- NAME-HERMAN DAVID A C/O-
 M/A- CITY/ST- ZIP- LEP CD-6220 AMT- .00 TRANSFER FR-0000-000000-0
 M/F-000007 RATE-110 FLD ACT-00 DT WAD-11/17/98 BATCH-AS1 FLD 000-99323MRC00005 INIT-17 FIGS/KWH-01904 KW-
 TRF-IF-CODE-2 TAX-ID-N-140-02-101
 CRT BY-0010 F--(010)01-0000 RM-REMOVE C/F CHANGE B--CXI

174 004457 S/O TREE-STOP SEQ-000 S/C STAT-POSTED ACTVTY DT-11/19/98 BATCH-RING TAKENBY-CXD ORDER DT-11/16/98 TIME-1030
 ACT CI-1 T/C-1 DT WAD-11/17/98 MOVE FR-BOOK BATCH- NAME-KOPLER CAROL ANN C/O-
 M/A- CITY/ST- ZIP- LEP CD-0210 AMT- .00 TRANSFER FR-0000-000000-0
 M/F-000007 RATE-110 FLD ACT-00 DT WAD-11/17/98 BATCH- FLD 000- INIT-CMP FIGS/KWH- KW-
 TRF-IF-CODE-2 TAX-ID-N-140-02-101
 CRT BY-0010 F--(010)01-0000 RM-REMOVE C/F CHANGE B--CXI

174 004457 TRANS-0000 C-000 ACTVT. STAT-ERROR ACTVTY DT-11/10/98 BATCH-1010 CRT DT-11/10/98 MADE BY-FRM
 NAME-INLALD FOMES LI-11-1400 REF#RPTORD TIME-00 AMT- .00 APPROVD BY-
 TIME-1104 DT WADTD-11/10/98 CHG B-- COMMENT-

174 004457 TRANS-3000 C-000 ACTVT. STAT-POSTED ACTVTY DT-11/19/98 BATCH-1010 CRT DT-11/19/98 MADE BY-JHB
 TRANS FLD-0000 BUSHWOOD PARK DR #130 CITY/ST-TAMP FL ZIP-336144435 APPROVD BY-
 TIME-1132 DT WADTD-11/19/98 CHG B-- COMMENT-REF CORRES

174 004457 TRANS-3010 C-000 ACTVT. STAT-POSTED ACTVTY DT-11/19/98 BATCH-0010 CRT DT-11/19/98 MADE BY-MKY
 TRANS FLD-0000 APPROVD BY- M/F#-000000 000000

Mailing address Chg to Bushwood Park

TAX-ID-CODE-3 TAX-ID-NO-**
ORD BY-SHIRLEY PH-1 - RMK-

1800 0013462 S/O TYPE-SRCK SEQ-998 S/O STAT-COMLETE ACTVTY DT-02/24/99 BATCH-TP99 TAKENBY-CEB ORDER DT-02/24/99 TIM
ACTION CD-A AMOUNT- 2268.21 DUE DATE-03/05/99 DT WANTD-03/05/99
ORD BY- PH- RMK-
1800 0013462 S/O TYPE-SRCK SEQ-999 S/O STAT-COMLETE ACTVTY DT-02/24/99 BATCH-TP99 TAKENBY-CEB ORDER DT-02/24/99 TIM
ACTION CD-A AMOUNT- 832.17 DUE DATE-03/05/99 DT WANTD-03/05/99
ORD BY- PH- RMK-

1800 0021992 S/O TYPE-SDIS SEQ-998 S/O STAT-INCOMPLETE ACTVTY DT-03/02/99 BATCH-9999 TAKENBY- ORDER DT-03/02/99 TIM
M/F#000000000672 RETURN BY-03/05/99
*REG FIN NOT AMT- 2017.10 PAY BY DT-03/02/99 DIS AMT- 2017.10 DIS DT-03/03/99
FLD ACT ACT- COLLECT AMT- .00 FC REP- KWH RDG- DT WKD-00/00/00 EXT TO-00/00/00
TIME-0000 CR CD(2)- REASON COP- KW RDG- BATCH- CLR RECS-00/00/00
ORD BY- PH- RMK-
1800 0021992 S/O TYPE-SDIS SEQ-999 S/O STAT-OVERDUE ACTVTY DT-02/04/99 BATCH-9999 TAKENBY- ORDER DT-02/01/99 TIM
M/F#000000000672 RETURN BY-02/04/99
*REG FIN NOT AMT- 1776.92 PAY BY DT-02/01/99 DIS AMT- 1776.92 DIS DT-02/02/99
FLD ACT ACT- COLLECT AMT- .00 FC REP- KWH RDG- DT WKD-00/00/00 EXT TO-00/00/00
TIME-0000 CR CD(2)- REASON COP- KW RDG- BATCH- CLR RECS-00/00/00
ORD BY- PH- RMK-

1800 0022712 S/O TYPE-SDIS SEQ-999 S/O STAT-INCOMPLETE ACTVTY DT-03/02/99 BATCH-9999 TAKENBY- ORDER DT-03/02/99 TIM
M/F#000000000672 RETURN BY-03/05/99
*REG FIN NOT AMT- 1547.21 PAY BY DT-03/02/99 DIS AMT- 1547.21 DIS DT-03/03/99
FLD ACT ACT- COLLECT AMT- .00 FC REP- KWH RDG- DT WKD-00/00/00 EXT TO-00/00/00
TIME-0000 CR CD(2)- REASON COP- KW RDG- BATCH- CLR RECS-00/00/00
ORD BY- PH- RMK-

1800 0023422 S/O TYPE-SDIS SEQ-999 S/O STAT-INCOMPLETE ACTVTY DT-03/02/99 BATCH-9999 TAKENBY- ORDER DT-03/02/99 TIM
M/F#000000000672 RETURN BY-03/05/99
*REG FIN NOT AMT- 839.53 PAY BY DT-03/02/99 DIS AMT- 453.77 DIS DT-03/03/99
FLD ACT ACT- COLLECT AMT- .00 FC REP- KWH RDG- DT WKD-00/00/00 EXT TO-00/00/00
TIME-0000 CR CD(2)- REASON COP- KW RDG- BATCH- CLR RECS-00/00/00
ORD BY- PH- RMK-

1800 0023502 S/O TYPE-SDIS SEQ-999 S/O STAT-INCOMPLETE ACTVTY DT-03/02/99 BATCH-9999 TAKENBY- ORDER DT-03/02/99 TIM
M/F#000000000672 RETURN BY-03/05/99
*REG FIN NOT AMT- 1593.96 PAY BY DT-03/02/99 DIS AMT- 1593.96 DIS DT-03/03/99
FLD ACT ACT- COLLECT AMT- .00 FC REP- KWH RDG- DT WKD-00/00/00 EXT TO-00/00/00
TIME-0000 CR CD(2)- REASON COP- KW RDG- BATCH- CLR RECS-00/00/00
ORD BY- PH- RMK-

1800 0030631 S/O TYPE-STOF SEQ-999 S/O STAT-READY ACTVTY DT-03/02/99 BATCH-TCCA TAKENBY-KJW ORDER DT-03/02/99 TIM
ACT CD-1 DT WANTD-03/03/99 NCO/CONF-N REM PREM- C/O- M/A
CITY/ST- ZIP- TRANSFER TO-
ORD BY-NCO PH-1 - RMK-

1800 0030632 S/O TYPE-STON SEQ-999 S/O STAT-READY ACTVTY DT-03/02/99 BATCH-TCCA TAKENBY-KJW ORDER DT-03/02/99 TIM
ACT CD-1 T/O-1 DT WND-03/03/99 MOVE FR-FAX NAME-BRISTOL GREEN HOA C/O-
M/A-3550 BUSCHWOOD PARK DR #135 CITY/ST-TAMPA FL ZIP-336180000 DEP CD-6240 AMT 1500.00 TRANSFER FR-0000-0000

1800 0030632 TRANS-5411 Q-999 ACTVY STAT-POSTED ACTVY DT-03/28/01 BATCH-Q128 ORD DT-03/28/01 MADE BY-SRD
 TRANS FLD- 16.00CR APPRVD BY-
 TIME-1515 DT WANTD-03/28/01 CHGD BY- COMMENT-BILLED IN ERROR/CORRECTING APPRVD
 1800 0030632 TRANS-5450 Q-999 ACTVY STAT-POSTED ACTVY DT-03/28/01 BATCH-Q128 ORD DT-03/28/01 MADE BY-SRD
 TRANS FLD- 460.82CR APPRVD BY- JE-05901 REAS-53
 PAR-1582414199158 AMT- 460.82 FAF- AMT-
 FAF- AMT-
 TIME-1512 DT WANTD-03/28/01 CHGD BY- COMMENT-15 LIGHTS/POLES BILLED HERE IN ERROR SINCE 3/99/REF STCY APPRVD
 1800 0030632 S/O TYPE-STOF SEQ-999 S/O STAT-POSTED ACTVY DT-03/28/01 BATCH-CI&A TAKENBY-SRD ORDER DT-03/28/01 TIM
 ACT CD-1 DT WANTD-02/23/01 NCO/CONP- REM PREM- C/O- M/A-
 CITY/ST- ZIP- TRANSFER TO-
 ORD BY-MIKE SHANNON PH-(000)000-0000 RMK-BILLED IN ERROR SINCE 3/99//SHB THE LINKS HOA/CORRECTING

 1800 0030633 S/O TYPE-STON SEQ-999 S/O STAT-POSTED ACTVY DT-03/28/01 BATCH-CI&A TAKENBY-SRD ORDER DT-03/28/01 TIM
 ACT CD-1 T/O-1 DT WND-02/23/01 MOVE FR-NA NAME-THE LINKS HOA C/O-DEE ANNE KING
 M/A-PO BOX 1058 CITY/ST-RUSKIN FL ZIP-335701058 DEP CD-6220 AMT- .00 TRANSFER FR-0000-0000
 TAX-ID-CODE-3 TAX-ID-NO-***
 ORD BY-DEE ANNE KING PH-(813)645-1569 RMK-BRISTOL BILLED ON DIGIT 1 IN ERROR/LINKS RESP SINCE 3/99/CUST AWAKE CHANGE B

 1800 0030981 S/O TYPE-STOF SEQ-999 S/O STAT-POSTED ACTVY DT-03/28/01 BATCH-CI&A TAKENBY-SRD ORDER DT-03/28/01 TIM
 ACT CD-1 DT WANTD-02/23/01 NCO/CONP- REM PREM- C/O- M/A-
 CITY/ST- ZIP- TRANSFER TO-
 ORD BY-HCBCC PH-(000)000-0000 RMK-MEMO FR MESSERSMITH/COUNTY BILLING CUSTOMER SINCE 10/99//BPCO

 1800 0031011 TRANS-3537 Q-999 ACTVY STAT-POSTED ACTVY DT-03/28/01 BATCH-Q128 ORD DT-03/28/01 MADE BY-SRD
 ADD ACCOUNT CHG ACCOUNT DEL ACCOUNT X MAST ACCOUNT 0000000000{ NMST ACCOUNT 0000000000{
 TIME-1012 DT WANTD-03/28/01 CHGD BY- COMMENT- APPRVD
 1800 0031011 S/O TYPE-STOF SEQ-999 S/O STAT-POSTED ACTVY DT-03/28/01 BATCH-CI&A TAKENBY-SRD ORDER DT-03/28/01 TIM
 ACT CD-1 DT WANTD-02/23/01 NCO/CONP- REM PREM- C/O- M/A-
 CITY/ST- ZIP- TRANSFER TO-
 ORD BY-HCBCC PH-(000)000-0000 RMK-BPCO/PER MEMO FR MESSERSMITH HCBCC BILLING CUSTOMER SINCE 10/99

 1800 0038531 TRANS-3537 Q-999 ACTVY STAT-POSTED ACTVY DT-03/28/01 BATCH-Q128 ORD DT-03/28/01 MADE BY-SRD
 ADD ACCOUNT CHG ACCOUNT DEL ACCOUNT X MAST ACCOUNT 0000000000{ NMST ACCOUNT 0000000000{
 TIME-1016 DT WANTD-03/28/01 CHGD BY- COMMENT- APPRVD
 1800 0038531 S/O TYPE-STOF SEQ-999 S/O STAT-POSTED ACTVY DT-03/28/01 BATCH-CI&A TAKENBY-SRD ORDER DT-03/28/01 TI
 ACT CD-1 DT WANTD-02/23/01 NCO/CONP- REM PREM- C/O- M/A-
 CITY/ST- ZIP- TRANSFER TO-
 ORD BY-HCBCC PH-(000)000-0000 RMK-BPCO/PER MEMO FR MESSERSMITH HCBCC BILLING CUSTOMER SINCE 10/99

 1800 0046632 S/O TYPE-SCRA SEQ-999 S/O STAT-COMPLETE ACTVY DT-03/20/01 BATCH-LINQ TAKENBY-MCL ORDER DT-03/20/01 TI
 START DATE-03/20/01 DROP DATE-00/00/00 ARR TYPE-WEEKLY ARR REASON-
 ARR RMK- TYPE BUSINESS-
 ARR AMT- 253.44 BY-04 03 01
 ORD BY-BARBARA RUSHING PH-(813)932-8488 RMK-

 1800 0046811 S/O TYPE-SCRA SEQ-999 S/O STAT-COMPLETE ACTVY DT-03/20/01 BATCH-LINQ TAKENBY-MCL ORDER DT-03/20/01 TI
 START DATE-03/20/01 DROP DATE-00/00/00 ARR TYPE-WEEKLY ARR REASON-
 ARR RMK- TYPE BUSINESS-

Exhibit C

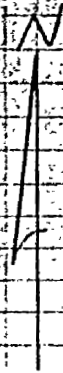

Culbreath Rd.

Site →

DeJure Ct.

Culbreath Cove

V.O.

TAMPA
ELECTRIC
CO. ENERGY COMPANY
1911 PALM ST.

THIS WORK ORDER HAS BEEN DESIGNED IN
COMPLIANCE WITH TAMPA ELECTRIC CO.
CONSTRUCTION STANDARDS AND/OR THE
NATIONAL ELECTRICAL SAFETY CODE.

BY _____ DATE _____

BLOOMINGDALE

RANGE 20 E. T. 21 N. S. 22

RANGE 21 E. T. 21 N. S. 22

7

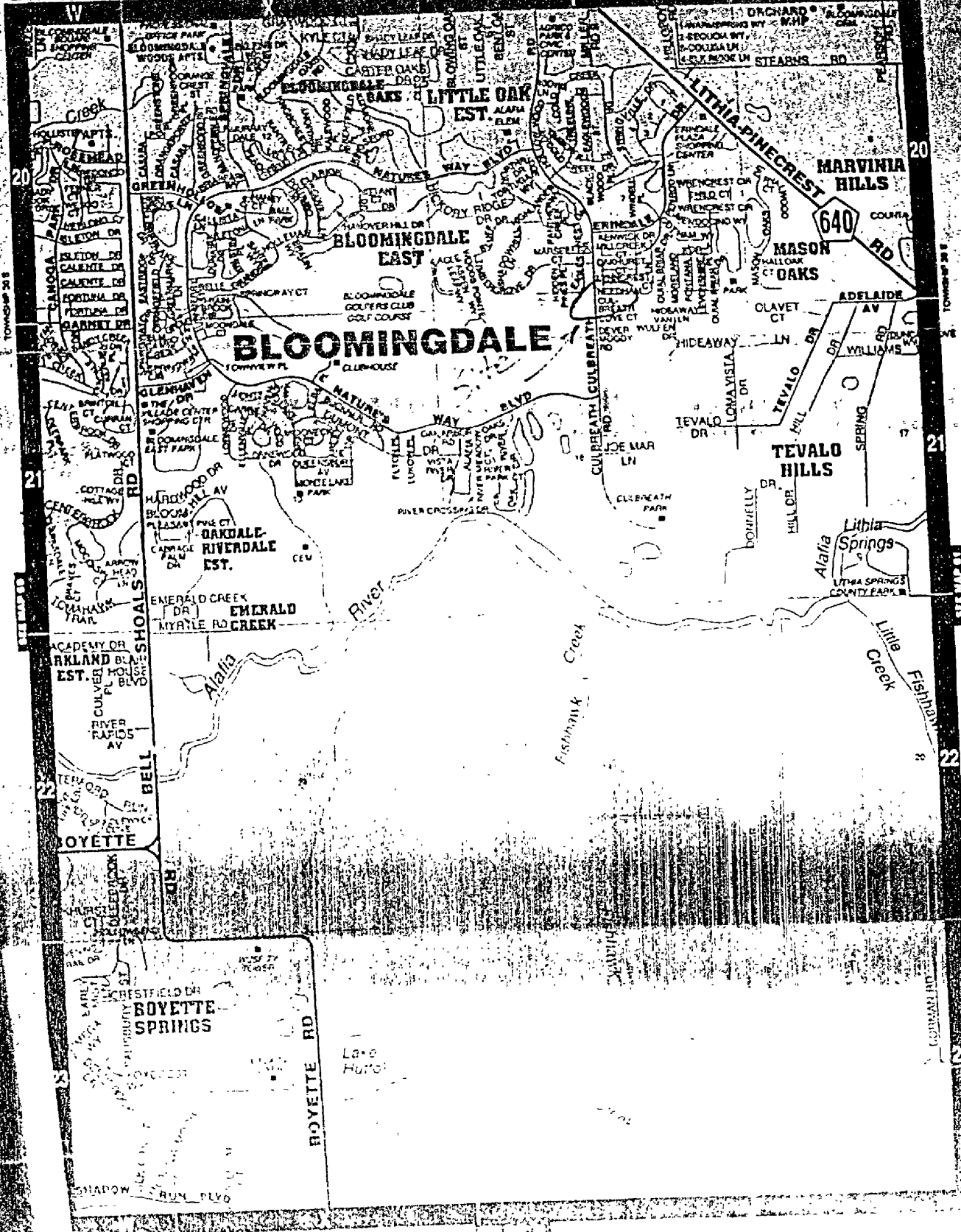

BLOOMINGDALE

MARVINIA HILLS

MASON OAKS

TEVALO HILLS

BOYETTE SPRINGS

PERMIT # R1002887

HILLSBOROUGH COUNTY
RIGHT - OF - WAY USE PERMIT

Date: 6-5-96

Mtr. Service Unit #: _____

Name of Road Culbreath Rd. Sec. _____ Twp. _____ Rge. _____

Location: Culbreath Rd. north of Culbreath Cove

Will the proposed utility installation be within the limits of a proposed County Project?
No Yes _____ CIP# _____

If Yes, what type? Road Improvement Water/Wastewater Improvement Stormwater
 Scenic Corridor Intersection Improvement Other _____

Will the proposed facility be dedicated to the County? No Yes _____
Access Connection? No Yes If yes, what type? Type I Type II Type III _____

Permission is hereby granted to Tampa Electric Company
Address P.O. Box 111 Tampa, FL 33601 Telephone # 228-4704 for the construction and
maintenance of Directional bore new underground conduit w/ cable to serve Bloomingdale Unit 3 Phase 2

Subject to the following conditions:

1. The applicant declared that prior to filing this application that he has ascertained the location of all existing utilities both aerial and underground and the accurate locations are shown on the plans. As letters of notification were mailed on 6-5-96 to the following utilities/municipalities: Hillsborough County Utilities, General Telephone and Time Warner Cable
2. The construction and maintenance of such utility shall not interfere with the property and rights of a prior occupant.
3. All work shall be done in keeping with standards approved by the County Engineer of Hillsborough County, Florida, and under the supervision of said County Engineer or representative.
4. All materials and equipment shall be subject to inspection by said County Engineer or representative.
5. All construction shall be performed in a manner meeting the approval of the County Engineer of Hillsborough County and to Safety Standards as prescribed by Manual on Uniform Traffic Control Devices and Hillsborough County shall be relieved of all responsibility from damage of any nature arising from issuance of this permit.
6. It is understood and agreed that the rights and privileges herein referred to are granted only to the extent of the County's public utility and interest in the same. The permittee shall be liable for any damage to the property and rights of the County, its employees, or the public from the construction, maintenance, or operation of the utility or attempted exercises by said permittee of the aforesaid rights and privileges.
7. All Hillsborough County property and/or rights-of-way shall be restored to original condition as far as practicable and meeting the approval of the County Engineer or representative.
8. All overhead installations shall conform to clearance standards of the Florida Department of Transportation (FDOT), and all underground crossing installations shall be installed at a minimum depth of thirty-six (36) inches below the pavement at least thirty (3) inches below ditch grade. Cable TV and communication lines shall be installed a minimum of twenty-four (24) inches below existing grade. Exceptions may be made in special cases by authority from the County Engineer or representative.
9. The attached sketch or sets of plans covering details of this installation shall be made a part of this permit.

HILLSBOROUGH COUNTY

Florida

Office of the County Administrator
Daniel A. Kleiman

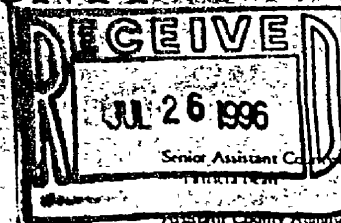

Senior Assistant County Administrator

Assistant County Administrators

Edwin Hunsaker
Cressa Johnson
Janice Keel
Robert Taylor

COUNTY COMMISSIONERS

Chairman
C. J. ...
C. J. ...
C. J. ...
C. J. ...
C. J. ...



PERMIT APPROVAL

Permit Number: RW002887

Applicant: TAMPA ELECTRIC COMPANY

P.O. Box 111

TAMPA, FLORIDA 33601

Name of Road: CULBREATH ROAD

Approved: X Disapproved: _____

Comments: PER PLAN.

Special Conditions: _____ Fee: \$120⁰⁰

1) Notify SOUTH Service Unit, Phone Number 871-7619 forty-eight (48) hours in advance of starting construction and again immediately upon completion.
Contact person: CHUCK JOHNSON

2) Prior to an open cut or jack & bore operation a twenty-four (24) hour notice must be given to the above referenced maintenance unit.

3) A copy of this approval must be submitted to the above referenced maintenance unit.

4) All work is to be in accordance with the Hillsborough County Utility Accommodation Survey and the Manual of Traffic Control and Safe Practices.

Approval Date: 7-3-96

Signed: _____

EDWIN HUNSAKER II



WORK ORDER (TEST) ESTIMATE SHEET (1/1/85)

W.O. # 1633615 TASK # 28 DATE OF ESTIMATE 2/6/2015

LOCATION Delaware Ct / SW of Cr (Blng. AA/GG Unit 3 Ph. 2)
TASK DESC Install 3 pulls of male tape from energized source

STATUS PR MATERIAL TYPE R/A WORK ORDER PRIORITY 61 REQ'D DATE _____
ENGR. OR MADE BY LEP ENGR. APPROVED BY _____

JOB PREP TYPE A ORG. LOCATION (OPT.) _____ BEN. LOCATION (OPT.) _____ PERF. LOCATION (OPT.) _____
AREA ESA REF. NUMBER _____ REF. DATE _____ PROJECT NO. _____

GRID NUMBER 3238 ENG. EST. TIME _____ ENG. EST. DATE _____
CUSTOMER NAME Blng. AA/GG Unit 3 Ph. 2 CUSTOMER PHONE _____

PURPOSE _____

INSTRUCTIONS _____

JUNO (Y/N/C-D) _____
PERMITS (Y/N/C-D) _____

	EASEMENT	PAYMENT	CANDY	RE-IMBURSE	HEAVY TRAF	SWITCHING	VOLT CURF	METER DEPT	3 - GROUND	4 - POLE HAUL OUT	5 - POLE PULL	6 - POLE HAUL IN	7 - SERVICES	8 - METERS SET	9 - TREE TRIM
	<input checked="" type="checkbox"/>	<input checked="" type="checkbox"/>	<input type="checkbox"/>	<input checked="" type="checkbox"/>	<input type="checkbox"/>	<input type="checkbox"/>	<input type="checkbox"/>	<input type="checkbox"/>	<input checked="" type="checkbox"/>	<input checked="" type="checkbox"/>	<input type="checkbox"/>	<input type="checkbox"/>	<input type="checkbox"/>	<input type="checkbox"/>	<input type="checkbox"/>

PRIMARY CKT - SUB 1633615
RELATED CKT - SUB _____
SCHOOL TAX DIST (5) _____ ADD. OHP _____ OHS _____ UGP _____ UGS _____
REM OHP _____ OHS _____ UGP _____ UGS _____

MAT. REQUIRED DATE _____ STORE FROM _____ W.O. TYPE _____

ACCTS. APPROVED _____
CODE _____

INSTALL PMT & SEC 2500 PMT
8-20-76

P.M.
10.16 AC CABLE

P.M.T.
50 KVA

(3)

60
125
310
340
320
280
770
237
105

2547
35 - make up
2582
130
2712

CRABS - INS. BUSH

6 Tap - 500 mm
4.1. 6 x 3 - 18

9 Tap - 500 mm

500 mm

SEC CABLE

40

240
210

2540

2400

WO#

WORK ORDER RESOURCES

SHEET OF

CODE	GRID #/RESOURCE NAME	POLE #/QUANTITY	USE	AMOUNT	FUNCTION/DESCRIPTION
09	B 3197832230	3			CNE
10	A PK451ASN	1	IN		CNE
11	A PK411E	2	FM		CNE
12	A FAULT/PA	1	IN		
13					
14					
15	B 3204938863	4			CNE
16	A PK451ASN	1	IN		CNE
17	A PK411E	2	FM		CNE
18	A FAULT/PA	1	IN		
19					
20					
21	B 3208033858	5			CNE
22	A PK451ASN	1	IN		CNE
23	A PK411E	2	FM		CNE
24	A FAULT/PA	1	IN		
25					
26					
27		6			CNE
28			IN		CNE
29			FM		CNE
30			IN		CNE
31			FM		CNE
32					
33					
34					
35					
36					
37					
38					
39					
40					



WORK ORDER
(EST) ESTIMATE SHEET (457 (1) 794)

W.O. # 458368 TASK # 121 DATE OF ESTIMATE 082096

LOCATION Delaware Ct/ Swift Cir

TASK DESC. Install Pri & Sec Cable & PMTs

STATUS PR MATERIAL TYPE R WORK ORDER PRIORITY 61 REQ'D DATE

JOB PREP TYPE A ENGR. OR MADE BY LEP ENGR. APPROVED BY

AREA ESA ORIG. LOCATION (OPT) BEN. LOCATION (OPT) PERF. LOCATION (OPT)

GRID NUMBER 3238 REF. NUMBER REF. DATE PROJECT NO.

ENG. EST. TIME ENG. EST. DATE

CUSTOMER NAME Bldg. AHSS Unit 3 Ph 2 CUSTOMER PHONE

PURPOSE

INSTRUCTIONS

JUNO (Y/N/C-CD)

PERMITS (Y/N/C-CD)

EASEMENT	<input checked="" type="checkbox"/>	3 - GROUND
PAYMENT	<input checked="" type="checkbox"/>	4 - POLE HAUL OUT
CANDY	<input checked="" type="checkbox"/>	5 - POLE PULL
RE-IMBURSE	<input checked="" type="checkbox"/>	6 - POLE HAUL IN
HEAVY TRAF	<input type="checkbox"/>	7 - SERVICES
SWITCHING	<input type="checkbox"/>	8 - METERS SET
VOLT CURR	<input type="checkbox"/>	9 - TREE TRIM
METER DEPT	<input type="checkbox"/>	

TASK		
#	R/Y/N	#
<input type="checkbox"/>	<input type="checkbox"/>	<input type="checkbox"/>
<input type="checkbox"/>	<input type="checkbox"/>	<input type="checkbox"/>
<input type="checkbox"/>	<input type="checkbox"/>	<input type="checkbox"/>
<input type="checkbox"/>	<input type="checkbox"/>	<input type="checkbox"/>
<input type="checkbox"/>	<input type="checkbox"/>	<input type="checkbox"/>
<input type="checkbox"/>	<input type="checkbox"/>	<input type="checkbox"/>
<input type="checkbox"/>	<input type="checkbox"/>	<input type="checkbox"/>
<input type="checkbox"/>	<input type="checkbox"/>	<input type="checkbox"/>
<input type="checkbox"/>	<input type="checkbox"/>	<input type="checkbox"/>
<input type="checkbox"/>	<input type="checkbox"/>	<input type="checkbox"/>

PRIMARY CKT - SUB

RELATED CKT - SUB

HOQ TAX DIST ADD OHP

REQUIRED DATE STORE ROOM

CODE	GRID #	RESOURCE NAME	POLE #	ACTION DESCRIPTION

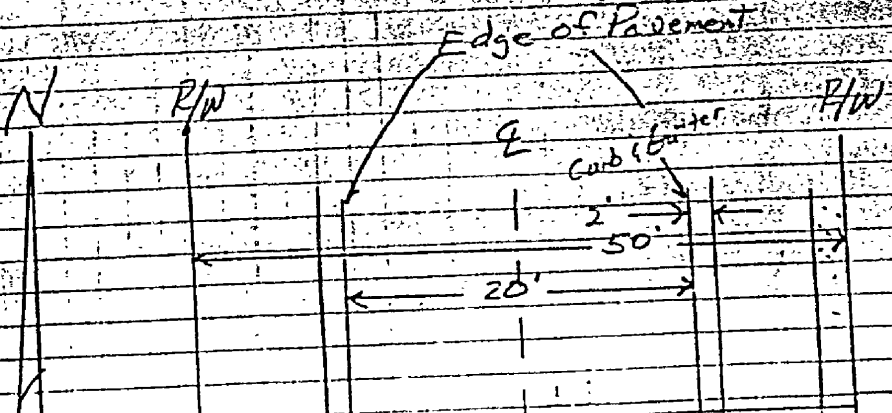

Duncombe Dr

TECO PMT

4' CONC. SW

4'

0.
 STAMPA
 REFERENCE

THIS WORK ORDER IS SUBJECT TO THE
 COMPLIANCE WITH THE REGULATIONS OF
 CONSTRUCTION STANDARDS AND
 REGULATIONS OF THE CITY OF

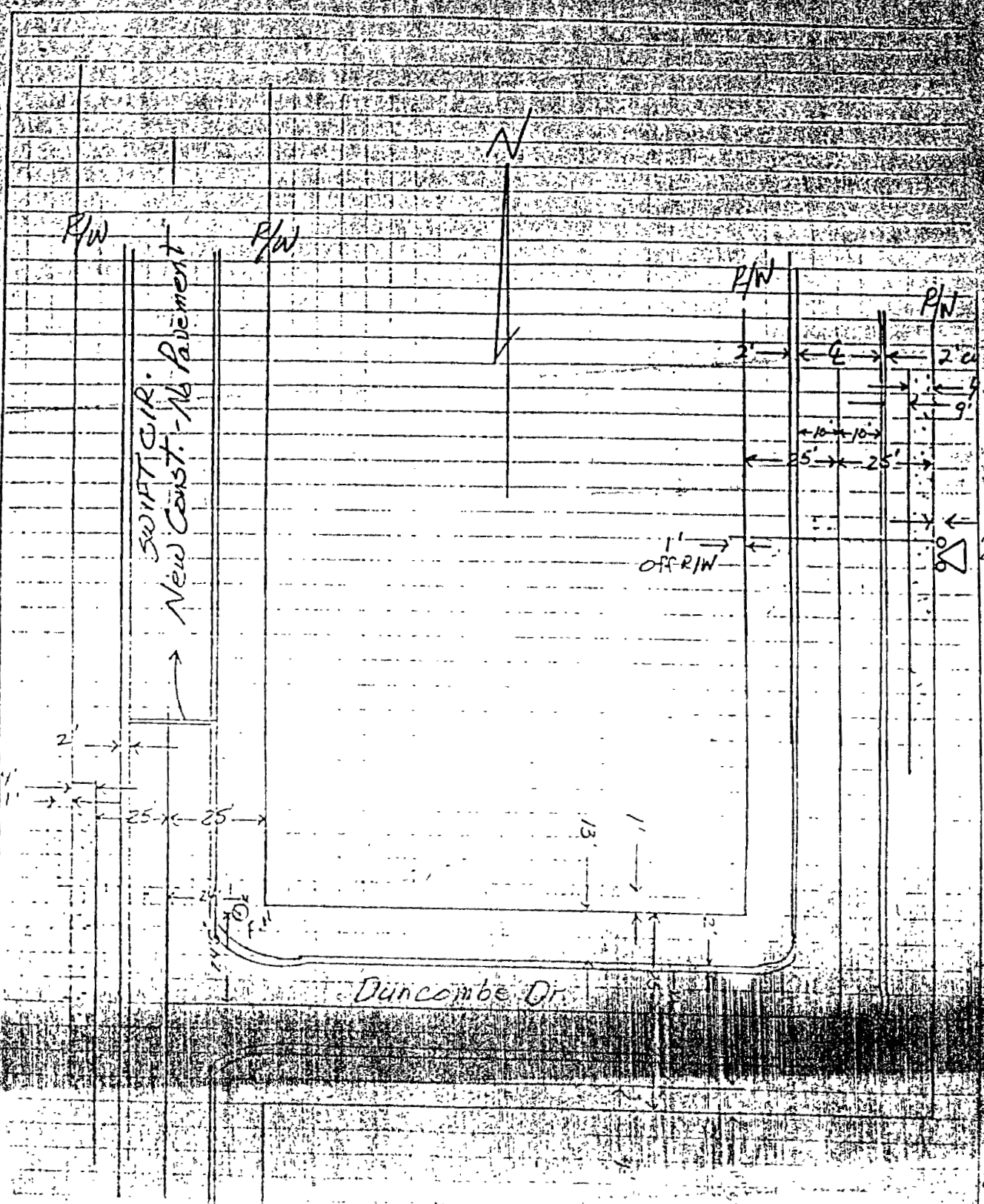

1.0. L5E325-77

TAMPA
ELECTRIC
COMPANY

THIS WORK ORDER HAS BEEN DESIGNED IN COMPLIANCE WITH TAMPA ELECTRIC CO. CONSTRUCTION STANDARDS AND/OR THE NATIONAL ELECTRICAL SAFETY CODE

N

New Const.
50/1FT PIP

End of Property

R/W

R/W

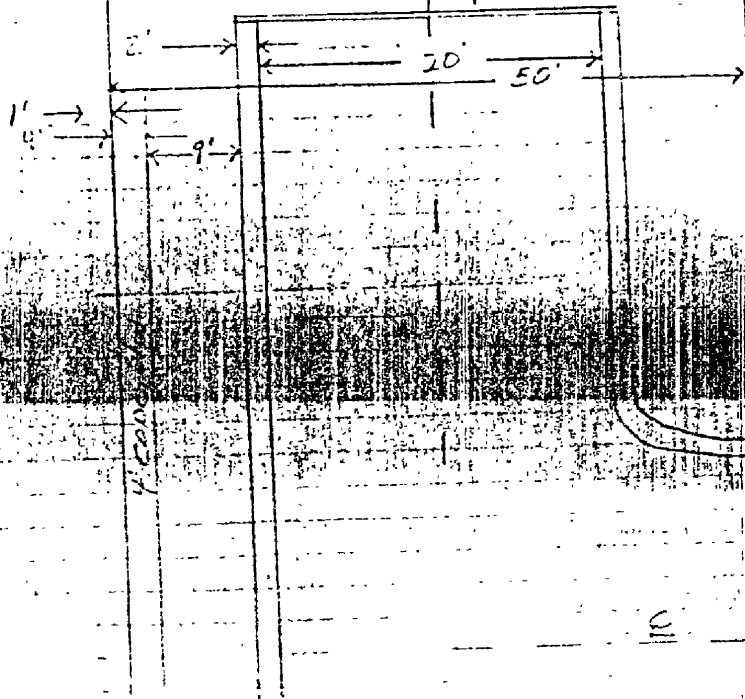

N.O.

TAMPA ELECTRIC

THIS WORK ORDER HAS BEEN DESIGNED IN COMPLIANCE WITH TAMPA ELECTRIC CO. CONSTRUCTION STANDARDS AND THE NATIONAL ELECTRICAL SAFETY CODE.

Looking North

R/W

R/W

R/W

R/W

500-4-Cir

Duncombe Dr

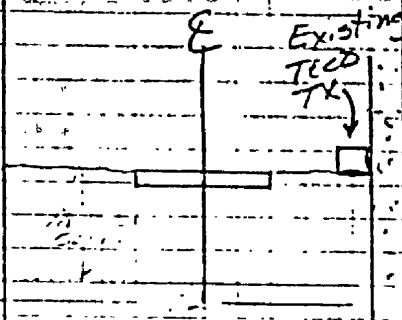
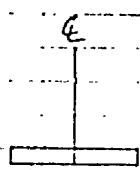

Duncombe Dr

W.O.

TAMPA
ELECTRIC
A SERVICE COMPANY

THIS WORK ORDER HAS BEEN DESIGNED IN
COMPLIANCE WITH TAMPA ELECTRIC CO
CONSTRUCTION STANDARDS AND/OR THE
NATIONAL ELECTRICAL SAFETY CODE

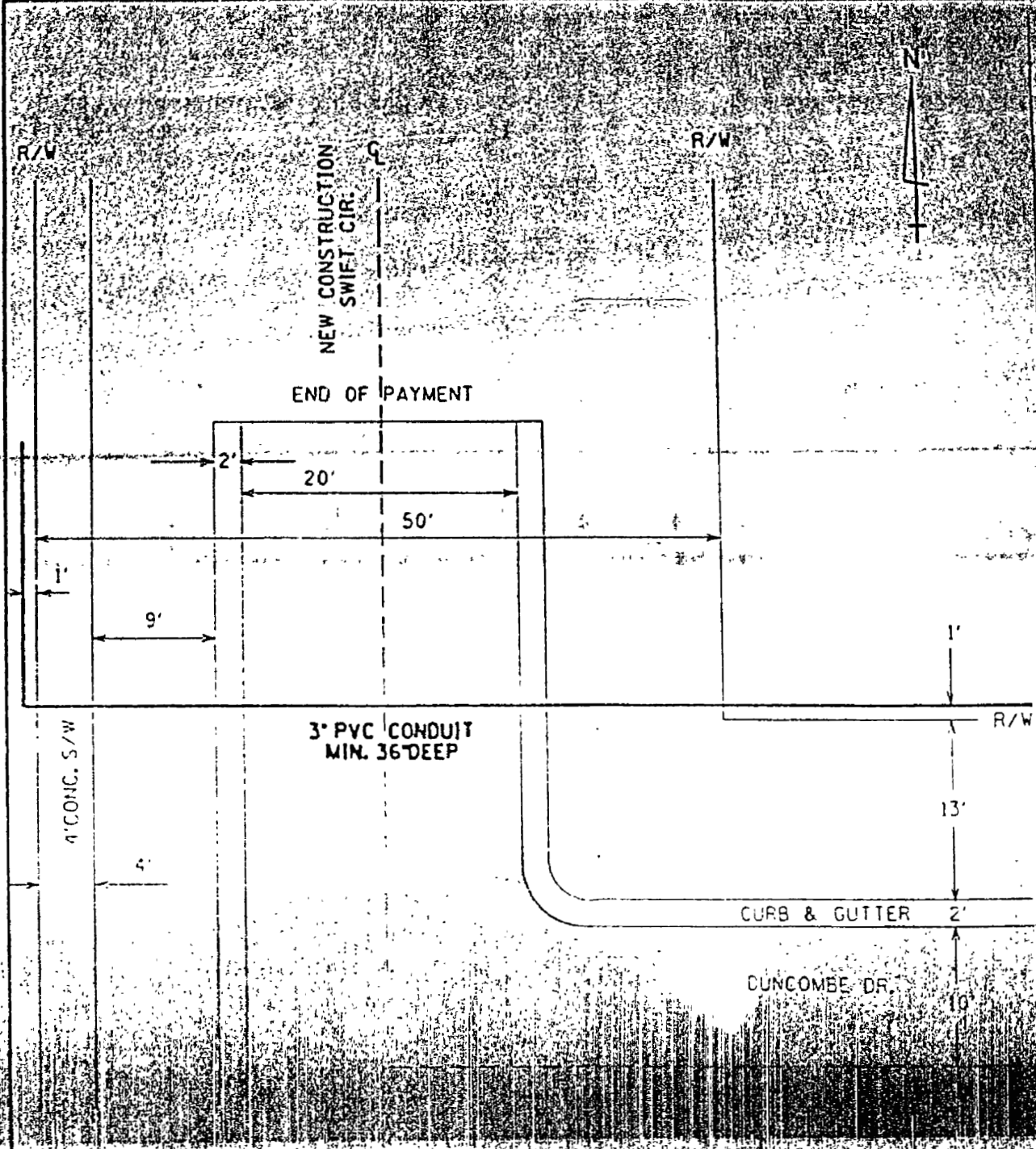

S. R. SECTION STATE RD. NO. COUNTY HILLSBOROUGH

APPLICATION TO INSTALL, OPERATE AND MAINTAIN A 7620 VOLT SINGLE PHASE, 60 CYCLE DISTRIBUTION LINE ALONG AND/OR ACROSS INDICATED COUNTY ROAD

W. O. L58365
 TAMPA
 ELECTRIC
 A FLORIDA SERVICE COMPANY

BLOOMINGDALE AA&GG
 UNIT 3 PHASE 2

PROPOSED CONSTRUCTION DATE
 REG. NO.
 B. J.

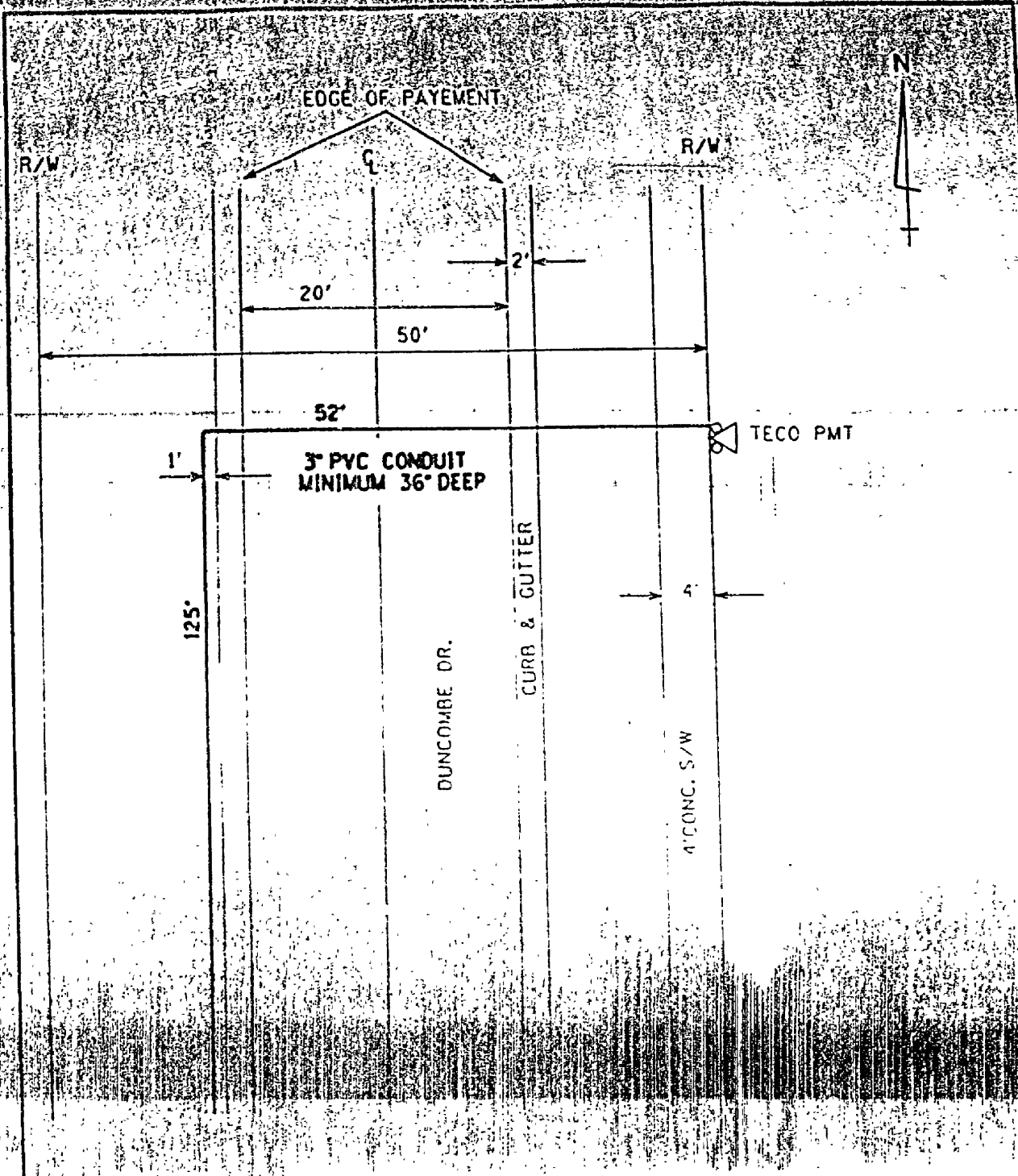

S.P.R. SECTION STATE FD. NO. COUNTY HILLSBOROUGH

APPLICATION TO INSTALL, OPERATE AND MAINTAIN A 7620 VOLT
SINGLE PHASE, 60 CYCLE DISTRIBUTION
LINE ALONG AND ON ADDRESS INDICATED DRAWING

W. O. L58365

BLOOMINGDALE #A&CC

PLANS

UNITS

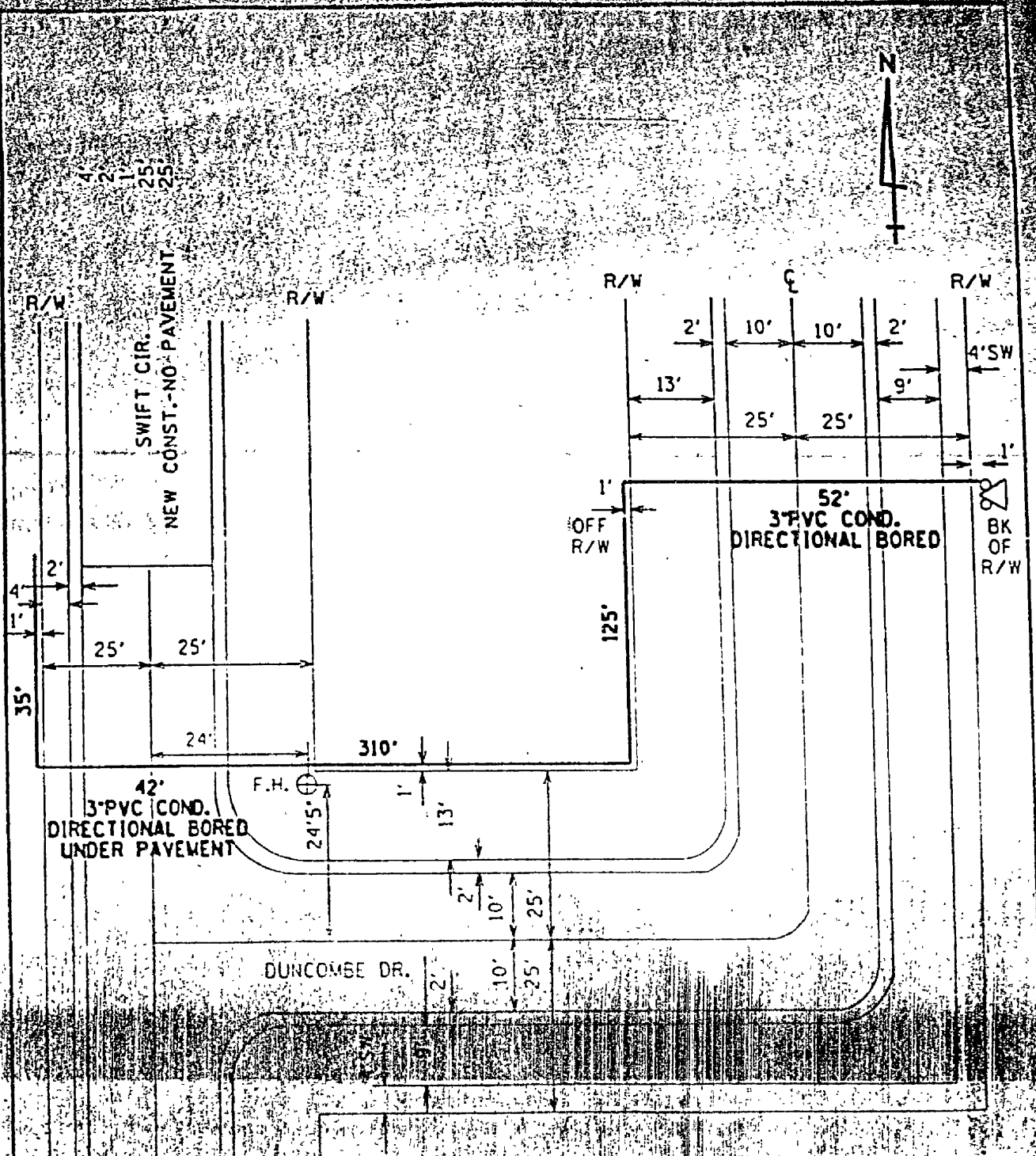

S. R. SECTION STATE RD. NO. COUNTY HILLSBOROUGH

APPLICATION TO INSTALL, OPERATE AND MAINTAIN A 7620 VOLT SINGLE-PHASE, 60 CYCLE DISTRIBUTION LINE ALONG AND/OR ACROSS INDICATED CITY ROAD

W. O. L58365
 TAMPA
 ELECTRIC

BLOOMINGDALE 44890

DATE: 11/11/11
 TIME: 10:00 AM

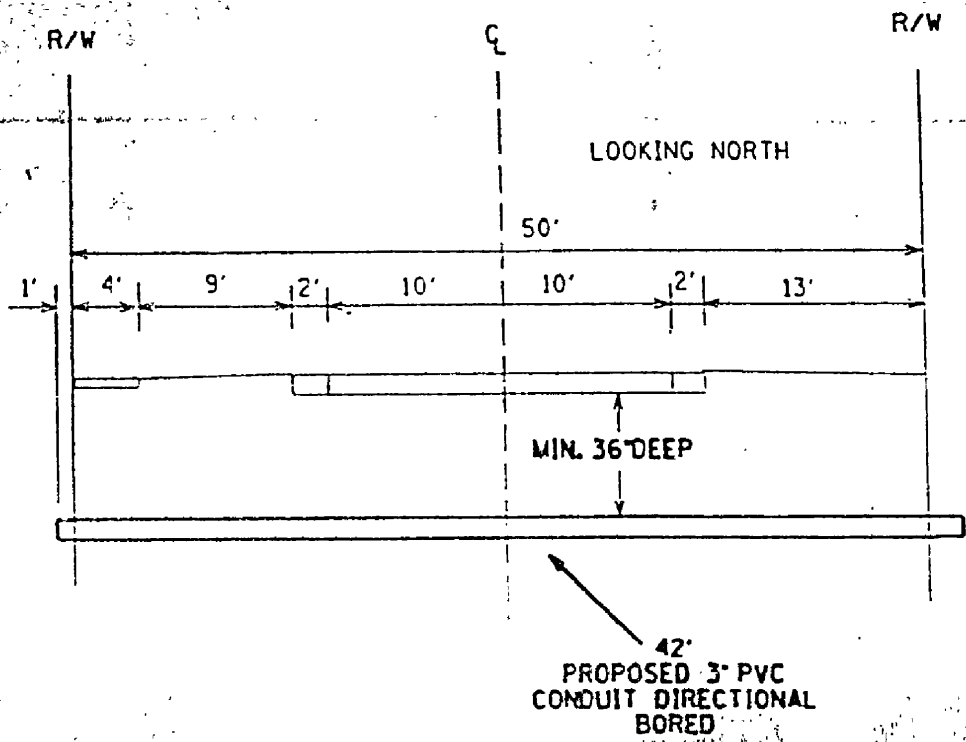

S. R. SECTION STATE PD. NO. COUNTY HILLSBOROUGH

APPLICATION TO INSTALL, OPERATE AND MAINTAIN A 7520 VOLT SINGLE PHASE, 60 CYCLE DISTRIBUTION LINE ALONG AND/OR ACROSS

W. O. 158365 BLOOMINGDALE AND S. SWIFT C. R. UNIT 3

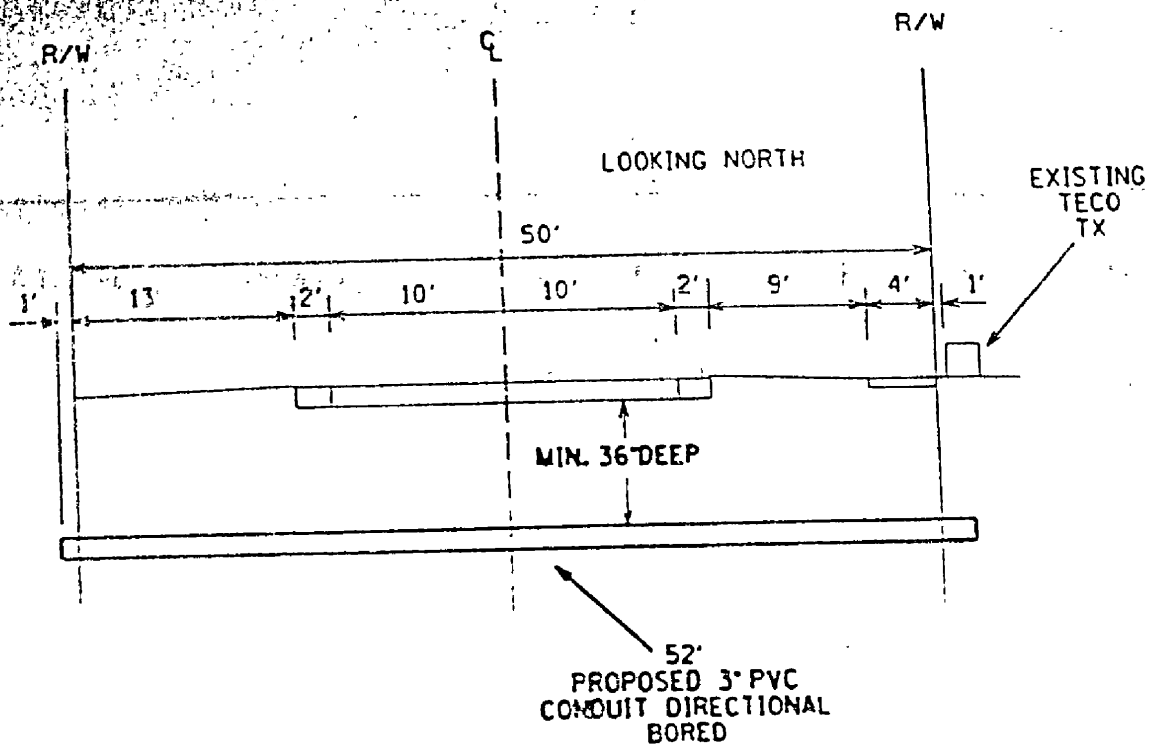

S. R. SECTION 13 W. 1/2 STATE RD. NO. 100 COUNTY HILLSBOROUGH

APPLICATION TO INSTALL, OPERATE AND MAINTAIN A 7620 VOLT SINGLE PHASE, 60 CYCLE DISTRIBUTION LINE ALONG AND/OR ACROSS INDICATED COUNTY ROAD

WV-01158365

WEST VIRGINIA ELECTRIC

BLOOMING ALE AA&GG

100 UNCOMBE DR.

UNIT 3 PHASE 2

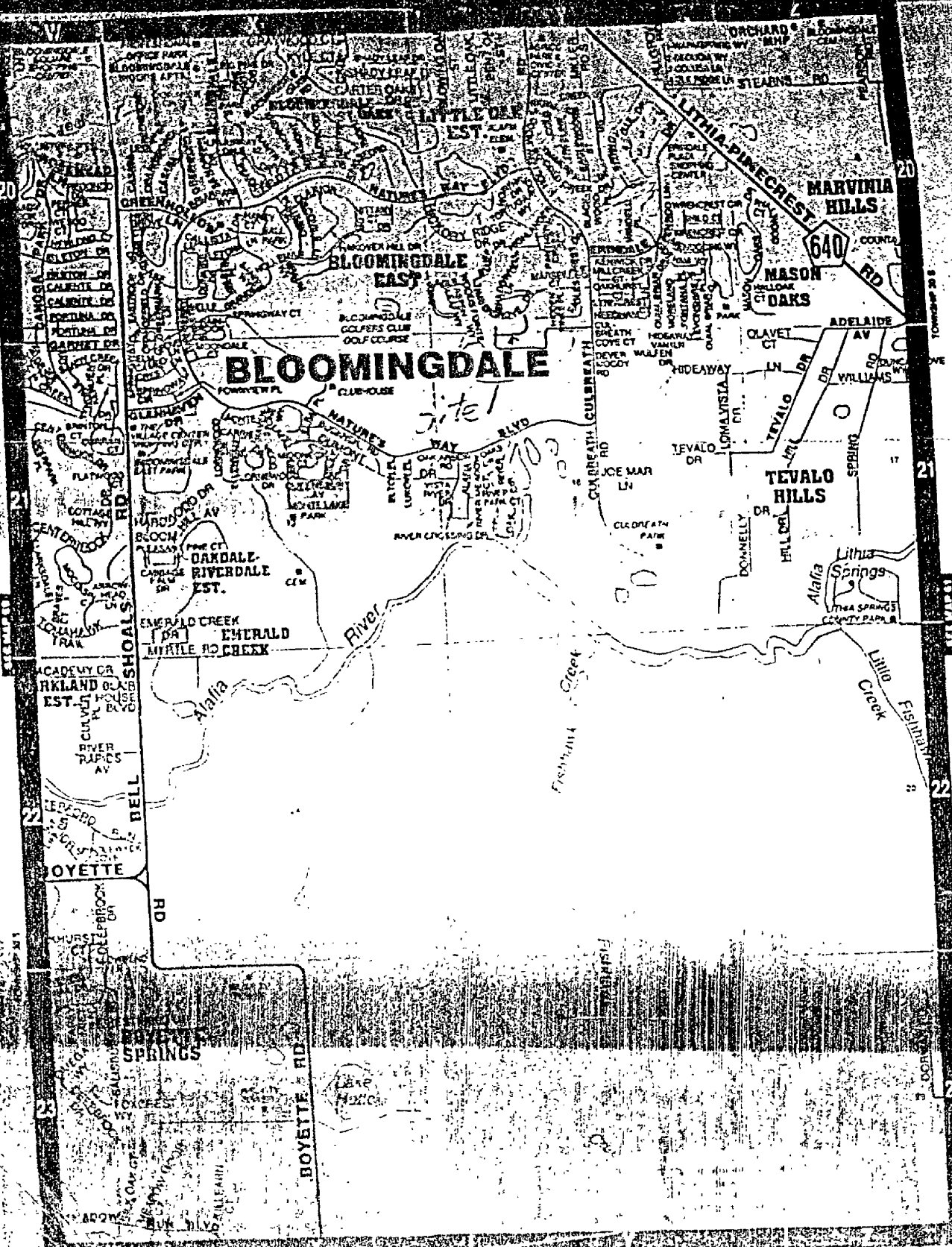

MAP 60

Township 21 S

Range 3 E

Section 21

Section 22

Section 23

PERMIT # R1002889

HILLSBOROUGH COUNTY
RIGHT - OF - WAY USE PERMIT

Date: 6-5-96

Mtc. Service Unit #: _____

Name of Road Duncombe Dr. Sec. _____ Twp. _____ Rge. _____

Location: Duncombe Dr. and Swift Circle

Will the proposed utility installation be within the limits of a proposed County Project?
 No Yes _____ CIP# _____

If Yes, what type? Road Improvement Water/Wastewater Improvement Stormwater
 Scenic Corridor Intersection Improvement Other _____

Will the proposed facility be dedicated to the County? No Yes _____

Access Connection? No Yes If yes, what type? Type I Type II Type III _____

Permission is hereby granted to Tampa Electric Company
 Address P.O. Box 111 Tampa, FL 33601 Telephone # 228-4704 for the construction and
 maintenance of Directional bore new underground conduit w/ cable to serve Bloominodale Unit 3 Phase 2

Subject to the following conditions:

1. The applicant declared that prior to filing this application that he has ascertained the location of all existing utilities both aerial and underground and the accurate locations are shown on the plans. As letters of notification were mailed on 6-5-96 to the following utilities/municipalities: Hillsborough County Utilities, General Telephone and Time Warner Cable
2. The construction and maintenance of such utility shall not interfere with the property and rights of a prior occupant.
3. All work shall be done in keeping with standards approved by the County Engineer of Hillsborough County, Florida, and under the supervision of said County Engineer or representative.
4. All materials and equipment shall be subject to inspection by said County Engineer or representative.
5. All construction shall be performed in a manner meeting the approval of the County Engineer of Hillsborough County and to Safety Standards as prescribed by Manual on Uniform Traffic Control Devices and Hillsborough County shall be relieved of all responsibility from damage of any nature arising from issuance of this permit.
6. It is understood and agreed that the rights and privileges herein set out are granted only to the extent of the County's right, title and interest in the land to be entered upon and used by the Permittee and the Permittee will, at all times, assume all risks of the indemnify, defend and save harmless the County from and against all loss, damage, cost or expense arising in any manner on account of the exercise or attempted exercises by said permittee of the aforesaid rights and privileges.
7. All Hillsborough County property and/or rights-of-way shall be restored to original condition as far as practicable and meeting the approval of the County Engineer or representative.
8. All overhead installations shall conform to present standards of the Florida Department of Transportation (FDOT) and all underground crossings shall be installed at a minimum depth of thirty-six (36) inches below the pavement at least thirty (3) inches below ditch grade. Cable TV and communication lines shall be installed a minimum of twenty-four (24) inches below existing grade. Exceptions may be made in special cases by authority from the County Engineer or representative.
9. The attached sketch or sets of plans covering details of this installation shall be made a part of this permit.

WORK ORDER NO. 15824
TASK NO. 22
ESA GRID NO. 2738
PRINT DATE 05/28/96
JUL 26 1996
TIME 11:00 AM

LOCATION OF WORK: DUNCOMBE/SWIFT CR
MADE BY: LESTER, PATRICK
APPROVED BY: *AKL*
CANDY REF NO.
PHONE: 813-000-0000
REQD DATE:

CIRCUIT NUMBERS: 13687Y
SUBSTATIONS: PEARSO
TASK DESCRIPTION: INSTALL 2 DIRECTIONAL BORE STREET CROSSINGS - 3"
WORK ORDER DESC:
PURPOSE:

SPEC INSTRUCTIONS:

NO RECONCILABLE MATERIAL

UNION	-	530-41110	-	530
25000	-	530-81142	-	530
DAYTIME	-	530-83402	-	530
OPERATION	-	530-83402	-	530

BY: _____
DATE: _____

***** WORK ORDER *****

WORK ORDER NO. 1589
TASK NO. 1589

ORDER TYPE: 1 AREA: CSA

PRINT DATE: 05/20/96 TIME: 12:01:37

LOCATION OF WORK: CULBREATH RD/DELAWARE CT/275 N

PROJ. NO.:

MADE BY: LESTER PATRICK

APPROVED BY: [Signature]

CANDY REF. NO.:

CUSTOMER: PLMS AA/GB UNIT 3 PH 2

PHONE: 813-000-0000

CIRCUIT NUMBERS: 13687Y
SUBSTATIONS: PEARSON

REQD. DATE: _____

TASK DESCRIPTION: DIRECTION FORE 1-2" CONDUIT UNDER CULBREATH RD

WORK ORDER DESC:
PURPOSE:

SPEC INSTRUCTIONS: HOLD FOR ROAD REPAIR

NO RECONCILABLE MATERIAL

	X	QTY	
INSTALL	100	500-A1110-	500
		35-011-	500
		000-55400-	500
		000-50100-	500

[Handwritten signature]

NON-ISSUE TICKET
SPECIAL AND MAJOR

STOCKS REF. NO.

STATUS: PE
317780001 SBA 101204

WORK ORDER NO. 15534
TASK NO. 181

ACCOUNT NO. 530-41510-04-180

170300

EST. NO.	BIN	STOCK	ISSUE	DESCRIPTION	INSTALL	CONSUME
QTY	LOCATION	NUMBER	QTY		QTY	QTY
7	CA	900 004	5835560	7 HAN(HOLE SEC DRD - 17 IN X 30	***	***

ENGINEERED BY
LESTER PATRICK

PLLED BY

CHECKED BY

DATE
[Signature]

DATE
[Signature]

DATE
TICKET NO.

***** W O R K O R D E R *****

WORK ORDER NO. 5835
TAX NO. 19
AREA: ESA GRID NO. 8238

WORK ORDER TYPE: 1
***** PRINT DATE 05/16/96 TIME 15:30:41 *****

LOCATION OF WORK: SUIFT CR/DELAMERE CT

PROJ. NO. 7

MADE BY: LESTER PATRICK

APPROVED BY: *[Signature]*

CANDY REF. NO.

MAY 21 1996

CUSTOMER: BLMG, AA/66 UNIT 2 PHASE 2

PHONE: 813-000-0000

CIRCUIT NUMBERS: 13697Y

REQD-DATE: _____

SUBSTATIONS: PEARSO

TASK DESCRIPTION: INSTALL SECONDARY HAND HOLES

WORK ORDER DESC :

PURPOSE:

NO RECONCILABLE MATERIAL

SPEC INSTRUCTNS:

	%	ACCT
INSTALL	- 100	530-A1110-___-530
REMOVL	-	530-P1167-___-530
MAINTENANCE	-	530-59402-___-530
OPERATION	-	530-58402-___-530

30472

***** U.D.R.K. D.R.D.E.R. *****
WORK ORDER TYPE: 1 AREA: ESN: 0000 NG: 3838
***** PRINT DATE: 05/16/95 TIME: 15:30:57 *****

LOCATION OF WORK: SUFT CR/DELAHRE CT
MADE BY: LESTER PATRICK APPROVED BY: CANDY REF NO:
CUSTOMER: BLHD AA & GG UNIT 3 PH 2 PHONE: 813-600-0000

CIRCUIT NUMBERS:
SUBSTATIONS: RECD DATE: 2 01 95

TASK DESCRIPTION: INSTALL SERVICE CONDUIT
WORK ORDER DESC:
PURPOSE:

SPEC INSTRUCTIONS:

	X	ACCT
INSTALL	- 100	530-A0303-__-530
REMOVE	-	530-P0362-__-530
MAINTENANCE	-	530-59402-__-530
OPERATION	-	530-58402-__-530

SUPPLIER'S COMMENTS:

JOHN

100 COMPANY

STATUS:
 STOREHOUSE:

EST. NO.	QTY	U.	LOC.	DESCRIPTION	PRICE	TOTAL
	224	EA	180	COUPLING, PVC	0.10	22.40
	1	EA	150	COUPLING, PVC	2.10	2.10
	7	EA	220	ELBOW, GALV. 2 IN. 90 DEG.	0.70	4.90
	2	EA	220	ELBOW, GALV. 3/4 IN. 90 DEG.	0.70	1.40
	12	EA	160	ELECT. GALV. 3/4 IN. 90 DEG.	0.70	8.40
	1600	FT	1000	CONDUIT, PVC 2 A 20 FT W/BELL	0.00	1600.00
	740	FT	1000	CONDUIT, PVC 2 A 20 FT W/BELL	0.00	740.00
	4	EA	180	COUPLING, PVC	0.10	0.40
	1450	FT	1000	CONDUIT, PVC 1/2 A 20 FT W/BELL	0.00	1450.00
	4	EA	100	CEMENT, PVC CLEAR FAST DRY	0.00	4.00
	2350	FT	10076C	TAPE, PULLING POLYESTER, RATED	0.00	2350.00
	4	EA	100	GRAB GLUE	0.00	4.00

ENGINEERED BY: CESTER PATRICK
 PULLED BY: [Signature]
 CHECKED BY: [Signature]
 DATE: [Blank]
 DATE: [Blank]
 DATE: [Blank]

WORK ORDER NO. 118
TASK NO. 3125
WORK ORDER TYPE: I
AREA: ESH
GRID NO. 3125
PRINT DATE: 05/16/96 TIME: 15:30:36

LOCATION OF WORK: SWIFT CR/DELAMERE CT
PROJ. NO.
MADE BY: LESTER PATRICK
APPROVED BY: *[Signature]* CANDY REF. NO.

CUSTOMER: BLMD AA & GG UNIT 3 PH 2
MAY 21 1996
PHONE: 813-000-0000

CIRCUIT NUMBERS: 13687Y
SUBSTATIONS: PEARSO
REQD-DATE: _____

TASK DESCRIPTION: INSTALL PRIMARY & SECONDARY CONDUIT
WORK ORDER DESC:
PURPOSE:

SPEC INSTRUCTNS:

	%	ADCT
INSTALL	- 100	530-A1110-___-530
REMOVE	-	530-P1162-___-530
MAINTENANCE	-	530-59407-___-530
OPERATION	-	530-59407-___-530

ADDITIONAL COMMENTS:

CLASS: _____ INTD: _____ UNIT: _____
DATE: _____ TIME: _____
BY: _____

STAFF: _____
CHECKED BY: _____
APPROVED BY: _____
DATE: _____

TAMPA
ELECTRIC
A T & D ENERGY COMPANY

T & D CREW UNDERGROUND MATERIAL
STORES REQUEST/ISSUE/INSTALL/RETURN/REMOVE SLIP

S-152 R 11/00

ISSUE FROM STOREROOM NO. 04
OR
RETURN TO STOREROOM NO. _____

REF. NO. _____
TRUCK NO. Duty
USE TYPE 2696

WORK ORDER/MEMO NO.	TASK NO.
<u>158365</u>	<u>01</u>
IC.	

CHK LOC	NARC DR FEG	SUB	RES CLEC	GEN LOC
<u>530</u>	<u>A111</u>	<u>00</u>	<u>06</u>	<u>530</u>

STOCK NO.	QTY	DESCRIPTION	STOCK NO.	QTY	DESCRIPTION
262-0625	EA	Tx Pin 25 KVA 7 6 240/120	555-0950	EA	Conn Tx Stud 6 Tape
262-0037	EA	Tx Pin 37 KVA 7 6 240/120	555-0990	EA	Conn Al CA-to-Flat #2A1
262-0850	EA	Tx Pin 50 KVA 7 6 240/120	555-2030	EA	Conn Al CA-to-Flat #1A1
262-0675	EA	Tx Pin 25 KVA 7 6 240/120	555-4840	EA	Conn URD 600 6POS-10-350
262-0167	EA	Tx Pin 167 KVA 7 6 240/120	555-4850	EA	Conn URD 600 6POS-10-500
260-1001	EA	Pud Tx 40 48 48 Cond	555-4850	EA	Conn URD 600 6POS-10-500
260-1002	EA	Pud Tx 40 52 48 Cond	551-2000	FT	Conduit Galv 2 In
542-3160	FT	Conduit Galv 2 In	551-2180	EA	Coupling Galv 2 In
542-6110	FT	Conduit Galv 2 In	551-2270	EA	Coupling Galv 2 In
542-6000	FT	Conduit Galv 2 In	551-3000	FT	Conduit Galv 2 In
542-6120	FT	Conduit Galv 2 In	551-3160	FT	Conduit Galv 2 In
542-6110	FT	Conduit Galv 2 In	551-4000	FT	Conduit Galv 2 In
542-6110	FT	Conduit Galv 2 In	551-4100	FT	Conduit Galv 2 In
542-6110	FT	Conduit Galv 2 In	551-5000	FT	Conduit Galv 2 In
542-6110	FT	Conduit Galv 2 In	551-3160	FT	Conduit Galv 2 In
542-6110	FT	Conduit Galv 2 In	551-2000	FT	Conduit Galv 2 In
542-6110	FT	Conduit Galv 2 In	551-2180	EA	Coupling Galv 2 In
542-6110	FT	Conduit Galv 2 In	551-2270	EA	Coupling Galv 2 In
542-6110	FT	Conduit Galv 2 In	551-3000	FT	Conduit Galv 2 In
542-6110	FT	Conduit Galv 2 In	551-3160	FT	Conduit Galv 2 In
542-6110	FT	Conduit Galv 2 In	551-4000	FT	Conduit Galv 2 In
542-6110	FT	Conduit Galv 2 In	551-4100	FT	Conduit Galv 2 In
542-6110	FT	Conduit Galv 2 In	551-5000	FT	Conduit Galv 2 In
542-6110	FT	Conduit Galv 2 In	551-3160	FT	Conduit Galv 2 In
542-6110	FT	Conduit Galv 2 In	551-2000	FT	Conduit Galv 2 In
542-6110	FT	Conduit Galv 2 In	551-2180	EA	Coupling Galv 2 In
542-6110	FT	Conduit Galv 2 In	551-2270	EA	Coupling Galv 2 In
542-6110	FT	Conduit Galv 2 In	551-3000	FT	Conduit Galv 2 In
542-6110	FT	Conduit Galv 2 In	551-3160	FT	Conduit Galv 2 In
542-6110	FT	Conduit Galv 2 In	551-4000	FT	Conduit Galv 2 In
542-6110	FT	Conduit Galv 2 In	551-4100	FT	Conduit Galv 2 In
542-6110	FT	Conduit Galv 2 In	551-5000	FT	Conduit Galv 2 In

STATUS: BA
 WORK ORDER NO: 15864
 SPECIAL INVOICE NO: ON 210
 ACCOUNT NO: 590-A1510-06-530

QTY	U/BA	SEC	STOCK	ISSUE	DESCRIPTION	INSTALL	CONSUME
						QTY	QTY
1	EA		5542510	10	TX PA 50KVA 7 8 120/2400		
2	EA		5542510	275	PAV 1D170 XLB 10KV GN	*****	*****
2	EA		5542510	140	PAV 1D470X270N XLP 600V		
2	EA		5542510	140	PAV 1D250X350N XLP 600V		
2	EA		5522000	25	CONDUIT PVC 2 1/2 20FT 1/2 BELL	*****	*****
2	EA		2001001	3	PAD CONC 40X40X4 25-50KVA TX	*****	*****
2	EA		5549630	2	TERM SAFEBREAK 200A 170 STR	*****	*****
2	EA		5542510	5	COND COPPER BARE #4	*****	*****
1	EA		5542260	1	CAB COND 2"	*****	*****
1	EA		5542260	1	CLAMP COND GND #1-4702-10-2	*****	*****
1	EA		5542260	1	BOLT MACH GALV #6X1-1/2	*****	*****
1	EA		5542260	1	TERM BOOTH 15KV	*****	*****
1	EA		5542260	1	PAD CONC 40X40X4 25-50KVA TX	*****	*****
3	EA		5542510	3	CONDUIT PVC 2 1/2 20FT 1/2 BELL	*****	*****
3	EA		5542510	3	COND COPPER BARE #4	*****	*****
3	EA		5542510	3	TERM SAFEBREAK 200A 170 STR	*****	*****
3	EA		5542510	3	PAV 1D470X270N XLP 600V	*****	*****
3	EA		5542510	3	PAV 1D250X350N XLP 600V	*****	*****

STATUS: SA
 STORE ORDER NO: 530-A1110-05-590
 WORK ORDER NO: 15985
 TASK NO:
 ACCOUNT NO: 530-A1110-05-590

EST	U/BIN	STOCK	ISSUE	DESCRIPTION	INSTALL	CONSUME
QTY	LOCATION	NUMBER	QTY		QTY	QTY
3	EA SEC A02	2620050	3	TX, PH, 50KVA, 7.5-12V/250V	3	
2785	FT SEC A05	5428100	2785	CA, AL, 10 1/0, XLP, 15KV, CN	2613	
70	FT SEC A05	5428400	70	CA, AL, 204/062/0N, XLP, 600V	*****	*****
1400	FT SEC A05	5428500	1400	CA, AL, 20500&250N, XLP, 600V	1400	
20	FT YSW	5522000	20	CONDUIT, PVC, 2" A, 20FT W/BELL	*****	*****
3	EA YT	2001001	3	PAD CONC 40X40X4 25-50KVA TX	*****	*****
7	EA 10047J	5549630	7	TERM SAFEBREAK 200A 1/0 STR	*****	*****
20	FT 10080C3	5342510	0	COND COPPER BARE #4	*****	*****
1	EA 1H105C1A	5522260	1	CAP, CONDUIT 2"	*****	*****
1	EA 1H106B1A	5272970	1	CLAMP CONC ONG 1-1/4T02-10-2	*****	*****
6	EA 1H10701C	5233050	6	BOLT MACH GALV 3/8X1-1/4	*****	*****
3	EA 1J099E1	5550930	3	TERM, SLIP FIT AL 5/8" 6-TAP	*****	*****
6	EA 1J099E2	5550250	6	TERMINAL, SLIP FIT AL 5/8 IN	*****	*****
18	EA 1J101A1	5554840	18	CONNECTOR, URD 600V 6 POS	*****	*****
1	EA 1J101B	5550930	1	TERM, POTHS 30, 15KV, OUTDR, JACK	1	
4	EA 1J105E3	5532750	4	FAULT IND SPI CIR 400A 1/0AL	*****	*****
3	EA 1K104A1	5554840	3	CONN URD 600V 6-POS	*****	*****
3	EA 1K105C1	5855240	3	REPELLENT, FIRE ANI 4 OZ	*****	*****
3	EA 1K105U2	5853140	3	PADLOCK 5000510, BRASS REC	*****	*****

C. Jacobs
 9-3-96

Floures
 09/05/96

ORDER TYPE: *ORD* AREA: *ESA* WORK ORDER NO: *15273073*
 PRINT DATE: *08/29/96* TIME: *11:03:02* TASK NO: *3228*

LOCATION OF WORK: *DEL AERE CT SWIFT CR* PROJ NO: *15273073*
 MADE BY: *LESTER PATRICK* APPROVED BY: *BRR* CANDY REF NO:
 CUSTOMER: *BLMD AA & GO UNIT 3 PH 2* PHONE: *813-660-0000*

CIRCUIT NUMBERS: *13687Y* REQD-DATE: _____
 SUBSTATIONS: *PEAR*

TASK DESCRIPTION: *INSTALL PRI & SEC CABLE & PMTS*
 WORK ORDER DESC:
 PURPOSE:

SPEC INSTRUCTNS:

	%	ACCT
T30S R21E 18 NW	INSTALL - 100	530-A1110-___-530
T30S R21E 18 NE	REMOVE -	530-P1162-___-530
T30S R21E 07 SE	MAINTENANCE -	530-56402-___-530
	OPERATION -	530-56402-___-530

SUPERV'S COMMENTS: *2*
Phasing Wrons *15273073*
15270960
2613
2613 FT. cable

TASKING

UNIT	EST	ACT	RES
POLE TRIM:	N	0	0
POLE HAUL-OUT:	N	0	0
POLE MILLING:	N	0	0
POLE HAUL-IN:	N	0	0
GROUNDING:	R	31	0
SERVICES:	N	0	0
METERS:	N	0	0

THIS WORK ORDER HAS BEEN CONSTRUCTED WITH EXPENSE OF THE COMPANY
 ESTD BY: *W. P. [Signature]* *9-6-96*

SYSTEM DISTRIBUTION ENGINEERING
 UNDERGROUND CABLE PULLING TENSION PROGRAM

CONFIGURATION DATA

PROJECT TITLE = BLOOMINGDALE AA/GO 0-1 PE-C
 PROJECT LOCATION = CULBERTSON RD
 CABLE TYPE = 1/0-1/0 AL
 CONDUCTOR AREA = 135123.0 CM
 CONDUCTOR DIAMETER = 1.0000 INCHES
 CONDUCTOR WEIGHT = .50 LB/FT
 CONDUCTOR MATERIAL = AL
 CONDUIT DIAMETER = 2 INCHES
 BENDING RADIUS 45 DEG BENDS = 1.00 INCHES
 BENDING RADIUS 90 DEG BENDS = 9.50 INCHES
 SECTION 1= 90 DEGREE BEND
 SECTION 2= 60 FOOT STRAIGHT SECTION
 SECTION 3= 90 DEGREE BEND
 SECTION 4= 125 FOOT STRAIGHT SECTION
 SECTION 5= 90 DEGREE BEND
 SECTION 6= 310 FOOT STRAIGHT SECTION
 SECTION 7= 90 DEGREE BEND
 SECTION 8= 140 FOOT STRAIGHT SECTION
 SECTION 9= 90 DEGREE BEND

CALCULATED DATA

PERCENT CONDUIT FILL = 25.43
 JAM RATIO = 2.00
 CLEARANCE = .1875 INCHES
 MAXIMUM ALLOWABLE TENSION = 50000 LBS
 MAXIMUM ALLOWABLE SIDEWALL PRESSURE = 75000 LBS

POINT	PULL WITH BEND AT POINT		PULL WITH BEND AT POINT	
	TENSION LBS	PRESSURE LBS	TENSION LBS	PRESSURE LBS
1	1000	1000	1000	1000
2	1000	1000	1000	1000
3	1000	1000	1000	1000
4	1000	1000	1000	1000
5	1000	1000	1000	1000
6	1000	1000	1000	1000
7	1000	1000	1000	1000
8	1000	1000	1000	1000
9	1000	1000	1000	1000

SYSTEM DISTRIBUTION ENGINEERING
 UNDERGROUND CABLE PULLING TENSION PROGRAM

***CONFIGURATION DATA**

PROJECT TITLE = AN/00 UNIT 3 PE 2
 PROJECT LOCATION = SHIPT CIRCLE
 CABLE TYPE = 1/C-1/0 AL
 CONDUCTOR AREA = 133129.0 CM
 CONDUCTOR DIAMETER = 1.0939 INCHES
 CONDUCTOR WEIGHT = .59 LB/FT
 CONDUCTOR MATERIAL = AL
 CONDUIT DIAMETER = 2 INCHES
 BENDING RADIUS 45 DEG BENDS = .60 INCHES
 BENDING RADIUS 90 DEG BENDS = 9.50 INCHES
 SECTION 1 = 90 DEGREE BEND
 SECTION 2 = 540 FOOT STRAIGHT SECTION
 SECTION 3 = SWEEP 1 58.73 DEGREES 20.38 FOOT RADIUS
 SECTION 4 = 40 FOOT STRAIGHT SECTION
 SECTION 5 = 90 DEGREE BEND

***CALCULATED RESULTS**

PERCENT CONDUIT FILL = 18.46
 JAM RATIO = 2.74
 CLEARANCE = .99 INCHES
 MAXIMUM ALLOWABLE TENSION = 1518.0 LBS
 MAXIMUM ALLOWABLE SIDEWALL PRESSURE = 7.5 PSI

POINT	FILL WITH BEND AT POINT		FILL WITH STR. AT POINT	
	PERCENT	PRESSURE (PSI)	PERCENT	PRESSURE (PSI)
1	18.46	7.5	18.46	7.5
2	18.46	7.5	18.46	7.5
3	18.46	7.5	18.46	7.5
4	18.46	7.5	18.46	7.5
5	18.46	7.5	18.46	7.5
6	18.46	7.5	18.46	7.5

CAUTION: ENGINEER SHOULD CHECK ALL
 AVAILABLE DATA BEFORE USING THIS PROGRAM
 AND SHOULD CONSULT WITH MANUFACTURER

SYSTEM DISTRIBUTION ENGINEERING
 UNDERGROUND CABLE PULLING TENSION PROGRAM

CONFIGURATION DATA

PROJECT TITLE = 8000V/1000A/1000 FT
 PROJECT LOCATION = UNDERGROUND
 CABLE TYPE = 1/2" - 1000 A
 CONDUCTOR AREA = 109129.3 CM
 CONDUCTOR DIAMETER = 11.000 INCHES
 CONDUCTOR WEIGHT = 1.50 LB/FT
 CONDUCTOR MATERIAL = AL
 CONDUIT DIAMETER = 1 INCHES
 BENDING RADIUS 45 DEG BENDS = 10.00 INCHES
 BENDING RADIUS 90 DEG BENDS = 10.00 INCHES
 SECTION 1 = 50 DEGREE BEND
 SECTION 2 = 100 FOOT STRAIGHT SECTION
 SECTION 3 = 90 DEGREE BEND
 SECTION 4 = 100 FOOT STRAIGHT SECTION
 SECTION 5 = 90 DEGREE BEND
 SECTION 6 = 100 FOOT STRAIGHT SECTION
 SECTION 7 = 90 DEGREE BEND
 SECTION 8 = 100 FOOT STRAIGHT SECTION
 SECTION 9 = 90 DEGREE BEND

UNCALCULATED RESULTS

PERCENT CONTACT FILL = 1.00
 JAM RATIO = 3.00
 CLEARANCE = 1.00 INCHES
 MAXIMUM ALLOWABLE TENSION = 1000 LBS
 MAXIMUM ALLOWABLE SIDEWALL PRESSURE = 100 LBS/INCH

POINT	FORCE WITH REEL AT POINT TENSION (LBS)	FORCE WITH REEL AT 20 FT TENSION (LBS)	FORCE WITH REEL AT 20 FT PRESSURE (LBS)
1	1000	1000	1000
2	1000	1000	1000
3	1000	1000	1000
4	1000	1000	1000
5	1000	1000	1000
6	1000	1000	1000
7	1000	1000	1000
8	1000	1000	1000
9	1000	1000	1000

SYSTEM DISTRIBUTION ENGINEERING
 UNDERGROUND CABLE PULLING TENSION RECORD

CONFIGURATION DATA

PROJECT TITLE = BLOOMINGDALE AA/CG U-3 P-2
 PROJECT LOCATION = DULLESBATH RD
 CABLE TYPE = 1/C-1/A AL
 CONDUCTOR AREA = 139129.0 CM
 CONDUCTOR DIAMETER = 1.0090 INCHES
 CONDUCTOR WEIGHT = .50 LB/FT
 CONDUCTOR MATERIAL = AL
 CONDUIT DIAMETER = 3 INCHES
 BENDING RADIUS 45 DEG BENDS = .00 INCHES
 BENDING RADIUS 90 DEG BENDS = 13.00 INCHES
 SECTION 1= 90 DEGREE BEND
 SECTION 2= 60 FOOT STRAIGHT SECTION
 SECTION 3= 90 DEGREE BEND
 SECTION 4= 125 FOOT STRAIGHT SECTION
 SECTION 5= 90 DEGREE BEND
 SECTION 6= 310 FOOT STRAIGHT SECTION
 SECTION 7= 90 DEGREE BEND
 SECTION 8= 340 FOOT STRAIGHT SECTION
 SECTION 9= 90 DEGREE BEND

CALCULATED RESULTS

PERCENT CONDUIT FILL = 1.11
 JAN RATIO = 3.12
 CLEARANCE = 1.29 INCHES
 MAXIMUM ALLOWABLE TENSION = 1522.0 LBS
 MAXIMUM ALLOWABLE STEEL WALL PRESSURE = 125.0 LBS

POINT	FOIL WITH STEEL AT POINT		STEEL WITH FOIL AT POINT	
	TENSION LBS	PRESSURE LBS	TENSION LBS	PRESSURE LBS
1	1000	1000	1000	1000
2	1000	1000	1000	1000
3	1000	1000	1000	1000
4	1000	1000	1000	1000
5	1000	1000	1000	1000
6	1000	1000	1000	1000
7	1000	1000	1000	1000
8	1000	1000	1000	1000
9	1000	1000	1000	1000

DATE: 10/10/87
 BY: [Signature]

SYSTEM DISTRIBUTION ENGINEERING
 UNDEGROUND CABLE TENSION PROGRAM

CONFIGURATION DATA

PROJECT TITLE = BLOOMINGDALE AA/20 J-3 P4-2
 PROJECT LOCATION = HOLEBETH RD
 CABLE TYPE = 17/C-1/3 AL
 CONDUCTOR AREA = 139129.0 CM
 CONDUCTOR DIAMETER = 1.1095 INCHES
 CONDUCTOR WEIGHT = .50 LB/FT
 CONDUCTOR MATERIAL = AL
 CONDUIT DIAMETER = 2 INCHES
 BENDING RADIUS 45 DEG BENDS = 1.00 INCHES
 BENDING RADIUS 90 DEG BENDS = 9.50 INCHES
 SECTION 1= 40 DEGREE BEND
 SECTION 2= 340 FOOT STRAIGHT SECTION
 SECTION 3= 90 DEGREE BEND
 SECTION 4= 310 FOOT STRAIGHT SECTION
 SECTION 5= 90 DEGREE BEND
 SECTION 6= 125 FOOT STRAIGHT SECTION
 SECTION 7= 90 DEGREE BEND
 SECTION 8= 50 FOOT STRAIGHT SECTION
 SECTION 9= 90 DEGREE BEND

CALCULATED RESULTS

PERCENT CONDUIT FILL = 25.7
 JAM RATIO = 2.05
 CLEARANCE = 1.00 INCHES
 MAXIMUM ALLOWABLE TENSION = 1500.0 POUNDS
 MAXIMUM ALLOWABLE SIDEWALL PRESSURE = 250.00 POUNDS

POINT	FULL WITH REEL AT POINT 1		FULL WITH REEL AT POINT 10	
	TENSION(LBS)	PRESSURE(P/SI)	TENSION(LBS)	PRESSURE(P/SI)
1	100	100	227.45	425.45
2	100	100	225.41	400
3	44.40	100	180.00	225.50
4	350.00	100	350.00	100
5	350.00	100	350.00	100
6	350.00	100	350.00	100
7	350.00	100	350.00	100
8	350.00	100	350.00	100
9	350.00	100	350.00	100

1 INCHES MAXIMUM CLEARANCE

Alleg
Unit 5 Ph 2
Lot 34 BCL 7

FLICKER CALCULATIONS

1. Flicker Due to Transformer _____ V

2. Flicker Due to Secondary
(Flicker) (Span Length)
(from Table) x (100') _____ V

3. Flicker Due to Service
(Flicker) (Span Length)
(from Table) x (100') _____ V

4. Total Flicker Voltage _____ V

Maximum Limit is 12V Total Flicker

If flicker exceeds this limit for worst case customer,
try increasing transformer one size and recalculate flicker.

5/2/10

WORKS ISSUE TICKET
 SPECIAL MAJOR MINOR

STORES REF. NO.

STATUS: BA
 STOREROOM: EBA NO: 004

WORK ORDER NO: 158265
 TASK NO:

ACCOUNT NO: 530-60102-04-390

EST	U/	BIN	STOCK	ISSUE	DESCRIPTION	INSTA	CONSUME
QTY	J	LOCATION	NUMBER	QTY		QTY	QTY
1	EA	SEC 602	5272070	1	BRACKET DUAL CUTOUT & ARREST	*****	*****
1	EA	10035A2	5272060	1	BRACKET CUTOUT ARREST & POTHD	*****	*****
1	EA	10075A	5282290	1	CUTOUT, 100A, 15KV, LBH, FUSED	1	
1	EA	10079A	5270680	1	ARRESTER, LIGHTNING 10KV	1	
9	FT	10080C	5341900	0	CONDUCTOR COPPER #6	*****	*****
1	FT	10080C3	5342510	0	COND COPPER BARE #4	*****	*****
3	FT	10080C3	5343320	0	WIRE, HANCOIL, #4 BARE, STR	*****	*****

ENGINEERED BY
 LESTER PATRICK

FILLED BY

CHECKED BY

DATE

TIME

[Handwritten signature]

[Handwritten signature]

WORK ORDER NO. D-R-D-E-R *****
 WORK ORDER TYPE: 1 AREA: ESA GRID NO: 3238
 PRINT DATE: 08/29/96 TIME: 11:03:25 *****

LOCATION OF WORK: COLBREATH/DELAHAYE CT, 180 N ES PROJ NO:

MADE BY: LESTER PATRICK APPROVED BY: BRR CANDY REF. NO:

CUSTOMER: DLMD AA/GG UNIT 3 PH 2 PHONE: 613-000-0000

CIRCUIT NUMBERS: 13687Y REQD DATE: _____
 SUBSTATIONS: PEARS

TASK DESCRIPTION: FRAME 1 PH TERMINAL POLE
 WORK ORDER DESC: _____
 PURPOSE: _____

SPEC INSTRUCTNS:

	X	ACCT
T30S R21E 18 NE	INSTALL - 100	530-A0102-___-530
T30S R21E 07 SE	REMOVE -	530-P0102-___-530
	MAINTENANCE -	530-59301-___-530
	OPERATION -	530-59301-___-530

SUPERV'S COMMENTS: _____

WORKING

	CD	TRNG	F
PILE TRING	N	0	0
POLE HAUL OUT	N	0	0
POLE FURLING	N	0	0
POLE HAUL IN	N	0	0
GROUNDING	N	0	0
SERVICES	N	0	0

Handwritten signature or initials

CONSTRUCTION ALERT-FINAL

TO: Tj Szelistowski ESA

DATE: 06/28/96

FROM: John Currier

RE: UMD _____ Mobile Home Park
URD X _____ Subdivision
URD _____ Townhouses

CONSTRUCTION CAN BEGIN AT:

Name of Park Subdivision: Bloomington AA&GG Unit 3 Phase 2

Physical Address: Bloomington Subdivision

DESCRIBED AS FOLLOWS:

Phase of Unit Number 2

Number of Lots 52

Block and Lot Numbers

Coordinate construction with Glen Cross 254-7567 _____ at _____

Please Notify Mickey Quevedo when UMD or URD system is energized.
(Residential Development Rep)

Approximate Date Service is Needed: 07/29/96

Remarks: 530-A1110-530



CONSTRUCTION ALERT-FINAL

TO: TJ Szelistowski ESA

DATE: 06/28/96

FROM: John Currier

RE: UMD _____ Mobile Home Park
URD X _____ Subdivision
URD _____ Townhouses

CONSTRUCTION CAN BEGIN AT:

Name of Park Subdivision: Bloomington AA&GG Unit 3 Phase 2

Physical Address: Bloomington Subdivision

DESCRIBED AS FOLLOWS:

Phase of Unit Number 2

Number of Lots 52

Block and Lot Numbers

Coordinate construction with Glen Cross 254-7567 _____ at _____

Please Notify Mickey Quevedo when UMD or URD system is energized.
(Residential Development Rep)

Approximate Date Service is Needed: 07/29/96

Remarks: 530-A1110-530

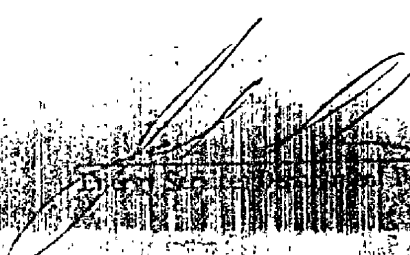

***** W.O.R. D.R.O.E.R. *****
 WORK ORDER NO: 158345
 TASK NO: 26
 GRID NO: 9188
 AREA: EBA
 PRINT DATE: 08/29/96 TIME 11:03:14

LOCATION OF WORK: DELAWARE CT / SWIFT CR
 PROJ NO:
 MADE BY: LESTER PATRICK
 APPROVED BY:
 CANDY REF NO:
 CUSTOMER: BLMG AA & GG UNIT 3 PH 2
 PHONE: 813-000-0000
 CIRCUIT NUMBERS: 13687Y
 REQD DATE:
 SUBSTATIONS: PEARS

TASK DESCRIPTION: SWITCHING INSTRUCTIONS BLMG AA/GG UNIT 3 PH 2
 WORK ORDER DESC: NO RECONCILIATION MATERIAL
 PURPOSE:

SPEC INSTRUCTNS: ENERGIZE PRIMARY FROM TERM POLE 32107-36848 SW 32700 TO LEFT SIDE OF PMT 12-09 - OPEN R/S PMT 03-63 NEW N.O. AS PER SWITCHING SCHEMATIC S-051-96E SWITCH PER OP3-6

	%	ACCT
T30S R21E 10 NE	INSTALL -	530-A1110-___-530
T30S R21E 07 SE	REMOVE -	530-P1162-___-530
	MAINTENANCE -	530-59402-___-530
	OPERATION -	530-59402-___-530

SUPERVISOR'S COMMENTS:
*Phasing Wrong Old Subdivision
 Was on C phase New on B phase
 Phasing was corrected at SW pole 3126*

TASK LOG:
 [Faded and mostly illegible text]

W.D.J.
9-6-96

For L58365

Delaware CT/Swift CR

see Aperture
Card Number

Card, 1, 2, 3, 4, 5, 6, 7, 8, 9, 10, 11
12, 13, 14

WORK ORDER NO. 0380 E R

WORK ORDER NO. TASK NO.

WORK ORDER TYPE

PRINT DATE 08/29/76 TIME 11:02:29

LOCATION OF WORK DELAWARE CT SWIFT CR

PROJ NO

MADE BY LESTER PATRICK

APPROVED BY BRB

CANDY REF NO

CUSTOMER BLND AA & GO UNIT 3 PH 2

PHONE 6813-000-400

CIRCUIT NUMBERS 13487Y
SUBSTATIONS PEAR

REQD DATE

TASK DESCRIPTION: HEGGAR GROUND & DRIVE NECESSARY RODS
WORK ORDER DESC
PURPOSE

NO RECONCILABLE MATERIAL

SPEC INSTRUCTNS

T30S R21E 18 NW
T30S R21E 18 NE
T30S R21C 07 SE

	A	ACCT
INSTALL	- 100	530-A0702-530
REMOVE	-	530-F0702-530
MAINTENANCE	-	530-59301-530
OPERATION	-	530-59301-530

SUPERVISOR'S COMMENTS

Lester Patrick

8/29/76

CONSTRUCTION ALERT

No. 1

TO: TJ Szelistowski E.S.A

DATE: 04/16/96

RE: Subdivision

LOCATION: Off Natures Way Blvd.

Name: Bloomingdale Section AA&GG Unit 3 Phase 2

NO. OF LOTS 52 UNITS

TYPE OF SERVICE: O.H. X UG

SITE CONSTRUCTION TO BEGIN: 05/16/96

CONDUIT INSTALLATION: TECO X CUSTOMER UNKNOWN

PROJECT CONTACT: Glenn Cross 254-7567
OWNER: Brandon Property Partnership
611 Bay Street
Tampa, Florida 33606

COMMERCIAL INEQ.

RESIDENTIAL INEQ.

FACILITIES:

Lift Station Laundry
Clubhouse Tennis Cls.
Elevator Other

A/C X HP
2 Ton 4KW

AREA LIGHTS

Yes No Unknown

FACILITY VOLTAGE DEMAND KW DEPOSIT
TOTAL

STYLE:

Coil Cont. CP

Lift
Station

STREET LIGHTS:

X Yes No Unknown

LOAD FACTOR: 5

REQ. NO. 530-A1110-530

REMARKS:

1300 to 2040 sq ft. homes

SIGNATURE Mickey Quevedo
Mickey Quevedo
Energy Service

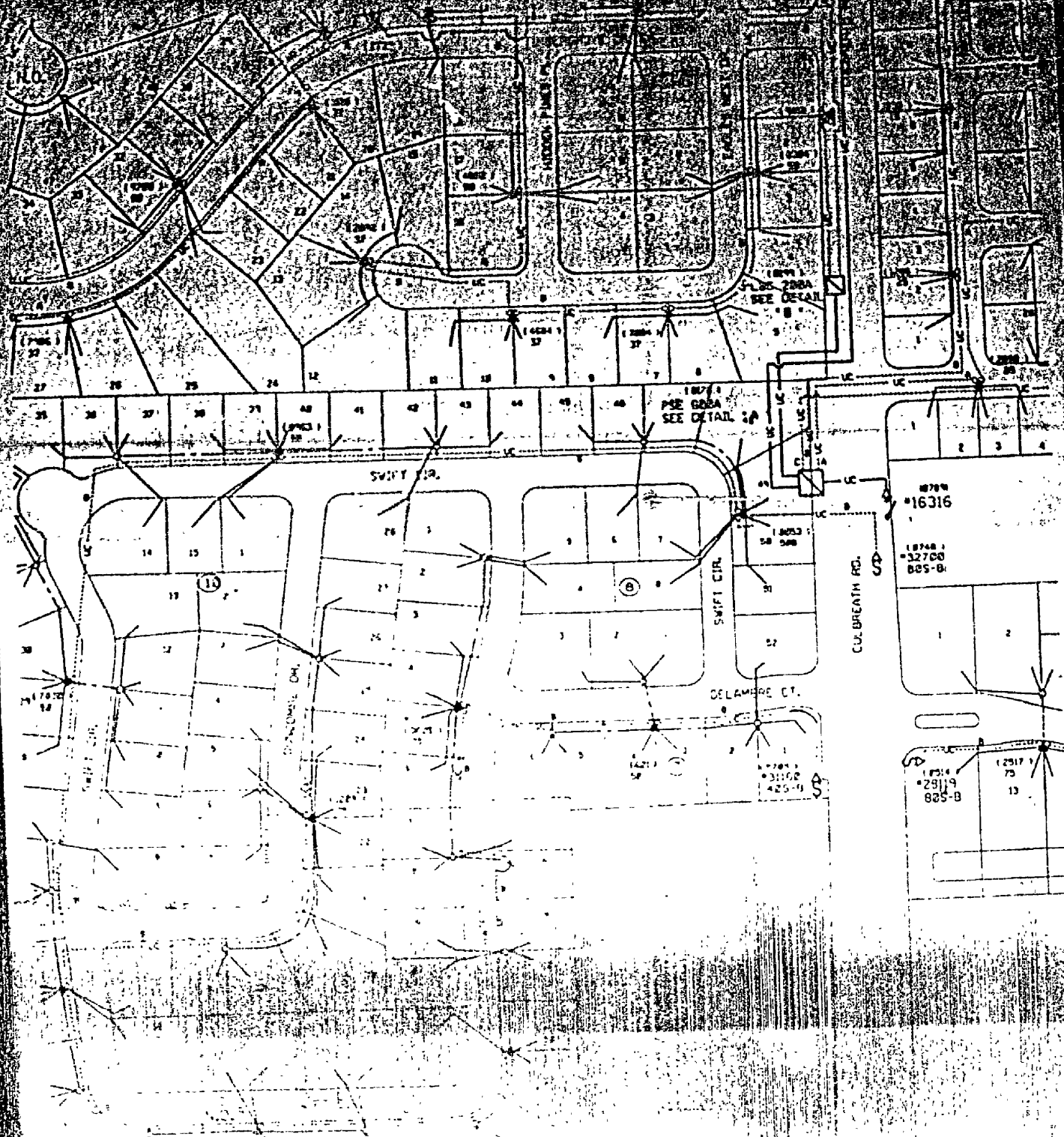

1874 1
*16316

1874 2
*32700
805-B

1874 3
*28119
*425-1
8-528

1874 4
*1317
70
13

1874 1
1874 2
1874 3
1874 4



TASKS USED:									
1	2	3	4	5	6	7	8	9	10
11	12	13	14	15	16	17	18	19	20
21	22	23	24	25	26	27	28	29	30

OH
 US
 AL
 CL
 MZ

WORK ORDER

W.O. # **-19** PROJECT: _____ LOCATION: _____
 ASSIGNED TO: **LEP** EST. TIME: **8.0** CUSTOMER: _____
 DATE ON HOLD: _____ PAYMENT: _____ CONTRACT: _____ FACILITY: _____
 DATE RECEIVED: _____

TASK	DATE	INITIAL	TASK
JOB PLANNING AND CONTACT			DRAW ONE LINE DIAGRAM
FIELD INSPECTION CHECK			DRAW SCHEMATIC
FIELD SKETCH AND ENGINEERING			SWITCHING SCHEM
STAKE FACILITIES			PHASE AND FUSE
ESTIMATE MATERIALS			TERMINAL BOX SWITCH NUMBER
COST ESTIMATE			OBTAIN SWITCH NUMBER
MARK PRINTS/EASEMENTS			ASSIGN WORK ORDER
SECURE EASEMENT INFORMATION			ASSIGN GRID NUMBER
COMPLETE EASEMENT REQUEST			MAKE GRID PLACARDS
SECURE PERMIT INFORMATION - P.P.I.D			TRANSFORMER CONNECTIONS
PROCESS PAYMENT RECEIVED			STATUS UPDATE
OT RELEASE YES - NO			TIME TRIP PERMISSION
LAYOUT FACILITIES ON PRINT			TIME TRIP TEST
COMPLETE CONTRACT AND MAIL			WORKSHEET
COMPLETE ORDER FORM - AL/SI			WORKSHEET (REVISIONS)
COMPLETE AL/SI COST PROPOSAL			ACCURACY CHECK
VOLTAGE COMPLAINT			ACCURACY CHECK
INITIAL VOLTAGE CHECK			FIELD SKETCH APPROVAL
FLICKER CALCULATION			ROUTE BACK TO TECHNICIAN
DRIVEWAY/SIDEWALK/YARD CROSSING PERMISSION			PERMITS FILE
CANDY CALL REQUIRED			PRELIMINARY APPROVAL
JOINT USE REQUIRED			PRELIMINARY APPROVAL
REVIEW CHART			FINAL APPROVAL
RECHECK VOLTAGE			
CHECK TX OVERLOAD/TLM			
GRID CHANGE ORDER			
REVIEW CONSTRUCTION PRINTS			
MEETING CONFERENCE			
DRAW W O SKETCH			
MAKE TRACING			
DRAFT PERMIT SKETCH			

MAY 2 1996

7:00 PM 2143 JUL 26 1996

DATE	COMMENT	INITIAL	DATE	COMMENT

TAMPA ELECTRIC
ENERGY COMPANY

TASKS USED:										OH	UG	AL	SL	MIX
1	2	3	4	5	6	7	8	9	10	<input type="checkbox"/>	<input checked="" type="checkbox"/>	<input type="checkbox"/>	<input type="checkbox"/>	<input type="checkbox"/>
11	12	13	14	15	16	17	18	19	20	<input type="checkbox"/>	<input checked="" type="checkbox"/>	<input type="checkbox"/>	<input type="checkbox"/>	<input type="checkbox"/>
21	22	23	24	25	26	27	28	29		<input type="checkbox"/>	<input type="checkbox"/>	<input type="checkbox"/>	<input type="checkbox"/>	<input type="checkbox"/>

ENGINEER
WORK ORDER NUMBER

PROJECT: -16 LOCATION: EST. DATE: 8.0 CUSTOMER: LE-P

DATE ON HOLD: DATE RECEIVED: CONTRACT: EASEMENT: PERMIT:

TASK	DATE	INITIAL	TASK
1. PLANNING AND CONTACT			DRAW ONE LINE DIAGRAM
2.0 INSPECTION CHECK			DRAW SCHEMATIC
3.0 SKETCH AND ENGINEERING			SWITCHING SCHEM
4.0 FACILITIES			PHASE AND FUSE
5.0 MATERIALS			TERMINAL BOX SWITCH NUMBER
6.0 ESTIMATE			OBTAIN SWITCH NUMBER
7.0 PRINTS/EASEMENTS			ASSEMBLE WORK ORDER
8.0 EASEMENT INFORMATION			ACTION GRID NUMBER
9.0 COMPLETE EASEMENT REQUEST			MAKE GRID PLACARDS
10.0 PERMIT INFORMATION - P. R. 411			TRANSCRIBE CORRECT MAP
11.0 CROSS PAYMENT RECEIVED			STATUS UPDATE
12.0 RELEASE YES - NO			TREE TRIM PERMISSION
13.0 PUT FACILITIES ON PRINT			TREE TRIM PERM
14.0 COMPLETE CONTRACT AND MAP			WORK ORDER
15.0 COMPLETE ORDER FORM - AL/SL			WORK ORDER THE JUNE
16.0 COMPLETE AL/SL COST PROPOSAL			ACCURACY CHECK
17.0 TAG COMPLAINT			ACCURACY CHECK
18.0 VOLTAGE CHECK			FIELD SPLIT W APPROVAL
19.0 XE R CALCULATION			ROUTE BACK TO TECHNICAL
20.0 VEYWAY/SIDEWALK AND CROSSING EMISSION			BUDGET
21.0 JOB CALL REQUIRED			PRELIMINARY APPROVAL
22.0 UT USE REQUIRED			PRELIMINARY APPROVAL
23.0 TFW CHART			FINAL APPROVAL
24.0 CHECK VOLTAGE			
25.0 CHECK TX OVERLOAD/TLM			
26.0 CHANGE ORDER			
27.0 NEW CONSTRUCTION PRINTS			
28.0 MEETING CONFERENCE			
29.0 WWO SKETCH			
30.0 FIELD TRACING			
31.0 FIELD PERMIT SKETCH			

MAY 21 1996

DATE	COMMENT	INITIAL	DATE	COMMENT



TASKS USED:										OH	LS	A	M	V
1	2	3	4	5	6	7	8	9	10	<input type="checkbox"/>	<input type="checkbox"/>	<input type="checkbox"/>	<input type="checkbox"/>	<input type="checkbox"/>
11	12	13	14	15	16	17	18	19	20					
21	22	23	24	25	26	27	28	29	30					

WORK ORDER NO.

PROJECT: **58365-01** LOCATION: *Sanford*

ASSIGNED TO: **LEP** EST. NO: **480** CUSTOMER: *...*

DATE ON HOLD: _____ PAYMENT: _____ CONTRACT: _____ TAGMENT: _____

TASK	DATE	INITIAL	TASK
JOB PLANNING AND CONTACT			PREPARE LINE DIAGRAM
FIELD INSPECTION CHECK			DRAWING CHECK
FIELD SKETCH AND FINISH BOND			CONDUCTOR LIST
STAKE FACILITIES			POLE AND ERECTION
ESTIMATE MATERIALS			TERMINAL LIST AND CONNECTIONS
COST ESTIMATE			CREATING WORK ORDER
MARK POINTS FACILITY			ASSIGN WORK ORDER
SECURE BASEMENT INFORMATION			ASSIGN WORK ORDER
COMPLETE BASEMENT REQUEST			MAKE GOOD AS APPLICABLE
SECURE PERMIT INFORMATION			TRAINING AND DOCUMENTATION
PROCESS PAYMENT RECEIVED			STATUS REPORT
P.T. RELEASE YES/NO			FIELD DOCUMENTATION
LAYOUT FACILITY'S OFFPRINT			FIELD TRIP LOG
COMPLETE CONTRACT AND MAIL			WORK ORDER
COMPLETE ORDER FORM ALZM			WORK ORDER FILED
COMPLETE ALZM COST PROPOSAL			ALZM BACK ORDER
VOLTAGE COMPLAINT			ALZM BACK ORDER
INITIAL VOLTAGE CHECK			FIELD REPORT FILED
Flicker Calculation			FIELD BACK ORDER FILED
DRIVEWAY/SIDEWALK/YARD CROSSING PERMITS			FIELD REPORT
CANDY CALL REQUIRED			PERMITS AND FIELD REPORT
JOINT USE REQUIRED			PERMITS AND FIELD REPORT
REVIEW CHART			FIELD REPORT
IF CHECK VOLTAGE			
CHECK TX OVERLOAD/TLM			
GRID CHANGE ORDER			
VIEW CONSTRUCTION PRINTS			
ELTING CONFERENCE			
RAW W.O. SKETCH			
AKE TRACING			
RAFT PERMIT SKETCH			

MAY 15 1976

File Here

DATE	COMMENT	INITIAL	DATE
26	File		

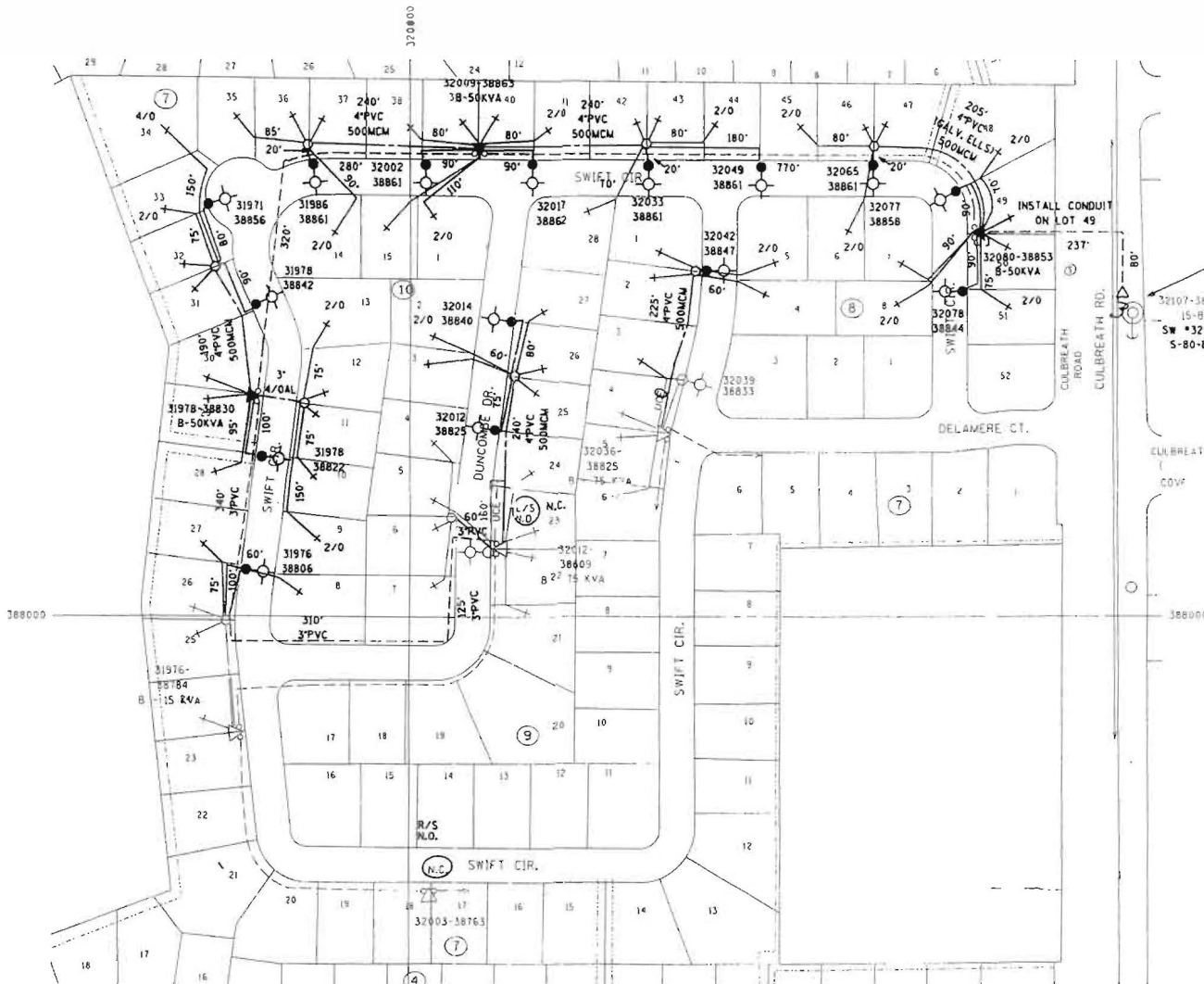

ONLY AN AUTHORIZED REPRESENTATIVE OF TAMPA ELECTRIC CO. SHALL UTILIZE THIS DRAWING TO DETERMINE EXACT LOCATION OF UNDERGROUND LINES. IF IT IS NECESSARY TO EXCAVATE IN THE GENERAL AREA OF INDICATED ELECTRICAL LINES PRIOR TO DIGGING CONTACT TAMPA ELECTRIC CO.

THIS WORK ORDER HAS BEEN DESIGNED IN COMPLIANCE WITH TAMPA ELECTRIC CO. CONSTRUCTION STANDARDS AND/OR THE NATIONAL ELECTRICAL SAFETY CODE:
 BY: *Justin Patrick* DATE: *8/22/96*

- STREET LIGHTING NOTES:
1. INSTALL STREET LIGHTS ON PROPERTY LINE, UNLESS OTHERWISE SHOWN.
 2. INSTALL STREET LIGHTS 6 FEET FROM CURB, UNLESS OTHERWISE NOTED.
 3. STREET LIGHT CABLE IS #10 CU IN 2" CONDUIT.
 4. INSTALL SMALL HANDHOLE (STOCK #553180) AT BASE OF ALL STREET LIGHTS, EXCEPT IN FRONT OF TRANSFORMERS AND SECONDARY HANDHOLES.
 5. STREET LIGHTS ARE 100 WATT COBRA HEAD FIXTURES MOUNTED ON 35" CONCRETE POLES.
 6. STREET LIGHT CONDUIT INSTALLED PARALLEL TO THE RIGHT-OF-WAY SHOULD BE IN ELECTRIC UTILITY EASEMENTS.

- GENERAL NOTES:
1. PHASE UP RESIDENTIAL
 1. PRIMARY: 1C-1/0 AL CN 15KV CABLE IN 2" PVC, UNLESS NOTED.
 2. SECONDARY: 3C-4/0 AL 600V CABLE IN 3" PVC.
 3. SERVICES: 3C-2/0 AL 600 IN 2" PVC, UNLESS NOTED.
 4. INSTALL ALL CONDUIT PER TEC SPEC 1-43.
 5. ST. LIGHT CONDUIT: 2" PVC WITH PVC ELLS. TO BE STUBBED UP 6FT BEHIND CURB.
 6. SERVICES BY INSPECTOR
 - A. 3" PVC IN ELECTRIC POWER EASEMENT
 - B. 2" PVC (10 SEC.) STUBBED OUT REAR OF PMT AND HANDHOLES.

**1997*
**EDA 65*
**L58309*
**Card 1*

13687Y-PEARSON

REV.	DATE	DESCRIPTION	TAMPA ELECTRIC COMPANY	
5	8/25/96	CHANGED N.O. POINT AND ADDED TASK 2 NOTE	SCALE: 1"=100'	REVISIONS
4	8/15/96	ADDED DISTANCES TO LIGHT RUNS	DRAWN: TML	DATE: 5/22/96
3	5/20/96	ADDED EXISTING N.O. & PRIMARY	CHKD: LEP	DATE: 5/22/96
2	5/17/96	REVISED PROPERTY LINE & SERVICE LOT 34	APPD: L	DATE: 5/22/96
1	5/15/96	REVISED PRIMARY LINE	DISTRIBUTION ENGINEERING	

BLOOMINGDALE AA & GG H-
 UNIT 3 PHASE 2 W.D. L58365
 SHEET OF

Exhibit D

State of Florida



Department of State

I certify the attached is a true and correct copy of the Articles of Incorporation of THE LINKS HOMEOWNERS' ASSOCIATION, INC., a corporation organized under the laws of the State of Florida, filed on December 19, 1995, as shown by the records of this office.

The document number of this corporation is N95000005955.

Given under my hand and the
Great Seal of the State of Florida
at Tallahassee, the Capitol, this the
Second day of July, 2003



CR2EO22 (2-03)

Glenda E. Hood
Glenda E. Hood
Secretary of State

EXHIBIT "B"

ARTICLES OF INCORPORATION

OF

THE LINKS

HOMEOWNERS' ASSOCIATION, INC.

95 DEC 13 11:00 AM
FILED
SECRETARY OF STATE
TALLAHASSEE, FLORIDA

The undersigned hereby associate to form a corporation not for profit under Chapter 617 of the Florida Statutes.

ARTICLE I

NAME

The name of this corporation shall be THE LINKS HOMEOWNERS' ASSOCIATION, INC., hereinafter referred to as the ("Association").

ARTICLE II

PURPOSE

The purpose of the Association is to acquire title to and own, and whether owned or not, to operate, maintain and preserve the Common Area, as such term is defined in the Declaration of Covenants, Conditions, Restrictions, and Easements for THE LINKS HOMEOWNERS' ASSOCIATION, INC., which will be recorded among the Public Records of Hillsborough County, Florida, (hereinafter called "Declaration"), in the development located in Hillsborough County, Florida, known as THE LINKS. The Association is also formed to maintain the privately owned areas of THE LINKS HOMEOWNERS' ASSOCIATION which are not maintained by their owners.

ARTICLE III

POWERS

The Association shall have all of the powers given to corporations not for profit by the Florida Statutes and all of the powers expressly conferred upon it by the Declaration, together with all powers necessary to fulfill all such stated powers and the duties expressly given to it by such Declaration. These powers include, but are not limited to, the power to:

A. Maintain, repair, improve and insure the Common Area as defined in the Declaration and other real or personal property which the Association owns or which it has assumed the obligation to maintain, including without limitation the surface water management system which includes the lakes, retention areas, culverts and related appurtenances;

B. Make and collect assessments from its Members;

C. Pay all Association expenses;

D. Acquire title to and exercise all rights of ownership in and to any real or personal property;

E. Convey real or personal property;

F. Make, amend and enforce reasonable rules and regulations for the use of the property it owns or maintains;

G. Enforce the terms of the Declaration, these Articles, and the By-Laws of the Association;

H. Sue and be sued;

I. Contract for operation and maintenance services;

J. Operate and maintain common property, specifically the surface water management system as permitted by the Southwest Florida Water Management District, including all lakes, retention areas, water management areas, ditches, culverts, structures, and related appurtenances;

K. Require all owners to be members of the Association;

L. Exist in perpetuity, but in the event that the Association is dissolved, the property consisting of the surface water management system ("SWMS") shall be conveyed to an appropriate agency or local government, and if not accepted, then the SWMS shall be dedicated to a similar, non-profit corporation;

M. Take any other action necessary for the purposes for which the Association is formed.

ARTICLE IV

MEMBERS

1. Every record owner of a fee interest in any Lot, as defined in the Declaration, including contract Sellers, shall be a Member of the Association. The foregoing is not intended to include persona or entities who hold an interest merely as security for the performance of an obligation. Membership shall be appurtenant to, and may not be separated from, ownership of a Parcel.

2. Change of membership in the Association shall be established by the recording, in the Public Records of Hillsborough County, Florida, of a deed or other instrument establishing a

record of title to a Lot, and shall be evidenced by delivery to the Association of a copy of such instrument. The membership of the prior owner shall be terminated as of the date of delivery of such deed or other instrument.

3. The share of a Member in the funds and assets of the Association cannot be assigned, hypothecated or transferred in any manner except upon transfer of his Lot.

4. There shall be two (2) classes of membership as follows:

(a) Class A. As long as there is a Class B membership, Class A Members shall be all Owners, as defined in the Declaration, other than the Declarant, as defined in the Declaration, and shall be entitled to one vote for each Lot owned. Upon termination of Class B membership, Class A Members shall be all Owners, including the Declarant, as long as the Declarant is an Owner and each Owner shall be entitled to one vote for each Lot owned. If more than one (1) person owns an interest in any Lot, all such persons shall be Members, but there shall be only one (1) vote cast with respect to such Lot. Such vote may be exercised as the Owners determine among themselves, but no split vote shall be permitted.

(b) Class B. The Class B Member shall be the Declarant and as long as there is a Class B voting membership the Declarant shall be entitled to three (3) votes for each Lot owned. Class B membership shall cease and be converted to Class A membership and any Class B Lots then subject to the terms of the Declaration shall become Class A Lots upon the happening of any of the following events, whichever occurs earlier:

(i) When the total votes outstanding in the Class A membership equal the total votes outstanding in the Class B membership,

(ii) January 1, 2000, or

(iii) When the Declarant waives in writing its right to Class B membership.

ARTICLE V

BOARD OF DIRECTORS

1. The affairs of the Association shall be initially managed by a Board of three (3) Directors, whose names and address are:

Glen E. Cross
8925 Eagle Watch Drive
P. O. Box 3341
Riverview, FL 33569

Scott M. Shimberg
8925 Eagle Watch Drive
P. O. Box 3341
Riverview, FL 33569

Noreen S. Folsom
8925 Eagle Watch Drive
P. O. Box 3341
Riverview, FL 33569

2. New Directors shall be appointed or elected and the number of Directors shall be increased or diminished in accordance with the By-Laws of the Association, but there shall not be less than three.

ARTICLE VI

OFFICERS

The officers of the Association shall be President, Vice President, Secretary and Treasurer, and such additional officers as

the By-Laws specify. The officers shall be elected by Directors at their annual meeting or at any special meeting called for that purpose.

The first officers who shall serve until the first election are:

President:	Glen E. Cross 8925 Eagle Watch Drive P. O. Box 3341 Riverview, FL 33569
Vice President:	Scott M. Shimberg 8925 Eagle Watch Drive P. O. Box 3341 Riverview, FL 33569
Secretary/Treasurer:	Noreen S. Folsom 8925 Eagle Watch Drive P. O. Box 3341 Riverview, FL 33569

ARTICLE VII

BY-LAWS

The BY-Laws of the Association shall be adopted by the first Board of Directors and may be altered as follows:

1. An amendment may be proposed by any Member or any Director prior to a meeting at which it will be considered.
2. Notice of the subject matter of the proposed amendment shall be included in the notice of the meeting at which the amendment is to be considered.
3. The amendment must be approved, either in person or by proxy by at least a majority of the entire membership of the Board of Directors.

4. No amendment may change the qualifications for membership in the Association.

5. No amendment which will affect the Declarant shall be adopted unless the Declarant has consented thereto in writing.

6. As long as there is a Class B membership, the Federal Housing Administration or the Veterans Administration shall have the right to veto amendments.

7. A copy of the amendment shall be recorded in the Public Records of Hillsborough County, Florida.

ARTICLE VII

AMENDMENT OF ARTICLES

These Articles may be amended in the manner set forth in Chapter 617, Florida Statutes, provided, however, that any amendment to these Articles shall require the assent of written consent of the Members entitled to cast two-thirds (2/3) of the total votes able to be cast at any regular or special meeting of the membership duly caused and convened. No such amendment may diminish any rights of the Class B Member, however, unless jointed in by such Class B Member.

ARTICLE IX

DISSOLUTION OF THE ASSOCIATION

The term of the Association shall be perpetual unless dissolved by the unanimous written consent of the Members and all mortgagees.

Upon dissolution of the Association, other than incident to a merger or consolidation, the assets of the Association (including without limitation the surface water management system portions of the Common Area) shall be dedicated to an appropriate public agency to be used for purposes similar to those for which the Association was created. In the event that such dedication is refused acceptance, such assets shall be granted, conveyed and assigned to any non-profit corporation, association, trust or other organization to be devoted to such similar purposes, but in no event shall such assets inure to the individual benefit of any Member or other private individual. The Article is subject to the provisions of Section 617.05 Florida Statutes.

ARTICLE X

INITIAL SUBSCRIBERS

The name and address of the initial subscriber is as follows:

Glen E. Cross
8925 Eagle Watch Drive
P. O. Box 3341
Riverview, FL 33569

ARTICLE XI

RESIDENT AGENT

The Resident Agent of the Association, for purposes of accepting service of process shall be Glen E. Cross, whose address within the State of Florida is 8925 Eagle Watch Drive, P. O. Box 3341, Riverview, Florida, 33569. The mailing address of the corporation is P.O. Box 3341, Riverview, FL 33569.

ARTICLE XII

FHA/VA APPROVAL

As long as there is a Class B membership, the following actions will require the prior approval of the Federal Housing Administration or the Veterans Administration: annexation of additional properties, mergers and consolidations, mortgaging of the Common Area, dissolution and amendment of these Articles. Such approval may be presumed by any third party upon the filing or recording of any document requiring such action or actions.

IN WITNESS WHEREOF, the undersigned incorporator has executed these Articles of Incorporation for the purpose of forming the Association this 30th day of May, 1995.



Glen E. Cross

STATE OF FLORIDA

COUNTY OF HILLSBOROUGH

I HEREBY CERTIFY that on this 30th day of May, 1995, before me the undersigned authority, personally appeared GLEN E. CROSS, to me known to be the person described in and who executed the foregoing Articles of Incorporation, and he acknowledged before me that he executed the same for the purposes therein expressed.

WITNESS my hand and official seal at said County and State the day and year first above written.

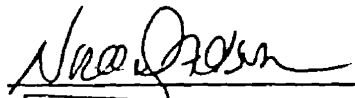

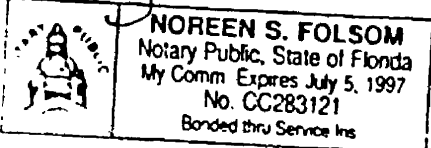
NOREEN S. FOLSOM
Notary Public, State of Florida
My Comm Expires July 5, 1997
No. CC283121
Bonded thru Service Ins

Notary Public

CERTIFICATE DESIGNATING PLACE OF BUSINESS OR DOMICILE
FOR THE SERVICE OF PROCESS WITHIN THIS STATE,
NAMING AGENT UPON WHOM PROCESS MAY BE SERVED

In pursuance of Chapter 48.091, Florida Statutes, the following is submitted, in compliance with said Act:

THE LINKS HOMEOWNERS' ASSOCIATION, INC., desiring to organize under the laws of the State of Florida, with its principal place of business at City of Riverview, County of Hillsborough, State of Florida has named Glen E. Cross, located at 8925 Eagle Watch Drive, P. O. Box 3341, City of Riverview, County of Hillsborough, State of Florida, 33569, as its agent to accept service of process within this state.

ACKNOWLEDGEMENT: (MUST BE SIGNED BY DESIGNATED AGENT)

Having been named to accept service of process for the above stated corporation, at place designated in this certificate, I hereby accept to act in this capacity, and agree to comply with the provision of said Act relative to keeping open said office.

By: 
Glen E. Cross
Dated: 5/10/95

95 DEC 10
12 11 33 PM '95