

ORIGINAL



Writer's Direct Dial No. 727-820-5587

R. ALEXANDER GLENN
Deputy General Counsel - Florida

VIA HAND DELIVERY

March 28, 2005

Ms. Blanca S. Bayó, Director
Division of the Commission Clerk
and Administrative Services
Florida Public Service Commission
2540 Shumard Oak Boulevard
Tallahassee, Florida 32399-0850

RECEIVED-FPSC
COMMISSION CLERK
MAR 29 PM 1:17

Re: Docket No. 050117

Dear Ms. Bayó:

On February 10, 2005, Progress Energy Florida, Inc. ("PEF") initiated the subject docket by filing: Petition of Progress Energy Florida, Inc. to Relieve It of the Statutory Obligation to Provide Certain Customers within the City of Winter Park with Electrical Service (the "Petition"). In the Petition, PEF advised the Commission that the company would supplement the map appended to the Petition as Exhibit A with a set of more detailed maps further outlining the territorial boundary between PEF and the City of Winter Park (the "City").

Enclosed please find for filing on behalf of PEF an original and seven copies of a supplemental set of maps that further define and delineate PEF's and the City's respective territorial areas agreed upon by the parties during the arbitration that determined the value of PEF's electric distribution system. As contemplated by the Petition, these maps are intended to supplement the map filed as Exhibit A to the Petition and are, therefore, a part of and subject to the approval sought by the Petition.

Please acknowledge your receipt of the above filing on the enclosed copy of this letter and return to the undersigned. A CD-ROM containing the above-referenced maps in PDF format is also enclosed. Thank you for your assistance in this matter.

Sincerely,

R. Alexander Glenn

- CMP _____
- COM _____
- CTR _____
- ECR _____
- GCL _____
- OPC _____
- MMS _____
- RCA _____
- SCR _____
- SEC 1
- OTH _____

Enclosures

Progress Energy Service Company, LLC
P.O. Box 14042
St. Petersburg, FL 33733

RECEIVED & FILED

FPSC-BUREAU OF RECORDS

DOCUMENT NUMBER-DATE
03045 MAR 29 05
FPSC-COMMISSION CLERK

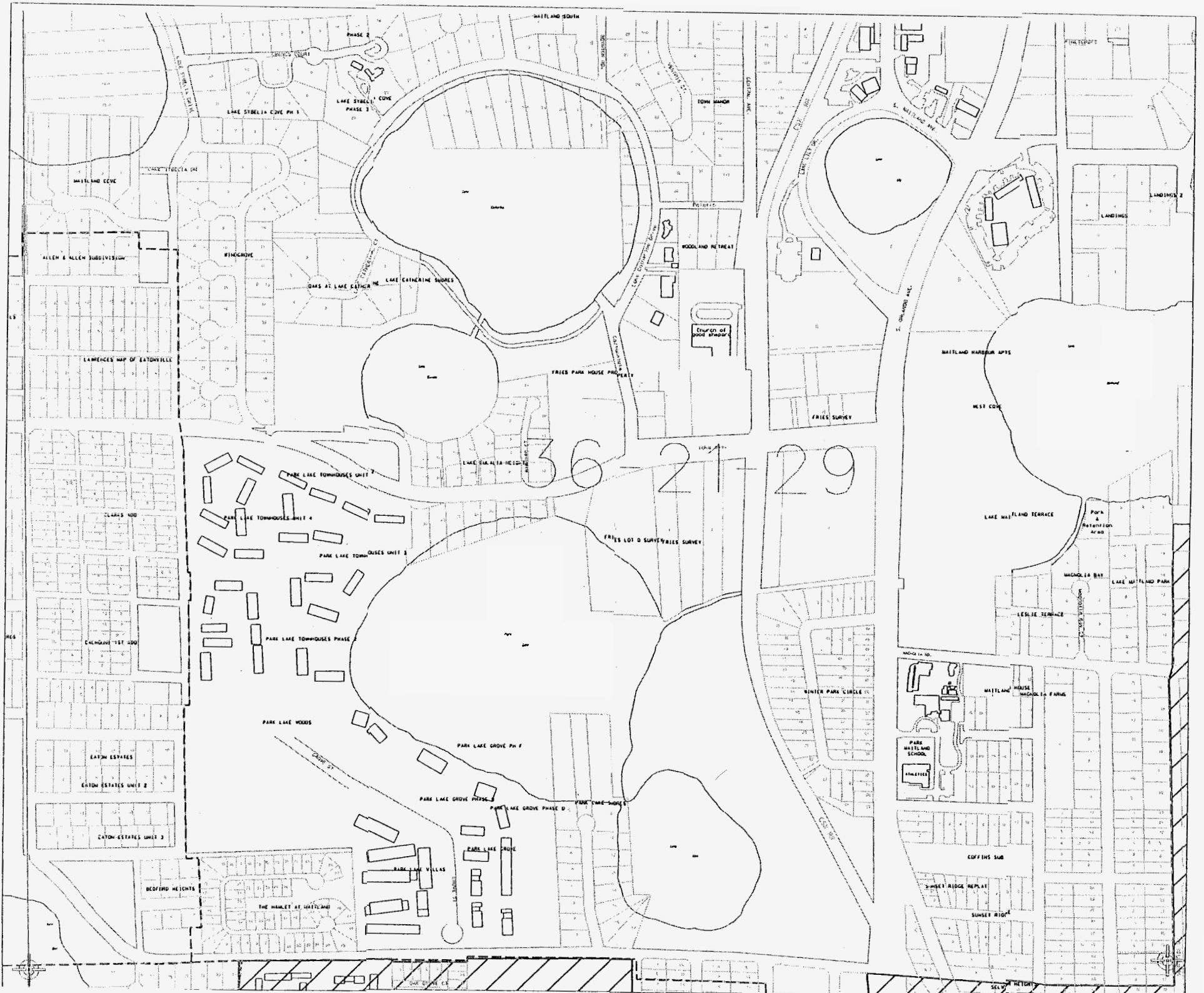

Winter Park
Service Area

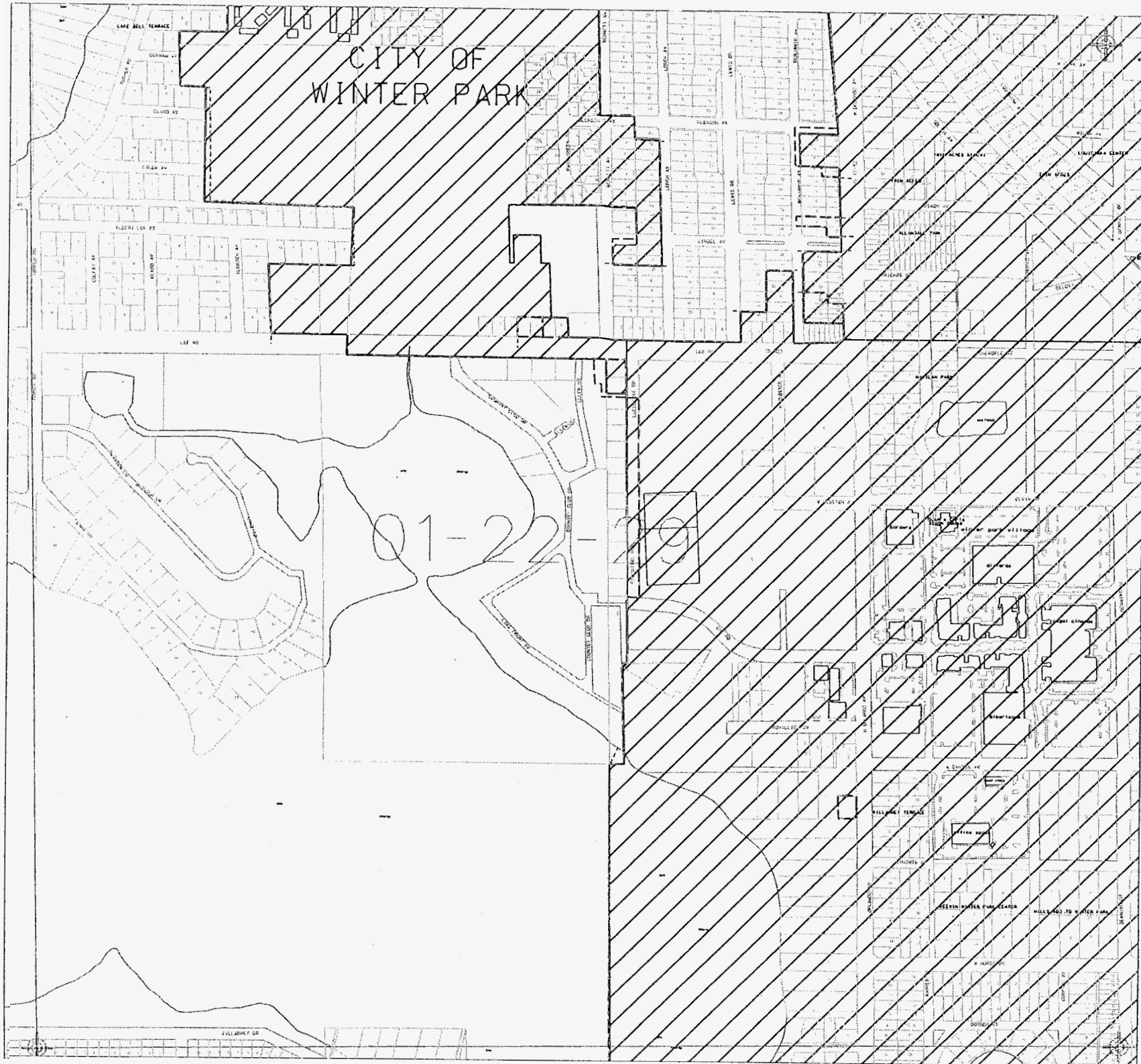

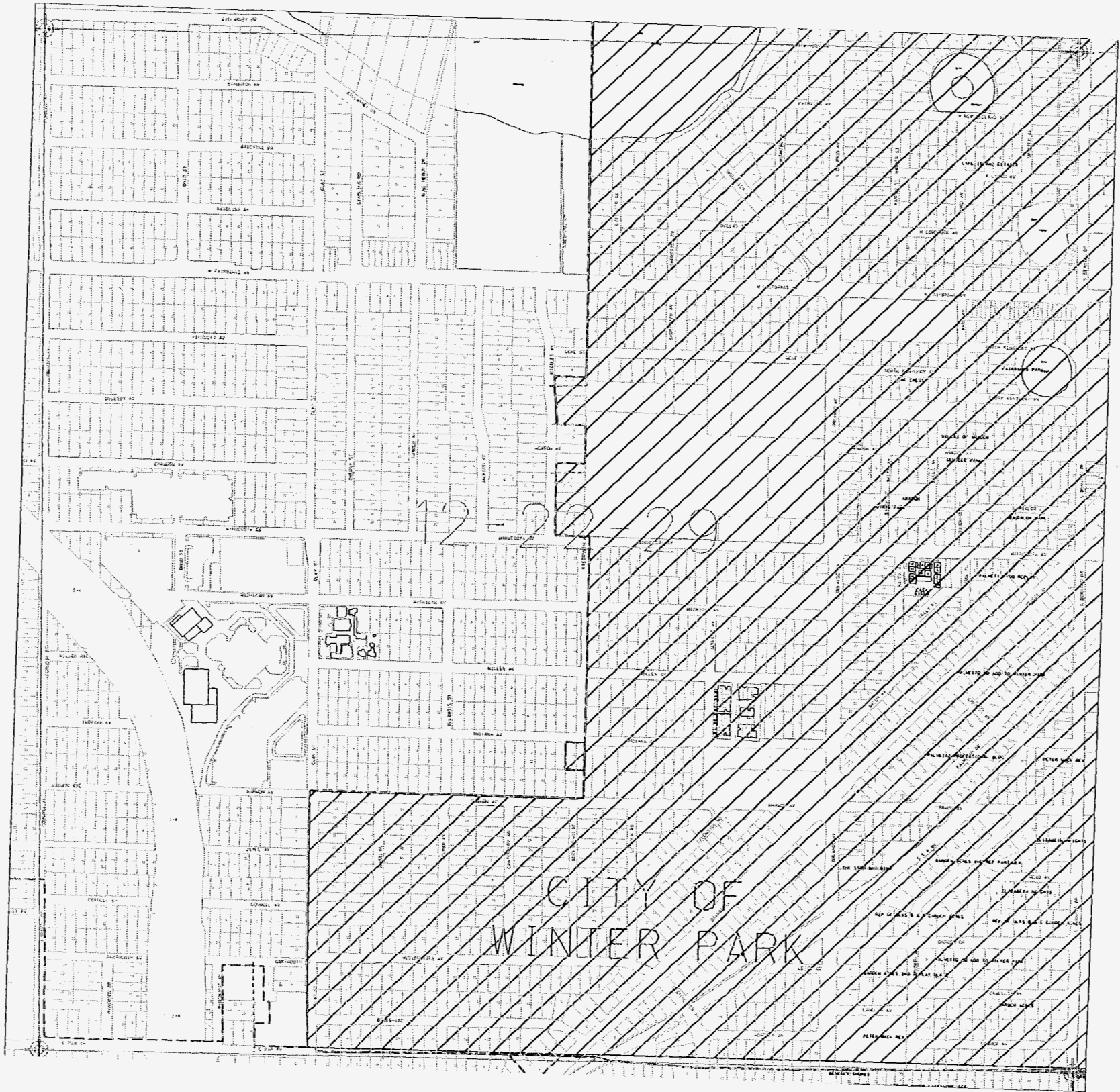

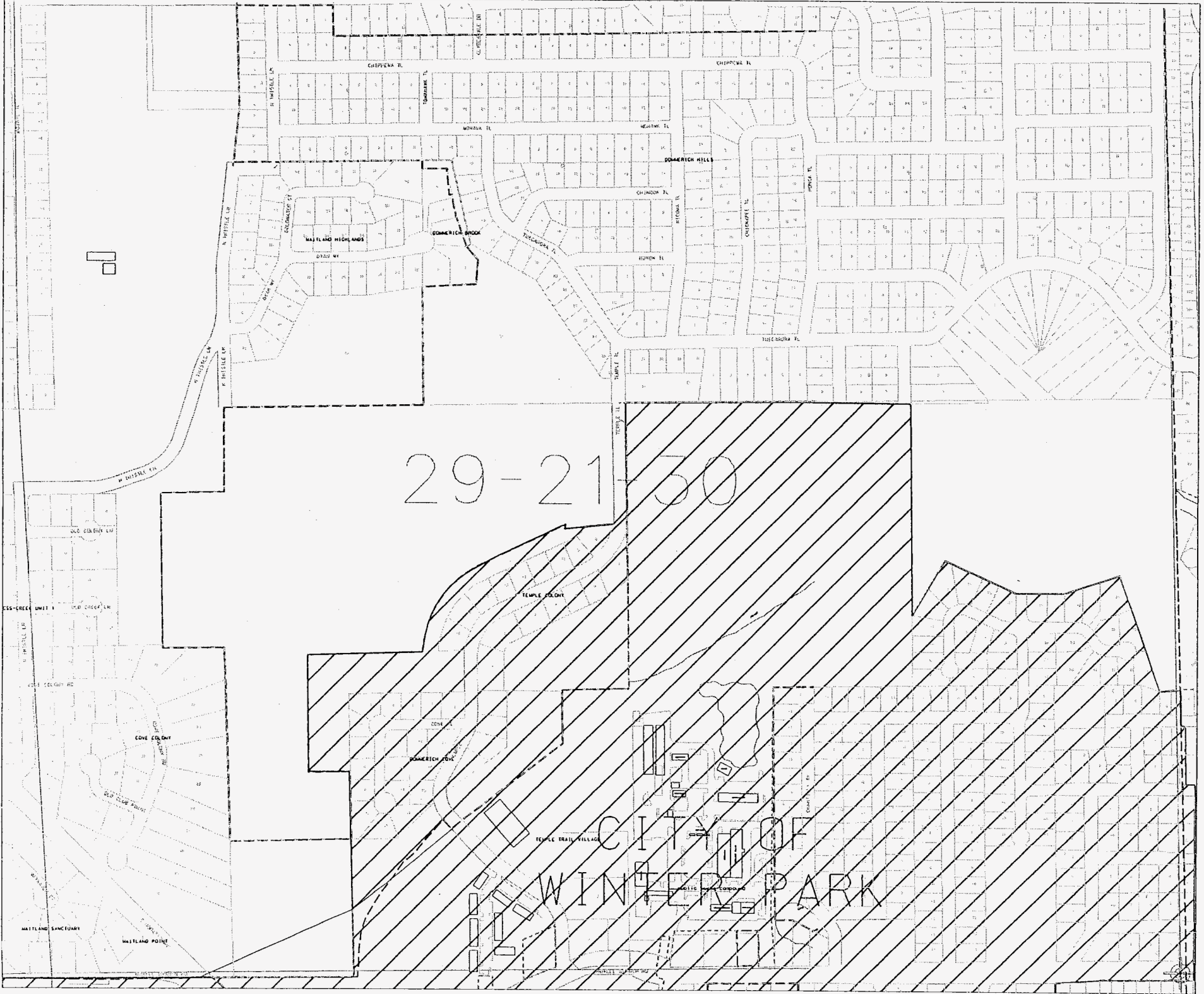

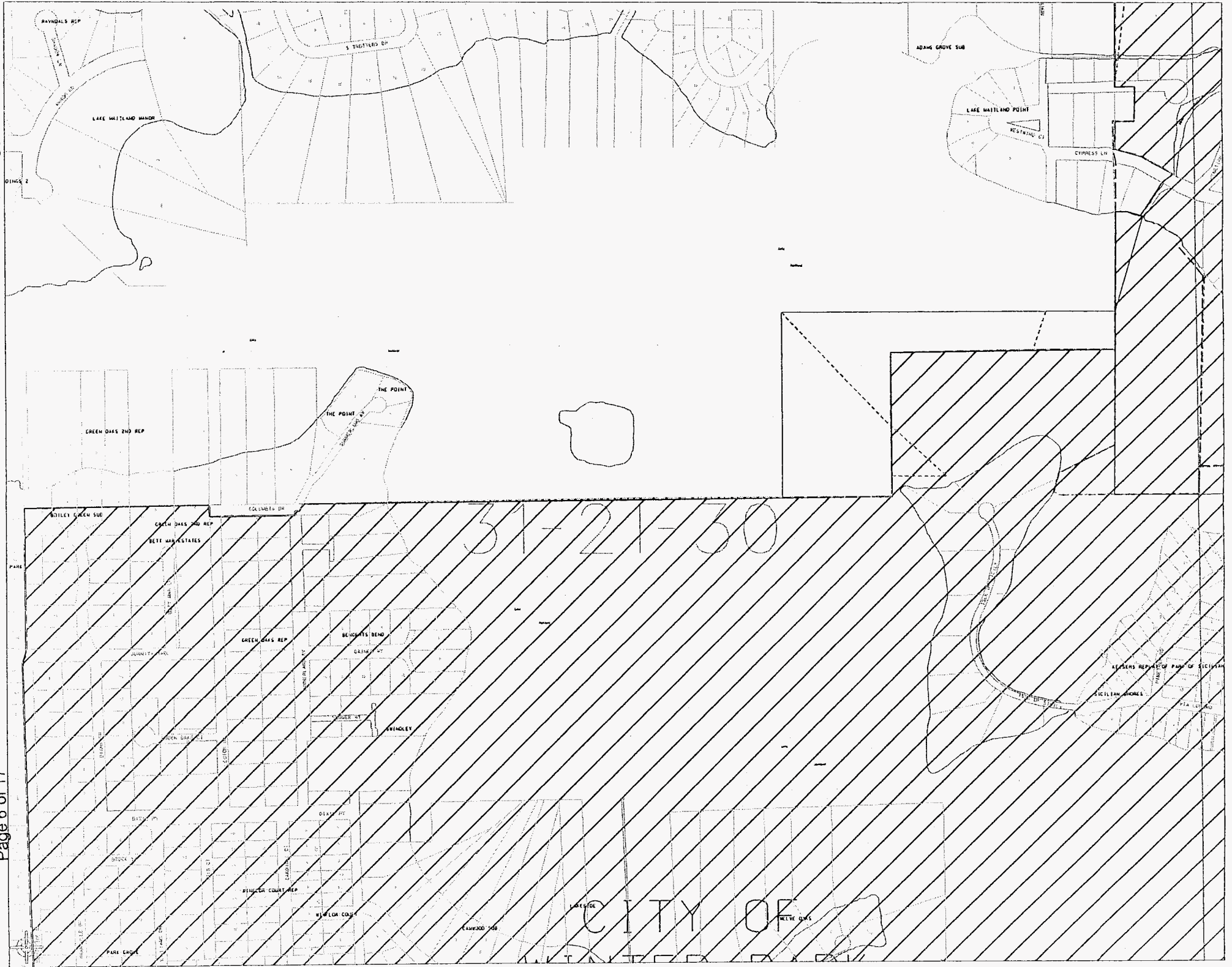

31-21-30

CITY OF WINTER GARDEN

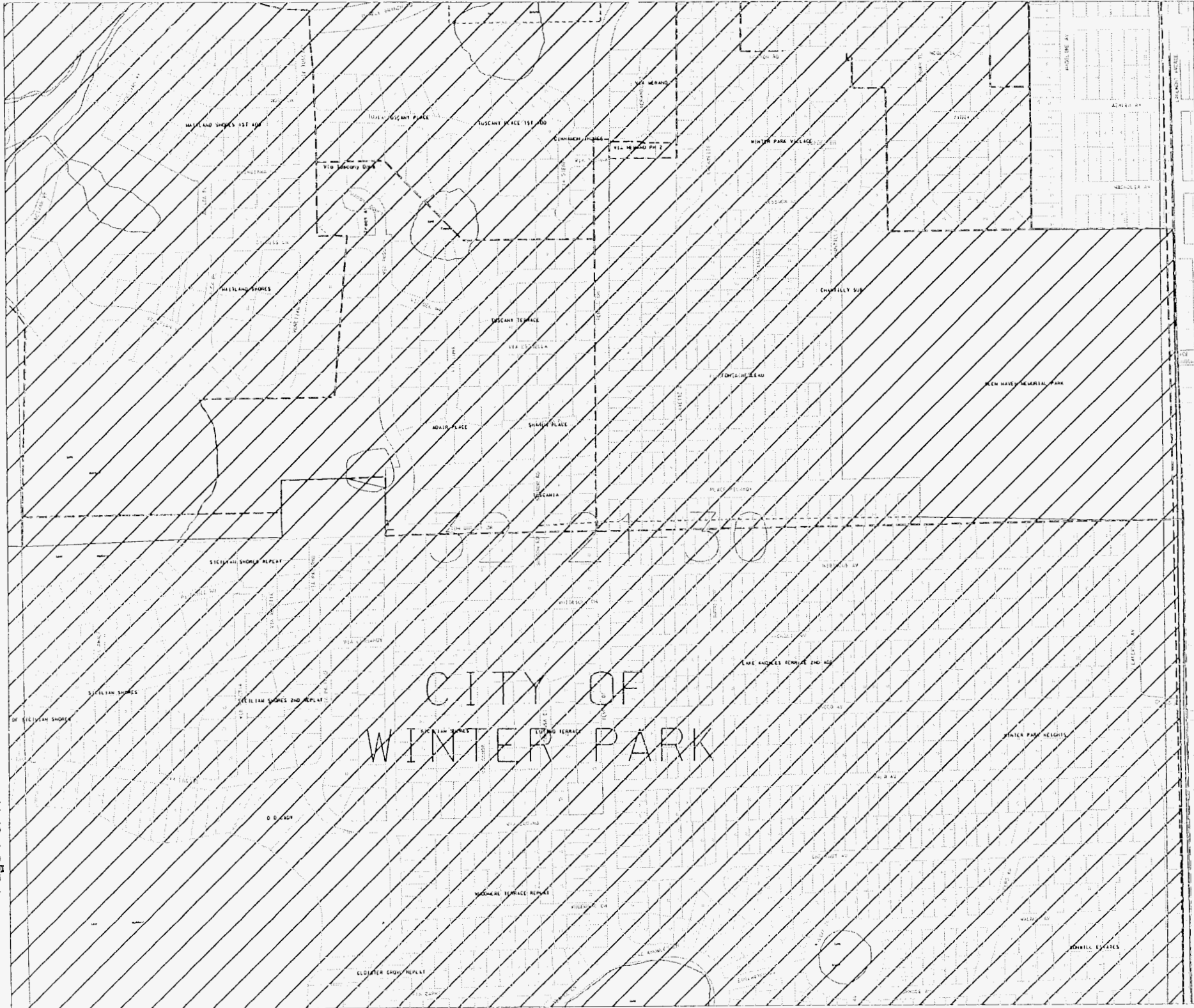



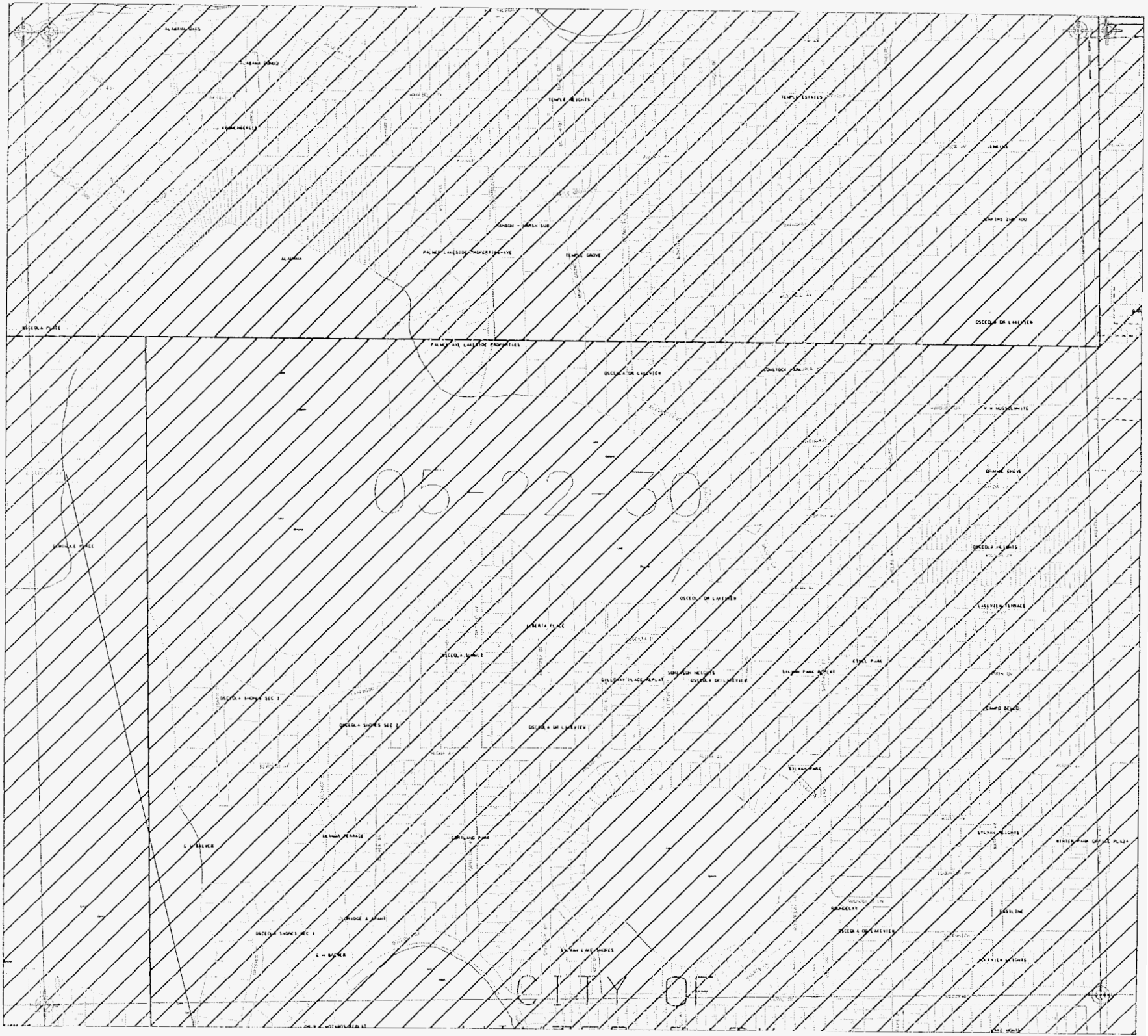



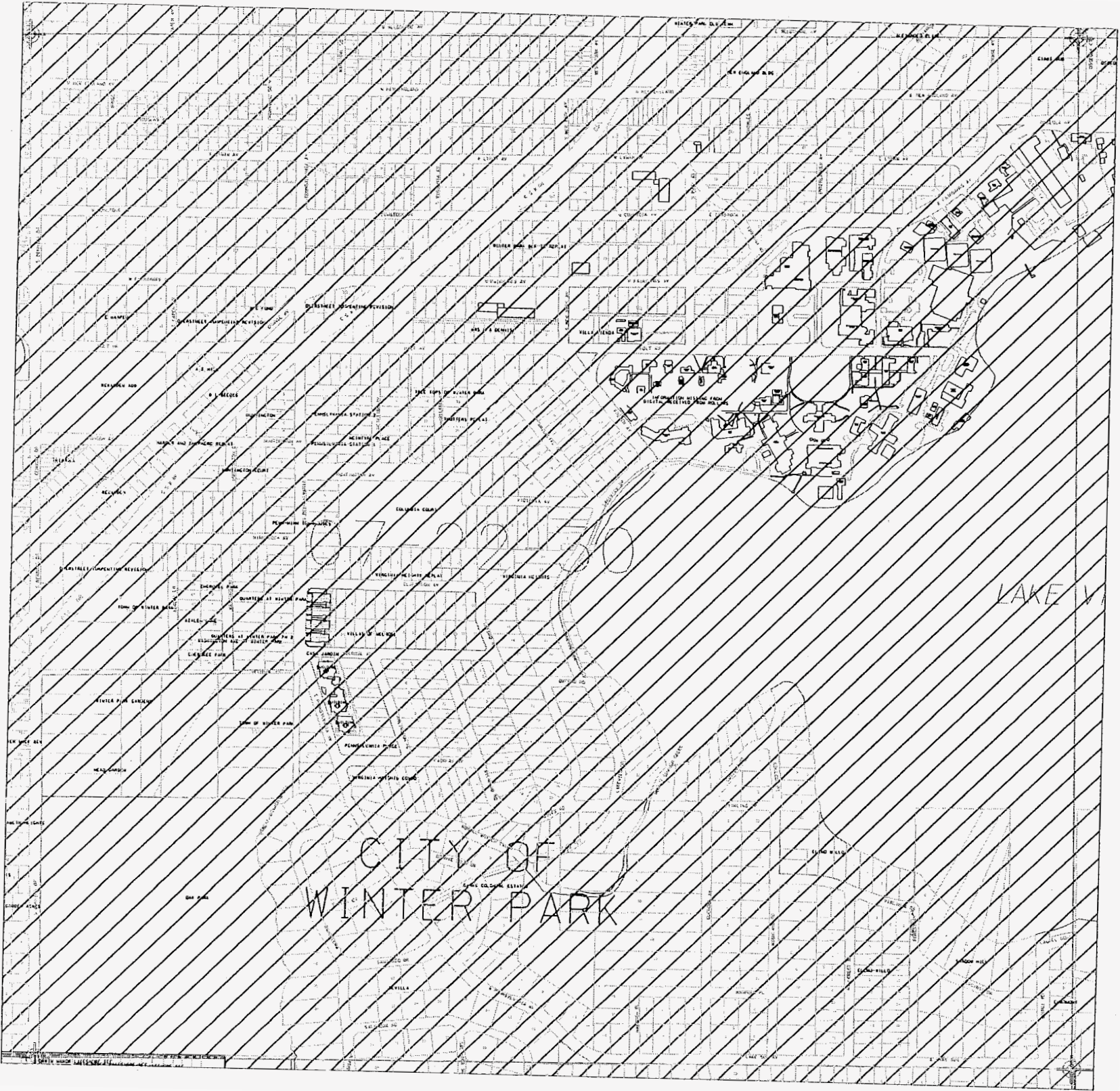

Winter Park
Service Area

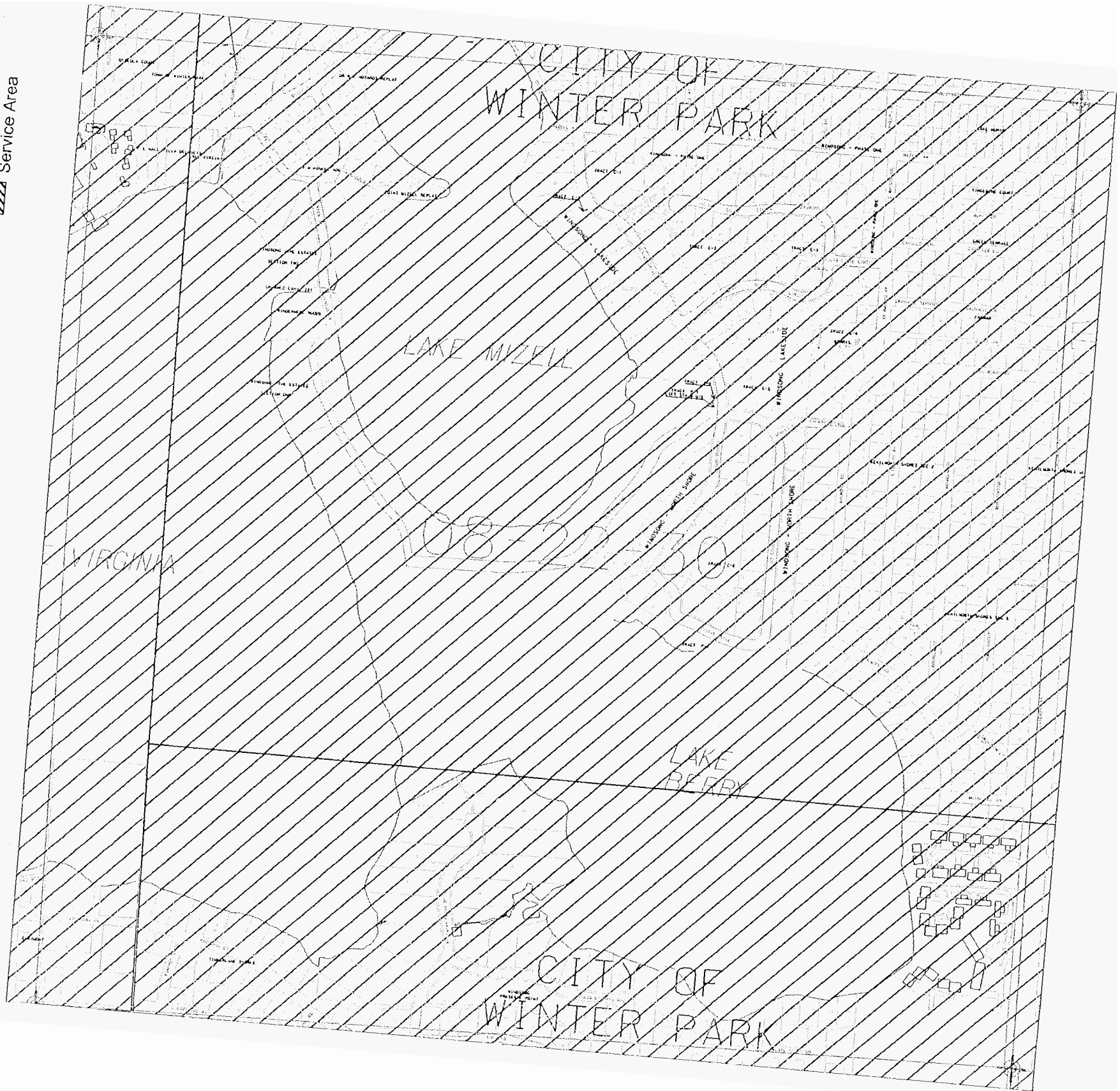

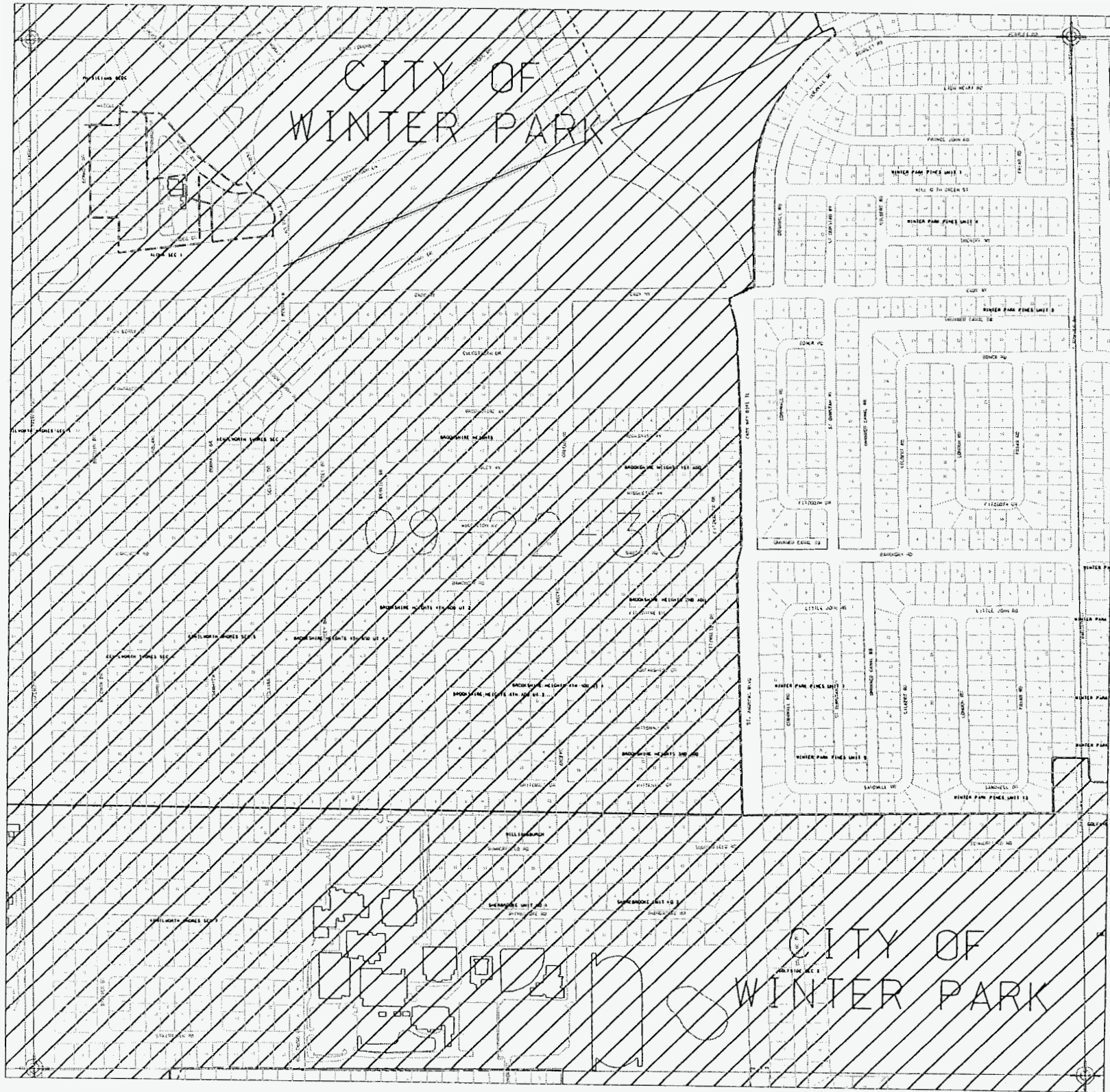

Winter Park
Service Area

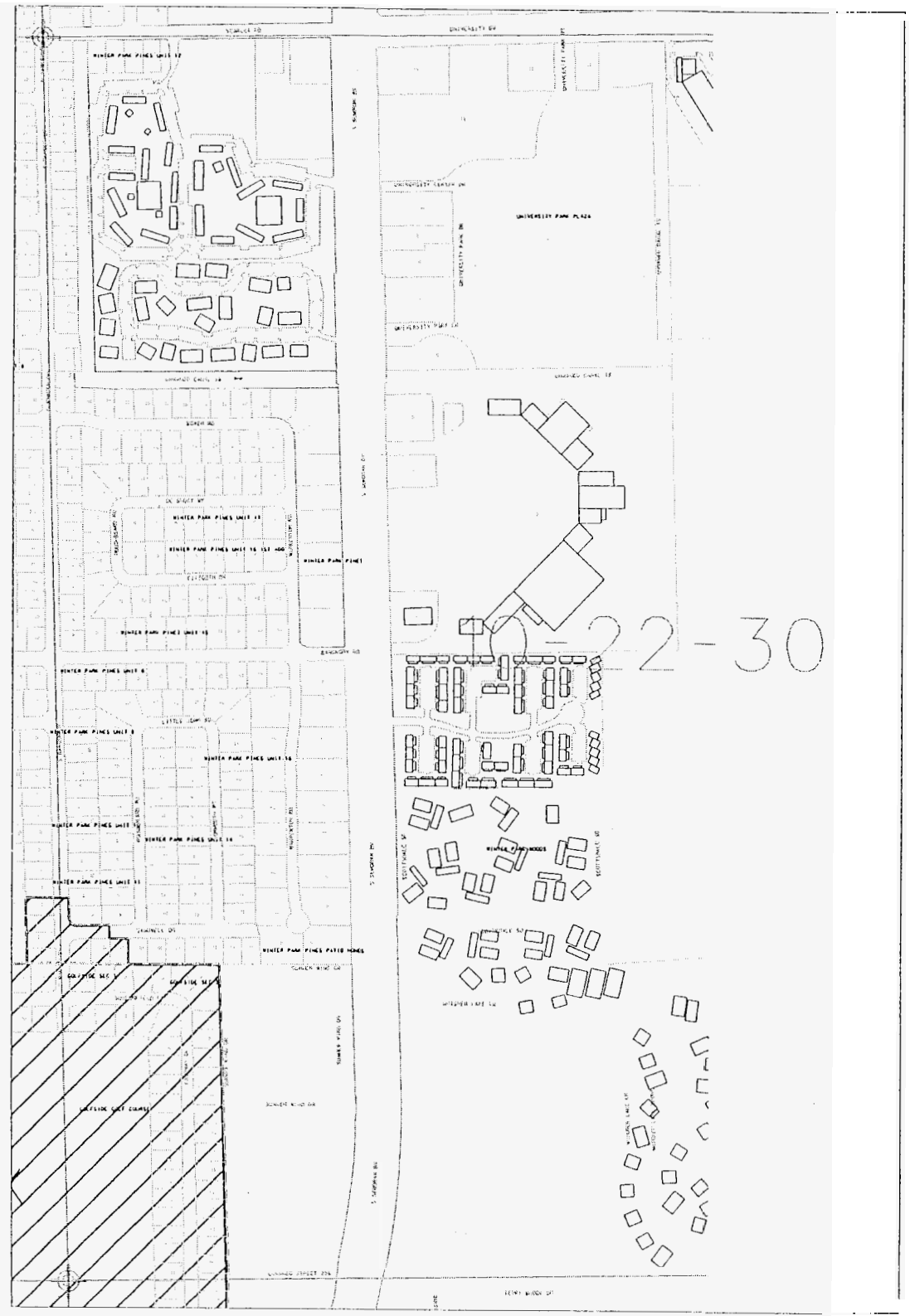

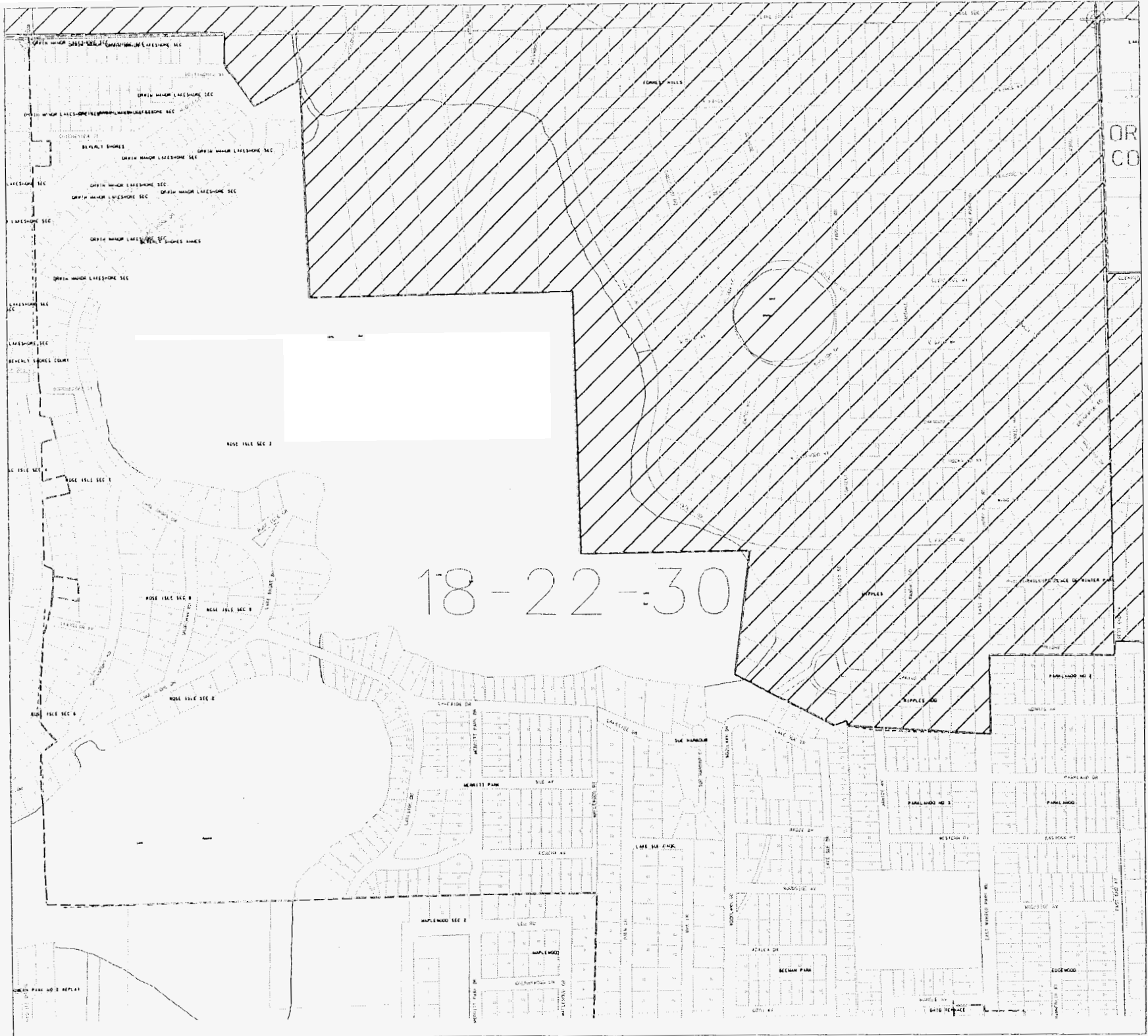

18-22-30

OR
CO

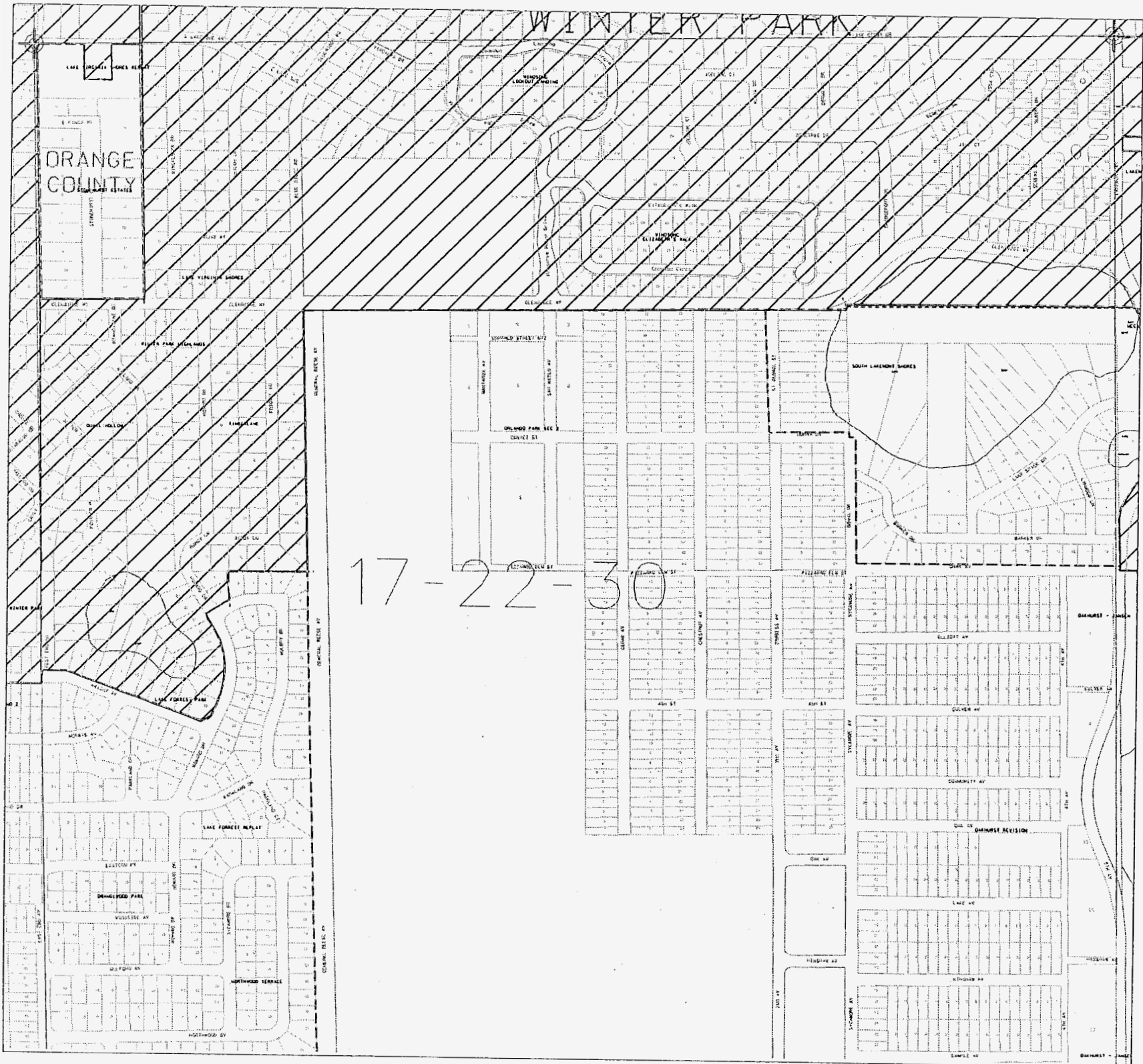

Winter Park
Service Area

