

ORIGINAL

Matilda Sanders

From: James A. McGee [jmcgee@tampabay.rr.com]
Sent: Monday, May 02, 2005 11:43 AM
To: Filings@psc.state.fl.us
Cc: Armstrong, Brian; Ken Hoffman
Subject: Docket No. 040133-EU, Joint Petition for Approval of Settlement, with Ex. B
Attachments: WREC-PEF Settlement Joint Petition (with Ex B maps).pdf

This electronic filing is made by:

James A. McGee
 P.O. Box 14042
 St. Petersburg, FL 33733
 727-820-5184
james.mcgee@pgnmail.com

Docket No. 040133-EU

In re: Petition of Withlacoochee River Electric Cooperative, Inc., to modify a Territorial Agreement with Progress Energy Florida, Inc., or, in the alternative, to resolve a territorial dispute in Hernando County, Florida.

On behalf of **Progress Energy Florida and Withlacoochee River Electric Cooperative.**

Consisting of **64 pages.**

The attached document for supplemental filing is the parties' **Joint Petition for Approval of Settlement and Implementation of First Phase, with Exhibit B, County Highway Maps,** including a filing letter.

CMP _____
 COM _____
 CTR _____
 ECR _____
 GCL _____
 OPC _____
 MMS _____
 RCA _____
 SCR _____
 SEC 1
 OTH Kim P.
 5/9/2005

DOCUMENT NUMBER-DATE
04255 MAY-2 05
 FPSC-COMMISSION CLERK

ORIGINAL



JAMES A. MCGEE
ASSOCIATE GENERAL COUNSEL
PROGRESS ENERGY SERVICE COMPANY, LLC

May 2, 2005

VIA ELECTRONIC FILING

Ms. Blanca S. Bayó, Director
Division of the Commission Clerk
and Administrative Services
Florida Public Service Commission
2540 Shumard Oak Boulevard
Tallahassee, Florida 32399-0850

Re: Docket No. 040133-EU; Joint Petition of Progress Energy Florida
and Withlacoochee River Electric Cooperative for Approval of
Settlement and Implementation of First Phase.

Dear Ms. Bayó:

My April 29, 2005 filing letter noted that the County Highway maps, Exhibit B to the subject Joint Petition, would be submitted by supplemental filing. I have therefore enclosed for supplemental filing the complete Joint Petition, including Exhibit B, which contains General Highway Maps for Hernando and Pasco Counties depicting the modified territorial boundary lines associated with the First Phase of the parties' settlement agreement.

Please acknowledge your receipt of the above filing as provided in the Commission's electronic filing procedures. Thank you for your assistance in this matter.

Very truly yours,

s/ James A. McGee

JAM/scc
Enclosures

cc: Brian P. Armstrong, Esquire
Kenneth A. Hoffman, Esquire

BEFORE THE FLORIDA PUBLIC SERVICE COMMISSION

In re: Petition of Withlacoochee River Electric Cooperative to modify a territorial agreement or, in the alternative, to resolve a territorial dispute with Progress Energy Florida in Hernando County.

Docket No. 040133-EU

Submitted for filing:
April 29, 2005

**JOINT PETITION FOR APPROVAL OF SETTLEMENT
AND THE IMPLEMENTATION OF FIRST PHASE**

Withlacoochee River Electric Cooperative, Inc. ("WREC") and Progress Energy Florida, Inc. ("Progress Energy") (collectively, "the Joint Petitioners"), jointly petition the Florida Public Service Commission ("the Commission") for approval of a settlement reached by WREC and Progress Energy, attached hereto as Exhibit A, which resolves all outstanding issues pending before the Commission in this proceeding and substantially furthers their ongoing negotiations to amend and consolidate four existing territorial agreements delineating their respective service areas in Citrus, Hernando and Pasco Counties. In conjunction with the approval of their settlement, the Joint Petitioners also seek the Commission's approval to implement the first phase of the settlement consisting of modifications to their Territorial Boundary Line in four areas of Hernando and Pasco Counties, including the Majestic Oaks development which is the subject of the pending dispute in this proceeding, and the transfer of certain customers related to the Boundary Line modifications in the three other areas. In support hereof, the Joint Petitioners represent as follows:

Background

1. By Order No. PSC-04-0339-PCO-EU, issued , 2004, the Prehearing Officer granted the Joint Motion of WREC and Progress Energy to hold this proceeding in abeyance to allow the parties to pursue the opportunity for an amicable settlement of the disputed issues then pending before the Commission. After extended negotiations, WREC and Progress Energy have reached a settlement which fairly balances their respective interests and, if approved by the Commission, will resolve all outstanding in the pending docket.

2. The negotiations that culminated in the settlement took place against a backdrop of existing negotiations between WREC and Progress Energy to amend and consolidate four currently effective territorial agreements that delineate their service areas in Citrus, Hernando and Pasco Counties.¹ WREC and Progress Energy were able to achieve a settlement that maintains a fair balance of their respective interests by expanding the scope of the settlement beyond the Majestic Oaks dispute in the pending docket to include six additional areas in Hernando and Pasco Counties which were among the areas under discussion in the parties' broader negotiations to amend and consolidate their current territorial agreements. As a result, the settlement will substantially further the parties' efforts toward such an amended and consolidated territorial agreement.

¹ The Commission has been made aware of these negotiations by virtue of two previous Joint Petitions filed by WREC and Progress Energy to extend the expiration dates in three of the current territorial agreements to provide the parties additional time to negotiate an amended and consolidated agreement.

The Settlement

3. The settlement reached by WREC and Progress Energy, as set forth in the attached Exhibit A, includes the following key provisions:

- The parties' territorial boundary line will be modified to located the entire Majestic Oaks development in Hernando County within the service territory of WREC, including 452 lots currently located in Progress Energy's service territory. This will also satisfy the desire of the developer, Majestic Oaks Partners, LLC, to have the development receive electric service from a single supplier.
- The territorial boundary line will be modified to place a portion of the area known as Masaryktown located south of the County Line Road in northern Pasco County within the service territory of WREC. The area contains approximately 366 customers currently served by Progress Energy.
- The territorial boundary line will be modified to include the area in and around Trilby located in northern Pasco County and eastern Hernando County within the service territory of WREC. The area contains approximately 1,671 electric customers currently served by Progress Energy.
- The territorial boundary line will be modified to include the area known as the East Pasco Well Field located in southern Pasco County within the service territory of Progress Energy. The area contains approximately 706 customers currently served by WREC from its Pasco Well Field substation

site, which Progress Energy will acquire and construction a new substation needed to serve customer growth in this and surrounding areas.

- The territorial boundary line will be modified to locate the area near Seven Springs in southern Pasco County within the service territory of Progress Energy. The area contains approximately 1754 customers currently served by WREC.
- The territorial boundary line will be modified to include the area known as East Gate Estates in southern Pasco County within the service territory of Progress Energy. The area contains approximately 78 customers currently served by WREC.
- The territorial boundary line will be modified to place the area known as Orangewood Mobile Home Park in southern Pasco County within the service territory of Progress Energy. The area contains approximately 257 customers currently served by WREC.
- Approximately 194 Extra-Territorial Customers under the current territorial agreements who are located within Progress Energy's service territory in Hernando and Pasco Counties and are currently served by WREC will be transferred to Progress Energy. All remaining Extra-Territorial Customers and the accounts of all former Extra-Territorial Customers that have experienced a change of use but are not yet served by the utility in whose service territory they are located will be addressed in the amended and consolidated territorial agreement such that service will be provided by the

utility in whose territory they are either currently located or will subsequently be located as the result of further boundary line modifications.

- The distribution facilities of each utility used exclusively for providing service to customers transferred pursuant to the settlement, including WREC's Pasco Well Field substation, will be transferred in conjunction with the customers.

4. Because of the settlement's broad scope, including the transfer of approximately 5,000 customers, it provides for implementation of the territorial boundary line modifications and related customer transfers in two phases. The first phase, consisting of the Majestic Oaks development in Hernando County and the Masaryktown, East Pasco Well Field, and East Gate Estates areas in Pasco County, is to be implemented in conjunction with the Commission's consideration of this Joint Petition for approval of the settlement. These areas are shown on the official General Highway County maps for Hernando and Pasco Counties contained in the attached Exhibit B.

The second phase includes the Trilby and Seven Springs areas, the two most populous areas covered by the settlement, the Orangewood Mobile Home Park in Pasco County, and the transfer of the Extra-Territorial Customers currently served by WREC in Hernando and Pasco Counties, which is to be implemented as a part of amendment and consolidation of the current agreements. As provided in the Settlement Agreement, the parties will submit the amended and consolidated territorial agreement and the second phase boundary line modifications and

customer transfers in a second joint petition which the parties have agreed to file for Commission approval by no later than June 30, 2005.

5. The parties expect that all first phase transfers of customers and related service facilities will be completed within six months of the Commission's order approving the transfers. The parties are agreeable to submitting periodic reports on the status of these customer and related facilities transfers if that is the Commission's desire, and will provide the Commission advance notification if extenuating circumstances require additional time to complete the transfers. The service addresses of the customers subject to transfer under the settlement's first phase are listed in the attached Exhibit C, which includes 799 customers to be transferred from WREC to Progress Energy and 359 customers to be transferred from Progress Energy to WREC (there are no customers residing in Majestic Oaks at this time).

6. Prior to the filing of this Joint Petition, all customers subject to transfer under the first phase implementation of the Settlement Agreement have been sent written notification of the settlement between WREC and Progress Energy, the transfer provisions described above, the necessity of Commission approval, and their opportunity to be heard in this regard. A sample copy of the letters providing such notification to the affected customers are contained in Exhibit D hereto. As of the time of filing, no responses to the notification letters have been received. A summary of the responses ultimately received, if any, will be provided by supplemental filing.

7. The parties represent that approval of the settlement, including the boundary line modifications and customer transfers provided for therein, will not cause a decrease in the reliability of electrical service to the existing or future customers of either utility. To the contrary, the parties believe that the settlement's boundary line modifications and customer transfers will enable the utilities to plan and operate their systems more efficiently, and will thereby serve to improve reliability, further the objective of eliminating uneconomic duplication of facilities, and promote the Commission's long-standing policy of encouraging territorial agreements between and among Florida's electric utilities.

WHEREFORE, WREC and Progress Energy respectfully request that the Commission grant this Joint Petition and approve the settlement contained in Exhibit A hereto and implementation of the settlement's first phase territorial boundary line modifications and transfers of customers and service facilities as described above

Respectfully submitted,



Brian P. Armstrong
Nabors, Giblin & Nickerson, P.A.
1500 Mahan Drive, Suite 200
Tallahassee, Florida 32308
Telephone: 850-224-4070
Facsimile: 850-224-4073
Attorney for
WITHLACOOCHEE RIVER ELECTRIC
COOPERATIVE, INC.

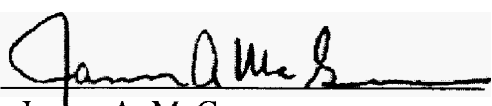

James A. McGee
Associate General Counsel
Progress Energy Service Company, LLC
Post Office Box 14042
St. Petersburg, Florida 33733-4042
Telephone: 727-820-5184
Facsimile: 727-820-5519
Attorney for
PROGRESS ENERGY FLORIDA, INC.

EXHIBIT A

**Settlement Resolving All Outstanding Issues
Between Progress Energy Florida and
Withlacoochee River Electric Cooperative
in Docket No. 040133-EU**

FPSC DOCKET No. 040133-EU

SETTLEMENT AGREEMENT

Withlacoochee River Electric Cooperative, Inc. ("WREC") and Progress Energy Florida, Inc. ("PEF") (also referred to individually as "Party" and collectively as "Parties") enter into this Settlement Agreement for the purpose of resolving all outstanding issues currently pending before the Florida Public Service Commission (the Commission) in Docket No. 031057-EI and, accordingly, hereby stipulate and agree as follows:

1. **Definitions.** As used in this Settlement Agreement, the definitions of following terms shall apply.
 - (a) The term "Existing Agreements" shall mean the four currently effective territorial agreements between the Parties that delineate their respective territorial areas in Citrus County and western Pasco County, which were approved by the Commission in Order No. 19610, issued July 5, 1988 in Docket No. 880234-EU; in eastern Pasco County, which was approved by the Commission in Order No. 20368, issued November 30, 1988 in Docket No. 881164-EU; and in Hernando County, which was approved by the Commission in Order No. 25309, issued November 7, 1991 in Docket No. 910940-EU.
 - (b) The term "Existing Territorial Boundary Line(s)" shall mean the territorial boundary line or lines established in each of the Existing Agreements.
 - (c) The term "Amended Agreement" shall mean the territorial agreement that results from the negotiations currently in process between the Parties to amend, consolidate and restate the Existing Agreements.

- (d) The term "Extra-Territorial Customers" shall mean those customers served by either Party on the effective date of the applicable Existing Agreement who are located within the service territory of the other Party established by such Existing Agreement.
- (e) The term "Effective Date" shall mean the date of a final order issued by the Commission approving this Settlement Agreement in its entirety and the implementation of Phase 1 as set forth herein.
2. The Existing Territorial Boundary Lines will be modified in a manner that places the following areas in the service territory of WREC: (a) the entire Majestic Oaks development located in Hernando County and depicted on the maps contained in the attached Exhibit A, including the portion thereof consisting of approximately 452 lots currently situated in PEF's service territory which is the subject of the pending docket; (b) the portion of the area known as Masaryktown located south of County Line Road in Pasco County, as depicted on the maps contained in the attached Exhibit A, which includes approximately 366 PEF customers; and (c) the area in and around Trilby in Pasco County, as depicted on the maps contained in the attached Exhibit A, which includes approximately 1,671 PEF customers.
3. The Existing Territorial Boundary Line will be modified in a manner that places the following areas in the service territory of PEF: (a) The area known as the "East Pasco Well Field" located in Pasco County, as depicted on the maps contained in the attached Exhibit A, which includes approximately 706 customers currently served by WREC from its Pasco Well Field substation; (b) the portion of the area near Seven Springs in Pasco County, as depicted on the maps contained in the

attached Exhibit A, which includes approximately 1,754 customers currently served by WREC; (c) the area known as East Gate Estates in Pasco County, as depicted on the maps contained in the attached Exhibit A, which includes approximately 78 customers currently served by WREC; and (d) the area known as Orangewood Mobile Home Park in Pasco County, as depicted on the maps contained in the attached Exhibit A, which includes approximately 257 customers currently served by WREC.

4. The approximately 194 Extra-Territorial Customers located within PEF's service territory in Hernando and Pasco Counties who are currently served by WREC under the Existing Agreements will also be transferred to PEF. All remaining Extra-Territorial Customers and the accounts of all former Extra-Territorial Customers that have experienced a change of use, and thus constitute New Customers under the terms of the Existing Agreements, but are not yet served by the utility in whose service territory they are located, will be addressed by the Amended Agreement which shall provide for the accounts of these current and former Extra-Territorial Customers as follows: (a) Such accounts will be served by the utility in whose service territory the accounts are currently located, which the Parties will implement in conjunction with, and subject to the same time limitations as the transfer of customers authorized by the Commission's final order approving the Amended Agreement, or (b) further modifications to the Existing Boundary Lines place such accounts in the service territory of the utility currently serving the accounts.

5. The modifications to the Existing Territorial Boundary Lines and the related customer transfers described in paragraphs 2 and 3 above, and the transfer of Extra-Territorial Customers described in paragraph 4 above, will be implemented in two phases.

(a) Phase 1 will be implemented in conjunction with the Parties' joint petition for approval of this Settlement Agreement and will include the following areas:

(1) The portion of the Majestic Oaks development currently located within PEF's service territory, as described in paragraph 2; (2) the portion of the Masaryktown area currently served by PEF, as described in paragraph 2; (3) the East Pasco Well Field area currently served by WREC, as described in paragraph 3; and (4) the East Gate Estates area currently served by WREC, as described in paragraph 3.

(b) Phase 2 will be included as a part of and implemented in conjunction with the Parties' joint petition for approval of the Amended Agreement, which the Parties will file not later than June 30, 2005, and will include the following areas: (1) The area in and around Trilby currently served by PEF, as described in paragraph 2; (2) the portion of the area near Seven Springs currently served by WREC, as described in paragraph 3; and (3) the area known as Orangewood Mobile Home Park currently served by WREC, as described in paragraph 3. Phase 2 will also include the transfer of the approximately 194 Extra-Territorial Customers currently served by WREC, as described in paragraph 4.

6. The number of customers identified for each of the areas described in paragraphs 2, 3 and 4, particularly those areas to be implemented in Phase 2, are based on estimates that may require adjustment as ongoing field inventories are completed. If the actual number of customers subject to transfer within these areas varies from the estimates such that either Party is adversely affected relative to the other Party, the Parties agree to identify other areas in which Boundary Line modifications would restore the customer balance reflected in these estimates and upon which the Parties' settlement was reached. Any such areas so identified will be included in the Amended Agreement.
7. The distribution facilities of each Party used exclusively for providing service to customers transferred to the other Party pursuant to this Settlement Agreement or the Amended Agreement shall be transferred in conjunction with the transfer of customers. Compensation for such distribution facilities shall be paid in accordance with the following provision:

The receiving Party shall compensate the transferring Party in an amount based upon the replacement cost (new), less depreciation calculated on a straight line basis over the life of the asset (facility) as determined from the transferring Party's books and records. The replacement cost shall be determined by applying a cost escalator such as the Handy Whitman Index or a common engineering cost estimation methodology to the original cost, as long as both parties apply the same escalation method.

The distribution facilities subject to this paragraph include, without limitation, WREC's Pasco Well Field substation identified in paragraph 3(a). Upon Commission

approval of this Settlement Agreement, WREC shall assign to PEF its ownership, leasehold, easement and other interests, if any, in the substation's distribution facilities, the substation property, and the roadway providing ingress and egress thereto, and shall provide to PEF such other documents or transfer instruments as may be reasonably necessary to establish PEF's interest in the substation. WREC shall be paid for the transfer of its interests in such substation property and roadway in an amount to be determined by mutual agreement, in addition to the compensation WREC shall receive for the substation's distribution facilities provided for in this paragraph.

8. In addition to the areas described in paragraphs 2 and 3, WREC and PEF recognize the existence of other areas covered by the Existing Agreements that may also warrant Territorial Boundary Line modifications due to various conditions which have arisen or changed since the Boundary Lines were initially established. These additional Boundary Line modifications will be included in the Amended Agreement as they are identified by the Parties.
9. This Settlement Agreement is expressly conditioned upon approval in its entirety by a final order of the Commission. In the event such approval is denied by the Commission, this Settlement Agreement shall be null and void, and of no further force or effect.
10. Except as amended, revised, or otherwise provided for by this Settlement Agreement, the terms and conditions of the Existing Agreements shall remain in full force and effect until such time as this Settlement Agreement and the Existing

Agreements are subsumed within, and amended, restated and consolidated by the Amended Agreement. Until such time, in the event of any conflict or inconsistency between this Settlement Agreement and any of the Existing Agreements, the terms and conditions of this Settlement Agreement shall prevail.

11. The Parties agree that this Settlement Agreement resolves all outstanding issues between the Parties currently pending before the Commission in Docket No. 040133-EU, and that upon approval of the Agreement as provided herein and the consent of the intervenor, Majestic Oaks Partners, LLC, the docket should be closed by the Commission.
12. This Settlement Agreement may be executed in counterpart originals, and a facsimile of an original signature will be deemed an original.

In Witness Whereof, the Parties evidence their acceptance and agreement with the provisions of this Settlement Agreement by the signatures of their duly authorized representatives.

Dated April 28, 2005.

**WITHLACOOCHEE RIVER ELECTRIC
COOPERATIVE, INC.**

By 

Billy E. Brown
Executive Vice President
and General Manager

PROGRESS ENERGY FLORIDA, INC.

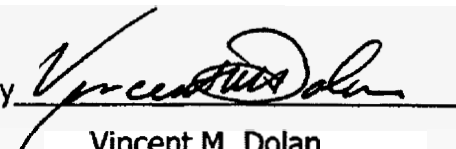
By 

Vincent M. Dolan
Vice President

EXHIBIT B

**General Highway Maps for
Hernando and Pasco Counties**
depicting the First Phase
modified territorial boundary lines

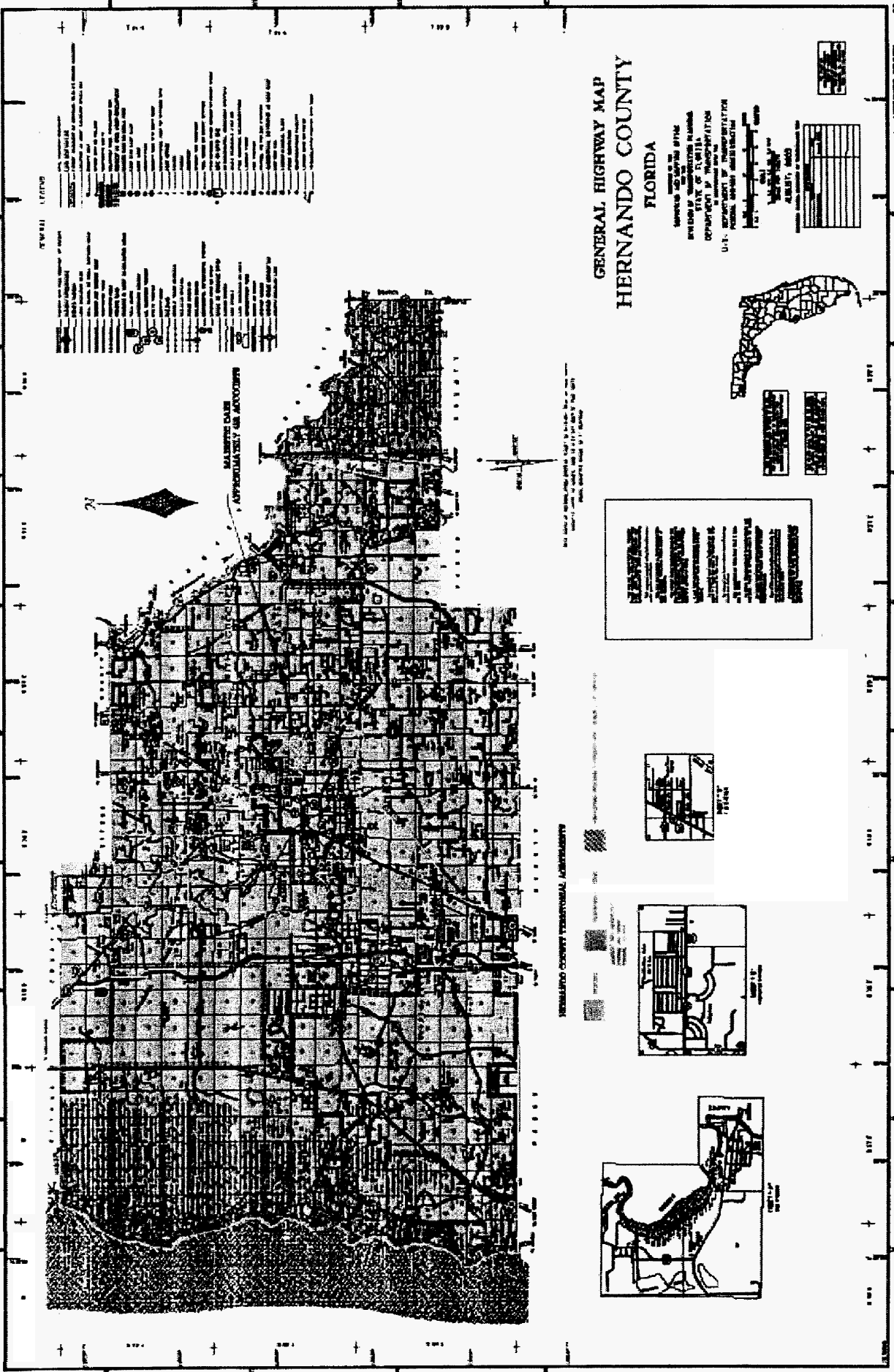

GENERAL HIGHWAY MAP HERNANDO COUNTY FLORIDA

DESIGNED BY
BUREAU OF HIGHWAYS
STATE OF FLORIDA
DEPARTMENT OF TRANSPORTATION
PUBLISHED BY THE DEPARTMENT OF TRANSPORTATION
HAINES, FLORIDA



LEGEND
SOLID LINE
DASHED LINE
DOTTED LINE
THIN SOLID LINE
THICK SOLID LINE
THICK DASHED LINE
THICK DOTTED LINE
THICK SOLID LINE WITH DASHES
THICK SOLID LINE WITH DOTS
THICK SOLID LINE WITH WAVES
THICK SOLID LINE WITH WAVES AND DOTS
THICK SOLID LINE WITH WAVES AND DASHES
THICK SOLID LINE WITH WAVES AND DOTS AND DASHES

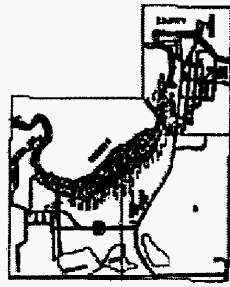
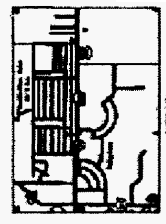

LEGEND

1	Primary Highway
2	Secondary Highway
3	Tertiary Highway
4	County Road
5	Railroad
6	Electric Railroad
7	Streetcar
8	Water
9	Canal
10	Lock
11	Dam
12	Airport
13	Cemetery
14	School
15	Church
16	Post Office
17	Jail
18	Prison
19	Hospital
20	School Bus
21	Gas Station
22	Telephone Office
23	Police Station
24	Fire Department

SCALE BAR
1 INCH = 1 MILE



HERNANDO COUNTY TRANSPORTATION ADMINISTRATION
1958

DESIGNED BY
BUREAU OF HIGHWAYS
STATE OF FLORIDA
DEPARTMENT OF TRANSPORTATION
PUBLISHED BY THE DEPARTMENT OF TRANSPORTATION
HAINES, FLORIDA

HERNANDO COUNTY, FLORIDA

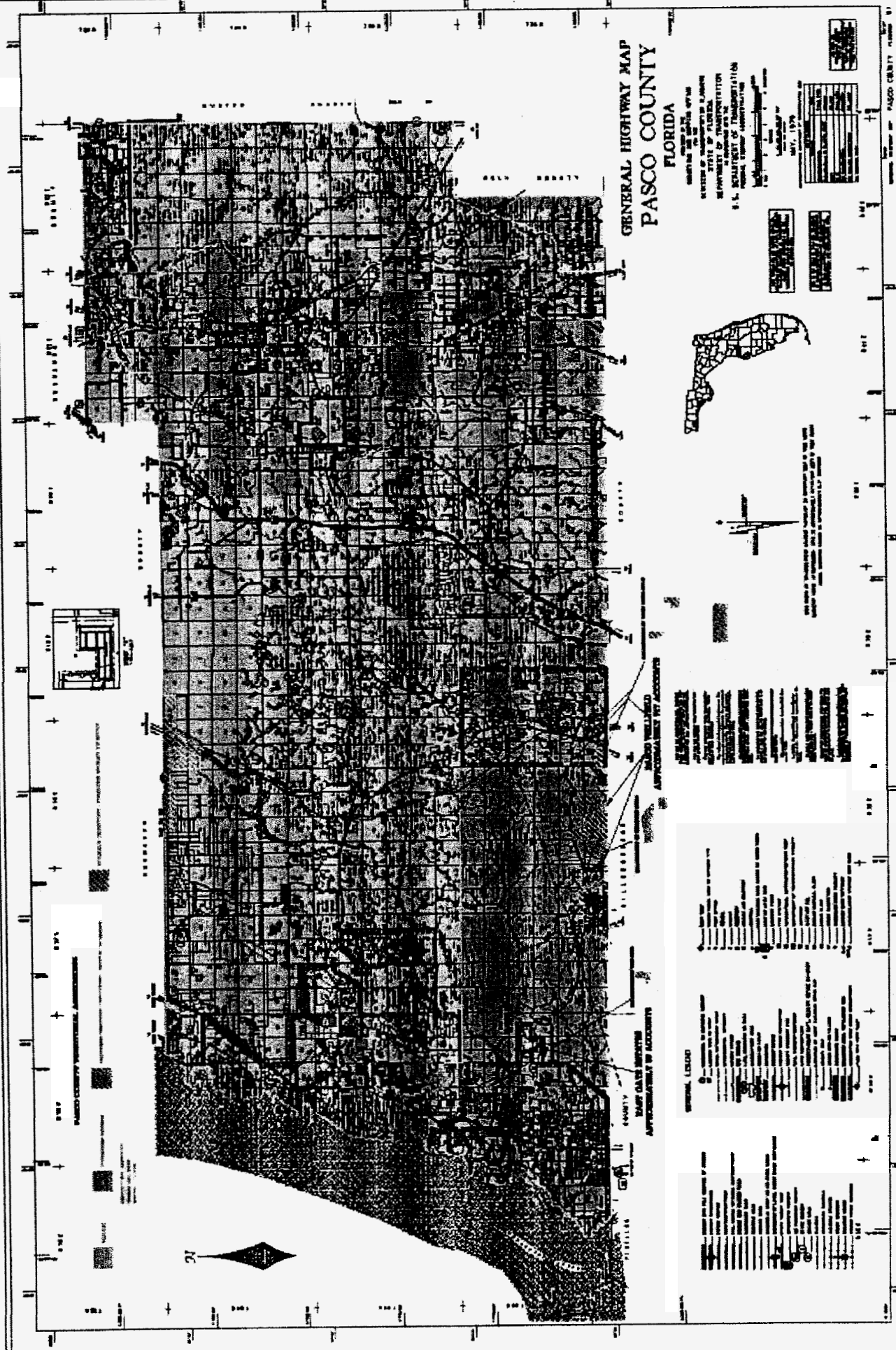

**GENERAL HIGHWAY MAP
PASCO COUNTY
FLORIDA**

DESIGNED BY THE BUREAU OF
ROADS AND TRANSPORTATION
U.S. DEPARTMENT OF TRANSPORTATION
WASHINGTON, D.C.

CLASSIFICATION	SYMBOL
Interstate Highway	(Solid black line)
Primary Highway	(Thick black line)
Secondary Highway	(Thin black line)
County Road	(Dashed black line)
Unimproved Road	(Thin solid black line)



- SYMBOLS USED TO INDICATE**
- Interstate Highway
 - Primary Highway
 - Secondary Highway
 - County Road
 - Unimproved Road
 - Waterway
 - Canal
 - Railroad
 - Power Line
 - Telephone Line
 - Gas Line
 - Water Line
 - Fire Line
 - Electric Line
 - Gasoline Station
 - Hotel
 - Restaurant
 - Post Office
 - City
 - Town
 - Village
 - Unincorporated Place
 - Unimproved Land
 - Swamp
 - Marsh
 - Forest
 - Open Land
 - Water

GENERAL LEGEND

Shaded areas indicate land under various types of ownership or use. The shading is not intended to indicate any specific ownership or use, but is merely a general indication of the character of the land.

ROAD DATA SUMMARY
APPROXIMATELY BY ACCIDENTS

This summary is based on data furnished by the Florida Department of Transportation for the year 1954. It is intended to provide a general indication of the relative safety of the roads in Pasco County.

ROAD DATA SUMMARY
APPROXIMATELY BY ACCIDENTS

This summary is based on data furnished by the Florida Department of Transportation for the year 1954. It is intended to provide a general indication of the relative safety of the roads in Pasco County.

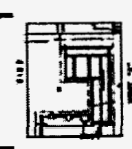

Scale: 1 inch = 1 mile

Vertical Scale: 1 inch = 100 feet

Horizontal Scale: 1 inch = 1 mile

Vertical Datum: Mean Sea Level

Horizontal Datum: North American Datum of 1954

Projection: Universal Transverse Mercator

Zone: 18N

Units: Feet

Scale: 1 inch = 1 mile

Vertical Scale: 1 inch = 100 feet

Horizontal Scale: 1 inch = 1 mile

Vertical Datum: Mean Sea Level

Horizontal Datum: North American Datum of 1954

Projection: Universal Transverse Mercator

Zone: 18N

Units: Feet

EXHIBIT C

**Service Addresses of Customers
Subject to First Phase Transfer**

EXHIBIT C

Progress Energy Florida, Inc. Accounts to be transferred to Withlacoochee River Electric Cooperative, Inc.

<u>Premise</u>	<u>Account</u>	<u>Customer Name</u>	<u>Service Address</u>	<u>Meter #</u>
683758080	4042271101	[REDACTED]	21027 MORELAND DR BROOKSVILLE FL 34610	3266869
388323042	2874237119		18308 RAILROAD RD BROOKSVILLE FL 34610	7282429
959024700	8198594417		18952 US HIGHWAY 41, REAR BROOKSVILLE FL 34610	3254972
378276555	8942872388		17914 US HIGHWAY 41 TRLR ACROSS, FROM AMERICAN FENCE 34610	3257330
264943178	4380603532		18750 KUKA LN BROOKSVILLE FL 34610	5375689
264943178	4380603532		18750 KUKA LN BROOKSVILLE FL 34610	0
856927405	1672277576		17850 US HIGHWAY 41, TEMP MASSARYKTOWN FL 34609	3245973
169760005	8933334580		17728 US HIGHWAY 41, OFFICE TRAILER BROOKSVILLE FL 34610	7237774
884617427	8101274219		17728 US HIGHWAY 41, SHOP BROOKSVILLE FL 34610	2638574
307525307	9977344003		17375 SQUIRREL PRAIRIE RD TWR FL1395 MASARYKTOWN FL 34609	7204630
947533050	7114200320		17375 SQUIRREL PRAIRIE RD TELE MASARYKTOWN FL 34609	7208786
24011804	2550950299		20621 MORELAND DR, AGRICULTURAL POLE BROOKSVILLE FL 34610	9117896
162457954	4639497559		20620 COUNTY LINE RD, NEW HOUSE BROOKSVILLE FL 34610	5370354
778024121	7324581185		17709 BROAD ST SIGN BROOKSVILLE FL 34604	7171366
935498524	1307648452		18633 KUKA LN BARN BROOKSVILLE FL 34610	1322891
149644541	6899750046		18824 COUNTY LINE RD TWR B, SITE 86860 BROOKSVILLE FL 34610	3257310
265016113	8033720113		18824 COUNTY LINE RD BROOKSVILLE FL 34610	693414
265016113	8033720113		18824 COUNTY LINE RD BROOKSVILLE FL 34610	0
862262615	2894768295		18824 COUNTY LINE RD TWR C, CELL TWR BROOKSVILLE FL 34610	3257272
345785942	4185007385		20817 MORELAND DR HSE BROOKSVILLE FL 34610	3257322
388276263	4038238821	20801 MORELAND DR BROOKSVILLE FL 34610	3004820	
388276263	4038238821	20801 MORELAND DR BROOKSVILLE FL 34610	0	
388319521	4056672107	21220 HI HO LN HSE BROOKSVILLE FL 34610	1126256	
847134221	1928849522	21230 HI HO LN BROOKSVILLE FL 34610	1287957	

EXHIBIT C

Progress Energy Florida, Inc. Accounts to be transferred to Withlacoochee River Electric Cooperative, Inc.

<u>Premise</u>	<u>Account</u>	<u>Customer Name</u>	<u>Service Address</u>	<u>Meter #</u>
714604854	5811340392	[REDACTED]	18351 KUKA LN SPRING HILL FL 34610	0
714604854	5811340392		18351 KUKA LN SPRING HILL FL 34610	3268335
265047299	8036744320		0000 COUNTY LINE RD BROOKSVILLE FL 34609	7070153
265041766	3748434061		18044 COUNTY LINE RD BROOKSVILLE FL 34610	5116432
265042269	8036600314		18030 COUNTY LINE RD BROOKSVILLE FL 34610	7057363
265041263	3066583321		18044 COUNTY LINE RD BROOKSVILLE FL 34610	3085913
695352733	9672829265		0 PRESTON HOLLOW DR SIGN BROOKSVILLE FL 34609	5335956
265040760	8036168286		18240 COUNTY LINE RD BROOKSVILLE FL 34610	7091849
265040760	8036168286		18240 COUNTY LINE RD BROOKSVILLE FL 34610	0
137248923	260494522		18430 COUNTY LINE RD SIGN, OUTDOOR ADV BROOKSVILLE FL 34610	3135989
265023658	8035736253		18430 COUNTY LINE RD LITE BROOKSVILLE FL 34610	870640
265023658	8035736253		18430 COUNTY LINE RD LITE BROOKSVILLE FL 34610	0
302330247	9998049405		18430 COUNTY LINE RD, REPLACEMENT SVC BROOKSVILLE FL 34610	8731065
265024664	8035880265		18430 COUNTY LINE RD, MAIN PLANT BROOKSVILLE FL 34610	2796771
265024664	8035880265		18430 COUNTY LINE RD, MAIN PLANT BROOKSVILLE FL 34610	0
265022652	8035304224		18624 COUNTY LINE RD, HSE BROOKSVILLE FL 34610	7045282
265023155	1192875523		18620 COUNTY LINE RD, SHED BROOKSVILLE FL 34610	5176846
719445321	7324569410		18620 COUNTY LINE RD, TRLR BROOKSVILLE FL 34610	0
719445321	7324569410		18620 COUNTY LINE RD, TRLR BROOKSVILLE FL 34610	1295279
265018628	4414083046		18650 COUNTY LINE RD BROOKSVILLE FL 34610	1357600
516291272	4705453456	18624 COUNTY LINE RD, GARAGE BROOKSVILLE FL 34610	5156437	
265018125	6463867045	18648 COUNTY LINE RD BROOKSVILLE FL 34610	1357668	
265019634	882180056	18640 COUNTY LINE RD BROOKSVILLE FL 34610	1278643	
265020137	8773824103	18630 COUNTY LINE RD BROOKSVILLE FL 34610	5033109	

EXHIBIT C

Progress Energy Florida, Inc. Accounts to be transferred to Withlacoochee River Electric Cooperative, Inc.

<u>Premise</u>	<u>Account</u>	<u>Customer Name</u>	<u>Service Address</u>	<u>Meter #</u>
265016616	4026991386	[REDACTED]	18744 COUNTY LINE RD, HOUSE BROOKSVILLE FL 34610	7146995
706415737	4926033092	[REDACTED]	18744 COUNTY LINE RD, BILLBOARD BROOKSVILLE FL 34610	390052
265014604	8033000063	[REDACTED]	18924 COUNTY LINE RD BROOKSVILLE FL 34610	7026781
265014604	8033000063	[REDACTED]	18924 COUNTY LINE RD BROOKSVILLE FL 34610	0
759322764	8033288085	[REDACTED]	18924 COUNTY LINE RD BROOKSVILLE FL 34610	3054674
265014101	7787307598	[REDACTED]	18944 COUNTY LINE RD BROOKSVILLE FL 34610	1401463
265014101	7787307598	[REDACTED]	18944 COUNTY LINE RD BROOKSVILLE FL 34610	0
265014101	7787307598	[REDACTED]	18944 COUNTY LINE RD BROOKSVILLE FL 34610	1401463
265014101	7787307598	[REDACTED]	18944 COUNTY LINE RD BROOKSVILLE FL 34610	0
756173984	8033576106	[REDACTED]	18924 COUNTY LINE RD, SGN BROOKSVILLE FL 34610	390290
265009574	8032568039	[REDACTED]	19520 COUNTY LINE RD, PUMP BROOKSVILLE FL 34610	2634596
265008568	8032280012	[REDACTED]	19520 COUNTY LINE RD, RENTAL BROOKSVILLE FL 34610	7247960
264966316	8044376854	[REDACTED]	14437 COUNTY LINE RD BROOKSVILLE FL 34609	3102750
265009071	8032424023	[REDACTED]	19520 COUNTY LINE RD, HOUSE BROOKSVILLE FL 34610	1132383
265006053	9979533	[REDACTED]	18820 CIBORA DR BROOKSVILLE FL 34610	3246534
265007059	5555442035	[REDACTED]	18825 CIBORA DR BROOKSVILLE FL 34610	1092200
264999011	8036888336	[REDACTED]	19832 COUNTY LINE RD BROOKSVILLE FL 34610	0
339989816	5202756326	[REDACTED]	19832 COUNTY LINE RD, SANCTUARY BROOKSVILLE FL 34610	7203285
265005047	631193381	[REDACTED]	18925 CIBORA DR BROOKSVILLE FL 34610	1161920
265005047	631193381	[REDACTED]	18925 CIBORA DR BROOKSVILLE FL 34610	0
681947783	8031127936	[REDACTED]	19832 COUNTY LINE RD BROOKSVILLE FL 34610	5083864
265006556	8031415959	[REDACTED]	18820 CIBORA DR, BARN BROOKSVILLE FL 34610	5109357
748132020	3818827381	[REDACTED]	18820 CIBORA DR HSE BROOKSVILLE FL 34610	1250942
717262910	1811566294	[REDACTED]	20052 BOWMAN RD BROOKSVILLE FL 34610	1252683

EXHIBIT C

Progress Energy Florida, Inc. Accounts to be transferred to Withlacoochee River Electric Cooperative, Inc.

<u>Premise</u>	<u>Account</u>	<u>Customer Name</u>	<u>Service Address</u>	<u>Meter #</u>
717262910	1811566294	[REDACTED]	20052 BOWMAN RD BROOKSVILLE FL 34610	0
502644379	5250288320	[REDACTED]	20001 BOWMAN RD BROOKSVILLE FL 34610	1212226
652110326	7932784209	[REDACTED]	20001 BOWMAN RD BROOKSVILLE FL 34610	732729
388297389	4047167442	[REDACTED]	20125 BOWMAN RD BROOKSVILLE FL 34610	5109378
546719251	4047023436	[REDACTED]	20139 BOWMAN RD BROOKSVILLE FL 34610	5176910
388296886	5416571200	[REDACTED]	20201 BOWMAN RD TRLR BROOKSVILLE FL 34610	7053693
663571203	630079140	[REDACTED]	20201 BOWMAN RD BROOKSVILLE FL 34610	3248863
388297892	7055656219	[REDACTED]	20138 BOWMAN RD BROOKSVILLE FL 34610	7038686
511444364	2685668546	[REDACTED]	20126 BOWMAN RD BROOKSVILLE FL 34610	5151388
388295377	7009679311	[REDACTED]	20138 BOWMAN RD PUMP BROOKSVILLE FL 34610	7138655
516836416	8949428584	[REDACTED]	20153 BOWMAN RD BROOKSVILLE FL 34610	7237761
726957229	9003624547	[REDACTED]	20140 BOWMAN RD BROOKSVILLE FL 34610	5103016
264963298	8037176353	[REDACTED]	20320 COUNTY LINE RD BROOKSVILLE FL 34610	5097521
264963298	8037176353	[REDACTED]	20320 COUNTY LINE RD BROOKSVILLE FL 34610	740560
388295880	4764133515	[REDACTED]	20237 BOWMAN RD BROOKSVILLE FL 34610	1006269
587076450	3018875194	[REDACTED]	20235 BOWMAN RD BROOKSVILLE FL 34610	9157365
603431998	7647991363	[REDACTED]	20251 BOWMAN RD BROOKSVILLE FL 34610	9125924
796188822	6524307093	[REDACTED]	20007 BOWMAN RD BROOKSVILLE FL 34610	7264948
570656015	4046159375	[REDACTED]	20315 BOWMAN RD BROOKSVILLE FL 34610	5445940
264962292	8037032347	[REDACTED]	20430 COUNTY LINE RD BROOKSVILLE FL 34610	5078462
264962292	8037032347	[REDACTED]	20430 COUNTY LINE RD BROOKSVILLE FL 34610	5078462
388296383	4046015369	[REDACTED]	20339 BOWMAN RD BROOKSVILLE FL 34610	5445939
264942172	8093052234	[REDACTED]	18944 KUKA LN, RENTAL MH BROOKSVILLE FL 34610	3102663

EXHIBIT C

Progress Energy Florida, Inc. Accounts to be transferred to Withlacoochee River Electric Cooperative, Inc.

<u>Premise</u>	<u>Account</u>	<u>Customer Name</u>	<u>Service Address</u>	<u>Meter #</u>
264961789	5483945441		15115 COUNTY LINE RD BROOKSVILLE FL 34609	305662
388294371	4193327403		20613 BOWMAN RD BROOKSVILLE FL 34610	322919
713041231	4045871354		20613 BOWMAN RD, TRLR BROOKSVILLE FL 34610	3082703
713041231	4045871354		20613 BOWMAN RD, TRLR BROOKSVILLE FL 34610	0
264945190	8816312088		18321 KUKA LN, COTTAGE BROOKSVILLE FL 34610	799429
264946196	2525155419		18321 KUKA LN BROOKSVILLE FL 34610	7017453
264946196	2525155419		18321 KUKA LN BROOKSVILLE FL 34610	0
264944687	1607513147		18509 KUKA LN BROOKSVILLE FL 34610	7067391
264943681	8093628274		18633 KUKA LN BROOKSVILLE FL 34610	5239120
264944184	3093484263		18633 KUKA LN UNIT BROOKSVILLE FL 34610	0
105241154	4870455140		18810 KUKA LN BROOKSVILLE FL 34610	1312993
264942675	8093196240		18833 KUKA LN BROOKSVILLE FL 34610	3066627
388270227	4036510704		21008 PRIBIL AVE BROOKSVILLE FL 34610	1140850
747750746	3592737279		20613 BOWMAN RD, NURS BROOKSVILLE FL 34610	1266945
264516448	8809005578		20649 BOWMAN RD, NEW HOME BROOKSVILLE FL 34610	7146876
264516448	8809005578		20649 BOWMAN RD, NEW HOME BROOKSVILLE FL 34610	0
289353127	9541773227		20649 BOWMAN RD BARN BROOKSVILLE FL 34610	3257323
768246487	4045295318		20649 BOWMAN RD, B BROOKSVILLE FL 34610	1382331
768685103	4045439329		20649 BOWMAN RD BROOKSVILLE FL 34610	5368887
624058016	4038670856		20600 MORELAND DR BROOKSVILLE FL 34610	5251901
540306150	5560163381		10 US HIGHWAY 41, BARN/PUMP BROOKSVILLE FL 34610	5299916
264941166	5502293197		20620 COUNTY LINE RD BARN, & WELL BROOKSVILLE FL 34610	9167005
264941166	5502293197		20620 COUNTY LINE RD BARN, & WELL BROOKSVILLE FL 34610	0
264941669	7747022196		20630 COUNTY LINE RD, FRONT TRLR BROOKSVILLE FL 34610	5205196

EXHIBIT C

Progress Energy Florida, Inc. Accounts to be transferred to Withlacoochee River Electric Cooperative, Inc.

<u>Premise</u>	<u>Account</u>	<u>Customer Name</u>	<u>Service Address</u>	<u>Meter #</u>
388299904	255916495	[REDACTED]	20720 BOWMAN RD LITE, REAR BROOKSVILLE FL 34610	0
388299904	255916495		20720 BOWMAN RD LITE, REAR BROOKSVILLE FL 34610	9117919
388277269	4038814867		20620 MORELAND DR BROOKSVILLE FL 34610	1322922
388277269	4038814867		20620 MORELAND DR BROOKSVILLE FL 34610	0
388277772	5693159488		20638 MORELAND DR BROOKSVILLE FL 34610	7053692
264940160	8094924364		20720 COUNTY LINE RD BROOKSVILLE FL 34610	5279642
437439917	5731702118		17701 US HIGHWAY 41, TA52 BROOKSVILLE FL 34610	7202092
388299401	838595127		20720 BOWMAN RD LITE BROOKSVILLE FL 34610	0
388299401	838595127		20720 BOWMAN RD LITE BROOKSVILLE FL 34610	7264974
388300910	6775471055		20742 BOWMAN RD LITE BROOKSVILLE FL 34610	0
388300910	6775471055		20742 BOWMAN RD LITE BROOKSVILLE FL 34610	1099257
388301413	4048895561		20748 BOWMAN RD BROOKSVILLE FL 34610	1212723
388276766	4038526844		20707 MORELAND DR BROOKSVILLE FL 34610	7056835
388278275	6127145462		20700 MORELAND DR BROOKSVILLE FL 34610	3257336
944335938	9920066421		20719 MORELAND DR BROOKSVILLE FL 34610	3181884
125303103	9815532470		18430 KUKA LN, BROOKSVILLE FL 34610	7170147
36581629	1940969318		17709 US HIGHWAY 41, SHED BROOKSVILLE FL 34610	7211642
372980943	3483196375		17709 US HIGHWAY 41 UNIT B BROOKSVILLE FL 34610	3248873
388310467	1397078331		17709 US HIGHWAY 41 UNIT A BROOKSVILLE FL 34610	0
388310467	1397078331		17709 US HIGHWAY 41 UNIT A BROOKSVILLE FL 34610	3243441
536621023	4050047646	17745 STUDENT ACRES ST BROOKSVILLE FL 34610	5159490	
388303928	4049759626	17835 STUDENT ACRES ST BROOKSVILLE FL 34610	219009	
388304431	4049903633	17829 STUDENT ACRES ST BROOKSVILLE FL 34610	5023667	
388307952	1263087137	20813 CHASON LN BROOKSVILLE FL 34610	7091826	

EXHIBIT C

Progress Energy Florida, Inc. Accounts to be transferred to Withlacoochee River Electric Cooperative, Inc.

<u>Premise</u>	<u>Account</u>	<u>Customer Name</u>	<u>Service Address</u>	<u>Meter #</u>
388308455	4051631759	[REDACTED]	20817 CHASON LN BROOKSVILLE FL 34610	7102332
388308958	9763347547	[REDACTED]	17838 STUDENT ACRES ST BROOKSVILLE FL 34610	5239657
506738296	7918832002	[REDACTED]	20821 CHASON LN BROOKSVILLE FL 34610	5141580
508169834	4590019028	[REDACTED]	20819 CHASON LN BROOKSVILLE FL 34610	5151349
553308048	4050911703	[REDACTED]	17841 US HIGHWAY 41 BROOKSVILLE FL 34610	5176862
646310736	4050335669	[REDACTED]	17900 STUDENT ACRES ST BROOKSVILLE FL 34610	1224756
667114313	640136063	[REDACTED]	20809 CHASON LN BROOKSVILLE FL 34610	1357620
708360816	4051199729	[REDACTED]	17835 US HIGHWAY 41 BROOKSVILLE FL 34610	7264966
777559532	4049615610	[REDACTED]	17853 STUDENT ACRES ST BROOKSVILLE FL 34610	1260682
119079824	8472526282	[REDACTED]	18913 QUARTER HORSE LN BROOKSVILLE FL 34610	3257292
476325140	908392067	[REDACTED]	18821 QUARTER HORSE LN, LOT 4 BROOKSVILLE FL 34610	9104578
502643876	1046489339	[REDACTED]	20732 MORELAND DR BROOKSVILLE FL 34610	5117853
388278778	4039390900	[REDACTED]	20736 MORELAND DR BROOKSVILLE FL 34610	802912
683757577	503569060	[REDACTED]	20735 MORELAND DR BROOKSVILLE FL 34610	0
683757577	503569060	[REDACTED]	20735 MORELAND DR BROOKSVILLE FL 34610	5320347
304399957	328144378	[REDACTED]	20808 BOWMAN RD, TRAILER BROOKSVILLE FL 34610	1271707
388302419	1691443250	[REDACTED]	20816 BOWMAN RD BROOKSVILLE FL 34610	1290950
388302922	5229427244	[REDACTED]	17941 STUDENT ACRES ST BROOKSVILLE FL 34610	5384255
388303425	4049471609	[REDACTED]	17925 STUDENT ACRES ST BROOKSVILLE FL 34610	5045856
388306443	5411277056	[REDACTED]	17809 US HIGHWAY 41 BROOKSVILLE FL 34610	0
388306443	5411277056	[REDACTED]	17809 US HIGHWAY 41 BROOKSVILLE FL 34610	7210427
388306946	9769751143	[REDACTED]	17809 US HIGHWAY 41, REAR BLDG, BROOKSVILLE FL 34610	7203242
388307449	2574684050	[REDACTED]	17811 US HIGHWAY 41 BROOKSVILLE FL 34610	7081166

EXHIBIT C

Progress Energy Florida, Inc. Accounts to be transferred to Withlacoochee River Electric Cooperative, Inc.

<u>Premise</u>	<u>Account</u>	<u>Customer Name</u>	<u>Service Address</u>	<u>Meter #</u>
388279281	7661734057	[REDACTED]	20746 MORELAND DR BROOKSVILLE FL 34610	1099228
567443354	4039678927	[REDACTED]	20818 MORELAND DR BROOKSVILLE FL 34610	1174420
664793974	4277997256	[REDACTED]	17839 US HIGHWAY 41 BROOKSVILLE FL 34610	2629295
802297150	9644568159	[REDACTED]	17835 US HIGHWAY 41 SIGN BROOKSVILLE FL 34610	1337652
264939657	8095212381	[REDACTED]	20800 COUNTY LINE RD BROOKSVILLE FL 34610	565474
264940663	8095068374	[REDACTED]	20720 COUNTY LINE RD BROOKSVILLE FL 34610	3051394
264940663	8095068374	[REDACTED]	20720 COUNTY LINE RD BROOKSVILLE FL 34610	0
264960280	8043080760	[REDACTED]	15289 COUNTY LINE RD BROOKSVILLE FL 34609	5104389
388274754	4037950800	[REDACTED]	20928 MORELAND DR BROOKSVILLE FL 34610	893288
388274754	4037950800	[REDACTED]	20928 MORELAND DR BROOKSVILLE FL 34610	0
388274754	4037950800	[REDACTED]	20928 MORELAND DR BROOKSVILLE FL 34610	893288
388274754	4037950800	[REDACTED]	20928 MORELAND DR BROOKSVILLE FL 34610	0
388304934	4050479675	[REDACTED]	17943 US HIGHWAY 41 BROOKSVILLE FL 34610	2634273
388304934	4050479675	[REDACTED]	17943 US HIGHWAY 41 BROOKSVILLE FL 34610	0
732609943	7199350141	[REDACTED]	20907 BOWMAN RD OFC BROOKSVILLE FL 34610	0
732609943	7199350141	[REDACTED]	20907 BOWMAN RD OFC BROOKSVILLE FL 34610	5384258
388273245	1040906466	[REDACTED]	20849 MORELAND DR BROOKSVILLE FL 34610	777902
388273748	7661728504	[REDACTED]	20837 MORELAND DR REAR BROOKSVILLE FL 34610	7147062
388274251	74799401	[REDACTED]	20837 MORELAND DR BROOKSVILLE FL 34610	0
388274251	74799401	[REDACTED]	20837 MORELAND DR BROOKSVILLE FL 34610	5072224
531160455	6324088151	[REDACTED]	17921 US HIGHWAY 41 BROOKSVILLE FL 34610	7077575
798468800	2749621370	[REDACTED]	17909 US HIGHWAY 41 MASSARYKTOWN FL 34609	692256
388279784	4039822934	[REDACTED]	20848 MORELAND DR, #CHRCH BROOKSVILLE FL 34610	1305747
606215853	5410209009	[REDACTED]	20838 MORELAND DR BROOKSVILLE FL 34610	1133867
840167200	6820801185	[REDACTED]	20829 MORELAND DR, PARSONAGE BROOKSVILLE FL 34610	0
840167200	6820801185	[REDACTED]	20829 MORELAND DR, PARSONAGE BROOKSVILLE FL 34610	7214037

EXHIBIT C

Progress Energy Florida, Inc. Accounts to be transferred to Withlacoochee River Electric Cooperative, Inc.

<u>Premise</u>	<u>Account</u>	<u>Customer Name</u>	<u>Service Address</u>	<u>Meter #</u>
713992404	4040398976		20830 MORELAND DR BROOKSVILLE FL 34610	1252747
743422934	4039966940		20848 MORELAND DR BROOKSVILLE FL 34610	5360410
743422934	4039966940		20848 MORELAND DR BROOKSVILLE FL 34610	0
747960938	8670995407		20848 MORELAND DR, EDUCATION BLDG BROOKSVILLE FL 34610	7247999
388312479	4052927843		17728 US HIGHWAY 41, OFF BROOKSVILLE FL 34610	2790124
388312479	4052927843		17728 US HIGHWAY 41, OFF BROOKSVILLE FL 34610	0
567535403	4530048441		20911 MORELAND DR BROOKSVILLE FL 34610	1174386
552587752	4053215860		17728 US HIGHWAY 41, 2 BROOKSVILLE FL 34610	2921861
708361319	7027779476		17728 US HIGHWAY 41, 1 BROOKSVILLE FL 34610	2921404
749750674	6626256073		20915 MORELAND DR BROOKSVILLE FL 34610	5447327
264939154	8095356397		20930 COUNTY LINE RD BROOKSVILLE FL 34610	788368
264939154	8095356397		20930 COUNTY LINE RD BROOKSVILLE FL 34610	0
264946699	8037320360		75 KOSTKA DR BROOKSVILLE FL 34609	565202
594521856	8095500402		20936 COUNTY LINE RD BROOKSVILLE FL 34610	5221789
516532209	4429804182		20916 MORELAND DR BROOKSVILLE FL 34610	7020297
516532209	4429804182		20916 MORELAND DR BROOKSVILLE FL 34610	0
541320552	3623863304		20939 MORELAND DR SPRING HILL FL 34610	1161821
541320552	3623863304		20939 MORELAND DR SPRING HILL FL 34610	0
388293365	7591258068		18045 US HIGHWAY 41 BROOKSVILLE FL 34610	225562
388305437	3850014133		17929 US HIGHWAY 41 BROOKSVILLE FL 34610	7265028
388312982	8044355257		20948 BOWMAN RD BROOKSVILLE FL 34610	1140792
388312982	8044355257		20948 BOWMAN RD BROOKSVILLE FL 34610	0
388313988	4053503883		18036 US HIGHWAY 41 HSE BROOKSVILLE FL 34610	5104393
388282299	4041263034		18409 SKINNER DR BROOKSVILLE FL 34610	5426836
388283305	4041407045		18325 SKINNER DR BROOKSVILLE FL 34610	5017724

EXHIBIT C

Progress Energy Florida, Inc. Accounts to be transferred to Withlacoochee River Electric Cooperative, Inc.

<u>Premise</u>	<u>Account</u>	<u>Customer Name</u>	<u>Service Address</u>	<u>Meter #</u>
388291353	1824436509		18151 US HIGHWAY 41 BROOKSVILLE FL 34610	1212725
388291353	1824436509		18151 US HIGHWAY 41 BROOKSVILLE FL 34610	0
388291856	4044719275		18133 US HIGHWAY 41 BROOKSVILLE FL 34610	5168155
388292359	8382494188		18145 US HIGHWAY 41 BROOKSVILLE FL 34610	324 3838
388292862	4044863287		18127 US HIGHWAY 41 BROOKSVILLE FL 34610	0
388292862	4044863287		18127 US HIGHWAY 41 BROOKSVILLE FL 34610	5375712
388282802	4040975017		18425 SKINNER DR BROOKSVILLE FL 34610	1212757
5586635824	4041119022		18431 SKINNER DR BROOKSVILLE FL 34610	1278664
388290850	4044287241		18213 US HIGHWAY 41 BROOKSVILLE FL 34610	7024694
264938451	2641049310		21010 COUNTY LINE RD BROOKSVILLE FL 34610	3237762
264947202	8037464376		99 KOSTKA DR MASARYKTOWN FL 34609	5111883
264935130	3931174367		21009 PRIBIL AVE BROOKSVILLE FL 34610	1375318
388281796	2119174044		18515 SKINNER DR BROOKSVILLE FL 34610	1038309
388286826	4041695063		18528 SKINNER DR, TRLR BROOKSVILLE FL 34610	3047528
388280790	4040686999		18533 SKINNER DR BROOKSVILLE FL 34610	5375708
388280790	4040686999		18533 SKINNER DR BROOKSVILLE FL 34610	0
388270730	4036654710		18713 SKINNER DR BROOKSVILLE FL 34610	5057965
388271233	4352683422		18703 SKINNER DR BROOKSVILLE FL 34610	5283958
388271736	7846622498		18648 SKINNER DR BROOKSVILLE FL 34610	3220470
219777050	8191677306		18249 US HIGHWAY 41, TELE TOWER BROOKSVILLE FL 34610	9125945
388290347	4043999224		18249 US HIGHWAY 41 BROOKSVILLE FL 34610	9157376
388317509	6449518 98		18236 US HIGHWAY 41 BROOKSVILLE FL 34610	5406091
388317509	6449518 98		18236 US HIGHWAY 41 BROOKSVILLE FL 34610	0
733664734	4044143234		18249 US HIGHWAY 41 BARN BROOKSVILLE FL 34610	5384273

EXHIBIT C

Progress Energy Florida, Inc. Accounts to be transferred to Withlacoochee River Electric Cooperative, Inc.

<u>Premise</u>	<u>Account</u>	<u>Customer Name</u>	<u>Service Address</u>	<u>Meter #</u>
388272742	4037086743	[REDACTED]	18626 SKINNER DR BROOKSVILLE FL 34610	875168
388272742	4037086743		18626 SKINNER DR BROOKSVILLE FL 34610	0
388280287	8598186575		18607 SKINNER DR BROOKSVILLE FL 34610	1322916
388280287	8598186575		18607 SKINNER DR BROOKSVILLE FL 34610	0
388284311	4042127091		21012 MORELAND DR BROOKSVILLE FL 34610	832356
350713517	6971663579		18118 US HIGHWAY 41, #B TRLR IN BACK BROOKSVILLE FL 34610	1295224
350713517	6971663579		18118 US HIGHWAY 41, #B TRLR IN BACK BROOKSVILLE FL 34610	0
855773246	1049022078		21100 BOWMAN RD BROOKSVILLE FL 34610	1200788
855773246	1049022078		21100 BOWMAN RD BROOKSVILLE FL 34610	0
556810437	4053647899		18036 US HIGHWAY 41 SHOP BROOKSVILLE FL 34610	2629294
734516816	4053791909		18036 US HIGHWAY 41, OFF BROOKSVILLE FL 34610	5384252
388281293	4041551057		18432 SKINNER DR BROOKSVILLE FL 34610	5369705
264937142	8098236598		18749 ROSEPHIL ST BROOKSVILLE FL 34610	5372997
264936136	8098092587		18737 ROSEPHIL ST, 1 BROOKSVILLE FL 34610	3257324
264936639	8097948571		18737 ROSEPHIL ST, 2 BROOKSVILLE FL 34610	848313
388269221	43732369		21040 PRIBIL AVE BROOKSVILLE FL 34610	3032653
388269724	8180592203		21022 PRIBIL AVE BROOKSVILLE FL 34610	5075661
264937645	7586598117		18805 ROSEPHIL ST BROOKSVILLE FL 34610	795317
676254326	682286022		18825 ROSEPHIL ST BROOKSVILLE FL 34610	5281712
264938148	8096364464		18921 ROSEPHIL ST BROOKSVILLE FL 34610	7062754
264938148	8096364464	18921 ROSEPHIL ST BROOKSVILLE FL 34610	0	
55642311	1884165576	18301 US HIGHWAY 41, COTTAGE #2 BROOKSVILLE FL 34610	1100387	
388288838	4043711202	18301 US HIGHWAY 41, COTTAGE 1 BROOKSVILLE FL 34610	9120019	
388289341	4043567197	18301 US HIGHWAY 41 BROOKSVILLE FL 34610	1164621	

EXHIBIT C

Progress Energy Florida, Inc. Accounts to be transferred to Withlacoochee River Electric Cooperative, Inc.

<u>Premise</u>	<u>Account</u>	<u>Customer Name</u>	<u>Service Address</u>	<u>Meter #</u>
388289844	4043855218	[REDACTED]	18301 US HIGHWAY 41, OFF BROOKSVILLE FL 34610	7209082
388289844	4043855218		18301 US HIGHWAY 41, OFF BROOKSVILLE FL 34610	0
388285820	4041983086		18528 SKINNER DR, COTTAGE BROOKSVILLE FL 34610	5239131
388285820	4041983086		18528 SKINNER DR, COTTAGE BROOKSVILLE FL 34610	0
388286323	4041839074		18528 SKINNER DR HSE BROOKSVILLE FL 34610	7050181
388284814	3327451206		21026 MORELAND DR BROOKSVILLE FL 34610	7182814
388284814	3327451206		21026 MORELAND DR BROOKSVILLE FL 34610	0
532911398	4042559128		21043 MORELAND DR BROOKSVILLE FL 34610	3068863
532911398	4042559128		21043 MORELAND DR BROOKSVILLE FL 34610	0
388285317	2594537169		21044 MORELAND DR BROOKSVILLE FL 34610	1188819
388285317	2594537169		21044 MORELAND DR BROOKSVILLE FL 34610	0
666520773	4042847141		21104 MORELAND DR BROOKSVILLE FL 34610	5096807
388314994	551443335		18200 US HIGHWAY 41 BROOKSVILLE FL 34610	5239054
388315497	4555566020		18236 US HIGHWAY 41 LOT 2 BROOKSVILLE FL 34610	5094319
388316000	2189912054		18236 US HIGHWAY 41 PUMP BROOKSVILLE FL 34610	5384240
520523011	4053935910		18204 US HIGHWAY 41 REAR BROOKSVILLE FL 34610	5160908
525842236	2047088515		18236 US HIGHWAY 41 LOT 3 BROOKSVILLE FL 34610	5146609
703976165	367618531		18236 US HIGHWAY 41 LOT 1 BROOKSVILLE FL 34610	5373027
264933621	8097372531		18806 ROSEPHIL ST BROOKSVILLE FL 34610	5447729
264933621	8097372531		18806 ROSEPHIL ST BROOKSVILLE FL 34610	0
264934124	7921277122	18748 ROSEPHIL ST BROOKSVILLE FL 34610	5241021	
264934627	3879356316	18736 ROSEPHIL ST HSE BROOKSVILLE FL 34610	1037922	
264934627	3879356316	18736 ROSEPHIL ST HSE BROOKSVILLE FL 34610	0	
362291330	9321293279	18814 ROSEPHIL ST BROOKSVILLE FL 34610	3180587	
388268718	4036222683	21128 PRIBIL AVE BROOKSVILLE FL 34610	7024571	
388268718	4036222683	21128 PRIBIL AVE BROOKSVILLE FL 34610	0	

EXHIBIT C

Progress Energy Florida, Inc. Accounts to be transferred to Withlacoochee River Electric Cooperative, Inc.

<u>Premise</u>	<u>Account</u>	<u>Customer Name</u>	<u>Service Address</u>	<u>Meter #</u>
779245588	8817157223	[REDACTED]	18736 ROSEPHIL ST, GAR BROOKSVILLE FL 34610	5438879
264931106	8096652487	[REDACTED]	18902 ROSEPHIL ST BROOKSVILLE FL 34610	3267352
264931609	6552630196	[REDACTED]	18848 ROSEPHIL ST BROOKSVILLE FL 34610	5063447
264932112	6253625157	[REDACTED]	18838 ROSEPHIL ST BROOKSVILLE FL 34610	5447727
264932615	8097084518	[REDACTED]	18826 ROSEPHIL ST BROOKSVILLE FL 34610	1140786
264928591	8276235528	[REDACTED]	18944 ROSEPHIL ST BROOKSVILLE FL 34610	870347
264929094	333445533	[REDACTED]	18932 ROSEPHIL ST BROOKSVILLE FL 34610	5372999
264929094	333445533	[REDACTED]	18932 ROSEPHIL ST BROOKSVILLE FL 34610	0
264929597	8096220458	[REDACTED]	18920 ROSEPHIL ST BROOKSVILLE FL 34610	1042570
264930100	8096508475	[REDACTED]	18910 ROSEPHIL ST BROOKSVILLE FL 34610	1067756
388318515	9797165559	[REDACTED]	18306 US HIGHWAY 41 BROOKSVILLE FL 34610	808683
388318515	9797165559	[REDACTED]	18306 US HIGHWAY 41 BROOKSVILLE FL 34610	0
388319018	9445653288	[REDACTED]	18306 US HIGHWAY 41 BROOKSVILLE FL 34610	5375713
388316503	5842715258	[REDACTED]	18236 US HIGHWAY 41 LOT 4 BROOKSVILLE FL 34610	3273892
388317006	5178720356	[REDACTED]	21172 BECK LN LOT 5 BROOKSVILLE FL 34610	1313039
23949519	3528571078	[REDACTED]	18515 US HIGHWAY 41 BROOKSVILLE FL 34610	0
23949519	3528571078	[REDACTED]	18515 US HIGHWAY 41 BROOKSVILLE FL 34610	1038299
388288335	4043423181	[REDACTED]	18451 US HIGHWAY 41 BROOKSVILLE FL 34610	5060182
388321533	4056816118	[REDACTED]	18442 US HIGHWAY 41 BROOKSVILLE FL 34610	5375715
623439326	5960135045	[REDACTED]	18531 US HIGHWAY 41 BROOKSVILLE FL 34610	2649327
623439326	5960135045	[REDACTED]	18531 US HIGHWAY 41 BROOKSVILLE FL 34610	0
388320527	4056240070	[REDACTED]	21220 HI HO LN, TLR 1 BROOKSVILLE FL 34610	7279656
388321030	4056384086	[REDACTED]	21220 HI HO LN, COTTAGE BROOKSVILLE FL 34610	1212726
607237193	7920614201	[REDACTED]	18402 US HIGHWAY 41, OFFICE BROOKSVILLE FL 34610	0
607237193	7920614201	[REDACTED]	18402 US HIGHWAY 41, OFFICE BROOKSVILLE FL 34610	5239642

EXHIBIT C

Progress Energy Florida, Inc. Accounts to be transferred to Withlacoochee River Electric Cooperative, Inc.

<u>Premise</u>	<u>Account</u>	<u>Customer Name</u>	<u>Service Address</u>	<u>Meter #</u>
537593322	4055952053	[REDACTED]	18316 US HIGHWAY 41 BROOKSVILLE FL 34610	799013
388318012	3145200516	[REDACTED]	18252 US HIGHWAY 41 REAR BROOKSVILLE FL 34610	7000420
388318012	3145200516	[REDACTED]	18252 US HIGHWAY 41 REAR BROOKSVILLE FL 34610	0
750145529	4055520024	[REDACTED]	18324 US HIGHWAY 41 BROOKSVILLE FL 34610	3193858
4665900	5626085153	[REDACTED]	21208 PRIBIL AVE TRLR A BROOKSVILLE FL 34610	0
4665900	5626085153	[REDACTED]	21208 PRIBIL AVE TRLR A BROOKSVILLE FL 34610	3246550
388267712	4036078676	[REDACTED]	21208 PRIBIL AVE BROOKSVILLE FL 34610	5092386
388267712	4036078676	[REDACTED]	21208 PRIBIL AVE BROOKSVILLE FL 34610	0
561337451	4805081265	[REDACTED]	18604 US HIGHWAY 41, BROOKSVILLE FL 34610	9149906
264927082	8098956648	[REDACTED]	21220 COUNTY LINE RD BROOKSVILLE FL 34610	565449
388266203	3891022319	[REDACTED]	18725 US HIGHWAY 41, 2 BROOKSVILLE FL 34610	7087538
388266706	1106996446	[REDACTED]	18725 US HIGHWAY 41, 1 BROOKSVILLE FL 34610	5251907
388267209	7315817476	[REDACTED]	18709 US HIGHWAY 41 BROOKSVILLE FL 34610	5239058
264926579	9456638019	[REDACTED]	21240 COUNTY LINE RD BROOKSVILLE FL 34610	5279580
264917022	938367143	[REDACTED]	18832 DVORAK DR BROOKSVILLE FL 34610	5051013
264917022	938367143	[REDACTED]	18832 DVORAK DR BROOKSVILLE FL 34610	0
264917525	62067136	[REDACTED]	18824 DVORAK DR BROOKSVILLE FL 34610	5141594
264918028	7505211000	[REDACTED]	18816 DVORAK DR BROOKSVILLE FL 34610	0
264918028	7505211000	[REDACTED]	18816 DVORAK DR BROOKSVILLE FL 34610	7146998
264918531	8455133309	[REDACTED]	18808 DVORAK DR BROOKSVILLE FL 34610	5195553
470980203	1688586273	[REDACTED]	18815 DVORAK DR BROOKSVILLE FL 34610	7264986
861229127	8220648188	[REDACTED]	21304 FONTAINE AVE BROOKSVILLE FL 34610	0
861229127	8220648188	[REDACTED]	21304 FONTAINE AVE BROOKSVILLE FL 34610	7103856
388325557	7222864590	[REDACTED]	18528 US HIGHWAY 41 PUMP BROOKSVILLE FL 34610	0
388325557	7222864590	[REDACTED]	18528 US HIGHWAY 41 PUMP BROOKSVILLE FL 34610	3162122

EXHIBIT C

Progress Energy Florida, Inc. Accounts to be transferred to Withlacoochee River Electric Cooperative, Inc.

<u>Premise</u>	<u>Account</u>	<u>Customer Name</u>	<u>Service Address</u>	<u>Meter #</u>
388326060	3309347272	[REDACTED]	18642 US HIGHWAY 41 BROOKSVILLE FL 34610	7264984
388326563	6434906122	[REDACTED]	18722 US HIGHWAY 41 MASSARYKTOWN FL 34609	0
388326563	6434906122	[REDACTED]	18722 US HIGHWAY 41 MASSARYKTOWN FL 34609	681488
388326563	6434906122	[REDACTED]	18722 US HIGHWAY 41 MASSARYKTOWN FL 34609	7206192
388326563	6434906122	[REDACTED]	18722 US HIGHWAY 41 MASSARYKTOWN FL 34609	7209098
463553922	5650261596	[REDACTED]	18652 US HIGHWAY 41, BILLBOARD BROOKSVILLE FL 34610	5082837
530075484	4259743330	[REDACTED]	18714 US HIGHWAY 41 SPRINGHILL FL 34610	0
530075484	4259743330	[REDACTED]	18714 US HIGHWAY 41 SPRINGHILL FL 34610	9157356
264920543	8389918574	[REDACTED]	18945 DVORAK DR BROOKSVILLE FL 34610	9149948
264926076	4127351002	[REDACTED]	21250 COUNTY LINE RD BROOKSVILLE FL 34610	1295293
388262682	4534998433	[REDACTED]	18837 US HIGHWAY 41 BROOKSVILLE FL 34610	0
388262682	4534998433	[REDACTED]	18837 US HIGHWAY 41 BROOKSVILLE FL 34610	1002402
388263185	6136278312	[REDACTED]	18829 US HIGHWAY 41 BROOKSVILLE FL 34610	5339017
388263688	4034926599	[REDACTED]	18821 US HIGHWAY 41 BROOKSVILLE FL 34610	1099415
388264191	3770141166	[REDACTED]	18813 US HIGHWAY 41 BROOKSVILLE FL 34610	733662
388264694	4035214614	[REDACTED]	18807 US HIGHWAY 41 BROOKSVILLE FL 34610	729812
388265197	8628362567	[REDACTED]	18749 US HIGHWAY 41 BROOKSVILLE FL 34610	5320332
388265700	4035502637	[REDACTED]	18741 US HIGHWAY 41 BROOKSVILLE FL 34610	796637
264914507	3152707164	[REDACTED]	18914 DVORAK DR BROOKSVILLE FL 34610	1322921
264915010	8100108725	[REDACTED]	18906 DVORAK DR BROOKSVILLE FL 34610	5107364
264915513	7564643506	[REDACTED]	18858 DVORAK DR BROOKSVILLE FL 34610	1305692
264916016	8100684766	[REDACTED]	18848 DVORAK DR BROOKSVILLE FL 34610	5016232
264916519	8506935322	[REDACTED]	18840 DVORAK DR BROOKSVILLE FL 34610	5372996
264919034	8101548821	[REDACTED]	18855 DVORAK DR BROOKSVILLE FL 34610	7037510
264919537	8099388671	[REDACTED]	18903 DVORAK DR BROOKSVILLE FL 34610	3136695

EXHIBIT C

Progress Energy Florida, Inc. Accounts to be transferred to Withlacoochee River Electric Cooperative, Inc.

<u>Premise</u>	<u>Account</u>	<u>Customer Name</u>	<u>Service Address</u>	<u>Meter #</u>
264920040	7661868076		18911 DVORAK DR BROOKSVILLE FL 34610	3257264
692467525	4057824187		21417 FONTAINE AVE BROOKSVILLE FL 34610	5320189
264913501	8099676694		18930 DVORAK DR BROOKSVILLE FL 34610	7091770
264913501	8099676694		18930 DVORAK DR BROOKSVILLE FL 34610	0
264914004	8099820709		18922 DVORAK DR BROOKSVILLE FL 34610	5073930
264914004	8099820709		18922 DVORAK DR BROOKSVILLE FL 34610	0
353673059	9617849090		000 US HIGHWAY 41 SIGN, C/S COUNTYLINE RD BROOKSVILLE FL 34610	1194137
388261676	6825532194		18903 US HIGHWAY 41 BROOKSVILLE FL 34610	9149896
969016318	665933264		21437 FONTAINE AVE BROOKSVILLE FL 34610	3185234
388323545	3654619130		18311 DADE LN BROOKSVILLE FL 34610	7048456
388327569	4058688247		18810 US HIGHWAY 41 BROOKSVILLE FL 34610	5239052
388327569	4058688247		18810 US HIGHWAY 41 BROOKSVILLE FL 34610	0
388328072	4058832254		18810 US HIGHWAY 41 BROOKSVILLE FL 34610	682391
388261173	2911522455		18907 US HIGHWAY 41 BROOKSVILLE FL 34610	5239056
388262179	6179231411		18853 US HIGHWAY 41 BROOKSVILLE FL 34610	824055
388328575	4059552308		18902 US HIGHWAY 41 BROOKSVILLE FL 34610	7214826
388329078	4065600726		18092 US HIGHWAY 41 BROOKSVILLE FL 34610	691681
388329581	4065312703		18920 US HIGHWAY 41 BROOKSVILLE FL 34610	9125927
388322036	8890072534		18433 DADE LN BROOKSVILLE FL 34610	879258
388322539	4057248141		18409 DADE LN BROOKSVILLE FL 34610	5375714
732022942	4230937232		18327 DADE LN BROOKSVILLE FL 34610	3267499
388330084	8143992374		18928 US HIGHWAY 41 BROOKSVILLE FL 34610	5283921
388330587	772765321		18946 US HIGHWAY 41 BROOKSVILLE FL 34610	0
388330587	772765321		18946 US HIGHWAY 41 BROOKSVILLE FL 34610	5034752

EXHIBIT C

Progress Energy Florida, Inc. Accounts to be transferred to Withlacoochee River Electric Cooperative, Inc.

<u>Premise</u>	<u>Account</u>	<u>Customer Name</u>	<u>Service Address</u>	<u>Meter #</u>
388327066	4058976260		18746 US HIGHWAY 41, PARSN BROOKSVILLE FL 34610	5283957
388327066	4058976260		18746 US HIGHWAY 41, PARSN BROOKSVILLE FL 34610	0
601563856	4060128345		18902 US HIGHWAY 41 LOT 19 BROOKSVILLE FL 34610	5181517
601564359	4059840321		18902 US HIGHWAY 41 LOT 18 BROOKSVILLE FL 34610	5163398
601564862	2375941532		18902 US HIGHWAY 41 LOT 17 BROOKSVILLE FL 34610	1361880
601565365	4060416368		18902 US HIGHWAY 41 LOT 16 BROOKSVILLE FL 34610	5163998
601565868	4061424435		18902 US HIGHWAY 41 LOT 15 BROOKSVILLE FL 34610	5218258
601566371	4061136412		18902 US HIGHWAY 41 LOT 14 BROOKSVILLE FL 34610	5191933
601574922	4067472855		18902 US HIGHWAY 41 LOT 20 BROOKSVILLE FL 34610	1361837
601575425	4067760878		18902 US HIGHWAY 41 LOT 26 BROOKSVILLE FL 34610	5283954
603754421	4059264287		18902 US HIGHWAY 41 LITE BROOKSVILLE FL 34610	0
601569892	4064016613		18902 US HIGHWAY 41 LOT 5 BROOKSVILLE FL 34610	5283905
601570395	4064592654		18902 US HIGHWAY 41 LOT 4 BROOKSVILLE FL 34610	5283906
601570898	4064304636		18902 US HIGHWAY 41 LOT 3 BROOKSVILLE FL 34610	5214113
601571904	4064880677		18902 US HIGHWAY 41 LOT 1 BROOKSVILLE FL 34610	5283956
601573916	4066896815		18902 US HIGHWAY 41 LOT 22 BROOKSVILLE FL 34610	5283913
601574419	4067184832		18902 US HIGHWAY 41 LOT 21 BROOKSVILLE FL 34610	5212144
601343542	4063728598		18902 US HIGHWAY 41 LOT 7 BROOKSVILLE FL 34610	5221817
601344045	4063440571		18902 US HIGHWAY 41 LOT 6 BROOKSVILLE FL 34610	5221819
601566874	4062000475		18902 US HIGHWAY 41 LOT 13 BROOKSVILLE FL 34610	5211592
601567377	4061712458		18902 US HIGHWAY 41 LOT 12 BROOKSVILLE FL 34610	5212613
601567880	4062576518		18902 US HIGHWAY 41 LOT 11 BROOKSVILLE FL 34610	5283903

EXHIBIT C

Progress Energy Florida, Inc. Accounts to be transferred to Withlacoochee River Electric Cooperative, Inc.

<u>Premise</u>	<u>Account</u>	<u>Customer Name</u>	<u>Service Address</u>	<u>Meter #</u>
601568383	4062288497		18902 US HIGHWAY 41 LOT 10 BROOKSVILLE FL 34610	7287848
601568886	4063152558		18902 US HIGHWAY 41 LOT 8 BROOKSVILLE FL 34610	9149903
601569389	4062864531		18902 US HIGHWAY 41 LOT 9 BROOKSVILLE FL 34610	3272657
601572407	4065888748		18902 US HIGHWAY 41 LOT 23 BROOKSVILLE FL 34610	5283955
601572910	4066176765		18902 US HIGHWAY 41 LOT 24 BROOKSVILLE FL 34610	5283952
601573413	6035934042		18902 US HIGHWAY 41 LOT 25 BROOKSVILLE FL 34610	5283953
590671894	4068624933		18725 BATES RD BROOKSVILLE FL 34610	5137843
516532712	4068480922		18821 BATES RD BROOKSVILLE FL 34610	5156436
516532712	4068480922		18821 BATES RD BROOKSVILLE FL 34610	0
519068838	4068336910		18901 BATES RD BROOKSVILLE FL 34610	5160915
388363282	161745008		85 HUSEK ST MASARYKTOWN FL 34609	751286
388364288	963667138		16395 SQUIRREL PRAIRIE RD BROOKSVILLE FL 34604	292171
714310803	7244734064		77 HUSEK ST MASARYKTOWN FL 34609	3170788
388365294	4068768949		21950 SQUIRREL PRAIRIE RD BROOKSVILLE FL 34610	1251468
567171231	7465248076		16415 SQUIRREL PRAIRIE RD MASARYKTOWN FL 34609	1174362
388365797	4068912956		21950 SQUIRREL PRAIRIE RD BROOKSVILLE FL 34610	5375717
388356743	3852768170		17027 SQUIRREL PRAIRIE RD BROOKSVILLE FL 34604	1312998
388357246	163473121		17047 SQUIRREL PRAIRIE RD BROOKSVILLE FL 34604	7177026
388355737	4069056966		SQUIRREL PRAIRIE RD, PUMP BROOKSVILLE FL 34610	5176851
388357749	163329119		17089 SQUIRREL PRAIRIE RD MASARYKTOWN FL 34609	5030822
910640442	4066775491		17143 SQUIRREL PRAIRIE RD MASARYKTOWN FL 34609	5098765
242517839	4849996134		0000 SQUIRREL PRAIRIE RD, PUMP LOT 20 BROOKSVILLE FL 34610	7279664
506850829	3544554148		18822 MC MULLEN RD, PERM BROOKSVILLE FL 34610	3217613

EXHIBIT C

Progress Energy Florida, Inc. Accounts to be transferred to Withlacoochee River Electric Cooperative, Inc.

<u>Premise</u>	<u>Account</u>	<u>Customer Name</u>	<u>Service Address</u>	<u>Meter #</u>
506850829	3544554148	[REDACTED]	18822 MC MULLEN RD. PERM BROOKSVILLE FL 34610	0
757586408	3493881238	[REDACTED]	18822 MC MULLEN RD. PUMP BROOKSVILLE FL 34610	5204565
670893855	5637030360	[REDACTED]	18954 MC MULLEN RD BROOKSVILLE FL 34610	7101581
670893855	5637030360	[REDACTED]	18954 MC MULLEN RD BROOKSVILLE FL 34610	0
710369295	4069633007	[REDACTED]	18410 SQUIRREL PRAIRIE RD BROOKSVILLE FL 34604	5370209
265017622	789123431	[REDACTED]	18744 COUNTY LINE RD, PUMP BROOKSVILLE FL 34610	5178275
264935633	6281258326	[REDACTED]	21013 PRIBIL AVE BROOKSVILLE FL 34610	5078524

EXHIBIT C

Withlacoochee River Electric Cooperative, Inc. Accounts to be transferred to Progress Energy

<u>Account Number</u>	<u>Member ID</u>	<u>Name</u>	<u>Service Address</u>	
1421 410 273 780	0137342001		PO BOX 971	SYDNEY NS CANADA B1T 6J4
1395 850 328 520	0215495001		PO BOX 76	LISTUIGUJ PQ CANADA G0C 2R0
1398 030 330 310	0066746001		910 LAUZON RD	WINDSOR ONT CANADA N8S 3M5
1398 360 330 090	5419055001		641 ROSS BEACH RR 2	BELLE RIVER ONT CANADA N0R 1A0
1398 370 330 580	7594065002		1961 OLIVE RD	WINDSOR ONT CANADA N8T 1R4
1398 400 330 290	0017462001		RR 1	TILBURY ONT CANADA N0P 2L0
1400 370 318 070	0121193001		12 DISHER STREET WEST	ST CATARINES ONT CANADA L2P 2H3
1395 800 333 540	7824180002		18046 EAGLE LN	LUTZ FL 33549
1395 850 328 520	0213534001		PO BOX 123	INDIAN ROCKS BEACH FL 33785
1395 850 332 480	5209062001		17900 EAGLE LN	LUTZ FL 33558
1395 860 331 520	0226642001		17720 EAGLE LN	LUTZ FL 33558
1395 860 332 600	7924115001		17916 EAGLE LN	LUTZ FL 33558
1395 890 333 170	0179372002		18018 EAGLE LN	LUTZ FL 33558
1395 900 328 880	1858069001		17218 EAGLE LN	LUTZ FL 33558
1395 900 329 780	5584052001		17400 EAGLE LN	LUTZ FL 33558
1395 900 330 220	0074939001		17448 EAGLE LN	LUTZ FL 33558
1395 910 329 280	0193993001		17308 EAGLE LN	LUTZ FL 33558
1395 910 329 670	0075040001		17340 EAGLE LN	LUTZ FL 33558
1395 920 328 710	6652058001		17202 EAGLE LN	LUTZ FL 33558
1395 920 329 920	3703150002		C/O JAMES HOLLOWAY	17416 EAGLE LN LUTZ FL 33558
1395 920 330 770	0210212001		17550 EAGLE LN	LUTZ FL 33558
1395 920 331 750	8096098001		17734 EAGLE LN	LUTZ FL 33558
1395 920 333 380	7824180001		18046 EAGLE LN	LUTZ FL 33558
1395 930 329 210	5714061001		17250 EAGLE LN	LUTZ FL 33558
1395 930 330 060	7108084001		17432 EAGLE LN	LUTZ FL 33558
1395 930 331 220	0124067001		17642 EAGLE LN	LUTZ FL 33558
1395 940 328 600	0081193005		17418 US HIGHWAY 41 N	LUTZ FL 33549
1395 940 329 520	0140406002		17324 EAGLE LN	LUTZ FL 33558
1395 940 331 850	0105317001		17750 EAGLE LN	LUTZ FL 33558
1395 950 329 080	0076860001		17234 EAGLE LN	LUTZ FL 33558
1395 950 331 410	0177906001		17704 EAGLE LN	LUTZ FL 33558
1395 950 332 170	0161221001		17824 EAGLE LN	LUTZ FL 33558
1395 960 333 050	7224064001		SEIRRA PINES	18004 EAGLE LN LUTZ FL 33558
1396 000 332 350	0095659001		17840 EAGLE LN	LUTZ FL 33558
1396 000 332 800	0204844001		17932 EAGLE LN	LUTZ FL 33558
1396 000 332 860	0216970001		17946 EAGLE LN	LUTZ FL 33558
1396 010 331 140	0225014001		17636 EAGLE LN	LUTZ FL 33558
1396 030 330 350	0198215001		17504 EAGLE LN	LUTZ FL 33558
1396 040 329 500	0212363193		30432 STATE ROAD 54	WESLEY CHAPEL FL 33543
1396 040 329 710	0212363080		# 63169504	10555 MOON LAKE RD NEW PORT RICHEY FL 34654

EXHIBIT C

Withlacoochee River Electric Cooperative, Inc. Accounts to be transferred to Progress Energy

<u>Account Number</u>	<u>Member ID</u>	<u>Name</u>	<u>Service Address</u>		
1396 050 333 300	0212363082	# 63169504	10555 MOON LAKE RD	NEW PORT RICHEY FL	34654
1396 050 333 450	0009120003	ATTN:ACCOUNTS PAYABLE	525 GRAND REGENCY BLVD	BRANDON FL	33510
1396 060 330 940	0012572001	OR GLORIA J HARMON	17616 EAGLE LN	LUTZ FL	33558
1396 160 328 490	1024065001	SIERRA PINES	1039 WILDWOOD LN	LUTZ FL	33558
1396 160 328 680	0090948001	17151 EAGLE LN	LUTZ FL		33558
1396 170 328 940	1071077001	17231 EAGLE LN	LUTZ FL		33558
1396 180 333 080	0104501001	18005 EAGLE LN	LUTZ FL		33558
1396 190 330 190	5713053001	SIERRA PINES	17449 EAGLE LN	LUTZ FL	33558
1396 200 329 950	0089692001	17421 EAGLE LN	LUTZ FL		33558
1396 200 331 490	0180052001	PO BOX 7121	TAMPA FL		33673
1396 200 332 920	0199809001	17947 EAGLE LN	LUTZ FL		33558
1396 210 331 920	7728108003	17751 EAGLE LN	LUTZ FL		33558
1396 210 332 740	0018694001	17933 EAGLE LN	LUTZ FL		33558
1396 210 333 240	0255728001	18019 EAGLE LN	LUTZ FL		33558
1396 210 333 240	0116767001	7610 PINERY WAY # 1B	TAMPA FL		33615
1396 220 329 250	0158805001	17305 EAGLE LN	LUTZ FL		33558
1396 230 332 260	0035342001	17833 EAGLE LN	LUTZ FL		33558
1396 230 332 580	0117609001	17915 EAGLE LN	LUTZ FL		33558
1396 230 333 340	0053819001	18037 EAGLE LN	LUTZ FL		33558
1396 240 329 750	0250359001	17118 ORANGEWOOD DR	LUTZ FL		33548
1396 240 329 750	0094194001	5109 ALICE RD	TAMPA FL		33624
1396 250 328 470	8535085001	1101 WILDWOOD LN	LUTZ FL		33558
1396 250 329 140	7476091001	17245 EAGLE LN	LUTZ FL		33558
1396 260 329 590	7696090001	PO BOX 82747	TAMPA FL		33682
1396 270 329 410	1001014001	17321 EAGLE LN	LUTZ FL		33558
1396 280 330 340	7563053001	SIERRA PINE	17511 EAGLE LN	LUTZ FL	33558
1396 290 328 690	0249995001	1102 WILDWOOD LN	LUTZ FL		33558
1396 290 328 690	0019304001	1102 WILDWOOD LN	LUTZ FL		33558
1396 290 331 360	0126624001	17655 EAGLE LN	LUTZ FL		33558
1396 290 331 570	0120690001	17725 EAGLE LN	LUTZ FL		33558
1396 290 333 560	0007289001	1108 SIERRA PINES BLVD	LUTZ FL		33558
1396 300 332 370	5835066003	C/O ANN SCIBILIA	1101 COUNTRY LN	LUTZ FL	33558
1396 320 331 180	0255998001	17635 EAGLE LN	LUTZ FL		33558
1396 320 331 180	3475065001	APT F	17834 JAMESTOWN WAY	LUTZ FL	33558
1396 400 329 130	0235459001	17244 CHINABERRY RD	LUTZ FL		33558
1396 410 329 280	8004101001	17304 CHINABERRY RD	LUTZ FL		33558
1396 450 328 270	0233049001	1117 WILDWOOD LN	LUTZ FL		33558
1396 450 332 650	6901095001	1110 COUNTRY LN	LUTZ FL		33558
1396 450 333 280	0231712001	1125 SIERRA PINES BLVD	LUTZ FL		33558
1396 490 329 960	7856051001	SIERRA PINES	1124 LIVE OAK LN	LUTZ FL	33558
1396 500 329 740	0035219005	PO BOX 1343	LUTZ FL		33548

EXHIBIT C

Withlacoochee River Electric Cooperative, Inc. Accounts to be transferred to Progress Energy

<u>Account Number</u>	<u>Member ID</u>	<u>Name</u>	<u>Service Address</u>	
1396 500 333 560	0154934001		1138 SIERRA PINES BLVD	LUTZ FL 33558
1396 520 329 420	0133468001		17320 CHINABERRY RD	LUTZ FL 33558
1396 540 331 040	0220475001		1140 PADDOCK CT	LUTZ FL 33558
1396 550 328 700	3158009001		1136 WILDWOOD LN	LUTZ FL 33558
1396 550 332 250	0085207001		1151 COUNTRY LN	LUTZ FL 33558
1396 560 328 210	0166621001		1133 WILDWOOD LN	LUTZ FL 33558
1396 560 328 960	0177077001		18617 LAKESHORE DR	LUTZ FL 33549
1396 560 328 960	0210503002		17230 CHINABERRY RD	LUTZ FL 33558
1396 570 328 820	3158019001		17214 CHINABERRY RD	LUTZ FL 33558
1396 590 332 350	0099215001		1115 COUNTRY LN	LUTZ FL 33558
1396 600 329 570	0114237001		17336 CHINABERRY RD	LUTZ FL 33558
1396 620 330 770	3292059001		1141 PADDOCK CT	LUTZ FL 33558
1396 630 329 930	9435082001		1140 LIVE OAK LN	LUTZ FL 33558
1396 640 332 610	5566070001		1120 COUNTRY LN	LUTZ FL 33558
1396 650 331 100	0196502001		1148 PADDOCK CT	LUTZ FL 33558
1396 720 333 220	0190446001		1141 SIERRA PINES BLVD	LUTZ FL 33558
1396 750 328 330	0132145001		1149 WILDWOOD LN	LUTZ FL 33558
1396 760 330 700	0195707001		1201 PADDOCK CT	LUTZ FL 33558
1396 770 329 930	6991051001		1202 LIVE OAK LN	LUTZ FL 33558
1396 780 331 080	0261548001		1200 PADDOCK CT	LUTZ FL 33558
1396 800 328 690	0194300001		17151 CHINABERRY RD	LUTZ FL 33558
1396 800 333 540	1124076001		PO BOX 1561	LUTZ FL 33548
1396 810 328 960	0162348001		17231 CHINABERRY RD	LUTZ FL 33558
1396 810 329 550	1058057001		17335 CHINABERRY RD	LUTZ FL 33558
1396 810 332 190	0137810001		1150 COUNTRY LN	LUTZ FL 33558
1396 810 332 340	9026066001		1140 COUNTRY LN	LUTZ FL 33558
1396 820 329 250	0048398002		17321 CHINABERRY RD	LUTZ FL 33558
1396 820 329 720	7591057001		SIERRA PINES	17351 CHINABERRY RD LUTZ FL 33558
1396 830 329 420	0048398001		17321 CHINABERRY RD	LUTZ FL 33558
1396 830 344 150	0084369001		1210 WISPER RUN CT	LUTZ FL 33558
1396 860 332 470	0174506001		1130 COUNTRY LN	LUTZ FL 33558
1396 880 331 620	8175007001		1215 COUNTRY LN	LUTZ FL 33558
1396 900 329 140	0034836002		17245 CHINABERRY RD	LUTZ FL 33558
1396 930 328 790	0181265001		17215 CHINABERRY RD	LUTZ FL 33558
1396 950 330 040	0177483003		1216 LIVE OAK LN	LUTZ FL 33558
1396 950 330 840	0114498001		1217 PADDOCK CT	LUTZ FL 33558
1396 950 331 040	4941000001		1216 PADDOCK CT	LUTZ FL 33558
1396 980 342 960	0175343001		1220 BIG MOSS LAKE RD	LUTZ FL 33558
1396 980 345 760	0247934001		1270 LAKE COMO DR	LUTZ FL 33558
1396 980 345 760	5723050001		ROSE HARBOR APTS #108	11914 ROSE HARBOR DR TAMPA FL 33625
1397 020 330 110	3585011001		PO BOX 2091	LAND O LAKES FL 34639

EXHIBIT C

Withlacoochee River Electric Cooperative, Inc. Accounts to be transferred to Progress Energy

<u>Account Number</u>	<u>Member ID</u>	<u>Name</u>	<u>Service Address</u>	
1397 040 328 430	0137623001		1225 WILDWOOD LN	LUTZ FL 33558
1397 040 333 560	0048934002		1236 SIERRA PINES BLVD	LUTZ FL 33558
1397 050 344 460	0238473001		PO BOX 360308	TAMPA FL 33673
1397 072 345 340	0010067001		1235 LAKE COMO DR	LUTZ FL 33558
1397 080 330 550	0231456002		17524 DRIFTWOOD LN	LUTZ FL 33558
1397 080 330 670	4287059002		17540 DRIFTWOOD LN	LUTZ FL 33549
1397 080 331 210	0251048001		17634 DRIFTWOOD LN	LUTZ FL 33558
1397 080 331 210	0128949002		20904 RUBY RED WAY	LAND O LAKES FL 34639
1397 080 343 110	1009005001		1240 BIG MOSS LAKE RD	LUTZ FL 33558
1397 100 331 460	5829051003		17710 DRIFTWOOD LN	LUTZ FL 33558
1397 110 344 270	0005954001		20307 MOSS BRANCH CT	LUTZ FL 33558
1397 140 328 780	0152774001		17214 DRIFTWOOD LN	LUTZ FL 33558
1397 140 344 210	0005954002		20307 MOSS BRANCH CT	LUTZ FL 33558
1397 150 329 960	0162471001		17441 DRIFTWOOD LN	LUTZ FL 33558
1397 150 342 760	0206557001		1246 BIG MOSS LAKE RD	LUTZ FL 33558
1397 150 345 400	0139760001		1245 LAKE COMO DR	LUTZ FL 33558
1397 150 345 560	5220015001		1271 LAKE COMO DR	LUTZ FL 33558
1397 160 328 400	7455069001		SIERRA PINES	1241 WILDWOOD LN LUTZ FL 33558
1397 160 328 940	0132988001		LOT 130	17230 DRIFTWOOD LN LUTZ FL 33558
1397 160 344 850	0088799002		20411 MOSS BRANCH CT	LUTZ FL 33558
1397 160 346 410	0253350001		20704 PRESTON LN	LUTZ FL 33558
1397 160 346 410	0225360001		7851 BRISTOL PARK DR	APOLLO BEACH FL 33572
1397 170 329 560	5212050001		17334 DRIFTWOOD LN	LUTZ FL 33558
1397 170 329 690	0133976001		17350 DRIFTWOOD LN	LUTZ FL 33558
1397 170 331 660	0105451001		1241 COUNTRY LN	LUTZ FL 33558
1397 170 345 870	0154869001		1300 LAKE COMO DR	LUTZ FL 33558
1397 180 329 150	9372060001		17244 DRIFTWOOD LN	LUTZ FL 33558
1397 180 330 800	0184239002		17554 DRIFTWOOD LN	LUTZ FL 33558
1397 190 330 100	3585011006		PO BOX 2091	LAND O LAKES FL 34639
1397 190 330 700	4287059001		17540 DRIFTWOOD LN	LUTZ FL 33558
1397 190 331 020	0185740002		17618 DRIFTWOOD LN	LUTZ FL 33558
1397 190 331 360	0132458001		17650 DRIFTWOOD LN	LUTZ FL 33558
1397 190 344 250	6000015001		20311 MOSS BRANCH CT	LUTZ FL 33558
1397 190 344 770	5856012001		20401 MOSS BRANCH CT	LUTZ FL 33558
1397 190 345 010	0159361001		20425 MOSS BRANCH CT	LUTZ FL 33558
1397 190 346 160	0137624002		20636 PRESTON LN	LUTZ FL 33558
1397 200 330 430	0210503001		17230 CHINABERRY RD	LUTZ FL 33558
1397 200 331 890	7723120001		17746 DRIFTWOOD LN	LUTZ FL 33558
1397 200 344 310	1316129001		21419 NORTHWOOD DR	LUTZ FL 33549
1397 200 346 450	0249722001		20712 PRESTON LN	LUTZ FL 33558
1397 210 328 710	0199545001		SUSAN L SELLERS	17150 DRIFTWOOD LN LUTZ FL 33558

EXHIBIT C

Withlacoochee River Electric Cooperative, Inc. Accounts to be transferred to Progress Energy

<u>Account Number</u>	<u>Member ID</u>	<u>Name</u>	<u>Service Address</u>	
1397 210 345 170	0106282002		20445 MOSS BRANCH CT	LUTZ FL 33558
1397 220 329 270	6264085002		17304 DRIFTWOOD LN	LUTZ FL 33558
1397 220 329 430	0110430001		17320 DRIFTWOOD LN	LUTZ FL 33558
1397 220 344 710	5446079001		20347 MOSS BRANCH CT	LUTZ FL 33558
1397 220 345 350	0139960001		1245 LAKE COMO DR	LUTZ FL 33558
1397 220 345 970	1034062001		20612 PRESTON LN	LUTZ FL 33558
1397 220 346 050	0191036001		20624 PRESTON LN	LUTZ FL 33558
1397 240 332 040	8407008001		17810 DRIFTWOOD LN	LUTZ FL 33558
1397 240 344 590	3462007001		20341 MOSS BRANCH CT	LUTZ FL 33558
1397 250 343 170	1182073001		MARY P BUSTILLO	PO BOX 667 LUTZ FL 33548
1397 250 344 360	0117445001		20321 MOSS BRANCH CT	LUTZ FL 33558
1397 260 345 080	5606150001		20435 MOSS BRANCH CT	LUTZ FL 33558
1397 270 344 430	7084076001		20327 MOSS BRANCH CT	LUTZ FL 33558
1397 270 346 330	0101377001		20701 PRESTON LN	LUTZ FL 33558
1397 290 332 190	1519061001		17826 DRIFTWOOD LN	LUTZ FL 33558
1397 310 344 460	0044043001		20333 MOSS BRANCH CT	LUTZ FL 33558
1397 320 332 300	0213301001		17842 DRIFTWOOD LN	LUTZ FL 33558
1397 320 345 580	0086088001		1305 LAKE COMO DR	LUTZ FL 33558
1397 320 345 900	0253017001		20605 PRESTON LN	LUTZ FL 33558
1397 320 345 900	0228389001		7836 EXCALIBER RD	FRISCO TX 75035
1397 330 328 400	7455069002		SIERRA PINES	1241 WILDWOOD LN LUTZ FL 33549
1397 370 333 340	0208124001		MELISSA L. TODD	1309 SIERRA PINES BLVD LUTZ FL 33558
1397 370 345 850	0101528001		1316 LAKE COMO DR	LUTZ FL 33558
1397 380 329 210	0212363143		30432 STATE ROAD 54	WESLEY CHAPEL FL 33543
1397 380 346 570	0047678001		20721 PRESTON LN	LUTZ FL 33558
1397 390 332 440	9320052001		17900 DRIFTWOOD LN	LUTZ FL 33558
1397 420 331 380	0247795001		17653 DRIFTWOOD LN	LUTZ FL 33558
1397 420 331 380	0207460002		MISTY M WYATT	17653 DRIFTWOOD LN LUTZ FL 33558
1397 420 331 480	0233216001		17715 DRIFTWOOD LN	LUTZ FL 33558
1397 420 343 190	0200903001		ROBIN PETERSON	1320 BIG MOSS LAKE RD LUTZ FL 33558
1397 430 344 710	0054773002		20301 MOSS BEND CT	LUTZ FL 33558
1397 440 328 670	0223719001		18519 FLORALTON DR	SPRING HILL FL 34610
1397 440 331 040	1081082001		AND THERESA REED	17621 DRIFTWOOD LN LUTZ FL 33558
1397 450 328 990	5812067001		17231 DRIFTWOOD LN	LUTZ FL 33558
1397 450 330 760	4932006001		17545 DRIFTWOOD LN	LUTZ FL 33558
1397 450 332 580	0191519001		OR JESUS MUNIZ	17916 DRIFTWOOD LN LUTZ FL 33558
1397 450 333 580	0187471001		1314 SIERRA PINES BLVD	LUTZ FL 33558
1397 450 344 990	0230240001		C/O LOUIS PALAZZO	20410 MOSS BEND CT LUTZ FL 33558
1397 450 345 860	0100922001		1324 LAKE COMO DR	LUTZ FL 33558
1397 460 330 130	0251303001		17320 DRIFTWOOD LN	LUTZ FL 33558
1397 460 330 130	0234569001		23301 SAINT CROIX PL	LAND O LAKES FL 34639

EXHIBIT C

Withlacoochee River Electric Cooperative, Inc. Accounts to be transferred to Progress Energy

<u>Account Number</u>	<u>Member ID</u>	<u>Name</u>	<u>Service Address</u>	
1397 460 331 610	1496003001		17729 DRIFTWOOD LN	LUTZ FL 33558
1397 460 346 440	0039714001		20715 PRESTON LN	LUTZ FL 33558
1397 470 328 440	2789055001		1321 WILDWOOD LN	LUTZ FL 33558
1397 470 329 850	1573004001		SIERRA PINES	17409 DRIFTWOOD LN LUTZ FL 33558
1397 470 330 870	0176480001		17605 DRIFTWOOD LN	LUTZ FL 33558
1397 480 328 810	0232207001		17215 DRIFTWOOD LN	LUTZ FL 33558
1397 480 329 720	0033861001		17351 DRIFTWOOD LN	LUTZ FL 33558
1397 500 330 610	0144075001		17533 DRIFTWOOD LN	LUTZ FL 33558
1397 500 344 710	0054773001		20301 MOSS BEND CT	LUTZ FL 33558
1397 520 329 130	0144242001		17245 DRIFTWOOD LN	LUTZ FL 33558
1397 520 330 010	0256492001		2148 CAPRI DR	CLEARWATER FL 33763
1397 520 330 010	0063969001		191 JENKINS AVE	MASARYKTOWN FL 34604
1397 520 331 210	5319006001		17637 DRIFTWOOD LN	LUTZ FL 33558
1397 520 346 470	0155721001		20719 PRESTON LN	LUTZ FL 33558
1397 530 329 430	0215505001		17321 DRIFTWOOD LN	LUTZ FL 33558
1397 530 329 580	1073102001		17335 DRIFTWOOD LN	LUTZ FL 33558
1397 530 332 140	0173767001		17829 DRIFTWOOD LN	LUTZ FL 33558
1397 530 332 750	0254745001		17934 DRIFTWOOD LN	LUTZ FL 33558
1397 530 332 750	0232647012		DBA ADVANTAGE 1ST RESAL	5340 US HIGHWAY 98 N LAKELAND FL 33809
1397 530 345 630	7813058001		1340 LAKE COMO DR	LUTZ FL 33558
1397 540 330 420	0053763001		17515 DRIFTWOOD LN	LUTZ FL 33558
1397 550 330 260	0127386001		17451 DRIFTWOOD LN	LUTZ FL 33558
1397 560 332 910	0020741001		17950 DRIFTWOOD LN	LUTZ FL 33558
1397 570 330 200	0088364002		5146 LARCH LN	NEW PORT RICHEY FL 34653
1397 570 333 050	2890076001		18018 DRIFTWOOD LN	LUTZ FL 33558
1397 580 329 240	0089303001		17305 DRIFTWOOD LN	LUTZ FL 33558
1397 580 331 900	1461001001		1320 COUNTRY LN	LUTZ FL 33558
1397 590 333 160	2890076003		18018 DRIFTWOOD LN	LUTZ FL 33558
1397 590 333 160	0348050208		11300 N CENTRAL AVE	TAMPA FL 33612
1397 590 333 360	0161211001		1337 SIERRA PINES BLVD	LUTZ FL 33558
1397 590 343 370	0072243001		20124 HIDEAWAY LN	LUTZ FL 33558
1397 610 328 430	2336061001		1337 WILDWOOD LN	LUTZ FL 33558
1397 630 343 210	0029366001		20050 HIDEAWAY LN	LUTZ FL 33558
1397 650 342 720	0189253001		1336 BIG MOSS LAKE RD	LUTZ FL 33558
1397 650 344 650	0861082001		20305 MOSS BEND CT	LUTZ FL 33558
1397 650 345 200	2329067001		1375 LAKE COMO DR	LUTZ FL 33558
1397 670 343 020	1131113002		20036 HIDEAWAY LN	LUTZ FL 33558
1397 670 343 240	5557069002		5205 WILCOX RD	TAMPA FL 33624
1397 670 343 450	0103874001		20131 HIDEAWAY LN	LUTZ FL 33558
1397 680 344 650	7739074002		20315 MOSS BEND CT	LUTZ FL 33558
1397 690 343 300	5557069003		5205 WILCOX RD	TAMPA FL 33624

EXHIBIT C

Withlacoochee River Electric Cooperative, Inc. Accounts to be transferred to Progress Energy

<u>Account Number</u>	<u>Member ID</u>	<u>Name</u>	<u>Service Address</u>	
1397 700 332 580	8976119001		8197 BRISTOL BAY AVE LAKELAND FL	33810
1397 710 328 740	0808007001		1344 WILDWOOD LN LUTZ FL	33558
1397 710 330 570	0211969001		5807 N THATCHER AVE TAMPA FL	33614
1397 720 331 180	6878013003		2611 W LUTZ LAKE FRN RD LUTZ FL	33558
1397 720 331 880	0132796001		1344 COUNTRY LN LUTZ FL	33558
1397 720 344 840	5577050001		20404 MOSS BEND CT LUTZ FL	33558
1397 720 344 930	0241510001		20416 MOSS BEND CT LUTZ FL	33558
1397 720 344 930	8128005001		20416 MOSS BEND CT LUTZ FL	33558
1397 730 332 300	0131366002		17847 DRIFTWOOD LN LUTZ FL	33558
1397 730 333 540	0158215001		1346 SIERRA PINES BLVD LUTZ FL	33558
1397 750 332 430	0166095001		106 2ND AVE SE LUTZ FL	33549
1397 750 332 430	0131366003		17847 DRIFTWOOD LN LUTZ FL	33558
1397 780 331 680	0774052001		17730 HICKORY TREE CT LUTZ FL	33558
1397 790 329 590	5459105001		17334 MEADOW LN LUTZ FL	33558
1397 790 330 340	0112224001		17452 MEADOW LN LUTZ FL	33558
1397 790 332 290	0131366001		17847 DRIFTWOOD LN LUTZ FL	33558
1397 790 332 800	0247979001		17935 DRIFTWOOD LN LUTZ FL	33558
1397 790 332 800	0125528001		4238 BRIARBERRY LN TAMPA FL	33624
1397 800 344 550	0121901001		20325 MOSS BEND CT LUTZ FL	33558
1397 810 328 950	0121037001		17230 MEADOW LN LUTZ FL	33558
1397 810 329 880	0083464001		17408 MEADOW LN LUTZ FL	33558
1397 810 330 940	0218702001		17620 HICKORY TREE CT LUTZ FL	33558
1397 820 329 440	9368062002		17320 MEADOW LN LUTZ FL	33558
1397 830 329 120	1615007001		17244 MEADOW LN LUTZ FL	33558
1397 830 329 270	0902053001		17304 MEADOW LN LUTZ FL	33558
1397 830 329 720	0136423001		17350 MEADOW LN LUTZ FL	33558
1397 830 330 180	5690058001		17440 MEADOW LN LUTZ FL	33558
1397 830 330 890	0185091001		17604 HICKORY TREE CT LUTZ FL	33558
1397 830 333 050	0110715001		18001 DRIFTWOOD LN LUTZ FL	33558
1397 850 331 070	0044568001		17636 HICKORY TREE CT LUTZ FL	33558
1397 850 331 500	0188422001		17714 HICKORY TREE CT LUTZ FL	33558
1397 860 330 010	1321075001		17424 MEADOW LN LUTZ FL	33558
1397 860 331 170	0171401001		17652 HICKORY TREE CT LUTZ FL	33558
1397 860 343 560	5399056001		20135 GREEN GRASS LN LUTZ FL	33558
1397 870 328 750	0215827001		1408 WILDWOOD LN LUTZ FL	33558
1397 870 333 280	0234750001		1411 SIERRA PINES BLVD LUTZ FL	33558
1397 870 342 750	5399056002		1404 BIG MOSS LAKE RD LUTZ FL	33558
1397 870 343 240	0027770001		20105 GREEN GRASS LN LUTZ FL	33558
1397 880 328 380	0102594001		1351 WILDWOOD LN LUTZ FL	33558
1397 880 330 840	0185091002		17604 HICKORY TREE CT LUTZ FL	33558
1397 890 344 670	8331005001		20341 MOSS BEND CT LUTZ FL	33558

EXHIBIT C

Withlacoochee River Electric Cooperative, Inc. Accounts to be transferred to Progress Energy

<u>Account Number</u>	<u>Member ID</u>	<u>Name</u>	<u>Service Address</u>	
1397 890 344 950	7146077002		20415 MOSS BEND CT	LUTZ FL 33558
1397 900 332 860	6040001001		17951 DRIFTWOOD LN	LUTZ FL 33558
1397 900 345 230	0217174001		20445 MOSS BEND CT	LUTZ FL 33558
1397 910 343 500	0125163001		1412 BIG MOSS LAKE RD	LUTZ FL 33558
1397 910 345 010	3035006001		20425 MOSS BEND CT	LUTZ FL 33558
1397 920 331 940	4621059001		1410 COUNTRY LN	LUTZ FL 33558
1397 920 344 850	8971002001		20405 MOSS BEND CT	LUTZ FL 33558
1397 920 345 080	0226878001		20435 MOSS BEND CT	LUTZ FL 33558
1397 950 328 280	0253150001		1417 WILDWOOD LN	LUTZ FL 33558
1397 950 328 280	0136156001		13495 CHAMBORD ST	BROOKSVILLE FL 34613
1398 000 343 590	5741010001		1420 BIG MOSS LAKE RD	LUTZ FL 33558
1398 020 333 560	4621096001		PO BOX 623	OLDSMAR FL 34677
1398 030 333 360	0499055002		1445 SIERRA PINES BLVD	LUTZ FL 33558
1398 030 344 510	1931051001		20345 MOSS BEND CT	LUTZ FL 33558
1398 040 343 550	0210343001		20204 GRAHAM LN	LUTZ FL 33558
1398 060 331 010	7494007001		17631 HICKORY TREE CT	LUTZ FL 33558
1398 070 331 360	6878013010		2611 W LUTZ LAKE FRN RD	LUTZ FL 33558
1398 070 344 660	0825096001		1505 LAKE COMO DR	LUTZ FL 33558
1398 080 331 580	0165612001		17725 HICKORY TREE CT	LUTZ FL 33558
1398 100 328 420	0136857001		1421 WILDWOOD LN	LUTZ FL 33558
1398 100 344 990	1321040001		1481 LAKE COMO DR	LUTZ FL 33558
1398 110 344 860	0244894001		1491 LAKE COMO DR	LUTZ FL 33558
1398 110 344 860	0230595001		21403 HOPSON RD	LAND O LAKES FL 34639
1398 110 345 150	9095005001		1465 LAKE COMO DR	LUTZ FL 33558
1398 120 328 890	0183698001		KIMBERLY SIDNEY #210	22702 CHESTERVIEW LOOP LAND O LAKES FL 34639
1398 120 329 550	0994109001		17329 MEADOW LN	LUTZ FL 33558
1398 120 329 680	0174291001		1431 PONDEROSA DR	LUTZ FL 33558
1398 120 330 850	0149539001		C/O RONNIE ESTEP SR	2312 MEADOWBROOK DR LUTZ FL 33558
1398 130 329 370	3045012001		17309 MEADOW LN	LUTZ FL 33558
1398 130 329 960	4942014001		1430 PONDEROSA DR	LUTZ FL 33558
1398 140 333 210	0499055001		1445 SIERRA PINES BLVD	LUTZ FL 33558
1398 140 344 580	3702069002		1515 LAKE COMO DR	LUTZ FL 33558
1398 150 333 080	3567050002		18002 DOGWOOD DR	LUTZ FL 33558
1398 160 343 630	0200782001		20200 GRAHAM LN	LUTZ FL 33558
1398 170 328 620	0158407001		1441 WILDWOOD LN	LUTZ FL 33558
1398 170 344 460	0057885002		7510 WEST DR	WESLEY CHAPEL FL 33544
1398 170 344 460	0128035001		EDWARD A MARTIN	7209 KINGSBURY CIR TAMPA FL 33610
1398 220 329 020	0043878001		1500 WILDWOOD LN	LUTZ FL 33558
1398 220 345 210	1479072001		1450 LAKE COMO DR	LUTZ FL 33558
1398 230 331 830	5670007001		1446 COUNTRY LN	LUTZ FL 33558
1398 240 344 220	4549078001		1704 W WATROUS AVE	TAMPA FL 33606

EXHIBIT C

Withlacoochee River Electric Cooperative, Inc. Accounts to be transferred to Progress Energy

<u>Account Number</u>	<u>Member ID</u>	<u>Name</u>	<u>Service Address</u>	
1398 240 344 270	7348070001	[REDACTED]	1551 LAKE COMO DR	LUTZ FL 33558
1398 240 344 370	0250988001	[REDACTED]	1541 LAKE COMO DR	LUTZ FL 33558
1398 240 344 370	0057885001	[REDACTED]	PO BOX 2004	LAND O LAKES FL 34639
1398 240 344 740	0203713001	[REDACTED]	1500 LAKE COMO DR	LUTZ FL 33558
1398 240 345 100	7352014001	[REDACTED]	1460 LAKE COMO DR	LUTZ FL 33558
1398 250 328 170	0152750001	[REDACTED]	1530 WOODFIELD CT	LUTZ FL 33558
1398 250 342 750	1452081001	[REDACTED]	1444 BIG MOSS LAKE RD	LUTZ FL 33558
1398 250 344 980	0252533001	[REDACTED]	1474 LAKE COMO DR	LUTZ FL 33558
1398 250 344 980	0223412003	[REDACTED]	12618 POMPANIC ST	SAN ANTONIO FL 33576
1398 260 344 170	0093714001	[REDACTED]	1567 LAKE COMO DR	LUTZ FL 33558
1398 260 344 620	0155182001	[REDACTED]	1510 LAKE COMO DR	LUTZ FL 33558
1398 260 344 850	7352014002	[REDACTED]	1484 LAKE COMO DR	LUTZ FL 33558
1398 270 329 110	0120596001	[REDACTED]	1516 WILDWOOD LN	LUTZ FL 33558
1398 270 345 020	9686024002	[REDACTED]	1470 LAKE COMO DR	LUTZ FL 33558
1398 280 344 080	0163035001	[REDACTED]	C/O MICHAEL HOOPS	1589 LAKE COMO DR LUTZ FL 33558
1398 290 329 960	0162910001	[REDACTED]	1512 PONDEROSA DR	LUTZ FL 33558
1398 290 331 590	8164002001	[REDACTED]	17716 DOGWOOD DR	LUTZ FL 33558
1398 290 332 460	0134201002	[REDACTED]	PO BOX 113	LUTZ FL 33548
1398 300 333 530	0118423001	[REDACTED]	1508 SIERRA PINES BLVD	LUTZ FL 33558
1398 300 343 750	0079551002	[REDACTED]	20208 GRAHAM LN	LUTZ FL 33558
1398 310 331 160	0136612001	[REDACTED]	17624 DOGWOOD DR	LUTZ FL 33558
1398 310 332 060	0076663002	[REDACTED]	17808 DOGWOOD DR	LUTZ FL 33558
1398 310 332 060	0231095001	[REDACTED]	5935 TOWER RD	LAND O LAKES FL 34638
1398 310 332 910	1478003001	[REDACTED]	SIERRA PINES	17944 DOGWOOD DR LUTZ FL 33558
1398 330 329 680	3128054001	[REDACTED]	17340 GUNLOCK RD	LUTZ FL 33558
1398 330 332 760	1884053001	[REDACTED]	17930 DOGWOOD DR	LUTZ FL 33558
1398 330 333 060	3567050003	[REDACTED]	18002 DOGWOOD DR	LUTZ FL 33558
1398 340 332 160	0245690001	[REDACTED]	17824 DOGWOOD DR	LUTZ FL 33558
1398 340 332 320	4953063001	[REDACTED]	17840 DOGWOOD DR	LUTZ FL 33558
1398 350 328 340	1490064001	[REDACTED]	1536 WOODFIELD CT	LUTZ FL 33558
1398 350 333 340	9471071001	[REDACTED]	1505 SIERRA PINES BLVD	LUTZ FL 33558
1398 370 331 320	0209070001	[REDACTED]	17644 DOGWOOD DR	LUTZ FL 33558
1398 420 330 430	0156745001	[REDACTED]	17510 GUNLOCK RD	LUTZ FL 33558
1398 430 329 180	3286086001	[REDACTED]	1532 WILDWOOD LN	LUTZ FL 33558
1398 440 329 960	0182107001	[REDACTED]	1512 PONDEROSA DR	LUTZ FL 33558
1398 470 328 820	1509055001	[REDACTED]	1507 WILDWOOD LN	LUTZ FL 33558
1398 480 331 020	0130984002	[REDACTED]	PSC 76 BOX 4647	APO AP 96319
1398 520 329 360	0074722005	[REDACTED]	1548 WILDWOOD LN	LUTZ FL 33558
1398 540 328 470	0103821001	[REDACTED]	1542 WOODFIELD CT	LUTZ FL 33558
1398 550 331 690	0164356001	[REDACTED]	17731 DOGWOOD DR	LUTZ FL 33558
1398 550 332 000	0119267001	[REDACTED]	PO BOX 1230	LUTZ FL 33548

EXHIBIT C

Withlacoochee River Electric Cooperative, Inc. Accounts to be transferred to Progress Energy

<u>Account Number</u>	<u>Member ID</u>	<u>Name</u>	<u>Service Address</u>	
1398 550 332 130	9723000001		1704 S HUBERT AVE	TAMPA FL 33629
1398 550 332 300	0122005001		17841 DOGWOOD DR	LUTZ FL 33558
1398 560 331 390	6040003001		17701 DOGWOOD DR	LUTZ FL 33558
1398 570 332 450	0078924002		17901 DOGWOOD DR	LUTZ FL 33558
1398 570 332 900	0078924005		17901 DOGWOOD DR	LUTZ FL 33558
1398 570 332 900	0116081001		17945 DOGWOOD DR	LUTZ FL 33558
1398 590 328 970	9893000001		1527 WILDWOOD LN	LUTZ FL 33558
1398 590 332 730	7036054002		17931 DOGWOOD DR	LUTZ FL 33558
1398 590 333 190	0063405001		18019 DOGWOOD DR	LUTZ FL 33558
1398 590 333 490	8568089001		18043 DOGWOOD DR	LUTZ FL 33558
1398 600 331 060	0224613002		17625 DOGWOOD DR	LUTZ FL 33558
1398 600 333 030	0226053001		5822 IMPERIAL KY	TAMPA FL 33615
1398 610 328 180	5556002002		1535 WOODFIELD CT	LUTZ FL 33558
1398 610 331 850	0206452001		ELSY M OGIBA	17747 DOGWOOD DR LUTZ FL 33558
1398 620 329 710	0157708002		17335 GUNLOCK RD	LUTZ FL 33558
1398 620 332 630	0046642001		PO BOX 1383	LUTZ FL 33548
1398 630 330 420	0147918001		23603 TURTLE LAKES LN	LUTZ FL 33559
1398 640 332 260	0134201001		PO BOX 113	LUTZ FL 33548
1398 680 331 560	0916067005		30337 CHAPEL DR	ZEPHYRHILLS FL 33544
1398 680 333 050	0226053002		5822 IMPERIAL KY	TAMPA FL 33615
1398 690 329 400	0144450001		1564 WILDWOOD LN	LUTZ FL 33558
1398 700 328 600	0083420001		1566 WOODFIELD CT	LUTZ FL 33558
1398 700 329 880	7850103001		SIERRA PINES	17411 GUNLOCK RD LUTZ FL 33558
1398 700 330 250	0161563001		17451 GUNLOCK RD	LUTZ FL 33558
1398 700 330 620	0503057001		17531 GUNLOCK RD	LUTZ FL 33558
1398 720 329 110	0001118001		1545 WILDWOOD LN	LUTZ FL 33558
1398 720 331 270	0233962001		17641 DOGWOOD DR	LUTZ FL 33558
1398 740 328 330	0133019001		OR RONALD G TORRES	1543 WOODFIELD CT LUTZ FL 33558
1398 750 329 690	0157708001		17335 GUNLOCK RD	LUTZ FL 33558
1398 760 330 110	7850103002		17431 GUNLOCK RD	LUTZ FL 33558
1398 820 329 220	0180143001		1565 WILDWOOD LN	LUTZ FL 33558
1398 840 328 780	0194334001		1610 WOODFIELD CT	LUTZ FL 33558
1398 910 328 450	5835066001		1565 WOODFIELD CT	LUTZ FL 33558
1398 940 329 750	2789085001		17340 WELLFIELD CT	LUTZ FL 33558
1398 950 330 110	0017466001		17430 WELLFIELD CT	LUTZ FL 33558
1398 950 330 250	8433000001		17450 WELLFIELD CT	LUTZ FL 33558
1398 960 330 780	0153889002		17550 WELLFIELD CT	LUTZ FL 33558
1398 970 329 930	8098105001		17410 WELLFIELD CT	LUTZ FL 33558
1398 980 331 050	0026971001		17610 WELLFIELD CT	LUTZ FL 33558
1398 990 330 450	0239705001		17510 WELLFIELD CT	LUTZ FL 33558
1399 040 329 390	7730051001		17325 WELLFIELD CT	LUTZ FL 33558

EXHIBIT C

Withlacoochee River Electric Cooperative, Inc. Accounts to be transferred to Progress Energy

<u>Account Number</u>	<u>Member ID</u>	<u>Name</u>	<u>Service Address</u>	
1399 060 328 940	9288073002		1620 WOODFIELD CT	LUTZ FL 33558
1399 070 328 650	0186895001		1623 WOODFIELD CT	LUTZ FL 33558
1399 130 328 020	4955079002		1651 OAKWOOD CT	LUTZ FL 33558
1399 150 329 240	0141317001		17239 GUNLOCK RD	LUTZ FL 33558
1399 190 330 840	0115032001		21038 VOYAGER BLVD # D3	LAND O LAKES FL 34638
1399 210 331 090	0115032003		17551 WELLFIELD CT	LUTZ FL 33558
1399 220 329 900	8187050001		17405 WELLFIELD CT	LUTZ FL 33558
1399 230 330 980	0115032002		17551 WELLFIELD CT	LUTZ FL 33558
1399 240 330 660	0223686001		17535 WELLFIELD CT	LUTZ FL 33558
1399 250 330 430	9769064001		17511 WELLFIELD CT	LUTZ FL 33558
1399 270 328 780	1234055001		1651 WOODFIELD CT	LUTZ FL 33558
1399 290 329 100	1358015001		17641 DEERFIELD DR	LUTZ FL 33558
1399 300 330 270	0011217001		17451 WELLFIELD CT	LUTZ FL 33558
1399 310 328 460	0131751001		1724 OAKWOOD CT	LUTZ FL 33558
1399 350 329 470	0207580001		16580 NORTHDAL OAKS DR	TAMPA FL 33624
1399 370 328 210	2602050001		1665 OAKWOOD CT	LUTZ FL 33558
1399 430 329 200	0065941001		17701 DEERFIELD DR	LUTZ FL 33558
1399 460 328 550	9193053001		1730 OAKWOOD CT	LUTZ FL 33558
1399 500 329 340	0253577001		17735 DEERFIELD DR	LUTZ FL 33558
1399 500 329 340	0154902001		26201 LOST HORSE LN	BROOKSVILLE FL 34601
1399 550 328 280	0119652001		1725 OAKWOOD CT	LUTZ FL 33558
1399 560 328 980	5140079001		17205 GUNLOCK RD	LUTZ FL 33558
1399 600 328 840	0198830001		17157 GUNLOCK RD	LUTZ FL 33558
1399 610 328 340	0142579001		1741 OAKWOOD CT	LUTZ FL 33558
1399 610 330 000	0216112002		WADE H BROXTON	17420 CEDARWOOD LOOP LUTZ FL 33558
1399 640 329 790	0178198001		17400 CEDARWOOD LOOP	LUTZ FL 33558
1399 650 330 130	0216112001		WADE H BROXTON	17420 CEDARWOOD LOOP LUTZ FL 33558
1399 710 320 320	0227214001		3281 LANDMARK DR	CLEARWATER FL 33761
1399 710 330 540	0124865001		17450 CEDARWOOD LOOP	LUTZ FL 33558
1399 720 330 280	0025697001		17430 CEDARWOOD LOOP	LUTZ FL 33558
1399 730 328 710	0152272001		17135 GUNLOCK RD	LUTZ FL 33558
1399 750 330 690	0095929002		17460 CEDARWOOD LOOP	LUTZ FL 33558
1399 790 329 480	5395056001		17801 DEERFIELD DR	LUTZ FL 33558
1399 820 329 730	0176263001		17802 DEERFIELD DR	LUTZ FL 33558
1399 950 317 260	0187355001		15007 BALOUGH RD	ODESSA FL 33556
1399 950 330 160	3433051003		17425 CEDARWOOD LOOP	LUTZ FL 33558
1399 950 330 350	4985077002		31137 SAINT JOE RD	DADE CITY FL 33525
1399 950 330 350	0262298001		17435 CEDARWOOD LOOP	LUTZ FL 33558
1399 960 317 710	0148260003		1835 EATON RD	ODESSA FL 33556
1399 960 317 930	6932180002		PO BOX 41	ELFERS FL 34680
1399 960 318 070	0184792001		15139 BALOUGH RD	ODESSA FL 33556

EXHIBIT C

Withlacoochee River Electric Cooperative, Inc. Accounts to be transferred to Progress Energy

<u>Account Number</u>	<u>Member ID</u>	<u>Name</u>	<u>Service Address</u>	
1399 960 330 470	0836051001	[REDACTED]	17451 CEDARWOOD LOOP	LUTZ FL 33558
1399 970 317 570	0111177002	[REDACTED]	1746 EATON RD	ODESSA FL 33556
1399 980 330 950	0066225001	[REDACTED]	17480 CEDARWOOD LOOP	LUTZ FL 33558
1399 990 330 680	1615056001	[REDACTED]	17485 CEDARWOOD LOOP	LUTZ FL 33558
1400 010 329 550	0254423001	[REDACTED]	5306 DEER RUN DR	FORT PIERCE FL 34951
1400 010 329 550	0074990001	[REDACTED]	3203 NEUBURG CT	COLLEGE STATION TX 77845
1400 010 329 790	0201674001	[REDACTED]	PO BOX 2049	LUTZ FL 33548
1400 020 318 380	0203456001	[REDACTED]	1738 AKSARBEN RD	ODESSA FL 33556
1400 060 317 400	0111177001	[REDACTED]	1746 EATON RD	ODESSA FL 33556
1400 070 317 880	0159471001	[REDACTED]	1747 DENNISON RD	ODESSA FL 33556
1400 100 318 080	0111177003	[REDACTED]	1746 EATON RD	ODESSA FL 33556
1400 100 327 850	0173490001	[REDACTED]	17036 BRIDLEPATH CT	LUTZ FL 33558
1400 120 329 820	0236669001	[REDACTED]	17834 DEERFIELD DR	LUTZ FL 33558
1400 130 328 070	0083252001	[REDACTED]	17040 BRIDLEPATH CT	LUTZ FL 33558
1400 150 330 990	0070900001	[REDACTED]	17490 CEDARWOOD LOOP	LUTZ FL 33558
1400 170 317 890	0140813001	[REDACTED]	PO BOX 141	ODESSA FL 33556
1400 180 318 740	0179707002	[REDACTED]	15254 STATE ROAD 54	ODESSA FL 33556
1400 180 318 740	0230848001	[REDACTED]	2919 BRADLEY CT	NEW PORT RICHEY FL 34655
1400 190 317 250	4700000001	[REDACTED]	1807 EATON RD	ODESSA FL 33556
1400 190 317 570	6932180001	[REDACTED]	PO BOX 41	ELFERS FL 34680
1400 190 328 410	0021499002	[REDACTED]	17114 BRIDLEPATH CT	LUTZ FL 33558
1400 190 328 690	0071629002	[REDACTED]	17128 BRIDLEPATH CT	LUTZ FL 33558
1400 200 328 560	0071629001	[REDACTED]	17128 BRIDLEPATH CT	LUTZ FL 33558
1400 210 328 870	0084648001	[REDACTED]	17202 BRIDLEPATH CT	LUTZ FL 33558
1400 220 317 420	0214100001	[REDACTED]	PO BOX 373	ODESSA FL 33556
1400 240 318 070	7763071001	[REDACTED]	PO BOX 171	ODESSA FL 33556
1400 250 330 260	0070523002	[REDACTED]	17551 CEDARWOOD LOOP	LUTZ FL 33558
1400 260 330 650	0044979001	[REDACTED]	17501 CEDARWOOD LOOP	LUTZ FL 33558
1400 280 331 050	7707084002	[REDACTED]	17500 CEDARWOOD LOOP	LUTZ FL 33558
1400 300 329 820	0158926001	[REDACTED]	17848 DEERFIELD DR	LUTZ FL 33558
1400 300 330 170	7733070001	[REDACTED]	17555 CEDARWOOD LOOP	LUTZ FL 33558
1400 320 329 010	0074195001	[REDACTED]	17224 BRIDLEPATH CT	LUTZ FL 33558
1400 320 330 520	0230334001	[REDACTED]	17541 CEDARWOOD LOOP	LUTZ FL 33558
1400 330 317 570	0037987002	[REDACTED]	1821 ANNA RD	ODESSA FL 33556
1400 330 318 420	0222562001	[REDACTED]	1830 AKSARBEN RD	ODESSA FL 33556
1400 360 317 260	1030061001	[REDACTED]	PO BOX 358	ODESSA FL 33556
1400 360 317 720	0148260004	[REDACTED]	1835 EATON RD	ODESSA FL 33556
1400 370 318 070	0204926003	[REDACTED]	1820 DENNISON RD	ODESSA FL 33556
1400 410 317 900	6517001004	[REDACTED]	PO BOX 14	ODESSA FL 33556
1400 420 329 170	0102171001	[REDACTED]	17238 BRIDLEPATH CT	LUTZ FL 33558
1400 440 329 550	1894066001	[REDACTED]	PO BOX 2345	LAND O LAKES FL 34639

EXHIBIT C

Withlacoochee River Electric Cooperative, Inc. Accounts to be transferred to Progress Energy

<u>Account Number</u>	<u>Member ID</u>	<u>Name</u>	<u>Service Address</u>	
1400 440 331 020	3202074001		17510 CEDARWOOD LOOP	LUTZ FL 33558
1400 450 317 480	1807053003		15110 STATE ROAD 54	ODESSA FL 33556
1400 460 317 250	0148260002		1835 EATON RD	ODESSA FL 33556
1400 460 318 080	5820018001		1836 DENNISON RD	ODESSA FL 33556
1400 480 317 720	3538061007		1650 S FISHCREEK PT	CRYSTAL RIVER FL 34429
1400 480 330 840	0143302001		17514 CEDARWOOD LOOP	LUTZ FL 33558
1400 490 317 900	6517001001		PO BOX 14	ODESSA FL 33556
1400 490 327 840	0113249001		17030 BRIDLEPATH CT	LUTZ FL 33558
1400 510 330 150	0144436001		17561 CEDARWOOD LOOP	LUTZ FL 33558
1400 530 329 380	0212363142		30432 STATE ROAD 54	WESLEY CHAPEL FL 33543
1400 540 329 740	0174606001		17569 CEDARWOOD LOOP	LUTZ FL 33558
1400 640 317 750	1807053001		15110 STATE ROAD 54	ODESSA FL 33556
1400 640 318 290	8521000001		15212 STATE ROAD 54	ODESSA FL 33556
1400 640 329 150	0158573001		17237 BRIDLEPATH CT	LUTZ FL 33558
1400 640 329 300	0047788001		PO BOX 471	LUTZ FL 33548
1400 660 318 090	0052743001		15148 STATE ROAD 54	ODESSA FL 33556
1400 660 323 080	0222487001		9625 WES KEARNEY WAY	RIVERVIEW FL 33569
1400 660 327 850	0115896001		17035 BRIDLEPATH CT	LUTZ FL 33558
1400 670 328 860	0033509001		17209 BRIDLEPATH CT	LUTZ FL 33558
1400 670 330 330	0163559001		17550 CEDARWOOD LOOP	LUTZ FL 33558
1400 690 328 210	7002063002		17101 BRIDLEPATH CT	LUTZ FL 33558
1400 690 330 530	0149181001		5945 BENT PINE DR #1336	ORLANDO FL 32822
1400 700 328 470	7002063001		PO BOX 1568	LUTZ FL 33548
1400 710 328 980	0252833002		17223 BRIDLEPATH CT	LUTZ FL 33558
1400 710 328 980	0025817002		PO BOX 2570	LAND O LAKES FL 34639
1400 710 329 450	0189154001		17315 BRIDLEPATH CT	LUTZ FL 33558
1400 710 330 160	0179493001		17560 CEDARWOOD LOOP	LUTZ FL 33558
1400 720 317 930	0023451002		15122 STATE ROAD 54	ODESSA FL 33556
1400 720 328 710	1277105001		1936 MEADOWBROOK DR	LUTZ FL 33558
1400 730 330 650	0133784001		17520 CEDARWOOD LOOP	LUTZ FL 33558
1400 750 328 000	0201394001		17041 BRIDLEPATH CT	LUTZ FL 33558
1400 760 329 630	1918072001		17580 CEDARWOOD LOOP	LUTZ FL 33558
1400 920 328 710	3642055001		2012 MEADOWBROOK DR	LUTZ FL 33558
1400 940 329 230	0153703001		17304 RAIN TREE RD	LUTZ FL 33558
1400 960 342 620	4689108002		1890 DAIQUIRI LN	LUTZ FL 33549
1400 970 329 490	3120059001		17308 RAIN TREE RD	LUTZ FL 33558
1400 970 342 400	0216984001		19921 LEONARD RD	LUTZ FL 33558
1400 970 342 490	0066108001		19935 LEONARD RD	LUTZ FL 33558
1400 980 342 180	3642003002		19936 STATE ROAD 54	LUTZ FL 33558
1400 990 341 950	5531005001		19825 LEONARD RD	LUTZ FL 33558
1401 000 341 740	0140676001		19805 LEONARD RD	LUTZ FL 33558

EXHIBIT C

Withlacoochee River Electric Cooperative, Inc. Accounts to be transferred to Progress Energy

<u>Account Number</u>	<u>Member ID</u>	<u>Name</u>	<u>Service Address</u>	
1401 010 329 690	0073954001	[REDACTED]	17312 RAINTREE RD	LUTZ FL 33558
1401 010 341 600	5629085001	[REDACTED]	19741 LEONARD RD	LUTZ FL 33558
1401 090 328 260	0192548001	[REDACTED]	17000 WINTERGREEN CT	LUTZ FL 33558
1401 230 329 450	0067834001	[REDACTED]	17307 RAINTREE RD	LUTZ FL 33558
1401 230 329 680	0014693001	[REDACTED]	17316 RAINTREE RD	LUTZ FL 33558
1401 260 316 560	0201491001	[REDACTED]	14951 OGDEN LOOP	ODESSA FL 33556
1401 260 328 170	0077610001	[REDACTED]	17036 WINTERGREEN CT	LUTZ FL 33558
1401 260 328 500	5199071002	[REDACTED]	2101 MEADOWBROOK DR	LUTZ FL 33558
1401 270 316 630	1009023001	[REDACTED]	14955 OGDEN LOOP	ODESSA FL 33556
1401 270 328 360	3553051002	[REDACTED]	17104 WINTERGREEN CT	LUTZ FL 33558
1401 280 313 730	0189661001	[REDACTED]	2007 CHESAPEAKE DR	ODESSA FL 33556
1401 280 314 010	0106906002	[REDACTED]	PO BOX 8473	TAMPA FL 33674
1401 280 314 030	0106906001	[REDACTED]	2008 CHESAPEAKE DR	ODESSA FL 33556
1401 290 314 810	0177887001	[REDACTED]	4518 W BEACHWAY DR	TAMPA FL 33609
1401 290 316 410	0178901001	[REDACTED]	14945 OGDEN LOOP	ODESSA FL 33556
1401 300 316 440	9314050001	[REDACTED]	14947 OGDEN LOOP	ODESSA FL 33556
1401 310 314 450	5657059002	[REDACTED]	14506 WATERLOO RD	ODESSA FL 33556
1401 310 314 450	5351800001	[REDACTED]	3741 S MERIDIAN ST	INDIANAPOLIS IN 46217
1401 310 314 640	0157867001	[REDACTED]	14515 WATERLOO RD	ODESSA FL 33556
1401 320 314 210	0242069001	[REDACTED]	14429 WATERLOO RD	ODESSA FL 33556
1401 320 314 210	0155863001	[REDACTED]	14456 GENEVA DR	ODESSA FL 33556
1401 320 314 760	0126380002	[REDACTED]	10340 N WAR HORSE PT	CRYSTAL RIVER FL 34428
1401 320 327 890	0187606001	[REDACTED]	17017 WINTERGREEN CT	LUTZ FL 33558
1401 330 314 570	0106450001	[REDACTED]	14505 WATERLOO RD	ODESSA FL 33556
1401 340 316 710	1618020001	[REDACTED]	14957 OGDEN LOOP	ODESSA FL 33556
1401 350 329 410	0067834002	[REDACTED]	17307 RAINTREE RD	LUTZ FL 33549
1401 370 313 940	0106906003	[REDACTED]	PO BOX 8473	TAMPA FL 33674
1401 370 314 400	0137852002	[REDACTED]	14410 GENEVA DR	ODESSA FL 33556
1401 370 328 760	5636063001	[REDACTED]	2100 MEADOWBROOK DR	LUTZ FL 33558
1401 370 328 960	0172803001	[REDACTED]	17294 RAINTREE RD	LUTZ FL 33558
1401 380 314 200	0036965001	[REDACTED]	14427 GENEVA DR	ODESSA FL 33556
1401 380 329 710	9504054001	[REDACTED]	17320 RAINTREE RD	LUTZ FL 33558
1401 390 316 560	1009035001	[REDACTED]	14956 OGDEN LOOP	ODESSA FL 33556
1401 400 313 690	3271002002	[REDACTED]	2019 CHESAPEAKE DR	ODESSA FL 33556
1401 400 316 120	0028407001	[REDACTED]	14820 GENEVA DR	ODESSA FL 33556
1401 420 314 400	0107132001	[REDACTED]	14426 GENEVA DR	ODESSA FL 33556
1401 420 328 430	0212363081	[REDACTED]	# 63169504	10555 MOON LAKE RD NEW PORT RICHEY FL 34654
1401 440 313 700	3271002001	[REDACTED]	2019 CHESAPEAKE DR	ODESSA FL 33556
1401 460 314 200	0008099001	[REDACTED]	14437 GENEVA DR	ODESSA FL 33556
1401 460 316 100	0028407002	[REDACTED]	14820 GENEVA DR	ODESSA FL 33556
1401 460 316 100	0249788001	[REDACTED]	JAMES STEVENS	90 S DAVIS ST BEVERLY HILLS FL 34465

EXHIBIT C

Withlacoochee River Electric Cooperative, Inc. Accounts to be transferred to Progress Energy

<u>Account Number</u>	<u>Member ID</u>	<u>Name</u>	<u>Service Address</u>	
1401 470 314 350	0045569001		14436 GENEVA DR	ODESSA FL 33556
1401 470 329 440	0839079002		17311 RAINTREE RD	LUTZ FL 33558
1401 490 316 520	0184514001		PO BOX 786	ODESSA FL 33556
1401 500 316 650	0071927004		PO BOX 684	ODESSA FL 33556
1401 510 313 790	5453064002		2029 CHESAPEAKE DR	ODESSA FL 33556
1401 510 316 330	0075680001		14939 OGDEN LOOP	ODESSA FL 33556
1401 520 314 040	0245302001		PO BOX 144	ODESSA FL 33556
1401 520 314 040	7353058001		8802 TUPELO DR	TAMPA FL 33637
1401 520 328 980	7695097001		17292 RAINTREE RD	LUTZ FL 33558
1401 520 329 250	5922055002		17301 RAINTREE RD	LUTZ FL 33558
1401 550 316 730	0048243006		14964 OGDEN LOOP	ODESSA FL 33556
1401 560 328 740	0178754001		2118 MEADOWBROOK DR	LUTZ FL 33558
1401 580 313 780	0257230001		14333 TIFTON LN # 1	ODESSA FL 33556
1401 580 313 780	0139690002		12875 VINELAND ST	SAN ANTONIO FL 33576
1401 580 329 710	8377074002		17324 RAINTREE RD	LUTZ FL 33558
1401 590 328 500	5584050002		17121 WINTERGREEN CT	LUTZ FL 33558
1401 600 313 650	0244597001		4348 NW 57TH BLVD	JENNINGS FL 32053
1401 600 313 650	0091766004		14337 TIFTON LN	ODESSA FL 33556
1401 600 313 650	0249218001		14945 BALOUGH RD	ODESSA FL 33556
1401 600 313 650	0204926001		14502 MIDDLEFIELD LN	ODESSA FL 33556
1401 600 313 720	0204926002		14502 MIDDLEFIELD LN	ODESSA FL 33556
1401 600 314 370	0032416001		14446 GENEVA DR	ODESSA FL 33556
1401 610 328 820	0178754002		2118 MEADOWBROOK DR	LUTZ FL 33558
1401 620 315 910	0024048002		24748 OAKS BLVD	LAND O LAKES FL 34639
1401 620 316 980	0056809002		122 GLADYS AVE	INGLIS FL 34449
1401 630 314 410	0026079001		14456 GENEVA DR	ODESSA FL 33556
1401 640 316 770	0203046001		PO BOX 852	ODESSA FL 33556
1401 640 328 300	0186288001		17105 WINTERGREEN CT	LUTZ FL 33558
1401 650 316 640	1056005001		14928 OGDEN LOOP	ODESSA FL 33556
1401 650 316 780	0071475002		14972 OGDEN LOOP	ODESSA FL 33556
1401 660 316 460	0235111001		14935 OGDEN LOOP	ODESSA FL 33556
1401 680 317 220	8001136010		PO BOX 3	ODESSA FL 33556
1401 690 317 010	3408052004		14433 SASSANDRA DR	ODESSA FL 33556
1401 700 313 770	0135658002		PO BOX 364	ODESSA FL 33556
1401 710 314 520	0063021001		14644 BLUESTONE LN	ODESSA FL 33556
1401 710 315 830	7536075001		14734 GENEVA DR	ODESSA FL 33556
1401 720 329 550	0213321001		17330 RAINTREE RD	LUTZ FL 33558
1401 730 314 440	3722110001		14466 GENEVA DR	ODESSA FL 33556
1401 730 316 720	1056015002		14924 OGDEN LOOP	ODESSA FL 33556
1401 740 316 850	0184514002		PO BOX 786	ODESSA FL 33556
1401 750 313 720	0135658001		PO BOX 364	ODESSA FL 33556

EXHIBIT C

Withlacoochee River Electric Cooperative, Inc. Accounts to be transferred to Progress Energy

<u>Account Number</u>	<u>Member ID</u>	<u>Name</u>	<u>Service Address</u>	
1401 750 315 650	0132238001		5111 ROCKING R DR	COLORADO SPRINGS CO 80915
1401 750 316 860	0235119001		14980 OGDEN LOOP	ODESSA FL 33556
1401 760 313 940	6932010190		OMB, SUITE 340	7530 LITTLE RD NEW PORT RICHEY FL 34654
1401 770 316 560	3545074007		14927 OGDEN LOOP	ODESSA FL 33556
1401 770 327 880	0055486005		2145 BROOKSIDE DR	LUTZ FL 33558
1401 780 314 690	0225122001		14520 GENEVA DR	ODESSA FL 33556
1401 780 314 970	0241635001		14550 GENEVA DR	ODESSA FL 33556
1401 780 315 080	0089277004		14608 GENEVA DR	ODESSA FL 33556
1401 780 315 110	0037440001		1022 GUNN HWY	ODESSA FL 33556
1401 790 316 790	0183641001		14920 OGDEN LOOP	ODESSA FL 33556
1401 800 314 630	4671010002		14510 GENEVA DR	ODESSA FL 33556
1401 800 316 800	0176107001		14916 OGDEN LOOP	ODESSA FL 33556
1401 800 328 700	0130183001		2150 MEADOWBROOK DR	LUTZ FL 33558
1401 810 315 500	7847010002		14642 GENEVA DR	ODESSA FL 33556
1401 810 315 550	7847010008		2633 SHEPHERDIA DR	ANCHORAGE AK 99508
1401 810 316 580	1009023003		14923 OGDEN LOOP	ODESSA FL 33556
1401 820 315 200	0216810001		14618 GENEVA DR	ODESSA FL 33556
1401 830 315 430	0046566001		14630 GENEVA DR	ODESSA FL 33556
1401 830 317 000	0157588002		14948 STATE ROAD 54	ODESSA FL 33556
1401 840 314 350	0189017002		14436 STATE ROAD 54	ODESSA FL 33556
1401 840 328 470	0169340001		2201 MEADOWBROOK DR	LUTZ FL 33558
1401 840 328 950	0114096001		17288 RAINTREE RD	LUTZ FL 33558
1401 840 329 220	0102964001		17293 RAINTREE RD	LUTZ FL 33558
1401 870 316 920	0072924002		14984 OGDEN LOOP	ODESSA FL 33556
1401 880 316 930	0208977001		14948 OGDEN LOOP	ODESSA FL 33556
1401 880 328 180	9649050001		17042 NATURE TRL	LUTZ FL 33558
1401 890 314 460	0189017001		14436 STATE ROAD 54	ODESSA FL 33556
1401 890 316 600	3545074001		14915 OGDEN LOOP	ODESSA FL 33556
1401 890 316 890	0115233001		14912 OGDEN LOOP	ODESSA FL 33556
1401 900 316 900	0143779002		14908 OGDEN LOOP	ODESSA FL 33556
1401 910 316 850	2376051001		670 ISLAND WAY APT 606	CLEARWATER BEACH FL 33767
1401 920 313 920	0218049001		PO BOX 1544	LAND O LAKES FL 34639
1401 920 314 390	0189017003		14436 STATE ROAD 54	ODESSA FL 33556
1401 930 314 920	0033447001		14540 STATE ROAD 54	ODESSA FL 33556
1401 930 315 600	0173133002		14651 GENEVA DR	ODESSA FL 33556
1401 930 316 330	0169088001		2101 ODESSA GARDENS LN	ODESSA FL 33556
1401 940 313 780	7400107001		14328 STATE ROAD 54	ODESSA FL 33556
1401 940 314 860	0086782001		14530 STATE ROAD 54	ODESSA FL 33556
1401 940 315 650	0217184001		PO BOX 91	ODESSA FL 33556
1401 950 328 940	0140474001		17286 RAINTREE RD	LUTZ FL 33558
1401 960 315 460	8192099001		14633 GENEVA DR	ODESSA FL 33556

EXHIBIT C

Withlacoochee River Electric Cooperative, Inc. Accounts to be transferred to Progress Energy

<u>Account Number</u>	<u>Member ID</u>	<u>Name</u>	<u>Service Address</u>	
1401 970 313 650	5792004079	5555 ULMERTON RD	CLEARWATER FL	33760
1401 970 315 240	0181659001	14621 GENEVA DR	ODESSA FL	33556
1401 970 316 910	0048243008	14944 STATE ROAD 54	ODESSA FL	33556
1401 990 316 350	0172103001	2121 ODESSA GARDENS LN	ODESSA FL	33556
1402 040 316 600	0169825001	C/O DIANE GARCIA	2130 ODESSA GARDENS LN	ODESSA FL 33556
1402 040 327 890	0182674001	2219 BROOKSIDE DR	LUTZ FL	33558
1402 080 315 480	0129861001	14634 STATE ROAD 54	ODESSA FL	33556
1402 110 316 440	0176719001	2131 ODESSA GARDENS LN	ODESSA FL	33556
1402 110 316 680	0174513001	PO BOX 826	ODESSA FL	33556
1402 120 315 740	0178656001	14640 STATE ROAD 54	ODESSA FL	33556
1402 130 315 570	0088978001	14636 STATE ROAD 54	ODESSA FL	33556
1402 140 315 610	8109200001	14638 STATE ROAD 54	ODESSA FL	33556
1402 160 315 920	0173984001	14746 STATE ROAD 54	ODESSA FL	33556
1402 170 315 780	0166957002	14712 ST RD 54	ODESSA FL	33556
1402 190 327 890	0029676001	2235 BROOKSIDE DR	LUTZ FL	33558
1402 190 328 450	0135049001	17119 NATURE TRL	LUTZ FL	33558
1402 190 347 090	8008100001	2260 SOFIA DR	LUTZ FL	33558
1402 200 329 490	0196562002	17304 RIVERSTONE DR	LUTZ FL	33558
1402 210 328 750	0254015001	2224 MEADOWBROOK DR	LUTZ FL	33558
1402 210 328 750	0246073001	2224 MEADOWBROOK DR	LUTZ FL	33558
1402 210 328 750	0221774001	APT 2008	11500 N DALE MABRY HWY	TAMPA FL 33618
1402 210 333 210	9483001056	0258200045332 PASCO WEL	P O BOX 278	DADE CITY FL 33526
1402 220 316 480	0169623001	2141 ODESSA GARDENS LN	ODESSA FL	33556
1402 230 328 950	7338060001	17282 RAINTREE RD	LUTZ FL	33558
1402 230 346 770	0093747003	2230 SOFIA DR	LUTZ FL	33558
1402 250 347 130	7994090001	C/O TEDDY MEADE	2260 SOFIA DR	LUTZ FL 33558
1402 260 347 260	7993005001	2280 SOFIA DR	LUTZ FL	33558
1402 270 329 200	0060772001	17285 RAINTREE RD	LUTZ FL	33558
1402 270 329 500	0196562001	17304 RIVERSTONE DR	LUTZ FL	33558
1402 270 329 670	0187316001	17310 RIVERSTONE DR	LUTZ FL	33558
1402 280 325 810	0235726001	4946 LAND O LAKES BLVD	LAND O LAKES FL	34639
1402 280 346 580	7462090001	2216 SOFIA DR	LUTZ FL	33558
1402 320 328 210	0008672001	2250 BROOKSIDE DR	LUTZ FL	33558
1402 320 333 290	9318060029	STE 211	2535 LANDMARK DR	CLEARWATER FL 33761
1402 340 328 460	0099317001	2245 MEADOWBROOK DR	LUTZ FL	33558
1402 350 327 880	0078398001	2251 BROOKSIDE DR	LUTZ FL	33558
1402 370 328 740	0147209001	2246 MEADOWBROOK DR	LUTZ FL	33558
1402 380 328 950	0256360001	TAMARA L KAPP	17278 RAINTREE RD	LUTZ FL 33558
1402 380 328 950	0193811003	17278 RAINTREE RD	LUTZ FL	33558
1402 380 328 950	7024050002	13436 LISA DR	HUDSON FL	34667
1402 390 329 340	0240082001	17300 RIVERSTONE DR	LUTZ FL	33558

EXHIBIT C

Withlacoochee River Electric Cooperative, Inc. Accounts to be transferred to Progress Energy

<u>Account Number</u>	<u>Member ID</u>	<u>Name</u>	<u>Service Address</u>	
1402 430 346 450	0152851001		2201 SOFIA DR	LUTZ FL 33558
1402 450 347 140	0227780001		2261 SOFIA DR	LUTZ FL 33558
1402 460 346 530	9268103001		2211 SOFIA DR	LUTZ FL 33558
1402 470 346 610	5892071001		2221 SOFIA DR	LUTZ FL 33558
1402 480 346 890	0120301003		2241 SOFIA DR	LUTZ FL 33558
1402 480 346 890	0155070001		4552 TAMPA DOWNS BLVD	LUTZ FL 33558
1402 480 346 890	0213316001		24739 GEORGE RD	LAND O LAKES FL 34639
1402 480 346 980	0203002001		2251 SOFIA DR	LUTZ FL 33558
1402 490 327 880	0009529002		2311 BROOKSIDE DR	LUTZ FL 33558
1402 490 346 720	0003378001		2231 SOFIA DR	LUTZ FL 33558
1402 510 347 280	7055025001		PO BOX 337	LAND O LAKES FL 34639
1402 540 328 460	2517061001		2313 MEADOWBROOK DR	LUTZ FL 33558
1402 540 346 570	9268103005		2215 SOFIA DR	LUTZ FL 33558
1402 570 329 240	0178343001		17245 RIVERSTONE DR	LUTZ FL 33558
1402 570 329 890	1109123001		17330 RIVERSTONE DR	LUTZ FL 33558
1402 580 329 570	0148785001		17315 RIVERSTONE DR	LUTZ FL 33558
1402 590 328 220	8998063001		2316 BROOKSIDE DR	LUTZ FL 33558
1402 620 327 880	0151029001		2323 BROOKSIDE DR	LUTZ FL 33558
1402 620 328 730	0128761001		2322 MEADOWBROOK DR	LUTZ FL 33558
1402 620 328 940	0834093001		PO BOX 270973	TAMPA FL 33688
1402 640 347 540	0078558003		2326 SOFIA DR	LUTZ FL 33558
1402 650 347 150	0113679001		2327 SOFIA DR	LUTZ FL 33558
1402 690 347 280	0166344001		11421 GROVEWOOD BLVD	LAND O LAKES FL 34638
1402 700 328 490	0231631001		2331 MEADOWBROOK DR	LUTZ FL 33558
1402 710 329 570	0080616001		SANDY COLLIFLOWER	LUTZ FL 33558
1402 720 329 890	0135004001		17340 RIVERSTONE DR	17335 RIVERSTONE DR LUTZ FL 33558
1402 730 329 230	0068695002		17269 RAINTREE RD	LUTZ FL 33558
1402 750 328 740	4950070001		2338 MEADOWBROOK DR	LUTZ FL 33558
1402 760 328 920	0213334001		17270 RAINTREE RD	LUTZ FL 33558
1402 770 347 200	0166344003		11421 GROVEWOOD BLVD	LAND O LAKES FL 34638
1402 820 347 320	0123867001		C/O MICHAEL FREY	2351 SOFIA DR LUTZ FL 33558
1402 850 327 840	0324076001		2347 BROOKSIDE DR	LUTZ FL 33558
1402 850 328 500	0202999001		2345 MEADOWBROOK DR	LUTZ FL 33558
1402 860 347 560	0078558002		2326 SOFIA DR	LUTZ FL 33558
1402 910 329 540	0059568001		17345 RIVERSTONE DR	LUTZ FL 33558
1402 920 329 260	0012575001		17265 RAINTREE RD	LUTZ FL 33558
1402 990 329 000	0163109001		17263 RAINBOW LN	LUTZ FL 33558
1403 010 327 950	8499085001		2405 BROOKSIDE DR	LUTZ FL 33558
1403 010 329 240	0219841001		17261 RAINTREE RD	LUTZ FL 33558
1403 040 329 460	3585011004		APT 307	7650 BAYSHORE DR LUTZ FL 33706
1403 050 328 760	0007470001		2406 MEADOWBROOK DR	LUTZ FL 33558

EXHIBIT C

Withlacoochee River Electric Cooperative, Inc. Accounts to be transferred to Progress Energy

<u>Account Number</u>	<u>Member ID</u>	<u>Name</u>	<u>Service Address</u>	
1403 050 329 880	7728055003		PO BOX 915	LUTZ FL 33548
1403 050 346 730	0240738002		1419 W WATERS AVE # 116	TAMPA FL 33604
1403 060 328 180	0164367001		2404 BROOKSIDE DR	LUTZ FL 33558
1403 100 346 880	6063022001		20744 STATE ROAD 54	LUTZ FL 33558
1403 150 327 830	5459171001		17004 STATE ROAD 54	LUTZ FL 33558
1403 200 347 240	1650085002		14806 N 15TH ST	LUTZ FL 33549
1403 200 347 240	0245720001		20826 STATE ROAD 54	LUTZ FL 33558
1403 200 347 240	0123032001		3766 E LAKE DR	LAND O LAKES FL 34639
1403 220 328 080	0053567001		17026 STATE ROAD 54	LUTZ FL 33558
1403 250 329 880	4598053002		17360 RIVERSTONE DR	LUTZ FL 33549
1403 270 328 730	0227324001		2428 MEADOWBROOK DR	LUTZ FL 33558
1403 270 329 240	5209067001		17260 RAINTREE RD	LUTZ FL 33558
1403 290 329 590	0156736001		17365 RIVERSTONE DR	LUTZ FL 33558
1403 290 329 970	4598053001		17360 RIVERSTONE DR	LUTZ FL 33558
1403 310 328 260	3179050001		17048 STATE ROAD 54	LUTZ FL 33558
1403 820 331 900	0212363169		30432 STATE ROAD 54	WESLEY CHAPEL FL 33543
1404 250 343 390	0120501001		519 ROANOKE ST	DUNEDIN FL 34698
1404 370 343 380	0134617001		19250 GOPHERTRAIL PL	LAND O LAKES FL 34638
1404 390 343 220	0116090001		2635 HAILEY LN	LAND O LAKES FL 34638
1404 480 343 220	0144229001		13112 SADDLEBROOK CIR	FAIRHOPE AL 36532
1404 490 343 380	0226391001		2640 HAILEY LN	LAND O LAKES FL 34638
1404 540 343 220	1768500001		C/O DARRYL W DAVIS	2653 HAILEY LN LAND O LAKES FL 34638
1404 580 343 400	7992028001		2652 HAILEY LN	LAND O LAKES FL 34638
1404 670 343 190	5607058001		2711 HAILEY LN	LAND O LAKES FL 34638
1404 690 343 390	8070081001		2710 HAILEY LN	LAND O LAKES FL 34638
1404 740 343 190	0152264001		2721 HAILEY LN	LAND O LAKES FL 34638
1404 780 343 360	5673055001		2720 HAILEY LN	LAND O LAKES FL 34638
1406 100 343 430	9457001001		730 N LECANTO HWY	LECANTO FL 34461
1421 110 274 570	0096973001		5703 CALLA DR	NEW PORT RICHEY FL 34653
1421 150 274 720	4576115001		5708 CALLA DR	NEW PORT RICHEY FL 34653
1421 150 274 800	0209116001		6949 COLEUS CT	NEW PORT RICHEY FL 34653
1421 160 274 470	0230548001		5708 BAKER RD	NEW PORT RICHEY FL 34653
1421 220 274 480	0214864001		5714 BAKER RD	NEW PORT RICHEY FL 34653
1421 240 274 750	3587074003		5714 CALLA DR	NEW PORT RICHEY FL 34653
1421 250 274 330	0054054001		6901 CARPEL DR	NEW PORT RICHEY FL 34653
1421 250 274 610	0026522001		5723 CALLA DR	NEW PORT RICHEY FL 34653
1421 270 274 200	9417055001		6841 CARPEL DR	NEW PORT RICHEY FL 34653
1421 280 273 770	0113057001		5019 MAGPIE DR	NEW PORT RICHEY FL 34652
1421 280 273 870	0143149001		6805 CARPEL DR	NEW PORT RICHEY FL 34653
1421 280 273 970	0111106001		6813 CARPEL DR	NEW PORT RICHEY FL 34653
1421 280 274 080	0042743003		6829 CARPEL DR	NEW PORT RICHEY FL 34653

EXHIBIT C

Withlacoochee River Electric Cooperative, Inc. Accounts to be transferred to Progress Energy

<u>Account Number</u>	<u>Member ID</u>	<u>Name</u>	<u>Service Address</u>	
1421 280 274 370	0079326001		5721 BAKER RD	NEW PORT RICHEY FL 34653
1421 280 274 510	2931084001		5722 BAKER RD	NEW PORT RICHEY FL 34653
1421 350 274 690	0110895001		5724 CALLA DR	NEW PORT RICHEY FL 34653
1421 370 274 630	0204749001		5730 CALLA DR	NEW PORT RICHEY FL 34653
1421 400 274 540	0136743001		5734 BAKER RD	NEW PORT RICHEY FL 34653
1421 420 274 400	3069005001		6908 CAROB DR	NEW PORT RICHEY FL 34653
1421 430 273 630	0257245001		6733 CAROB DR	NEW PORT RICHEY FL 34653
1421 430 273 630	0227837001		6733 CAROB DR	NEW PORT RICHEY FL 34653
1421 440 274 290	3369009002		6852 CAROB DR	NEW PORT RICHEY FL 34653
1421 450 273 970	7696067003		6818 CAROB DR	NEW PORT RICHEY FL 34653
1421 450 274 070	0150974001		6828 CAROB DR	NEW PORT RICHEY FL 34653
1421 450 274 160	0008116001		6836 CAROB DR	NEW PORT RICHEY FL 34653
1421 460 273 780	7536126001		6752 CAROB DR	NEW PORT RICHEY FL 34653
1421 460 273 870	0059454003		C/O JOANNE FITAPELLI	6808 CAROB DR NEW PORT RICHEY FL 34653
1421 460 274 200	0165668001		6846 CAROB DR	NEW PORT RICHEY FL 34653
1421 460 274 560	1146061001		MERRILL GARDENS	414 CHAPMAN RD E # 1103 LUTZ FL 33549
1421 460 274 560	0242411001		20128 COUNTY LINE RD	LUTZ FL 33558
1421 460 274 560	0249114001		5740 BAKER RD	NEW PORT RICHEY FL 34653
1421 520 274 600	0230364001		5748 BAKER RD	NEW PORT RICHEY FL 34653
1421 550 273 630	0063391001		6741 CAROB DR	NEW PORT RICHEY FL 34653
1421 580 274 610	0100907001		5754 BAKER RD	NEW PORT RICHEY FL 34653
1421 610 273 840	1684052001		6749 CAROB DR	NEW PORT RICHEY FL 34653
1421 620 273 910	6917100001		6801 CAROB DR	NEW PORT RICHEY FL 34653
1421 620 273 980	0185602001		6807 CAROB DR	NEW PORT RICHEY FL 34653
1421 620 274 020	0191200001		6811 CAROB DR	NEW PORT RICHEY FL 34653
1421 620 274 070	6022005001		6817 CAROB DR	NEW PORT RICHEY FL 34653
1421 620 274 140	0082163001		6823 CAROB DR	NEW PORT RICHEY FL 34653
1421 620 274 210	0229077001		320 CRYSTAL BEACH AVE	PO BOX 121 CRYSTAL BEACH FL 34681
1421 620 274 270	0147551001		6837 CAROB DR	NEW PORT RICHEY FL 34653
1421 620 274 320	0230452002		7351 CANDLELIGHT CT	NEW PORT RICHEY FL 34652
1421 620 274 320	0232325001		3742 BEECHWOOD DR	HOLIDAY FL 34691
1421 620 274 380	3052040001		6901 CAROB DR	NEW PORT RICHEY FL 34653
1421 620 274 450	7929065001		6911 CAROB DR	NEW PORT RICHEY FL 34653
1421 630 273 750	0247519002		6745 CAROB DR	NEW PORT RICHEY FL 34653
1421 630 274 650	9199054001		5804 BAKER RD	NEW PORT RICHEY FL 34653
1421 690 274 510	0118482002		5805 BAKER RD	NEW PORT RICHEY FL 34653
1421 690 274 680	0069850001		5810 BAKER RD	NEW PORT RICHEY FL 34653
1421 740 274 710	0211097001		5818 BAKER RD	NEW PORT RICHEY FL 34653
1421 750 274 530	0116677001		5811 BAKER RD	NEW PORT RICHEY FL 34653
1421 790 274 740	0030714001		5824 BAKER RD	NEW PORT RICHEY FL 34653
1421 800 274 570	0047695001		4977 MARLIN DR	NEW PORT RICHEY FL 34652

EXHIBIT C

Withlacoochee River Electric Cooperative, Inc. Accounts to be transferred to Progress Energy

<u>Account Number</u>	<u>Member ID</u>	<u>Name</u>	<u>Service Address</u>	
1421 880 274 510	0139672001	[REDACTED]	5837 CHICORY CT	NEW PORT RICHEY FL 34653
1421 930 274 620	1264002001	[REDACTED]	5833 BAKER RD	NEW PORT RICHEY FL 34653
1421 950 274 500	0104129001	[REDACTED]	5843 CHICORY CT	NEW PORT RICHEY FL 34653
1422 000 274 620	0232059001	[REDACTED]	5838 CHICORY CT	NEW PORT RICHEY FL 34653
1422 020 274 500	0141673001	[REDACTED]	5849 CHICORY CT	NEW PORT RICHEY FL 34653
1422 030 274 710	0227501001	[REDACTED]	5845 BAKER RD	NEW PORT RICHEY FL 34653
1422 070 274 620	0071977002	[REDACTED]	5846 CHICORY CT	NEW PORT RICHEY FL 34653
1422 080 274 490	0065024001	[REDACTED]	5855 CHICORY CT	NEW PORT RICHEY FL 34653
1422 140 274 490	0135434001	[REDACTED]	5861 CHICORY CT	NEW PORT RICHEY FL 34653
1422 190 274 770	0244055001	[REDACTED]	5857 BAKER RD	NEW PORT RICHEY FL 34653
1422 190 274 770	2939066001	[REDACTED]	6537 CABBAGE LN	NEW PORT RICHEY FL 34653
1422 200 274 500	0146819002	[REDACTED]	5903 CHICORY CT	NEW PORT RICHEY FL 34653
1422 260 274 500	0173605001	[REDACTED]	5909 CHICORY CT	NEW PORT RICHEY FL 34653
1422 260 274 620	3080064001	[REDACTED]	5908 CHICORY CT	NEW PORT RICHEY FL 34653
1422 280 274 730	0218614001	[REDACTED]	5911 BAKER RD	NEW PORT RICHEY FL 34653
1422 320 274 620	1596102001	[REDACTED]	5916 CHICORY CT	NEW PORT RICHEY FL 34653
1422 330 274 500	0179709001	[REDACTED]	5917 CHICORY CT	NEW PORT RICHEY FL 34653
1422 340 274 760	0222162001	[REDACTED]	5917 BAKER RD	NEW PORT RICHEY FL 34653
1422 370 274 760	0206065009	[REDACTED]	PO BOX 1870	NEW PORT RICHEY FL 34656
1422 390 274 620	0014160001	[REDACTED]	5926 CHICORY CT	NEW PORT RICHEY FL 34653
1422 450 274 760	0240126001	[REDACTED]	5929 BAKER RD	NEW PORT RICHEY FL 34653
1422 490 274 760	0228406001	[REDACTED]	C/O LINDA SAKADALES	711 SPRING LAKE BLVD NW PORT CHARLOTTE FL 33952
1422 500 274 500	0228034002	[REDACTED]	5117 BOYSTER COVE	NEW PORT RICHEY FL 34652
1422 500 274 500	0247139001	[REDACTED]	5935 CHICORY CT	NEW PORT RICHEY FL 34653
1422 500 274 620	0177572001	[REDACTED]	5934 CHICORY CT	NEW PORT RICHEY FL 34653
1422 500 274 760	0235960001	[REDACTED]	5935 BAKER RD	NEW PORT RICHEY FL 34653
1422 570 274 500	0091544001	[REDACTED]	5943 CHICORY CT	NEW PORT RICHEY FL 34653
1422 570 274 620	0126508001	[REDACTED]	3607 S DOUGLAS RD	COCONUT GROVE FL 33133
1422 610 274 770	0248870001	[REDACTED]	5947 BAKER RD	NEW PORT RICHEY FL 34653
1422 610 274 770	0228473001	[REDACTED]	ROBERT LANZI	PO BOX 724 NEW PORT RICHEY FL 34656
1422 630 274 620	0076678001	[REDACTED]	5948 CHICORY CT	NEW PORT RICHEY FL 34653
1422 640 274 500	0166303001	[REDACTED]	5949 CHICORY CT	NEW PORT RICHEY FL 34653

EXHIBIT D

**Sample Notification Letters
to Affected Customers**



2501 25th St. North
MAC SP14
St. Petersburg, FL 33713

April 29, 2005

Name
Address
Town, FL zip code



Dear _____

To ensure that electric utilities in Florida, such as Progress Energy Florida (PEF), are able to provide reliable and economical electric service to their customers, utilities enter into agreements with one another establishing the geographical areas in which each utility is the exclusive provider of electric service. Utilities enter into these territorial agreements in an effort to avoid the unnecessary and uneconomic construction of duplicate electrical distribution lines and other facilities to serve their customers. Approval of the Florida Public Service Commission (FPSC) is required to ensure these objectives are met.

Over the past many years, we at PEF (formerly known as Florida Power) have had the pleasure of serving customers in your area because of a territorial agreement approved by the FPSC in 1988 between our company and our neighboring utility, Withlacoochee River Electric Cooperative, Inc. (WREC). Because of the 1988 agreement's expiration, we will soon enter into a new territorial agreement with WREC that will revise some of the service area boundaries between the utilities and enable each utility to serve its customers more reliably and economically. The new agreement must be approved by the FPSC before it can become effective and you will have the opportunity prior to that approval to provide your comments to the Commission. If you wish, we will provide the pertinent contact information for the FPSC when the territorial agreement has been filed and docketed.

If approved by the FPSC, the terms of the new territorial agreement call on Withlacoochee River Electric Cooperative, Inc. to provide electric service in your area. Your account would be transferred to WREC at some point in the upcoming months. While we regret losing the opportunity to serve you and your neighbors in the future, WREC is an excellent utility and I am confident you will find their service to be satisfactory.

You will not need to do anything to initiate this transfer since PEF and WREC will handle all of the arrangements on your behalf. If you have a deposit with Progress Energy, your deposit will be refunded directly to you. You should not experience any disruption of service as a result of this transfer and you will be notified in the unlikely event that a minimal interruption of service is required.

To provide you a rate comparison, in February, 2005 the residential rate of PEF for 1,000 Kilowatt-Hours (KWH) was \$92.07. For the same month, the residential rate of

WREC for 1,000 KWH was \$90.99. The rates of both utilities are subject to periodic change and may be raised or lowered in the future.

Please let us know if you have any questions or concerns about the proposed transfer of your service to Withlacoochee River Electric Cooperative, Inc., or if you would like information about contacting the FPSC. You can reach us by phone at 1-800-510-0140 or at the address shown above.

Sincerely,

Melissa Seixas
Customer Service Manager
Progress Energy Florida

cc: Mr. Billy Brown
Withlacoochee River Electric Cooperative, Inc.

March 9, 2005



WITHLACOOCHEE
RIVER
ELECTRIC
COOPERATIVE, INC.

«Name»
«Address1»
«Address2»
«Address3»

«Zip»

Account No. «Account_No» Member I.D. «MemberID»

Dear «Name»

We are writing to inform you that Withlacoochee River Electric Cooperative, Inc., and Progress Energy Florida have recently agreed to revise some of the service area boundaries that were established several years ago. Geographical boundaries like these are common among most of Florida's electric utilities and are approved by the Public Service Commission to avoid unnecessary and uneconomic construction of duplicate electrical facilities. Safety concerns also arise when high voltage lines owned and maintained by different companies are in close proximity to one another.

This change will directly affect your account. Upon receiving the approval of the Florida Public Service Commission, work will begin to transfer your service to Progress Energy. It has been our pleasure to provide service to your area for many years and we will do everything we can to make this transition simple and worry free for you. We do not anticipate that this transfer will result in any major disruptions. You will have the opportunity to comment on this change directly to the PSC, and we will provide any pertinent contact information for you once the agreement has been filed and docketed in Tallahassee.

Any deposit that WREC is holding for this account will first be applied to any outstanding balance, and the remainder refunded to you. The same is true for the five dollar (\$5.00) membership fee except where there is another active WREC account. In that case, the membership fee will be transferred to an active account. Capital Credits associated with your membership will continue to be paid to you according to the standing bylaws of the Cooperative.

There is nothing that you will need to do to initiate this change. However, if you have questions or concerns, we have established a single contact for your convenience. You may call us at 727-868-9465 extension 6202 or contact us via e-mail at servicetransfer@wrec.net. You may also visit our web-site at wrec.net for more detailed information relating to the current territorial issues before the Commission.

Again, it has been our pleasure to have you as a member/owner of our Cooperative and we hope that we have provided a reliable and economic source of power.

Sincerely,

A handwritten signature in cursive script that reads "Billy E. Brown".

Billy E. Brown
Executive Vice President and General Manager

P.O. Box 278, Dade City, FL 33526-0278

Phone (352) 567-5133 / Fax (352) 521-5971

Your Touchstone Energy® Partner

