

ORIGINAL

050820-WS

10-27-05

OCT 31 2005

WE DO NOT KNOW WHO YOU ARE OR WHAT YOUR NAME.

WHAT ARE YOU GOING TO DO IN THE BLACK LINES? ALSO WHAT DO THE BLACK LINES MEAN?

ARE YOU GOING TO RUIN WATER AND WASTE WATER LINES THROUGH THE SUBDIVISION? IF SO WILL THERE BE ANY CHARGES?

ANY INFORMATION WILL BE HELPFUL IN MAKING OUR DECISION.

RECEIVED FPSC

05 NOV -2 AM 10:38

COMMISSION CLERK

- CMP _____
- COM _____
- CTR _____
- DR _____
- GCL _____
- OPC _____
- RCA _____
- SCR _____
- SGA _____
- SEC _____
- OTH KMP

THANK YOU
MELVIN + NANCY
JOHNS

412 PINNACLE DR
OMER, MI. 48249

29197 EDGEWOOD



DOCUMENT NUMBER DATE

10845 NOV 10 05

COMMISSION CLERK

WILSON TOWN
412 FOUNTAIN BLVD
WILSON, N.C. 27894



Florida Public Service Commission
3540 Shumard Oak Blvd.

TALITHA HUSSE, Floridian
3540 Shumard Oak Blvd.



Territory to be added

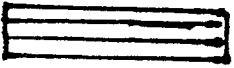

Existing Territory

Lake Jim Long

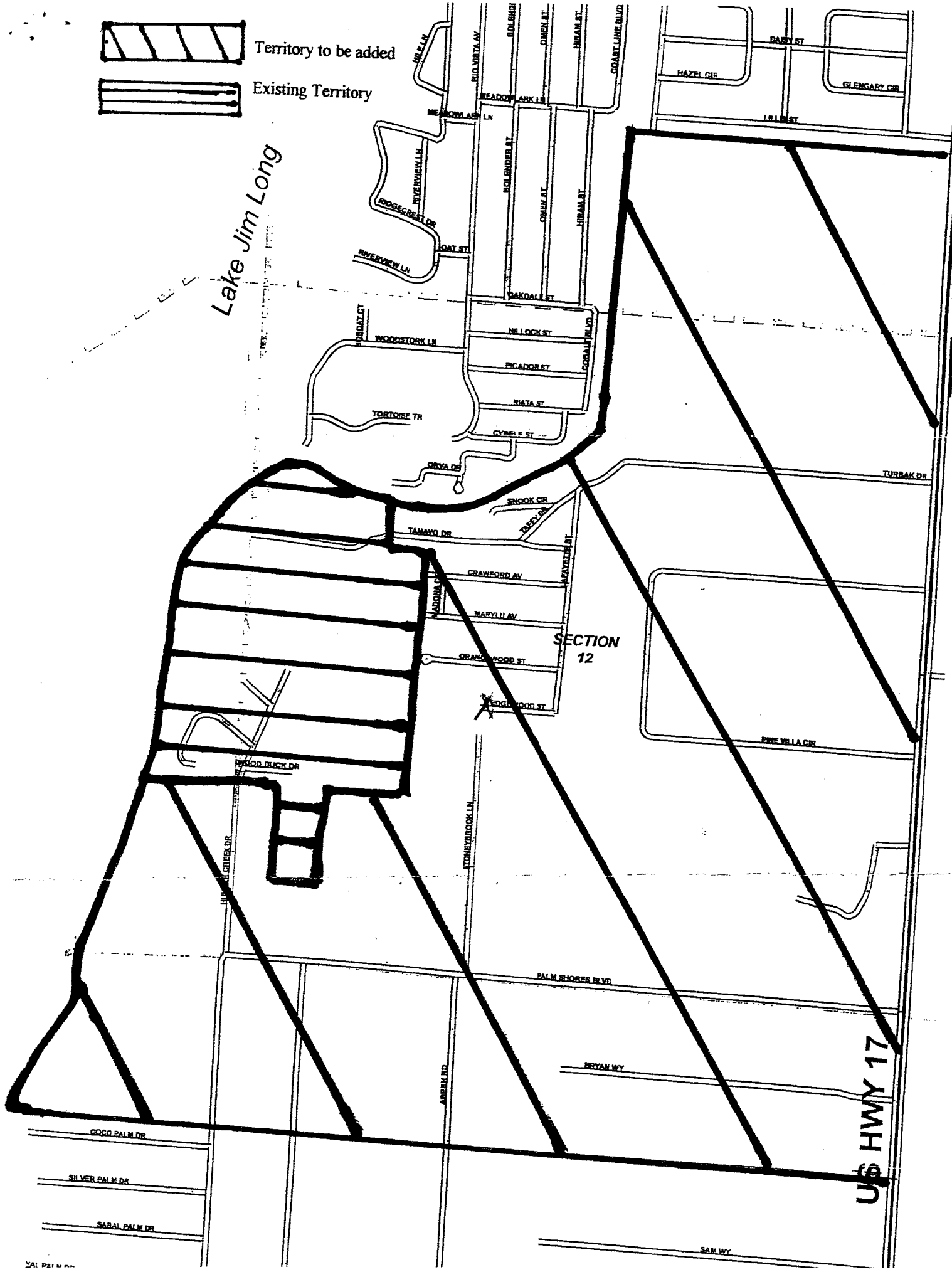

SECTION 12

US HWY 17

GOLD PALM DR
SILVER PALM DR
SABAL PALM DR