

ORIGINAL

050820-WS

RECEIVED-PPSC

05 NOV -2 AM 10: 38

LEGAL NOTICE

COMMISSION
CLERK

Notice is hereby given on October 18, 2005, pursuant to Section 367.045, Florida Statutes, of the application of MSM Utilitites, LLC to amend its Water Certificate No.611-W and Wastewater Certificate No. 527-S to add territory in Charlotte County, Florida as described in Exhibit A attached hereto and made a part hereof.

Any objection to the said application must be made in writing and filed with the Director, Division of the Commission Clerk & Administrative Services, Florida Public Service Commission, 2540 Shumard Oak Boulevard, Tallahassee, Florida 32399-0850, within thirty (30) days from the date of this notice. At the same time, a copy of said objection should be mailed to the applicant whose address is set forth below. The objection must state the grounds for the objection with particularity.

MSM Utilities, LLC
9696 Bonita Beach Road
Suite 210
Bonita Springs, FL 34135

CMP _____
COM _____
CTR _____
ECR 1
GCL 1
OPC _____
RCA _____
SCR _____
SGA _____
SEC 1
OTH Kum P.

DOCUMENT NUMBER: DATE

10855 NOV 10 05

PPSC-COMMISSION CLERK

10-29-05

R.E.: Water Cert: 611.00
Wastewater: 527.5
Charlotte County

I can't afford this, I don't
want this! We are still
recovering from Charley &
most of us can't pay for this.
I refuse to have city
water & sewer on my
property

Sandra L. Breslin



Sandra Breslin
29469 Turbak Dr.
Punta Gorda, FL 33982

OCT 1 2005

EXHIBIT A

Territory to be added:

THE SOUTH $\frac{1}{4}$ OF SECTION 12, TOWNSHIP 40 SOUTH, RANGE 23 EAST, CHARLOTTE COUNTY, FLORIDA, LYING SOUTHERLY OF BRANCH CREEK (TIDAL)

TOGETHER WITH

THE NORTH $\frac{1}{4}$ OF SECTION 12, TOWNSHIP 40 SOUTH, RANGE 23 EAST, CHARLOTTE COUNTY, FLORIDA, LYING EAST OF THE SEABOARD COASTLINE RAILROAD

TOGETHER WITH

THE SOUTH $\frac{1}{4}$ SECTION 12, TOWNSHIP 40 SOUTH, RANGE 23 EAST, CHARLOTTE COUNTY, FLORIDA, LYING WEST OF THE SEABOARD COASTLINE RAILROAD AND SOUTH OF BRANCH CREEK (TIDAL)

LESS AND EXCEPT

THE EXISTING SERVICE TERRITORY FOR THE OAKS AT RIVER EDGE (FORMERLY: HUNTERS CREEK VILLAGE) BEING DESCRIBED AS FOLLOWS:

TOWNSHIP 40 SOUTH, RANGE 23 EAST, SECTION 12

THE NE $\frac{1}{4}$ OF THE NW $\frac{1}{4}$ OF THE SW $\frac{1}{4}$ OF THE SW $\frac{1}{4}$ OF SECTION 12, TOWNSHIP 40 SOUTH, RANGE 23 EAST, CHARLOTTE COUNTY, FLORIDA

AND

THE SE $\frac{1}{4}$ OF THE NW $\frac{1}{4}$ OF THE SW $\frac{1}{4}$ OF THE SW $\frac{1}{4}$ OF SECTION 12, TOWNSHIP 40 SOUTH, RANGE 23 EAST CHARLOTTE COUNTY, FLORIDA

AND

THE NW $\frac{1}{4}$ OF THE SW $\frac{1}{4}$ OF SECTION 12, TOWNSHIP 40 SOUTH, RANGE 23 EAST CHARLOTTE COUNTY, FLORIDA

AND

THAT PORTION OF GOVERNMENT LOT 2, SECTION 12, TOWNSHIP 40 SOUTH, RANGE 23 EAST, CHARLOTTE COUNTY, FLORIDA, LYING SOUTH OF LEE BRANCH CREEK

AND

THE WESTERLY 30 FEET OF THE SW $\frac{1}{4}$ OF THE SW $\frac{1}{4}$ OF SECTION 12, TOWNSHIP 40 SOUTH, RANGE 23 EAST, CHARLOTTE COUNTY, FLORIDA

TOWNSHIP 40 SOUTH, RANGE 23 EAST SECTION 11

ALL OF GOVERNMENT LOT 5, LYING SOUTH OF LEE BRANCH CREEK IN SECTION 11, TOWNSHIP 40 SOUTH, RANGE 23, EAST CHARLOTTE COUNTY, FLORIDA

AND

THE NE $\frac{1}{4}$ OF THE SE $\frac{1}{4}$ OF SECTION 11, TOWNSHIP 40 SOUTH, RANGE 23 EAST, CHARLOTTE COUNTY, FLORIDA, LYING EAST OF HUNTERS CREEK

TOGETHER WITH

THE SOUTH $\frac{1}{4}$ OF SECTION 1, TOWNSHIP 40 SOUTH, RANGE 23 EAST, CHARLOTTE COUNTY, FLORIDA, LYING EAST OF SEABOARD COASTLINE RAILROAD

THE SOUTH $\frac{1}{4}$ OF SECTION 11, TOWNSHIP 40 SOUTH, RANGE 23 EAST, CHARLOTTE COUNTY, FLORIDA, LYING EAST OF HUNTERS CREEK

THE NORTH $\frac{1}{4}$ OF SECTION 14, TOWNSHIP 40 SOUTH, RANGE 23 EAST, CHARLOTTE COUNTY, FLORIDA, LYING EAST OF HUNTERS CREEK

THE NORTH $\frac{1}{4}$ OF SECTION 13, TOWNSHIP 40 SOUTH, RANGE 23 EAST, CHARLOTTE COUNTY, FLORIDA



Territory to be added

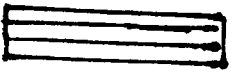

Existing Territory

Lake Jim Long

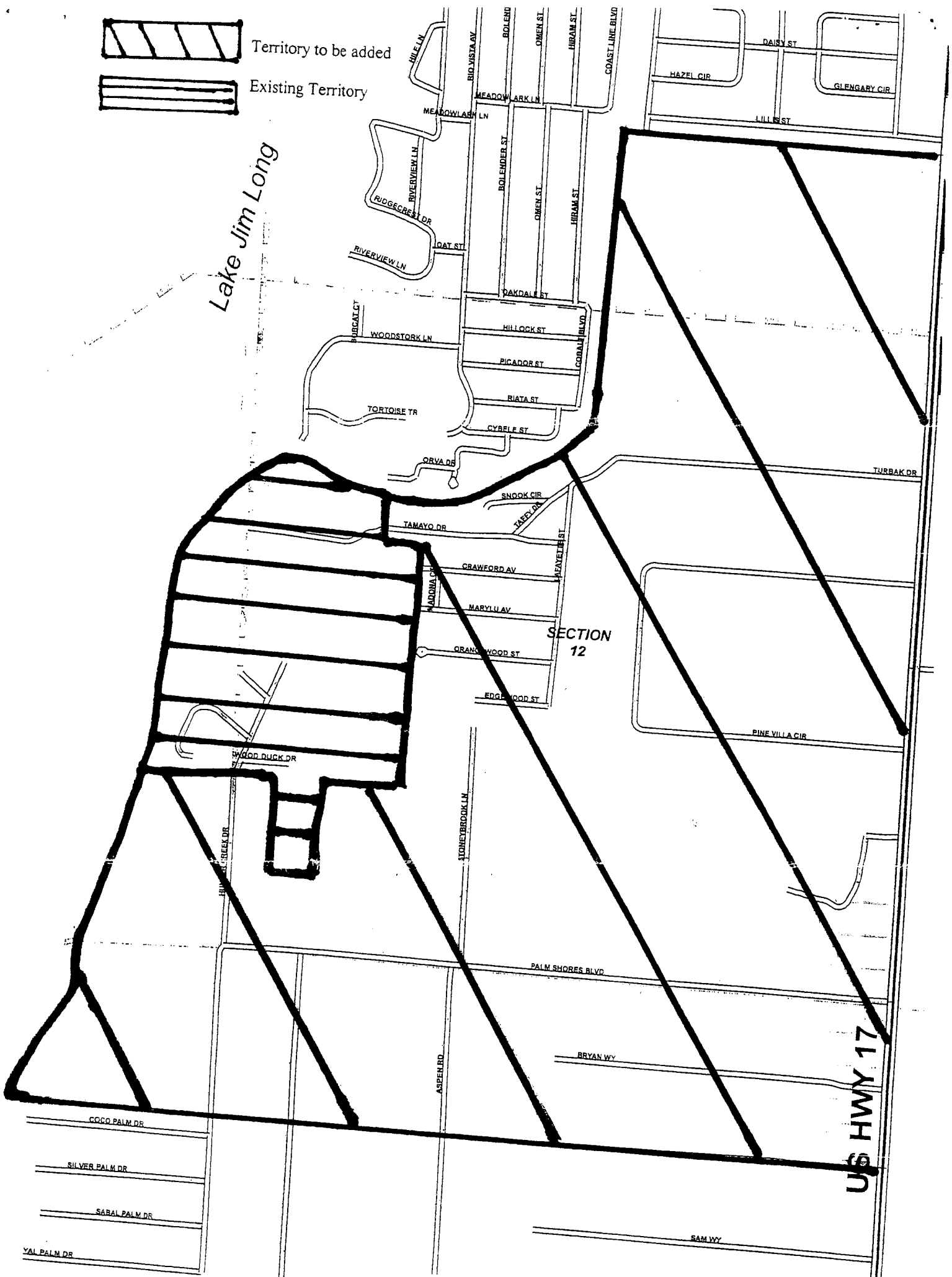

SECTION 12

US HWY 17

- COCO PALM DR
- SILVER PALM DR
- SABAL PALM DR
- YAL PALM DR