

State of Florida



ORIGINAL

Public Service Commission

CAPITAL CIRCLE OFFICE CENTER • 2540 SHUMARD OAK BOULEVARD  
TALLAHASSEE, FLORIDA 32399-0850

-M-E-M-O-R-A-N-D-U-M-

---

**DATE:** December 30, 2005

**TO:** Kay B. Flynn, Chief of Records, Division of the Commission Clerk & Administrative Services

**FROM:** Stanley D. Rieger, Utilities System/Engineering Specialist, Division of Economic Regulation *SDR*

**RE:** 050820-WS - Application for amendment of Certificates 611-W and 527-S to extend water and wastewater service areas to include territory in Charlotte County by MSM Utilities, LLC.

---

Please include the attached December 1, 2005, Department of Community Affairs letter in the docket file of Docket No. 050820-WS. Thank you.

RECEIVED-FPSC  
05 DEC 30 PM 3:21  
COMMISSION  
CLERK

- CMP \_\_\_\_\_
- COM \_\_\_\_\_
- CTR \_\_\_\_\_
- ECR \_\_\_\_\_
- GCL \_\_\_\_\_
- OPC \_\_\_\_\_
- RCA \_\_\_\_\_
- SCR \_\_\_\_\_
- SGA \_\_\_\_\_
- SEC   1
- OTH \_\_\_\_\_

DOCUMENT NUMBER-DATE

11981 DEC 30 05

FPSC-COMMISSION CLERK



STATE OF FLORIDA  
DEPARTMENT OF COMMUNITY AFFAIRS

*"Dedicated to making Florida a better place to call home"*

JEB BUSH  
Governor

THADDEUS L. COHEN, AIA  
Secretary

December 1, 2005

05 DEC -5 AM 11:08  
REGISTRATION

Ms. Patti Daniel  
Division of Commission Clerk and Administration Services  
2540 Shumard Oak Boulevard  
Tallahassee, Florida 32399-0850

RE: Docket No. 050820-WS  
Application for Amendment of Certificate No. 611-W and 527-S to extend  
wastewater service area in Charlotte County  
Applicant: MSM Utilities, Inc.

Dear Ms. Daniel:

The Department has reviewed the application by MSM Utilities, Inc to extend  
wastewater service for consistency with the Charlotte County Comprehensive Plan. The  
Department finds that the development is consistent with the Plan.

The proposed development is in an area of the Peace River Shores subdivision  
bordered on the west by the Peace River, on the north by St. Lilac Street, on the east by US  
Hwy 17 and to the south by Coco Palm Drive. The Charlotte County Future Land Use Map  
classification for the area is Low Density Residential. The Low Density Residential land use  
designation allows up to five dwelling units per acre. The extension of the central wastewater  
utility will allow property owners to develop parcels to their maximum entitlement and  
minimize the impact of development on the Peace River. A portion of the southwestern area  
to be serviced by the utility company is in the Category I Hurricane Evacuation Zone and  
none of the area is in a flood plain. (See map attachments)

2555 SHUMARD OAK BOULEVARD • TALLAHASSEE, FLORIDA 32399-2100  
Phone: 850.488.8466/Suncom 278.8466 FAX: 850.921.0781/Suncom 291.0781  
Internet address: <http://www.dca.state.fl.us>

CRITICAL STATE CONCERN FIELD OFFICE  
2796 Overseas Highway, Suite 212  
Marathon, FL 33050-2227  
(305) 289-2402

COMMUNITY PLANNING  
2555 Shumard Oak Boulevard  
Tallahassee, FL 32399-2100  
(850) 488-2356

EMERGENCY MANAGEMENT  
2555 Shumard Oak Boulevard  
Tallahassee, FL 32399-2100  
(850) 413-9969

HOUSING & COMMUNITY DEVELOPMENT  
2555 Shumard Oak Boulevard  
Tallahassee, FL 32399-2100  
(850) 488-7956

Ms. Patti Daniel  
December 1, 2005  
Page 2 of 2

Thank you for this opportunity to comment on this project. If you have any questions, please contact Tom Tumminia, Community Planner, in the Division of Community Planning, at 850-922-1824.

Sincerely yours,

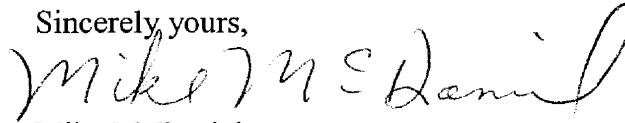
A handwritten signature in black ink that reads "Mike McDaniel". The signature is written in a cursive style with a large, looping "M" and "D".

Mike McDaniel  
Growth Management Administrator

MMD/tjt

cc: Mr. Michael Konefal, Director of Community Development, Charlotte County  
Mr. David Crawford, SWFRPC, Local Plan Assistance  
MSM Utility, Inc, Applicant

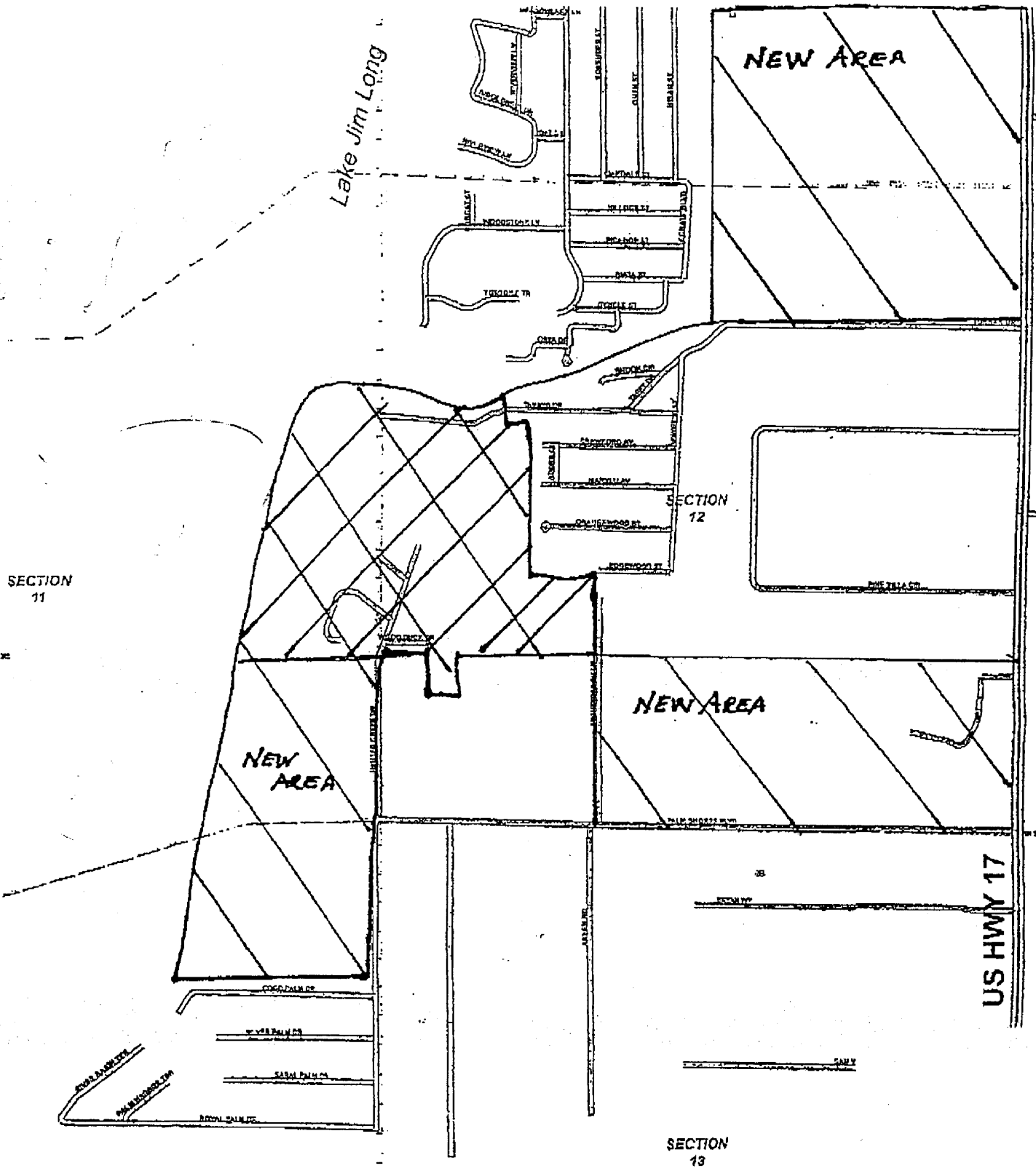

No longer in the proposed territory:  
 Peace River Subdivision  
 Southside of Turbak Drive  
 Pine Villa Subdivision  
 Palm Shores between Stoneybrook and Hunter Creek Drive  
 Property south of Palm Shores west of US 17

# Charlotte County GIS Map

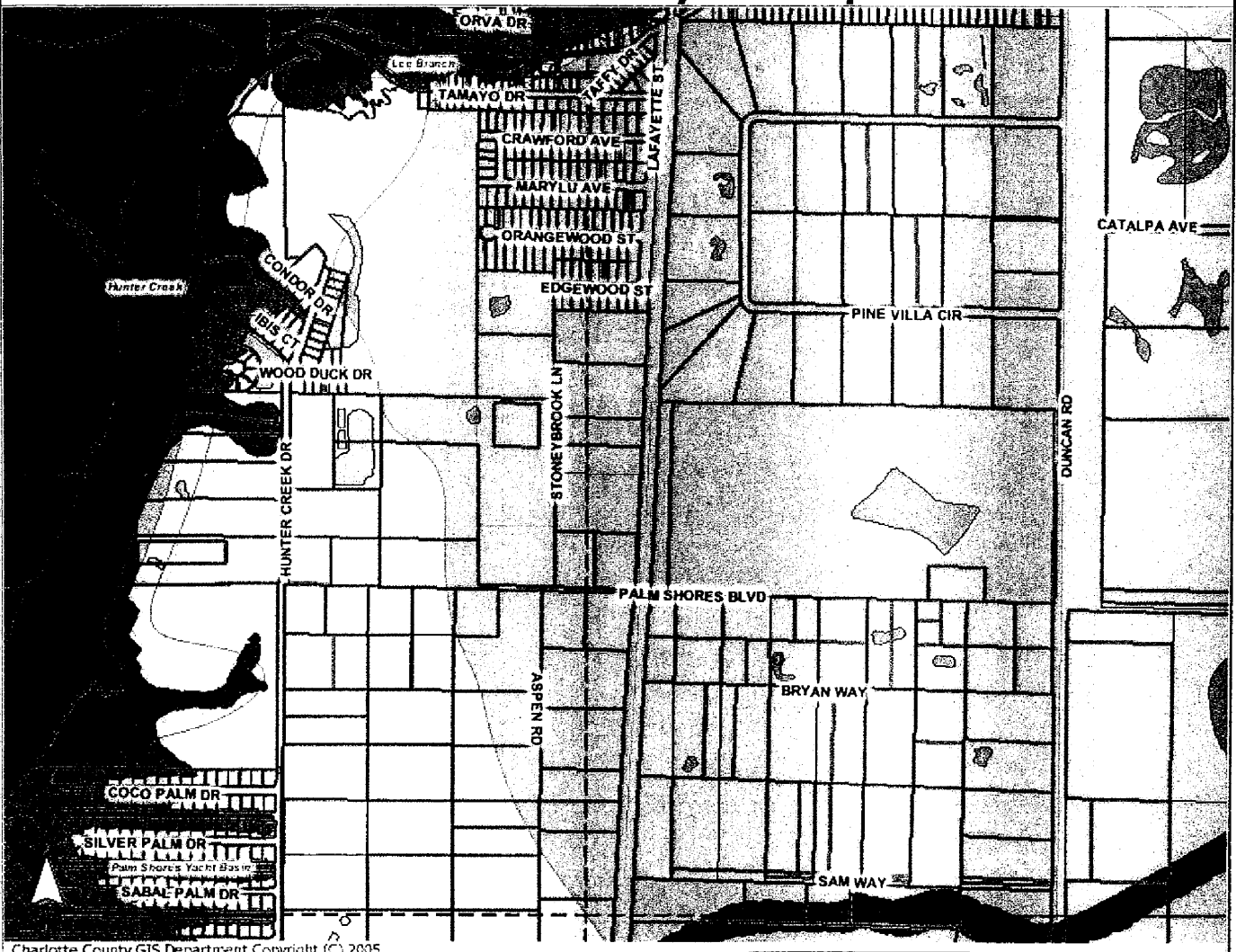

Charlotte County GIS Department Copyright (C) 2005

0 1500ft



Copyright 2005  
 Charlotte County GIS  
 18500 Murdock Circle  
 Port Charlotte, FL 33948

Legend

[Symbol]	Lot
[Symbol]	Accounts
[Symbol]	Water
[Symbol]	SWFWMD Flood Zones Effective 5/3/2007
[Symbol]	4
[Symbol]	4C 2000
[Symbol]	4C 400
[Symbol]	5
[Symbol]	6
[Symbol]	Storm Surge
[Symbol]	1 Zone
[Symbol]	2 Zone 1
[Symbol]	3 Zone 2
[Symbol]	4 Zone 3
[Symbol]	5 Zone 4
[Symbol]	6 Zone
[Symbol]	Future Land Use
[Symbol]	Agriculture
[Symbol]	Conservation Area
[Symbol]	City
[Symbol]	County
[Symbol]	County 1
[Symbol]	County 2
[Symbol]	County 3
[Symbol]	County 4
[Symbol]	County 5
[Symbol]	County 6
[Symbol]	County 7
[Symbol]	County 8
[Symbol]	County 9
[Symbol]	County 10
[Symbol]	County 11
[Symbol]	County 12
[Symbol]	County 13
[Symbol]	County 14
[Symbol]	County 15
[Symbol]	County 16
[Symbol]	County 17
[Symbol]	County 18
[Symbol]	County 19
[Symbol]	County 20
[Symbol]	County 21
[Symbol]	County 22
[Symbol]	County 23
[Symbol]	County 24
[Symbol]	County 25
[Symbol]	County 26
[Symbol]	County 27
[Symbol]	County 28
[Symbol]	County 29
[Symbol]	County 30
[Symbol]	County 31
[Symbol]	County 32
[Symbol]	County 33
[Symbol]	County 34
[Symbol]	County 35
[Symbol]	County 36
[Symbol]	County 37
[Symbol]	County 38
[Symbol]	County 39
[Symbol]	County 40
[Symbol]	County 41
[Symbol]	County 42
[Symbol]	County 43
[Symbol]	County 44
[Symbol]	County 45
[Symbol]	County 46
[Symbol]	County 47
[Symbol]	County 48
[Symbol]	County 49
[Symbol]	County 50
[Symbol]	County 51
[Symbol]	County 52
[Symbol]	County 53
[Symbol]	County 54
[Symbol]	County 55
[Symbol]	County 56
[Symbol]	County 57
[Symbol]	County 58
[Symbol]	County 59
[Symbol]	County 60
[Symbol]	County 61
[Symbol]	County 62
[Symbol]	County 63
[Symbol]	County 64
[Symbol]	County 65
[Symbol]	County 66
[Symbol]	County 67
[Symbol]	County 68
[Symbol]	County 69
[Symbol]	County 70
[Symbol]	County 71
[Symbol]	County 72
[Symbol]	County 73
[Symbol]	County 74
[Symbol]	County 75
[Symbol]	County 76
[Symbol]	County 77
[Symbol]	County 78
[Symbol]	County 79
[Symbol]	County 80
[Symbol]	County 81
[Symbol]	County 82
[Symbol]	County 83
[Symbol]	County 84
[Symbol]	County 85
[Symbol]	County 86
[Symbol]	County 87
[Symbol]	County 88
[Symbol]	County 89
[Symbol]	County 90
[Symbol]	County 91
[Symbol]	County 92
[Symbol]	County 93
[Symbol]	County 94
[Symbol]	County 95
[Symbol]	County 96
[Symbol]	County 97
[Symbol]	County 98
[Symbol]	County 99
[Symbol]	County 100

DISCLAIMER : This map is a representation of compiled public information. It is believed to be an accurate and true depiction for the stated purpose, but Charlotte County and its employees make no guaranties, implied or otherwise to the accuracy or completeness. We therefore do not accept any responsibilities as to its use. This is not a survey or is it to be used for design. C.C.G.I.S. maintains a record regarding the methods used to produce this map and can be furnished upon request.

# Charlotte County GIS Map

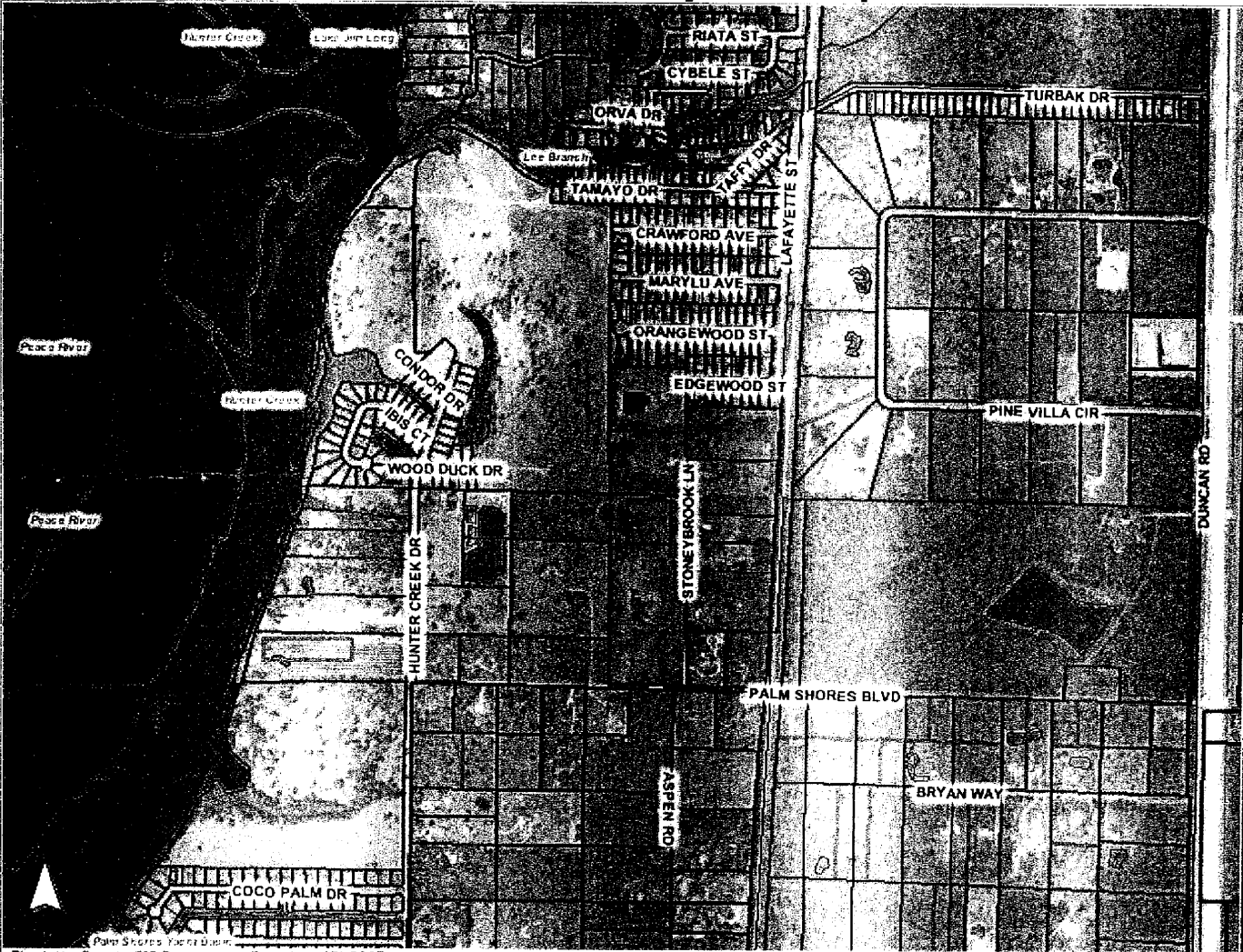

Charlotte County GIS Department Copyright (C) 2005

0 1500ft

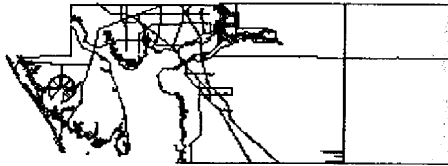

Copyright 2005  
 Charlotte County GIS  
 18500 Murdock Circle  
 Port Charlotte, FL 33948

- Legend**
- Lots
  - Accounts
  - Water
  - Water
  - Future Land Use
  - Agriculture
  - Character Based CRA
  - City
  - County Residence
  - Commercial Center
  - Commercial Corridor
  - High Density Residential
  - High Intensity Industrial
  - Low Density Residential
  - Low Intensity Industrial
  - Medium Density Residential
  - Mixed Use
  - Parks & Recreation
  - Preservation
  - Public Utility & Facilities
  - Recreational Vehicle Park
  - Resource Conservation
  - Rural Single Residential
  - Other

**DISCLAIMER :** This map is a representation of compiled public information. It is believed to be an accurate and true depiction for the stated purpose, but Charlotte County and its employees make no guaranties, implied or otherwise to the accuracy or completeness. We therefore do not accept any responsibilities as to its use. This is not a survey or is it to be used for design. C.C.G.I.S. maintains a record regarding the methods used to produce this map and can be furnished upon request.