

LAW OFFICES
ROSE, SUNDSTROM & BENTLEY, LLP
2548 BLAIRSTONE PINES DRIVE
TALLAHASSEE, FLORIDA 32301

FREDERICK L. ASCHAUER, JR.
CHRIS H. BENTLEY, P.A.
ROBERT C. BRANNAN
F. MARSHALL DETERDING
JOHN R. JENKINS, P.A.
KYLE L. KEMPER
STEVEN T. MINDLIN, P.A.
CHASITY H. O'STEEN
DAREN L. SHIPPY
WILLIAM E. SUNDSTROM, P.A.
DIANE D. TREMOR, P.A.
JOHN L. WHARTON
ROBERT M. C. ROSE (1924-2006)

(850) 877-6555
FAX (850) 656-4029
www.rsbattorneys.com

REPLY TO CENTRAL FLORIDA OFFICE

September 9, 2008

VIA HAND DELIVERY

CENTRAL FLORIDA OFFICE
SANLANDO CENTER
2180 W. STATE ROAD 434, SUITE 2118
LONGWOOD, FLORIDA 32779
(407) 830-6331
FAX (407) 830-8522

MARTIN S. FRIEDMAN, P.A.
BRIAN J. STREET

CHRISTIAN W. MARGELI, P.A.
(LICENSED IN NEW YORK ONLY)

RECEIVED-FPSC
09 SEP - 9 AM 10:13
COMMISSION
CLERK

WS899

Ann Cole, Commission Clerk
Office of Commission Clerk
Florida Public Service Commission
2540 Shumard Oak Boulevard
Tallahassee, FL 32399

RE: Docket No. 080582 -WS; Application of Gold Coast Utility Corp., for
Amendment of Water and Wastewater Certificates in Polk County (Saddlebag and
Alico Properties)
Our File No.: 40057.09

Dear Ms. Cole:

Enclosed for filing is an original and twelve (12) copies of Gold Coast Utility Corp.'s
Application for Amendment to Water and Wastewater Certificates in Polk County, Florida
along with this firm's check in the amount of \$2,000.00, which we believe to be the
appropriate filing fee for this matter.

Should you have any questions regarding this filing, please do not hesitate to give me

COM a call.
ECR
GCL
OPC
RCP
SSC
SGA
ADM MSF/mp
CLK Enclosures

Tenitz forwarded to ECR.

Very truly yours,

Martin S. Friedman
MARTIN S. FRIEDMAN
For the Firm

cc: Mr. Keith A. Burge (w/enclosure)
Saddlebag Lake Owners Association, Inc. (w/o enclosure)
Alico, Inc. (w/o enclosure)

DOCUMENT NUMBER-DATE
08370 SEP-9 08
FPSC-COMMISSION CLERK

BEFORE THE FLORIDA PUBLIC SERVICE COMMISSION

IN RE: Application of
GOLD COAST UTILITY CORP.
for amendment to water and wastewater
certificates in Polk County, Florida

DOCKET NO. 080582

**APPLICATION FOR AMENDMENT TO
CERTIFICATES OF AUTHORIZATION**

GOLD COAST UTILITY CORP. ("Applicant"), by and through its undersigned attorneys, and pursuant to Section 367.045, Florida Statutes, and Rule 25-30.036, Florida Administrative Code, files this Application for Amendment of Certificate No. 590-W and Certificate No. 508-S to extend its water and wastewater service areas to include the land more fully described in Exhibit "A" ("Extension Area"), in Polk County, and in support thereof states:

GENERAL INFORMATION

1. The exact name of the Applicant and the address of its principal business offices are:

GOLD COAST UTILITY CORP.
12292 Florida Avenue
Stuart, FL 34994

2. The names and address of the persons authorized to receive notices and communications in respect to this application are:

Martin S. Friedman, Esquire
Christian W. Marcelli, Esquire
Rose, Sundstrom & Bentley, LLP
2180 W. State Road 434, Suite 2118
Longwood, FL 32779
PHONE: (407)830-6331
FAX: (407)830-8522
mfriedman@rsbattorneys.com
cmarcelli@rsbattorneys.com

DOCUMENT NUMBER - DATE
08370 SEP -9 00
FPSC-COMMISSION CLERK

3. The purpose of this application is to extend the Applicant's certificated water and wastewater service areas to include the Extension area described in Exhibit "A". The Extension Area is adjacent to the Applicant's existing certificated water and wastewater service areas.

4. The approval of this Application is in the public interest because there (a) is a need for water and wastewater service to the Extension Area; (b) the applicant has the financial, technical and managerial ability to provide water and wastewater service at reasonable rates to the area; (c) it is in the public interest for the Applicant, as the utility whose certificated water and wastewater service area adjoins the Extension Area, to provide water and wastewater service to such area; and (d) the approval of the Application to amend the Applicant's water and wastewater certificates to include the Extension Area within its certificated water and wastewater service areas will not interrupt, curtail or otherwise affect the provision of water and wastewater service to existing customers.

**INFORMATION REQUIRED BY
RULE 25-30.036(3), FLORIDA ADMINISTRATIVE CODE**

- (a) The Applicant's complete name and address is as shown above.
- (b) The Applicant is an established water and wastewater utility which has been providing service for many years. It has both the financial and technical ability to render reasonably sufficient, adequate and efficient service. A copy of the financial sections of the Applicant's most recent Annual Report filed with the Commission is attached hereto as Exhibit "B". With respect to the Applicant's technical ability, attached as Exhibit "C" is a schedule listing the operators and their license numbers. There are no outstanding Consent Orders or Notices of Violation from DEP. The Applicant's regulatory accountants are Cronin, Jackson, Nixon & Wilson, CPAs, and its attorneys are the law firm of Rose,

Sundstrom & Bentley, LLP.

- (c) To the best of Applicant's knowledge, the provision by the Applicant of water and wastewater service to the Extension Area is consistent with the water and wastewater sections of the Polk County Comprehensive Plan at the time this Application is filed, as approved by the Department of Community Affairs.
- (d) Documentary evidence of the Applicant's ownership of the land on which its plants are constructed is attached hereto as Exhibit "D".
- (e) A description of the Extension Area is attached as Exhibit "A".
- (f) There are currently no detailed water and wastewater systems maps showing the lines and treatment facilities in the territory proposed. The Saddlebag Lake Resort portion of the Extension Area currently has water and wastewater lines and will disconnect its water and wastewater treatment facilities upon connection with the Utility. For the remainder of the Extension Area, a detailed development plan has not yet been developed.
- (g) N/A
- (h) N/A
- (i) A copy of the official county tax assessment map or other map showing township, range and section, is attached hereto as Exhibit "E".
- (j) The existing lines and treatment facilities currently serving the Applicant's existing certificated water and wastewater service areas have sufficient capacity to serve the Extension Area.
- (k) The Utility holds South Florida Water Management District Water Use Permit No. 53-00030-W, issued June 12, 2008, expiring on June 12, 2013; the Utility

No. 53-00030-W, issued June 12, 2008, expiring on June 12, 2013; the Utility holds DEP Domestic Wastewater Facility Permit No. FLA110434, issued October 28, 2005, expiring October 27, 2010

- (l) N/A
- (m) A portion of the Extension Area is the Saddlebag Lake Resort which is a fully developed "55+ community" and consists of approximately 750 home sites. Saddlebag Lake Resort also includes community recreational facilities. In addition, it is anticipated that the customers in the remainder of the Extension area will be a mix of residential customers such as single and multifamily homes, and commercial customers such as offices and retail customers.
- (n) The inclusion of the Extension Area within the Applicant's certificated water and wastewater service areas will not have any impact on the Applicant's rates or service availability charges.
- (o) The original and two (2) copies of the tariff sheets reflecting the Extension Area are attached hereto as Exhibit "F".
- (p) The Applicant cannot locate the original certificates, and such certificates are no longer issued.
- (q) Current rates for the Applicant were established by the Commission in Docket No. 060246-WS pursuant to Order No. PSC-07-0609-PAA-WS, issued July 30, 2007, and revised pursuant to Order PSC-08-0535-PSS-WS, issued August 18, 2008.
- (r) Attached hereto as Exhibit "G" is an Affidavit regarding the current status of the Applicant's current Tariff and Annual Report on file with the Public Service

Commission ("PSC").

REQUIRED NOTICES

1. Attached hereto is Exhibit "H" which is an affidavit that the notice of actual application was given in accordance with Section 367.045(1)(a), Florida Statutes, and Rule 25-30.030(5), Florida Administrative Code, by regular mail to the following:

- (a) the governing body of the municipality, county or counties in which the system or territory to be served is located;
- (b) the privately owned water and wastewater utility that holds a certificate granted by the PSC and that is located within the county in which the utility or the territory proposed to be served is located;
- (c) if any portion of the proposed territory is within one mile of a county boundary, the utility shall notice the privately owned utilities located in the bordering counties and holding a certificate granted by the Commission;
- (d) the regional planning council;
- (e) the Office of Public Counsel;
- (f) the Public Service Commission's Director of Records and Reporting;
- (g) the appropriate regional office of the Department of Environmental Protection ("DEP"); and
- (h) the appropriate water management district;

Copies of the Notice and a list of entities noticed accompany the affidavit.

2. Attached hereto as Exhibit "I" is the affidavit that notice of actual application was given in accordance with Rule 25-30.030(6), Florida Administrative Code, by regular mail or personal delivery to each property owner in the Extension Area.

3. Late Filed Exhibit "J" will be an affidavit that the notice of application was published once a week in a newspaper of general circulation in the territory in accordance with Rule 25-30.030, Florida Administrative Code. A copy of the proof of publication will accompany the affidavit.

FILING FEE

The number of ERCs in the Extension Area is approximately 1230 ERCs. Pursuant to Rule 25-30.020, Florida Administrative Code, the appropriate filing fee is \$2,000.00 (\$1,000.00 for water and \$1,000.00 for wastewater). A check for the amount of the filing fee is included with this Application.

Respectfully submitted on this 9th day of
September, 2008, by:

ROSE, SUNDSTROM & BENTLEY, LLP
2180 W. State Road 434, Suite 2118
Longwood, Florida 32779
Telephone: (407) 830-6331
Facsimile: (407) 830-8522

BY: 
MARTIN S. FRIEDMAN
For the Firm

EXHIBIT "A"

EXTENSION AREA

TO BE ADDED TO WATER and WASTEWATER CERTIFICATES:

ALICO LAND DEVELOPMENT, INC.

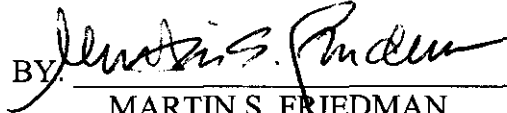
In Section 6, Township 30 South, Range 29 East, Polk County, Florida

The West ½ of the SE ¼ of the SW ¼ and the East ½ of the SW ¼ of the SW ¼

AND;

In Section 7, Township 30 South, Range 29 East, Polk County, Florida

In the NE 1/4, less the East 40' for County Road and less a parcel beginning at the SE corner of the NE ¼ of the section, thence N 89°04'47" West along the South boundary of said NE ¼ a net distance of 330.00 feet, thence North parallel with the East boundary of said NE ¼ a net distance of 330.00 feet, thence S 89°04'47" East parallel with said South boundary a net distance of 330.00 feet to said East boundary, thence South along said East boundary a net distance of 330.00 feet to the Point of Beginning, subject to Right-of-Way of Boy Scout Camp Road.

AND;

The NE ¼ of the NW ¼.

SADDLEBAG LAKE OWNER'S ASSOCIATION

In Section 1, Township 30 South, Range 28 East

The SE ¼

AND;

In Section 6, Township 30 South, Range 28

The West ½ of the Southwest ¼, all of which property is located in Polk County, Florida.

EXHIBIT "B"

(FINANCIAL INFORMATION)

FINANCIAL

SECTION

COMPARATIVE BALANCE SHEET - ASSETS AND OTHER DEBITS

ACCT. NO. (a)	ACCOUNT NAME (b)	REF. PAGE (c)	CURRENT YEAR (d)	PREVIOUS YEAR (e)
	DEFERRED DEBITS			
181	Unamortized Debt Discount & Expense	F-13		
182	Extraordinary Property Losses	F-13		
183	Preliminary Survey and Investigation Charges			
184	Clearing Accounts			
185*	Temporary Facilities			
186	Misc. Deferred Debits	F-14	70,131	42,036
187*	Research & Development Expenditures			
190	Accumulated Deferred Income Taxes			
Total Deferred Debits			70,131	42,036
TOTAL ASSETS AND OTHER DEBITS			\$ 711,354	\$ 643,904

* Not Applicable for Class B Utilities

NOTES TO THE BALANCE SHEET

The space below is provided for important notes regarding the balance sheet.

COMPARATIVE BALANCE SHEET - ASSETS AND OTHER DEBITS

ACCT. NO. (a)	ACCOUNT NAME (b)	REF. PAGE (c)	CURRENT YEAR (d)	PREVIOUS YEAR (e)
UTILITY PLANT				
101-106	Utility Plant	F-7	\$ 1,949,083	\$ 1,691,889
108-110	Less: Accumulated Depreciation and Amortization	F-8	(1,177,941)	(1,122,886)
Net Plant			771,142	569,003
114-115	Utility Plant Acquisition Adjustments (Net)	F-7		
116*	Other Plant Adjustments (specify)			
Total Net Utility Plant			771,142	569,003
OTHER PROPERTY AND INVESTMENTS				
121	Nonutility Property	F-9		
122	Less: Accumulated Depreciation and Amortization			
Net Nonutility Property				
123	Investment in Associated Companies	F-10		
124	Utility Investments	F-10		
125	Other Investments	F-10		
126-127	Special Funds	F-10		
Total Other Property and Investments				
CURRENT AND ACCRUED ASSETS				
131	Cash		(131,782)	31,002
132	Special Deposits	F-9		
133	Other Special Deposits	F-9		
134	Working Funds			
135	Temporary Cash Investments			
141-144	Accounts and Notes Receivable, Less Accumulated Provision for Uncollectable Accounts	F-11	1,863	1,863
145	Accounts Receivable from Associated Companies	F-12		
146	Notes Receivable from Associated Companies	F-12		
151-153	Materials and Supplies			
161	Stores Expense			
162	Prepayments			
171	Accrued Interest and Dividends Receivable			
172*	Rents Receivable			
173*	Accrued Utility Revenues			
174	Misc. Current and Accrued Assets	F-12		
Total Current and Accrued Assets			(129,919)	32,865

* Not Applicable for Class B Utilities

COMPARATIVE BALANCE SHEET - EQUITY CAPITAL AND LIABILITIES

ACCT. NO. (a)	ACCOUNT NAME (b)	REF. PAGE (c)	CURRENT YEAR (d)	PREVIOUS YEAR (e)
EQUITY CAPITAL				
201	Common Stock Issued	F-15	\$ 500	\$ 500
204	Preferred Stock Issued	F-15		
202,205*	Capital Stock Subscribed			
203,206*	Capital Stock Liability for Conversion			
207*	Premium on Capital Stock			
209*	Reduction in Par or Stated Value of Capital Stock			
210*	Gain on Resale or Cancellation of Reacquired Capital Stock			
211	Other Paid-in Capital		189,219	123,219
212	Discount on Capital Stock			
213	Capital Stock Expense			
214-215	Retained Earnings (Deficit)	F-16	(679,247)	(601,805)
216	Reacquired Capital Stock			
218	Proprietary Capital (Proprietorship and Partnership Only)			
Total Equity Capital (Deficit)			(489,528)	(478,086)
LONG TERM DEBT				
221	Bonds	F-15		
222*	Reacquire Bonds			
223	Advances from Associated Companies	F-17		
224	Other Long Term Debt	F-17	638,107	612,468
Total Long Term Debt			638,107	612,468
CURRENT AND ACCRUED LIABILITIES				
231	Accounts Payable		59,417	48,687
232	Notes Payable	F-18		
233	Accounts Payable to Associated Co.	F-18		
234	Notes Payable to Associated Co.	F-18	133,601	50,799
235	Customer Deposits			
236	Accrued Taxes		85	85
237	Accrued Interest	F-19		
238	Accrued Dividends			
239	Matured Long Term Debt			
240	Matured Interest			
241	Miscellaneous Current and Accrued Liabilities	F-20		
Total Current and Accrued Liabilities			193,103	99,571

* Not Applicable for Class B Utilities

COMPARATIVE BALANCE SHEET - EQUITY CAPITAL AND LIABILITIES

ACCT. NO. (a)	ACCOUNT NAME (b)	REF. PAGE (c)	CURRENT YEAR (d)	PREVIOUS YEAR (e)
DEFERRED CREDITS				
251	Unamortized Premium on Debt	F-13		
252	Advances for Construction	F-20		
253	Other Deferred Credits	F-21		
255	Accumulated Deferred Investment Tax Credits			
Total Deferred Credits				
OPERATING RESERVES				
261	Property Insurance Reserve			
262	Injuries and Damages Reserve			
263	Pensions and Benefits Reserve			
265	Miscellaneous Operating Reserves			
Total Operating Reserves				
CONTRIBUTIONS IN AID OF CONSTRUCTION				
271	Contributions in Aid of Construction	F-22	836,447	836,447
272	Accumulated Amortization of Contributions in Aid of Construction	F-22	(466,775)	(426,496)
Total Net C.I.A.C.			369,672	409,951
ACCUMULATED DEFERRED INCOME TAXES				
281	Accumulated Deferred Income Taxes - Accelerated Depreciation			
282	Accumulated Deferred Income Taxes - Liberalized Depreciation			
283	Accumulated Deferred Income Taxes - Other			
Total Accum. Deferred Income Taxes				
TOTAL EQUITY CAPITAL AND LIABILITIES			\$ 711,354	\$ 643,904

COMPARATIVE OPERATING STATEMENT

ACCT. NO. (a)	ACCOUNT NAME (b)	REF. PAGE (d)	PREVIOUS YEAR (c)	CURRENT YEAR * (e)
UTILITY OPERATING INCOME				
400	Operating Revenues	F-3(b)	\$ 393,232	\$ 466,245
469.530	Less: Guaranteed Revenue and AFPI	F-3(b)		
Net Operating Revenues			393,232	466,245
401	Operating Expenses	F-3(b)	449,892	440,221
403	Depreciation Expense	F-3(b)	28,589	55,055
	Less: Amortization of CIAC	F-22	(25,462)	(40,279)
Net Depreciation Expense			3,127	14,776
406	Amortization of Utility Plant Acquisition Adjustment	F-3(b)		
407	Amortization Expense (Other than CIAC)	F-3(b)		
408	Taxes Other Than Income	W/S-3	39,441	48,110
409	Current Income Taxes	W/S-3		
410.10	Deferred Federal Income Taxes	W/S-3		
410.11	Deferred State Income Taxes	W/S-3		
411.10	Provision for Deferred Income Taxes - Credit	W/S-3		
412.10	Investment Tax Credits Deferred to Future Periods	W/S-3		
412.11	Investment Tax Credits Restored to Operating Income	W/S-3		
Utility Operating Expenses			492,460	503,107
Net Utility Operating Income			(99,228)	(36,862)
469/530	Add Back: Guaranteed Revenue and AFPI	F-3(b)		
413	Income From Utility Plant Leased to Others			
414	Gains (Losses) From Disposition of Utility Property			
420	Allowance for Funds Used During Construction			
Total Utility Operating Income [Enter here and on Page F-3(c)]			(99,228)	(36,862)

* For each account, column e should agree with columns f, g + h on F-3(b)

COMPARATIVE OPERATING STATEMENT (Cont'd)

WATER SCHEDULE W-3* (f)	SEWER SCHEDULE S-3* (g)	OTHER THAN REPORTING SYSTEMS (h)
\$ 169,486	\$ 296,759	N/A
N/A		
169,486	296,759	-
160,025	280,196	
28,194	26,861	
(19,742)	(20,537)	
8,452	6,324	-
28,788	19,322	
197,265	305,842	
(27,779)	(9,083)	
(27,779)	(9,083)	N/A

* Total of Schedules W-3/S-3 for all rate groups

COMPARATIVE OPERATING STATEMENT (Cont'd)

ACCT. NO. (a)	ACCOUNT NAME (b)	REF. PAGE (d)	PREVIOUS YEAR (c)	CURRENT YEAR (e)
Total Utility Operating Income [from Page F-3(a)]			\$ (99,228)	\$ (36,862)
OTHER INCOME AND DEDUCTIONS				
415	Revenues From Merchandising, Jobbing and Contract Deductions			
416	Costs and Expenses of Merchandising, Jobbing and Contract Work			
419	Interest and Dividend Income		1,772	6
421	Miscellaneous Nonutility Revenue			3,750
426	Miscellaneous Nonutility Expenses		(442,199)	(1,828)
Total Other Income and Deductions			(440,427)	1,928
TAXES APPLICABLE TO OTHER INCOME				
408.20	Taxes Other Than Income			
409.20	Income Taxes			
410.20	Provision for Deferred Income Taxes			
411.20	Provision for Deferred Income Taxes - Credit			
412.20	Investment Tax Credits - Net			
412.30	Investment Tax Credits Restored to Operating Income			
Total Taxes Applicable to Other Income				
INTEREST EXPENSE				
427	Interest Expense	F-19	39,228	42,508
428	Amortization of Debt Discount & Expense	F-13		
429	Amortization of Premium on Debt	F-13		
Total Interest Expense			39,228	42,508
EXTRAORDINARY ITEMS				
433	Extraordinary Income			
434	Extraordinary Deductions			
409.30	Income Taxes, Extraordinary Items			
Total Extraordinary Items				
NET INCOME			(578,883)	(77,442)

Explain Extraordinary Income:

SCHEDULE OF YEAR END RATE BASE

ACCT. NO. (a)	ACCOUNT NAME (b)	REF. PAGE (c)	WATER UTILITY (d)	WASTEWATER UTILITY (e)
101	Utility Plant In Service	F-7	\$ 840,966	\$ 1,006,585
	Less:			
	Nonused and Useful Plant (1)			
108.1	Accumulated Depreciation	F-8	(489,011)	(688,930)
110.1	Accumulated Amortization	F-8		
271	Contributions in Aid of Construction	F-22	(411,774)	(424,673)
252	Advances for Construction	F-20		
Subtotal			(59,819)	(107,018)
272	Add: Accumulated Amortization of Contributions in Aid of Construction	F-22	246,889	219,886
Subtotal			187,070	112,868
114	Plus or Minus: Acquisition Adjustments (2)	F-7	-	-
115	Accumulated Amortization of Acquisition Adjustments (2)	F-7		
	Working Capital Allowance (3)		20,003	35,025
	Other (Specify):			
RATE BASE			\$ 207,073	\$ 147,893
NET UTILITY OPERATING INCOME			\$ (27,779)	\$ (9,083)
ACHIEVED RATE OF RETURN (Operating Income / Rate Base)			-- %	-- %

NOTES:

- (1) Estimated if not known.
 - (2) Include only those Acquisition Adjustments that have been approved by the Commission.
 - (3) Calculation consistent with last rate proceeding.
- In absence of a rate proceeding, Class A utilities will use the Balance Sheet Method and Class B Utilities will use the One-eighth Operating and Maintenance Method.

**UTILITY PLANT
ACCOUNTS 101 - 106**

ACCT. NO. (a)	DESCRIPTION (b)	WATER (c)	SEWER (d)	OTHER THAN REPORTING SYSTEMS (e)	TOTAL (f)
101	Plant Accounts Utility Plant In Service	\$ 840,966	\$ 1,006,585	N/A	\$ 1,847,551
102	Utility Plant Leased to Others				
103	Property Held for Future Use				
104	Utility Plant Purchased or Sold				
105	Construction Work in Progress	11,858	89,674		101,532
106	Completed Construction Not Classified				
Total Utility Plant		\$ 852,824	\$ 1,096,259	N/A	\$ 1,949,083

**UTILITY PLANT ACQUISITION ADJUSTMENTS
ACCOUNTS 114 AND 115**

Report each acquisition adjustment and related accumulated amortization separately. For any acquisition adjustment approved by the Commission, include the Order Number.

ACCT. NO. (a)	DESCRIPTION (b)	WATER (c)	SEWER (d)	OTHER THAN REPORTING SYSTEMS (e)	TOTAL (f)
114	Acquisition Adjustment			\$ -	\$ -
					-
					-
					-
					-
					-
					-
					-
Total Plant Acquisition Adjustment		\$ -	\$ -	\$ -	\$ -
115	Accumulated Amortization			\$ -	\$ -
					-
					-
					-
					-
					-
					-
					-
Total Accumulated Amortization		\$ -	\$ -	\$ -	\$ -
Total Acquisition Adjustments		\$ -	\$ -	\$ -	\$ -

ACCUMULATED DEPRECIATION (ACCT. 108) AND AMORTIZATION (ACCT. 110)

DESCRIPTION (a)	WATER (b)	SEWER (c)	OTHER THAN REPORTING SYSTEMS (d)	TOTAL (e)
ACCUMULATED DEPRECIATION Account 108				
Balance first of year	\$ 460,816	\$ 662,070	N/A	\$ 1,122,886
Credits during year:				
Accruals charged:				
to Account 108.1 (1)	28,194	28,861		55,055
to Account 108.2 (2)				
to Account 108.3 (2)				
Other Accounts (Specify)				
Rounding	1	(1)		
Salvage				
Other Credits (specify):				
Total credits	28,195	26,860		55,055
Debits during year:				
Book cost of plant retired	-	-		
Cost of removal				
Other debits (specify)				
Total debits				
Balance end of year	\$ 489,011	\$ 688,930	N/A	\$ 1,177,941

DESCRIPTION	WATER	SEWER	OTHER THAN REPORTING SYSTEMS	TOTAL
ACCUMULATED AMORTIZATION Account 110				
Balance first of year N/A	N/A	N/A	N/A	N/A
Credits during year:				
Accruals charged:				
to Account 110.2 (2)				
Other Accounts (specify):				
Total credits				
Debits during year:				
Book cost of plant retired				
Other debits (specify)				
Total debits				
Balance end of year	N/A	N/A	N/A	N/A

- (1) Account 108 for Class B utilities.
- (2) Not applicable for Class B utilities.
- (3) Account 110 for Class B utilities.

**REGULATORY COMMISSION EXPENSE
AMORTIZATION OF RATE CASE EXPENSE (ACCTS. 666 AND 766)**

DESCRIPTION OF CASE (DOCKET NO.) (a)	EXPENSE INCURRED DURING YEAR (b)	CHARGED OFF DURING YEAR	
		ACCT. (c)	AMOUNT (d)
None	\$ -	-	\$ -
Total	\$ -		\$ -

NONUTILITY PROPERTY (ACCOUNT 121)

Report separately each item of property with a book cost of \$25,000 or more included in Account 121.
Other items may be grouped by classes of property.

DESCRIPTION (a)	BEGINNING YEAR (b)	ADDITIONS (c)	REDUCTIONS (d)	ENDING YEAR BALANCE (e)
None	\$ -	\$ -	\$ -	\$ -
Total Nonutility Property	\$ -	\$ -	\$ -	\$ -

SPECIAL DEPOSITS (ACCOUNTS 132 AND 133)

Report hereunder all special deposits carried in Accounts 132 and 133

DESCRIPTION OF SPECIAL DEPOSITS (a)	YEAR END BOOK COST (b)
SPECIAL DEPOSITS (Account 132): None	\$ -
Total Special Deposits	\$ -
OTHER SPECIAL DEPOSITS (Account 133): None	\$ -
Total Other Special Deposits	\$ -

UTILITY NAME: Gold Coast Utility Corp.

YEAR OF REPORT
December 31, 2007

**INVESTMENTS AND SPECIAL FUNDS
ACCOUNTS 123-127**

Report hereunder all investments and special funds carried in Accounts 123 through 127.

DESCRIPTION OF SECURITY OR SPECIAL FUND (a)	FACE OR PAR VALUE (b)	YEAR END BOOK COST (c)
INVESTMENT IN ASSOCIATED COMPANIES (Account 123): N/A	\$ -	\$ -
Total Investment In Associated Companies		\$ -
UTILITY INVESTMENTS (Account 124): N/A	\$ -	\$ -
Total Utility Investments		\$ -
OTHER INVESTMENTS (Account 125): N/A	\$ -	\$ -
Total Other Investments		\$ -
SPECIAL FUNDS (Class A Utilities: Accounts 126 & 127; Class B Utilities: Account 127)) N/A		\$ -
Total Special Funds		\$ -

ACCOUNTS AND NOTES RECEIVABLE - NET
ACCOUNTS 141 - 144

Report hereunder all accounts and notes receivable included in Accounts 141, 142 and 144. Amounts included in Accounts 142 and 144 should be listed individually.

DESCRIPTION (a)		TOTAL (b)
CUSTOMER ACCOUNTS RECEIVABLE (Account 141):		
Combined Water & Wastewater	\$ 1,863	
Wastewater		
Other		
Total Customer Accounts Receivable		\$ 1,863
OTHER ACCOUNTS RECEIVABLE (Acct. 142):		
	\$ -	
Total Other Accounts Receivable		
NOTES RECEIVABLE (Acct. 144):		
	\$ -	
Total Notes Receivable		
Total Accounts and Notes Receivable		1,863
ACCUMULATED PROVISION FOR UNCOLLECTABLE ACCOUNTS (Account 143):		
Balance First of Year	\$ -	
Add: Provision for uncollectables for current year		
Collections of accounts previously written off		
Utility accounts		
Others		
Total Additions		
Deduct accounts written off during year:		
Utility accounts		
Others		
Total accounts written off		
Balance end of year		
Total Accounts and Notes Receivable - Net		\$ 1,863

ACCOUNTS RECEIVABLE FROM ASSOCIATED COMPANIES
ACCOUNT 145

Report each account receivable from associated companies separately.

DESCRIPTION (a)	TOTAL (b)
None	\$ -
Total	\$ -

NOTES RECEIVABLE FROM ASSOCIATED COMPANIES
ACCOUNT 146

Report each note receivable from associated companies separately.

DESCRIPTION (a)	INTEREST RATE (b)	TOTAL (c)
None		\$ -
Total		\$ -

MISCELLANEOUS CURRENT AND ACCRUED ASSETS
ACCOUNT 174

DESCRIPTION - Provide itemized listing (a)	TOTAL (c)
None	\$ -
Total	\$ -

UTILITY NAME: Gold Coast Utility Corp.

YEAR OF REPORT
December 31, 2007

UNAMORTIZED DEBT DISCOUNT AND EXPENSE AND PREMIUM ON DEBT
Report the net discount and expense or premium separately for each security issue.

DESCRIPTION (a)	AMOUNT WRITTEN OFF DURING YEAR (b)	YEAR END BALANCE (c)
UNAMORTIZED DEBT DISCOUNT AND EXPENSE (Account 181):		
N/A	\$ -	\$ -
_____	_____	_____
_____	_____	_____
_____	_____	_____
Total Unamortized Debt Discount and Expense	_____	_____
UNAMORTIZED PREMIUM ON DEBT (Account 251):		
N/A	\$ -	\$ -
_____	_____	_____
_____	_____	_____
_____	_____	_____
Total Unamortized Premium on Debt	\$ -	\$ -

EXTRAORDINARY PROPERTY LOSSES
ACCOUNT 182

Report each item separately.

DESCRIPTION (a)	TOTAL (b)
EXTRAORDINARY PROPERTY LOSSES (Acct. 182):	
N/A	\$ -
_____	_____
_____	_____
_____	_____
Total Extraordinary Property Losses	\$ -

STATEMENT OF RETAINED EARNINGS

- Dividends should be shown for each class and series of capital stock. Show amounts as dividends per share.
- Show separately the state and federal income tax effect of items shown in Account No. 439.

ACCT. NO. (a)	DESCRIPTION (b)	AMOUNTS (c)
215	Unappropriated Retained Earnings: Balance beginning of year (Deficit)	\$ (601,805)
439	Changes to account: Adjustments to Retained Earnings (requires Commission approval prior to use): Credits: _____ _____	_____ _____
	Total Credits	
	Debits: _____ _____	_____ _____
	Total Debits	
435	Balance transferred from Income	(77,442)
436	Appropriations of Retained Earnings: _____ _____	_____ _____
	Total appropriations of Retained Earnings	
437	Dividends declared: Preferred stock dividends declared _____	_____
438	Common stock dividends declared _____	_____
	Total Dividends Declared	
	Year end Balance	(679,247)
214	Appropriated Retained Earnings (state balance and purpose of each appropriated amount at year end): _____ _____ _____	_____ _____ _____
214	Total Appropriated Retained Earnings	
	Total Retained Earnings (Deficit)	\$ (679,247)

Notes to Statement of Retained Earnings:

NOTES PAYABLE (ACCTS. 232 AND 234)

DESCRIPTION OF OBLIGATION (INCLUDING DATE OF ISSUE AND DATE OF MATURITY) (a)	INTEREST		PRINCIPAL AMOUNT PER BALANCE SHEET (d)
	ANNUAL RATE (b)	FIXED OR VARIABLE* (c)	
NOTES PAYABLE (Account 232):			
N/A	%		\$ -
	%		
	%		
	%		
	%		
	%		
	%		
Total Account 232			\$ -
NOTES PAYABLE TO ASSOC. COMPANIES (Account 234):			
Keith Burge	10.00 %	F	\$ 99,357
Reginald J. Burge	10.00 %	F	34,244
	%		
	%		
	%		
	%		
	%		
Total Account 234			\$ 133,601

* For variable rate obligations, provide the basis for the rate. (i.e.. Prime +2%, etc)

**ACCOUNTS PAYABLE TO ASSOCIATED COMPANIES
ACCOUNT 233**

Report each account payable separately.

DESCRIPTION (a)	TOTAL (b)
N/A	\$ -
Total	

**ACCRUED INTEREST AND EXPENSE
ACCOUNTS 237 AND 427**

DESCRIPTION OF DEBT (a)	BALANCE BEGINNING OF YEAR (b)	INTEREST ACCRUED DURING YEAR		INTEREST PAID DURING YEAR (e)	BALANCE END OF YEAR (f)
		ACCT. DEBIT (c)	AMOUNT (d)		
ACCOUNT NO. 237.1 - Accrued Interest on Long Term Debt					
Fidelity Federal	\$ -		\$ 12,795	\$ 12,795	\$ -
Home Depot Credit	-		49	49	
National City Bank			28,764	28,764	
Keith Burge			900	900	
Total Account No. 237.1	-		42,508	42,508	-
ACCOUNT NO. 237.2 - Accrued Interest in Other Liabilities					
None			-	-	-
Total Account 237.2	-				
Total Account 237 (1)	\$ -		\$ 42,508	\$ 42,508	\$ -
INTEREST EXPENSED:					
Total accrual Account 237		237	\$ 42,508		
Less Capitalized Interest Portion of AFUDC:					
None					
Net Interest Expensed to Account No. 427 (2)			\$ 42,508		

(1) Must Agree to F-2(a), Beginning and Ending Balance of Accrued Interest
(2) Must agree to F-3(c), Current Year Interest Expense

**OTHER DEFERRED CREDITS
ACCOUNT 253**

DESCRIPTION - Provide Itemized listing (a)	AMOUNT WRITTEN OFF DURING YEAR (b)	YEAR END BALANCE (c)
REGULATORY LIABILITIES (Class A Utilities: Account 253.1)		
N/A	\$ -	\$ -
Total Regulatory Liabilities	\$ -	\$ -
OTHER DEFERRED LIABILITIES (Class A Utilities: Account 253.2)		
N/A	\$ -	\$ -
Total Deferred Liabilities	\$ -	\$ -
TOTAL OTHER DEFERRED CREDITS	\$ -	\$ -

**CONTRIBUTIONS IN AID OF CONSTRUCTION
ACCOUNT 271**

DESCRIPTION (a)	WATER (b)	SEWER (c)	W & WW OTHER THAN SYSTEM REPORTING (d)	TOTAL (e)
Balance first of year	\$ 411,774	\$ 424,673	N/A	\$ 836,447
Add credits during year:				-
Less debits charged during				-
Total Contributions In Aid of Construction	\$ 411,774	\$ 424,673	\$ -	\$ 836,447

**ACCUMULATED AMORTIZATION OF CONTRIBUTIONS IN AID OF CONSTRUCTION
ACCOUNT 272**

DESCRIPTION (a)	WATER (b)	SEWER (c)	W & WW OTHER THAN SYSTEM REPORTING (d)	TOTAL (e)
Balance First of year	\$ 227,147	\$ 199,349	N/A	\$ 426,496
Debits during year:	19,742	20,537		40,279
Credits during year (specify): Rounding				-
Total Accumulated Amortization of Contributions In Aid of Construction	\$ 246,889	\$ 219,886		\$ 466,775

**RECONCILIATION OF REPORTED NET INCOME WITH TAXABLE INCOME FOR FEDERAL INCOME TAXES
(UTILITY OPERATIONS)**

1. The reconciliation should include the same detail as furnished on schedule M-1 of the federal income tax return for the year. The reconciliation shall be submitted even though there is no taxable income for the year. Descriptions should clearly indicate the nature of each reconciling amount and show the computation of all tax accruals.

2. If the utility is a member of a group which files a consolidated federal tax return, reconcile reported net income with taxable net income as if a separate return were to be filed, indicating intercompany amounts to be eliminated in such consolidated return. State names of group members, tax assigned to each group member, and basis of allocation, assignment, or sharing of the consolidated tax among group members.

DESCRIPTION (a)	REFERENCE (b)	AMOUNT (c)
Net income for the year (loss)	F-3(c)	\$ (77,442)
Reconciling items for the year:		
Taxable income not reported on the books:		
_____	_____	_____
_____	_____	_____
_____	_____	_____
Deductions recorded on books not deducted for return:		
_____	_____	_____
_____	_____	_____
_____	_____	_____
Income recorded on books not included in return:		
_____	_____	_____
_____	_____	_____
_____	_____	_____
Deduction on return not charged against book income:		
_____	_____	_____
_____	_____	_____
_____	_____	_____
Federal tax net income (loss)		\$ (77,442)
Computation of tax:		
The tax return has not been prepared, however, a loss is expected.		

EXHIBIT "C"

(OPERATORS)

Water Treatment Plant:

Danny Alexander, Lic. No. C-12379

Wastewater Treatment Plant:

John Ridgeway, Lic. No. 0012822

EXHIBIT "D"

**(EVIDENCE OF OWNERSHIP OR RIGHT TO USE
WATER AND WASTEWATER TREATMENT PLANT SITES)**

INSTR # 2005300608
BK 06529 PGS 0323-0325 PG(5)3
RECORDED 12/08/2005 02:07:53 PM
RICHARD M WEISS, CLERK OF COURT
POLK COUNTY
DEED DOC 0.70
RECORDING FEES 27.00
RECORDED BY S Wiggins

THIS DOCUMENT PREPARED BY:
Martin S. Friedman, Esquire
ROSE, SUNDBSTROM & BENTLEY, LLP
2180 W. State Road 434, Suite 2118
Longwood, FL 32779

213029-000000-013020
223029-000000-011030
153029-000000-022020
Parcel ID Number(s)

**Corrective General Warranty Deed
(To correct legal description)**

This Indenture, made this 24th day of November, 2005, by LAKE HAVEN UTILITY ASSOCIATES, LTD., a Florida limited partnership d/b/a LAKE WALES UTILITY COMPANY, whose address is P.O. Box 402279, Miami Beach, FL 33140 (hereinafter "Grantor"), to GOLD COAST UTILITY CORP., a Florida corporation, whose address is 2340 N.E. Dixie Highway, Jensen Beach, FL 34957 (hereinafter "Grantee").

(Whenever used herein the term "grantor" and "grantee" include all the parties to this instrument and the heirs, legal representatives and assigns of individuals, and the successors and assigns of corporations).

Witnesseth, said Grantor, for and in consideration of the sum of Ten Dollars, (\$10.00) and other valuable considerations, receipt whereof is hereby acknowledged, hereby grants, bargains, sells, aliens, remises, releases, conveys and confirms unto Grantee, all that certain land situate in Polk County, Florida, viz:

SEE, LEGAL DESCRIPTION ATTACHED HERETO AS EXHIBIT "A"

Together with all the tenements, hereditaments and appurtenances thereto belonging or in anywise appertaining.

To Have and to Hold, the same in fee simple forever.

And said Grantor hereby covenants with said Grantee that Grantor is lawfully seized of said land in fee simple; that Grantor has good right and lawful authority to sell and convey said land; that Grantor hereby fully warrants the title to said land and will defend same against the lawful claims of all persons whomsoever; and that said land is free of all encumbrances except taxes accruing subsequent to December 31, 2004.

In Witness Whereof, Grantor has signed and sealed these presents the day and year first above written.

Signed, sealed and delivered in our presence:

Cal. Yarnall
Print Name: Cal Yarnall
Lawrence Ellingsworth
Print Name: Lawrence Ellingsworth

LAKE HAVEN UTILITY ASSOCIATES, LTD.
d/b/a LAKE WALES UTILITY COMPANY

Mark Rubin
BY: MARK RUBIN
Its: General Partner

State of Florida
County of Dade

The foregoing instrument was acknowledged before me this 24th day of November, 2005, by MARK RUBIN, as General Partner of LAKE HAVEN UTILITY ASSOCIATES, LTD., d/b/a LAKE WALES UTILITY COMPANY, on behalf of the partnership, who is personally known to me or who has produced proper identification as identification.

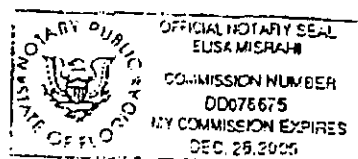

Elisa Misrahi
Notary Public - State of Florida at Large
Printed Name: ELISA MISRAHI
My Commission Expires: 12/28/06

First American Title Insurance Company

EXHIBIT A

Beginning at a concrete monument set on the South line of a roadway 80.00 feet wide, said concrete monument being 3430.54 feet North and 2700.00 feet East of the Southwest corner of Section 21, Township 30 South, Range 29 East, and run South 880.54 feet; thence West 70.39 feet to a point on the Northerly line of a roadway 60 feet wide; thence Northwesterly along said Northerly line on a curve concave to the Southwest, having a radius of 315.00 feet, a central angle of $08^{\circ}33'31''$ and a chord bearing North $39^{\circ}02'04''$ West, an arc distance of 47.05 feet; thence North 163.49 feet; thence East 60.00 feet; thence North 670.58 feet to a point on the South line of a roadway 80 feet wide; thence Northeasterly along said South line on a curve concave to the Northwest, having radius of 2040.00 feet, a central angle of $01^{\circ}09'28''$ and chord bearing North $76^{\circ}00'57''$ East, an arc of 41.22 feet to the POINT OF BEGINNING;

AND:

Beginning at a concrete monument on the North line of a roadway 80.00 feet wide, said concrete monument being 3513.31 feet North and 2700.00 feet East of the Southwest corner of Section 21, Township 30 South, Range 29 East, and run North 1236.69 feet; thence West 100.00 feet; thence South 200.00 feet; thence East 60.00 feet; thence South 501.74 feet; thence West 230.00 feet; thence South $33^{\circ}01'26''$ West 238.54 feet; thence South 400.00 feet to a point on the North line of a roadway 80 feet wide; thence Northeasterly along said North line on a curve concave to the Northwest, having a radius of 1960.00 feet, a central angle of $11^{\circ}52'05''$ and a chord bearing North $80^{\circ}45'46''$ East, and arc distance of 405.99 feet to the POINT OF BEGINNING.

AND:

A Right-of-Way 15 feet wide, through Section 21, Township 30 South, Range 29 East, Polk County, Florida, said Right-of-Way being 5 feet to the right (South) of and 10 feet to the left (North) of the centerline described as: Begin for the same at a point North 3455.17 feet, and East 2700.00 feet from the Southwest corner of Section 21, thence Easterly along a curve concave to the North having a radius of 2035.00 feet, a central angle of $11^{\circ}26'02''$ and a chord bearing and distance of North $69^{\circ}41'01''$ East 405.43 feet, an arc distance of 406.10 feet to the end of said curve, thence North $63^{\circ}58'00''$ East, 598.00 feet; thence North $86^{\circ}28'00''$ East 78.39 feet; thence North $63^{\circ}58'00''$ East 117.59 feet; thence Easterly along a curve concave to the North having a radius of 865.00 feet, a central angle of $07^{\circ}44'00''$ and a chord bearing and distance of North $60^{\circ}05'00''$ East 116.66 feet, and arc distance of 116.75 feet to the end of said curve, thence North $56^{\circ}14'00''$ East 146.67 feet, thence North $78^{\circ}44'00''$ East 20.00 feet; thence South $89^{\circ}32'00''$ East 1293.00 feet more or less to the East line of said Section 21;

AND:

Part of Sections 15 and 22, Township 30 South, Range 29 East, described as:

Begin at the Northeast corner of Section 22 and run thence along the North line of said Section 22 North $89^{\circ}32'34''$ West, 453.79 feet; thence South $45^{\circ}49'30''$ West 944.89 feet; thence North $44^{\circ}10'30''$ West 127.28 feet; thence North $00^{\circ}49'30''$ East 102.84 feet; thence North $45^{\circ}49'30''$ East 700.22 feet; thence South $44^{\circ}10'30''$ East 100.00 feet; thence South $45^{\circ}49'30''$ East 213.01 feet; thence South $89^{\circ}32'34''$ East 494.89 feet, more or less, to the East line of Section 15; thence South along the East line of said Section

First American Title Insurance Company

15, 100.00 feet, more or less, to the POINT OF BEGINNING.

AND:

A Right-of-Way 15.00 feet wide through Section 22, Township 30 South, Range 29 East Polk County, Florida, said Right-of-Way being 5.00 feet to the left (South) of and 10.00 feet to the right (North) of the centerline described as: Begin for the same at a point located 1,215.26 feet West of the Northeast corner of Section 22, measured along the North line of Section 22, and 528.95 feet South of said North line of Section 22, measured along a line perpendicular to said North line of Section 22, said POINT OF BEGINNING also South $66^{\circ}56'43''$ West 1325.38 feet from said Northeast corner of Section 22; thence North $89^{\circ}32'00''$ West 450.16 feet; thence South $45^{\circ}28'00''$ West 1021.84 feet; thence North $89^{\circ}32'00''$ West, parallel to and 1,250.00 feet South of the North line Section 22, a distance of 2,899.00 feet more or less to the West line Section 22.

AND:

A Right-of-Way 15 feet wide through Section 22, Township 30 South, Range 39 East, Polk County, Florida, said Right-of-Way being 7.50 feet on either side of the centerline hereinafter described: Begin at a point on the North $89^{\circ}32'00''$ West 2,899 foot line described above, 254.00 feet from the beginning thereof; thence South $00^{\circ}28'00''$ West 642.00 feet; thence South $46^{\circ}53'00''$ West 125 feet more or less.

EXHIBIT "E"
(DETAILED SYSTEM MAPS)

SEC. 6 TWP. 30 R. 29
W 1/2 of the SW 1/4

SEC. 1 TWP. 30 R. 28
SE 1/4

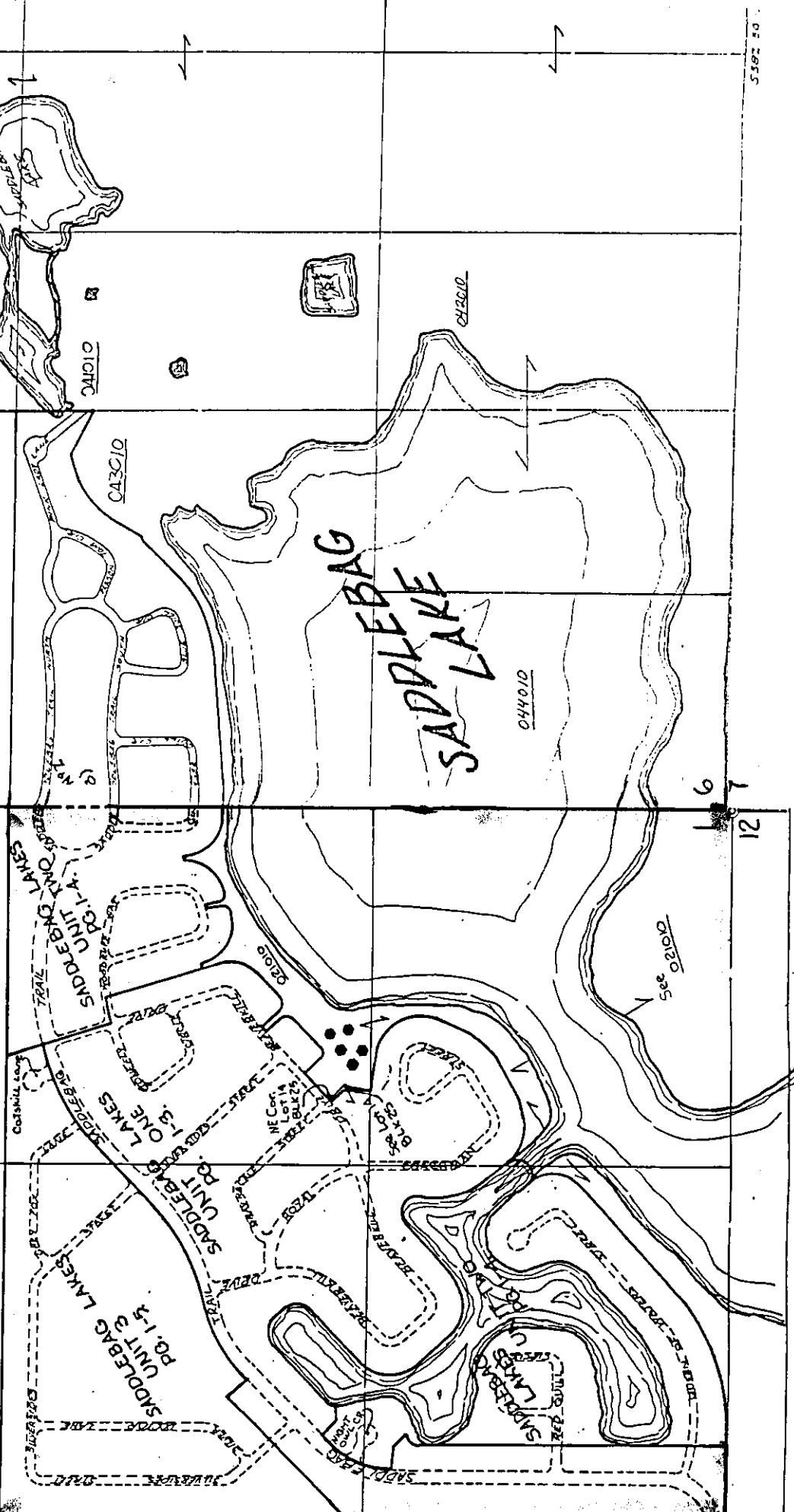

EXHIBIT "F"

**Proposed Tariff Sheet
(Original & two (2) copies)**

GOLD COAST UTILITY CORP.
WATER TARIFF

SECOND REVISED SHEET NO. 3.0
CANCELS FIRST REVISED SHEET NO. 3.0

TERRITORY AUTHORITY

CERTIFICATE NUMBER – 590 – W

COUNTY – Polk

COMMISSION ORDER(s) APPROVING TERRITORY SERVED –

<u>Order Number</u>	<u>Date Issued</u>	<u>Docket Number</u>	<u>Filing Type</u>
PSC-97-0567-FOF-WS	5/20/97	961485-WS	Grandfather
PSC-06-0331-PAA-WS	4/24/06	050902-WS	Transfer
PSC-06-0770-FOF-WS	9/18/06	060166-WS	Amendment
_____	__/__/__	_____ -WS	Amendment

(Continued to Sheet No. 3.1)

Keith Burge
ISSUING OFFICER
Secretary/Treasurer
TITLE

(Continued from Sheet No. 3.1)

DESCRIPTION OF TERRITORY SERVED

In Section 6, Township 30 South, Range 29 East, Polk County, Florida

The West ½ of the SE ¼ of the SW ¼ and the East ½ of the SW ¼ of the SW ¼

AND;

In Section 7, Township 30 South, Range 29 East, Polk County, Florida

In the NE 1/4, less the East 40' for County Road and less a parcel beginning at the SE corner of the NE ¼ of the section, thence N 89°04'47" West along the South boundary of said NE ¼ a net distance of 330.00 feet, thence North parallel with the East boundary of said NE ¼ a net distance of 330.00 feet, thence S 89°04'47" East parallel with said South boundary a net distance of 330.00 feet to said East boundary, thence South along said East boundary a net distance of 330.00 feet to the Point of Beginning, subject to Right-of-Way of Boy Scout Camp Road.

AND;

The NE ¼ of the NW ¼;

AND;

In Section 1, Township 30 South, Range 28 East

The SE ¼

AND;

In Section 6, Township 30 South, Range 28

The West ½ of the Southwest ¼, all of which property is located in Polk County, Florida.

Keith Burge
ISSUING OFFICER
Secretary/Treasurer
TITLE

COMMUNITIES SERVED LISTING

<u>County Name</u>	<u>Development Name</u>	<u>Schedule(s) Available</u>	<u>Sheet No.</u>
Polk	Nalcrest Apartments	RS, GS	12.0, 13.0
Polk	Island Oak Apartments	RS, GS	12.0, 13.0
Polk	Village Green Apartments	RS, GS	12.0, 13.0
Polk	Walden Shores	RS, GS	12.0, 13.0
Polk	Granada Condos	RS, GS	12.0, 13.0
Polk	Fedhaven	RS, GS	12.0, 13.0
Polk	Saddlebag Lake Resort	RS, GS	12.0, 13.0

Keith Burge
ISSUING OFFICER
Secretary/Treasurer
TITLE

GOLD COAST UTILITY CORP.
WASTEWATER TARIFF

SECOND REVISED SHEET NO. 3.0
CANCELS FIRST REVISED SHEET NO. 3.0

TERRITORY AUTHORITY

CERTIFICATE NUMBER – 508 – S

COUNTY – Polk

COMMISSION ORDER(S) APPROVING TERRITORY SERVED –

<u>Order Number</u>	<u>Date Issued</u>	<u>Docket Number</u>	<u>Filing Type</u>
PSC-97-0567-FOF-WS	5/20/97	961485-WS	Grandfather
PSC-06-0331-PAA-WS	4/24/06	050902-WS	Transfer
PSC-06-0770-FOF-WS	9/18/06	060166-WS	Amendment
_____	__/__/__	_____ -WS	Amendment

(Continued to Sheet No. 3.1)

Keith Burge
ISSUING OFFICER
Secretary/Treasurer
TITLE

(Continued from Sheet No. 3.1)

DESCRIPTION OF TERRITORY SERVED

In Section 6, Township 30 South, Range 29 East, Polk County, Florida

The West ½ of the SE ¼ of the SW ¼ and the East ½ of the SW ¼ of the SW ¼

AND;

In Section 7, Township 30 South, Range 29 East, Polk County, Florida

In the NE 1/4, less the East 40' for County Road and less a parcel beginning at the SE corner of the NE ¼ of the section, thence N 89°04'47" West along the South boundary of said NE ¼ a net distance of 330.00 feet, thence North parallel with the East boundary of said NE ¼ a net distance of 330.00 feet, thence S 89°04'47" East parallel with said South boundary a net distance of 330.00 feet to said East boundary, thence South along said East boundary a net distance of 330.00 feet to the Point of Beginning, subject to Right-of-Way of Boy Scout Camp Road.

AND;

The NE ¼ of the NW ¼;

AND;

In Section 1, Township 30 South, Range 28 East

The SE ¼

AND;

In Section 6, Township 30 South, Range 28

The West ½ of the Southwest ¼, all of which property is located in Polk County, Florida.

Keith Burge
ISSUING OFFICER
Secretary/Treasurer
TITLE

GOLD COAST UTILITY CORP.
WASTEWATER TARIFF

FIRST REVISED SHEET NO. 4.0
CANCELS ORIGINAL SHEET NO. 4.0

COMMUNITIES SERVED LISTING

<u>County Name</u>	<u>Development Name</u>	<u>Schedule(s) Available</u>	<u>Sheet No.</u>
Polk	Nalcrest Apartments	RS, GS	12.0, 13.0
Polk	Island Oak Apartments	RS, GS	12.0, 13.0
Polk	Village Green Apartments	RS, GS	12.0, 13.0
Polk	Walden Shores	RS, GS	12.0, 13.0
Polk	Granada Condos	RS, GS	12.0, 13.0
Polk	Fedhaven	RS, GS	12.0, 13.0
Polk	Saddlebag Lake Resort	RS, GS	12.0, 13.0

Keith Burge
ISSUING OFFICER
Secretary/Treasurer
TITLE

EXHIBIT "G"

(AFFIDAVIT OF TARIFF AND ANNUAL REPORT)

AFFIDAVIT

STATE OF FLORIDA

COUNTY OF SEMINOLE

BEFORE ME, the undersigned authority, authorized to administer oaths and take acknowledgments, personally appeared MARTIN S. FRIEDMAN, who, after being duly sworn on oath, did depose on oath and say that he is the attorney for Gold Coast Utility Corp.; that Gold Coast Utility Corp. has a Tariff on file with the Public Service Commission; and that on September 8, 2008, he did verify on the Public Service Commission's website that Gold Coast Utility Corp.'s 2007 Annual Report is on file.

FURTHER AFFIANT SAYETH NAUGHT.

MARTIN S. FRIEDMAN

Sworn to and subscribed before me this the 8th day of September, 2008, by MARTIN S. FRIEDMAN, who is personally known to me.

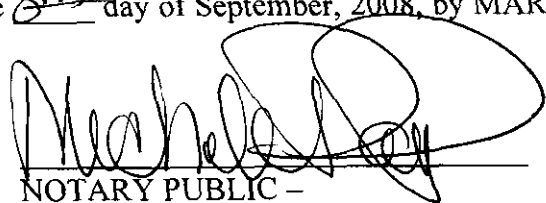
NOTARY PUBLIC -
STATE OF FLORIDA

 **D. Michele Parks**
Commission # DD580151
Expires September 24, 2010
Banded Troy Fair - Insurance, Inc. 800-388-7018

Printed Name: _____
My Commission Expires: _____

EXHIBIT "H"

(AFFIDAVIT OF NOTICE OF APPLICATION TO LIST OF ENTITIES)

AFFIDAVIT OF MAILING

STATE OF FLORIDA

COUNTY OF SEMINOLE

BEFORE ME, the undersigned authority, authorized to administer oaths and take acknowledgments, personally appeared MICHELE PARKS, who, after being duly sworn on oath, did depose on oath and say that she is the Legal Assistant to Martin S. Friedman, Esquire, attorney for Gold Coast Utility Corp., and that on the 8th day of September, 2008, she did send by regular U.S. mail, a copy of the notice attached hereto to each of the utilities, governmental bodies, agencies, or municipalities, in accordance with the list provided by the Florida Public Service Commission, which is also attached hereto.

FURTHER AFFIANT SAYETH NAUGHT.

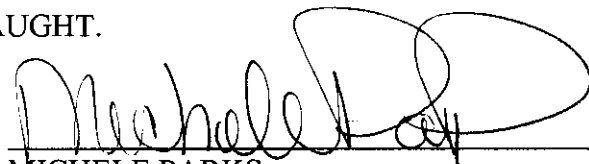

MICHELE PARKS

Sworn to and subscribed before me this 8TH day of September, 2008, by Trina L. Collins, who is personally known to me.



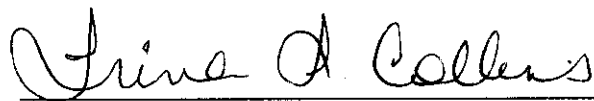

NOTARY PUBLIC – STATE OF FLORIDA
Printed Name: _____
My Commission Expires: _____

**NOTICE OF APPLICATION FOR AN EXTENSION OF SERVICE AREA
BY GOLD COAST UTILITY CORP. IN POLK COUNTY, FLORIDA**

NOTICE IS HEREBY GIVEN on this 8th day of September, 2008, pursuant to Section 367.045, Florida Statutes, and Section 25-30.030, Florida Administrative Code, of the of the Application of Gold Coast Utility Corp., to amend Water Certificate No. 590-W and Wastewater Certificate No. 508-S, to add territory in Polk County, Florida. The Applicant proposes to extend its existing certificated water and wastewater service area to include the following land in Polk County, Florida:

In Section 6, Township 30 South, Range 29 East, Polk County, Florida

The West ½ of the SE ¼ of the SW ¼ and the East ½ of the SW ¼ of the SW ¼

AND

In Section 7, Township 30 South, Range 29 East, Polk County, Florida

In the NE ¼, less the East 40' for County Road and less a parcel beginning at the SE corner of the NE ¼ of the section, thence N 89°04'47" West along the South boundary of said NE ¼ a net distance of 330.00 feet, thence North parallel with the East boundary of said NE ¼ a net distance of 330.00 feet, thence S 89°04'47" East parallel with said South boundary a net distance of 330.00 feet to said East boundary, thence South along said East boundary a net distance of 330.00 feet to the Point of Beginning, subject to Right-of-Way of Boy Scout Camp Road

AND

The NE ¼ of the NW ¼.

AND

In Section 1, Township 30 South, Range 28 East

The SE ¼

AND

In Section 6, Township 30 South, Range 28

The West ½ of the Southwest ¼, all of which property is located in Polk County, Florida.

Any objections to the Application must be made in writing and filed with the Commission Clerk, Office of Commission Clerk, Florida Public Service Commission, 2540 Shumard Oak Boulevard, Tallahassee, Florida 32399-0850, no later than 30 days from the date of this Notice, with a copy to Martin S. Friedman, Esquire, Rose, Sundstrom & Bentley, LLP, 2180 W. State Road 434, Suite 2118, Longwood, Florida 32779. The objection must state the grounds for the objection with particularity.

Gold Coast Utility Corp.
(863) 696-0504

**LIST OF WATER AND WASTEWATER UTILITIES IN POLK COUNTY
(VALID FOR 60 DAYS)
08/12/2008 - 10/10/2008**

<u>UTILITY NAME</u>	<u>POLK COUNTY</u>	<u>MANAGER</u>
ALTURAS UTILITIES, L.L.C. (WU871) P. O. BOX 566 HAINES CITY, FL 33845-0566		CHRISTIE MCCORMICK (863) 421-6827
ANGLERS COVE WEST, LTD. (WS817) P. O. BOX 5252 LAKELAND, FL 33807-5252		TODD MAXWELL (863) 647-1581
AQUA UTILITIES FLORIDA, INC. (WS884) 762 WEST LANCASTER AVENUE BRYN MAWR, PA 19010-3402		KIMBERLY A. JOYCE (610) 645-1077
CAL CLAIR, INC. D/B/A BREEZE HILL UTILITY (WS863) P. O. BOX 1408 LAKE WALES, FL 33859-1408		CALVIN C. BLAKE (863) 696-1666
CHC VII, LTD. (WS816) P. O. BOX 5252 LAKELAND, FL 33807-5252		TODD MAXWELL (863) 647-1581
CROOKED LAKE PARK SEWERAGE COMPANY (SU785) 227 CALOOSA LAKE CIRCLE, NORTH LAKE WALES, FL 33859-8605		KENNETH J. KNOWLTON (863) 638-3117
CYPRESS LAKES UTILITIES, INC. (WS800) 200 WEATHERSFIELD AVENUE ALTAMONTE SPRINGS, FL 32714-4027		PATRICK C. FLYNN (407) 869-1919
FOUR LAKES GOLF CLUB, LTD. (WS815) P. O. BOX 5252 LAKELAND, FL 33807-5252		TODD MAXWELL (863) 647-1581
FOUR POINTS UTILITY CORPORATION (WS898) 101 GOLDEN MALAY PALM WAY DAVENPORT, FL 33897-8602		DENNA MEIXNER (863) 424-0130
GOLD COAST UTILITY CORP. (WS899) 12292 FLORIDA AVENUE STUART, FL 34994-9141		KEITH A. BURGE (772) 201-3299
GRENELEFE RESORT UTILITY, INC. (WS770) 5601 WINDHOVER DRIVE ORLANDO, FL 32819-7914		BILL GOAZIOU (407) 351-3350

**LIST OF WATER AND WASTEWATER UTILITIES IN POLK COUNTY
(VALID FOR 60 DAYS)
08/12/2008 - 10/10/2008**

<u>UTILITY NAME</u>	<u>MANAGER</u>
<u>POLK COUNTY</u>	
HIDDEN COVE, LTD. (WS814) P. O. BOX 5252 LAKELAND, FL 33807-5252	TODD MAXWELL (863) 647-1581
KEEN SALES, RENTALS AND UTILITIES, INC. (WU771) 685 DYSON ROAD HAINES CITY, FL 33844-8587	EARLENE KEEN (863) 421-6827
MOUNTAIN LAKE CORPORATION (WU791) P. O. BOX 832 LAKE WALES, FL 33859-0832	ROBERT E. MARTIN (863) 676-3494
ORCHID SPRINGS DEVELOPMENT CORPORATION (WS789) 250 AVENUE K, S.W., SUITE 103 WINTER HAVEN, FL 33880-3919	CAROL C. RHINEHART (863) 324-3698
PARK WATER COMPANY (WU776) 25 FIRST AVENUE NORTH LAKE WALES, FL 33859-8761	ANTHONY STAIANO (863) 638-1285
PINECREST RANCHES, INC. (WU779) P. O. BOX 2427 BARTOW, FL 33831-2427	S. NORMAN DUNCAN (863) 559-7997
PLANTATION LANDINGS, LTD. (WS813) P. O. BOX 5252 LAKELAND, FL 33807-5252	TODD MAXWELL (863) 647-1581
RIVER RANCH WATER MANAGEMENT, L.L.C. (WS850) 5601 WINDHOVER DRIVE ORLANDO, FL 32819-7936	MARK WALTRIP (407) 351-3351 EXT 101
S. V. UTILITIES, LTD. (WS812) P. O. BOX 5252 LAKELAND, FL 33807-5252	TODD MAXWELL (863) 647-1581
SUNRISE UTILITIES, LLC (WU870) P. O. BOX 566 HAINES CITY, FL 33845-0566	CHRISTIE MCCORMICK (863) 421-6827
TEVALO, INC. D/B/A MCLEOD GARDENS WATER COMPANY (WU841) P. O. BOX 2898 WINTER HAVEN, FL 33883-2898	LAURA V. GRIFFITH (863) 293-2577

**LIST OF WATER AND WASTEWATER UTILITIES IN POLK COUNTY
(VALID FOR 60 DAYS)
08/12/2008 - 10/10/2008**

UTILITY NAME

MANAGER

POLK COUNTY

WEST LAKELAND WASTEWATER, INC. (SU836)
P. O. BOX 2303
EATON PARK, FL 33840-2303

SUZZANE AVERETT BRITT
(863) 665-1748 EXT 25

**LIST OF WATER AND WASTEWATER UTILITIES IN POLK COUNTY
(VALID FOR 60 DAYS)
08/12/2008 - 10/10/2008**

UTILITY NAME

MANAGER

GOVERNMENTAL AGENCIES

CENTRAL FL. REGIONAL PLANNING COUNCIL
P.O. BOX 2089
BARTOW, FL 33831

CITY MANAGER, CITY OF BARTOW
450 NORTH WILSON
BARTOW, FL 33831-3954

CLERK, BOARD OF COUNTY COMMISSIONERS, POLK COUNTY
P. O. BOX 9000, DRAWER CC-1
BARTOW, FL 33831-9000

DEP CENTRAL DISTRICT
3319 MAGUIRE BLVD., SUITE 232
ORLANDO, FL 32803-3767

DEP SOUTHWEST DISTRICT
3804 COCONUT PALM DRIVE
TAMPA, FL 33618-8318

MAYOR, CITY OF AUBURNDALE
P. O. BOX 186
AUBURNDALE, FL 33823-0186

MAYOR, CITY OF DAVENPORT
P. O. BOX 125
DAVENPORT, FL 33836-0125

MAYOR, CITY OF EAGLE LAKE
P. O. BOX 129
EAGLE LAKE, FL 33839-0129

MAYOR, CITY OF FROSTPROOF
P. O. BOX 308
FROSTPROOF, FL 33843-0308

MAYOR, CITY OF FT. MEADE
P. O. BOX 856
FT. MEADE, FL 33841-0856

MAYOR, CITY OF HAINES CITY
P. O. BOX 1507
HAINES CITY, FL 33845-1507

**LIST OF WATER AND WASTEWATER UTILITIES IN POLK COUNTY
(VALID FOR 60 DAYS)
08/12/2008 - 10/10/2008**

UTILITY NAME

MANAGER

GOVERNMENTAL AGENCIES

MAYOR, CITY OF LAKE ALFRED
120 EAST POMELO STREET
LAKE ALFRED, FL 33850-2136

MAYOR, CITY OF LAKE WALES
P. O. BOX 1320
LAKE WALES, FL 33859-1320

MAYOR, CITY OF LAKELAND
228 SOUTH MASSACHUSETTS AVENUE
LAKELAND, FL 33801-5086

MAYOR, CITY OF MULBERRY
P. O. BOX 707
MULBERRY, FL 33860-0707

MAYOR, CITY OF WINTER HAVEN
P. O. BOX 2277
WINTER HAVEN, FL 33883-2277

MAYOR, TOWN OF DUNDEE
P. O. BOX 1000
DUNDEE, FL 33838-1000

MAYOR, TOWN OF HILLCREST HEIGHTS
151 SCENIC HIGHWAY, N.
P. O. BOX 129
BABSON PARK, FL 33827-0127

MAYOR, TOWN OF LAKE HAMILTON
P. O. BOX 126
LAKE HAMILTON, FL 33851-0126

MAYOR, TOWN OF POLK CITY
P. O. BOX 1139
POLK CITY, FL 33868-1139

MAYOR, VILLAGE OF HIGHLAND PARK
1337 NORTH HIGHLAND PARK
LAKE WALES, FL 33853-7422

S.W. FLORIDA WATER MANAGEMENT DISTRICT
2379 BROAD STREET
BROOKSVILLE, FL 34609-6899

**LIST OF WATER AND WASTEWATER UTILITIES IN POLK COUNTY
(VALID FOR 60 DAYS)
08/12/2008 - 10/10/2008**

UTILITY NAME

MANAGER

GOVERNMENTAL AGENCIES

SO. FLORIDA WATER MANAGEMENT DISTRICT
P.O. BOX 24680
WEST PALM BEACH, FL 33416-4680

**LIST OF WATER AND WASTEWATER UTILITIES IN POLK COUNTY
(VALID FOR 60 DAYS)
08/12/2008 - 10/10/2008**

UTILITY NAME

MANAGER

STATE OFFICIALS

STATE OF FLORIDA PUBLIC COUNSEL
C/O THE HOUSE OF REPRESENTATIVES
THE CAPITOL
TALLAHASSEE, FL 32399-1300

OFFICE OF COMMISSION CLERK
FLORIDA PUBLIC SERVICE COMMISSION
2540 SHUMARD OAK BOULEVARD
TALLAHASSEE, FL 32399-0850

EXHIBIT "I"

(AFFIDAVIT OF NOTICE OF APPLICATION TO PROPERTY OWNERS)

AFFIDAVIT OF MAILING

STATE OF FLORIDA

COUNTY OF SEMINOLE

BEFORE ME, the undersigned authority, authorized to administer oaths and take acknowledgments, personally appeared Michele Parks, who, after being duly sworn on oath, did depose on oath and say that she is the Legal Assistant to Martin S. Friedman, Esquire, attorney for Gold Coast Utility Corp., and that on the 8th day of September, 2008, she did send by regular U.S. mail, a copy of the notice attached hereto to each of the property owners in the proposed territory.

FURTHER AFFIANT SAYETH NAUGHT.

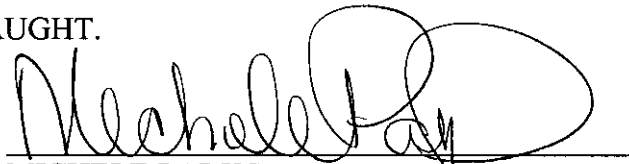

MICHELE PARKS

Sworn to and subscribed before me this 8TH day of September, 2008, by Michele Parks, who is personally known to me.

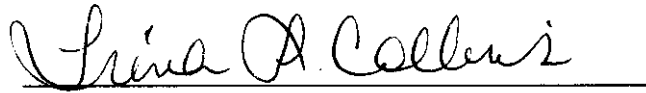

NOTARY PUBLIC – STATE OF FLORIDA
Printed Name: _____
My Commission Expires: _____



**NOTICE OF APPLICATION FOR AN EXTENSION OF SERVICE AREA
BY GOLD COAST UTILITY CORP. IN POLK COUNTY, FLORIDA**

NOTICE IS HEREBY GIVEN on this 8th day of September, 2008, pursuant to Section 367.045, Florida Statutes, and Section 25-30.030, Florida Administrative Code, of the of the Application of Gold Coast Utility Corp., to amend Water Certificate No. 590-W and Wastewater Certificate No. 508-S, to add territory in Polk County, Florida. The Applicant proposes to extend its existing certificated water and wastewater service area to include the following land in Polk County, Florida:

In Section 6, Township 30 South, Range 29 East, Polk County, Florida

The West ½ of the SE ¼ of the SW ¼ and the East ½ of the SW ¼ of the SW ¼

AND

In Section 7, Township 30 South, Range 29 East, Polk County, Florida

In the NE ¼, less the East 40' for County Road and less a parcel beginning at the SE corner of the NE ¼ of the section, thence N 89°04'47" West along the South boundary of said NE ¼ a net distance of 330.00 feet, thence North parallel with the East boundary of said NE ¼ a net distance of 330.00 feet, thence S 89°04'47" East parallel with said South boundary a net distance of 330.00 feet to said East boundary, thence South along said East boundary a net distance of 330.00 feet to the Point of Beginning, subject to Right-of-Way of Boy Scout Camp Road

AND

The NE ¼ of the NW ¼.

AND

In Section 1, Township 30 South, Range 28 East

The SE ¼

AND

In Section 6, Township 30 South, Range 28

The West ½ of the Southwest ¼, all of which property is located in Polk County, Florida.

Any objections to the Application must be made in writing and filed with the Commission Clerk, Office of Commission Clerk, Florida Public Service Commission, 2540 Shumard Oak Boulevard, Tallahassee, Florida 32399-0850, no later than 30 days from the date of this Notice, with a copy to Martin S. Friedman, Esquire, Rose, Sundstrom & Bentley, LLP, 2180 W. State Road 434, Suite 2118, Longwood, Florida 32779. The objection must state the grounds for the objection with particularity.

Gold Coast Utility Corp.
(863) 696-0504

EXHIBIT "J"
(AFFIDAVIT OF PUBLICATION)
TO BE LATE FILED