

BEFORE THE FLORIDA PUBLIC SERVICE COMMISSION

090009-EI

ATTACHMENT B

COM _____
ECR 1
GCL _____
OPC _____
RCP _____
SSC _____
SGA _____
ADM _____
CLK _____

CONFIDENTIAL

Question 65.

Please identify the steps taken to undertake any analysis or determination of the costs and/or benefits of signing the EPC contract on a date after December 31, 2008. If no analysis of the sort was done, please state how, from a prudent expenditure of funds standpoint, the determination to sign the SSW/WEC EPC was made. Please identify all documents relating to or containing such analyses or determination.

Answer

It is unclear what is meant by the "analysis" or "determination" of "costs and/or benefits" in this question. PEF was not required to do a cost benefit analysis before signing the EPC contract, because the total overall project cost was within the estimate provided in the need determination proceeding. Nevertheless, PEF considered myriad factors prior to executing the EPC contract. For example, PEF considered all of the contractual provisions as a whole in determining whether the EPC contract represented a reasonable overall deal given the market conditions at the time. As a result of PEF's more than two years of tough negotiating, the EPC agreement included a number of provisions favorable to PEF and its customers, including but not limited to:

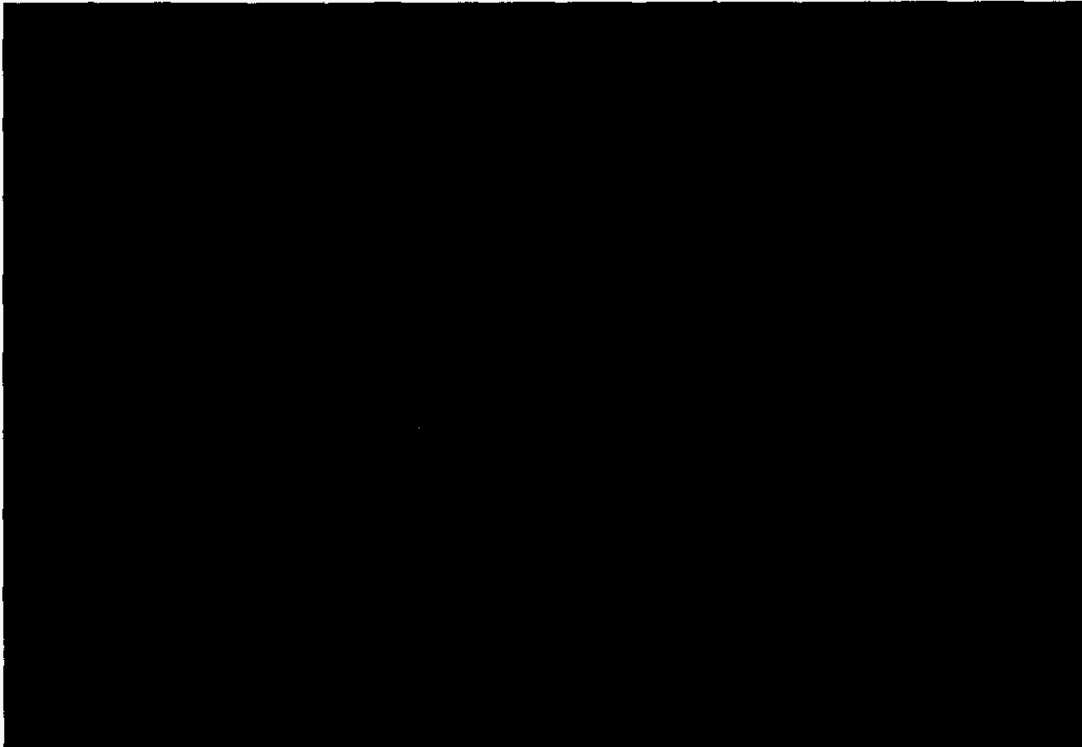

15277733.1 00309-39362

DOCUMENT NUMBER-DATE

07723 JUL 28 08

FPSC-COMMISSION CLERK



Furthermore, PEF's understanding of the regulatory environment indicated that if PEF retained the right to suspend work through the EPC, PEF would be able to ensure that any licensing risk was no greater than it would have been had execution of the EPC been postponed until after the NRC issued the COL/LWA schedule. Rather, PEF believed that the execution of the EPC Agreement would actually reduce the licensing risk to the extent the NRC understood the contractual commitment to move forward with the LNP when the NRC considered the review schedule for the LNP. Also, please see PEF's response to OPC Interrogatory No. 63.

Levy Nuclear Plant Integrated Project Plan (IPP)

Presentation to Senior Management
September 8th, 2008



*Specific slides (marked) in this presentation
contain PGN Proprietary and Confidential
Information, and should be treated as such.*



Levy Nuclear Project

Key Activities to Date

- Dec 2006 – Levy Site Announced
- Sep 2007 – Closing on 3,105 acre “Rayonier” site
- Dec 2007 – Closing on 2,159 acre “Lybass” site
- Mar 2008 – Petition for Levy Need Determination submitted
- Mar 2008 – LOI executed for Long-Lead Equipment
- Mar 2008 – Levy Comp Plan Land Amendment **Approved**
- Jun 2008 – Site Certification Application (SCA) submitted
- Jul 2008 – Combined License Application (COLA) submitted
- Jul 2008 – Limited Work authorization (LWA) submitted
- Aug 2008 – FL PSC Order on Levy Need Petition **Issued**
- Aug 2008 – EPC Offer to WEC/SSW by PGN CEO
- Sep 2008 – Levy “Special Exception” Zoning **Approved**

Levy Site Location

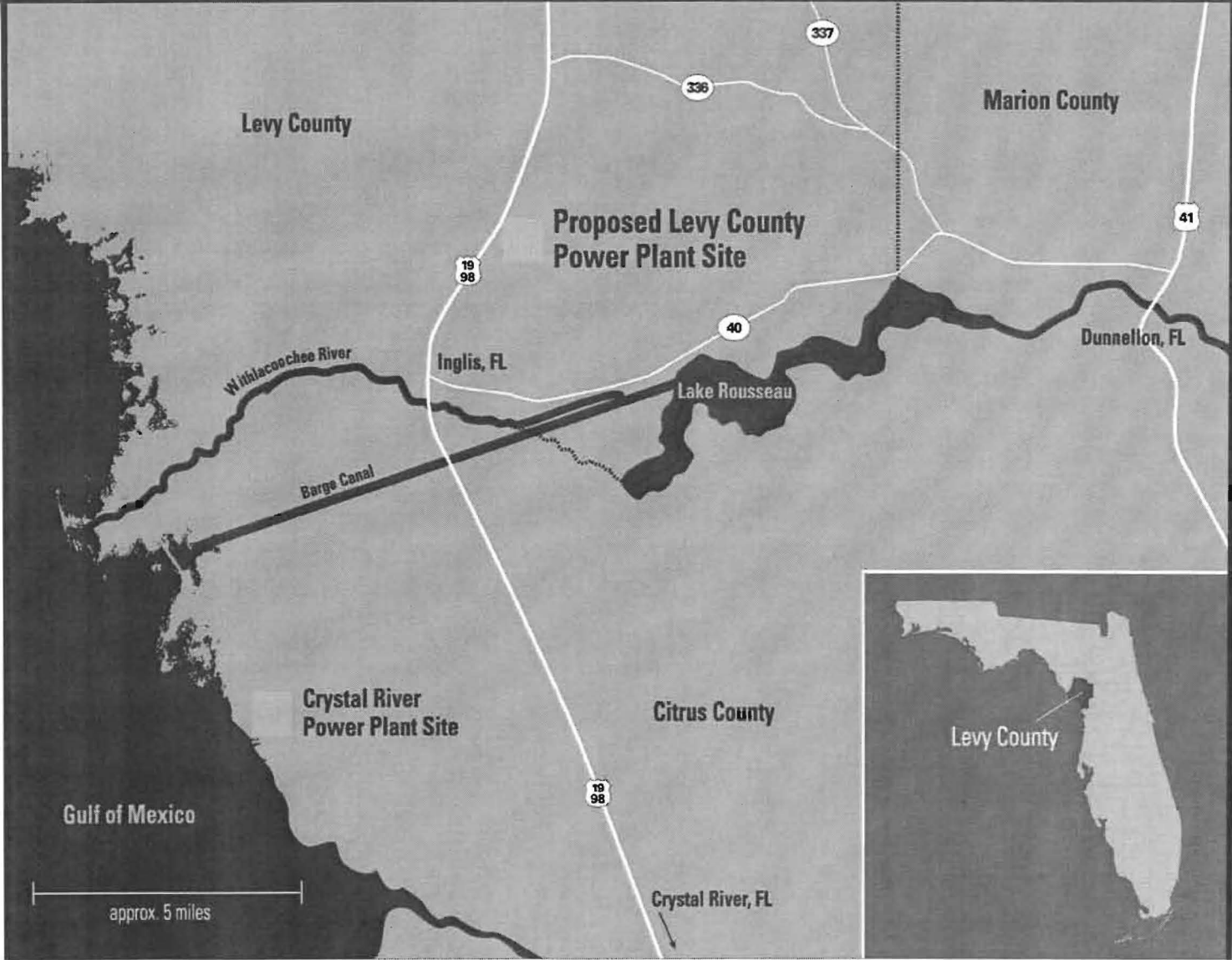

Levy Site

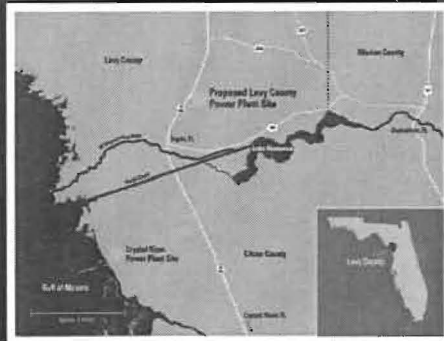

Units 1 & 2
Make-Up
Pumphouse



AP1000

Artist Conceptual View

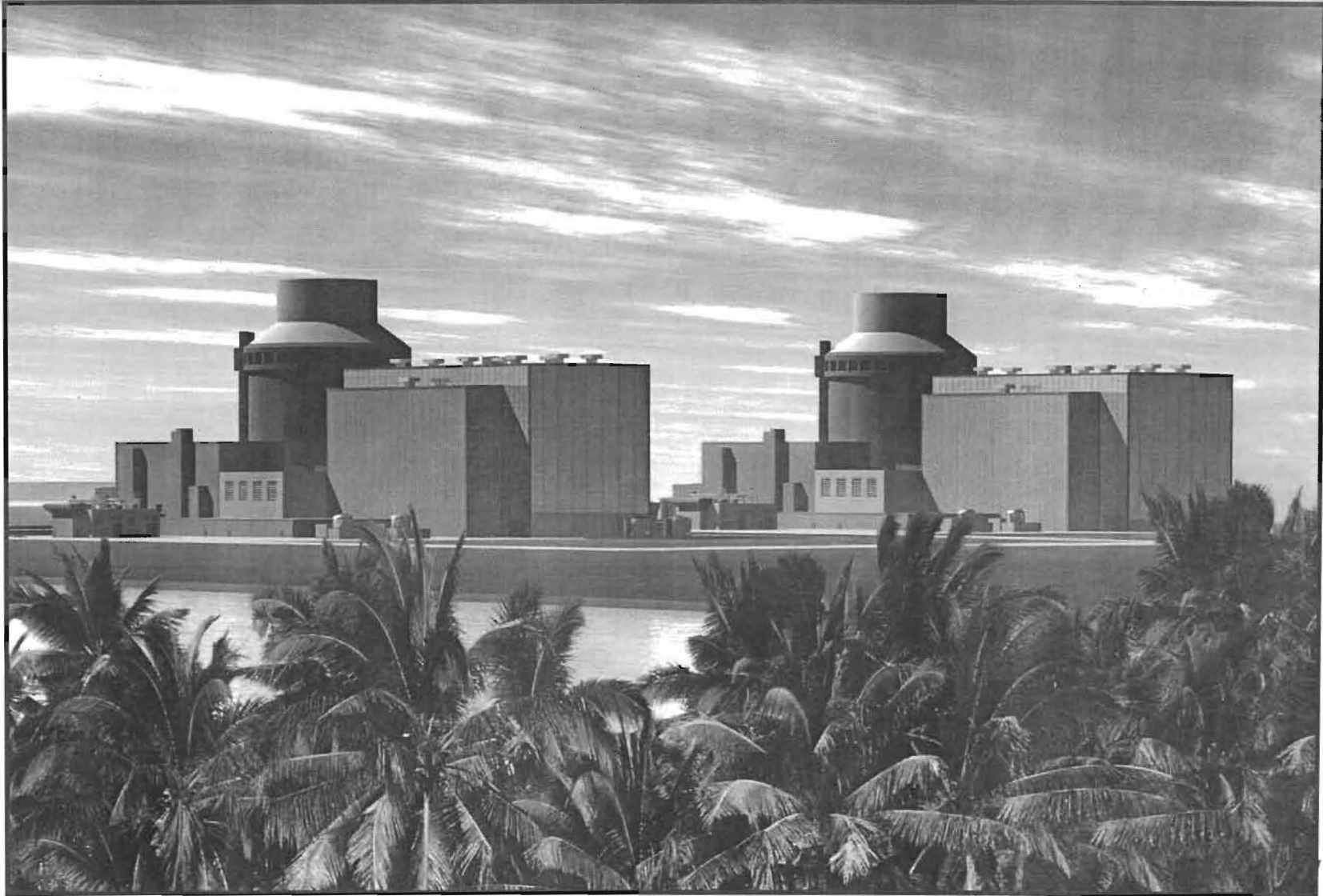

Levy Site Layout

(Graphic from Levy Zoning Application)

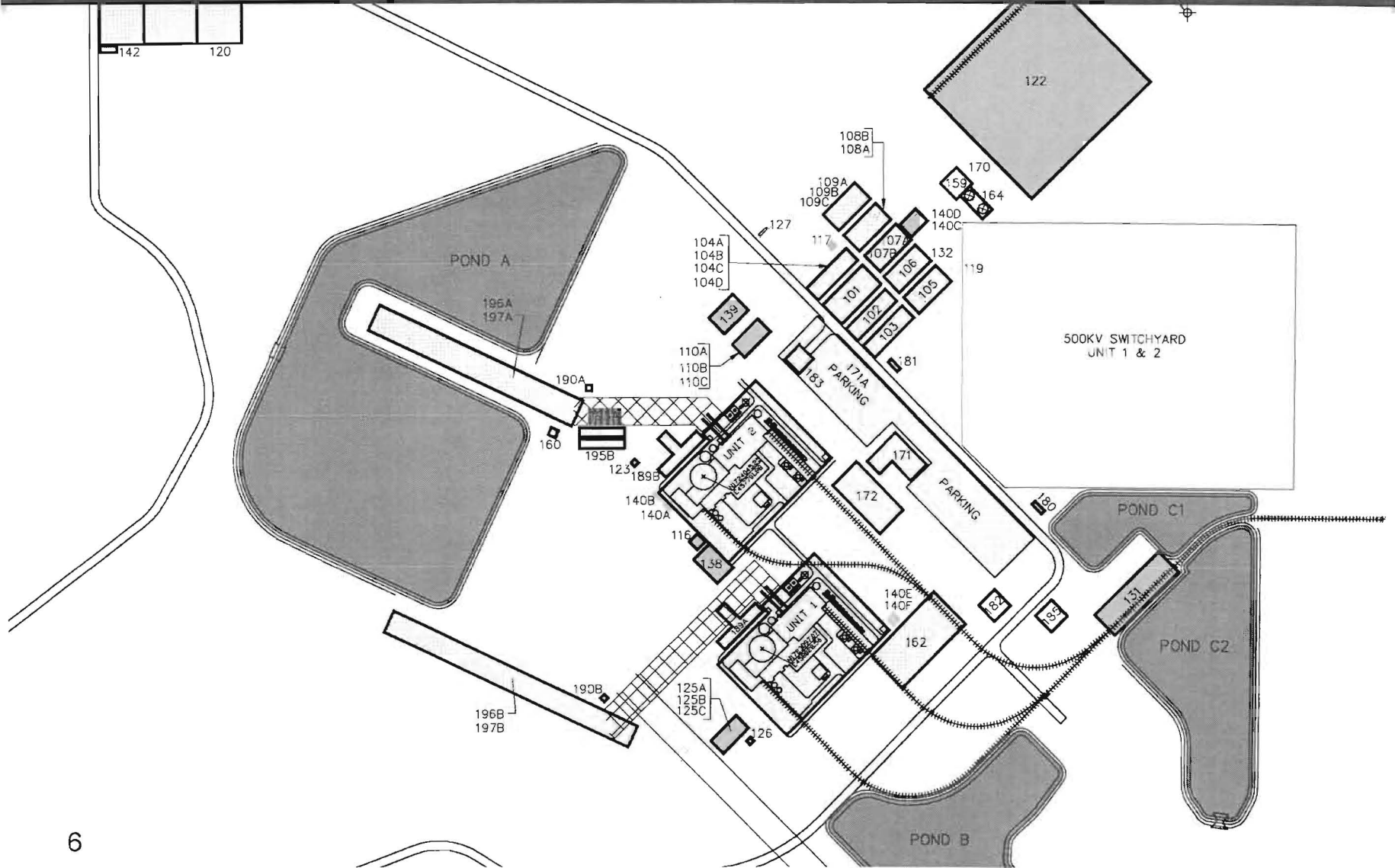

Levy Nuclear Plant

Common Nuclear & Transmission Project Risk

Program Key Risk ID

1. Cost escalation/estimate validity
2. Project scope change
3. Availability of skilled craft labor
4. Project Financing
5. Land Acquisition
6. State and Local Permitting, including Public Acceptance
7. Federal Licensing and State Certification Approval for Construction

Likelihood

Very High
High
Moderate
Low
Very Low

		5			
		1	3		
	2, 6	4			
		7			

Minimal Moderate Significant Severe Critical Consequence

Overall Project Risk Assessment

Cost	Schedule	Performance	Safety	Environmental
↑ G	↑ G	↔ G	↔ G	↔ G

Barge Canal

(Looking West)



Crystal River Site

Discharge Canal



Levy Site Industrial Rail Spur

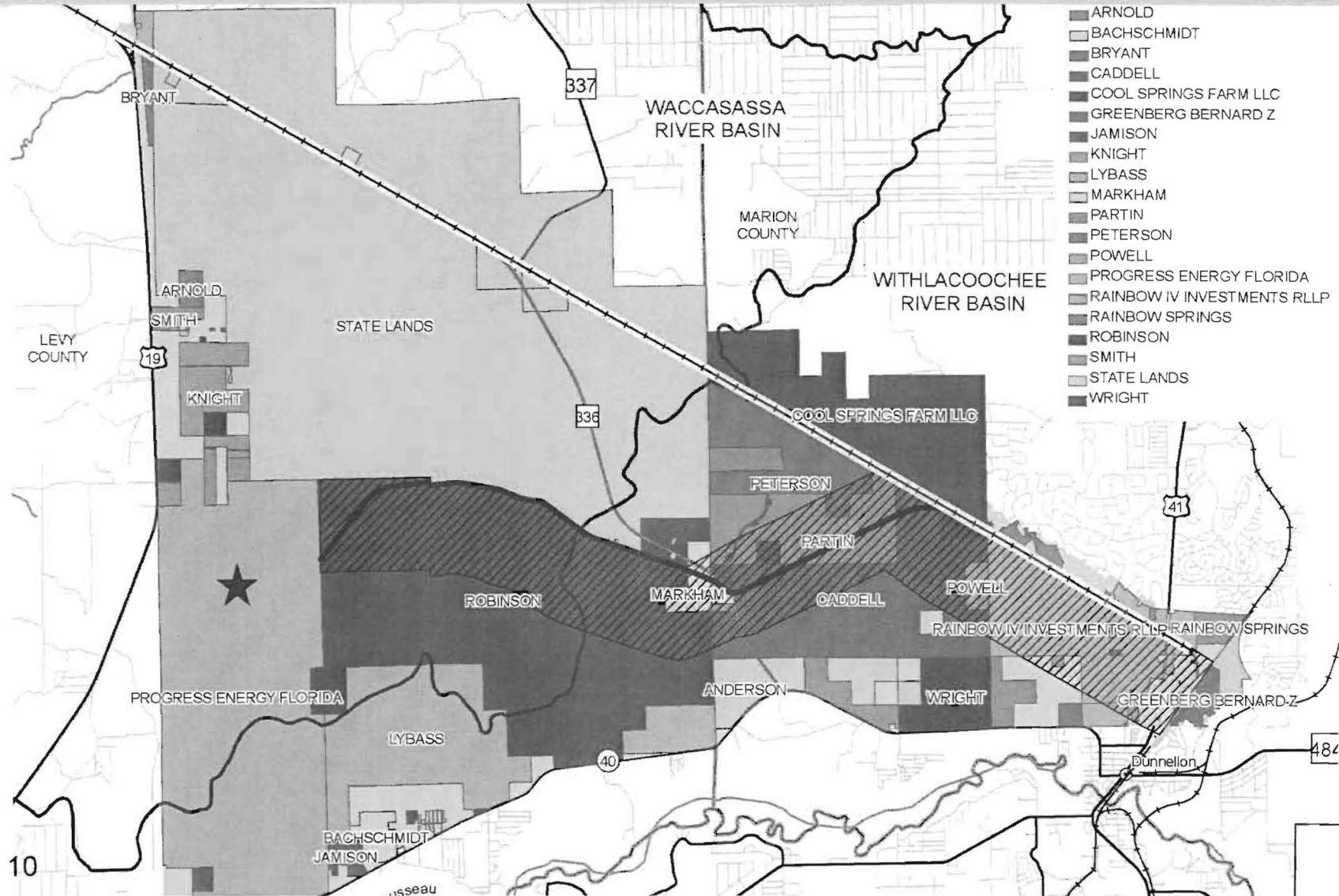

AP1000 Reactor Technology

Design Certification

Sept 2004 Staff Final Design Approval (Rev 15)
Dec 2005 Commission Approval (Rev 15)
Jan 2007 Final Rule Issued (Rev 15)

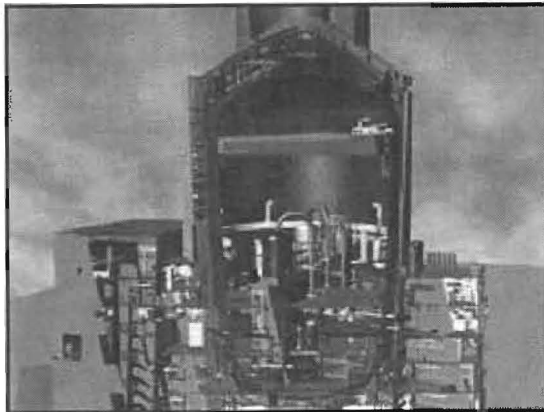

 **U.S. NRC**
UNITED STATES NUCLEAR REGULATORY COMMISSION

Protecting People and the Environment

About NRC	Nuclear Reactors	Nuclear Materials	Radioactive Waste	Nuclear Security	Public Meetings & Involvement
---------------------------	----------------------------------	-----------------------------------	-----------------------------------	----------------------------------	---

Home > Electronic Reading Room > Document Collections > NRC Regulations (10 CFR) > Part Index > Appendix D to Part 52-- Design Certification Rule for the AP1000 Design

Appendix D to Part 52-- Design Certification Rule for the AP1000 Design

I. Introduction

Appendix D constitutes the standard design certification for the AP1000³ design, in accordance with 10 CFR part 52, subpart B. The applicant for certification of the AP1000 design is Westinghouse Electric Company LLC.

II. Definitions

A. *Generic design control document (generic DCD)* means the document containing the Tier 1 and Tier 2 information and generic technical specifications that is incorporated by reference into this appendix.

B. *Generic technical specifications* means the information required by 10 CFR 50.36 and 50.36a for the portion of the plant that is within the scope of this appendix.

C. *Plant-specific DCD* means the document maintained by an applicant or licensee who references this appendix consisting of the information in the generic DCD as modified and supplemented by the plant-specific departures and exemptions made under Section VIII of this appendix.

D. *Tier 1* means the portion of the design-related information contained in the generic DCD that is approved and certified by this appendix (Tier 1 information). The design descriptions, interface requirements, and site parameters are derived from Tier 2 information. Tier 1 information includes:

1. Definitions and general provisions;

AP1000 Reactor Technology

Design Certification (continued)

May 2007	WEC Submits DCD Amendment request (Rev 16)
Jan 2008	NRC docket DCD Amendment request (Rev 16)
Mar 2010	Initial NRC Estimate of Final SER (Rev 16)
Apr 2011	Initial NRC estimate of Final Rule Making (Rev 16)

but....

Jun 2008	NRC Letter on Extending DCD Amendment Schedule
Sep 2008	WEC to submit updated DCD Amendment (Rev 17)
4 th Qtr 2008	NRC to issue revised DCD Amendment Schedule <i>(potential 3 to 6 month schedule shift)</i>

Revision 17 Significant Changes

- Change to Integrated Head Package design
- Revision to 50.46 analyses methodology (Cobra-Trac)
- Revised station battery voltage (125 V to 250 V)



Operational Experience

NuStart



Operational Experience

AP1000 NuStart Members

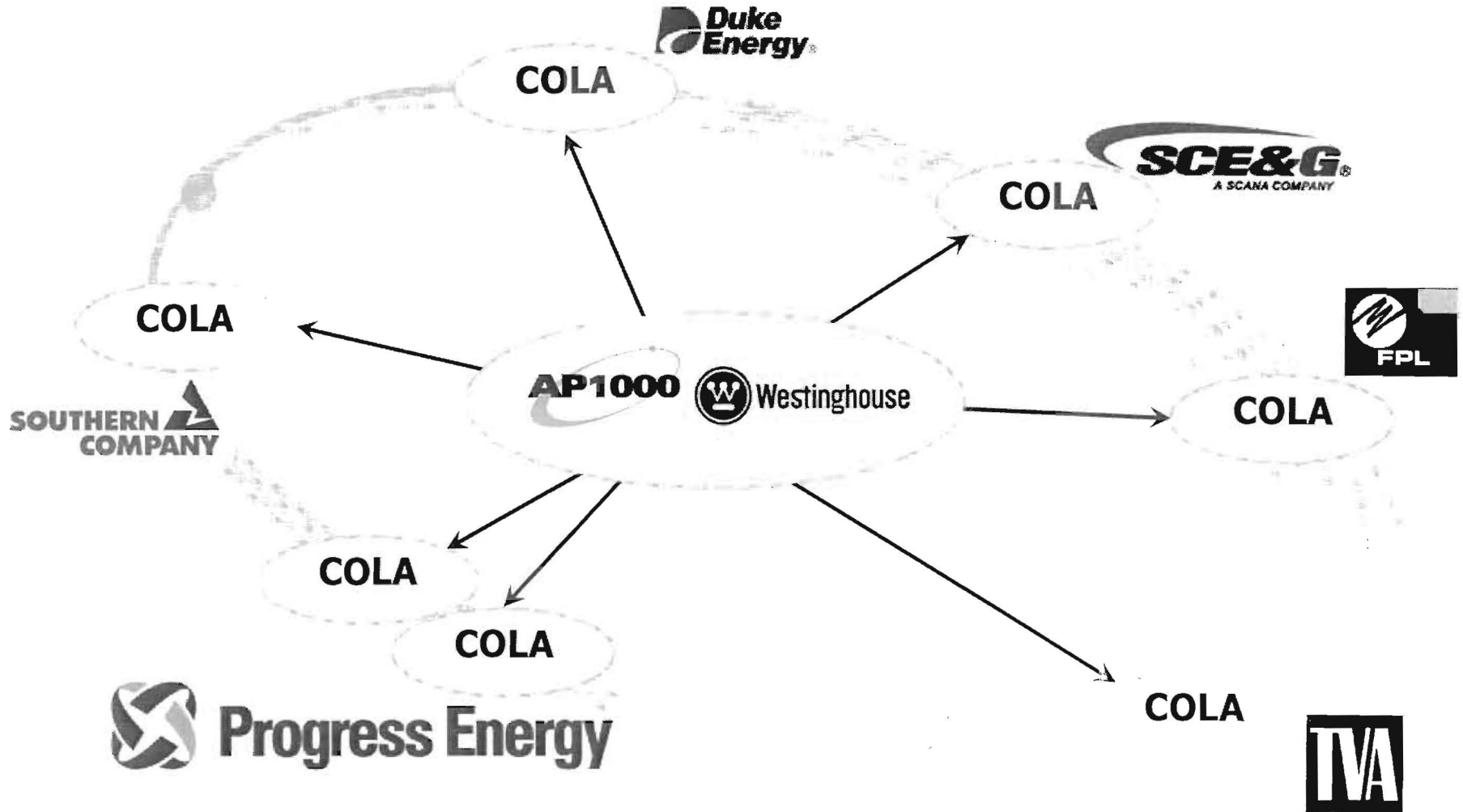

Levy Management Organization

Nuclear Projects & Construction (NP&C)

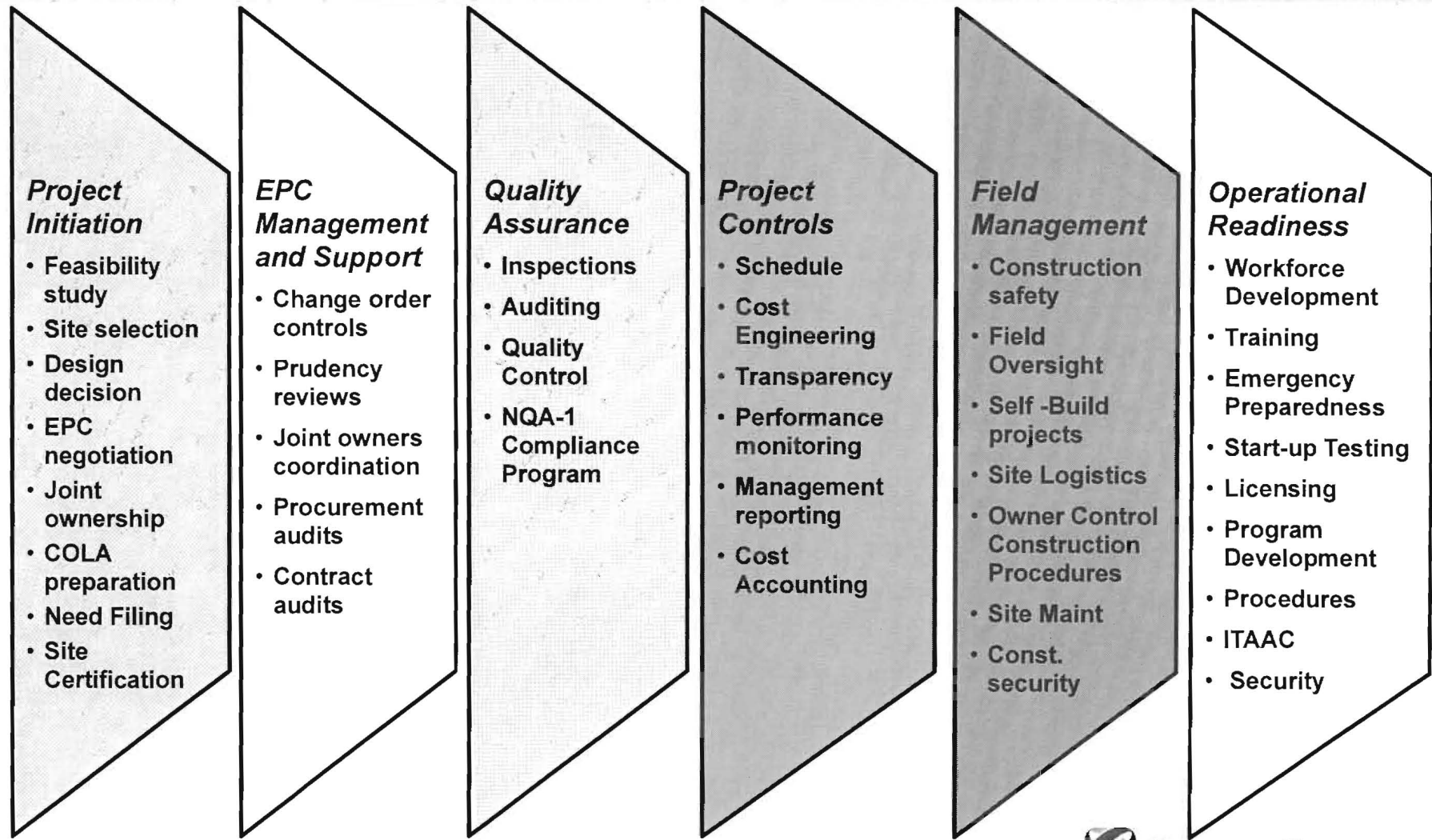

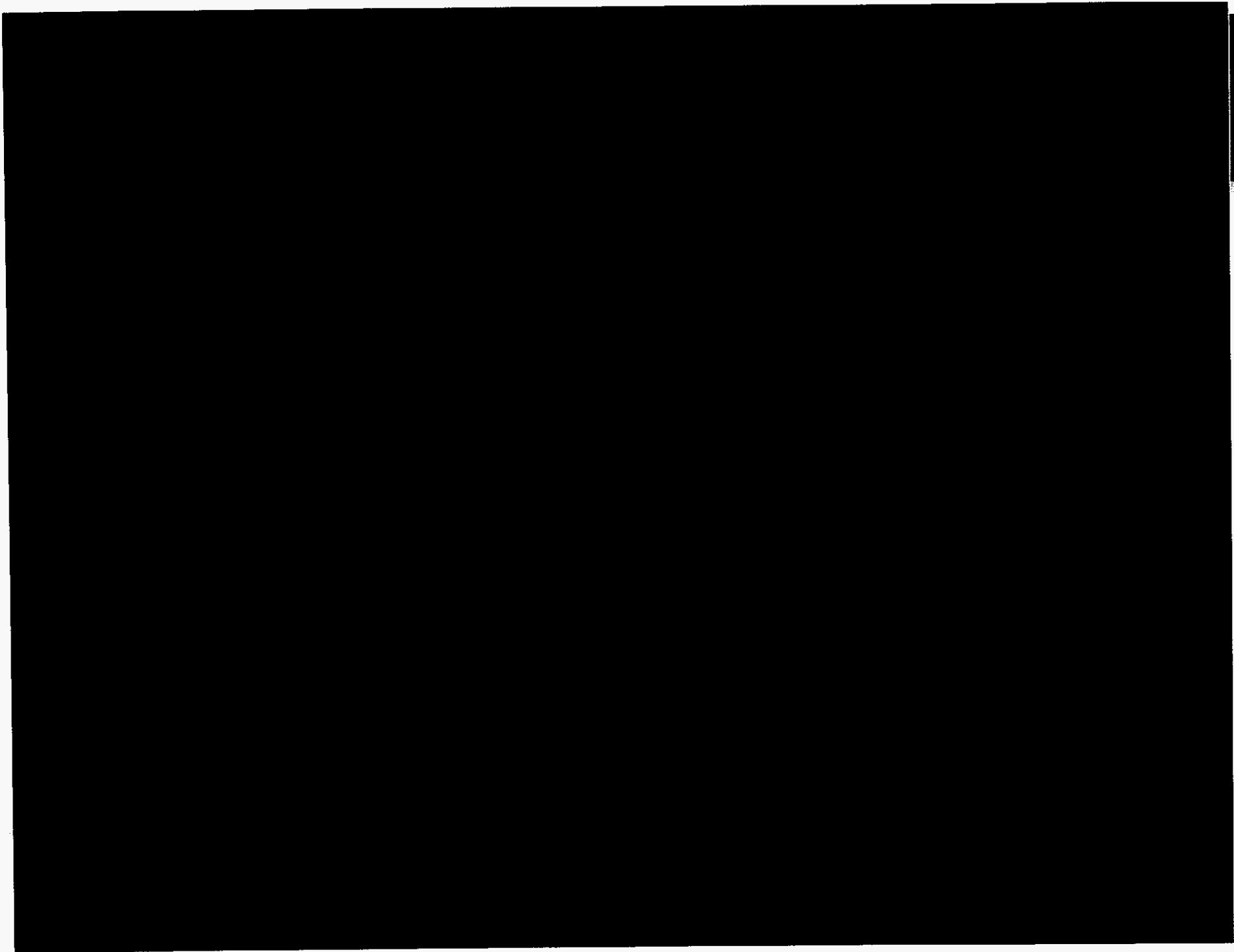

09NC-OPCP0D7-89-000016

Levy Staffing

Construction & Project Management and Permanent

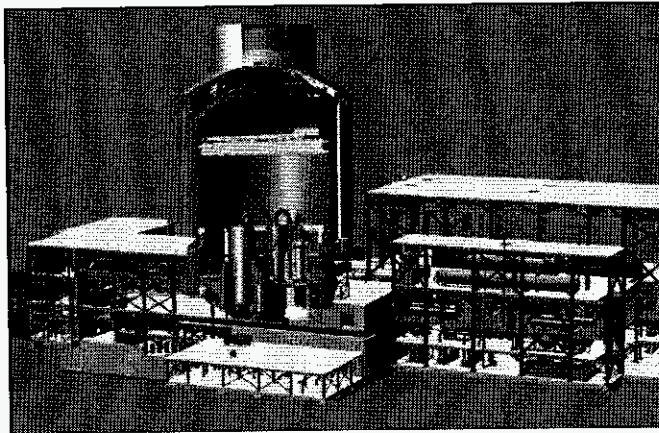

Construction & Project Management

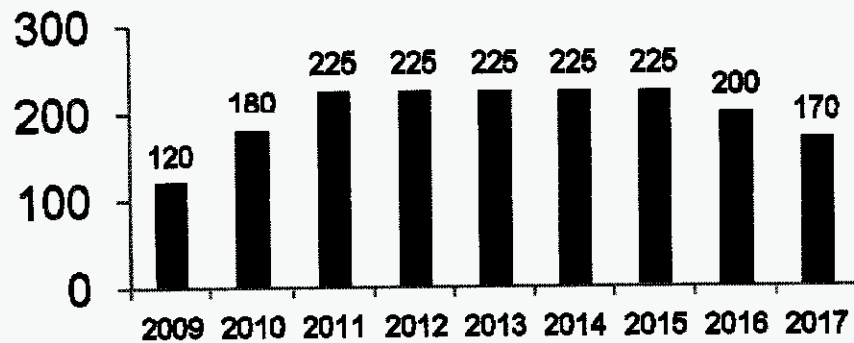

Permanent

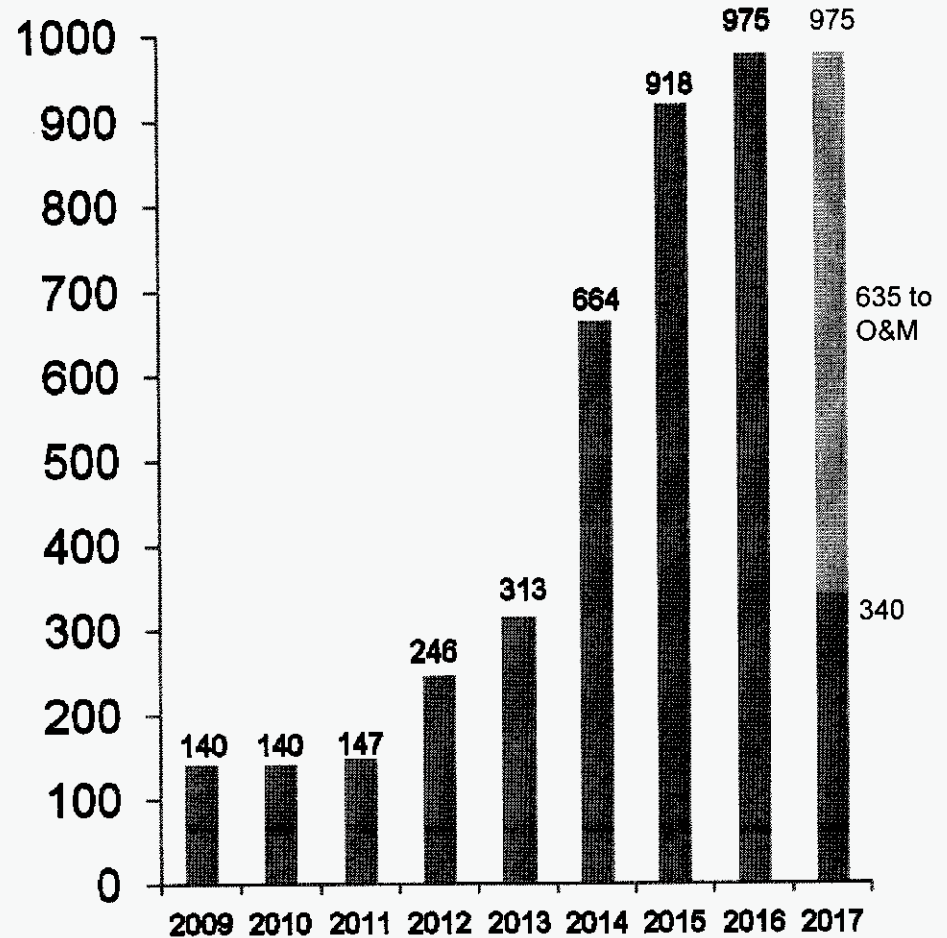

Levy Staffing Operations Pipeline

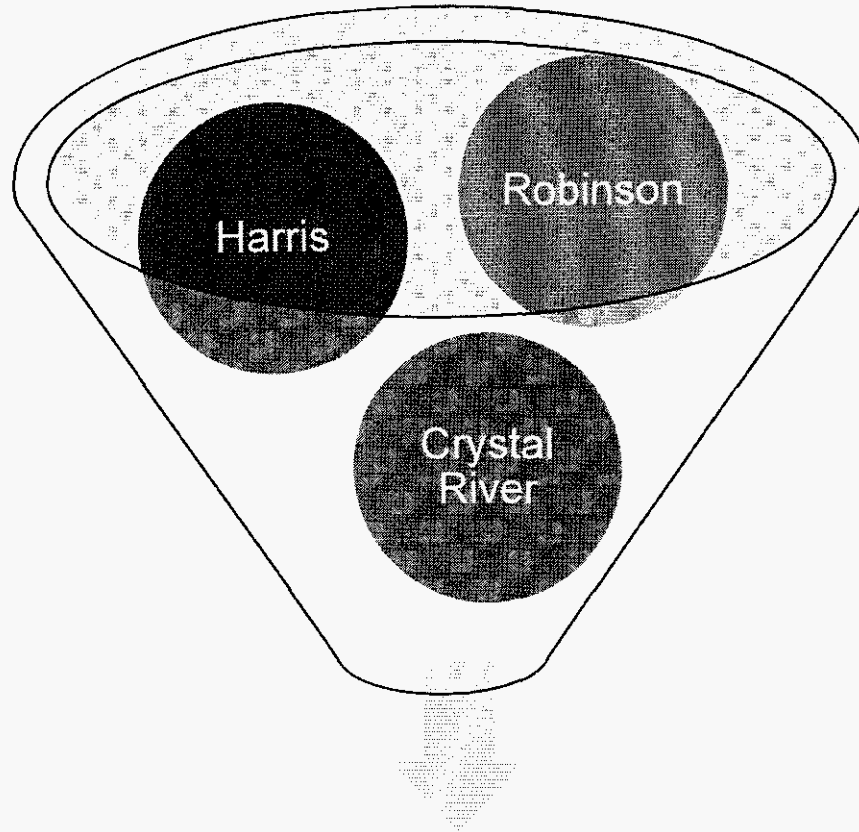

Levy Operations Staff

Licensed Operators

RNP - Starting in 2010: add 10 operators every other year for the next 4 years (30 total) Levy License class 2011, 2013, 2015

HNP - Starting in 2010: add 10 operators every other year for the next 4 years (30 total) Levy License Class 2012, 2014, 2016

CR3 - Starting 2009: 10 operators each year for the next 4 years (40 total) Levy License Class 2011, 2012, 2013, 2014

Non Licensed Operators

RNP- Starting in 2012: Add 10 NLOs each year for 2 years

HNP: - Starting in 2012: Add 10 NLOs each year for 2 years

CR3 - Starting in 2009: Add 10 NLOs each year for 6 years; feed Levy starting in 2012



Levy Estimated Timeline

1st Unit

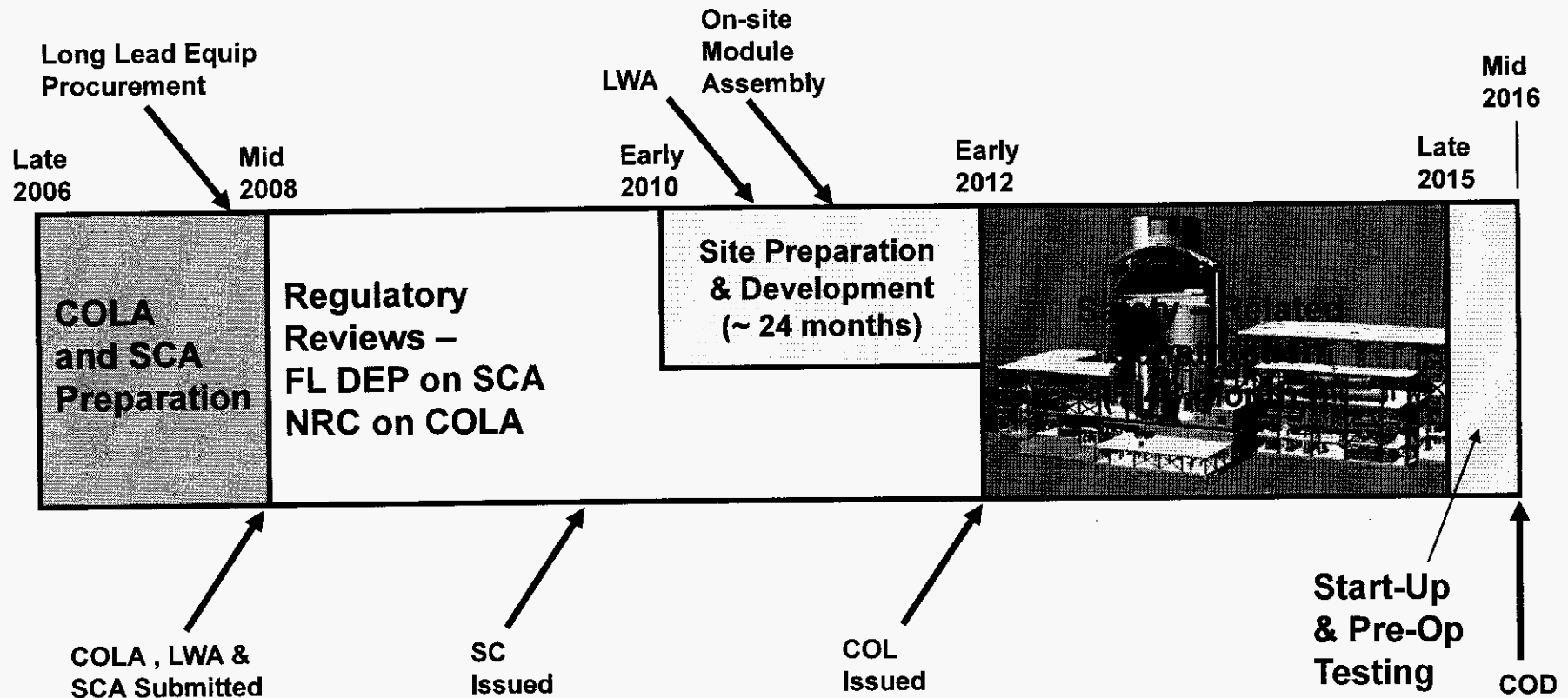

COLA – Combined Construction & Operating License Application
 SCA – Site Certification Application



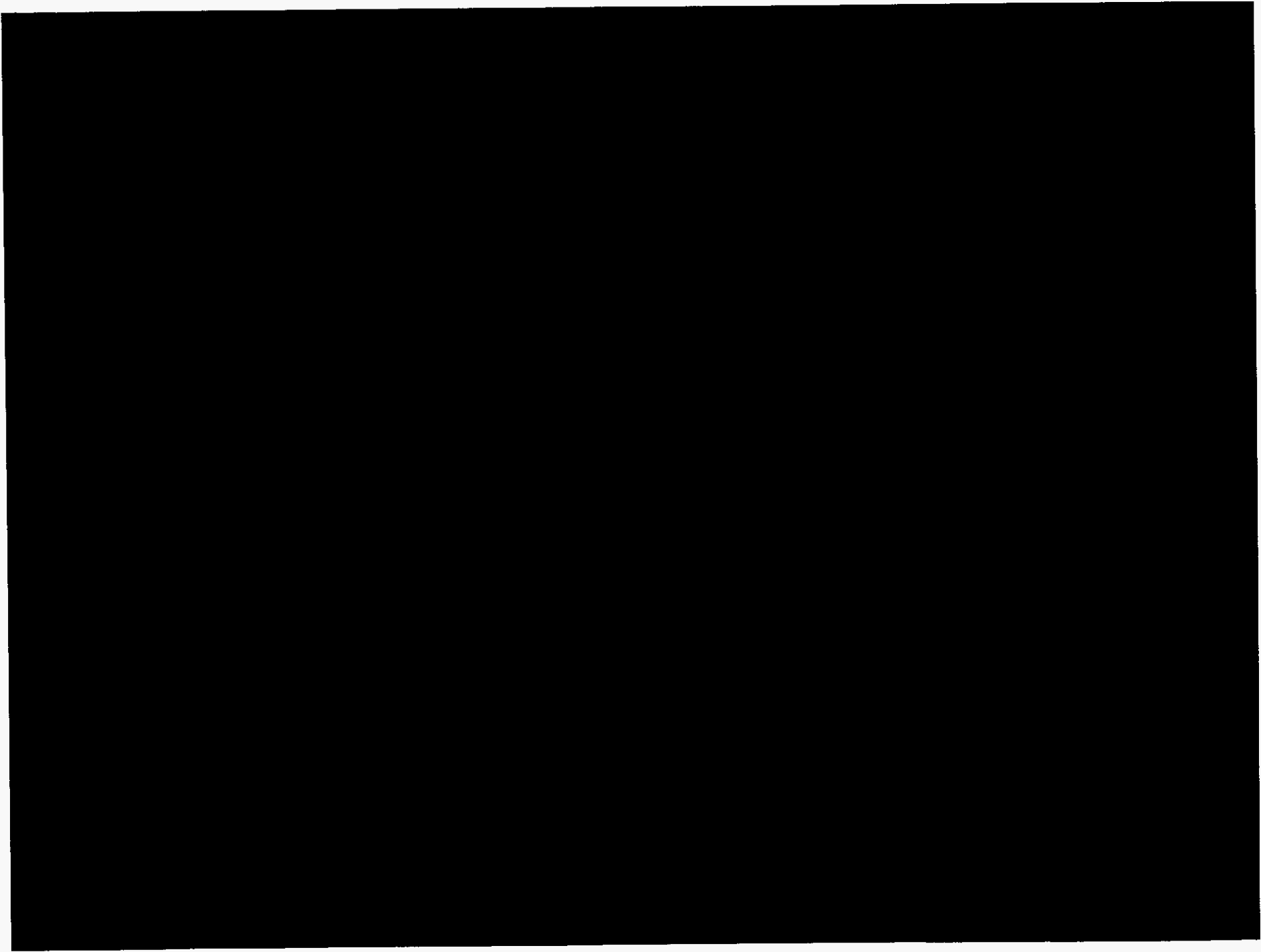

09N09NC-OPCP0D7-89-00002122

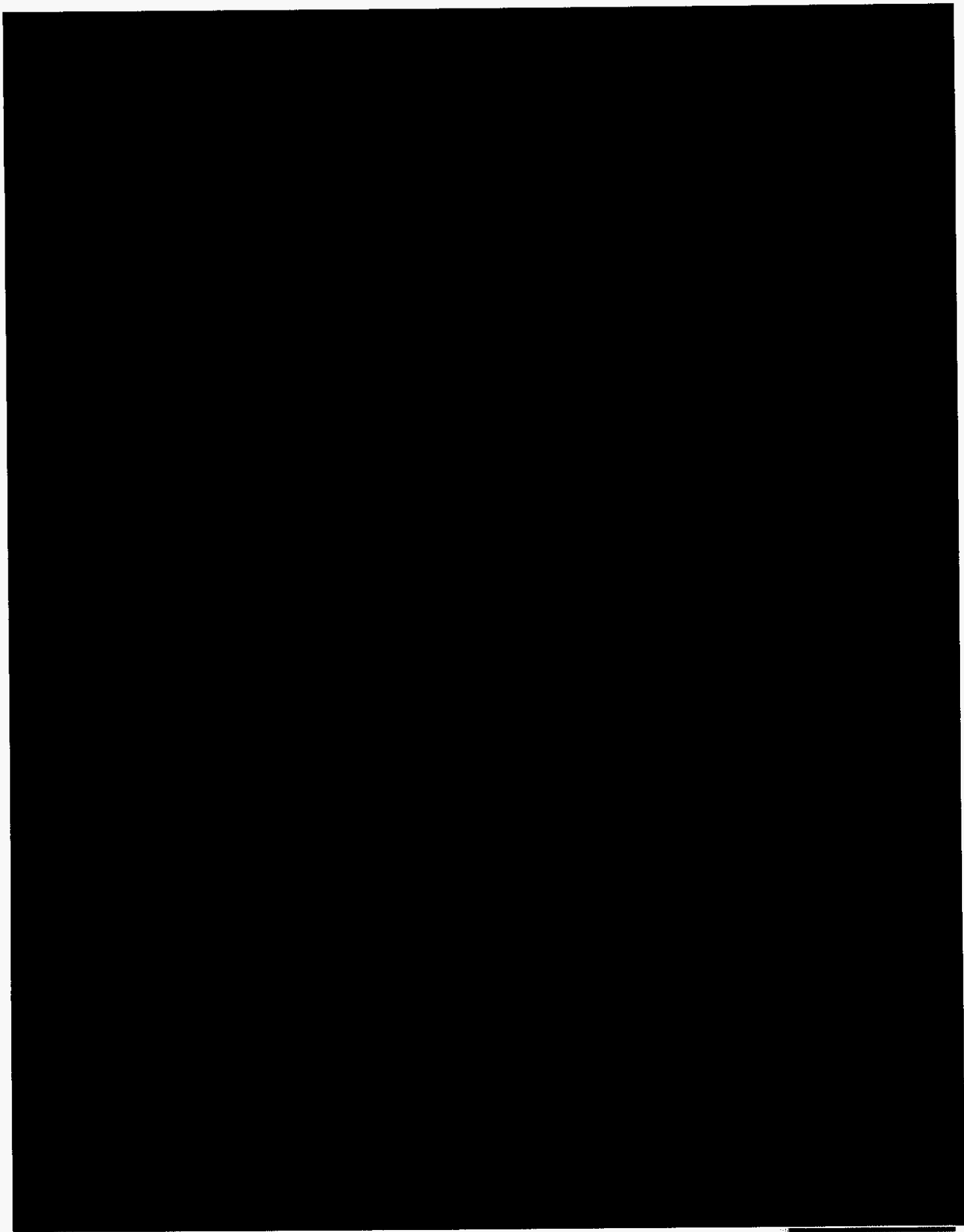

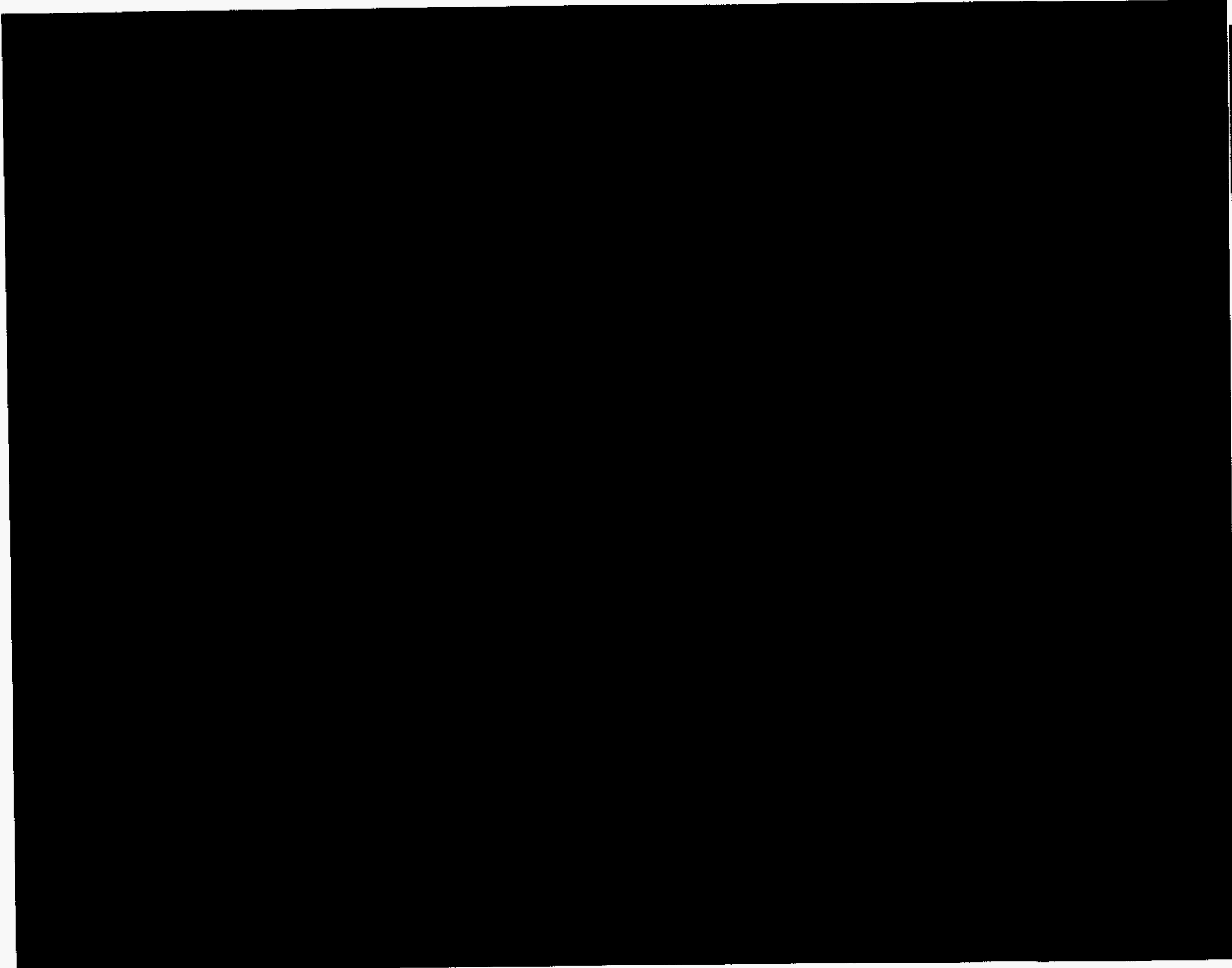

09NC-OPCPOD7-89-000022

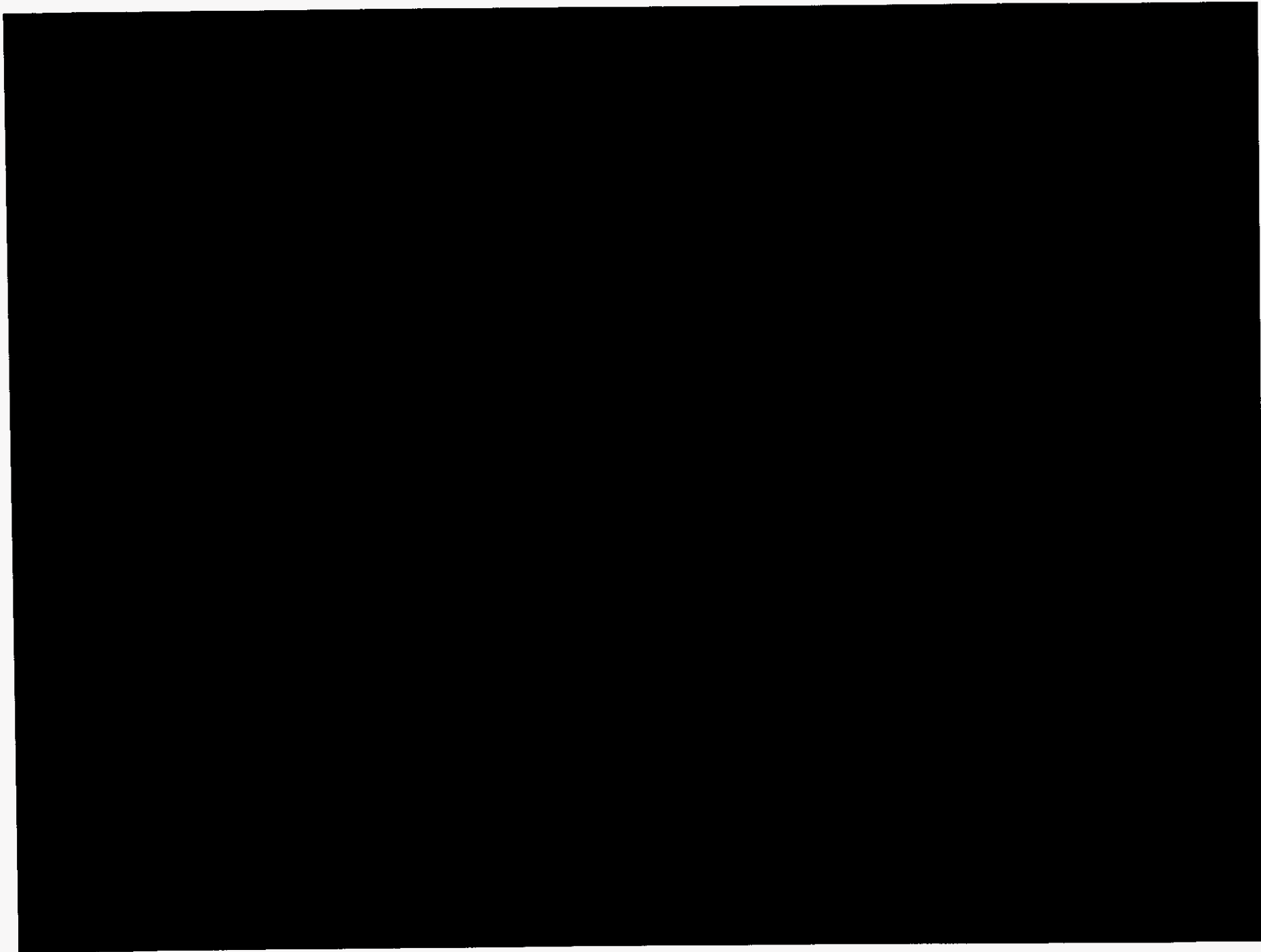

09NC-OPCPOD7-9-000023

Levy Nuclear Plant

Nuclear - Project Risk

Program Key Risk ID

- 8. Limited Work Authorization (LWA) Approval
- 9. QA Program Implementation
- 10. Achieving Plant Training and Staffing Objectives
- 11. Site Geotechnical Challenges

Likelihood

Very High

High

Moderate

Low

Very Low

		9			
					8, 10 11

Minimal

Moderate

Significant

Severe

Critical

Consequence

Overall Project Risk Assessment

Cost	Schedule	Performance	Safety	Environmental
↑	↑	↔	↔	↔



Levy Regulatory Logic



LEVY REGULATORY LOGIC (Dates Are Estimated)

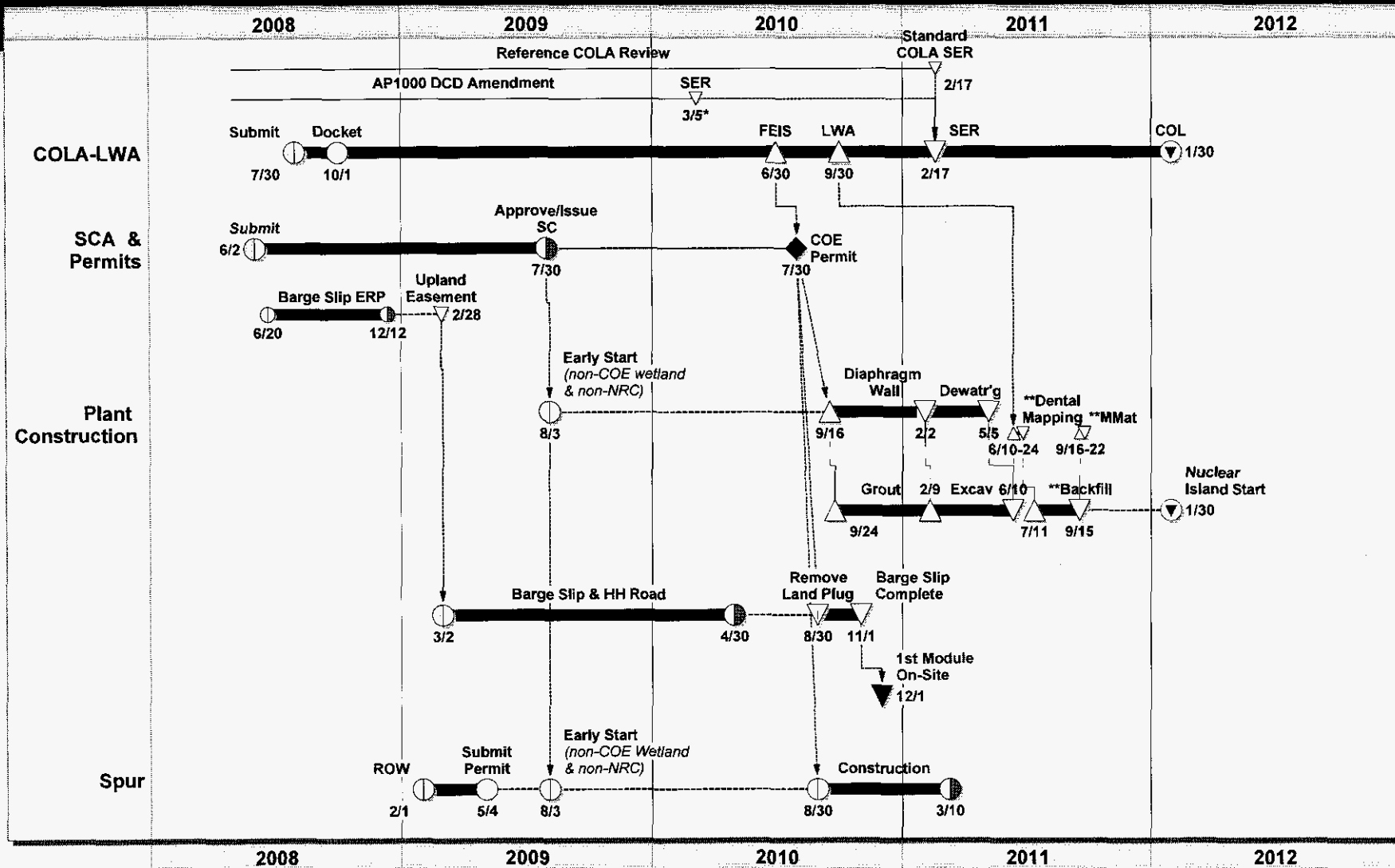

* Date is likely to be revised by NRC.
** LWA Scope



Levy Site Foundation Concept

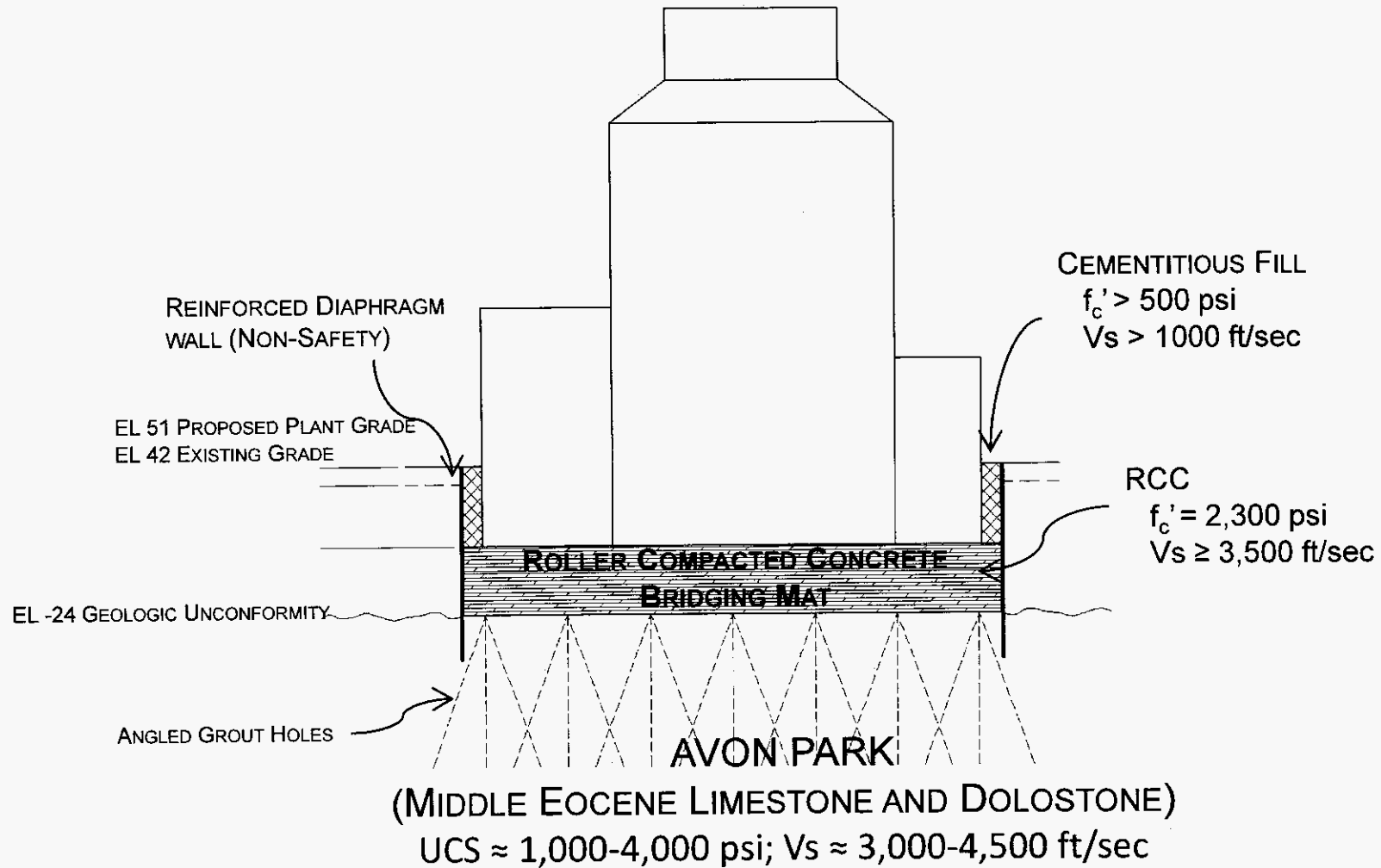

Sharing the China Experience

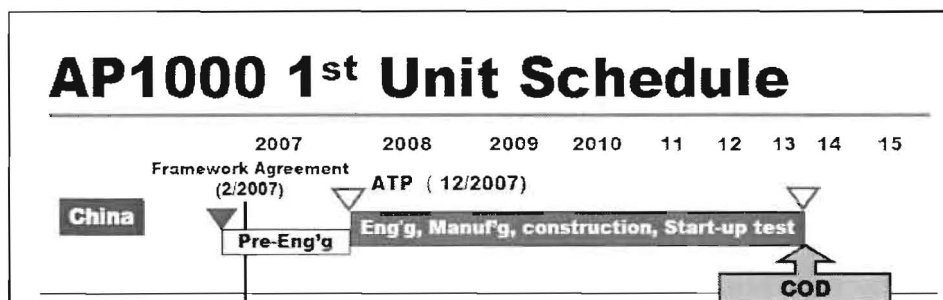
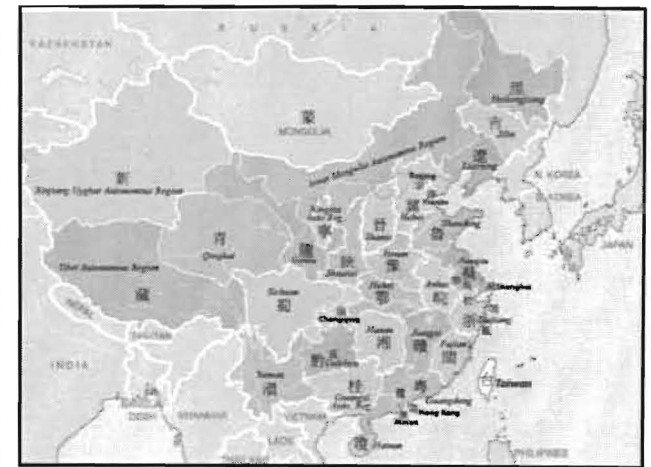

AP1000

Construction Simulation Video

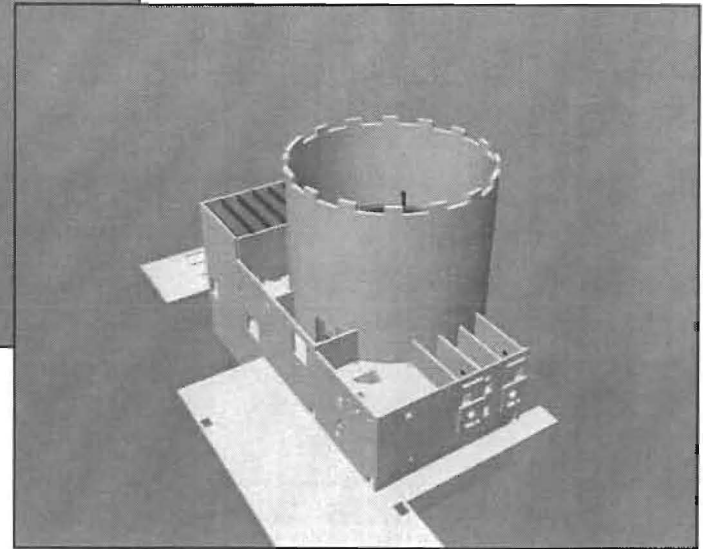
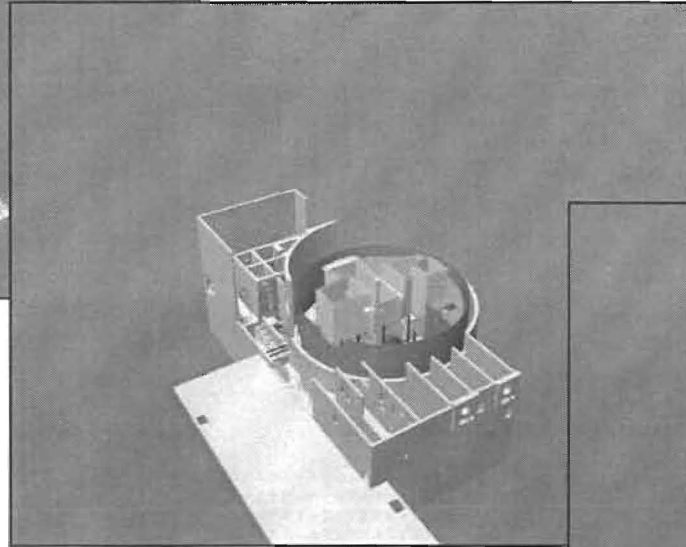
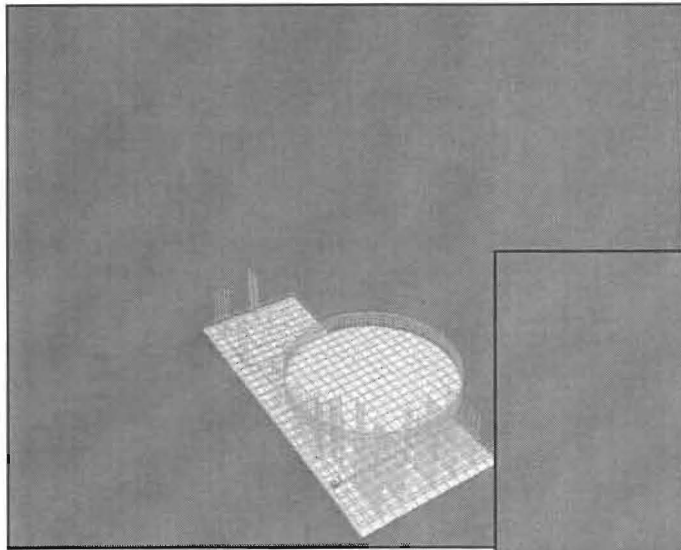

[AP1000 Virtual Construction Sequences 8 minutes.AVI](#)

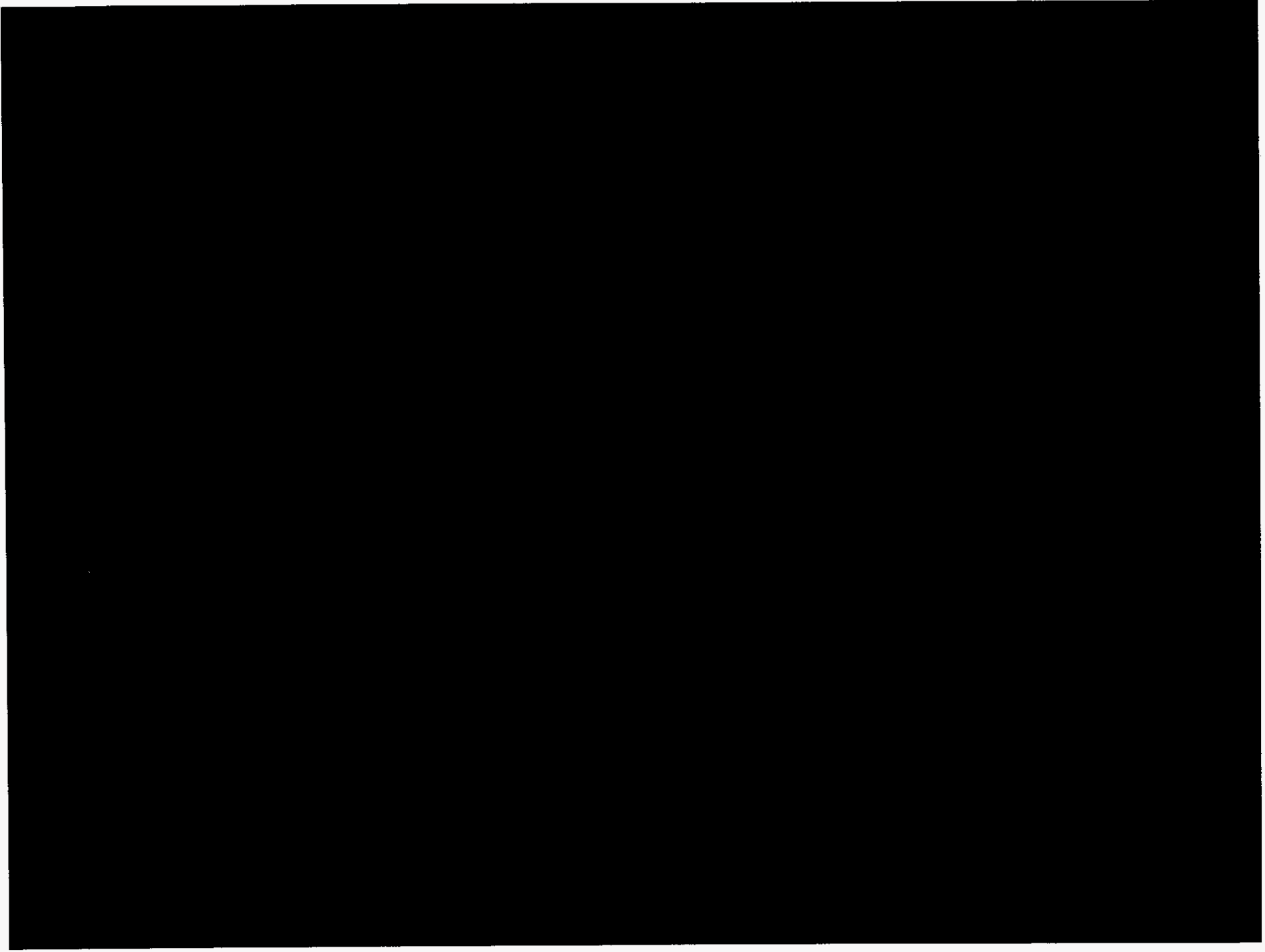

09NC-OPCPD7-89-000029

Levy Transmission

Key Activities (thru 2009)

Continue activities for certain engineering, land acquisition, major equipment procurement and contracting strategies, and external communication activities

- Strategic Right-of-Way acquisition
- North and South Admin Substations and Lines -- Detail design, permitting, material and equipment procurement, ROW clearing, and construction
- Crystal River Substation (Phase I) -- Detail design, permitting, material and equipment procurement, and construction
- Levy-Central Florida South 500kV line -- Begin detail design, permitting
- Levy-Crystal River Plant 500kV line -- Begin detail design, permitting
- Crystal River Plant–Brookridge 230kV line -- Begin detail design, permitting, begin material and equipment procurement
- Brookridge Substation -- Begin detail design, permitting, begin material and equipment procurement
- Citrus Substation -- Begin detail design, permitting

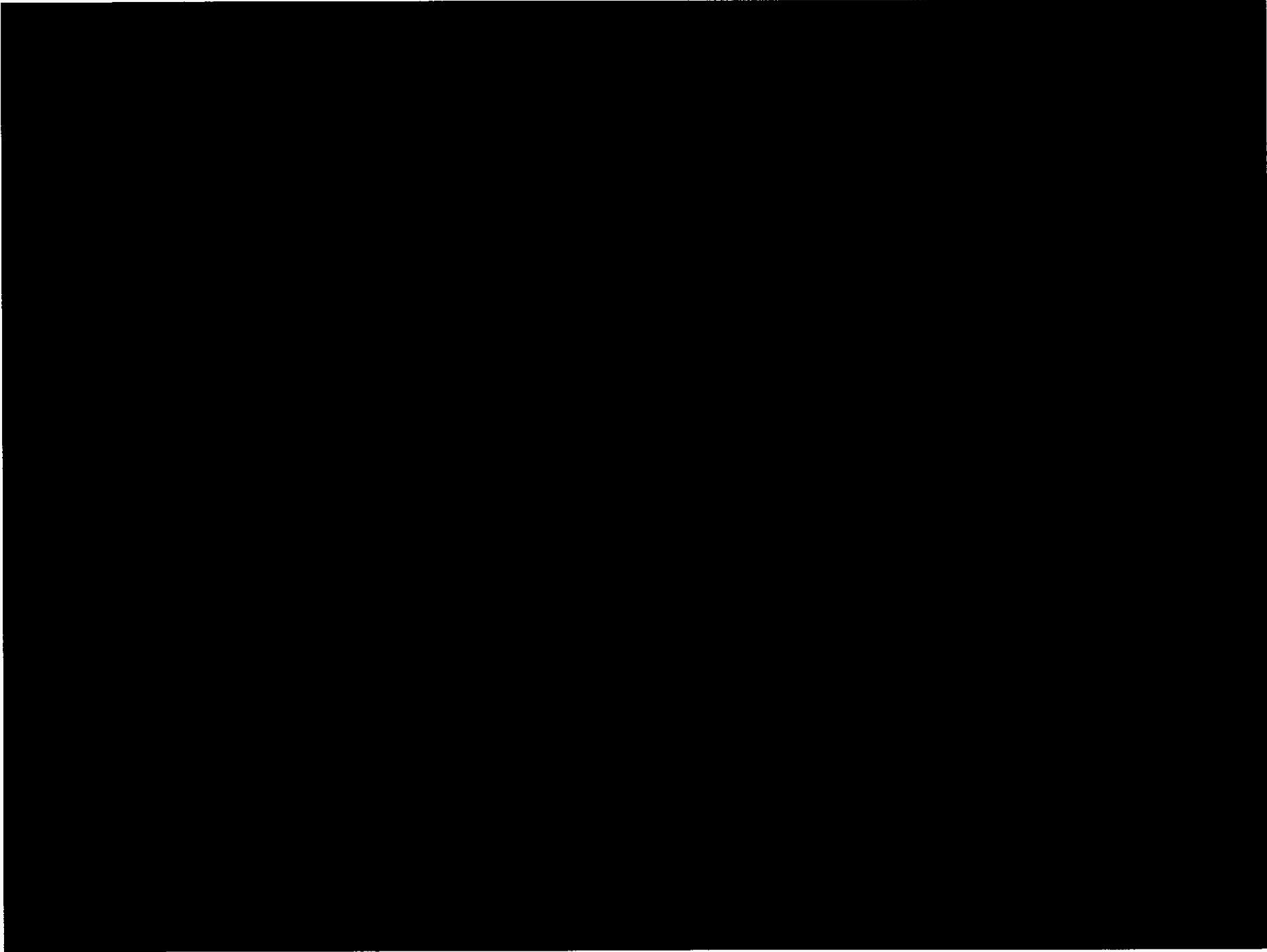

Levy Nuclear Project Transmission - Project Risk

Program Key Risk ID

- 12. Lack of public acceptance influences decision makers
- 13. Co-location with Suncoast Parkway II and Florida Gas Transmission (FGT) Expansion

Likelihood

Very High

High

Moderate

Low

Very Low

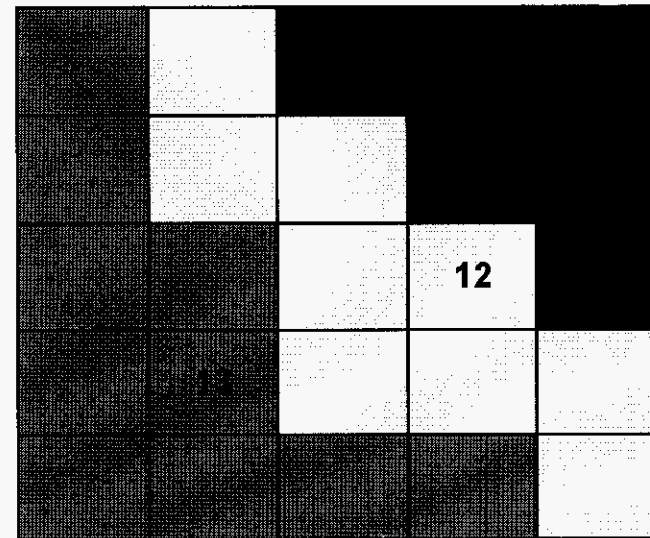

Minimal

Moderate

Significant

Severe

Critical

Consequence

Overall Project Risk Assessment

Cost	Schedule	Performance	Safety	Environmental
↔	↔	↔	↔	↔



Levy Nuclear Project

Transmission Contract Strategy

- The recommended contracting strategy is a hybrid approach
- Hybrid approach includes:
 - ◆ Owner's Engineer to supplement existing resources
 - ◆ Program Manager for Line Construction
 - ◆ Program Manager for Right of Way Acquisition
 - ◆ Engineer Procure Construct & Design Bid Build strategy for substations contracted directly with PEF
 - ◆ Major Equipment contracts by PEF
- PEF directly contracts for and manages certain aspects of the program using either lump sum or target cost plus incentives as dictated by marketplace factors and PEF's risk appetite

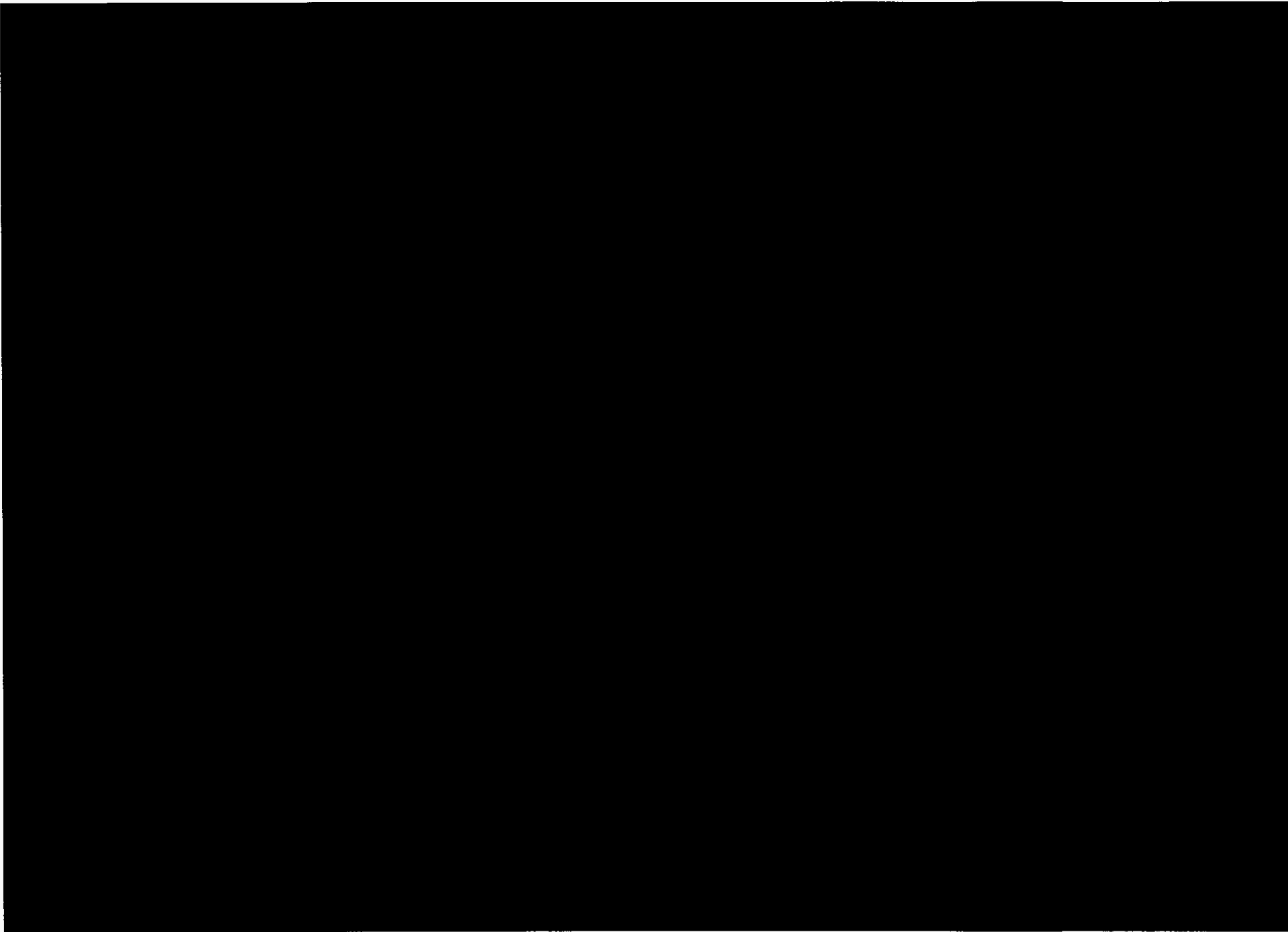

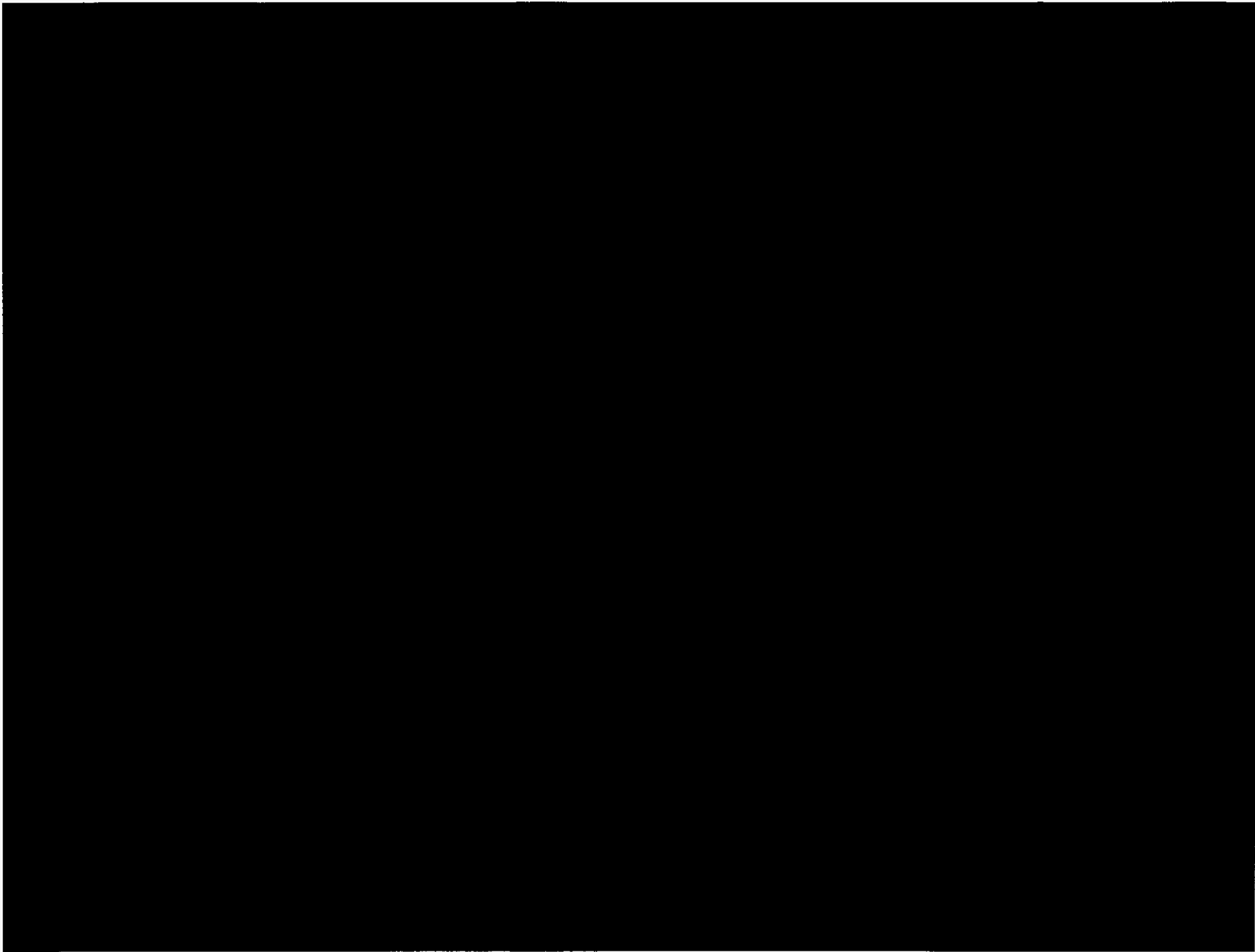

09NC-OPCP0D7-89-000035

Levy Nuclear Project Recommendation

- Approve Levy Combined IPP - \$ 17.2 B
- Authorize Spending thru 2009 for Levy

Transmission \$60.5M (Year '09) \$100.6M (All Years thru '09)

- Rights-of-Way acquisitions and/or option arrangements
- Purchase agreements for long-lead time equipment
- Engineering contracts, Crystal River Substation Ph I

Nuclear \$791.6M (Year '09) \$1,105.9M (All Years thru '09)

- COLA , other regulatory permitting/approval activities
- EPC engineering, construction planning, early site preparation activities
- Long-lead equipment procurement

- **Planned Return to SMC**

Important IPP Milestone Activities	Return Date
Final EPC Contract complete; revised cash flow analysis available	1 st Qtr 2009
Joint Owner Agreements complete; Terms & Conditions known	1 st Qtr 2009
Authorization to issue Full Notice to Proceed to WEC/SSW	4 th Qtr 2009

Levy Site



Progress Energy

The Westinghouse AP1000™

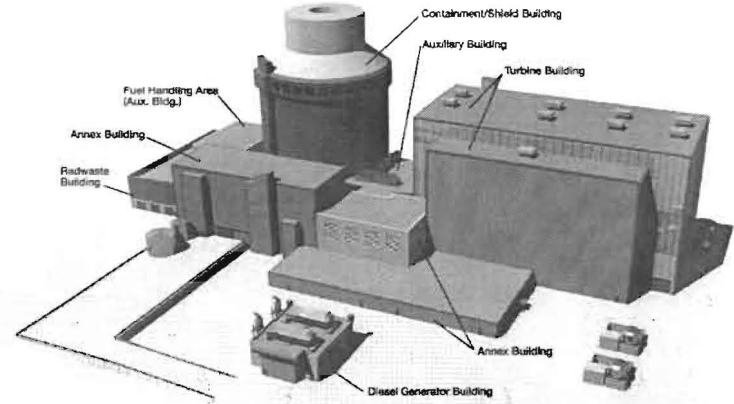

AP1000™

Questions

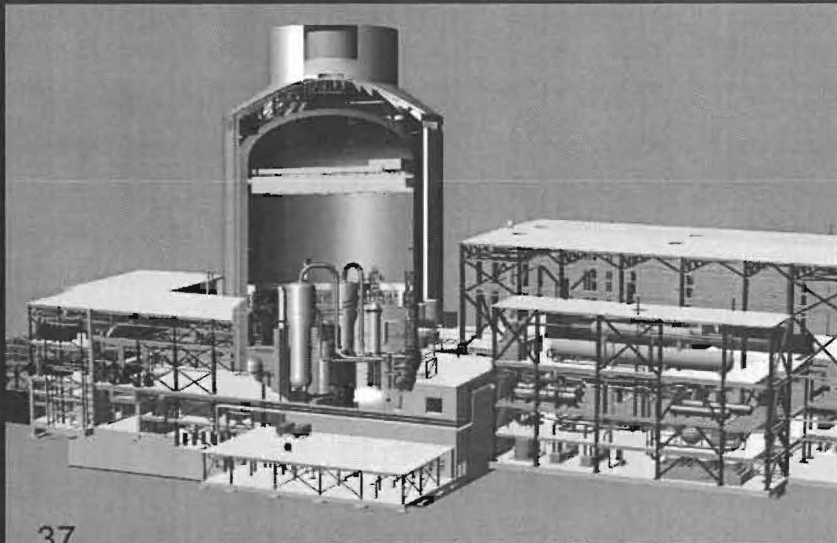

37

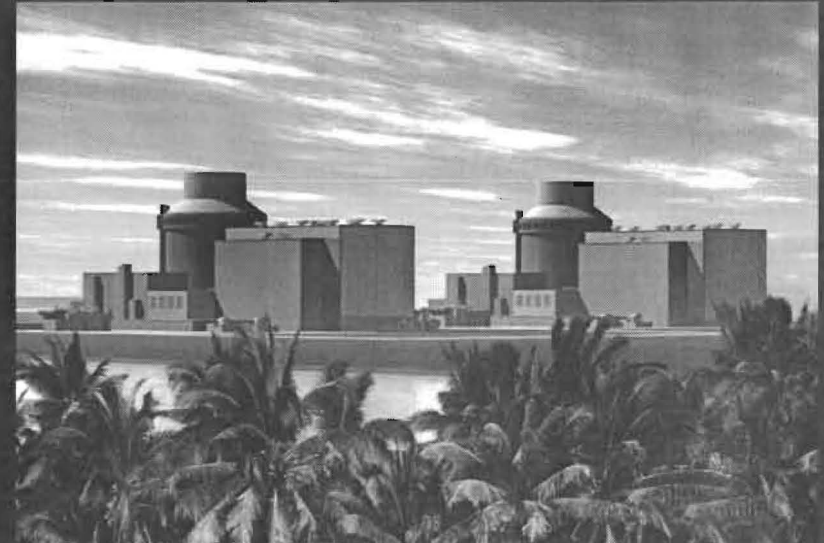

CONFIDENTIAL

Levy Update

For SMC Meeting on June 17, 2009



09NC-OPCPOD7-92-000001

CONFIDENTIAL

Agenda / Topics

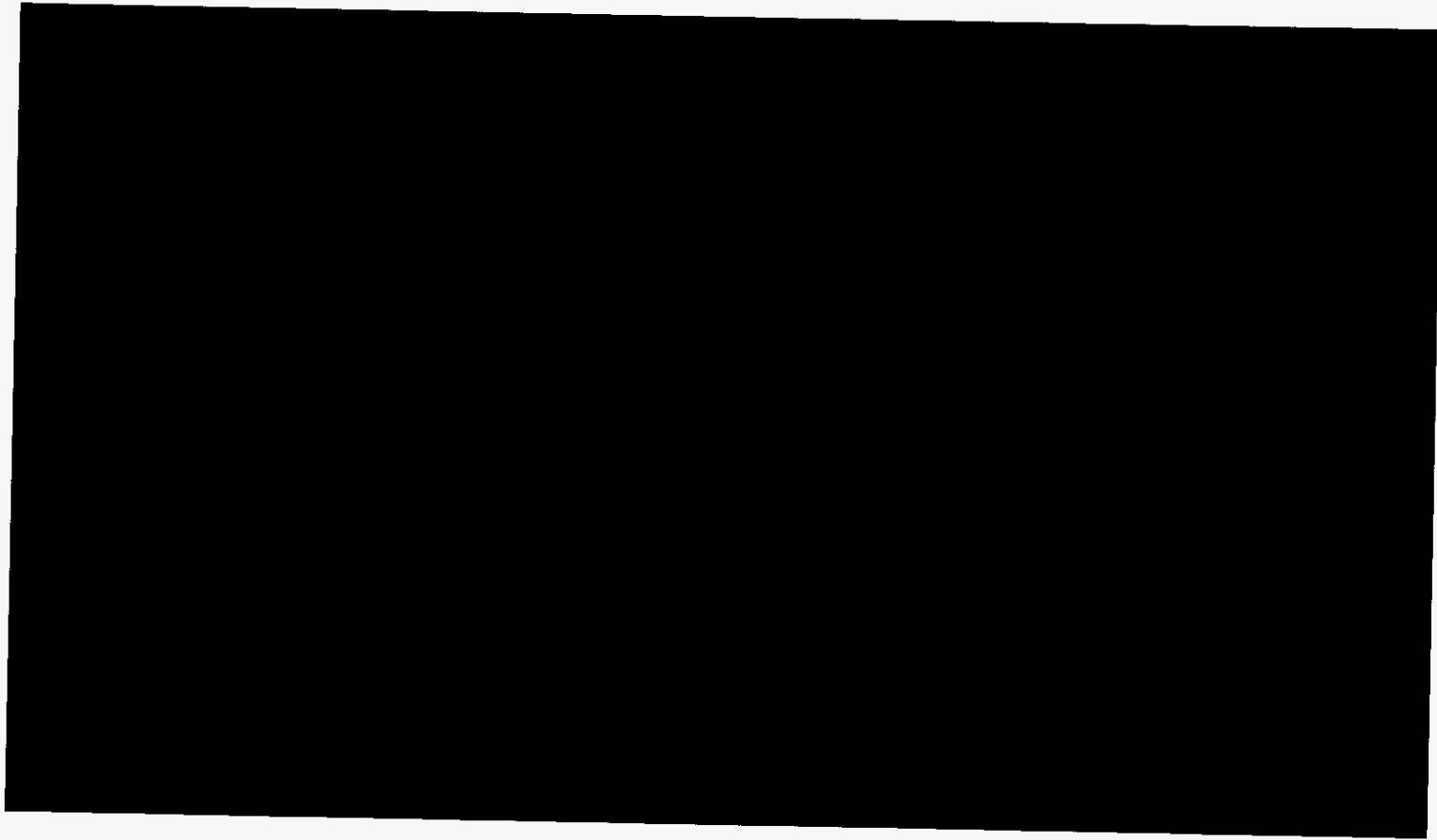

CONFIDENTIAL

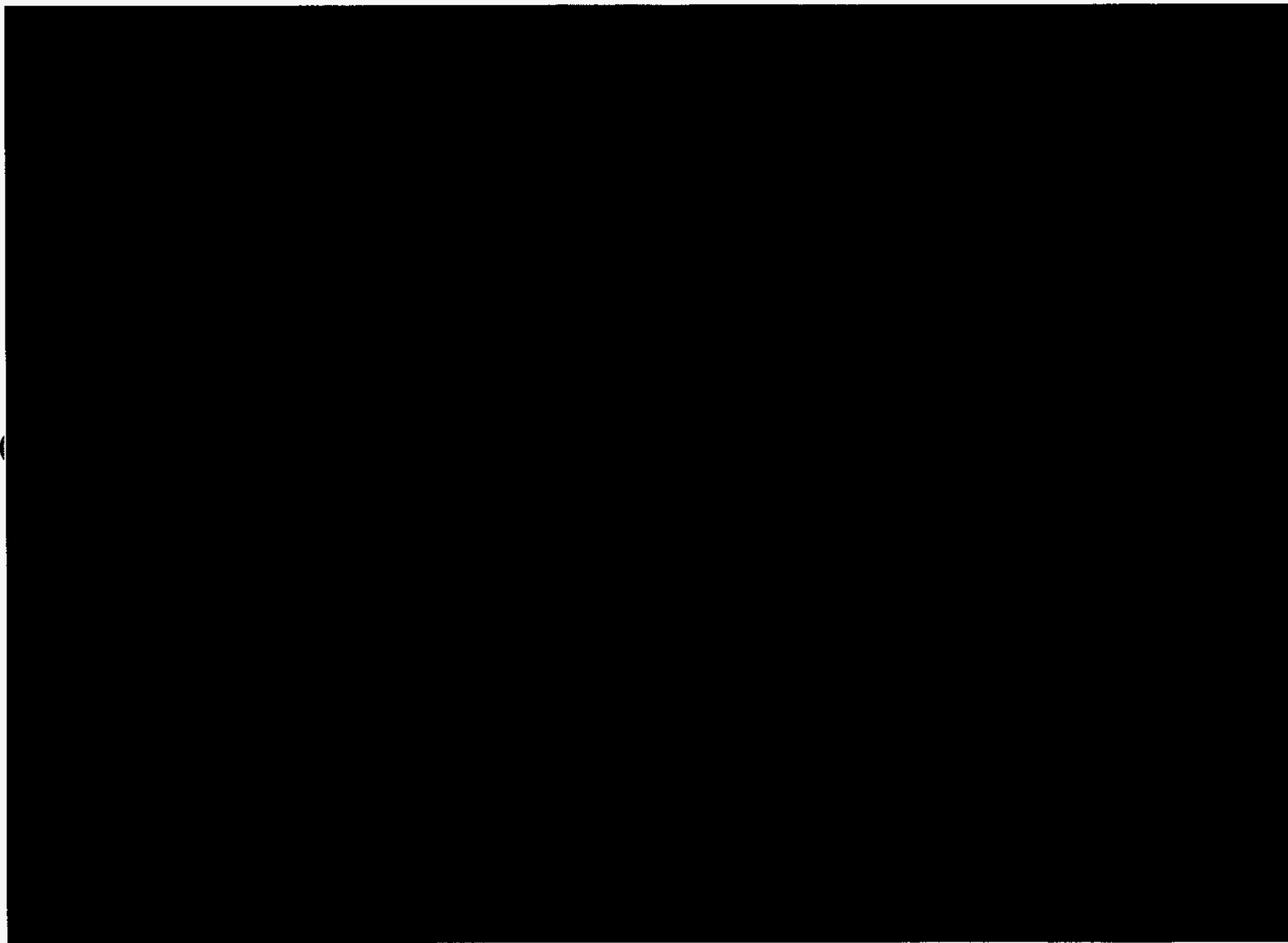

CONFIDENTIAL

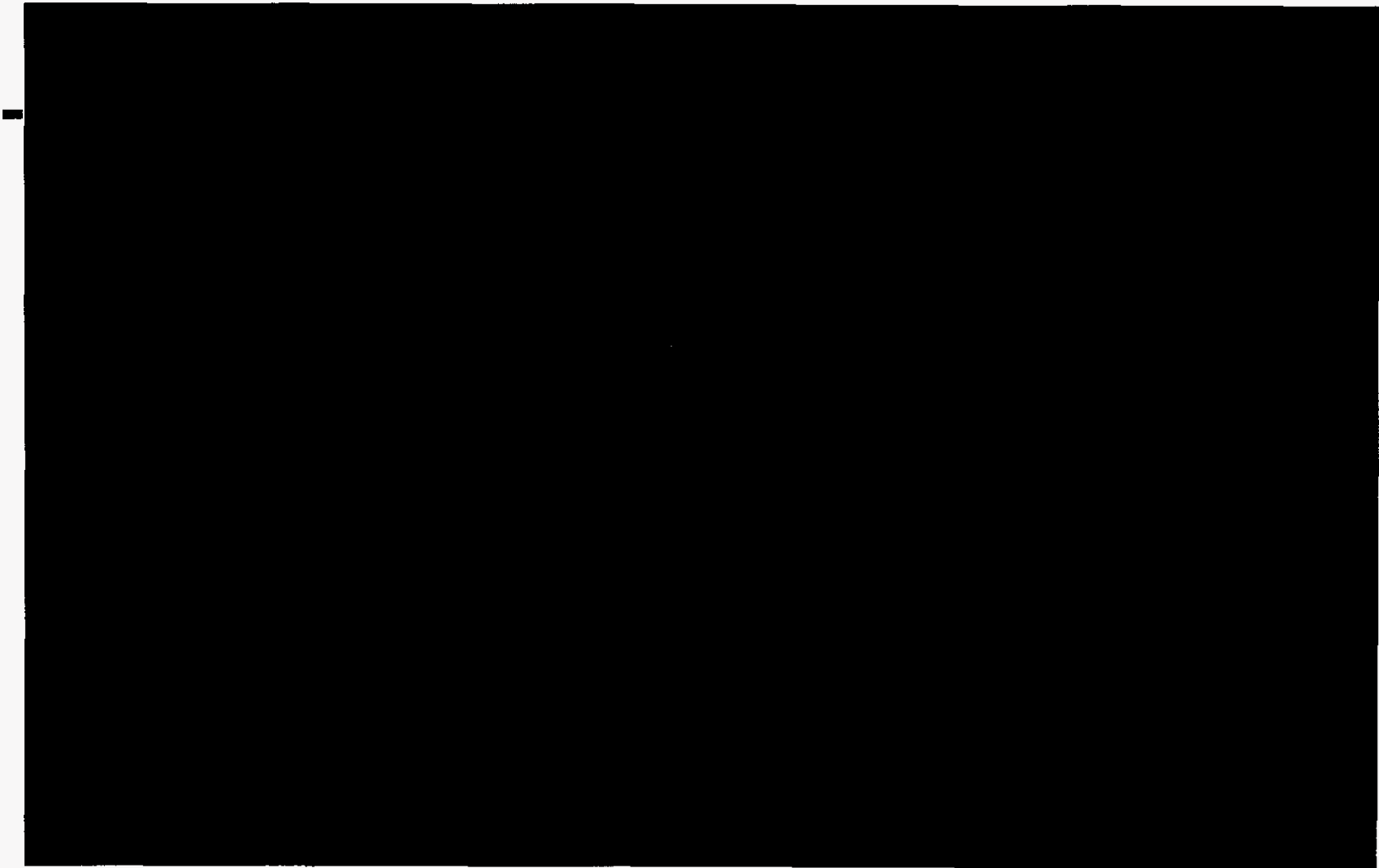

Multiple objectives to solve for...

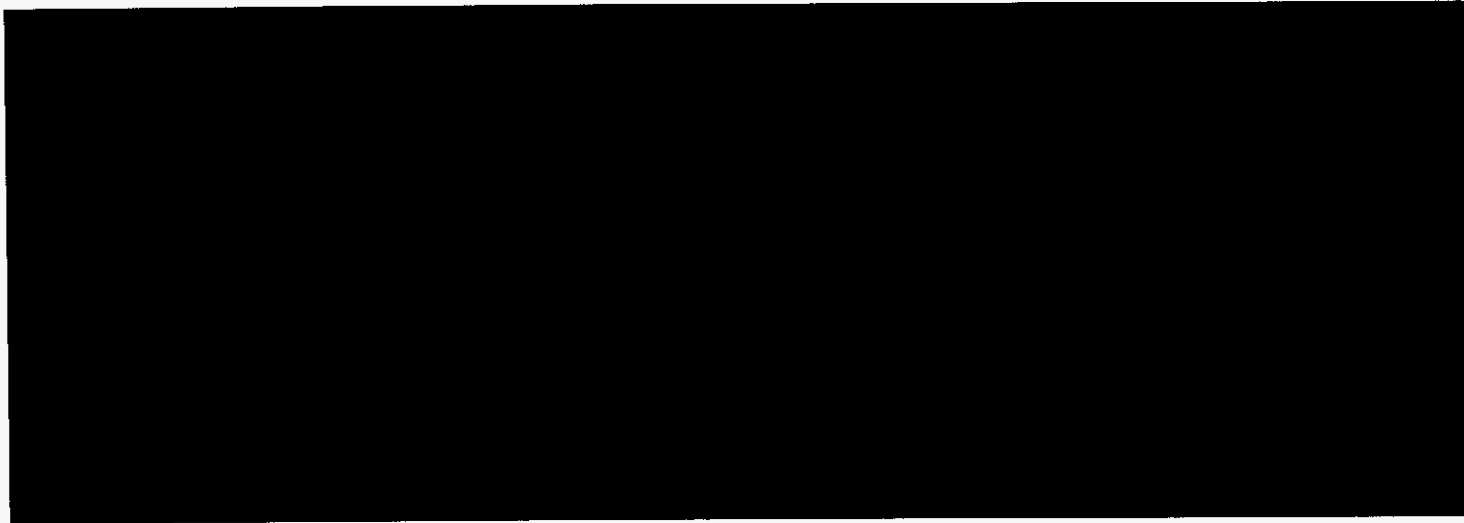

- PEF operational benefits

- ◆ Source of CO2-free generation, a key to PEF attaining emission compliance goals
- ◆ More balanced, less volatile fuel mix for customers
- ◆ Proper long-term policy decision for State

CONFIDENTIAL

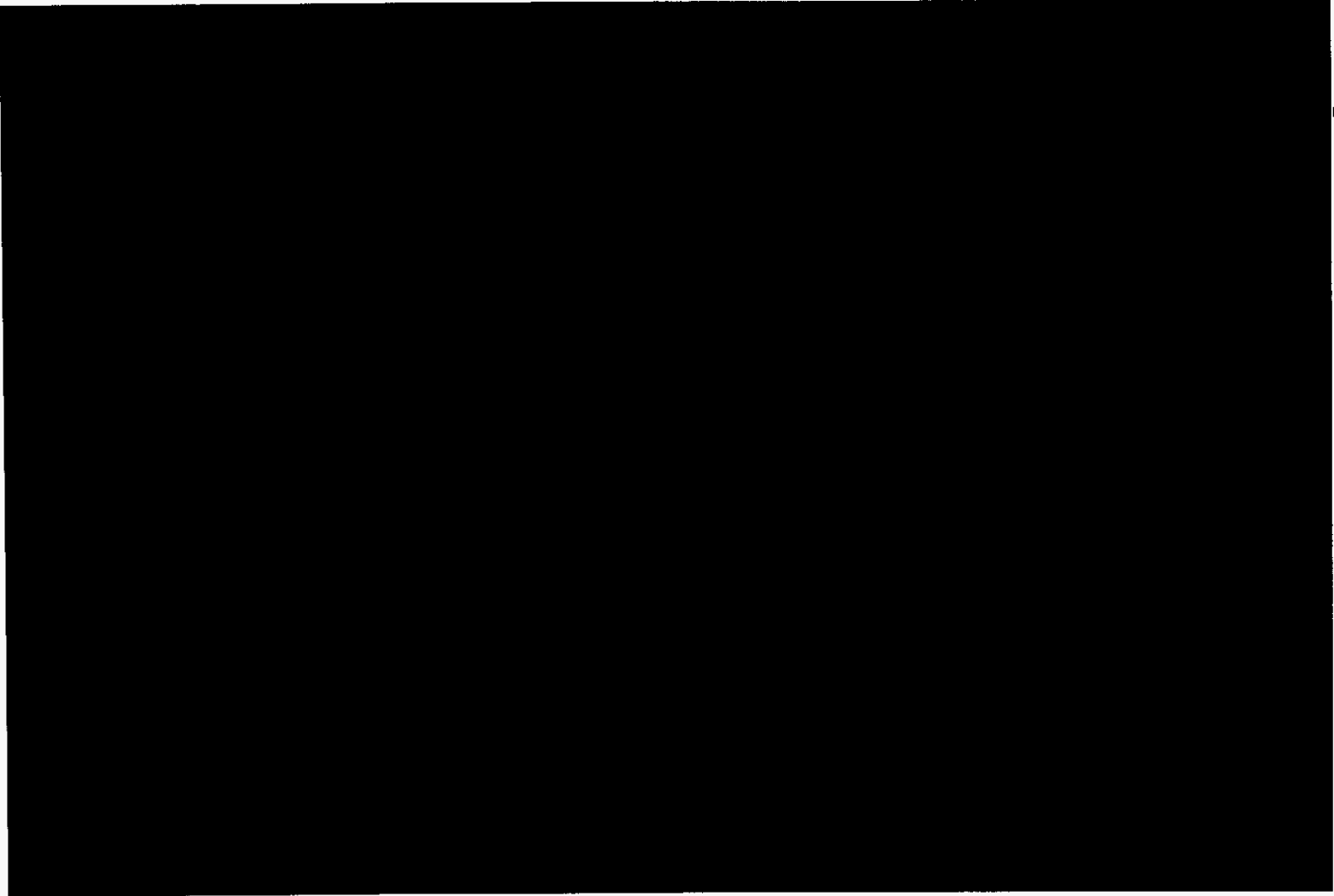

Table of CPVRR's Over Life

2007	50% Ownership Fuel Cost Sensitivity		
	Low Fuel	Mid Fuel	High Fuel
No Carbon Tax			433
Bingaman Specter			1,692
EPA			2,227
MIT		817	3,594
Lieberman Warner	248	2,130	5,048

100% Ownership Fuel Cost Sensitivity		
Low Fuel	Mid Fuel	High Fuel
		2,512
		5,089
	670	6,194
	3,490	8,953
2,806	6,257	11,768

These numbers are based on our need case filing, and will be subject to revision, up or down, based on a number of factors, including EPC renegotiations

CONFIDENTIAL

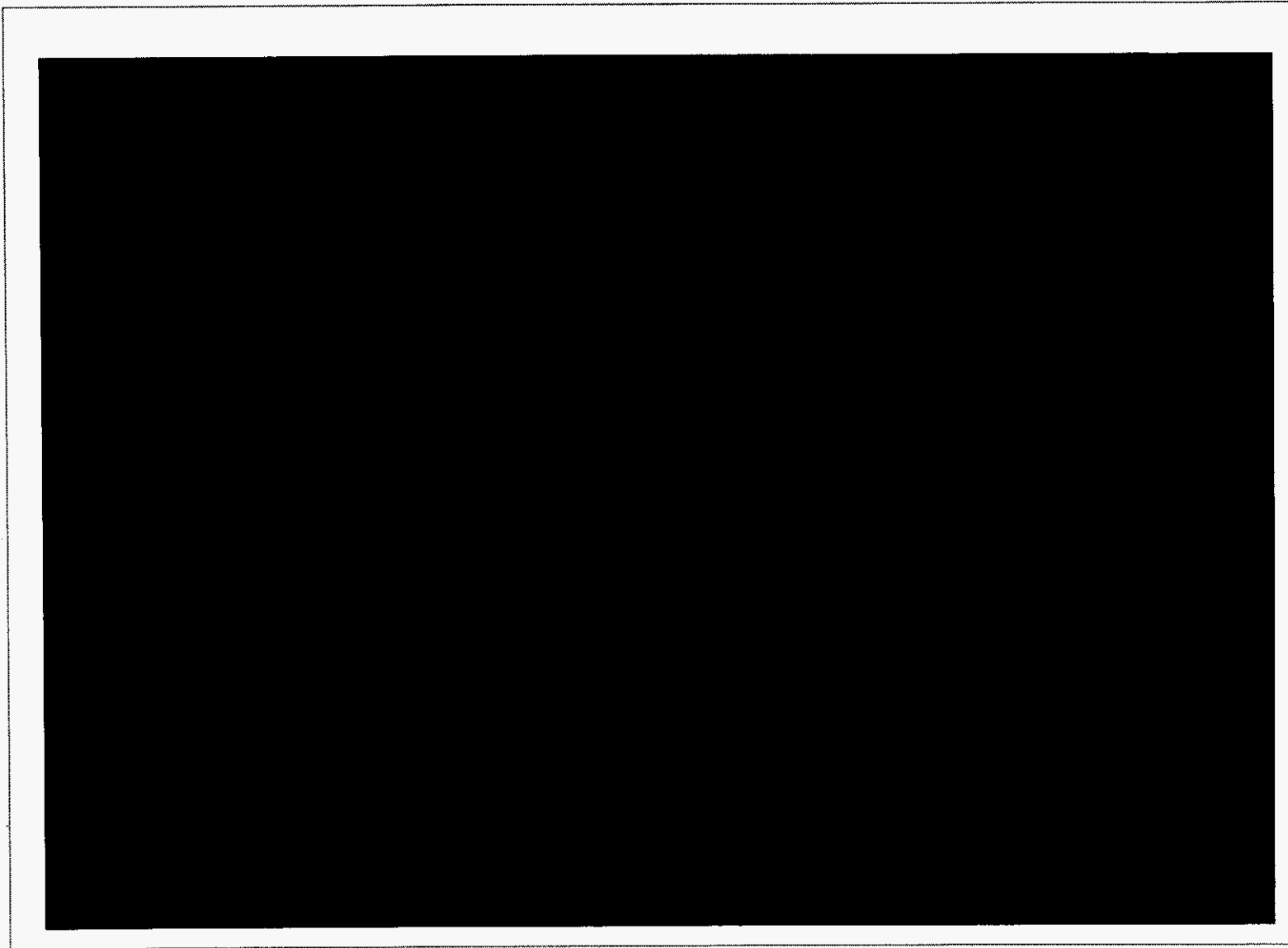

CONFIDENTIAL

Current State of Contacts



CONFIDENTIAL

2010

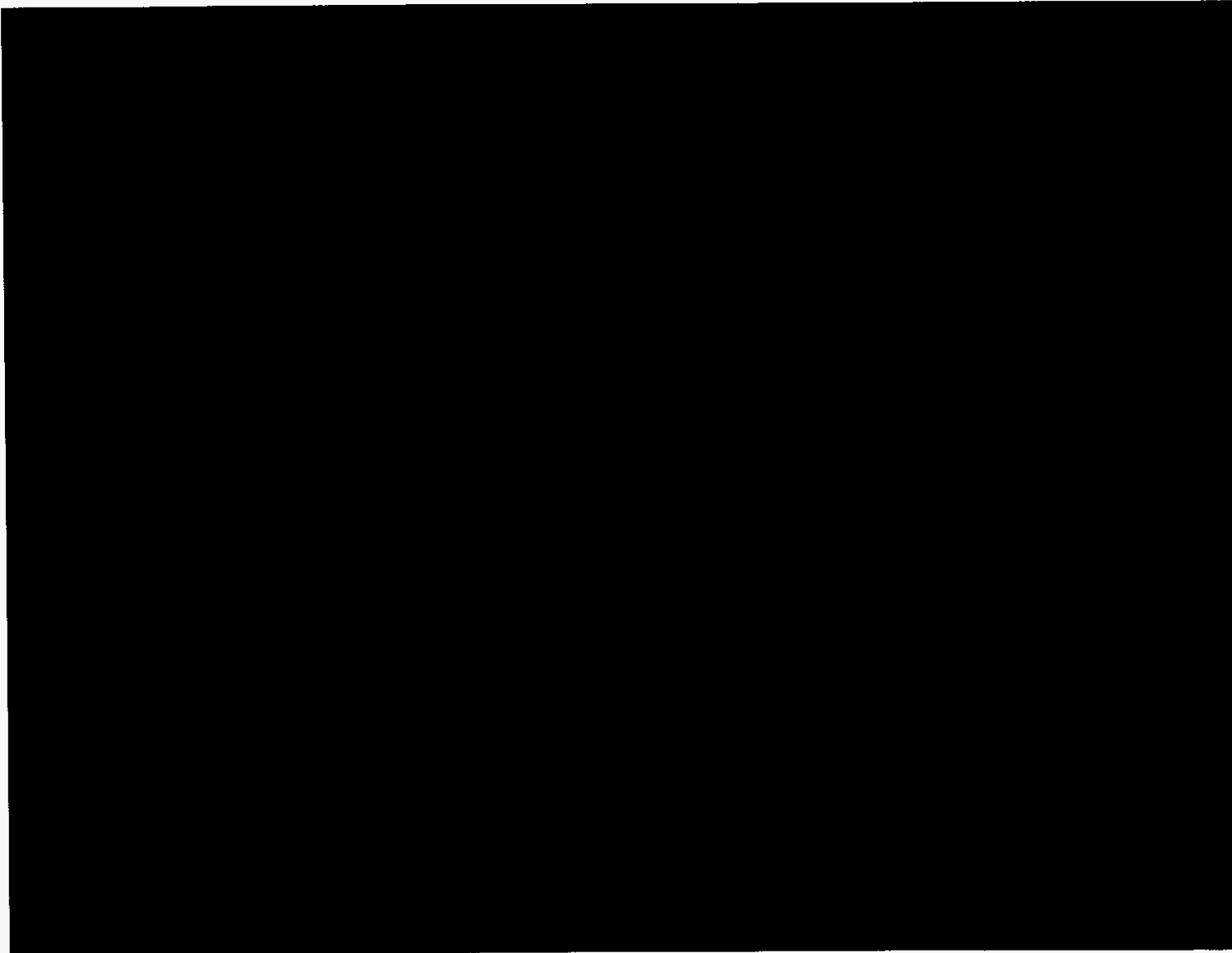

09NC-OPCPOD7-92-000010

Nuclear cost recovery timeline

- | | |
|-----------|---|
| July 15 | <ul style="list-style-type: none">• Intervenor testimony due |
| July 27 | <ul style="list-style-type: none">• FPSC staff testimony due |
| Aug 10 | <ul style="list-style-type: none">• Rebuttal Testimony due |
| Aug 21 | <ul style="list-style-type: none">• Discovery Actions completed |
| Sept 8-11 | <ul style="list-style-type: none">• Hearings |
| Oct. 7 | <ul style="list-style-type: none">• Staff recommendation |
| Oct 16 | <ul style="list-style-type: none">• Agenda hearing |
| Oct 26 | <ul style="list-style-type: none">• Standard Order |

CONFIDENTIAL

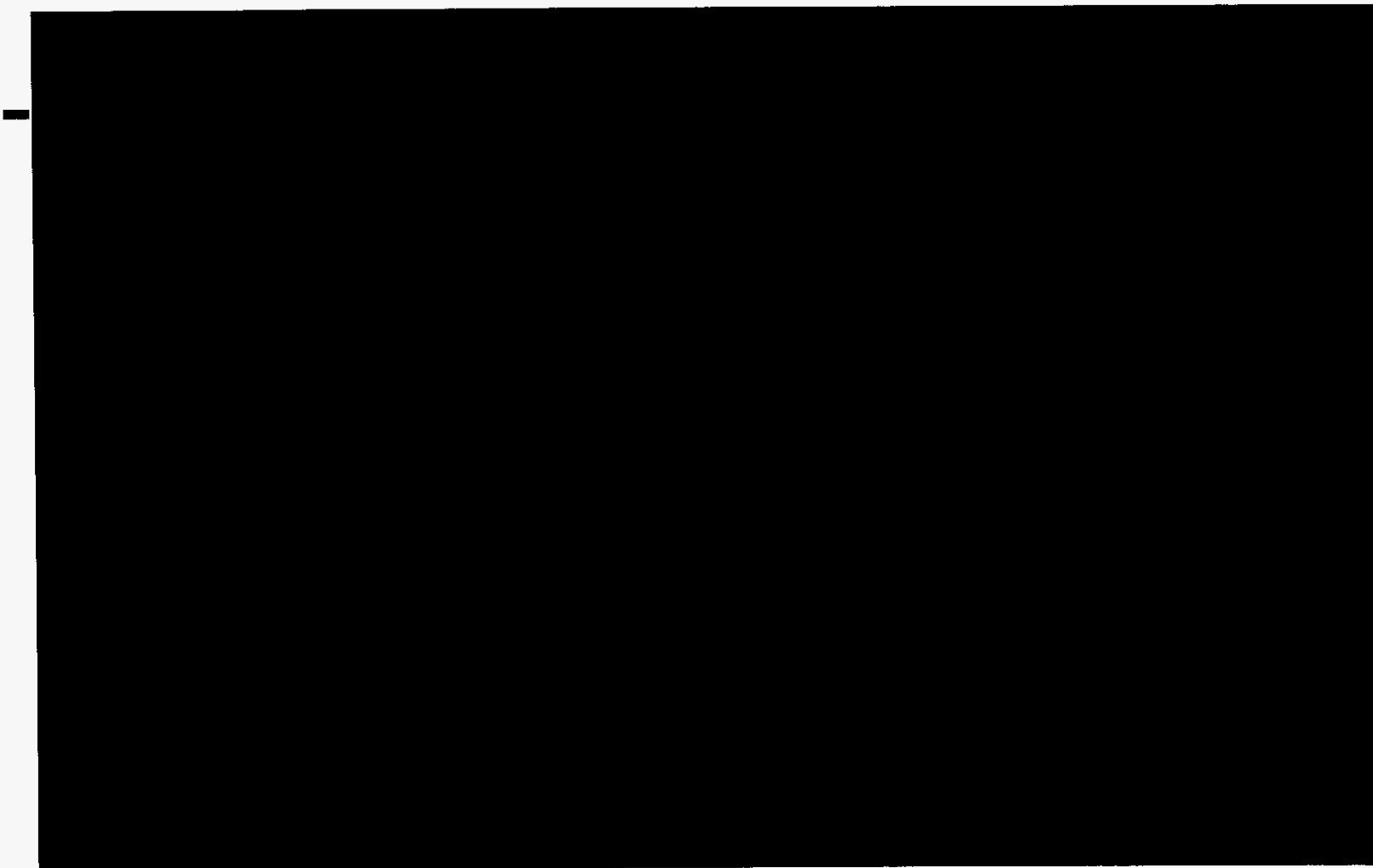

CONFIDENTIAL

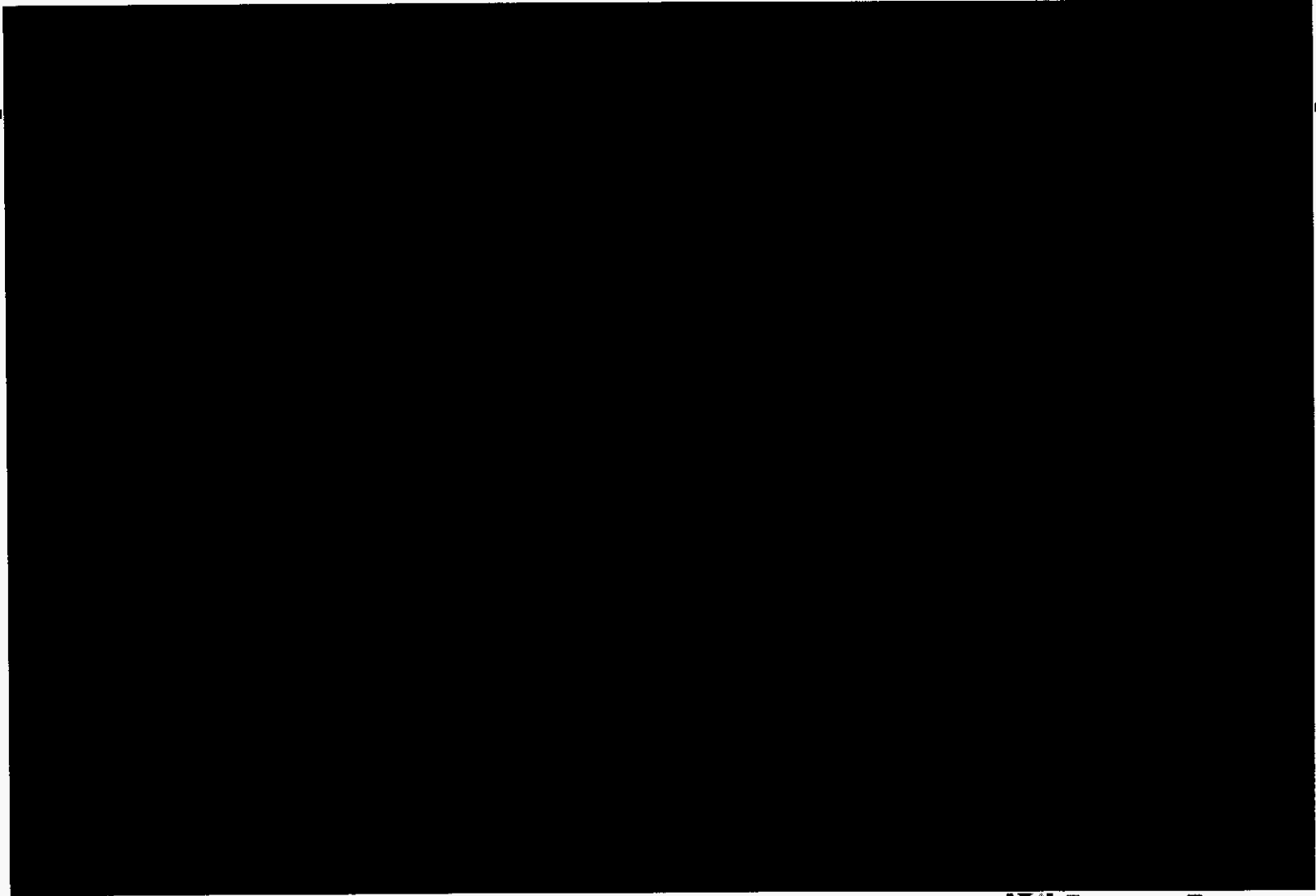

CONFIDENTIAL

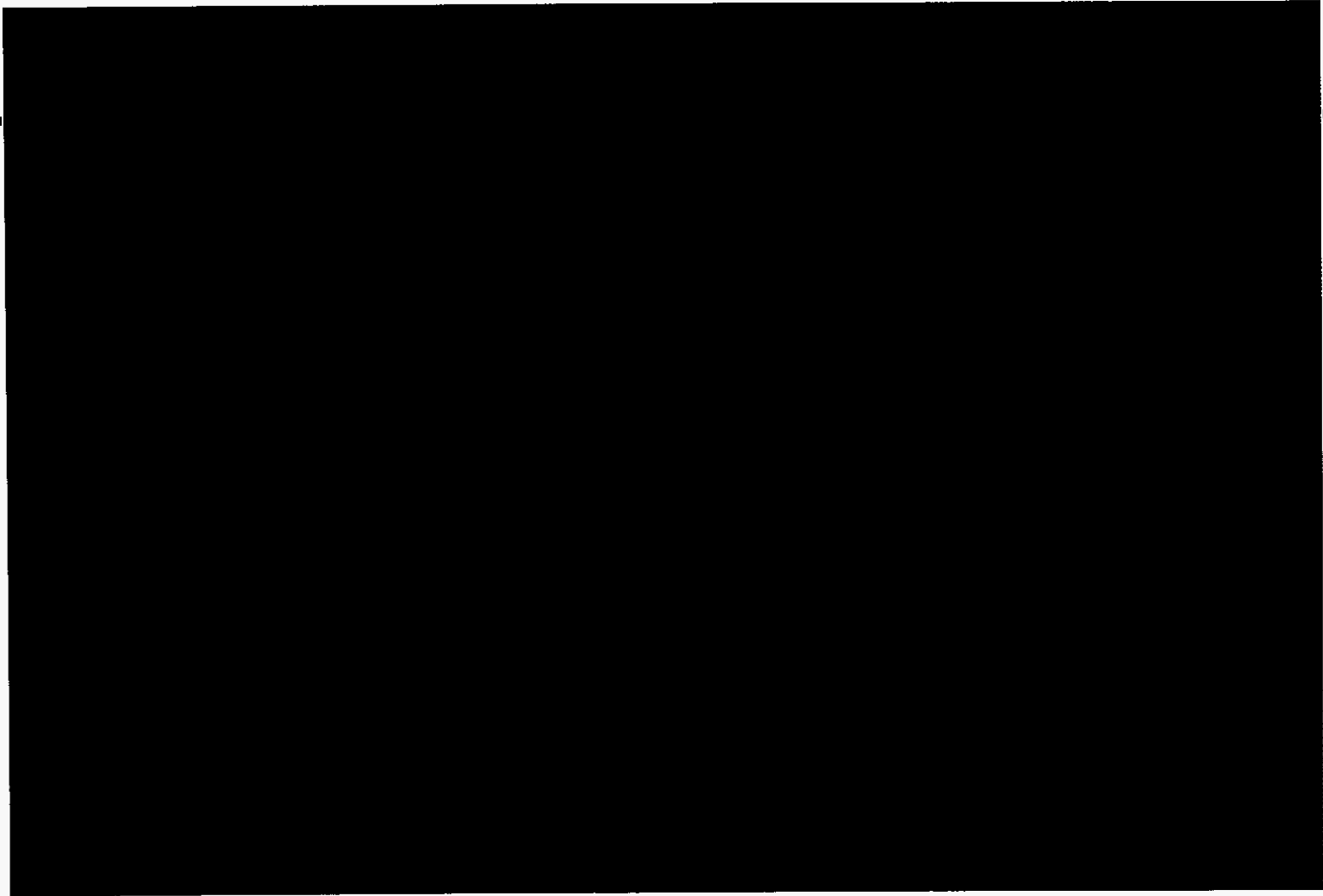

CONFIDENTIAL

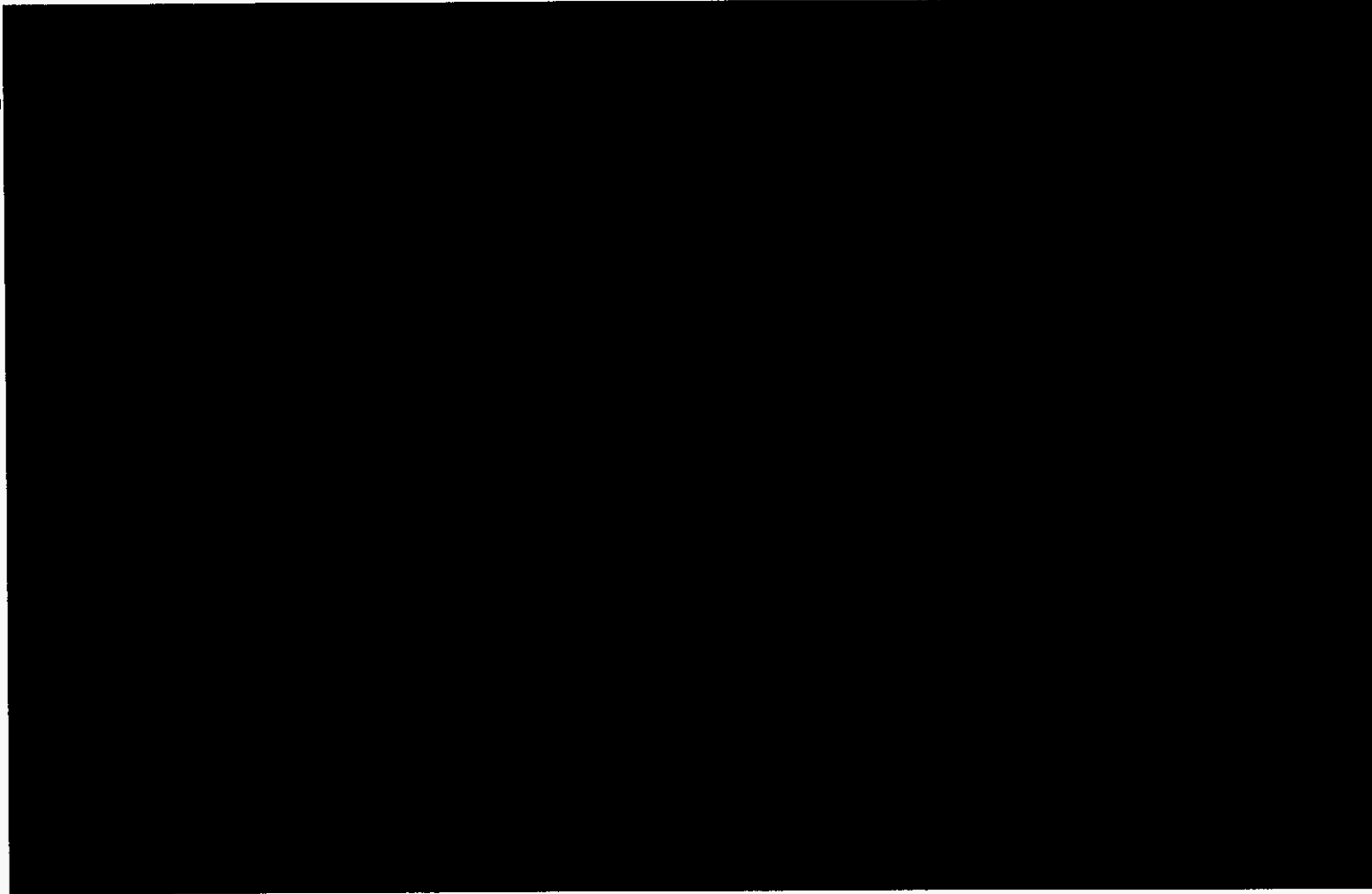

CONFIDENTIAL

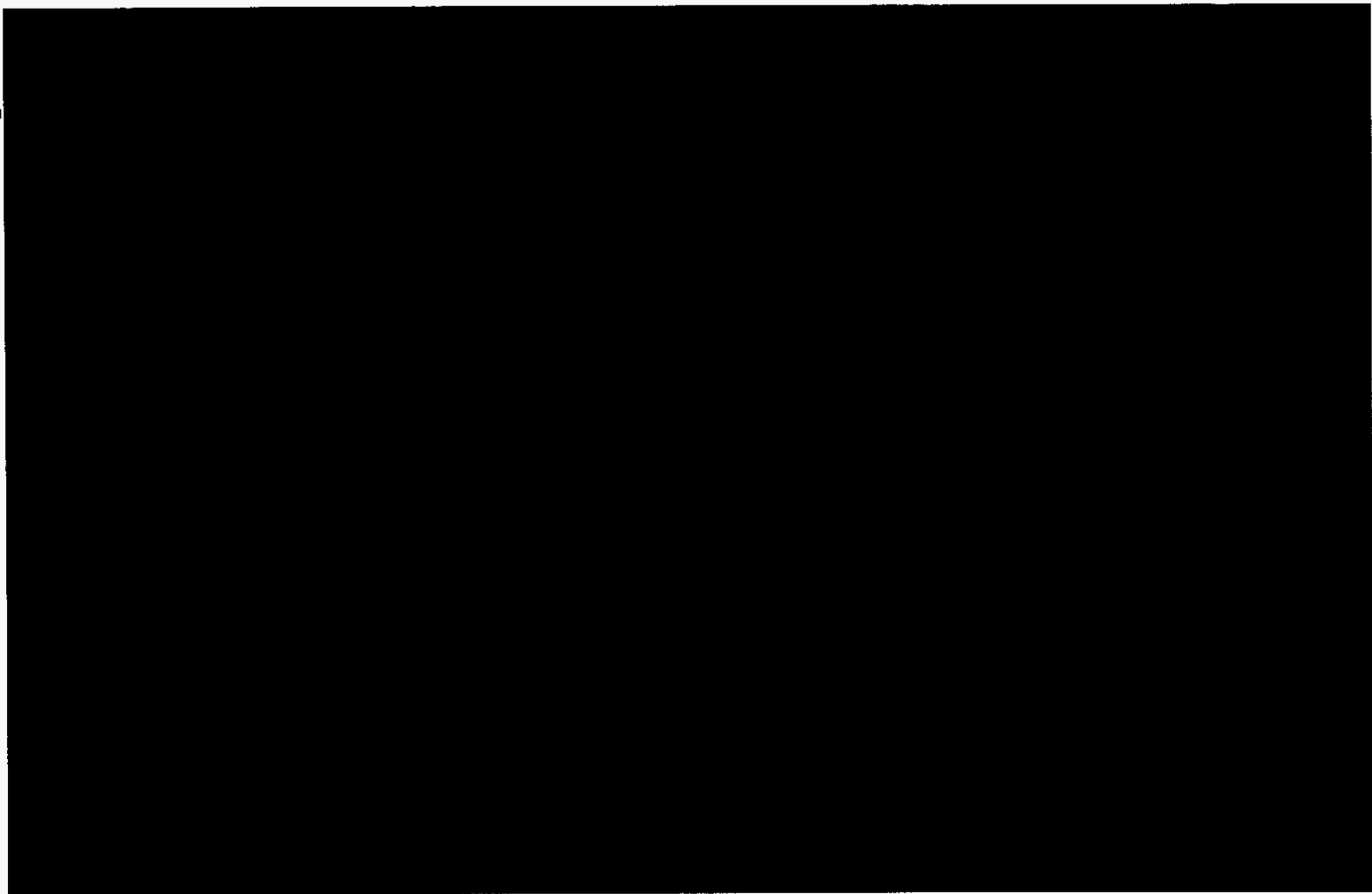

BEFORE THE FLORIDA PUBLIC SERVICE COMMISSION

IN RE: NUCLEAR COST RECOVERY
CLAUSE

Docket No. 090009-EI
Submitted for Filing: July 28, 2009

**PROGRESS ENERGY FLORIDA
REDACTED DOCUMENTS**

**09NC-OPCINT6-70a-000001
Through
09NC-OPCINT6-70a-000013**

BEFORE THE FLORIDA PUBLIC SERVICE COMMISSION

IN RE: NUCLEAR COST RECOVERY
CLAUSE

Docket No. 090009-EI
Submitted for Filing: July 28, 2009

**PROGRESS ENERGY FLORIDA
REDACTED DOCUMENTS**

**09NC-OPCPOD7-89-000038
Through
09NC-OPCPOD7-89-000039**

BEFORE THE FLORIDA PUBLIC SERVICE COMMISSION

IN RE: NUCLEAR COST RECOVERY
CLAUSE

Docket No. 090009-EI
Submitted for Filing: July 28, 2009

**PROGRESS ENERGY FLORIDA
REDACTED DOCUMENTS**

09NC-OPCPOD7-94-000001

BEFORE THE FLORIDA PUBLIC SERVICE COMMISSION

IN RE: NUCLEAR COST RECOVERY
CLAUSE

Docket No. 090009-EI
Submitted for Filing: July 28, 2009

**PROGRESS ENERGY FLORIDA
REDACTED DOCUMENTS**

**09NC-OPCPOD7-94-000002
Through
09NC-OPCPOD7-94-000004**

BEFORE THE FLORIDA PUBLIC SERVICE COMMISSION

IN RE: NUCLEAR COST RECOVERY
CLAUSE

Docket No. 090009-EI
Submitted for Filing: July 28, 2009

**PROGRESS ENERGY FLORIDA
REDACTED DOCUMENTS**

**09NC-OPCPOD7-94-000018
Through
09NC-OPCPOD7-94-000022**

BEFORE THE FLORIDA PUBLIC SERVICE COMMISSION

IN RE: NUCLEAR COST RECOVERY
CLAUSE

Docket No. 090009-EI
Submitted for Filing: July 28, 2009

**PROGRESS ENERGY FLORIDA
REDACTED DOCUMENTS**

**09NC-OPCPOD7-94-000023
Through
09NC-OPCPOD7-94-000088**

BEFORE THE FLORIDA PUBLIC SERVICE COMMISSION

IN RE: NUCLEAR COST RECOVERY
CLAUSE

Docket No. 090009-EI
Submitted for Filing: July 28, 2009

**PROGRESS ENERGY FLORIDA
REDACTED DOCUMENTS**

**09NC-OPCPOD7-94-000089
Through
09NC-OPCPOD7-94-000167**

BEFORE THE FLORIDA PUBLIC SERVICE COMMISSION

IN RE: NUCLEAR COST RECOVERY
CLAUSE

Docket No. 090009-EI
Submitted for Filing: July 28, 2009

**PROGRESS ENERGY FLORIDA
REDACTED DOCUMENTS**

**09NC-OPCPOD7-94-000169
Through
09NC-OPCPOD7-94-000171**

BEFORE THE FLORIDA PUBLIC SERVICE COMMISSION

IN RE: NUCLEAR COST RECOVERY
CLAUSE

Docket No. 090009-EI
Submitted for Filing: July 28, 2009

**PROGRESS ENERGY FLORIDA
REDACTED DOCUMENTS**

**09NC-OPCPOD7-94-000258
Through
09NC-OPCPOD7-94-000320**

BEFORE THE FLORIDA PUBLIC SERVICE COMMISSION

IN RE: NUCLEAR COST RECOVERY
CLAUSE

Docket No. 090009-EI
Submitted for Filing: July 28, 2009

**PROGRESS ENERGY FLORIDA
REDACTED DOCUMENTS**

**09NC-OPCPOD7-94-000321
Through
09NC-OPCPOD7-94-000339**

BEFORE THE FLORIDA PUBLIC SERVICE COMMISSION

IN RE: NUCLEAR COST RECOVERY
CLAUSE

Docket No. 090009-EI
Submitted for Filing: July 28, 2009

**PROGRESS ENERGY FLORIDA
REDACTED DOCUMENTS**

**09NC-OPCPOD7-94-000340
Through
09NC-OPCPOD7-94-000342**

BEFORE THE FLORIDA PUBLIC SERVICE COMMISSION

IN RE: NUCLEAR COST RECOVERY
CLAUSE

Docket No. 090009-EI
Submitted for Filing: July 28, 2009

**PROGRESS ENERGY FLORIDA
REDACTED DOCUMENTS**

09NC-OPCPOD7-94-000343

BEFORE THE FLORIDA PUBLIC SERVICE COMMISSION

IN RE: NUCLEAR COST RECOVERY
CLAUSE

Docket No. 090009-EI
Submitted for Filing: July 28, 2009

**PROGRESS ENERGY FLORIDA
REDACTED DOCUMENTS**

09NC-OPCPOD7-94-000344

BEFORE THE FLORIDA PUBLIC SERVICE COMMISSION

IN RE: NUCLEAR COST RECOVERY
CLAUSE

Docket No. 090009-EI
Submitted for Filing: July 28, 2009

**PROGRESS ENERGY FLORIDA
REDACTED DOCUMENTS**

**09NC-OPCPOD7-94-000345
Through
09NC-OPCPOD7-94-000430**

BEFORE THE FLORIDA PUBLIC SERVICE COMMISSION

IN RE: NUCLEAR COST RECOVERY
CLAUSE

Docket No. 090009-EI
Submitted for Filing: July 28, 2009

**PROGRESS ENERGY FLORIDA
REDACTED DOCUMENTS**

**09NC-OPCPOD7-94-000431
Through
09NC-OPCPOD7-94-000493**

BEFORE THE FLORIDA PUBLIC SERVICE COMMISSION

IN RE: NUCLEAR COST RECOVERY
CLAUSE

Docket No. 090009-EI
Submitted for Filing: July 28, 2009

**PROGRESS ENERGY FLORIDA
REDACTED DOCUMENTS**

**09NC-OPCPOD7-94-000494
Through
09NC-OPCPOD7-94-000503**

BEFORE THE FLORIDA PUBLIC SERVICE COMMISSION

IN RE: NUCLEAR COST RECOVERY
CLAUSE

Docket No. 090009-EI
Submitted for Filing: July 28, 2009

**PROGRESS ENERGY FLORIDA
REDACTED DOCUMENTS**

**09NC-OPCPOD7-94-000504
Through
09NC-OPCPOD7-94-000553**

BEFORE THE FLORIDA PUBLIC SERVICE COMMISSION

IN RE: NUCLEAR COST RECOVERY
CLAUSE

Docket No. 090009-EI
Submitted for Filing: July 28, 2009

**PROGRESS ENERGY FLORIDA
REDACTED DOCUMENTS**

**09NC-OPCPOD7-94-000554
Through
09NC-OPCPOD7-94-000603**

BEFORE THE FLORIDA PUBLIC SERVICE COMMISSION

IN RE: NUCLEAR COST RECOVERY
CLAUSE

Docket No. 090009-EI
Submitted for Filing: July 28, 2009

**PROGRESS ENERGY FLORIDA
REDACTED DOCUMENTS**

**09NC-OPCPOD7-94-000604
Through
09NC-OPCPOD7-94-000642**

BEFORE THE FLORIDA PUBLIC SERVICE COMMISSION

IN RE: NUCLEAR COST RECOVERY
CLAUSE

Docket No. 090009-EI
Submitted for Filing: July 28, 2009

**PROGRESS ENERGY FLORIDA
REDACTED DOCUMENTS**

**09NC-OPCPOD7-94-000643
Through
09NC-OPCPOD7-94-000645**

BEFORE THE FLORIDA PUBLIC SERVICE COMMISSION

IN RE: NUCLEAR COST RECOVERY
CLAUSE

Docket No. 090009-E1
Submitted for Filing: July 28, 2009

**PROGRESS ENERGY FLORIDA
REDACTED DOCUMENTS**

**09NC-OPCPOD7-94-000646
Through
09NC-OPCPOD7-94-000648**

BEFORE THE FLORIDA PUBLIC SERVICE COMMISSION

IN RE: NUCLEAR COST RECOVERY
CLAUSE

Docket No. 090009-EI
Submitted for Filing: July 28, 2009

**PROGRESS ENERGY FLORIDA
REDACTED DOCUMENTS**

09NC-OPCPOD7-94-000649

Through

09NC-OPCPOD7-94-000656

BEFORE THE FLORIDA PUBLIC SERVICE COMMISSION

IN RE: NUCLEAR COST RECOVERY
CLAUSE

Docket No. 090009-EI
Submitted for Filing: July 28, 2009

**PROGRESS ENERGY FLORIDA
REDACTED DOCUMENTS**

**09NC-OPCPOD7-94-000657
Through
09NC-OPCPOD7-94-000660**

BEFORE THE FLORIDA PUBLIC SERVICE COMMISSION

IN RE: NUCLEAR COST RECOVERY
CLAUSE

Docket No. 090009-EI
Submitted for Filing: July 28, 2009

**PROGRESS ENERGY FLORIDA
REDACTED DOCUMENTS**

09NC-OPCPOD7-94-000682

Through

09NC-OPCPOD7-94-000688

BEFORE THE FLORIDA PUBLIC SERVICE COMMISSION

IN RE: NUCLEAR COST RECOVERY
CLAUSE

Docket No. 090009-EI
Submitted for Filing: July 28, 2009

**PROGRESS ENERGY FLORIDA
REDACTED DOCUMENTS**

**09NC-OPCPOD7-94-000689
Through
09NC-OPCPOD7-94-000695**

BEFORE THE FLORIDA PUBLIC SERVICE COMMISSION

IN RE: NUCLEAR COST RECOVERY
CLAUSE

Docket No. 090009-EI
Submitted for Filing: July 28, 2009

**PROGRESS ENERGY FLORIDA
REDACTED DOCUMENTS**

**09NC-OPCPOD7-94-000696
Through
09NC-OPCPOD7-94-000702**

BEFORE THE FLORIDA PUBLIC SERVICE COMMISSION

IN RE: NUCLEAR COST RECOVERY
CLAUSE

Docket No. 090009-EI
Submitted for Filing: July 28, 2009

**PROGRESS ENERGY FLORIDA
REDACTED DOCUMENTS**

09NC-OPCPOD7-94-000703

Through

09NC-OPCPOD7-94-000717

BEFORE THE FLORIDA PUBLIC SERVICE COMMISSION

IN RE: NUCLEAR COST RECOVERY
CLAUSE

Docket No. 090009-EI
Submitted for Filing: July 28, 2009

**PROGRESS ENERGY FLORIDA
REDACTED DOCUMENTS**

**09NC-OPCPOD7-94-000718
Through
09NC-OPCPOD7-94-000724**