

Ruth Nettles

090392-WS

From: Trina Collins [TCollins@RSBattorneys.com]
Sent: Tuesday, January 19, 2010 4:57 PM
To: Filings@psc.state.fl.us
Cc: smlubertozzi@uiwater.com; keweeks@uiwater.com; pcflynn@uiwater.com; jdwilliams@uiwater.com; frankdenjup@att.net; dswain@milianswain.com; Jared Deason; Jennifer Brubaker; Martin Friedman; Christian W. Marcelli; Trina Collins
Subject: Filing in Docket No.: 090392-WS; Application of Utilities, Inc. of Pennbrooke for an Increase in Water and Wastewater Rates in Lake County, Florida
Importance: High
Attachments: PSC Clerk 09 (Response to Staff's 1st Data Request).ltr.pdf

- a. Martin S. Friedman, Esq.
Christian W. Marcelli, Esq.
Rose, Sundstrom & Bentley, LLP
Sanlando Center
2180 W. State Road 434, Suite 2118
Longwood, FL 32779
Phone: (407) 830-6331
Fax: (407) 830-8522
Email: cmarcelli@rsbattorneys.com
- b. Docket No. 090392-WS; Application of Utilities, Inc. of Pennbrooke for an Increase in Water and Wastewater Rates in Lake County, Florida - Filing the Utility's responses to the Commission Staff's December 18, 2009 correspondence requesting additional information
- c. Utilities, Inc. of Pennbrooke
- d. 73 Pages.
- e. Letter to Commission Clerk and response attachments 73 pages.

DOCUMENT NUMBER-DATE

00455 JAN 20 0

FPSC-COMMISSION CLERK

LAW OFFICES
ROSE, SUNDBSTROM & BENTLEY, LLP
2548 BLAIRSTONE PINES DRIVE
TALLAHASSEE, FLORIDA 32301

FREDERICK L. ASCHAUER, JR.
CHRIS H. BENTLEY, P.A.
ROBERT C. BRANNAN
F. MARSHALL DETERDING
JOHN R. JENKINS, P.A.
KYLE L. KEMPER
STEVEN T. MINDLIN, P.A.
CHASITY H. O'STEEN
WILLIAM E. SUNDBSTROM, P.A.
DIANE D. TREMOR, P.A.
JOHN L. WHARTON

ROBERT M. C. ROSE (1924-2006)

(850) 877-6555
FAX (850) 656-4029
www.tsbattorneys.com

REPLY TO CENTRAL FLORIDA OFFICE

CENTRAL FLORIDA OFFICE
SANLANDO CENTER
2180 W. STATE ROAD 434, SUITE 2118
LONGWOOD, FLORIDA 32779
(407) 830-6331
FAX (407) 830-8522

MARTIN S. FRIEDMAN, P.A.
BRIDGET M. GRIMSLEY
CHRISTIAN W. MARCELLI
BRIAN J. STREET

January 19, 2009

E-FILING

Ann Cole, Commission Clerk
Office of Commission Clerk
Florida Public Service Commission
2540 Shumard Oak Boulevard
Tallahassee, FL 32399

RE: Docket No.: 090392-WS; Application of Utilities, Inc. of Pennbrooke for an
Increase in Water and Wastewater Rates in Lake County, Florida
Our File No. 30057.177

Dear Ms. Cole:

The following are the Utility's responses to the Commission Staff's December 18,
2009 correspondence requesting additional information:

1. The following items relate to the pro forma plant improvements
reflected in adjustment (A)(5) on MFR Schedule A-3.

For each addition, provide the following:

- (a) a statement why each addition is necessary;
- (b) a copy of all invoices and other support documentation if the
plant addition has been completed or in process;
- (c) a copy of the signed contract or any bids, if the plant addition has
not been completed;
- (d) a status of the engineering and permitting efforts, if the plant
addition has not been through the bidding processing; and

DOCUMENT NUMBER-DATE

00455 JAN 20 09

FPSC-COMMISSION CLERK

- (e) the projected in-service date for each outstanding plant addition.

RESPONSE:

1. Replace Well #1

- (a) Engineering design, permitting, construction inspection, and well drilling services associated with the complete replacement of Well #1 due to imminent failure of its well casing, which would result in a failure to produce sufficient amounts of water during peak day demand periods. The casing comes in contact with the pump bowls of Pump #1 each time the pump cycles off causing damage to the pump assembly and to the interior of the casing. Well #1 cannot be relied upon to function as designed, which significantly impairs the Utility's ability to maintain adequate pressure and volume during peak demand periods as required by rule.
- (b) The project has not yet started, but the work is budgeted for completion in 2010.
- (c) Attached is a proposal by CPH Engineers for the design, permitting and construction services activities associated with this project at a cost of \$36,143. Also attached is an engineering estimate of the cost to construct the proposed well for \$408,250. This estimate was produced by comparing the cost of the proposed new well to a recent bid proposal submitted to the City of Eustis with similar aquifer characteristics and production zone.
- (d) The engineering consultant and his two sub-consultants (for electrical engineering and hydrogeology services) have been selected and are prepared to start work immediately.
- (e) It is estimated that the design and permitting process will take approximately 4 months followed immediately by the bidding process with construction to be completed by December 31, 2010.

2. WTP Electrical improvements

- (a) Replace an undersized 200 amp service with a new 400 amp service, appropriately sized breaker and new pump control panel containing three (3) HSP starters and two (2) well pump starters and controls. Replace the existing 175 amp breaker at the emergency generator with a 350 amp breaker so that the all of the generator's output can be used to its maximum. Replace

- the existing 200 amp ATS with a 400 amp ATS so that the generator can supply power to all critical equipment.
- (b) The electrical system's components have been evaluated to determine which ones must be replaced, but the work has not yet commenced.
 - (c) Attached is a proposal from Thompson Electric Co. in the amount of \$54,965 to complete the proposed project.
 - (d) The project has been successfully bid out and the preferred contractor selected.
 - (e) The projected in-service date is expected to be completed by the end of the third quarter, 2010.
3. Lift Station Upgrade (including pumps, control panel, and 100 amp underground electric service)
- (a) Pennbrooke Lift Station #1 is a master lift station; all influent flow generated daily within the community passes through this pump station. The existing submersible sewage pumps are undersized for peak flow generated during wet weather resulting in overflows into stormwater structures. The proposed solution is to replace the pumps with larger 5.0 Hp 3-phase Flygt pumps that have a larger pumping capacity as well as install a control panel equipped to operate the larger pumps. The existing pumps will be stored and used as backup pumps for lift stations 2, 3, or 4. The original control panel, installed in 1986, will be retired. An underground electric service will be installed to connect the pump station to the WWTP's emergency generator in order to insure the operability of the master lift station during power outages. This will allow for more efficient use of the Pennbrooke trailer mounted generator at the five remaining Pennbrooke lift stations so as to avoid overflow of raw sewage and the resulting health hazard.
 - (b) The project has not yet begun.
 - (c) Attached are proposals describing the delivery of parts, materials and labor to complete the job at a total cost of \$42,811.00.
 - (d) The suppliers and contractors for the project have been selected and are ready to proceed with the project.
 - (e) The new Flygt pumps and control panel are estimated to take 10-12 weeks to deliver with installation of the panel and electric service to follow. The project is scheduled to be completed before July 31, 2010.
2. The following item pertains to the Utility's water and wastewater treatment systems. Please provide your latest Wastewater Treatment Plant Site Map

that shows the wastewater plants, equalization tanks, filter and reclaimed water storage tank and any proposed additions.

RESPONSE: Please see the attached maps.

3. The following items relate to Pennbrooke's requested rate case expense.

(a) For each individual person, in each firm providing consulting services to the applicant pertaining to this docket, provide the billing rate, and an itemized description of work performed. Please provide detail of hours worked associated with each activity. Also, provide a description and associated cost for all expenses incurred to date.

(b) For each firm or consultant providing services for the applicant in this docket, please provide copies of all invoices for services provided to date.

(c) If rate consultant invoices are not broken down by hour, please provide reports that detail by hour, a description of actual duties performed, and amount incurred to date.

(d) Please provide an estimate of costs to complete the case by hour for each consultant or employee, including a description of estimated work to be performed, and detail of the estimated remaining expense to be incurred through the PAA process.

(e) Please provide an itemized list of all other costs estimated to be incurred through the PAA process.

RESPONSE: Please see the attached rate case expense update and rate case expense invoices.

4. According to the MFR Schedule B-3, the Utility has proposed pro forma adjustments to Salaries, Officer's Salaries, Pensions and Benefits, Vehicle Depreciation Expense, Well Replacement Depreciation Expense, and Payroll Taxes. Please provide all of the Utility's calculations, bases, workpapers, and support documentation for the above pro forma adjustments.

RESPONSE: Please see the attached documentation supported the respective pro forma adjustments.

5. According to the MFR Schedule B-3, Pennbrooke has proposed a pro forma Deferred Maintenance for a hydro Tank Inspection and for a Recoat Storage Tank Interior. Please provide all of the Utility's calculations, bases, workpapers, and support documentation for the above pro forma Deferred Maintenance.

RESPONSE: Please see the attached support documentation from Knight Engineering Consultants, Inc. and The Huntington Company.

Should you have any questions regarding this filing, please do not hesitate to give me a call.

Very truly yours,



CHRISTIAN MARCELLI
For the Firm

CWM/der
Enclosures

cc: Steven M. Lubertozi, Executive Director of Regulatory Accounting and Affairs (w/enclosures) (via e-mail)
Kirsten E. Weeks, Manager of Regulatory Accounting (w/enclosures) (via e-mail)
Patrick C. Flynn, Regional Director (w/enclosures) (via e-mail)
John Williams, Director of Governmental Affairs (w/enclosures) (via e-mail)
Mr. Frank Seidman (w/enclosures) (via e-mail)
Ms. Deborah Swain (w/enclosures) (via e-mail)
Jared Deason, Division of Economic Regulation (w/enclosures) (via e-mail)
Jennifer Brubaker, Esquire, Office of General Counsel (w/enclosures) (via e-mail)

M:\1 ALTAMONTE\UTILITIES INC\PENNBROOKE\177) 2009 Rate Case\FSC Clerk 09 (Response to Staff's 1st Data Request).ltr.doc



August 5, 2009

Mr. Bryan Gongre
Regional Manager
Utilities, Inc. of Pennbrooke
200 Weathersfield Ave.
Altamonte Springs, FL 32714

101 North Woodland Boulevard
Suite 600
DeLand, Florida 32720

Phone: 386.736.4142
Fax: 386.736.8412

www.cphengineers.com

Re: Pennbrooke Water System, Well #1 Replacement, PWS ID No. 3354653

Dear Mr. Gongre:

We are pleased to submit this proposal to provide professional engineering services associated with the design and construction of a replacement to the existing Well #1. It is our understanding that this well experiences stability problems in operation that affects the well pump.

Scope of Services

Services under this contract are design and construction services. Subconsultant services for each shall include Bailey Engineering for the electrical engineering design, permitting and construction administration and the Colinas Group for well construction testing, oversight and permitting.

The scope of work included in *design services* comprises the design, permitting, and bidding of the new replacement well to the existing Well #1. It is our understanding that the new Well #1 is needed to match the current conditions of the existing Well #1. Permits will be acquired through St Johns River Water Management, Florida Department of Environmental Protection, and Lake County.

The scope of work included in *construction services* comprises shop drawing review, Contractor coordination, subconsultant review and coordination, on-site inspections, contract start-up and close-out, and pay request review. Assuming that the proposed well is placed within 100 feet of the existing well, it is our preliminary opinion that the cost of construction for the replacement well will be approximately \$400,000.

Payment

Compensation paid Engineer for services described herein and rendered by principals and employees assigned to the project are computed by multiplying Standard Classification Billing Rates for all classifications of employees directly engaged on the project, times the number of hours worked on the project.

The *fee for design services*, described herein is estimated to be \$19,110.00, including out-of-pocket expenses, without increase. The *fee for construction services*, described herein is estimated to be \$17,033.00, including out-of-pocket expenses, without increase. A more detailed description of these fees has been provided in Attachment A of this proposal.

A 10% markup will be applied to subconsultant services coordinated through CPH. Out-of-pocket expenses and subconsultant costs will be specifically identified in periodic invoicing, and include such items as transportation and subsistence of principals and employees when traveling in



connection with the project, toll telephone calls, photocopies, blueprints and plots, etc. Invoices will be submitted periodically, indicating the hours expended during that billing cycle.

Progress invoices will be submitted based on the Engineer's estimate of the percent of work complete at the time of invoicing.

Expenses for items not specifically valued herein are to be reimbursed to the engineer at the actual cost thereof. Said expenses shall include transportation and subsistence of principals and employees, when traveling in connection with the Project, toll telephone calls, and similar project related items.

Charges for the services rendered by principals and employees as witnesses in any litigation, hearing or proceeding in accordance with this Contract will be computed at a rate of \$600 per day or any portion thereof.

If this Contract is terminated during prosecution of the services prior to completion of the services, payments to be made on account of that and all prior work under this Contract shall be due and payable, and shall constitute total payment for services rendered. In addition, upon termination, engineer shall be paid for any Supplementary Services authorized and rendered.

If you are in agreement with the terms and fees proposed, please sign on the space provided below and return one (1) copy to us.

Terms and Agreement

The Terms and Agreement (Exhibit A - attached) made part of this contract shall apply for the professional services outlined above.

If you have any questions, please contact our office.

Sincerely,
CPH ENGINEERS, INC.

Erin M. Reed, P.E.
Project Manager

Stephen N. Romano, P.E.
Vice President/Branch Manager

DESIGN SERVICES ACCEPTED BY (\$19,110.00):

UTILITIES, INC. OF PENNBROOKE

Date: _____

CONSTRUCTION SERVICES ACCEPTED BY (\$17,033.00):

UTILITIES, INC. OF PENNBROOKE

Date: _____

ATTACHMENT A

DETAIL OF SERVICES		
ITEM	DESCRIPTION	COST
DESIGN SERVICES		
D.1	Design and Bidding	\$ 8,450
D.2	Permitting	\$ 5,750
D.3	Electrical sub-consultant	\$ 3,500
D.4	Hydrogeologist sub-consultant	\$ 500
D.5	Reimbursables	\$ 910
DESIGN TOTAL		\$ 19,110
CONSTRUCTION SERVICES		
C.1	Bidding Construction Administration	\$ 4,870
C.2	Project Closeout - Certification / Record Drawings	\$ 5,220
C.3	Electrical sub-consultant	\$ 1,800
C.4	Hydrogeologist sub-consultant	\$ 5,143
CONSTRUCTION TOTAL		\$ 17,033
TOTAL PROJECT COST		\$ 36,143

**EXHIBIT A
Standard Provisions to Agreement**

Agreement between Utilities, Inc. of Pembroke (hereinafter referred to as "OWNER/CLIENT") and CPH Engineers, Inc. (hereinafter referred to as "CPH") for professional services which may include engineering, surveying, architecture, landscape architecture, environmental, forestry, planning, transportation/traffic, etc. dated August 5, 2009.

Standard of Care

CPH will endeavor to provide services in a manner consistent with the level of care and skill ordinarily exercised by other professionals under similar circumstances practicing in the same or similar locality. The standard of care shall be exclusively judged at the time services are rendered and not according to later standards. CPH makes no express or implied warranty with regard to its services.

Compensation, Out of Pocket and Subcontract Expenses

"Compensation" as used in the Agreement includes those costs which are connected with the conditions of employment and pay of the employees and include salaries of those employees directly engaged in the performance of the requested services and employer contributions for social security, workers compensation, unemployment and payroll taxes, medical and insurance benefits, retirement benefits, holiday and sick leave pay and other allowed benefits. "Out of Pocket Expenses" as used in the Agreement include such items as travel and subsistence, printing and reproduction, telephone/communications charges, freight, postage, computer and similar costs. "Subcontract Expenses" as used in this Agreement include subcontracts for special consultants such as licensed land surveyors, soils borings and geotechnical and geohydrological services, laboratory services, environmental scientist services and other professional scientific or technical service organizations.

Invoice payments are due upon receipt of the invoice and must be kept current for services to continue. If the OWNER/CLIENT fails to pay any invoice due within 45 days of the date of the invoice, CPH may, without waiving any other claim or right against OWNER/CLIENT, suspend services under this agreement until CPH has been paid in full all amounts due CPH and/or any of its consultants and subconsultants. OWNER/CLIENT shall pay CPH interest at 12% per annum on all invoices that remain unpaid for more than 45 days.

Additional Services

"Additional Services" of CPH are services which are not considered normal or customary basic services, except to the extent provided in the basic Agreement, and may include such items as preparation of grant or funding applications and supporting documents; additional services or costs resulting from significant changes in the scope or extent of the project or its design or project delays; providing renderings or models for the OWNER/CLIENT's use; preparing documents for alternate bids; furnishing the services of special consultants; resident project representation or resident inspection; services resulting from the award of additional separate contracts; special field surveys; reproducible Record Drawings or original Drawings; providing "as-built" drawings; additional services during construction; serving as a consultant or witness for the OWNER/CLIENT during any litigation, public hearing, etc.; and services normally furnished by the OWNER/CLIENT; or other services not otherwise specifically provided for in the Agreement. Additional services are not included in the basic payment provisions of the Agreement except to the extent specifically provided herein.

Opinions of Cost

Since CPH has no control over the cost of labor, materials, equipment or services furnished by others, or over the CONTRACTOR(s)' methods of determining prices, or over competitive bidding or market conditions, our opinions of probable project cost and construction cost are made on the basis of our experience and qualifications and represent our best judgment as an experienced and qualified professional, familiar with the construction industry; but CPH cannot and does not guarantee that proposals, bids, or actual project costs or construction costs will not vary from opinions of probable cost prepared by us.

Re-Use of Documents

All documents including Drawings and Specifications prepared by CPH pursuant to this Agreement belong to CPH and are instruments of our service in respect to the project. They are not intended or represented to be suitable for reuse by

the OWNER/CLIENT on another project or any extension of this project, or for use by others on this project, any extension, or any other project.

Underground Utilities and Structures

The locations of all existing utilities shown on the drawings prepared by CPH will be based on surveys of at-grade or above grade physical culture (such as valve boxes, hydrants, utility poles, permanent markers) and surveying to pick up temporary utility locate markings provided by the utility. CPH assumes no responsibility for the accuracy of utilities shown by temporary markings provided by the utility or the locations of utilities based on other non-physical features (such as plans prepared by others including mark-ups of locations provided by the utility). The below grade vertical and horizontal locations of utilities will not be required to be surveyed by CPH, and consequently, CPH assumes no responsibility for the location of below grade utilities. The OWNER/CLIENT agrees to release CPH from any liability to OWNER/CLIENT for the failure to locate any existing utility where its physical location could not have reasonably been known based on the above.

Termination

The obligation to provide further services under this Agreement, may be terminated by either party upon fifteen (15) days' written notice in the event of substantial failure by the other party to perform in accordance with the terms of the Agreement through no fault of the terminating party. If the Agreement is terminated during prosecution of the services and prior to the completion of services, CPH shall be compensated by the OWNER/CLIENT for all services performed under this Agreement to the date of termination. In addition, CPH will be paid for all reasonable expenses resulting from such termination.

Construction Administration

Where construction administration is provided as a part of the basic services as outlined in the Agreement, CPH shall not be required to make exhaustive or continuous on-site inspections, but shall make periodic observations as may be outlined in more detail in the basic Agreement. CPH shall not be responsible for the means, methods, techniques, procedures of construction, or schedules selected by the CONTRACTOR or the safety precautions and programs incident to the work of the CONTRACTOR. CPH will periodically visit the site at intervals outlined in the Agreement to become generally familiar with the progress of the work to keep the Owner advised of the work. CPH will observe the work of the CONTRACTOR to endeavor to determine if the work is in general conformance with the project documents. CPH shall not be responsible for the failure of the CONTRACTOR to perform the construction work in accordance with the Documents. CPH shall provide the OWNER/CLIENT with written notice of any uncorrected defects or deficiencies coming to its attention in the course of the periodic visits above-mentioned. During such visits and on the basis of its on-site observations, CPH may recommend to the OWNER that the CONTRACTOR's work be disapproved or rejected as failing to conform to the Documents. CPH shall not have the right or duty to stop the CONTRACTOR's work.

Professional Services Provided by Others

Surveying, soils, planning, architecture, landscape architecture, legal, accounting, construction inspection and other services may be provided by the OWNER/CLIENT or others on this project and the results furnished to CPH. It is agreed that CPH may rely upon the results of those services by others in performing its work without verification of same. CPH assumes no responsibility for the accuracy or technical adequacy of such professional services provided by others.

CPH's Approval for Payment

Approval of a CONTRACTOR's application for payment is an expression of opinion by CPH and shall at no time be considered as legal obligation on the part of CPH. Neither shall same be considered as an acceptance of any work or materials furnished. CPH's approval for payment is an expression of opinion by CPH that to the best of our knowledge, information and belief, the quality of the work included for payment is in general accordance with the Contract Documents (subject to an evaluation of the work as a functioning improvement upon substantial completion and to the results of any subsequent tests or inspection made). By approving an application for payment, CPH will not be deemed to have represented that we have made any examination of how or for what purpose any CONTRACTOR has used the money paid on any of the CONTRACTOR's work or that title to any of the CONTRACTOR's work, materials or equipment has passed to the OWNER/CLIENT, free and clear of any liens, claims, security interests or encumbrances.

Checking of Shop Drawings

Checking of shop drawings is only for general conformance with the design concept of the project and general compliance with the information given in the Contract Documents. Any action shown is subject to the requirements of the Plans and Specifications. It is the CONTRACTOR's responsibility and not that of the CPH, for dimensions which shall be confirmed and correlated at the job site; fabrication processes and techniques of construction; coordination of his work with that of all other trades and the satisfactory performance of his work.

Pre-existing Contaminants

CPH shall not be considered a generator, transporter, or disposer of materials affected by regulated contaminants. Because involvement with OWNER/CLIENT's contaminated substances can expose CPH to severe risks, OWNER/CLIENT shall, to the fullest extent permitted by law, waive any claim against CPH, and indemnify, defend, and hold CPH harmless from any claim or liability for injury or loss allegedly arising from CPH's involvement with OWNER/CLIENT's contaminated substances. OWNER/CLIENT shall also compensate CPH for any time spent or expense incurred by CPH in defense of any such claim. Such compensation shall be based on CPH's prevailing fee schedule and expense reimbursement policy.

Site Safety Responsibilities

CPH's site responsibilities are limited solely to the activities of CPH and CPH's employees on the site. These responsibilities shall not be inferred by any party to mean that CPH has responsibility for site safety for any reason. Safety in, on, or about the site is the sole and exclusive responsibility of the Contractor alone. The Contractor's methods of work performance, superintendence of the contractor's employees and subcontractors, and sequencing of construction are also the sole and exclusive responsibility of the Contractor alone. OWNER/CLIENT warrants that: 1) these responsibilities will be made clear in OWNER/CLIENT's agreement with the Contractor; 2) OWNER/CLIENT's agreement with the Contractor shall require the Contractor, to the extent of Contractor's negligence, to indemnify, defend, and hold OWNER/CLIENT and CPH harmless up to a limit of \$1,000,000 from any fine, penalty, claim, or liability for injury or loss arising from OWNER/CLIENT'S or CPH's alleged failure to exercise site safety responsibility; and 3) OWNER/CLIENT's agreement with the Contractor shall require the Contractor to make OWNER/CLIENT and CPH additional insureds under the Contractor's general liability insurance policy, which insurance protection shall be primary protection for OWNER/CLIENT and CPH, and shall hold OWNER/CLIENT and CPH harmless from claims, losses, and defense cost arising from the negligence of contractor or subcontractor on any tier up to a limit of \$1,000,000. Given the foregoing, OWNER/CLIENT also shall, to the fullest extent permitted by law, waive any claim against CPH, and indemnify, defend, and hold CPH harmless up to a limit of \$1,000,000 from any claim or liability for injury or loss arising from CPH's alleged failure to exercise site safety responsibility. OWNER/CLIENT also shall compensate CPH for any time spent and attorney fees and expenses incurred by CPH in defense of any such claim. Such compensation shall be based upon CPH's prevailing fee schedule and expense reimbursement policy. (The term "any claim" above referenced shall include, but not limited to, any claim for breach of contract, tort, or statute alleging negligence, errors, omissions, strict liability, statutory liability, breach of warranty, negligent misrepresentation, or other acts giving rise to liability.)

Governing Law, Venue, Jurisdiction

This instrument is to be interpreted and construed according to the laws of the State of Florida. It is agreed between the parties to this contract that any litigation, lawsuit or court action of any character arising from this agreement shall be filed and/or defended in Seminole County, Florida. All parties under this contract hereby voluntarily submit to the exclusive jurisdiction of the Florida Courts and the exclusive venue in Seminole County, Florida and do hereby waive any objections to either personal or subject matter jurisdiction of the Florida Courts or to said venue.

Attorney Fees and Costs

In connection with any dispute arising out of this Contract, each party shall be responsible for their own attorney's fees and costs incurred for services rendered in connection with such dispute, including appellate proceedings and post judgment proceedings.

Waiver of Consequential Damages

OWNER/CLIENT and CPH mutually agree to waive all claims of consequential damages, including, but not limited to, loss of use, lost profits, and delay damages, against each other, arising from disputes, claims, or other matters relating to this Agreement.

Project Development, Approvals and Scheduling

CPH will, in the course of its work, attempt to generally identify issues that would adversely affect the development of the site for use as proposed by the Owner/Developer. However, CPH cannot control the regulatory process, actions of others, or unforeseen conditions and does not guarantee that the project can be developed for use as proposed, nor does CPH guarantee the timing of or ultimate regulatory approval of the site for development as proposed.

The local, state, and federal entities and authorities ("Authorities") having jurisdiction over the project may or may not approve the proposed use of the project. Additionally, it is uncertain how long those Authorities will take to consider and to take action on the applications for the proposed use of the project. Said decisions and approvals are subject to the decision making process of those Authorities. Therefore, CPH cannot represent or guarantee that said Authorities will approve, in whole or in part, the requested use of the project or that the decision making process will be timely for the project's use, or that the Authorities will grant variances applicable to the project. Therefore, the OWNER/CLIENT bears the risk of non-approval of the proposed use and the timing thereof. The OWNER/CLIENT needs to consider the ramifications to it if the project is not approved or only approved in part.

Limitation of Liability:

Site Check Studies

OWNER/CLIENT acknowledges that CPH's Site Check Studies pursuant to this Agreement are general in nature and are performed before design is started or completed. OWNER/CLIENT acknowledges the recommendation of CPH that the OWNER/CLIENT should not close on the subject property unless and until all applicable agency approvals are obtained and the permitting process is completed. If OWNER/CLIENT elects to close on the subject property prior to that time, OWNER/CLIENT accepts all risks and liability from closing prior to obtaining all applicable agency approvals and completion of the permitting process. The OWNER/CLIENT agrees to limit the liability of CPH and CPH's officers, directors, and employees for any and all claims arising from CPH's or CPH's officers', directors', and employees' professional acts, negligence, errors, omissions, breach of this contract, or indemnity relating to CPH's Site Check Studies under this contract such that the total aggregate liability of CPH and CPH's officers, directors, and employees to the OWNER/CLIENT shall not exceed the fee for the Site Check Study paid by OWNER/CLIENT to CPH under this Agreement or \$10,000, whichever is greater.

Design And Other Professional Services

OWNER/CLIENT acknowledges that CPH's services pursuant to this Agreement are to assist the client and are for the scope of services as outlined in the attached contract. The OWNER/CLIENT agrees to limit the liability of CPH and CPH's officers, directors, and employees for any and all claims arising from CPH's or CPH's officers', directors', and employees' professional acts, negligence, errors, omissions, breach of this contract, or indemnity, such that the total aggregate liability of CPH and CPH's officers, directors, and employees to the OWNER/CLIENT shall not exceed the fee paid by OWNER/CLIENT to CPH under this Agreement or \$50,000, whichever is greater.

City of Eustis Bid #012-07

Qty.	Description	Vendors ->	Tab Sheet			
		Diversified Drilling	A.C. Shultes of Flor.	McMahan Constr.	Brandes Design	
LS	Mobilization and Demobilization (Not to exceed 10% of the total base bid)		52,000.00	72,500.00	40,000.00	45,000.00
	Preconstruction Video		785.00	1,000.00	1,000.00	500.00
LS	Obtain SJRWMD well construction permit		350.00	500.00	1,000.00	1,000.00
200 lf	Furnish & Install 24" well casing (0.375" min. wall thickness - by Cable Tool Method)		63,000.00	90,000.00	50,000.00	60,000.00
80 lf	Drilling nominal 23" diameter borehole		15,680.00	17,600.00	16,000.00	20,000.00
280 lf	Furnish & Install 16" well casing (0.375" min. wall thickness)		27,440.00	33,600.00	15,400.00	18,200.00
400 sks	Grout 16" well casing in place		6,000.00	20,000.00	12,000.00	14,000.00
480 lf	Drilling Nominal 15" diameter borehole		81,600.00	96,000.00	72,000.00	86,400.00
LS	Geophysical Logging		7,500.00	4,000.00	6,500.00	7,500.00
LS	Furnish, install and remove test pump and appurtenance devices for well development, step-drawdown test, & Aquifer Performance Test.		7,500.00	15,000.00	8,500.00	10,000.00
24 hrs.	Well Development		6,720.00	4,800.00	7,200.00	8,400.00
LS	Step Drawdown Test		2,560.00	3,200.00	2,000.00	3,000.00
48 hrs.	Constant Rate Discharge Test		13,440.00	7,200.00	14,400.00	16,800.00
LS	Physical/Chemical Sampling and Testing. (During drilling and Aquifer Performance Test)		6,000.00	6,000.00	3,000.00	3,500.00
LS	Disinfection of well		3,500.00	2,000.00	3,000.00	4,000.00
LS	Bacteriological sampling and testing (18 minimum out of 20 samples) for well		3,600.00	6,000.00	2,000.00	2,500.00
LS	Priority Pollutant testing of well (FDEP)		5,000.00	3,000.00	4,500.00	6,000.00
LS	Pump & Motor 1800 gpm/100 HP		19,800.00	45,000.00	40,000.00	45,000.00
LS	Concrete Pedestal, slab, piping, pump column, valves, fencing and gate, site restoration, and miscellaneous work for well		5,800.00	142,000.00	122,600.00	6,000.00
LS	Sodium Hypochlorite One Pump Skid		9,983.00	24,000.00	12,000.00	26,000.00
225 lf	12" DIP Raw Water Main		50,850.00	24,750.00	9,000.00	39,375.00
18 lf	14" DIP Raw Water Main		5,040.00	2,250.00	900.00	3,330.00
LS	12" Raw Water Meter		4,000.00	6,000.00	4,970.00	11,000.00
1.03 TN	Fittings		8,652.00	3,090.00	1,030.00	3,090.00
2 ea.	12" Gate Valve		3,600.00	6,000.00	3,000.00	5,000.00
LS	Electrical and Instrumentation		115,500.00	161,000.00	70,000.00	70,000.00
	Total Base Bid Amount		\$525,900.00	\$796,490.00	\$522,000.00	\$515,595.00
						Contingency

City of Eustis Bid #012-07

Penbrook Estimate
\$35,000.00
\$1,000.00
\$1,000.00
\$50,000.00
\$15,000.00
\$15,000.00
\$10,000.00
\$50,000.00
\$8,500.00
\$8,500.00
\$7,000.00
\$3,000.00
\$14,000.00
\$5,000.00
\$3,000.00
\$2,000.00
\$4,500.00
\$35,000.00
\$10,000.00
\$0.00
\$20,000.00
\$0.00
\$4,000.00
\$1,500.00
\$4,000.00
\$50,000.00
\$355,000.00
\$53,250.00
\$408,250.00

Thompson Electric Company

P.O. Box 1478 Winter Park, FL 32790
Phone: (407) 365-6666 fax: (407) 365-9358

1.2 c

Proposal

January 11, 2010

Utilities, Inc.
200 Weathersfield Avenue
Altamonte Springs, FL 32714
Attn: Bryan Gongre

Reference: Pennbrooke Fairways WTP, New Service and Control Panel

Dear Bryan Gongre,

Thompson Electric is pleased to offer the following quotation for your review.

Electrical installation as follows:

- New 400Amp 3 Phase 480V Electrical Service with the following:
 - 400Amp Self Contained Meter Base.
 - 400Amp 3 Pole NEMA 3R Service Rated 480V Transfer Switch.
 - 400Amp 3 Phase NEMA 3R I-Line Distribution Panel with 1 - 300Amp Control Panel Feeder Breaker and 1 - 40Amp XFMR Breaker.
- New 300Amp Feeder from 480V Distribution Panel to new Main Pump Control Panel.
- New Main Pump Control Panel.
 - 3 - 40HP High Service Pump Starters and Breakers.
 - 2 - 25HP Well Pump Starter and Breakers.
 - GST Well Control Logic with Alternator.
 - Distribution System Control Logic with Alternator.
 - Hydro Tank Air Add Control System.
 - Alarm Relay Logic for GST Tanks and Distribution System.
 - Alarm Light and Horn with Silence and Reset Buttons.
- Install new 350Amp Circuit Breaker in the existing Generator Breaker Enclosure.
- Install new 350Amp Feeder from New Generator Breaker to the new Generator Transfer Switch.
- Install new Control Conductors from the existing Generator to the new Generator Transfer Switch.
- Install new Conduit and Wire to pick up existing loads from the new Main Pump Control panel to the existing Pump Control Panel (add Terminal Strips as necessary).
- Remove existing 225Amp Transfer Switch and Wiring.
- Remove old Breakers, Starters and Controls from existing Pump Control Panel to make way for new Wire Terminal Strip to pick up existing Pump Circuits.
- Furnish Electrical Permit and Inspections as required.

TOTAL PRICE - \$54,965.00

Thompson Electric Company

P.O. Box 1478 Winter Park, FL 32790
Phone: (407) 365-6666 fax: (407) 365-9358

1.3c

Proposal

Page 1 of 2

Page 2 of 2

Pennbrooke Fairways WTP, New Service and Control Panel

This proposal may be withdrawn by us if not accepted within 30 days.

Respectfully submitted,

William P. Bahler
Project Manager

WPB/ssk

Acceptance of Proposal - By signing below, you hereby agree that the above prices, specifications, and conditions are satisfactory and are hereby accepted. Thompson Electric Company is authorized to perform the work as outlined above. Payment will be made to Thompson Electric Company when the work has been completed.

Client Signature: _____

Date: _____

Business Unit # - _____

OP # - _____

Thompson Electric Company

P.O. Box 1478 Winter Park, FL 32790
Phone: (407) 365-6666 fax: (407) 365-9358

1.3c

PROPOSAL

December 23, 2009

Utilities, Inc.
200 Weathersfield Avenue
Altamonte Springs, FL 32714
Attn: Chuck Schwades

Reference: Pennbrooke Fairways Lift Station No. 1 Control Panel Replacement

Dear Chuck Schwades,

Thompson Electric is pleased to offer the following quotation for your review.

- Install (new) owner furnished 3Ø Lift Station Pump Control Panel
- Connect Floats and Pumps to new Panel
- Connect Panel to new 3Ø Service furnished under separate contract.

TOTAL \$8,500.00

~~NOTE~~ This does not include Electrical Service.

Respectfully submitted,

William P. Bahler
Project Manager

WPB/ssk

Acceptance of Proposal – By signing below, you hereby agree that the above prices, specifications, and conditions are satisfactory and are hereby accepted. Thompson Electric is authorized to perform the work as outlined above. Payment will be made to Thompson Electric when the work has been completed.

Client Signature: _____

Date: _____

Business Unit # - _____

OP # - _____

Thompson Electric Company

P.O. Box 1478 Winter Park, FL 32790
Phone: (407) 365-6666 fax: (407) 365-9358

1.3c

PROPOSAL

December 23, 2009

Utilities, Inc.
200 Weathersfield Avenue
Altamonte Springs, FL 32714
Attn: Chuck Schwades

Reference: Pennbrooke Fairways Lift Station No. 1 Modifications

Dear Chuck Schwades,

Thompson Electric is pleased to offer the following quotation for your review.

Install new 100Amp 120/240v 3Ø 4 Wire underground service from WWTP service, (this will be on Generator Power during power failure) to new 3Ø Pump Control Panel furnished and installed under separate contract.

(New service only) TOTAL \$17,000.00

~~(Note)~~ This does not include new Control Panel installation (existing Panel is 1Ø)

Respectfully submitted,

William P. Bahler
Project Manager

WPB/esk

Acceptance of Proposal – By signing below, you hereby agree that the above prices, specifications, and conditions are satisfactory and are hereby accepted. Thompson Electric is authorized to perform the work as outlined above. Payment will be made to Thompson Electric when the work has been completed.

Client Signature: _____

Date: _____

Business Unit # - _____

OP # - _____



ITT

ITT Water & Wastewater Florida, LLC 1.3c
Flygt Products
2152 Sprint Blvd, Apopka Florida 32703
Phone: 407-880-2900 • Fax: 407-880-2962

To: Utilities Inc. of Florida

Date: January 8, 2010

Subject: Pennbrook Fairways LS #1
Quote Number: 2010-APO-0016

We are pleased to offer the following equipment:

- (2) 4" Flygt NP3102/463 submersible wastewater pumps, 5hp, 3/230v, each with 50' of motor cable.
- (1) Duplex control panel to Utilities Inc. standards, 5hp, 3/230v.
- (4) Liquid level sensing floats, each with 40' of cable.
- (1) Startup service by a representative of this company.

Price: \$17,311.00, plus taxes, freight included, F.O.B. factory.

THIS PROPOSAL WILL EXPIRE IN NINETY (90) DAYS UNLESS EXTENDED IN WRITING BY ITT WATER & WASTEWATER.

NOTE: WE DO NOT SUPPLY, PIPING, VALVES, GUIDE BARS, PRESSURE GAUGES, DISCONNECTS, JUNCTION BOXES, KELLUMS GRIPS, SURGE PROTECTION EQUIPMENT, SPARE PARTS, LABOR OR ANY OTHER ITEM NOT SPECIFICALLY LISTED ABOVE.

TERMS: Subject to credit approval net 45 days after date of invoice or 100% payable before start-up of equipment (whichever comes first). A service charge of 1.5% per month will be added to all balances unpaid 30 days after invoice date. Failure to pay in accordance with these terms will void all warranties. A cancellation charge of 20% of the value of the order will be assessed for special orders or control panels cancelled after production is completed.

- CONDITIONS:**
1. Price is firm based on our receiving complete approval and release for productions four (4) weeks after drawings have been submitted by ITT Water & Wastewater, Florida, LLC.
 2. PARTIAL BILLING WILL BE MADE ON ANY PARTIAL SHIPMENT.

We thank you for your interest in our equipment and look forward to being of service to you in the near future.

IN THE ABSENCE OF A FORMAL ISSUED PURCHASE ORDER, A SIGNED FACSIMILE COPY OF THIS PROPOSAL IS ACCEPTABLE AS A BINDING CONTRACT.

ITT Water & Wastewater, Florida, LLC

Company Name: _____

Accepted By: _____

Dale M. Jahn

Print Name: _____

Salesman

Date: _____



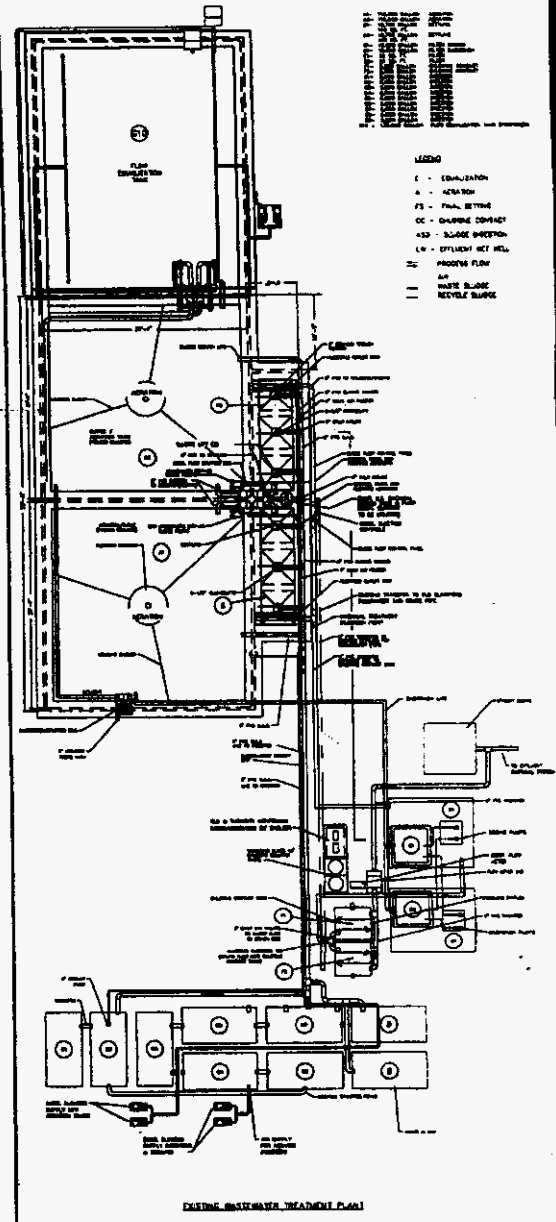
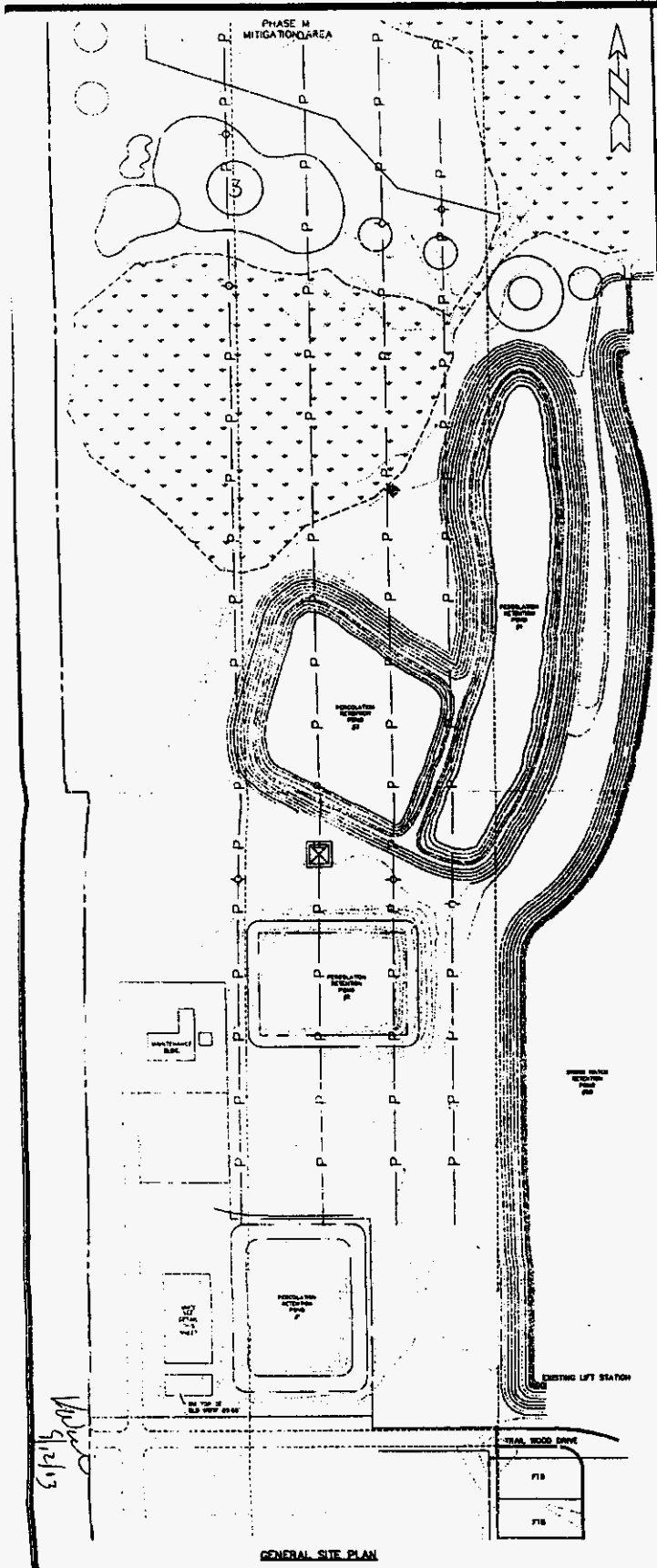

Drawn by	NEWSON	DATE
Checked by		
Date	12-12-84	
Scale	1"=60'	
File No.	16332-C2	
Sheet: 1 of		

PENNBROOKE UTILITIES, INC.
WASTEWATER TREATMENT FACILITY
SITE PLAN

PENNBROOKE UTILITIES, INC.
 501 S.R. 44
 LEESBURG, FLORIDA 34748
 (352) 328-5600



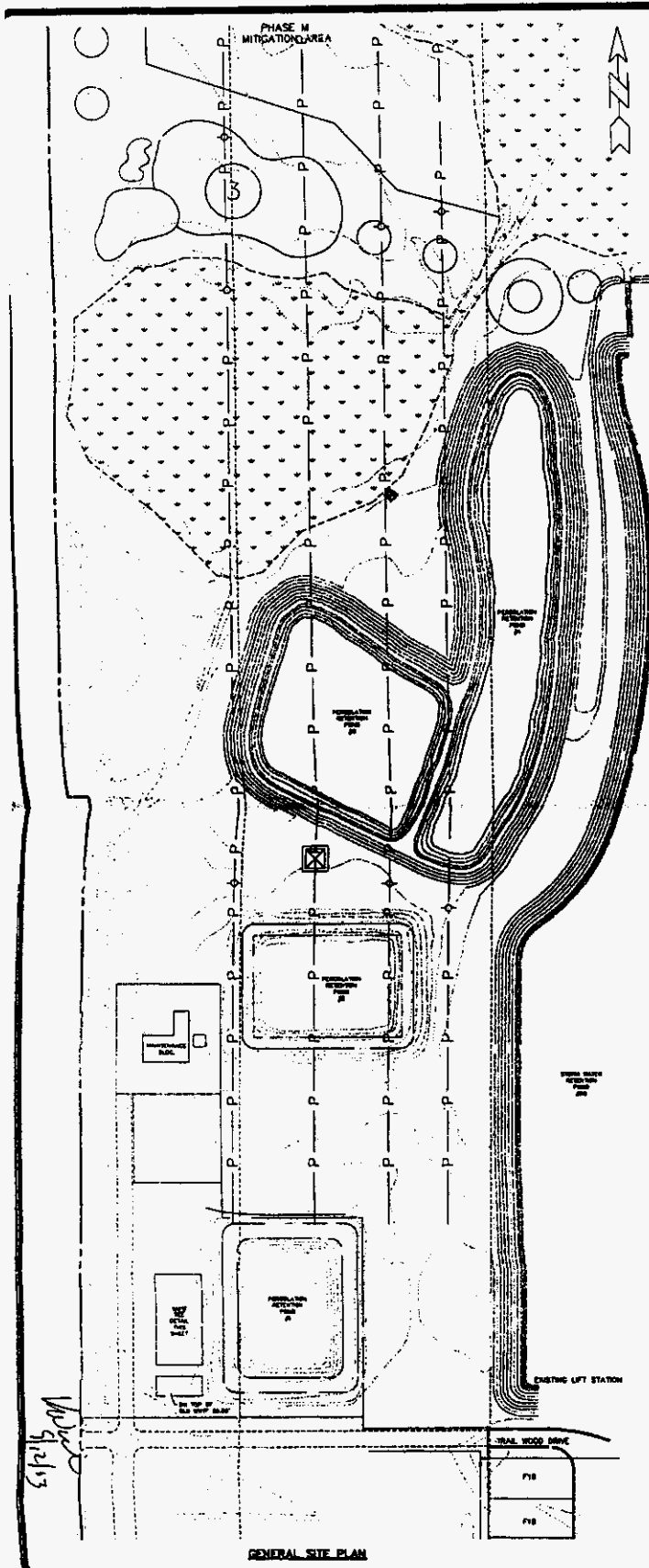

GENERAL SITE PLAN

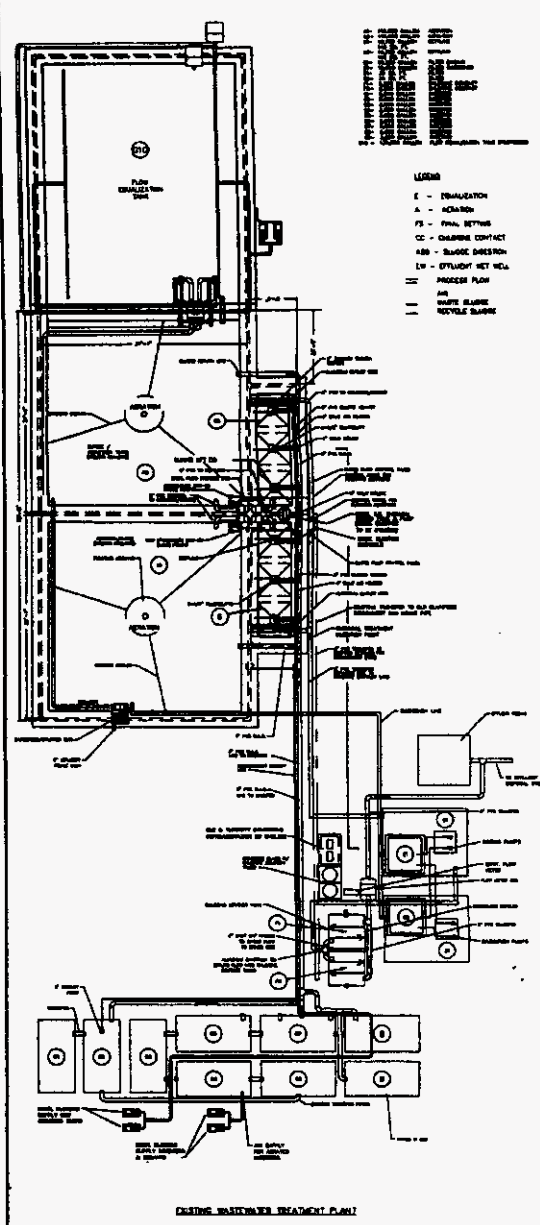

EXISTING WASTEWATER TREATMENT PLANT

Drawn by	REYBON	BATD
Checked by		
Date	10-18-86	
Scale	1"=40'	
File No.	1828-02	
Sheet: 1 of 1		

PENNBROOKE UTILITIES, INC.
WASTEWATER TREATMENT FACILITY
SITE PLAN

PENNBROOKE UTILITIES, INC.
 301 S.R. 44
 LEESBURG, FLORIDA 34748
 (352) 326-5600



**Explanation: Provide the total amount of rate case expenses requested in the application. State whether the total includes the amount up to proposed agency action or through a hearing before the Commission. Provide a list of each firm providing service.

(1)	(2)	(3.00)	(4)	(5)	(6)			
Line #	Firm or Vendor Name	Hourly Rate Per Person	Estimated Hours	Total Estimated of Charges by Firm	Actual Hours Incurred as of 12/31/09	Actual Amounts Charged as of 12/31/09	Amount Remaining from Original Estimate	Type of Service Rendered
1	Milam, Swain & Associates	200.00	-	-	-	-	-	Assist w/MFRs, data requests, multi facilitation
2	Milam, Swain & Associates	140.00	-	-	-	-	-	Assist w/MFRs, data requests, multi facilitation
3	Milam, Swain & Associates	140.00	-	-	-	-	-	Assist w/MFRs, data requests, multi facilitation
4	Ross, Sandstrom & Bessley, LLP	290.00	112.50	32,825	27	13,300.00	19,324	Legal Fees (includes \$4000.00 Billing Fee)
4	Ross, Sandstrom & Bessley, LLP	320.00	112.50	36,000	3	224.00	35,776	Legal Fees
5	M&R Consultants	145.00	240.00	35,000	209	30,365.00	4,635	UB&J Analysis, Assist w/ MFRs, data requests, multi facilitation
6	Public Service Commission	n/a	n/a	4,000	-	-	4,000	Filing Fee (included in Christian Marroli's Actual Amounts Charged)
7	Water Service Corp.	n/a	n/a	-	-	423.23	-	(423) Costs associated with Auditors coming to visit Northbrook, IL office
7	Water Service Corp.	29.00	275	7,975	117	3,393.00	4,582	Assist w/MFRs, data requests, multi facilitation
8	Water Service Corp.	28.00	0	-	59	1,647.52	(1,648)	Assist w/MFRs, data requests, multi facilitation
8	Water Service Corp.	62.00	40	2,480	2	93.00	2,387	Billing Analysis, Implementation of Rates
9	Water Service Corp.	33.92	40	1,357	-	-	1,357	Assist w/MFRs, data requests, multi facilitation
10	Water Service Corp.	37.93	0	-	14	521.54	(522)	Assist w/MFRs, data requests, multi facilitation
10	Water Service Corp.	106.24	20	2,125	-	-	2,125	Assist w/MFRs, data requests, multi facilitation
11	Water Service Corp.	33.92	201	6,794	-	-	6,794	Assist w/MFRs, data requests, multi facilitation
11	Water Service Corp.	37.93	0	-	18	682.74	(683)	Assist w/MFRs, data requests, multi facilitation
12	Water Service Corp.	36.90	0	-	6	243.13	(243)	Assist w/MFRs, data requests, multi facilitation
12	Water Service Corp.	33.92	50	1,696	-	-	1,696	Assist w/MFRs, data requests, multi facilitation
13	Water Service Corp.	37.93	0	-	2	75.86	(76)	Assist w/MFRs, data requests, multi facilitation
12	Water Service Corp.	36.90	0	-	1	38.90	(39)	Assist w/MFRs, data requests, multi facilitation
13	Water Service Corp.	33.00	30	990	-	-	990	Billing Analysis, Implementation of Rates
14	Water Service Corp.	33.92	20	678	3	101.76	377	Assist w/MFRs, data requests, multi facilitation
15	Water Service Corp.	37.93	0	-	32	455.16	(453)	Assist w/MFRs, data requests, multi facilitation
15	Water Service Corp.	111.00	40	4,440	1	111.00	4,329	Assist w/MFRs, data requests, multi facilitation
16	Water Service Corp.	48.00	10	400	-	-	400	Billing Analysis, Implementation of Rates
17	Water Service Corp.	15.00	20	300	23	378.75	(79)	Assist w/MFRs, data requests, multi facilitation
18	Water Service Corp.	39.00	350	13,650	148	5,772.00	7,878	Assist w/MFRs, data requests, multi facilitation
18	Water Service Corp.	36.00	8	288	8	270.00	(18)	Assist w/MFRs, data requests, multi facilitation
19	Water Service Corp.	40.00	0	-	39	1,540.00	(1,540)	Assist w/MFRs, data requests, multi facilitation
18	Water Service Corp.	37.93	0	-	1	37.93	(38)	Customer Notices, Mailings, etc.
19	Water Service Corp.	32.00	20	640	-	-	640	Customer Notices, Mailings, etc.
20	Water Service Corp.	43.01	100	4,301	-	-	4,301	Assist w/MFRs, data requests, multi facilitation
21	Water Service Corp.	23.00	0	-	2	34.50	(35)	Assist w/MFRs, data requests, multi facilitation
20	Water Service Corp.	49.00	250	12,250	151	7,399.00	4,851	Assist w/MFRs, data requests, multi facilitation
21	Water Service Corp.	50.00	0	-	30	1,500.00	(1,500)	Assist w/MFRs, data requests, multi facilitation
22	Water Service Corp.	81.50	30	2,445	-	-	2,445	Assist w/MFRs, data requests, multi facilitation
23	Water Service Corp.	n/a	n/a	2,336	-	-	2,336	Customer notices, postage
24	Water Service Corp.	n/a	n/a	286	-	-	286	Customer notices, stock
25	Water Service Corp.	n/a	n/a	1,200	-	-	1,200	Travel, Airfare
26	Water Service Corp.	n/a	n/a	1,600	-	-	1,600	Travel, Hotel/Accommodations
27	Water Service Corp.	n/a	n/a	400	-	-	400	Travel, Rental Car
28	Water Service Corp.	n/a	n/a	-	-	-	-	Printing Services, copies
29	Water Service Corp.	n/a	n/a	-	-	66.49	(66)	Temp Services
30	Water Service Corp.	n/a	n/a	12,000	-	13.72	11,986	Post. Exp & other misc.
32	Estimate Through			\$ 187,758		68,929.12	\$ 118,829	
33								
34	JA PAA							
35	Commission Hearing							
36								
37	Amortization Period 4 Years							
38	Explanation of difference from Section 367.0616, Florida							
39								
40	Amortization of Rate Case Expenses:							
41								
42		(A)	(B)	(C)				
43	Water		Water	Total				
44	Prior amortized rate case expenses		0	\$ -				
45	Current rate case expenses	101,423.48	86,333	187,758				
46	Total proposed rate case expenses	101,423.48	86,333	187,758				
47	Assess Amortization	25,354.37	5,214.83	30,569.20				
48								
49	Method of allocation between systems:							
50								
51	Customer (based on ERCCounter 12/31/08)	1,465.00	1247.0	2712.0				
52								
53	Percentage of average customer	0.54	46%	100%				

260	2010161	2907	001	Wuola, Kirsten Ellen	418	7/17/2009	49.00	49.00	AA	61279
260	2010161	2907	001	Wuola, Kirsten Ellen	415	7/17/2009	24.50	24.50	AA	61278
260	2010161	2907	001	Wuola, Kirsten Ellen	415	7/17/2009	490.00	490.00	AA	61278
260	2010161	2907	001	Purvis, Eric Patricia	415	7/17/2009	99.00	99.00	AA	61278
260	2010161	2907	001	Wuola, Kirsten Ellen	415	7/17/2009	490.00	490.00	AA	61278
260	2010161	2907	001	Wuola, Kirsten Ellen	418	7/17/2009	490.00	490.00	AA	61278
260	2010161	2907	001	Wuola, Kirsten Ellen	418	7/17/2009	49.00	49.00	AA	61279
260	2010161	2907	001	Purvis, Eric Patricia	415	7/17/2009	99.00	99.00	AA	61278
260	2010161	2907	001	Purvis, Eric Patricia	415	7/17/2009	99.00	99.00	AA	61278
260	2010161	2907	001	Wuola, Kirsten Ellen	418	7/17/2009	49.00	49.00	AA	61279
260	2010161	2907	001	Purvis, Eric Patricia	415	7/17/2009	99.00	99.00	AA	61278
260	2010161	2907	001	Wuola, Kirsten Ellen	415	7/17/2009	99.00	99.00	AA	61278
260	2010161	2907	001	Wuola, Kirsten Ellen	415	7/17/2009	99.00	99.00	AA	61278
260	2010161	2907	001	Purvis, Eric Patricia	415	7/17/2009	99.00	99.00	AA	61278
260	2010161	2907	001	Purvis, Eric Patricia	415	7/17/2009	99.00	99.00	AA	61278
260	2010161	2907	001	Wuola, Kirsten Ellen	418	7/17/2009	49.00	49.00	AA	61279
260	2010161	2907	001	Clemens, Daniel	465	8/15/2009	147.00	147.00	AA	63261
260	2010161	2907	001	Clemens, Daniel	465	8/15/2009	18.97	18.97	AA	63261
260	2010161	2907	001	Clemens, Daniel	465	8/15/2009	10.00	210.00	AA	63261
260	2010161	2907	001	Purvis, Eric Patricia	415	8/15/2009	49.00	49.00	AA	63261
260	2010161	2907	001	Clemens, Daniel	468	8/15/2009	273.00	273.00	AA	63776
260	2010161	2907	001	Clemens, Daniel	468	8/15/2009	42.00	42.00	AA	63776
260	2010161	2907	001	Clemens, Daniel	468	8/15/2009	84.00	84.00	AA	63776
260	2010161	2907	001	Clemens, Daniel	468	8/15/2009	14.00	14.00	AA	63776
260	2010161	2907	001	Clemens, Daniel	468	8/15/2009	65.51	65.51	AA	63776
260	2010161	2907	001	Purvis, Eric Patricia	468	8/15/2009	331.30	331.30	AA	63776
260	2010161	2907	001	Very, John Patrick	464	8/15/2009	111.00	111.00	AA	63776
260	2010161	2907	001	Martinez, Mikekella	490	8/20/2009	52.30	52.30	AA	64923
260	2010161	2907	001	Purvis, Eric Patricia	477	9/15/2009	117.00	117.00	AA	64922
260	2010161	2907	001	Purvis, Eric Patricia	477	9/15/2009	19.50	19.50	AA	64922
260	2010161	2907	001	Purvis, Eric Patricia	477	9/15/2009	156.00	156.00	AA	64922
260	2010161	2907	001	Wuola, Kirsten Ellen	477	9/15/2009	343.00	343.00	AA	64922
260	2010161	2907	001	Wuola, Kirsten Ellen	477	9/15/2009	588.00	588.00	AA	64922
260	2010161	2907	001	Wuola, Kirsten Ellen	477	9/15/2009	441.00	441.00	AA	64922
260	2010161	2907	001	Flynn, Patrick C	477	9/15/2009	75.36	75.36	AA	64921
260	2010161	2907	001	Wuola, Kirsten Ellen	477	9/15/2009	686.00	686.00	AA	64921
260	2010161	2907	001	Clemens, Daniel	477	9/15/2009	140.00	140.00	AA	64922
260	2010161	2907	001	Clemens, Daniel	477	9/15/2009	84.00	84.00	AA	64922
260	2010161	2907	001	Purvis, Eric Patricia	477	9/15/2009	156.00	156.00	AA	64922
260	2010161	2907	001	Purvis, Eric Patricia	477	9/15/2009	39.00	39.00	AA	64922
260	2010161	2907	001	Clemens, Daniel	477	9/15/2009	56.00	56.00	AA	64922
260	2010161	2907	001	Wuola, Kirsten Ellen	477	9/15/2009	588.00	588.00	AA	64922
260	2010161	2907	001	Wuola, Kirsten Ellen	477	9/15/2009	147.00	147.00	AA	64922
260	2010161	2907	001	Purvis, Eric Patricia	477	9/15/2009	312.00	312.00	AA	64922
260	2010161	2907	001	Heath, Peggy Jean	483	9/22/2009	113.79	113.79	AA	65696
260	2010161	2907	001	Heath, Peggy Jean	483	9/22/2009	75.86	75.86	AA	65696
260	2010161	2907	001	Heath, Peggy Jean	483	9/22/2009	75.86	75.86	AA	65696
260	2010161	2907	001	DeFonseca, Susan M	483	9/22/2009	28.43	28.43	AA	65696
260	2010161	2907	001	DeFonseca, Susan M	483	9/22/2009	9.48	9.48	AA	65696
260	2010161	2907	001	Martinez, Mikekella	483	9/22/2009	37.50	37.50	AA	65696
260	2010161	2907	001	Martinez, Mikekella	483	9/22/2009	15.00	15.00	AA	65696
260	2010161	2907	001	Heath, Peggy Jean	483	9/22/2009	75.86	75.86	AA	65696
260	2010161	2907	001	DeFonseca, Susan M	483	9/22/2009	113.79	113.79	AA	65696
260	2010161	2907	001	DeFonseca, Susan M	483	9/22/2009	274.99	274.99	AA	65696
260	2010161	2907	001	DeFonseca, Susan M	483	9/22/2009	75.86	75.86	AA	65696
260	2010161	2907	001	Martinez, Mikekella	483	9/22/2009	60.00	60.00	AA	65696
260	2010161	2907	001	Clemens, Daniel	486	9/22/2009	45.00	45.00	AA	65820
260	2010161	2907	001	Clemens, Daniel	486	9/22/2009	84.00	84.00	AA	65820
260	2010161	2907	001	Clemens, Daniel	486	9/22/2009	56.00	56.00	AA	65820
260	2010161	2907	001	Clemens, Daniel	486	9/22/2009	324.00	324.00	AA	65820
260	2010161	2907	001	Purvis, Eric Patricia	486	9/22/2009	97.50	97.50	AA	65820
260	2010161	2907	001	Purvis, Eric Patricia	486	9/22/2009	156.00	156.00	AA	65820
260	2010161	2907	001	Purvis, Eric Patricia	486	9/22/2009	117.00	117.00	AA	65820
260	2010161	2907	001	Purvis, Eric Patricia	486	9/22/2009	117.00	117.00	AA	65820
260	2010161	2907	001	Purvis, Eric Patricia	486	9/22/2009	117.00	117.00	AA	65820
260	2010161	2907	001	Flynn, Patrick C	486	9/22/2009	18.97	18.97	AA	65820
260	2010161	2907	001	Flynn, Patrick C	486	9/22/2009	37.93	37.93	AA	65820
260	2010161	2907	001	Flynn, Patrick C	486	9/22/2009	113.79	113.79	AA	65820
260	2010161	2907	001	Flynn, Patrick C	486	9/22/2009	66.38	66.38	AA	65820
260	2010161	2907	001	Flynn, Patrick C	486	9/22/2009	56.90	56.90	AA	65820
260	2010161	2907	001	Cummins, Bryan Keith	486	9/22/2009	75.86	75.86	AA	65820
260	2010161	2907	001	Purvis, Eric Patricia	486	9/22/2009	117.00	117.00	AA	65820
260	2010161	2907	001	Purvis, Eric Patricia	486	9/22/2009	156.00	156.00	AA	65820
260	2010161	2907	001	Clemens, Daniel	486	9/22/2009	36.00	36.00	AA	65820
260	2010161	2907	001	Martinez, Mikekella	492	10/20/2009	3.75	3.75	AA	67121
260	2010161	2907	001	Martinez, Mikekella	492	10/20/2009	37.50	37.50	AA	67121
260	2010161	2907	001	Valrie, LaWanda H	492	10/20/2009	34.56	34.56	AA	67121
260	2010161	2907	001	Heath, Peggy Jean	489	10/15/2009	37.93	37.93	AA	67121
260	2010161	2907	001	Wuola, Kirsten Ellen	489	10/15/2009	9.48	9.48	AA	67121
260	2010161	2907	001	Wuola, Kirsten Ellen	489	10/15/2009	49.00	49.00	AA	67121
260	2010161	2907	001	Wuola, Kirsten Ellen	489	10/15/2009	196.00	196.00	AA	67121
260	2010161	2907	001	Wuola, Kirsten Ellen	489	10/15/2009	196.00	196.00	AA	67121
260	2010161	2907	001	Purvis, Eric Patricia	489	10/15/2009	156.00	156.00	AA	67121
260	2010161	2907	001	Purvis, Eric Patricia	489	10/15/2009	117.00	117.00	AA	67121
260	2010161	2907	001	Purvis, Eric Patricia	489	10/15/2009	117.00	117.00	AA	67121
260	2010161	2907	001	Purvis, Eric Patricia	489	10/15/2009	78.00	78.00	AA	67121
260	2010161	2907	001	Clemens, Daniel	489	10/15/2009	84.00	84.00	AA	67121
260	2010161	2907	001	Clemens, Daniel	489	10/15/2009	56.00	56.00	AA	67121
260	2010161	2907	001	Clemens, Daniel	489	10/15/2009	84.00	84.00	AA	67121
260	2010161	2907	001	Purvis, Eric Patricia	489	10/15/2009	117.00	117.00	AA	67121
260	2010161	2907	001	Purvis, Eric Patricia	489	10/15/2009	117.00	117.00	AA	67121
260	2010161	2907	001	Purvis, Eric Patricia	489	10/15/2009	117.00	117.00	AA	67121
260	2010161	2907	001	Purvis, Eric Patricia	489	10/15/2009	78.00	78.00	AA	67121
260	2010161	2907	001	Martinez, Mikekella	495	10/20/2009	67.50	67.50	AA	68183
260	2010161	2907	001	Martinez, Mikekella	495	10/20/2009	60.00	60.00	AA	68183
260	2010161	2907	001	Clemens, Daniel	501	10/15/2009	84.00	84.00	AA	68643
260	2010161	2907	001	Clemens, Daniel	501	10/15/2009	28.00	28.00	AA	68643
260	2010161	2907	001	Purvis, Eric Patricia	501	10/15/2009	175.50	175.50	AA	68643
260	2010161	2907	001	Purvis, Eric Patricia	501	10/15/2009	117.00	117.00	AA	68643
260	2010161	2907	001	Purvis, Eric Patricia	501	10/15/2009	234.00	234.00	AA	68643
260	2010161	2907	001	Flynn, Patrick C	501	10/15/2009	18.97	18.97	AA	68643
260	2010161	2907	001	Clemens, Daniel	501	10/15/2009	56.00	56.00	AA	68643

260	2010161	2907	901	Ciccomini, Daniel	907	11/15/2009	116.00	116.00	AA	69637
260	2010161	2907	901	Ciccomini, Daniel	907	11/15/2009	116.00	116.00	AA	69637
260	2010161	2907	901	Flynn, Patrick C	307	11/15/2009	38.68	38.68	AA	69637
260	2010161	2907	901	Flynn, Patrick C	307	11/15/2009	48.23	48.23	AA	69637
260	2010161	2907	901	Waska, Kristin Elise	907	11/15/2009	600.00	600.00	AA	69637
260	2010161	2907	901	Waska, Kristin Elise	907	11/15/2009	500.00	500.00	AA	69637
260	2010161	2907	901	Waska, Kristin Elise	907	11/15/2009	400.00	400.00	AA	69637
260	2010161	2907	901	Flynn, Patrick C	307	11/15/2009	116.00	116.00	AA	69637
260	2010161	2907	901	Ciccomini, Daniel	907	11/15/2009	200.00	200.00	AA	70574
260	2010161	2907	901	Perioli, Eric Patricia	518	11/02/2009	40.00	40.00	AA	70574
260	2010161	2907	901	Perioli, Eric Patricia	518	11/02/2009	240.00	240.00	AA	70574
260	2010161	2907	901	Perioli, Eric Patricia	518	11/02/2009	320.00	320.00	AA	70574
260	2010161	2907	901	Perioli, Eric Patricia	518	11/02/2009	38.68	38.68	AA	70574
260	2010161	2907	901	Conroy, Bryan Keith	518	11/02/2009	38.68	38.68	AA	70574
260	2010161	2907	901	Flynn, Patrick C	307	11/02/2009	116.00	116.00	AA	70574
260	2010161	2907	901	Ciccomini, Daniel	518	11/02/2009	87.00	87.00	AA	70574
260	2010161	2907	901	Ciccomini, Daniel	518	11/02/2009	145.00	145.00	AA	70574
260	2010161	2907	901	Ciccomini, Daniel	518	11/02/2009	58.00	58.00	AA	70574
260	2010161	2907	901	Ciccomini, Daniel	518	11/02/2009	116.00	116.00	AA	70574
260	2010161	2907	901	Flynn, Patrick C	307	11/02/2009	58.00	58.00	AA	70574
260	2010161	2907	901	Perioli, Eric Patricia	526	12/15/2009	160.00	160.00	AA	71840
260	2010161	2907	901	Perioli, Eric Patricia	526	12/15/2009	120.00	120.00	AA	71840
260	2010161	2907	901	Perioli, Eric Patricia	526	12/15/2009	120.00	120.00	AA	71840
260	2010161	2907	901	Perioli, Eric Patricia	526	12/15/2009	80.00	80.00	AA	71840
260	2010161	2907	901	Perioli, Eric Patricia	526	12/15/2009	80.00	80.00	AA	71840
260	2010161	2907	901	Ciccomini, Daniel	526	12/15/2009	116.00	116.00	AA	71840
260	2010161	2907	901	Ciccomini, Daniel	526	12/15/2009	45.50	45.50	AA	71840
260	2010161	2907	901	Flynn, Patrick C	532	12/15/2009	48.23	48.23	AA	71840
260	2010161	2907	901	Perioli, Eric Patricia	532	12/15/2009	140.00	140.00	AA	71840
260	2010161	2907	901	Ciccomini, Daniel	532	12/15/2009	87.00	87.00	AA	71840
260	2010161	2907	901	Ciccomini, Daniel	532	12/15/2009	58.00	58.00	AA	71840
260	2010161	2907	901	Flynn, Patrick C	532	12/15/2009	48.23	48.23	AA	72921
260	2010161	2907	901	Perioli, Eric Patricia	532	12/15/2009	9.65	9.65	AA	72921
260	2010161	2907	901	Ciccomini, Daniel	532	12/15/2009	80.00	80.00	AA	72921
260	2010161	2907	901	Ciccomini, Daniel	532	12/15/2009	116.00	116.00	AA	72921
260	2010161	2907	901	Ciccomini, Daniel	532	12/15/2009	116.00	116.00	AA	72921
260	2010161	2907	901	Ciccomini, Daniel	532	12/15/2009	58.00	58.00	AA	72921
260	2010161	2907	901	Ciccomini, Daniel	532	12/15/2009	45.50	45.50	AA	72921
260	2010161	2907	901	Ciccomini, Daniel	532	12/15/2009	58.00	58.00	AA	72921
260	2010161	2908	903	OFFICE TRAM	149136	3/24/2009	66.49	66.49	AA	50302
260	2010161	2908	901	FEDERAL EXPRESS	192175	9/21/2009	13.72	13.72	AA	64923
260	2010161	2909	901	PUBLIC SERVICE COMMISSION	219548	12/10/2009	343.79	343.79	AA	71300
260	2010161	2909	901	PUBLIC SERVICE COMMISSION	219557	12/10/2009	280.44	280.44	AA	71300
260	2010161	2910	901	MANAGEMENT & REGULATORY COUNCIL	175691	7/27/2009	1,160.00	1,160.00	AA	69294
260	2010161	2910	901	MANAGEMENT & REGULATORY COUNCIL	176634	7/8/2009	1,160.00	1,160.00	AA	69183
260	2010161	2910	901	MANAGEMENT & REGULATORY COUNCIL	176634	7/8/2009	1,480.00	1,480.00	AA	69183
260	2010161	2910	901	MANAGEMENT & REGULATORY COUNCIL	193373	6/8/2009	2,175.00	2,175.00	AA	64029
260	2010161	2910	901	MANAGEMENT & REGULATORY COUNCIL	209913	1/14/2009	3,190.00	3,190.00	AA	64747
260	2010161	2910	901	MANAGEMENT & REGULATORY COUNCIL	209916	1/14/2009	18,225.00	18,225.00	AA	64747
260	2010161	2910	901	MANAGEMENT & REGULATORY COUNCIL	212951	1/11/2009	3,190.00	3,190.00	AA	64773
260	2010161	2910	901	MANAGEMENT & REGULATORY COUNCIL	212951	1/11/2009	13,960.00	13,960.00	AA	64773
260	2010161	2910	901	MANAGEMENT & REGULATORY COUNCIL	232099	12/16/2009	72.30	72.30	AA	73521
260	2010161	2910	901	MANAGEMENT & REGULATORY COUNCIL	232099	12/29/2009	941.30	941.30	AA	72240
260	2010161	2914	901				72,770.08	(3,942.10)		68,827.98
260	2010161	2914	901				72,770.08	(3,942.10)		68,827.98
260	2010161	2914	901							

Planned
Unplanned

2008 TY FLORIDA RATE CASES
SALARY ADJUSTMENT SUMMARY

Utilities, Inc. of Pennbrooke

Operations (601/701):	
From w/p a	\$164,066
Per books	175,215
Adjustment	<u>(\$11,148)</u>
W	<u>(\$6,022)</u>
WW	<u>(\$5,126)</u>
Office (601/701):	
From w/p a	\$49,759
Per books	55,111
Adjustment	<u>(\$5,351)</u>
W	<u>(\$2,891)</u>
WW	<u>(\$2,460)</u>
Officers (603/703):	
From w/p a	\$13,383
Per books	27,266
Adjustment	<u>(\$13,883)</u>
W	<u>(\$7,499)</u>
WW	<u>(\$6,384)</u>
Captive Adjustment (601/701):	
From w/p c	(\$17,864)
Per books	(18,840)
Adjustment	<u>\$976</u>
W	<u>\$527</u>
WW	<u>\$449</u>
Payroll Taxes (408.12):	
From w/p a	\$17,978
Per books	16,321
Adjustment	<u>\$1,658</u>
W	<u>\$895</u>
WW	<u>\$762</u>
Benefits (604/704):	
From w/p a	\$43,780
Per books	49,571
Adjustment	<u>(\$5,792)</u>
W	<u>(\$3,129)</u>
WW	<u>(\$2,663)</u>
Vehicles (341.5/391.7)	
From w/p b and b-1	\$73,633
Per books	82,155
Adjustment	<u>(\$8,521)</u>
W	<u>(\$4,603)</u>
WW	<u>(\$3,918)</u>
Vehicle A/D (108.1)	
From w/p b and b-1	(\$29,927)
Per books	(62,834)
Adjustment	<u>\$32,907</u>
W	<u>\$17,776</u>
WW	<u>\$15,131</u>
Vehicle Depreciation Expense (341.5/391.7)	
From w/p a and b-1	\$10,465
Per books	8,543
Adjustment	<u>\$1,922</u>
W	<u>\$1,038</u>
WW	<u>\$884</u>
Vehicle Transportation Expense (650/750)	
From w/p b-2	\$17,508
Per books	18,395
Adjustment	<u>(\$887)</u>
W	<u>(\$479)</u>
WW	<u>(\$408)</u>

2005 TV FL RATE CASE
SALARY ADJUSTMENT

July 04

Index	Name	Position	Vehicle Number	Depreciation Start	Vehicle Price	Vehicle Accumulated Depreciation	Vehicle Depreciation Expense
	Alder, James	Operator	0429	April 2004	\$18,233	(\$14,433)	\$3,800
	Anderson, David	Operator	0901	January 2009		*Will be included as a per item adjustment	
	Avanti Jr, Arthur	Field Technician	0514	February 2005	19,024	(12,419)	3,171
	Baloy, Alex	Operator	0280	June 2002	12,256	(13,256)	928
	Baloy, Alex	Operator	0301	September 2002	19,053	(19,053)	2,117
	Bass, Christopher	Motor Reader	0830	November 2007	20,820	(9,048)	3,670
	Bazzani, David	Operator	0434	July 2004	19,341	(14,321)	3,227
	Bazgon, John	Business Manager					
	Brown, Dore	Motor Reader	0019	January 2000	15,363	(15,363)	-
	Brown, Robert	Operator	0461	July 2004	16,797	(12,597)	2,799
	Callahan, Robert	Operator	0726	December 2006	17,224	(6,991)	2,871
	Canfield, Anthony	Operator	0457	May 2004	16,268	(8,870)	3,328
	Carver, Nathaniel	Project Manager	0659	July 2004	26,206	(10,119)	4,348
	Chad, Ronald	Cost Consultant/Spreader	0803	August 2007	17,962	(4,241)	2,994
	Coates, Bill	Area Manager	0422	March 2004	21,654	(17,444)	2,609
	Collins Jr, John	Operator	0703	September 2006	17,264	(6,753)	2,894
	Coit, James	Lead Operator	0110	September 2002	19,053	(19,053)	2,117
	Cooper, Ronald	Operator	0302	September 2002	19,053	(19,053)	2,117
	Cooper, Robert	Operator	0431	April 2004	24,240	(19,501)	4,207
	Correa, Jay	Lead Operator	0802	August 2007	17,962	(4,241)	2,994
	David, Donald	Lead Operator	0303	September 2002	19,053	(19,053)	2,117
	Deaton, Rick	Regional Vice President	0430	February 2004	17,506	(15,801)	5,418
	Diaz, Steven	Field Technician	0655	July 2004	16,386	(14,548)	3,221
	Dixon, James	Operator	0511	February 2005	19,054	(12,424)	3,171
	Dobson, Brian	Operator	0427	November 2007	17,277	(3,418)	2,930
	Dunn, Alvin	Operator	0102	October 2000	14,158	(14,158)	-
	Flankin, Jeffrey	Lead Operator	0637	February 2006	19,787	(9,418)	3,286
	Flynn, Patrick	Regional Operator	0512	February 2006	19,858	(14,851)	4,899
	Franke, Kenneth	Field Technician	0304	September 2002	13,889	(13,889)	1,365
	Franke, Orel	Operator	0766	July 1997	23,415	(23,415)	-
	Gallagher, Richard	Field Technician	0812	July 2007	20,347	(3,087)	3,391
	Garcia Jr, Leonard	Operator	0423	April 2004	19,054	(15,089)	3,176
	Gardner, Dwayne	Area Manager	0864	March 2008	22,372	(3,107)	3,487
	Gardner, Patrick	Lead Operator	0638	February 2006	19,634	(9,544)	3,272
	George, Bryan	Regional Manager	0818	October 2007	29,220	(6,689)	4,870
	Goodell, Scotty	Project Manager	0629	February 2006	25,851	(12,247)	4,809
	Greiner Jr, Leroy	Field Technician (PT)	0610	September 2005	18,681	(10,379)	3,114
	Hakney, Stephen	Lead Operator	0741	March 2007	16,707	(5,103)	2,785
	Harrison, Dan	Operator	0831	October 2007	19,447	(4,851)	3,241
	Hampson, Jerome	Operator	0728	January 2007	16,504	(5,301)	2,751
	Hays, Scotty	Safety Manager	0729	January 2007	20,136	(9,783)	4,899
	Hogan, Raymond	Operator	0771	May 2007	16,222	(4,506)	2,704
	Holliman, James	Field Technician	0810	July 2007	20,310	(3,077)	3,385
	Holsinger, Roger	Lead Operator	0450	April 2004	18,233	(14,433)	2,839
	Kay, Thomas	Lead Operator	0934	August 1998	14,946	(14,946)	-
	Kelso, Joseph	Lead Operator	0888	March 2008	18,205	(2,228)	2,538
	Leach, Mark	Field Technician	0897	July 2007	20,310	(3,077)	3,385
	Lennard, Scott	Field Technician	0658	May 2006	21,721	(8,242)	3,953
	Lewman, Alexander	Operator	0814	January 2000	15,363	(15,363)	-
	McFarland, John	Field Supervisor	0509	February 2005	29,473	(19,239)	4,912
	McPhee, Alton	Lead Operator	0448	June 2004	19,664	(15,921)	3,277
	Merrill, Matthew	Field Technician	0808	July 2007	20,347	(4,887)	3,381
	Nail, William	Area Manager	0823	November 2007	22,388	(4,333)	3,731
	Ortiz, Michael	Field Technician	0833	November 2007	20,253	(3,918)	3,376
	Parrell, Raymond	Operator	0701	September 2006	16,172	(6,389)	2,895
	Passmore, Jonathan	Field Technician	0813	August 2007	20,494	(4,839)	3,416
	Pfeist, Steve	Operator	0704	September 2006	16,020	(6,120)	2,670
	Phillips, Christopher	Operator	0903	December 2004	16,750	(11,409)	2,792
	Plunk, Jeffrey	Field Supervisor	0809	July 2007	20,347	(3,087)	3,391
	Precht, Thomas	Operator	0823	November 2007	17,577	(3,418)	2,930
	Raines, Craig	Lead Operator	0751	May 2007	16,222	(4,506)	2,704
	Ramberg, Roberts	Motor Reader	0824	November 2007	17,577	(3,418)	2,930
	Richardson, James	Operator	0635	March 2006	18,544	(8,737)	3,091
	Schneider, Keith	Operator	0611	May 2006	13,118	(5,919)	2,220
	Schultz, Kevin	Field Technician	0516	April 2005	16,561	(10,139)	2,760
	Schweizer, Charles	Area Manager	0544	May 2006	24,201	(10,736)	4,024
	Shuffell, David	Lead Operator	0608	September 2007	19,546	(4,644)	3,258
	Shaw, Anthony	Field Technician	0312	September 2002	18,619	(18,619)	2,058
	Silken, Emily	Area Manager	0428	April 2004	23,213	(20,039)	4,219
	Silken, Tary	Operator (PT)					
	Smith, Donald	Field Technician	0913	December 2004	22,344	(15,266)	3,724

2008 FY FL RATE CASE
SALARY ADJUSTMENT

7/1/08

Shelton, Stacy	Operator	0510	December 2004	21,924	(14,971)	1,654
Shover, Malcolm	Area Manager	0609	September 2005	22,545	(12,425)	1,758
Sokol, Corey	Lead Operator	0625	April 2004	18,233	(14,435)	3,639
Songhomer, James	Operator	0740	April 2007	16,424	(4,790)	2,737
Sompolovskii, Stephen	Operator	0705	October 2006	18,292	(8,360)	3,040
Tsui, David	Field Technician	0511	September 2005	17,711	(6,888)	2,951
Tsui, Paul	Field Technician	0536	February 2006	16,822	(8,080)	2,770
Vannote Jr, Nathan	Lead Operator	0562	July 2000	15,338	(15,138)	
Waldhild, Robert	Lead Operator	0739	April 2007	17,624	(4,565)	2,857
Wickham, Colby	Field Technician	0829	November 2007	20,820	(6,048)	3,470
White, Ronald	Field Supervisor	0811	July 2007	20,310	(5,077)	3,385
Wurshfeldt, Anthony	Project Manager	0435	July 2004	23,138	(17,360)	3,860
Williams, Ellen	Operator	0424	April 2004	18,233	(14,435)	3,639
Wilson, Michael	Regional Manager	0728	January 2007	28,711	(9,579)	4,785
Woodside, Michael	Operator (PT)					
Worrell, David	Operator	0436	April 2004	18,847	(14,921)	3,141
Wright, James	Operator	0427	April 2004	18,742	(14,830)	3,124
Wright, Thomas	Field Technician	0721	January 2007	18,387	(6,129)	3,064
Abbas, Liana	Office Clerk (1)					
Adams, Kimberly	Customer Service Representative (1)					
Adkins, Isabel	Customer Service Representative (1)					
Alford, Matthew	Account Receivable Clerk (1)					
Christen, Ellen	Customer Service Representative (1)					
Drysdale, Susan	Self Assistant (1)					
Hahn, Peggy	Office Clerk (1)					
Mayfield, Loren	Customer Service Representative (1)					
Leitch, Lanna	Customer Service Representative (1)					
Neel, Brent	Office Clerk (1)					
Palmer, Benjamin	Account Receivable Clerk (1)					
Rapard, Ann	Office Clerk (1)					
Ross, Karen	Office Manager (1)					
Shiffon, Jacqueline	Customer Service Representative (1)					
Thompson, Emilylyn	Associate Payroll Clerk (1)					
Turner, Diane	Payroll Support					
Ward, Susan	Regulatory Assistant					
Walt, William	Operations Director					
Wassinger, Lora	Human Resources Consultant					
Wasson Jr, Barry	IT Manager					
Chang, Yoo	Account Payable Clerk (PT)					
Cheney, Ryanneleen	Regulatory Assistant					
Smith, Agnes	Administrative Assistant					
Cochran, Daniel	Regulatory Assistant *					
Crosson, Lisa	Chief Operations Officer					
Carroll, Eric	Plant Asset Accountant					
Dunn, Brian	IT Specialist					
Dave, Heidi	IT Specialist					
Di Marco, Michelle	Senior Accountant					
Dryden, Michael	Regulatory Accounting Manager					
Dolan, Carlos	Fixed Asset Accountant					
Faloutsos, Apollonia	Account Payable Manager					
Friedman, Avraie	Account Manager					
Georgiev, Lena	Regulatory Manager					
Gomez, Samuel	Data Entry Clerk					
Quinn, Deborah	Bill Clerk					
Harrell, Justin	Account Payable Clerk					
Haynes Jr, John	Director of Finance					
Hopkins, John Robert	Manager of Human Resources					
Hoy, John	Chief Regulatory Officer					
Jayash, James	Chief Financial Officer					
Kervey, Justin	Accountant					
Kim, Christine	Accounting Manager					
Krueger, Adrienne	Customer Service Representative Manager					
Krugman, Stacy	Executive Assistant					
Lingeman, Brent	Financial Analyst					
Laboranti, Susan	Chief Financial Officer					
Lappin, Nancy	Account Manager					
Layman, Phyllis	Account Manager					
Martinez, Barbara	Accountant					
Mazzoni, Michelle	Administrative Clerk (PT)					
Melhorn, Mary Ellen	Billing Specialist					

2008 TY FL RATE CASE
SALARY ADJUSTMENT

McClain, Pamela	Data Specialist	31,189	366	31,755	1,164	52,930	1,832	54,772	4,150	56	396	1,643	3,191	R,144
McLean, Pamela	Typist Support	54,420	-	54,420	2,224	33,624	1,947	37,371	4,404	56	396	1,727	2,303	R,144
Miles, Doreen	Regulatory Accountant	46,000	-	46,000	1,053	47,053	1,444	48,497	3,724	56	396	1,460	1,947	R,144
Minnick, Margaret	Account Manager	41,142	4,476	45,618	1,036	46,654	1,633	48,277	3,693	56	396	1,448	1,931	R,144
Minsky, Christopher	Billing Analyst	39,000	367	39,367	899	40,266	1,430	42,296	3,236	56	396	1,369	1,892	R,144
Nyquist, Dorely	Senior Regulatory Accountant	72,982	-	72,982	1,813	74,216	2,596	76,813	5,076	56	396	2,204	3,073	R,144
Oster, Tom	IT Manager	110,000	-	110,000	2,475	112,475	3,937	116,412	6,310	56	396	2,492	4,636	R,144
Panas, Nicholas	IT Specialist	40,997	325	41,322	930	42,252	1,480	43,732	3,248	56	396	1,313	1,730	R,144
Pode, Henry	Supervisor	33,648	43	33,691	790	33,981	1,236	37,137	2,841	56	396	1,114	1,482	R,144
Potter, Victoria	Senior Accountant	60,000	-	60,000	1,500	61,500	2,147	63,647	4,358	56	396	1,905	2,540	R,144
Potter, Erin	Senior Regulatory Accountant *	38,500	-	38,500	2,048	40,548	2,119	42,667	4,794	56	396	1,880	2,307	R,144
Ross, Kaitlin	Salary Coordinator	67,800	-	67,800	1,321	69,121	2,419	71,540	5,473	56	396	2,146	2,862	R,144
Rubens, William	Tax Accountant	73,501	-	73,501	1,699	75,200	2,702	79,902	6,112	56	396	2,397	3,196	R,144
Sabino, Melissa	Mail Clerk	34,216	5,436	39,652	892	40,544	1,419	41,963	3,230	56	396	1,239	1,679	R,144
Schmanker, Lawrence	President	349,500	-	349,500	7,839	357,339	11,591	368,930	11,982	56	396	11,090	14,786	R,144
Smith III, George	Project Manager	80,700	-	80,700	1,816	82,516	2,888	85,404	6,333	56	396	2,562	3,416	R,144
Shah, Kiranmudr	Field Agent Administrator	63,000	-	63,000	1,462	64,462	2,236	66,798	3,262	56	396	2,064	2,732	R,144
Shelton, Brian	Regulatory Accountant	50,100	-	50,100	1,127	51,227	1,793	53,020	4,228	56	396	1,591	2,121	R,144
Simmons, Robyn	Office Specialist	62,400	-	62,400	1,404	63,804	2,233	66,037	5,232	56	396	1,981	2,641	R,144
Smalley K. Thomas	Systems Specialist	61,600	-	61,600	1,374	62,974	2,185	64,808	4,943	56	396	1,938	2,584	R,144
Smith, George	Accounting Manager	72,500	-	72,500	1,611	74,111	2,595	76,706	5,070	56	396	2,202	2,968	R,144
Stee, Leslie	Executive Assistant	63,800	-	63,800	1,426	65,226	2,283	67,519	5,165	56	396	2,026	2,701	R,144
Stover, John	General Counsel	207,000	-	207,000	4,638	211,638	7,408	219,046	9,798	56	396	6,372	8,763	R,144
Sullivan, Donald	Business Director	362,700	-	362,700	3,616	366,316	3,721	370,037	9,086	56	396	3,102	6,803	R,144
Talia, Leonard	Administrative Clerk	29,994	37	30,031	636	30,706	1,073	31,781	2,421	56	396	953	1,271	R,144
Wicks, Kristin	Regulatory Accounting Manager *	81,510	-	81,510	2,771	84,281	2,530	87,231	6,073	56	396	2,617	3,489	R,144
Williams III, John	Director of Operational Affairs	102,000	-	102,000	2,299	104,299	3,630	107,949	8,187	56	396	2,230	4,319	R,144
Yip Jr, David	Regulatory Accountant	42,436	-	42,436	953	43,391	1,313	44,910	3,436	56	396	1,347	1,796	R,144
Young, David	Director of Strategic Planning	206,000	-	206,000	3,288	209,288	1,815	211,819	8,257	56	396	1,345	4,315	R,144
Zavitz, Aimee	Account Manager	38,000	4,110	42,110	917	43,027	1,311	44,338	6,276	56	396	1,130	1,800	R,144
		22,382,710	2107,414	24,490,124	311,923	24,802,047	637,000	25,439,047	7,750,227	89,376	247,227	\$303,808	\$405,744	1,321,966

2000 FY PL RATE CASES
SALARY ADJUSTMENT

wp a

McClain, Pamela	Data Specialist					
McLain, Pamela	Payroll Support					
Melan, Theresa	Regulatory Assessment					
Merritt, Margaret	Account Manager					
Messy, Christopher	Billing Analyst					
Myattson, Denise	Senior Regulatory Accountant					
Orfan, Tom	IT Manager					
Phelan, Nicholas	IT Specialist					
Pugh, Nancy	Receptionist					
Putnam, Valerie	Senior Accountant					
Reich, Rita	Senior Regulatory Accountant *					
Ross, Kimberly	Utility Cost/Benefit					
Salovey, William	Tax Accountant					
Schultz, Miriam	Mail Clerk					
Schumacher, Lawrence	President					
Scott III, George	Project Manager					
Shah, Kristin	Financial Accountant					
Shah, Steve	Regulatory Accountant					
Simmons, Robby	Office Specialist					
Smith, J. Thomas	Systems Specialist					
Small, George	Accounting Manager					
Shaw, Leslie	Executive Assistant					
Shover, John	General Counsel					
Stadler, Donald	Business Director	0649	February 2006	29,749	(14,463)	4,958
Valko, Lawrence	Administrative Clerk					
Watts, Kirstin	Regulatory Accounting Manager *					
Williams III, John	Director of Governmental Affairs					
Yap Jr, Lowell	Regulatory Accountant					
Yant, Darin	Director of Strategic Planning					
Zavala, Annette	Account Manager					
				<u>1,035,162</u>	<u>(992,163)</u>	<u>254,119</u>

2009 FY RATE CASES
SALARY ADJUSTMENT

USDA, Inc. of Pennsylvania	Position	Current Salary	2009 Quarterly	Total	Salary 2.27% Increase (September 09)	Total 2009	Salary 3.2% Increase (April 10)	Total Pro Forma Salary	Pro Forma FICA	Pro Forma FUTA	Pro Forma SUTA	Pro Forma Pension	Pro Forma 401K	Pro Forma Health Insurance
Alley, James	Operator													
Anderson, David	Operator	34,663	4,178	38,841	874	39,717	1,780	41,108	3,149	46	123	1,233	1,644	6,647
Asato Jr, Arthur	Field Technician													
Bailey, Alan	Operator													
Bailey, Alvin	Operator													
Bauer, Christopher	Motor Reader	5,080	51	5,131	115	5,246	184	5,432	416	10	26	163	217	1,390
Bennett, David	Operator													
Boungou, John	Business Manager	2,018	-	2,018	45	2,063	72	2,135	163	2	4	64	85	235
Brown, Thomas	Motor Reader													
Brown, Robert	Operator													
Callahan, Robert	Operator													
Carroll, Anthony	Operator													
Carver, Nathaniel	Project Manager	3,431	-	3,431	77	3,508	123	3,631	278	3	8	109	145	435
Chad, Ronald	Cost Construction Specialist													
Coates, Bill	Area Manager													
Collier Jr, John	Operator													
Conk, James	Lead Operator													
Cook, Ronald	Operator													
Copier, Robert	Operator													
Devree, Joe	Lead Operator													
Dick, Donald	Lead Operator													
Duchan, Edif	Regional Vice President	4,047	-	4,047	91	4,138	165	4,283	254	2	4	128	171	235
Ebert, Sharon	Field Technician													
Edson, James	Operator													
Birkholz, Brian	Operator	6,703	286	6,989	157	7,146	230	7,376	566	10	27	222	296	1,438
Finch, Alan	Operator													
Fordner, Jeffrey	Lead Operator													
Flynn, Patrick	Regional Director	4,411	-	4,411	99	4,510	158	4,668	334	2	6	140	187	303
Funklin, Kenneth	Field Technician													
Furnell, Cindy	Operator													
Gabara, Richard	Field Technician													
Gama Jr, Leonard	Operator													
Gardner, Dominick	Area Manager	3,226	-	3,226	73	3,299	113	3,414	281	3	9	102	137	486
Garvin, Paulie	Lead Operator													
Geiger, Bryan	Regional Manager	4,243	-	4,243	85	4,328	151	4,479	344	3	8	135	180	429
Givens, Scott	Project Manager													
Ginsinger Jr, Leroy	Field Technician (PT)													
Haley, Stephen	Lead Operator													
Hanlon, Don	Operator													
Hampton, James	Operator													
Harris, Scott	Utility Manager	2,130	-	2,130	48	2,178	76	2,254	172	2	4	68	90	235
Hays, Raymond	Operator													
Hollibaugh, Joseph	Field Technician													
Holmgren, Roger	Lead Operator													
Keen, Thomas	Lead Operator													
Kilmer, Joseph	Lead Operator													
Land, Mark	Field Technician													
Land, Scott	Field Technician													
Lanning, Alexander	Operator													
Mason, John	Field Supervisor													
McFay, Allan	Lead Operator	41,205	2,038	43,243	973	44,215	1,346	45,763	3,001	36	151	1,373	1,831	506
Morrell, Matthew	Field Technician													
Nail, William	Area Manager													
Owens, Michael	Field Technician	2,346	-	2,346	53	2,398	84	2,482	190	3	9	34	99	306
Parrish, Raymond	Operator	6,633	262	6,895	155	7,053	247	7,280	588	10	28	219	292	1,519
Pennington, Jonathan	Field Technician													
Pfeiff, Steve	Operator													
Phillips, Christopher	Operator													
Pfeifer, Jeffrey	Field Supervisor													
Porcell, Trevor	Operator													
Rabin, Craig	Lead Operator													
Ramaglia, Roberto	Motor Reader													
Rickard, James	Operator	4,970	147	5,117	115	5,232	183	5,415	434	10	26	162	217	1,390
Schaefer, Keith	Operator													
Schultz, Kevin	Field Technician													
Schumann, Charles	Area Manager	9,259	-	9,259	208	9,467	331	9,799	759	10	26	314	392	1,390
Shedden, David	Lead Operator													
Sims, Mickey	Field Technician													
Silva, Kelly	Area Manager													
Silman, Terry	Operator (PT)													
Smith, Donald	Field Technician	5,708	279	5,987	135	6,123	214	6,336	485	10	26	180	253	1,390

2008 FY FL RATE CASES
SALARY ADJUSTMENT

W-4

Union Loc. of Employees	Position	Vehicle Number	Depreciation Start	Vehicle Price	Vehicle Accumulated Depreciation	Vehicle Depreciation Expense
Alday, James	Operator					
Anderson, Daniel	Operator					
Austin Jr, Arthur	Field Technician					
Bailey, Alan	Operator					
Baliga, Alvin	Operator					
Brown, Christopher	Motor Reader	0630	November 2007	3,553	(691)	392
Burnette, David	Operator					
Burgess, John	Business Manager					
Burns, Dennis	Motor Reader					
Burns, Robert	Operator					
Callahan, Robert	Operator					
Cavalina, Anthony	Operator					
Carver, Malcolm	Project Manager	0649	July 2006	1,399	(583)	333
Chad, Ronald	Concrete Construction Specialist					
Coates, Bill	Area Manager					
Coffey Jr, John	Operator					
Cook, James	Lead Operator					
Cook, Ronald	Operator					
Cooper, Robert	Operator					
Davis, Jon	Lead Operator					
David, Donald	Lead Operator					
DeBour, Rich	Regional Vice President	0650	February 2006	940	(457)	157
Eller, Sherron	Field Technician					
Edwards, James	Operator					
Edwards, Brian	Operator	0827	November 2007	3,147	(612)	324
Fink, Allen	Operator					
Finkbeiner, Jeffrey	Lead Operator					
Flynn, Patrick	Regional Director	0512	February 2005	1,263	(1,295)	331
Funkhouser, Kenneth	Field Technician					
Funkhouser, Cindy	Operator					
Gabara, Richard	Field Technician					
Gaines Jr, James	Operator					
Garland, Thomas	Area Manager	0864	March 2008	1,335	(185)	185
Gardner, Patrick	Lead Operator					
Gardner, Bryan	Regional Manager	0818	October 2007	1,537	(320)	236
Garrett, Scotty	Project Manager					
Geisinger Jr, Larry	Field Technician (PT)					
Geisler, Stephen	Lead Operator					
Hamilton, Don	Operator					
Hampson, James	Operator					
Harris, Barry	Salary Manager	0729	January 2007	849	(287)	141
Harris, Raymond	Operator					
Hollister, James	Field Technician					
Holmquist, Roger	Lead Operator					
Kays, Thomas	Lead Operator					
Kelso, Joseph	Lead Operator					
Land, Mark	Field Technician					
Larson, Scott	Field Technician					
Larson, Alexander	Operator					
Maxwell, John	Field Supervisor					
McPherson, Alton	Lead Operator	0448	June 2004	19,564	(15,021)	3,277
Meyers, Matthew	Field Technician					
Miel, William	Area Manager					
Mitchell, Michael	Field Technician	0831	November 2007	1,258	(345)	230
Murphy, Raymond	Operator	0702	September 2006	3,017	(1,171)	503
Newington, Jonathan	Field Technician					
Pham, Steve	Operator					
Phillips, Christopher	Operator					
Phelan, Jeffrey	Field Supervisor					
Purcell, Trevor	Operator					
Ramos, Craig	Lead Operator					
Randolph, Roberts	Motor Reader					
Richardson, James	Operator	0655	March 2006	3,165	(1,494)	527
Schmidler, Keith	Operator					
Schmidt, Kevin	Field Technician					
Schwaner, Charles	Area Manager	0544	May 2006	4,190	(1,834)	688
Shelton, David	Lead Operator					
Shaw, Meloy	Field Technician					
Shelton, Kelly	Area Manager					
Shelton, Terry	Operator (PT)					
Smith, Donald	Field Technician	0513	December 2004	3,813	(2,595)	636

2006 TY FL RATE CASE
SALARY ADJUSTMENT

wp 6

Steehan, Barry Operator
 Stewart, Michael Area Manager
 Sufel, Corey Lead Operator
 Sumpster, James Operator
 Szupkowiak, Stephen Operator
 Tavel, David Field Technician
 Tavel, Paul Field Technician
 Vanmeter Jr, Nathan Lead Operator
 Wabefeld, Roland Lead Operator
 Williams, Cedric Field Technician
 White, Ronald Field Supervisor
 Wierzbicki, Anthony Field Manager
 Williams, Elise Operator
 Williams, Michael Regional Manager
 Woodside, Michael Operator (PT)
 Wozniak, David Operator
 Wright, James Operator
 Wright, Thomas Field Technician
 Abbott, Leanne Office Clerk (1)
 Bennett, Kimberly Customer Service Representative (1)
 Cahalan, Isabel Customer Service Representative (1)
 Chandler, Matthew Accounts Receivable Clerk (1)
 Christian, Elise Customer Service Representative (1)
 Dymowski, Susan Staff Assistant (1)
 Hanks, Peggy Office Clerk (1)
 Mayraki, Lorie Customer Service Representative (1)
 Lovell, Leanne Customer Service Representative (1)
 Neill, Heidi Office Clerk (1)
 Patisia, Rhiginia Accounts Receivable Clerk (1)
 Rappas, Ann Office Clerk (1)
 Saito, Karen Office Manager (1)
 Sillman, Jacqueline Customer Service Representative (1)
 Trivette, Fereshta Accounts Payable Clerk (1)
 Arzoo, Diane Payroll Support
 Beant, James Regulatory Assessment
 Bell, William Operations Director
 Beaupre, Louis Human Resources Generalist
 Chandler Jr, Barry IT Manager
 Chang, Yui Accounts Payable Clerk (PT)
 Chantry, Elyse Regulatory Assessment
 Svedala, Agnes Administrative Assistant
 Costantino, Daniel Regulatory Assessment *
 Cressel, Lee Chief Operations Officer
 Campbell, Eric Field Assets Assessment
 Dunn, Brian IT Specialist
 Davis, Mark IT Specialist
 Di Marco, Michelle Senior Assessment
 Dryden, Michael Regulatory Accounting Manager
 DeHaven, Charles Field Assets Assessment
 Faldutis, Antonette Accounts Payable Manager
 Friedman, Avram Accounts Manager
 Geoghegan, Lora Regulatory Manager
 Gomez, Ronald Data Entry Clerk
 Gustin, Deborah Bill Clerk
 Harrell, Justin Accounts Payable Clerk
 Hayes Jr, John Director of Finance
 Hopkins, John Robert Manager of Human Resources
 Hoy, John Chief Regulatory Officer
 Joseph, James Chief Financial Officer
 Kersey, Justin Assessment
 Kim, Christine Accounting Manager
 Knight, Adeline Customer Service Representative Manager
 Krasner, Roy Executive Assistant
 Langston, Samuel Financial Analyst
 Lohmeyer, Steven Chief Financial Officer
 Luppino, Nancy Accounts Manager
 Luppino, Phyllis Accounts Manager
 Masterson, Stephen Assessment
 McCard, Melville Administrative Clerk (PT)
 Mathews, Mary Ellen Billing Specialist
 McClain, Pamela Data Specialist
 McLane, Pamela Payroll Support
 Melis, Deborah Regulatory Assessment
 Minick, Margaret Accounts Manager

0611

July 2007

1,454

(667)

578

2000 TY PL RATE CASES
SALARY ADJUSTMENT

Mosley, Christopher	Billing Analyst	373	9	382										
Noyabov, Dmitry	Senior Regulatory Accountant				9	391								
Odeh, Tom	IT Manager						14	405	31	1	9	12	16	76
Pattana, Nicholas	IT Specialist	1,052	-	1,052										
Paul, Nancy	Receptionist	332	3	336	34	1,076	38	1,114	39	1	1	32	45	76
Petro, Victoria	Senior Accountant	332	0	336	8	343	14	419	32	1	1	11	17	76
Predd, Eric	Senior Regulatory Accountant *	576	-	576	13	387	21	555	27	1	1	11	14	76
Ross, Kandise	Salary Coordinator	647	-	647	30	579	38	607	46	1	1	18	24	76
Schaefer, William	Tax Accountant				15	681	23	599	46	1	1	18	24	76
Schreyer, William	Mail Clerk	722	-	722	16	738	23	684	32	1	1	21	24	76
Schwaninger, Lawrence	President	227	32	259	9	288	14	264	38	1	1	23	31	76
Smith III, George	Project Manager	1,341	-	1,341	17	789	28	806	31	1	1	12	16	76
Spak, Edithmole	Field Service Accountant	772	-	772	75	3,486	130	3,536	113	1	1	106	141	76
Stankovic, Brian	Regulatory Accountant	422	-	422	14	636	22	817	62	1	1	15	23	76
Stanton, Rodney	Office Specialist						22	638	50	1	1	30	36	76
Stewart, Jr, Thomas	Systems Specialist	397	-	397	13	610	21	632	48	1	1	19	25	76
Stewart, George	Accounting Manager	284	-	284	12	597	21	618	47	1	1	19	25	76
Stone, Leslie	Executive Assistant	696	-	696	16	708	22	734	56	1	1	22	29	76
Stover, John	General Counsel	610	-	610	14	624	22	646	49	1	1	19	26	76
Suchanek, Donald	Business Director	1,980	-	1,980	35	1,512	71	2,096	94	1	1	83	84	76
Valis, Leonardo	Administrative Clerk	1,537	-	1,537	6	394	35	1,637	87	1	1	49	65	76
Waska, Kinross	Regulatory Accounting Manager *	387	0	387	10	394	10	394	33	1	1	9	12	76
Williams III, John	Director of Governmental Affairs	780	-	780	27	806	28	834	64	1	1	23	33	76
Yip Jr, Lowell	Regulatory Accountant	976	-	976	22	998	23	1,023	78	1	1	31	41	76
Yount, Dennis	Director of Strategic Planning													
Zavitz, Annette	Account Manager	1,020	43	1,063	23	1,043	34	1,079	79	1	1	32	43	76
		344		407	9	416	15	430	67	1	1	12	17	76
		2,205,867	\$8,411	\$2,114,678	\$4,867	\$119,323	\$7,483	\$127,009	\$16,027	\$746	297	26,719	\$9,065	\$27,916

2006 FY FL RATE CASE
SALARY ADJUSTMENT

wp 2

Monney, Christopher	Billing Analyst				
Napoliello, Christy	Senior Regulatory Assessment				
Oster, Tom	IT Manager				
Pruett, Nicholas	IT Specialist				
Psaltis, Nancy	Receptionist				
Plano, Victoria	Senior Assessment				
Purich, Eric	Senior Regulatory Assessment *				
Ross, Kardin	Safety Coordinator				
Schmitt, William	Tax Assessor				
Schuyler, Miriam	Mail Clerk				
Schumacher, Lawrence	President				
Sevill III, George	Project Manager				
Shah, Kishorendr	Food Assets Assessment				
Shank, Brian	Regulatory Assessment				
Sinclair, Rodney	Office Specialist				
Smalley Jr, Thomas	Systems Specialist				
Spivak, George	Accounting Manager				
Starr, Leslie	Executive Assistant				
Starr, John	General Counsel				
Stubbins, David	Business Director	0649	February 2006	283	(138) 47
Valin, Leonardo	Administrative Clerk				
Walsh, Elmer	Regulatory Assessment Manager *				
Williams III, John	Director of Governmental Affairs				
Yip Jr, Lowell	Regulatory Assessment				
Yount, David	Director of Strategic Planning				
Zavala, Amalia	Account Manager				
				<u>217,540</u>	<u>(217,721)</u> <u>28,819</u>

2008 TY FL RATE CASES
 BENEFITS EXPENSE PER FULL TIME EMPLOYEE

w/p a-1

<u>Object Account</u>	<u>Description</u>	<u>2008 Expense</u>	<u># of Full Time Employees</u>	<u>Benefit Per Employee</u>
5630	DENTAL PREMIUMS	33,775.80	464	72.79
5635	DENTAL INS REIMBURSEMENTS	270,688.69	464	583.38
5645	EMPLOYEE INS DEDUCTIONS	(1,028,380.29)	464	(2,216.34)
5650	HEALTH COSTS & OTHER	(84,192.00)	464	(181.45)
5655	HEALTH INS REIMBURSEMENTS	3,875,061.17	464	8,351.42
5660	OTHER EMP PENSION/BENEFITS	501,855.68	464	1,081.59
5670	TERM LIFE INS	151,190.70	464	325.84
5675	TERM LIFE INS-OPT	(3,219.77)	464	(6.94)
5680	DEPEND LIFE INS-OPT	(4,263.63)	464	(9.19)
5690	TUITION	66,472.45	464	143.26
				<u>8,144.37</u>

2008 TY FL RATE CASES
 ADJUSTED VEHICLE AVERAGES FOR EMPLOYEES

w/p b

<u>Utilities, Inc. of Pennbrooke</u>	<u>12/31/2007</u>	<u>12/31/2008</u>	<u>Simple Average</u>
Vehicles	\$52,206	\$53,540	\$52,873
Vehicle A/D (3)	(10,314)	(27,795)	(19,054)
(3) Vehicle A/D -12/31/07 - Pennbrooke			
Blasco, Christopher	(\$99)		
Carver, Nathaniel	(350)		
Durham, Rick	(300)		
Eubanks, Brian	(87)		
Flynn, Patrick	(964)		
Gentilucci, Domenic	-		
Gongre, Bryan	64		
Haws, Scotty	(141)		
McPhee,, Allison	(3,277)		
Overton, Michael	(35)		
Parrish, Raymond	(670)		
Richardson, James	(967)		
Schwades, Charles	(1,147)		
Smith, Donald	(1,960)		
White, Ronald	(289)		
Sudduth, Donald	(91)		

2008 TY FL RATE CASES
 ADDITIONAL VEHICLES AND AVERAGES

w/p 8-1

<u>Utilities, Inc. of Pensacola</u>						
<u>Vehicle Number</u>	<u>Depreciation Start</u>	<u>Vehicle Price Simple Average</u>	<u>Vehicle A/D - 2007</u>	<u>Vehicle A/D - 2008</u>	<u>Vehicle A/D Simple Average</u>	<u>Vehicle Depreciation Expense</u>
0015	January 2000	\$571	(\$571)	(\$571)	(\$571)	\$0
0016	January 2000	571	(571)	(571)	(571)	-
0017	January 2000	668	(668)	(668)	(668)	-
0035	March 2000	1,335	(1,335)	(1,335)	(1,335)	-
0109	June 2001	709	(709)	(709)	(709)	-
0130	October 2001	656	(656)	(656)	(656)	-
0217	June 2002	641	(641)	(641)	(641)	-
0382	October 2003	723	(723)	(723)	(723)	29
0433	December 2003	2,375	(2,375)	(2,375)	(2,375)	78
0508	February 2005	915	(915)	(915)	(915)	255
0675	May 2006	1,553	(1,553)	(1,553)	(1,553)	98
0691	April 2007	6,125	(6,125)	(6,125)	(6,125)	167
0710	September 2006	1,402	(1,402)	(1,402)	(1,402)	657
0712	October 2006	571	(571)	(571)	(571)	150
0712	November 2007	791	(791)	(791)	(791)	61
8926	January 1989	1,154	(1,154)	(1,154)	(1,154)	85
		\$20,760	(\$8,808)	(\$12,937)	(\$10,873)	\$1,379

2008 TY FL RATE CASES
 TRANSPORTATION EXPENSE PER VEHICLE

w/p b-2

<u>Object Account</u>	<u>Description</u>	<u>2008 Expense</u>	<u># of Vehicles in Florida</u>	<u>Expense Per Vehicle</u>
6215	FUEL	\$427,022	105	\$4,067
6220	AUTO REPAIR/TIRES	147,150.43	105	1,401
6225	AUTO LICENSES	5,949.45	105	57
6230	OTHER TRANS EXPENSES	4,256.92	105	41
		<u>\$584,379</u>		<u>\$5,566</u>

Utilities, Inc. of Pennbrook

<u>Transportation Expense</u>	
Blasco, Christopher	\$950
Carver, Nathaniel	297
Durham, Rick	161
Eubanks, Brian	996
Flynn, Patrick	207
Gentiluoci, Domenic	332
Gongre, Bryan	293
Haws, Scotty	161
McPhee, Allison	5,566
Overton, Michael	346
Parrish, Raymond	1,038
Richardson, James	950
Schwadea, Charles	950
Smith, Donald	950
White, Ronald	950
Sudduth, Donald	53
Additional Vehicles	3,310
	<u>\$17,508</u>

2008 TY FL RATE CASES
CAPITALIZED TIME ADJUSTMENT

w/p c

Utilities, Inc. of Pennbrooke

Total Per Book Salaries	\$257,591
Total Per Book Operator Salaries	175,215
Percentage of Operator to Total	68.02%
Per Book Operator Salaries	\$175,215
Per Book Operator Payroll Taxes	11,101
Per Book Operator Benefits	33,719
	<hr/>
	\$220,035
Per Book Capitalized Time	(18,840.33)
Per Book Operator Payroll	220,035
Percentage of Total Payroll to Plant	<hr/>
	8.56%
Pro Forma Operator Payroll	\$208,630
Percentage of Total Payroll to Plant	8.56%
Pro Forma Capitalized Time	<hr/>
	(\$17,864)

State	Company	Business Unit	ERC	% to Total UI	
Illinois	00110	110100	2,677.0	0.94%	
	00111	111100	216.0	0.08%	
	00111	111101	216.0	0.08%	
	00112	112100	53.0	0.02%	
	00113	113100	256.6	0.09%	
	00114	114100	360.5	0.13%	
	00116	116100	115.4	0.04%	
	00117	117100	76.5	0.03%	
	00118	118100	382.0	0.13%	
	00118	118101	374.0	0.13%	
	00119	119100	2,227.4	0.79%	
	00119	119101	807.7	0.28%	
	00120	120100	348.0	0.12%	
	00121	121100	2,076.0	0.73%	
	00122	122100	1,420.5	0.50%	
	00123	123100	171.0	0.06%	
	00123	123101	184.0	0.06%	
	00124	124100	290.0	0.10%	
	00125	125100	194.0	0.07%	
	00126	126100	70.0	0.02%	
	00127	127100	219.0	0.08%	
	00128	128100	2,333.5	0.82%	
	00129	129100	246.0	0.09%	
	00130	130100	464.2	0.16%	
	00131	131100	475.4	0.17%	
	00131	131101	465.4	0.16%	
	00132	132100	124.0	0.04%	
	00133	133100	319.0	0.11%	
	00133	133101	316.0	0.11%	
	00134	134100	361.0	0.13%	
	Indiana	00150	150100	3,110.0	1.10%
		00150	150101	3,078.0	1.09%
		00151	151100	190.3	0.07%
		00151	151101	196.1	0.07%
00152		152100	1,819.5	0.64%	

ERC COUNT 12/08
 ALL UTILITIES, INC. COMPANIES

w/p d

State	Company	Business Unit	ERC	% to Total LT
North Carolina	00181	181100	267.2	0.09%
	00181	181101	108.2	0.04%
	00182	182101	663.0	0.23%
	00182	182102	778.2	0.27%
	00182	182103	2,653.5	0.94%
	00182	182104	2,128.0	0.75%
	00182	182105	1,092.1	0.39%
	00182	182106	2,441.5	0.86%
	00182	182107	2,214.0	0.78%
	00182	182109	123.0	0.04%
	00182	182110	17.0	0.01%
	00182	182112	249.2	0.09%
	00182	182113	78.0	0.03%
	00182	182114	242.3	0.09%
	00182	182115	1,132.0	0.40%
	00182	182116	510.8	0.18%
	00182	182117	492.3	0.17%
	00182	182119	67.0	0.02%
	00182	182120	66.0	0.02%
	00182	182122	448.0	0.16%
	00182	182123	203.5	0.07%
	00182	182125	161.9	0.06%
	00182	182126	159.4	0.06%
	00182	182128	75.0	0.03%
	00182	182129	686.0	0.24%
	00182	182130	67.0	0.02%
	00182	182132	222.0	0.08%
	00182	182133	368.0	0.13%
	00182	182134	275.0	0.10%
	00182	182136	115.0	0.04%
	00182	182137	301.0	0.11%
	00182	182138	300.0	0.11%
	00182	182140	374.0	0.13%
	00182	182141	1,454.8	0.51%
	00182	182142	36.0	0.01%
	00182	182143	101.0	0.04%
	00182	182144	137.0	0.05%
	00182	182145	46.0	0.02%
	00182	182146	239.0	0.08%
	00182	182147	258.0	0.09%
	00182	182148	326.5	0.12%
	00182	182149	69.0	0.02%
	00182	182151	130.5	0.05%
	00182	182152	974.1	0.34%
	00182	182153	1,220.5	0.43%
	00182	182154	177.0	0.06%
	00182	182155	176.0	0.06%
	00182	182157	163.0	0.06%
	00182	182158	34.0	0.01%
	00182	182159	78.0	0.03%
	00182	182160	51.8	0.02%
	00182	182162	28.0	0.01%
	00182	182163	67.0	0.02%
	00182	182164	59.0	0.02%
	00182	182165	59.4	0.02%
	00182	182166	46.0	0.02%
	00182	182167	26.0	0.01%
	00182	182168	138.0	0.05%
	00182	182169	531.0	0.19%
	00182	182170	106.0	0.04%
	00182	182171	224.5	0.08%
	00182	182172	452.0	0.16%
	00182	182173	439.5	0.16%
	00182	182175	197.0	0.07%
	00182	182176	124.0	0.04%
	00182	182178	696.0	0.25%
	00182	182179	269.5	0.10%
	00182	182180	93.0	0.03%
	00182	182181	60.0	0.02%
	00182	182182	131.8	0.05%
	00182	182183	118.0	0.04%
	00182	182184	223.0	0.08%
	00182	182185	117.0	0.04%
	00182	182186	181.0	0.06%
	00182	182187	181.0	0.06%
	00182	182189	1,265.0	0.45%
	00182	182190	1,298.0	0.46%
	00182	182192	165.4	0.06%

State	Company	Business Unit	ERC	% to Total UT
	00182	182193	162.4	0.06%
	00182	182195	111.0	0.04%
	00182	182196	135.6	0.05%
	00182	182197	134.6	0.05%
	00182	182199	155.0	0.05%
	00182	182200	61.0	0.02%
	00182	182201	62.0	0.02%
	00182	182203	37.0	0.01%
	00182	182204	228.0	0.08%
	00182	182205	222.0	0.08%
	00182	182206	44.0	0.02%
	00182	182207	34.0	0.01%
	00182	182208	78.0	0.03%
	00182	182209	733.0	0.26%
	00182	182210	449.5	0.16%
	00182	182211	31.0	0.01%
	00182	182212	65.5	0.02%
	00182	182213	27.0	0.01%
	00182	182214	242.0	0.09%
	00182	182215	76.0	0.03%
	00182	182216	153.0	0.05%
	00182	182217	372.0	0.13%
	00182	182218	564.0	0.20%
	00182	182219	179.0	0.06%
	00182	182227	591.0	0.21%
	00182	182229	1,833.0	0.65%
	00182	182231	838.7	0.30%
	00182	182233	652.6	0.23%
	00182	182235	193.0	0.07%
	00182	182236	189.0	0.07%
	00182	182238	140.0	0.05%
				14.27%
	00183	183101	2,472.6	0.87%
	00183	183102	922.6	0.33%
	00183	183104	1,275.0	0.45%
	00183	183105	2,738.0	0.97%
	00183	183106	2,669.0	0.94%
	00183	183108	1,146.0	0.40%
	00183	183109	511.0	0.18%
	00183	183112	138.5	0.05%
	00183	183113	102.0	0.04%
	00183	183114	53.0	0.02%
	00183	183115	24.0	0.01%
	00183	183116	43.8	0.02%
	00183	183117	114.0	0.04%
	00183	183118	44.0	0.02%
	00183	183119	87.0	0.03%
	00183	183120	37.6	0.01%
	00183	183121	101.8	0.04%
	00183	183122	34.0	0.01%
	00183	183124	287.5	0.10%
	00183	183125	46.0	0.02%
	00183	183126	30.0	0.01%
				4.54%
	00187	187100	1,487.5	0.52%
	00187	187101	1,434.5	0.51%
				1.03%
	00188	188100	2,115.6	0.75%
	00188	188101	1,348.6	0.48%
				1.22%
	00189	189100	2,959.0	1.04%
				1.04%
	00190	190100	337.0	0.12%
				0.12%
	00191	191100	961.5	0.34%
	00191	191101	1,357.5	0.48%
				0.82%
	00192	192100	127.0	0.04%
	00192	192101	127.0	0.04%
				0.09%
Tennessee	00220	220100	557.0	0.20%
				0.20%

State	Company	Business Unit	ERC	% to Total LU	
Florida	00241	241100	2,093.2	0.74%	Tierra Verde
	00242	242100	130.7	0.05%	
	00242	242101	130.7	0.05%	Lake Placid
	00245	245100	7,545.9	2.66%	
	00245	245101	1,065.0	0.38%	Alafaya
	00246	246100	1,745.0	0.62%	Longwood
	00248	248100	1,247.0	0.44%	
	00248	248101	1,145.5	0.40%	Cypress Lakes
	00249	249100	1,602.6	0.57%	
	00249	249101	908.0	0.32%	Eagle Ridge
	00250	250100	3,353.0	1.18%	Mid-County
	00251	251100	66.0	0.02%	
	00251	251101	43.0	0.02%	
	00251	251102	3,063.1	1.08%	
	00251	251103	2,966.8	1.05%	
	00251	251106	5,684.5	2.01%	LAUSI
	00252	252106	1,788.3	0.63%	
	00252	252107	152.0	0.05%	
	00252	252125	1,225.0	0.43%	
	00252	252126	1,023.0	0.36%	UIF - Pasco
	00252	252110	1,174.0	0.41%	
	00252	252111	1,160.5	0.41%	
	00252	252113	225.5	0.08%	
	00252	252114	61.0	0.02%	
	00252	252115	102.0	0.04%	
	00252	252116	77.0	0.03%	
	00252	252117	171.0	0.06%	
	00252	252118	345.0	0.12%	
	00252	252119	245.0	0.09%	
	00252	252121	224.3	0.08%	
	00252	252122	250.5	0.09%	UIF - Seminole
	00252	252123	260.5	0.09%	
	00252	252124	43.0	0.02%	UIF - Orange
	00252	252128	433.3	0.15%	UIF - Pinellas
	00252	252129	532.1	0.19%	
	00252	252130	78.8	0.03%	UIF - Marion
	00253	253101	1,104.7	0.39%	
	00253	253102	1,030.2	0.36%	Mike Grant
	00254	254100	197.0	0.07%	
	00254	254101	742.5	0.26%	ACME
	00255	255100	11,797.7	4.16%	
	00255	255101	9,158.0	3.23%	
	00255	255102	4.0	0.00%	Santando
	00256	256100	1,083.9	0.38%	Sandalhaven
	00257	257100	242.0	0.09%	
	00257	257101	241.0	0.09%	Beyside
	00259	259100	781.1	0.28%	
	00259	259101	760.7	0.27%	Labrador
	00260	260100	1,465.0	0.52%	
	00260	260101	1,247.0	0.44%	Peanbrooke
00261	261100	195.2	0.07%		
00261	261101	167.2	0.06%	Hutchinson Island	
00262	262100	203.8	0.07%		
00262	262101	171.0	0.06%	Sandy Creek	

ERC COUNT 12000
ALL UTILITIES, INC. COMPANIES

w/p 4

State	Company	Business Unit	ERC	% to Total LI	
Maryland	00286	286100	842.0	0.30%	
	00286	286101	81.0	0.03%	0.33%
	00287	287100	1,480.0	0.52%	0.52%
	00288	288100	1,114.1	0.39%	
	00288	288101	1,075.4	0.38%	0.77%
New Jersey	00300	300100	794.0	0.28%	
	00300	300101	276.0	0.10%	0.38%
Pennsylvania	00315	315100	768.5	0.27%	0.27%
	00316	316100	2,173.0	0.77%	0.77%
	00317	317100	1,724.0	0.61%	
	00317	317101	1,720.0	0.61%	1.21%
Virginia	00332	332100	169.0	0.06%	0.06%
	00333	333100	2,666.7	0.94%	
	00333	333101	2,679.7	0.95%	1.89%
Kentucky	00345	345101	761.8	0.27%	
	00345	345102	6,573.0	2.32%	2.59%
Louisiana	00356	356102	511.0	0.18%	
	00356	356103	493.0	0.17%	
	00356	356105	2,101.7	0.74%	
	00356	356106	2,069.9	0.73%	
	00356	356108	672.7	0.24%	
	00356	356109	661.8	0.23%	
	00356	356111	672.5	0.24%	
	00356	356112	668.5	0.24%	
	00356	356114	386.5	0.14%	
	00356	356115	363.0	0.13%	
	00356	356117	556.4	0.20%	
	00356	356118	534.6	0.19%	
	00356	356120	49.5	0.02%	
	00356	356121	47.8	0.02%	
	00356	356122	41.8	0.01%	
	00356	356124	161.0	0.06%	
	00356	356125	158.0	0.06%	
	00356	356127	105.0	0.04%	3.62% LWS
		00357	357101	4,575.8	1.61%
	00357	357102	4,265.4	1.50%	
	00357	357104	940.8	0.33%	
	00357	357105	811.8	0.29%	3.74% UIL

State	Company	Business Unit	ERC	% to Total LI	
Georgia	00385	385100	4,860.7	1.71%	
	00385	385101	4,726.2	1.67%	
	00385	385103	652.0	0.23%	
				3.61%	
		00386	386101	52.0	0.02%
		00386	386102	24.0	0.01%
		00386	386103	109.0	0.04%
		00386	386105	191.0	0.07%
		00386	386106	20.0	0.01%
		00386	386107	107.0	0.04%
		00386	386108	14.0	0.00%
		00386	386109	140.0	0.05%
		00386	386110	47.0	0.02%
		00386	386111	153.0	0.05%
		00386	386112	61.0	0.02%
		00386	386113	164.0	0.06%
		00386	386114	21.0	0.01%
		00386	386115	57.0	0.02%
		00386	386116	254.0	0.09%
		00386	386117	31.0	0.01%
		00386	386118	164.0	0.06%
		00386	386119	165.0	0.06%
		00386	386121	40.0	0.01%
		00386	386122	37.0	0.01%
		00386	386123	128.0	0.05%
		00386	386124	18.0	0.01%
		00386	386125	36.0	0.01%
		00386	386126	6.0	0.00%
		00386	386127	11.0	0.00%
		00386	386128	29.0	0.01%
		00386	386129	16.0	0.01%
					0.74%
	South Carolina	00400	400103	100.8	0.04%
00400		400104	64.0	0.02%	
00400		400105	97.0	0.03%	
00400		400106	154.0	0.05%	
00400		400108	21.0	0.01%	
00400		400109	298.6	0.11%	
00400		400110	205.0	0.07%	
00400		400111	86.0	0.03%	
00400		400113	127.0	0.04%	
00400		400114	17.0	0.01%	
00400		400115	116.0	0.04%	
00400		400116	114.0	0.04%	
00400		400118	42.4	0.01%	
00400		400119	164.0	0.06%	
00400		400120	190.8	0.07%	
00400		400121	47.0	0.02%	
00400		400122	95.5	0.03%	
00400		400123	253.0	0.09%	
00400		400124	67.0	0.02%	
00400		400125	22.0	0.01%	
00400		400126	115.0	0.04%	
00400		400127	3,474.1	1.23%	
00400		400128	3,129.1	1.10%	
00400		400130	2,234.8	0.79%	
00400		400131	2,215.2	0.78%	
00400		400133	141.0	0.05%	
00400		400134	140.0	0.05%	
00400		400136	198.0	0.07%	
00400		400137	187.0	0.07%	
00400		400138	163.0	0.06%	
00400		400139	78.8	0.03%	
00400		400140	328.5	0.12%	
00400		400141	1,080.8	0.38%	
00400		400143	3,172.6	1.12%	
00400		400144	219.0	0.08%	
00400		400145	230.0	0.08%	
00400		400147	114.0	0.04%	
					6.88%
		00401	401104	200.5	0.07%
		00401	401105	322.0	0.11%
		00401	401106	1.0	0.00%
	00401	401107	191.6	0.07%	
	00401	401108	351.0	0.12%	
	00401	401109	192.0	0.07%	
	00401	401110	67.0	0.02%	
	00401	401111	72.0	0.03%	
	00401	401112	116.5	0.04%	

State	Company	Business Unit	ERC	% to Total LT
	00401	401113	22.0	0.01%
	00401	401114	23.0	0.01%
	00401	401115	138.0	0.03%
	00401	401116	195.6	0.07%
	00401	401117	46.0	0.02%
	00401	401118	80.0	0.03%
	00401	401119	9.0	0.00%
	00401	401120	37.0	0.01%
	00401	401121	57.0	0.02%
	00401	401122	149.0	0.05%
	00401	401123	31.0	0.01%
	00401	401124	21.0	0.01%
	00401	401125	34.0	0.01%
	00401	401126	24.0	0.01%
	00401	401127	387.0	0.14%
	00401	401128	48.0	0.02%
	00401	401129	147.0	0.05%
	00401	401130	43.0	0.02%
	00401	401131	71.0	0.03%
	00401	401132	79.0	0.03%
	00401	401133	151.0	0.05%
	00401	401134	57.0	0.02%
	00401	401135	21.0	0.01%
	00401	401136	117.6	0.04%
	00401	401137	274.0	0.10%
	00401	401138	187.0	0.07%
	00401	401139	71.0	0.03%
	00401	401140	38.0	0.01%
	00401	401142	218.0	0.08%
	00401	401143	218.0	0.08%
	00401	401145	16.0	0.01%
	00401	401146	27.0	0.01%
	00401	401147	30.2	0.01%
	00401	401148	32.2	0.01%
	00401	401149	40.0	0.01%
	00401	401150	81.0	0.03%
	00401	401151	55.0	0.02%
	00401	401153	136.0	0.05%
	00401	401154	46.0	0.02%
	00401	401156	43.0	0.02%
	00401	401157	26.5	0.01%
	00401	401158	20.2	0.01%
	00401	401159	35.0	0.01%
	00401	401160	67.0	0.02%
	00401	401161	70.6	0.03%
	00401	401162	51.8	0.02%
	00401	401163	35.6	0.01%
	00401	401164	28.8	0.01%
	00401	401165	75.6	0.03%
	00401	401166	28.0	0.01%
	00401	401167	20.0	0.01%
	00401	401168	27.0	0.01%
	00401	401169	50.0	0.02%
	00401	401170	16.8	0.01%
	00401	401171	40.6	0.01%
	00401	401172	36.2	0.01%
	00401	401173	44.8	0.02%
	00401	401174	47.0	0.02%
	00401	401175	14.0	0.00%
	00401	401176	77.0	0.03%
	00401	401177	94.0	0.03%
	00401	401178	71.0	0.03%
	00401	401179	64.0	0.02%
	00401	401180	73.0	0.03%
	00401	401181	19.0	0.01%
	00401	401182	52.0	0.02%
	00401	401183	33.0	0.01%
	00401	401184	106.0	0.04%
	00401	401185	68.0	0.02%
	00401	401186	98.0	0.03%
	00401	401187	60.0	0.02%
	00401	401188	28.0	0.01%
	00401	401189	68.0	0.02%
	00401	401190	70.0	0.02%
	00401	401191	22.0	0.01%
	00401	401192	94.0	0.03%
				2.41%
	00402	402100	55.0	0.02%
	00402	402101	120.0	0.04%
				0.06%

State	Company	Business Unit	ERC	% to Total UI
	00403	403101	24.0	0.01%
	00403	403102	20.0	0.01%
	00403	403103	51.0	0.02%
	00403	403104	54.0	0.02%
	00403	403107	137.0	0.05%
	00403	403108	92.0	0.03%
	00403	403109	86.0	0.03%
	00403	403110	73.0	0.03%
	00403	403111	174.2	0.06%
	00403	403112	149.8	0.05%
	00403	403113	204.2	0.07%
	00403	403114	54.0	0.02%
	00403	403115	84.6	0.03%
	00403	403116	80.8	0.03%
	00403	403118	1.0	0.00%
				0.45%
	00406	406100	1,719.0	0.61%
	00406	406101	1,696.0	0.60%
				1.20%
Arizona	00425	425100	8,690.1	3.07%
				3.07%
Nevada	00450	450100	3,326.5	1.17%
				1.17%
	00451	451100	4,291.2	1.51%
	00451	451101	146.7	0.05%
				1.57%
	00452	452100	580.5	0.20%
				0.20%
	00453	453100	6,245.2	2.20%
	00453	453101	3,557.9	1.25%
	00453	453103	753.3	0.27%
	00453	453104	585.0	0.21%
				3.93%
Bio-Tech	00900	900100	296.8	0.10%
				0.10%
			<u>283,513.2</u>	<u>100.00%</u>
				<u>100.00%</u>

State	Company	Business Unit	ERC	% to Total Florida/South		
Florida	00241	241100	2,093.2	2.23%	Tierra Verde	
	00242	242100	130.7	0.14%		
	00242	242101	130.7	0.14%	Lake Placid	
	00245	245100	7,545.9	8.04%		
	00245	245101	1,065.0	1.14%	Alafaya	
	00246	246100	1,745.0	1.86%	Longwood	
	00248	248100	1,247.0	1.33%		
	00248	248101	1,145.5	1.22%	Cypress Lakes	
	00249	249100	1,602.6	1.71%		
	00249	249101	908.0	0.97%	Eagle Ridge	
	00250	250100	3,355.0	3.58%	Mid-County	
	00251	251100	66.0	0.07%		
	00251	251101	43.0	0.05%		
	00251	251102	3,063.1	3.27%		
	00251	251103	2,966.8	3.16%		
	00251	251106	5,684.5	6.06%	12.60%	LUSI
	00252	252106	1,788.3	1.91%		
	00252	252107	162.0	0.17%		
	00252	252125	1,225.0	1.31%		
	00252	252126	1,023.0	1.09%	4.48%	UIF - Pasco
	00252	252110	1,174.0	1.25%		
	00252	252111	1,160.5	1.24%		
	00252	252113	225.5	0.24%		
	00252	252114	61.0	0.07%		
	00252	252115	102.0	0.11%		
	00252	252116	77.0	0.08%		
	00252	252117	171.0	0.18%		
	00252	252118	345.0	0.37%		
	00252	252119	245.0	0.26%		
	00252	252121	224.5	0.24%		
	00252	252122	250.5	0.27%	4.30%	UIF - Seminole
	00252	252123	266.5	0.28%		
	00252	252124	43.0	0.05%	0.32%	UIF - Orange
	00252	252128	433.3	0.46%	0.46%	UIF - Pinellas
	00252	252129	532.1	0.57%		
	00252	252130	78.8	0.08%	0.65%	UIF - Marion
	00253	253101	1,104.7	1.18%		
	00253	253102	1,030.2	1.10%	2.28%	Miles Crux
	00254	254100	197.0	0.21%		
	00254	254101	742.5	0.79%	1.00%	ACME
	00255	255100	11,797.7	12.58%		
	00255	255101	9,158.0	9.76%		
	00255	255102	4.0	0.00%	22.34%	Seminole
	00256	256100	1,083.9	1.16%	1.16%	Sandhollow
	00257	257100	242.0	0.26%		
	00257	257101	241.0	0.26%	0.51%	Bayside
	00259	259100	781.1	0.83%		
	00259	259101	760.7	0.81%	1.64%	Labrador
	00260	260100	1,465.0	1.56%		
	00260	260101	1,247.0	1.33%	2.89%	Peachcreek
	00261	261100	195.2	0.21%		
	00261	261101	167.2	0.18%	0.35%	Hutchinson Island
	00262	262100	203.8	0.22%		
	00262	262101	171.0	0.18%	0.40%	Steady Creek

State	Company	Business Unit	ERC	% to Total Florida/South		
Louisiana	00356	356102	511.0	0.54%		
	00356	356103	493.0	0.53%		
	00356	356105	2,101.7	2.24%		
	00356	356106	2,069.9	2.21%		
	00356	356108	672.7	0.72%		
	00356	356109	601.8	0.71%		
	00356	356111	672.3		0.72%	
	00356	356112	668.3	0.71%		
	00356	356114	386.3	0.41%		
	00356	356115	363.0	0.39%		
	00356	356117	536.4	0.57%		
	00356	356118	534.6	0.57%		
	00356	356120	49.5	0.05%		
	00356	356121	47.8	0.05%		
	00356	356122	41.8	0.04%		
	00356	356124	161.0	0.17%		
	00356	356125	158.0	0.17%		
	00356	356127	105.0		0.11%	10.93% LWS
	00357	357101	4,575.8	4.88%		
	00357	357102	4,265.4	4.53%		
00357	357104	940.8	1.00%			
00357	357105	811.8	0.87%		11.29% U/L	
			93,816.5	100.00%		100.00%

State	Company	Business Unit	ERC	% to Total Florida	
Florida	00241	241100	2,093.2	2.87%	Tierra Verde
	00242	242100	130.7	0.18%	
	00242	242101	130.7	0.18%	Lake Placid
	00245	245100	7,545.9	10.34%	
	00245	245101	1,065.0	1.46%	Alefyra
	00246	246100	1,745.0	2.39%	Longwood
	00248	248100	1,247.0	1.71%	
	00248	248101	1,145.5	1.57%	Cypress Lakes
	00249	249100	1,602.6	2.20%	
	00249	249101	908.0	1.24%	Eagle Ridge
	00250	250100	3,355.0	4.60%	Mid-County
	00251	251100	66.0	0.09%	
	00251	251101	43.0	0.06%	
	00251	251102	3,063.1	4.20%	
	00251	251103	2,966.8	4.07%	
	00251	251106	5,684.5	7.79%	LUSI
	00252	252106	1,788.3	2.45%	
	00252	252107	162.0	0.22%	
	00252	252125	1,225.0	1.68%	
	00252	252126	1,023.0	1.40%	UIF - Pasco
	00252	252110	1,174.0	1.61%	
	00252	252111	1,160.5	1.59%	
	00252	252113	225.5	0.31%	
	00252	252114	61.0	0.08%	
	00252	252115	102.0	0.14%	
	00252	252116	77.0	0.11%	
	00252	252117	171.0	0.23%	
	00252	252118	345.0	0.47%	
	00252	252119	245.0	0.34%	
	00252	252121	224.5	0.31%	
	00252	252122	250.5	0.34%	UIF - Seminole
	00252	252123	260.5	0.36%	
	00252	252124	43.0	0.06%	UIF - Orange
	00252	252128	433.3	0.59%	UIF - Pinellas
	00252	252129	532.1	0.73%	
	00252	252130	78.8	0.11%	UIF - Marion
	00253	253101	1,104.7	1.51%	
	00253	253102	1,030.2	1.41%	Miles Grant
	00254	254100	197.0	0.27%	
	00254	254101	742.5	1.02%	ACME
	00255	255100	11,797.7	16.17%	
	00255	255101	9,158.0	12.55%	
	00255	255102	4.0	0.01%	Sanlando
	00256	256100	1,083.9	1.49%	Sandshaven
	00257	257100	242.0	0.33%	
	00257	257101	241.0	0.33%	Bayside
	00259	259100	781.1	1.07%	
	00259	259101	760.7	1.04%	Labrador
	00260	260100	1,465.0	2.01%	
	00260	260101	1,247.0	1.71%	Pensbrooka
	00261	261100	195.2	0.27%	
	00261	261101	167.2	0.23%	Hutchinson Island
	00262	262100	203.8	0.28%	
	00262	262101	171.0	0.23%	Sandy Creek
			72,968.0	100.00%	100.00%

<u>Neal, William</u>		<u>System</u>	<u>ERC Count (1)</u>	<u>Percentage to Total</u>	
241100	Tierra Verde	S	2,093.2	14.07%	14.07%
248100	Cypress Lakes	W	1,247.0	8.38%	
248101	Cypress Lakes	S	1,145.5	7.70%	16.09%
250100	Mid-County	S	3,355.0	22.56%	22.56%
Utilities, Inc. of Florida					
252106	Orangewood	W	1,788.3	12.02%	
252107	Orangewood	S	162.0	1.09%	
252125	Summertree	W	1,225.0	8.24%	
252126	Summertree	S	1,023.0	6.88%	
252128	Lake Tarpon	W	433.3	2.91%	31.14%
257100	Beyside	W	242.0	1.63%	
257101	Beyside	S	241.0	1.62%	3.25%
259100	Labrador	W	781.1	5.23%	
259101	Labrador	S	760.7	5.12%	10.37%
262100	Sandy Creek	W	203.8	1.37%	
262101	Sandy Creek	S	171.0	1.15%	2.52%
			14,871.9	100.00%	100.00%
<u>Florkins, Jeffrey</u>		<u>System</u>	<u>ERC Count (1)</u>	<u>Percentage to Total</u>	
241100	Tierra Verde	S	2,093.2	31.13%	31.13%
Utilities, Inc. of Florida					
252106	Orangewood	W	1,788.3	26.59%	
252107	Orangewood	S	162.0	2.41%	
252125	Summertree	W	1,225.0	18.22%	
252126	Summertree	S	1,023.0	15.21%	
252128	Lake Tarpon	W	433.3	6.44%	68.87%
			6,724.8	100.00%	100.00%
<u>Stewart, Malcolm</u>		<u>System</u>	<u>ERC Count (1)</u>	<u>Percentage to Total</u>	
242100	Lake Placid	W	130.7	3.39%	
242101	Lake Placid	S	130.7	3.39%	6.78%
249100	Engle Ridge	S	1,602.6	41.56%	
249101	Engle Ridge	S	908.0	23.55%	65.11%
256100	Sandhaven	S	1,083.9	28.11%	28.11%
			3,855.9	100.00%	100.00%

<u>Clard, Ronald</u>	<u>System</u>		<u>ERC Count (1)</u>	<u>Percentage to Total</u>	
242100 Lake Placid		W	130.7	0.71%	
242101 Lake Placid		S	130.7	0.71%	1.42%
248100 Cypress Lakes		W	1,247.0	6.78%	
248101 Cypress Lakes		S	1,145.5	6.23%	13.01%
249100 Eagle Ridge		S	1,602.6	8.71%	
249101 Eagle Ridge		S	908.0	4.94%	13.65%
250100 Mid-County		S	3,355.0	18.24%	18.24%
Utilities, Inc. of Florida					
252106 Orangerwood		W	1,788.3	9.72%	
252107 Orangerwood		S	162.0	0.88%	
252125 Summertree		W	1,225.0	6.64%	
252126 Summertree		S	1,023.0	5.56%	
252128 Lake Tarpon		W	433.3	2.36%	25.18%
253101 Miles Grant		W	1,104.7	6.01%	
253102 Miles Grant		S	1,030.2	5.60%	11.61%
256100 Sandalhaven		S	1,083.9	5.89%	5.89%
257100 Bayside		W	242.0	1.32%	
257101 Bayside		S	241.0	1.31%	2.63%
259100 Labrador		W	781.1	4.25%	
259101 Labrador		S	760.7	4.14%	8.38%
			18,394.7	100.00%	100.00%

<u>Wilson, Michael</u>	<u>System</u>		<u>ERC Count (1)</u>	<u>Percentage to Total</u>	
242100 Lake Placid		W	130.7	0.68%	
242101 Lake Placid		S	130.7	0.68%	1.37%
248100 Cypress Lakes		W	1,247.0	6.52%	
248101 Cypress Lakes		S	1,145.5	5.99%	12.51%
249100 Eagle Ridge		S	1,602.6	8.38%	
249101 Eagle Ridge		S	908.0	4.75%	13.12%
250100 Mid-County		S	3,355.0	17.54%	17.54%
Utilities, Inc. of Florida					
252106 Orangerwood		W	1,788.3	9.35%	
252107 Orangerwood		S	162.0	0.85%	
252125 Summertree		W	1,225.0	6.40%	
252126 Summertree		S	1,023.0	5.35%	
252128 Lake Tarpon		W	433.3	2.26%	24.21%
253101 Miles Grant		W	1,104.7	5.77%	
253102 Miles Grant		S	1,030.2	5.38%	11.16%
256100 Sandalhaven		S	1,083.9	5.67%	5.67%
257100 Bayside		W	242.0	1.26%	
257101 Bayside		S	241.0	1.26%	2.52%
259100 Labrador		W	781.1	4.08%	
259101 Labrador		S	760.7	3.98%	8.06%
261100 Hutchinson Island		W	195.2	1.02%	
261101 Hutchinson Island		S	167.2	0.87%	1.89%
262100 Sandy Creek		W	203.8	1.07%	
262101 Sandy Creek		S	171.0	0.89%	1.96%
			19,131.9	100.00%	100.00%

<u>Worrell, David</u>		<u>System</u>	<u>ERC Count(1)</u>	<u>Percentage to Total</u>	
241100	Tierra Verde	S	2,093.2	20.77%	20.77%
250100	Mid-County	S	3,355.0	33.28%	33.28%
Utilities, Inc. of Florida					
252106	Orangewood	W	1,788.3	17.74%	
252107	Orangewood	S	162.0	1.61%	
252125	Summertree	W	1,225.0	12.15%	
252126	Summertree	S	1,023.0	10.15%	
252128	Lake Tarpon	W	433.3	4.30%	43.95%
			10,079.8	100.00%	100.00%

<u>Anderson, Daniel</u>		<u>System</u>	<u>ERC Count(1)</u>	<u>Percentage to Total</u>	
Utilities, Inc. of Florida					
252129	Golden Hills	W	532.1	16.01%	
252130	Golden Hills	S	78.8	2.37%	18.38%
260100	Pembroke	W	1,465.0	44.09%	
260101	Pembroke	S	1,247.0	37.53%	81.62%
			3,322.9	100.00%	100.00%

<u>Balke, Alan</u> <u>Bryant, Dennis</u> <u>Finch, Allan</u> <u>Keys, Eugene</u> <u>Loreaux, Alexander</u> <u>Straubinger, James</u> <u>Taroff, Paul</u>		<u>System</u>	<u>ERC Count(1)</u>	<u>Percentage to Total</u>	
255100	Seminole	W	11,797.7	56.29%	
255101	Seminole	S	9,158.0	43.69%	
255102	Seminole	R	4.0	0.02%	100.00%
			20,959.7	100.00%	100.00%

<u>Biasco, Christopher</u> <u>Richardson, James</u> <u>Schwarz, Charles</u> <u>Smith, Donald</u> <u>White, Donald</u>		<u>System</u>	<u>ERC Count(1)</u>	<u>Percentage to Total</u>	
LUSI					
251100	Four Lakes	W	66.0	0.42%	
251101	Lake Saunders	W	43.0	0.27%	
251102	South	W	3,065.1	19.29%	
251103	South	S	2,966.8	18.67%	
251106	North	W	5,684.5	35.77%	74.42%
Utilities, Inc. of Florida					
252129	Golden Hills	W	532.1	3.35%	
252130	Golden Hills	S	78.8	0.50%	3.84%
254101	ACME	N R	742.5	4.67%	4.67%
260100	Pembroke	W	1,465.0	9.22%	
260101	Pembroke	S	1,247.0	7.85%	17.07%
			15,890.8	100.00%	100.00%

<u>Cahnan, Robert</u>	<u>System</u>		<u>ERC Count (1)</u>	<u>Percentage to Total</u>	
<u>Cosner, Robert</u>					
<u>Ebert, Shawn</u>					
<u>Galbraith, Richard</u>					
<u>Hollister, James</u>					
<u>Leard, Mark</u>					
<u>Leard, Scott</u>					
<u>Marinelli, John</u>					
<u>Merrell, Matthew</u>					
<u>Pennington, Jonathan</u>					
<u>Pinder, Jeffrey</u>					
<u>Shaw, Michel</u>					
<u>Wright, Thomas</u>					
245100 Alafaya	S		2,545.9	21.16%	
245101 Alafaya	R		1,065.0	2.99%	24.15%
246100 Longwood	S		1,745.0	4.89%	4.89%
Utilities, Inc. of Florida					
252110 Wenhamsfield	W		1,174.0	3.29%	
252111 Wenhamsfield	S		1,160.5	3.23%	
252113 Oakland Shores	W		225.5	0.63%	
252114 Little Wexiva	W		61.0	0.17%	
252115 Park Ridge	W		102.0	0.29%	
252116 Phillips	W		77.0	0.22%	
252117 Crystal Lake	W		171.0	0.48%	
252118 Ravens Park	W		345.0	0.97%	
252119 Ravens Park	S		245.0	0.69%	
252121 Bear Lake Manor	W		224.5	0.63%	
252122 Jansen	W		250.5	0.70%	
252123 Crescent Heights	W		260.5	0.73%	
252124 Davis Shores	W		43.0	0.12%	12.17%
255100 Sealand	W		11,797.7	33.09%	
255101 Sealand	S		9,158.0	25.68%	
255102 Sealand	R		4.0	0.01%	58.78%
			35,655.1	100.00%	100.00%

<u>Cardinal, Anthony</u>	<u>System</u>		<u>ERC Count (1)</u>	<u>Percentage to Total</u>	
<u>Hahay, Stephen</u>					
<u>Schneider, Keith</u>					
Utilities, Inc. of Florida					
252106 Orangewood	W		1,788.3	38.61%	
252107 Orangewood	S		162.0	3.50%	
252125 Summertree	W		1,225.0	26.45%	
252126 Summertree	S		1,023.0	22.09%	
252128 Lake Tarpon	W		433.3	9.36%	100.00%
			4,631.6	100.00%	100.00%

<u>Carver, Nathaniel</u>	<u>System</u>		<u>ERC Count (1)</u>	<u>Percentage to Total</u>	
245100 Alafaya		S	7,545.9	14.85%	
245101 Alafaya		R	1,065.0	2.10%	16.95%
246100 Longwood		S	1,745.0	3.43%	3.43%
LJJSI					
251100 Four Lakes		W	66.0	0.13%	
251101 Lake Saunders		W	43.0	0.08%	
251102 South		W	3,065.1	6.03%	
251103 South		S	2,966.8	5.84%	
251106 North		W	5,684.5	11.19%	23.28%
Utilities, Inc. of Florida					
252110 Weathersfield		W	1,174.0	2.31%	
252111 Weathersfield		S	1,160.5	2.28%	
252113 Oakland Shores		W	225.5	0.44%	
252114 Little Wokiva		W	61.0	0.12%	
252115 Park Ridge		W	102.0	0.20%	
252116 Phillips		W	77.0	0.15%	
252117 Crystal Lake		W	171.0	0.34%	
252118 Ravenna Park		W	345.0	0.68%	
252119 Ravenna Park		S	245.0	0.48%	
252121 Bear Lake Manor		W	224.5	0.44%	
252122 Janssen		W	250.5	0.49%	
252123 Crescent Heights		W	260.5	0.51%	
252124 Davis Shores		W	43.0	0.08%	
252129 Golden Hills		W	532.1	1.05%	
252130 Golden Hills		S	78.8	0.16%	9.74%
255100 Sanlando		W	11,797.7	23.22%	
255101 Sanlando		S	9,158.0	18.03%	
255102 Sanlando		R	4.0	0.01%	41.26%
260100 Pansbrooks		W	1,465.0	2.88%	
260101 Pansbrooks		S	1,247.0	2.45%	5.34%
			50,803.4	100.00%	100.00%

<u>Carver, Jr. John</u>	<u>System</u>		<u>ERC Count (1)</u>	<u>Percentage to Total</u>	
Utilities, Inc. of Florida					
252110 Weathersfield		W	1,174.0	4.64%	
252111 Weathersfield		S	1,160.5	4.59%	
252113 Oakland Shores		W	223.5	0.89%	
252114 Little Wokiva		W	61.0	0.24%	
252115 Park Ridge		W	102.0	0.40%	
252116 Phillips		W	77.0	0.30%	
252117 Crystal Lake		W	171.0	0.68%	
252118 Ravenna Park		W	345.0	1.36%	
252119 Ravenna Park		S	245.0	0.97%	
252121 Bear Lake Manor		W	224.5	0.89%	
252122 Janssen		W	250.5	0.99%	
252123 Crescent Heights		W	260.5	1.03%	
252124 Davis Shores		W	43.0	0.17%	17.15%
255100 Sanlando		W	11,797.7	46.63%	
255101 Sanlando		S	9,158.0	36.20%	
255102 Sanlando		R	4.0	0.02%	82.83%
			25,299.2	100.00%	100.00%

<u>Embarka, Brian</u>		<u>System</u>	<u>ERC Count (1)</u>		<u>Percentage to Total</u>	
LUSI						
251100	Four Lakes	W	66.0		0.44%	
251101	Lake Saunders	W	43.0		0.28%	
251102	South	W	3,065.1		20.23%	
251103	South	S	2,966.8		19.59%	
251106	North	W	5,684.5		37.53%	78.06%
Utilities, Inc. of Florida						
252129	Golden Hills	W	532.1		3.51%	
252130	Golden Hills	S	78.8		0.52%	4.03%
Pembroke						
260100	Pembroke	W	1,465.0		9.67%	
260101	Pembroke	S	1,247.0		8.23%	17.90%
			15,148.3		100.00%	100.00%

<u>Gambacci, Dominic</u>		<u>System</u>	<u>ERC Count (1)</u>		<u>Percentage to Total</u>	
245100	Alafaya	S	7,545.9		16.60%	
245101	Alafaya	R	1,065.0		2.34%	18.94%
LUSI						
251100	Four Lakes	W	66.0		0.15%	
251101	Lake Saunders	W	43.0		0.09%	
251102	South	W	3,065.1		6.74%	
251103	South	S	2,966.8		6.53%	
251106	North	W	5,684.5		12.50%	26.01%
Utilities, Inc. of Florida						
252129	Golden Hills	W	532.1		1.17%	
252130	Golden Hills	S	78.8		0.17%	1.34%
Santando						
255100	Santando	W	11,797.7		25.95%	
255101	Santando	S	9,158.0		20.14%	
255102	Santando	R	4.0		0.01%	46.10%
254101	ACME	N R	742.5		1.63%	1.63%
Pembroke						
260100	Pembroke	W	1,465.0		3.22%	
260101	Pembroke	S	1,247.0		2.74%	5.97%
			45,461.4		100.00%	100.00%

Gossett, Brian		System	ERC Count (1)	Percentage to Total	
245100	Alafaya	S	7,545.9	14.64%	
245101	Alafaya	R	1,065.0	2.07%	16.71%
246100	Longwood	S	1,745.0	3.39%	3.39%
LUSI					
251100	Four Lakes	W	66.0	0.13%	
251101	Lake Saunders	W	43.0	0.08%	
251102	South	W	3,065.1	5.95%	
251103	South	S	2,966.8	5.76%	
251106	North	W	5,684.3	11.03%	22.94%
Utilities, Inc. of Florida					
252110	Wentworthfield	W	1,174.0	2.28%	
252111	Wentworthfield	S	1,160.3	2.25%	
252113	Oakland Shores	W	225.5	0.44%	
252114	Little Wekiva	W	61.0	0.12%	
252115	Park Ridge	W	102.0	0.20%	
252116	Phillips	W	77.0	0.15%	
252117	Crystal Lake	W	171.0	0.33%	
252118	Ravenna Park	W	345.0	0.67%	
252119	Ravenna Park	S	245.0	0.48%	
252121	Bear Lake Manor	W	224.5	0.44%	
252122	Jensen	W	250.5	0.49%	
252123	Crescent Heights	W	260.5	0.51%	
252124	Davis Shores	W	43.0	0.08%	
252129	Golden Hills	W	532.1	1.03%	
252130	Golden Hills	S	78.8	0.15%	9.60%
254101	ACME	N R	742.5	1.44%	1.44%
255100	Sanlando	W	11,797.7	22.89%	
255101	Sanlando	S	9,158.0	17.77%	
255102	Sanlando	R	4.0	0.01%	40.66%
260100	Panabrooke	W	1,465.0	2.84%	
260101	Panabrooke	S	1,247.0	2.42%	5.26%
			51,545.9	100.00%	100.00%

Horne, Raymond		System	ERC Count (1)	Percentage to Total	
245100	Alafaya	S	7,545.9	25.52%	
245101	Alafaya	R	1,065.0	3.60%	29.12%
255100	Sanlando	W	11,797.7	39.90%	
255101	Sanlando	S	9,158.0	30.97%	
255102	Sanlando	R	4.0	0.01%	70.88%
			29,570.6	100.00%	100.00%

McPhee, Allan		System	ERC Count (1)	Percentage to Total	
260100	Panabrooke	W	1,465.0	54.02%	
260101	Panabrooke	S	1,247.0	45.98%	100.00%
			2,712.0	100.00%	100.00%

<u>Overton, Michael</u>		<u>System</u>	<u>ERC Count (1)</u>	<u>Percentage to Total</u>	
245101	Alafaya	R	1,065.0	4.51%	4.51%
LUSI					
251100	Four Lakes	W	66.0	0.28%	
251101	Lake Saunders	W	43.0	0.18%	
251106	North	W	5,684.5	24.10%	24.56%
Utilities, Inc. of Florida					
252110	Weatherfield	W	1,174.0	4.98%	
252113	Oakland Shores	W	225.5	0.96%	
252114	Little Wokiva	W	61.0	0.26%	
252115	Park Ridge	W	102.0	0.43%	
252116	Phillips	W	77.0	0.33%	
252117	Crystal Lake	W	171.0	0.72%	
252118	Ravenna Park	W	345.0	1.46%	
252121	Bear Lake Manor	W	224.5	0.95%	
252122	Jensen	W	250.5	1.06%	
252123	Crescent Heights	W	260.5	1.10%	
252124	Devis Shores	W	43.0	0.18%	
252129	Golden Hills	W	532.1	2.26%	14.69%
255100	Sandalo	W	11,797.7	50.01%	
255102	Sandala	R	4.0	0.02%	50.03%
260100	Pembrooke	W	1,465.0	6.21%	6.21%
			23,591.3	100.00%	100.00%
<u>Farrish, Raymond</u>		<u>System</u>	<u>ERC Count (1)</u>	<u>Percentage to Total</u>	
LUSI					
251100	Four Lakes	W	66.0	0.45%	
251101	Lake Saunders	W	43.0	0.30%	
251102	South	W	3,065.1	21.08%	
251103	South	S	2,966.8	20.41%	
251106	North	W	5,684.5	39.10%	81.34%
260100	Pembrooke	W	1,465.0	10.08%	
260101	Pembrooke	S	1,247.0	8.58%	18.66%
			14,537.4	100.00%	100.00%
<u>Phillips, Christopher</u>		<u>System</u>	<u>ERC Count (1)</u>	<u>Percentage to Total</u>	
245100	Alafaya	S	7,545.9	56.78%	
245101	Alafaya	R	1,065.0	8.01%	64.79%
246100	Longwood	S	1,745.0	13.13%	13.13%
Utilities, Inc. of Florida					
252110	Weatherfield	W	1,174.0	8.83%	
252113	Oakland Shores	W	225.5	1.70%	
252114	Little Wokiva	W	61.0	0.46%	
252115	Park Ridge	W	102.0	0.77%	
252116	Phillips	W	77.0	0.58%	
252117	Crystal Lake	W	171.0	1.29%	
252118	Ravenna Park	W	345.0	2.60%	
252121	Bear Lake Manor	W	224.5	1.69%	
252122	Jensen	W	250.5	1.88%	
252123	Crescent Heights	W	260.5	1.96%	
252124	Devis Shores	W	43.0	0.32%	22.08%
			13,289.9	100.00%	100.00%

Resendiz, Robert		System	ERC Count (1) Percentage to Total		
255100	Santando	W	11,797.7	99.97%	
255102	Santando	R	4.0	0.03%	100.00%
			11,801.7	100.00%	100.00%

Shilton, Terry		System	ERC Count (1) Percentage to Total		
			Utilities, Inc. of Florida		
252110	Weatherfield	W	1,174.0	8.14%	
252113	Oakland Shores	W	225.5	1.56%	
252114	Little Wekiva	W	61.0	0.42%	
252115	Park Ridge	W	102.0	0.71%	
252116	Phillips	W	77.0	0.53%	
252117	Cymal Lake	W	171.0	1.19%	
252118	Ravenna Park	W	345.0	2.39%	
252121	Bear Lake Manor	W	224.5	1.56%	
252122	Jensen	W	250.5	1.74%	18.23%
255100	Santando	W	11,797.7	81.77%	81.77%
			14,428.2	100.00%	100.00%

Yamamoto, Jr, Nathan		System	ERC Count (1) Percentage to Total		
246100	Longwood	S	1,745.0	100.00%	100.00%
			1,745.0	100.00%	100.00%

Weirbleck, Anthony		System	ERC Count (1) Percentage to Total		
242100	Lake Placid	W	130.7	0.77%	
242101	Lake Placid	S	130.7	0.77%	1.54%
248100	Cypress Lakes	W	1,247.0	7.34%	
248101	Cypress Lakes	S	1,145.3	6.74%	14.08%
249100	Eagle Ridge	S	1,602.6	9.43%	
249101	Eagle Ridge	S	908.0	5.34%	14.77%
250100	Mid-County	S	3,355.0	19.74%	19.74%
			Utilities, Inc. of Florida		
252106	Orangetwood	W	1,788.3	10.52%	
252107	Orangetwood	S	162.0	0.95%	
252125	Summertree	W	1,225.0	7.21%	
252126	Summertree	S	1,023.0	6.02%	
252128	Lake Tarpon	W	433.3	2.55%	27.25%
256100	Sandhaven	S	1,083.9	6.38%	6.38%
257100	Bayside	W	242.0	1.42%	
257101	Bayside	S	241.0	1.42%	2.84%
259100	Labrador	W	781.1	4.60%	
259101	Labrador	S	760.7	4.48%	9.07%
261100	Hutchinson Island	W	195.2	1.15%	
261101	Hutchinson Island	S	167.2	0.98%	2.13%
262100	Sandy Creek	W	203.8	1.20%	
262101	Sandy Creek	S	171.0	1.01%	2.21%
			16,997.0	100.00%	100.00%

UTILITIES, INC. OF PENNBROOKE
 CALCULATION OF WELL REPLACEMENT
 DEPRECIATION EXPENSE ADJUSTMENT

Well - 30 year life

307.2	Adjustment to retire well no. 1	(43,730)	
307.2	Depreciation expense on well retirement adjustment		(1,458)
307.2	Adjustment for replacement well	408,750	
307.2	Depreciation expense on well replacement adjustment		<u>13,625</u>
			<u>12,167</u>

Pumping Equipment - 20 year life

311.3	Adjustment to retire pumping equipment at well no. 1	(19,086)	
311.3	Depreciation expense on pumping retirement adjustment		(954)
311.3	Adjustment for pumping equipment replacement	27,250	
311.3	Depreciation expense on pumping replacement adjustment		<u>1,363</u>
			<u>408</u>

Water Treatment Equipment - 22 year life

320.3	Adjustment to retire electrical WTP components	(2,000)	
320.3	Depreciation expense on pumping retirement adjustment		(91)
320.3	Adjustment for electrical WTP improvements	10,000	
320.3	Depreciation expense on pumping improvement adjustment		<u>500</u>
			<u>409</u>

Total Water Depreciation Expense Adjustment for Upgrades

12,985

Lift Station - 25 year life

354.2	Adjustment to retire electrical WTP components	(2,000)	
354.2	Depreciation expense on pumping retirement adjustment		(80)
354.2	Adjustment for electrical WTP improvements	10,000	
354.2	Depreciation expense on pumping improvement adjustment		<u>400</u>
			<u>320</u>

Total Wastewater Depreciation Expense Adjustment for Upgrades

320

PROFESSIONAL SERVICES AGREEMENT

Between: Knight Engineering Consultants, Inc.; herein referred to as "Engineer"
11648 Osprey Pointe Blvd.
Clermont, Florida 34711

And: Utilities, Inc. of Pennbrooke; herein referred to as "Client"
200 Weathersfield Avenue
Altamonte Springs, Florida 32714

Re: Civil Engineering Services Proposal
Water Tank Inspections, Pennbrooke Fairways WTP

Knight Engineering Consultants, Inc. (KECI) is pleased to present this proposal for professional civil engineering services. Please find herein the Project Description, Scope of Services, Conditions of the Agreement, and Compensation for the proposed professional services.

PROJECT DESCRIPTION

The proposed project involves inspection and cleaning of one (1) 7,500 gallon hydropneumatic tank, one (1) 10,000 gallon hydropneumatic tank and three (3) 50,000 gallon ground storage tanks. The tanks are part of the Pennbrooke Fairways Water Treatment Plant (WTP).

SCOPE OF SERVICES

The scope of services includes inspection and cleaning services for the above described five (5) water tanks. The following services will be provided for each tank:

- Ultrasonic testing and recording of residual metal thickness for steel tanks
- Visual inspection and recording of conditions inside and outside of all tanks including corrosion and surface treatment (coating).
- Visual inspection and recording of condition of access cover (manway) and gasket
- Replacement of manway gasket if necessary
- Digital photography inside and outside of all tanks
- Brushing and/or pressure washing inside of tanks
- Removal of up to 1" soft sediment
- Rinsing inside of tanks
- Water Tank Inspection Report

PROFESSIONAL SERVICES AGREEMENT

Between: Knight Engineering Consultants, Inc.; herein referred to as "Engineer"
And: Utilities, Inc. of Pennbrooke; herein referred to as "Client"

Re: Civil Engineering Services Proposal
Water Tank Inspections, Pennbrooke Fairways WTP

The tanks will be cleaned and inspected on three (3) separate days. The first inspection will include one (1) hydropneumatic tank and one (1) ground storage tank. The second inspection will include one (1) hydropneumatic tank and one (1) ground storage tank. The third inspection will include one (1) ground storage tank. All inspections will occur within a 30 day period.

Each tank will need to be bypassed or taken offline during the inspection and cleaning process. The "Client" is responsible for these services. Each tank should be emptied by the client's representative prior to inspection and/or cleaning by the engineer or his assistant.

A boil water notice may be required and bacteriological samples collected. The "Client" is responsible for any and all boil water notices.

The scope of services includes the removal of soft sediment up to 1" in depth. Additional sediment removal will be done at the rate of \$90.00 per hour.

The scope of services includes provisions for sanitary tools and equipment to gain access to and complete interior cleaning of tanks.

The scope of services does not include any analysis of any existing potable water supply or distribution system.

CONDITIONS OF THE AGREEMENT

PROFESSIONAL SERVICES AGREEMENT

Between: Knight Engineering Consultants, Inc.: herein referred to as "Engineer"
 And: Utilities, Inc. of Pennbrooke; herein referred to as "Client"

Re: Civil Engineering Services Proposal
 Water Tank Inspections, Pennbrooke Fairways WTP

COMPENSATION

The total fee is \$2,150 per tank, \$10,750 total. The fee schedule is as follows:

Retainer Fee, due upon execution of this Agreement	\$5,375.00
Submittal Fee, due upon submittal to "Client"	\$5,375.00

The "Engineer" shall submit invoices to the "Client" for compensation of the work completed as specified in this section of this Agreement. Payment is due upon receipt of invoice. If the "Client" fails to make any payment due to the "Engineer" for services and/or expenses within thirty (30) days of the invoice date the "Engineer" reserves the right to discontinue any or all work on the subject property. If the "Engineer" employs legal services to collect overdue amounts, the "Client" agrees to pay all costs of collection, including reasonable attorney's fees, whether action be brought or not. The "Client" agrees to pay all required application and permit fees, all survey verification fees and any other fee that may be required to obtain the necessary permits that are not specifically noted by this Agreement.

Additional services will be provided only at the Client's request. Additional services will be billed at KECI's current hourly billing rates. KECI's current hourly billing rates are as follows:

Principle Engineer	\$175.00
Engineering Assistant/Mechanic	\$90.00
Administrative (Secretarial)	\$50.00

If this agreement meets your approval, please sign and return one copy along with a check for the retainer fee. Your execution of this contract shall serve as authorization to proceed with the work as described herein.

MUTUALLY UNDERSTOOD AND AGREED:

 Thomas L. Knight, P.E., President
 Knight Engineering Consultants, Inc.



 Patrick C. Flynn, Regional Director
 Utilities, Inc. of Pennbrooke

Date: _____

Date: _____

5b

1C

The Huntington Company

1168 Woodland Terrace Trail
 Altamonte Springs, FL 32714
 O (407) 276-6344
 F (407) 926-0139
 BNI To:

Estimate

Number: E102
 Date: December 28, 2009

Ship To:

Utilities Inc.
 2335 Sanders Road
 Northbrook, IL 60062

Description	Amount
Pembroke location: Drain the main holding tanks at the Pembroke location (3) and remove the damaged and inoperable ladders int eh tank with new aluminum ladders to gain access to the inside of the containers	963.00
Drain down 1 tank and remove the water inside. Powerwash ALL rust and corrosion out of the tanks, and remove the dabrjs with a pump system, and manually with buckets. After rust removal, the tank must be dry to apply a Paint to Metal primer.	
Apply an epoxy PTM on the entire inside of the tank TOP TO BOTTOM to prevent further rust damage in the tank. EACH TANK WILL TAKE 1 WEEK FROM START TO FINISH. So, 1 tank will need to be isolated from the others during this work.	
Tank 1	6,836.00
Tank 2	6,836.00
Tank 3	6,836.00
*****Confined space permits will need to be acquired prior to starting project	
***** All Proper ventilation equipment will be in use per code enforcement and safety during this project.	
After powerwash cleaning of the tanks we will Sandblast the inside of the 3 main tanks in preparations for the epoxy paint installation. All sand will be removed prior to final epoxy installation.	4,692.00

Sb

The Huntington Company

1180 Woodland Terrace Trail
Altamonte Springs, FL 32714
O (407) 278-5344
F (407) 926-0139
Bill To:

Utilities Inc.
2335 Sanders Road
Northbrook, IL 60062

Estimate

20

Number: E102

Date: December 28, 2009

Ship To:

Description	Amount
Purchaser: Location: POS BUS	
Total	\$26,063.00