

274324

NI FLORIDA, LLC
TAMIAMI VILLAGE WATER COMPANY, INC.
TERRITORY DESCRIPTION

Block 28, Township 43 East, Range 24 East
Block 28: A tract or parcel of land in the Southwest 1/4 of the Southwest 1/4 of Section 27, Township 43 South, Range 24 East, which is described as follows:
From the Southwest corner of said fraction of Section 27, thence S 87°14'10" W along the West line of said Section for 25.0 feet; thence S 89°52'40" E along the West right-of-way (25.0 feet from center line) of Lillian Road and parallel with the South line of said Section for 187.70 feet to an intersection with a Secondary proposition of a line parallel with and 200.00 feet (as measured on a perpendicular) from the Western line (S 87°14'10" W) of the Township Trak (S 1/4, 41, State Road 452) and the POINT OF BEGINNING.
Thence N 87°14'10" W along said proposition for 348.18 feet; thence S 84°13'40" E for 290.00 feet; thence S 02°56'20" W along the Western right-of-way (100.00 feet from center line) of said Township Trak for 200.00 feet to a point of curvature of a curve to the left (Radius 5029.56 feet, Chord bearing S 71°02'30" W) thence Southwesterly along the arc of said curve for 110.46 feet; thence N 89°52'40" W along said North right-of-way of Lillian Road for 210.55 feet to the POINT OF BEGINNING, Containing 2.232 acres more or less.
Block 28a: A tract or parcel of land in the Southwest 1/4 of the Southwest 1/4 of Section 27, Township 43 South, Range 24 East, which is described as follows:
From the Southwest corner of said fraction of Section 27, thence S 87°14'10" W along the West line of said Section for 25.0 feet; thence S 89°52'40" E along the West right-of-way (25.0 feet from center line) of Lillian Road and parallel with the South line of said Section for 187.70 feet to an intersection with a Secondary proposition of a line parallel with and 200.00 feet (as measured on a perpendicular) from the Western right-of-way (S 87°14'10" W) of the Township Trak (S 1/4, 41, State Road 452); thence N 87°14'10" W along said proposition for 348.18 feet to the POINT OF BEGINNING.
Thence continued N 87°14'10" W along said proposition for 175.45 feet; thence S 87°14'10" W along the Southern line of an 80.00 foot wide parcel (as recorded in D.B. 1887, page 1128) for 290.00 feet; thence S 02°56'20" W along said Western right-of-way (100.00 feet from center line) of said Township Trak for 450.00 feet; thence N 84°13'40" E for 290.00 feet to the POINT OF BEGINNING, Containing 1.875 acres more or less.
Block 28b: A tract or parcel of land in the Southwest 1/4 of Section 27, Township 43 South, Range 24 East, which is described as follows:
From the Southwest corner of said fraction of Section 27, thence S 87°14'10" W along the West line of said Section for 25.0 feet; thence S 89°52'40" E along the West right-of-way (25.0 feet from center line) of Lillian Road and parallel with the South line of said Section for 187.70 feet to an intersection with a Secondary proposition of a line parallel with and 200.00 feet (as measured on a perpendicular) from the Western right-of-way (S 87°14'10" W) of the Township Trak (S 1/4, 41, State Road 452); thence N 87°14'10" W along said proposition for 348.18 feet to the POINT OF BEGINNING.
Thence continued N 87°14'10" W along said proposition for 128.73 feet to the northern boundary of lands formerly owned to Miami Village of America; thence run N 89°54'20" E, along said northern boundary for 288.58 feet to the intersection with the curved westerly line (100.00 feet from center line) of the Township Trak (State Road No. 452); thence run southeasterly along said westerly line, along the arc of a curve to the right of radius 5029.56 feet (Chord bearing S 71°02'30" W) for 128.23 feet to a point of tangency; thence run S 02°56'20" W for 886.63 feet; thence run N 89°52'40" E for 291.00 feet to the POINT OF BEGINNING, Containing 1.922 acres more or less.

Section 27 and 28, Township 43 East, Range 24 South
A tract or parcel of land in Sections 27 and 28, Township 43 South, Range 24 East, encompassing Lorraine Avenue, a Waste Water Park, as recorded in Collier County Plat Book 3, pages 82 through 70 of the Lee County, Florida Public Records, which is described as follows:
Commencing at the Northeast corner of the Southwest 1/4 of the Southwest 1/4 of Section 21, Township 43 South, Range 24 East, run S 87°52'30" E, 25.00 feet; thence S 02°18'10" W, 173.25 feet to the POINT OF BEGINNING; the said course being 23 feet perpendicular and parallel to the West line of said Section.
Thence continue S 02°18'10" W, 314.47 feet, said course being 25 feet to the West line of the S.E. 1/4 of Section 21; thence S 87°52'30" E, 515.0 feet; thence S 02°18'10" W, 188.78 feet; thence N 89°11'30" E, 885.0 feet; thence S 87°52'30" E, 243.00 feet.
Thence N 87°52'30" E, 1128.25 feet to a point in the curve across to the Southeast, along the Western right-of-way line of U.S. 91.
Thence following the curve across to the Southeast in the Southeasterly direction following along the Western right-of-way line of U.S. 91, said curve having a central angle of 127°28'40" a radius of 8848.68 feet, a share of 1229.50 feet, and a distance of 1229.50 feet to a point lying on said curve on the Western right-of-way line of U.S. 91.
Thence S 87°52'30" E, 888.32 feet; thence S 55°15'10" W, 518.77 feet to a point; thence N 89°52'40" E, 140.00 feet to the POINT OF BEGINNING.
Also, the Northeast 1/4 of the Southwest 1/4 of said Section 28, Township 43 South, Range 24 East, subject to a 100 foot easement along the Eastern line of said Property.

6	CORRECTED MINOR TYPES	KAB	7/09	NI FLORIDA, LLC TAMIAMI VILLAGE WATER COMPANY, INC. MAP AND DESCRIPTION OF TERRITORY SERVED KEY ENGINEERING ASSOCIATES, INC. 4565 RUTLEDGE DRIVE PALM HARBOR, FL 34685 PHONE: 727-781-1111 FAX: 727-781-1112 8101 x 481
5	CORRECTED MINOR TYPES	KAB	8/09	
4	MINOR WATER METER LOCATION CHANGES	KAB	5/09	
3	ADDED REVISED TERRITORY DESCRIPTION	KAB	4/09	
2	ADDED WATER CUSTOMERS & MAP INFO	KAB	4/09	
1	SERVED TERRITORY MAP & DESCRIPTION	KAB	2/09	
DATE	DESCRIPTION	APPROVED	DATE	
PROJECT SUPERVISOR	APPROVED			
DATE	DESCRIPTION	APPROVED	DATE	

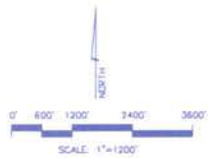

LEGEND	
	SECTION LINE
	SERVICE AREA BOUNDARY
	PARCEL LOT LINES
	SECTION/TOWNSHIP/RANGE
	282416

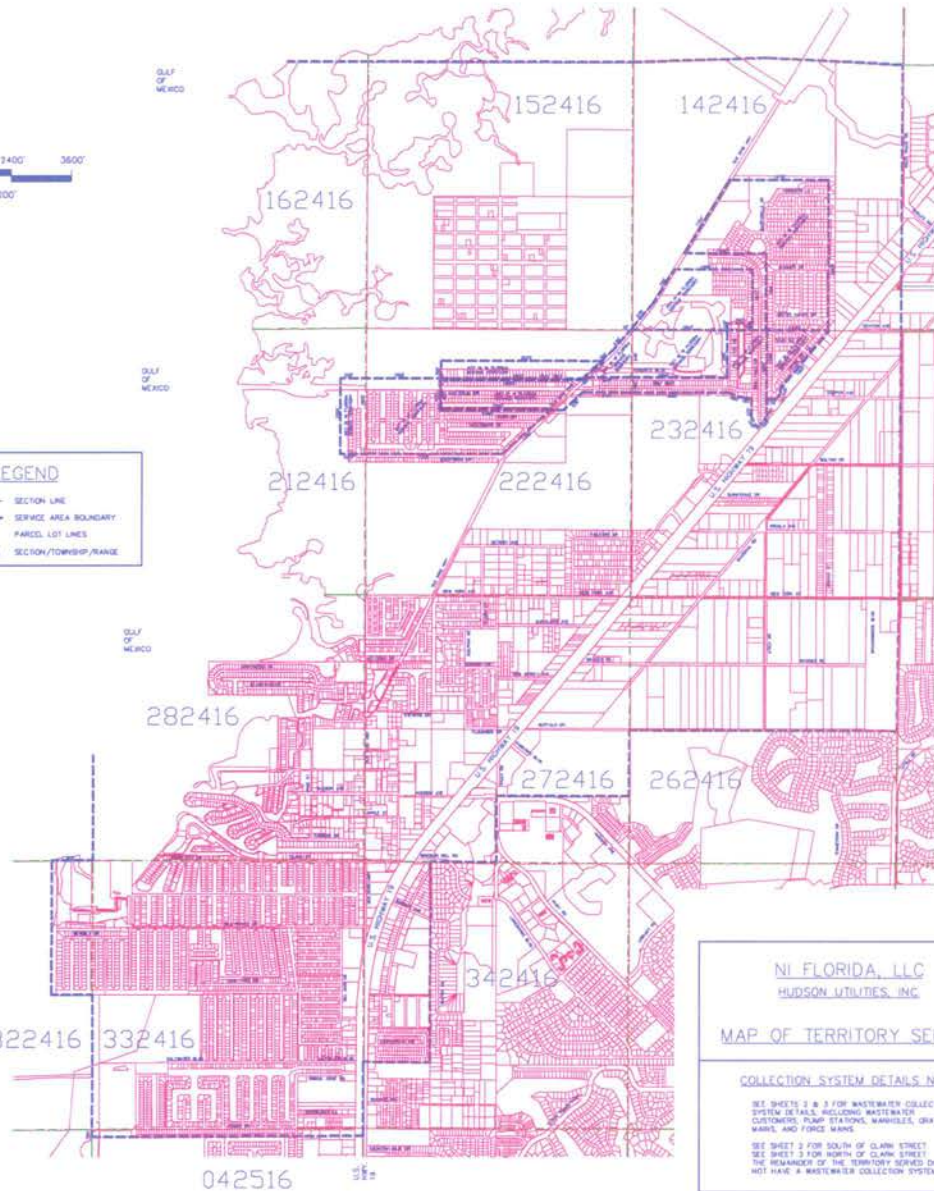

IN ADDITION TO THE WASTEWATER CUSTOMERS SHOWN ON SHEETS 2 AND 3 THERE IS COMMERCIAL WASTEWATER CUSTOMER AT THIS LOCATION

NI FLORIDA, LLC
HUDSON UTILITIES, INC.

MAP OF TERRITORY SERVED

COLLECTION SYSTEM DETAILS NOTE:

SEE SHEETS 2 & 3 FOR WASTEWATER COLLECTION SYSTEM DETAILS, INCLUDING WASTEWATER CUSTOMERS, PUMP STATIONS, MANHOLES, GRAVITY MAINS, AND FORCE MAINS.

SEE SHEET 2 FOR SOUTH OF CLARK STREET
SEE SHEET 3 FOR NORTH OF CLARK STREET
THE REMAINDER OF THE TERRITORY SERVED DOES NOT HAVE A WASTEWATER COLLECTION SYSTEM.

NI FLORIDA, LLC
HUDSON UTILITIES, INC.

LEGAL DESCRIPTION OF TERRITORY SERVED

Township 24 South, Range 18 East

Section 14:
All of said Section, LESS the following described portions thereof: Commence at the Southwest corner of said Section 14 and the POINT OF BEGINNING; Thence run North, along the West line of said Section 14, 30 feet to the center line of Old Dixie Highway; Thence run North 40 degrees East along the center line of Old Dixie Highway 670 feet; Thence run North 32 degrees East along the center line of Old Dixie Highway 780 feet; Thence run East, 1,566 feet; Thence run South, 1,075 feet; Thence run West, 300 feet; Thence run South, 130 feet to the South line of said Section 14; Thence run West, along the South line of said Section 14, 1,910 feet to the POINT OF BEGINNING. Also, commence at the Southwest corner of said Section 14; Thence run North along the West line of said Section 14, 30 feet to the center line of Old Dixie Highway; Thence run North 40 degrees East along the center line of Old Dixie Highway 870 feet; Thence run North 32 degrees East along the center line of Old Dixie Highway, 1,182 feet to the POINT OF BEGINNING; Thence continue North 32 degrees East along the center line of Old Dixie Highway, 1,104 feet; Thence run East, 1,075 feet; Thence run South, 2,985 feet to the South line of said Section 14; Thence run West, along the South line of said Section 14, 1,245 feet; Thence run North, 1,530 feet; Thence run West, 1,838 feet to the POINT OF BEGINNING. The areas excluded are portions of the Vireo Villas and Sea Pines Subdivisions served by Pasco County.

LESS the following described portion thereof: Commence at the Southwest corner of said Section 14; Thence run North, along the West line of said Section 14, 30 feet to the center line of Old Dixie Highway; Thence run North 40 degrees East along the center line of Old Dixie Highway 870 feet; Thence run North 32 degrees East along the center line of Old Dixie Highway 780 feet to the POINT OF BEGINNING; Thence continue North 32 degrees East along the center line of Old Dixie Highway 380 feet; Thence run East, 1,438 feet; Thence run South, 1,500 feet to the South line of Section 14; Thence run West, along the South line of Section 14, 790 feet; Thence run North 120 feet; Thence run East 500 feet; Thence run North, 1,075 feet; Thence run West 1,568 feet to the POINT OF BEGINNING.

Section 15: All of said Section.

Section 16: All of said Section.

Section 21:

All of said Section, LESS the South 1500 feet of the North 2500 feet of the East 500 feet of said Section. The areas excluded are a portion of the Sea Pines Subdivision served by Pasco County.

Section 22:

All of said Section, LESS the following described portions thereof: Commence at the Northwest corner of said Section 22; Thence run South along the West Section line 1,000 feet to the POINT OF BEGINNING; Thence run East 1,500 feet to the center of a canal; Thence run South 600 feet; Thence run East 2,000 feet to the center of Old Dixie Highway; Thence run South 47 degrees West along center of Old Dixie Highway 1,500 feet; Thence run West approximately 2,700 feet to the West section line of said Section 22; Thence run North, along the West section line 1,500 feet to the POINT OF BEGINNING. Also, commence at the Northwest corner of said Section 22; Thence run South along the West section line 1,500 feet to the POINT OF BEGINNING; Thence run North 200 feet; Thence run East 2,225 feet to the center of Old Dixie Highway; Thence run South 47 degrees West along center of Old Dixie Highway 513 feet; Thence run West approximately 2,850 feet to the POINT OF BEGINNING. Also, commence at the Northwest corner of said Section 22 and the POINT OF BEGINNING; Thence run South along the East line of said section 945 feet; Thence run West 948 feet to the center line of Old Dixie Highway; Thence run North 47 degrees East along the center line of Old Dixie Highway 790 feet; Thence run North 40 degrees East along the center line of Old Dixie Highway 530 feet to the North line of said Section 22; Thence run East, along the North line of said Section 22, 30 feet to the POINT OF BEGINNING. The areas excluded are a portion of the Sea Pines Subdivisions served by Pasco County.

LESS the following described portions thereof: Commence at the Northwest corner of said Section 22; Thence run South along the East Section line, 945 feet to the POINT OF BEGINNING; Thence continue South along East line of said Section, 300 feet; Thence run West 870 feet; Thence run South 47 degrees West parallel to centerline of Old Dixie Highway, 330 feet; Thence run West 2,450 feet; Thence run North, 600 feet to a point in the Canal; Thence run East along centerline of Canal, 2,800 feet to the centerline of Old Dixie Highway; Thence run North 47 degrees along the centerline of Old Dixie Highway, 80 feet; Thence run East 948 feet to the POINT OF BEGINNING.

Section 23:

All of said Section, LESS the following described portions thereof: Commence at the Northwest corner of said Section 23 and the POINT OF BEGINNING; Thence run East along the North line of said Section 23, 1,810 feet; Thence run South 945 feet; Thence run West 1,810 feet to the West section line of said Section 23; Thence run North along the West section line of said Section 23, 945 feet to the POINT OF BEGINNING. Also, commence at the Northwest corner of said Section 23; Thence run East along the North line of said Section 23, 2,700 feet to the POINT OF BEGINNING; Thence continue East along the North line of said Section 23, 1,240 feet; Thence run North 32 degrees West, parallel to U.S. 18, 1,500 feet; Thence run North 32 degrees West, parallel to U.S. 18, 140 feet; Thence run West, 175 feet; Thence run North, 1,380 feet to the POINT OF BEGINNING. The areas excluded are portions of the Vireo Villas and Sea Pines Subdivisions served by Pasco County.

LESS the following described portion thereof: Commence at the Northwest corner of said Section 23; Thence run East along the North line of said Section 23, 1,810 feet to the POINT OF BEGINNING; Thence run East along North line of said Section 23, 790 feet; Thence run South, 1,840 feet; Thence run South 28 degrees East, 80 feet to the West Right-of-Way line of U.S. Highway 18; Thence run Southwest along West Right-of-Way line of U.S. Highway 18, 320 feet; Thence run North 28 degrees West, 250 feet; Thence run North, 375 feet; Thence run West, 165 feet; Thence run North 84 degrees West, 380 feet; Thence run West 1,900 feet to a point on West line of said Section; Thence run North, 300 feet; Thence run East, 1,810 feet; Thence run North 945 feet to the POINT OF BEGINNING.

Section 26:

All of the North 1/2 of said Section 26.

Section 27:

All of said Section 27; LESS the South 1/2 of the Southeast 1/4.

Section 28: All of said Section.

Section 32: The East 818 feet of the North 1/2 of said Section 32.

Section 33: All of said Section.

Section 34:

The West 1/2 of the Northwest 1/4. The Northwest 1/4 of the SW 1/4.

Township 25 South, Range 18 East

Section 4:

The North 150 feet of said Section 4.

NI FLORIDA, LLC HUDSON UTILITIES, INC.			
MAP AND DESCRIPTION OF TERRITORY SERVED			
1. SERVICE TERRITORY MAP & DESCRIPTION		KAB	7/28
DATE	DESCRIPTION	APPROVED	SIGN
PROJECT SUPERVISOR	APPROVED		
KEY ENGINEERING ASSOCIATES, INC. 1462 RUTLEDGE DRIVE PALM HARBOR, FL 34885 PHONE: 727-781-1111 FAX: 727-781-1112			
DATE: 08/14/2010	SCALE: 1"=400'	SHEET: 1	OF: 3

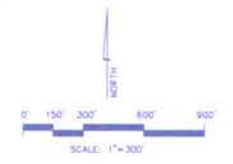
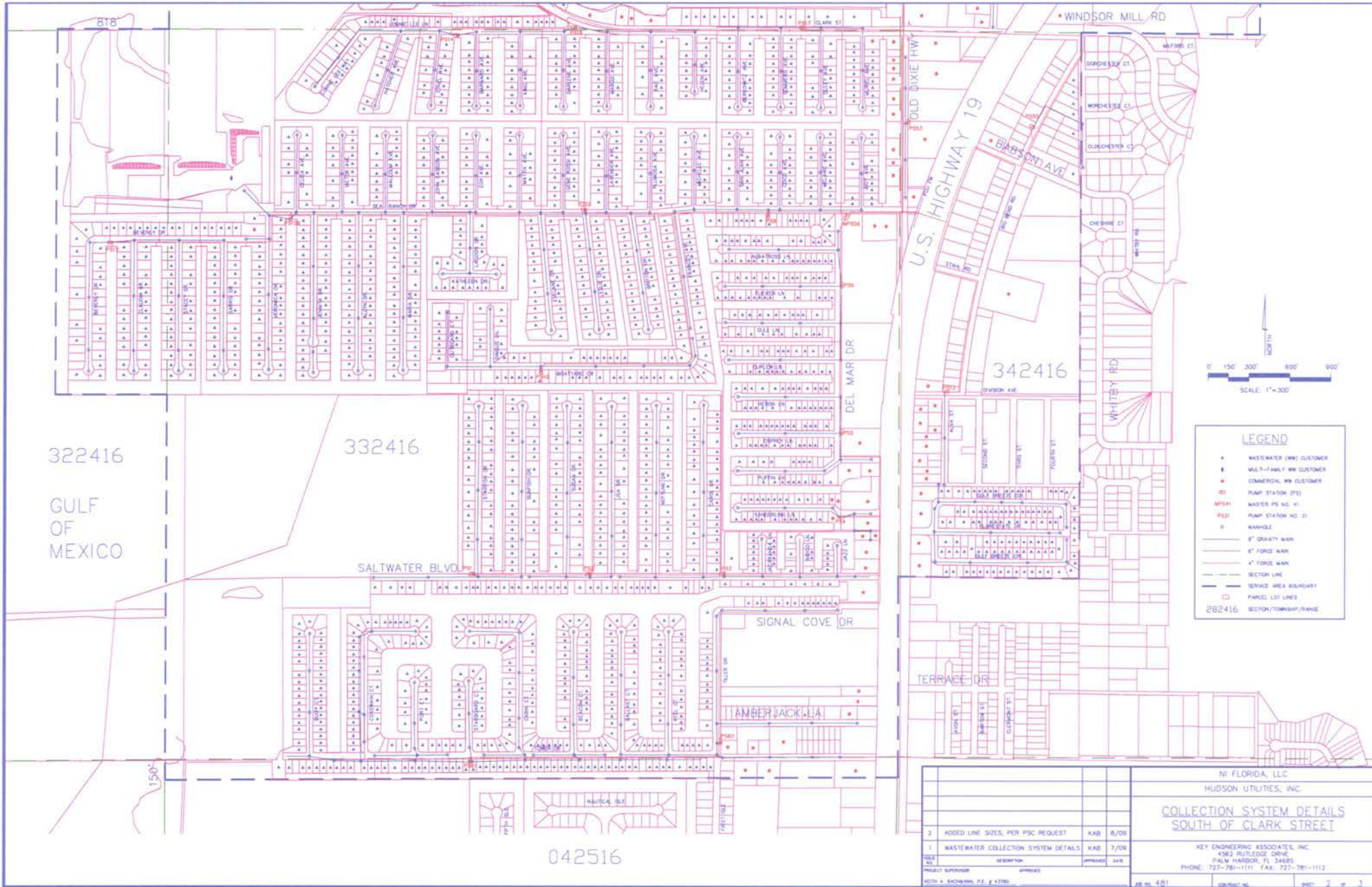

LEGEND

- WASTEWATER (WW) CUSTOMER
- MULTI-FAMILY WW CUSTOMER
- COMMERCIAL WW CUSTOMER
- PS1 PUMP STATION (PS)
- PS2 PUMP STATION NO. 2
- Ø MANHOLE
- 8" GRAVITY MAIN
- 4" FORCE MAIN
- 4" FORCE MAIN
- SECTION LINE
- SERVICE AREA BOUNDARY
- PARCEL LOT LINES
- 282416 SECTION/TOWNSHIP/RANGE

3	ADDED LINE SIZES, PDR PSC REQUEST	KAB	8/09
1	WASTEWATER COLLECTION SYSTEM DETAILS	KAB	7/09
DATE	DESCRIPTION	APPROVED	DATE
PROJECT SUPERVISOR	ENGINEER		

N FLORIDA, LLC
HUDSON UTILITIES, INC.

**COLLECTION SYSTEM DETAILS
SOUTH OF CLARK STREET**

KEY ENGINEERING ASSOCIATES, INC.
4562 PRULEDGE DRIVE
DALE HARBOR, FL 34685
PHONE: 727-781-1111 FAX: 727-781-1112

042516

PROJECT NO. 481

DATE: 7/09

322416
GULF OF MEXICO

332416

342416

042516

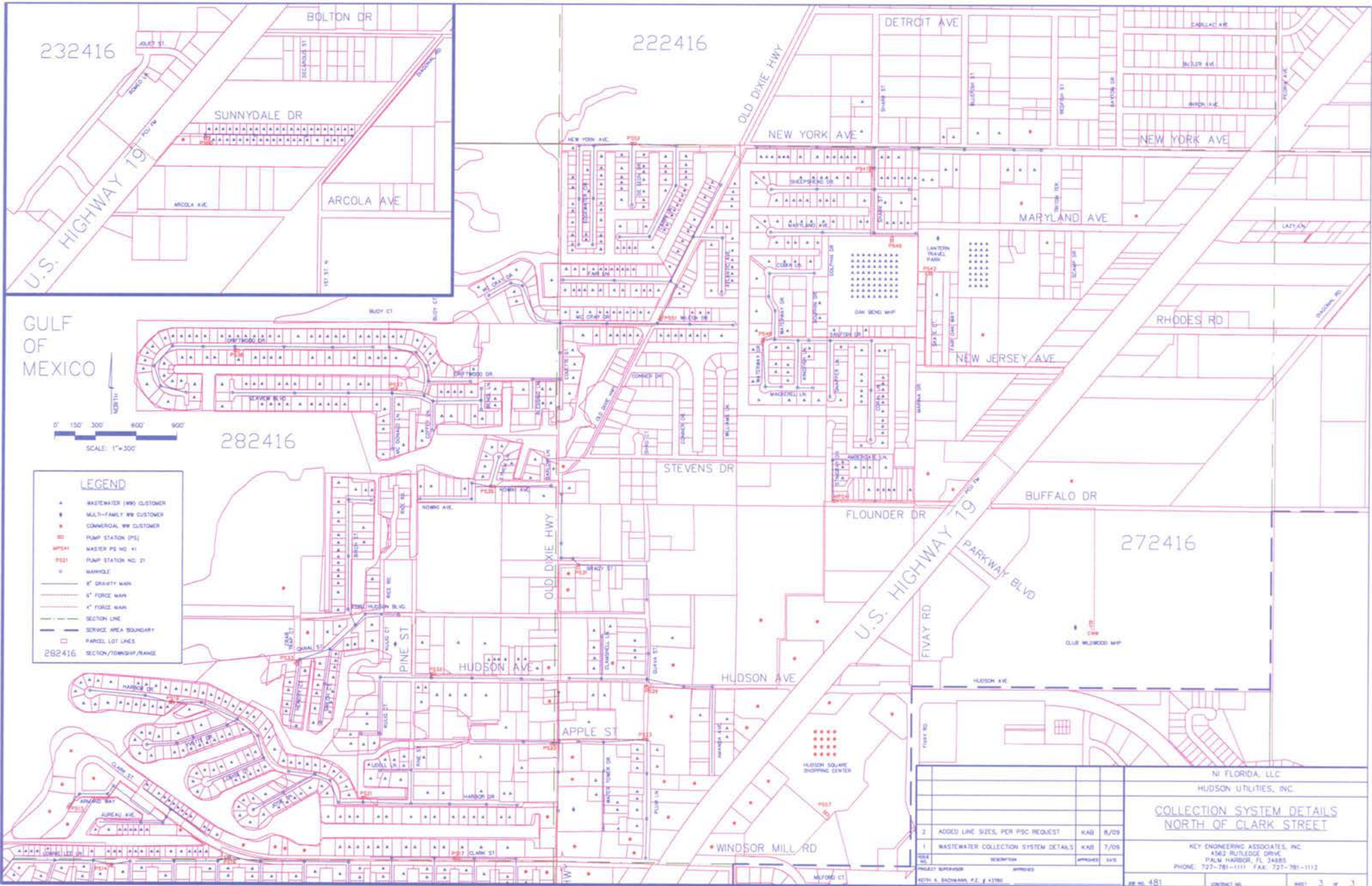

GULF OF MEXICO



LEGEND

- WASTEWATER (RW) CUSTOMER
- MULTI-FAMILY (MF) CUSTOMER
- COMMERCIAL (CW) CUSTOMER
- PS1 PUMP STATION (PS)
- PS2 PUMP STATION NO. 2
- MH MANHOLE
- 8" GRAVITY MAIN
- 8" FORCE MAIN
- 4" FORCE MAIN
- SECTION LINE
- SERVICE AREA BOUNDARY
- PARCEL LOT LINES
- SECTION/TOWNSHIP/RANGE

		NI FLORIDA, LLC HUDSON UTILITIES, INC.	
COLLECTION SYSTEM DETAILS NORTH OF CLARK STREET			
3	ADDED LINE SIZES, PER PSC REQUEST	KAB	8/09
1	WASTEWATER COLLECTION SYSTEM DETAILS	KAB	7/08
DATE	DESCRIPTION	APPROVED	DATE
PROJECT SUPERVISOR	APPROVED		
NATHAN A. BADWANK, P.E. # 43780			
SHEET NO. 491	CONTRACT NO.	DATE	PAGE 3 OF 3

KEY ENGINEERING ASSOCIATES, INC.
 4562 RUTLEDGE DRIVE
 PALM HARBOR, FL 34885
 PHONE: 727-781-1111 FAX: 727-781-1112