

From: jsinn@weilerengineering.org <jsinn@weilerengineering.org>
To: [James Contino](mailto:James.Contino@whartonsmith.com)jcontino@whartonsmith.com
chris@kwru.comchris@kwru.com
[Greg Wright](mailto:Greg.Wright@kwru.com)greg@kwru.com
[Ed Castle, P.E.](mailto:Ed.Castle@me.com)edrcastle@me.com
ssuggs@weilerengineering.orgssuggs@weilerengineering.org
lgermaine@weilerengineering.orglgermaine@weilerengineering.org
[Gregory Williams](mailto:Gregory.Williams@whartonsmith.com)gwilliams@whartonsmith.com
[Edgar Gonzalez](mailto:Edgar.Gonzalez@whartonsmith.com)egonzalez@whartonsmith.com
[Jean Laine](mailto:Jean.Laine@whartonsmith.com)jlaine@whartonsmith.com
CC: [Erica Marnati](mailto:Erica.Marnati@whartonsmith.com)emarnati@whartonsmith.com
[Angela Kushner](mailto:Angela.Kushner@whartonsmith.com)akushner@whartonsmith.com
Date: 2/21/2018 11:01:30 AM
Subject: RE: 17-160 - KWRU WWTP Filter Replacement - Progress Meeting #1

Hello All,
Generator Foundation Drawing attached
John
Weiler Engineering

----- Original Message -----

Subject: 17-160 - KWRU WWTP Filter Replacement - Progress Meeting #1
From: "James Contino" <jcontino@whartonsmith.com>
Date: 2/20/18 9:48 am
To: "chris@kwru.com" <chris@kwru.com>, "Greg Wright" <greg@kwru.com>, "Ed Castle, P.E. (edrcastle@me.com)" <edrcastle@me.com>, "ssuggs@weilerengineering.org" <ssuggs@weilerengineering.org>, "lgermaine@weilerengineering.org" <lgermaine@weilerengineering.org>, "John Sinn" <jsinn@weilerengineering.org>, "Gregory Williams" <gwilliams@whartonsmith.com>, "Edgar Gonzalez" <egonzalez@whartonsmith.com>, "Jean Laine" <jlaine@whartonsmith.com>
Cc: "Erica Marnati" <emarnati@whartonsmith.com>, "Angela Kushner" <akushner@whartonsmith.com>

To all,

Attached please the Progress Meeting #1 Agenda for tomorrow's conference call meeting.

KWRU 017636

The conference call information is as follows:

Date and time of conference call: Wednesday, 02/21/18 at 11:00AM

Conference Phone Number: 1-872-240-3412

Access Code: 250-559-805 #

Select # when prompted for Audio PIN

You are connected when you hear the beep

You will hear a beep when each participant is connected

Sincerely,

James M. Contino | Project Manager

Wharton-Smith, Inc. | Construction Group of Choice | www.whartonsmith.com

125 W. Indiantown Road, Suite 201, Jupiter, FL 33458

Office: (561) 748-5956 Ext. 2321 | Cell: (561) 354-8786 | Fax: (561) 748-5958

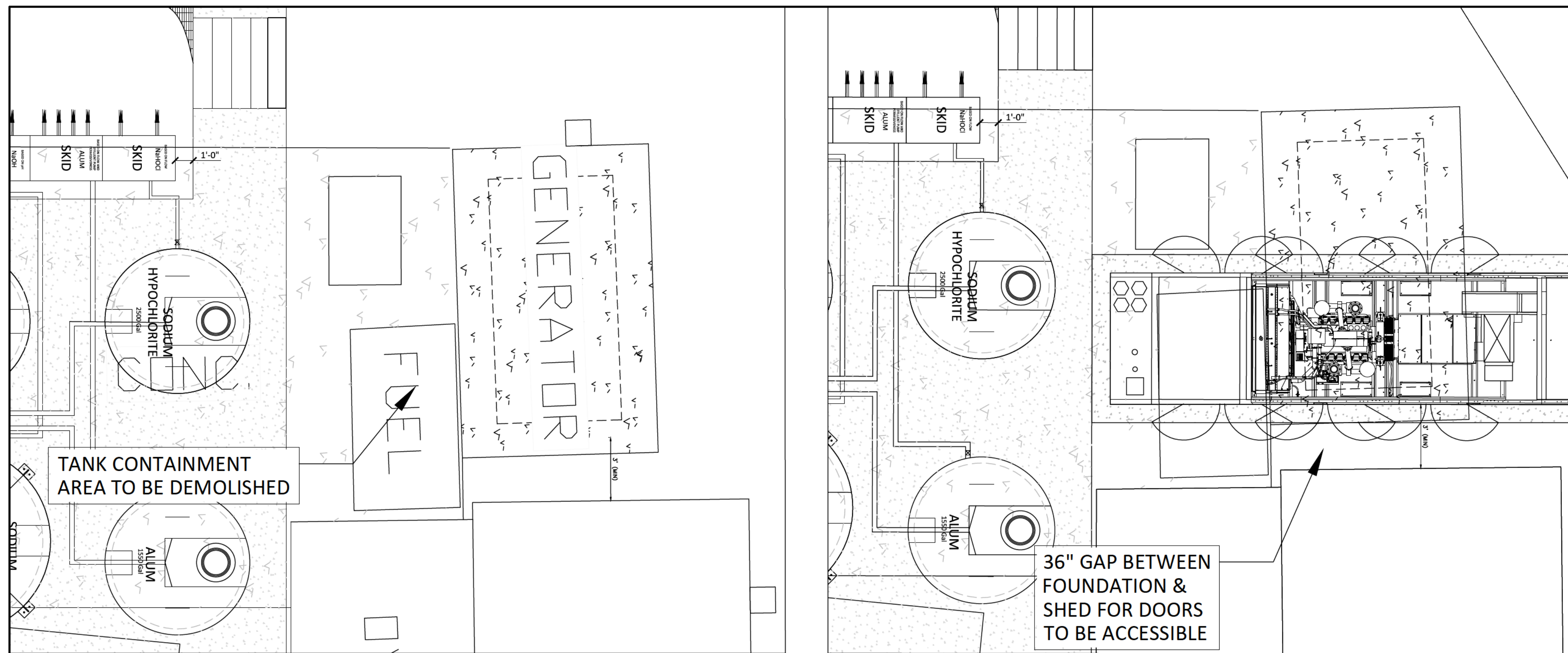

EXISTING CONDITIONS

PROPOSED CONDITIONS

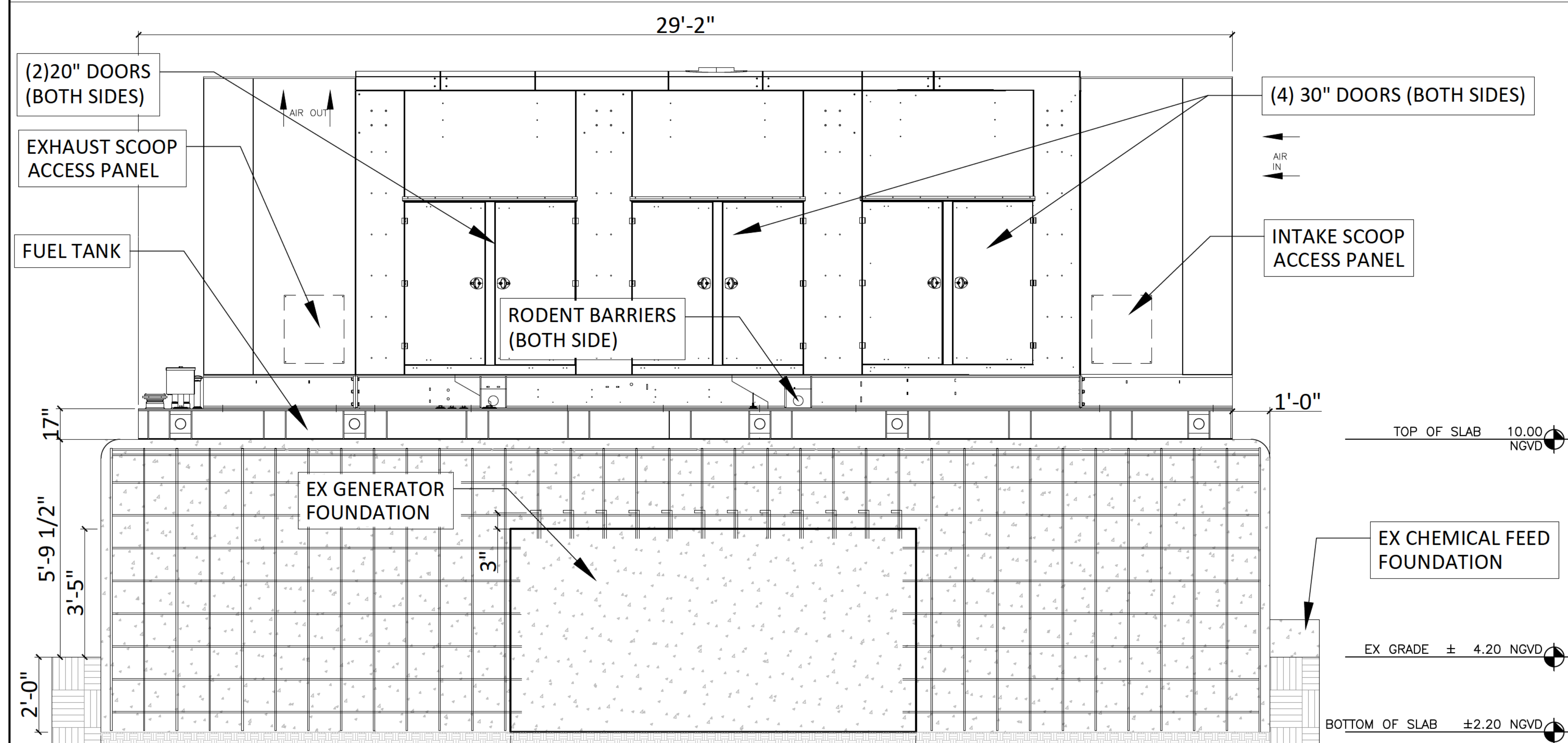

PROPOSED GENERATOR FOUNDATION DETAILS

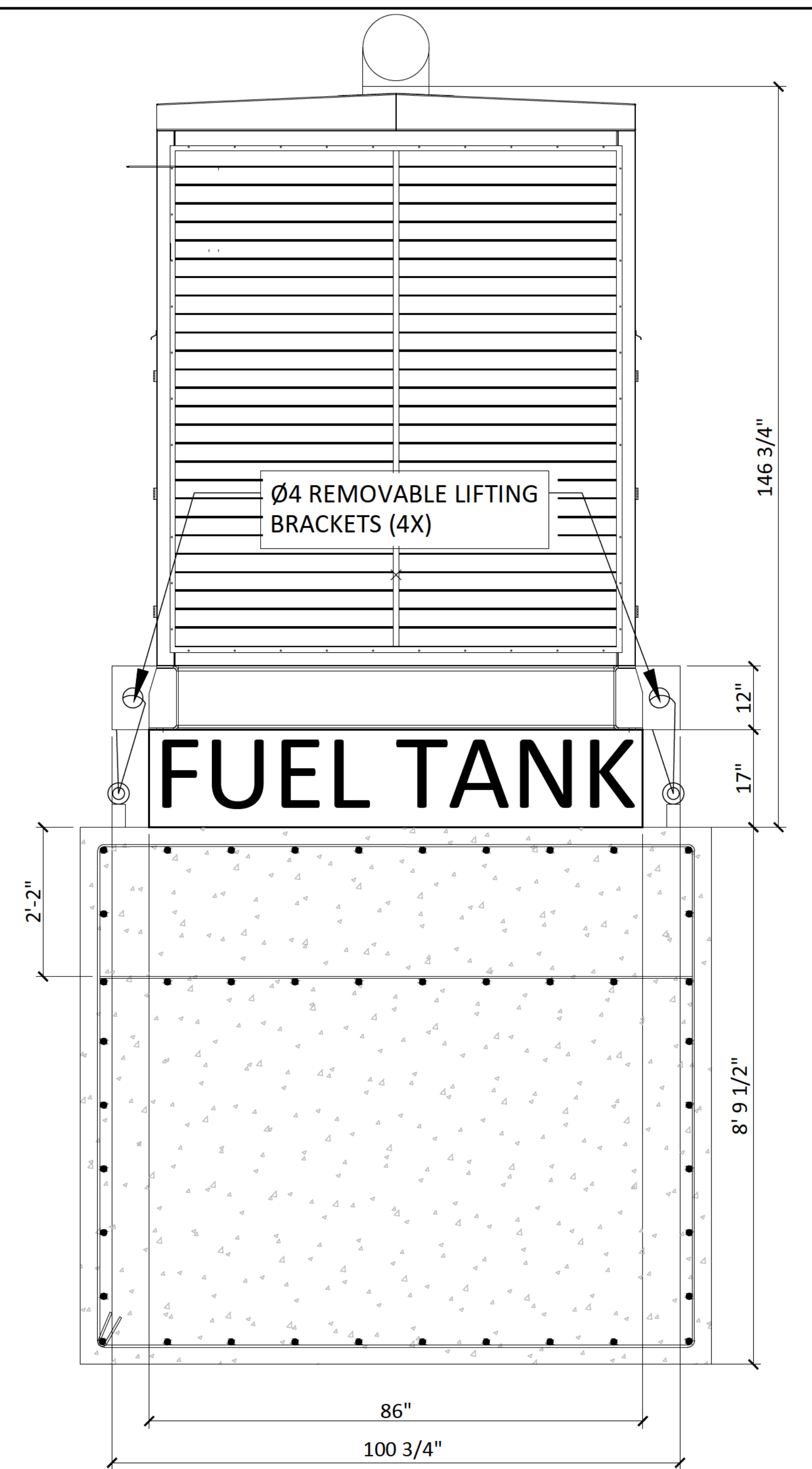

Design:	SJS
Drawn:	JC-S
Checked:	ERC
Approved By:	ERC
Scale:	AS SHOWN
Job No:	16013.001
Date Issued:	AS STAMPED

WEC THE WELLER ENGINEERING CORPORATION
 6805 OVERSEAS HWY
 MARATHON, FLORIDA 33050
 (305) 289-4161 PH, (305) 289-4162 FAX
 EB #6555

GENERATOR DETAILS FOR KWRU WWTP EXPANSION

Revisions	Description

THIS SHEET IS NOT VALID WITHOUT THE SIGNATURE AND ORIGINAL INKED SEAL OF A LICENSED PROFESSIONAL ENGINEER.

Edward R. Castle
 Professional Engineer
 State of Florida
 Registration No. 58574

Sheet No. D-05

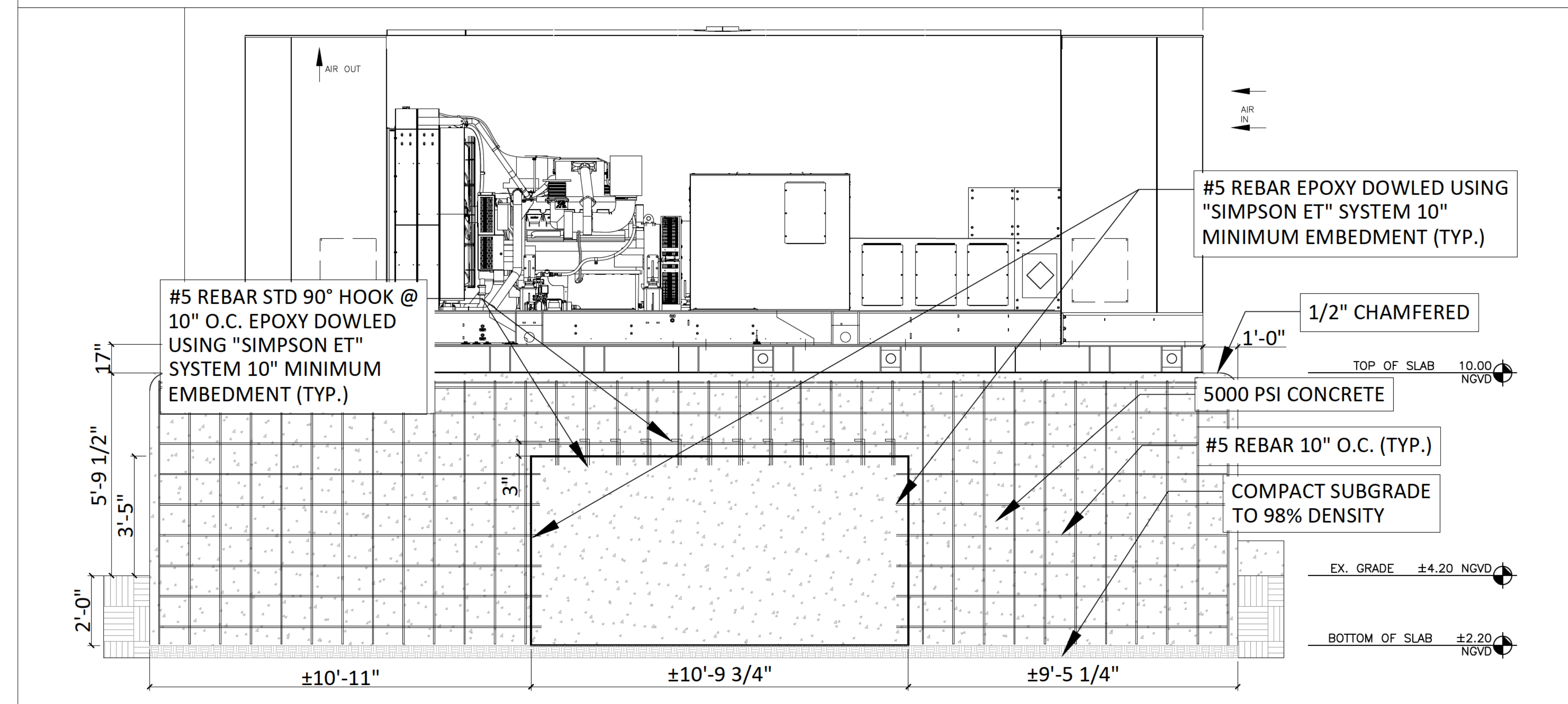
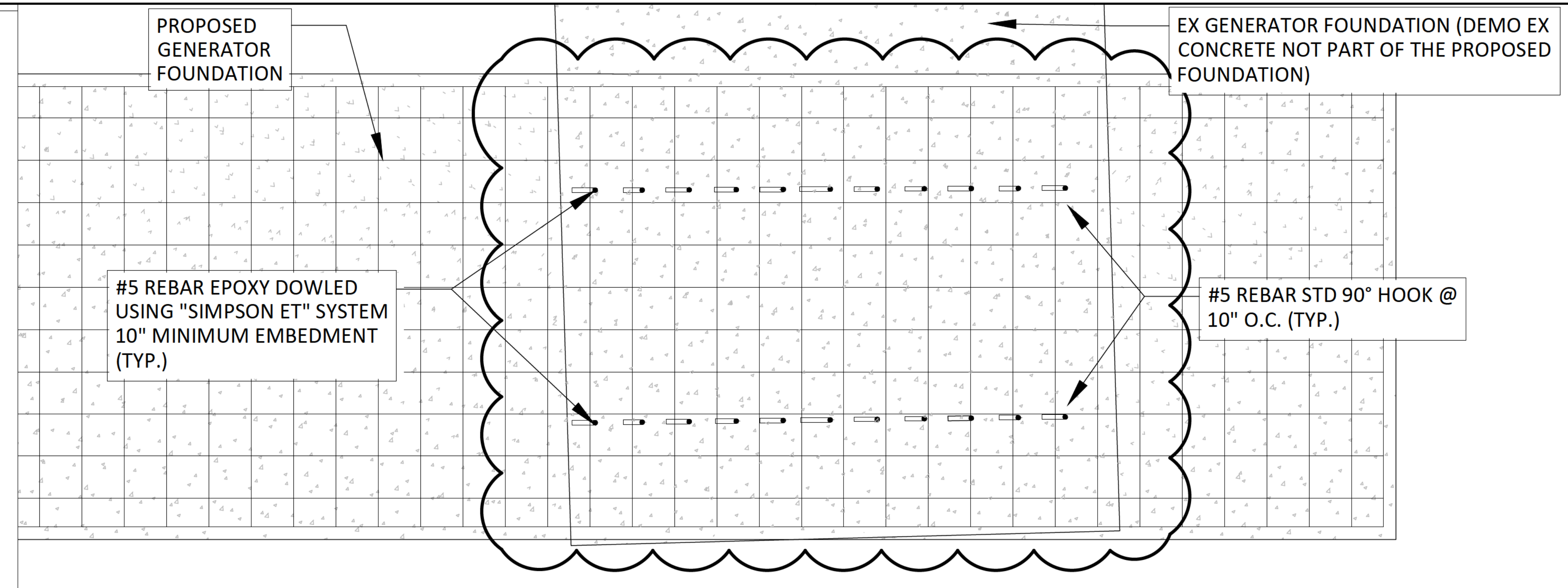
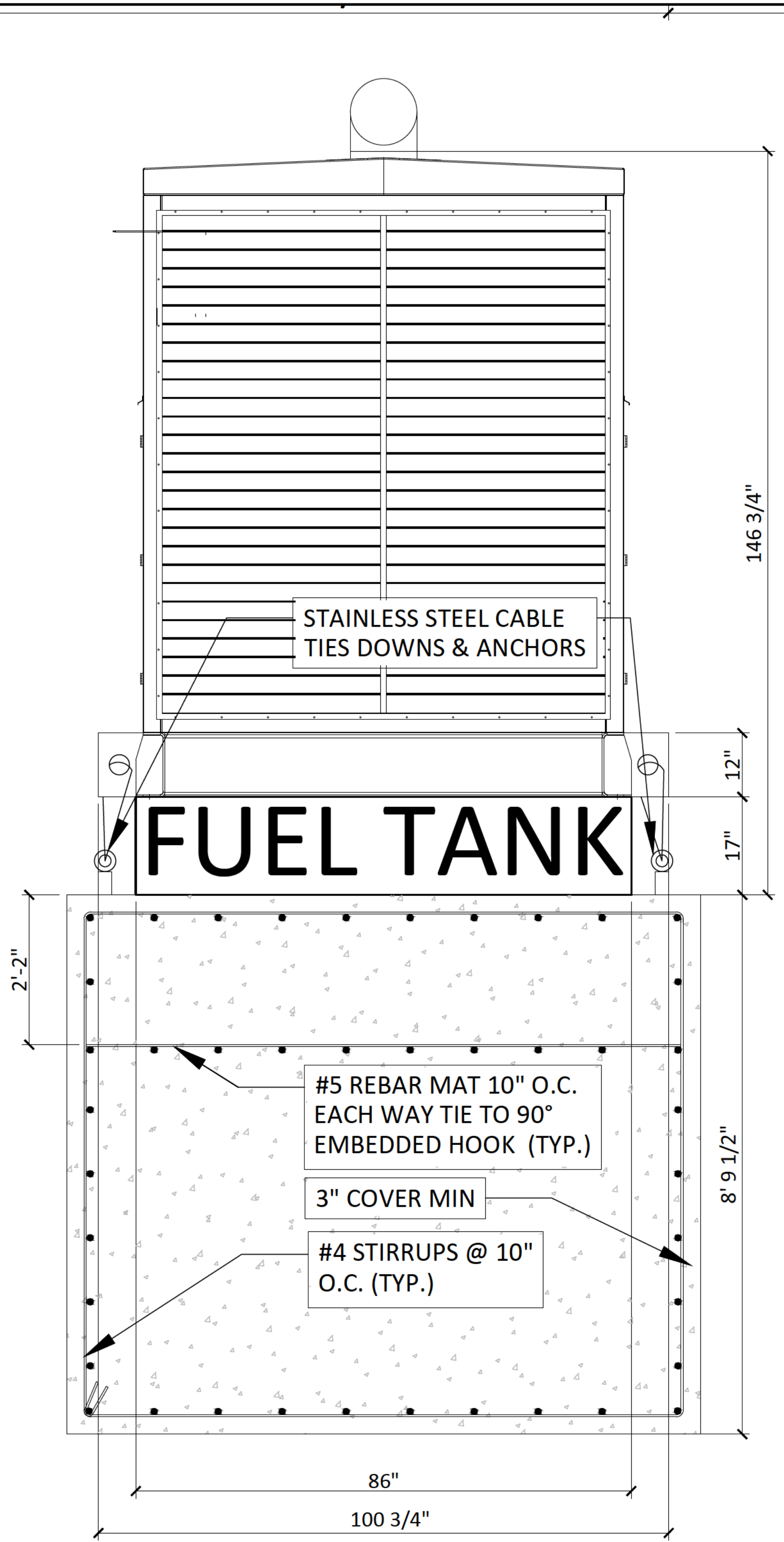

GENERATOR FOUNDATION DETAILS

Design:	SJS
Drawn:	CWK/SJS/JCS
Checked:	ERC
Approved By:	ERC
Scale:	AS SHOWN
Job No.:	16013.001
Date Issued:	AS STAMPED

THE WELER ENGINEERING CORPORATION
 6805 OVERSEAS HWY
 MARATHON, FLORIDA 33050
 (305) 289-4161 PH, (305) 289-4162 FAX
 EB #6555

GENERATOR DETAILS FOR KWRU WWTP EXPANSION

Revisions	Description

This sheet is not valid without the signature and official seal of a Florida Licensed Engineer.

Edward R. Castle
 Professional Engineer
 State of Florida
 Registration No. 58574

Sheet No. D-06