



Dianne M. Triplett  
Deputy General Counsel  
Duke Energy Florida, LLC.

April 5, 2019

**VIA ELECTRONIC FILING**

Adam Teitzman, Commission Clerk  
Florida Public Service Commission  
2540 Shumard Oak Boulevard  
Tallahassee, Florida 32399-0850

Re: *Duke Energy Florida, LLC's Petition for a limited proceeding to approve second solar base rate adjustment; Docket No. 20190072-EI*

Dear Mr. Teitzman:

On March 25, 2019, Duke Energy Florida, LLC ("DEF") electronically filed its Petition for a limited proceeding to approve second solar base rate adjustment, document number 03330-2019. Exhibit No. \_\_\_\_ (MGS-1) to the direct testimony of Matthew G. Stout was not legible. Please replace the previously provided Exhibit No. \_\_\_\_ (MGS-1) with the attached.

Thank you for your assistance in this matter. If you have any questions please feel free to contact me at (727) 820-5041.

Sincerely,

*s/Dianne M. Triplett*

DIANNE M. TRIPLETT

DMT/mw  
Enclosures

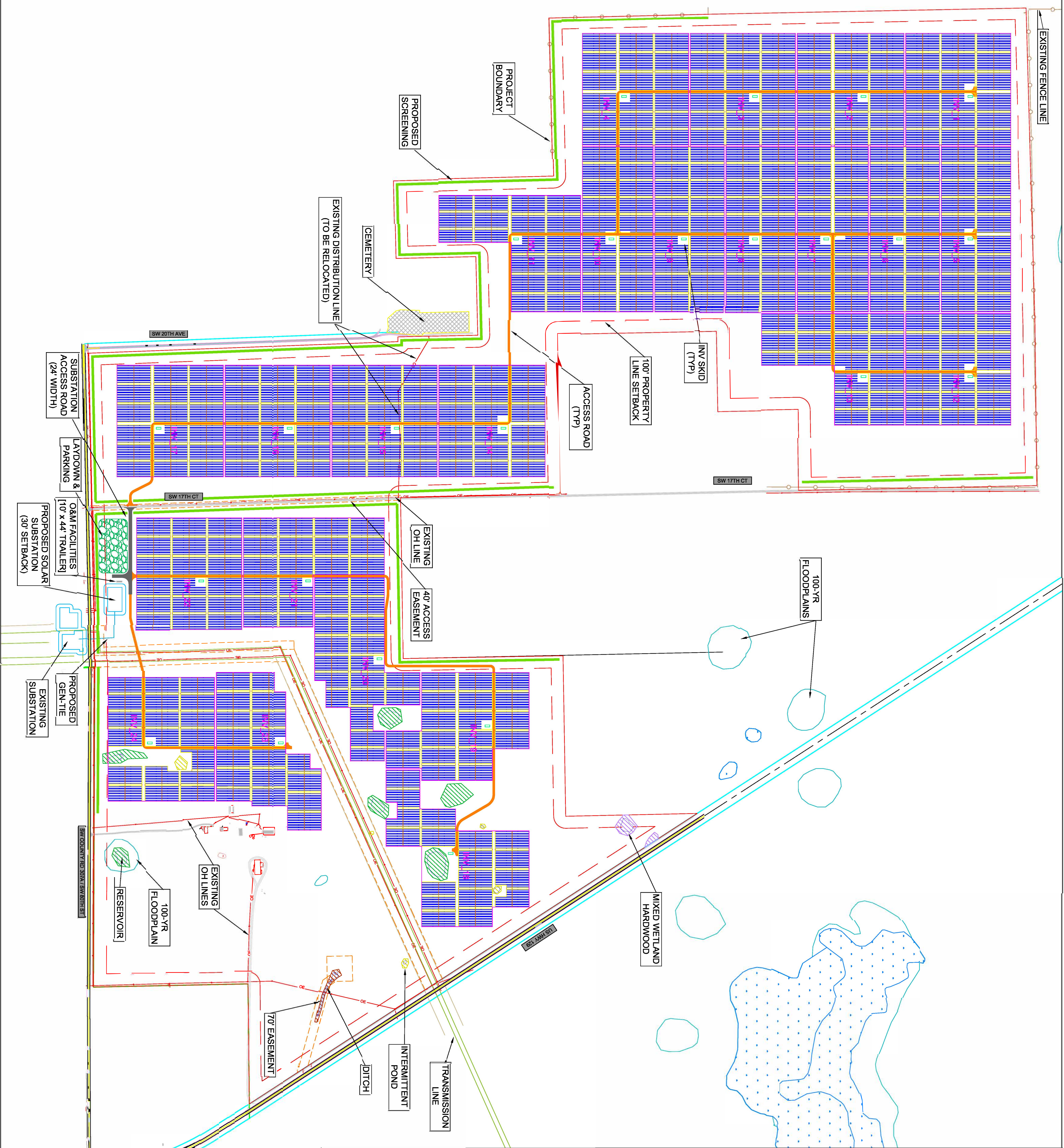

SYSTEM DESCRIPTION			
QUANTITY	DESCRIPTION	UNIT	PERCENT
57,232	JAN7501-380/PR	WP	21.0%
215,908	JAN7501-385/PR	WP	79.0%
273,140	TOTAL MODULES		100.0%
28	PARTIAL TRACKER ROW		
2	FULL TRACKER ROW		
3	MODULES PER TRACKER		
56	MODULES PER TRACKER		
84	MODULES PER TRACKER		
24	INVERTER POWER RATING		
3.36	INVERTER POWER RATING		
24	INVERTER BLOCKS		
3.36 MW (3.36 MVA) SKID	INVERTER BLOCKS		
24	TRANSFORMER		
ATT (1/52 DEG)	TRANSFORMER		
163	TRACKER ROWS		
3143	SMALL ROWS		
332.7K	FULL ROWS		
20.25	FEET		
32.7K	MMWD (FT)		
304.87	MMWD (FT)		
80.64	MMWD (FT)		
74.9	MMWD (FT)		
1.40	AT POI		
	DC/AC RATIO		

**LEGEND:**

- SITE BOUNDARY
- GEN-TIE LINE
- WETLANDS
- 100-YR FLOODPLAIN
- PV CONDITIONING EQUIPMENT PAD
- TRACKER ROWS (66 OR 84 MODULES TALL)
- INTERNAL ROADS (20' WIDTH)
- SUBSTATION ACCESS ROAD (24' WIDTH)
- TRANSMISSION LINE
- EXISTING OH LINE
- EXISTING FENCE LINE
- SUBSTATION

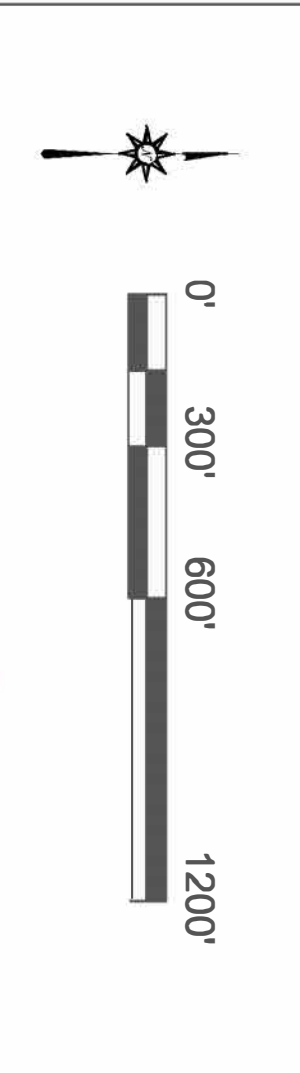

**PRELIMINARY - NOT FOR CONSTRUCTION**

ENGINEER'S SIGNATURE

REV	DATE	DESCRIPTION	DRW	CHK
A	10/29/18	RFP RESPONSE	BJR	
B	12/05/18	POND UPDATE	BJR	
C	01/14/19	JA SOL AR 380W / 385W	BJR	
D	01/17/19	100' SETBACK	BJR	

DATE: 10/15/2018  
 SCALE: NTS  
 DRAWN BY: BJR  
 CHECKED BY: BJR  
 APPROVED BY: BJR  
 REV. NO.  
 PROJECT #:

PROJECT LOCATION:  
**TRENTON**  
 29.630, -82.838

**SITE PLAN**

SHEET  
**G.200**



© Copyright M.A. Mortenson Company 2013. Mortenson Proprietary & Confidential