

State of Florida



# Public Service Commission

CAPITAL CIRCLE OFFICE CENTER • 2540 SHUMARD OAK BOULEVARD  
TALLAHASSEE, FLORIDA 32399-0850

**-M-E-M-O-R-A-N-D-U-M-**

---

**DATE:** June 10, 2024

**TO:** Adam J. Teitzman, Commission Clerk, Office of Commission Clerk

**FROM:** Ailynee Ramirez-Abundez, Public Utility Analyst I, Division of Engineering *ARA LK*

**RE:** Docket No. 20240095-WS - Resolution of the Board of County Commissioners of Citrus County declaring Citrus County subject of the provisions of Sections 367, F.S.

---

Please file the attached emails regarding "Citrus County Resolution Further Action" in the docket file mentioned above.

ARA/da

Attachment

CC: Office of Commission Clerk (Docket No. 20240095-WS)

**From:** [Cecilia B. Boehm](#)  
**To:** [Ailynee Ramirez-Abundez](#)  
**Cc:** [Marissa Ramos](#); [Steve L. Howard](#); [Mariselle Rodriguez](#); [Denise A. Dymond Lyn](#); [Sally L. Parker](#); [Elaine C. Thomas](#)  
**Subject:** RE: [EXTERNAL]Citrus County Resolution Further Action  
**Date:** Friday, June 7, 2024 2:26:57 PM  
**Attachments:** [image002.png](#)  
[image004.png](#)

---

CAUTION: This email originated from outside your organization. Exercise caution when opening attachments or clicking links, especially from unknown senders.

Good afternoon,

Please see the attached operational area map as requested.

I'm using Adobe Acrobat.

1. [Operational Area Map \(individual utilities\).pdf](#)
2. [Privately Owned Water and Wastewater Operational Area Map.pdf](#)

Respectfully yours,

*Cecilia Boehm*

Executive Assistant II

Citrus County Office of Utility Regulation (Administration)

3600 W. Sovereign Path, Suite 264, Lecanto, FL 34461

Main: 352-527-5210 | Direct: 352.527.5442 | E: [Cecilia.Boehm@citrusbocc.com](mailto:Cecilia.Boehm@citrusbocc.com)

*"Please Note: Florida has a very broad Public Records Law. Most written communications to or from State and Local Officials regarding State or Local business are public records available to the public and media upon request. Your email communications may therefore be subject to public disclosure."*

---

**From:** Denise A. Dymond Lyn <Denise.Lyn@citrusbocc.com>

**Sent:** Thursday, June 6, 2024 11:27 AM

**To:** Ailynee Ramirez-Abundez <ARamirez@psc.state.fl.us>; Cecilia B. Boehm <Cecilia.Boehm@citrusbocc.com>

**Cc:** Marissa Ramos <mramos@psc.state.fl.us>; Steve L. Howard <Steve.Howard@citrusbocc.com>; Mariselle Rodriguez <Mariselle.Rodriguez@citrusbocc.com>; Sally L. Parker <Sally.Parker@citrusbocc.com>; Elaine C. Thomas <Elaine.Thomas@citrusbocc.com>

**Subject:** RE: [EXTERNAL]Citrus County Resolution Further Action

Good Afternoon:

We will put that together and will get it to you as soon as is possible.

*Denise A. Dymond Lyn*

*City, County and Local Government Law Specialist*  
County Attorney | Citrus County BOCC

phone: (352) 341-6579 | email: [denise.lyn@citrusbocc.com](mailto:denise.lyn@citrusbocc.com)  
110 N. Apopka Avenue | Inverness, FL 34450



---

**From:** Ailynee Ramirez-Abundez <[ARamirez@psc.state.fl.us](mailto:ARamirez@psc.state.fl.us)>  
**Sent:** Thursday, June 6, 2024 10:57 AM  
**To:** Cecilia B. Boehm <[Cecilia.Boehm@citrusbocc.com](mailto:Cecilia.Boehm@citrusbocc.com)>  
**Cc:** Marissa Ramos <[mramos@psc.state.fl.us](mailto:mramos@psc.state.fl.us)>; Denise A. Dymond Lyn <[Denise.Lyn@citrusbocc.com](mailto:Denise.Lyn@citrusbocc.com)>; Steve L. Howard <[Steve.Howard@citrusbocc.com](mailto:Steve.Howard@citrusbocc.com)>; Mariselle Rodriguez <[Mariselle.Rodriguez@citrusbocc.com](mailto:Mariselle.Rodriguez@citrusbocc.com)>; Sally L. Parker <[Sally.Parker@citrusbocc.com](mailto:Sally.Parker@citrusbocc.com)>; Elaine C. Thomas <[Elaine.Thomas@citrusbocc.com](mailto:Elaine.Thomas@citrusbocc.com)>  
**Subject:** RE: [EXTERNAL]Citrus County Resolution Further Action

Good morning,

Thank you again for sending this information over.

Do you happen to have any reference sheets that indicate the general area or territory that each utility serves?

Best regards,

Ailynee Ramirez-Abundez  
Public Utility Analyst  
Division of Engineering  
Florida Public Service Commission  
[ARamirez@psc.state.fl.us](mailto:ARamirez@psc.state.fl.us)  
(850) 413-6974

---

**From:** Cecilia B. Boehm <[Cecilia.Boehm@citrusbocc.com](mailto:Cecilia.Boehm@citrusbocc.com)>  
**Sent:** Wednesday, June 5, 2024 4:33 PM  
**To:** Ailynee Ramirez-Abundez <[ARamirez@psc.state.fl.us](mailto:ARamirez@psc.state.fl.us)>  
**Cc:** Marissa Ramos <[mramos@psc.state.fl.us](mailto:mramos@psc.state.fl.us)>; Denise A. Dymond Lyn <[Denise.Lyn@citrusbocc.com](mailto:Denise.Lyn@citrusbocc.com)>; Steve L. Howard <[Steve.Howard@citrusbocc.com](mailto:Steve.Howard@citrusbocc.com)>; Mariselle Rodriguez <[Mariselle.Rodriguez@citrusbocc.com](mailto:Mariselle.Rodriguez@citrusbocc.com)>; Sally L. Parker <[Sally.Parker@citrusbocc.com](mailto:Sally.Parker@citrusbocc.com)>; Elaine C. Thomas <[Elaine.Thomas@citrusbocc.com](mailto:Elaine.Thomas@citrusbocc.com)>  
**Subject:** RE: [EXTERNAL]Citrus County Resolution Further Action

CAUTION: This email originated from outside your organization. Exercise caution when opening attachments or clicking links, especially from unknown senders.

Good afternoon,

Here is the requested information.

I'm using Adobe Acrobat.

[Utilities Contact List and Current Rates.pdf](#)

Respectfully yours,

*Cecilia Boehm*

Executive Assistant II

Citrus County Office of Utility Regulation (Administration)

3600 W. Sovereign Path, Suite 264, Lecanto, FL 34461

Main: 352-527-5210 | Direct: 352.527.5442 | E: [Cecilia.Boehm@citrusbocc.com](mailto:Cecilia.Boehm@citrusbocc.com)

"Please Note: Florida has a very broad Public Records Law. Most written communications to or from State and Local Officials regarding State or Local business are public records available to the public and media upon request. Your email communications may therefore be subject to public disclosure."

---

**From:** Ailynee Ramirez-Abundez <[ARamirez@psc.state.fl.us](mailto:ARamirez@psc.state.fl.us)>

**Sent:** Wednesday, June 5, 2024 3:23 PM

**To:** Denise A. Dymond Lyn <[Denise.Lyn@citrusbocc.com](mailto:Denise.Lyn@citrusbocc.com)>

**Cc:** Cecilia B. Boehm <[Cecilia.Boehm@citrusbocc.com](mailto:Cecilia.Boehm@citrusbocc.com)>; Marissa Ramos <[mramos@psc.state.fl.us](mailto:mramos@psc.state.fl.us)>

**Subject:** [EXTERNAL]Citrus County Resolution Further Action

**WARNING:** This email originated from an external Domain **DO NOT CLICK** unless you recognize the sender and know the content is safe.

Good afternoon Ms. Dymond Lyn,

We appreciate Citrus County providing staff with their resolution pursuant to Florida Statue 367.171. To assist staff with our certification process can Citrus County provide a list of the privately owned utilities regulated by Citrus County along with the contact information of the utility owners and the utility's rates?

Please let me know if you have any questions.

Thank you,

Ailynee Ramirez-Abundez  
Public Utility Analyst  
Division of Engineering

Florida Public Service Commission  
[ARamirez@psc.state.fl.us](mailto:ARamirez@psc.state.fl.us)  
(850) 413-6974

**CITRUS COUNTY  
OFFICE OF UTILITY REGULATION**

<b><u>BUSINESS NAME</u></b>	<b><u>ADDRESS</u></b>	<b><u>POC</u></b>	<b><u>PHONE #</u></b>	<b><u>EMAIL</u></b>
Central States Water Resource (CSWR)	P.O. Box 674538 Dallas, TX 75267-4538	Aaron Silas	Phone: 314-380-8510 314-323-3174 (mobile)	<a href="mailto:asilas@cswrgroup.com">asilas@cswrgroup.com</a>
Cinnamon Ridge Utilities	6909 Beach Blvd. Hudson, Florida 34667-1995	Paula Paxton Jennifer Smith	Phone: 727-863-2560 Emergency: 352-628-6608 Fax: 727-863-36370	<a href="mailto:jensmith6909@aol.com">jensmith6909@aol.com</a>
Citrus Waterworks	4939 Cross Bayou Boulevard New Port Richey, Florida 34652	Troy Rendell	Phone: 727-848-8292 314-323-3174 (mobile) Fax: 727-848-7701	<a href="mailto:trendell@uswatercorp.net">trendell@uswatercorp.net</a>
Dunnellon Hills Water System	P.O. Box 4 Inglis, Florida 34449-0004	Marshal Hash	Phone: 352-613-0103	<a href="mailto:marshall@hash.com">marshall@hash.com</a>
Forest Hills Water System	P.O. Box 4 Inglis, Florida 34449-0004	Marshal Hash	Phone: 352-613-0103	<a href="mailto:marshall@hash.com">marshall@hash.com</a>
Haggerty Point Water System	P.O. Box 4 Inglis, Florida 34449-0004	Marshal Hash	Phone: 352-613-0103	<a href="mailto:marshall@hash.com">marshall@hash.com</a>
Indian Springs Utilities	P.O. Box 518 Crystal River, Florida 34423	Jeff Schrade	Phone: 352-795-5205 Emergency: 352-634-0726	<a href="mailto:jschrade1@tampabay.rr.com">jschrade1@tampabay.rr.com</a>
La Prima Water System	P.O. Box 4 Inglis, Florida 34449-0004	Marshal Hash	Phone: 352-613-0103	<a href="mailto:marshall@hash.com">marshall@hash.com</a>
Lucky Hills Water System	P.O. Box 4 Inglis, Florida 34449-0004	Marshal Hash	Phone: 352-613-0103	<a href="mailto:marshall@hash.com">marshall@hash.com</a>
Meadow Wood Water System	P.O. Box 4 Inglis, Florida 34449-0004	Marshal Hash	Phone: 352-613-0103	<a href="mailto:marshall@hash.com">marshall@hash.com</a>
Pinewood Water System	P.O. Box 4 Inglis, Florida 34449-0004	Marshal Hash	Phone: 352-613-0103	<a href="mailto:marshall@hash.com">marshall@hash.com</a>
Springhorn Water System	P.O. Box 4 Inglis, Florida 34449-0004	Marshal Hash	Phone: 352-613-0103	<a href="mailto:marshall@hash.com">marshall@hash.com</a>
Tarawood Utilities, LLC	P.O. Box 1018 Floral City, Florida 34436-1018	John Thrumston	Phone: 352-302-5330 Phone: 407.970.7705	<a href="mailto:tarawoodutilities@gmail.com">tarawoodutilities@gmail.com</a>

## CURRENT RATES

<u>BUSINESS NAME</u>	<u>CURRENT RATES</u>
Central States Water Resource (CSWR)	Rate Meter Size 5/8"x3/4" <b>Water</b> - \$ 0.73 per 1,000 gallons <b>Wastewater</b> - \$ 3.49 per 1,000 gallons
Cinnamon Ridge Utilities	Rate Meter Size 5/8"x3/4" <b>Water</b> 0 to 5,000 gallons - \$2.24 5,001 to 10,000 gallons - \$2.35 10,001 to 15,000 gallons - \$2.44 Over 15,000 gallons - 2.54
Citrus Waterworks	Rate Meter Size 5/8"x3/4" <b>Water</b> - \$ 2.95 per 1,000 gallons
Dunnellon Hills Water System	Rate Meter Size 5/8"x3/4" <b>Water</b> - \$ 4.89 per 1,000 gallons
Forest Hills Water System	Rate Meter Size 5/8"x3/4" <b>Water</b> - \$ 4.94 per 1,000 gallons
Haggerty Point Water System	Rate Meter Size 5/8"x3/4" <b>Water</b> 5/8" x 3/4" - \$ 41.80 Full 3/4" - \$ 62.70 1" - \$ 104.50 1 1/2" - \$209.00 2" - \$ 334.40
Indian Springs Utilities	Rate Meter Size 5/8"x3/4" <b>Water</b> - \$ 4.49 per 1,000 gallons
La Prima Water System	Rate Meter Size 5/8"x3/4" <b>Water</b> - \$ 48.37 Flat Rate
Lucky Hills Water System	Rate Meter Size 5/8"x3/4" <b>Water</b> - \$ 4.28 per 1,000 gallons
Meadow Wood Water System	Rate Meter Size 5/8"x3/4" <b>Water</b> - \$ 35.76 Flat Rate
Pinewood Water System	Rate Meter Size 5/8"x3/4" <b>Water</b> - \$ 41.66 Flat Rate
Springhorn Water System	Rate Meter Size 5/8"x3/4" <b>Water</b> - \$ 43.76 Flat Rate
Tarawood Utilities, LLC	Rate Meter Size 5/8"x3/4" <b>Water</b> - \$ 7.61 per 1,000 gallons <b>Wastewater</b> - \$ 11.94 per 1,000 gallons

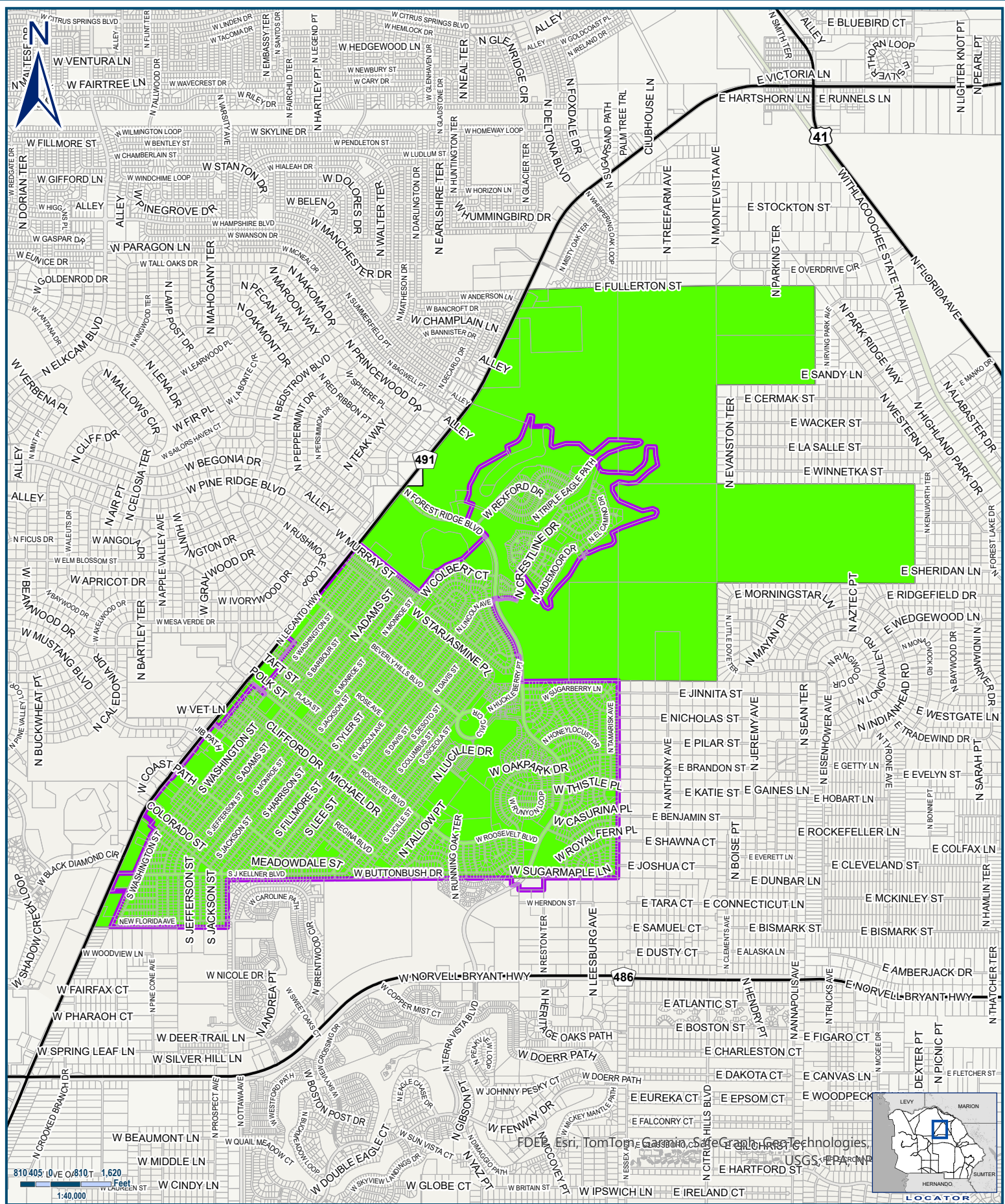

**Legend**

- Sanitary Sewer Private Operational Area
- Corporate Boundary
- Water Private Operational Area

Selected Private Owned Wastewater and Water Operational Area Map

**CENTRAL STATES WATER RESOURCES - BEVERLY HILLS**

**Geographic Information Systems**

Prepared By : Susan O'Connell  
 Date: June 7, 2024  
 Source: Enterprise Geodatabase  
 Map Number: S0001526MapSeriesP

Cynthia P. Sheahan  
 Director





This information is for general information only. The Florida Geographic Information System (FGIS) data is provided as a public service and is not intended to be used for legal purposes. The Florida Department of Transportation (FDOT) is not responsible for any errors or omissions in this information. The Florida Department of Transportation (FDOT) is not responsible for any errors or omissions in this information. The Florida Department of Transportation (FDOT) is not responsible for any errors or omissions in this information.

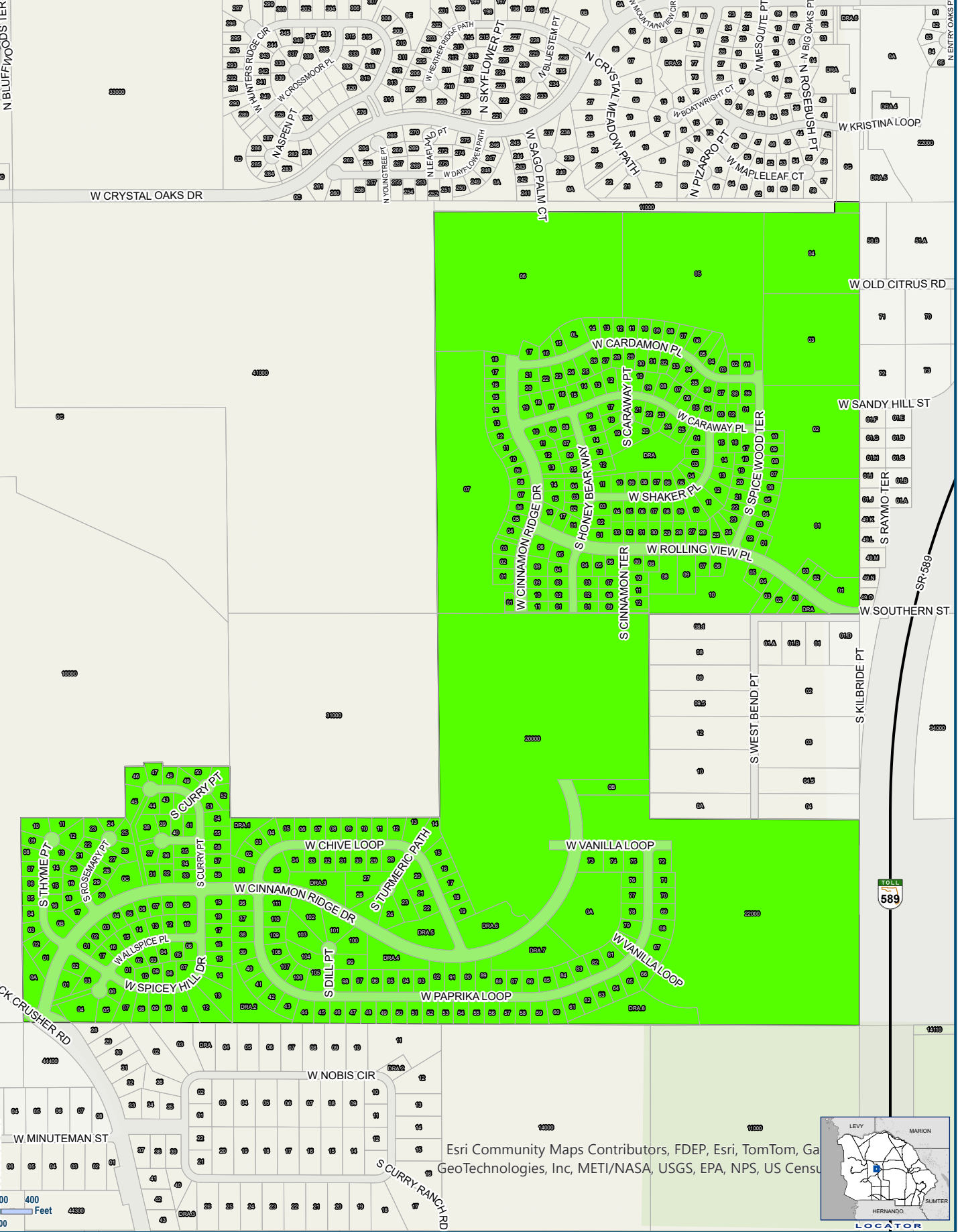



**Legend**

-  Sanitary Sewer Private Operational Area
-  Corporate Boundary
-  Water Private Operational Area

Selected Private Owned Wastewater and Water Operational Area Map

**CINNAMON RIDGE UTILITIES WATER**

**Geographic Information Systems**

Prepared By : Susan O'Connell  
Date: June 7, 2024  
Source: Enterprise Geodatabase  
Map Number: S0001526MapSeriesP



This information is for general information only. The Esri Community Maps Contributors, Esri, TomTom, GeoTechnologies, Inc, METI/NASA, USGS, EPA, NPS, US Census Bureau, and other contributors do not warrant the accuracy, reliability, or completeness of the information. Esri, TomTom, GeoTechnologies, Inc, METI/NASA, USGS, EPA, NPS, US Census Bureau, and other contributors are not responsible for any errors or omissions in this information. Esri, TomTom, GeoTechnologies, Inc, METI/NASA, USGS, EPA, NPS, US Census Bureau, and other contributors are not responsible for any damages, including but not limited to, negligence or consequential damages, arising from the use of this information.

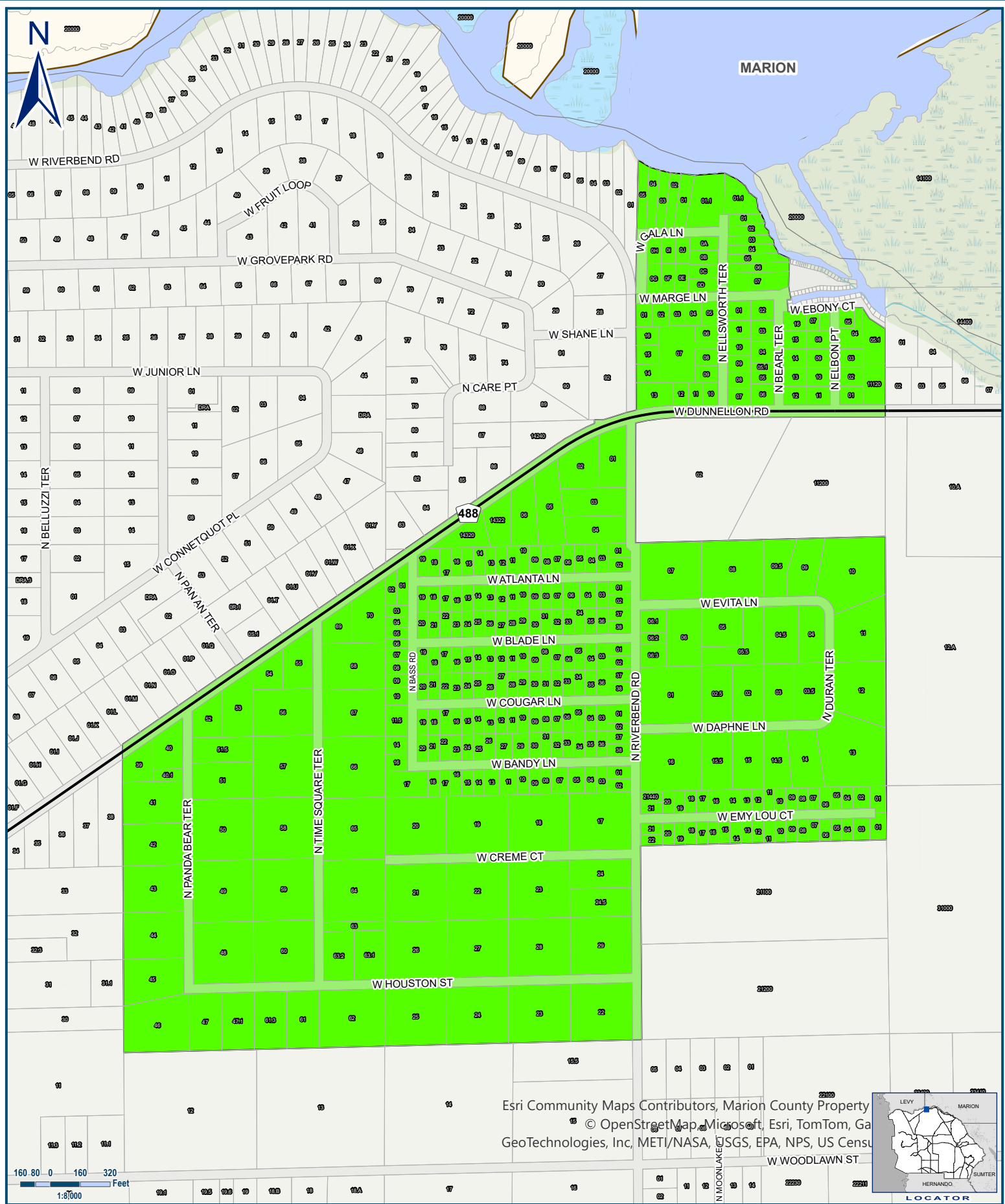

Esri Community Maps Contributors, Marion County Property  
 © OpenStreetMap, Microsoft, Esri, TomTom, Ga  
 GeoTechnologies, Inc, METI/NASA, USGS, EPA, NPS, US Censu



**Legend**

- Sanitary Sewer Private Operational Area
- Corporate Boundary
- Water Private Operational Area

Selected Private Owned  
 Wastewater and Water  
 Operational Area Map

**CITRUS WATERWORKS UTILITIES**

**Geographic Information Systems**

Prepared By : Susan O'Connell  
 Date: June 7, 2024  
 Source: Enterprise Geodatabase  
 Map Number: S0001526MapSeriesP

Cynthia P. Sheahon  
 Director



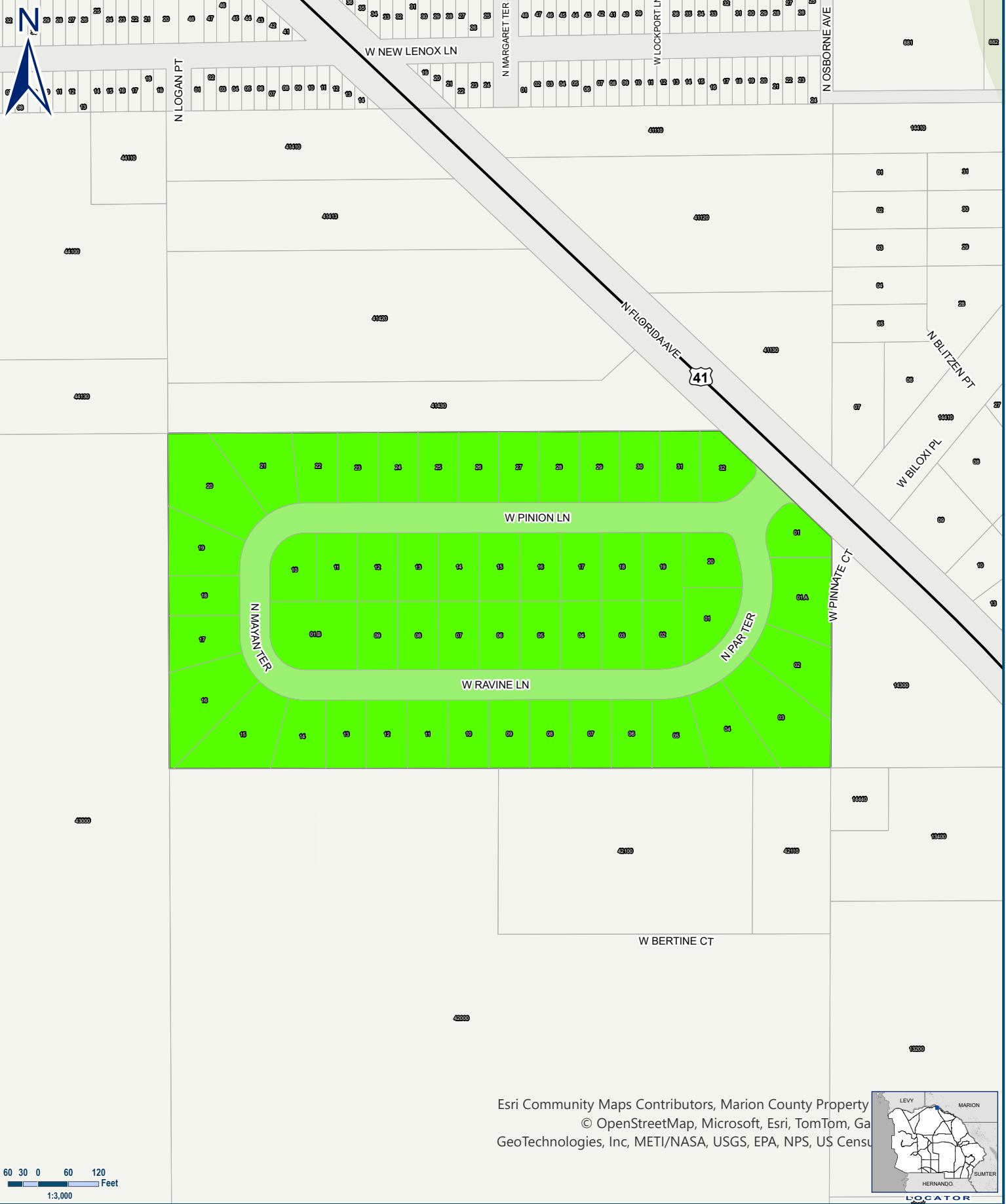

Esri Community Maps Contributors, Marion County Property  
 © OpenStreetMap, Microsoft, Esri, TomTom, Ga  
 GeoTechnologies, Inc, METI/NASA, USGS, EPA, NPS, US Censu



**Legend**

	Sanitary Sewer Private Operational Area		Corporate Boundary
	Water Private Operational Area		

Selected Private Owned  
 Wastewater and Water  
 Operational Area Map

**DUNNELLON HILLS WATER SYSTEM**

**Geographic Information Systems**

Prepared By : Susan O'Connell  
 Date: June 7, 2024  
 Source: Enterprise Geodatabase  
 Map Number: S0001526MapSeriesP

Cynthia P. Sheahon  
 Director



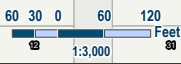

This information is for general information only. The Florida Department of Transportation, Florida Division makes every effort to provide accurate data and information as of the date of release. However, it does not warrant or represent any accuracy or reliability of the information provided. The user assumes all liability for any use of this information, including but not limited to, management or operation of any system. The user shall be held responsible for any errors, omissions, or delays in providing or delivering the data.



Esri Community Maps Contributors, FDEP, © OpenStreetMap, TomTom, Garmin, SafeGraph, GeoTechnologies, Inc, METI/NPS, US Census Bureau



**Legend**

	Sanitary Sewer Private Operational Area		Corporate Boundary
	Water Private Operational Area		

Selected Private Owned Wastewater and Water Operational Area Map

**FOREST HILLS WATER SYSTEM**

**Geographic Information Systems**

Prepared By : Susan O'Connell  
 Date: June 7, 2024  
 Source: Enterprise Geodatabase  
 Map Number: SO001526MapSeriesP

Cynthia P. Sheahon  
 Director



This information is for general information only. The Florida County Geographic Information System (GIS) Division makes every effort to provide accurate data and reports as of the date of creation. However, no warranty is made by the Florida Department of Environmental Protection for the accuracy of the data. The County shall not be liable for any errors, omissions, or delays in any data or information published by the Florida Department of Environmental Protection. The County shall not be liable for any errors, omissions, or delays in any data or information published by the Florida Department of Environmental Protection.

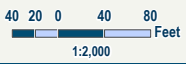

Esri Community Maps Contributors, FDEP, © OpenStreetMap  
TomTom, Garmin, SafeGraph, GeoTechnologies, Inc, Mapbox  
NPS, US Census Bureau



**Legend**

- Sanitary Sewer Private Operational Area
- Corporate Boundary
- Water Private Operational Area

Selected Private Owned  
Wastewater and Water  
Operational Area Map  
**HAGGERTY POINT WATER SYSTEM**

**Geographic Information Systems**

Prepared By : Susan O'Connell  
Date: June 7, 2024  
Source: Enterprise Geodatabase  
Map Number: S0001526MapSeriesP

Cynthia P. Sheahon  
Director



This information is for general information only. The Florida County Geographic Information System (GIS) Division makes every effort to provide accurate and up-to-date information. However, it is not intended to be used as a legal document. The user assumes all responsibility for any use of this information, including but not limited to, planning or construction. The County shall not be liable for any liability, damages, or losses of any kind or consequences of any use of this information, including but not limited to, planning or construction. The County shall not be liable for any liability, damages, or losses of any kind or consequences of any use of this information, including but not limited to, planning or construction.

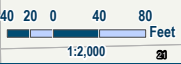

Esri Community Maps Contributors, FDEP, © OpenStreetMap  
TomTom, Garmin, SafeGraph, GeoTechnologies, Inc, METI/N  
NPS, US Census Bureau



**Legend**

- Sanitary Sewer Private Operational Area
- Corporate Boundary
- Water Private Operational Area

Selected Private Owned  
Wastewater and Water  
Operational Area Map  
**LA PRIMA WATER SYSTEM**

**Geographic Information Systems**

Prepared By : Susan O'Connell  
Date: June 7, 2024  
Source: Enterprise Geodatabase  
Map Number: S0001526MapSeriesP

Cynthia P. Sheahon  
Director



This information is to be used for general information only. The Florida County Geographic Information Systems Division makes every effort to provide accurate data and information as of the date of creation. However, no warranty is made by the Division as to the accuracy of the information. The County shall not be liable for any errors, omissions, or delays of any kind in connection with the use of the information, including but not limited to, damages or losses caused by reliance upon the accuracy or timeliness of the information and the liability, arising or resulting from the use of the information.

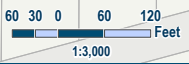
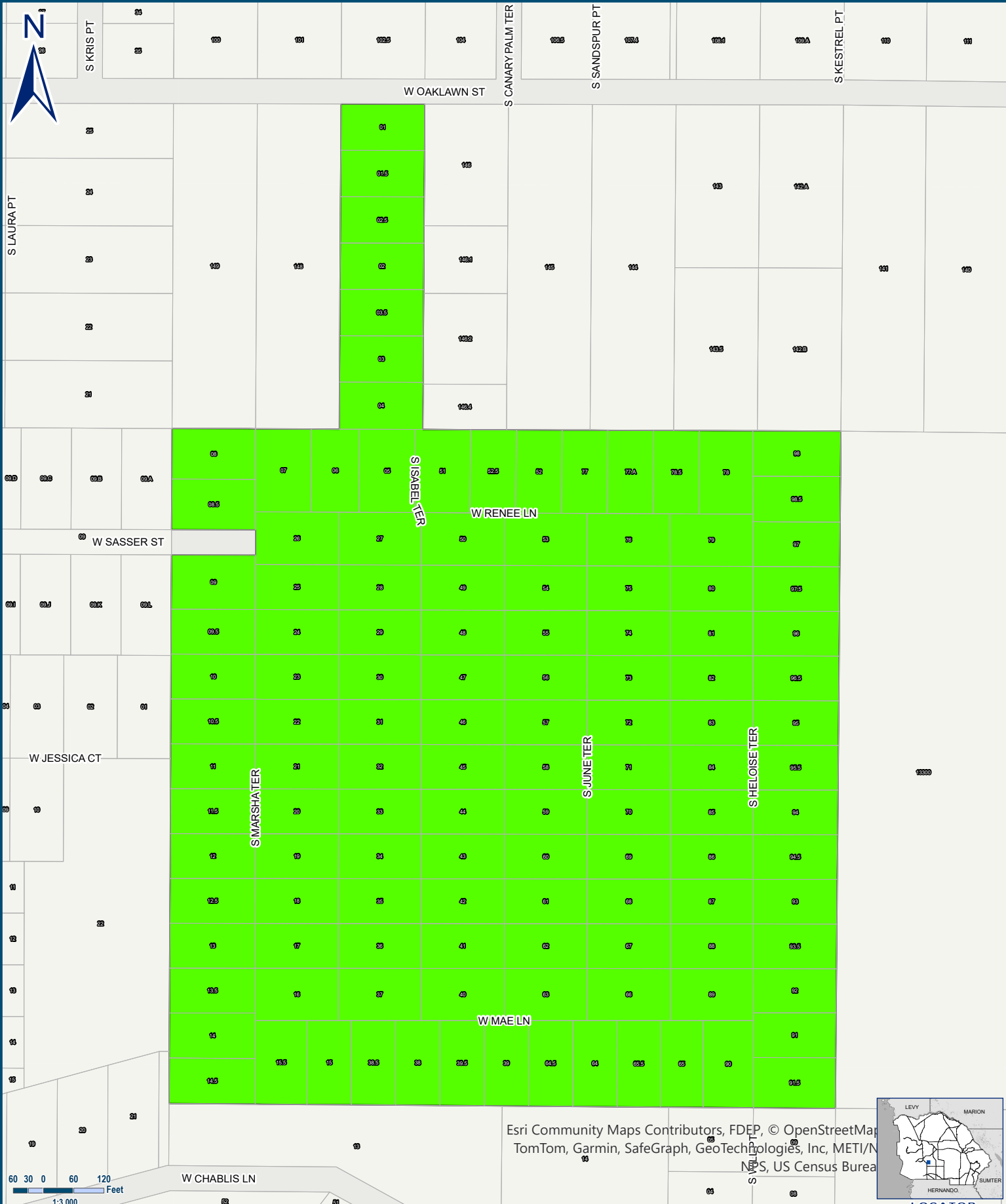

Esri Community Maps Contributors, FDEP, © OpenStreetMap, TomTom, Garmin, SafeGraph, GeoTechnologies, Inc, METI/NPS, US Census Bureau



**Legend**

- Sanitary Sewer Private Operational Area
- Corporate Boundary
- Water Private Operational Area

Selected Private Owned Wastewater and Water Operational Area Map

**LUCKY HILLS WATER SYSTEM**

**Geographic Information Systems**

Prepared By : Susan O'Connell  
 Date: June 7, 2024  
 Source: Enterprise Geodatabase  
 Map Number: S0001526MapSeriesP

Cynthia P. Sheahon  
Director



This information is for general information only. The Florida County Geographic Information System (GIS) Project makes every effort to provide accurate data and information as of the date of the map. However, it is not intended to be used for any purpose other than that for which it was prepared. The County shall not be held liable for any errors, omissions, or inaccuracies in any data or information provided by the user of the System, including but not limited to, management or maintenance of the System. The user shall be responsible for the accuracy and for verifying, updating, or deleting the data entered.



N HEART PT

N DUNKENFIELD AVE

N MARION WAY

N CHERRY TER

W GREENWOOD LN

W CRESTVIEW LN



W COTTAGE LN

W WILLIAM LARDER LN

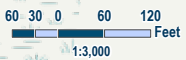
Esri Community Maps Contributors, FDEP, © OpenStreetMap, TomTom, Garmin, SafeGraph, GeoTechnologies, Inc, METI/NPS, US Census Bureau



Legend

-  Sanitary Sewer Private Operational Area
-  Corporate Boundary
-  Water Private Operational Area

Selected Private Owned  
Wastewater and Water  
Operational Area Map

**MEADOW WOOD WATER SYSTEM**

Geographic Information Systems

Prepared By : Susan O'Connell  
Date: June 7, 2024  
Source: Enterprise Geodatabase  
Map Number: S0001526MapSeriesP

Cynthia P. Sheahon  
Director



This information is to be used for general information only. The Citrus County Geographic Information System (GIS) data is provided as a public service and is not intended to be used for legal purposes. Citrus County Florida makes every effort to provide accurate GIS data and information as of the date of the original release of this information. Citrus County Florida makes every effort to provide accurate GIS data and information as of the date of the original release of this information. Citrus County Florida makes every effort to provide accurate GIS data and information as of the date of the original release of this information.





N TURKEY OAK DR

23000

10000

00A

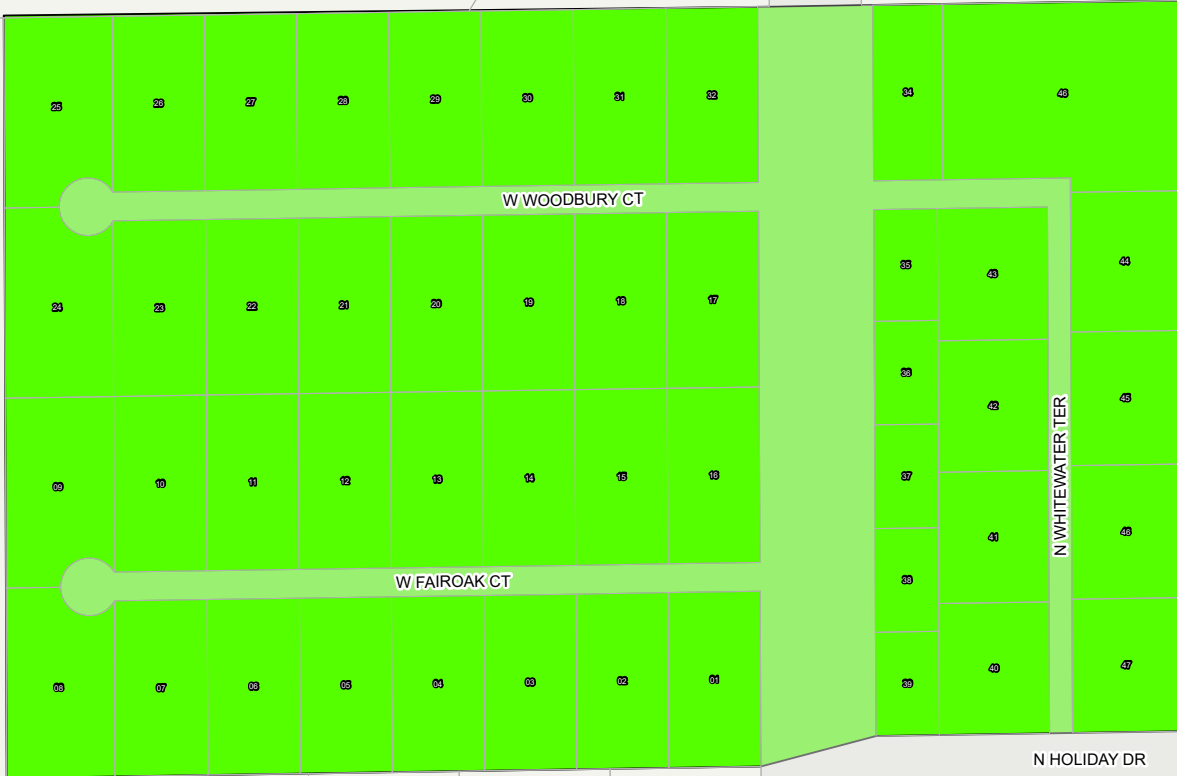

W WOODBURY CT

W FAIROAK CT

N WHITEWATER TER

23000

N HOLIDAY DR



W EDGEHILL CT

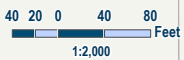
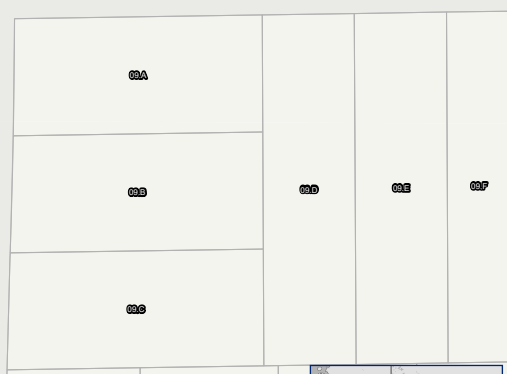



Esri Community Maps Contributors, FDEP, © OpenStreetMap  
 TomTom, Garmin, SafeGraph, GeoTechnologies, Inc, METI/N  
 NPS, US Census Bureau



LOCATOR

Legend

-  Sanitary Sewer Private Operational Area
-  Corporate Boundary
-  Water Private Operational Area

Selected Private Owned  
 Wastewater and Water  
 Operational Area Map  
**PINWOOD WATER SYSTEM**

Geographic Information Systems

Prepared By : Susan O'Connell  
 Date: June 7, 2024  
 Source: Enterprise Geodatabase  
 Map Number: S0001526MapSeriesP

Cynthia P. Sheahon  
 Director



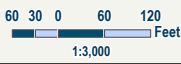
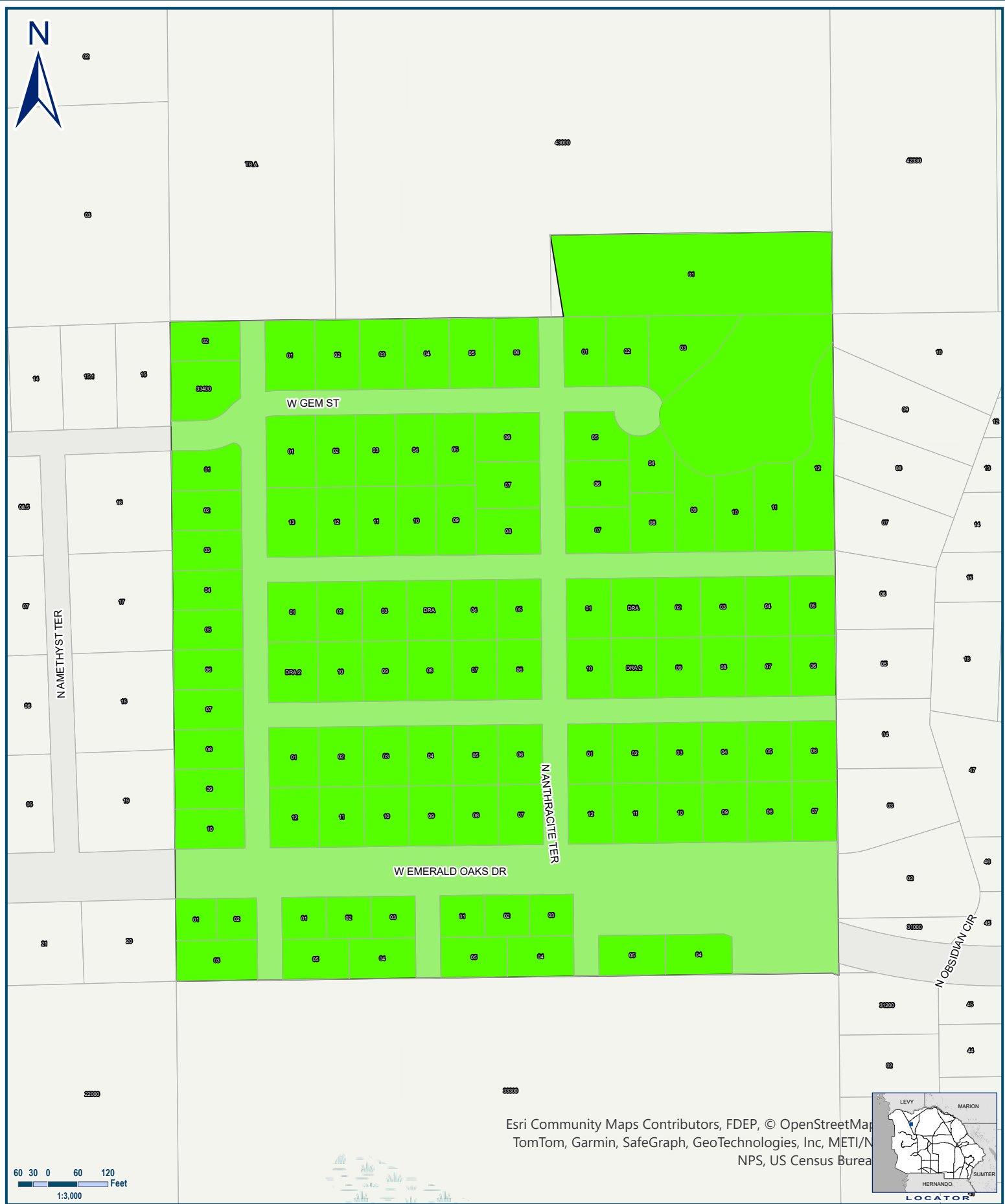

This information is for general information only. The Florida County Geographic Information System (GIS) data is provided as a public service and is not intended for use in any legal proceeding. The Florida County Geographic Information System (GIS) data is provided as a public service and is not intended for use in any legal proceeding. The Florida County Geographic Information System (GIS) data is provided as a public service and is not intended for use in any legal proceeding.



Esri Community Maps Contributors, FDEP, © OpenStreetMap, TomTom, Garmin, SafeGraph, GeoTechnologies, Inc, METI/NPS, US Census Bureau



Legend

-  Sanitary Sewer Private Operational Area
-  Corporate Boundary
-  Water Private Operational Area

Selected Private Owned Wastewater and Water Operational Area Map

SPRINGHORN WATER SYSTEM

Geographic Information Systems

Prepared By : Susan O'Connell  
Date: June 7, 2024  
Source: Enterprise Geodatabase  
Map Number: S0001526MapSeriesP

Cynthia P. Sheahon  
Director



This information is for general information only. The Florida County Geographic Information Systems Division makes every effort to provide accurate data and information as of the date of creation. However, no warranty is made by the Division as to the accuracy of the information. The County and the State of Florida are not responsible for any errors or omissions, including but not limited to, misstatements or omissions, or for any damages resulting from the use of this information, including but not limited to, misstatements or omissions, or for any damages resulting from the use of this information.

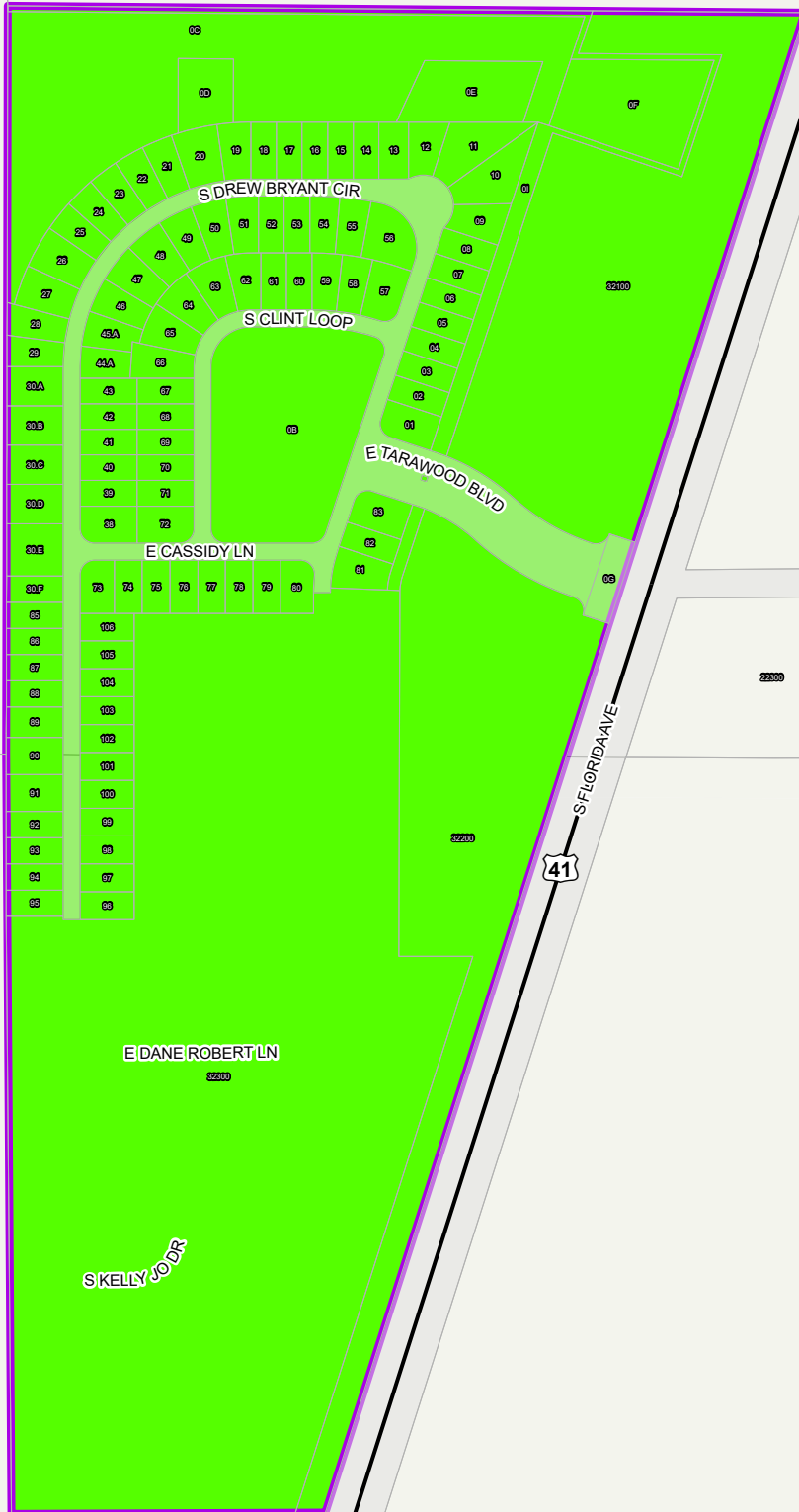

E DERBY OAKS DR

E PINTO CT

41

E DANE ROBERT LN

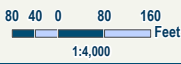

S KELLY JO DR



Esri Community Maps Contributors, FDEP, © OpenStreetMap, TomTom, Garmin, SafeGraph, GeoTechnologies, Inc, METI/NPS, US Census Bureau



LOCATOR

Legend	
	Sanitary Sewer Private Operational Area
	Corporate Boundary
	Water Private Operational Area

Selected Private Owned Wastewater and Water Operational Area Map  
**TARAWOOD**

**Geographic Information Systems**

Prepared By : Susan O'Connell  
 Date: June 7, 2024  
 Source: Enterprise Geodatabase  
 Map Number: SO001526MapSeriesP

Cynthia P. Sheahon  
Director



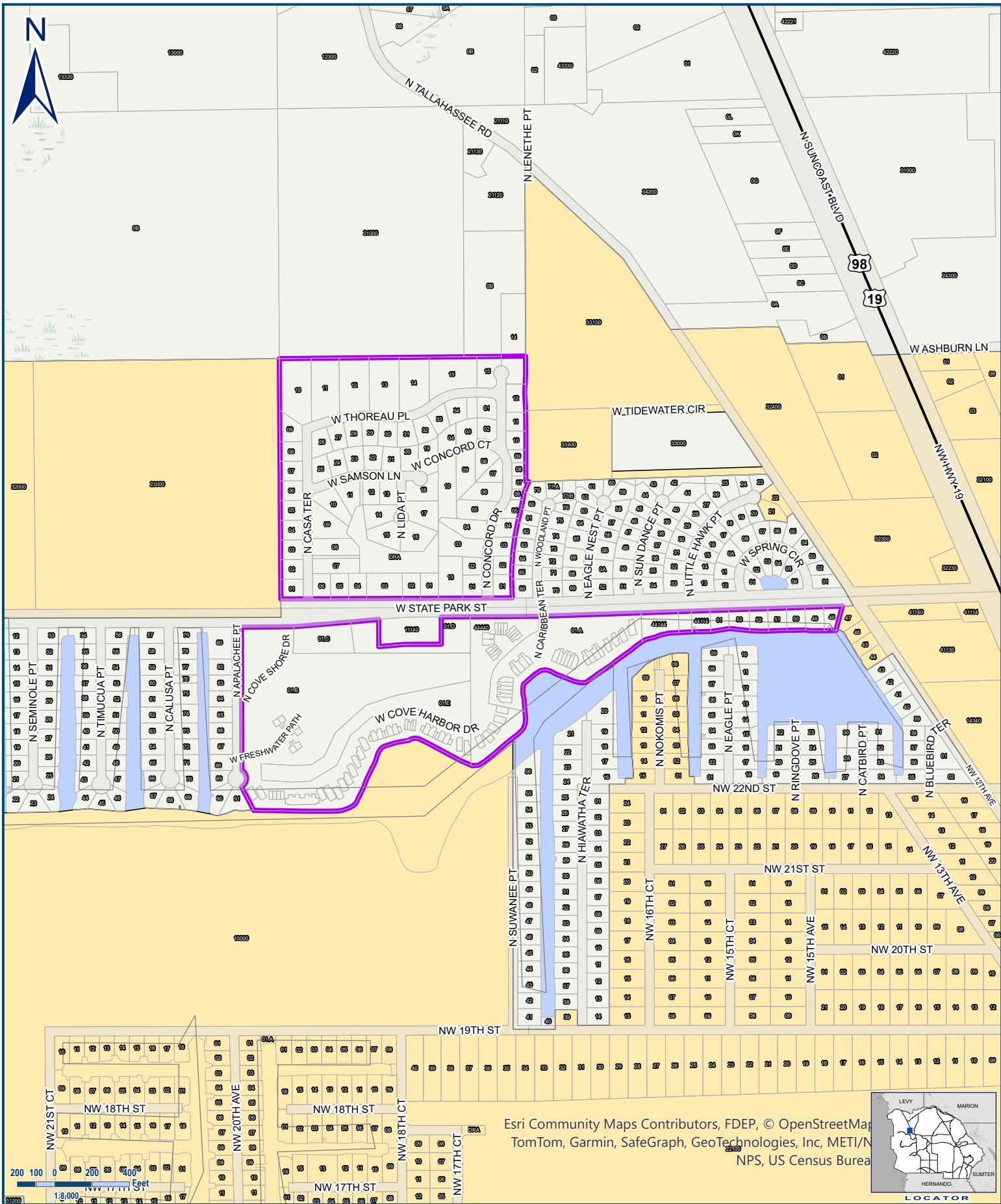

This information is for general information only. The Florida County Geographic Information System (GIS) system makes every effort to provide accurate data and information as of the date of the original release. However, no warranty is made by the State of Florida or any other entity for the accuracy, reliability, or completeness of the information. The County shall not be liable for any damage, including but not limited to, damages or losses caused by reliance upon the accuracy or completeness of the information and for liability arising out of reliance upon the information.



Esri Community Maps Contributors, FDEP, © OpenStreetMap  
TomTom, Garmin, SafeGraph, GeoTechnologies, Inc, MET/N  
NPS, US Census Bureau



- Legend**
-  Sanitary Sewer Private Operational Area
  -  Corporate Boundary
  -  Water Private Operational Area

Selected Private Owned  
Wastewater and Water  
Operational Area Map  
**INDIAN SPRINGS UTILITIES**

**Geographic Information Systems**  
Prepared By : Susan O'Connell  
Date: June 7, 2024  
Source: Enterprise Geodatabase  
Map Number: S0001526MapSeriesP



This information is for general informational purposes only. The Esri Community Maps Contributors, FDEP, © OpenStreetMap, TomTom, Garmin, SafeGraph, GeoTechnologies, Inc, MET/N, NPS, US Census Bureau, and Esri Community Maps Contributors do not warrant the accuracy, reliability, or completeness of the information provided. The Esri Community Maps Contributors, FDEP, © OpenStreetMap, TomTom, Garmin, SafeGraph, GeoTechnologies, Inc, MET/N, NPS, US Census Bureau, and Esri Community Maps Contributors are not responsible for any errors or omissions in this information. Esri Community Maps Contributors, FDEP, © OpenStreetMap, TomTom, Garmin, SafeGraph, GeoTechnologies, Inc, MET/N, NPS, US Census Bureau, and Esri Community Maps Contributors are not responsible for any damages, including but not limited to, direct, indirect, or consequential damages, arising from the use of this information.

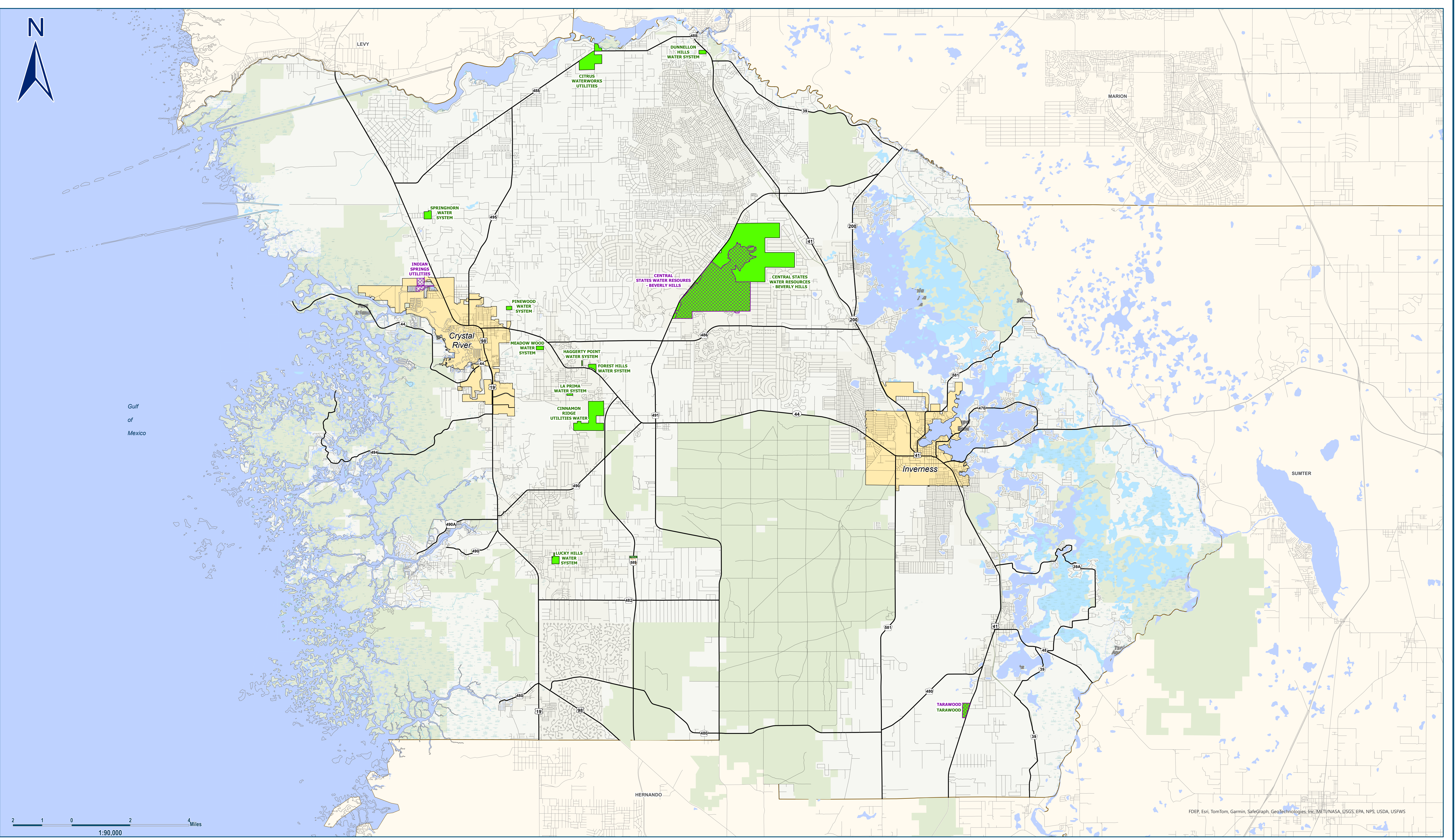

FDEP, Esri, TomTom, Garmin, SafeGraph, GeoTechnologies, Inc., METI/NASA, USGS, EPA, NPS, USDA, USFWS

**Legend**

- Water Private Operational Area
- Sanitary Sewer Private Operational Area
- Corporate Boundary

**Selected Private Owned Wastewater and Water Operational Area Map**

**Geographic Information Systems**

Prepared By : Susan O'Connell  
Date: June 7, 2024  
Source: Enterprise Geodatabase  
Map Number: SO001526P

Cynthia P. Skelhorn  
Director

This information is to be used for general purposes only. The Citrus County Geographic Information Systems Division makes every effort to provide content that is accurate and complete as of the date it is printed. However, all information provided must be independently verified by the user. Citrus County shall not be liable for any claims, demands, or losses of any kind in connection with the use of this information, including but not limited to, damages or losses caused by reliance upon the accuracy or timeliness of this information and the viewing, copying, or distributing of these materials.

